

1. thatched roof assembled to reed slats on a framework (50x50) creating a air cavity
Pavaflex Plus wood fibre insulation plank 180 mm (0,13 W/mK)
Pavaflex wood fibre insulation plank 100 mm (0,16 W/mK)
multiplex plank 18 mm
thatch mat as a finishing layer
pine construction with main frame beams 250x200 and horizontal secondary beams 70x200

2. Shou Sugi Ban burned accoya wood (EK Wood OÜ) 28x195
wooden framework 20x50
Pavaflex wood fibre insulation 160 mm (0,16 W/mK)
Pavaflex Plus wood fibre insulation 140 mm (0,13 W/mK) in timber frame construction
agepan DWD protect MDF 16 mm
plaster finish 10 mm

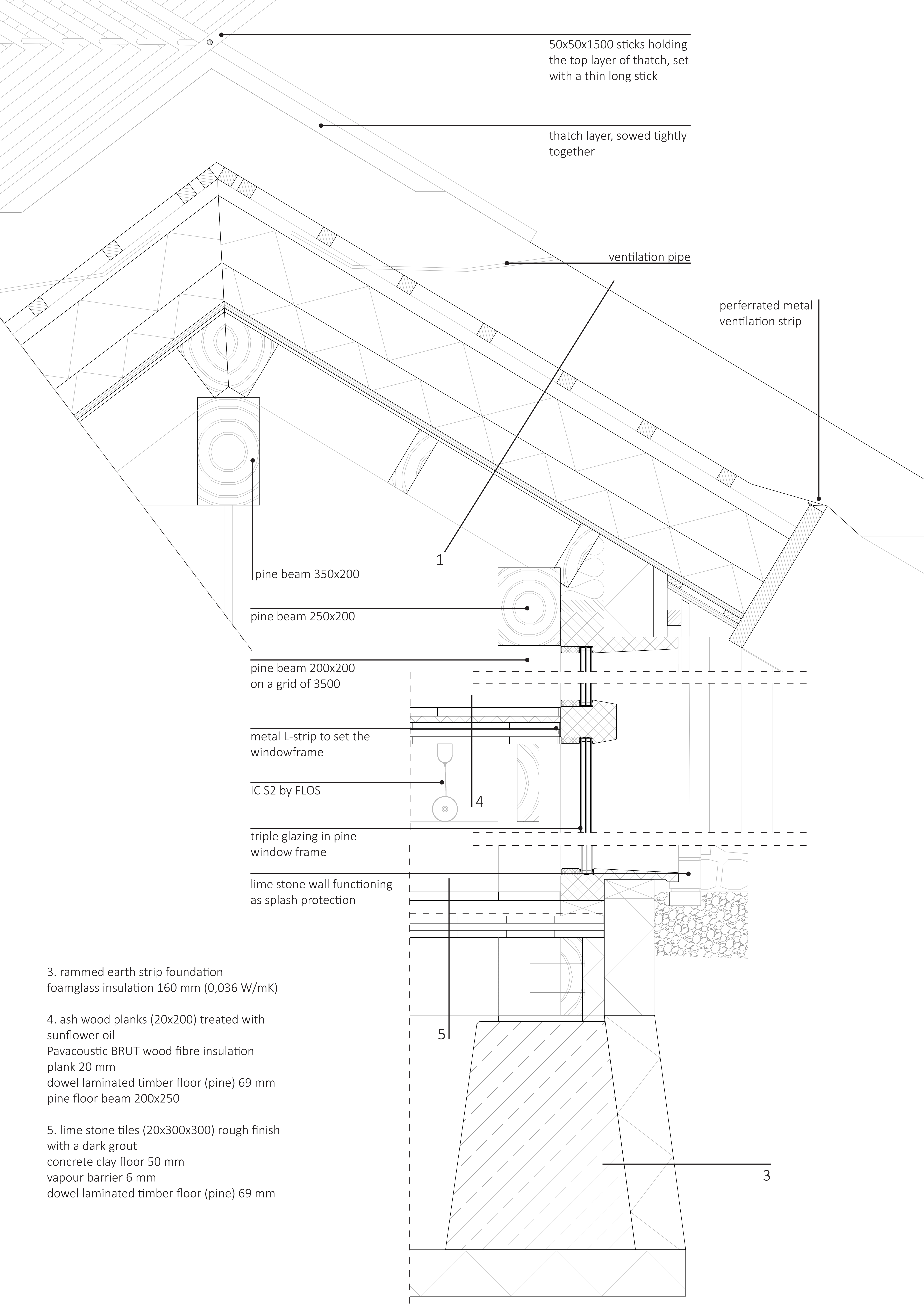

50x50x1500 sticks holding
the top layer of thatch, set
with a thin long stick

thatch layer, sowed tightly
together

ventilation pipe

perferrated metal
ventilation strip

pine beam 350x200

pine beam 250x200

pine beam 200x200
on a grid of 3500

metal L-strip to set the
windowframe

IC S2 by FLOS

triple glazing in pine
window frame

lime stone wall functioning
as splash protection

3. rammed earth strip foundation
foamglass insulation 160 mm (0,036 W/mK)

4. ash wood planks (20x200) treated with
sunflower oil
Pavacoustic BRUT wood fibre insulation
plank 20 mm
dowel laminated timber floor (pine) 69 mm
pine floor beam 200x250

5. lime stone tiles (20x300x300) rough finish
with a dark grout
concrete clay floor 50 mm
vapour barrier 6 mm
dowel laminated timber floor (pine) 69 mm