

Reflection

Interiors Buildings Cities Graduation project

Jiarui Xing 5992087



1. Relation between graduation project, master track, and MSc programme

My academic journey reflects a deepening and evolving relationship with architecture, systematically exploring a variety of design and analytical scales. Starting with my Masters, I progressed into the architecture profession, culminating in the “Interior Architecture Cities” studio, which guided my explorations from the urban scale to the built environment, to the building itself, and ultimately into the complex study of interior space. My graduate project focused on the theme of interior space, exploring the role of Desinger Architecture in the urban context and its wider impact on the city while conducting in-depth research and analysis. This approach emphasizes the interconnectedness between different scales, creating a dynamic and cyclical process where insights at one level guide and enrich the next. Through this journey, I have gained a comprehensive understanding of how architectural design integrates with the environment, and has promoted growth and innovation at each stage of exploration.

My final graduate project is a demountable archive design, which is a practical expression of the MSC project, thinking about architectural expression from the perspective of the entire life cycle of the building and sustainability.

2. Relationship between research and design

Before starting the design, I studied the historical stages of De Singel, including the functional spaces, design concepts and expressions of each historical stage, forming a relatively complex De Singel building community. At the same time, I also conducted research on the urban structure of Antwerp and the surrounding areas of De Singel, including residential areas, major urban roads and the relationship with the surrounding environment. These studies allowed me to discover many actual problems of De Singel, such as the chaotic flow caused by the complex historical stages, and the separation and isolation from the surrounding environment, which provided guidance for my design ideas and methods.

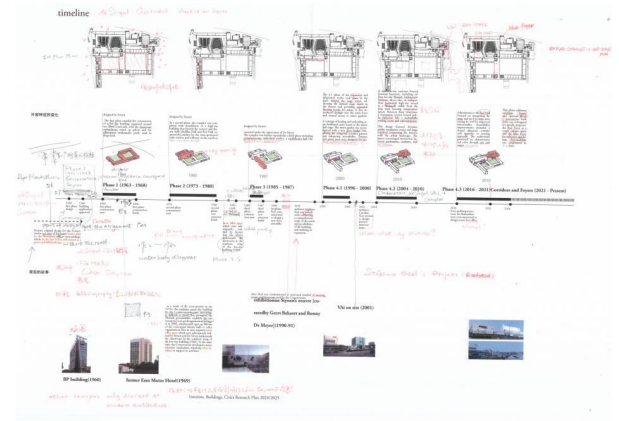

Timeline of Desinger Singel



City Structure (Antwerp)

At the same time, as my design ideas continue to advance, new questions will gradually arise, such as the choice of materials and structures, and the relationship between the expression of the facade and De Singel. These new problems arising from the design prompted me to conduct more in-depth research and investigation, including the internal sight relationship of De Singel and the influence of materials.

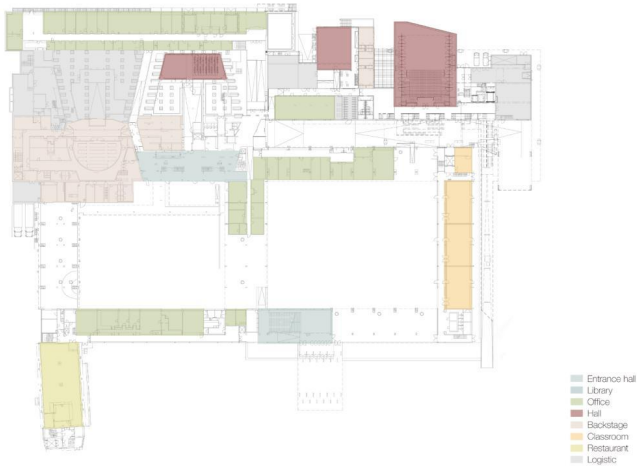

Function analyse

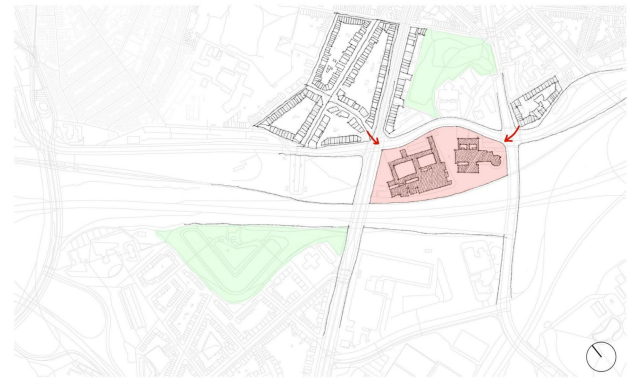

Site analyse

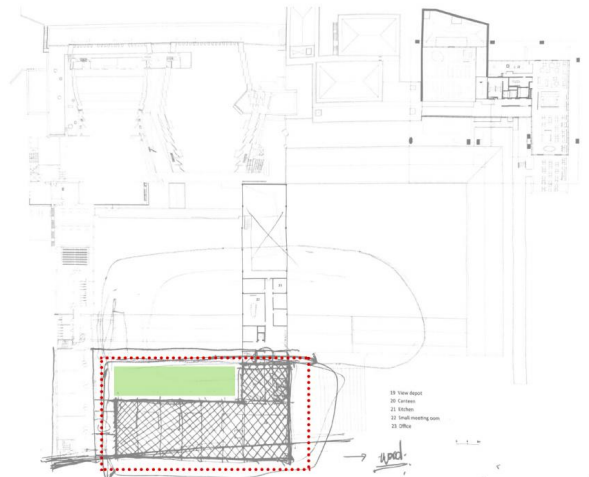
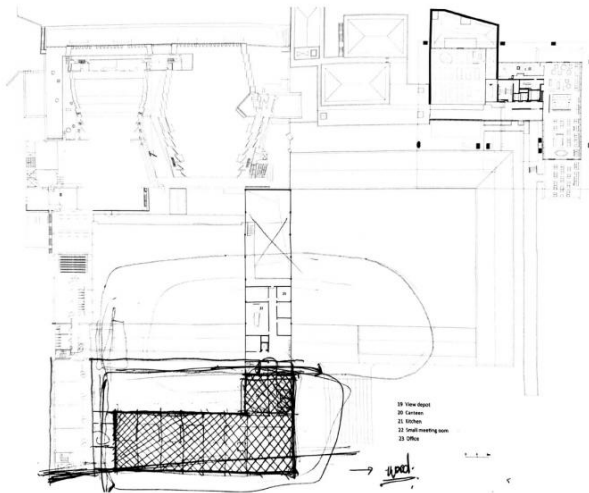

Analysis of connections and gardens

3. Assessment of the value of way of working

In my graduation project, I conducted site and historical research, participated in the production of site models and the production and analysis of large models of De Singel, and also analyzed many cases as design references, which made me more familiar with the functions, streamlines, historical stages and structures of De Singel, and explored the problems more deeply, which I think is also one of the prerequisites for design. At the same time, with the encouragement of the studio, the work of project journal is very valuable. The project journal helps me sort out the ideas of different design stages, as well as the workflow and reflection during the entire graduation project. In general, these methods help me sort out my design ideas and find my own direction in different design stages. The continuous modification and deepening of the design plan, and finally reaching a complete plan that combines logic and practicality, have a profound impact on my future architectural learning and work path.

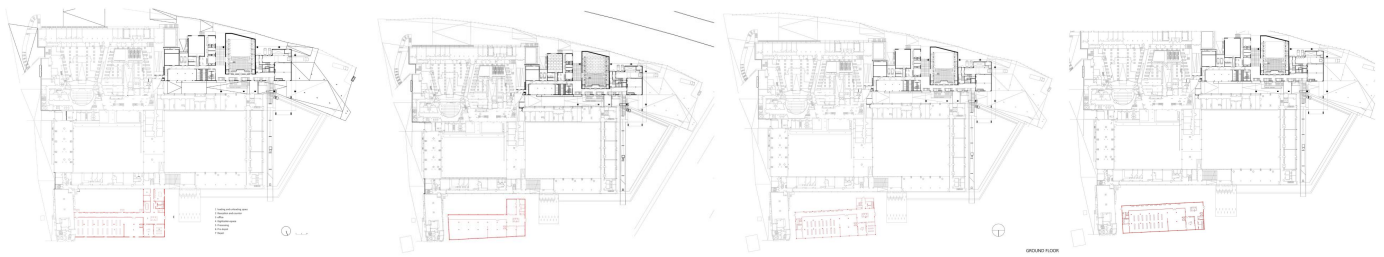

Design process

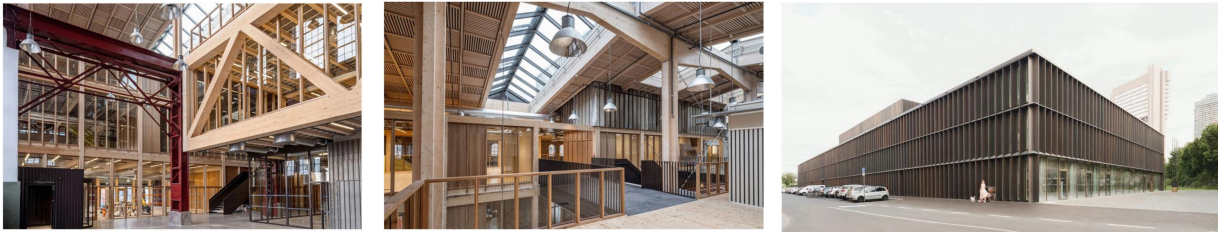

Reference: Gjuteriet Renovation /Kjellander+ Historical Archive of Cologne/Waechter

4. Assessment of academic and societal value, scope and implication

I designed a detachable and sustainable archive that is connected to De Singel. I hope to explore an industrial building and consider its recyclability and sustainability from the whole life cycle. On the social level, the all-wood structure and sustainable design strategy help an environmentally friendly society. At the same time, in terms of the relationship between archive and exhibition, I try to link archive and exhibition space together to break the serious atmosphere of archive space and let more people understand and recognize it.



Wood structure system

5. Value of transferability of project

Sustainability and the entire life cycle of buildings are one of the main issues we face today and one of the future development trends. My design space type is a grid space with a detachable working method, so it can be applied to different offices and exhibitions, or even temporary places.

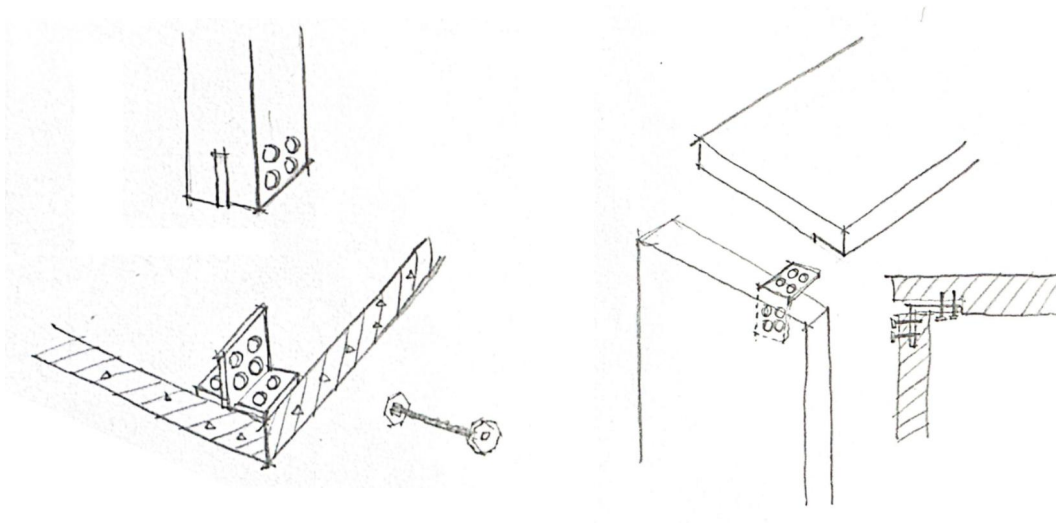

Demountable structure

6. Reflection questions to my work

1. How to balance the humidity and temperature control of the archive while considering sustainable structure?
2. How to combine interior design with urban experience?