

**PRESENTATION**

**MIXED-USE URBANITY**

**MAARTEN DE ROIJ 4085477**

MSC 4 FINAL PRESENTATION 11-11-16  
DWELLING STUDIO: DUTCH HOUSING

# Amsterdam wil 70.000 woningen bouwen



De gemeente Amsterdam presenteerde het plan waarin staat hoe de stad zich de komende decennia in grote lijnen moet ontwikkelen. Foto ANP © UNKNOWN



14 OKTOBER 2009, 11:10

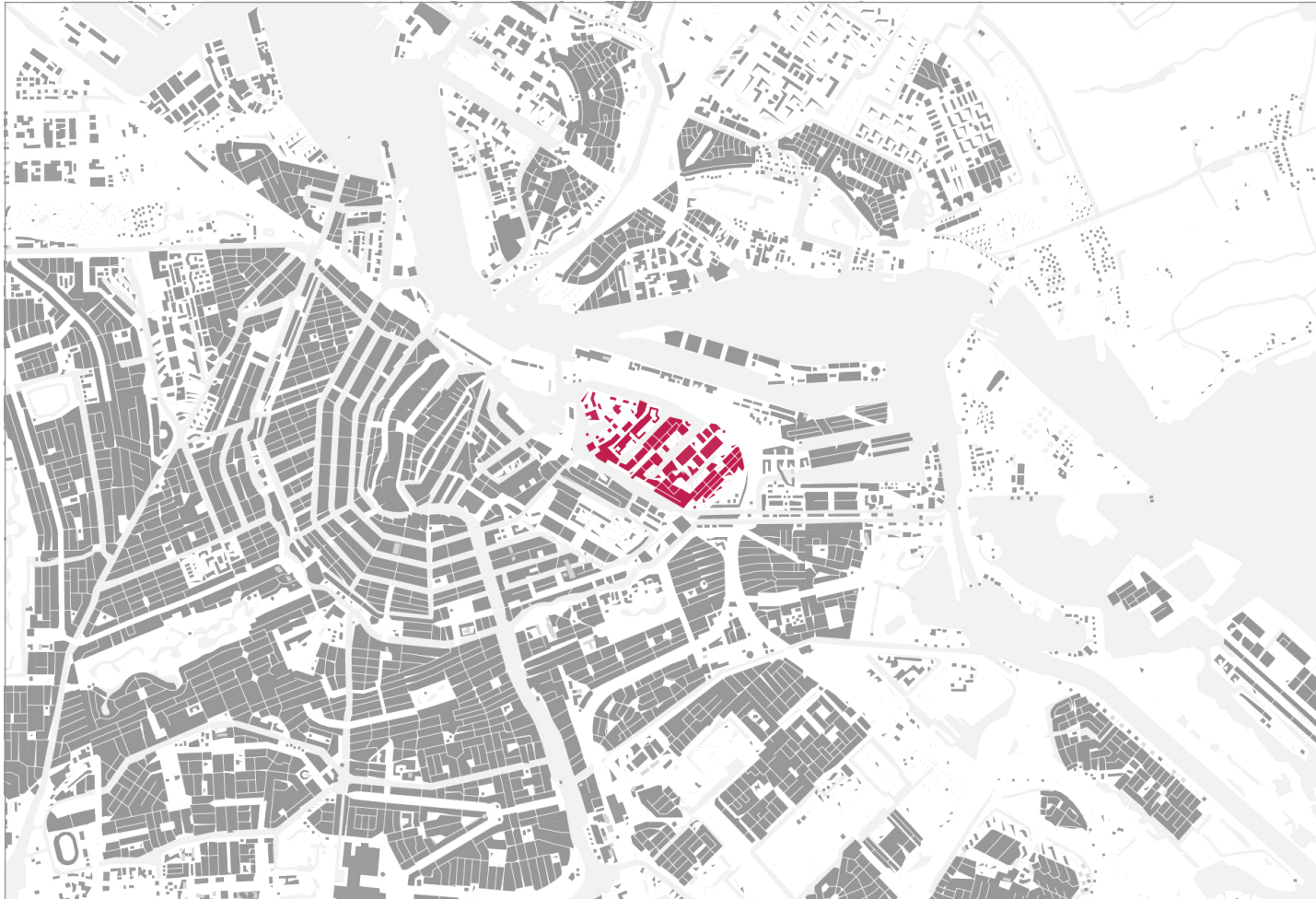

TARGET LOCATION: OOSTELIJKE EILANDEN







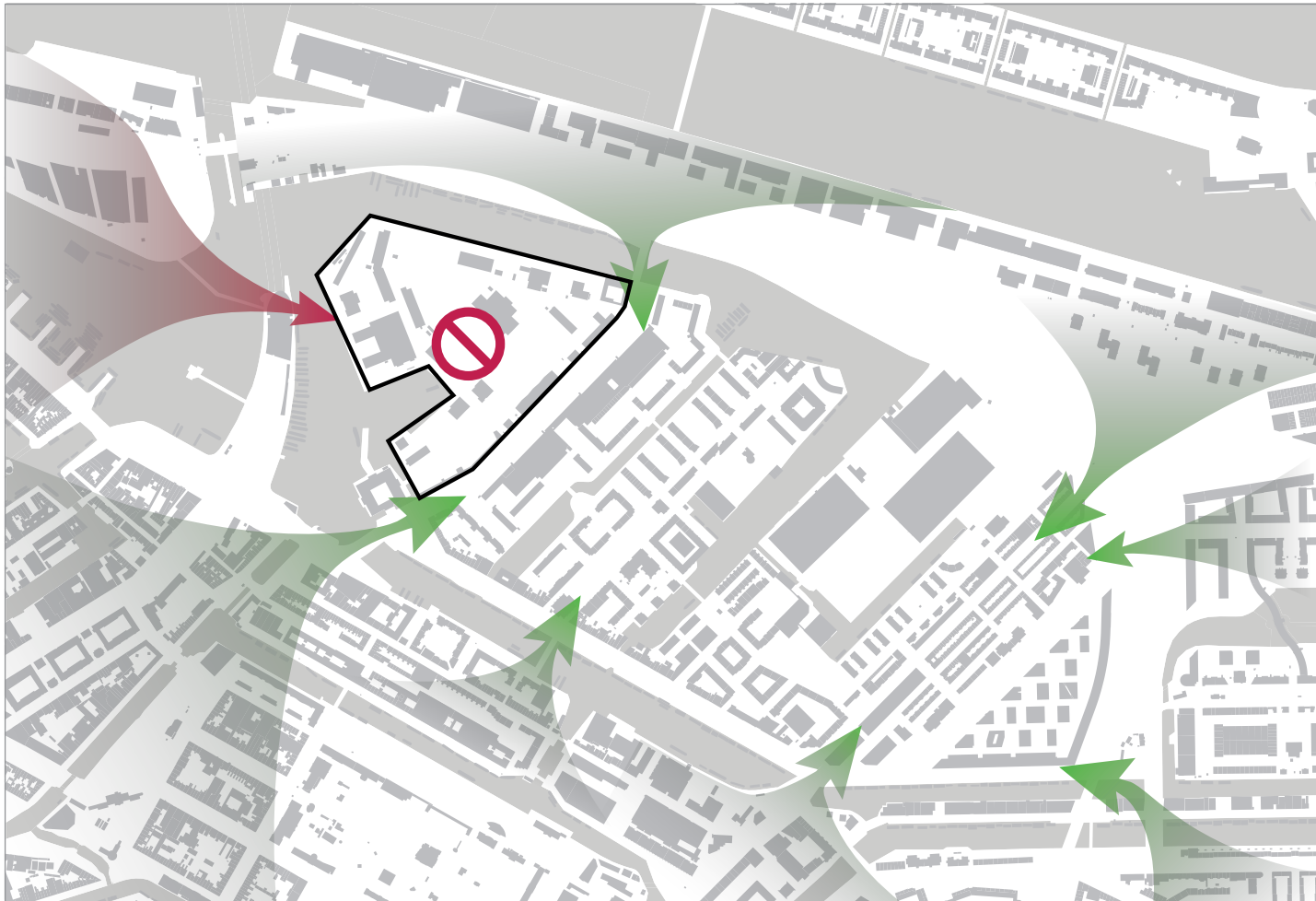

BADLY CONNECTED TO THE CITY

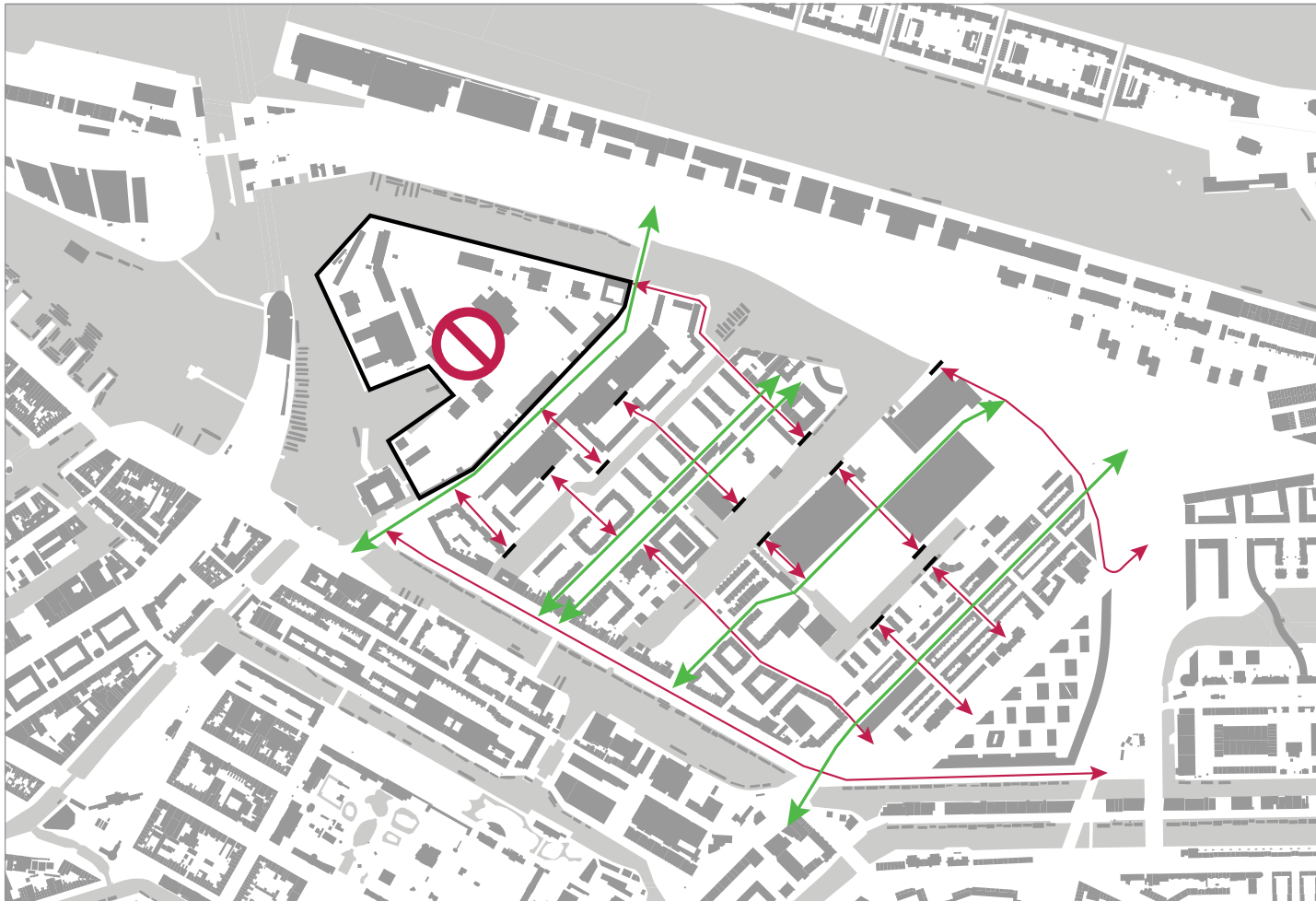

MISSING EAST WEST CONNECTIONS

# THE LOOP STRATEGY

**Similar functions** are **linked together**, which **strengthen** and **enhances** each of them.

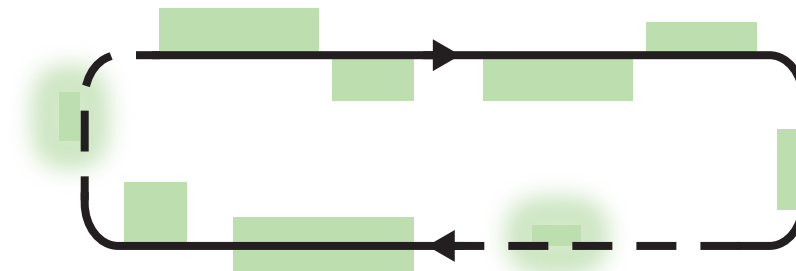



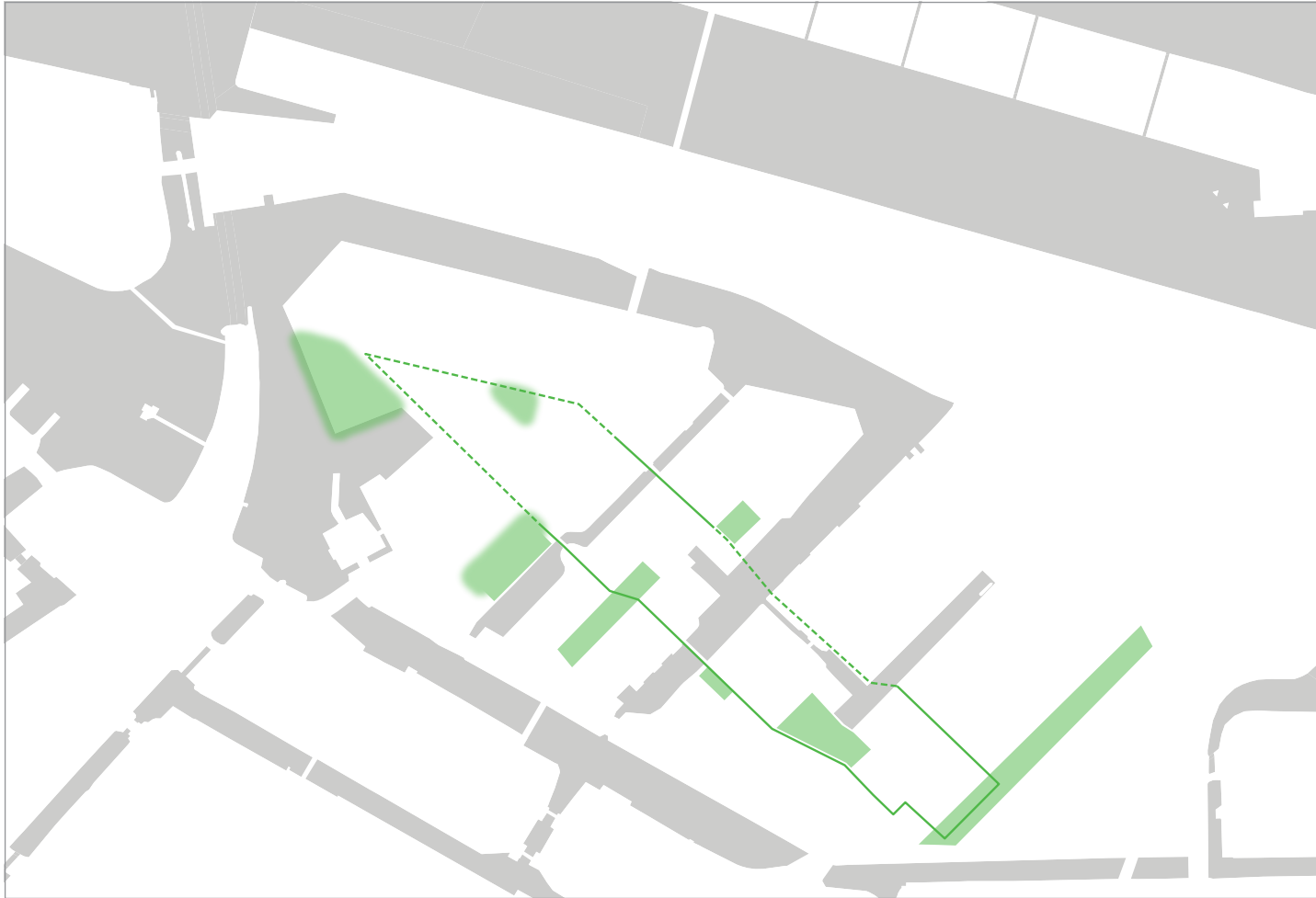

PARK LOOP



LOCAL FACILITIES LOOP

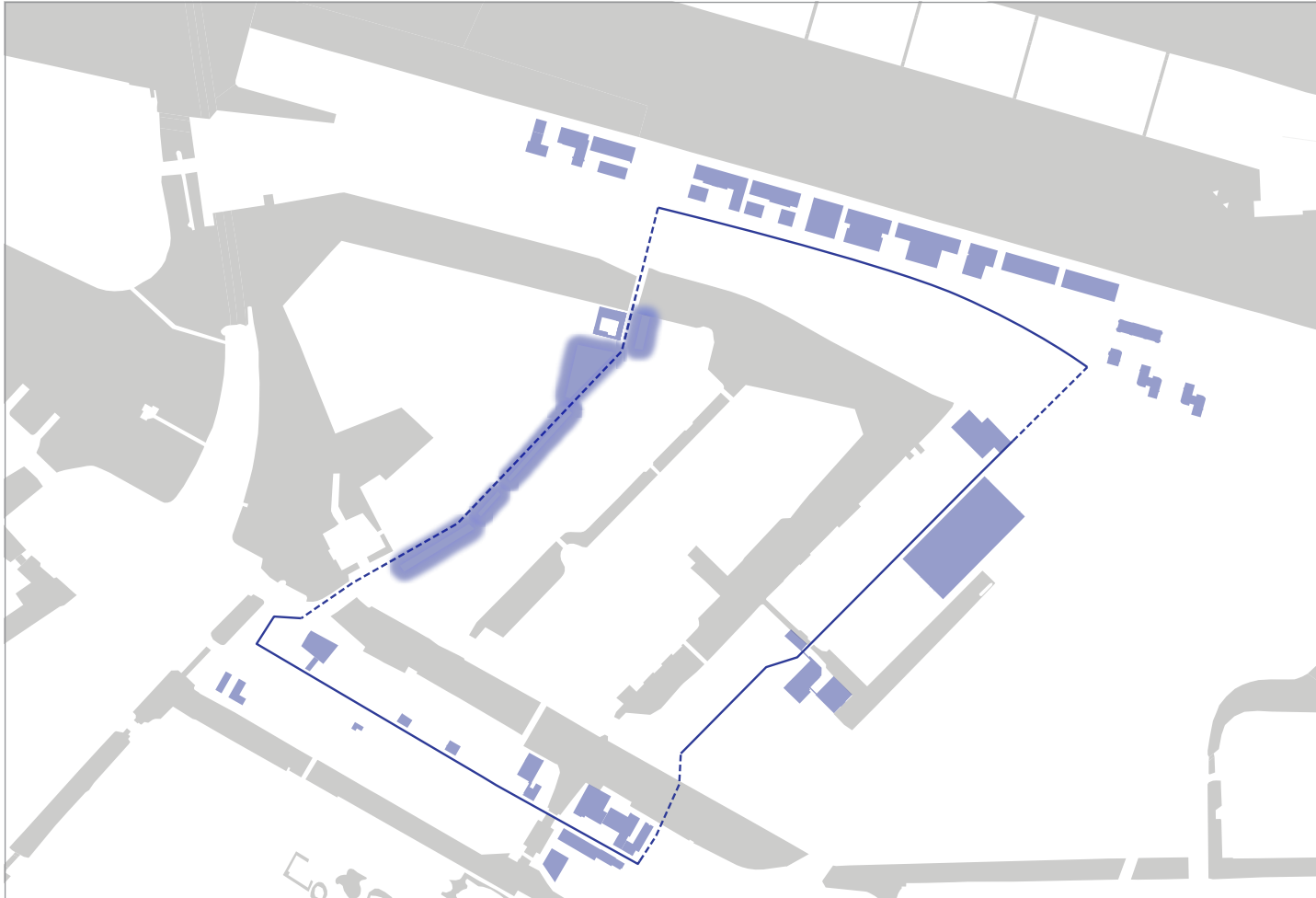

BUSINESS LOOP

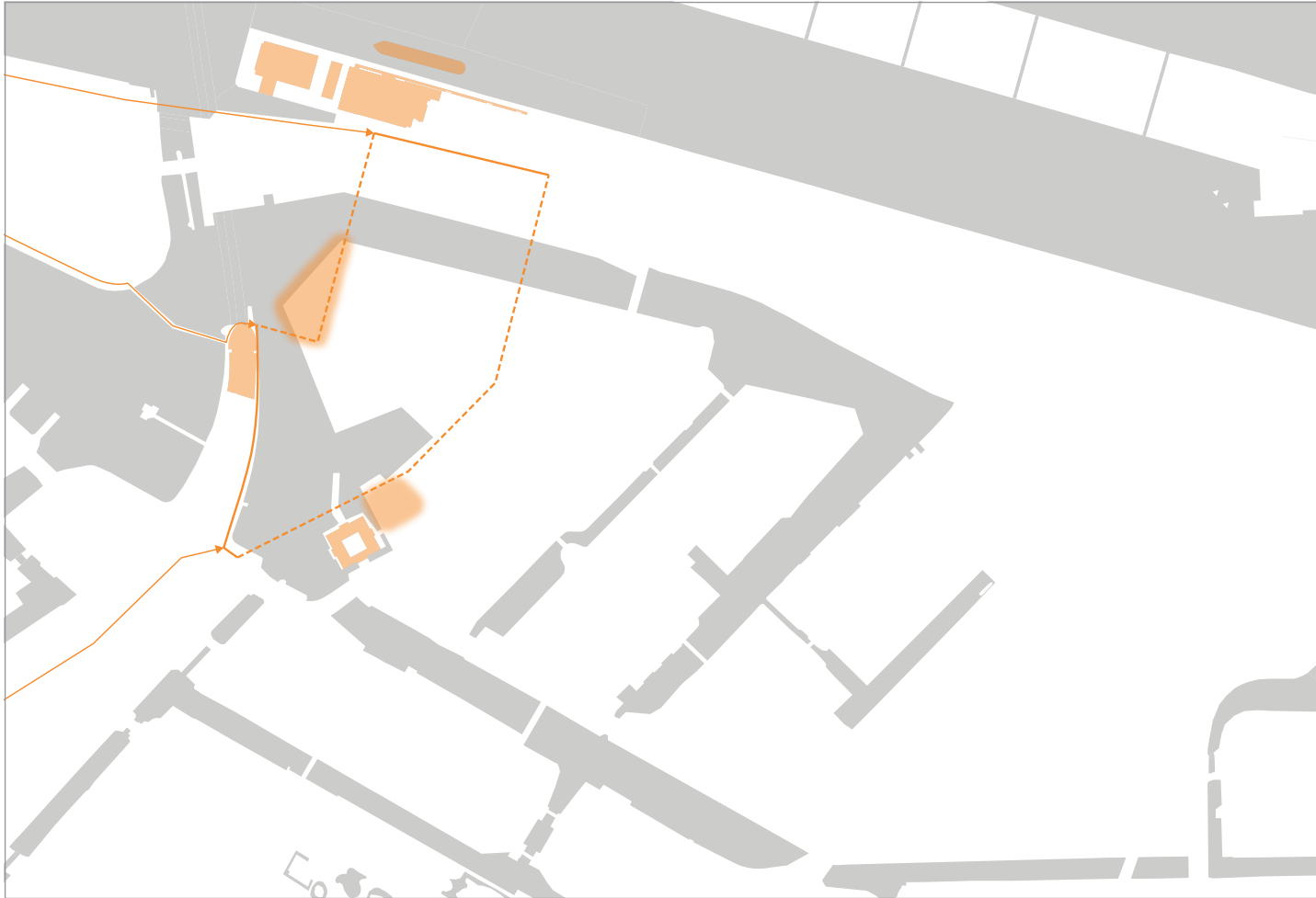

TOURIST LOOP



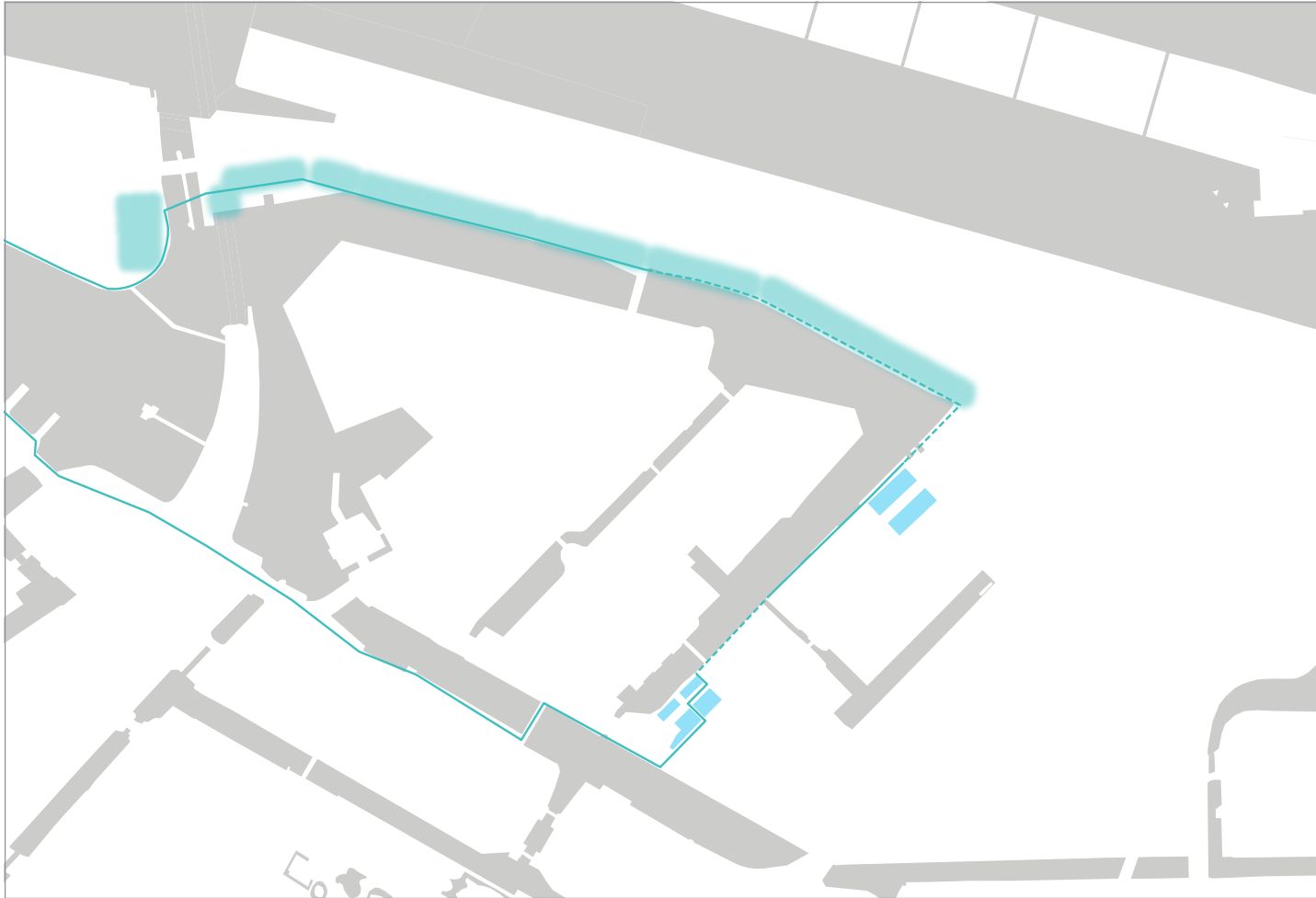

NEW WATER DEVELOPMENT LOOP

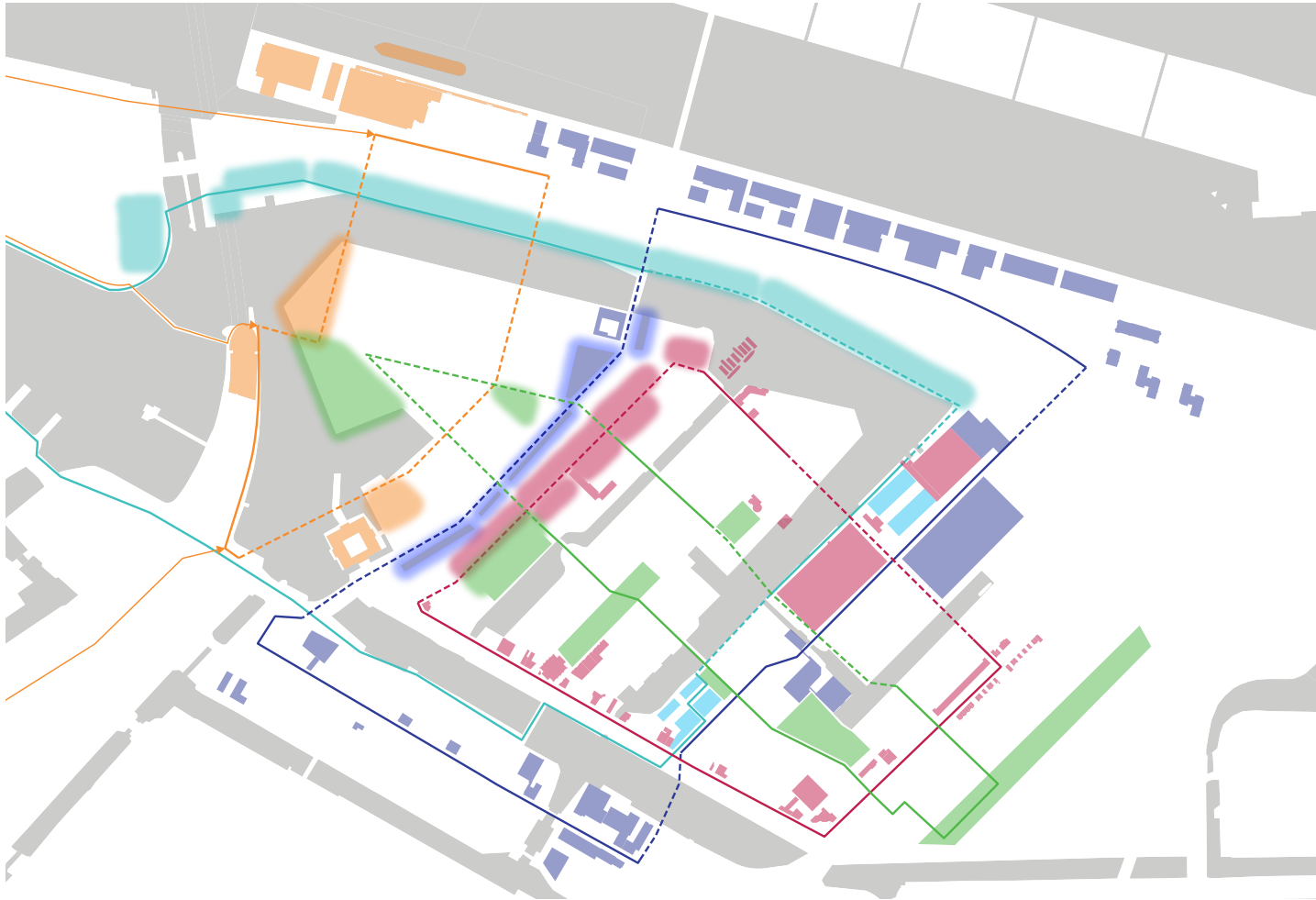

LOOP MASTERPLAN

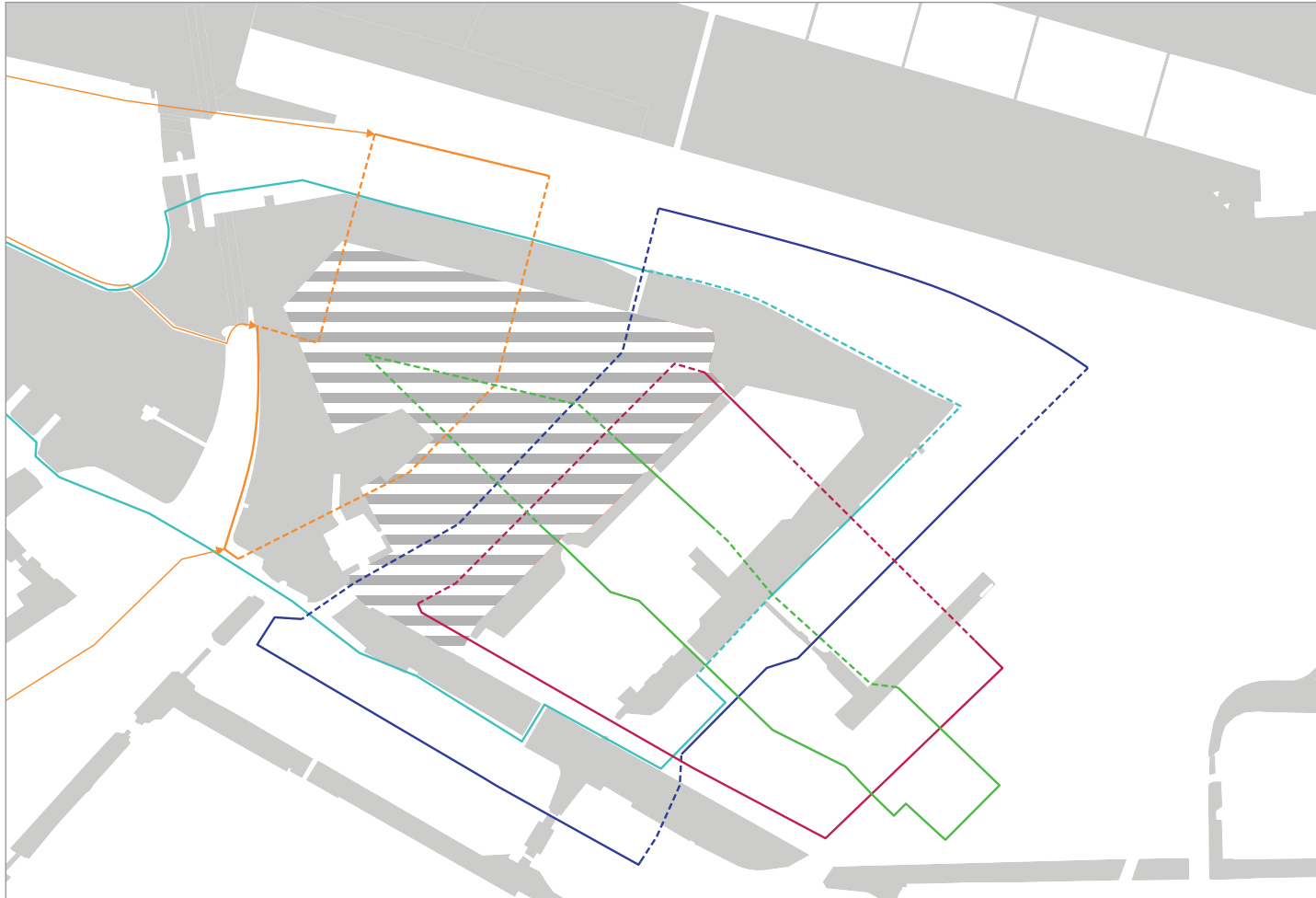

KATTENBURG: THE MISSING LINK

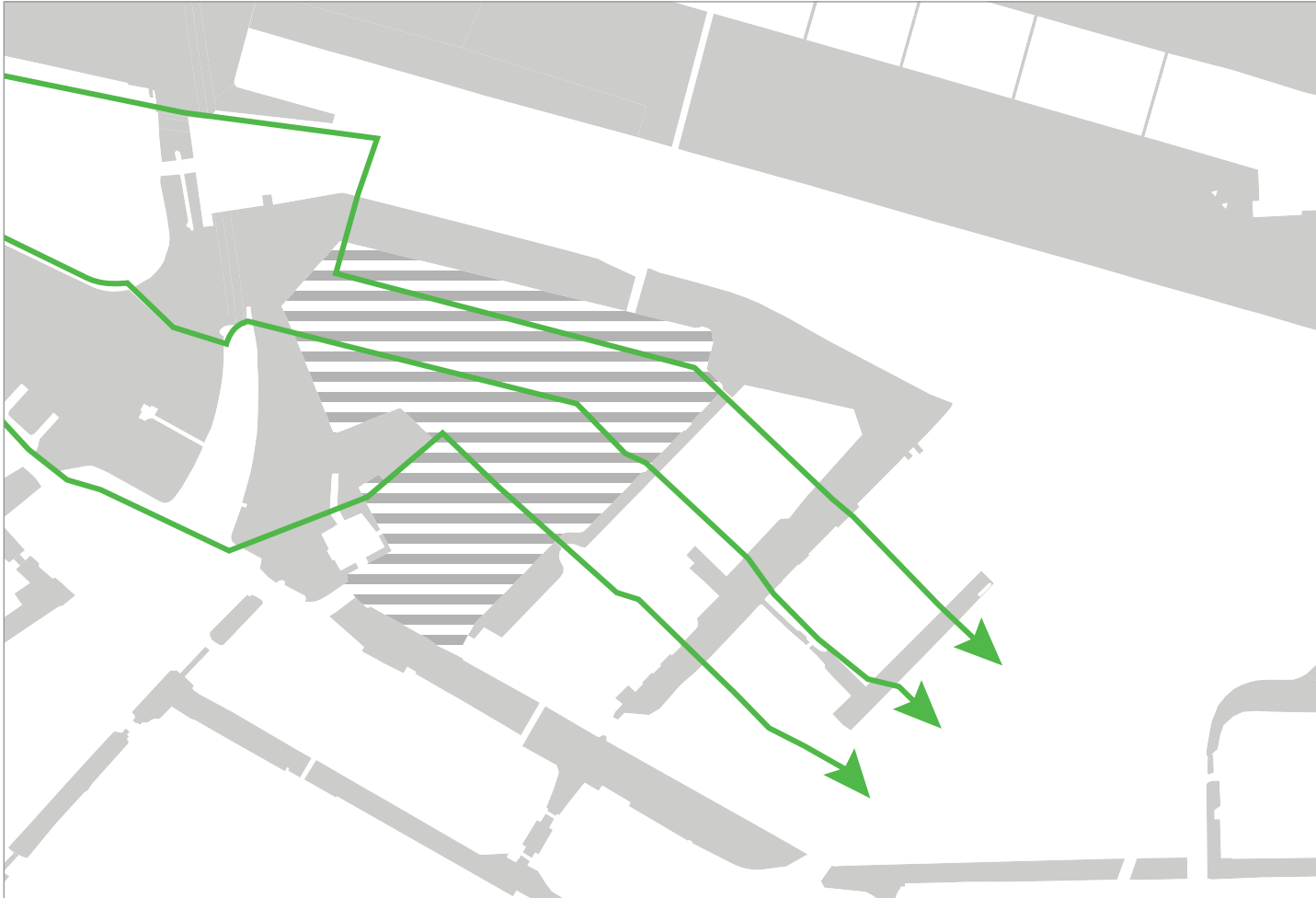

NEW EAST WEST CONNECTION



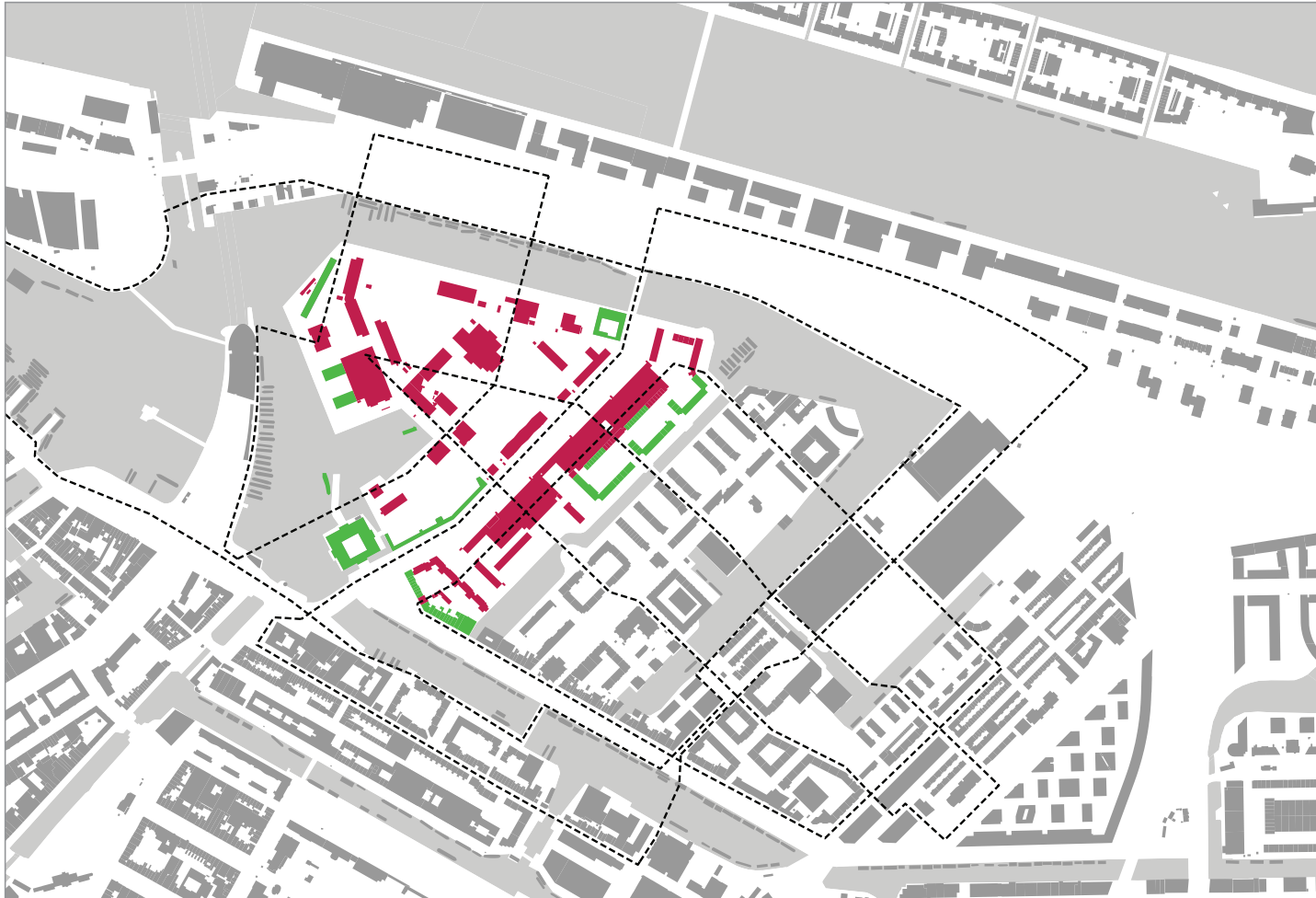

BUILDING TO DEMOLISH



**SCHEEPVAARTMUSEUM**  
 Historic building  
 Houses the navy Dutch navy museum



**MARINE 70'S BUILDING**  
 Recently renovated  
 Government/navy office building



**GEBOUW 027E**  
 Recently renovated  
 Has a new educational function



**HISTORIC BUILDING**  
 Old navy building  
 Bars or cafés can be connected to the park by placing their terrace in the green.



**KATTENBURGERSTRAAT  
 "WALL"**  
 Historic building  
 Located at the beginning on the west side of the Kattenburgerstraat.



**DCWS BUILDING**  
 New building  
 Will be a training center for the the navy



**KATTENBURGERPLEIN**  
 Protected Cityscape buildings  
 Even though the buildings look old, they are from the 30's.



**KATTENBURG DWELLINGS**  
 Social housing  
 Dwellings at waterfront have the highest quality and fits into the loop masterplan, but they still need drastic transformation



COURTYARD BLOCKS MASTERPLAN

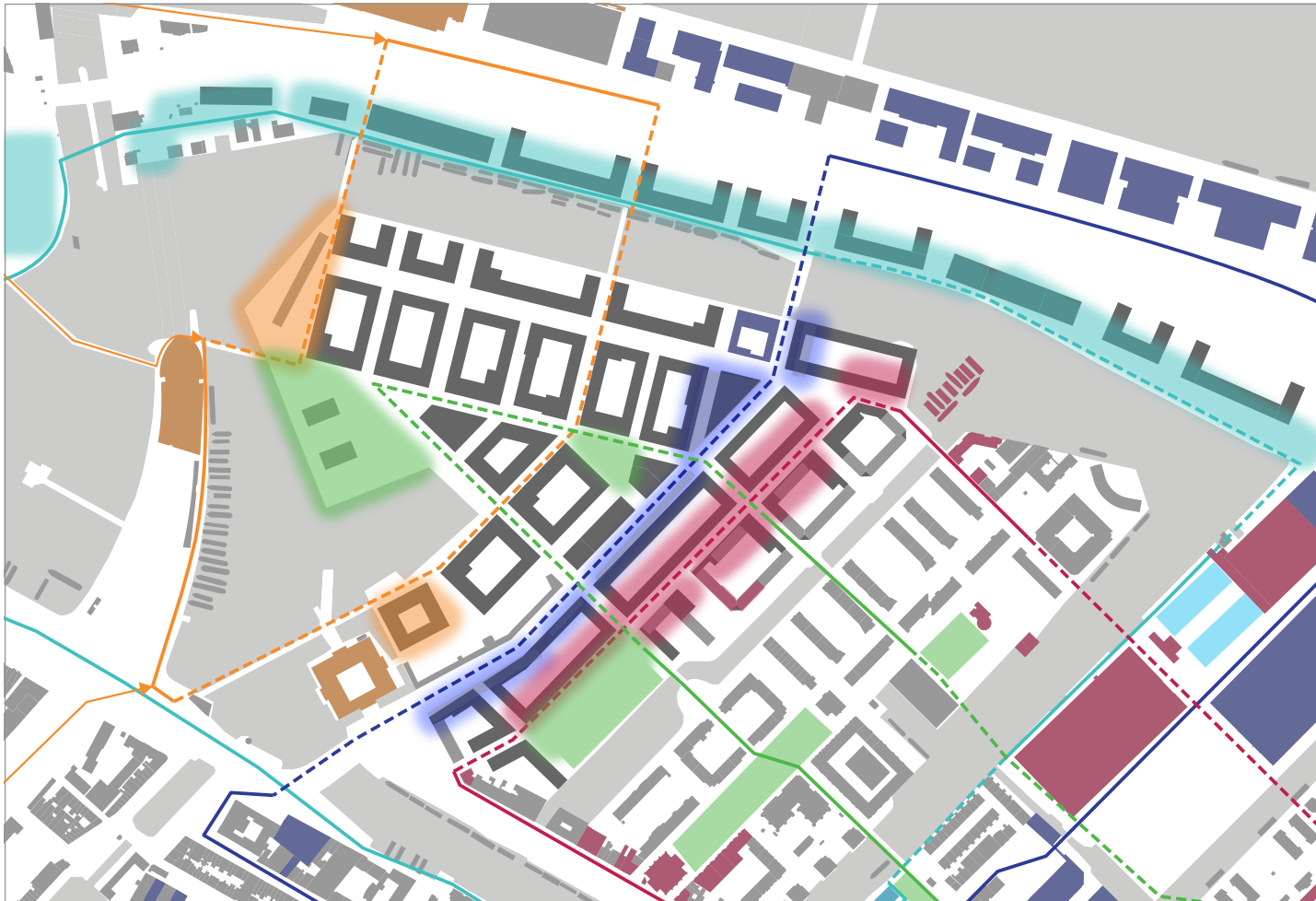

HIGHLY MIXED USED AREA





CENTRAL MIXED USE SITE



# **ARCHITECTURAL ASSIGNMENT:**

A MIXED USE BUILDING WITH A FOCUS ON DWELLINGS.

## **MY RESEARCH QUESTION:**

How can **different functions** be **combined** in a residential building in a way that they will **strengthen** and **enhance** each of them to create a **stronger mixed-use-building**?



Connection between functions

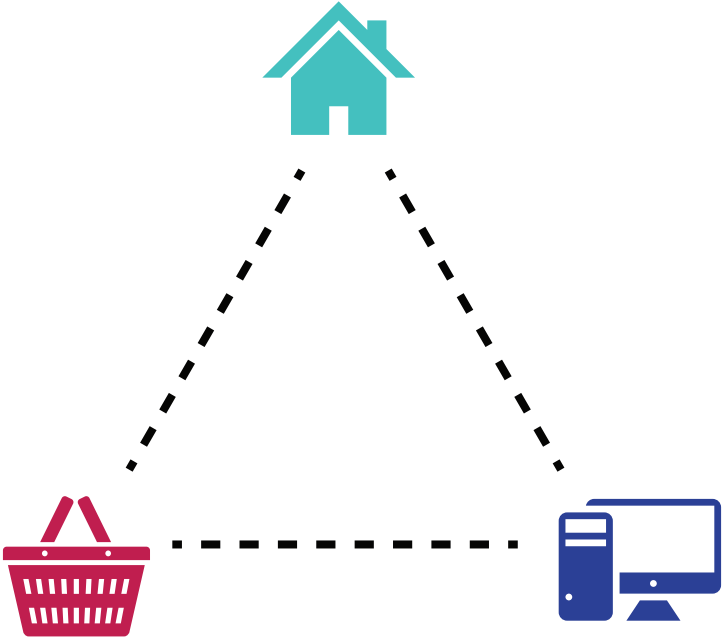

CONNECTIONS BETWEEN FUNCTIONS









shared utilities



SHARED FUNCTIONS



multiple functions

FUNCTION MATRIX	IDEAL ORIENTATION	ON GROUND FOOR	PREFERED LEVEL IN BUILDING	PUBLICNESS
	SOUTH	NO	HIGH	low
	SOUTH	NO	N/A	MEDIUM
	NORTH	YES	MEDIUM	HIGH
	NONE	YES	LOW	MEDIUM
	N/A	YES	LOW	HIGH
	NORTH	YES	N/A	MEDIUM

DIVERSE PROGRAM



3D Adaptable

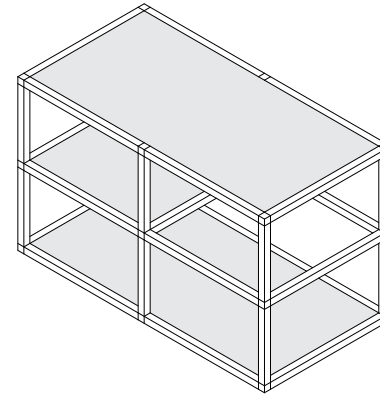
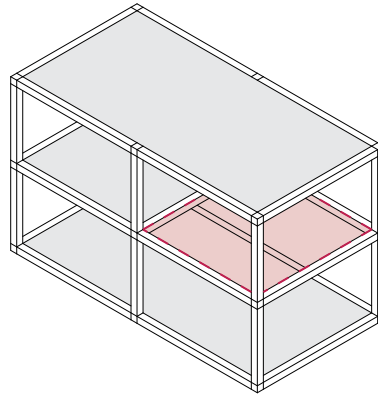
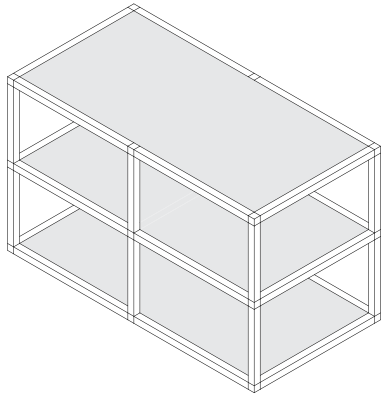

ADAPTABLE OVER TIME

**1+1=3**

Added value

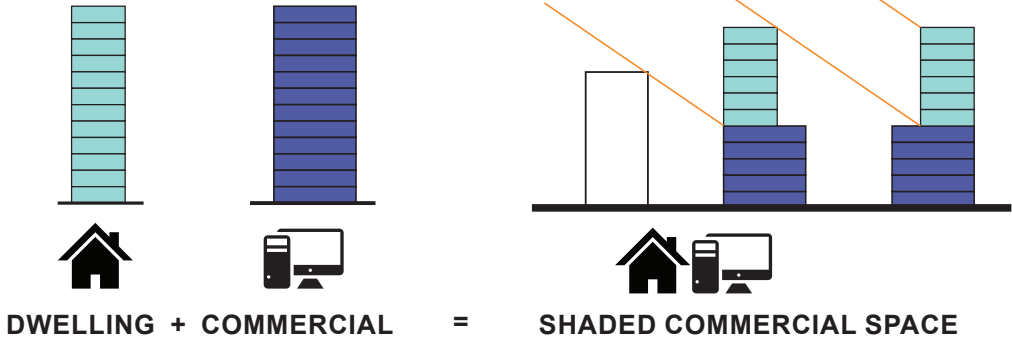

ADDED VALUE TROUGH COMBINATION



mixed use building



multiple functions



Connection between functions



3D Adaptable



Added value



shared utilities

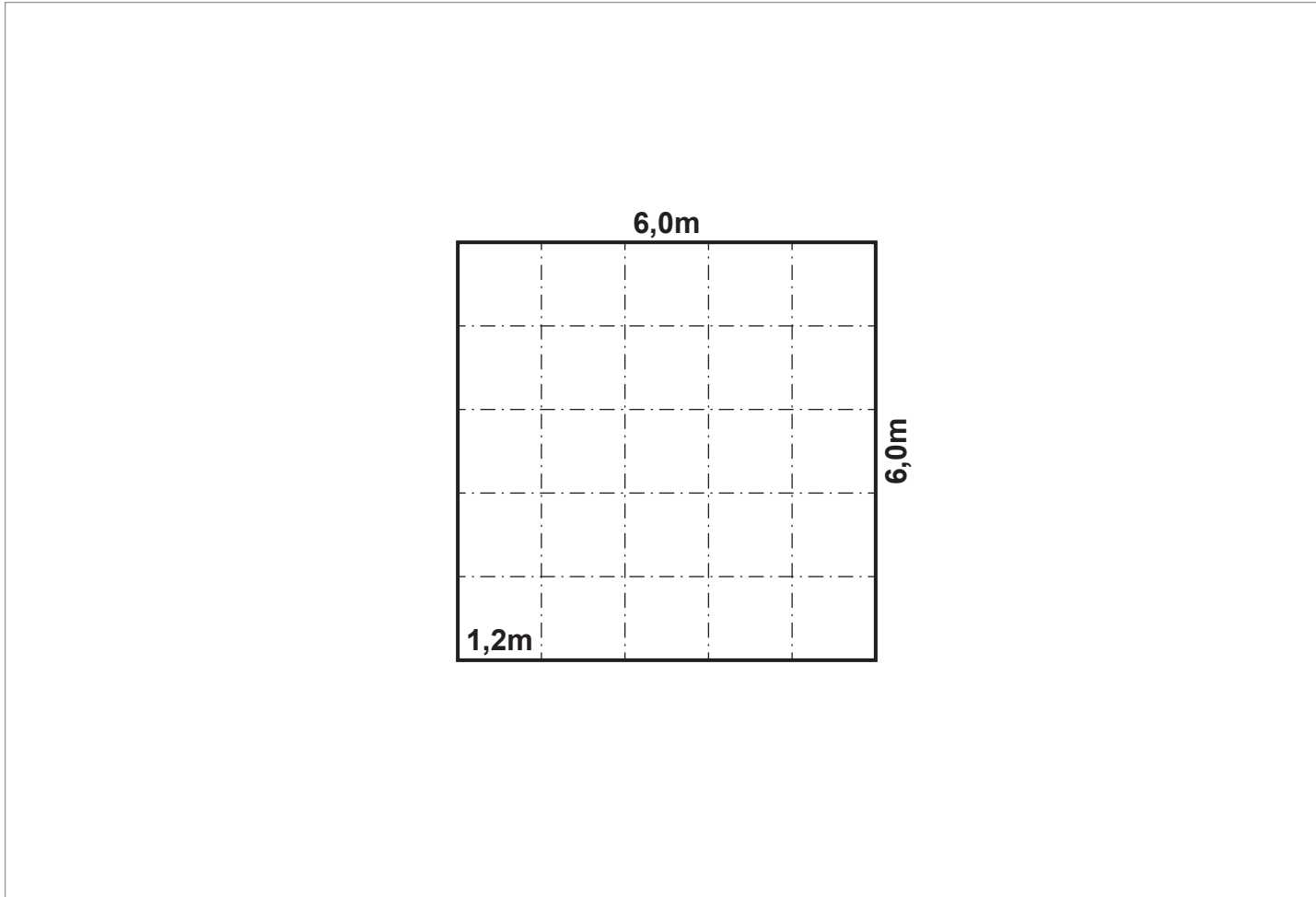



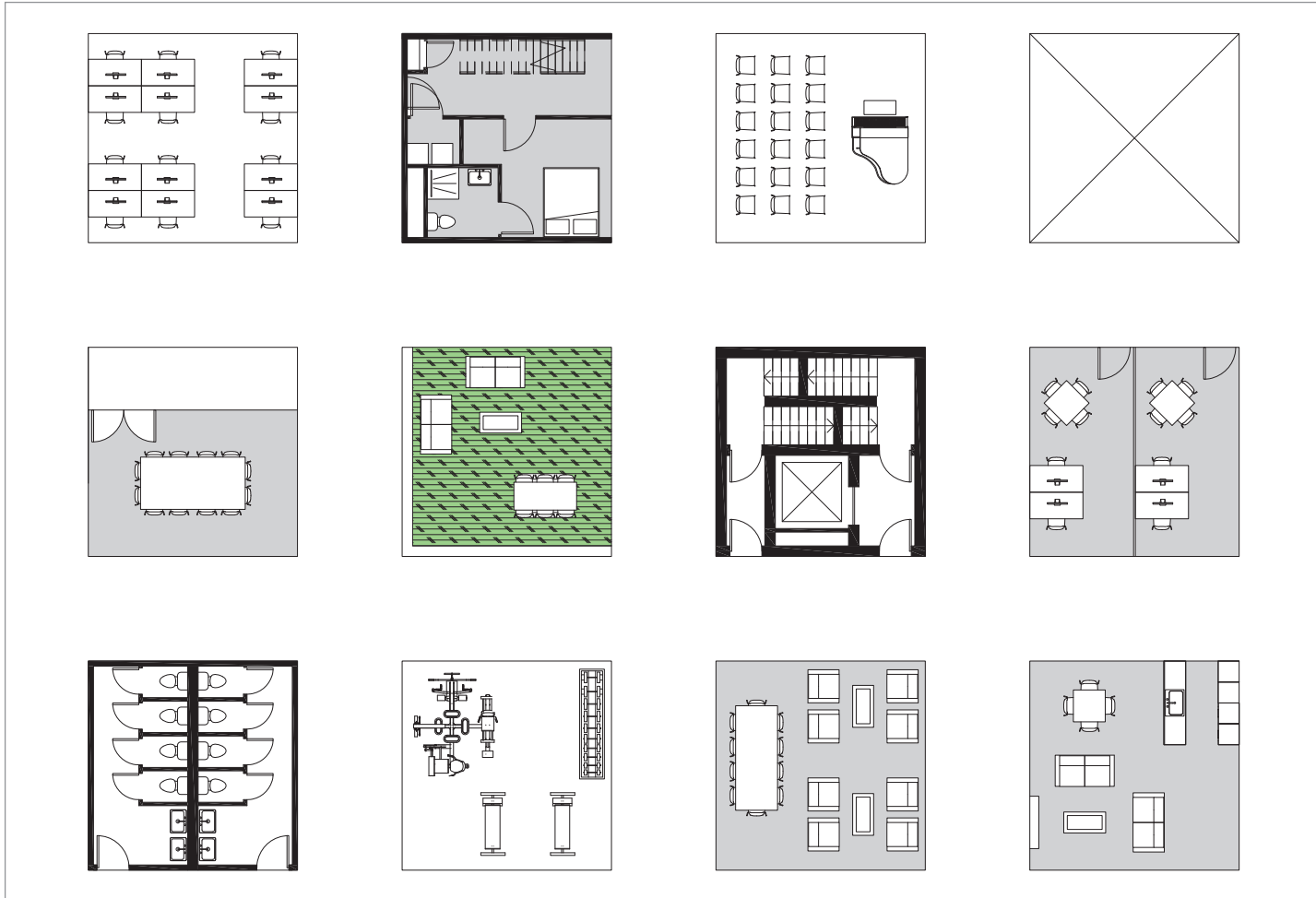



COMMERCIAL VS DWELLING USE

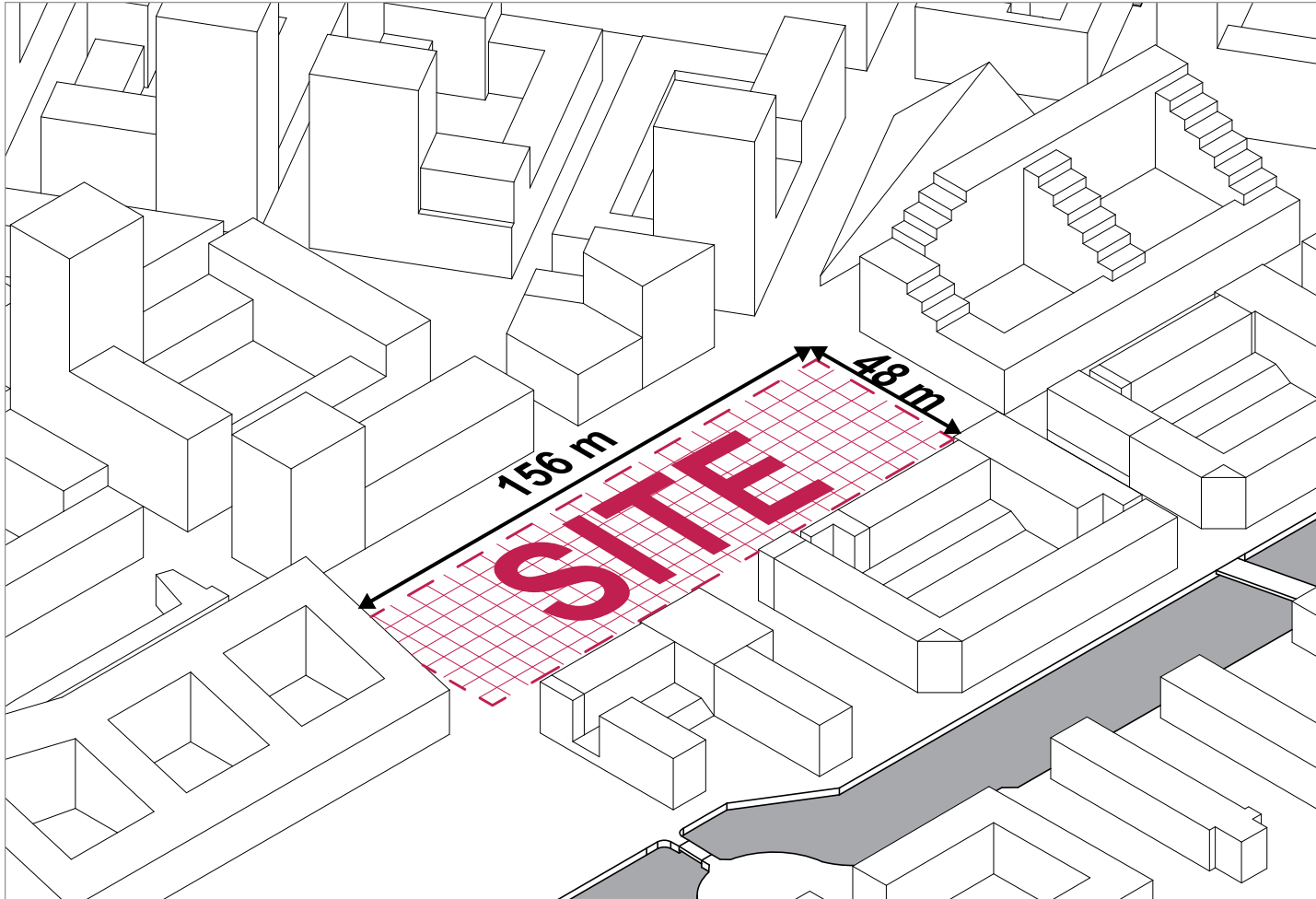

6X6M GRID PROJECTED ON THE SITE

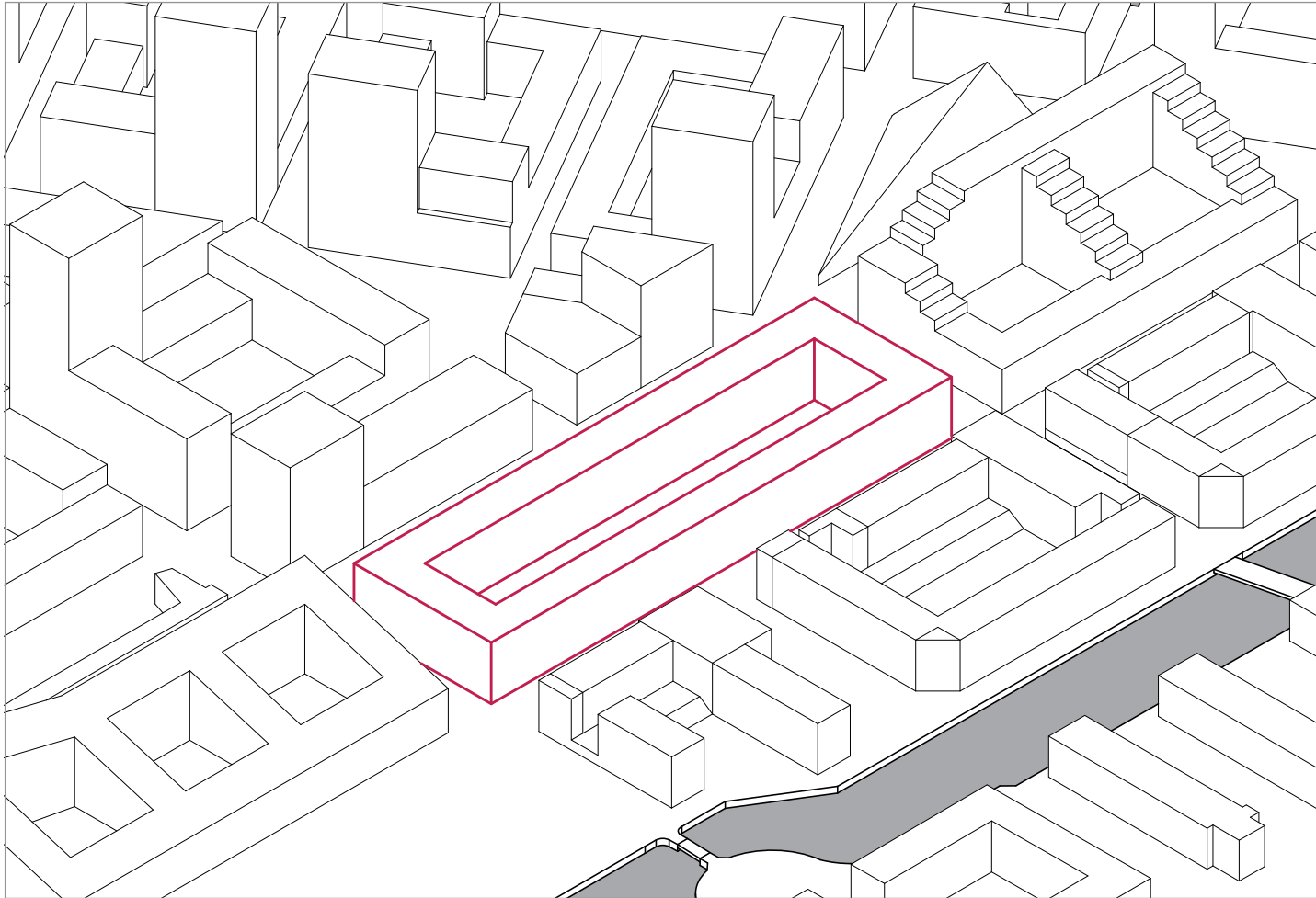

COURTYARD BLOCK

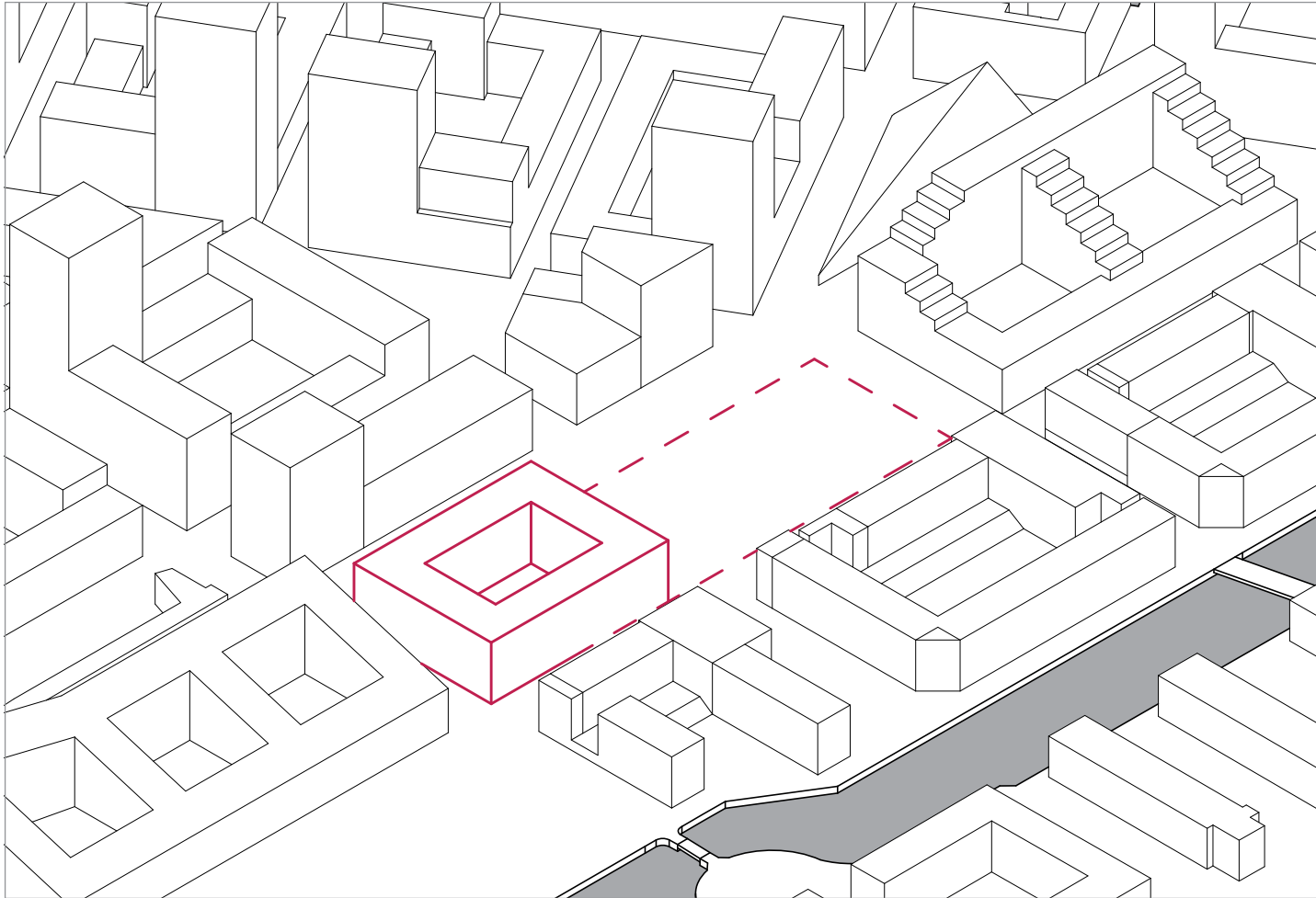

SMALLER COURTYARD FOR INTERACTION

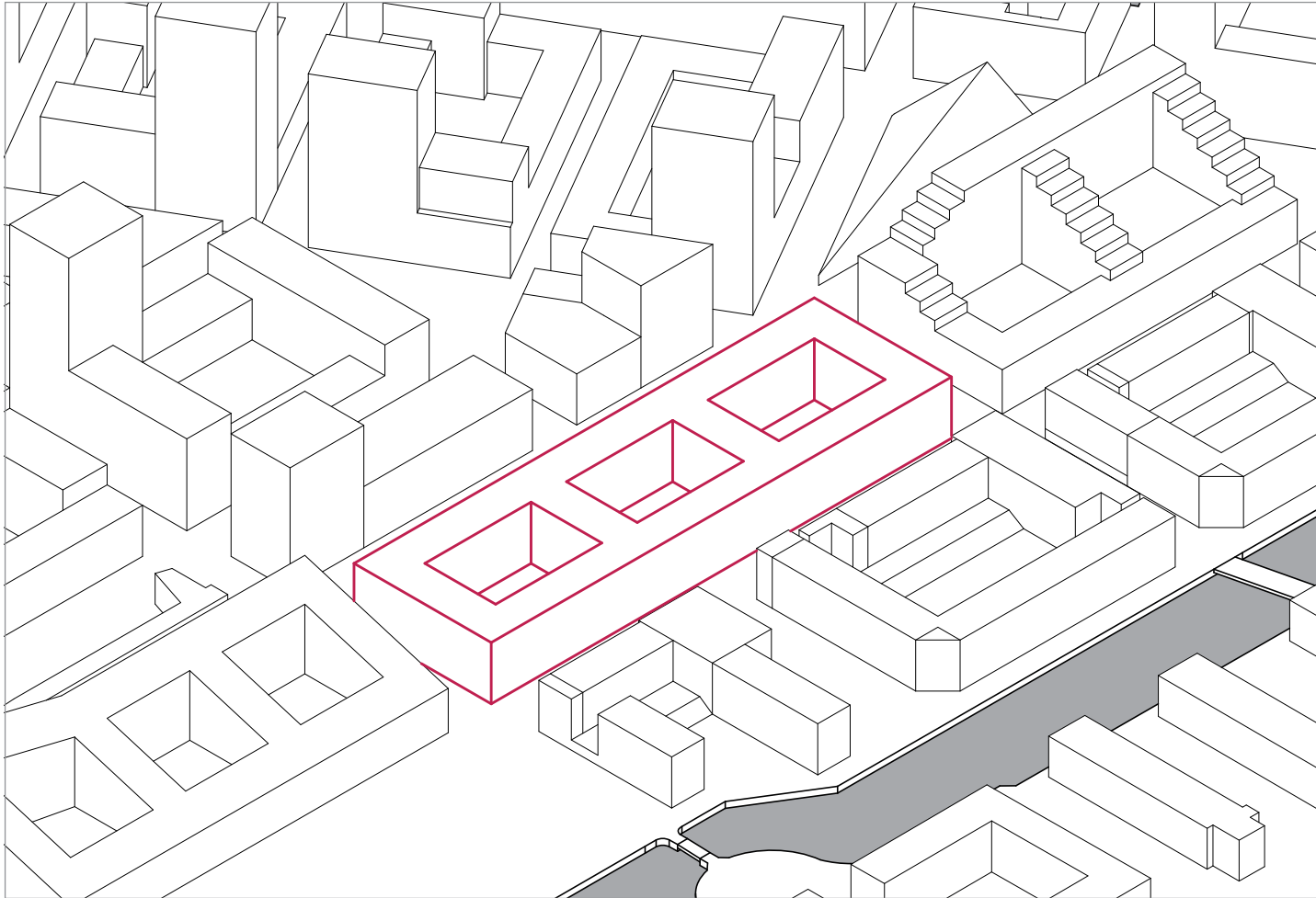

THREE COURTYARD BLOCKS IN SEQUENCE

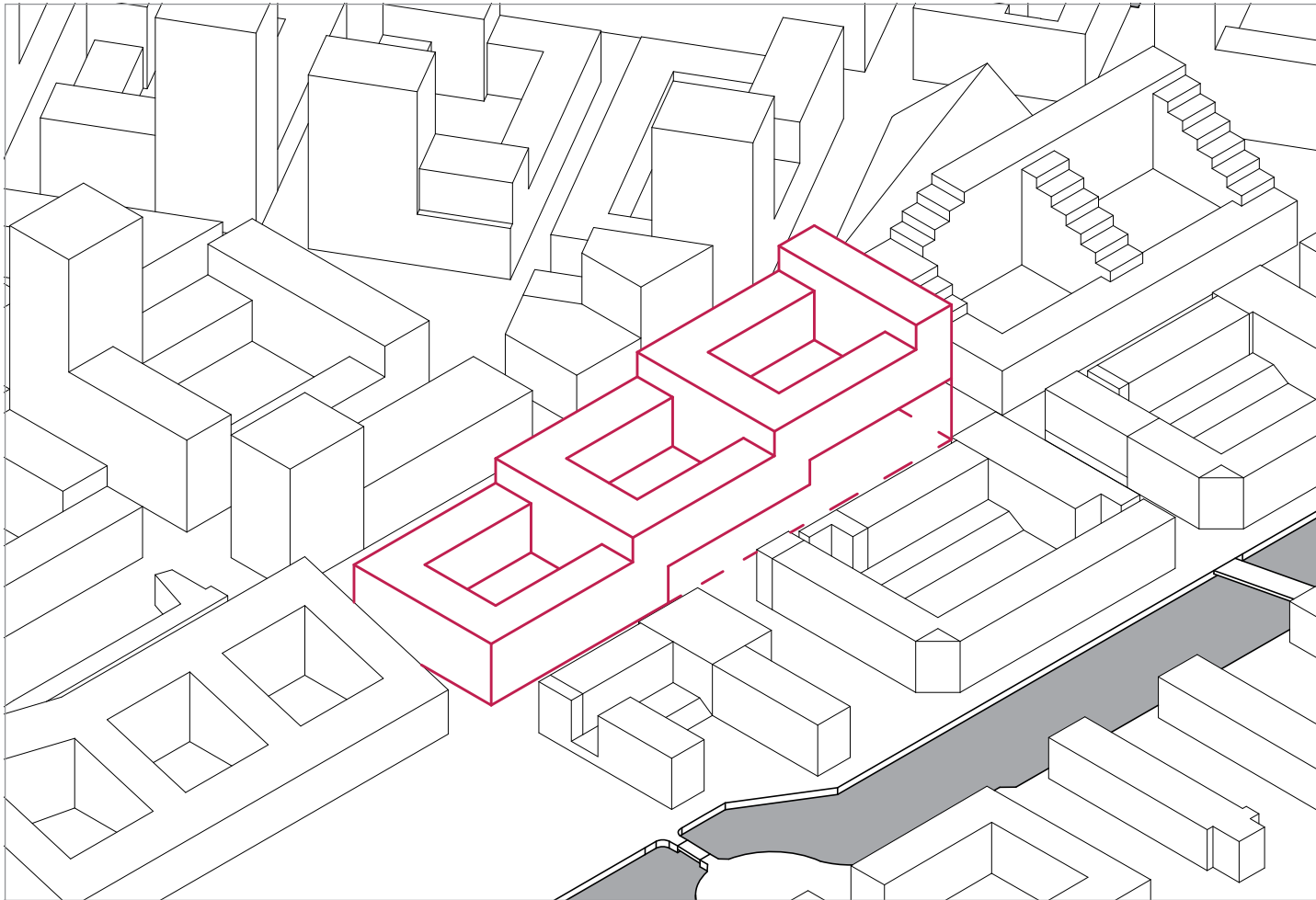

CASCADED COURTYARD BLOCKS

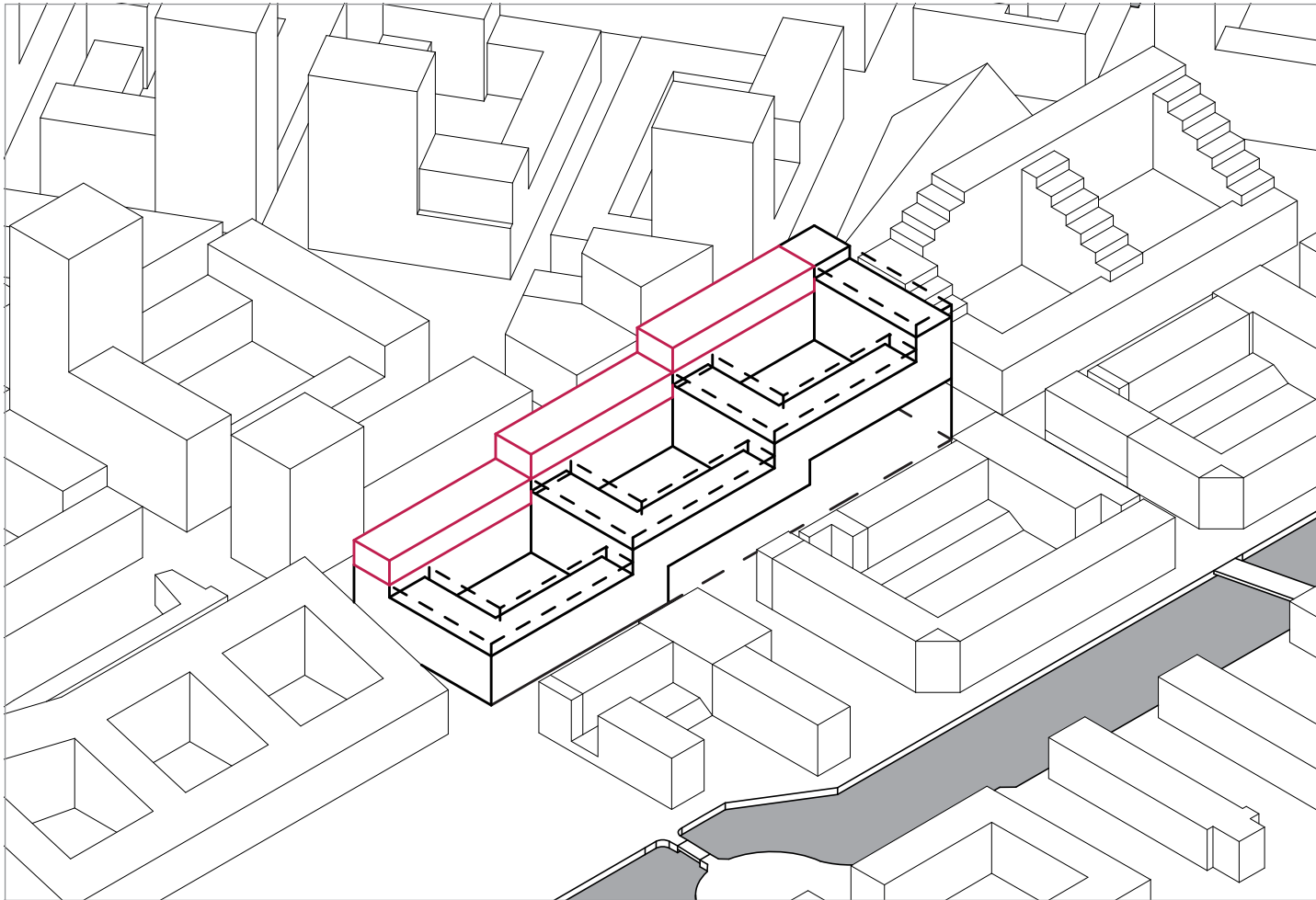

SUNLIGHT INTO COURTYARDS



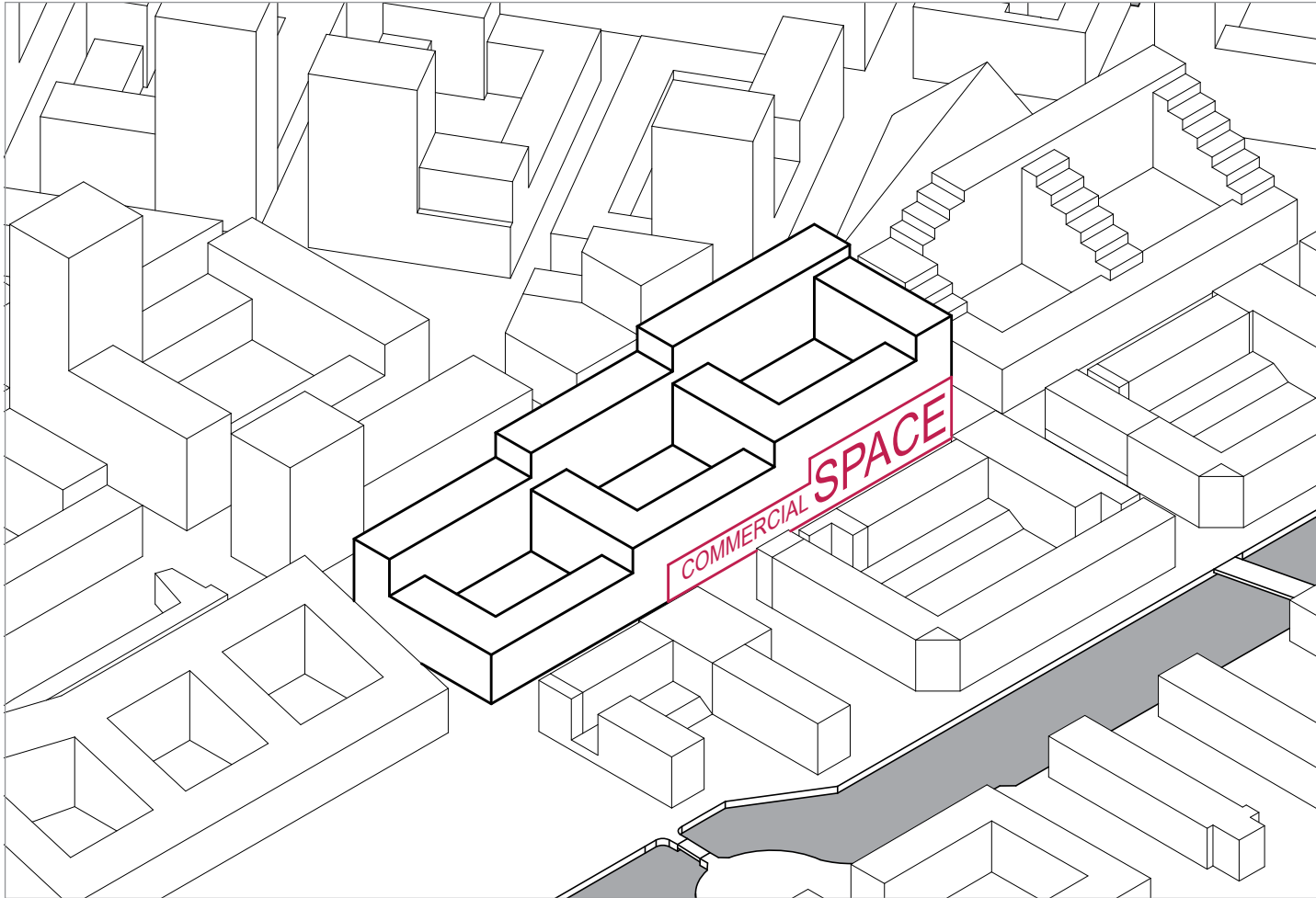

COMMERCIAL SPACE UNDERNEATH

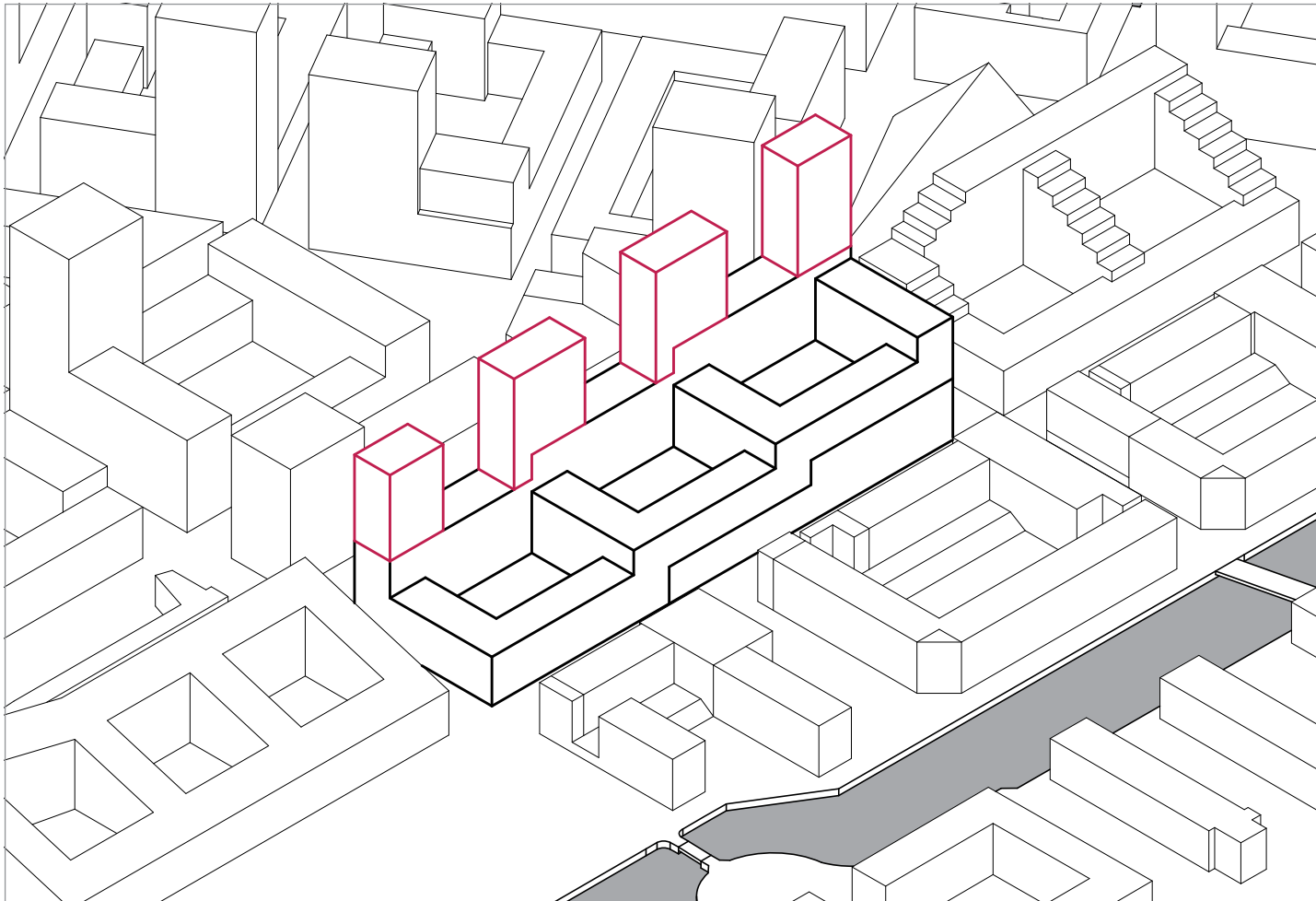

TOWERS FOR EXTRA DENSITY

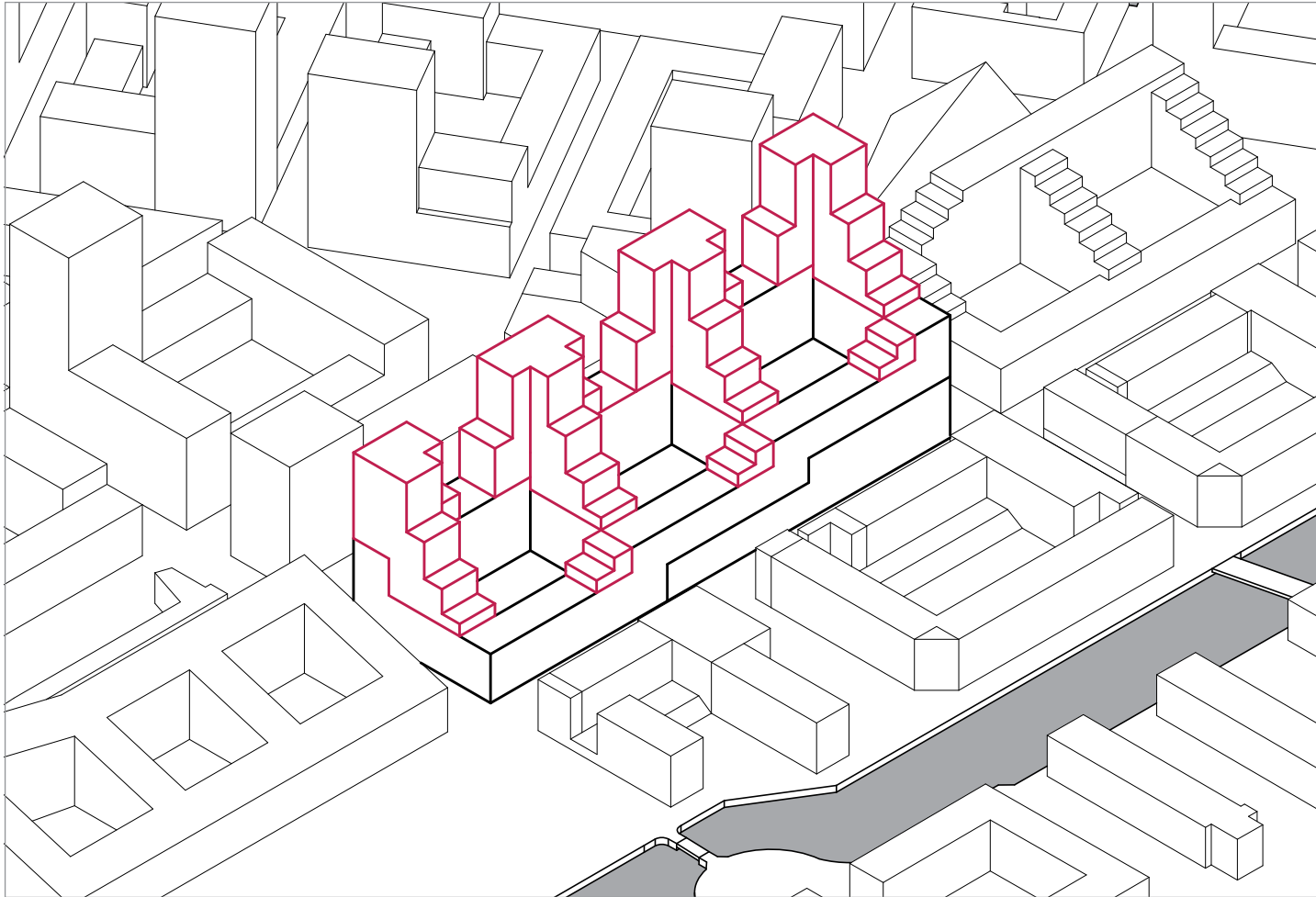

OPTIMALISATION

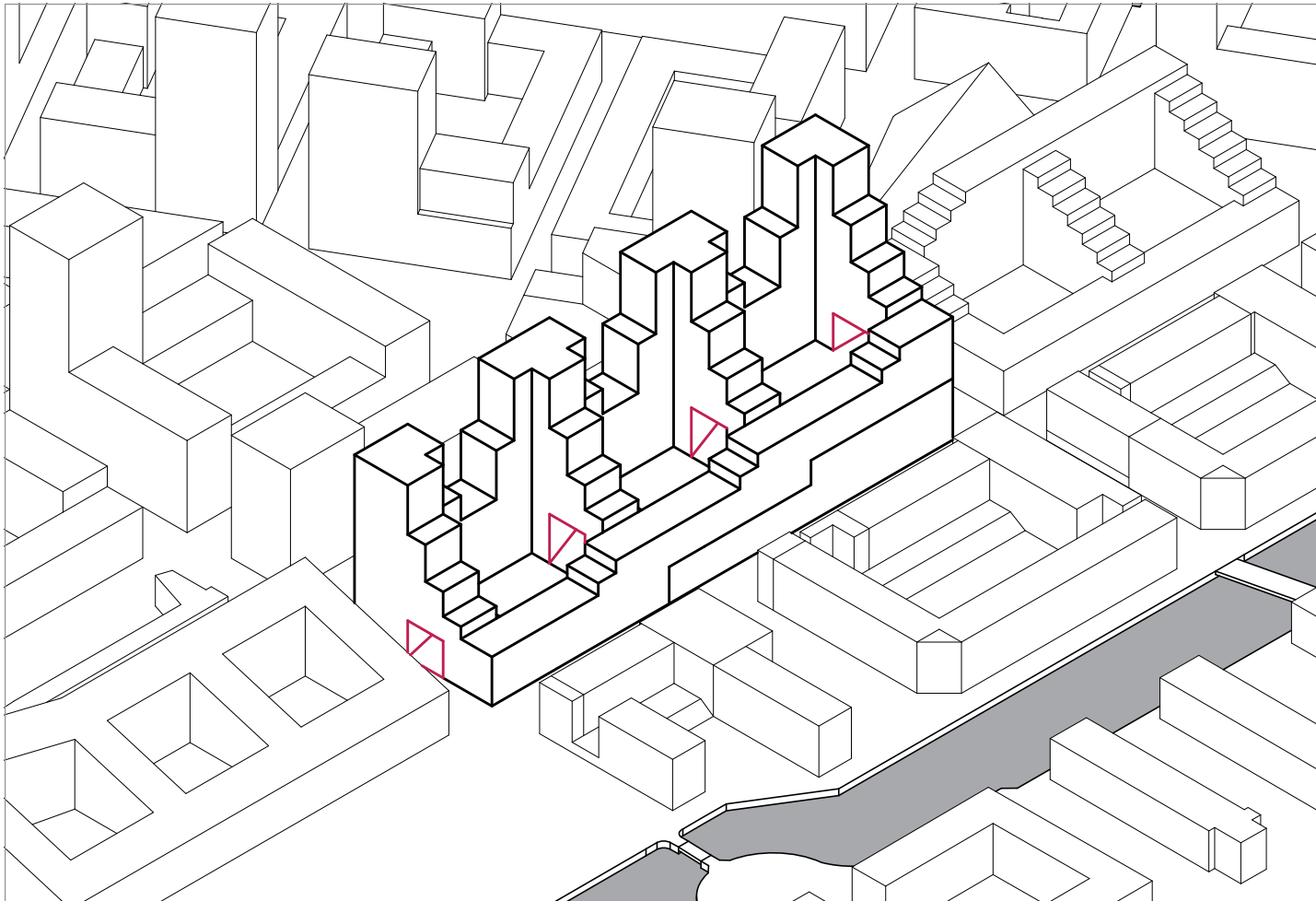

CONNECTING COURTYARDS

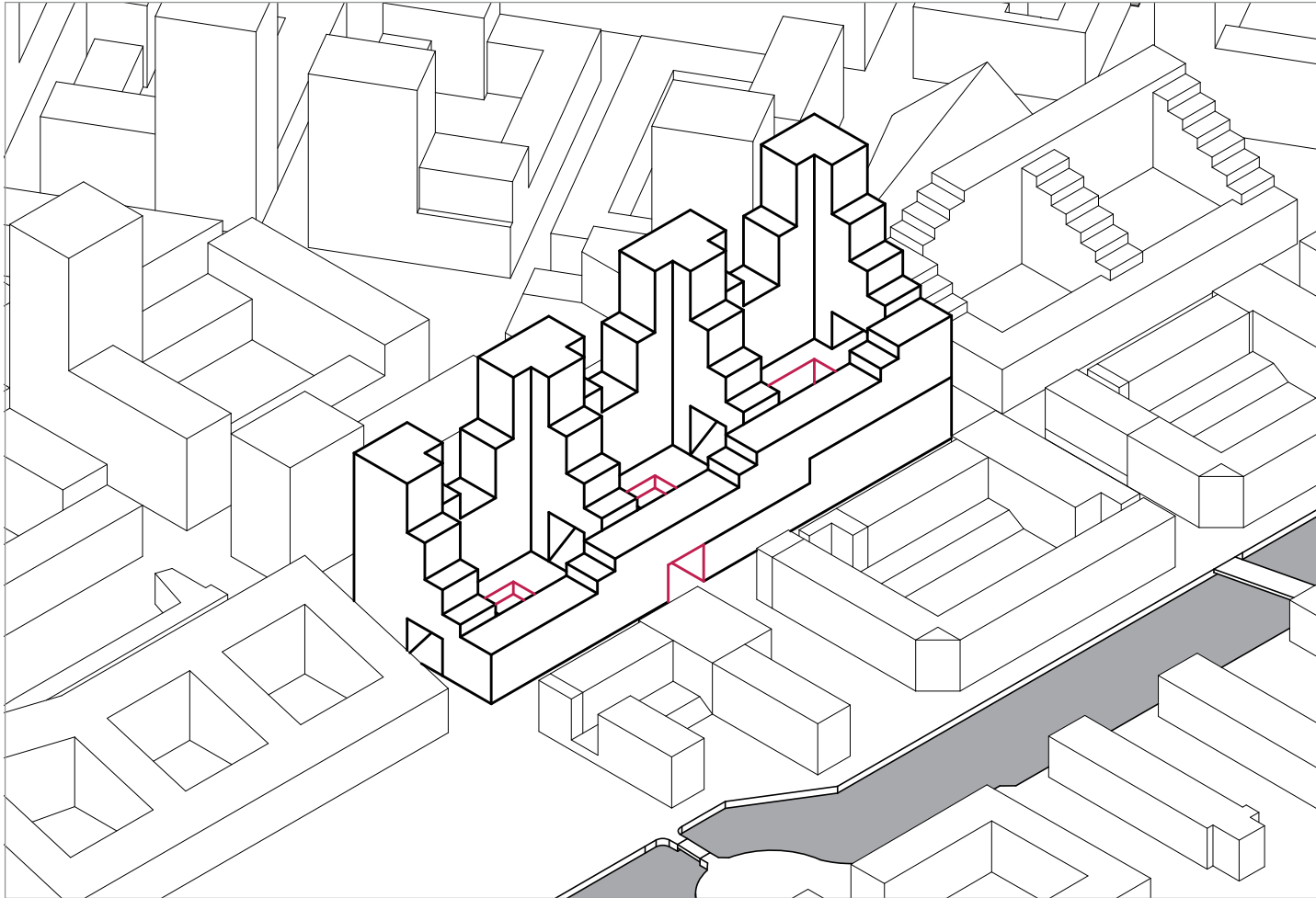

LIGHT SHAFTS AND CENTRAL ENTRANCE

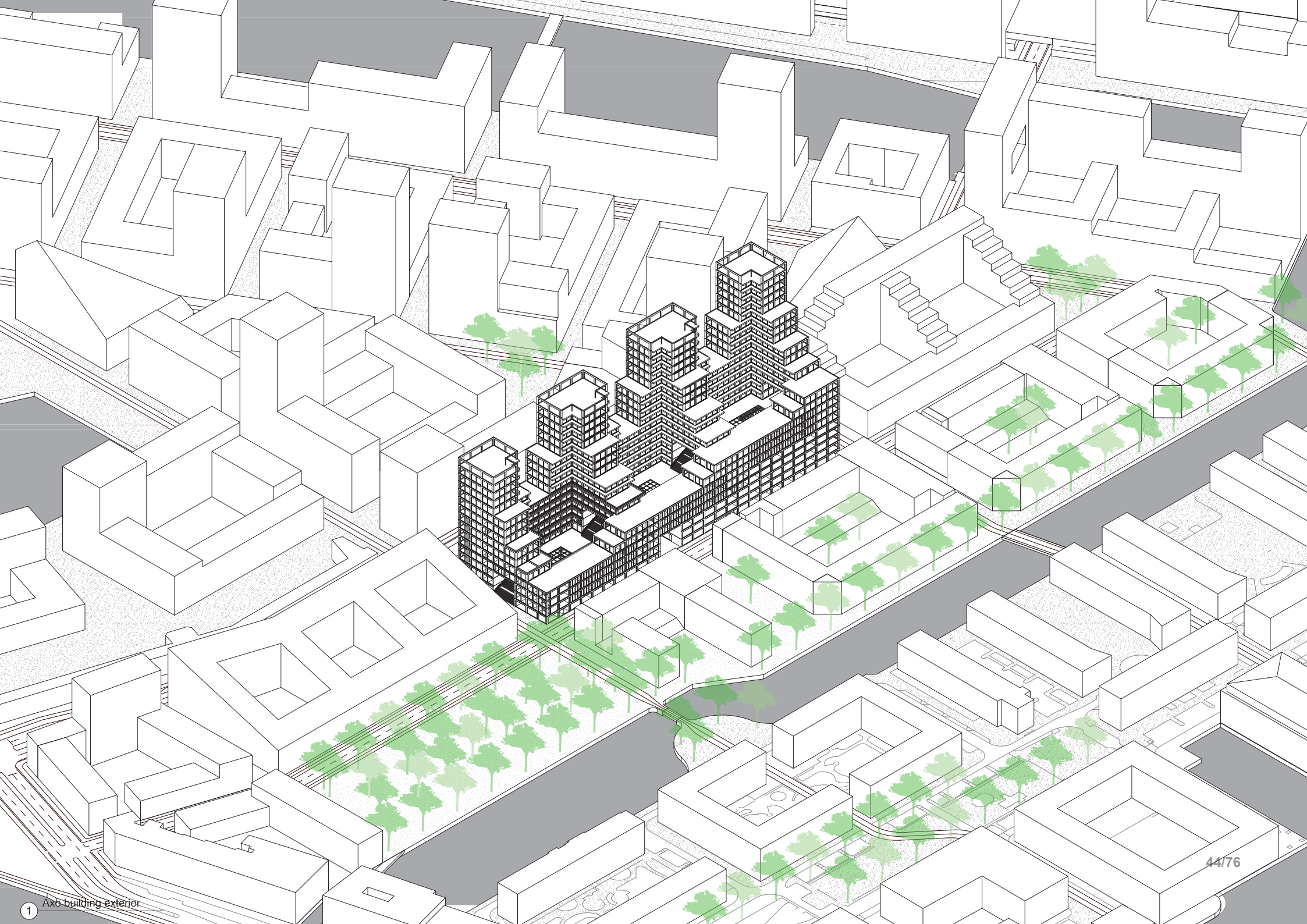

1 Ax6 building exterior





VIEW FROM THE SOUTH

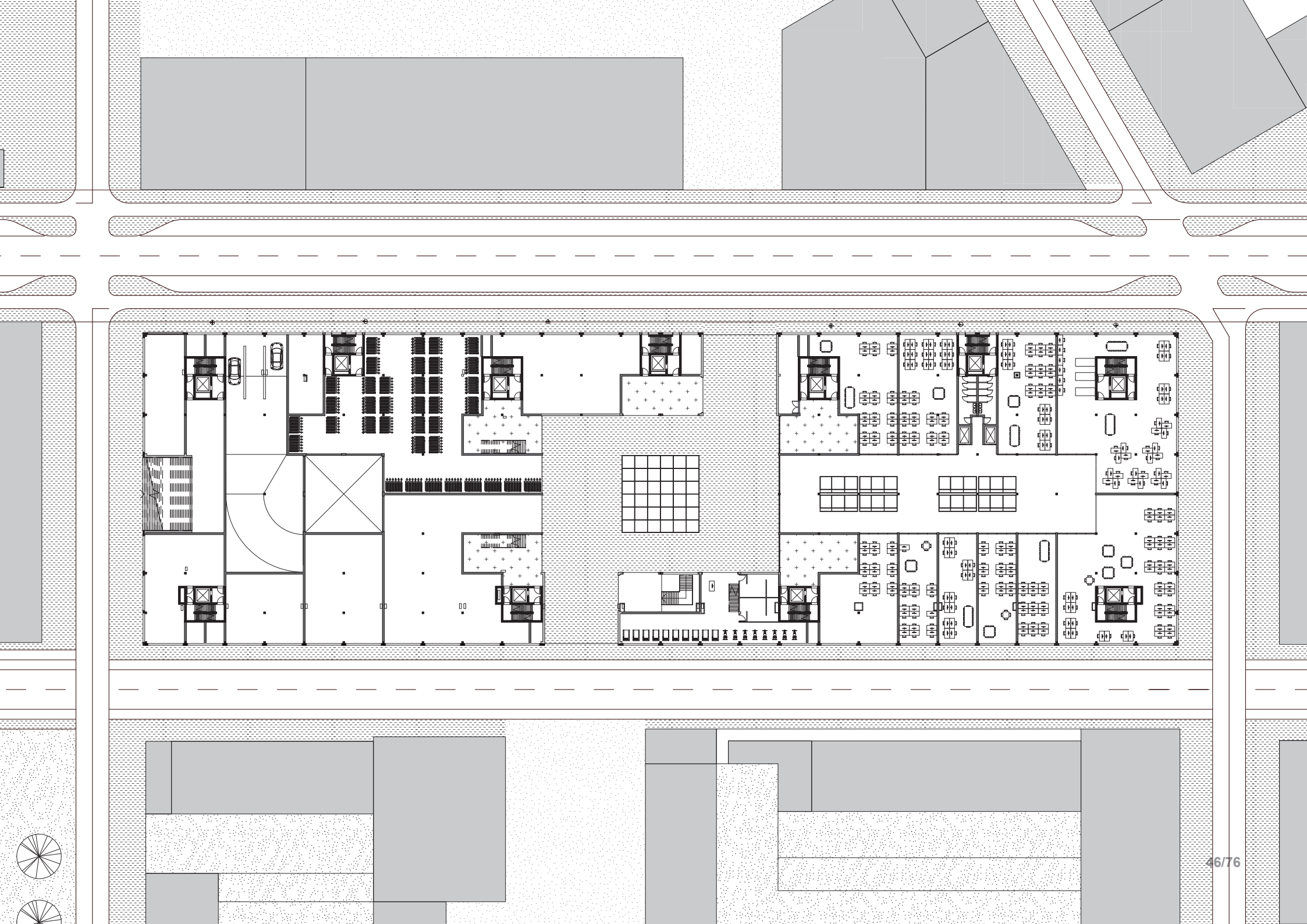





CENTRAL HALL

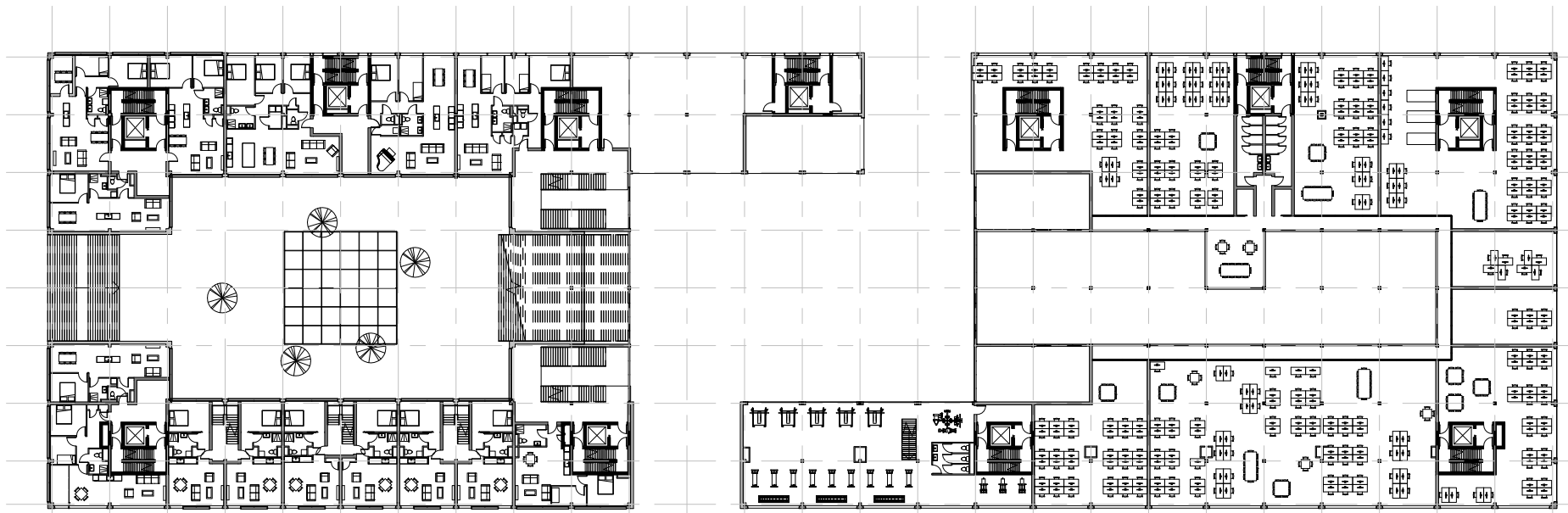

LEVEL 1, COURTYARD ONE



LEVEL 3, COMMERCIAL AREA

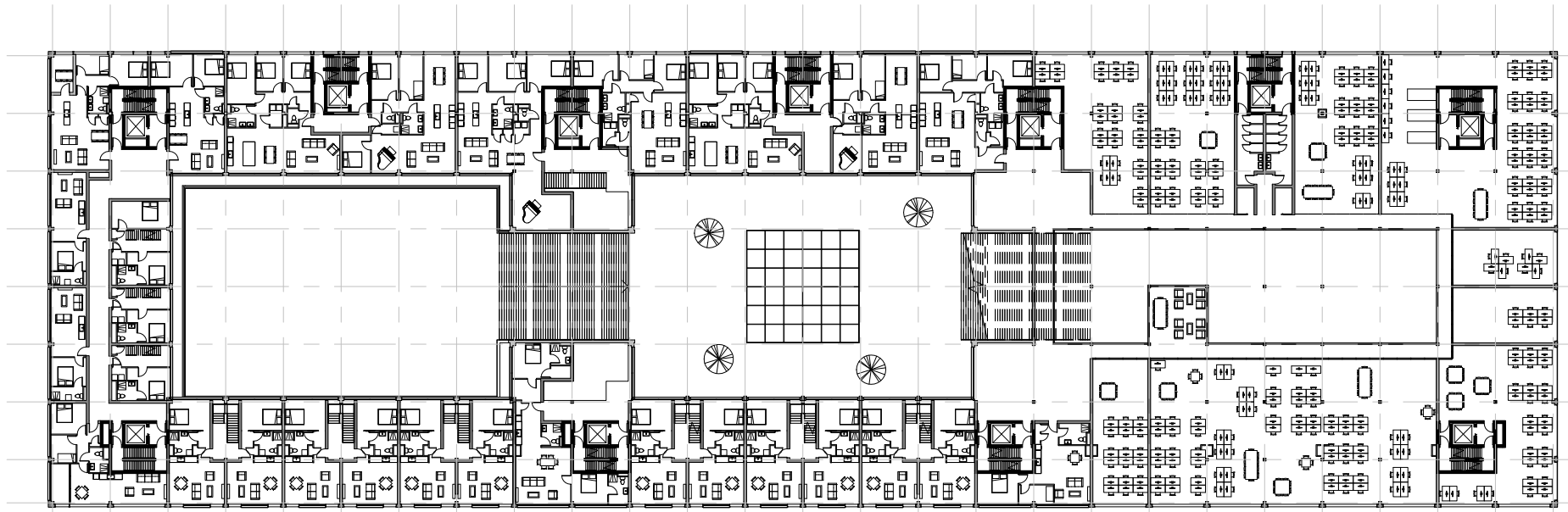

LEVEL 3, COURTYARD 2

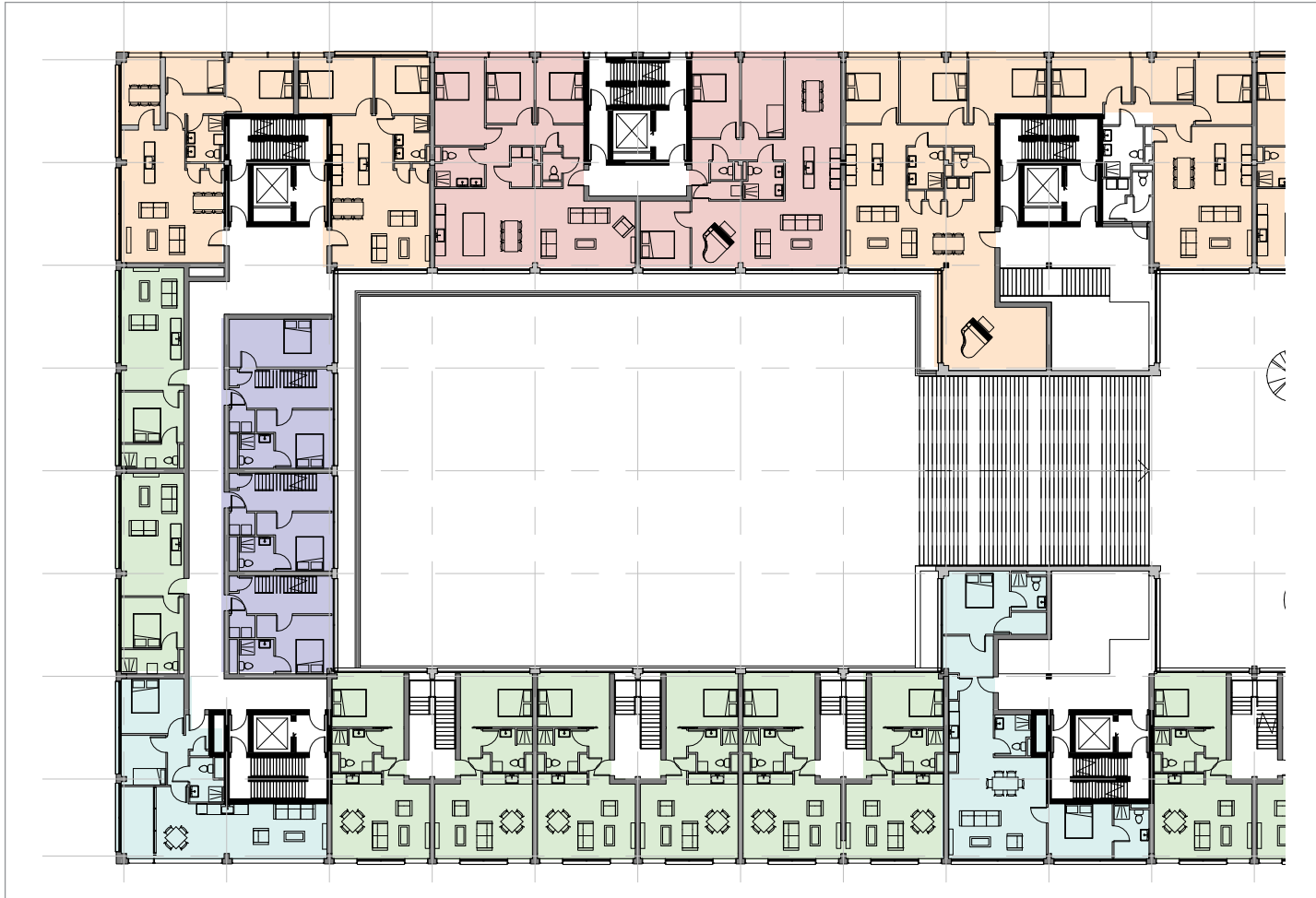

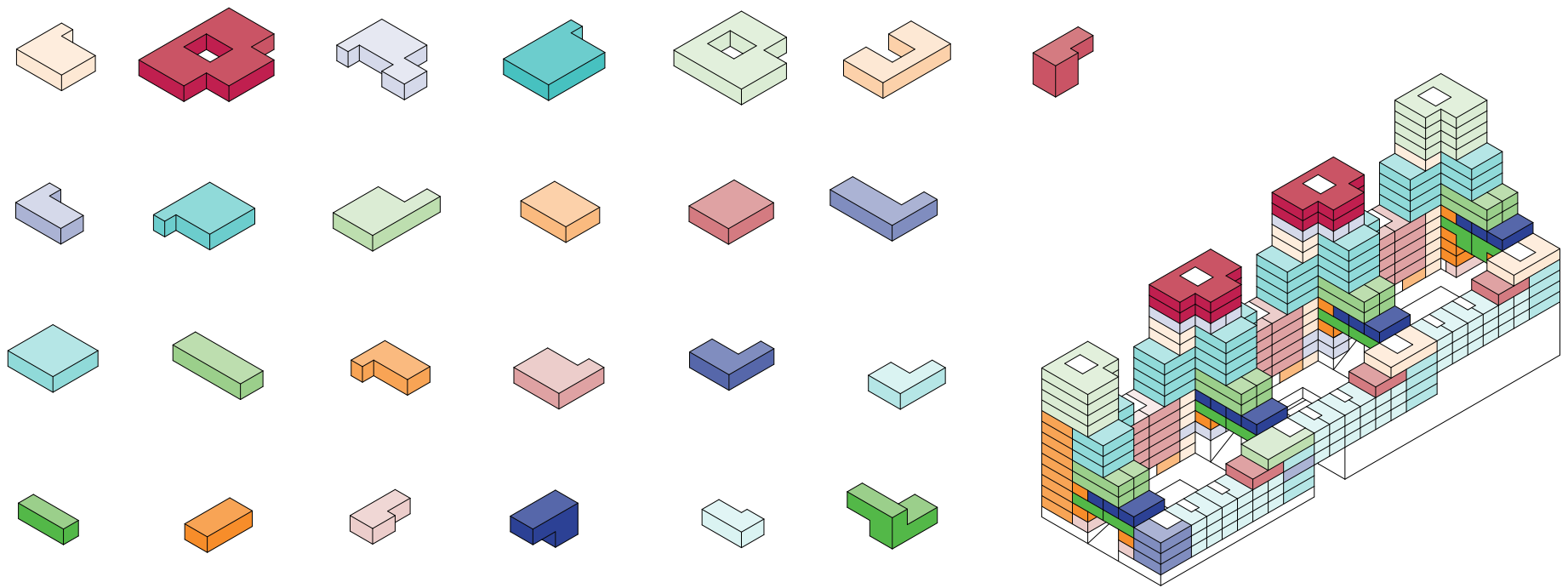

25 DWELLING TYPOLOGIES



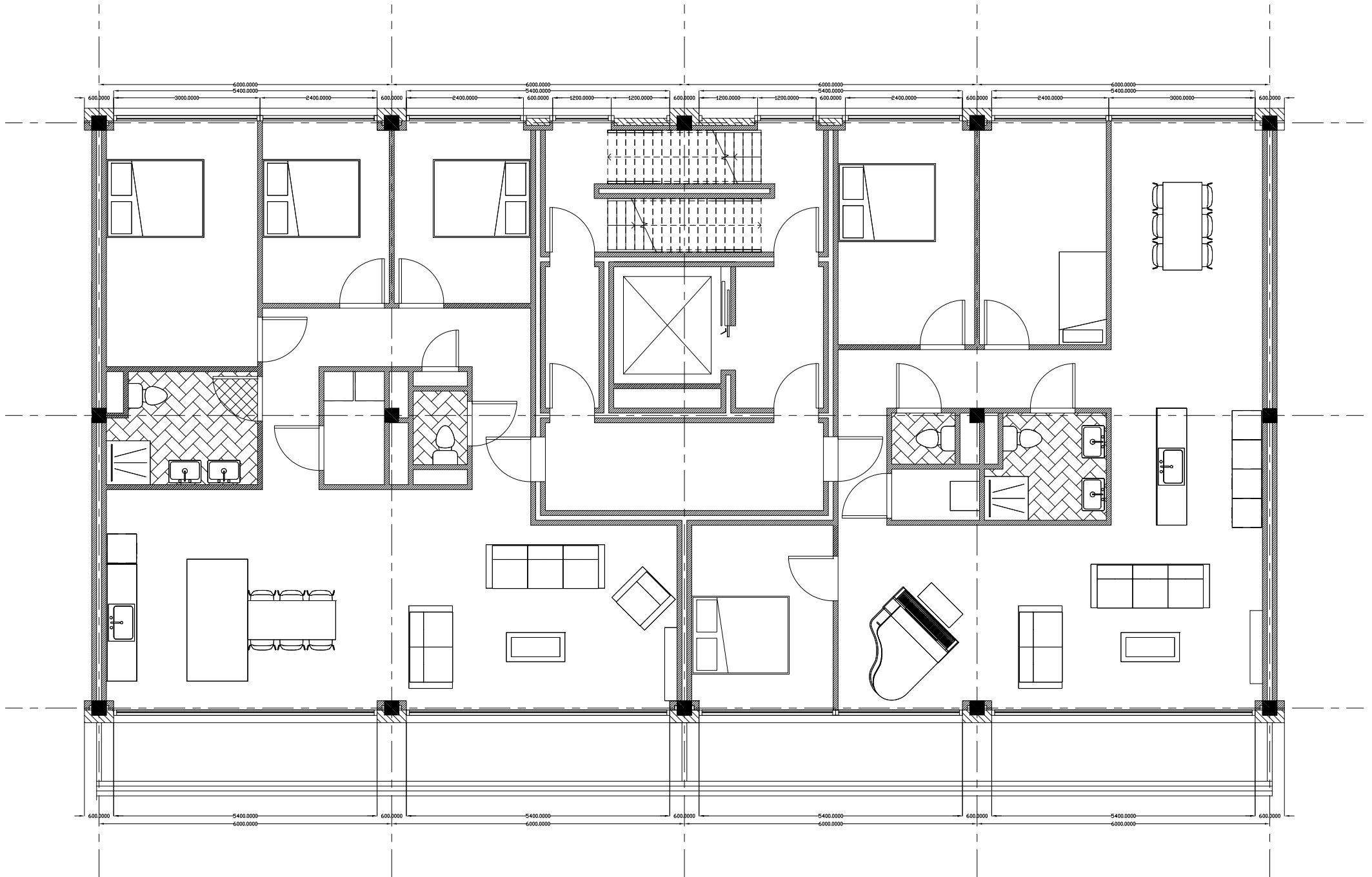



APARTMENT VIEW, LEVEL 4







COURTYARD ONE, LEVEL 1





NORTH WEST FACADE



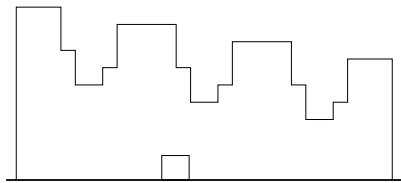

**Building shape**

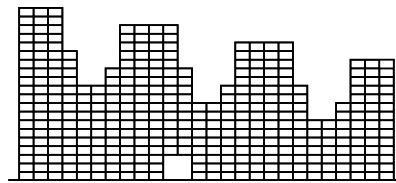

**Construction**

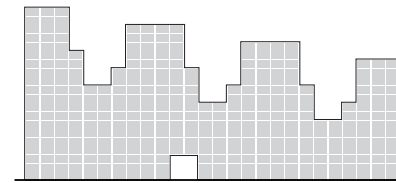

**Facade grid**

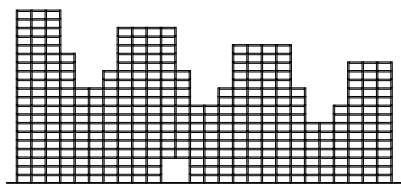

**Prefab panels**

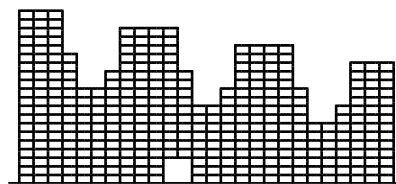

**600mm Tiles**

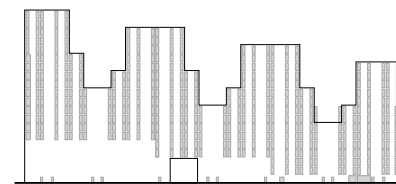

**Open-able windows**

FACADE LAYERS



WEST CORNER

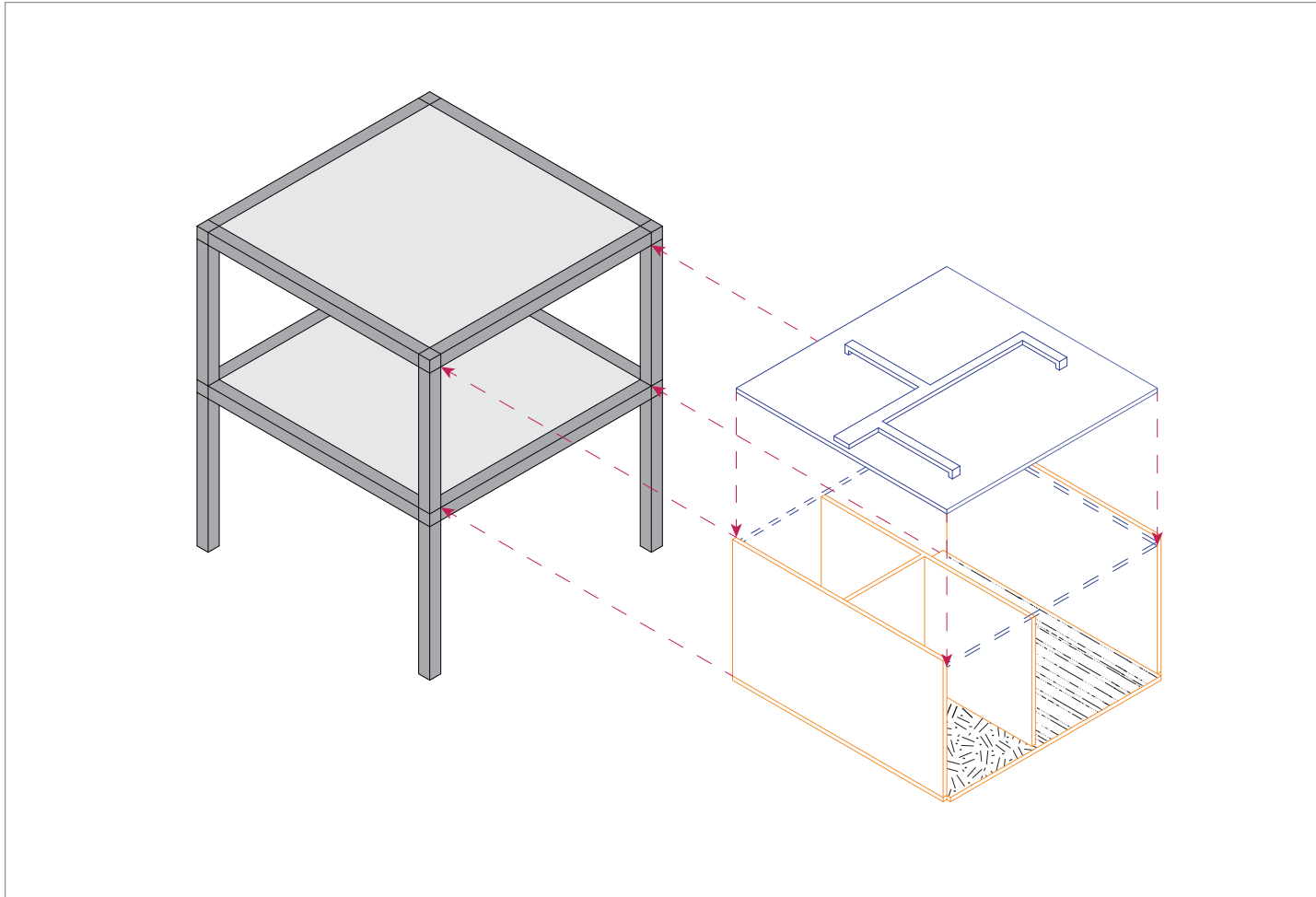

OPEN BUILDING SYSTEM

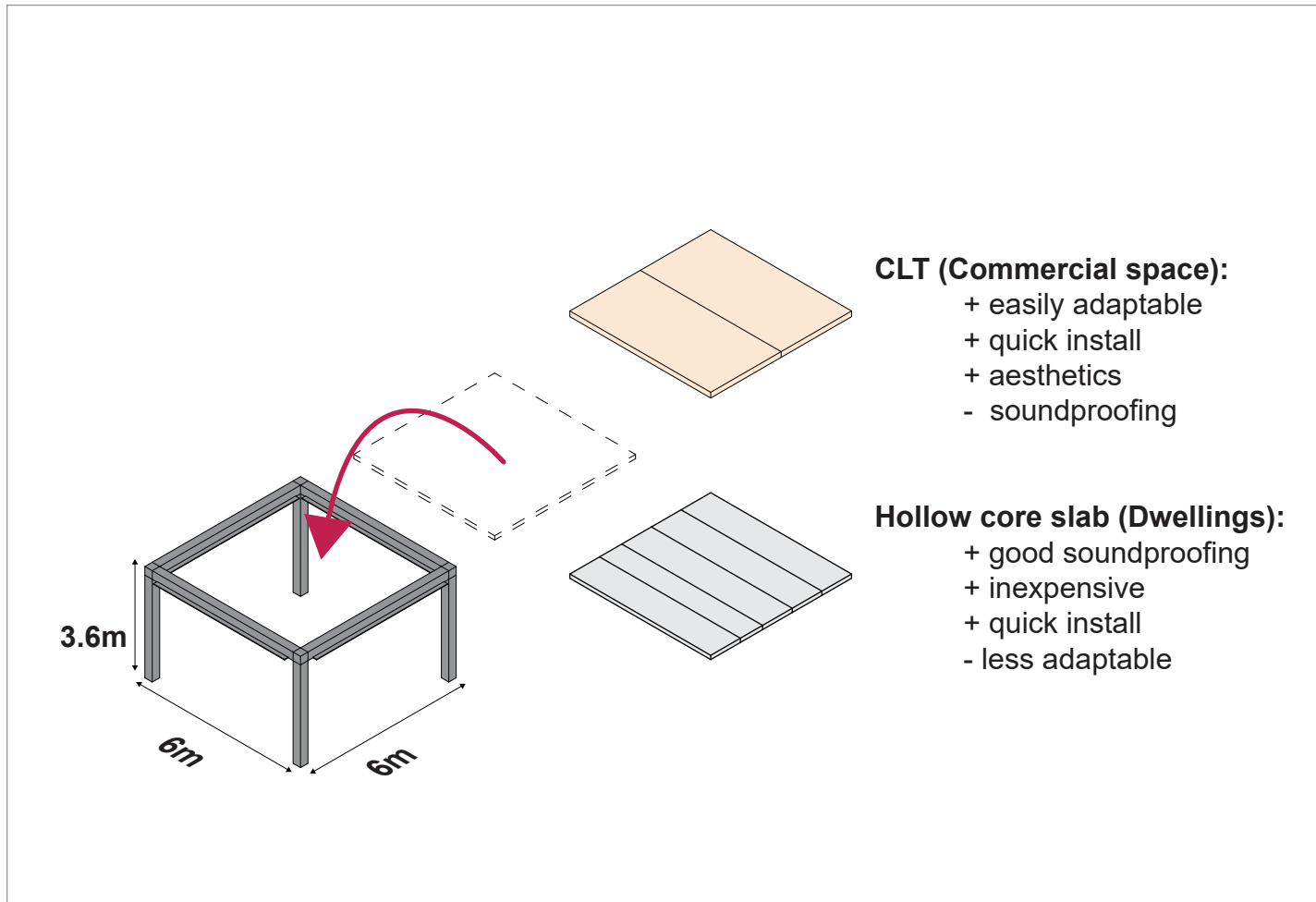

CONSTRUCTION PRINCIPLE



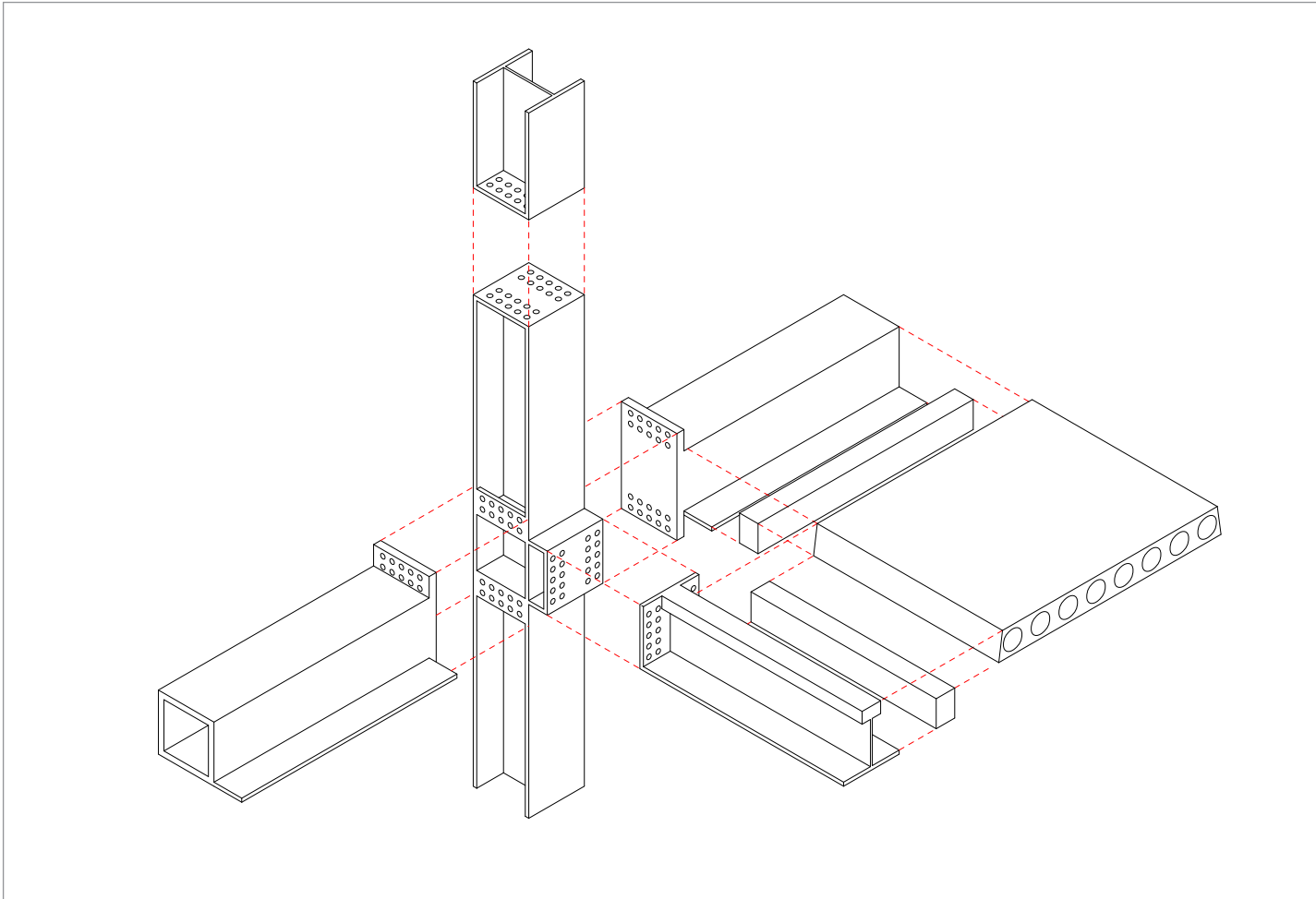

TYPICAL BEAM COLUMN CONNECTION

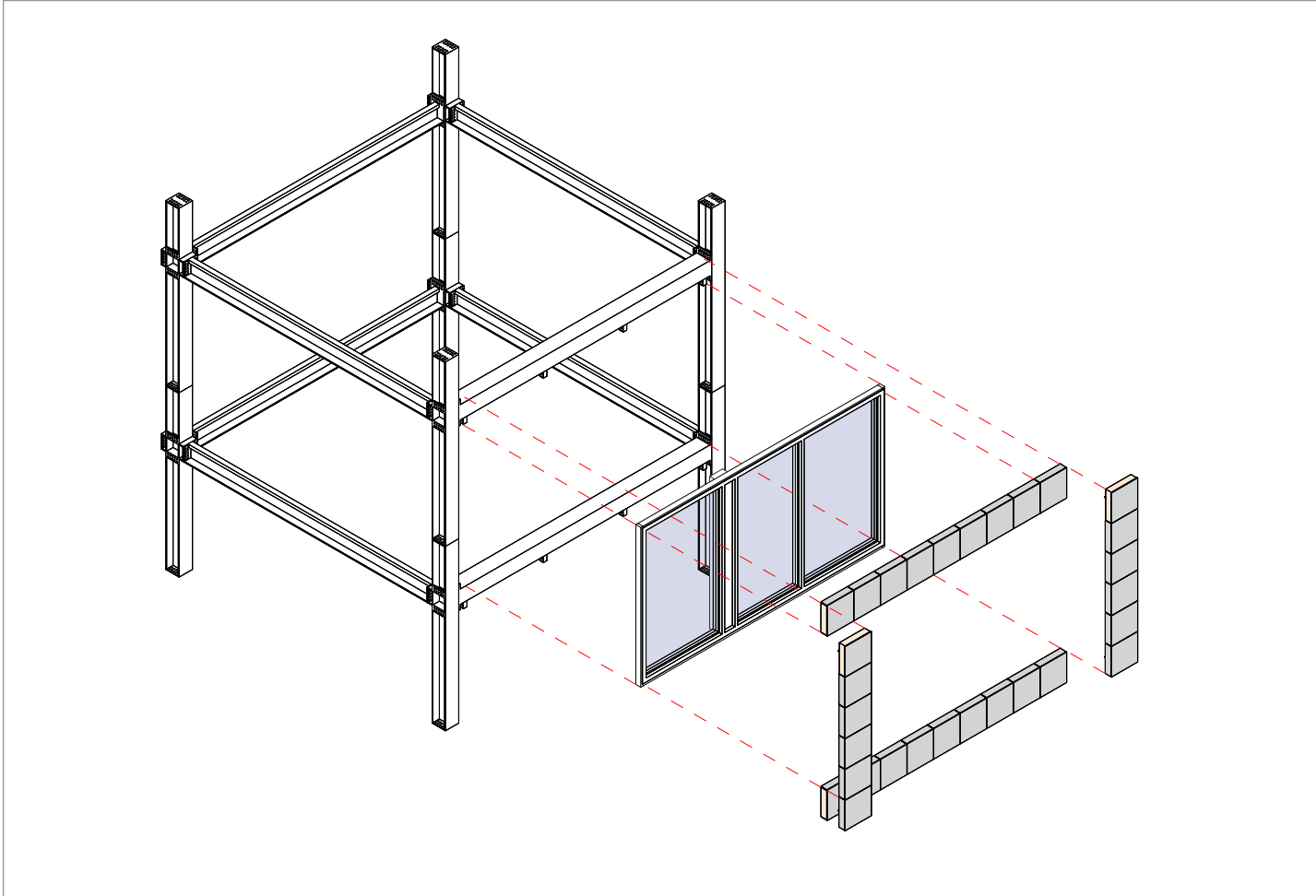

FACADE BUILD-UP

