

JOY

‘Joining Old and Young’

Design booklet

AR3AD110- Dwelling Graduation Studio
Ruveyda Koçak | 4436814
TU Delft

Table of Content

Table of content	p. 3
I. Starting points (P2)	p. 4
II. Site Location	p. 12
III. Building	p. 24
Masterplan	p. 25
Floorplans	p. 26
Dwelling types	p. 30
Facades	p. 32
IV. Climate	p. 34
Solar energy	p. 35
Rain water	p. 36
Heating & Cooling	p. 37
V. Structure	p. 38
Scheme	p. 39
Axonometry	p. 41
1:20	p. 43
Details	p. 44
VI. Design Studies	p.57
Library	p.58
Intergenerational living	p.60
Facade studies	p.64

I. Starting points (P 2)

Translation of some Design tools

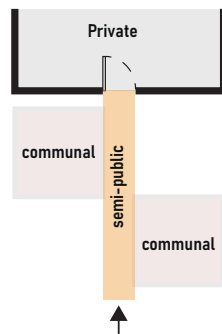
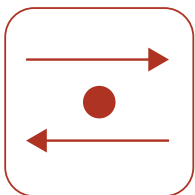
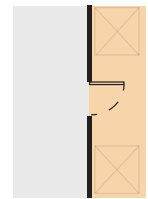
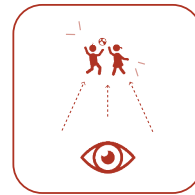
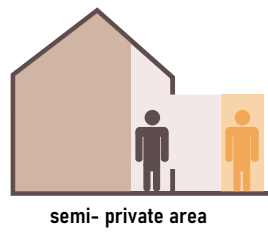
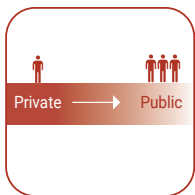
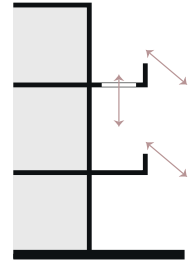
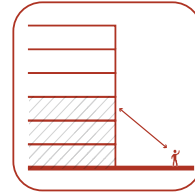
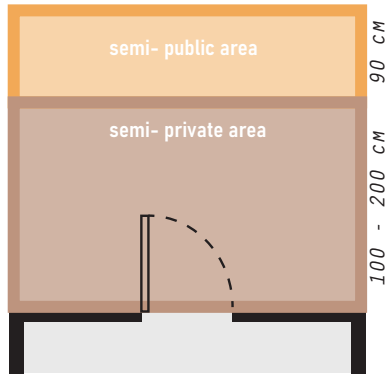

Main concepts

L
o
w
d
e
n
s
e
d

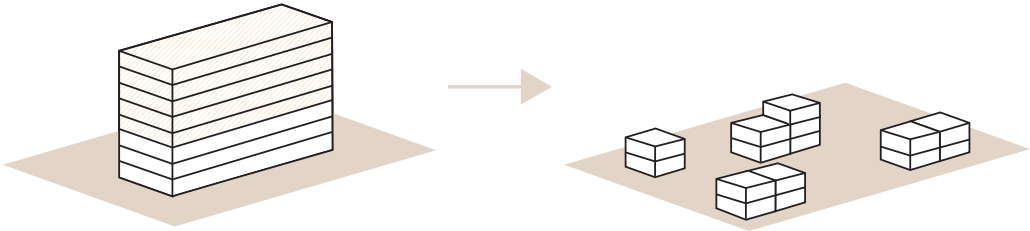

A
c
c
e
s
s
i
b
l
e

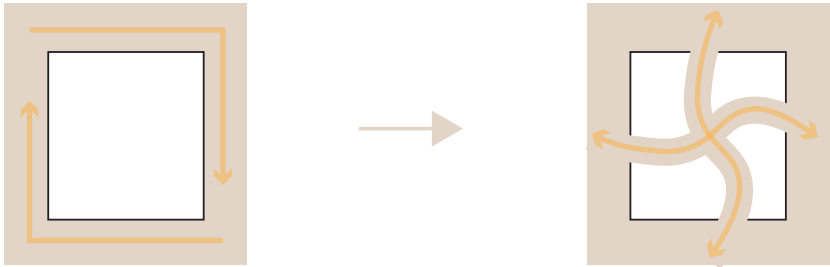

F
o
c
a
l
p
o
i
n
t

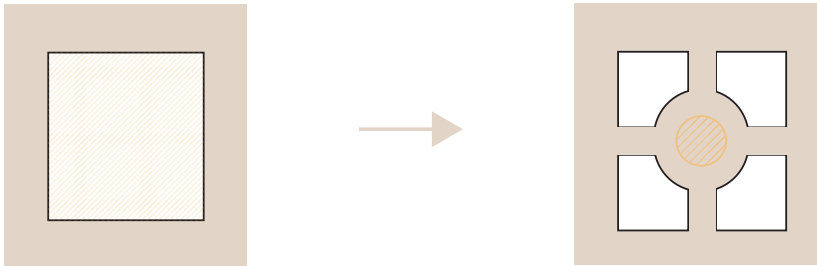

Main concepts

Extend the public center

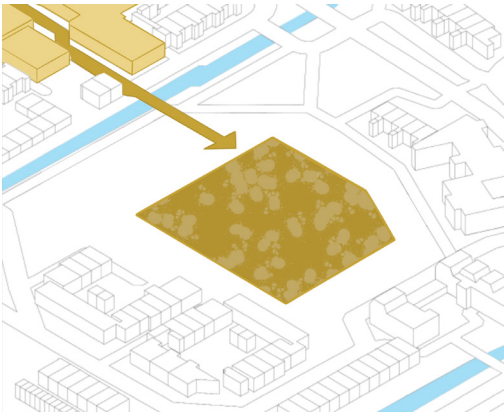

Connect

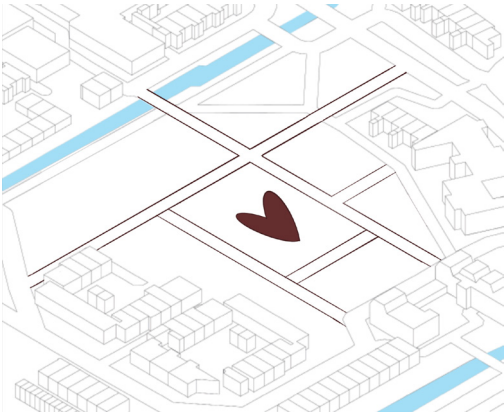

Create a Core

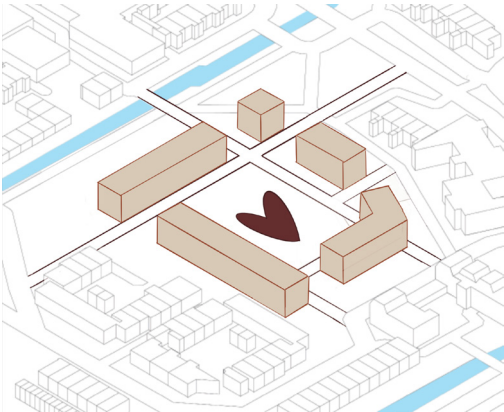

Ensemble

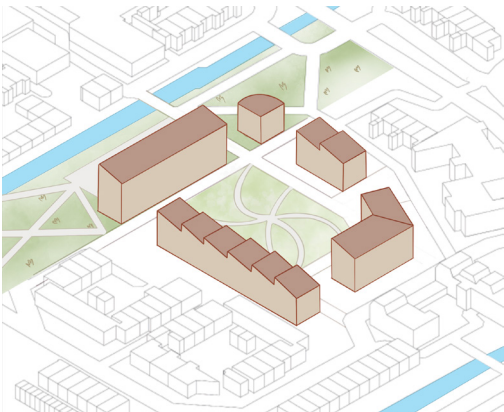

The 'Ensemble'

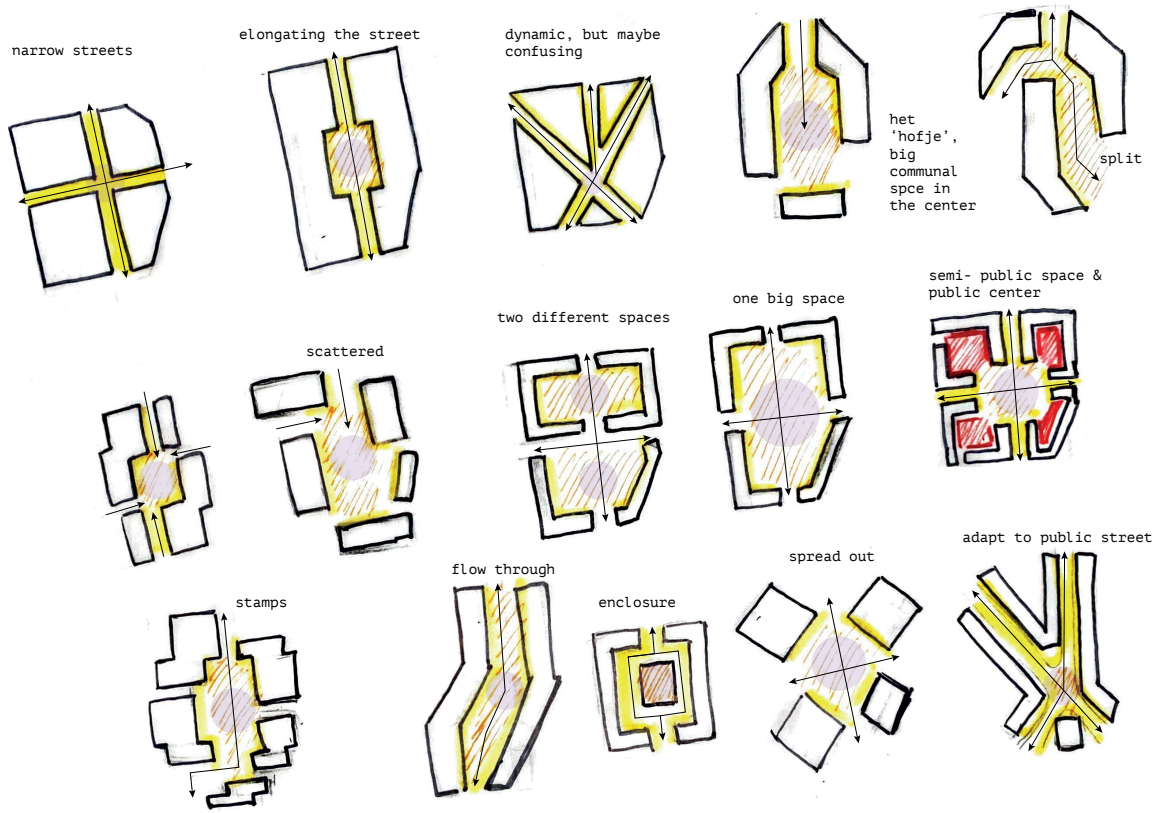

Mass studies

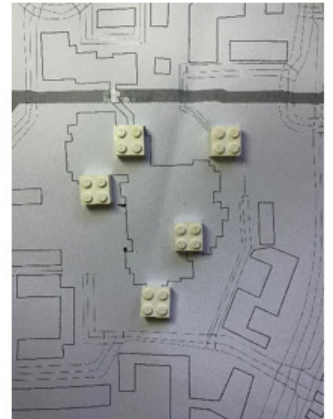

Mix & Match

Who?

FAMILY DENSON

JAYH (38)

NENKE (36)

NOAH (6)

What?

- Fulltime accountant
- Works near Delft
- Nurse at carehome on Monday and Thursday
- She has a affinity for elderly people.
- School at abtswoudeweg

What can you do ?

- Help elderly or others within toy with their accountancy
- Willingly to share his car with other residents.
- Volunteer at carepoint on Tuesdays
- Run errands with an elderly person on Monday evening (her regular grocery day)

Who?

NEL SMITH

NEL (70)

TON (75)

LINDA (35)

JOP (40)

What?

- Husband of Nel Passed away
- Daughter Visits Nel 1x week
- Son Lives abroad Calls 1x week

What can you do ?

- Nel loves gardening. She is willingly to contribute to the community garden and help to maintain it.
- Nel likes to bake.
- Nel likes to spend time with children.

FAMILY DENSON:

JAYH (38)

NENKE (36)

NOAH (6)

JAYH AND NENKE BOTH STUDIED IN DELFT. NENKE GREW UP IN TANTHOF AND KNOWS THE PLACE WELL. FAMILY DENSON LIVES CLOSE TO NEIGHBOR NEL. THEY HAVE A STRONG RELATIONSHIP WITH HER AND HELP EACH OTHER. NENKE GOES SHOPPING WITH HER ON MONDAYS AND JAYH HELPS HER WITH FINANCES.

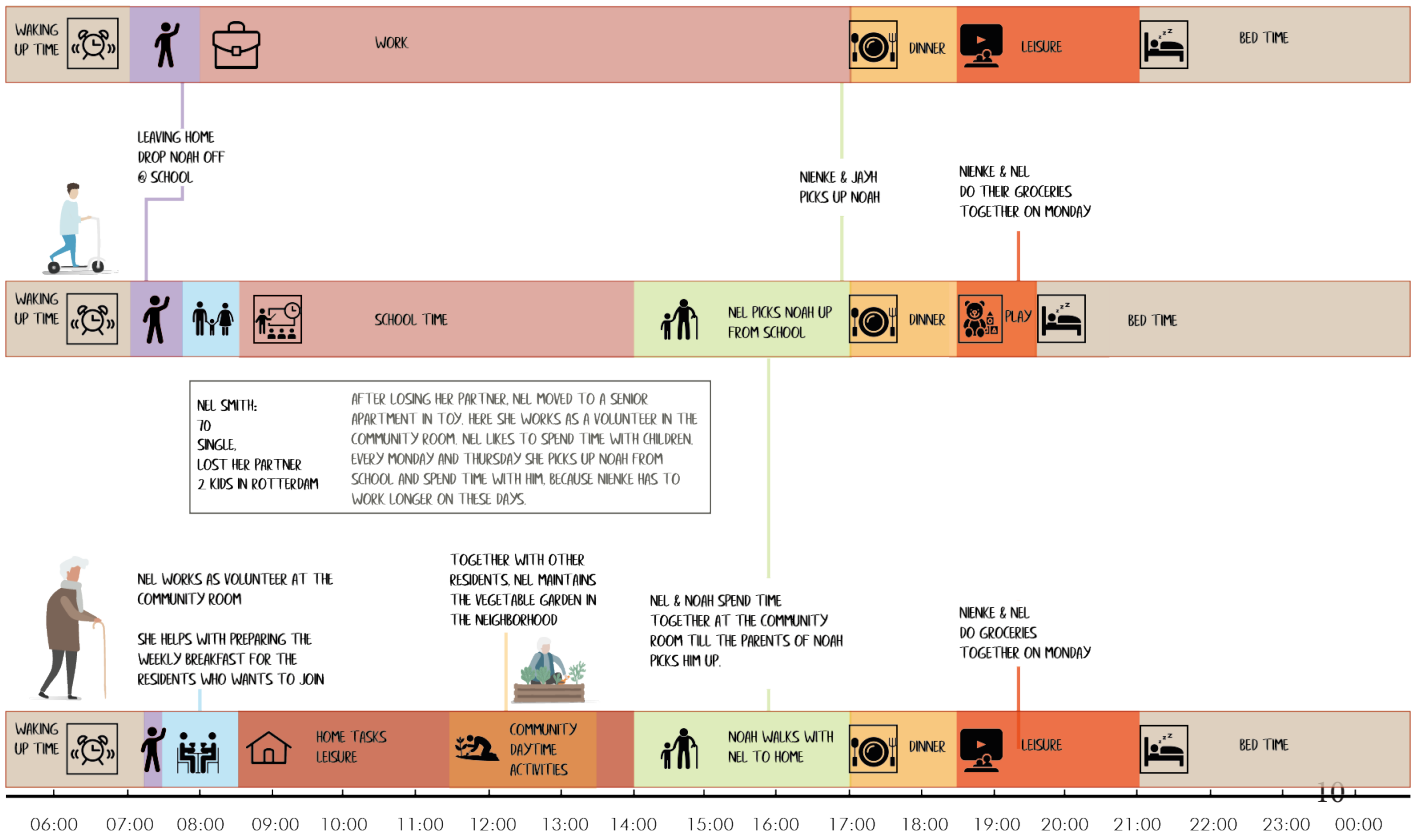

Inspiration



II. Site Location

Site Location



Design plot

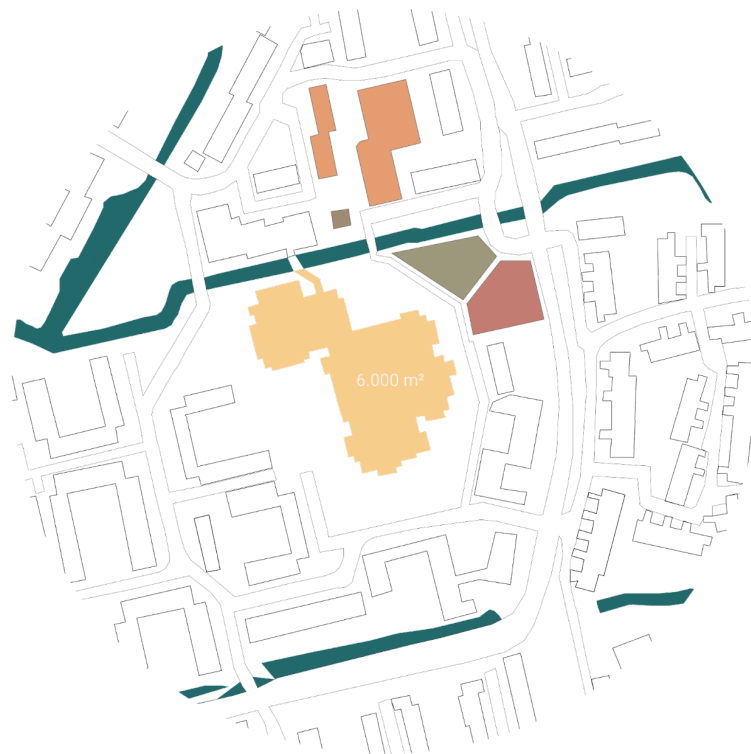
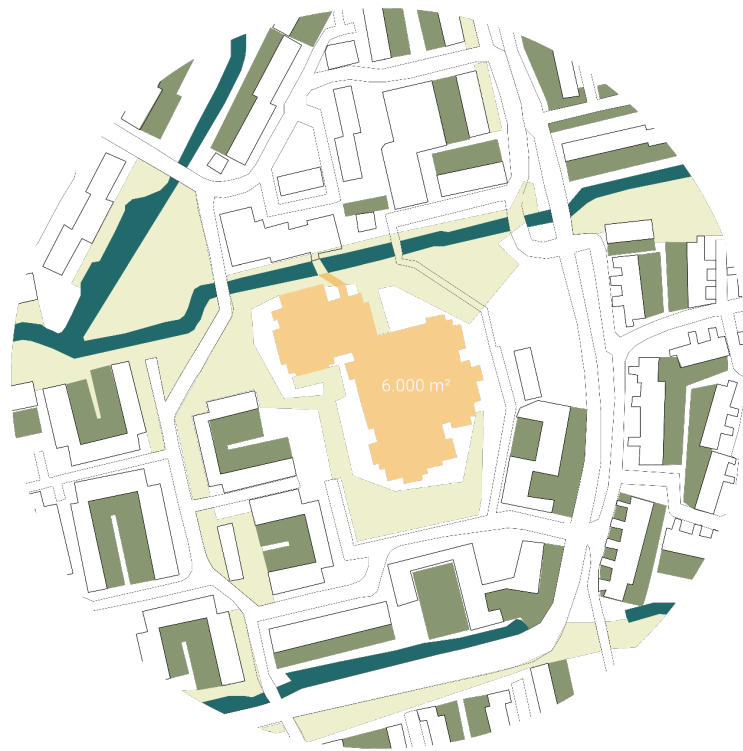

- Shops
- Restaurant
- Park
- Sportfield

Accessibility

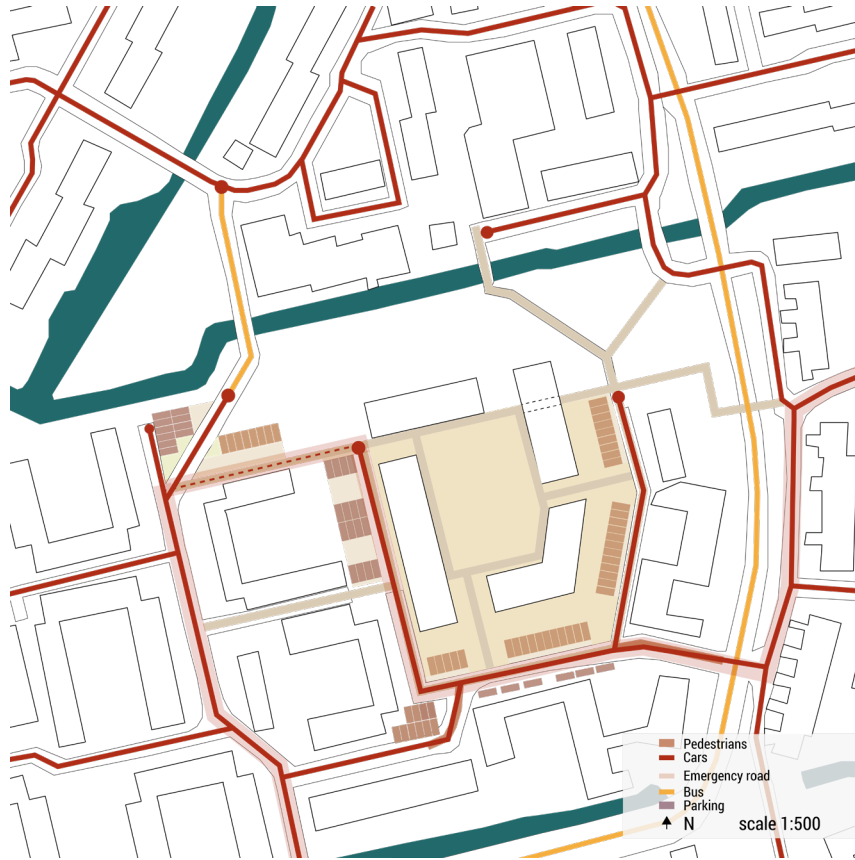

Program needs based on Site investigation

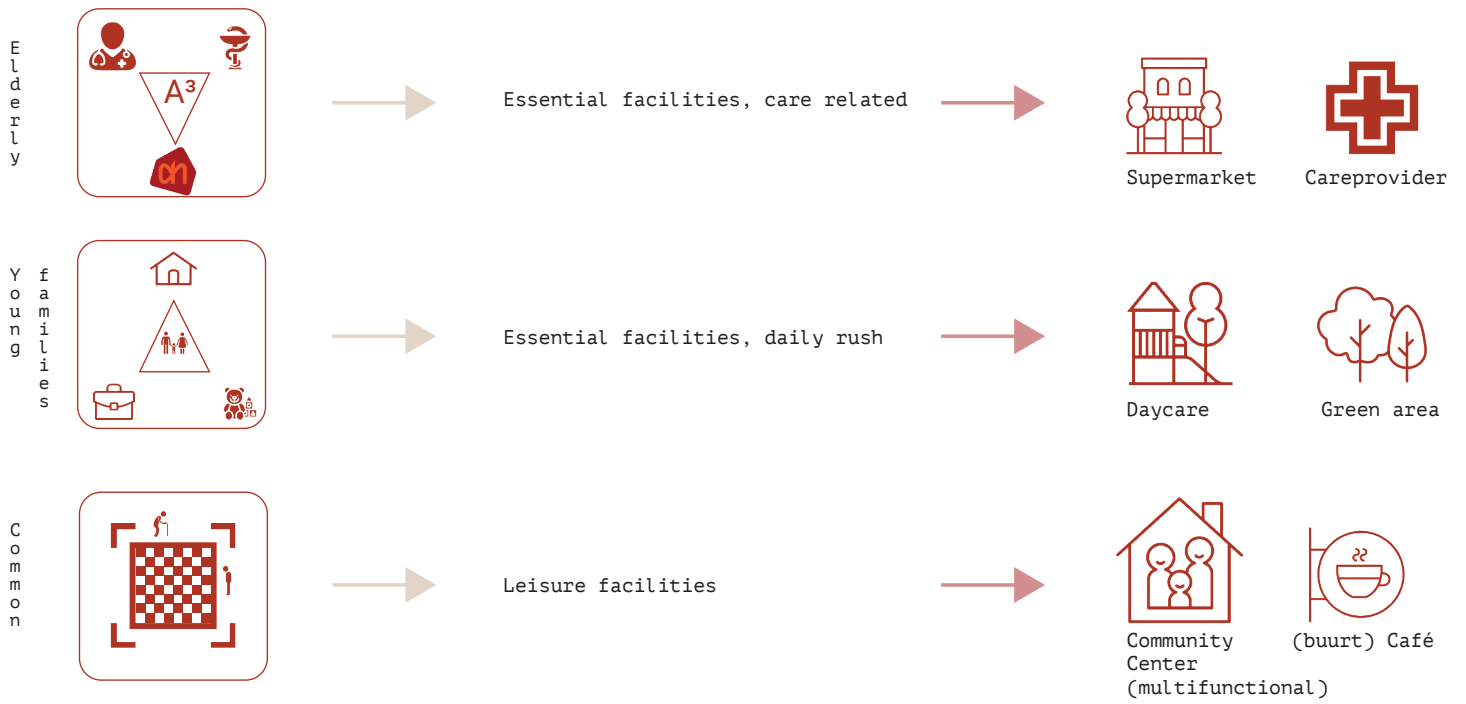

Neighbourhood Sections

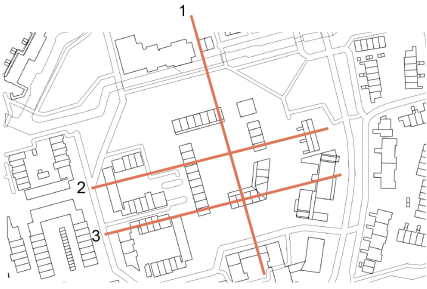

Section 1

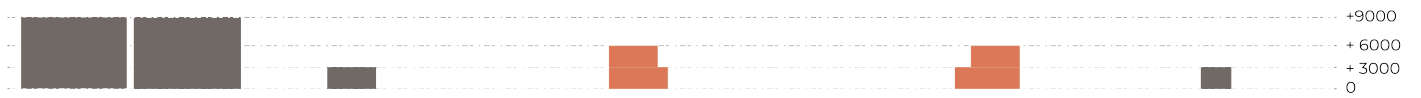

Section 2



Section 3

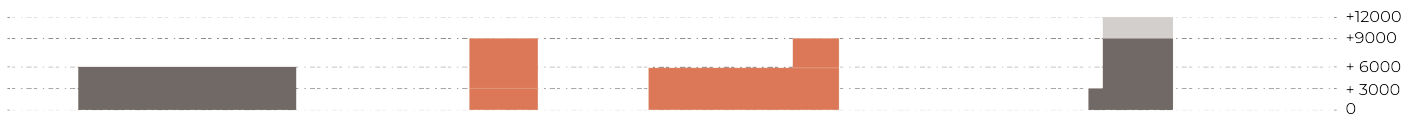

Materials on Site



Gradually Transition

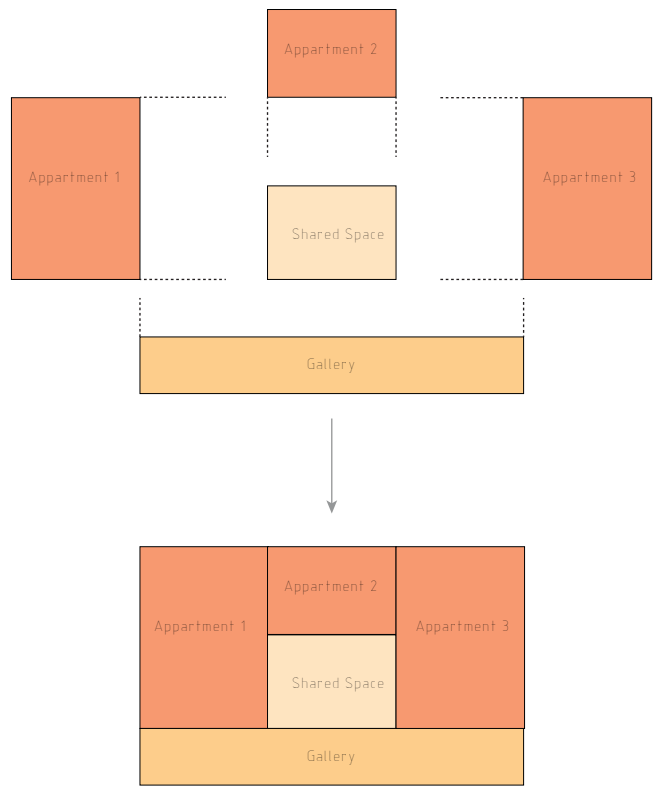
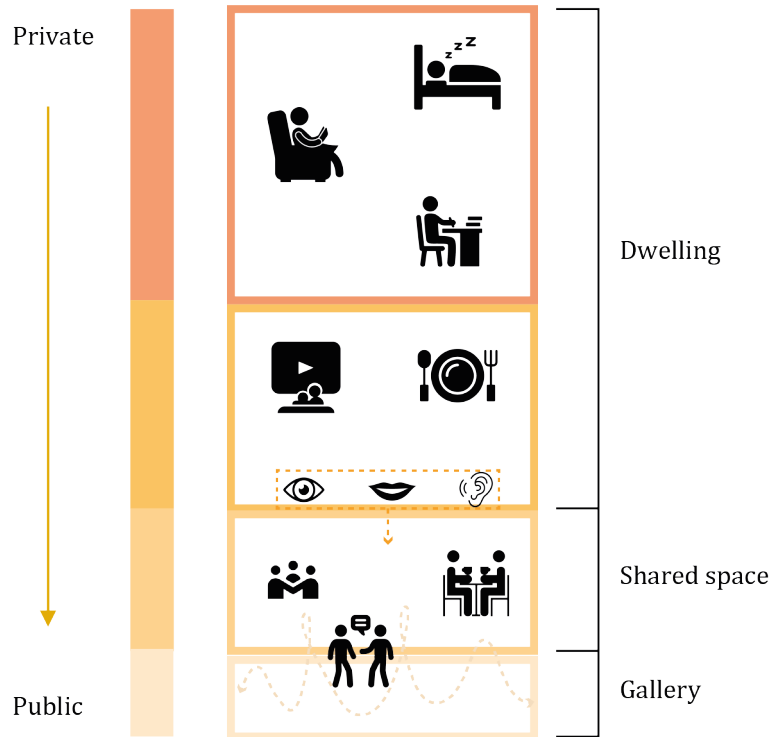

Mix & Match: Assemblies of different target groups

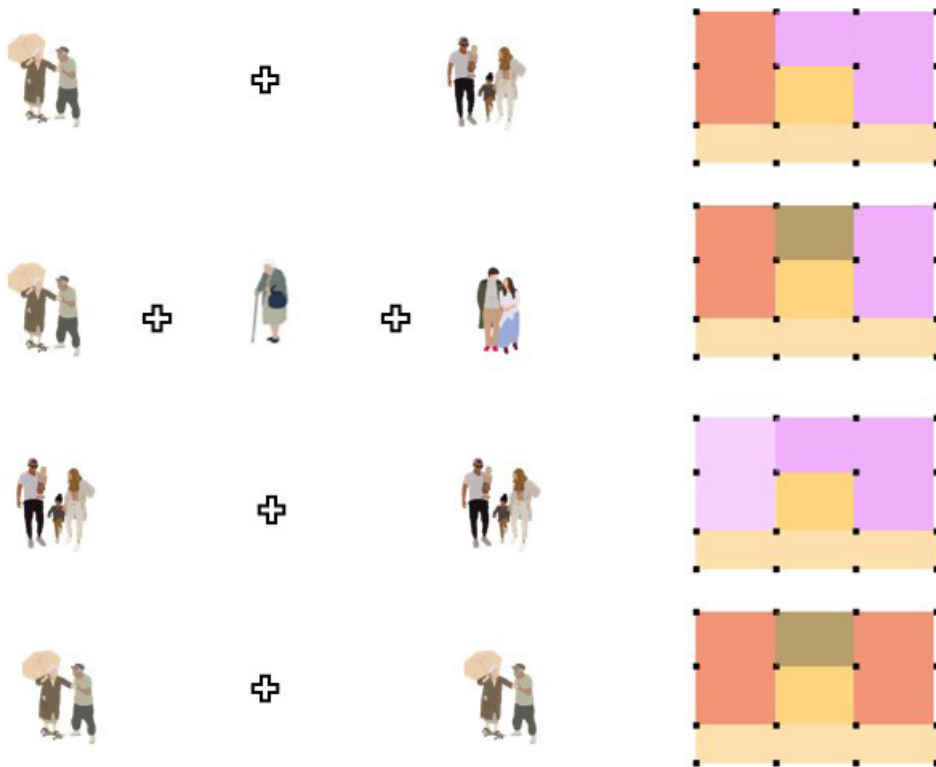
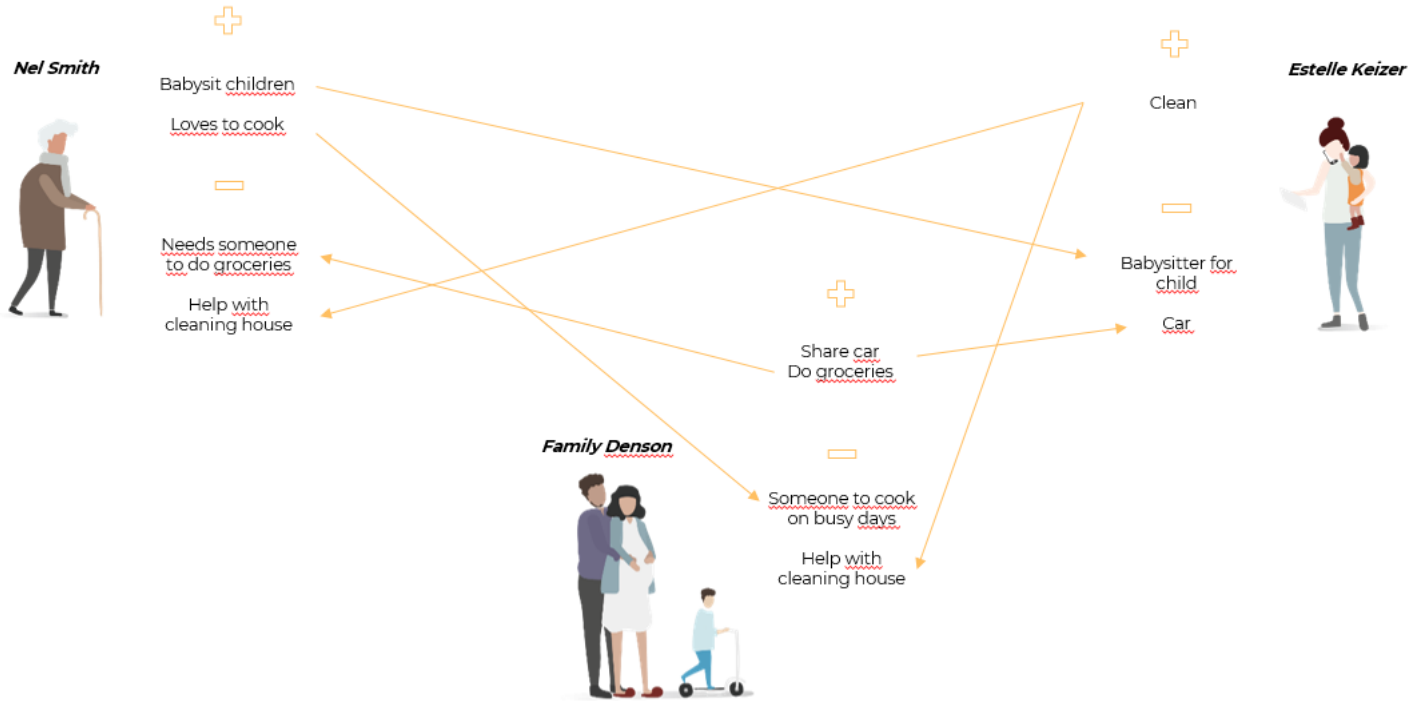

Case studies: The shared space

Family Home, Turkiye

From my personal experience a shared space is the heart of the home. The most precious and quality time we spent here with my family. Especially during good weathers. The situation of the shared terrace makes it easy to make and avoid social contact according to your needs.

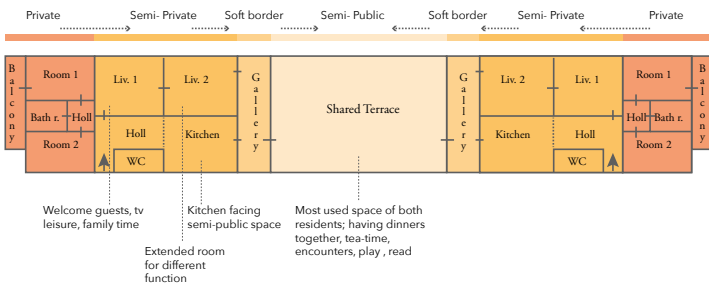

Morning, preparing breakfast

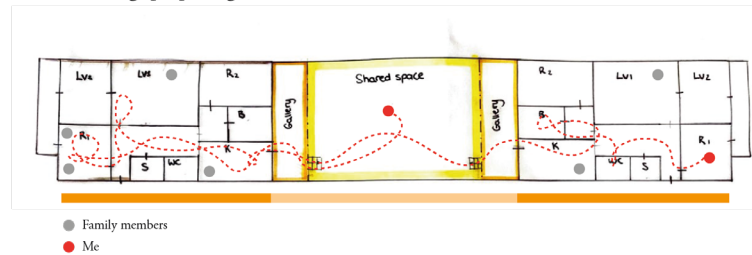

Breakfast / Dinner time

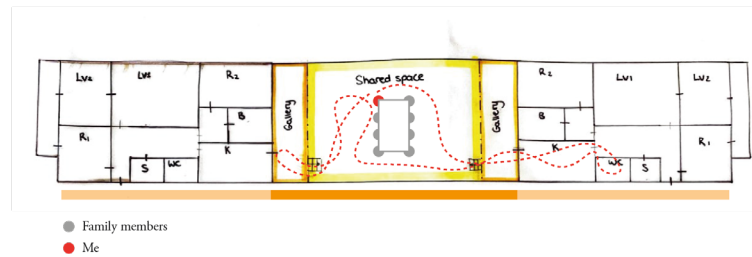

Afternoon

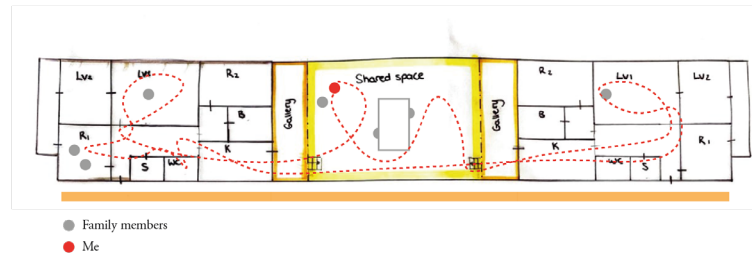

Evening

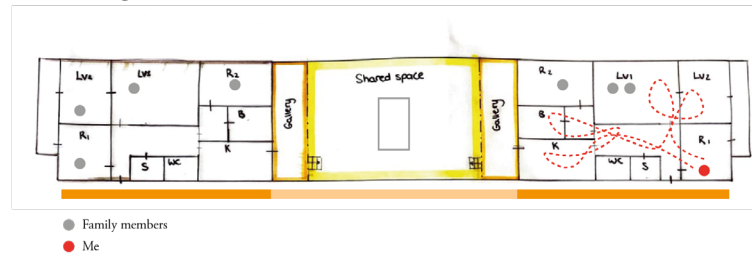

Case studies: The shared space

Communal gardens and terraces

To improve social cohesion within the living environment, communal spaces are a must. The place is not dedicated to one, but is open for everyone within the living environment. With this it is easier to create social contact and the sense of belonging. The shared space and or communal spaces are more and more visible in new architectural project. Both at street level (e.g. CPO-project Oosterburen or De Deeltuyn, DELVA) and roof level (e.g. see Little C, Rotterdam).



CPO-project Oosterburen, 's Hertogenbosch
Natuurbijhuis (z.d.), Geraadpleegd op: <https://natuurbijhuis.nl/portfolio/gezamenlijke-tuin-cpo-oosterburen/>



Little C, Rotterdam
Geraadpleegd op: <https://www.littlecoolhaven.nl/>



De Deeltuyn DELVA, Utrecht
Geraadpleegd op: <https://delva.la/projecten/de-deeltuyn/>

Case studies: The shared space

Experimentele flats, Overvecht-Utrecht

Another example over shared spaces is the experimentele flats in Utrecht. This project was a pilot, started in 1971 and still is holding on. The idea behind was to create more communal spaces within the apartment lifestyle that tend to be anonymous. Each apartment is facing the communal hall, that is designed to the needs of the residents. See photo's below.



Dieren, V. van. (z.d.), Geraadpleegd op: <https://www.gelderlander.nl/utrecht/50-jaar-experimentele-flats-in-overvecht-ja-er-geburde-weleens-wat-met-een-leuke-buurvrouw-ab97d789/208603268/>



Jonge, A. de. (z.d.), Geraadpleegd op: <https://www.gelderlander.nl/utrecht/50-jaar-experimentele-flats-in-overvecht-ja-er-geburde-weleens-wat-met-een-leuke-buurvrouw-ab97d789/208603268/>

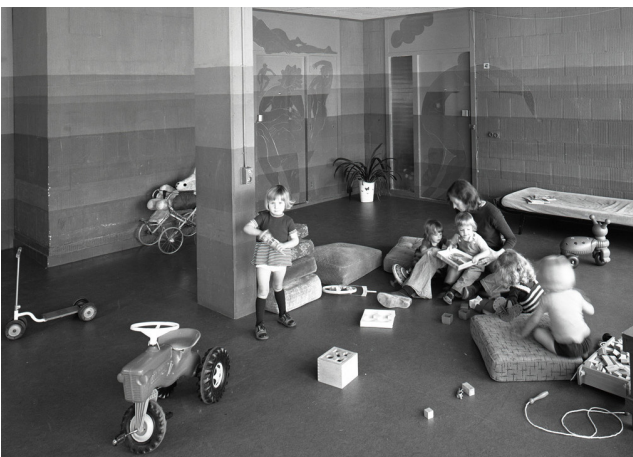

Het Utrechts Archief (z.d.), Geraadpleegd op: <https://www.gelderlander.nl/utrecht/50-jaar-experimentele-flats-in-overvecht-ja-er-geburde-weleens-wat-met-een-leuke-buurvrouw-ab97d789/208597898/>



Jonge, A. de. (z.d.), Geraadpleegd op: <https://www.gelderlander.nl/utrecht/50-jaar-experimentele-flats-in-overvecht-ja-er-geburde-weleens-wat-met-een-leuke-buurvrouw-ab97d789/208603268/>

III. Building

Masterplan

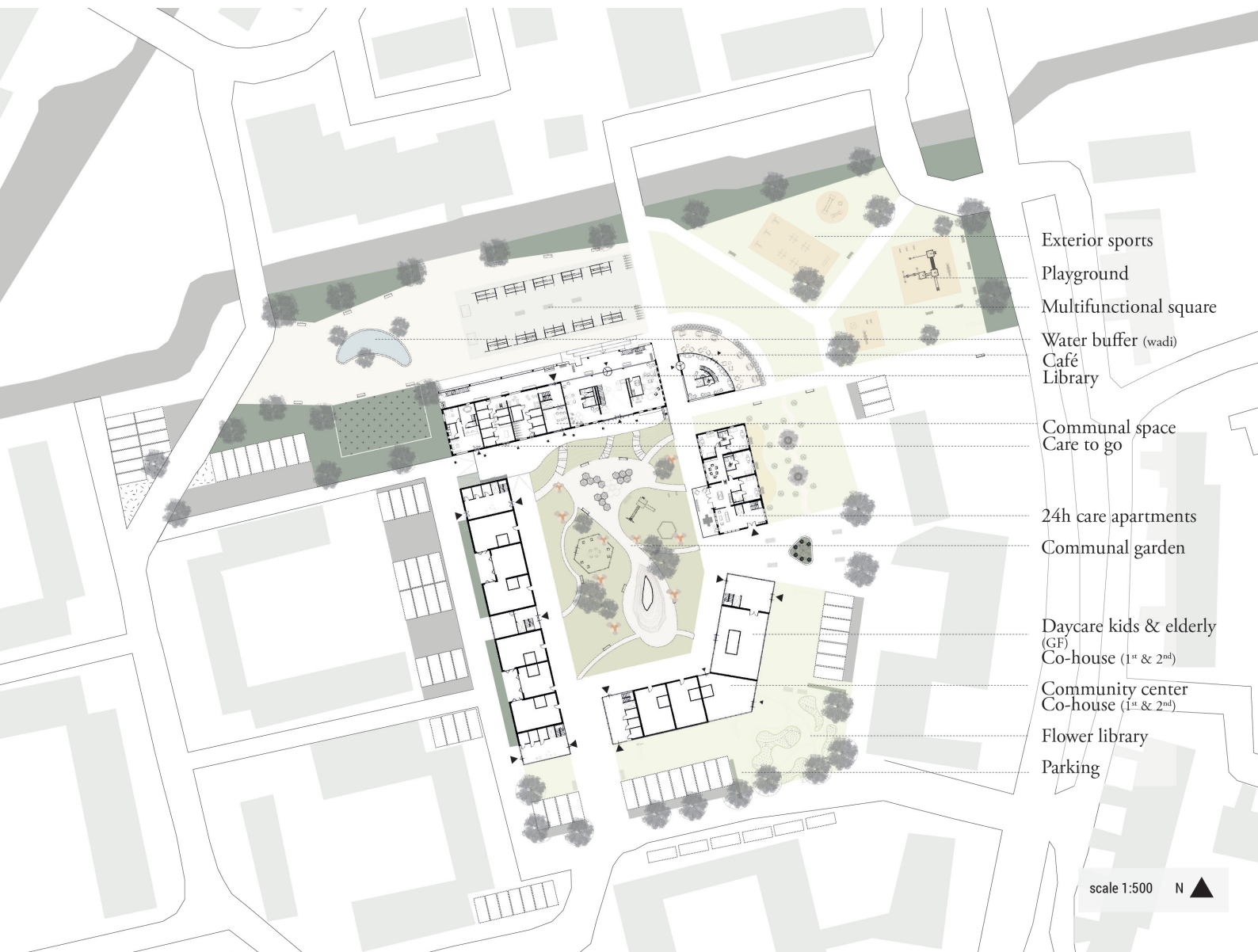

- Exterior sports
- Playground
- Multifunctional square
- Water buffer (wadi)
- Café
- Library
- Communal space
- Care to go
- 24h care apartments
- Communal garden
- Daycare kids & elderly (GF)
- Co-house (1st & 2nd)
- Community center
- Co-house (1st & 2nd)
- Flower library
- Parking

scale 1:500 N ▲

Ground floor plan

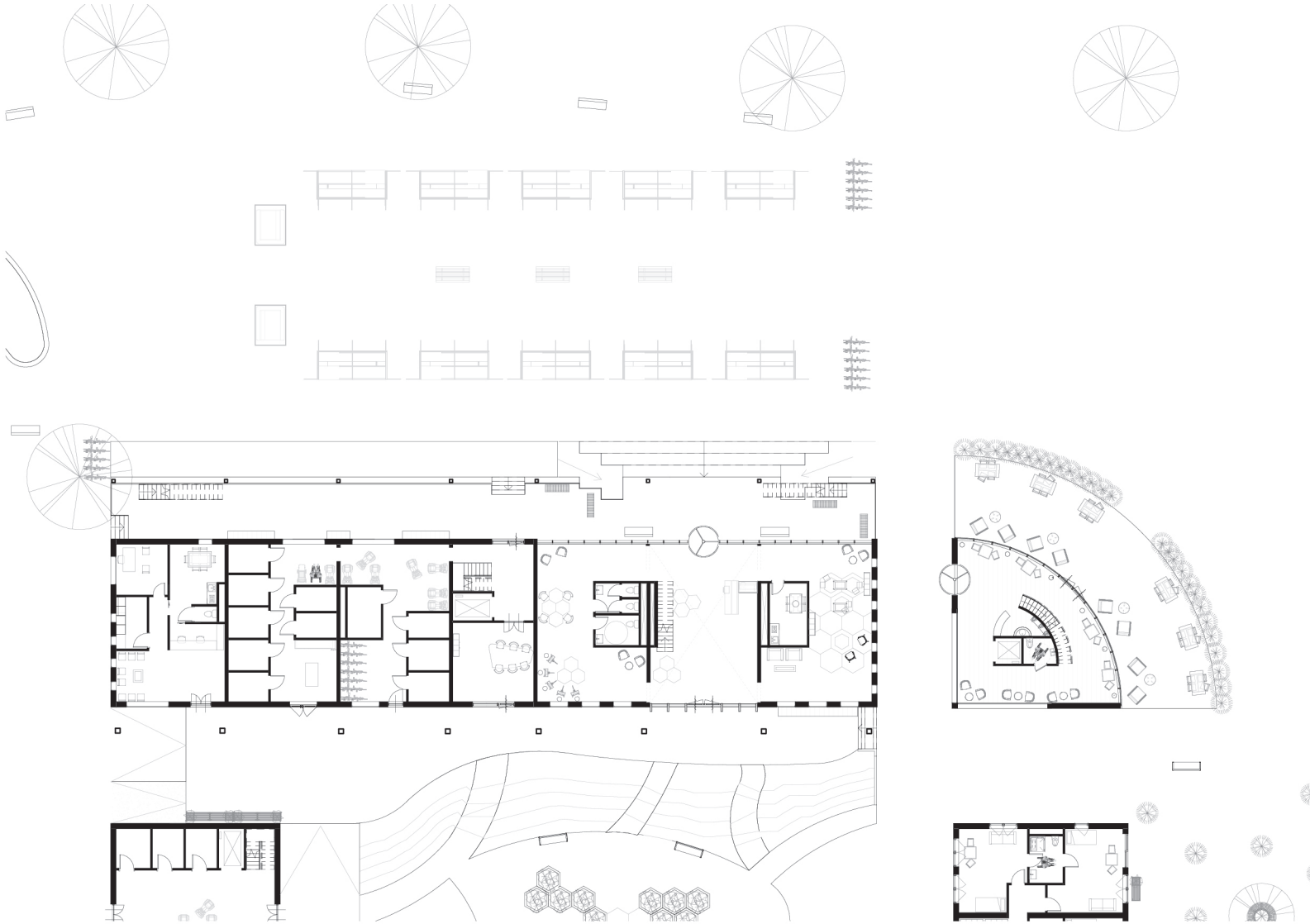

Floor plans

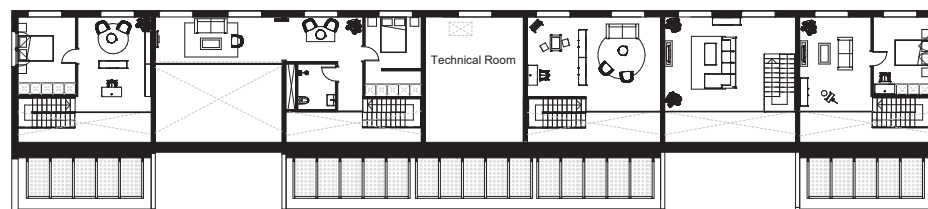
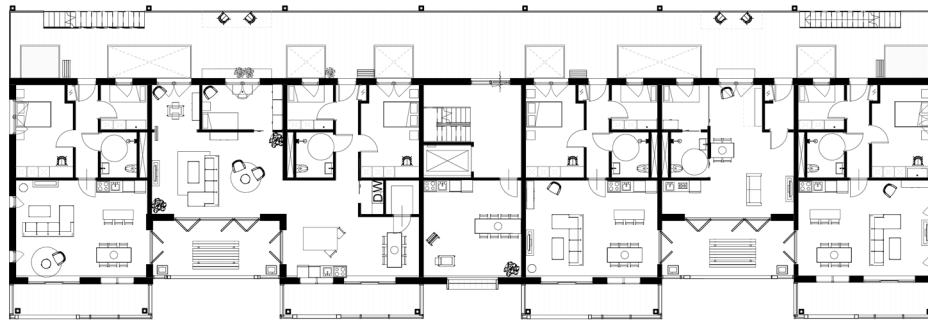
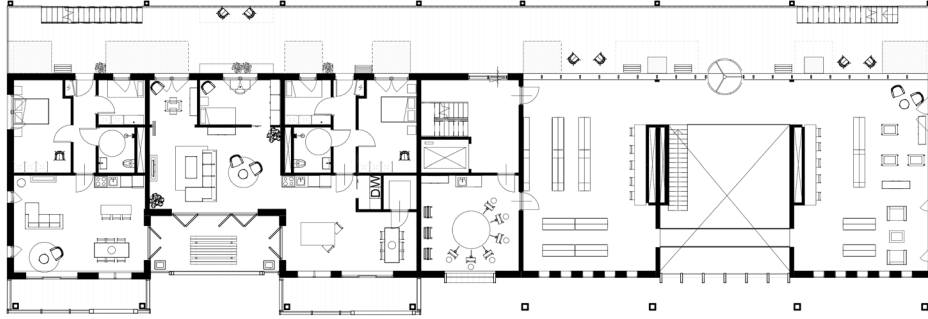

Roof plan

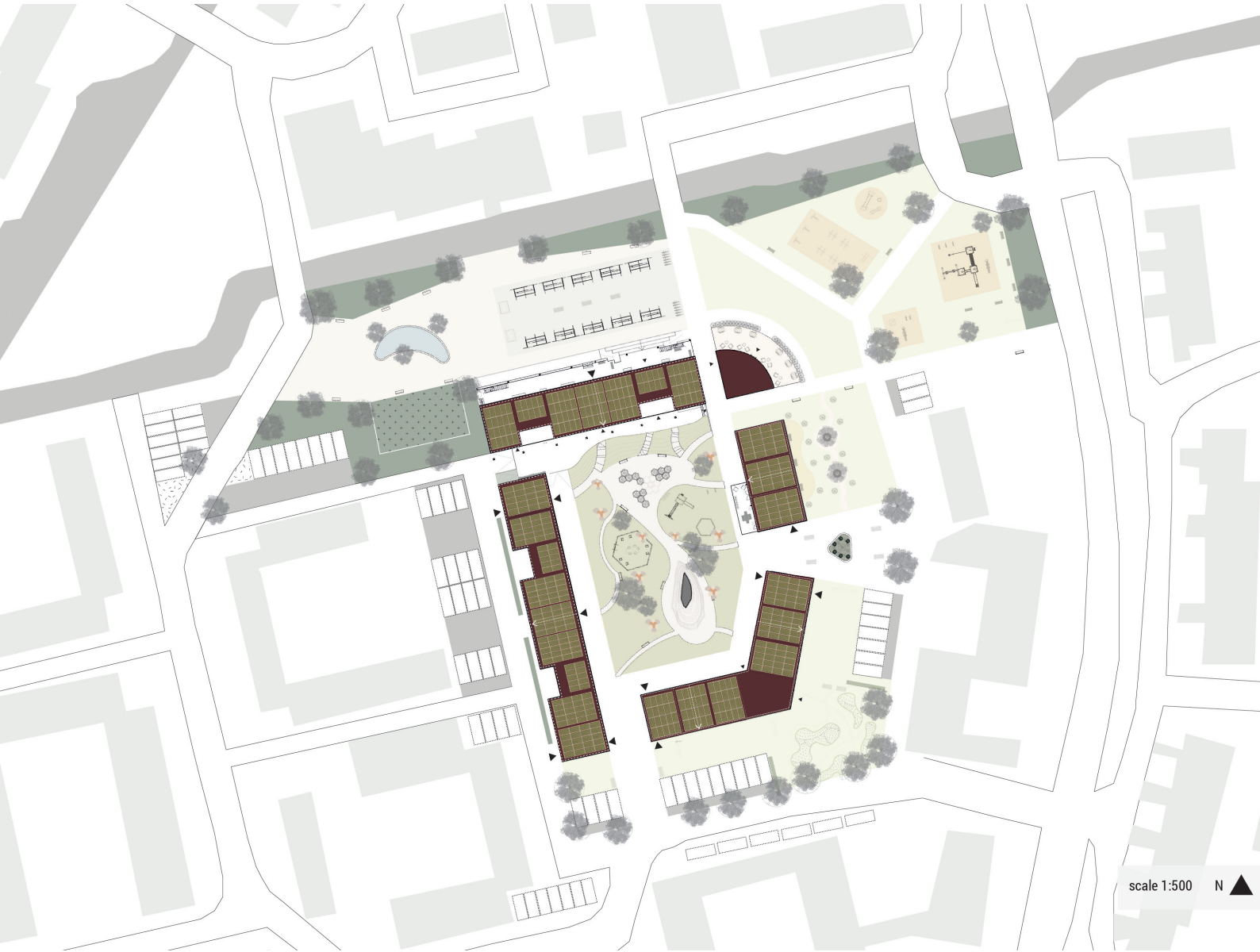
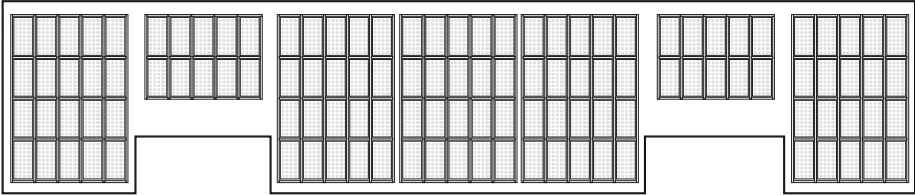

scale 1:500 N ▲

Formal vs. Organic

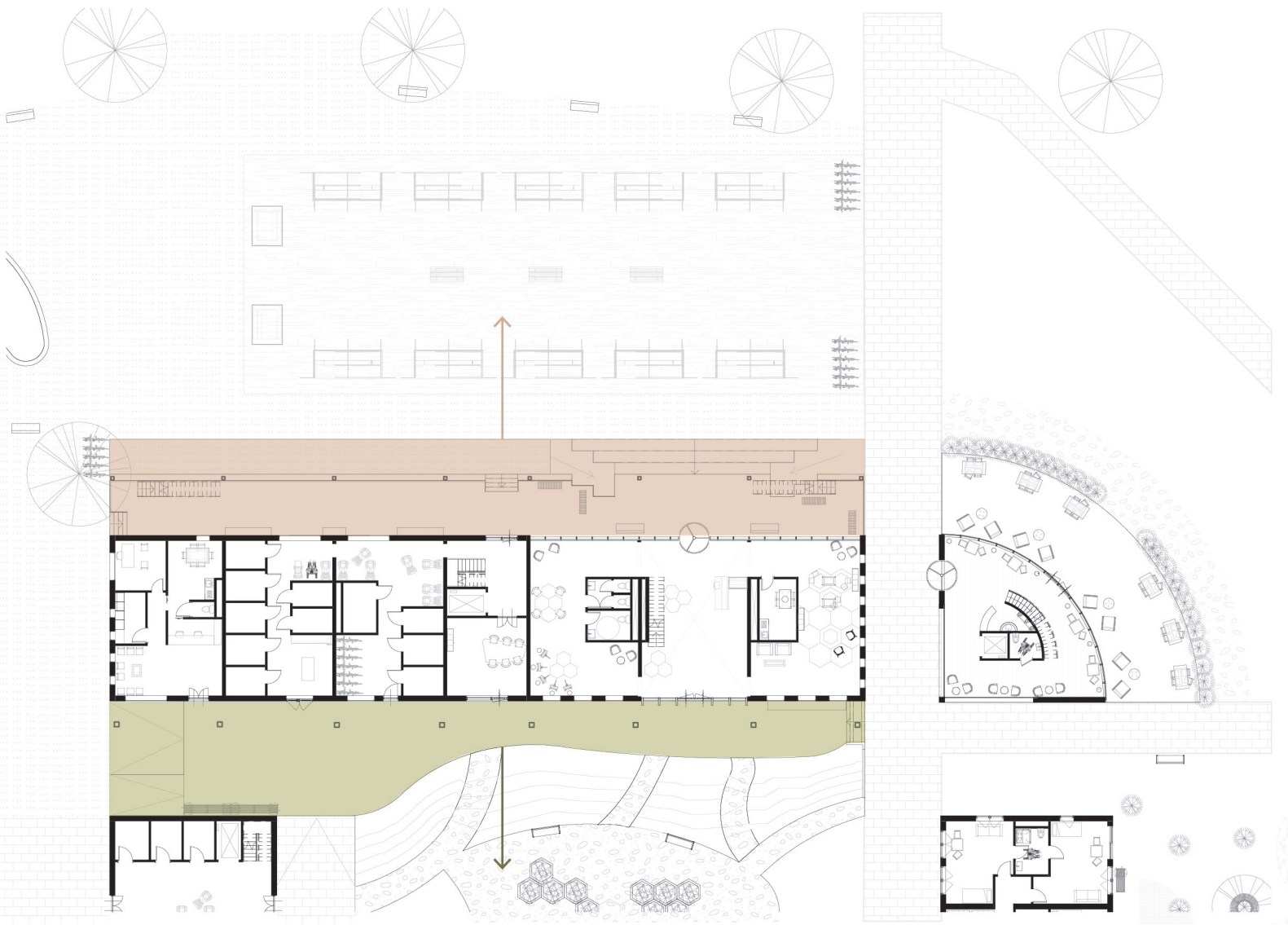

Dwelling types

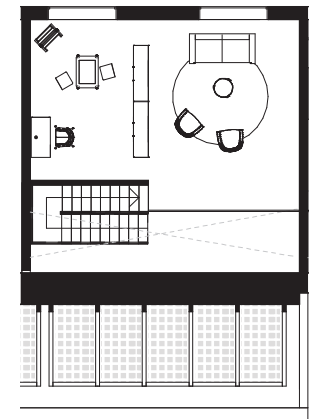
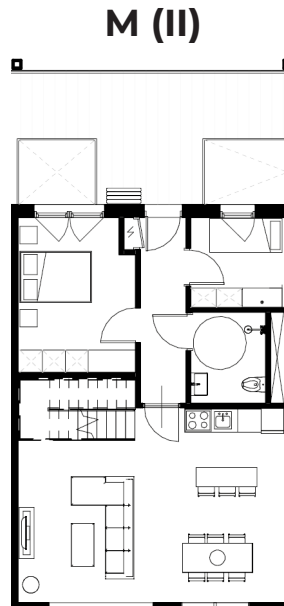
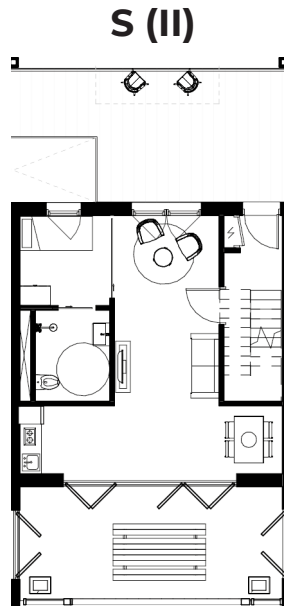

Dwelling types

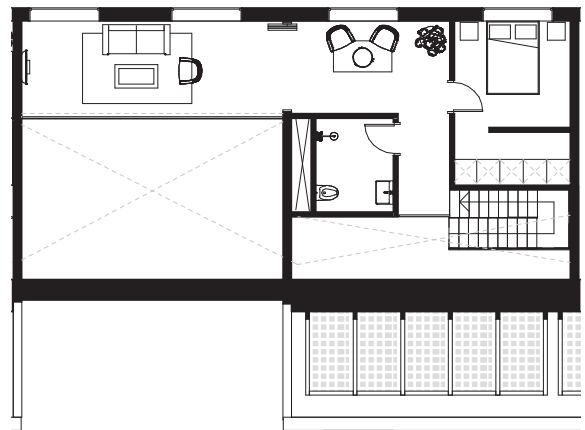
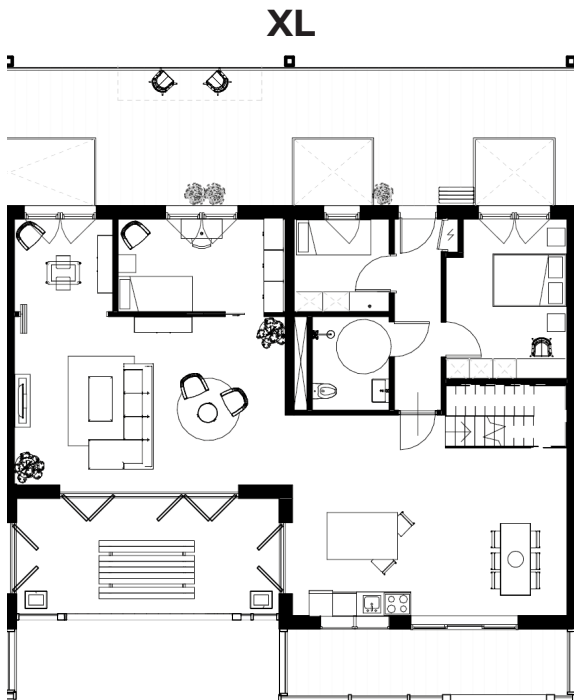
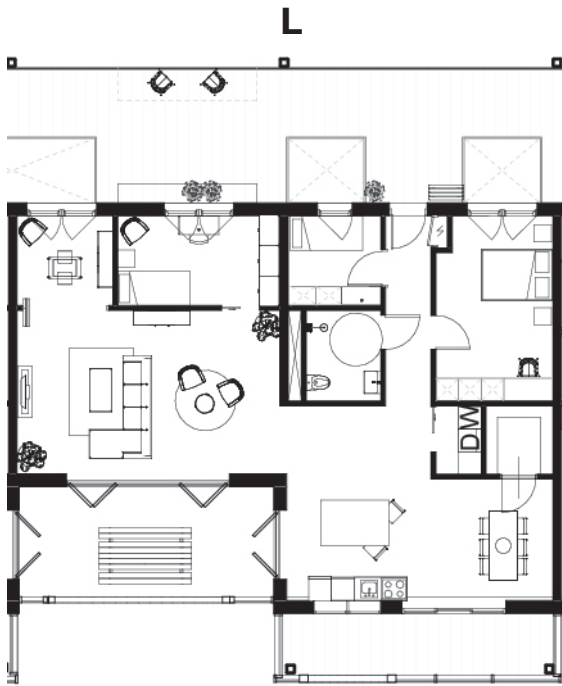

Facades



Facades



IV. Climate

Solar Energy

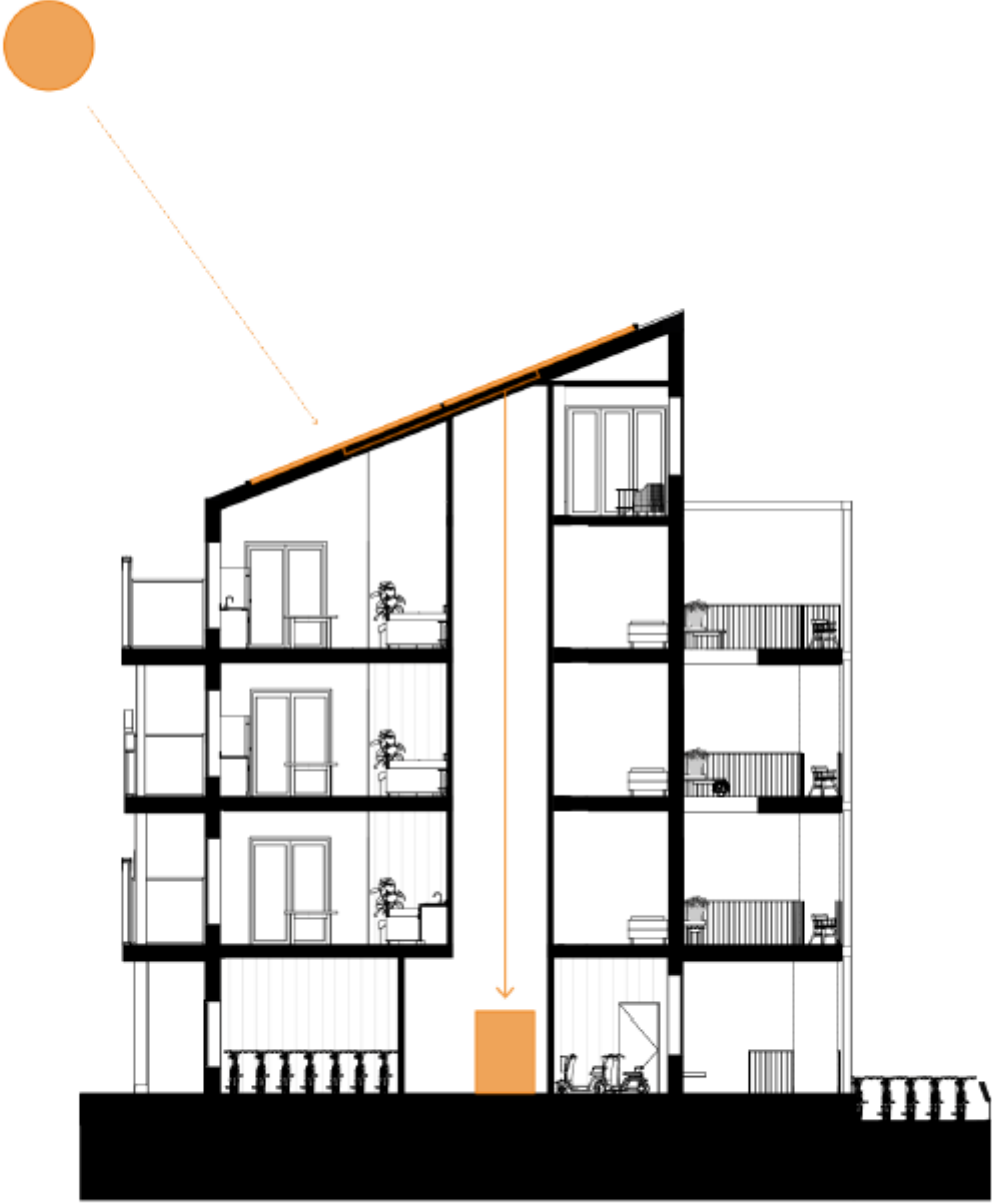

Rainwater





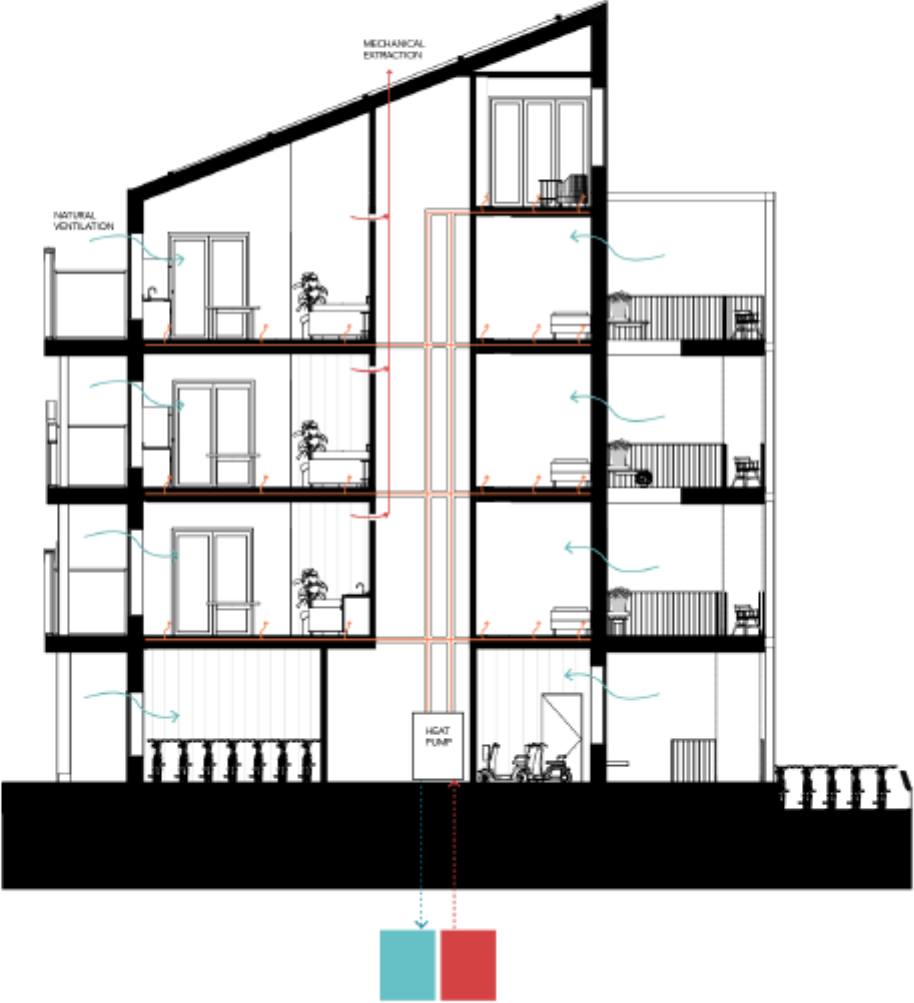

Heating & Cooling

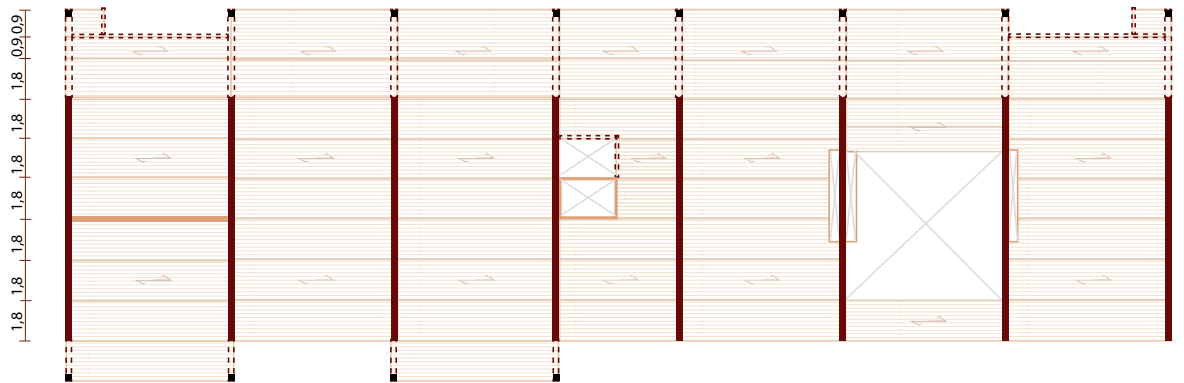

V. Structure





DC Level 1

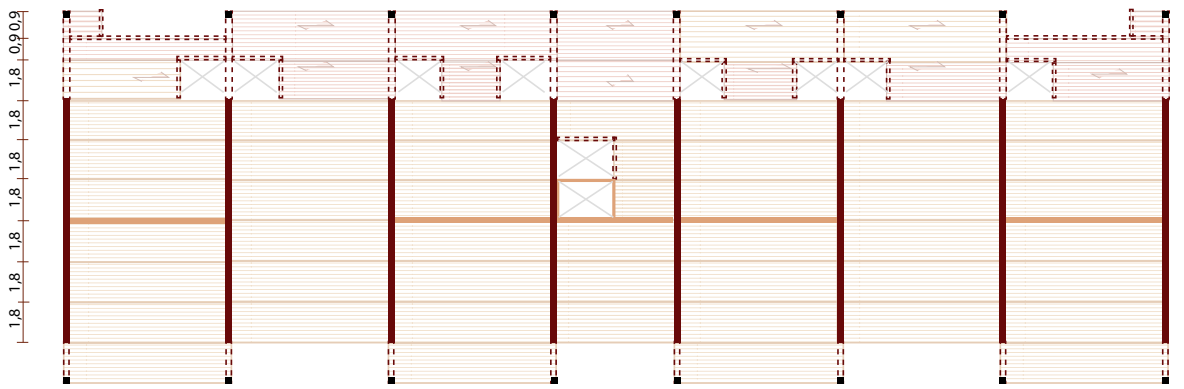

-  Bearing wall
-  Beam
-  Stabilisation
-  Column

DC Level 2 +



-  Bearing wall
-  Beam
-  Stabilisation
-  Column

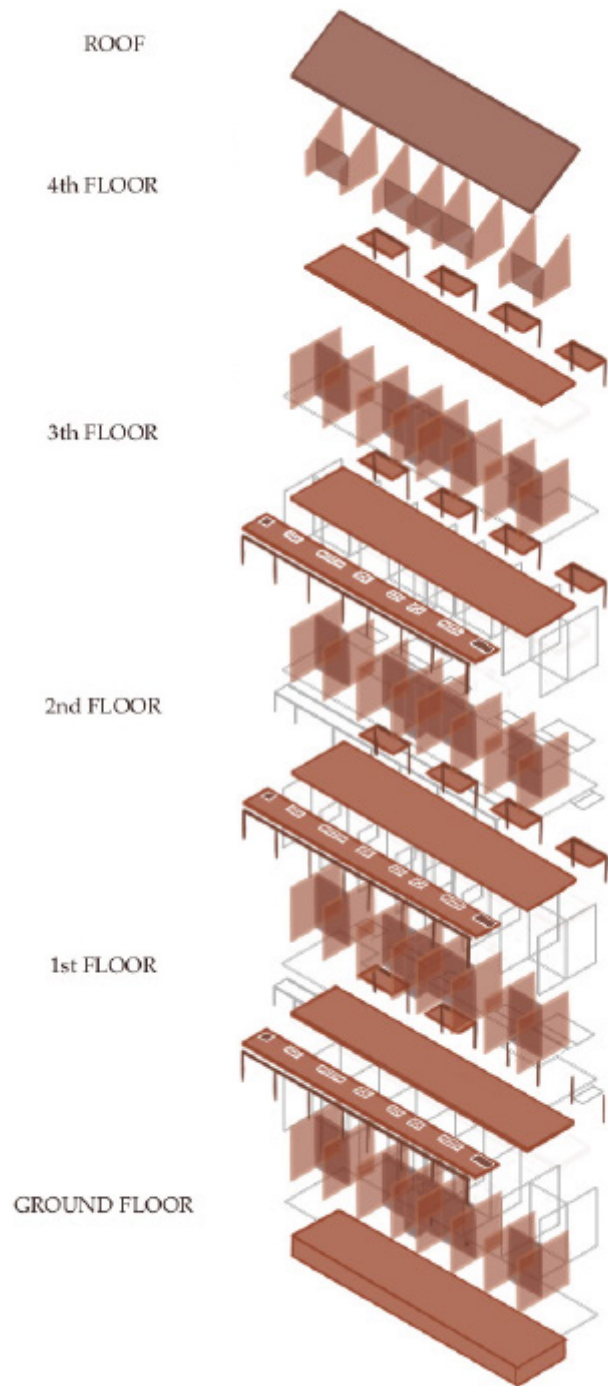

1:20

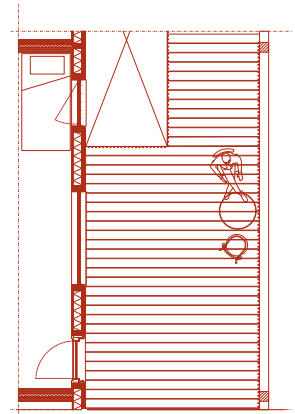
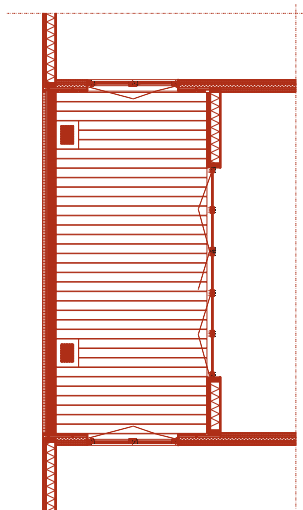
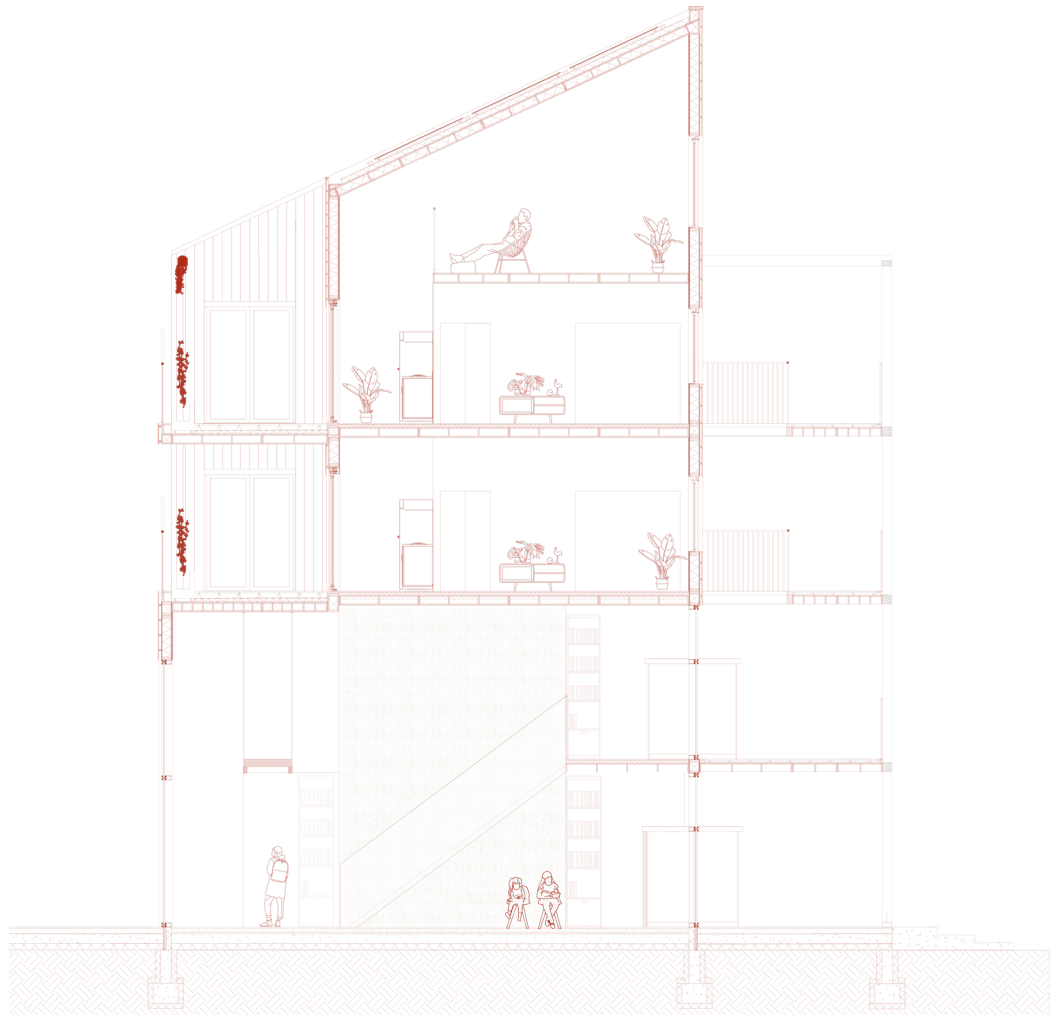
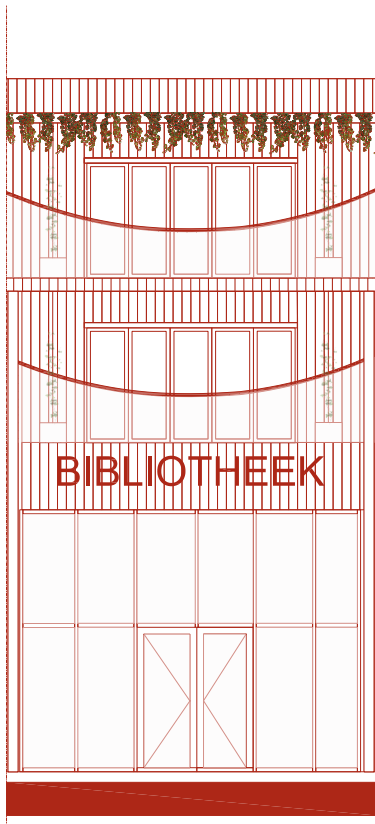

Details

Detail Roof (Voi)

ROOF

BIPV SOLAR PANELS	40
ROOFING SHINGELS	2
EPDM	1
INSULATION	100
KERTORIPA BOX	200
WITH INSULATION	150

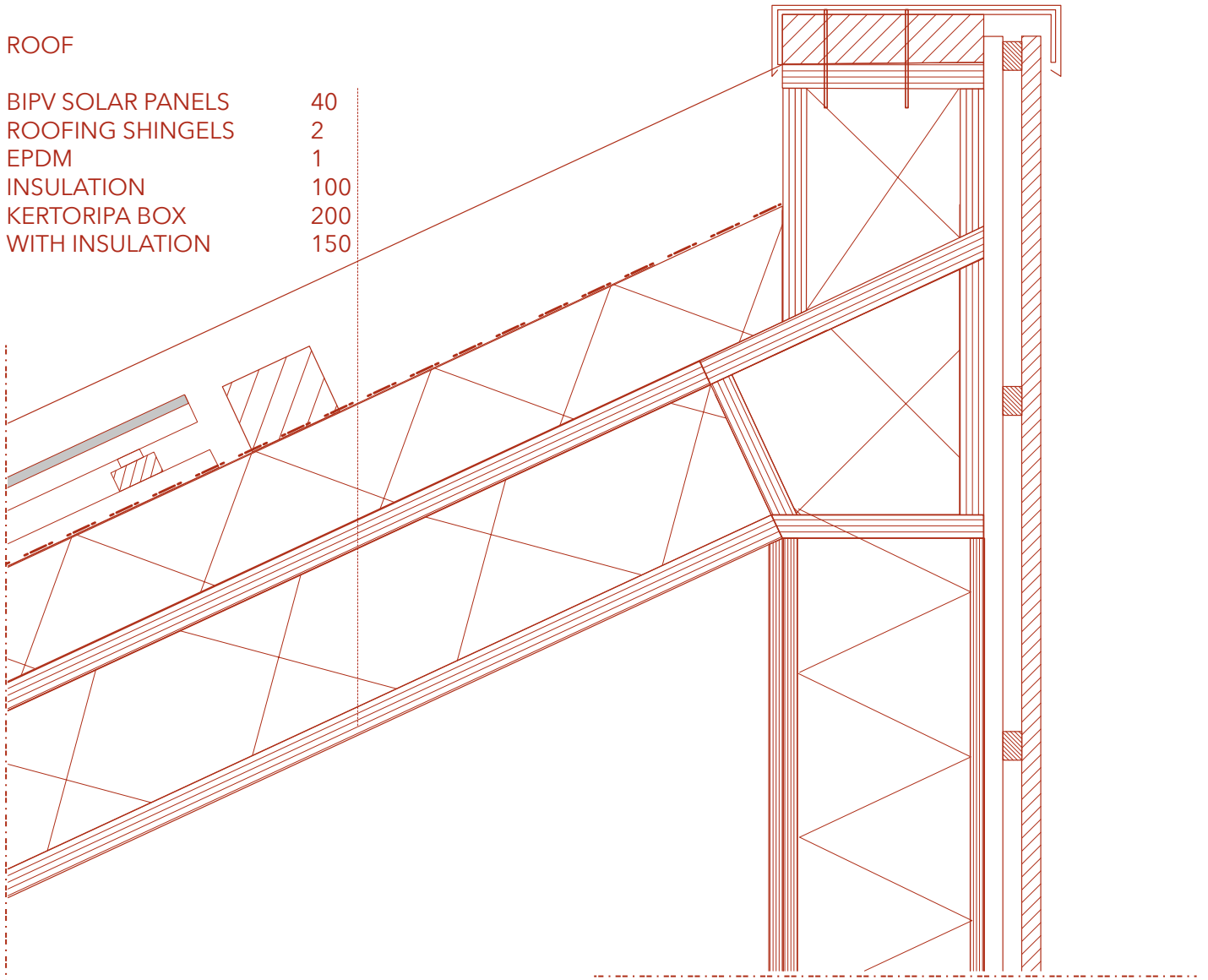

Detail Roof (V02)

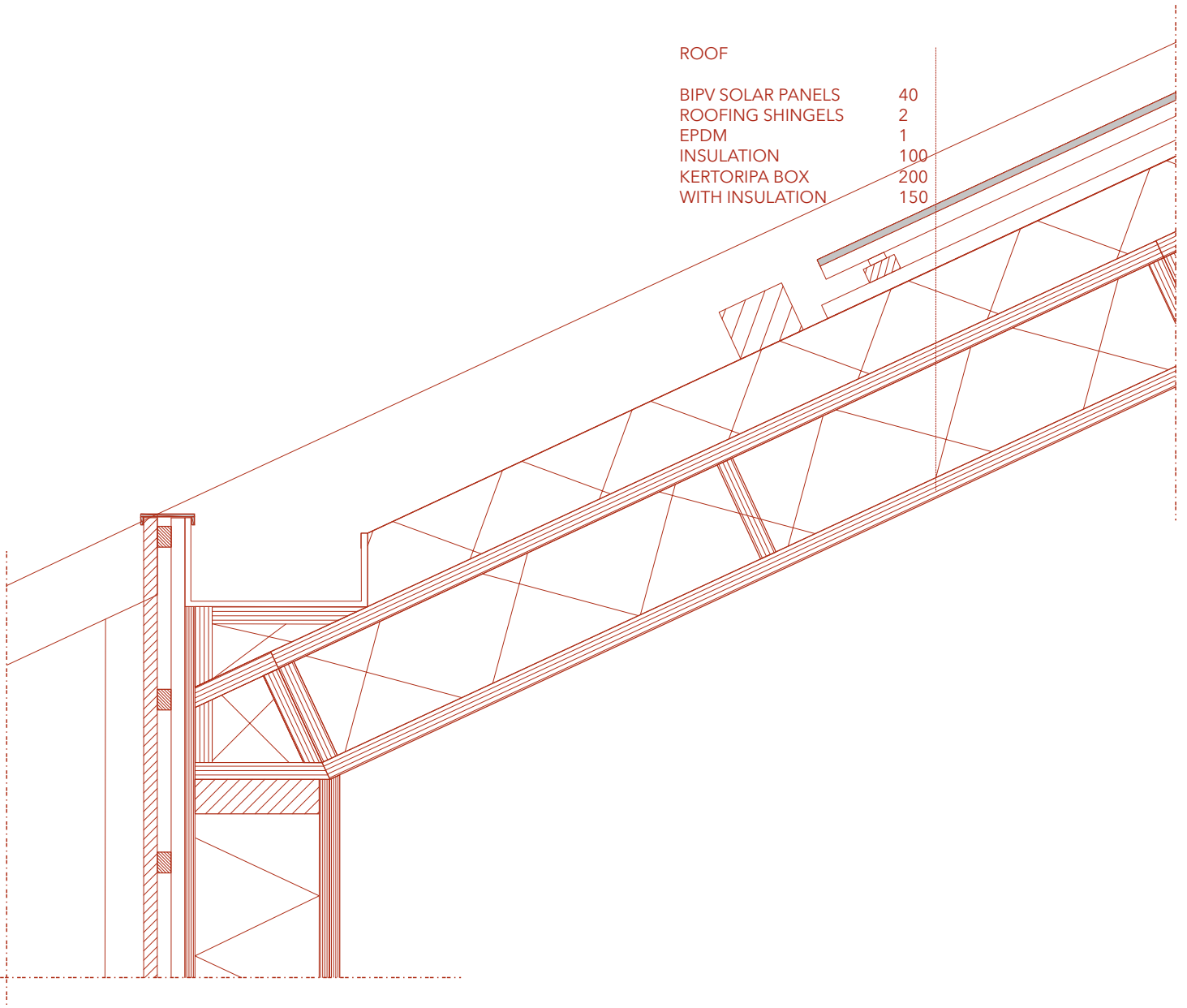

ROOF

BIPV SOLAR PANELS	40
ROOFING SHINGELS	2
EPDM	1
INSULATION	100
KERTORIPA BOX	200
WITH INSULATION	150

Detail Terrace (V03)

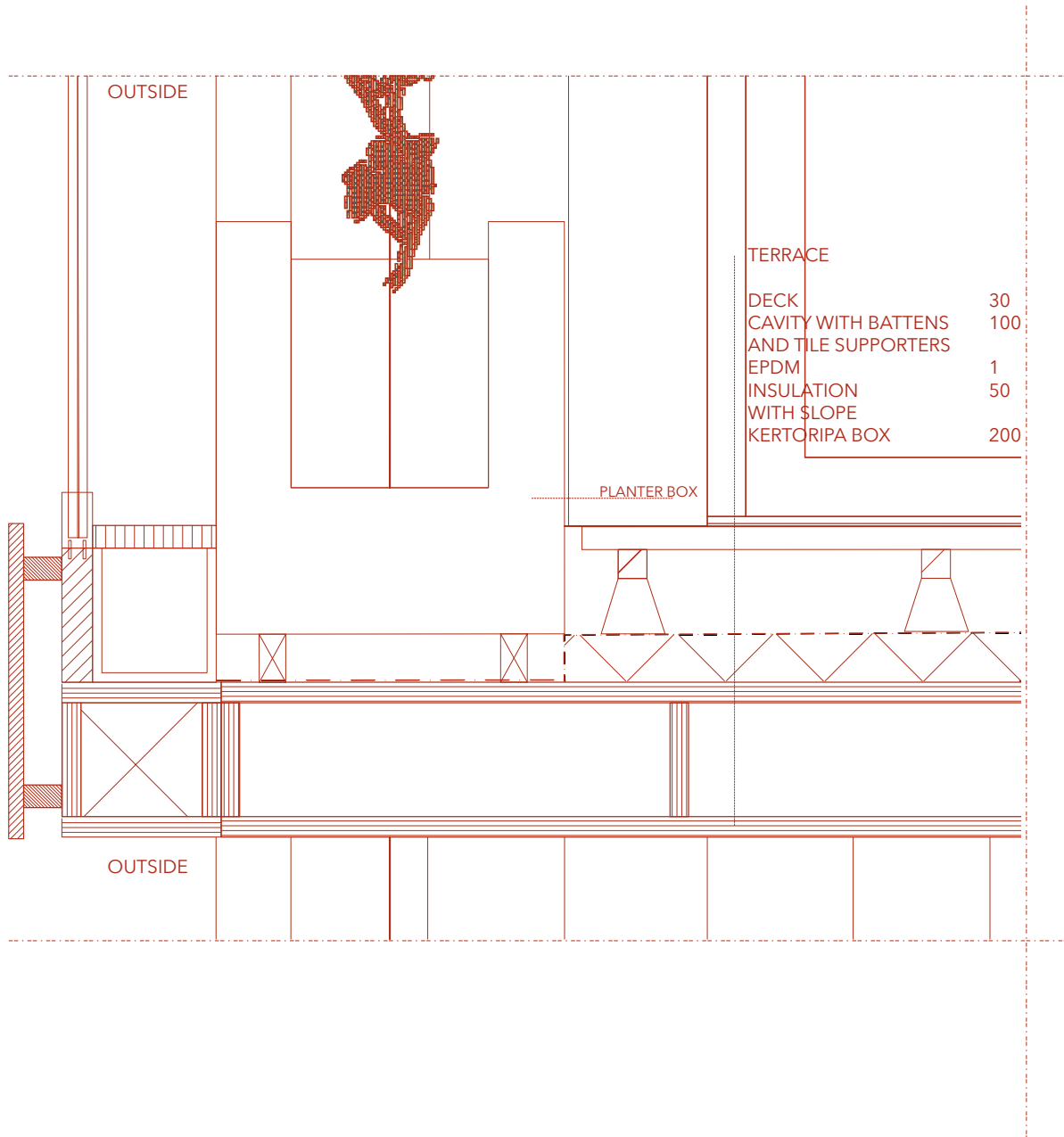

Detail Terrace (V04)

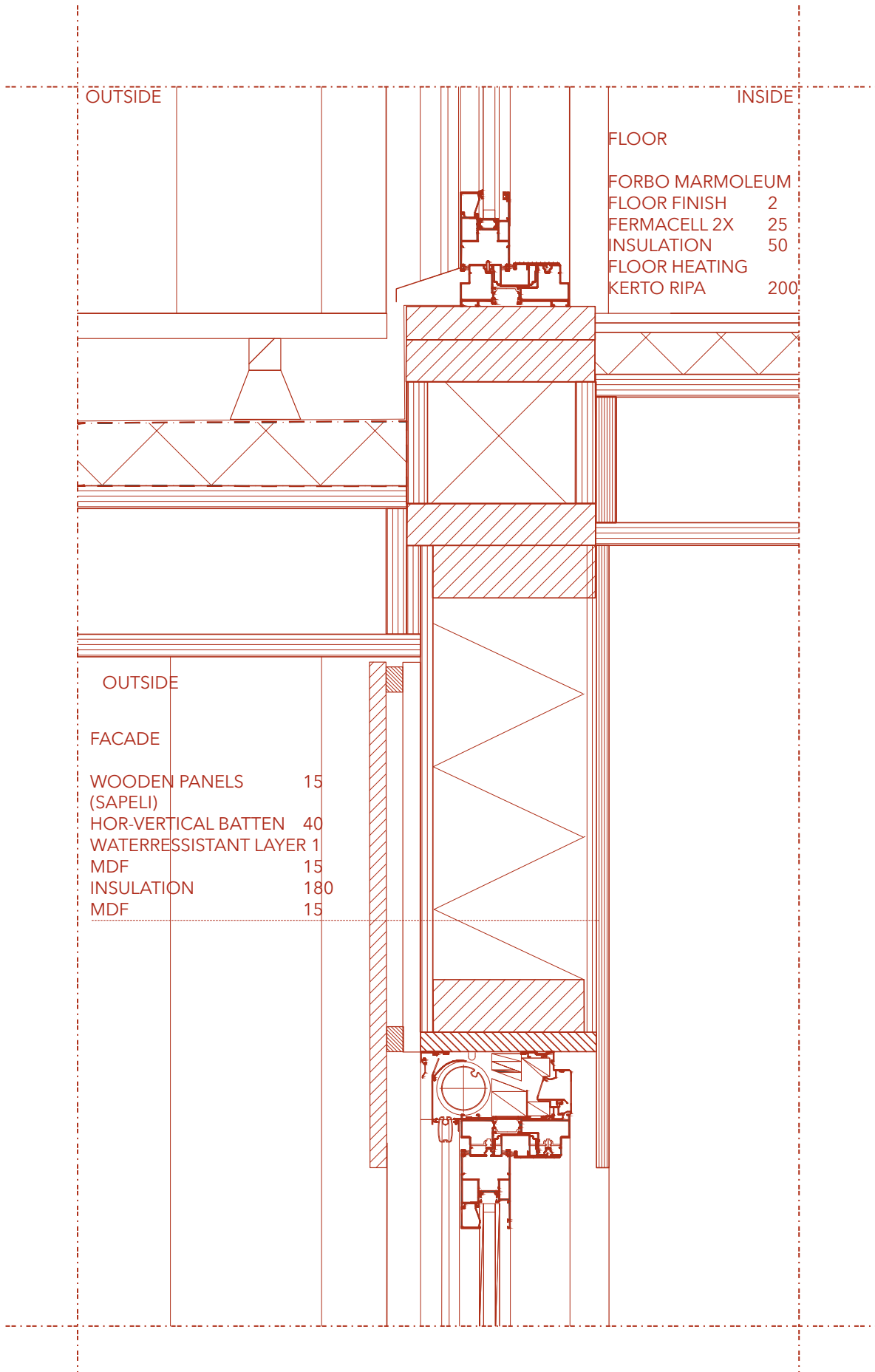

Detail Gallery (V05)

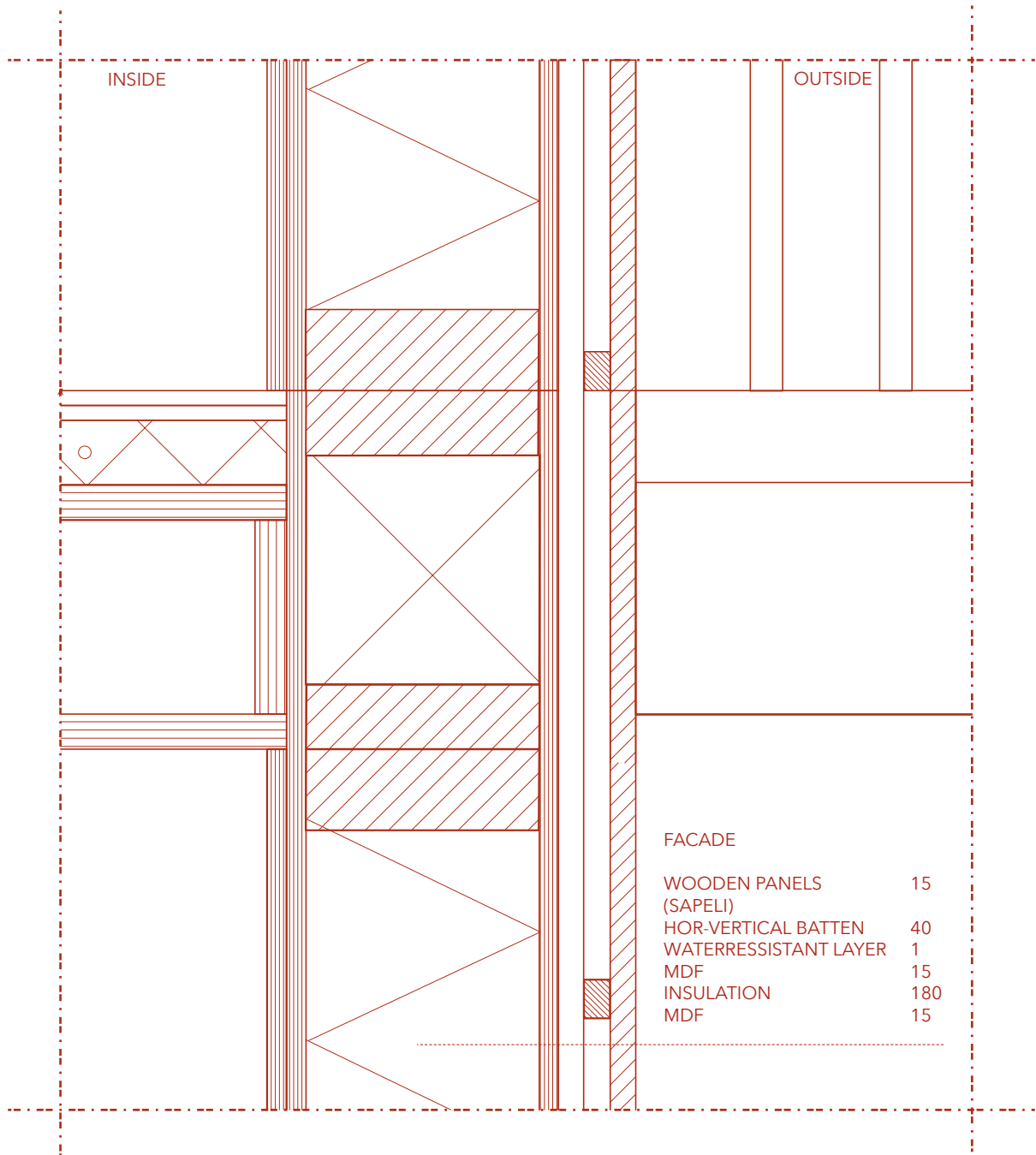

Detail Gallery (V06)

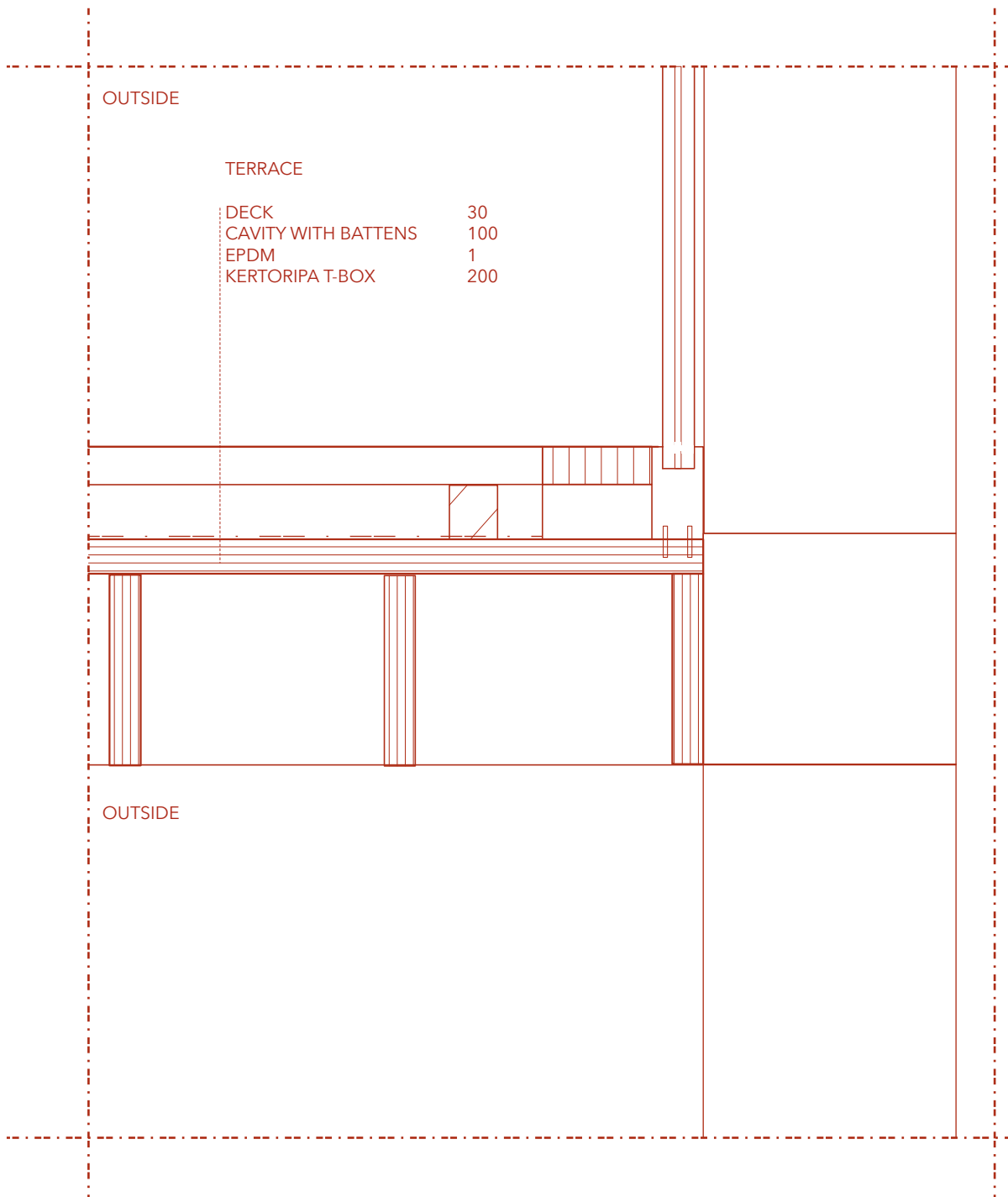

Detail Terrace (V07)

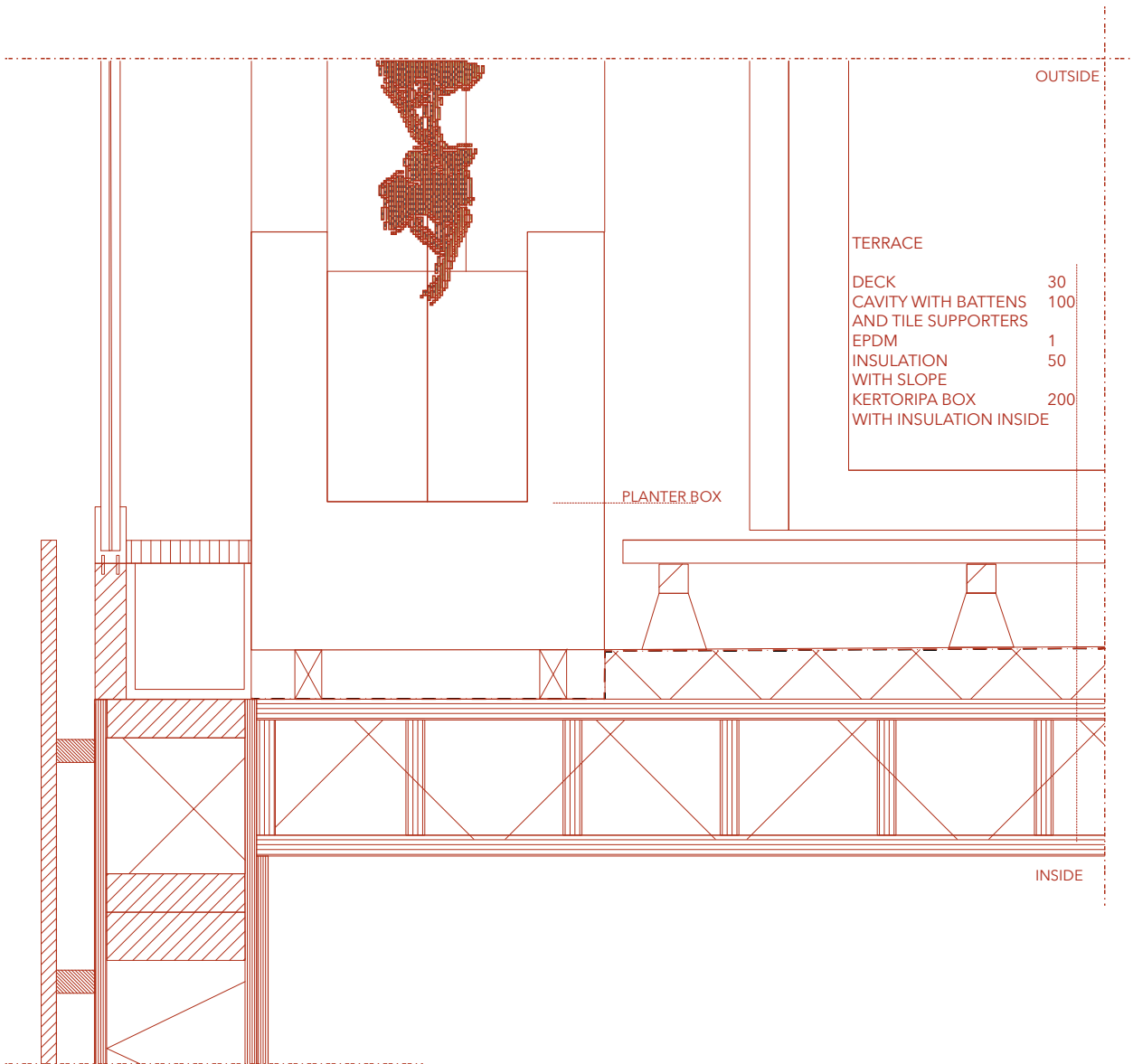

Detail Terrace (Vo8)

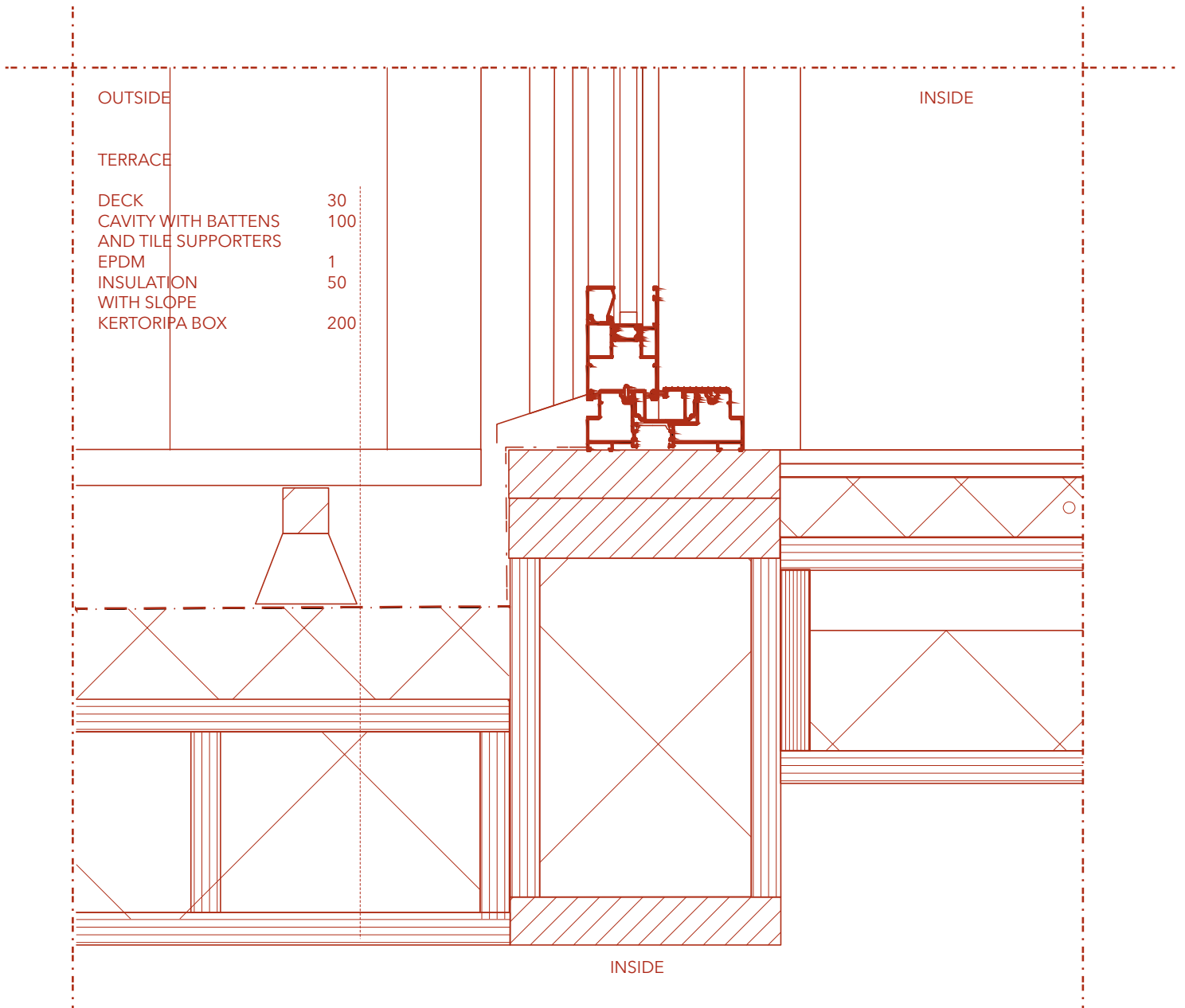

Detail Ground Floor (V09)

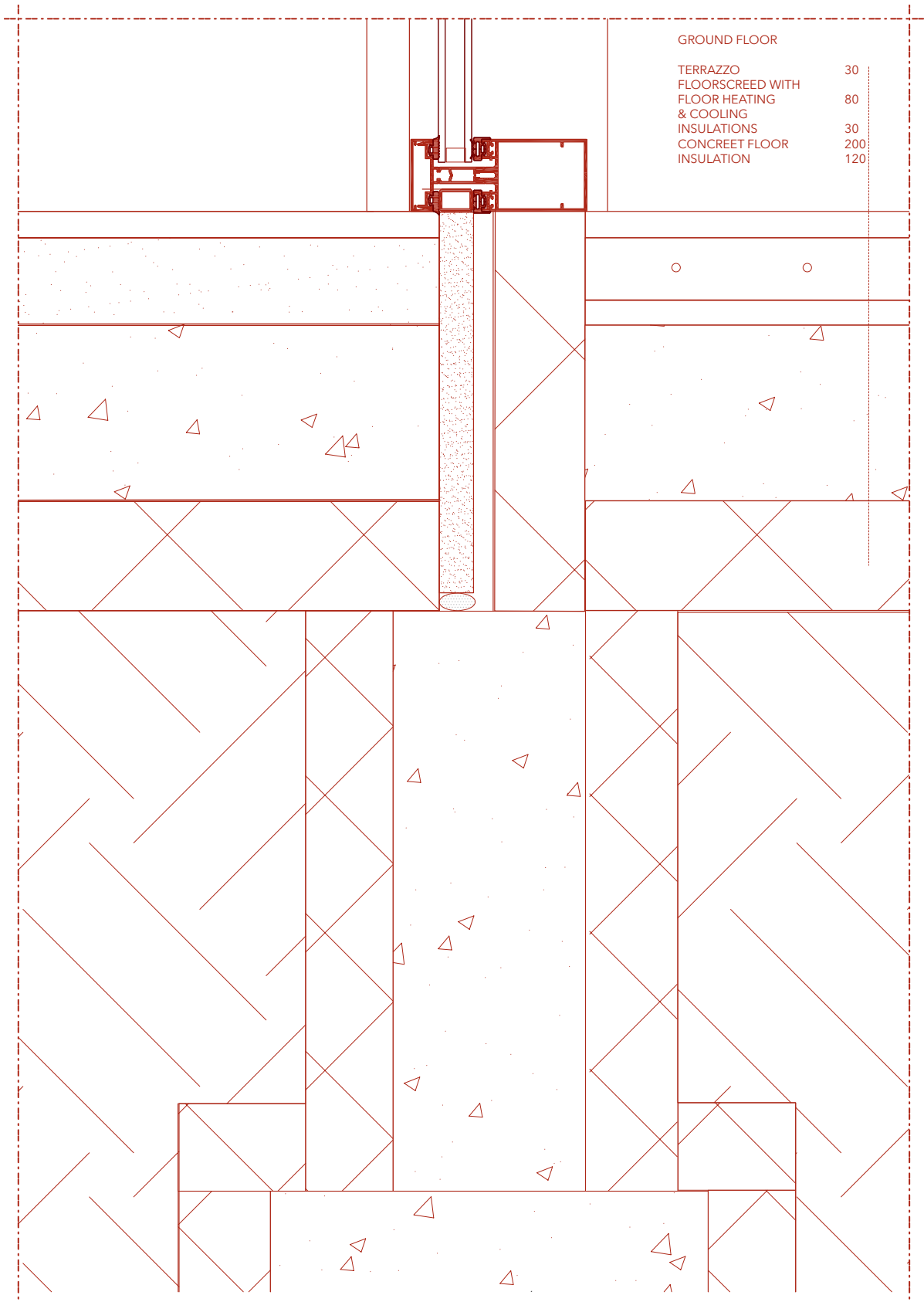

Detail Terrace (Hoi)

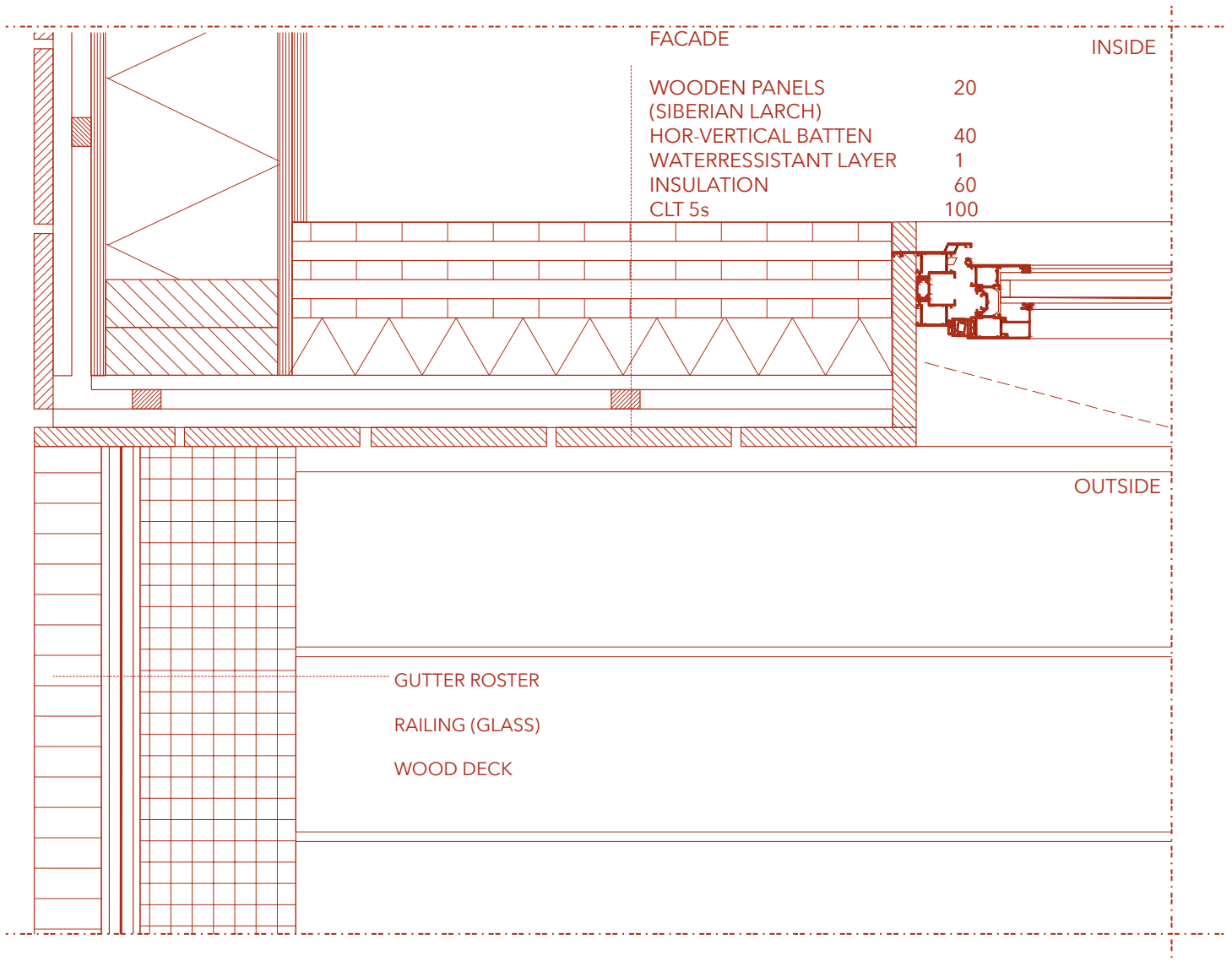

Detail Terrace (Ho2)

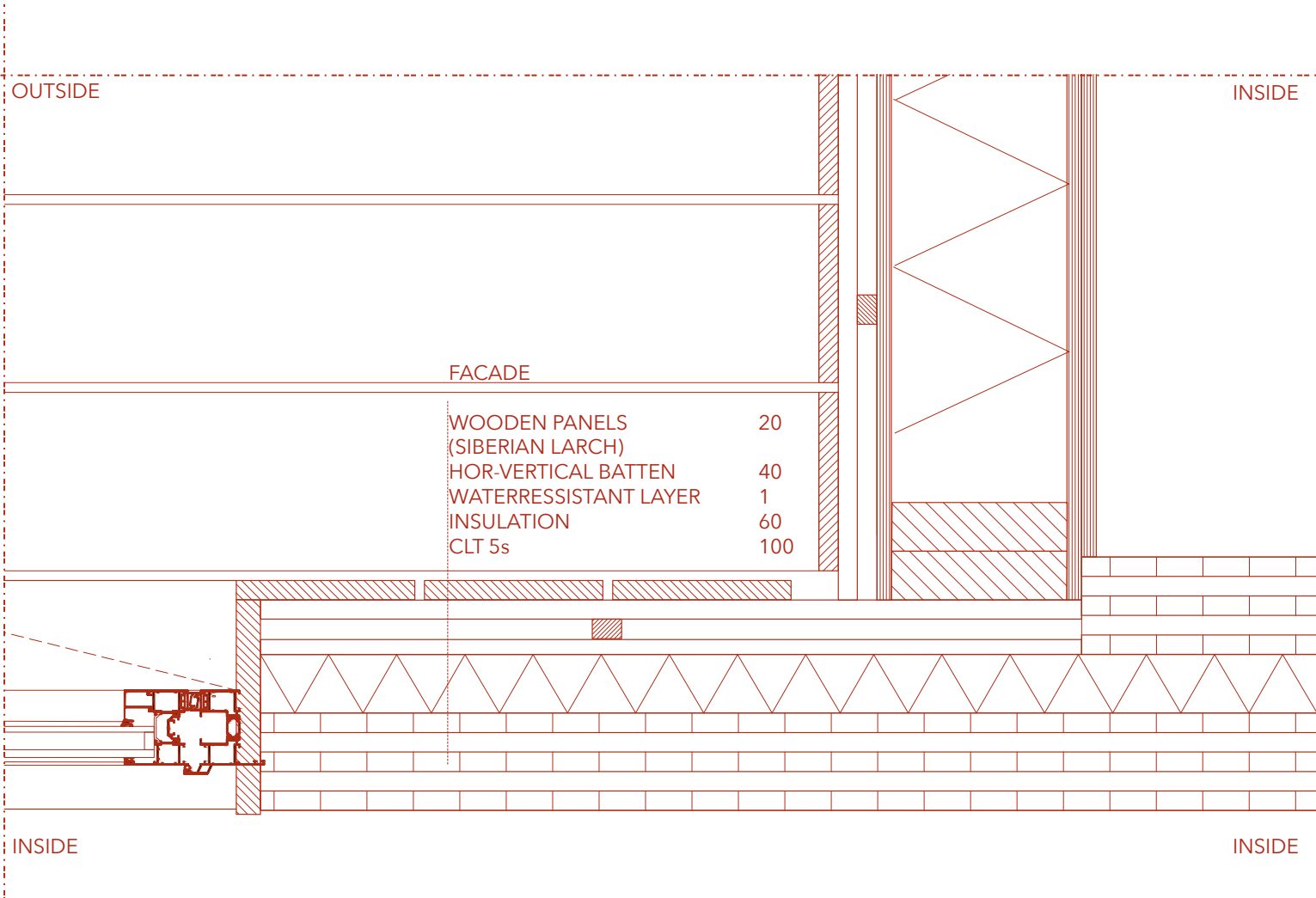

Design Studies

I. Library

Connect the Library

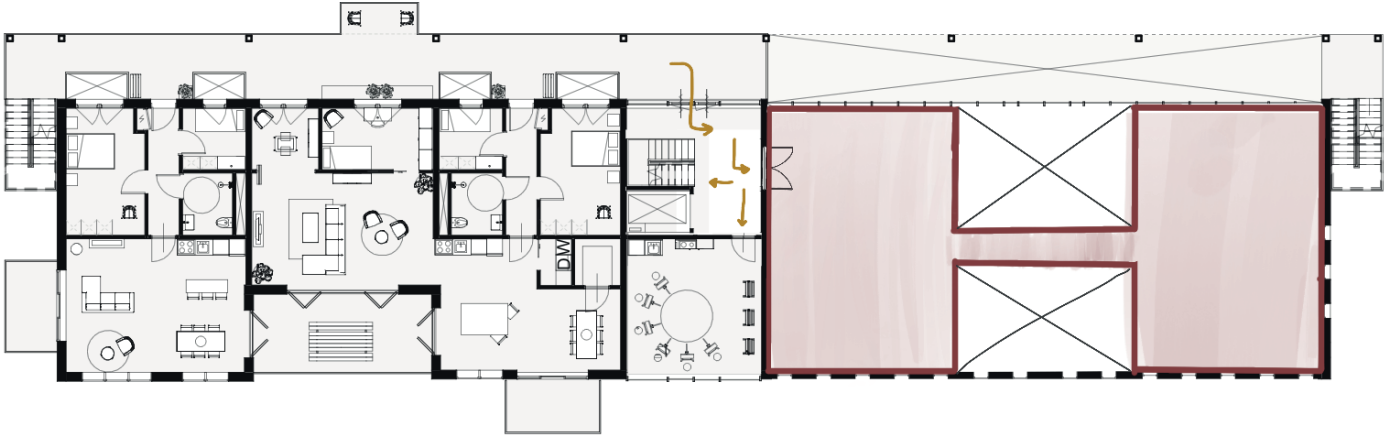

II. Intergenerational living

Case studies: Intergenerational living

STA | zwei+plus Intergenerational Housing

+1

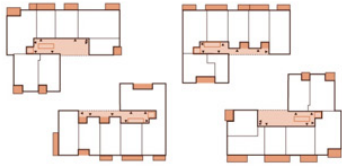

MF

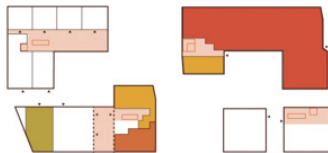

- Transition area
- Semi-private; balcony / niche
- Staircase / Elevator
- Kindergarden
- Communal space
- Greenery
- Care functions

+ Public and community functions on main floor

+ Upper floors are dedicated to living

+ Community spaces are close to entrance

- Some entrances are hard to recognize

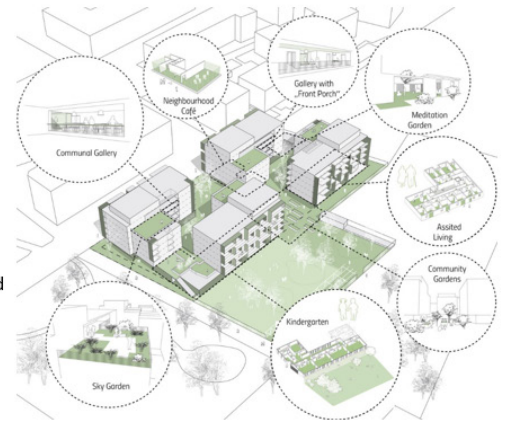

Intergenerational complex | Neubrandenburg Oststadt

+1

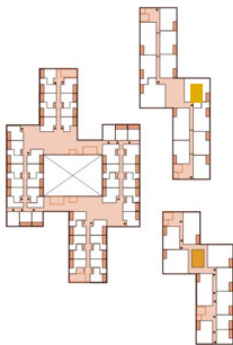

MF

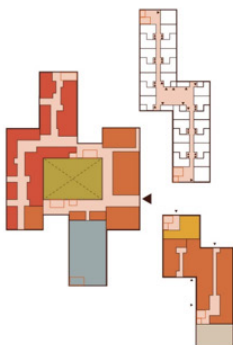

- Transition area
- Semi-private; balcony / niche
- Staircase / Elevator
- Kindergarden
- Communal space
- Greenery
- Care functions
- Parking
- Storage

+ public and community functions on main floor

+ upper floors are dedicated to living

+ each floor has a communal space

+ Communal spaces close to entrance

- The elderly housing and family houses are separated (in different blocks)



Case studies: Intergenerational living

Lange Eng Co-Housing community | Denmark



- Transition area
- Semi-private; balcony / niche
- Communal space
- Greenery

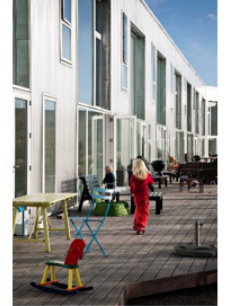

+ Communal spaces close to entrance

+ upper dwellings are connected to community garden

+ A front and back entrance (common & hidden entrance)

- High quantity of stairs

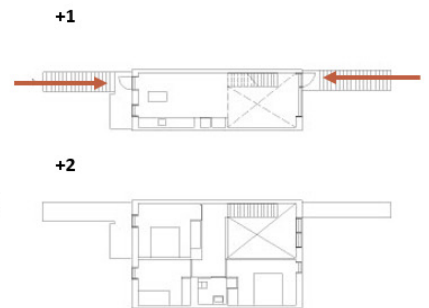

III. Facade Design

Facade studies

South facade



North facade



South facade



North facade



Facade studies

South facade



North facade



South



North



Facade studies

South



North



South



North



Facade studies

South



North



South



North



South



North

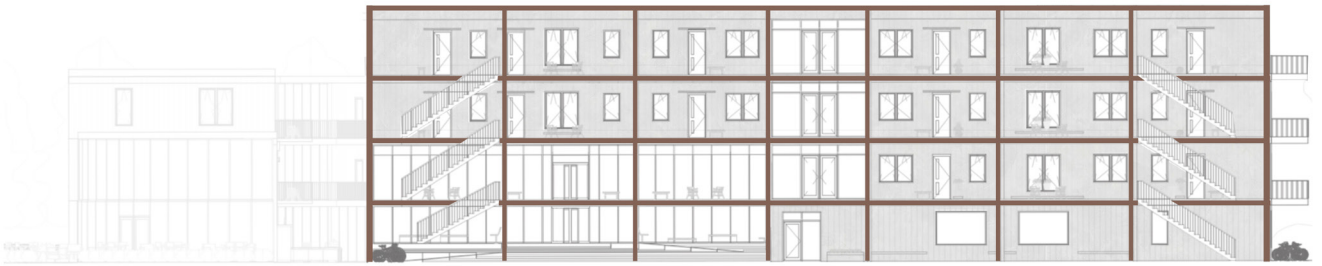

South



North

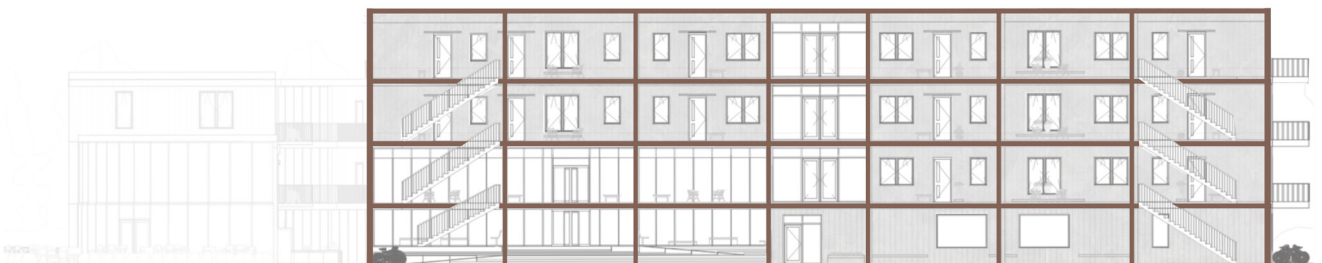

South



North



South



North



Facade studies

South



North



South



North



Facade studies

South



North



South



North



Hexagonal pattern
Balconies

Facade studies

South

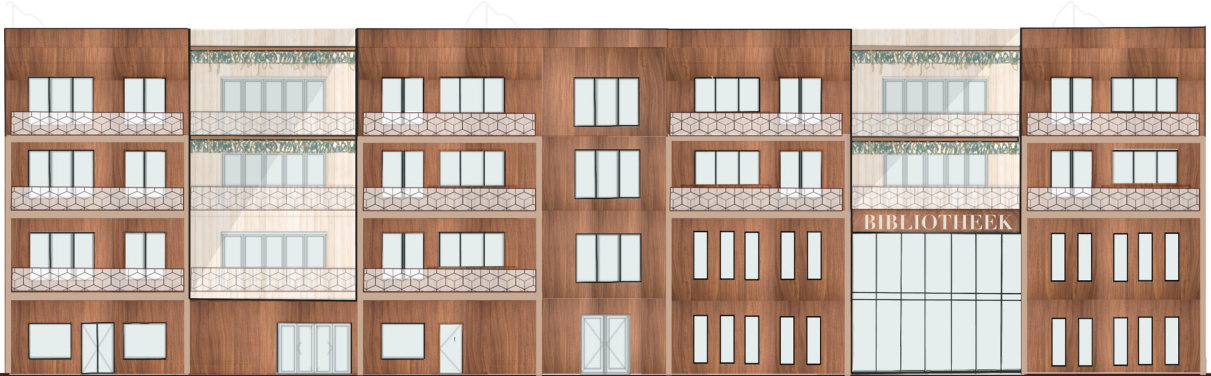

North

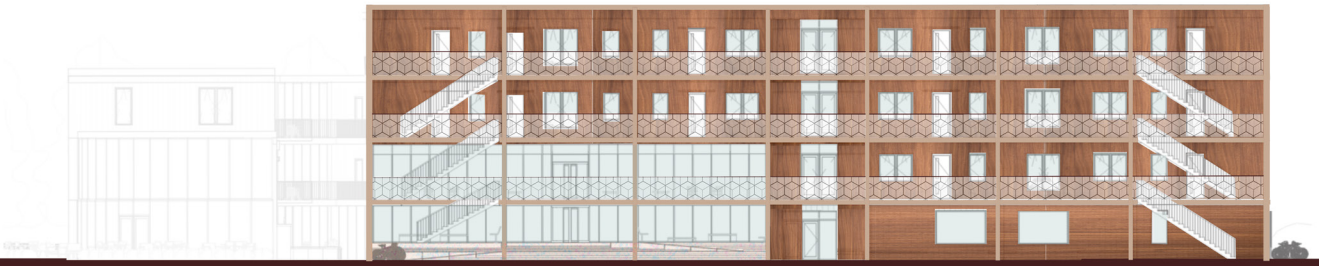

South



North

