

REDESIGNING RHYTHMS

*HOW URBAN RHYTHMS CAN ENHANCE THE
SENSE OF PLACE IN HERTEN*

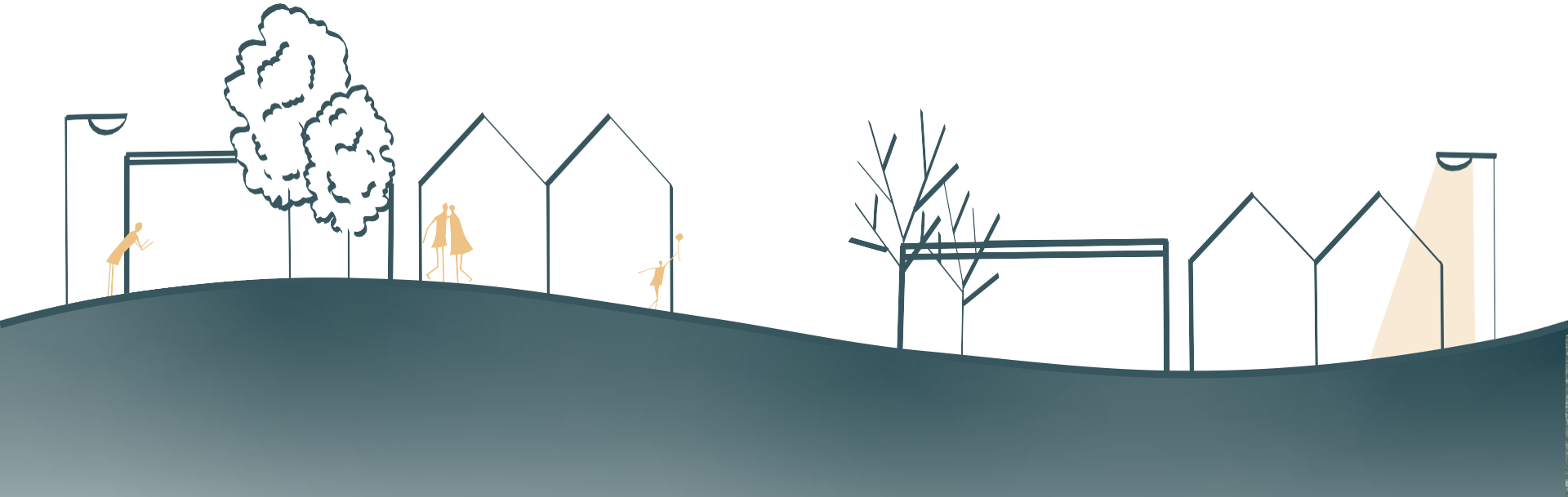

PRESENTATION STRUCTURE

PART 1 **INTRODUCING HERTEN**
LOCATION & PROBLEM STATEMENT

PART 2 **UNDERSTANDING THE PROJECT**
CONCEPTS & RHYTHMS

PART 3 **DESIGNING WITH RHYTHMS**
DESIGN PROPOSAL

INTRODUCING HERTEN

Part 1: Location & problem statement



LOCATION - HERTEN



OOL

HERTEN

OOLDERVESTE

MERUM



500 m

HERTEN



ST. MAARTEN





00L



MAASPLASSEN



FLOOD 2021





URBAN GROWTH IN HERTEN

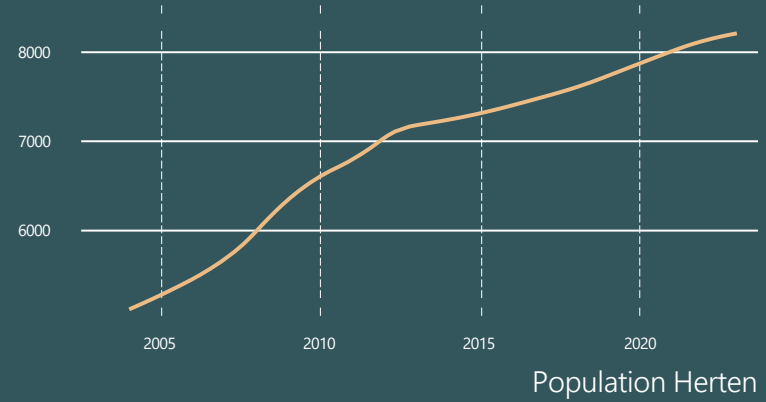

Legend

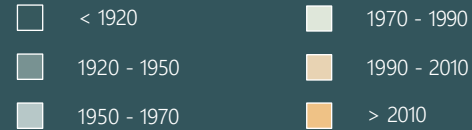

3DBAG. (n.d.). *3DBAG Viewer*. Retrieved January 20, 2024, from <https://3dbag.nl/en/download>

Kadaster. (n.d.). Herten. [Kadastralekaart.com](https://kadastralekaart.com/wijken/wijk-07-herthen-WK095707). Geraadpleegd op 22 mei 2024, from <https://kadastralekaart.com/wijken/wijk-07-herthen-WK095707>

OOLDERVESTE





VINEX

'Vierde ruimtelijke nota extra'

*A plan by the dutch government
in 1991 that aims to built an extra
650.000 houses.*

PROBLEM STATEMENT

A **lack in variety** in activities and lack in transformative capacity makes **Herten** feel static and impersonal. Inhabitants do not have a strong **sense of place.**

RESEARCH QUESTION

How can **urban rhythms** be used
in an **urban design** to enhance the
sense of place in **Herten**?

UNDERSTANDING THE PROJECT

Part 2: Concepts & rhythms

KEY CONCEPTS

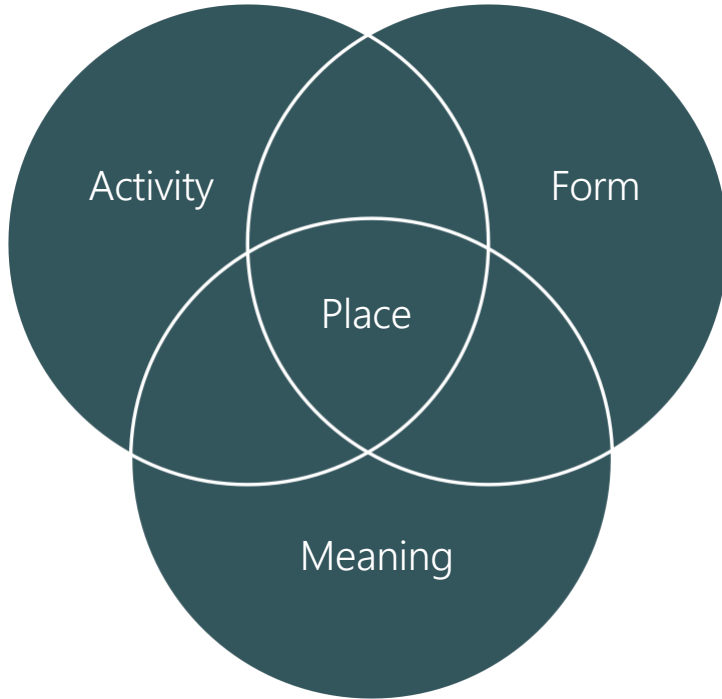

Sense of place

Sense of place is used to describe the relation between people and the places they find themselves in.

Montgomery, J. (1998). Making a city: urbanity, vitality and urban design. *Journal of Urban Design*, 3(1), 93–116. <https://doi.org/10.1080/13574809808724418>

THEORETICAL FRAMEWORK

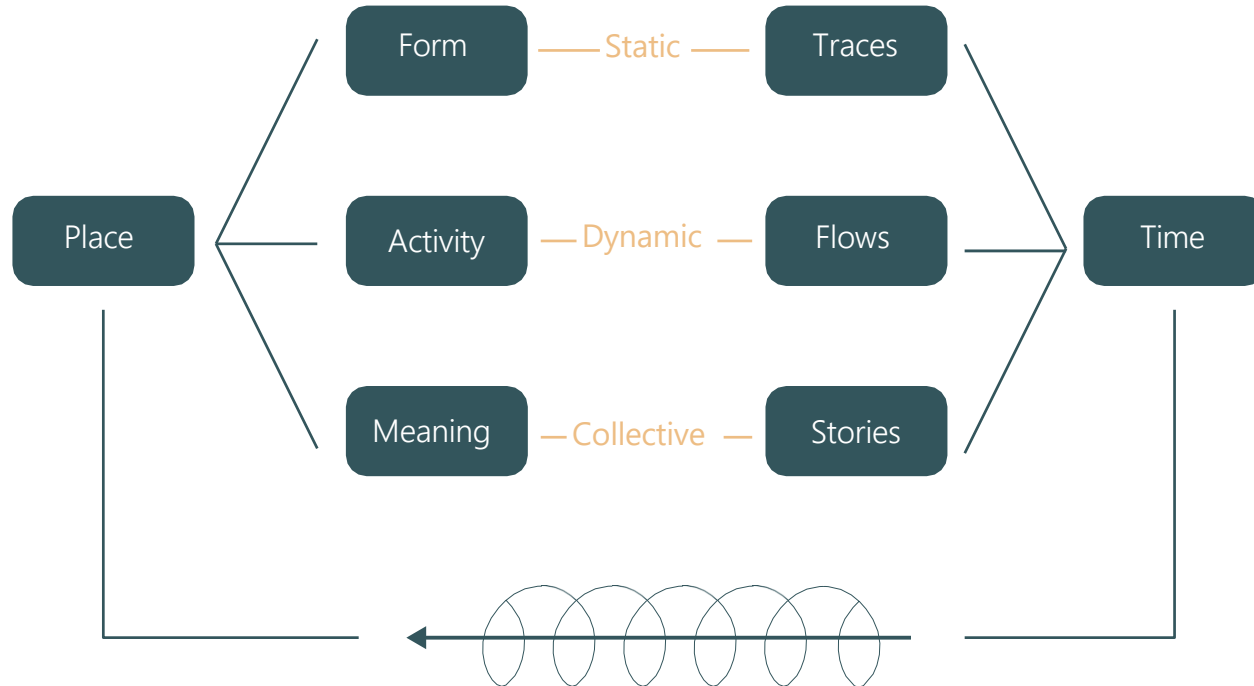

THEORETICAL FRAMEWORK

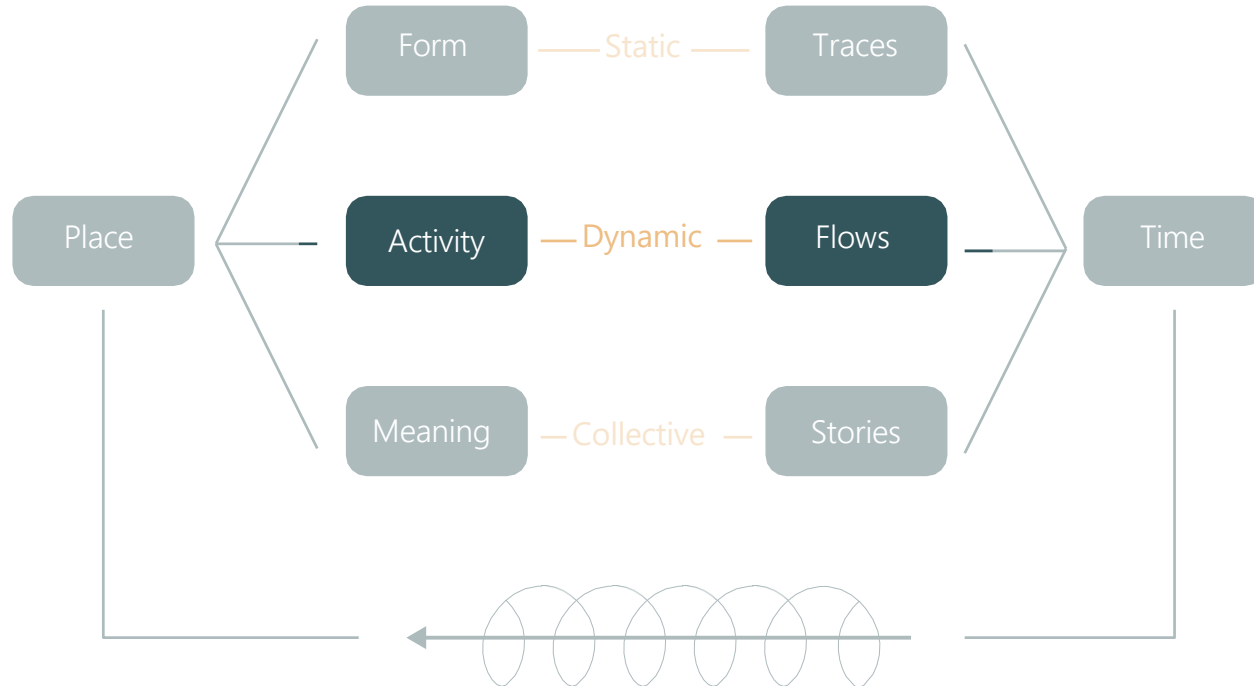

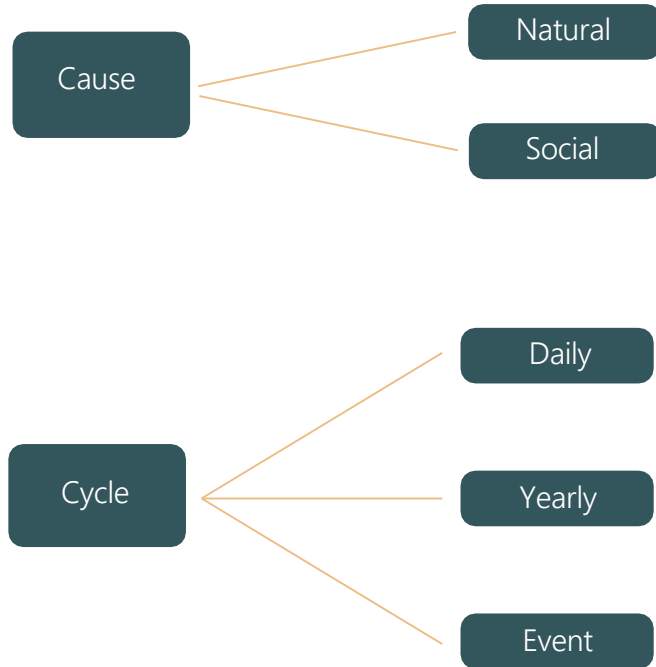

KEY CONCEPTS

Urban rhythms

Urban rhythms are elements that can be expected to repeat over a certain period of time, they are place specific.

Wunderlich, F. M. (2013). Place-Temporality and Urban Place-Rhythms in Urban Analysis and Design: An Aesthetic Akin to Music. *Journal of Urban Design*, 18(3), 383–408. <https://doi.org/10.1080/13574809.2013.772882>

NATURAL RHYTHMS THROUGHOUT THE YEAR

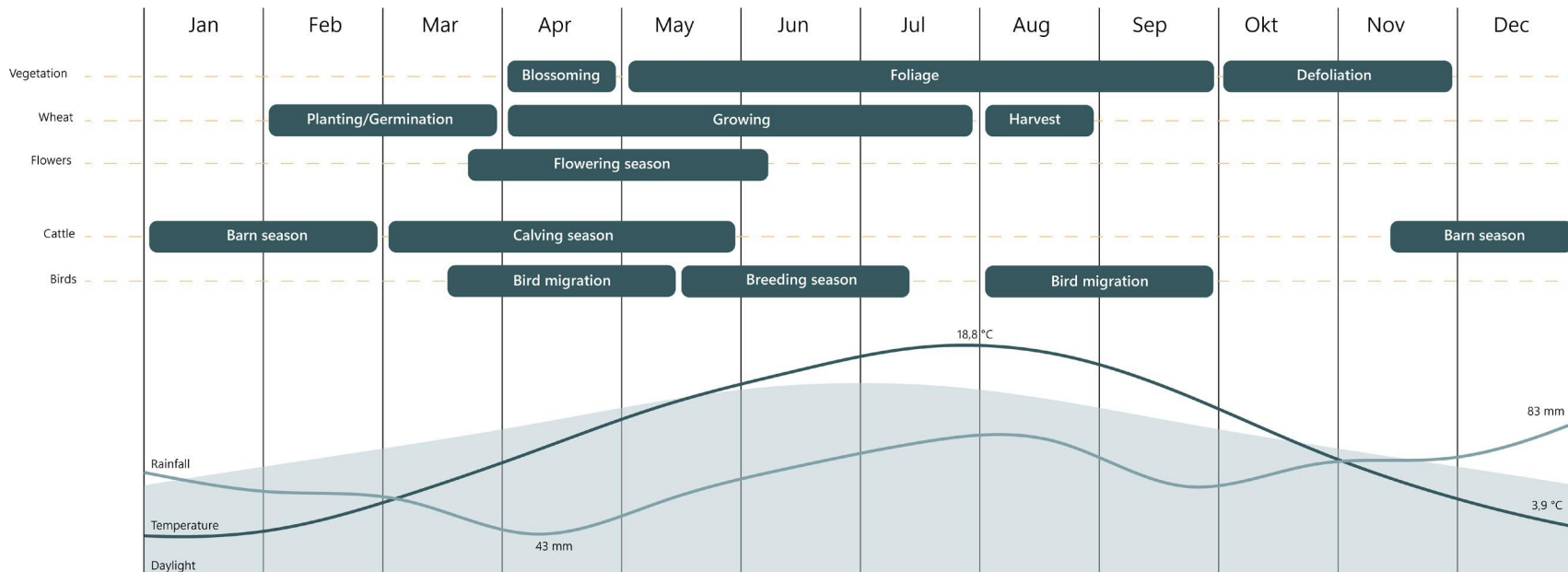

SOCIAL RHYTHMS THROUGHOUT THE YEAR

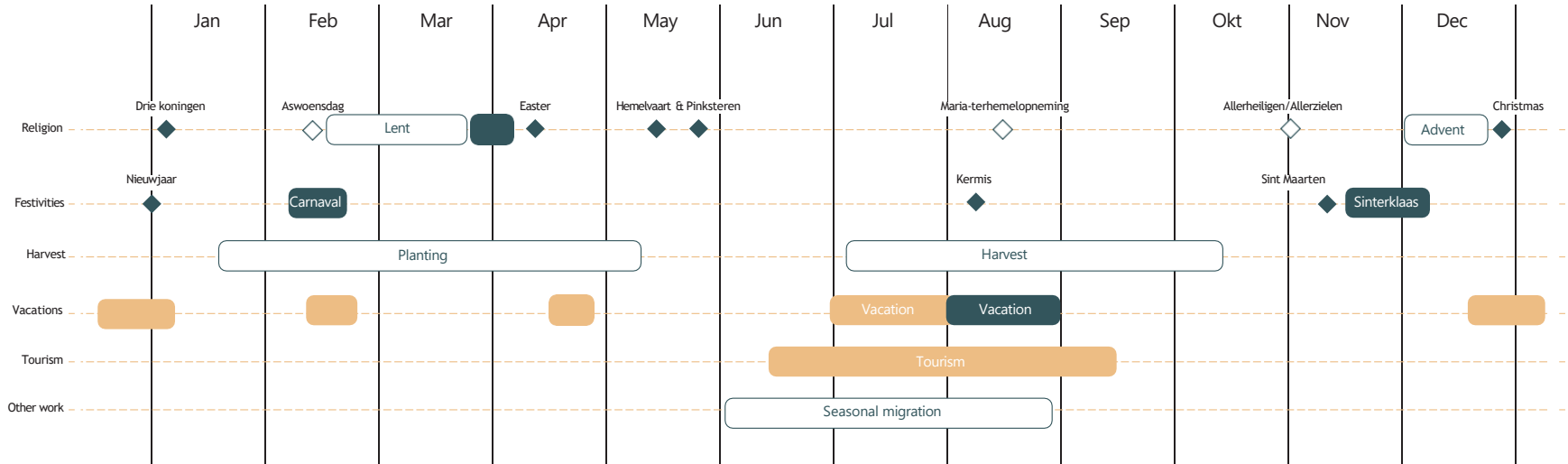

Legend

- Rhythms that have existed since at least 1900
- New rhythms
- Rhythms that have disappeared

BOOKLET RHYTHMS IN HERTEN

Y1. TEMPERATURE

During the year temperatures change, in Herten in winter the temperature is around 4 degrees celsius on average while in the summer this average temperature rises to 19 degrees celsius. The temperature, together with other weather variables have a big impact on the experience and usage of spaces.

Related rhythms: D2, E1, E2, D8, D9, Y9, Y11

Y2. DAYLIGHT

The amount of daylight differs throughout the year, in summer the days are longer than in winter, in winter the intensity of the daylight is also often lower than in summer, this means people might feel more tired and less inclined to go outside.

Related rhythms: D3, D11

Y3. RAINFALL

Rainfall can have a big impact on the physical environment: it is necessary for vegetation to grow, lots of rainfall can also cause the soil to become drassy and can cause the water level of the river to rise. When it is raining people often try to stay inside as much as possible and less people can be seen on the streets.

Related rhythms: Y4, E3, D8, D11

1.2 WEATHER VARIABLES THROUGHOUT THE YEAR

Notes from fieldwork



Changing conditions of a path throughout the year

Changes in behaviour

Different weather conditions can change the behaviour of people, in the example a path is shown, this path is rarely used in wet periods when puddles form along the path. People then instead choose to walk over the road.



Girl and grandmother walking

"lets find some puddles for you to ride through"
- Grandmother to her granddaughter
(translated)

ACTIVITIES IN THE NEIGHBORHOOD

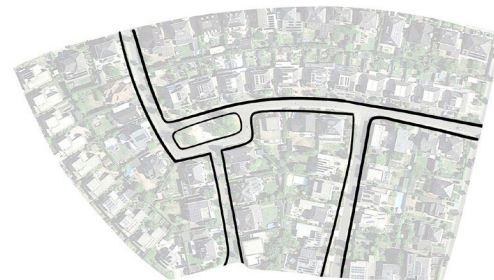
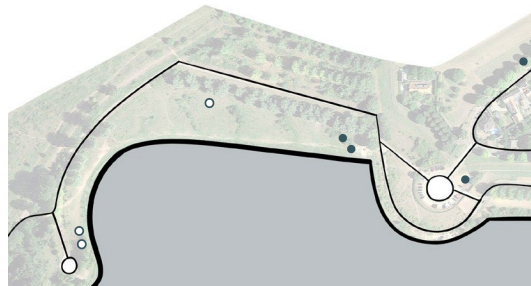

DESIGN LOCATION

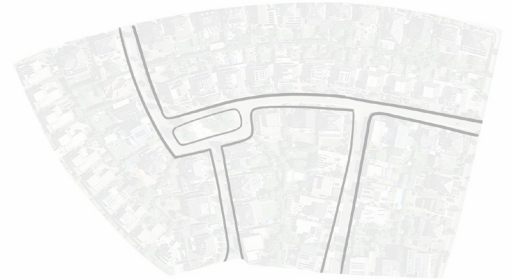
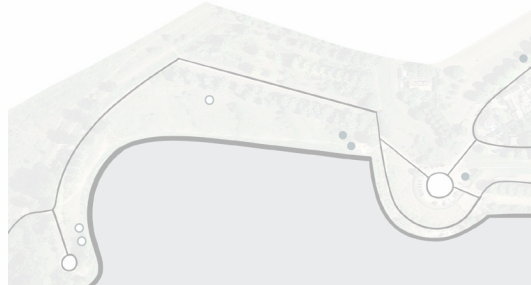

DESIGNING WITH RHYTHMS

Part 3: Design proposal

LOCATION ANALYSES



Church

Village centre

Old Watertower

Herten

Old village with expansions

Shops

Amenities

School

Daycare

Sports center

Main design axis

Oolderveste

Vinex neighborhood

OOLDERWEG

Water retention areas

DESIGN LOCATION



DESIGN GOALS

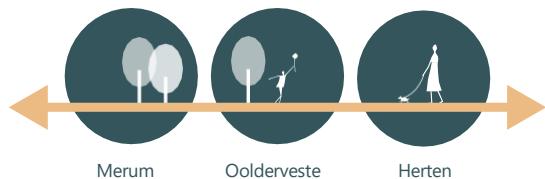

CREATING
BETTER CONNECTIONS

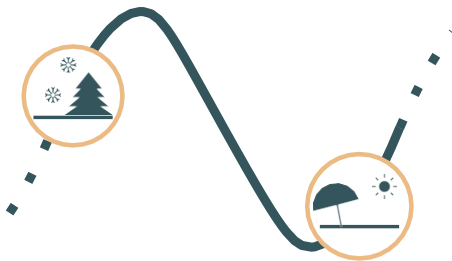

ADAPTING TO
RHYTHMS

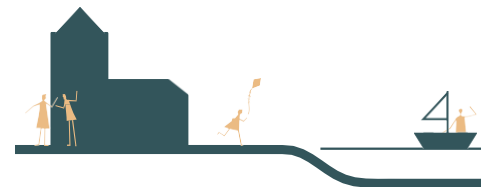

ENHANCING
SENSE OF PLACE

DESIGN CONCEPT

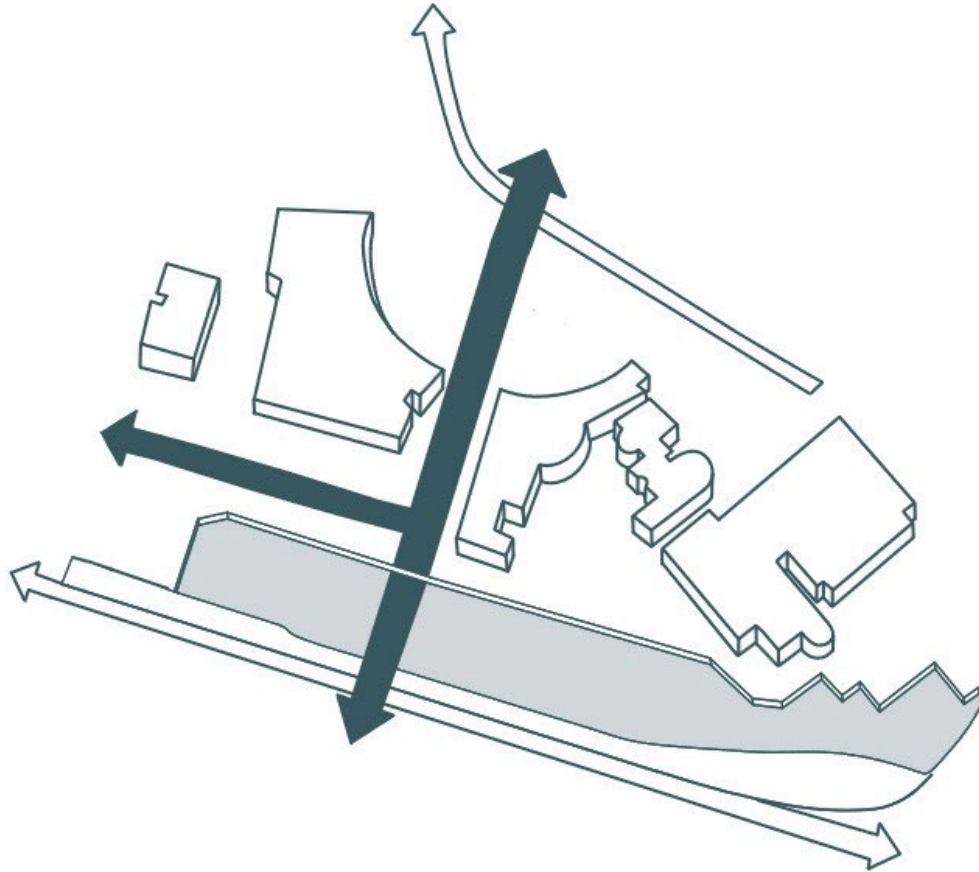

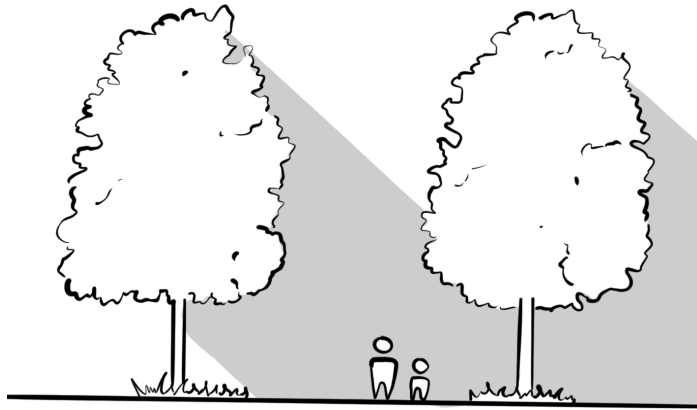

Water retention

Raised ground floor

Moveable flood barriers

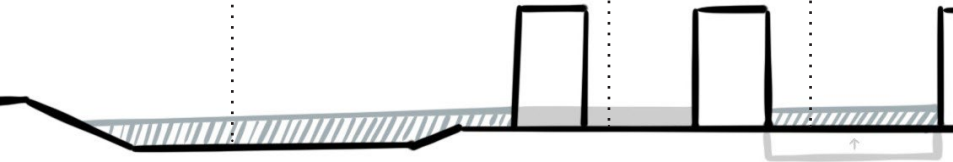

TRENDS

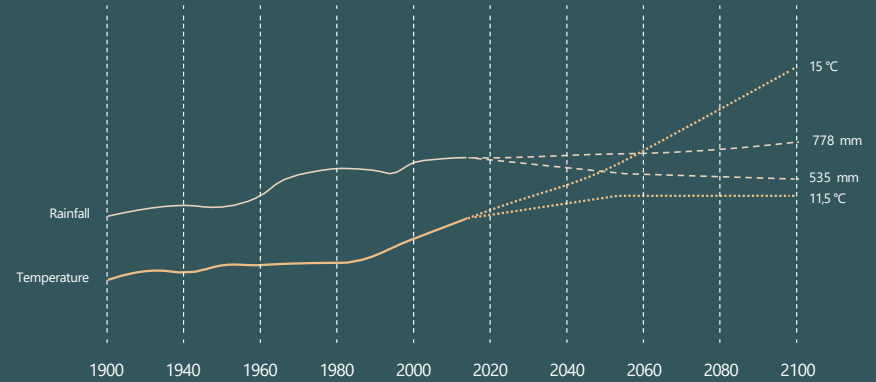

Climate change

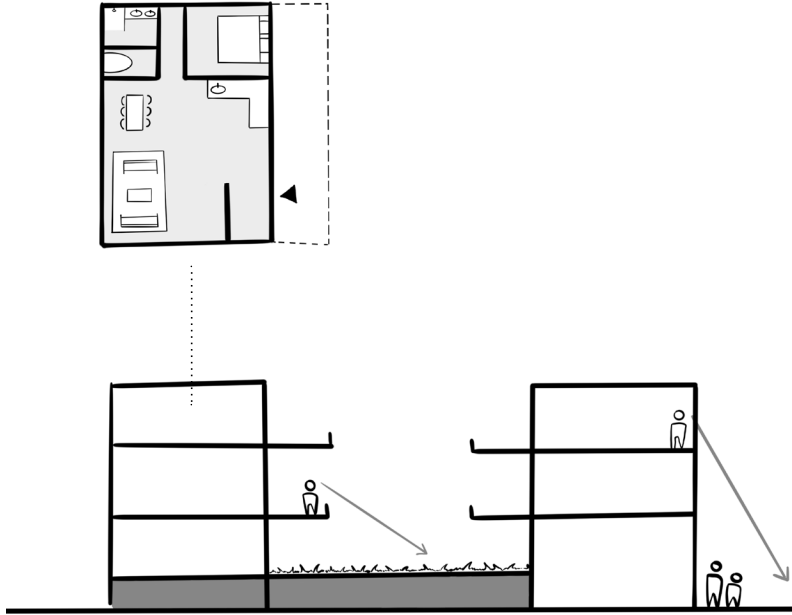

TRENDS

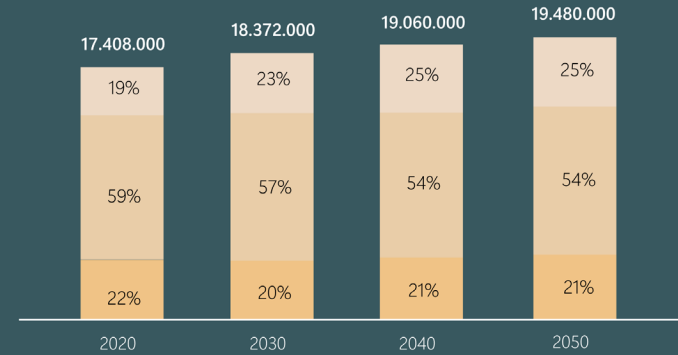

Demography

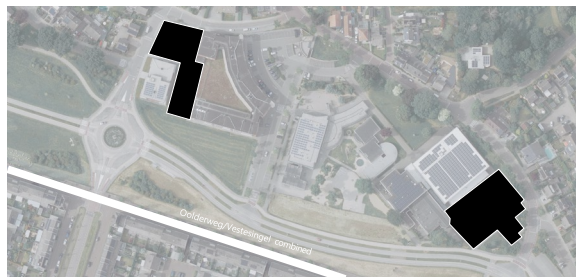
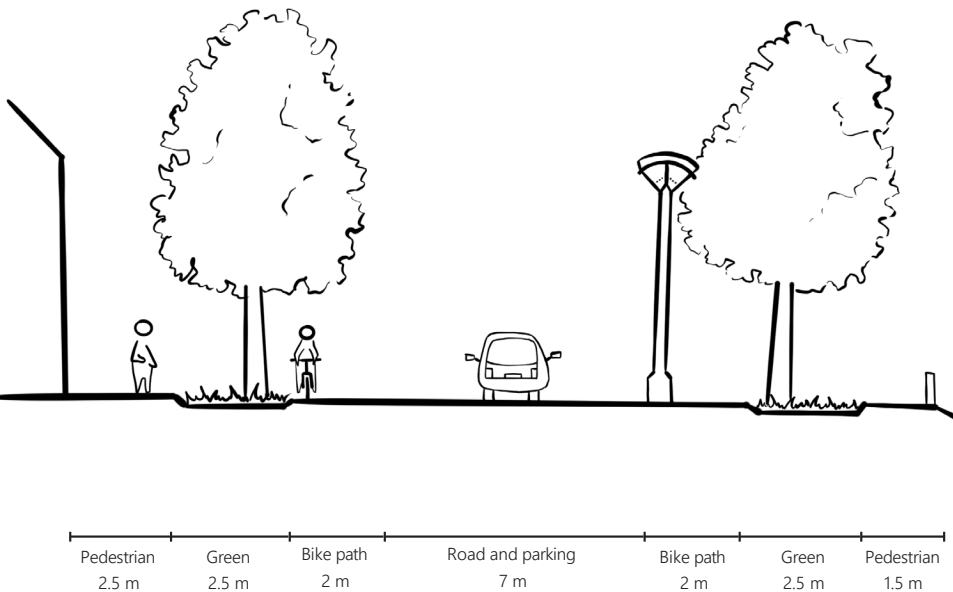

Legend

■ Parking

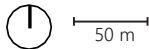

TRENDS

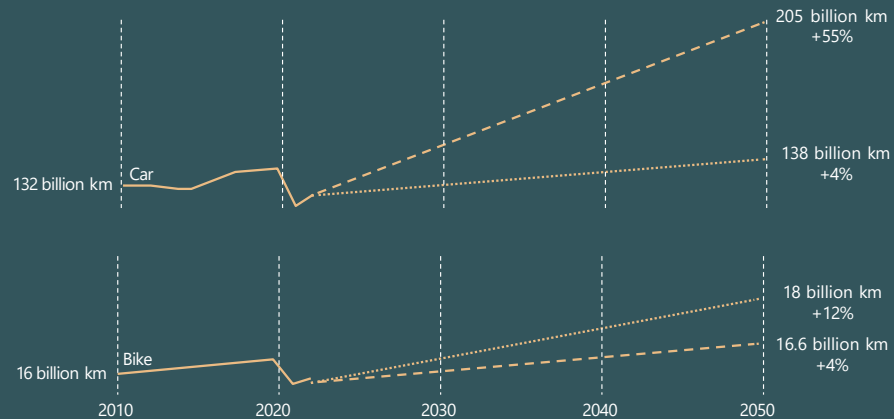

Mobility

DESIGN AMENITY AREA



Legend

- Slow traffic zone
- Roads
- Parking
- Private
- Flood barriers
- Green areas
- Green slopes
- Flower fields
- Existing buildings
- New buildings
- Existing trees
- Diverse trees
- Fruit trees
- Red beeches
Fagus sylvatica f. purpurea

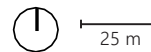

CENTRAL LANE DESIGN



Flood barriers



Water feature

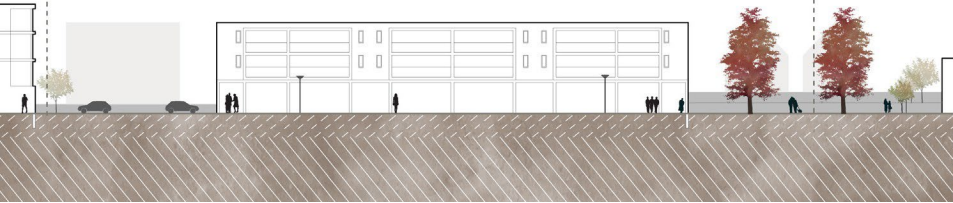

Watersquare



*Hertenheim
monument*

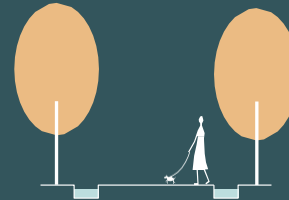

Open stream



*Water retention
park*

CENTRAL LANE DESIGN

Water retention park
Maashavenpark
Rotterdam - the Netherlands



Square with fountains
The Circles
Nanjing- China

Fountain area
Whale tale fountain
Victor Harbor - South Australia



Hertenheym monument

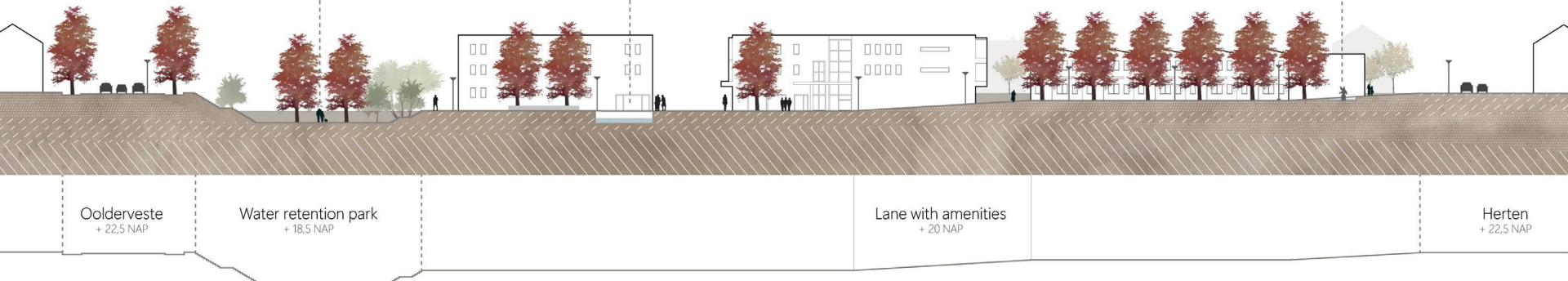

Oolderveste
+ 22,5 NAP

Water retention park
+ 18,5 NAP

Lane with amenities
+ 20 NAP

Herten
+ 22,5 NAP



ELEMENTARY SCHOOL

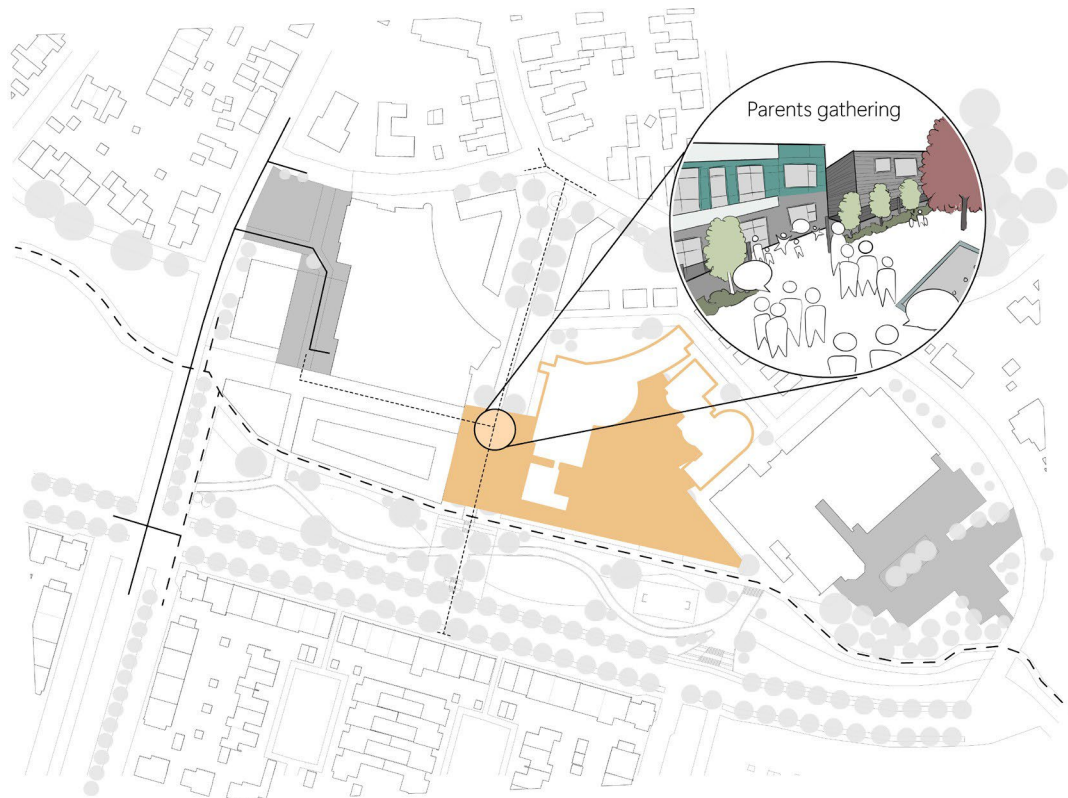

Legend

- Focus area
- Important building
- Parking
- Car route
- Cyclist route
- Pedestrian route

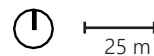

SHOPPING

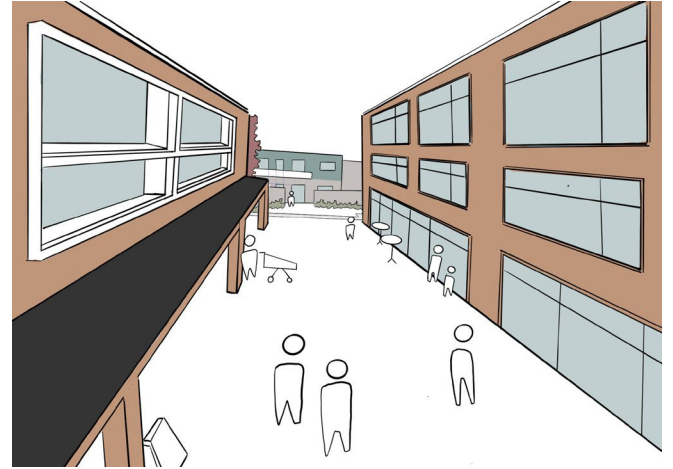
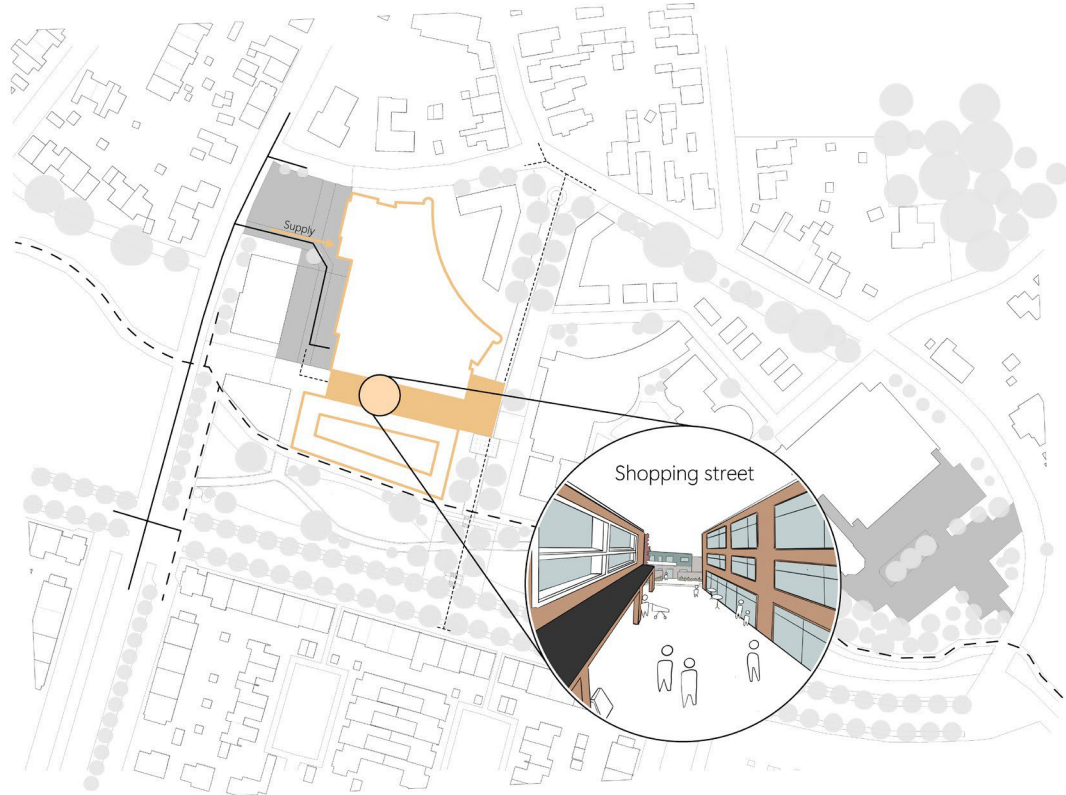

Legend

- Focus area
- Important building
- Parking
- Car route
- Cyclist route
- Pedestrian route

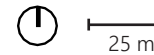

FLOOD

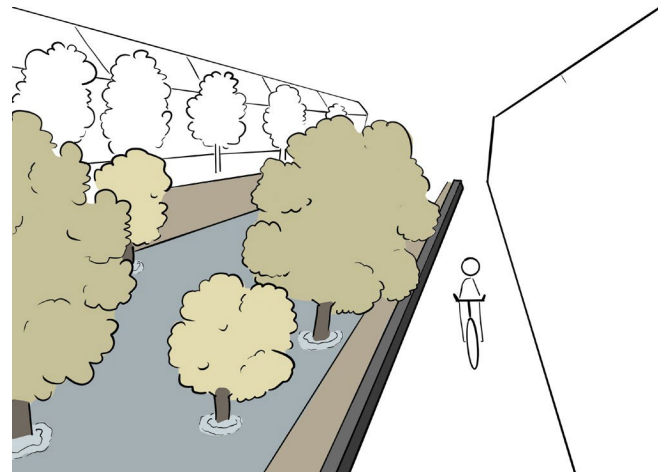

Legend



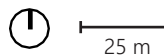

- Heavy rainfall
- Flood
- Extreme flood

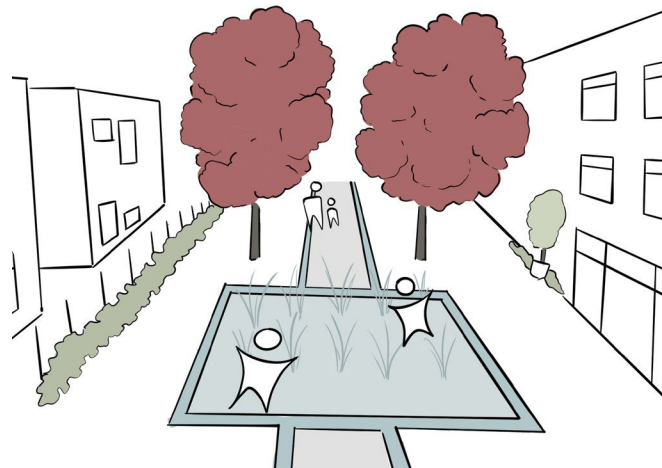
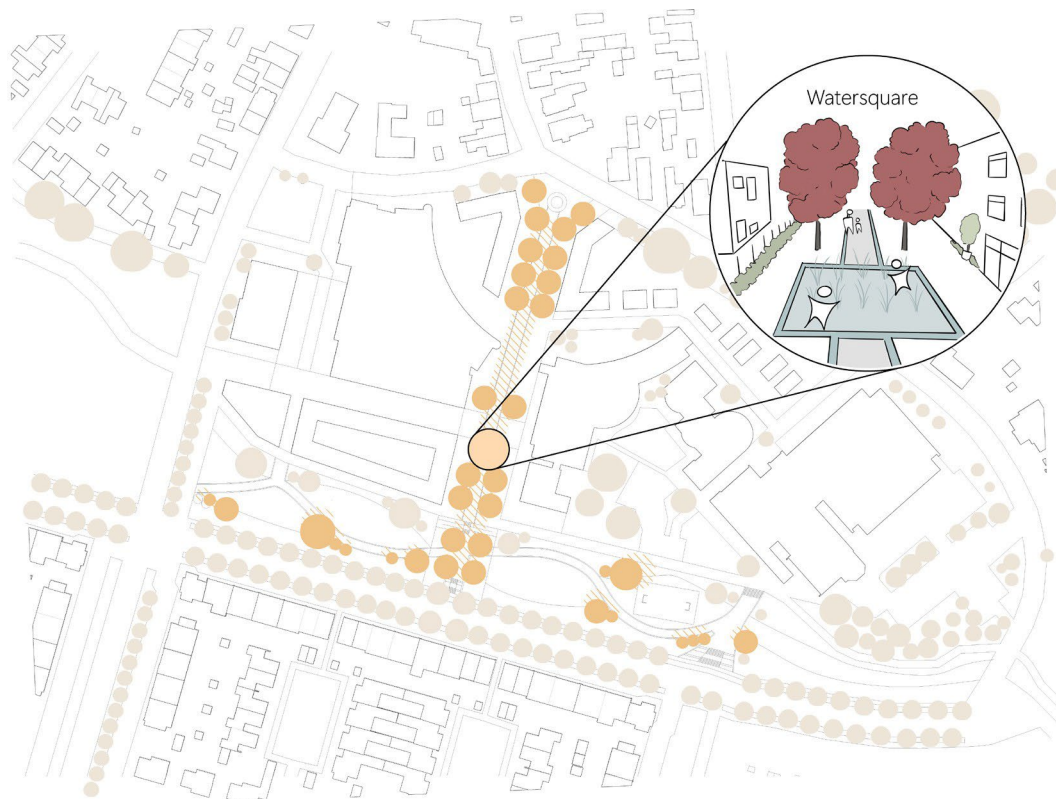

HEAT WAVE



Legend

-  Shaded walkways
 -  Trees providing shadow in frequently visited areas
 -  Other trees
-   25 m

MERUMER MARKET



Legend

- Focus area
- Possible expansion
- Fruit trees

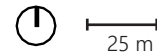

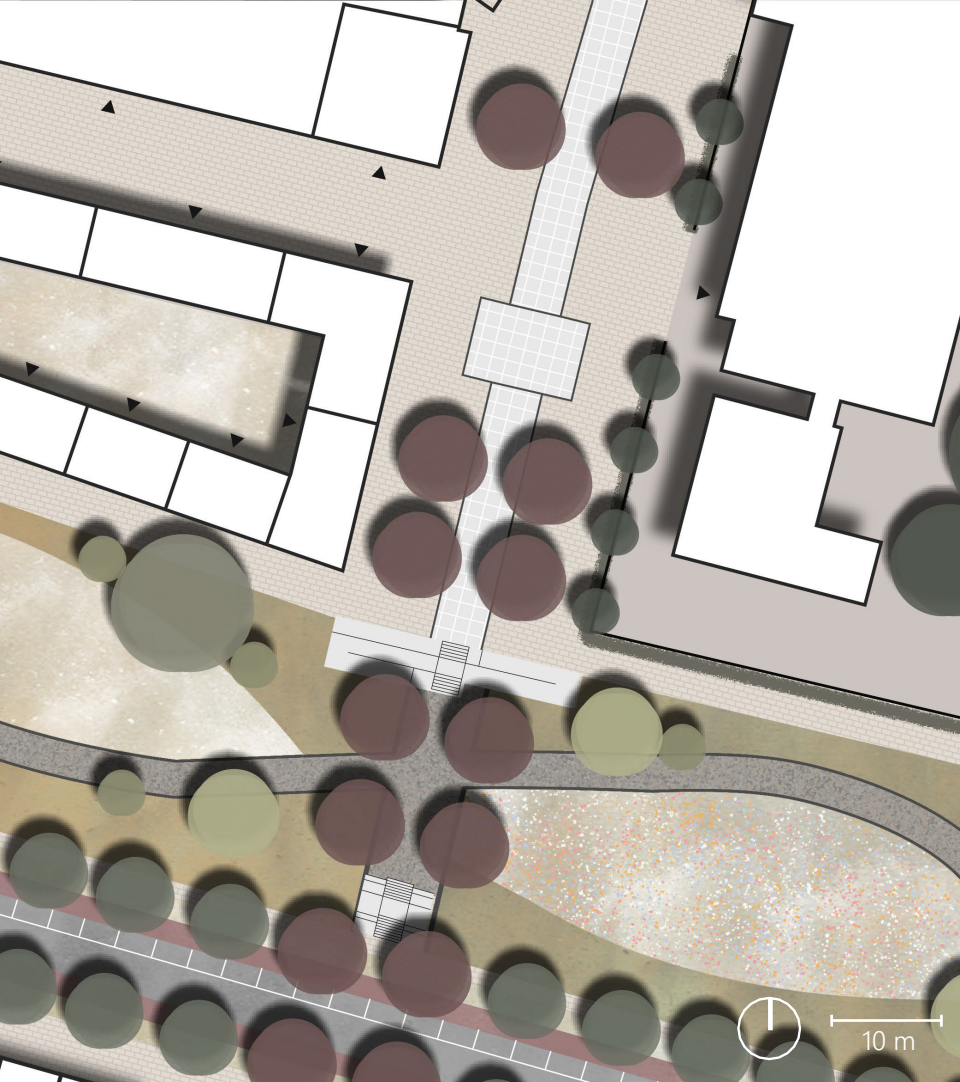



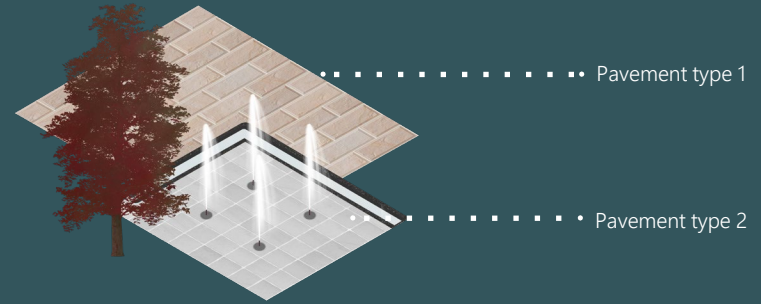











ZOOM IN



Legend

- | | |
|---|--|
|  Pavement type 1 |  Diverse existing trees |
|  Pavement type 2 |  Plane <i>Platananus</i> |
|  Playground |  Walnut <i>Juglans</i> |
|  Green areas |  Juneberry <i>Amelanchier lamarckii</i> |
|  Green slope |  Pear tree <i>Pyrus</i> |
|  Flower field |  Red beech <i>Fagus sylvatica f. purpurea</i> |
|  Bike path | |
|  Road | |
|  Building | |

SECTION CENTRAL LANE

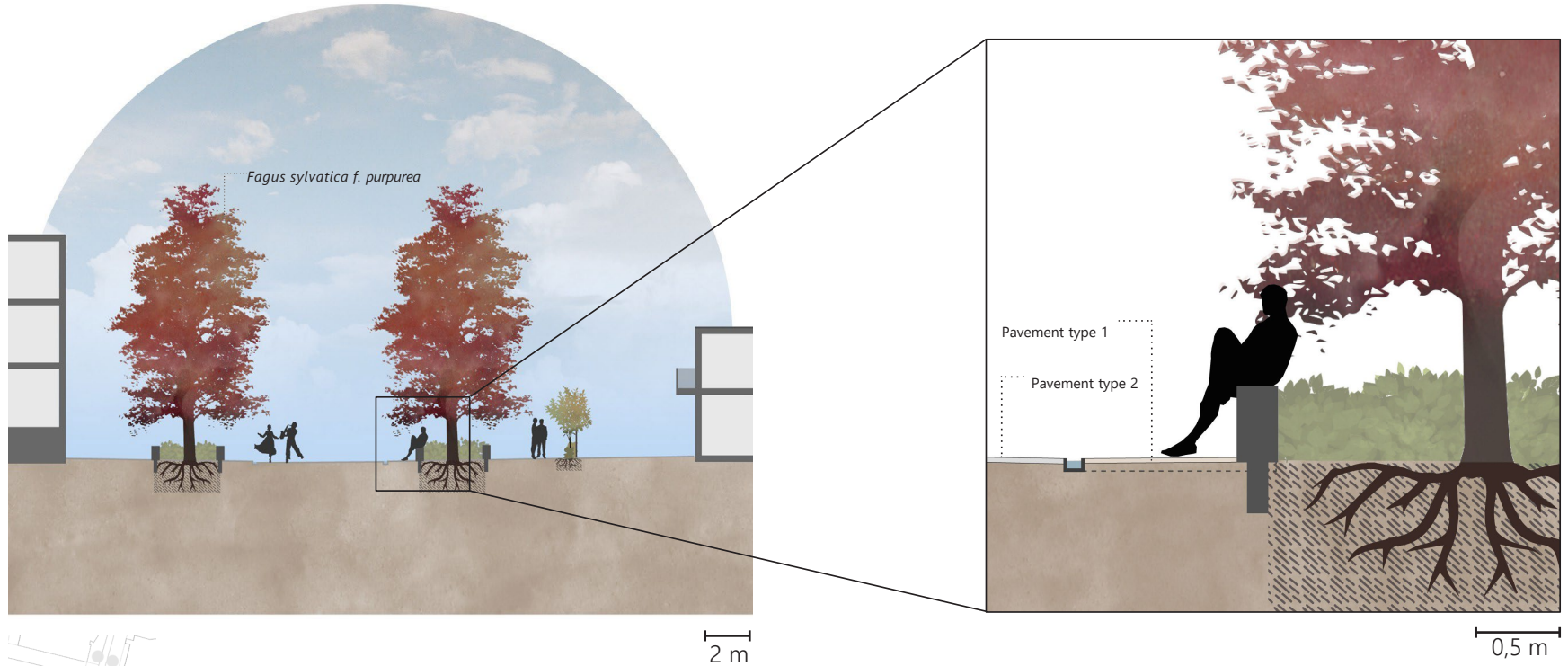

SECTION WATERSQUARE

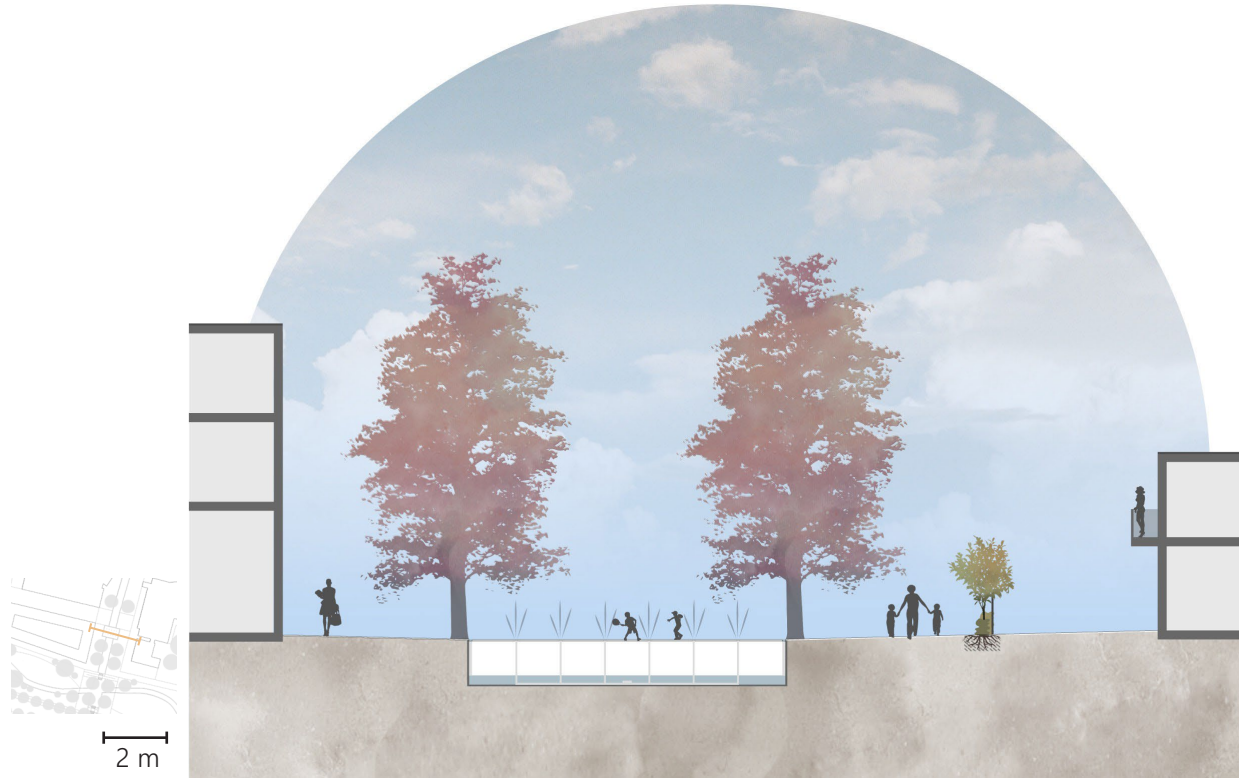

SECTION WATERSQUARE





PARK



Walnut tree
Juglans Regia



Pear tree
Pyrus 'Gieser Wildeman'



Juneberry
Amelanchier lamarckii

TOWARDS OOLDERVESTE





HERTEN IN 2030

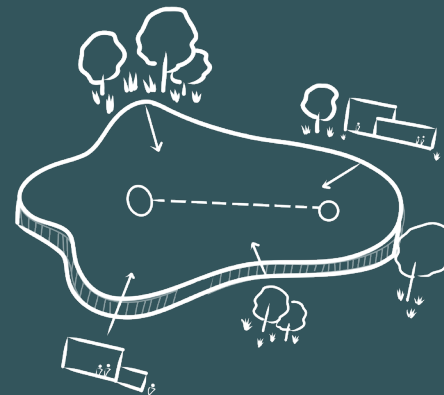

Legend

- Main green structure
 - Secondary green
 - New housing for elderly
 - Maasplassen
 - New connections
 - Pedestrian paths
- 100 m

FUTURE OF VINEX



