

INTERNATIONAL CENTRE

International Centre built in 1960s is a growing economy district along the 7th Avenue where most of the business activity was displaced after El Bogotazo.

PLAZA LAS NIEVES

One of several epicentres located along the 7th Avenue. Las Nieves is an important cultural hub appealing to an alternative young audience.

Crossings of Jimenez with 7th and 10th Avenue are important traffic points where major public transport routes intersect.

10th AVENUE

A traffic corridor transformed into a 40m wide avenue that became a physical barrier between the western decaying neighbourhoods and the old city centre in the east.

PLAZA SAN VICTORINO

San Victorino was once a bustling market full of street vendors, petty crime and prostitution. Recently it has been reclaimed and made into a public plaza. Similarly to the Third Millenium Park, the situation of the plaza has not improved even with the government input.

Barrios around San Victorino and Third Millenium Park are considered to be the PERICENTRE which is the main 'transmitter' of people that inhabit the historic centre daily - street vendors, shop owners etc.

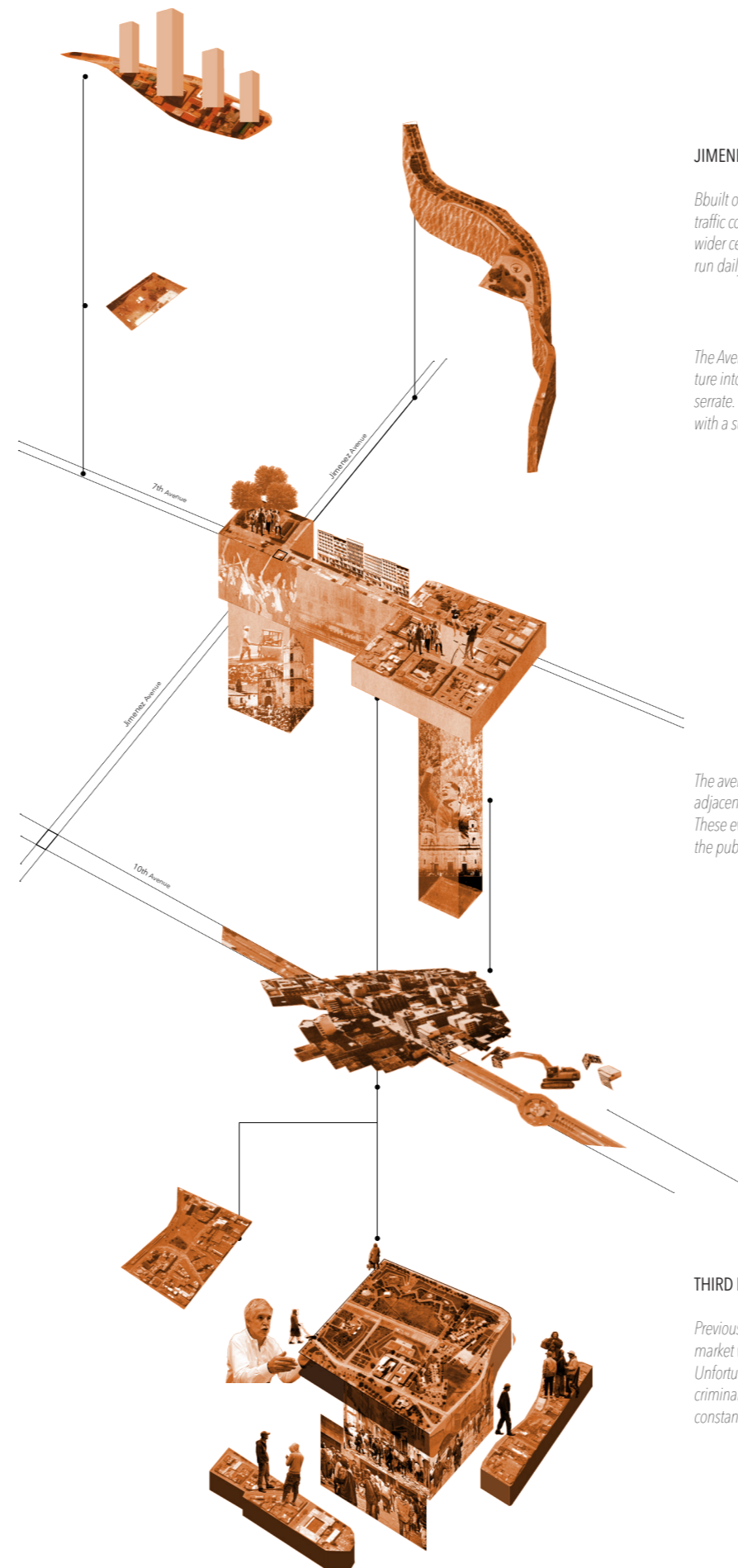

JIMENEZ DE QUESADA AVENUE

Built over the San Francisco river, it is an important traffic corridor and point of access to the squares and wider centre. Along the avenue Transmilenio buses run daily, bringing a high influx of people.

The Avenue was designed to be an 'injection' of nature into the city coming from the Andes and Montserrat. It is lined with native trees and water canals with a succession of small oasis that connect to it.

The avenue was widened through demolishing adjacent buildings during and after El Bogotazo. These events caused disapproval and backlash from the public.

THIRD MILLENIUM PARK

Previously known as 'El Cartucho', an infamous drug market was demolished to make way for a park. Unfortunately, clearing the area of drug dealers and criminals was not successful, with them still being a constant presence in the park.

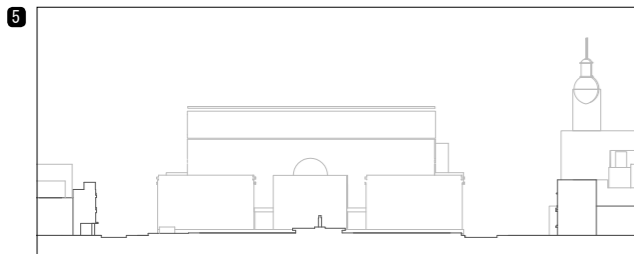
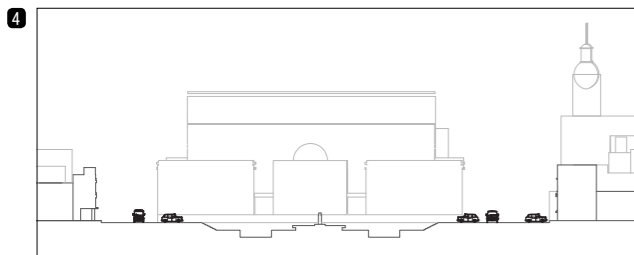
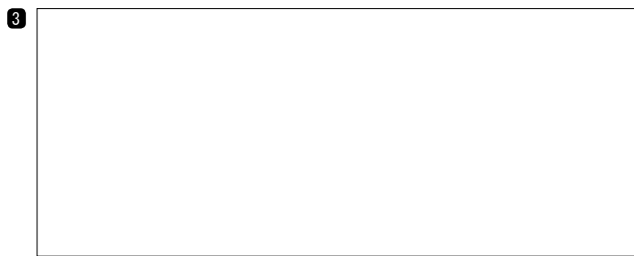
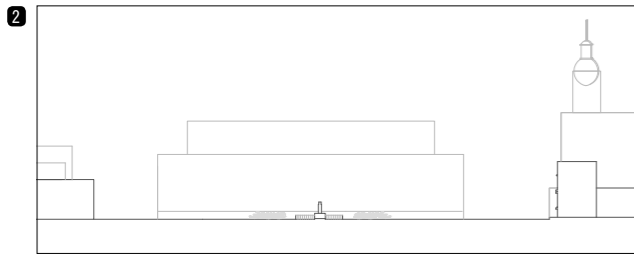
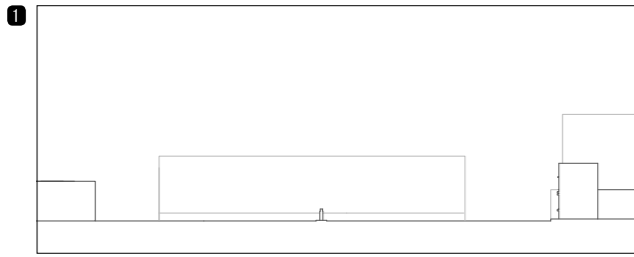

First surrounded by colonial houses, the open square created between them was used as a farmer's market.

Pillory Square
In the centre of the square a wooden column was used for punishment, representing the power of the King of Spain.



Plaza Mayor
Feature changed to small water source supply and later to a 'mono stack'



Constitution Square
The main feature of the square was a central fountain. The market, bullfighting and other such activities were suspended.



The pedestal of the statue was re-nued and the statue was turned from facing east (towards Cathedral) to north (facing Courthouse)



an English-styled garden was added



The sunken gardens were replaced by fountains. The square was also used for car parking.



Plaza de Bolívar

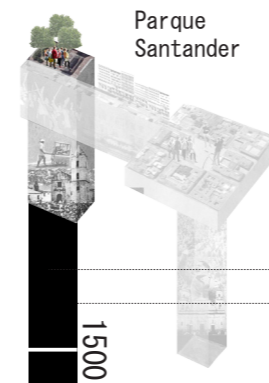

Parque Santander



ENTRANCE TO THE CITY
Before the colonial era, this area was the entrance to the city, a place of crossing the river San Francisco over numerous bridges.



CAPILLA DEL HUMILLADERO
Capilla del Humilladero was the first church to be erected in Bogotá, right after its founding in 1538.

PLAZA DE LA YERBA
Due to the vicinity of the river, the square became Plaza de la Yerba (Herba) - a traditional herb market marking this area as a place of extensive trade and influx of people and goods.



PLAZA AND CHURCH OF SAN FRANCISCO
First religious orders established their churches on Plaza de la Yerba, among them Franciscans and Dominicans. After building the church of San Francisco, the square was renamed in its honour.



CHURCH OF VERACRUZ AND LA TERCERA
Ceatusan testionse audandae. Iquae volupturiam quas nonseculi officitla nonsenis sum harionest quodi omnim dolupta epraectorum repudit et pos et as dolorit atibea dolectenia quibus



PARQUE SANTANDER
During a period of urban beautification, statue of Francisco de Paula Santander is erected and the square becomes an eponymous park - Parque Santander.



Parque Santander becomes a full fledged garden, surrounded by an iron fence and two main gates on Carreras 6 and 7, facing respectively east and west. The western entrance was facing the tramway line to Chapinero.



Hotel Granada built at the turn of the century was heavily damaged during El Bogotazo and finally demolished in 1960s.



DEFINED BORDERS
Modite pos ipsam ellorro officid un-tume velit la iduntis estent. Olum voloressequi aut officab ipsam et autem faceaquati to dem alis silitiatimet hitiis molum eate eos diti dolo muptae come corem laborib usciderum faciend itatioreptum quideni bearcia volora quae veri tempiorerepe num audae. Et esequod itunt, aliae consem atquist rumquam qui ut ut laborup tatemodit, siti nihillu ptiist et fuga. Mendita turepedi qui blabo. Ihilient estest, sequam quiat quaterpore et quiatem-porem niendaeces aut re nullestemolo con ressequamet unt.

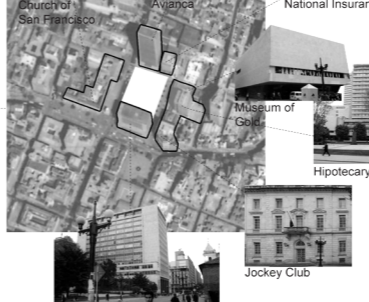

Bank of the Republic

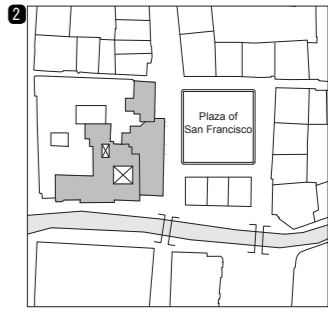
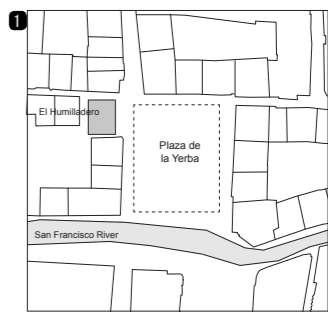

1500
1530
1600
1631
1700
1800
1870
1888
1900
1939
1963-1967
2000

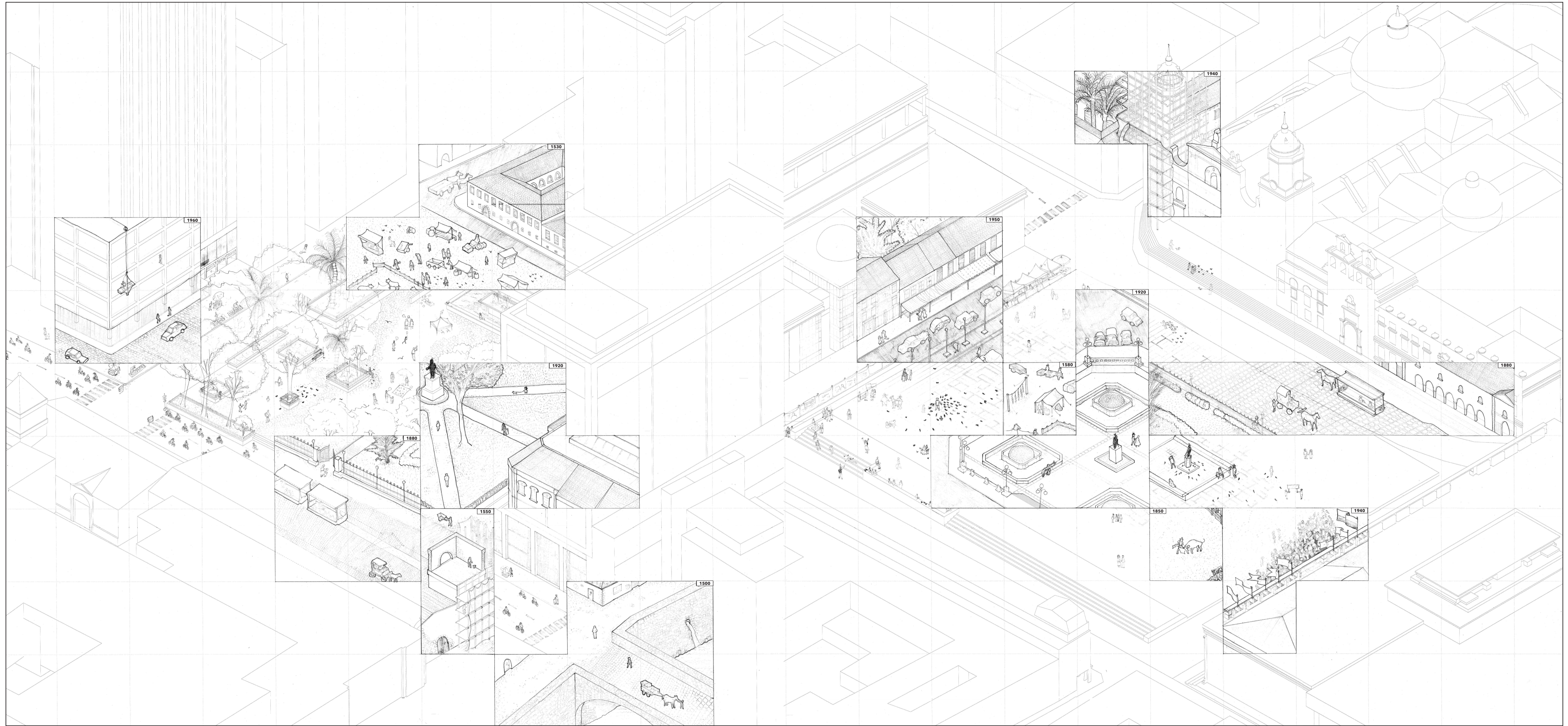

Parque Santander
side square

- 1500 bridge crossing / gate
- 1530 herb market
- 1550 church building
- 1880 tramline
- 1920 urban beautification
- 1960 towers built

Plaza Bolivar
main city square

- 1580 city market
- 1850 bull fighting
- 1880 tramline
- 1920 introducing car traffic
- 1940 protests/ renovation of the church tower
- 1950 shop arcade

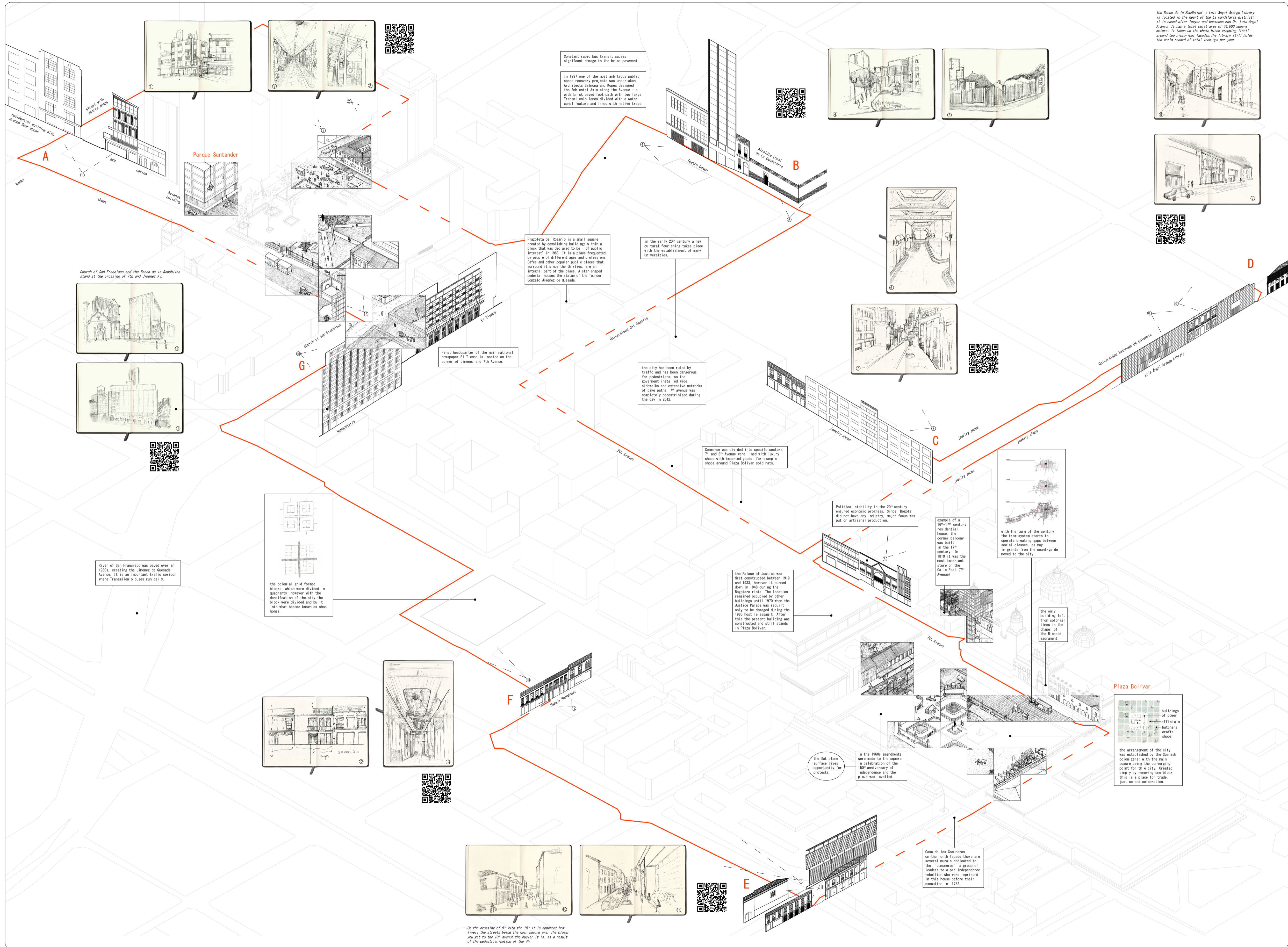

- A** Break in the continuity of facades – typology of towers interspersed with smaller semi-residential buildings.
- B** Small widening on the viaduct Avenue that creates a break in the continuity of the facade. Trees above it in the background, being one of the rare buildings in La Candelaria that have been restored to their primary function in order to revive the area.
- C** The garden belonging to the municipal centre of La Candelaria. A run down city block has been turned into a space for assemblies and cultural organized by the local political party. Once again there is a change in order. From high rise buildings towards square Avenue to the small colonial houses in the background as we progress towards La Candelaria.
- D** The Banco de la República's Luis Ángel Arango Library is located in the heart of the La Candelaria district. It is named after lawyer and business man Dr. Luis Ángel Arango. It has a total built area of 46,000 square meters. It takes up the whole block wrapping itself around the historical facade. The library still holds the world record of total book-use per year.
- E** In 1902 the Council of Bogotá ordered for the Mayor's Office to be built on the main plaza in the form of a shopping arcade which burned down in 1900. The design was assigned to Gastón Lleras. It was only in 1974 that the government managed to carry out the work. In the process many of the original details were not fulfilled. For example the commercial arcade on the ground floor which now has no function.
- F** Passage de Hernandez was built in 1880. The second level was added in 1938. It was used by Gastón Lleras. It was an essential sector to develop trade in the context of coffee, hygienic and trading the heavy colonial heritage for modernity.
- G** However, formal and informal trade co-exist, the best example being the informal traders (socialist) on Avenida Bolívar. They gather especially in front of the Monasteria building at 10am and trade merchandise among themselves until around 4pm when there is no more sunlight to inspect the merchandise properly. Several blocks around their place of trade is full of official offices, official dealers, jewelry stores etc. The "businessmen" meet all day between these formal places and their sidewalk.

Plaza Bolívar Parque Santander

- PB1** The market was subdivided as well as other activities such as bullfighting.
- PB2**
- PB3**
- PB4** the civil war of 1885, the same aspects the reception of the victory of independence, people gathered on the 7th Avenue and gathered on the square to show their support of the policy to keep the peace and legal policies. Regardless of the opposition between the conservatives and liberals they pulled the country out of the financial crisis and prevented the growth of new industries.
- PB5** Case of los Comunes on the north facade there are several murals dedicated to the "Comunes" a group of leaders to a pre-independence rebellion who were imprisoned in this house before their execution in 1782.
- PS1** Due to the vicinity of the river, a regional market was located in this area, dating way before establishment of Santa Fe. Later it became an important entrance to the old city (1500s), and the market continued growing, trading various goods – mainly herbs and other allimentary products from local farmers.
- PS2**
- PS3** First religious orders established their churches adjacent to the informal market. Vicinity of churches influenced the shape of the square making it Plaza San Francisco. Plaza gained more gravitas and competed in importance with the main square. The competition ceased when the current bishop decided that the Primary Cathedral was to be built in Plaza Bolívar.
- PS4** During the second half of the 19th century, the city was going through a period of urban beautification inspired by the aesthetics of the French capital and general were of neoclassicism. As a part of that movement statue of Francisco de Paula Santander is erected in the centre of the square, making it an economic park – Parque Santander. The park was styled as a French formal garden with all the footpaths leading to the central statue of Santander.
- PS5** From lines from Bolívar square to Chapinero, introduced at the end of 19th century, passed through the 7th Avenue, by Parque Santander. Due to the train station, the park was fenced off with a high wrought iron fence and two main gates on 6th and 7th Avenue.
- PS6** Accessibility to the park was amplified through the introduction of the tramway yet equally guarded through fencing off the garden.

product vendors



during most of the day, some even during night.

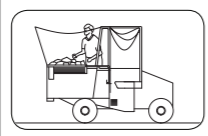

setting up the cart



selling the products

emerald dealers

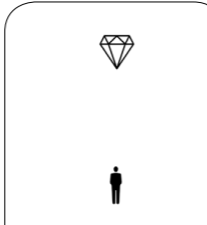

10am-4pm, not on weekends



gathering on the street to discuss



sealing a deal with a handshake

craftsmen



between 9:00- 18:00

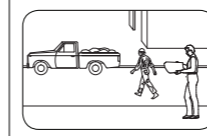

buying goods



making products (depending on the craft)



selling them on the street or designated shop

street performers

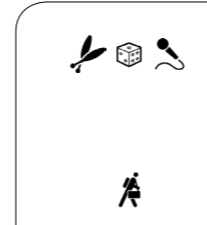

mostly weekends

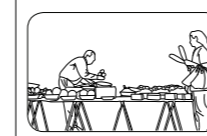

buying equipment for the activity



juggling or performing



getting tips from passersby or drivers

food vendors



during most of the day, some even during night.

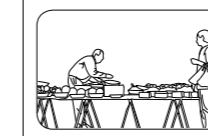

vendors go to get products from gathering point



setting up cart or booth



making or arranging the food

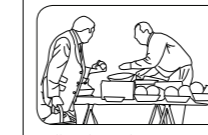

selling the products

shoe shiners

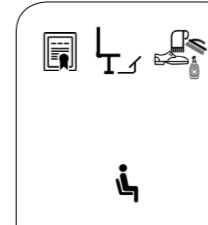

usually during office working hours (8am-5 pm)

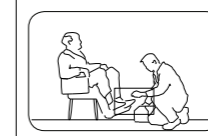

client approaches shoeshiner

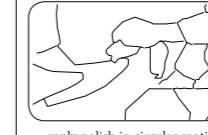

apply polish in circular motion



brush the shoe

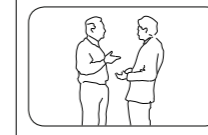

get payed by client and offer tourist guide services

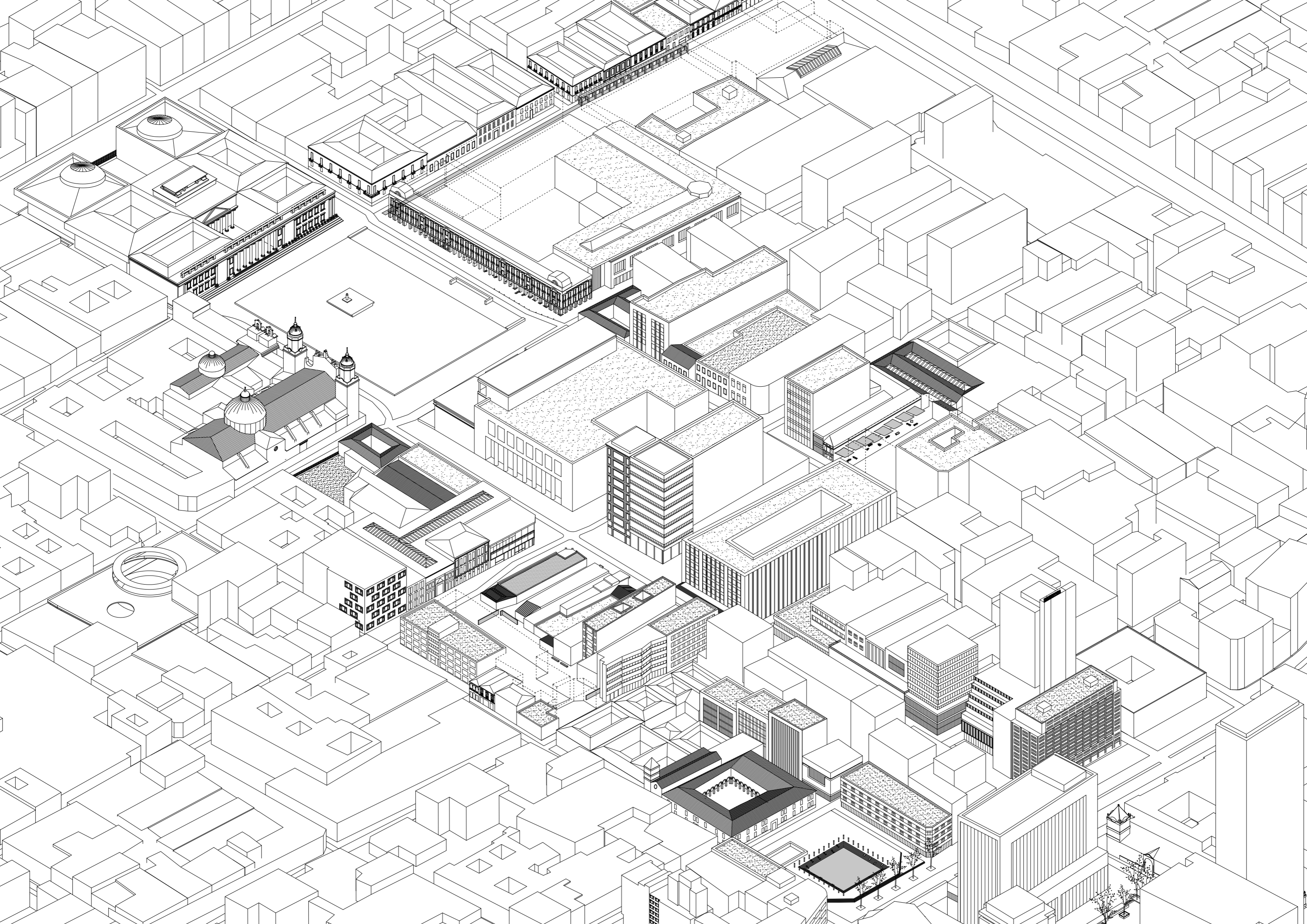

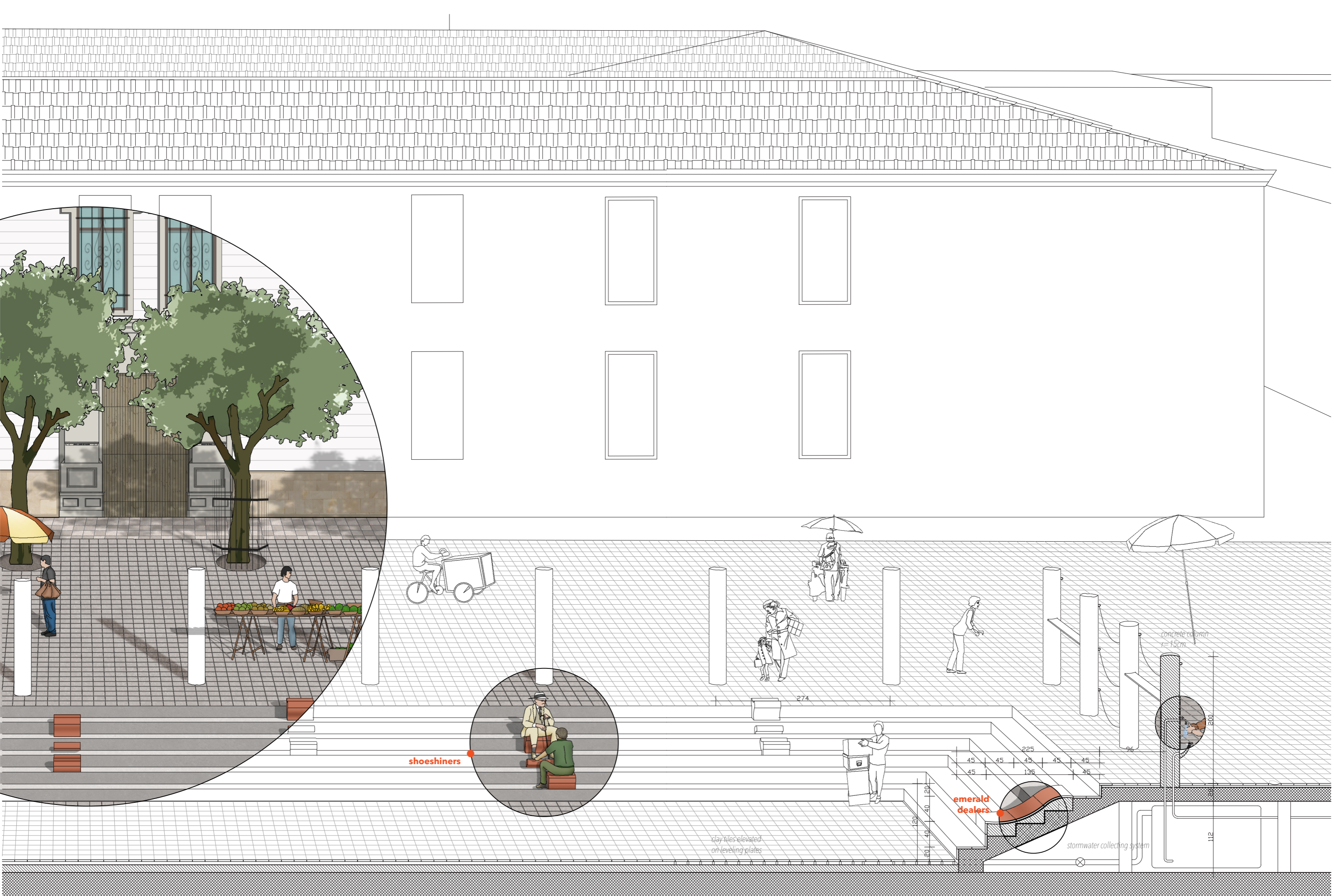

shoeshiners

emerald dealers

clay tiles elevated on leveling plates

concrete column r=15cm

stormwater collecting system

shoeshiners' work station

By examining the work process of Bogota's shoeshiners we have derived a design for a work station consisting of a client's seat and leg rest and a shoeshiners chair.

They are cast in concrete on site only after the auditorium steps have been put in place and are attached to the steps with metal anchors that have been inserted into their mold previous to pouring concrete.

The seats and leg rest are tiled with two types of curved clay tiles. An additional square clay tile can be inserted to cover the spaces in between.

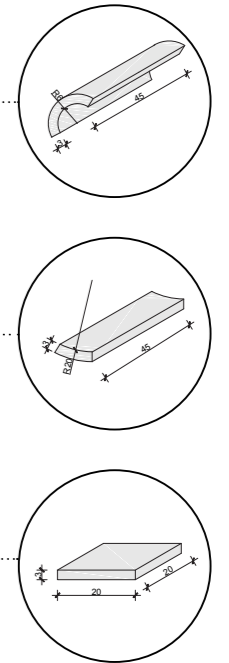
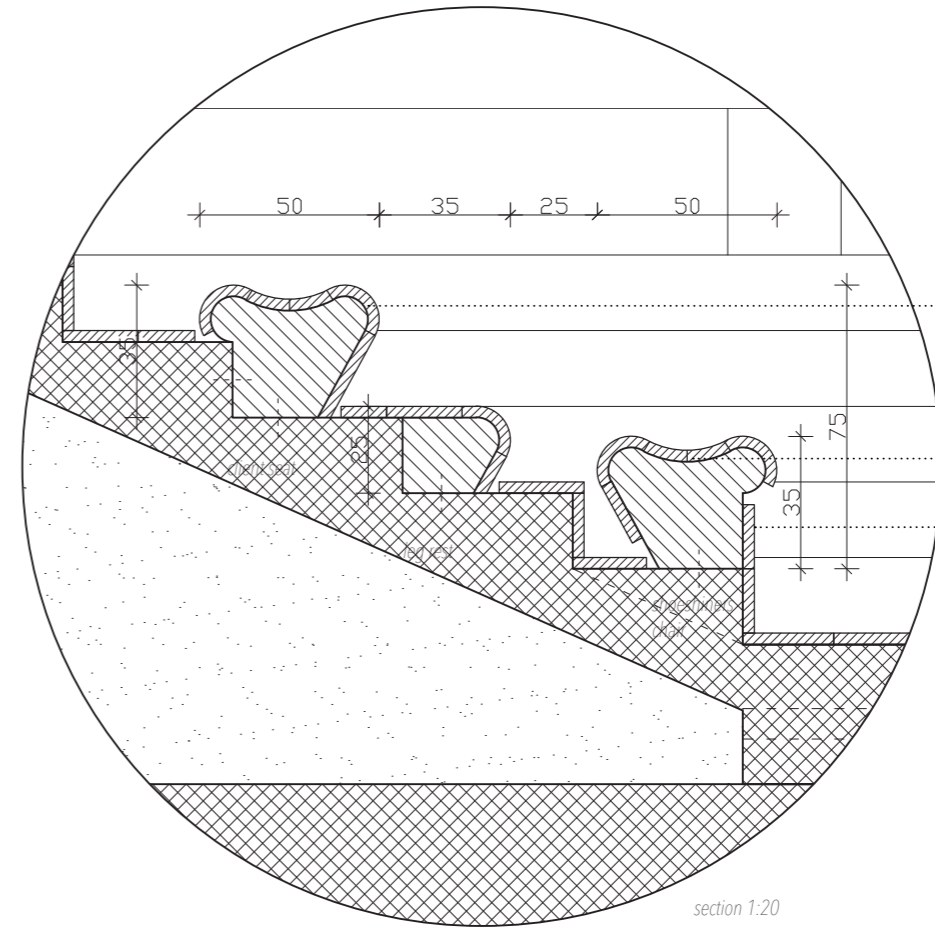
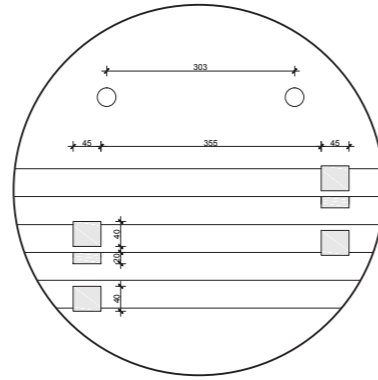

tile samples

craftsmen work station

Local craftsmen, mostly jewelry makers have a tendency to make and sell their product while sitting on the floor. This work station offers a table surface which can be occupied on three different heights and accommodate various activities.

The table is cast in concrete on site only after the auditorium steps have been put in place and are attached to the steps with metal anchors that have been inserted into their mold previous to pouring concrete.

The surface is tiled with a flat clay tile that follows the module of square paving.

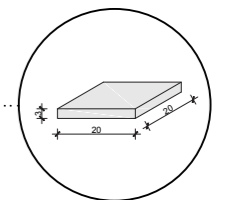
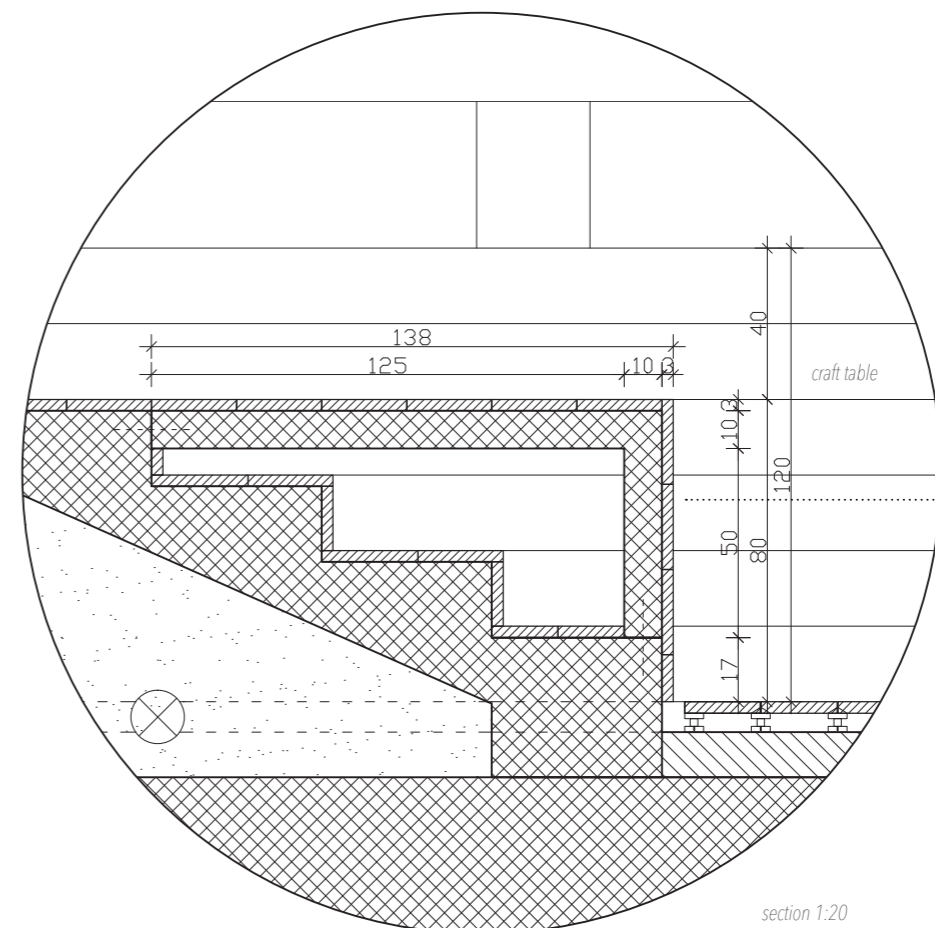
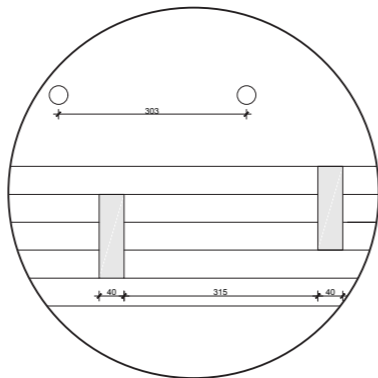

tile samples

**cart
stopper
tiles**

Customized tiles have been incorporated into the paving of the square. These tiles have slight indents that allow the vendors to secure their selling carts in place.

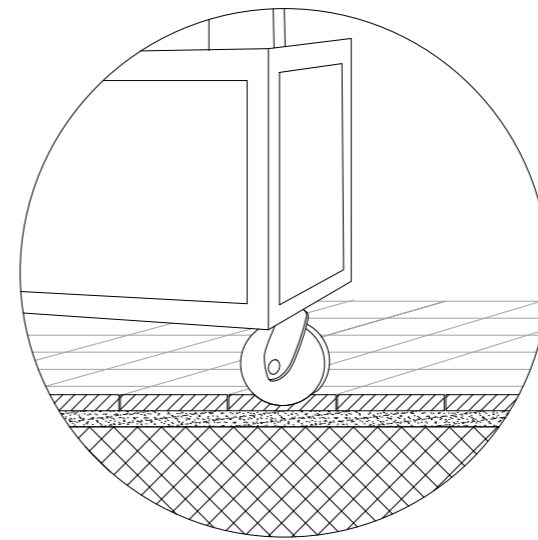

**stormwater
managing
system**

Rainwater accumulated at the bottom of the sunken auditorium is collected underneath the paving and taken away by a system of pipes. The water is then transported to a container placed between the slabs of the square and the garage where it is partially filtered. Cleansed water is then sent to the faucets built into the colonade and it can be used for washing the square after the market (keep in mind the water is not drinkable). Waste water is then either drained via a small basin on the column or taken to the sewage by the remaining street gutters.

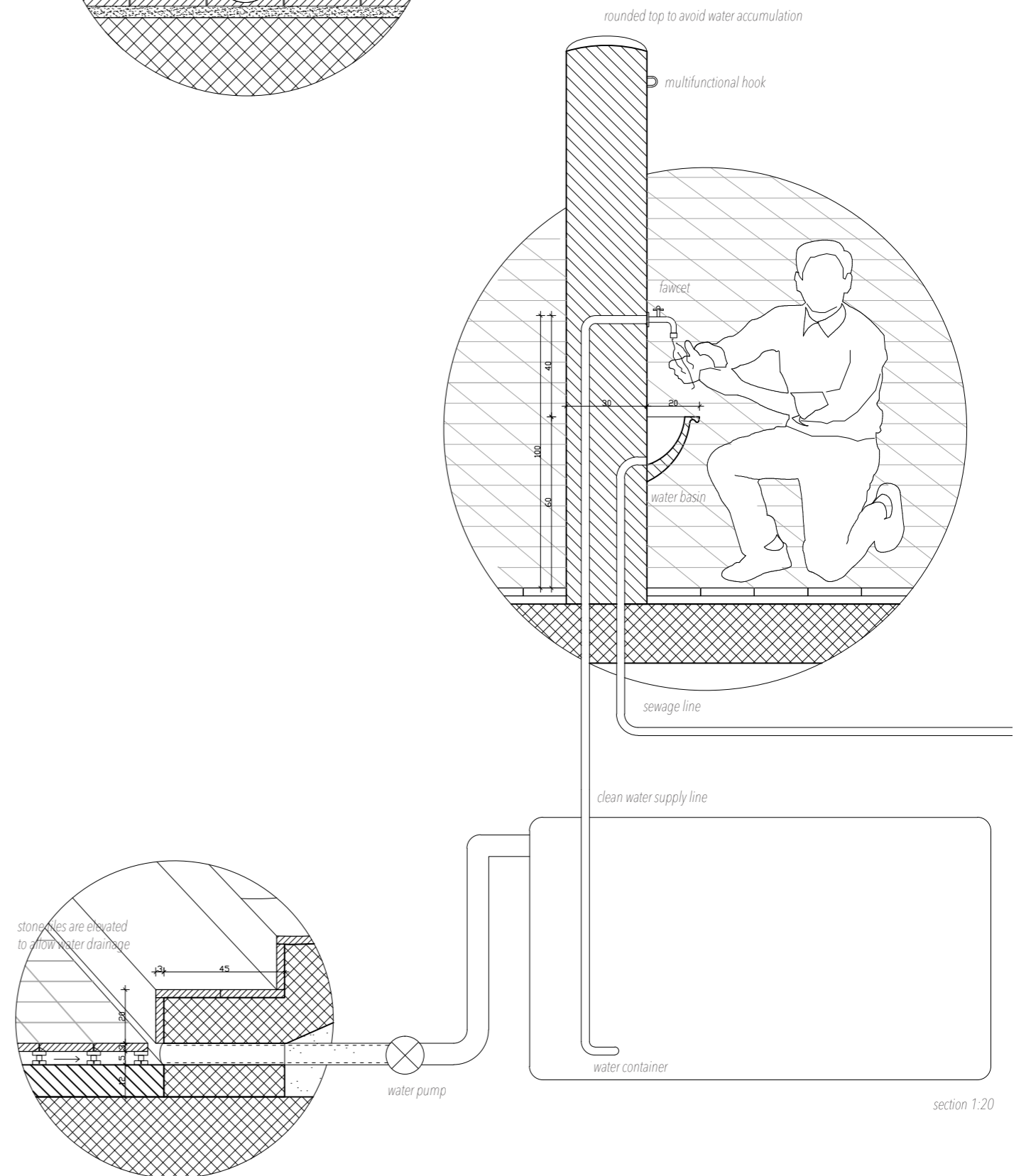

umbrella holder 1:20

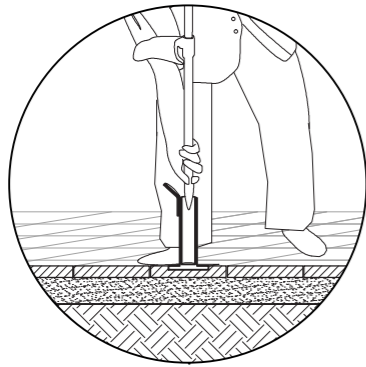

stopper tile 1:20

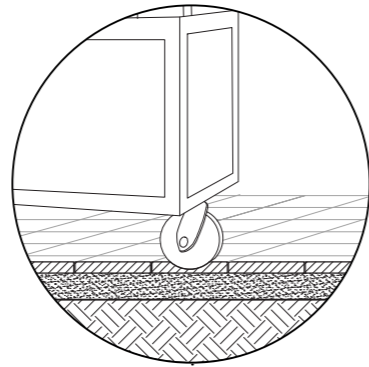

market stall hinge 1:20

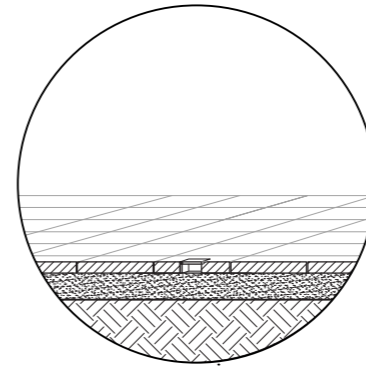

hinges

Customized clay tiles are installed that act as hinges for current and future commercial activity. Cart stoppers are intended to fix vending trolley in place.

Small metal posts serve both as umbrella holders for the vendors as well as a delineation of the market from the road.

Market stall hinges allow for tent structures to be installed and fixed.

All customized tiles are hand made by a single craftsman. Metal parts are inserted into clay before baking.

Plaza Bolivar

plan 1:50

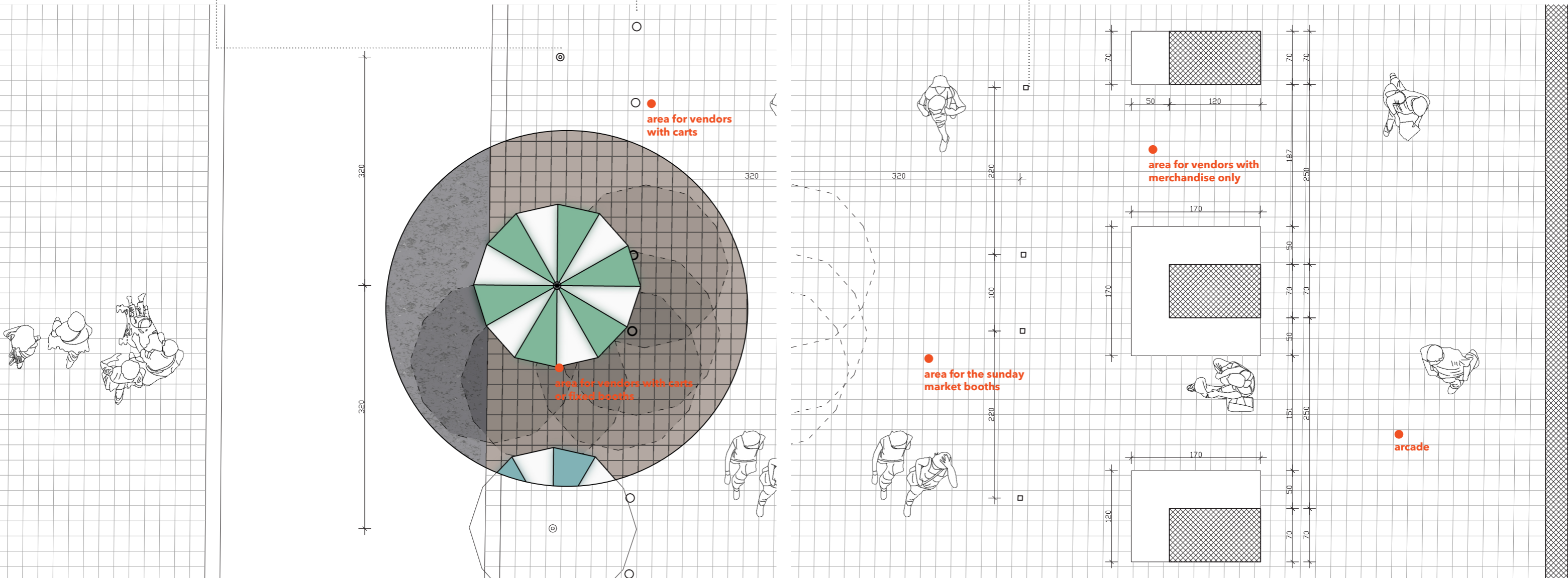

furniture

Tables are made of solid wood panels held up by steel profiles and attached to the arcade columns with screws.

The heights of tables vary to accommodate selling, leaning, playing chess etc. The users are encouraged to bring their own chairs and other items to enrich the area.

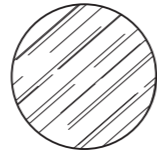
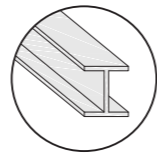

furniture-arcade connection detail

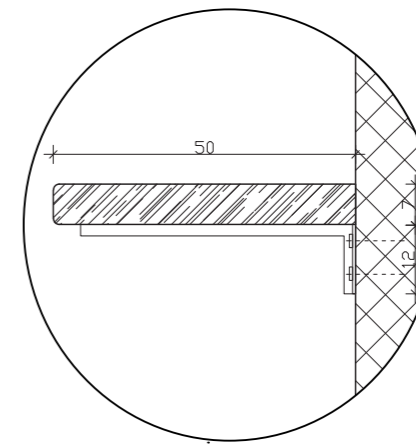

Plaza Bolivar

section 1:20

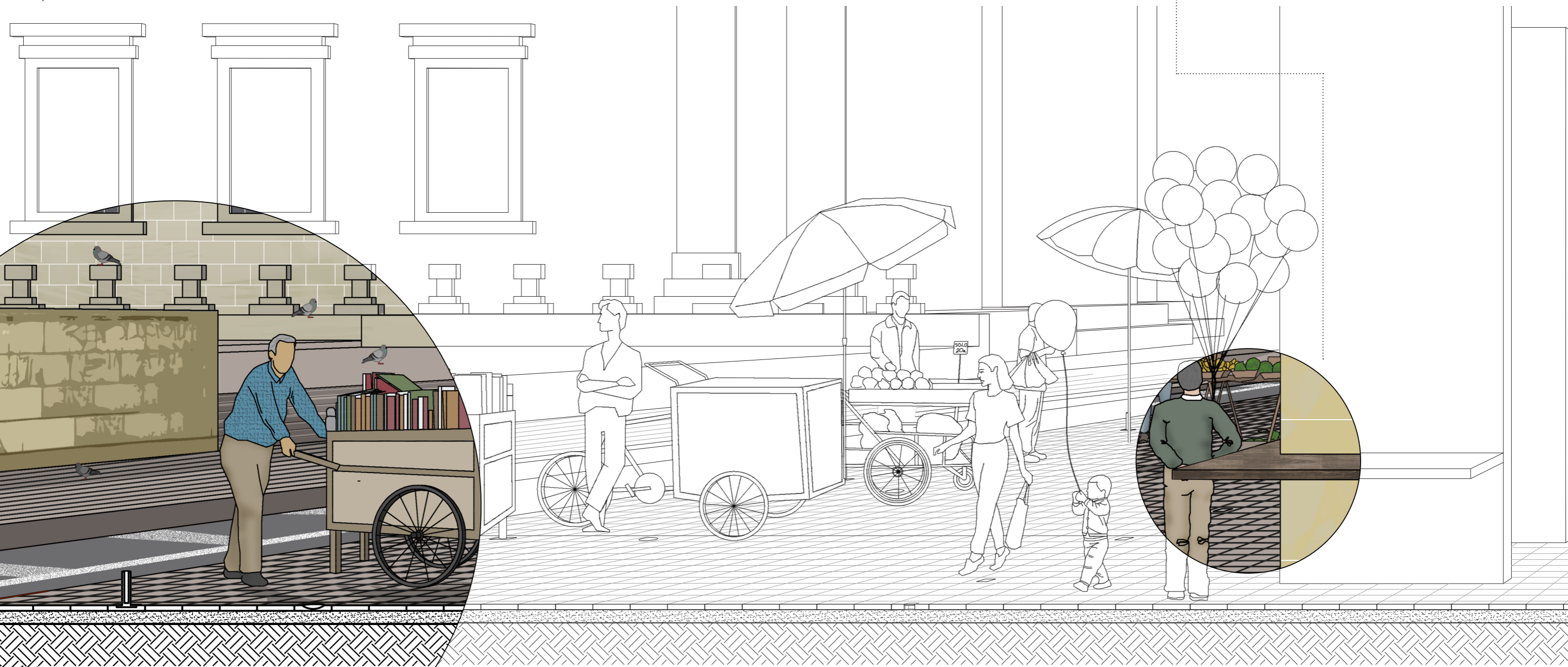

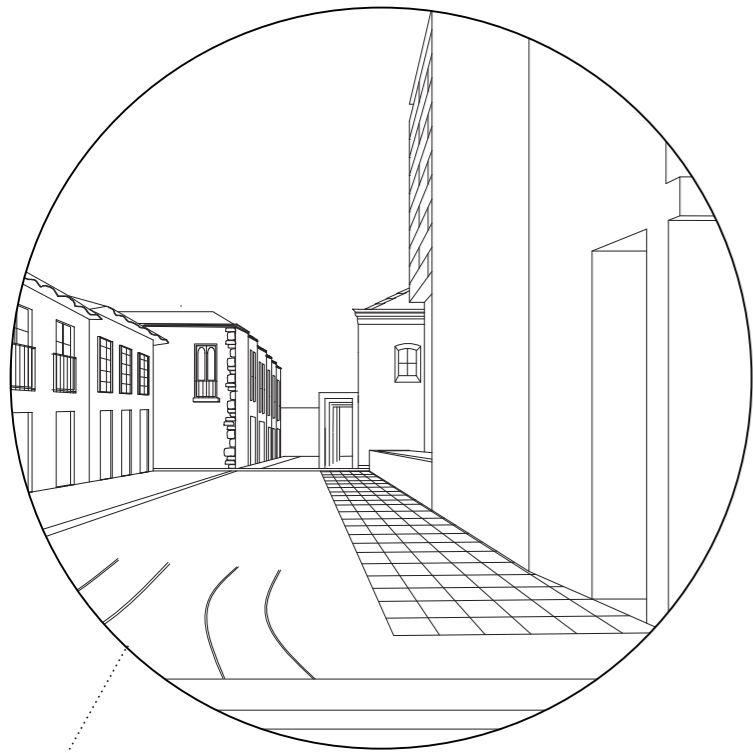

promenade paving

In order to relate the newly installed arcade to the existing one on Plaza Bolivar, a paved route is traced between the two. Tiles are made of clay and correspond to the ones in the arcade, hence becoming a linear extension of that area.

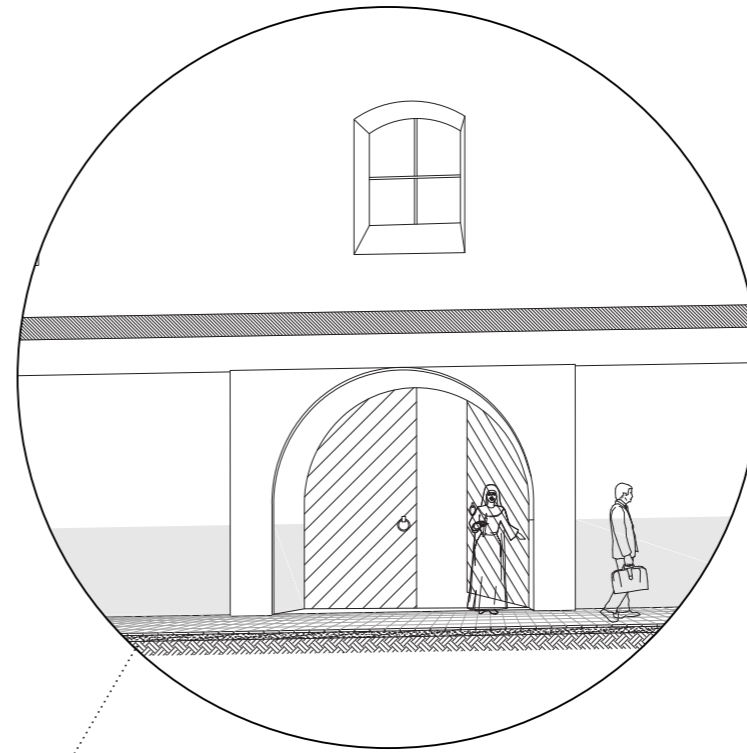
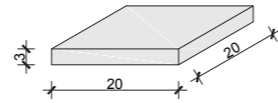

church entrance

The arcade covers the entrance to St. Ignazio church and its entrance is articulated with an arch.

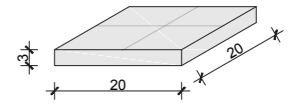

sidewalk arch

The start of the arcade is covering a sidewalk and creating a portal that pulls pedestrian towards the 'Promenade'. It is a frequent drop of point for taxi drivers with a high influx of people hence being a great selling spot. Due to that, this area is mostly dedicated to the vendors of products, beverages and snacks. They are labeled with a customized tile.

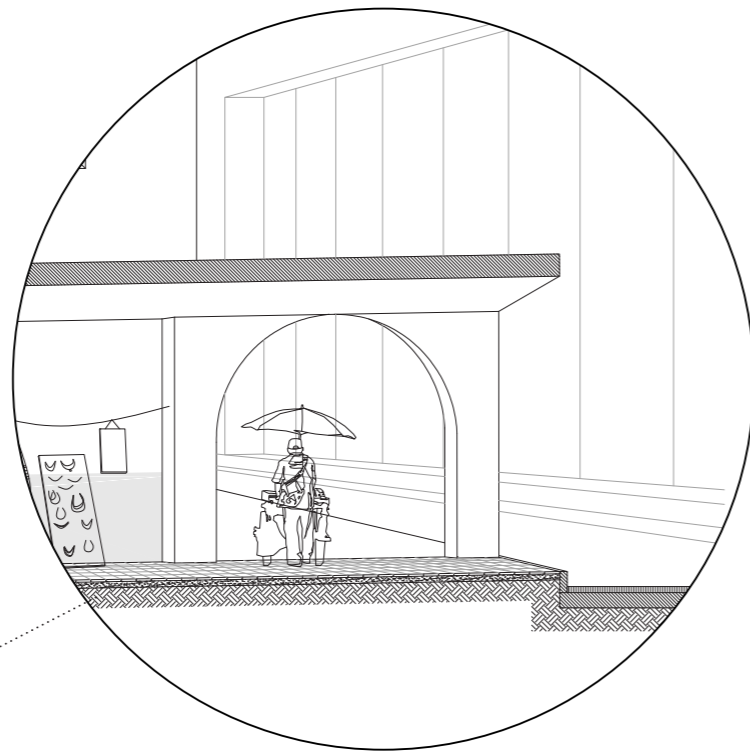
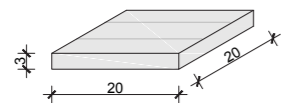

passage entrance

The end of the arcade is articulated with an arch that leads to Pasaje Rivas - a passage lined with locally crafted products. Hence, this end of the arcade is dedicated to vendors of hand crafted merchandise. They are labeled with a customized tile.

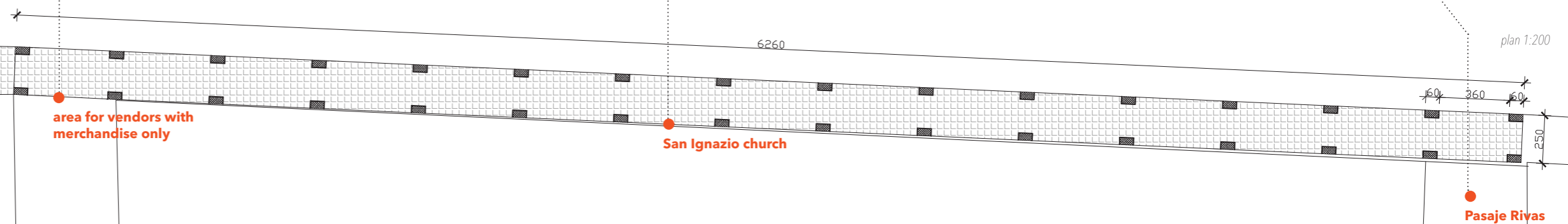
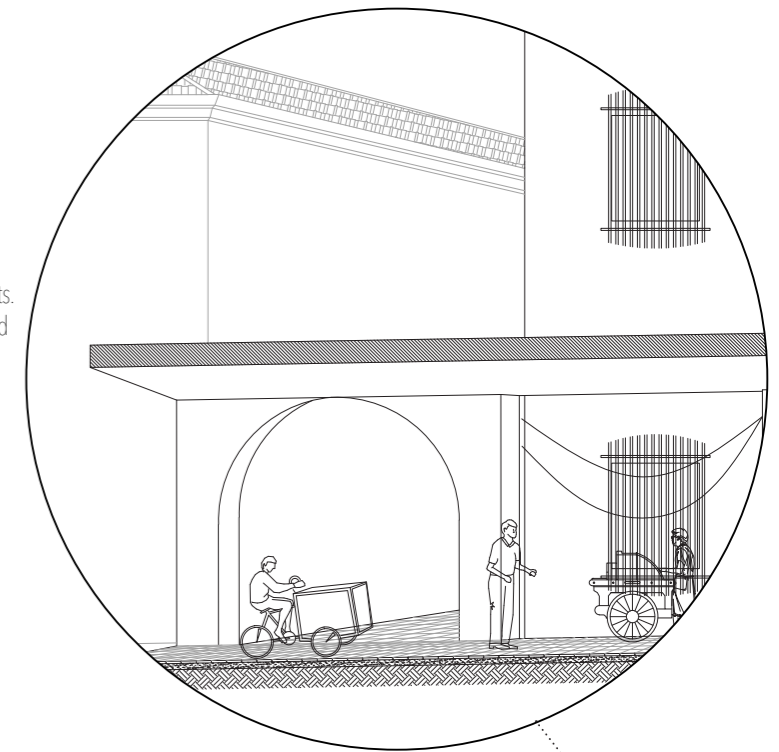

stormwater managing

The slab of the arcade is slightly pitched to direct the rainwater away from the open side of the arcade. The water is collected in a built in side gutter that gets the water to a pipe hidden in a column of the arcade. The water is release in a street gutter leading to the main sewage line.

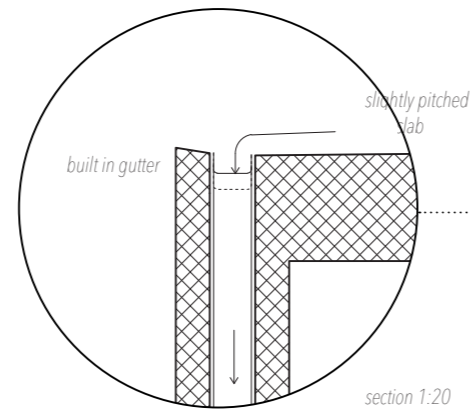

structure

The arcade is made out of concrete cast on site with a repeating mold. Due to the stability of the table construction and lack of additional load, the arcade requires no underground foundation but is simply laid on the ground. The construction is a simple post beam system comprising three arches - on both ends and the middle.

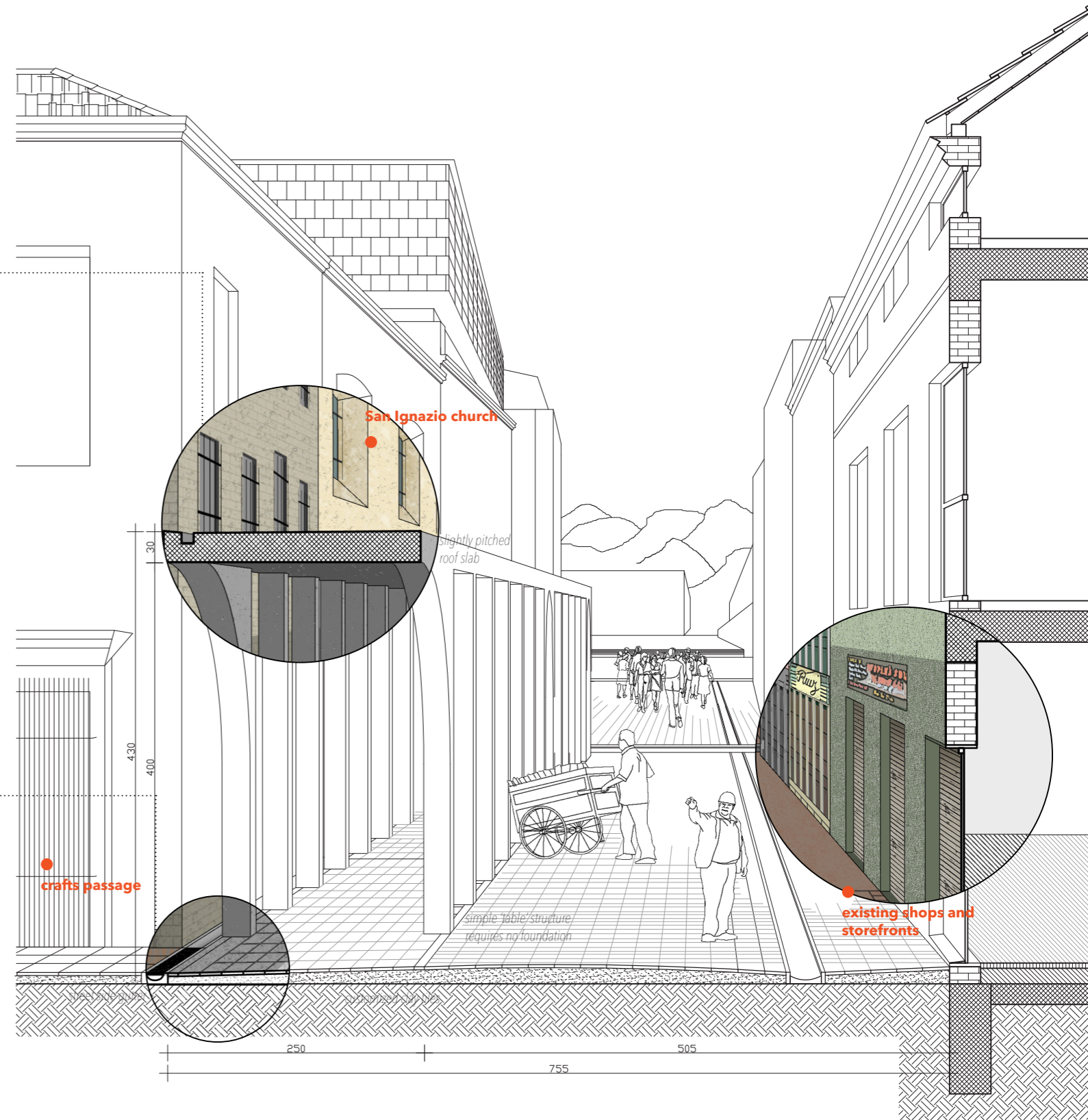
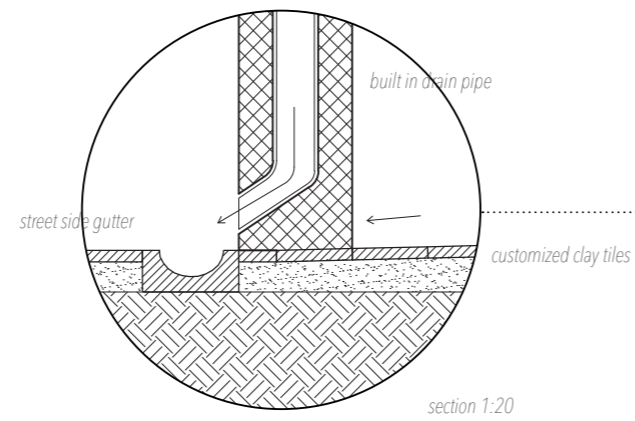

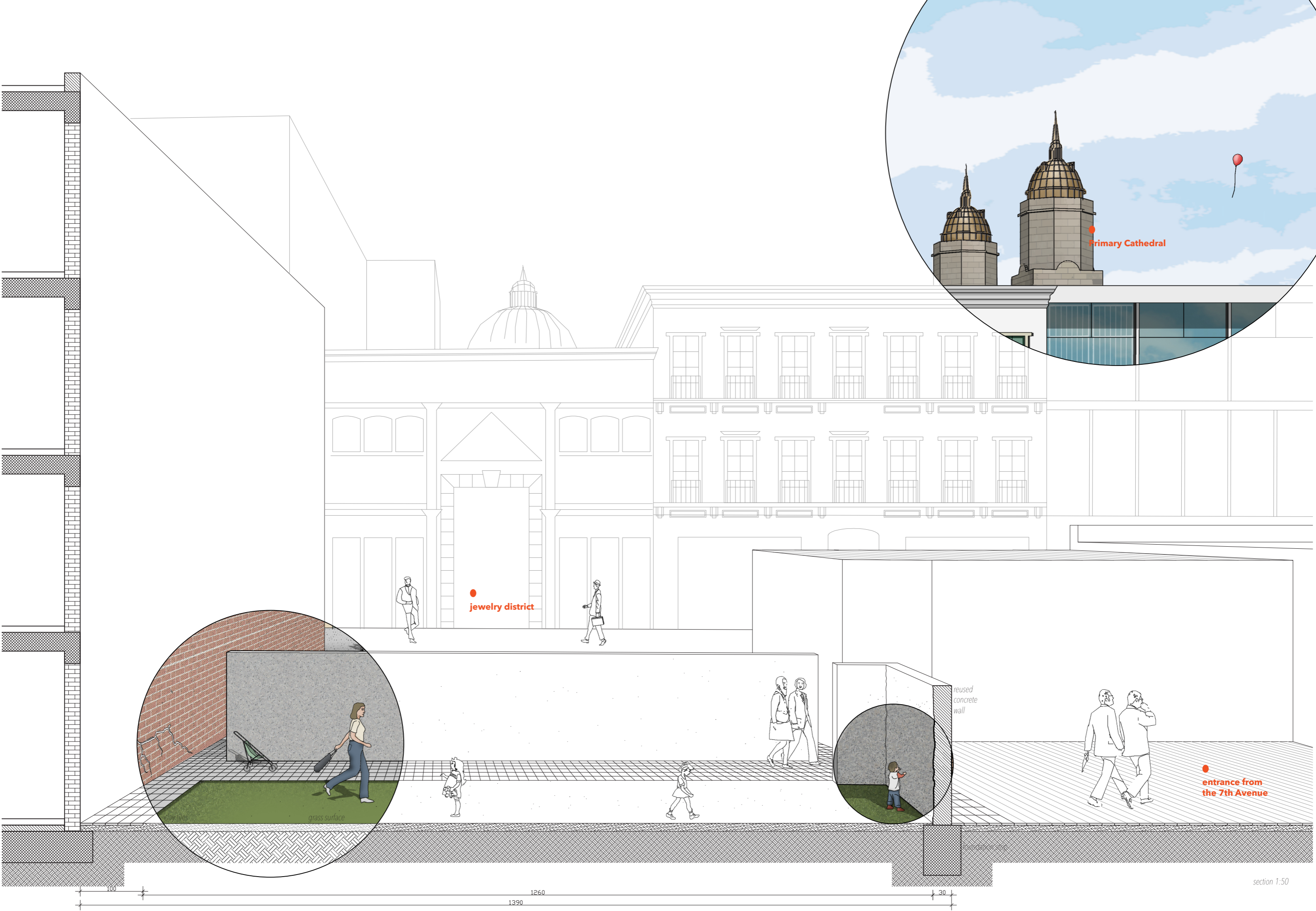

● jewelry district

● Primary Cathedral

reused concrete wall

● entrance from the 7th Avenue

100 1390 1260 30