

SECTIONS 1:100

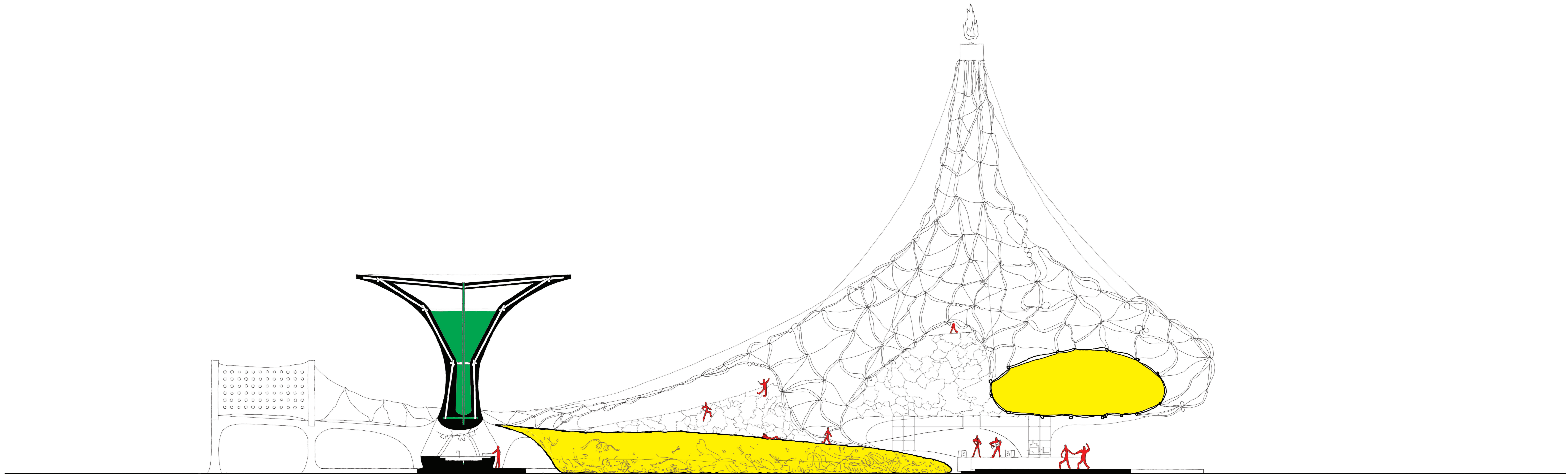

A-A 10 1 0

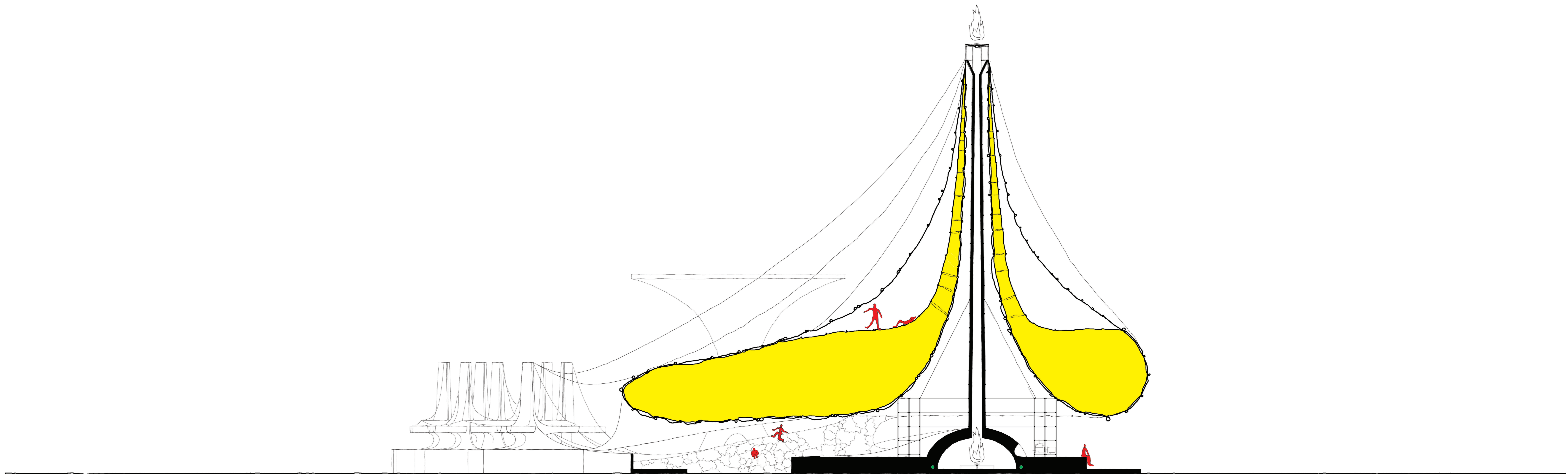

B-B 10 1 0

AXONOMETRY 1:50

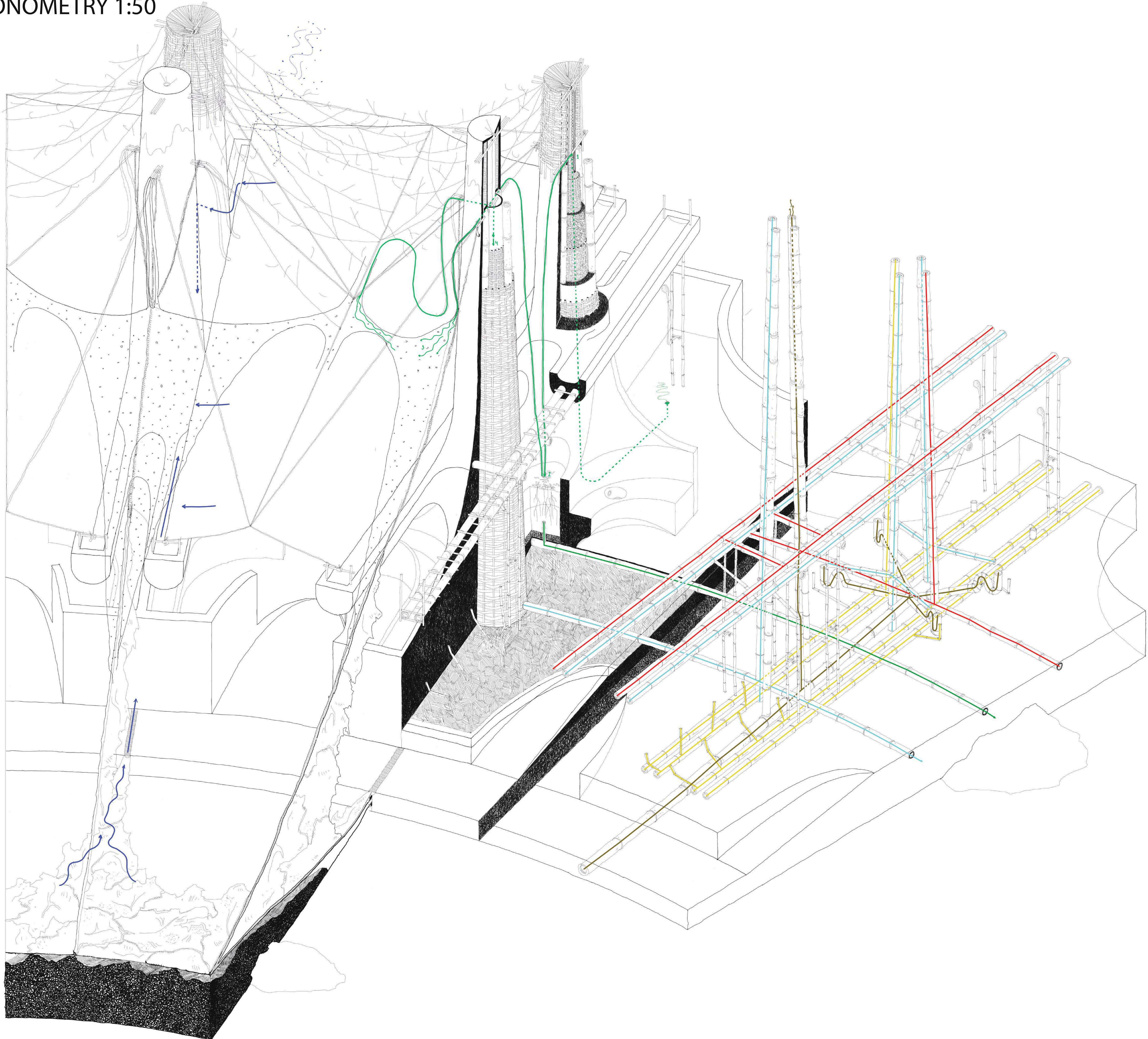

RAINWATER COLLECTION

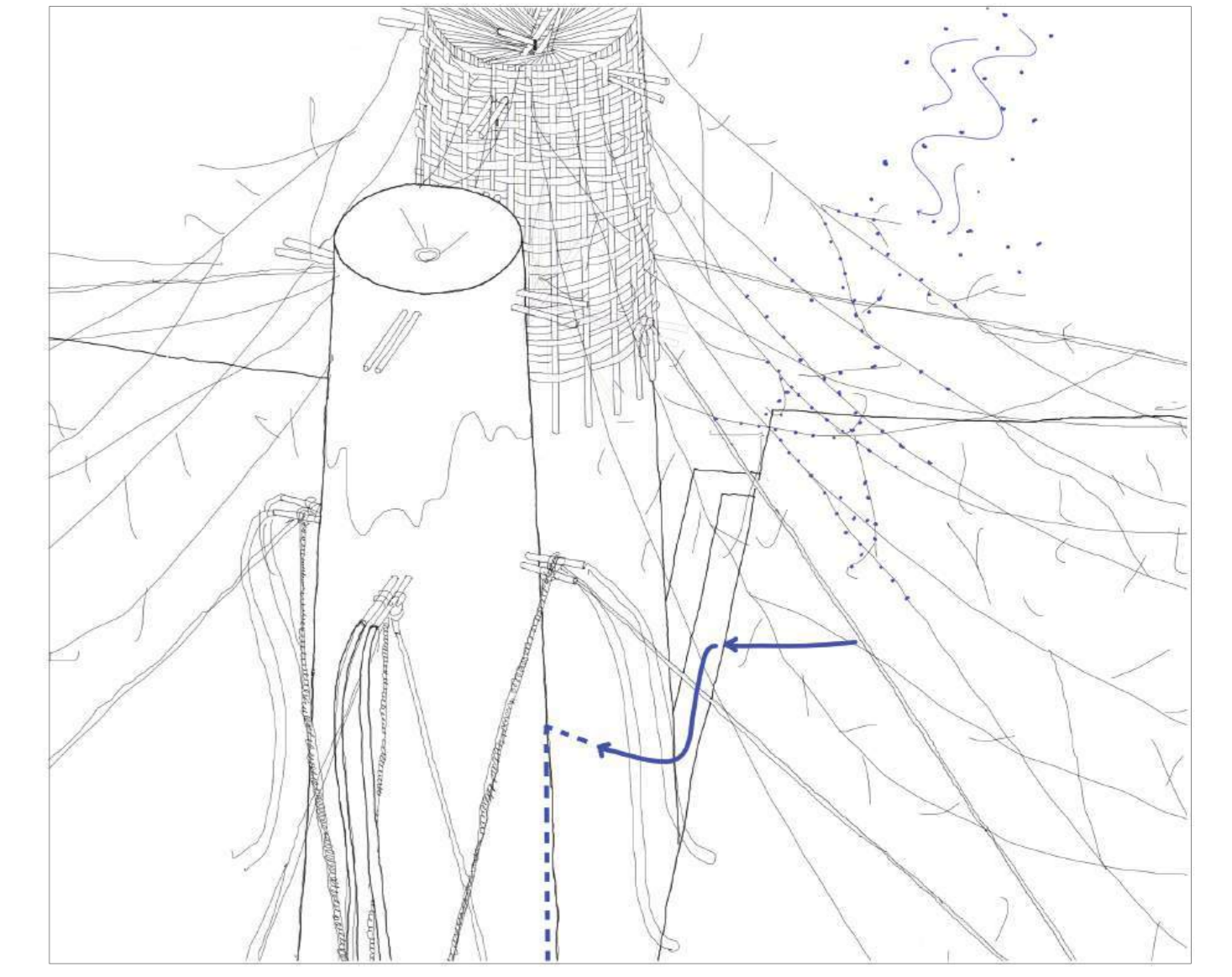

WATER FILTRATION

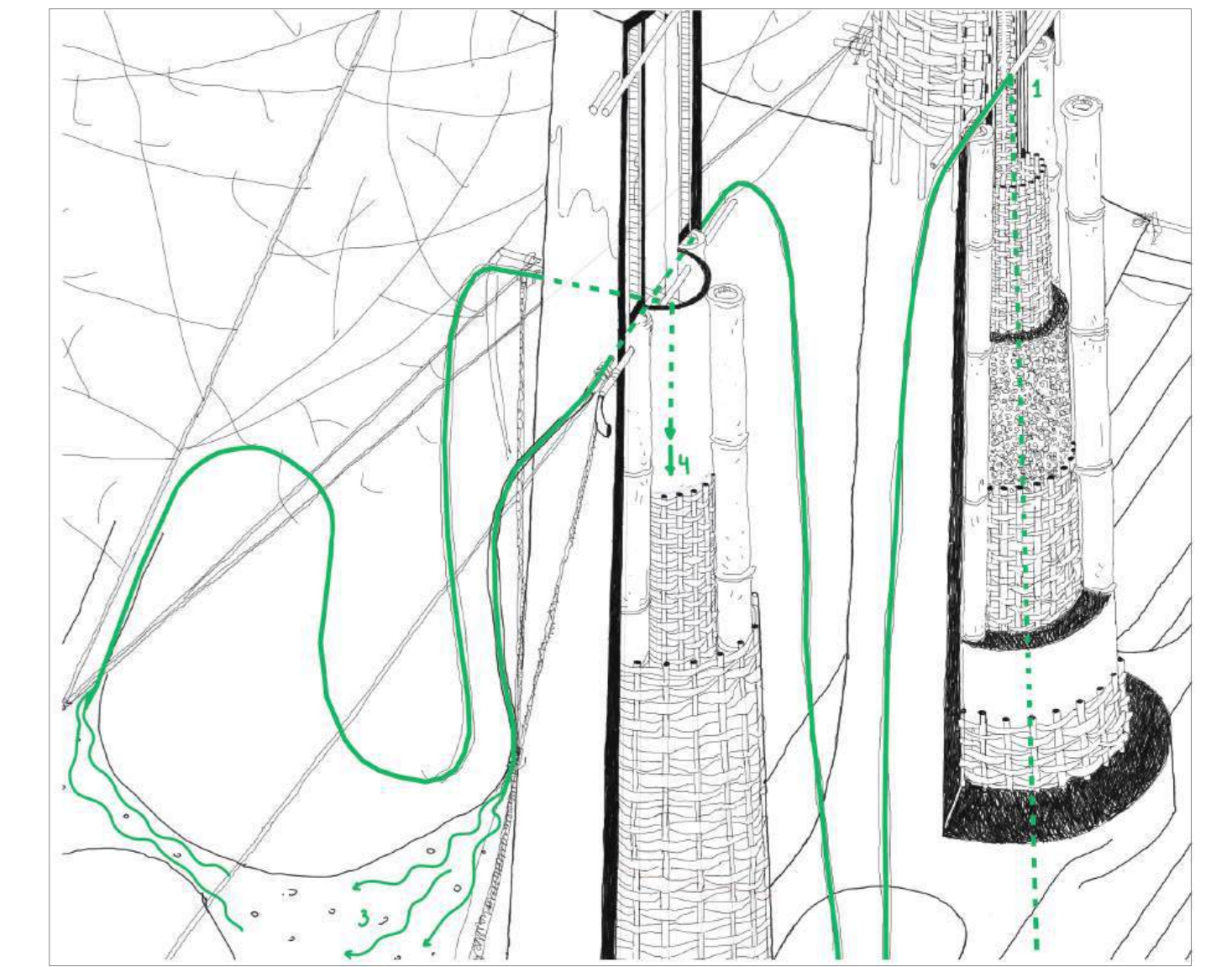

- RAINWATER
- WATER FROM URINALS AND SINKS
- FILTRATED WATER
- COLD WATER
- HOT WATER
- WASTE FROM TOILETS

DETAILS

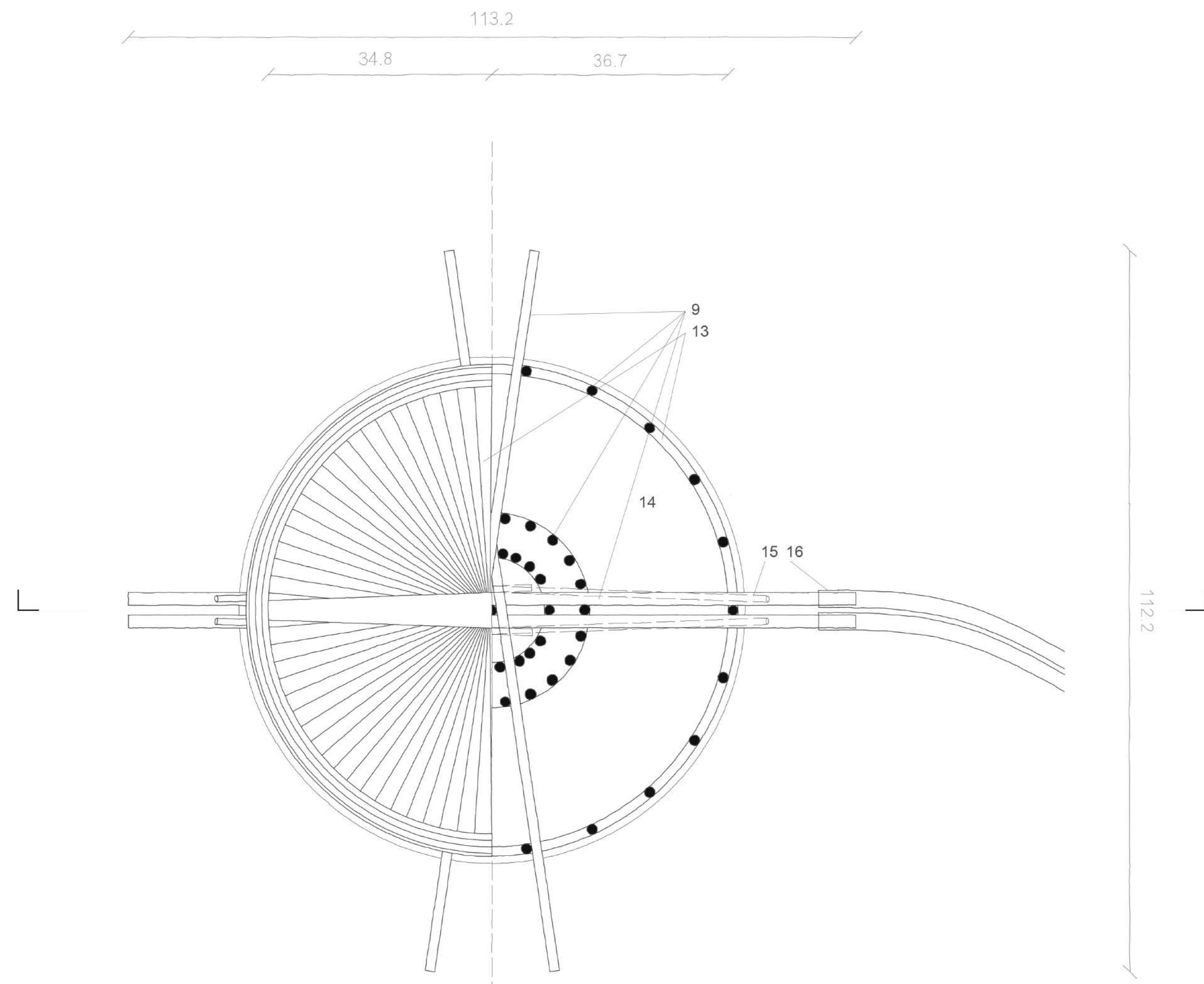

top view/ horizontal section of the top of the structure of the toilets 1:5

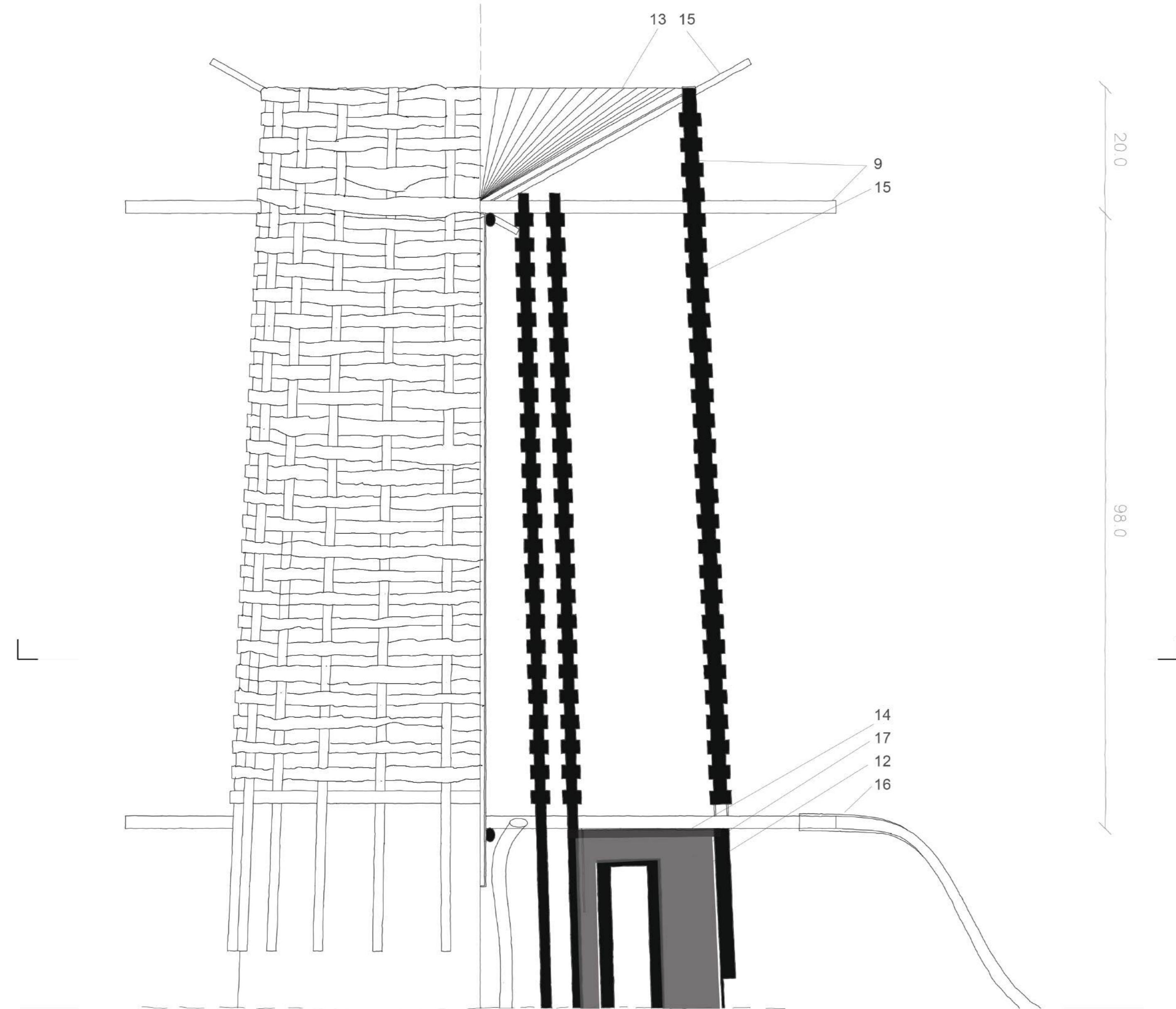

side view/ vertical section of the top of the structure of the toilets 1:5

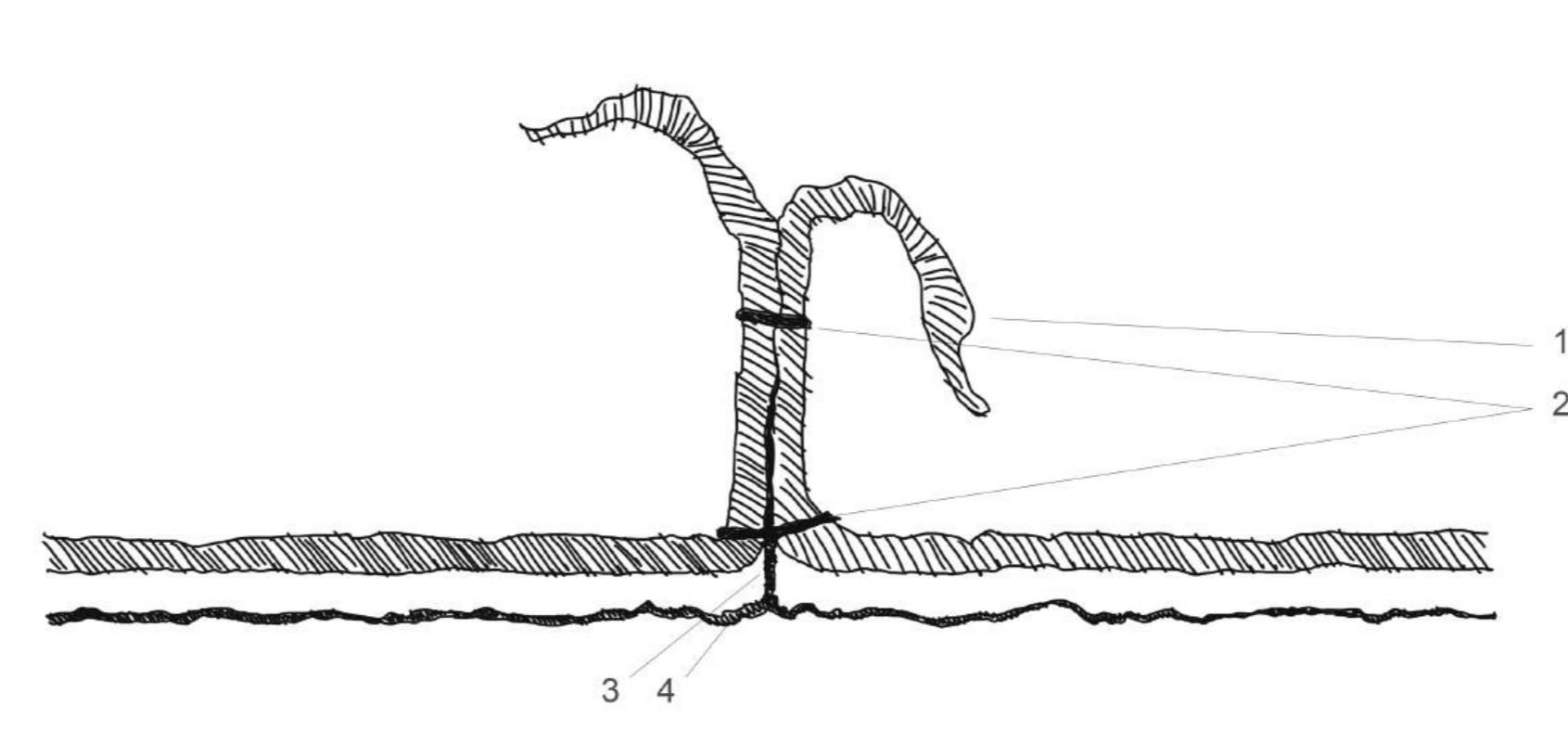

detail of the seam of the 'stomach' 1:2

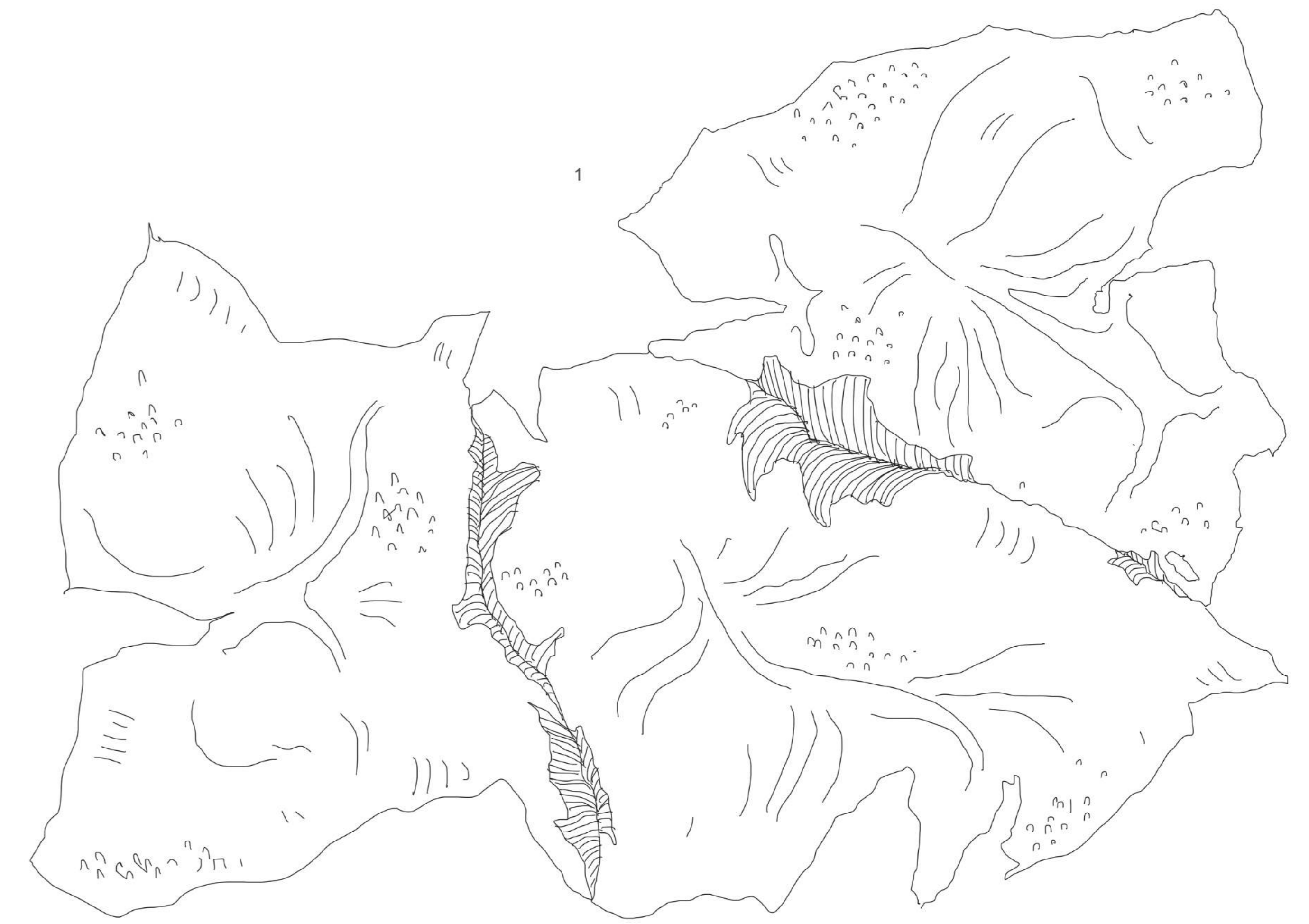
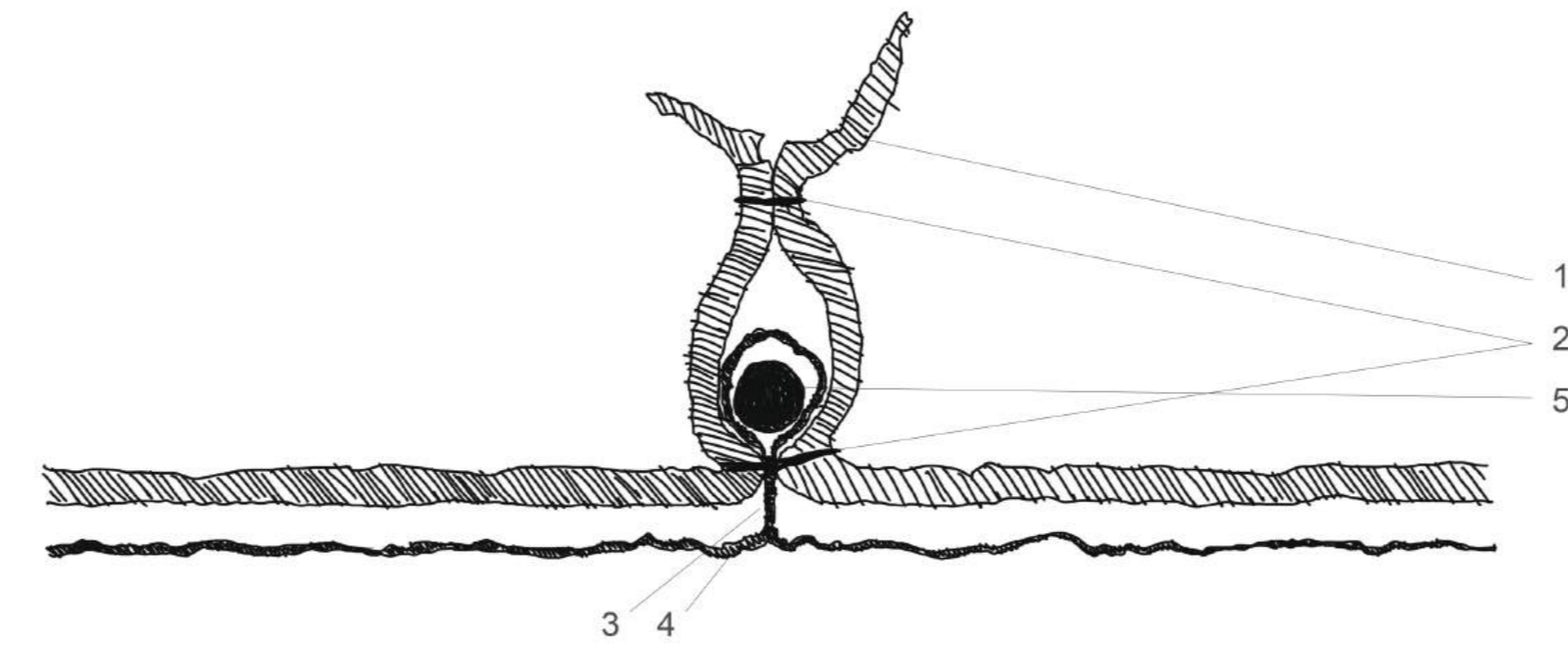

scheme of the connection of the cow stomachs 1:5

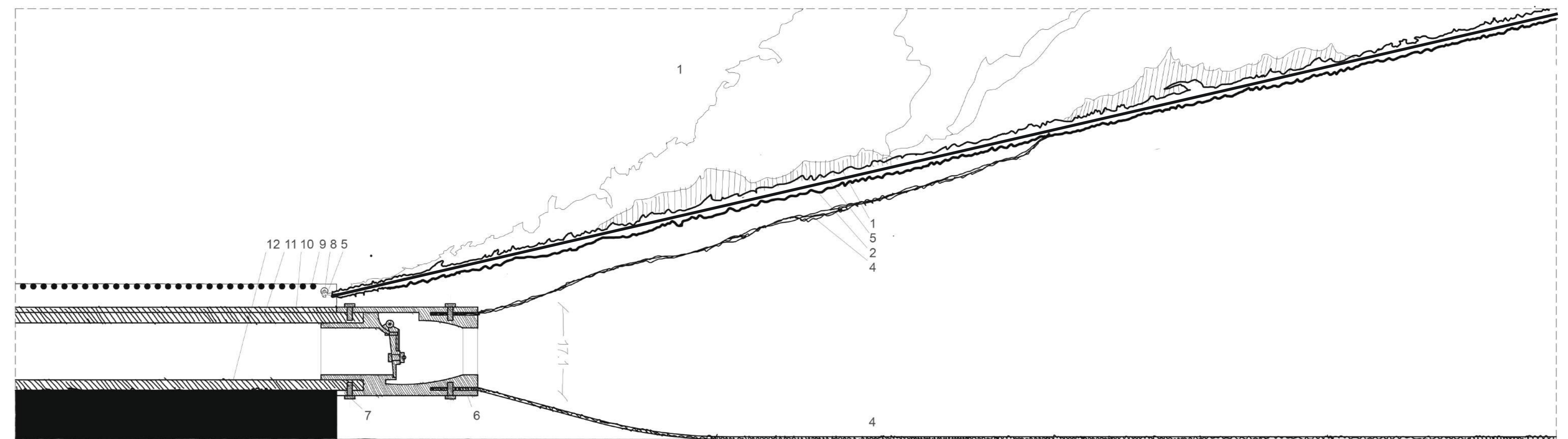

detailed section through the connection between the sewage pipe and the 'stomach' 1:5

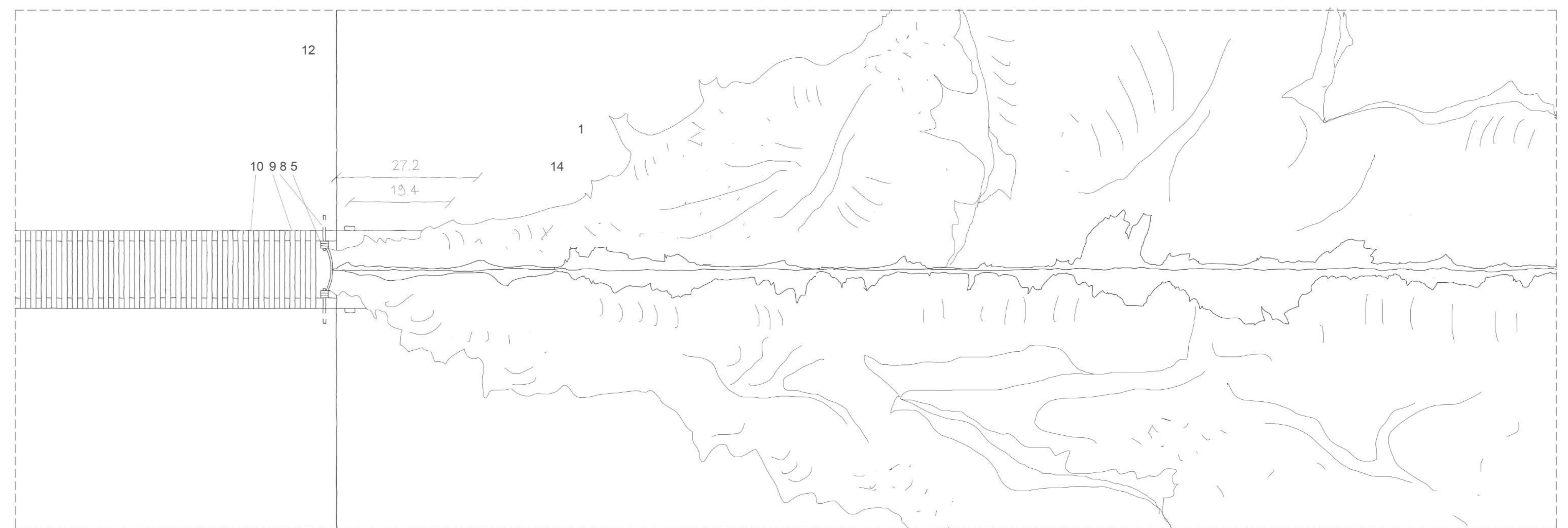

detailed top view of the connection between the sewage pipe and the 'stomach' 1:5

1. part stitched by each prson; 2. stitches made with jute rope; 3. seam made buy melting two plastic sheets together; 4. layer of plastic membrane made out of locally recycled waste; 5. jute rope, 1 cm diameter; 6. stainless steel valve preventing backflow of sewage; 7. steel bolt M10; 8. steel hook, 10 mm diameter; 9. wild sugarcane rod, 10 mm; 10. bamboo stem, 10 cm diameter; 11. bamboo stem, 10 cm diameter; 12. cob mixed with gravel; 13. wild sugarcane leaves; 14. clay mixed with lime, 5 mm; 15. wild sugarcane rod, 5 mm; 16. pig intestines covered with wax; 17. cob;

MODEL 1:100



MODEL 1:1

