



PRICEWATERHOUSECOOPERS 

COPY

CLASSIFICATION SHEET

This document relates to the following request:

December 16, 2009

References: VCO/FSMZ/DAPA/P19509003- CSDO

Pepsi Bottling Group  
 PBG International Holdings Jayhawk SCS  
 Tanglewood Finance Sàrl - Tax number 2002 2406 001  
 PBG Midwest Holdings S.à r.l - Tax number 2005 24 13584  
 PRB Luxembourg International S.à r.l. - Tax number 2008 24 33075

1. Key topics: Acquisition, reorganization, income from qualifying participations, functional currency, liquidation, beneficial ownership, financing activity	
2. Name of the advisor : PwC	
3. Corporate group's name, or fund sponsor: Pepsi Bottling Group	
4. Name of the project: Project First - Lebedyansky acquisition	
5. Amount intended to be invested:	BUREAU D'IMPOSITION SOC. 6 ENTRÉE
6. Date of receipt:	16 DEC. 2009

Francesco Tincani

P4 presentation

# Ground, things and representation in Luxembourg

Chair of Public Building

18/05/2017

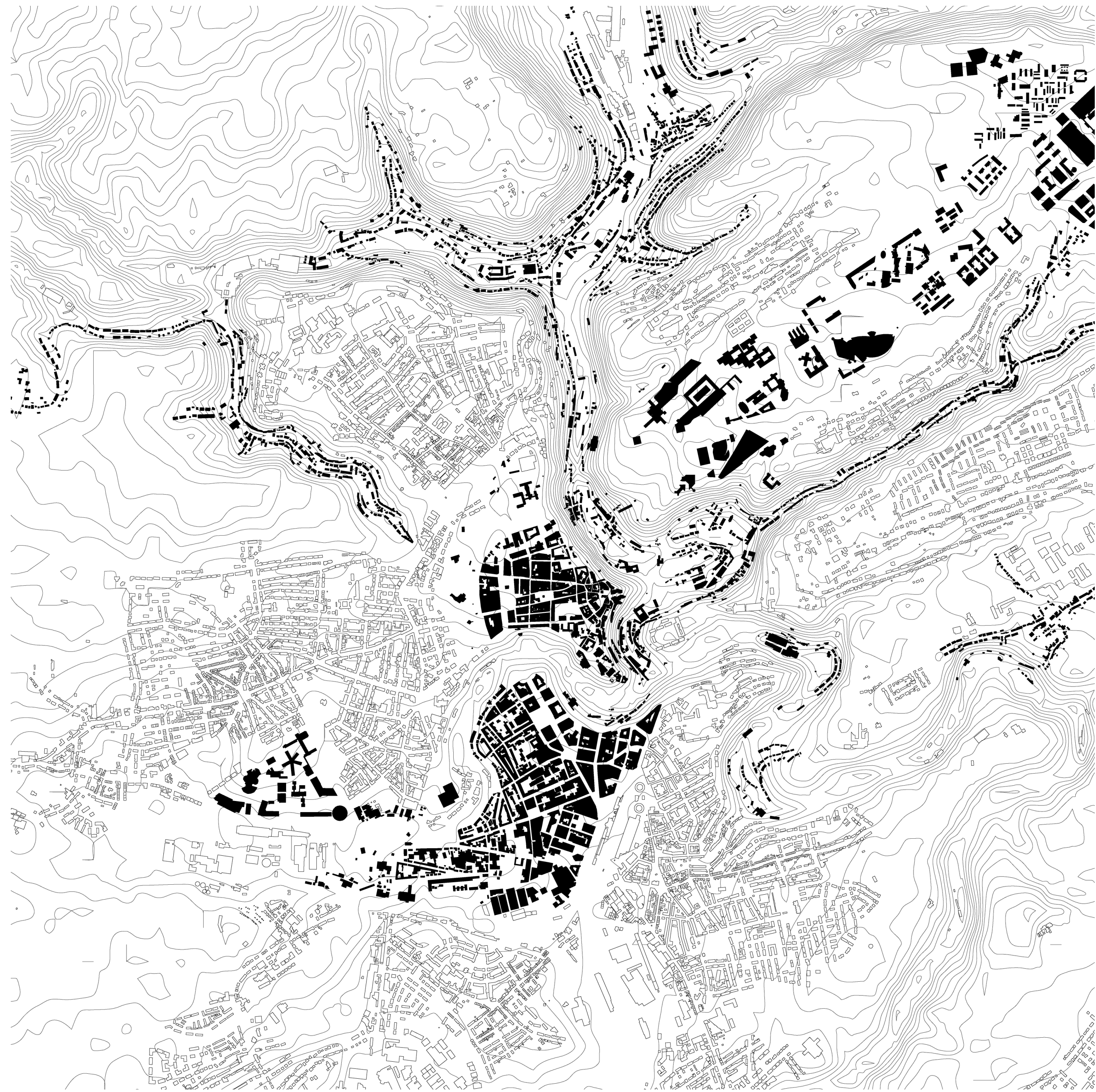

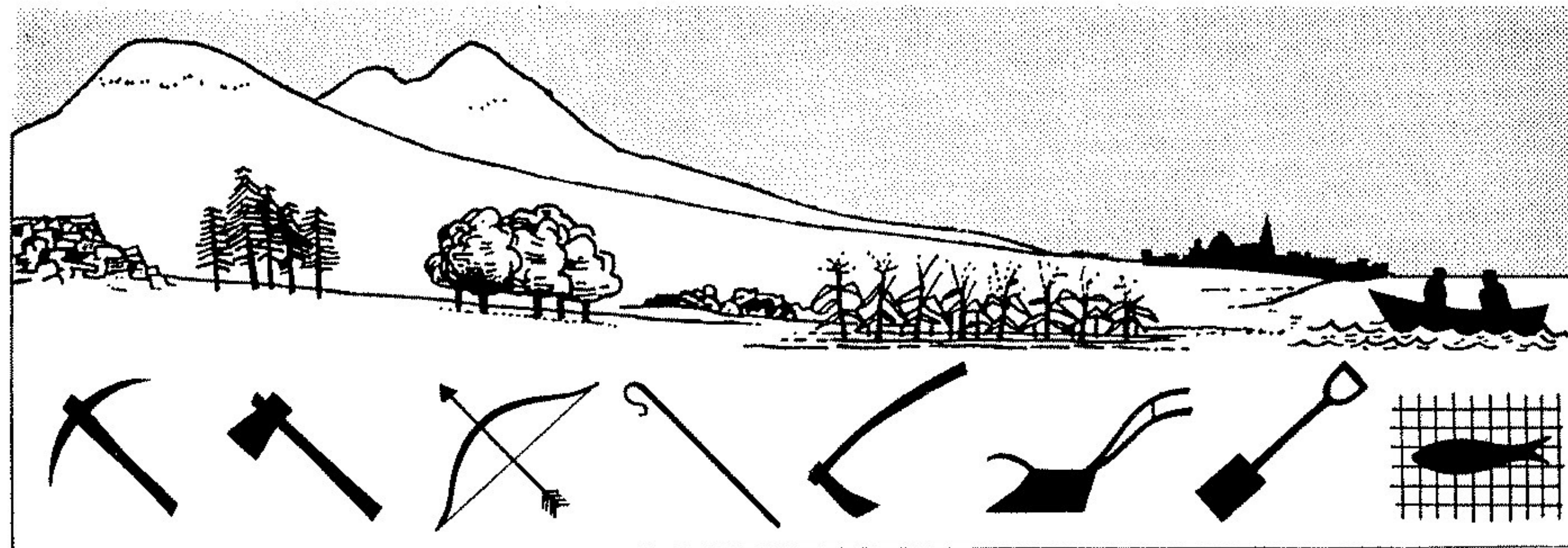

MINER      WOODMAN      HUNTER      SHEPHERD      PEASANT      GARDENER      FISHER

" HABITAT "

SMITHSONS

2 FEB 1960

- 1) It is useless to consider the house except as a part of a community owing to the inter-action of these on each other.
- 2) We should not waste our time codifying the elements of the house until the other relationship has been crystalised.
- 3) "Habitat" is concerned with the particular house in the particular type of community.

3 FEB 1960

- 4) Communities are the same everywhere.
  - 1) detached house - farm.
  - 2) Village.
  - 3) Towns of various sorts (Industrial)  
(Admin.)  
(Special.)
  - 4) Cities (multi functional).

5) They can be shown in relationship to their environment (Habitat) in the Geddes valley section.

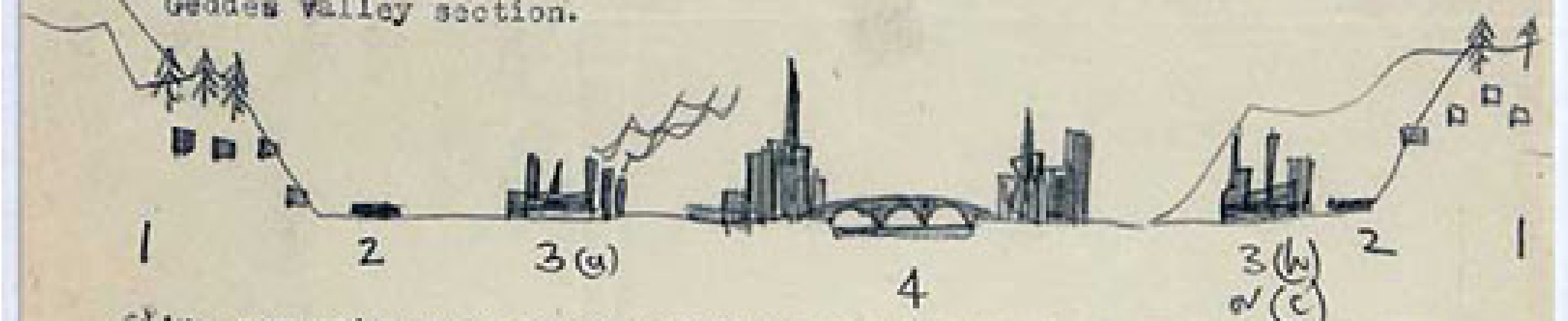

- 6) Any community must be internally convenient - have ease of circulation, in consequence whatever type of transport are available, density must increase as population increases, i.e. (1) is least dense (4) is most dense.
- 7) We must therefore study the dwelling and the groupings that are necessary to produce convenient communities at various points on the valley section.
- 8) The appropriateness of any solution may lie in the field of architectural invention rather than social anthropology.



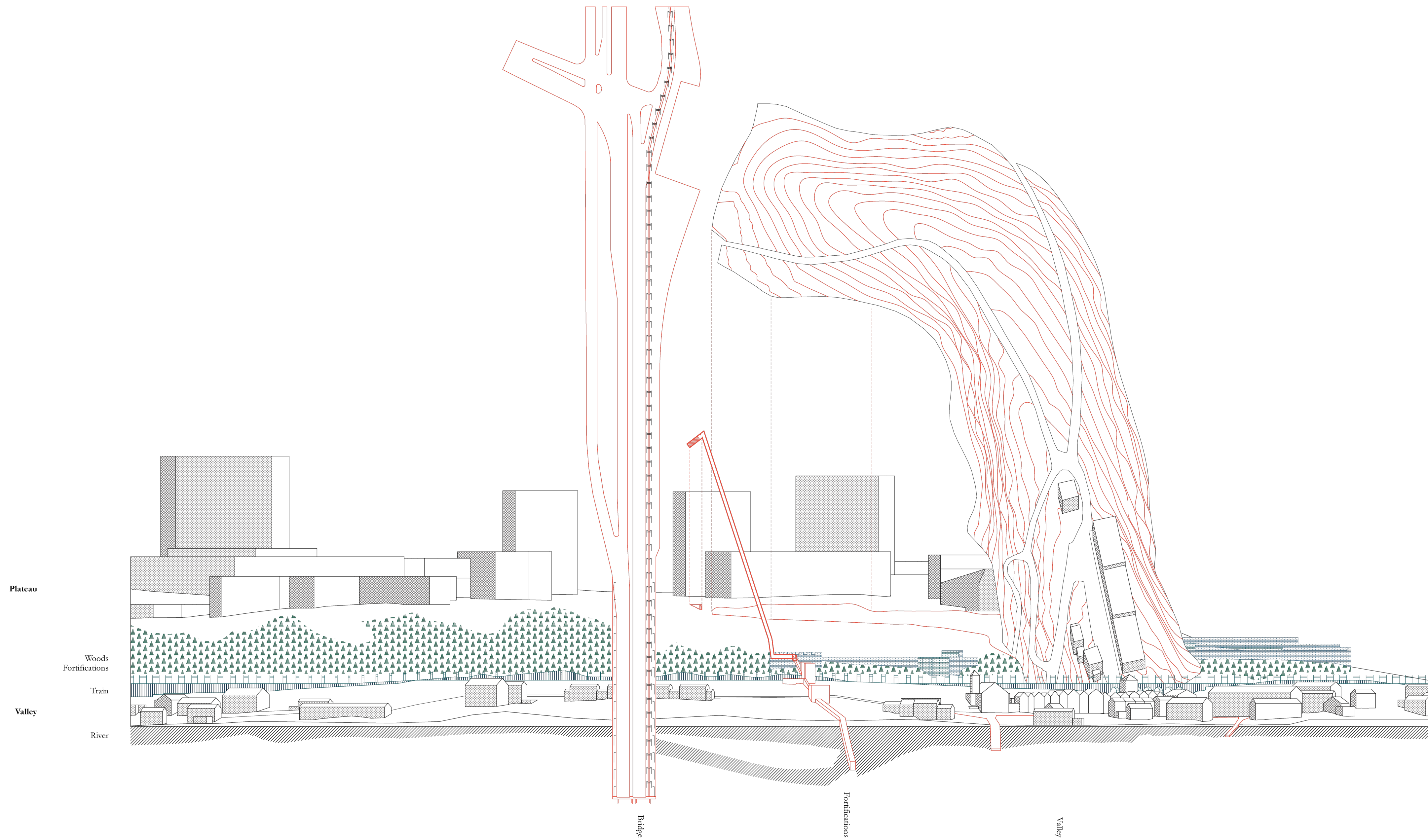



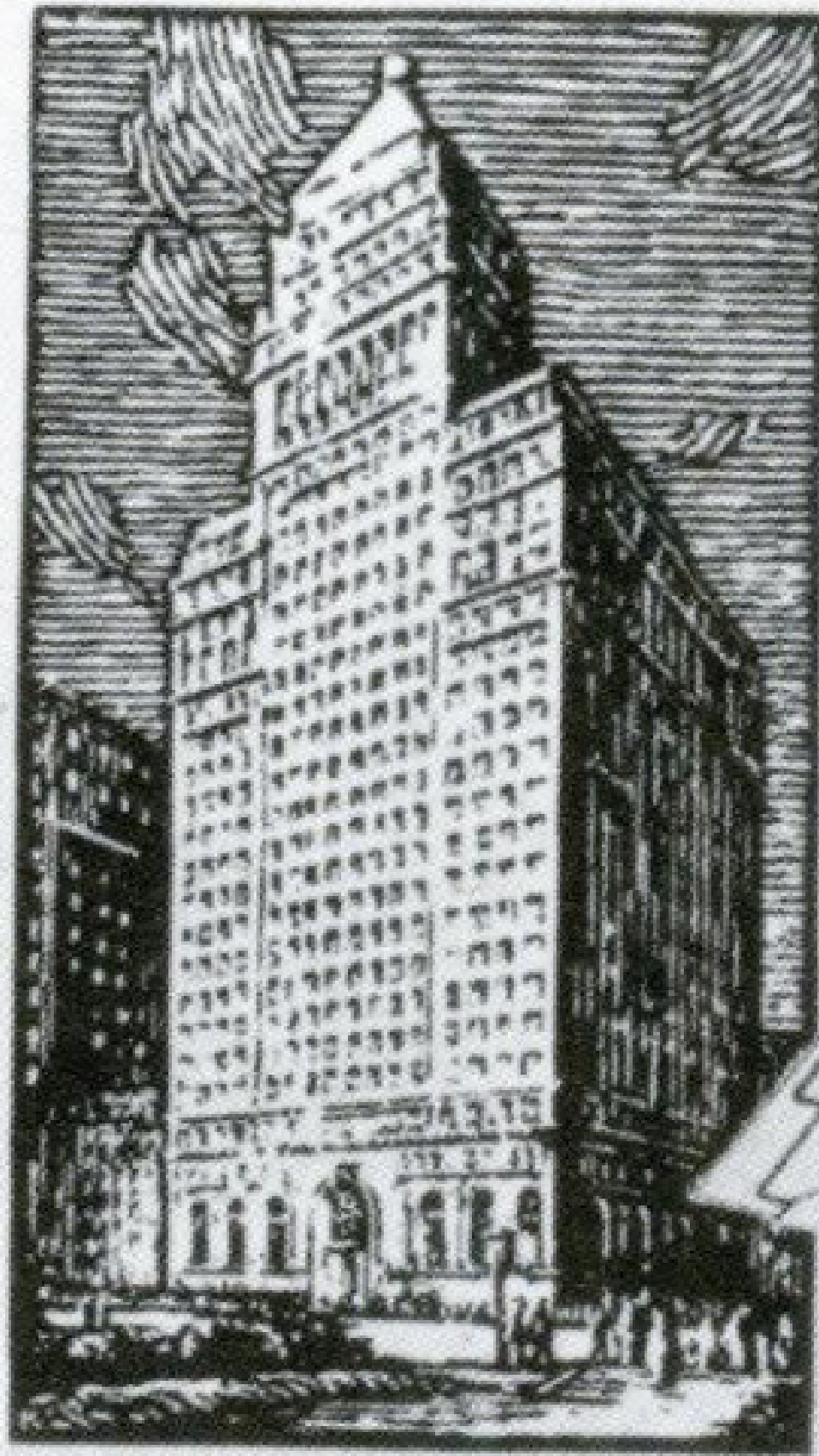

Typical office suit in The State Building consisting of two private offices and a large reception room. Maximum depth from windows to corridor walls is 24 feet, insuring natural light in every foot of the rental area, and no waste space.

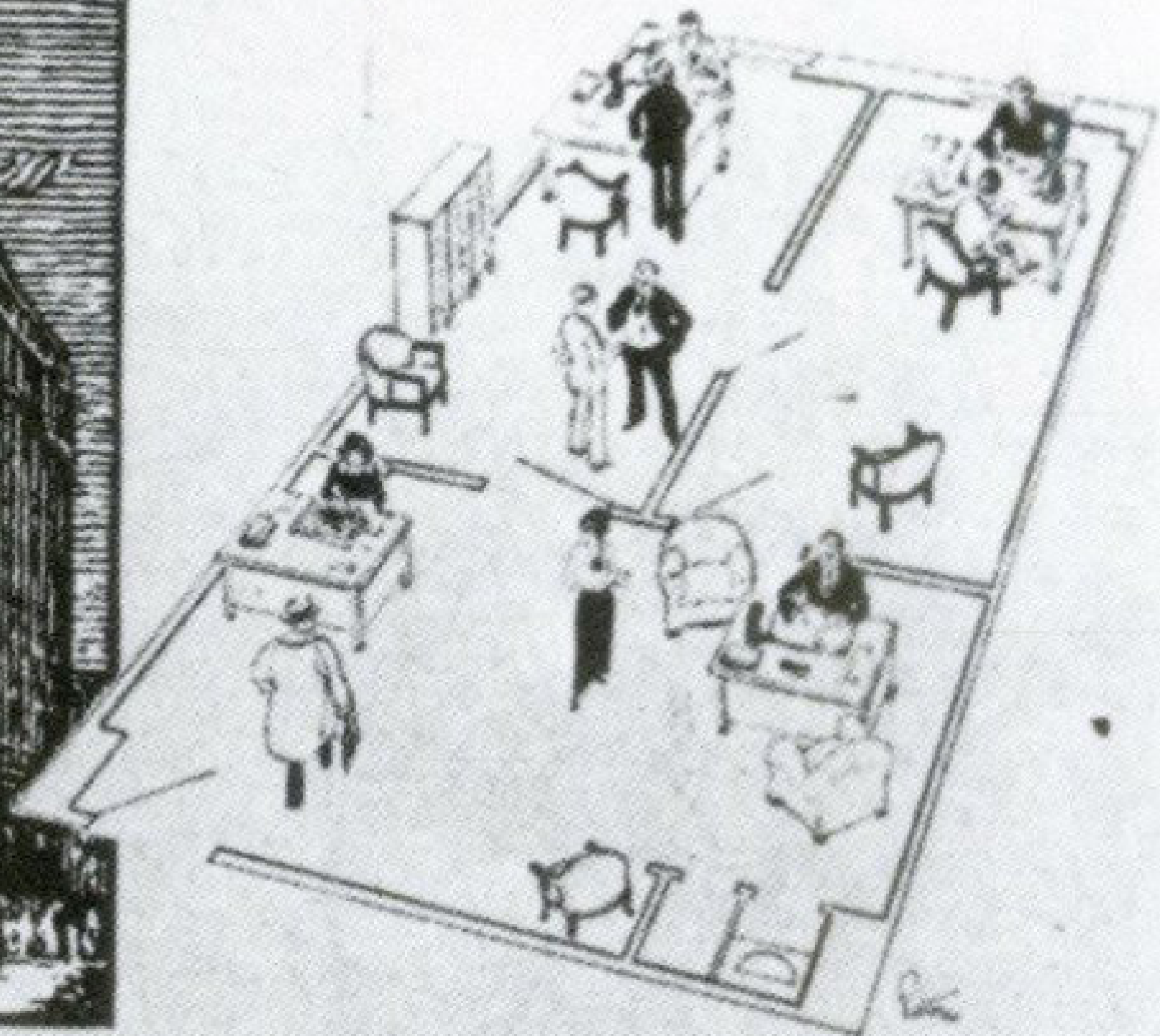

**This Suite at \$130 a Month**  
*in Chicago's Finest Office Building*

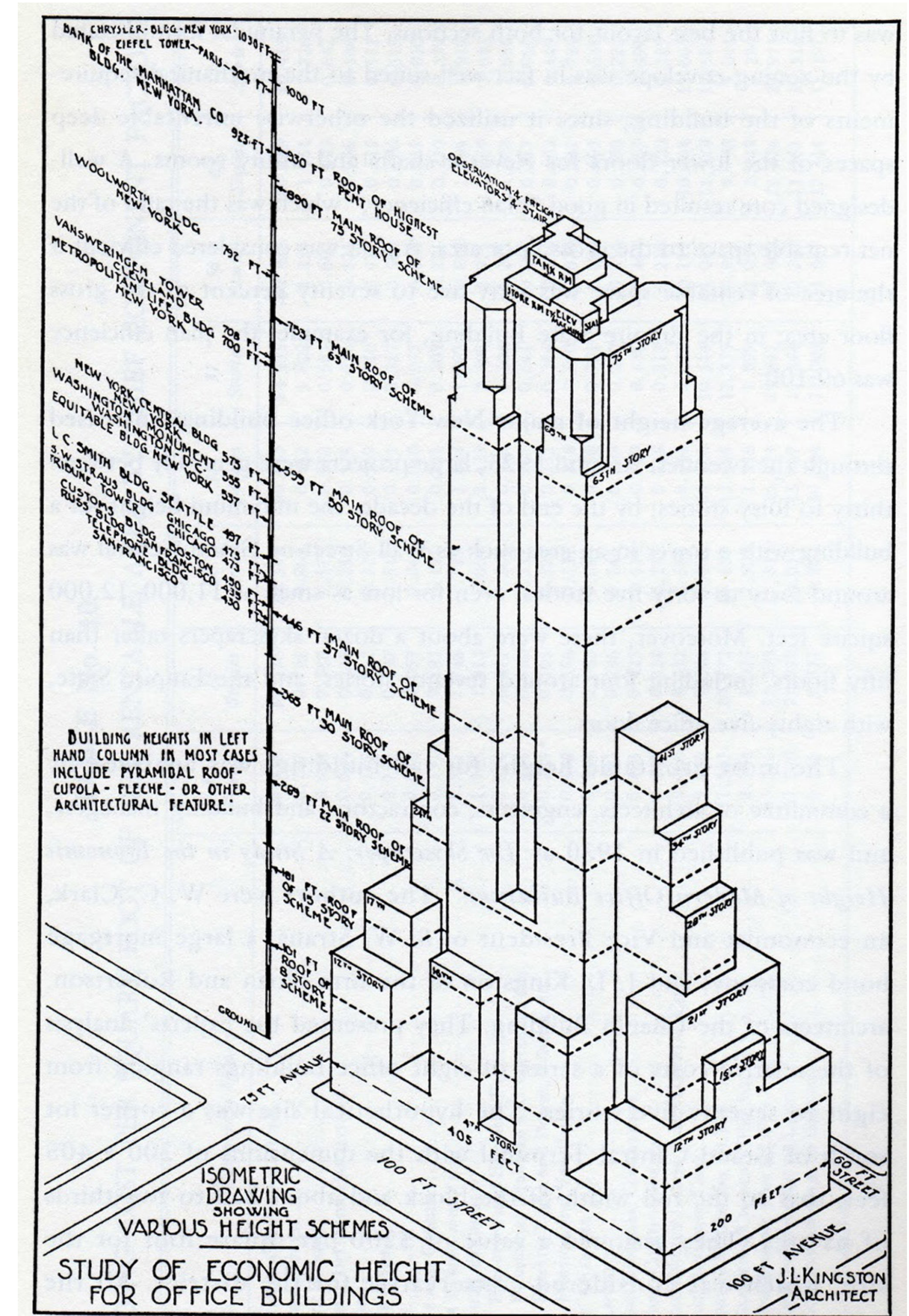

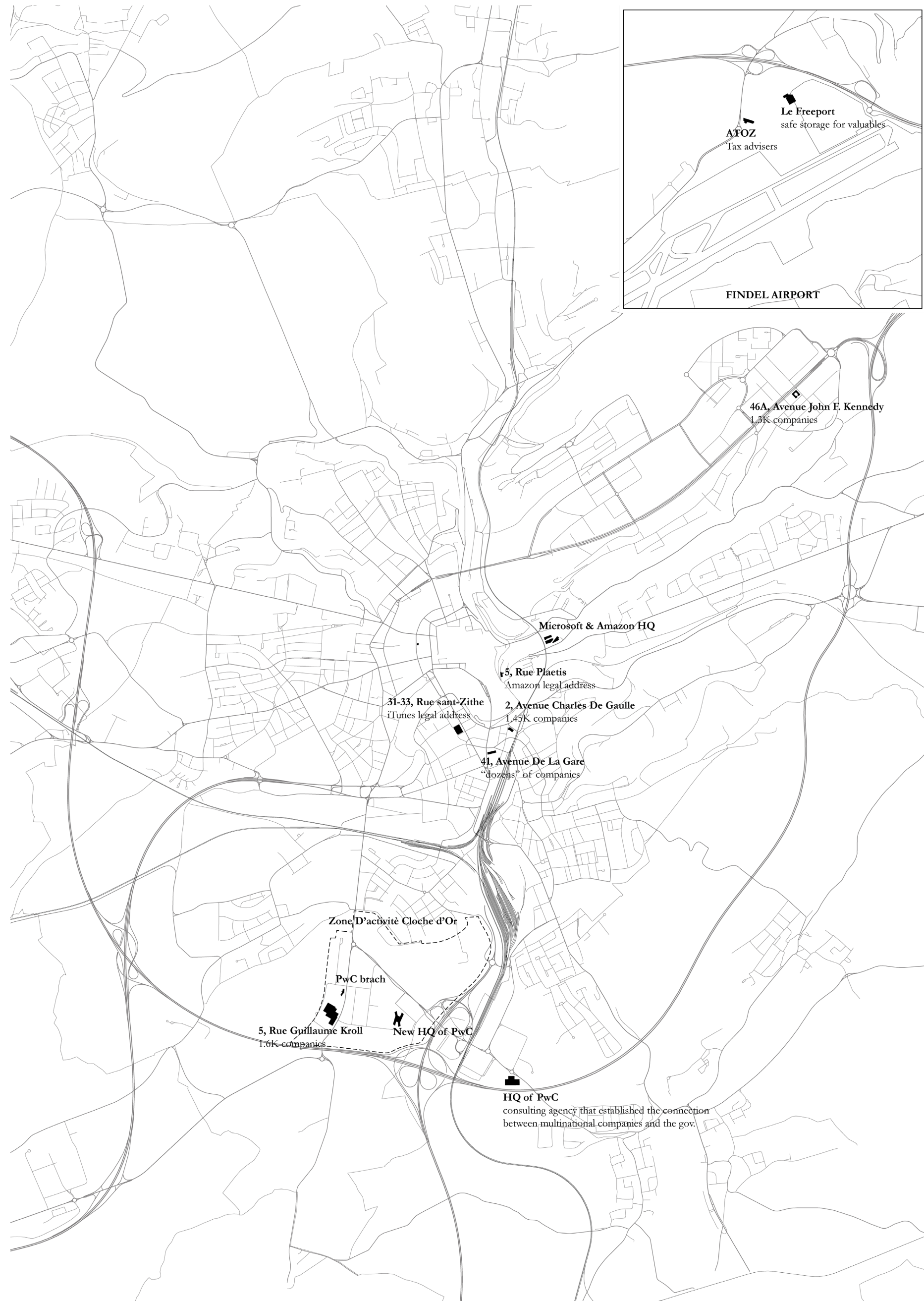



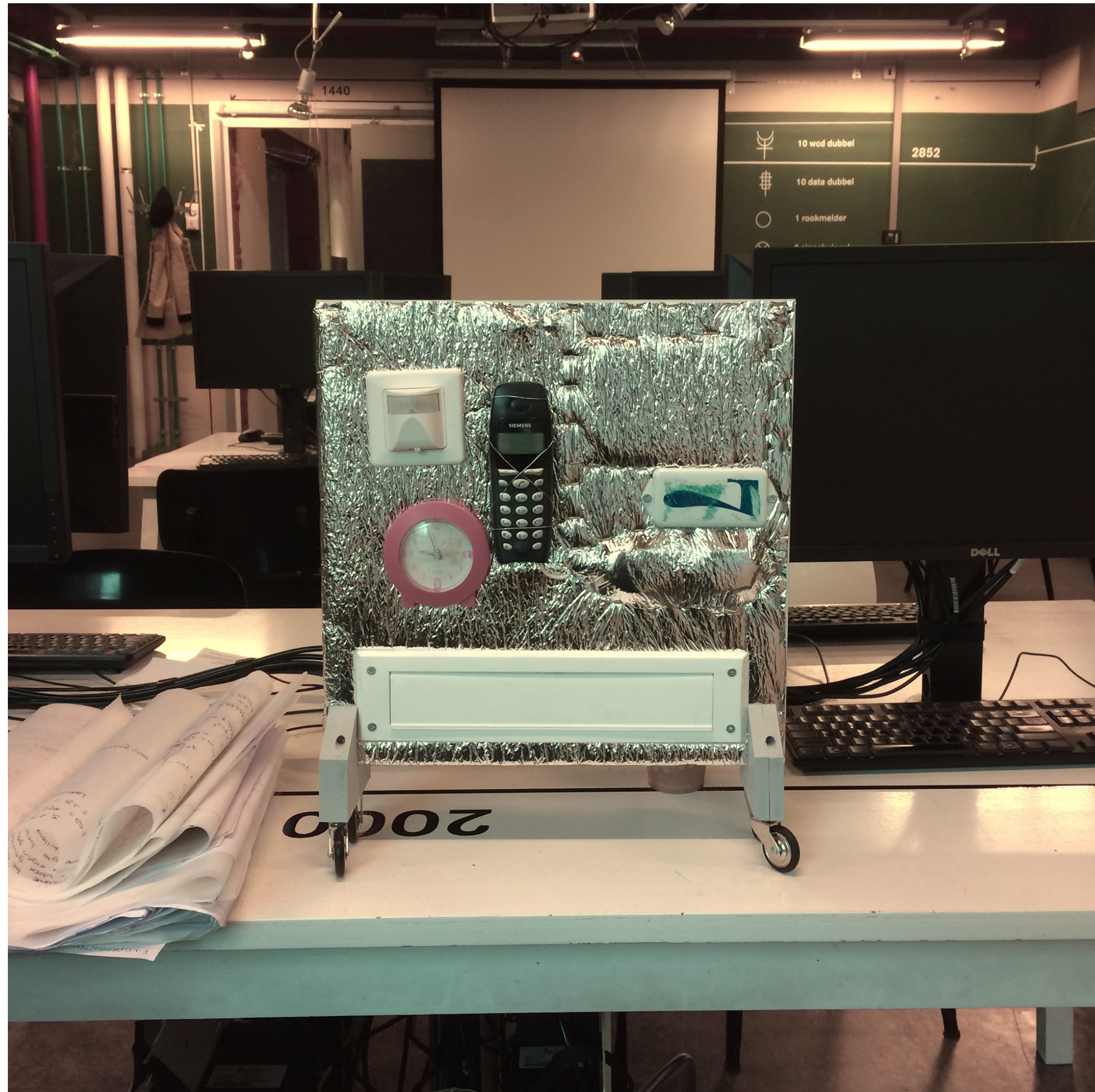

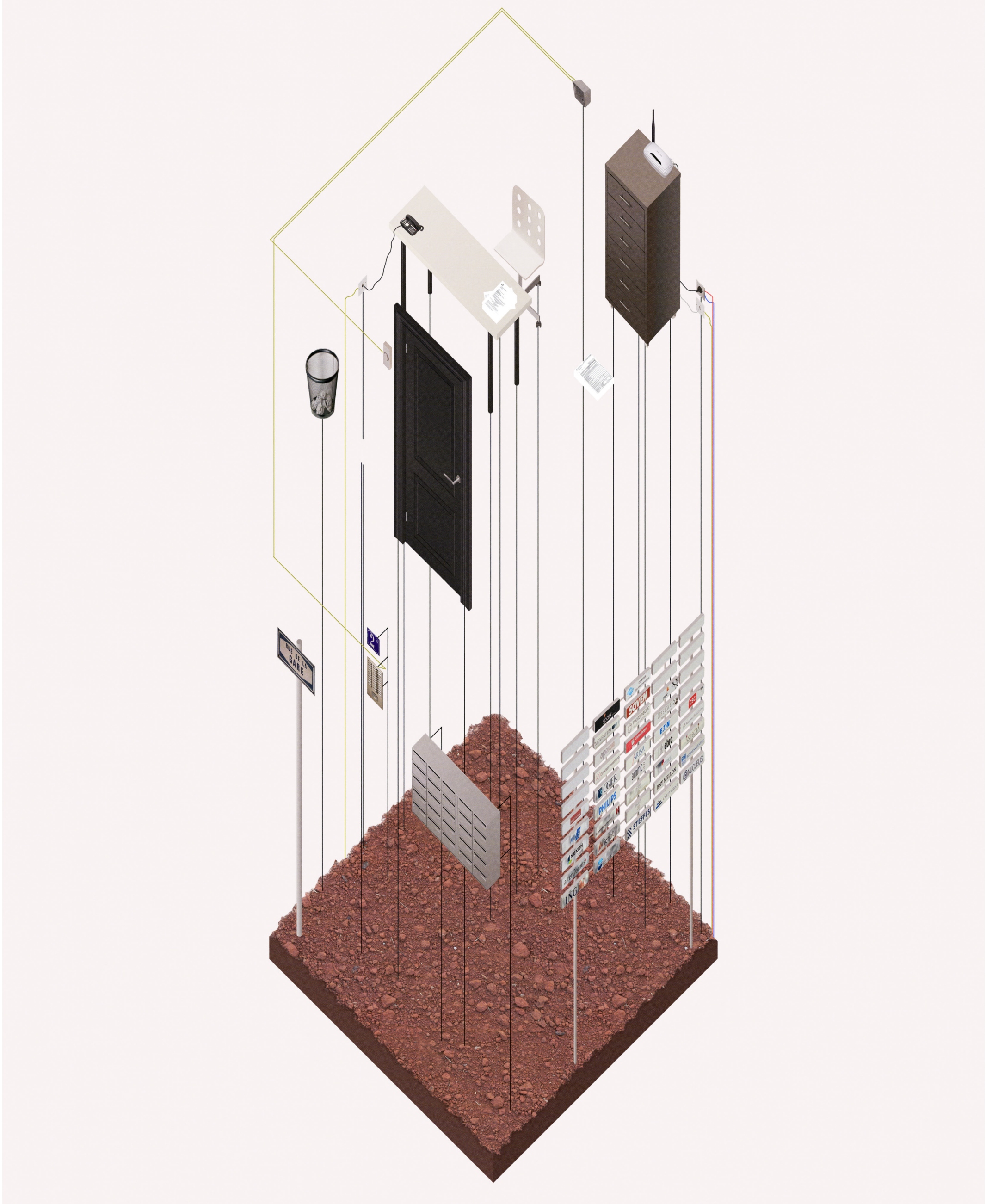



# LUXEMBOURG EN 1894

