

Creating the smart hospital

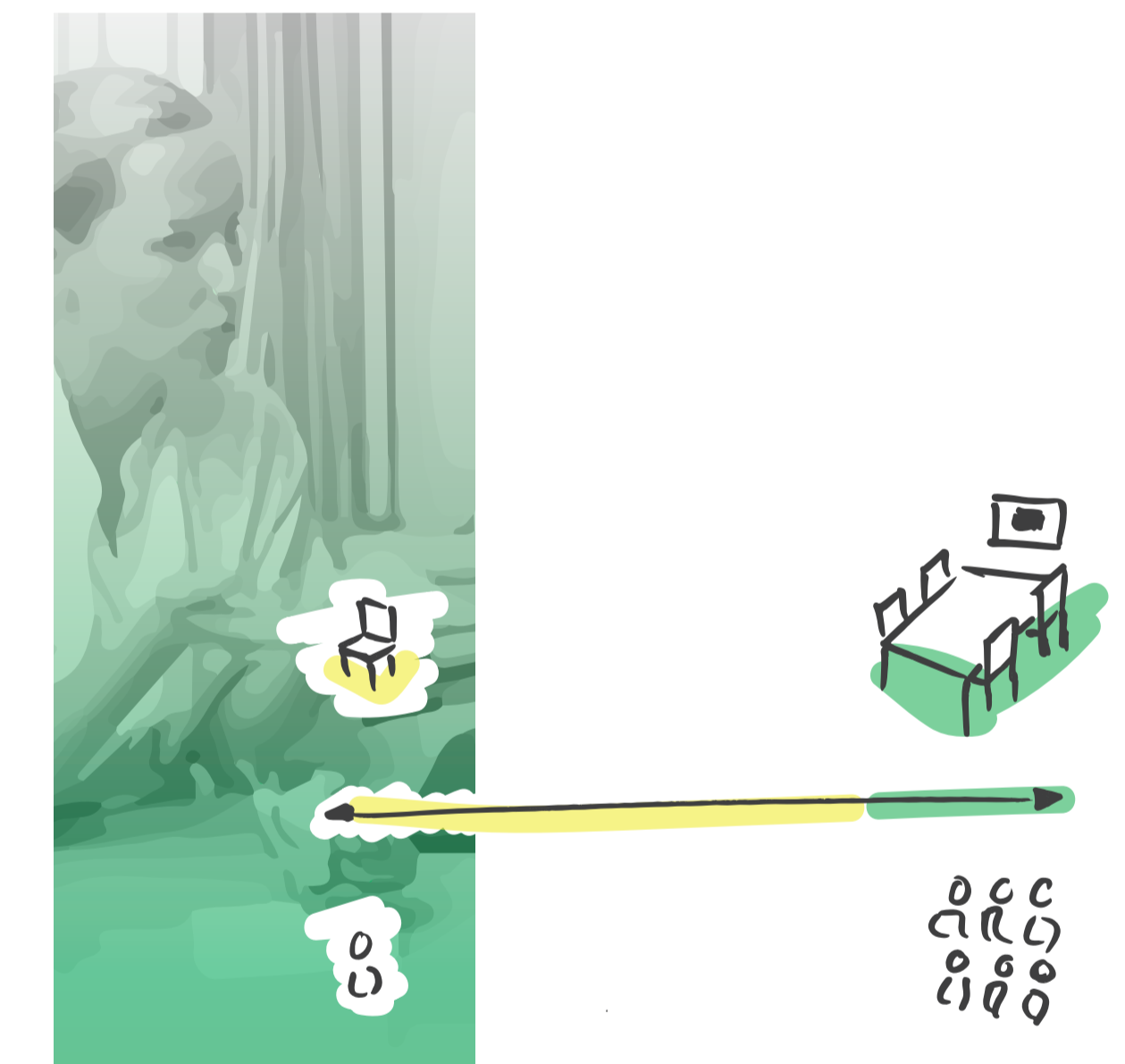
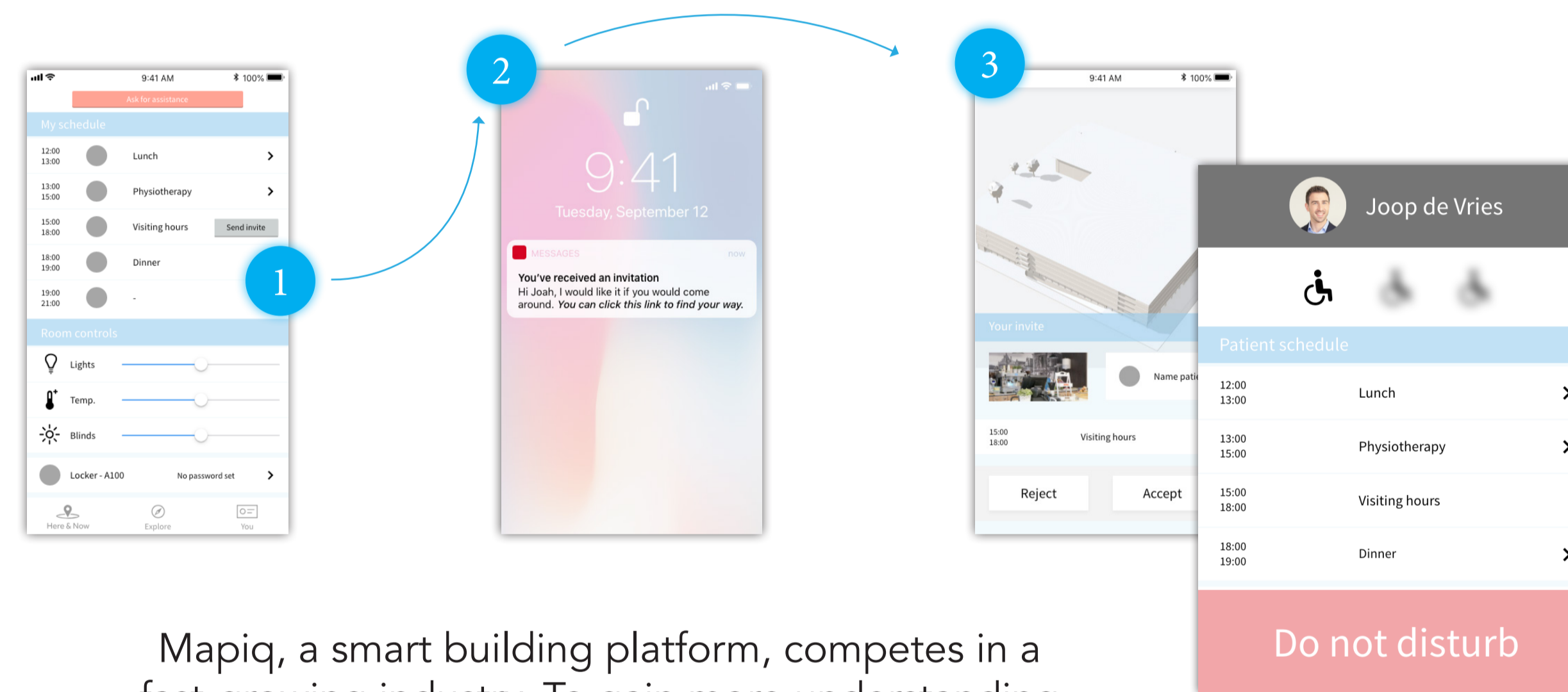

The vision sets out a broad view of what is possible. By simplifying a kiosk screen, patients and visitors can find their way in the hospital with a virtual representation of the building.

Otherwise, the staff of the hospital can control everything surrounding them in the building, making them able to open lockers with the Mapiq Now app and even sharing these with their colleagues by sending just a simple link.

Mapiq, a smart building platform, competes in a fast-growing industry. To gain more understanding of the applicability of Mapiq's product portfolio, the project focused on broad market research.

Mapiq's modular portfolio proved valuable to the hospital market, and a vision was created to show how Mapiq can claim its stake in the market.

In another part of the hospital building, the ward, patients are in need of rest in a hectic environment. Luckily, they can request to do not be disturbed. This immediately highlights the room panel outside their door; indicating to support staff that they should wait with non-urgent matters. If the patient wants to let their family know where they are, they can share his or her location with a link to the Mapiq portal.

There are many more features, for those contact me!

Geert J.G. Nysingh
Shaping future growth:
A market development strategy
13th of July, 2018
Strategic Product Design

Committee C.A.P.M. Bergema
A.Q. Beekman

Company B.O. de Planque