

'The Public Fibre'

The entering of Culturalfication within the Public Realm

Change of multicultural behaviour in the public realm of the city of Rotterdam

THIS PHENOMENON OF MORE AND MORE CULTURES INSIDE A DENSE SOCIETY IS WHAT I LIKE TO CALL

'CULTURALFICATION'

What impact has this 'culturalfication' on the public realm of the city?

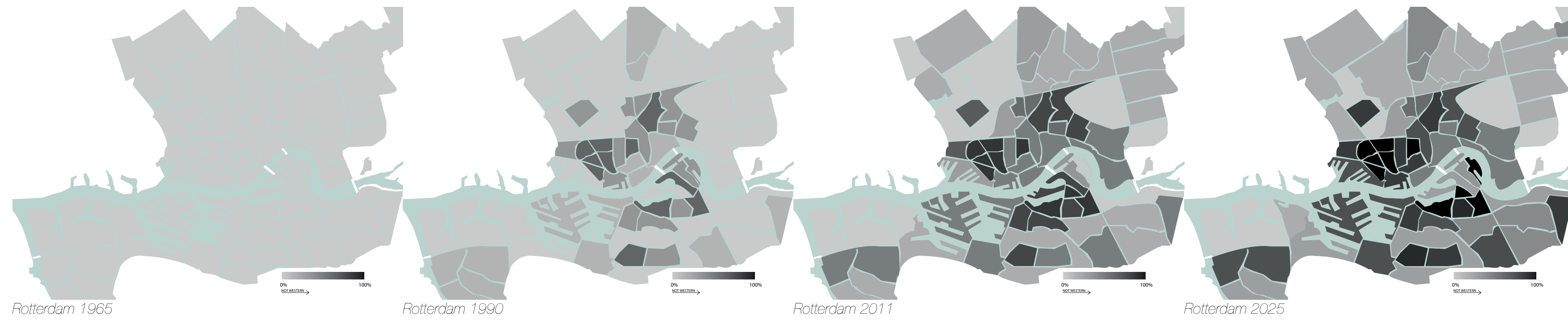

Functions according to use of the 4 most dominant cultures

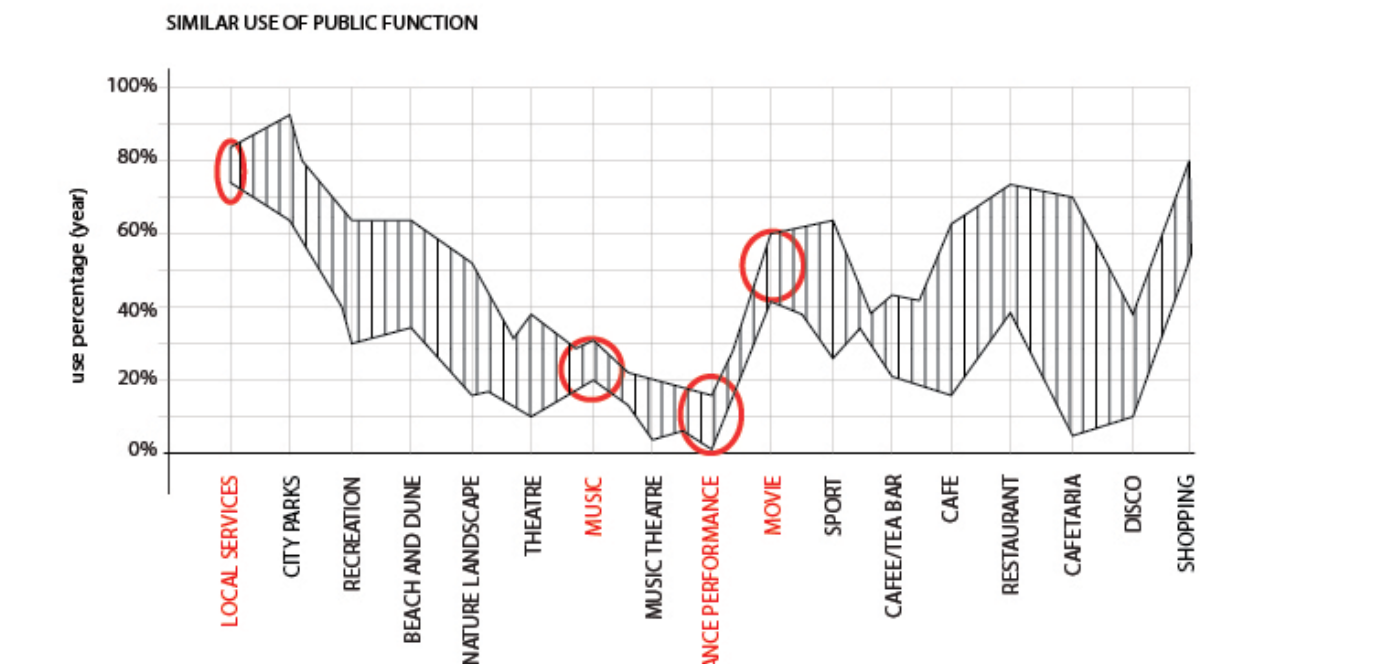
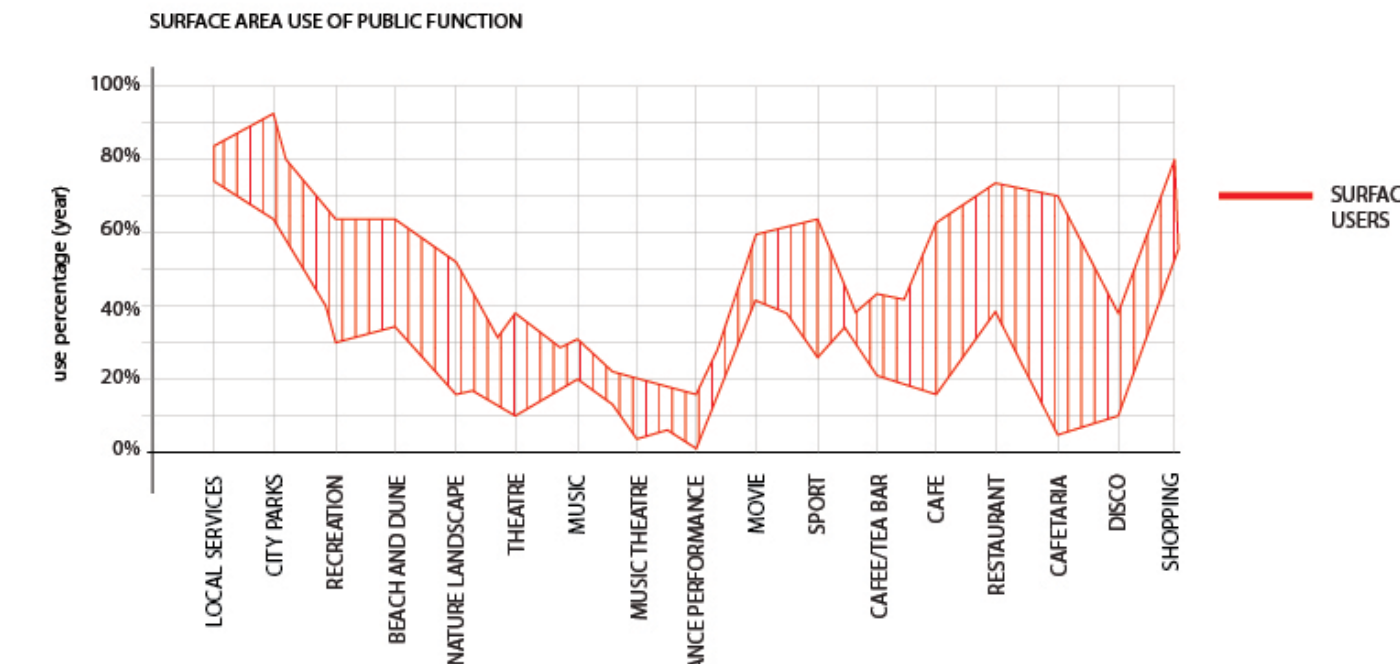
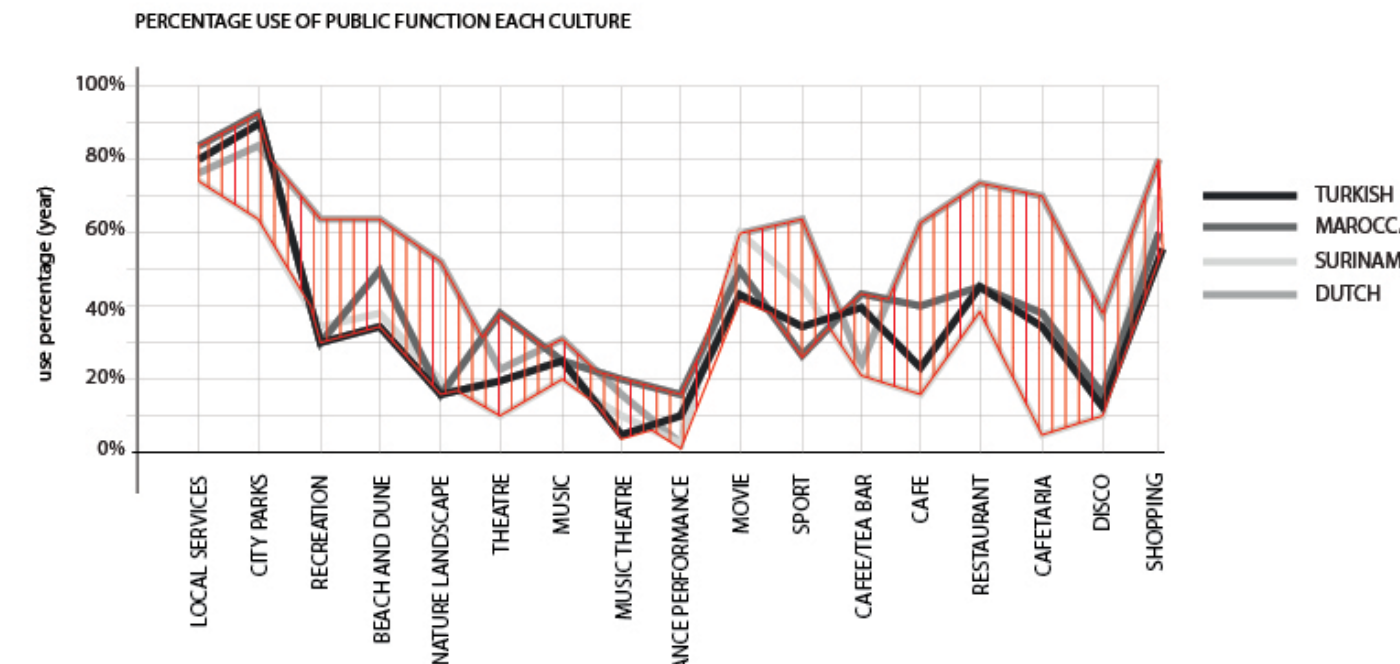
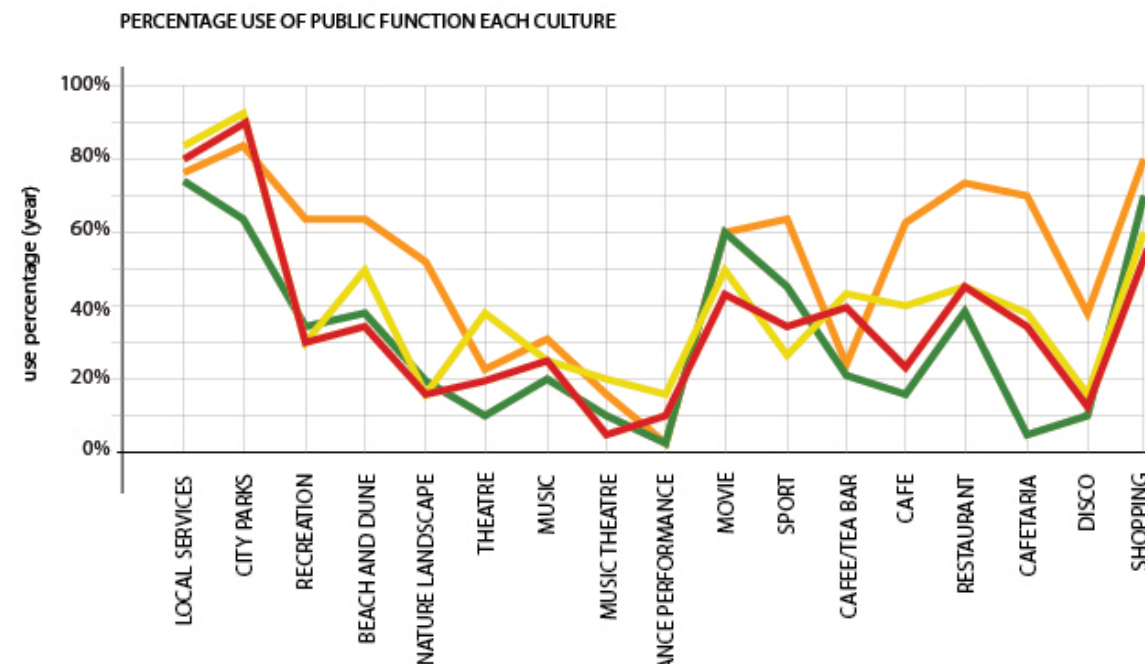

Urban Scene which makes use of the existing functions

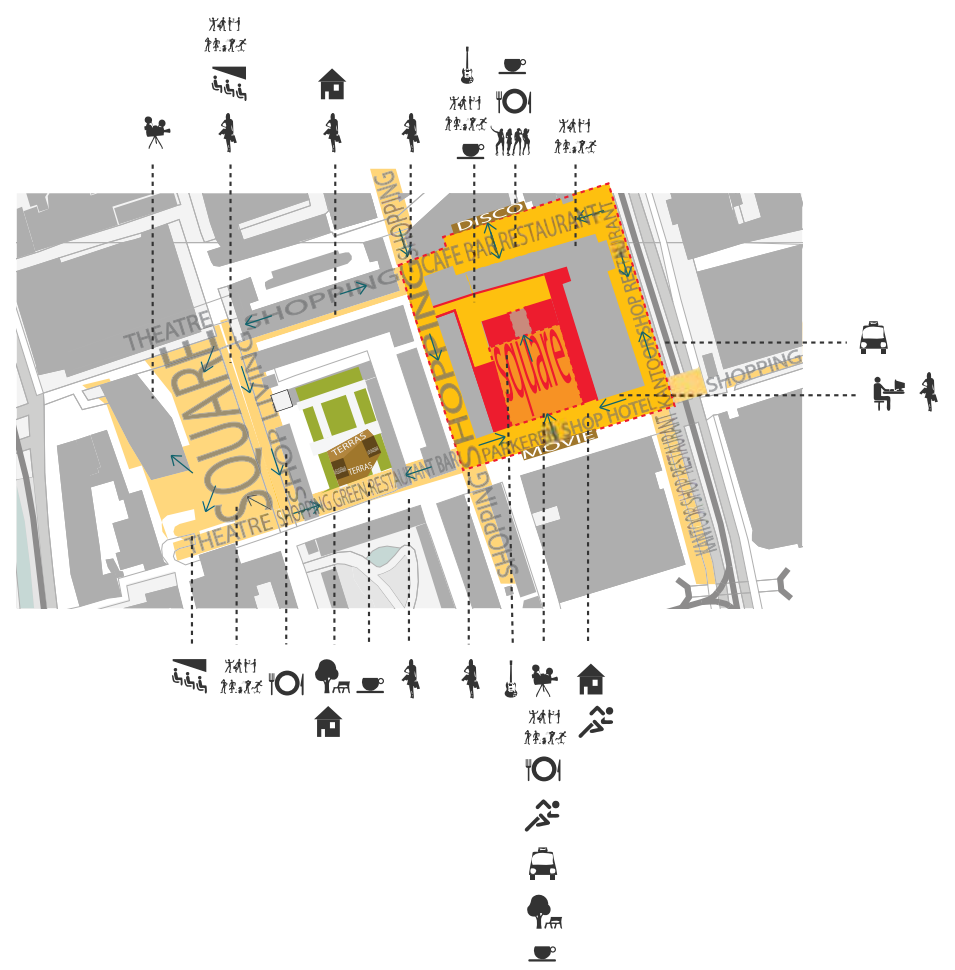

The Masterplan creates a 'Cultural Square' which provides a cultural stage!

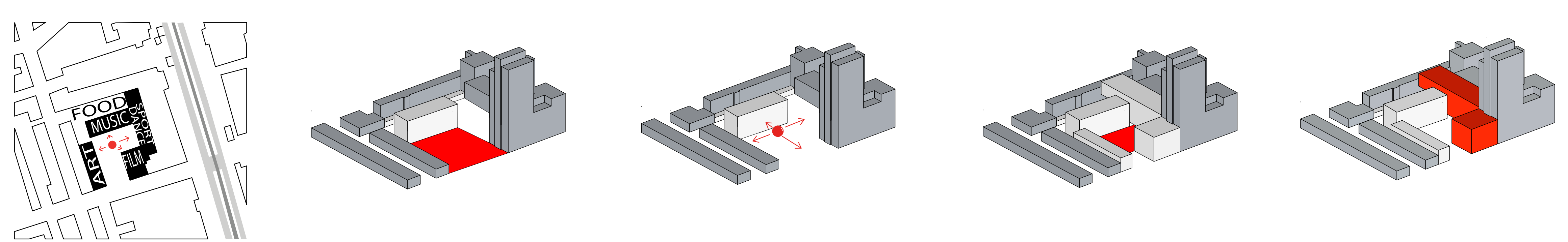

Early designsketches

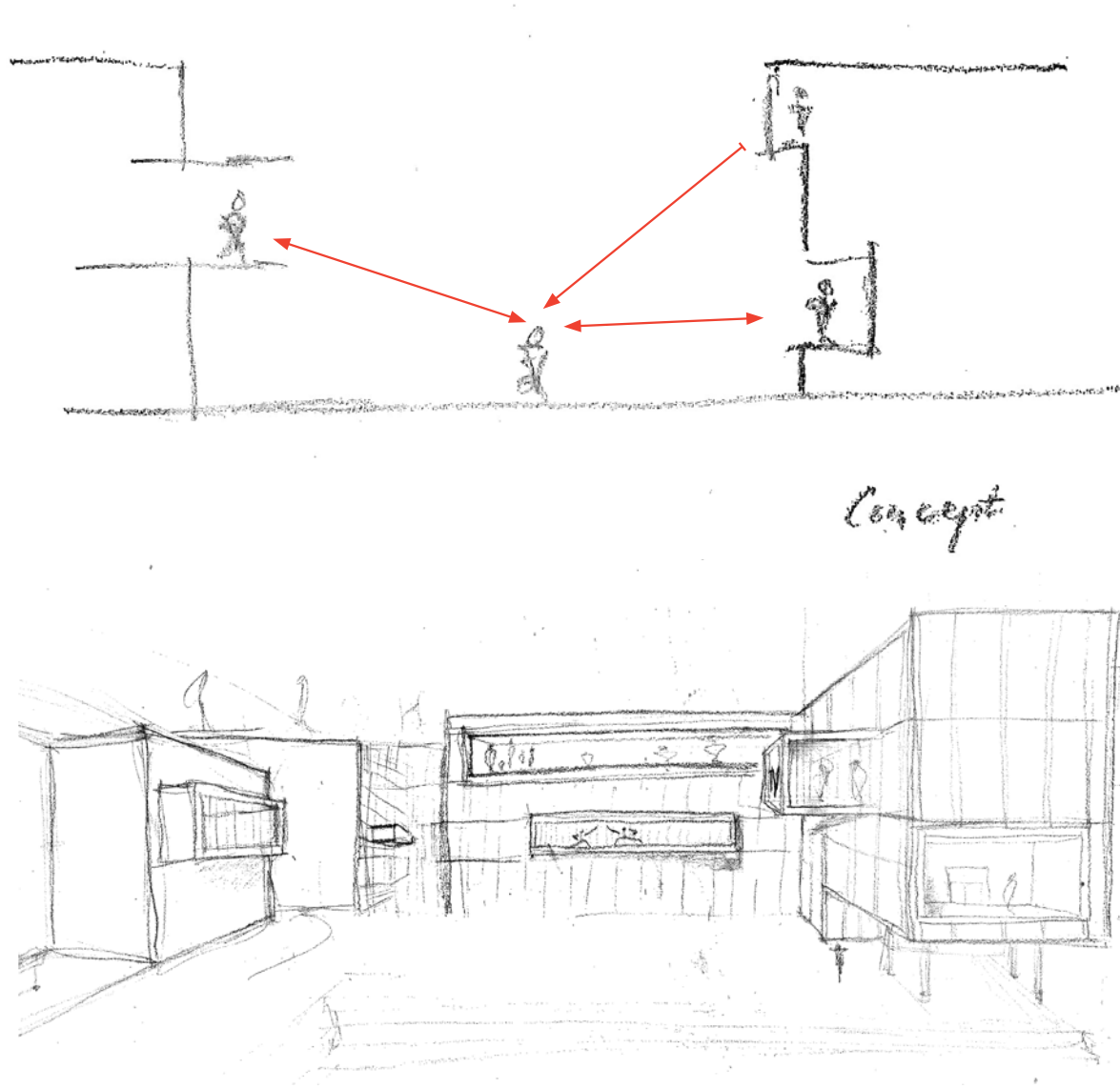

Program

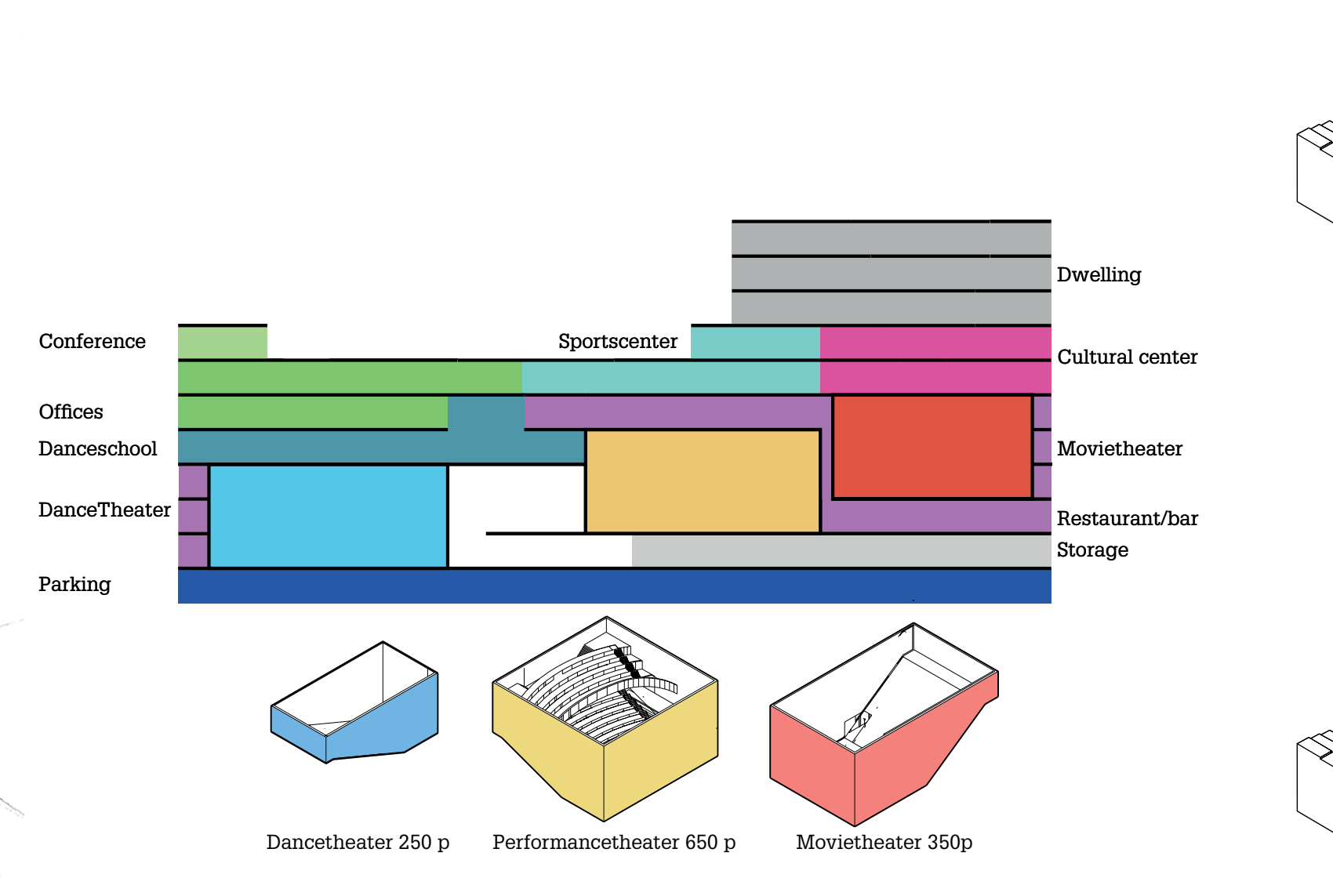

Program Generated

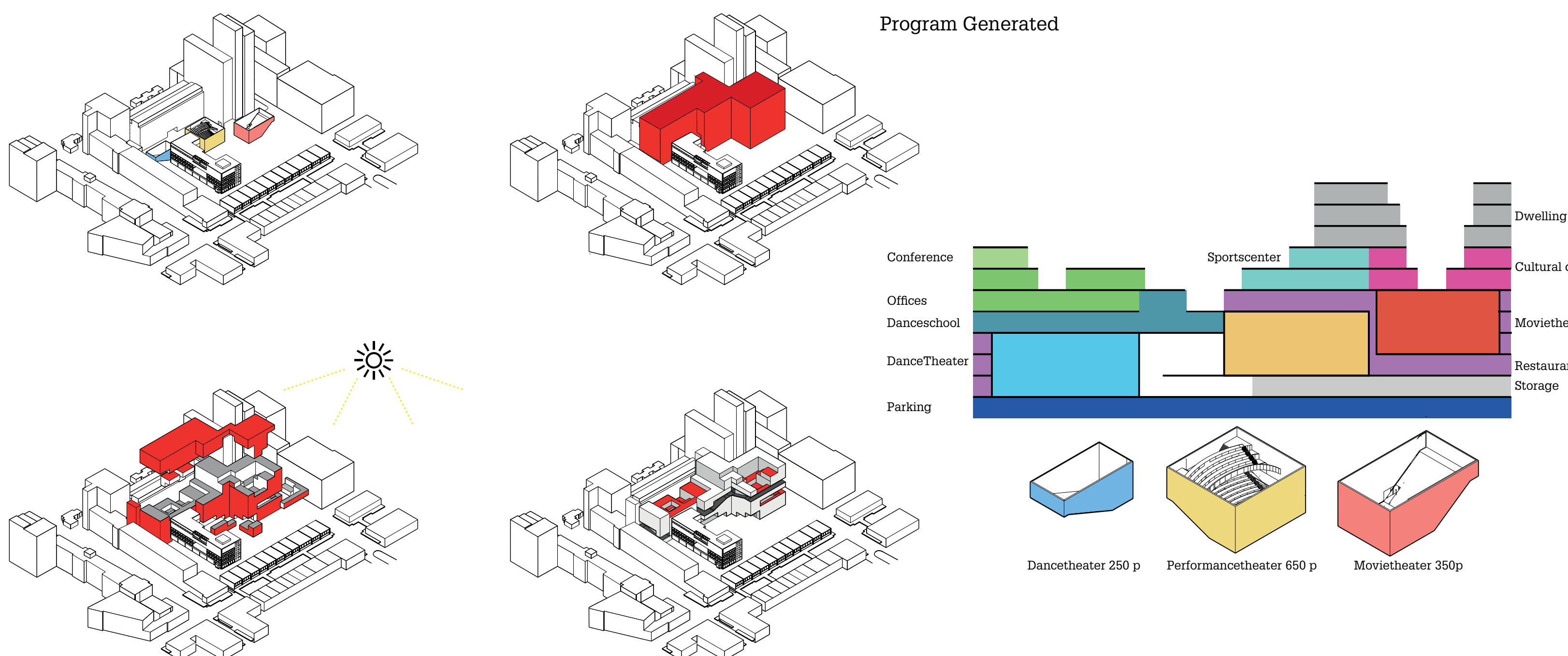

Maquette photo's

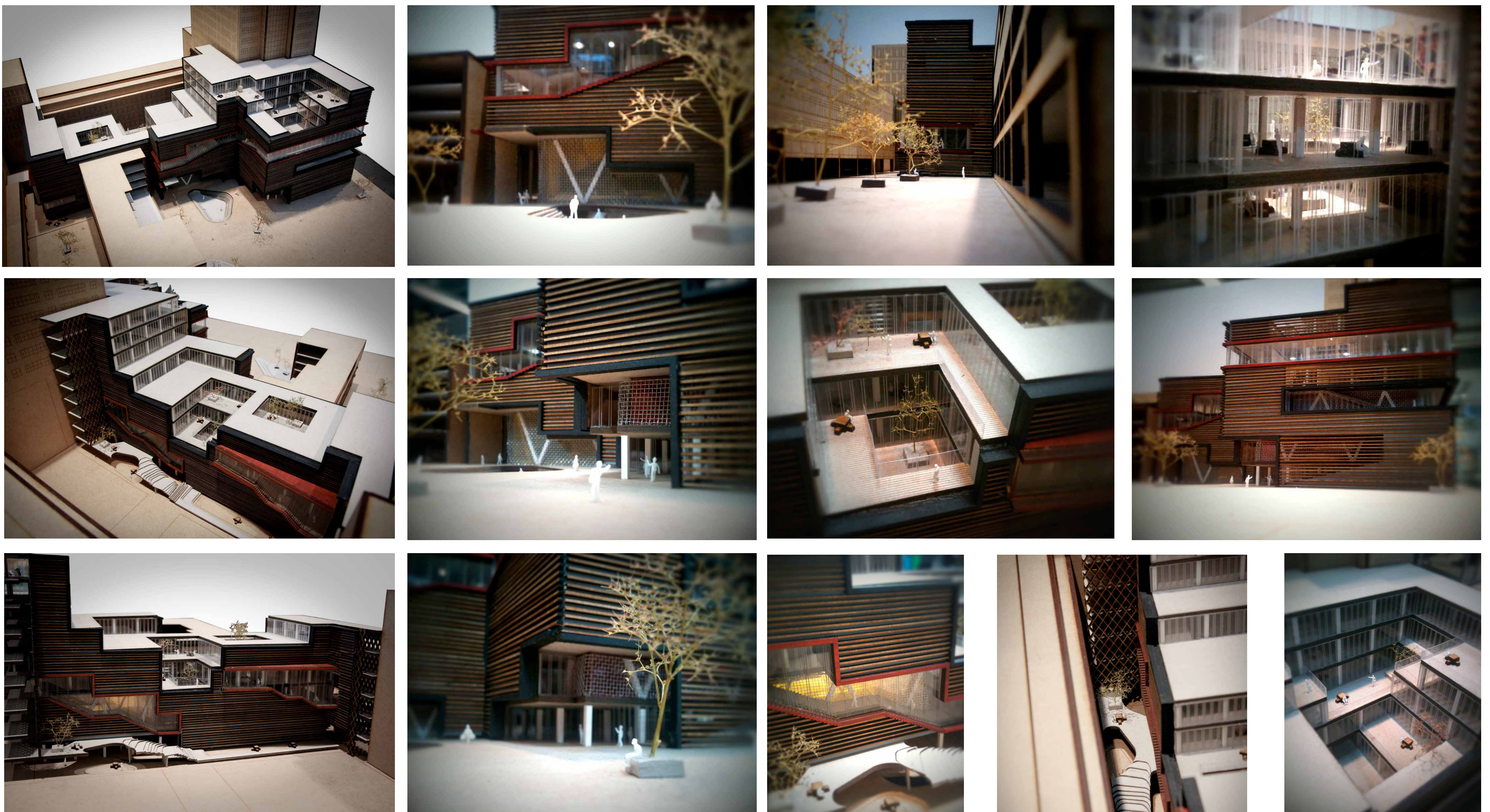

Sustainability

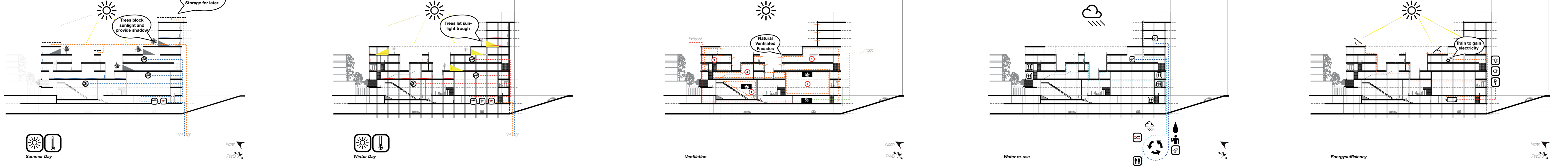

Construction Principle

