

DRAWING SET

FLUSSO E PROFITTO

Speed and Profit

Stefan Vuijst

June/9/2026

1:1000
SITE



45°27'34.7"N 9°16'45.6"E

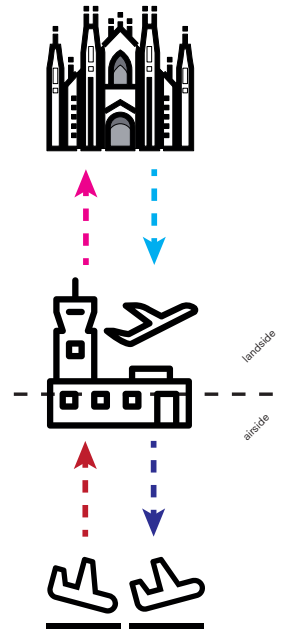

AXONOMETRIC VIEW

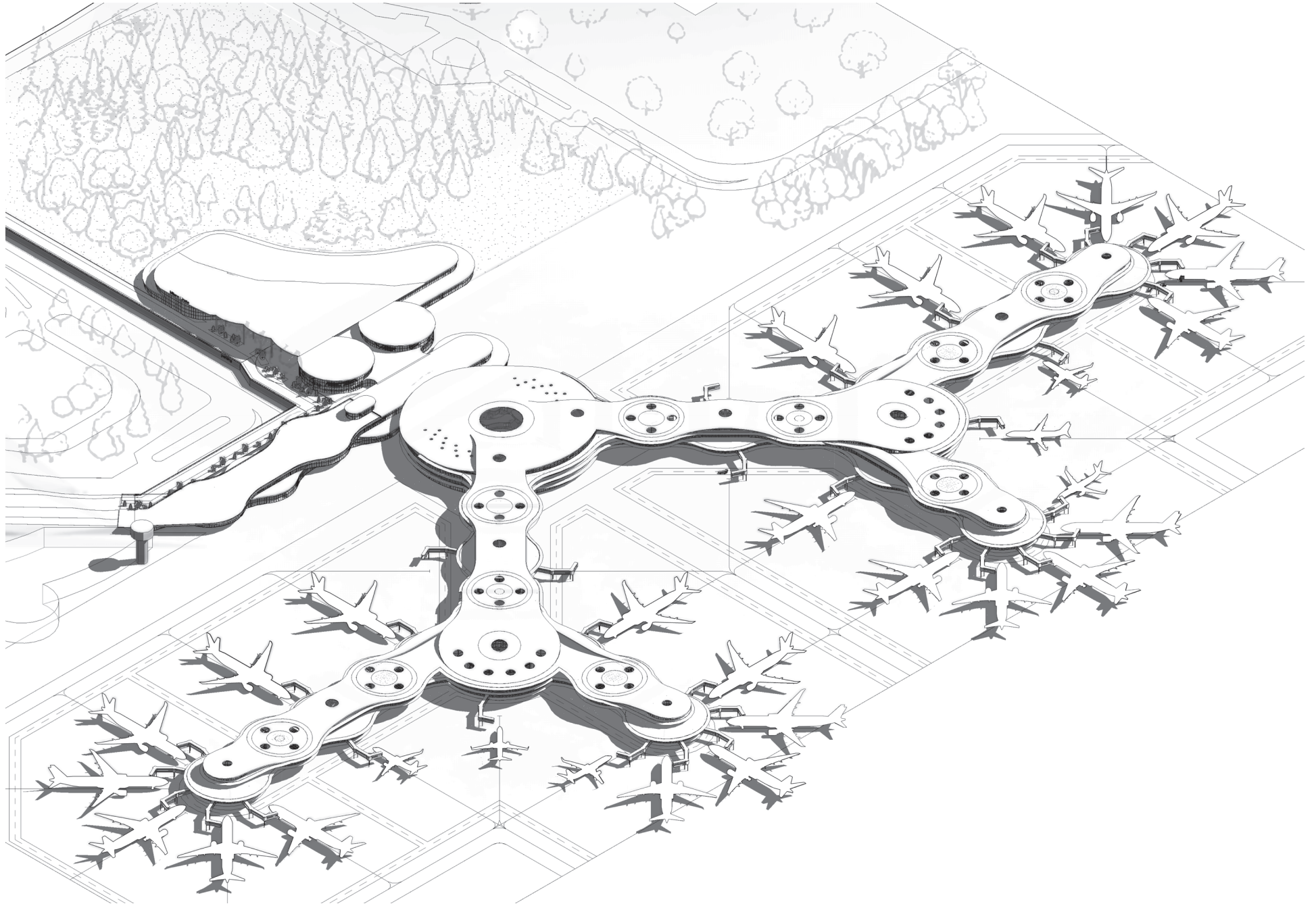

COMPONENTS

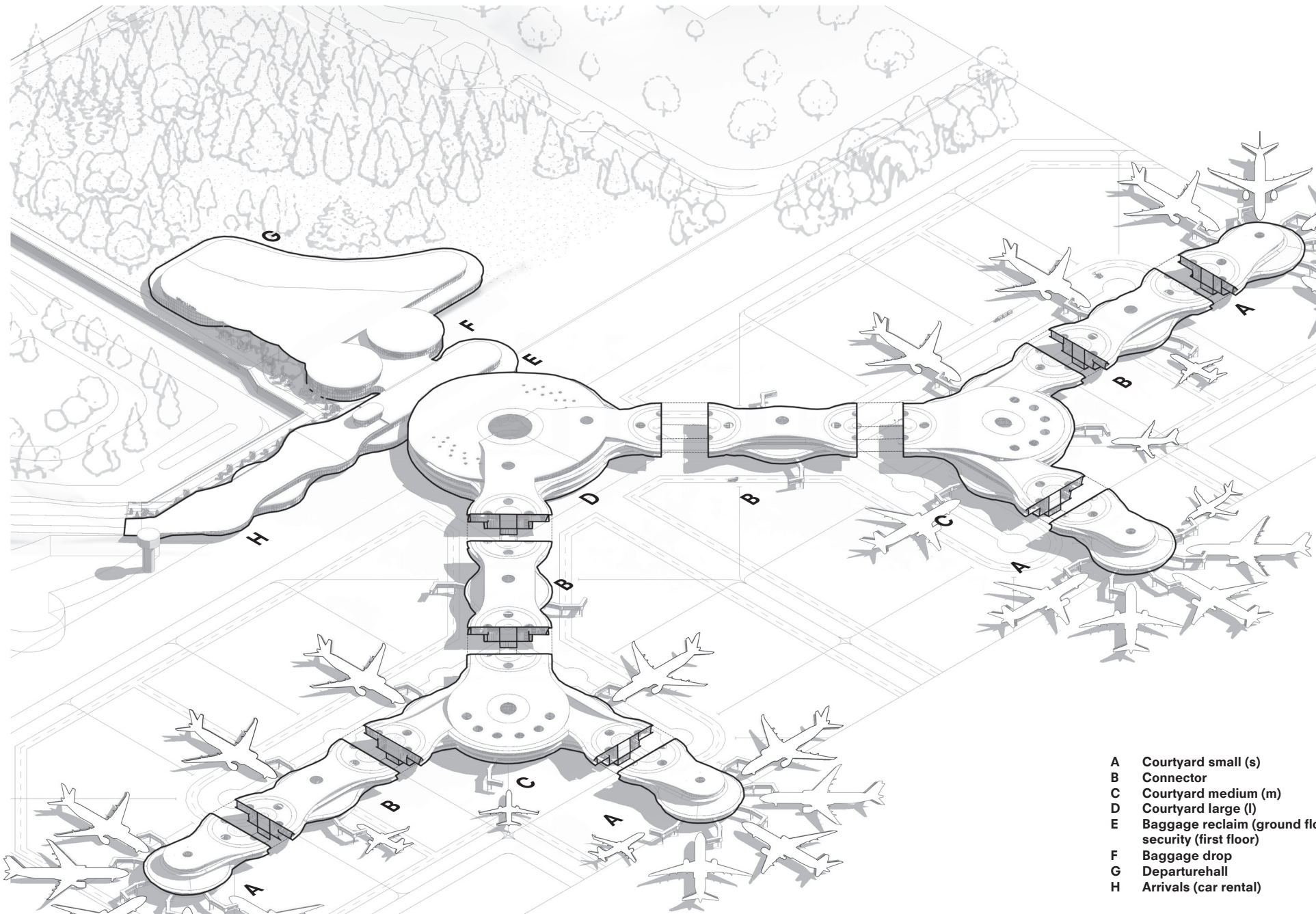

- A Courtyard small (s)
- B Connector
- C Courtyard medium (m)
- D Courtyard large (l)
- E Baggage reclaim (ground floor)
security (first floor)
- F Baggage drop
- G Departurehall
- H Arrivals (car rental)

1:200

FLOOR PLANS

GROUND FLOOR

ARRIVALS

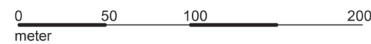
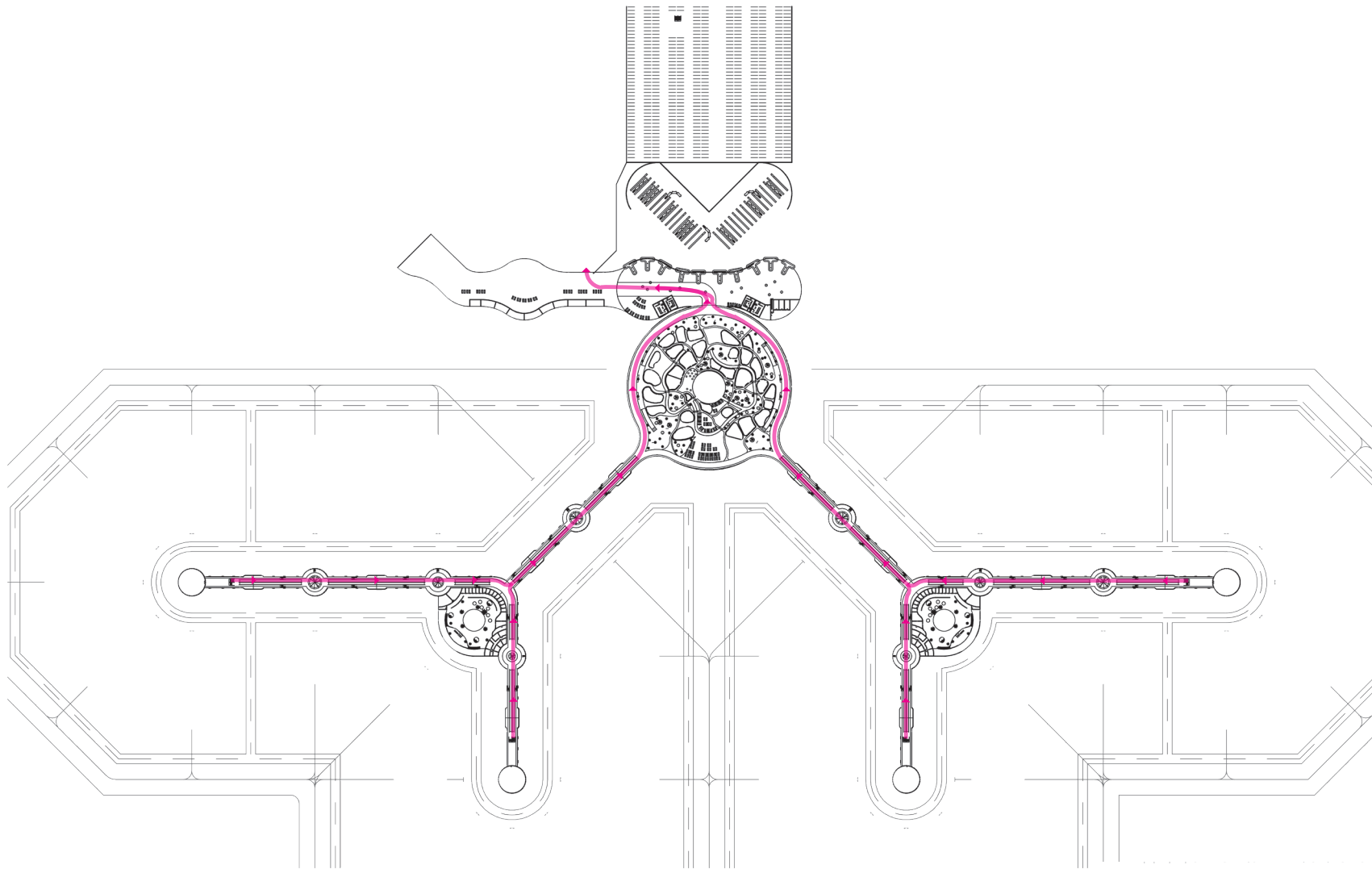

1:200

FLOOR PLANS

FIRST FLOOR

DEPARTURES

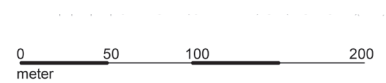
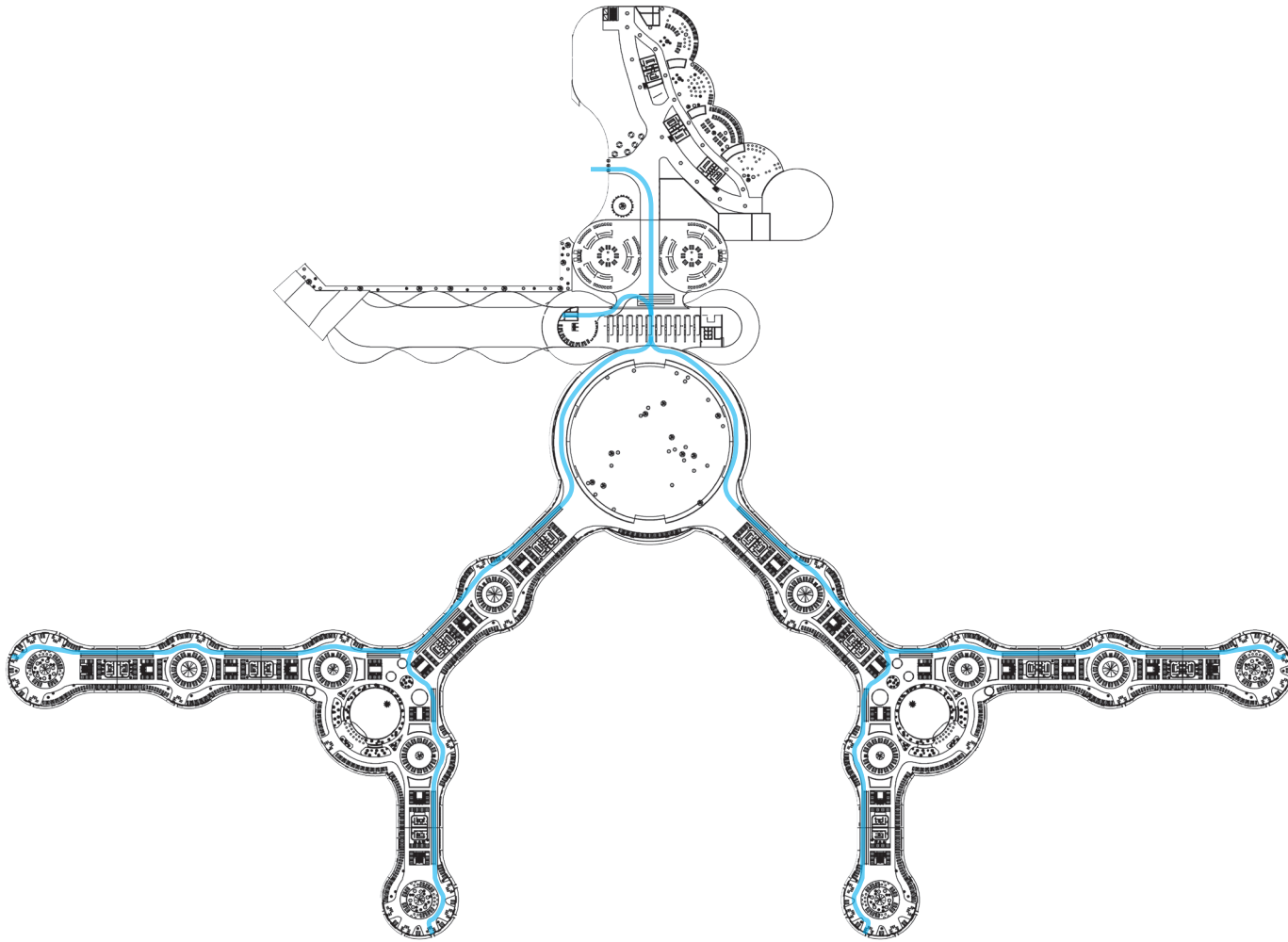

— FLOW DEPARTURES

DO_010

1:200

FLOOR PLANS

SECOND FLOOR

F&B

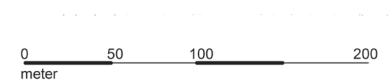
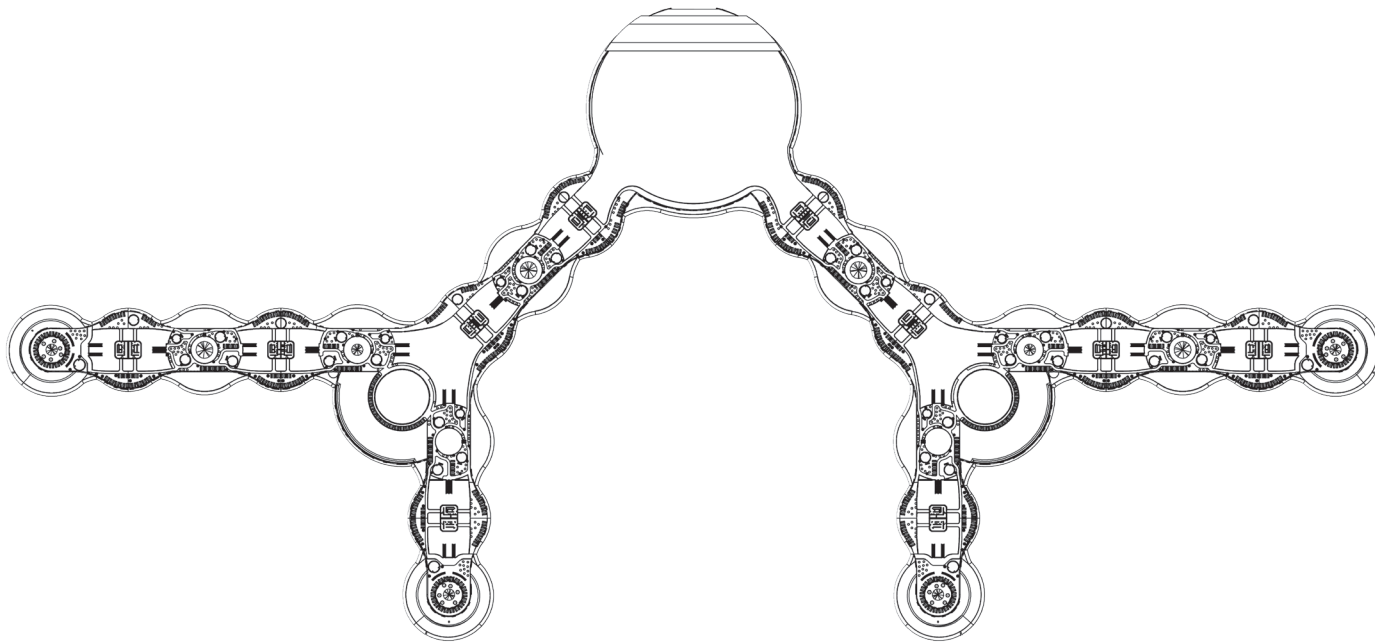
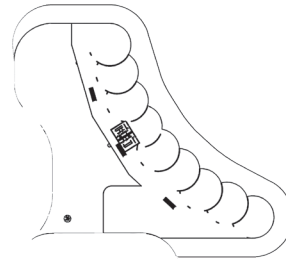

COURTYARD SMALL

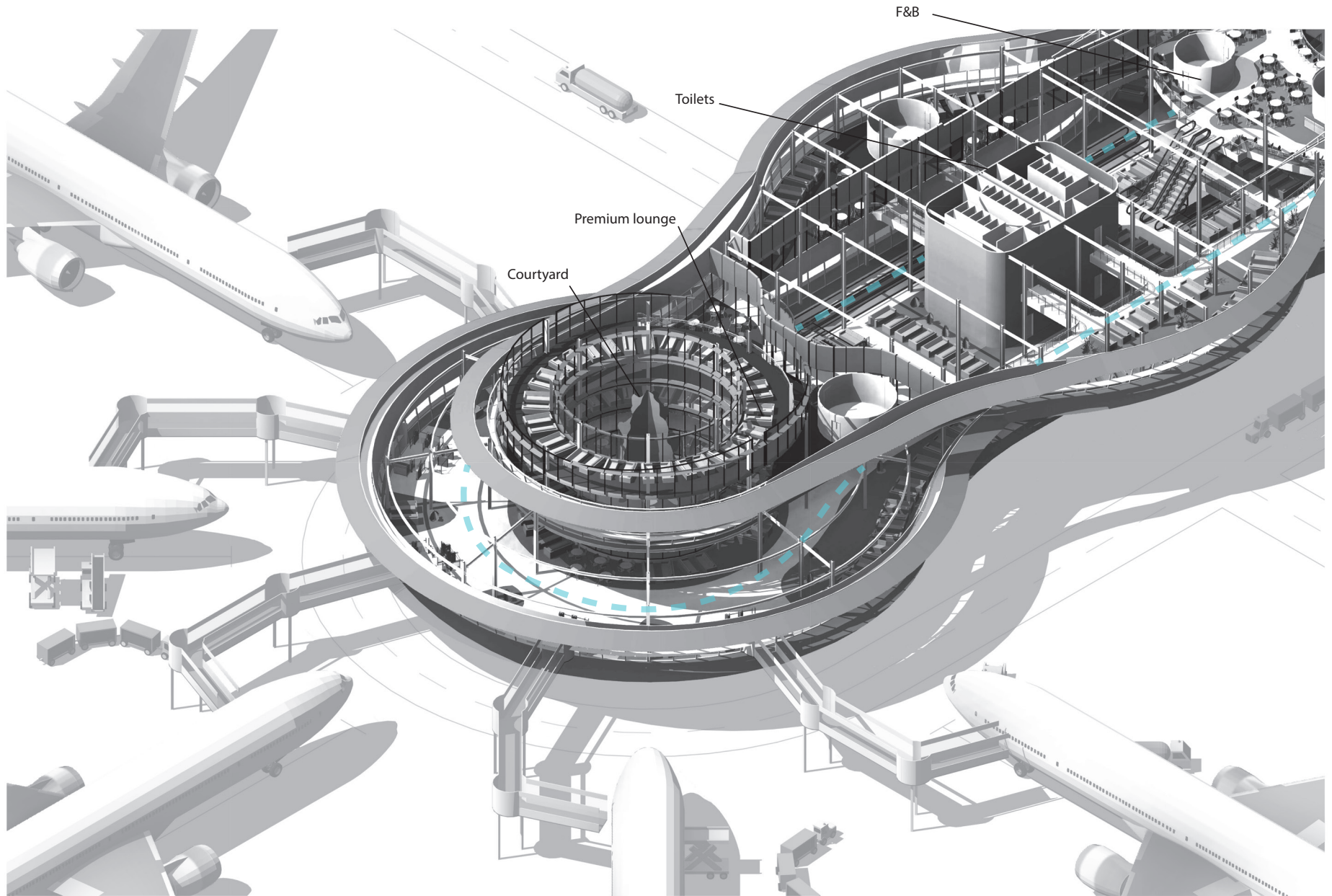

FLOOR PLANS

01 FIRST FLOOR

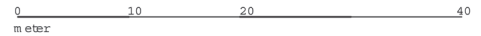
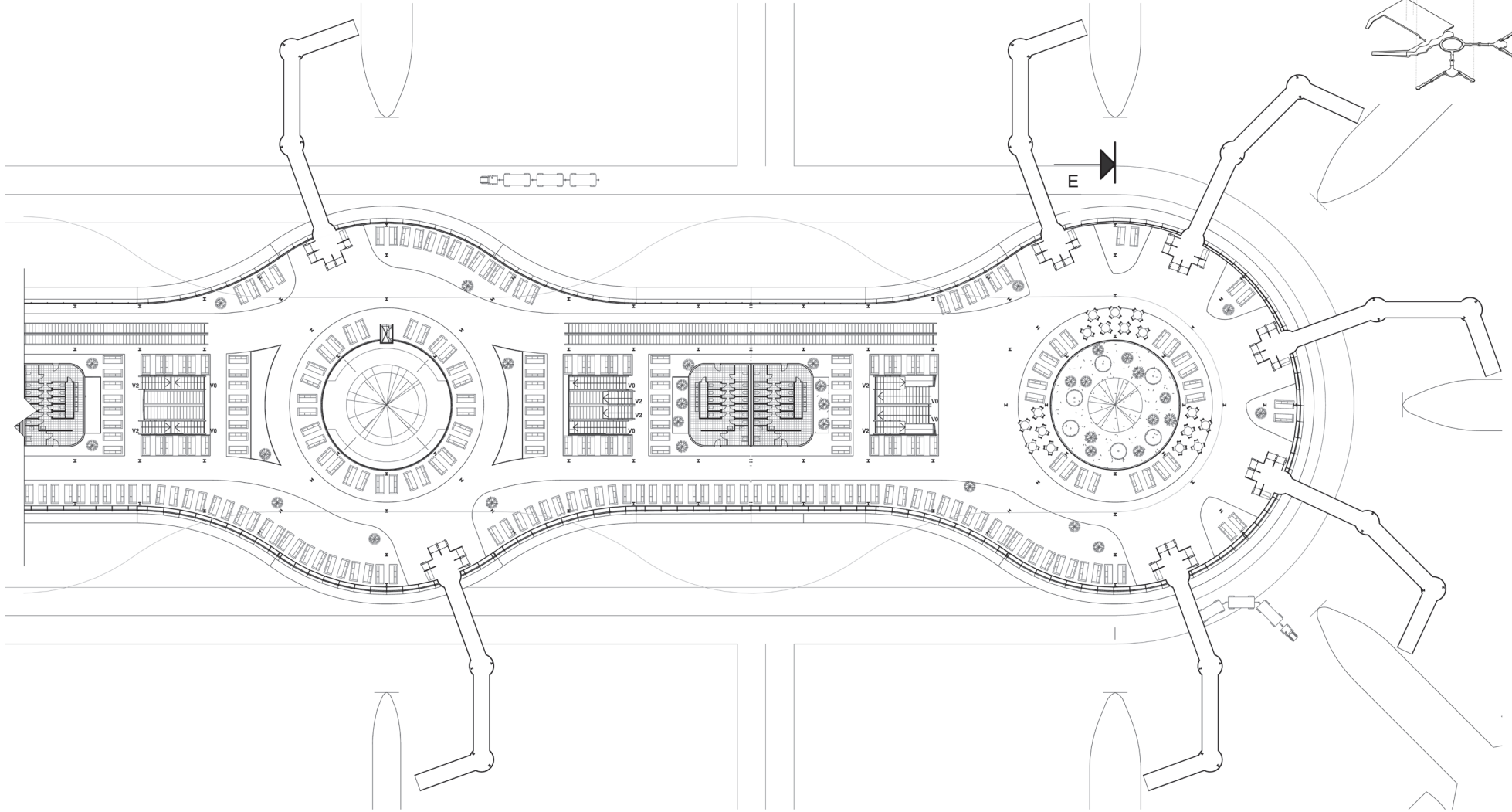
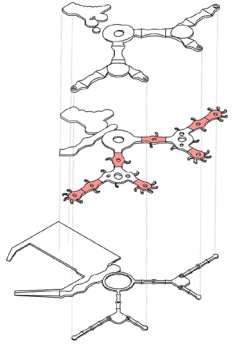

FLOOR PLANS

02 SECOND FLOOR

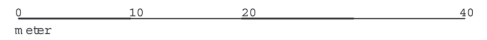
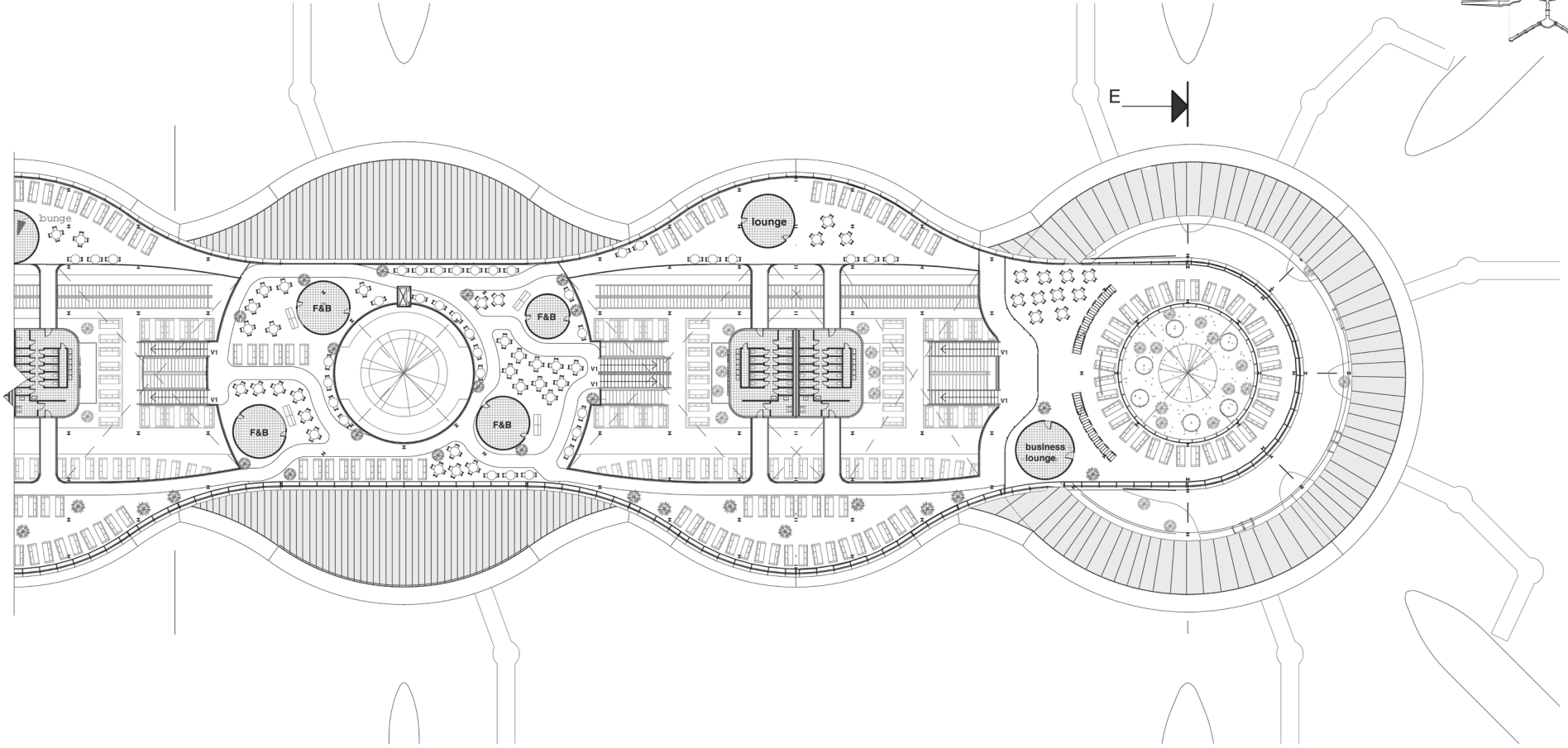
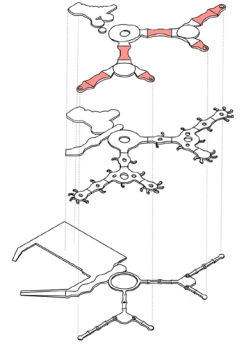

COURTYARD MEDIUM

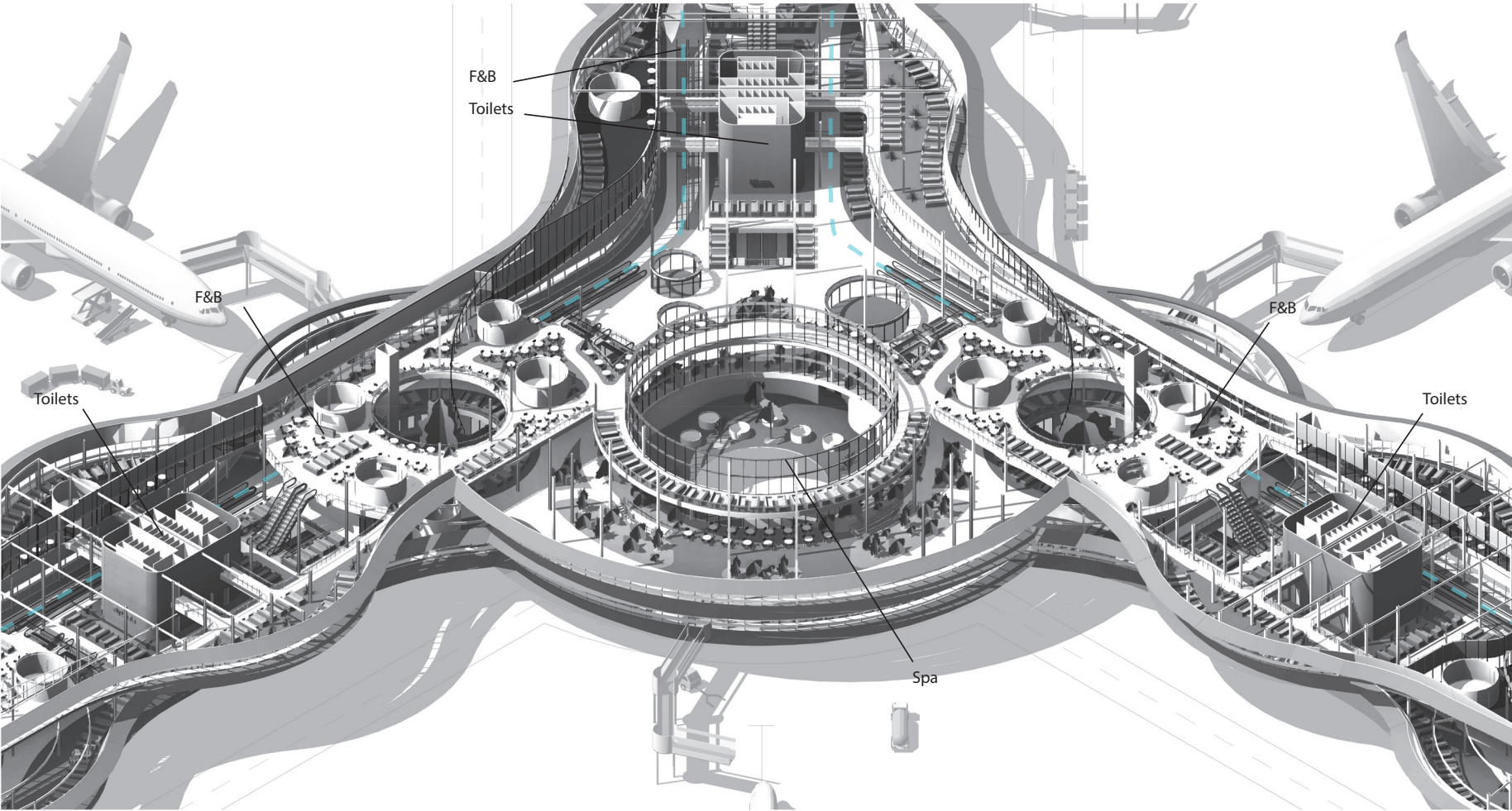

FLOOR PLANS

01 FIRST FLOOR

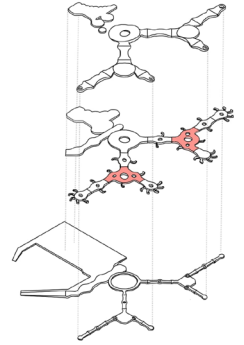
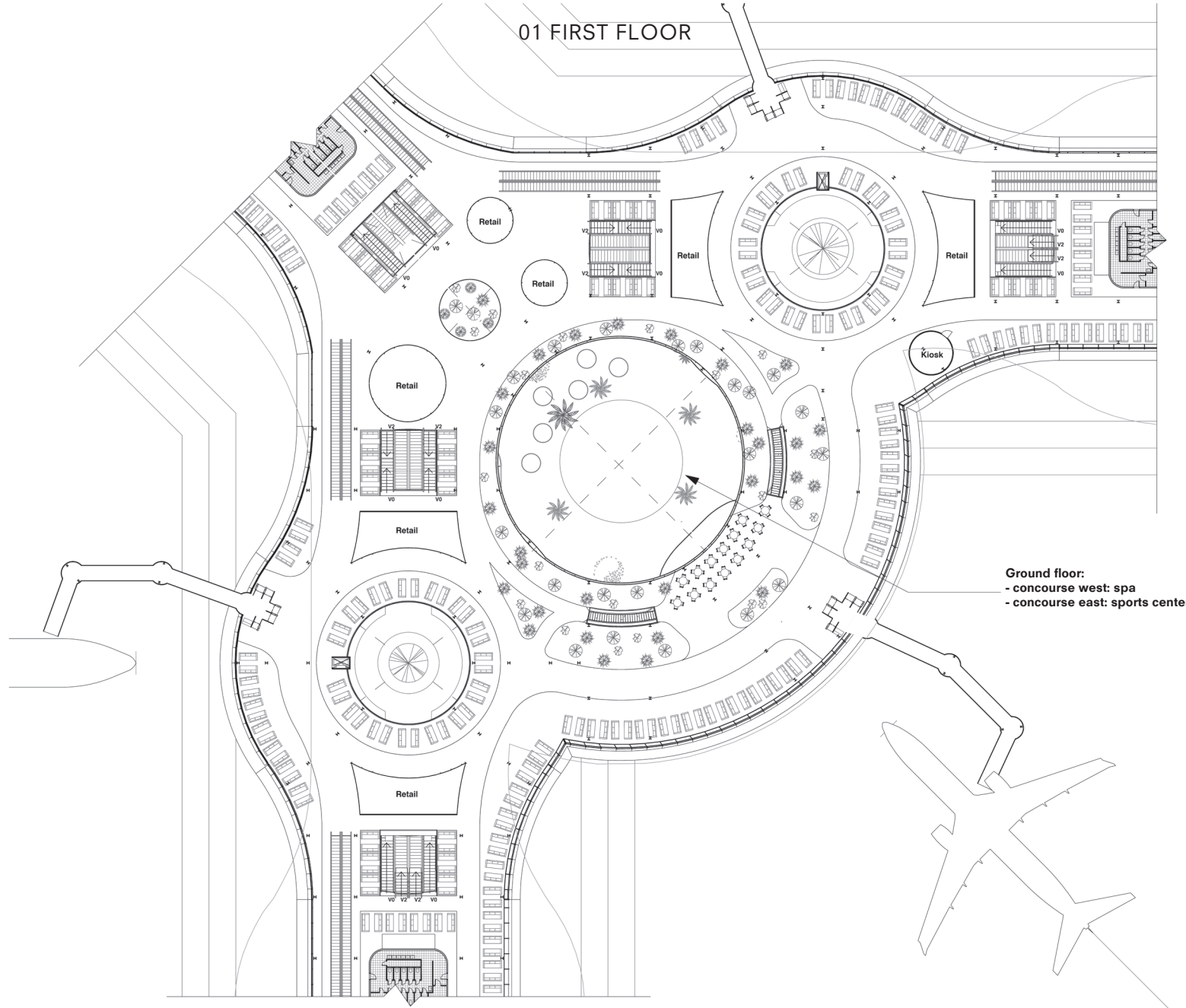

Ground floor:
- concourse west: spa
- concourse east: sports center

FLOOR PLANS

02 SECOND FLOOR

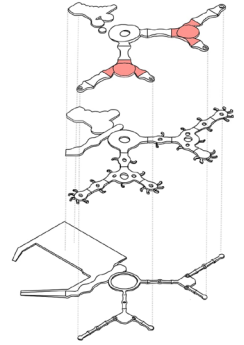
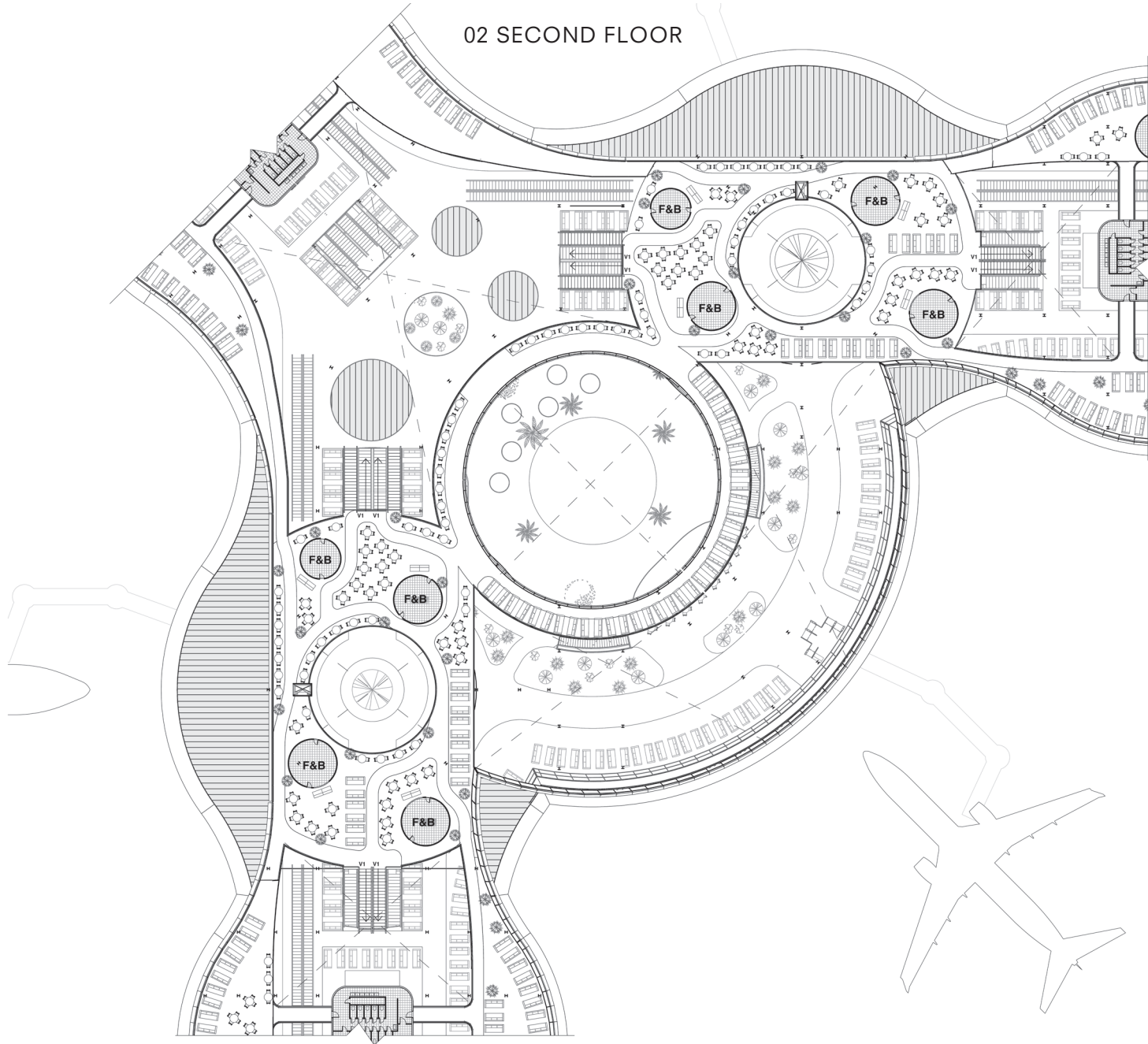

COURTYARD LARGE

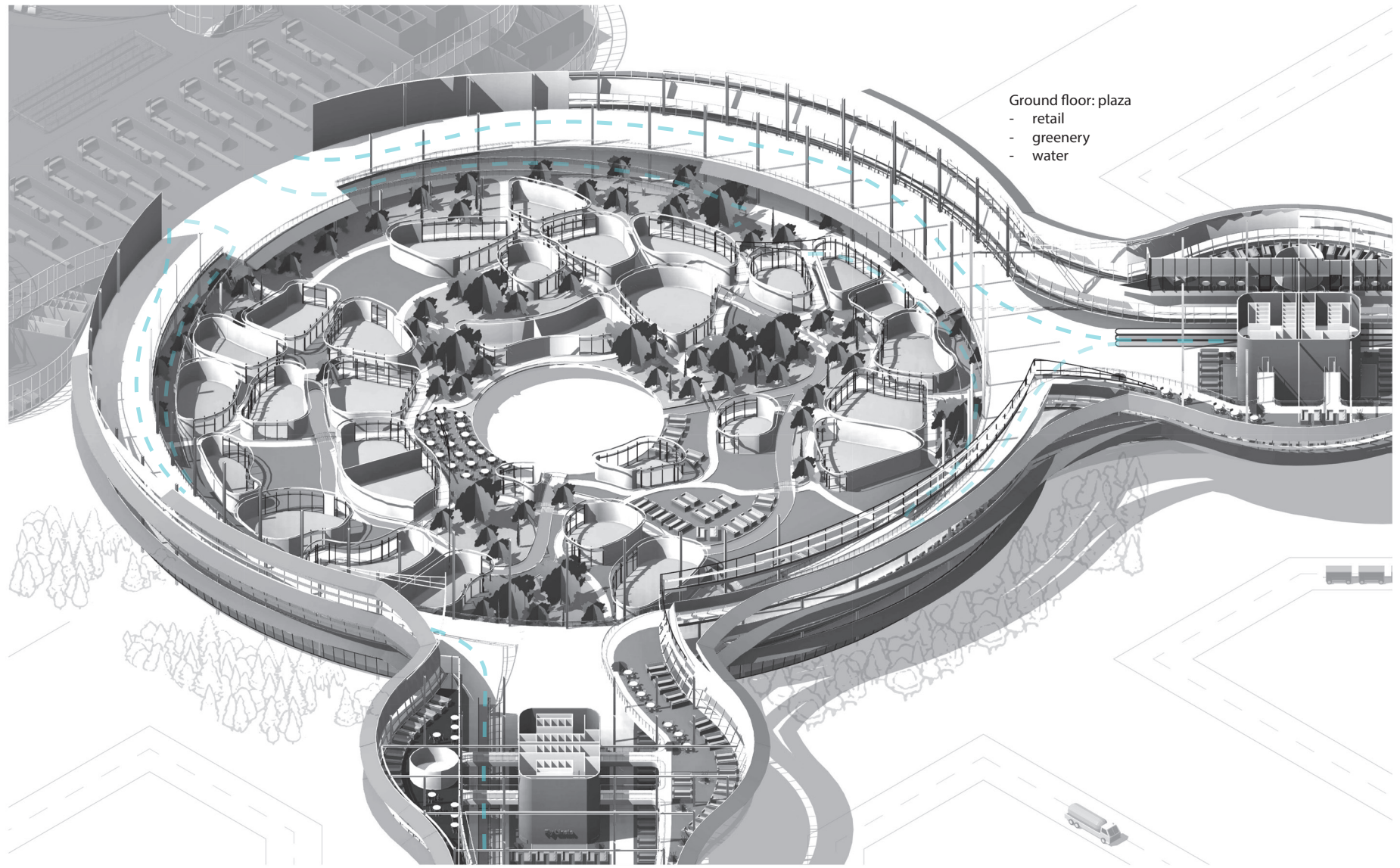

FLOOR PLANS

00 GROUND FLOOR

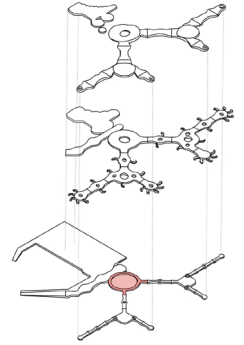

FLOOR PLANS

01 FIRST FLOOR

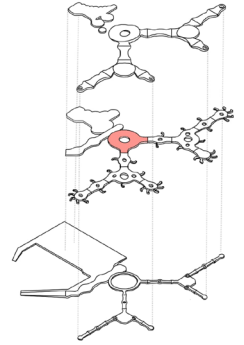
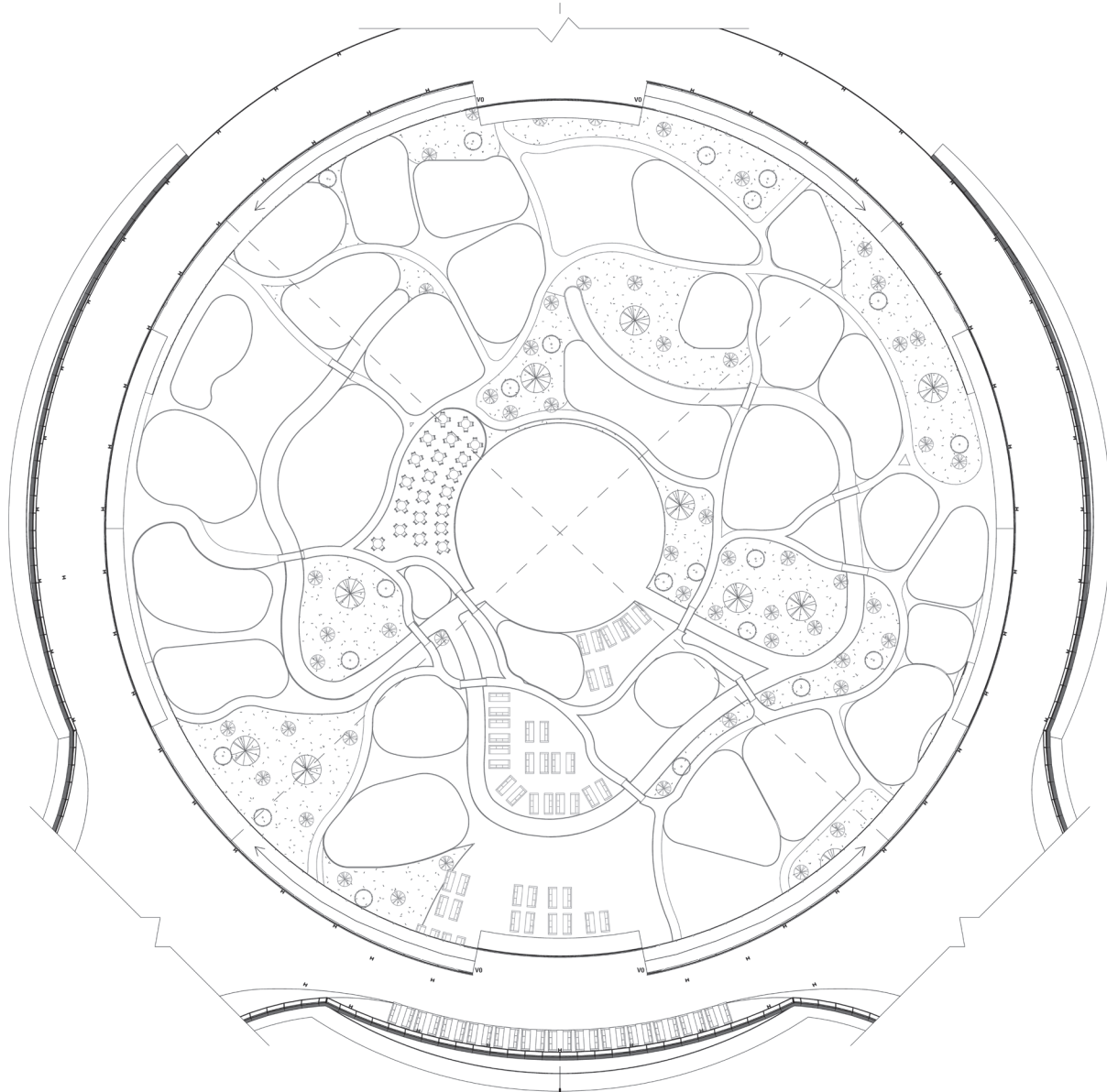

B →



DEPARTURE HALL

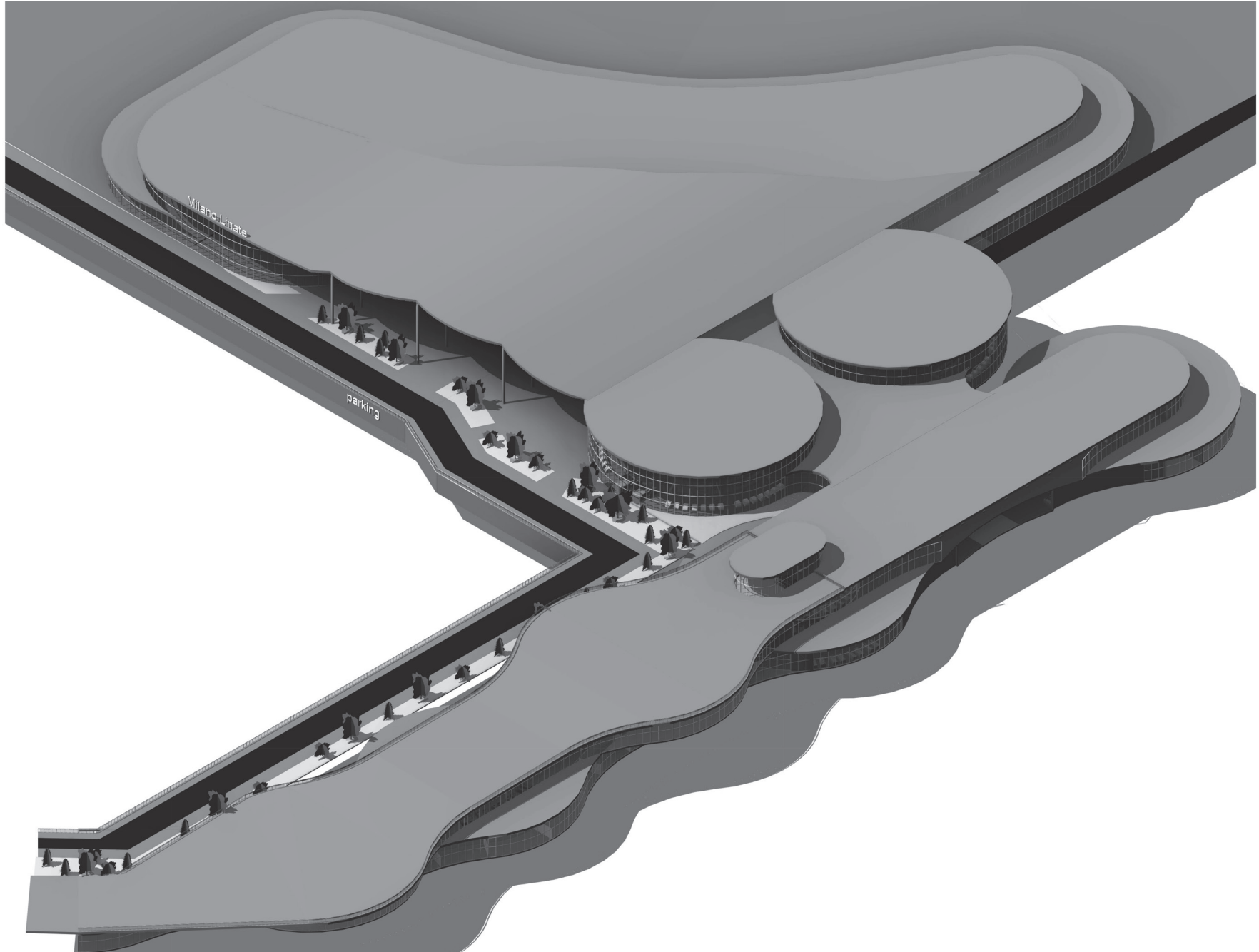

FLOOR PLANS

01 FIRST FLOOR

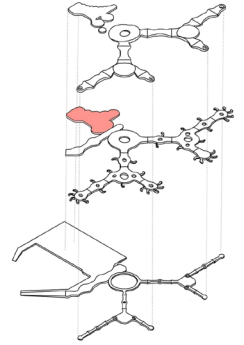
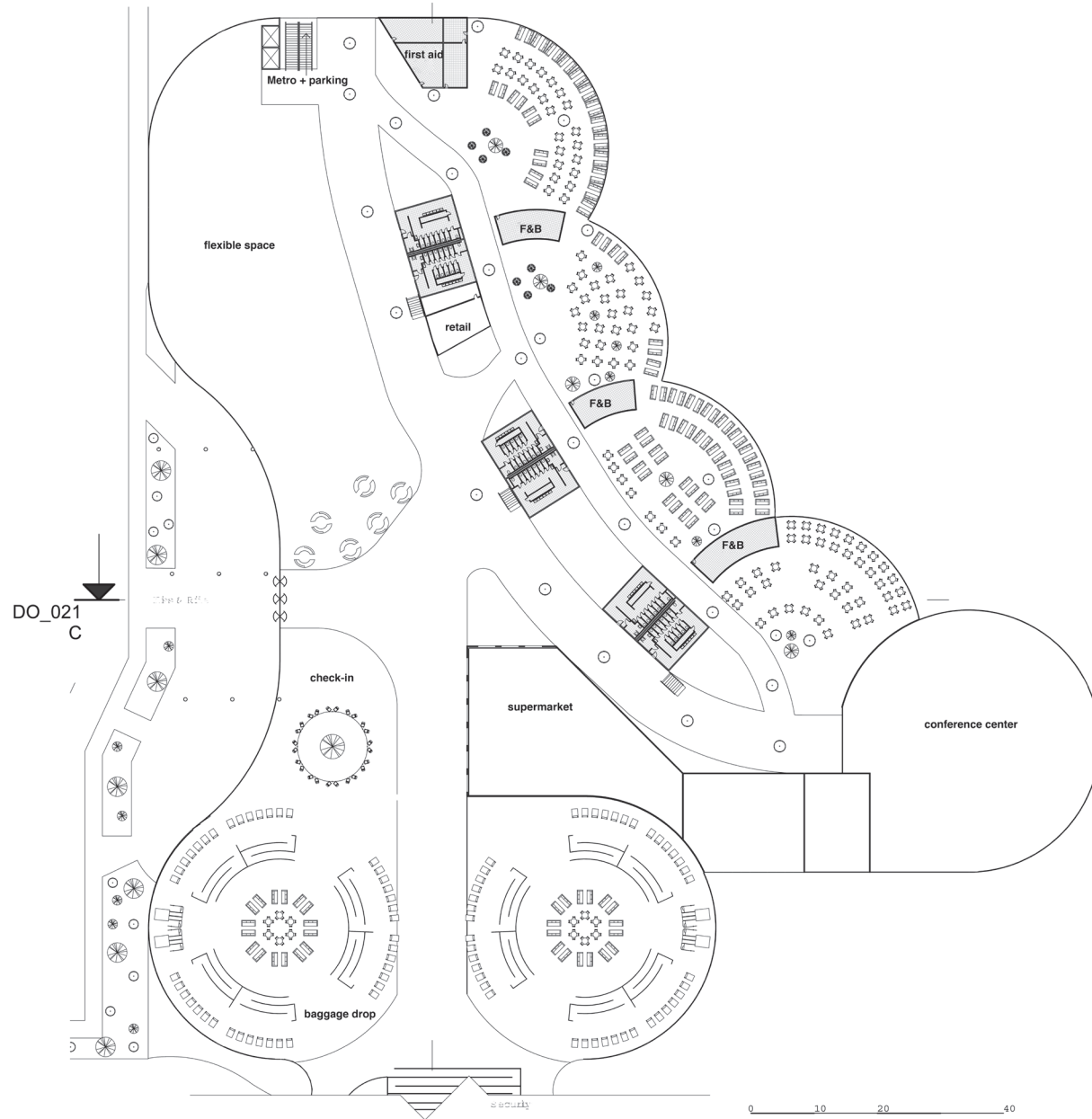

1:200
SECTIONS

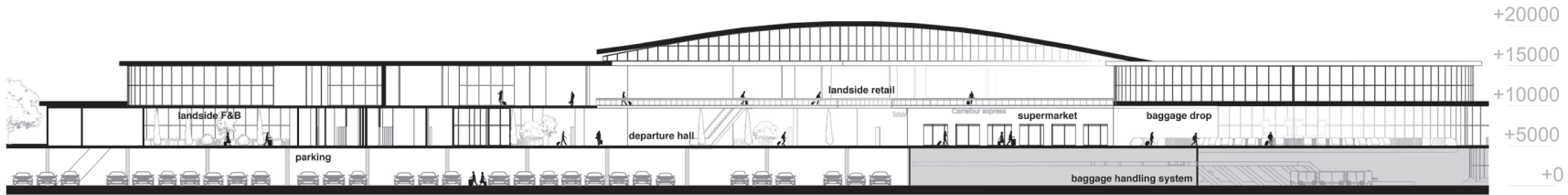
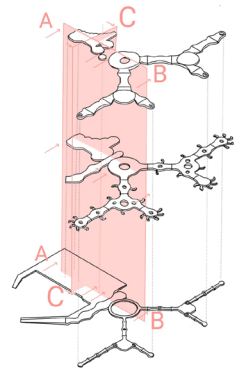

SECTION A DEPARTURE HALL

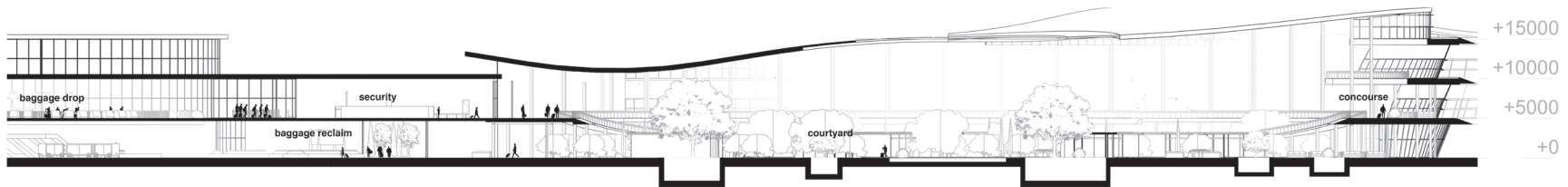

SECTION B COURTYARD

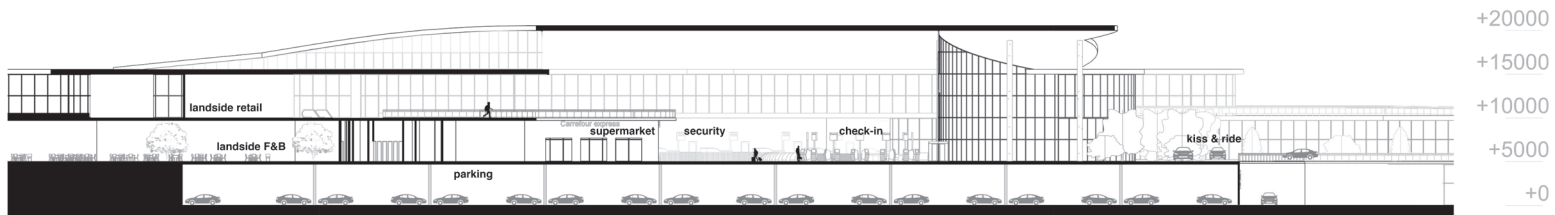

SECTION C DEPARTURE HALL



1:200
SECTIONS

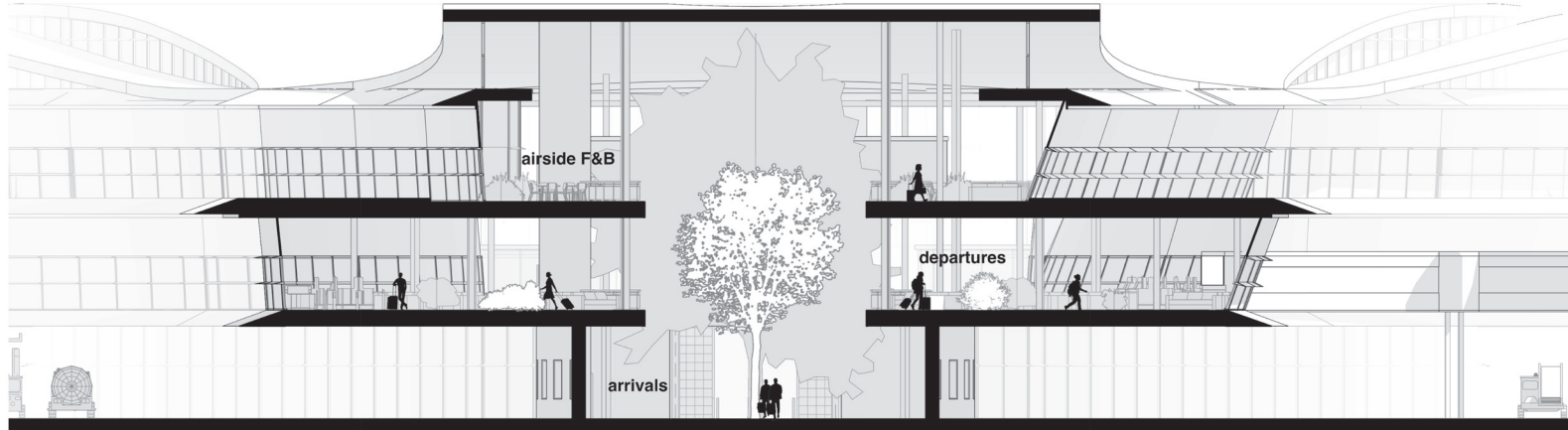
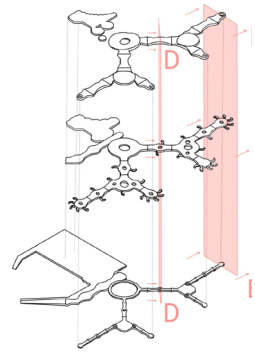

SECTION D CONCOURSE

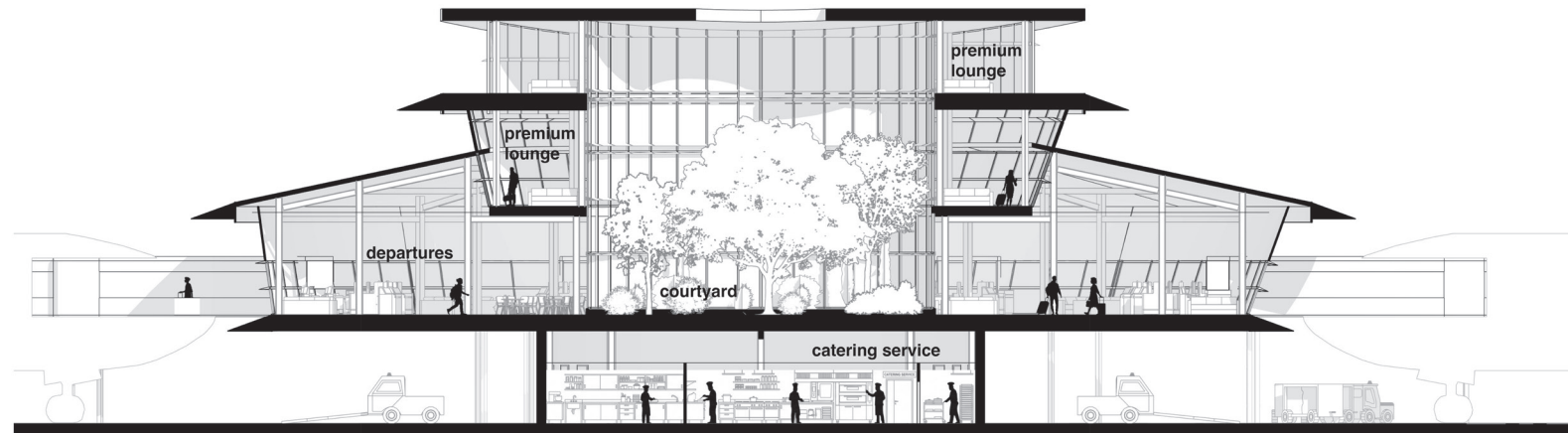

SECTION E CONCOURSE



1:200

ELEVATION - LANDSIDE

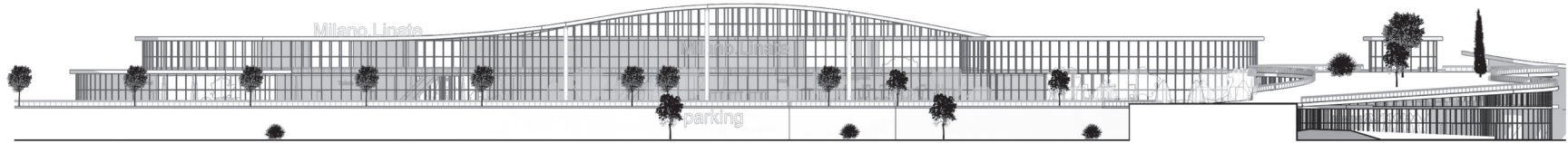
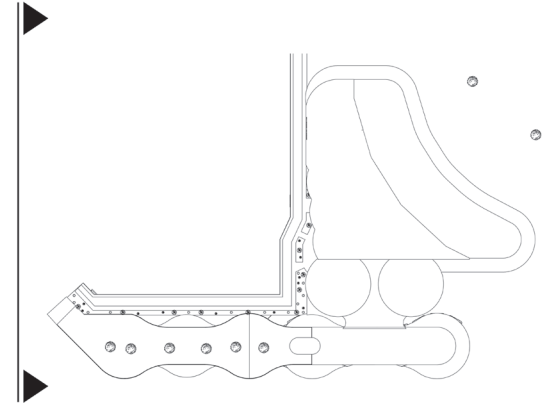

0 10 20 40
meter

1:200

ELEVATIONS - AIRSIDE

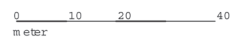
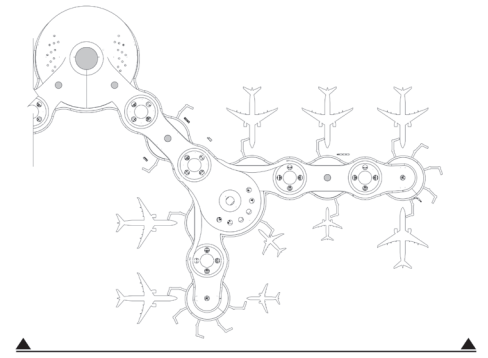

STRUCTURE CONCOURSE

Roof
CLT slab with Corten Steel finish

Bearing structure
Steel columns and beams
(span max 8 meters)

Foundation
Reinforced concrete foundation

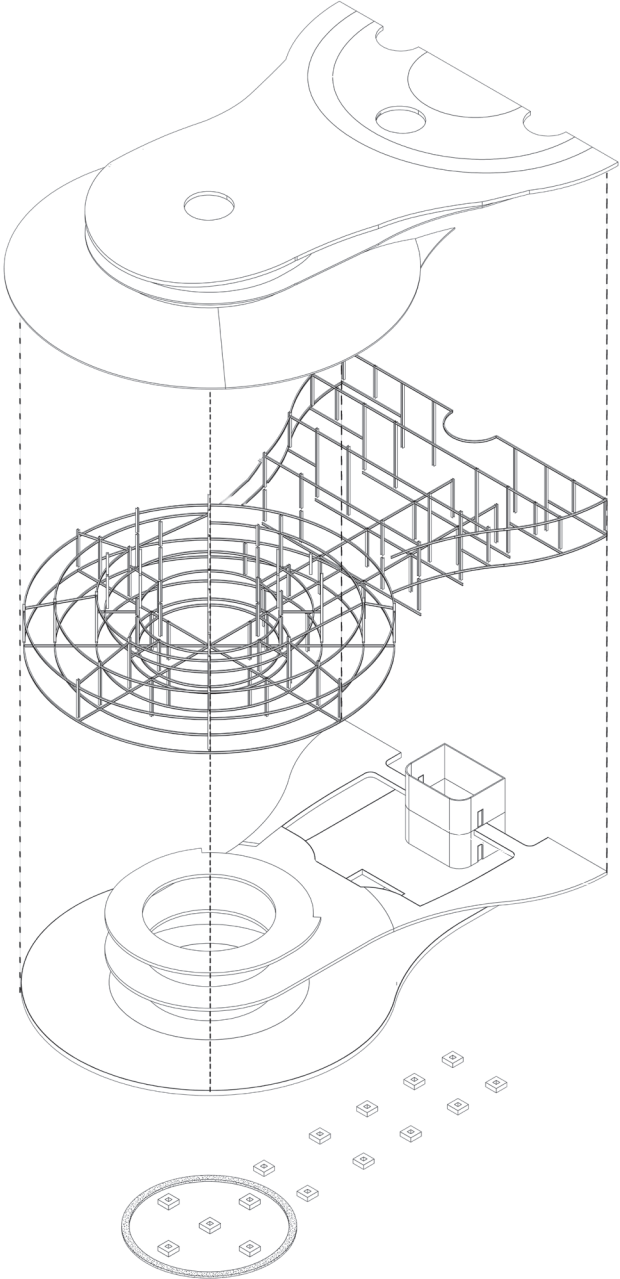

Ceiling
Grill ceiling wood

Floor
Prefabricated CLT panels

Stability core

CLIMATE

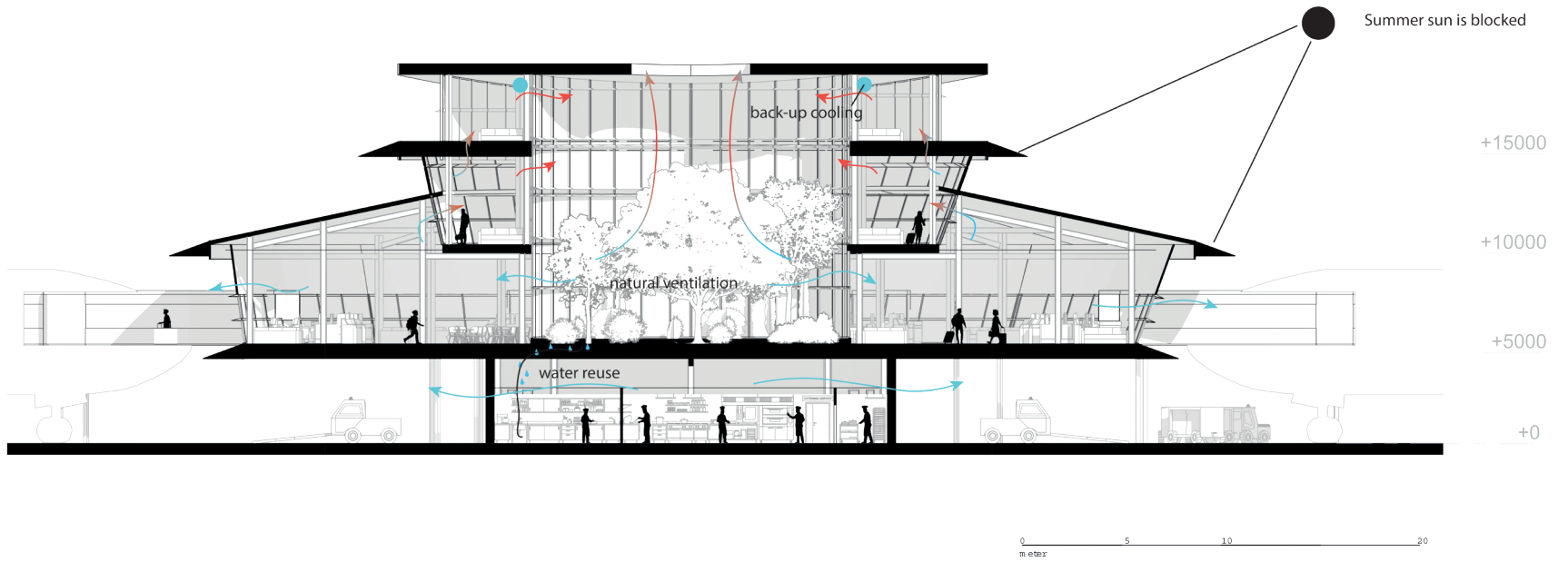

1:50

FRAGMENT - INTERIOR

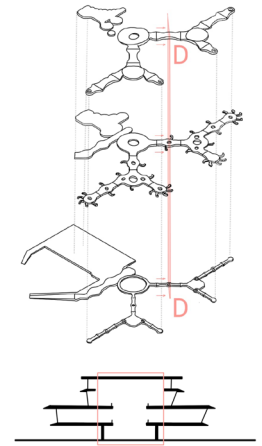
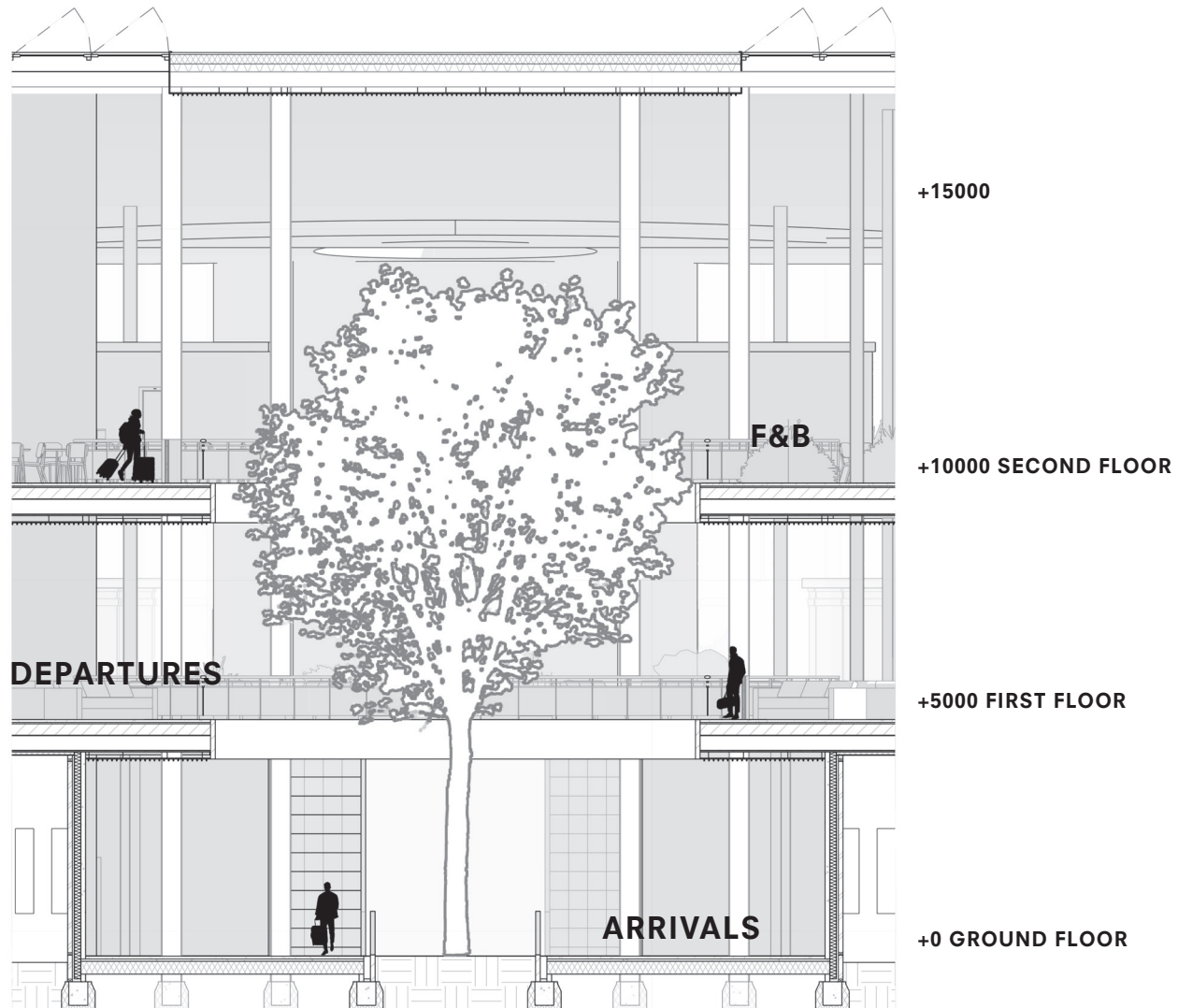

1:50

FRAGMENT - ENVELOPE

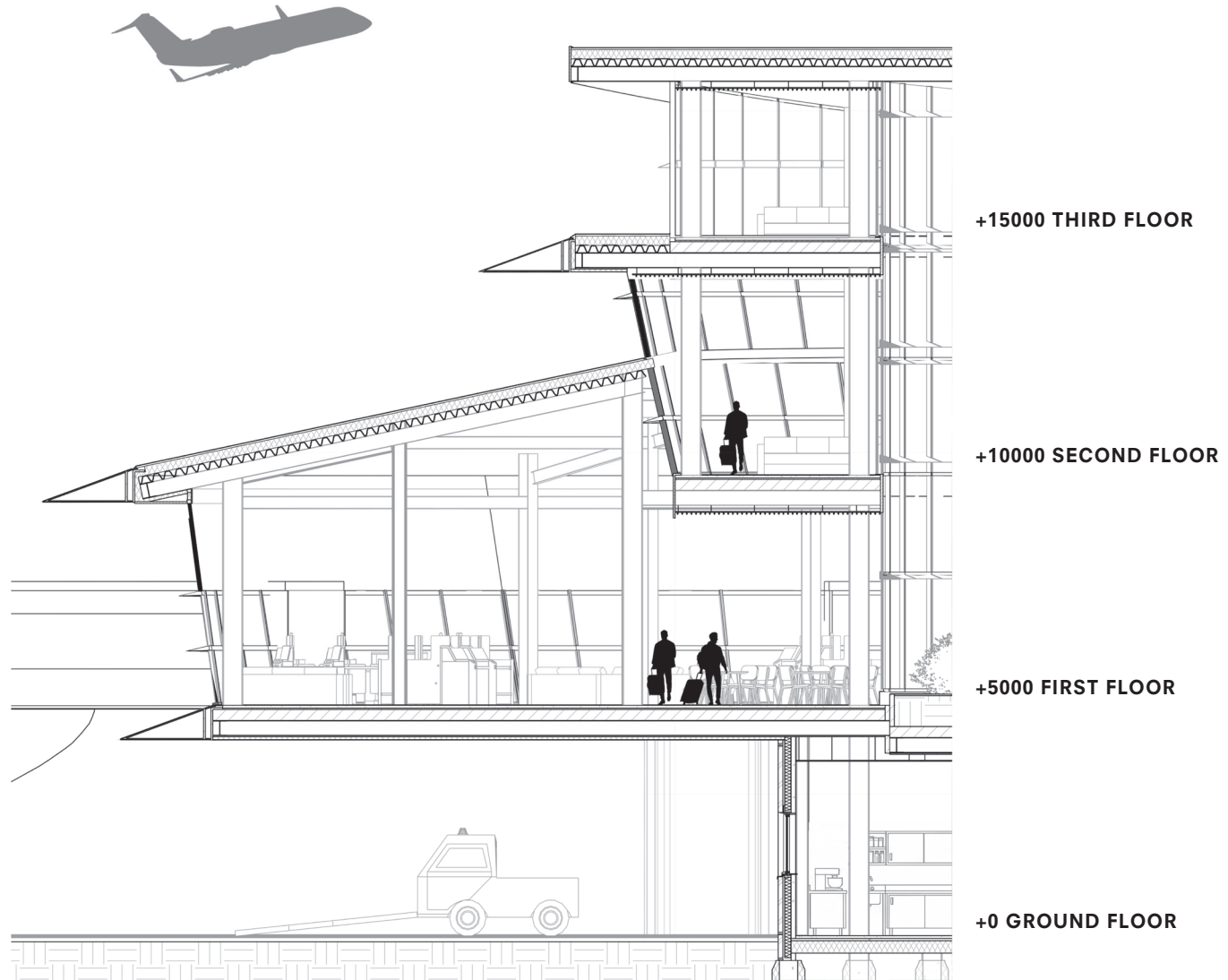

+15000 THIRD FLOOR

+10000 SECOND FLOOR

+5000 FIRST FLOOR

+0 GROUND FLOOR

0 1 2 4
meter

1:20
FACADE

Materials:

- transparency
- elegancy
- sustainability

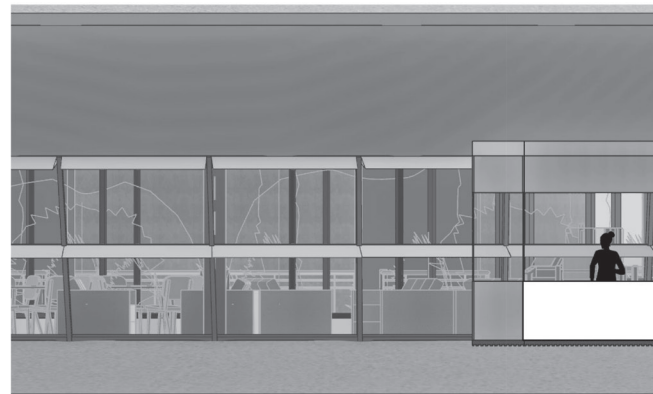
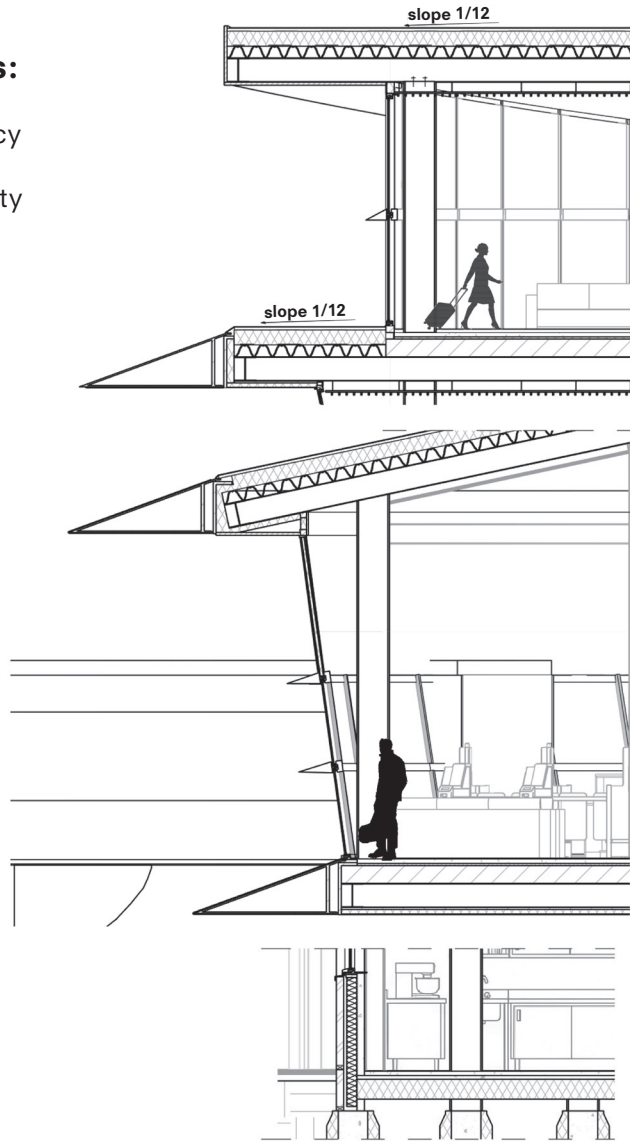

Finishes:

Top roof (wave):

- white coated aluminium



Ceiling:

- light wooden grid ceiling

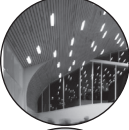

Roof:

- profiled corten steel

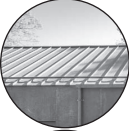

Construction:

- steel profile construction



Façade:

- HR++(+) glass
- aluminium curtain mulions



Floors:

- white marble floor finish

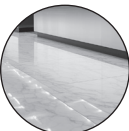

Wall:

- grey natural stone: Pietra di Ceppo

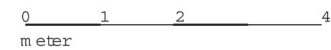

1:10

DETAIL V-01

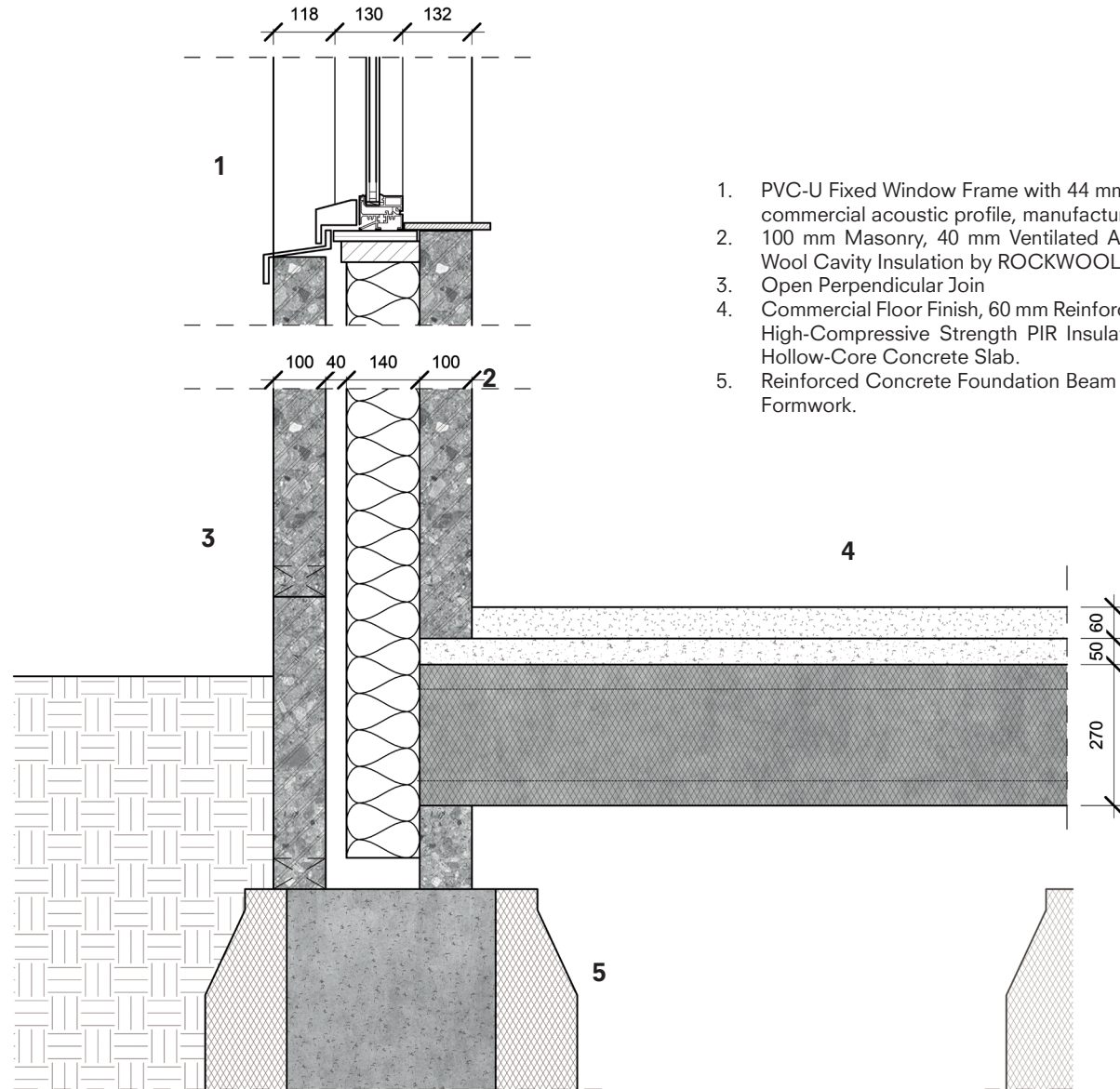
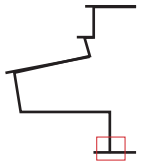

1. PVC-U Fixed Window Frame with 44 mm Double Glazing, high-insulation commercial acoustic profile, manufacturer Schüco.
2. 100 mm Masonry, 40 mm Ventilated Air Cavity, 140 mm Rigid Mineral Wool Cavity Insulation by ROCKWOOL, 100 mm Masonry.
3. Open Perpendicular Join
4. Commercial Floor Finish, 60 mm Reinforced Cementitious Screed, 50 mm High-Compressive Strength PIR Insulation Board, Precast Prestressed Hollow-Core Concrete Slab.
5. Reinforced Concrete Foundation Beam cast in Permanent Insulated EPS Formwork.

1:10
DETAIL V-02

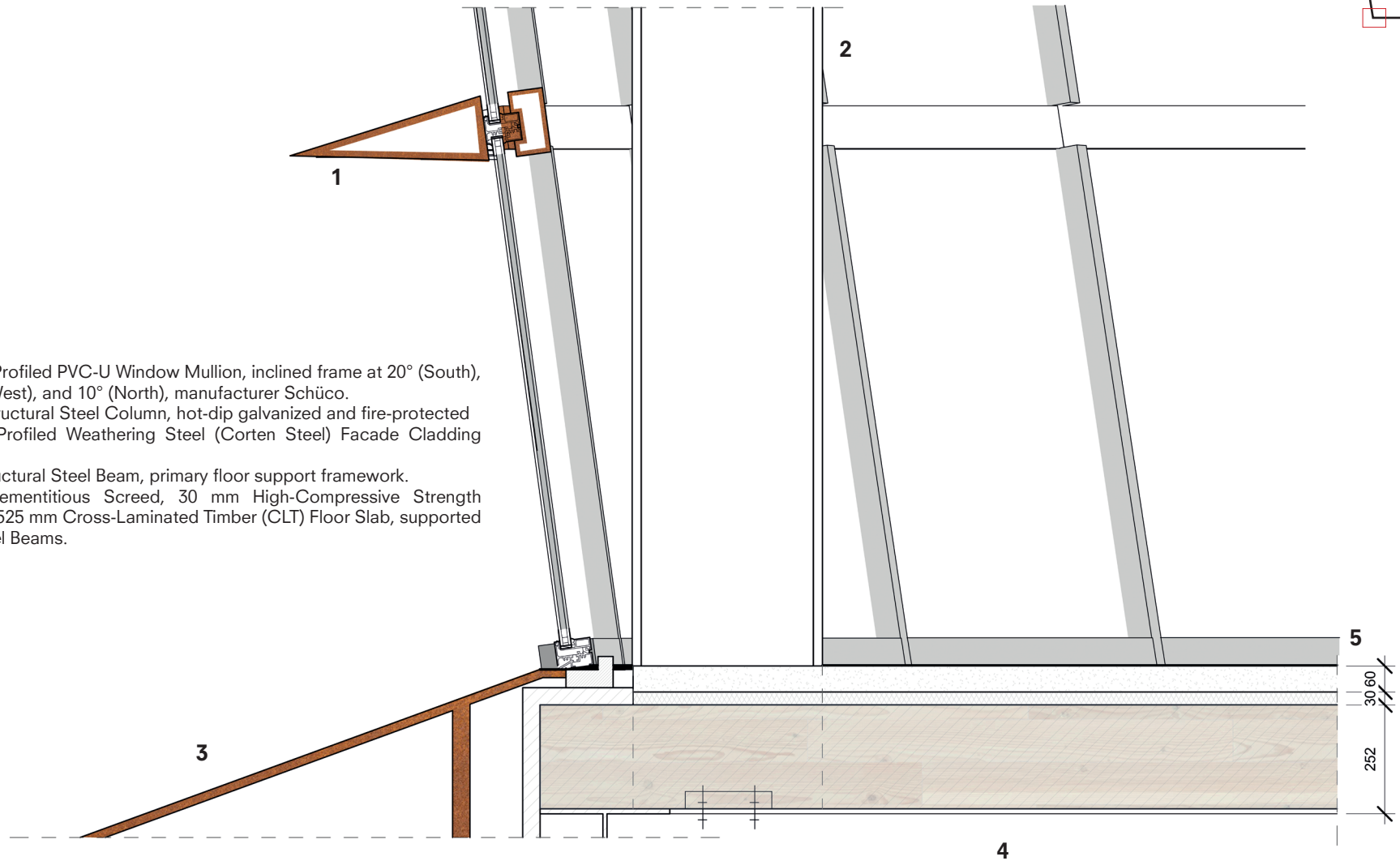
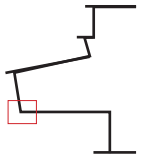

1. Triangular Profiled PVC-U Window Mullion, inclined frame at 20° (South), 15° (East/West), and 10° (North), manufacturer Schüco.
2. HE400A Structural Steel Column, hot-dip galvanized and fire-protected
3. Triangular Profiled Weathering Steel (Corten Steel) Facade Cladding Panels.
4. IPE300 Structural Steel Beam, primary floor support framework.
5. 60 mm Cementitious Screed, 30 mm High-Compressive Strength Insulation, 525 mm Cross-Laminated Timber (CLT) Floor Slab, supported on IPE Steel Beams.

1:10
DETAIL V-03

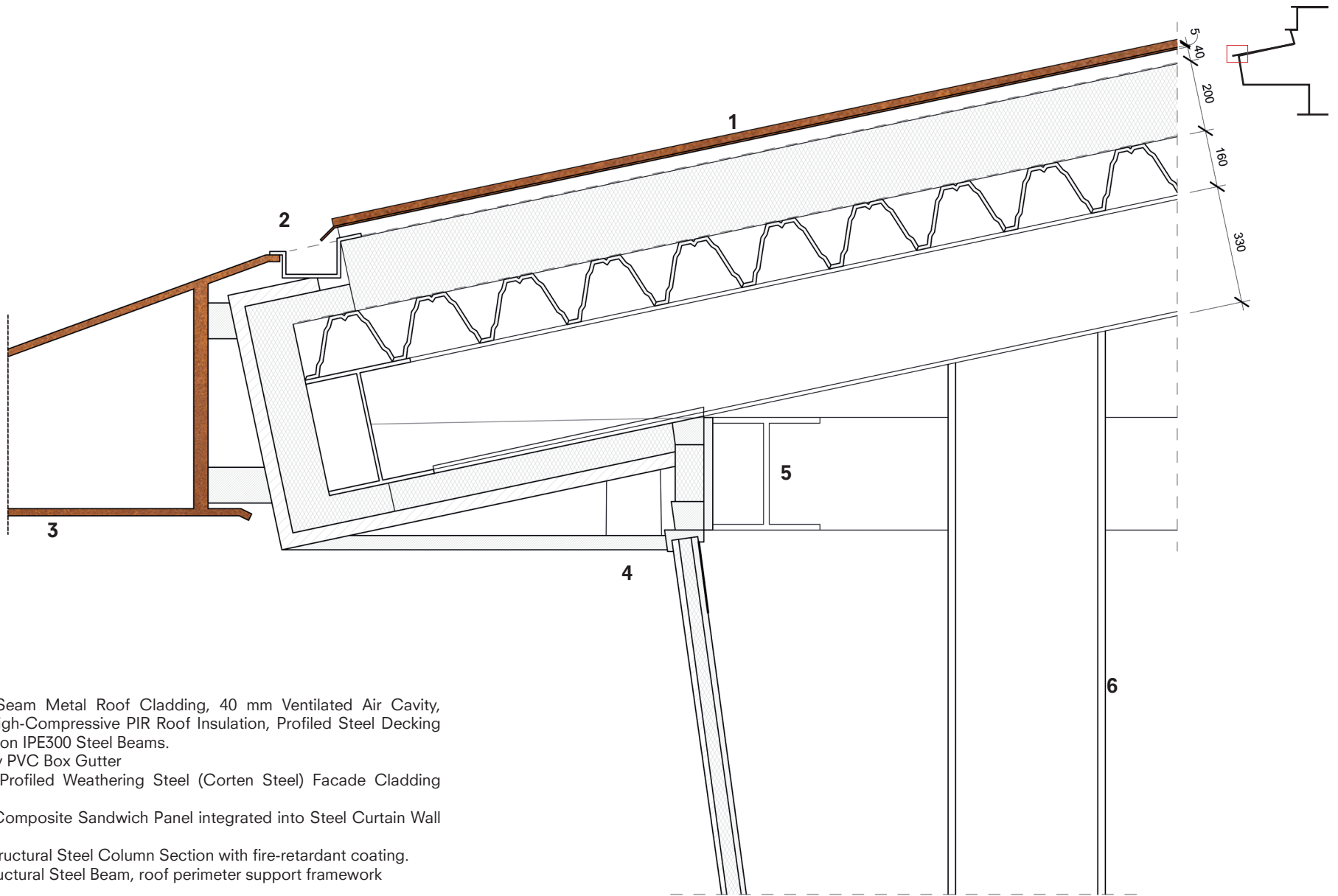

1. Standing Seam Metal Roof Cladding, 40 mm Ventilated Air Cavity, 200 mm High-Compressive PIR Roof Insulation, Profiled Steel Decking supported on IPE300 Steel Beams.
2. Heavy-duty PVC Box Gutter
3. Triangular Profiled Weathering Steel (Corten Steel) Facade Cladding Panels.
4. Insulated Composite Sandwich Panel integrated into Steel Curtain Wall System
5. HE400A Structural Steel Column Section with fire-retardant coating.
6. IPE300 Structural Steel Beam, roof perimeter support framework

0 0.1 0.2 0.4
 meter

1:10
DETAIL V-04

1. 60 mm Cementitious Screed, 30 mm High-Compressive Strength Insulation, 525 mm Cross-Laminated Timber (CLT) Floor Slab, supported on IPE Steel Beams.
2. HE400A Structural Steel Column Section with fire-retardant coating.
3. Suspended Wooden Grill Ceiling System, mounted on a steel grid,
4. Triangular Profiled PVC-U Window Mullion
5. HE400A Structural Steel Column Section with fire-retardant coating.

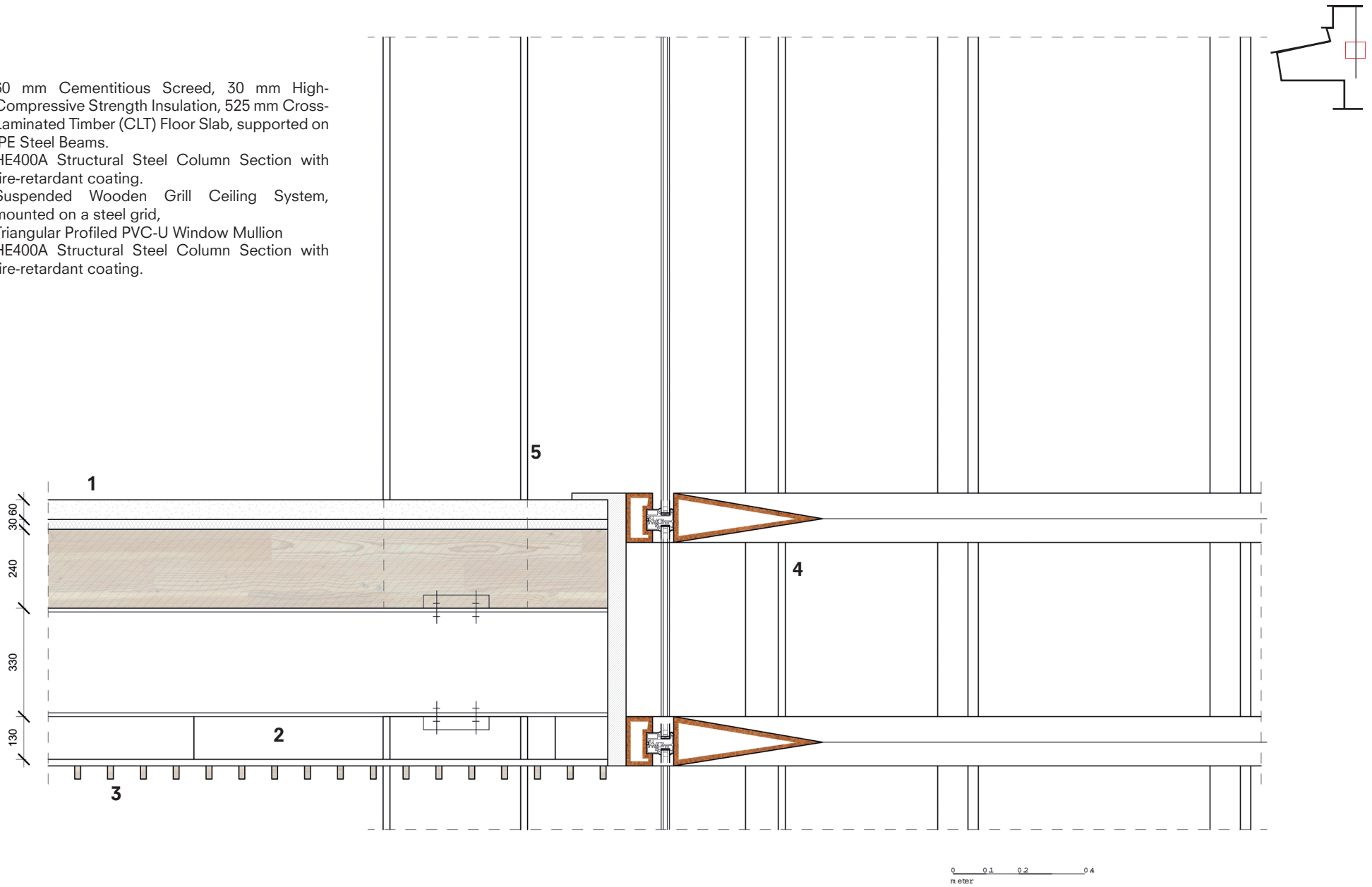

1:10
DETAIL V-05

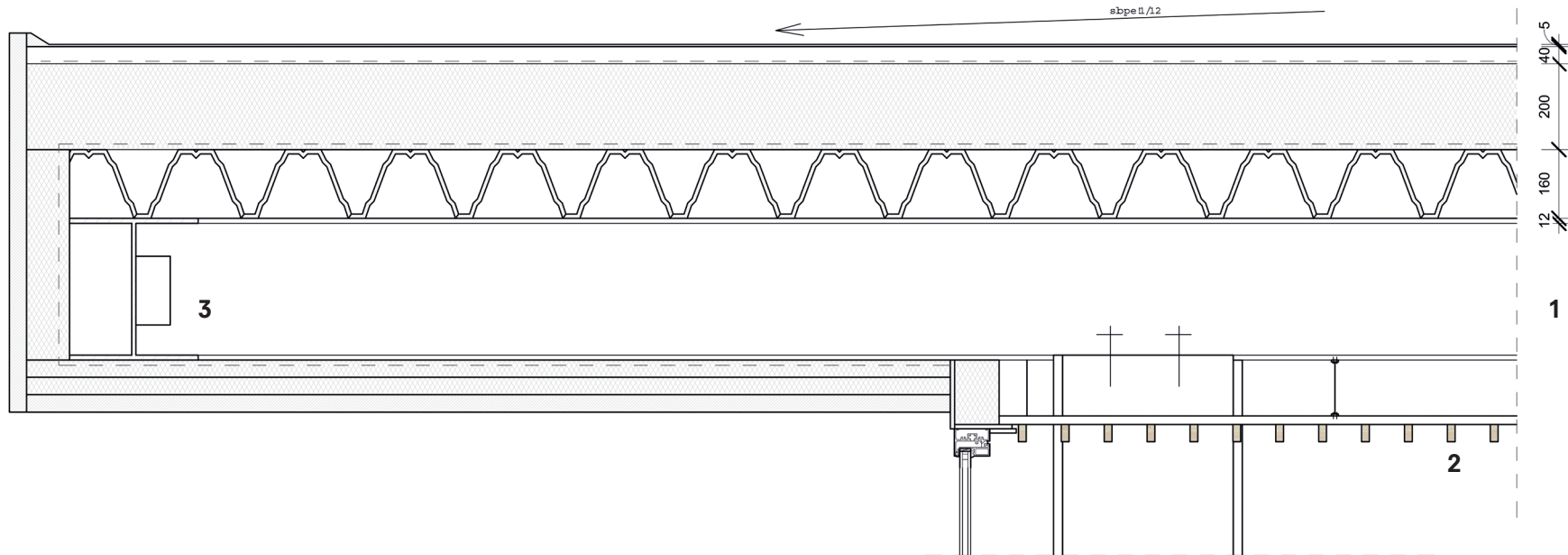

1. Standing Seam Metal Roof Cladding, 40 mm Ventilated Air Cavity, 200 mm High-Compressive PIR Roof Insulation, Profiled Steel Decking
2. Suspended Wooden Grill Ceiling System, mounted on a steel grid, Open Perpendicular Join
3. IPE300 Structural Steel Beam, roof perimeter support framework
1. Triangular Profiled PVC-U Window Mullion, manufacturer Schüco.
2. HE400A Structural Steel Column Section with fire-retardant coating.

4

5

0 0.1 0.2 0.4
 meter