

the region and the camp within the new landscape infrastructures

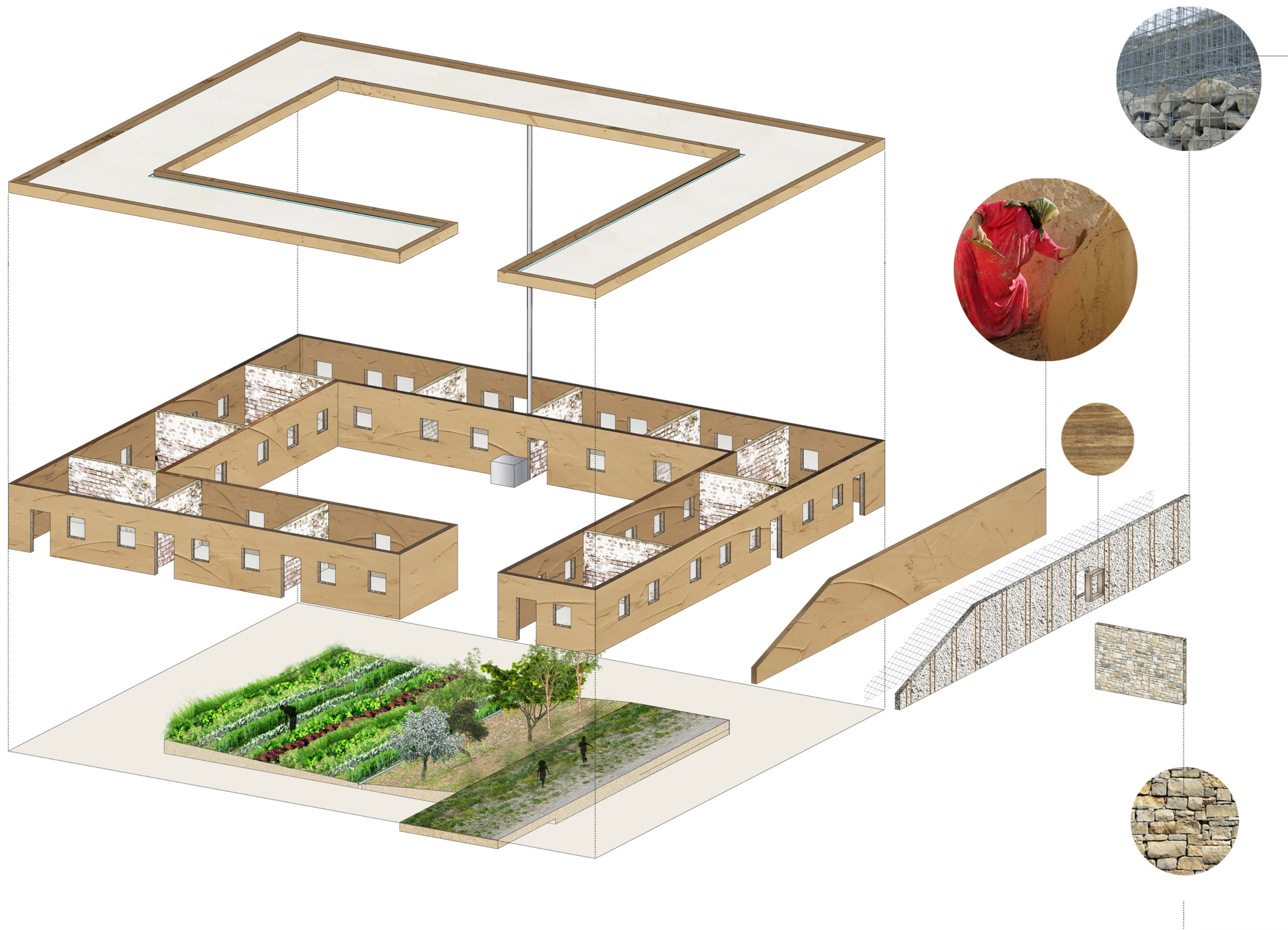

## the standard vs. the local

The well "Majen": collects rain water from a burt lime washed rooftop acting as a filter (vernacular technique). Local materials in a span of 5 km from the camp: the digged materials from the natural rehabilitation, the surrounding quarries are all providers for this local construction.  
The courtyard: a secured place with a vegetable garden for family use

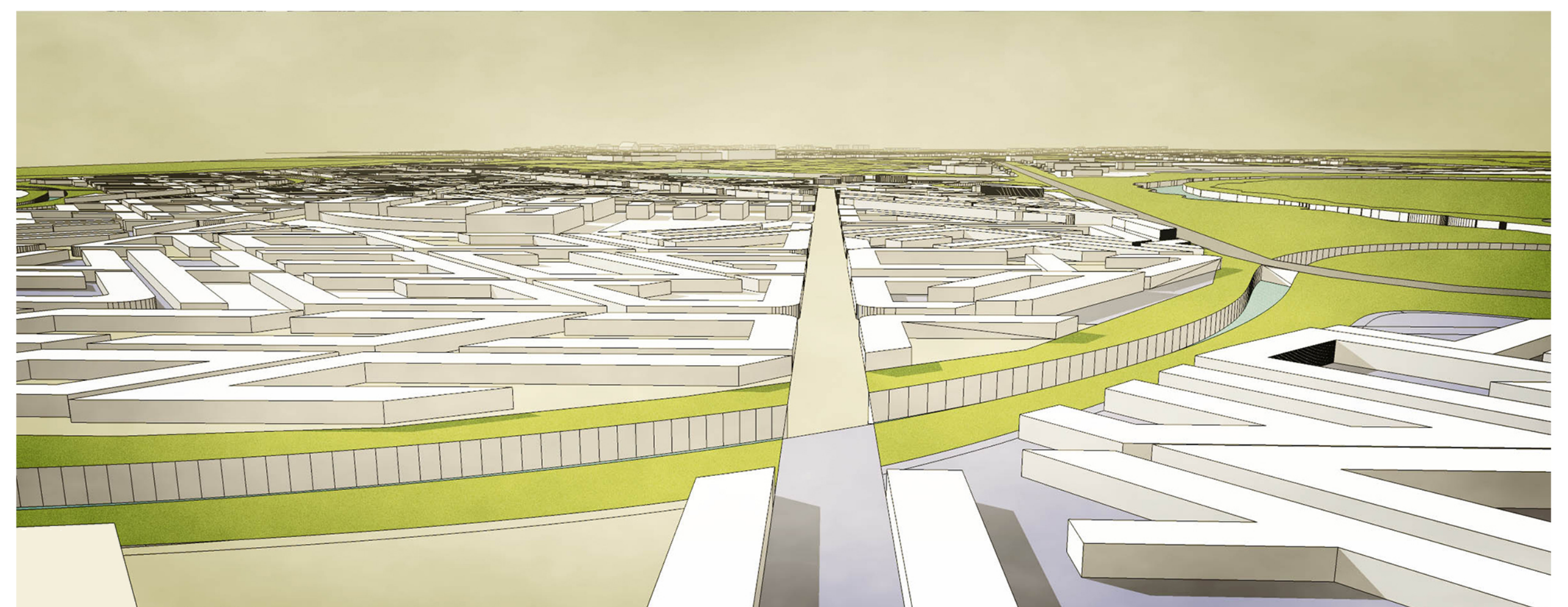

principles to shape new conditions on the refugee camp: questioning the rigid grid, adapting to the available materials, grafting on the landscape infrastructures and set the basis for a producing camp.

## dis-connection vs. re-connection



## the grid vs. new patterns



## the grid vs. new zoning



## the standard vs. the local



## the goods vs. the produce



## the wall vs. natural fence

