

DESIGNING FOR DURATION

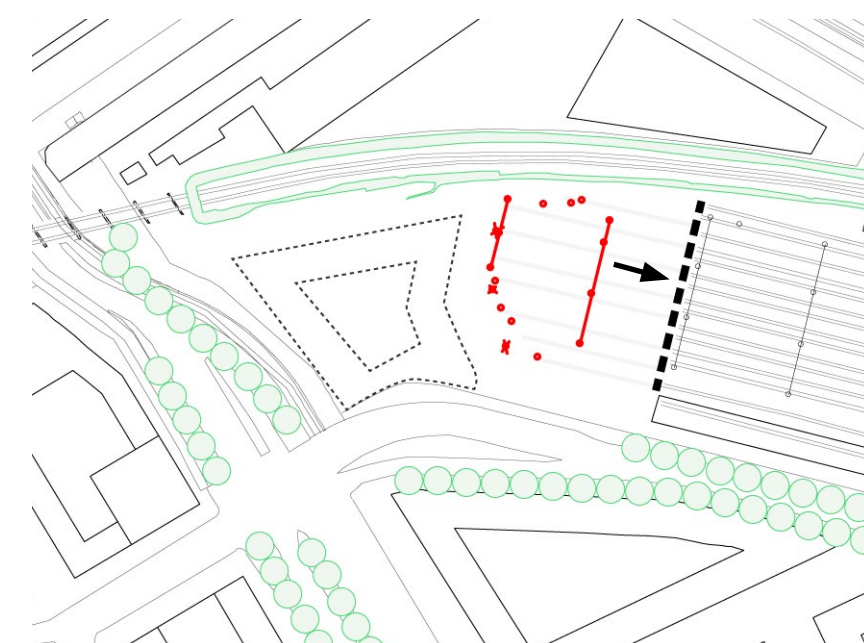

OPEN SITE

Currently the fenced off perimeter of the territory defines a highly isolated and introvert 'island'. Removal of the barriers is the initial step of transforming disconnection into an open and permeable public place.



CLEAR BOUNDARIES

Establishing a transparent and clear demarcation line between the functioning railway and the project terrain allows to frame and articulate the presence of historical railway, while also placing new activities right next to it without administrative contradictions.

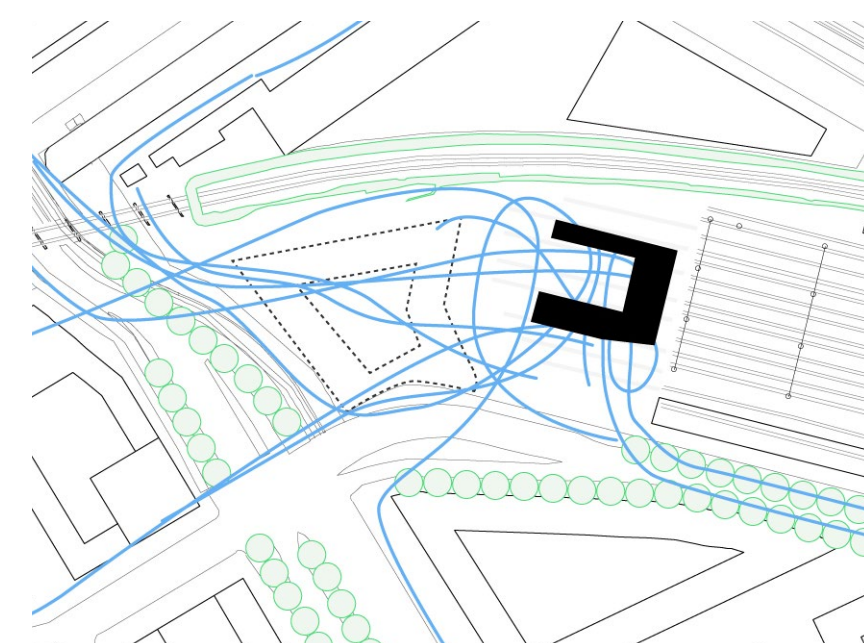

TEMPORARY CATALYST

The multiplicity of offered formats of public performance enable the pavilion to act as a catalyst for regenerating the perception of the area. The range of the temporary program of activities conditions the Spoorbzone area to be more connective and open.

• New Bus Stop



Site Plan 1:1000

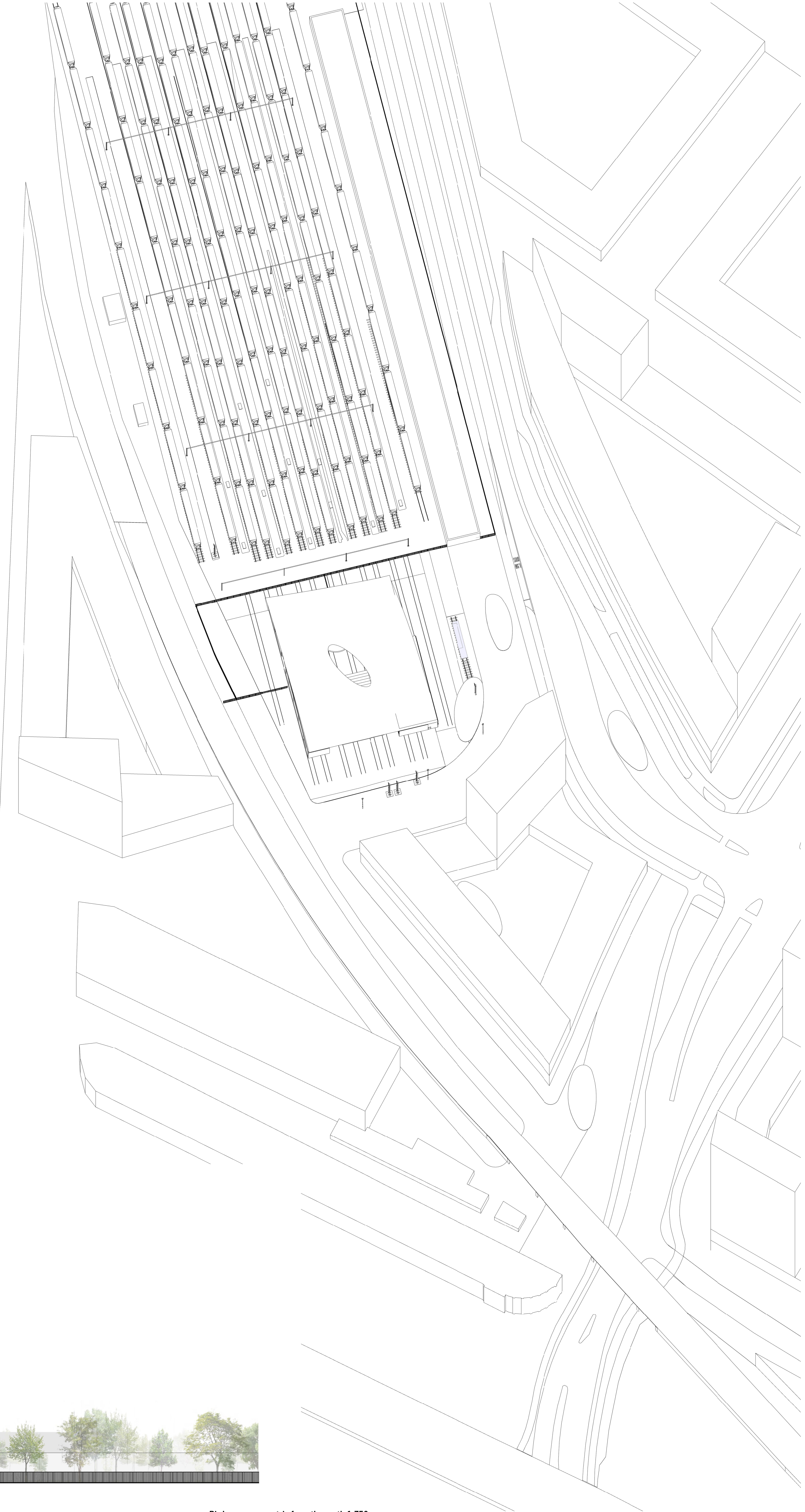

Birdseye axonometric from the north 1:750



POST-OCCUPANCY VALUE

As pavilion is disassembled, permanent parts of the design remain as ground for new future exhibits. The area is transformed into a permanent community park within the collectively harvested new public terrain.



Contextual South section 1:500

PAVILION DEFINING SITE OPERATIONS

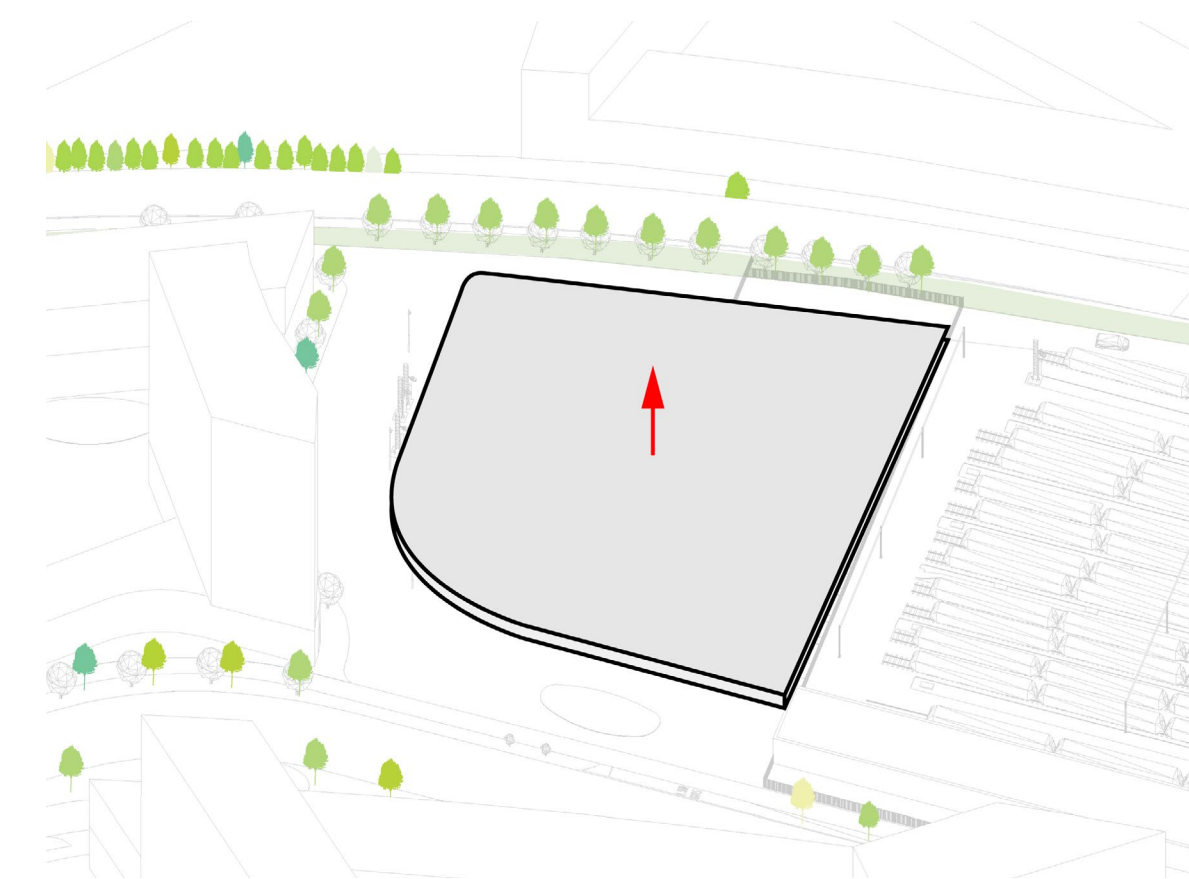

RECLAIMED RUBBLE PODIUM

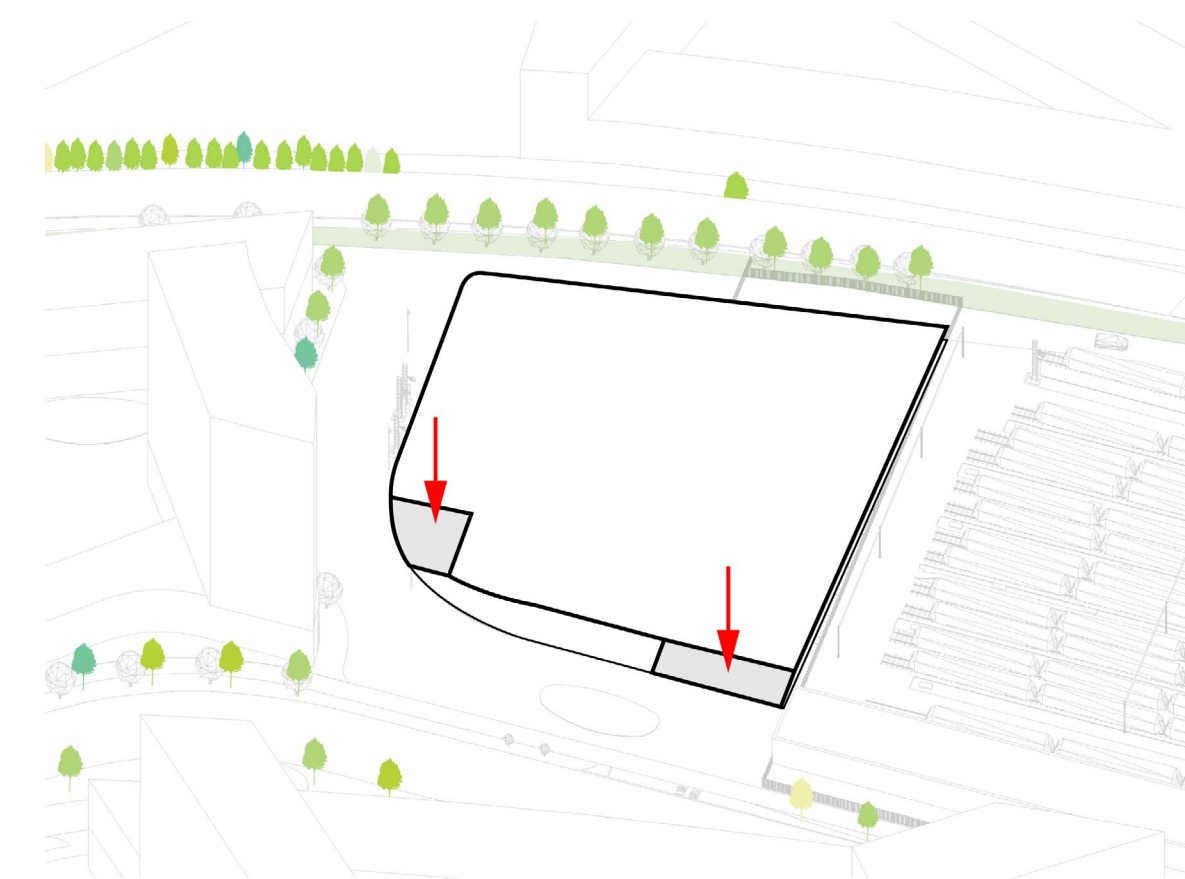

CONNECTIONS TO TERRAIN

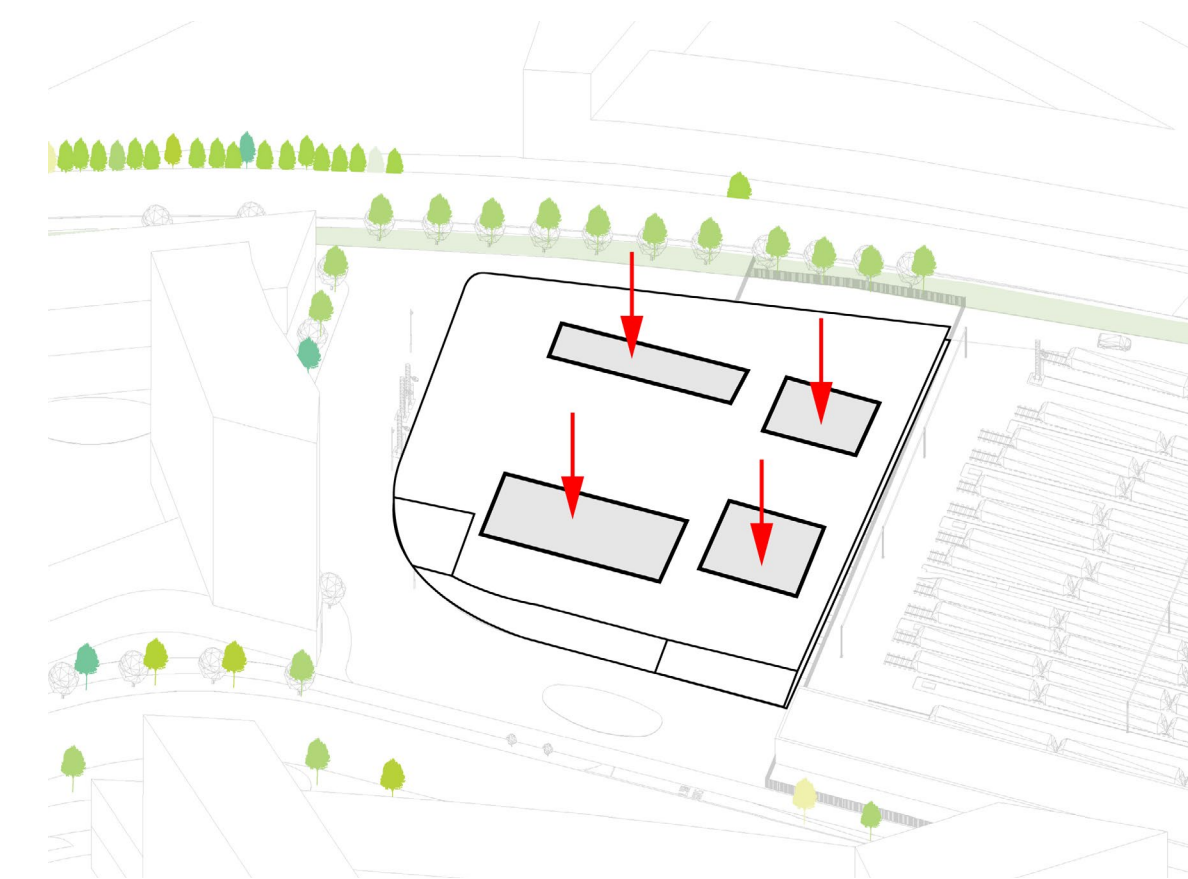

PERMANENT INTERVENTION

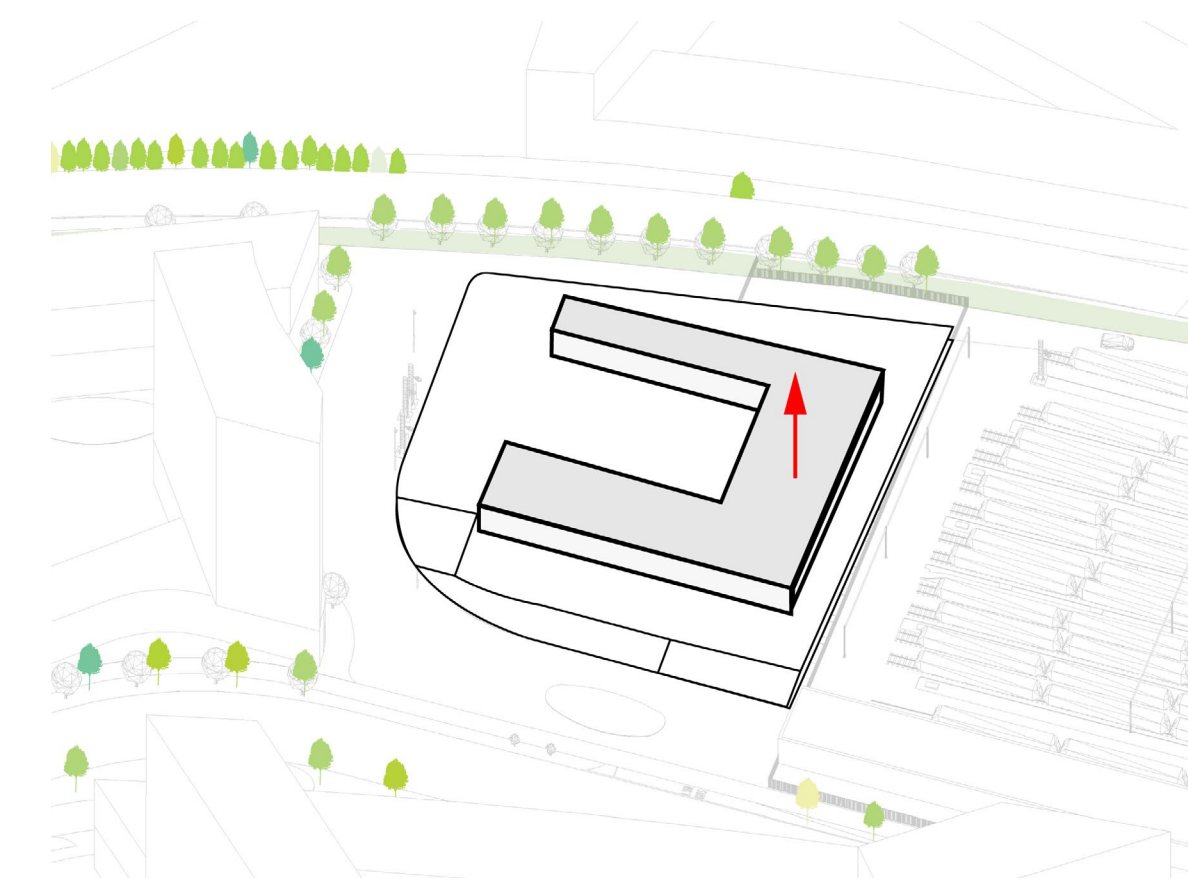

TEMPORARY PAVILLION VOLUME

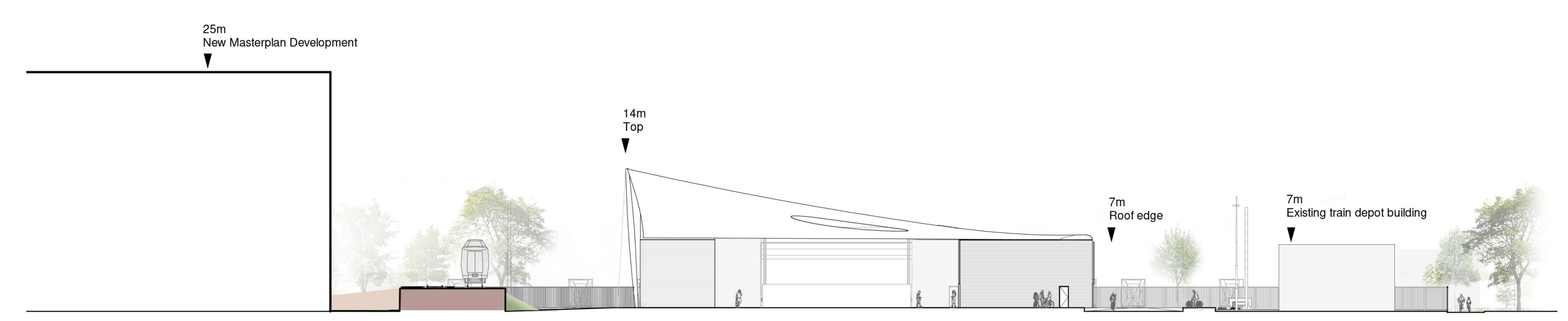

Contextual West section 1:500

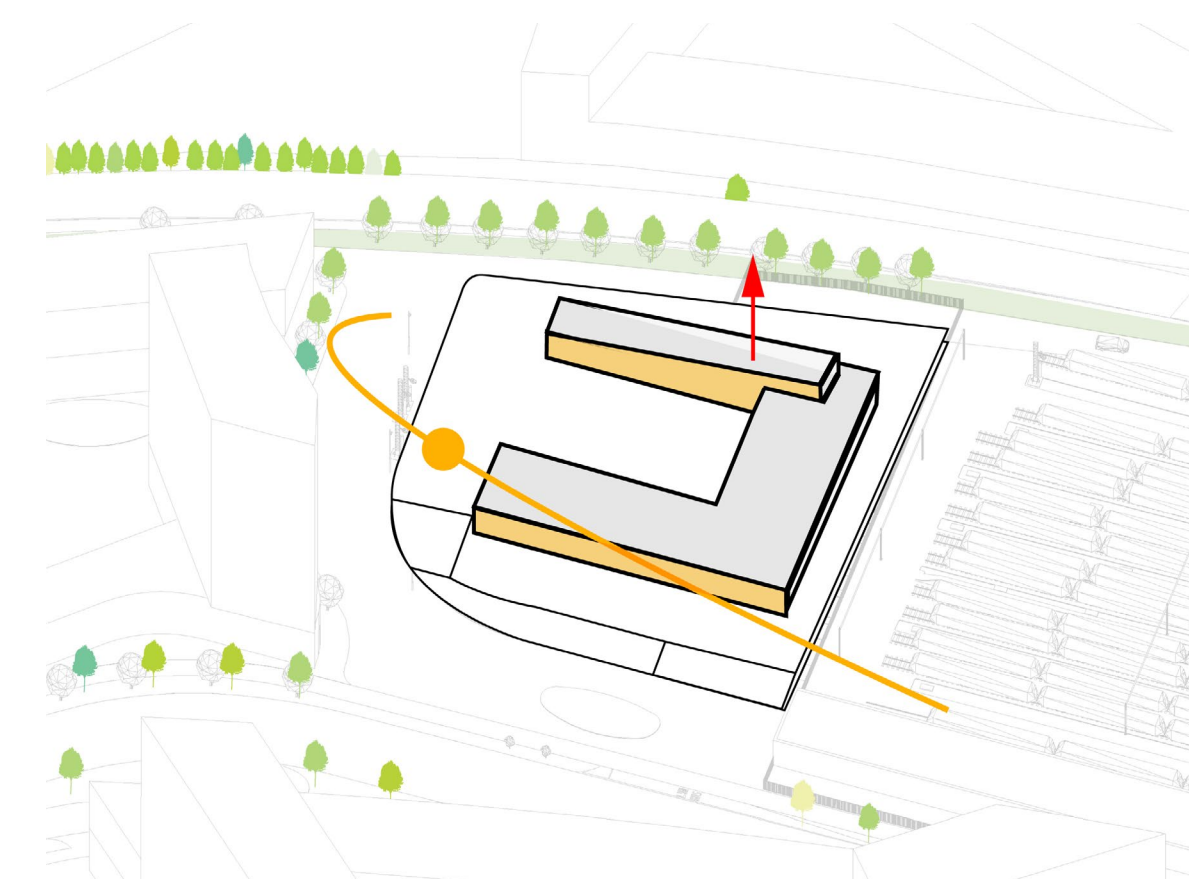

SOLAR EXPOSURE

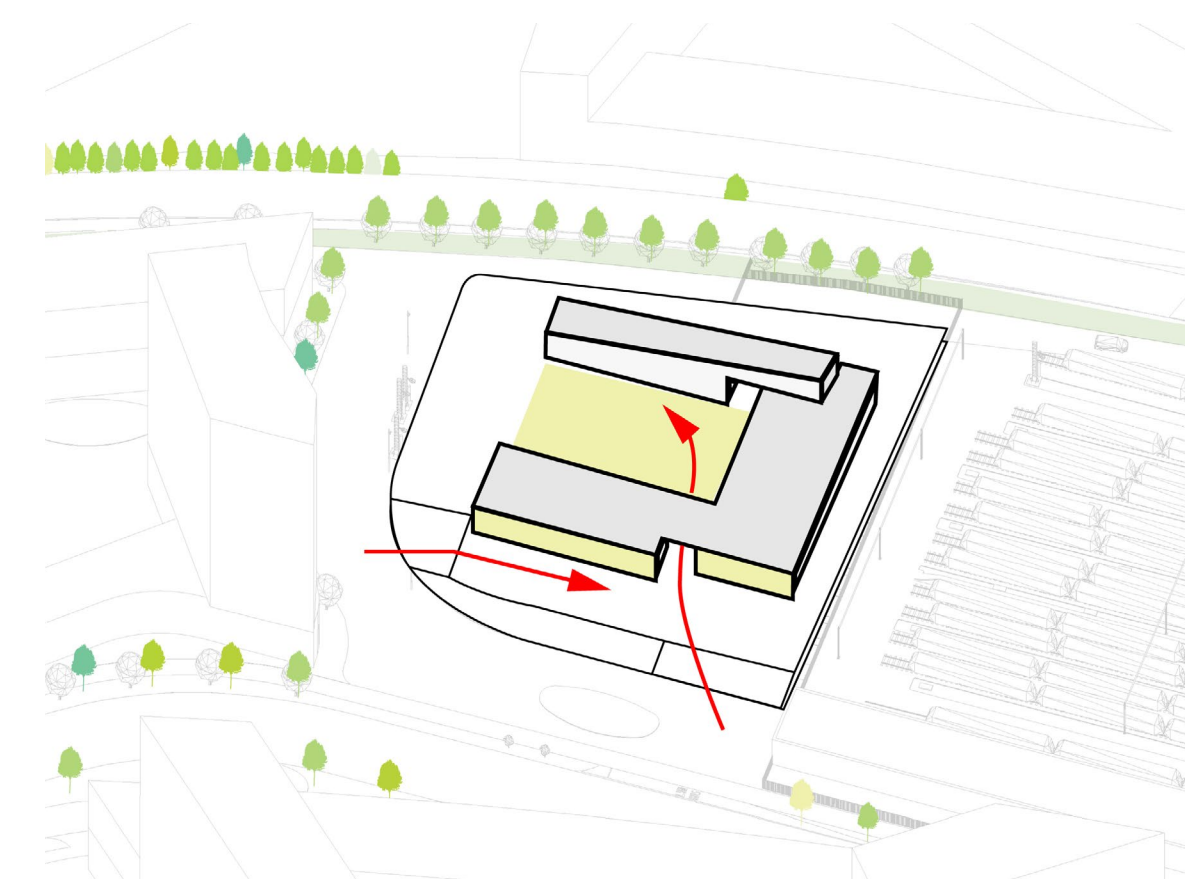

OPENINGS & PUBLIC ACTIVITY

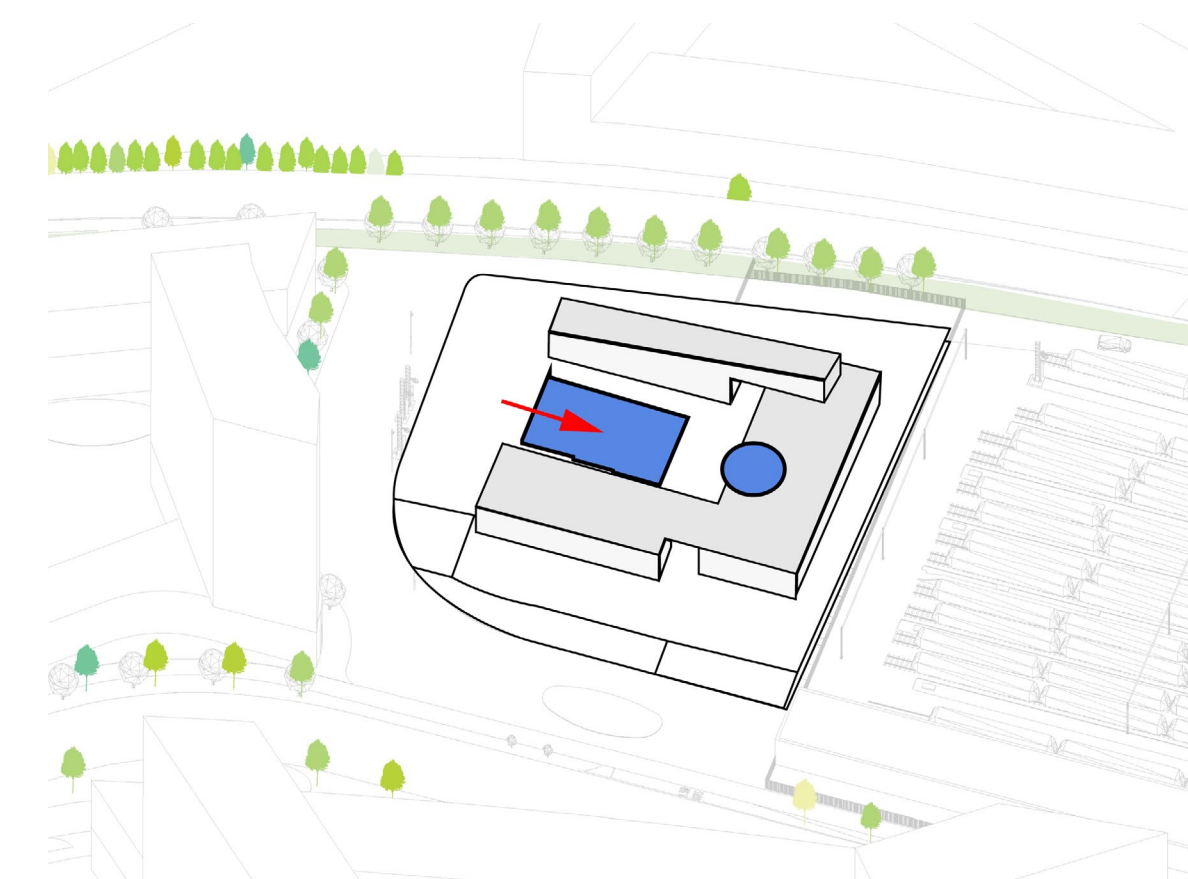

LARGE SEATING TO STAGE

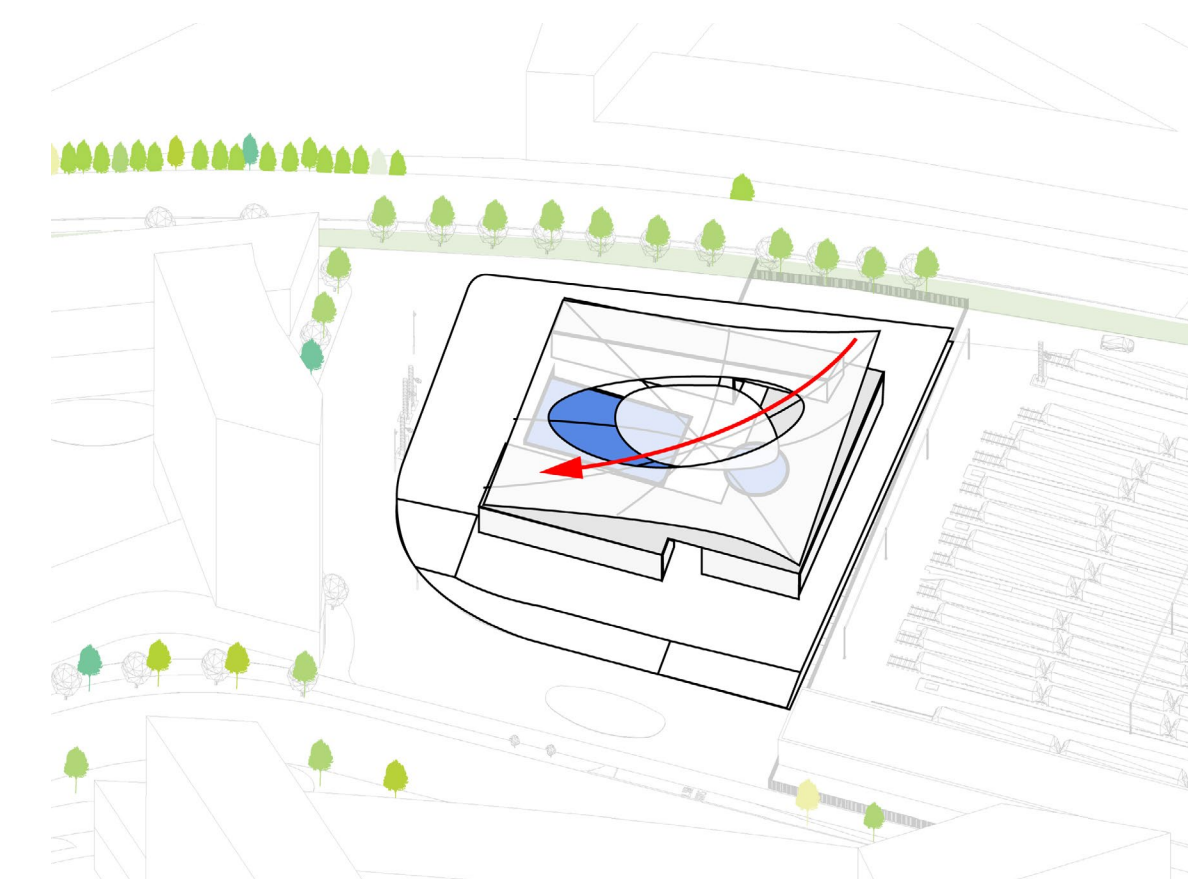

TENSILE ROOF COVER

MULTIPLICITY OF DESTINATIONS AND RANGE OF CONNECTIVITY

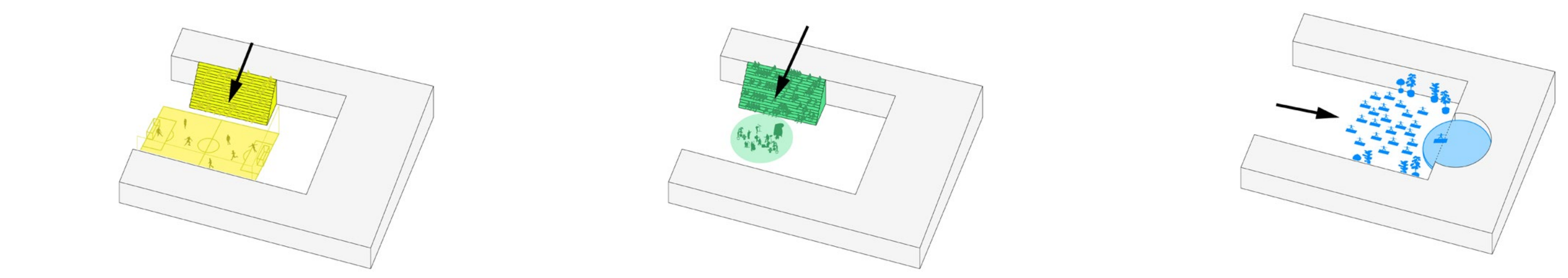

covered sports field

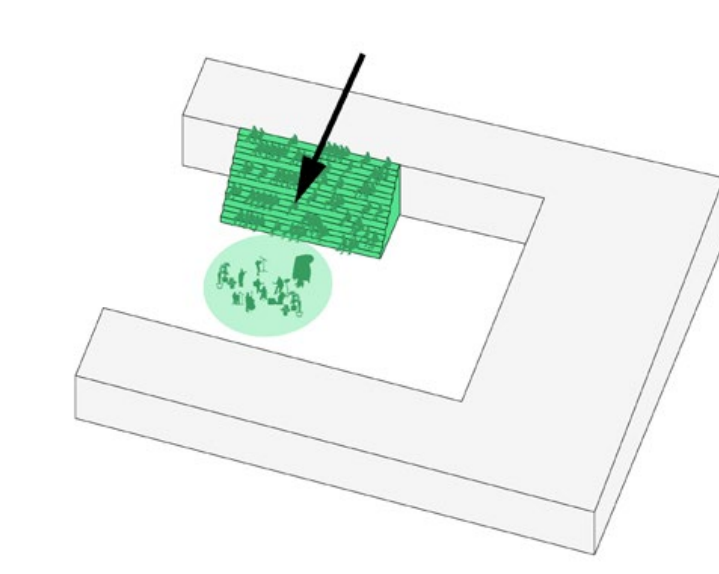

tribune concert

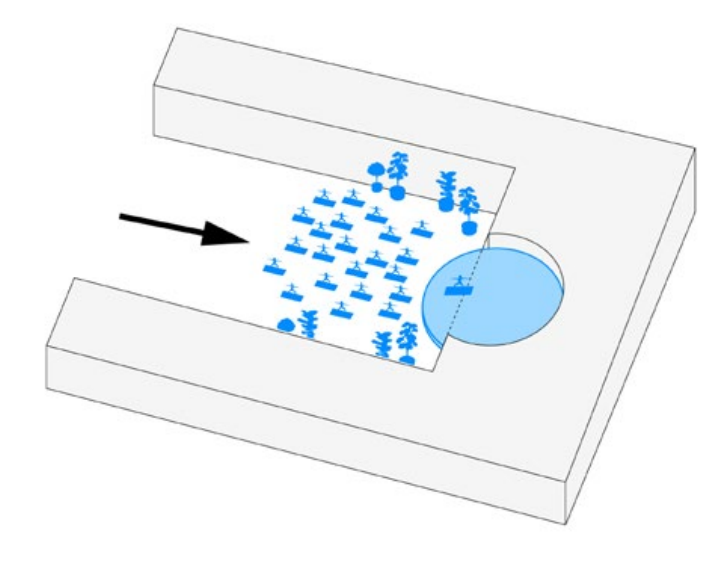

outdoor yoga class

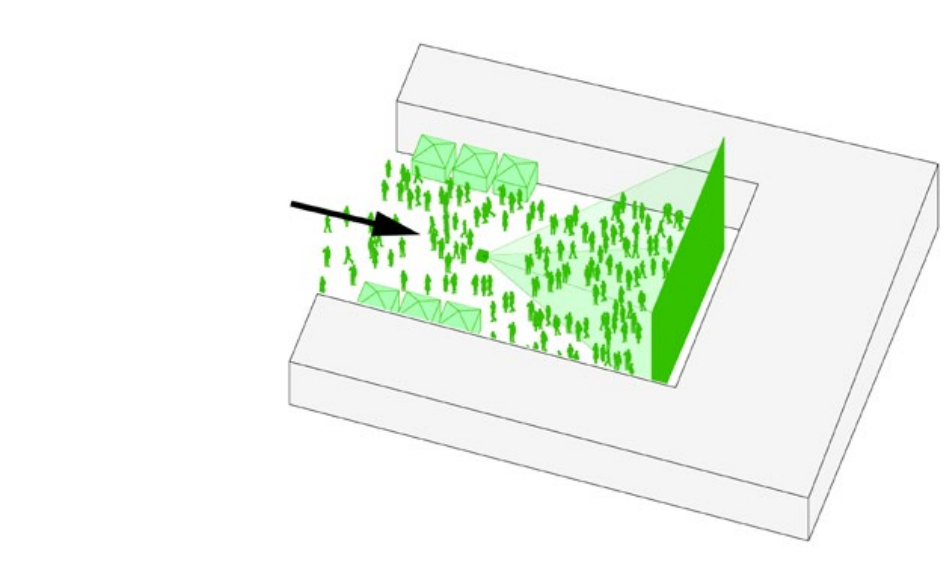

live football

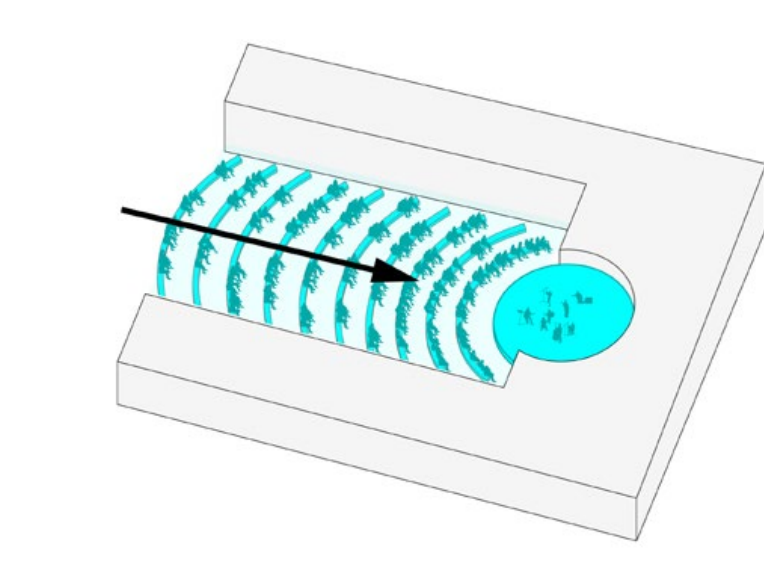

classical concert

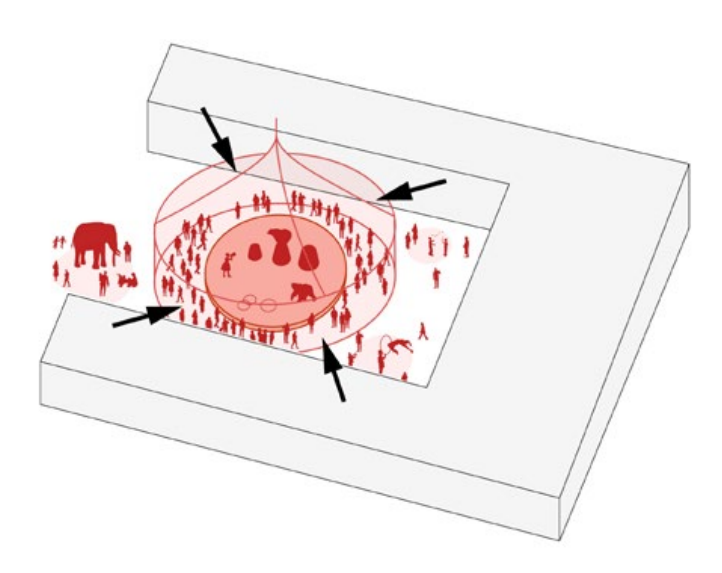

circus tent

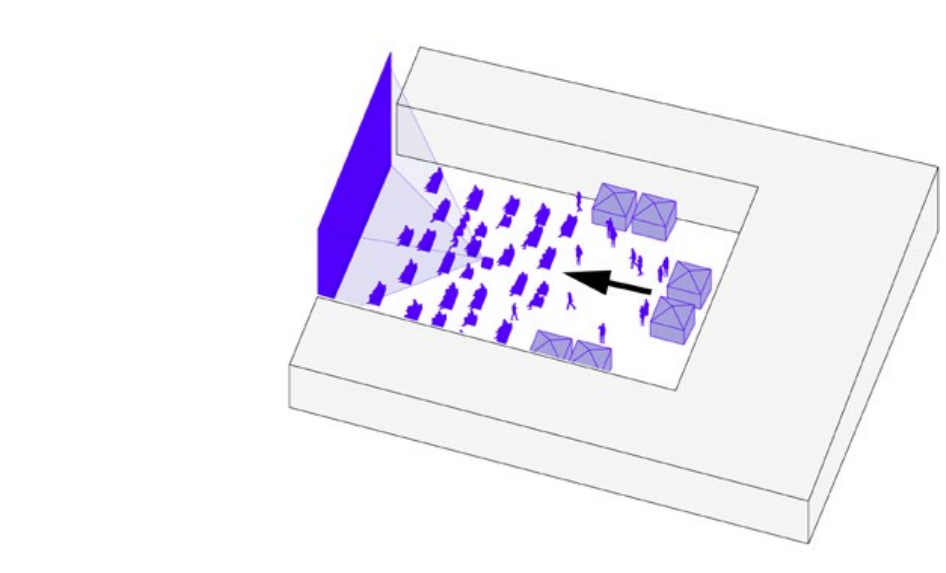

open-air cinema screening

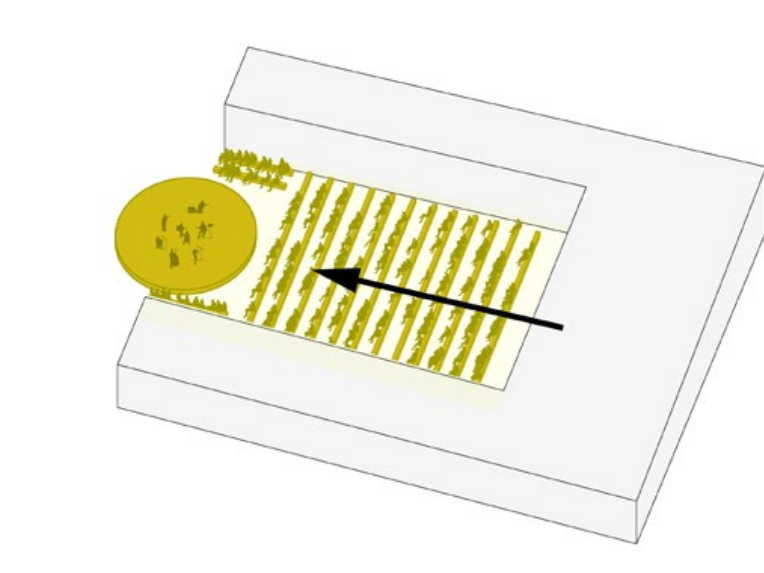

guerilla truck concert

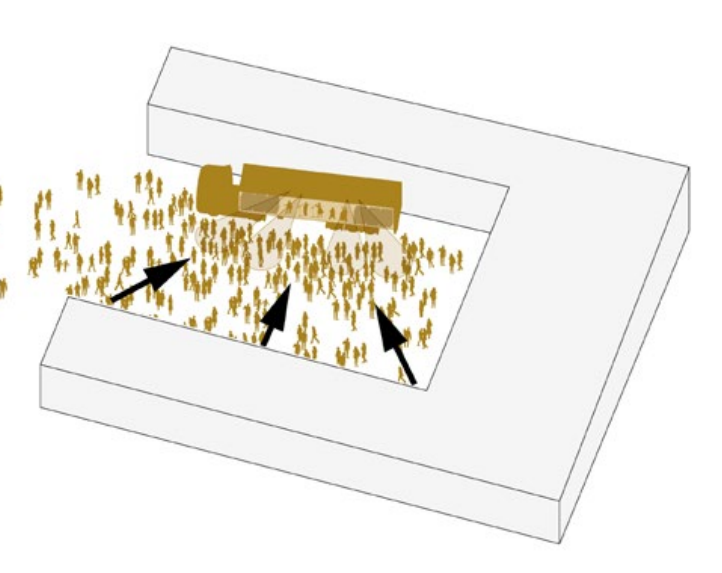

guerilla truck concert

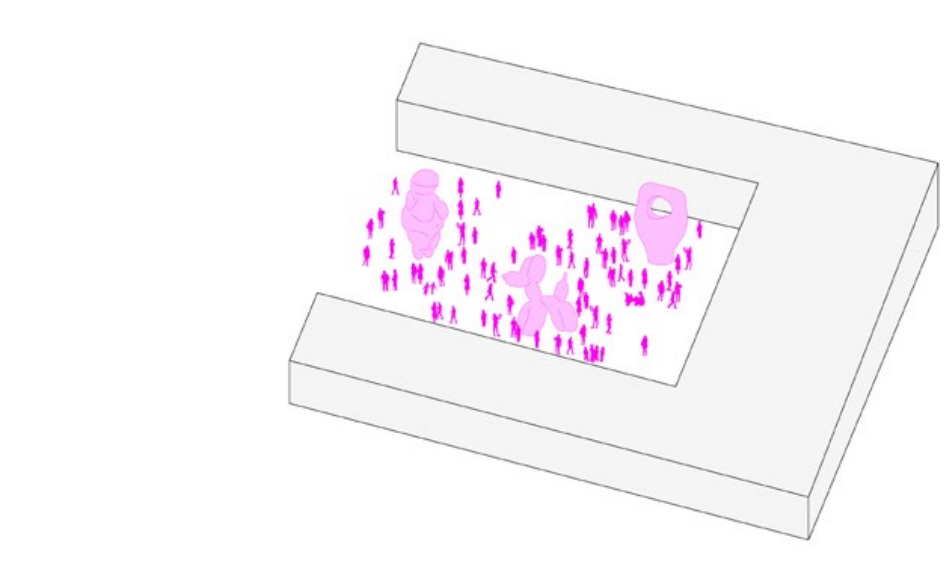

sculpture garden

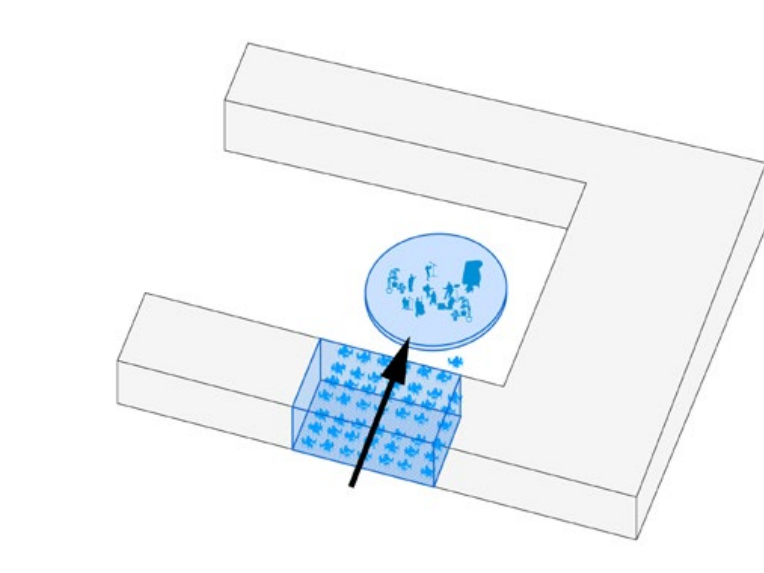

extended café concert

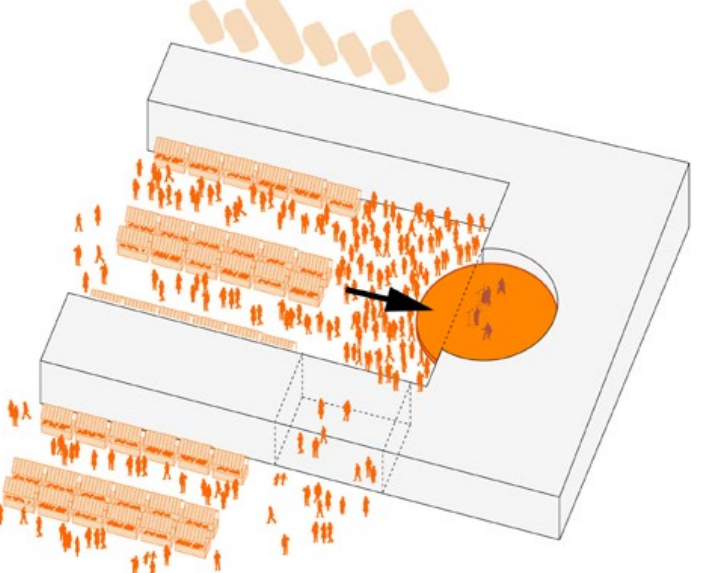

weekend market

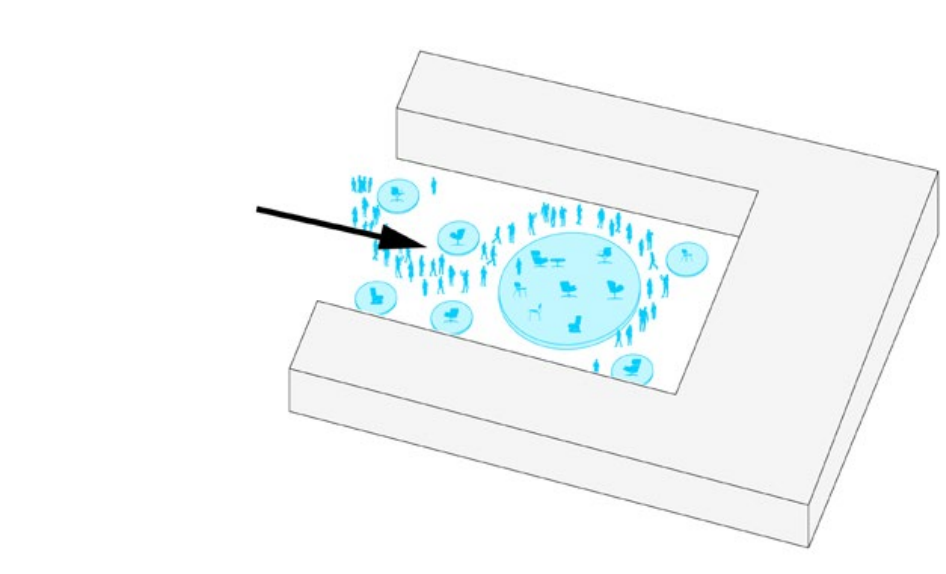

design fair & market

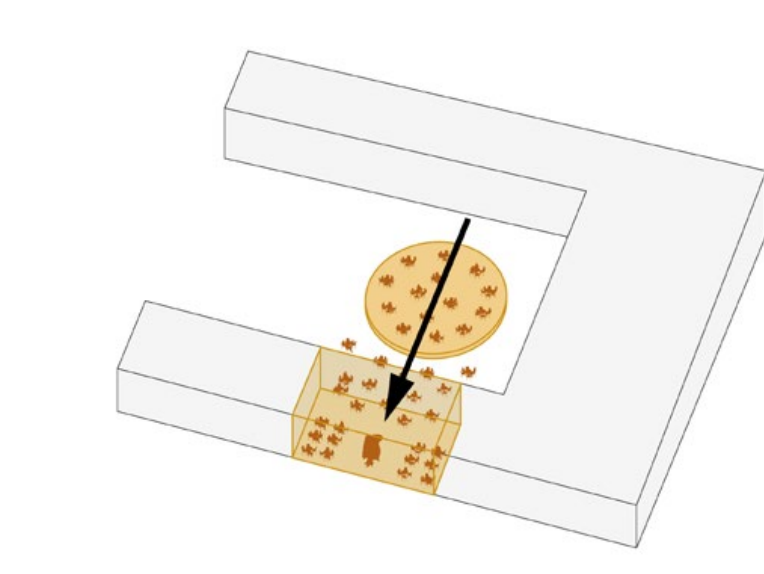

reverse café concert

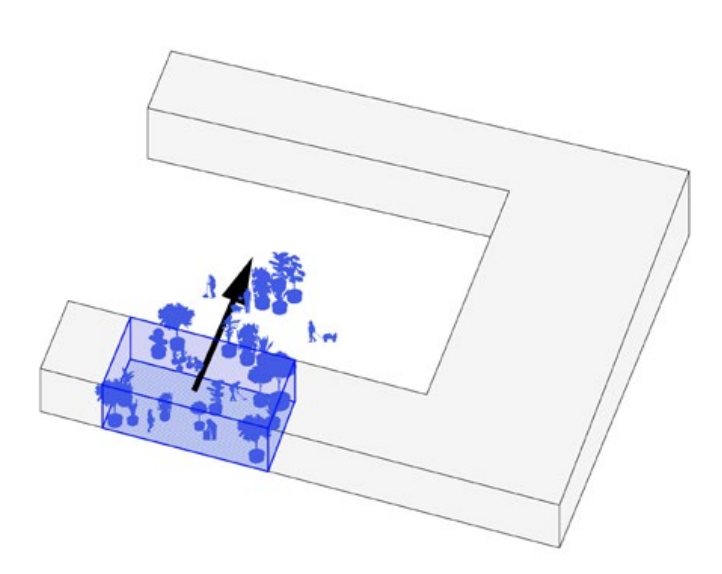

future park workshop

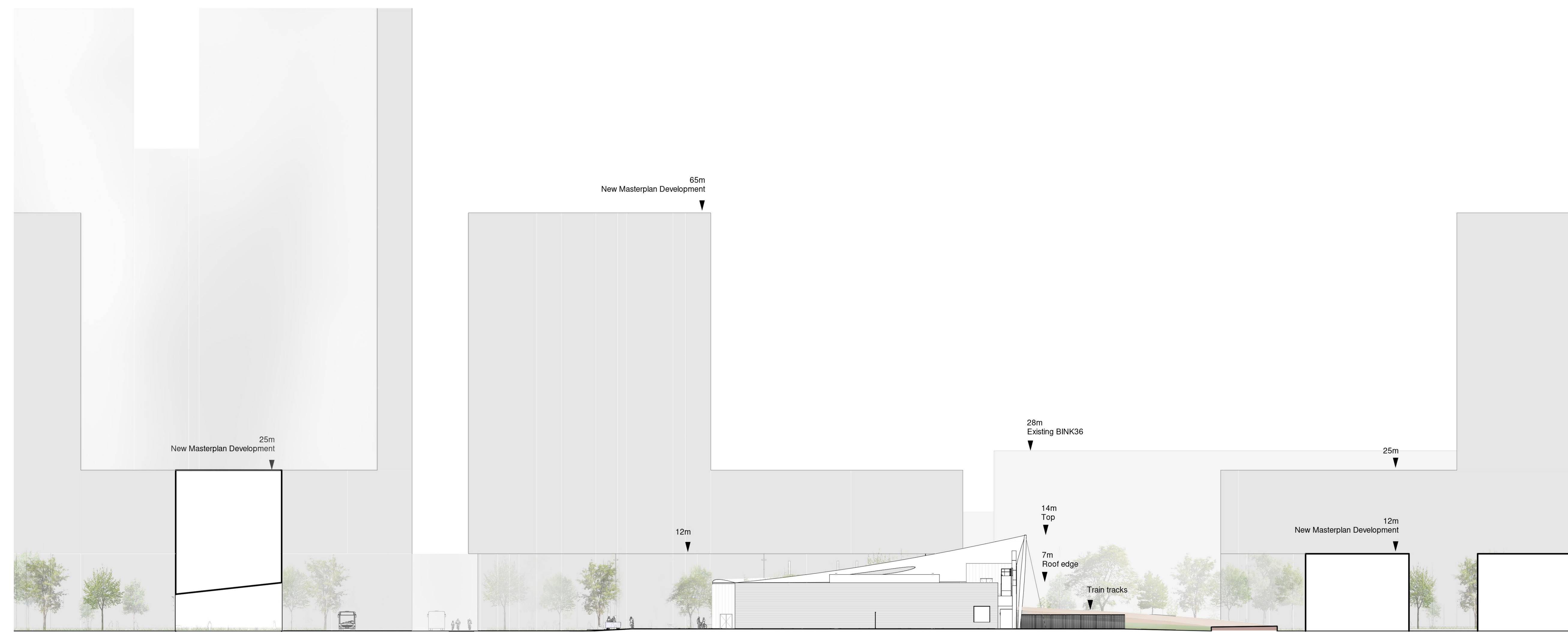

Contextual East section 1:500

PROGRAM AS FORM

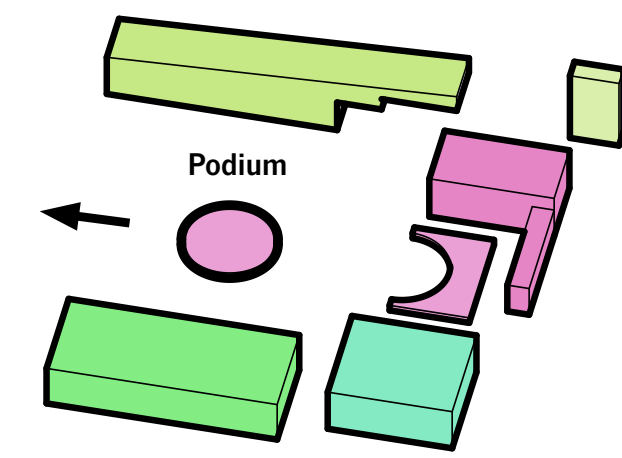
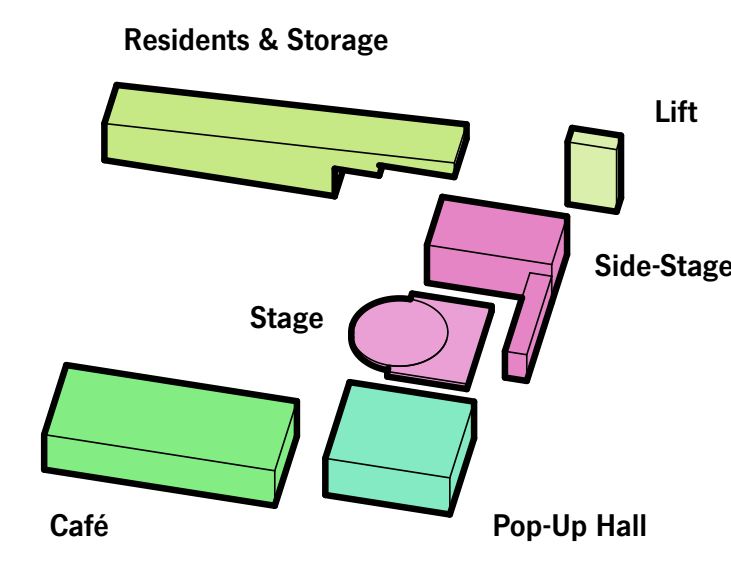
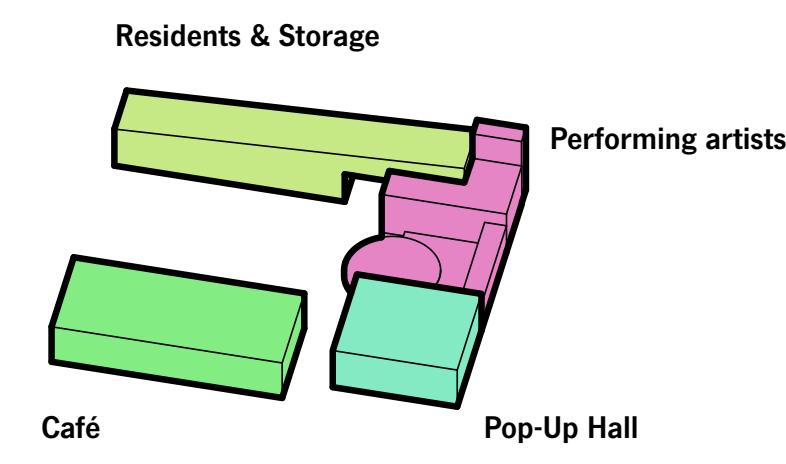

VIEW INTO A BUSY SUMMER DAY ON THE SOUTH FACADE FRONT

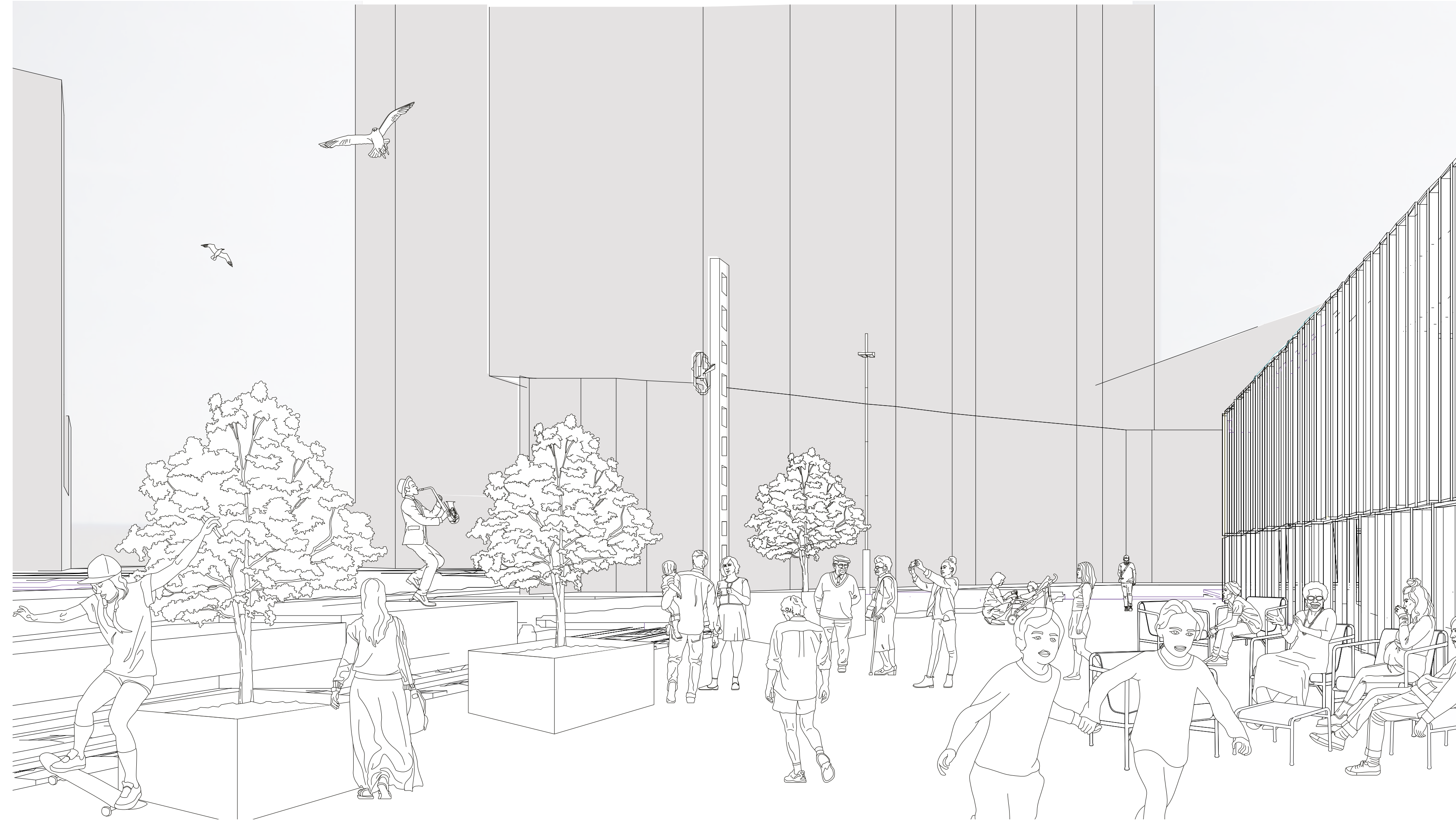

VIEW INTO A COURTYARD CONCERT SCENARIO

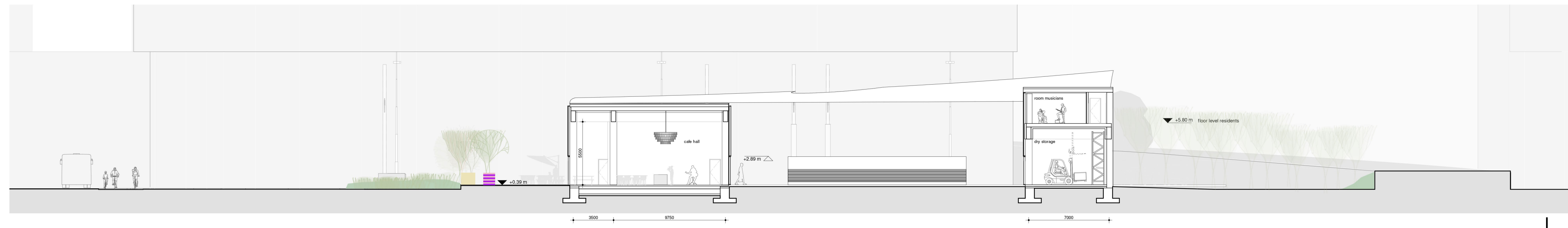
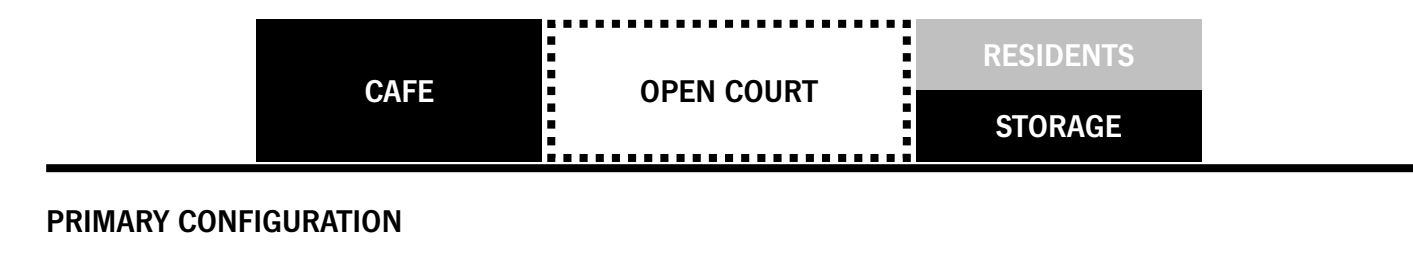

Cross section 1-1 through the café and resident wing 1:200

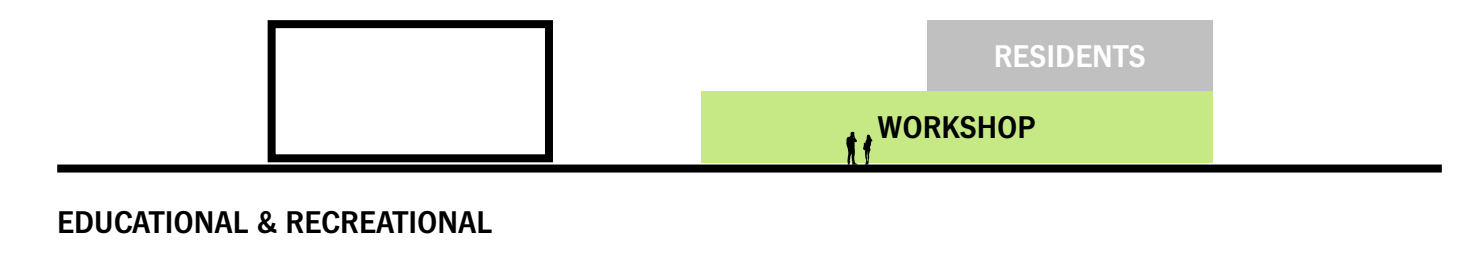
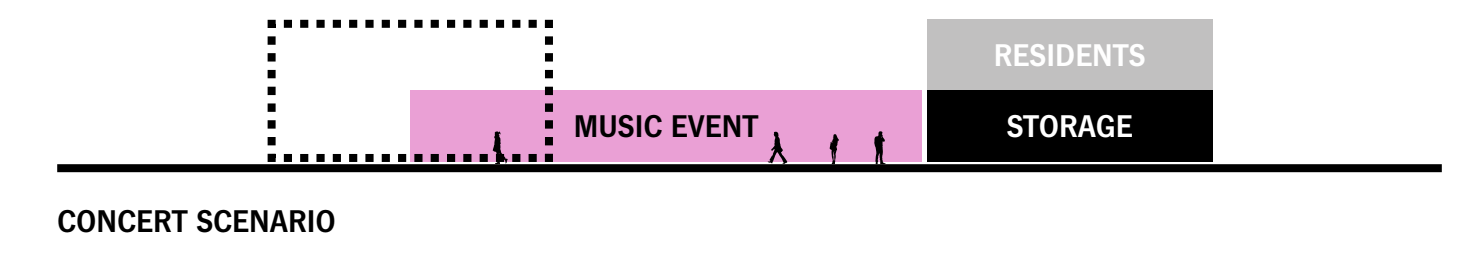

VIEW INTO THE CAFÉ HALL



VIEW INTO AN EXPERIMENTAL EVENT IN THE POP-UP HALL



VIEW FROM THE MUSICIAN'S ROOM ON FIRST FLOOR



CIRCULATION CHOREOGRAPHY

PRIMARY CIRCULATION SCHEME

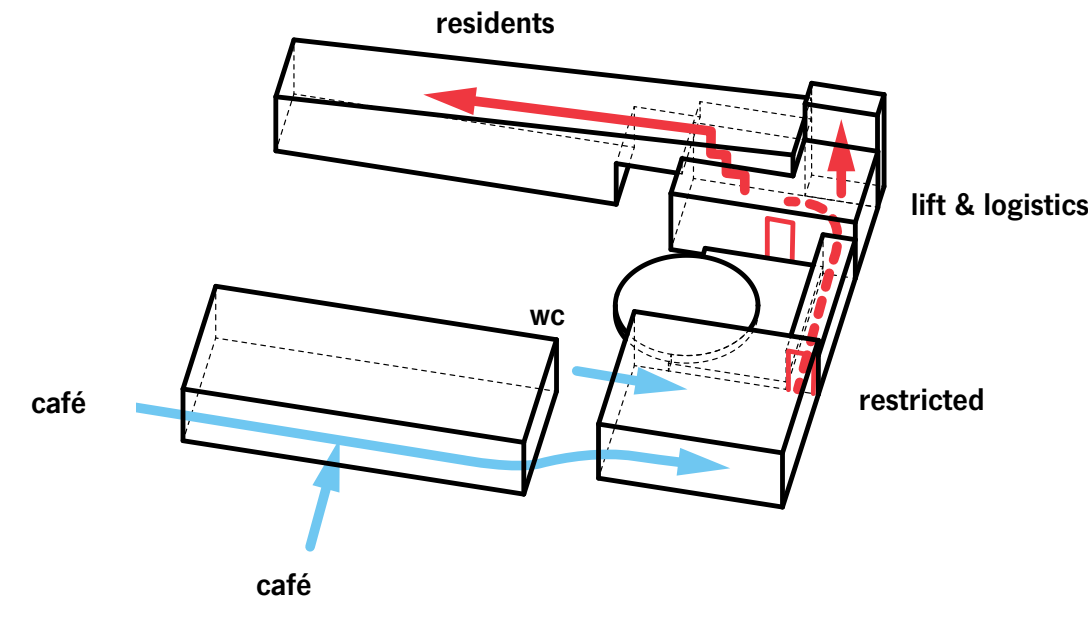

SUMMER SEASON SCENARIO

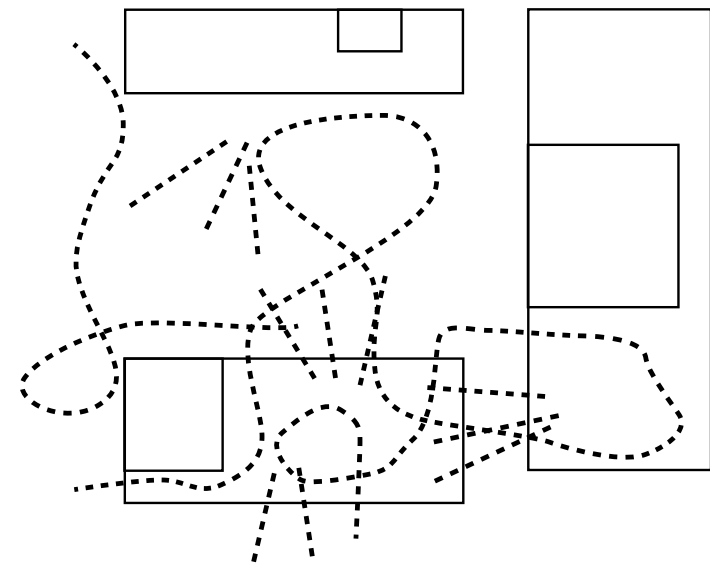

OFF-SEASON SCENARIO

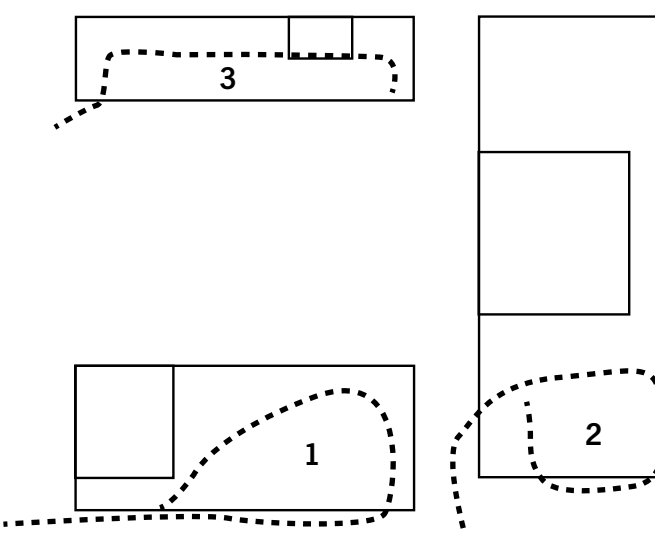

FUTURE PROOF LOGISTICS DIMENSIONS

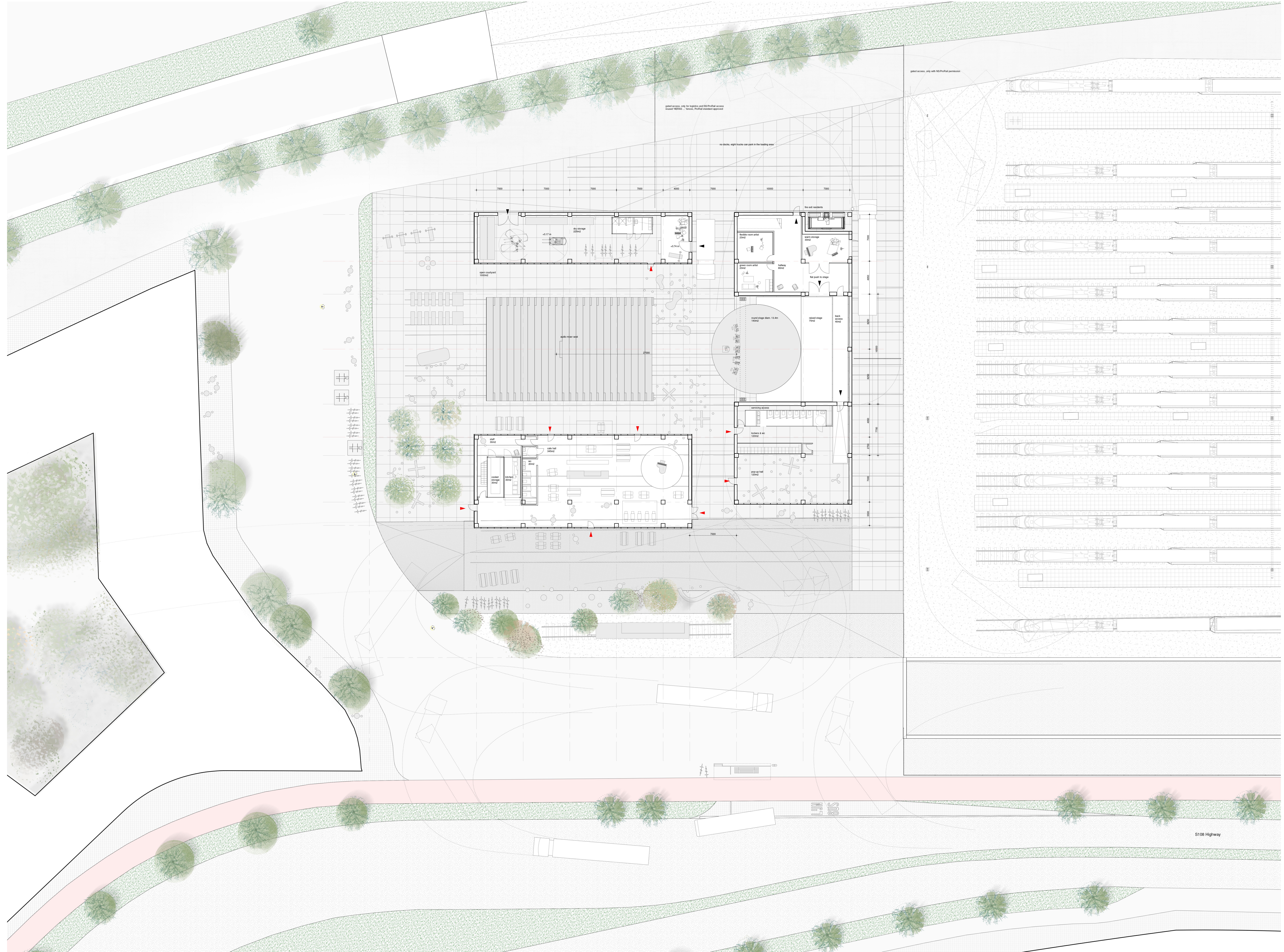
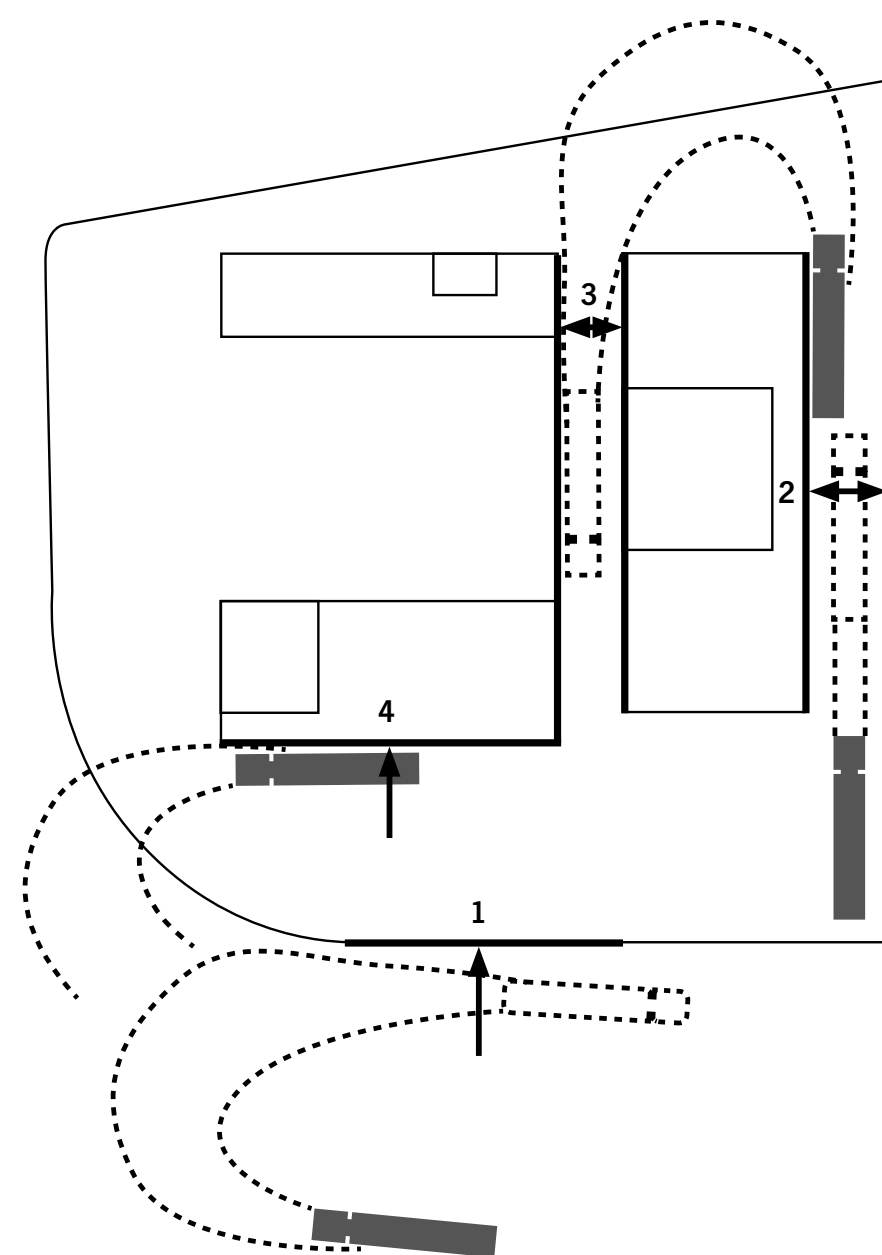

Ground floor plan 1:200

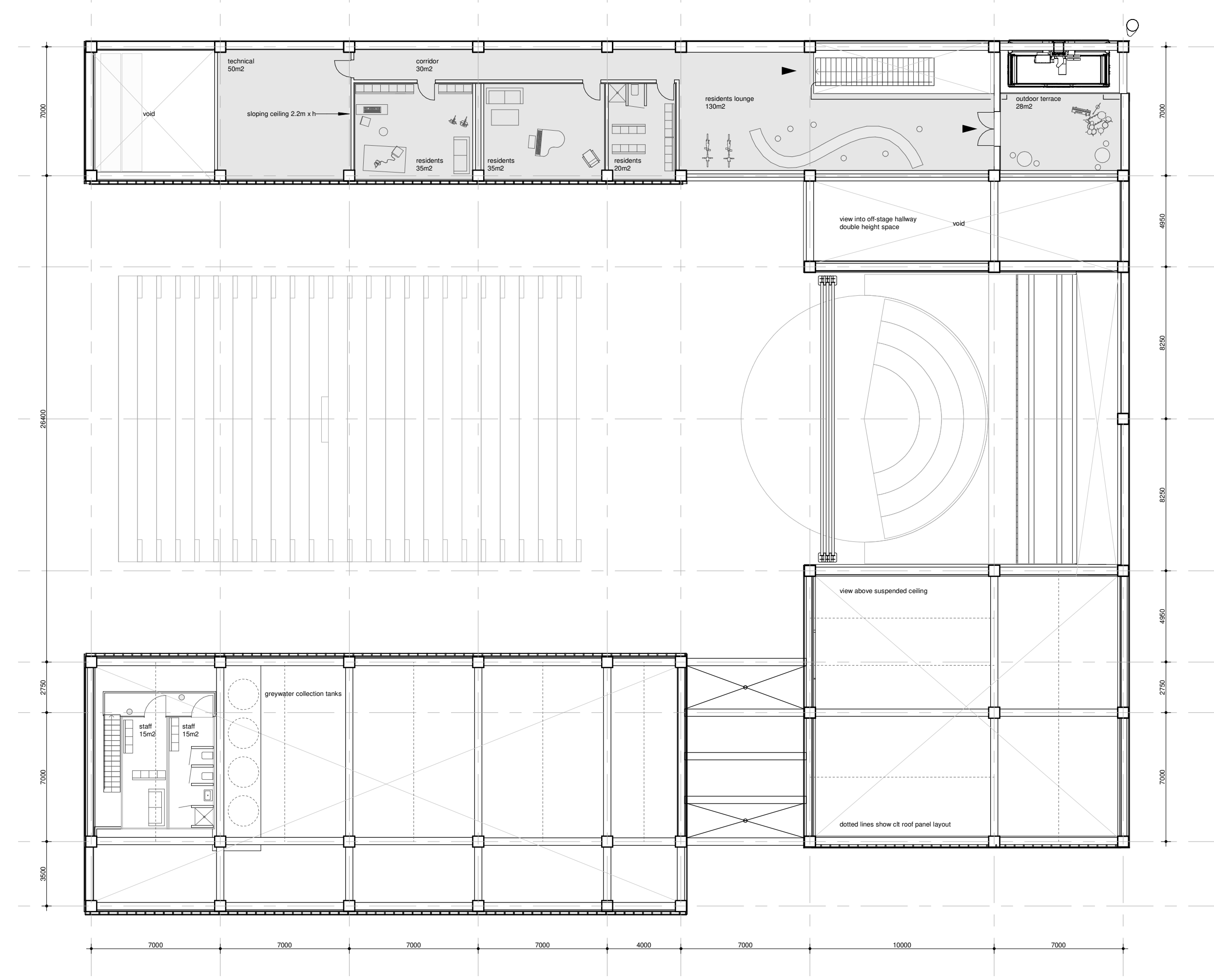

First floor plan 1:200

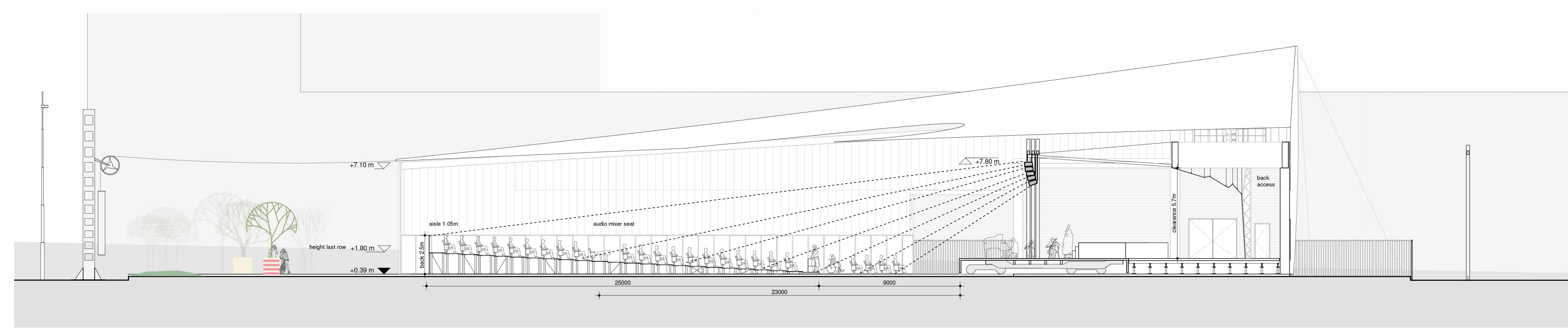

Long section B-B through the courtyard 1:200

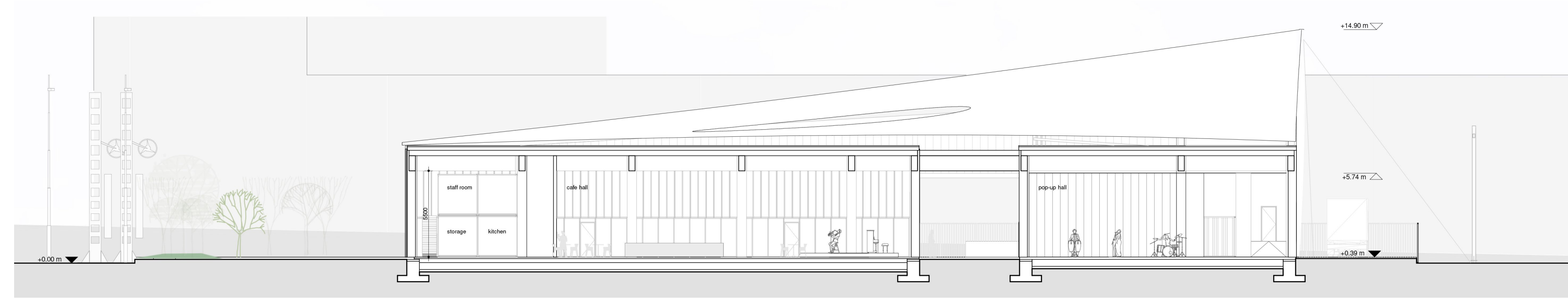

Long section A-A through the café and pop-up hall 1:200

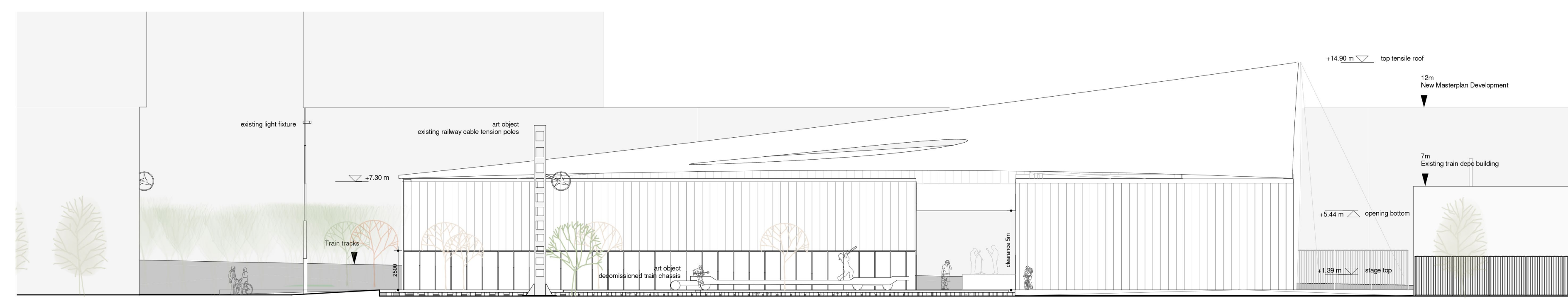

South facade 1:200

ARCHITECTURAL AMBITION: SEAMLESS TRANSITIONS BETWEEN INSIDE-OUT AND INVISIBLE CONNECTIONS OF MATERIALS

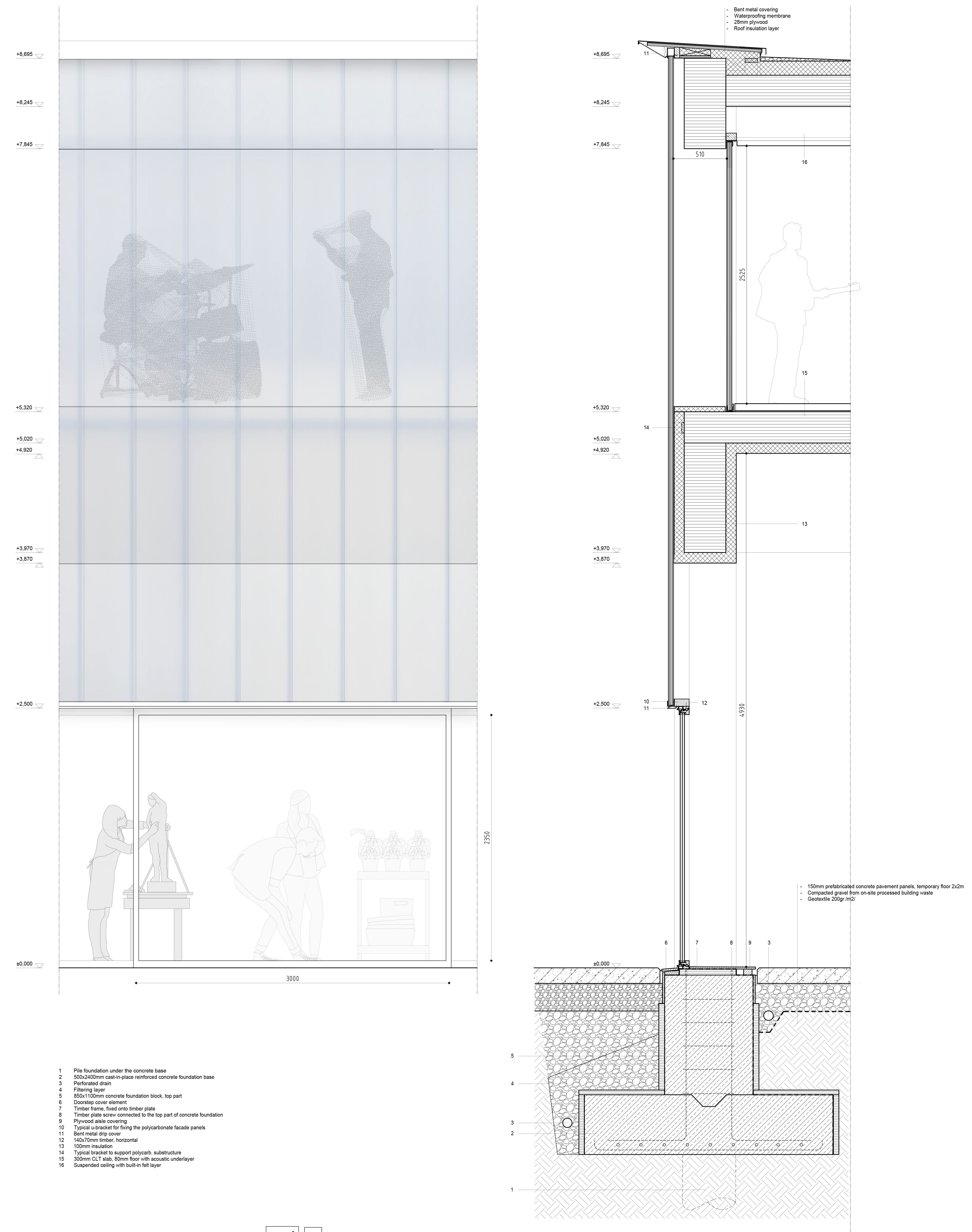

Fragment section through the courtyard facade 1:20

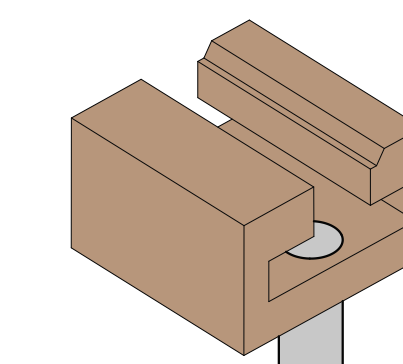

1. Pile foundation & existing soil

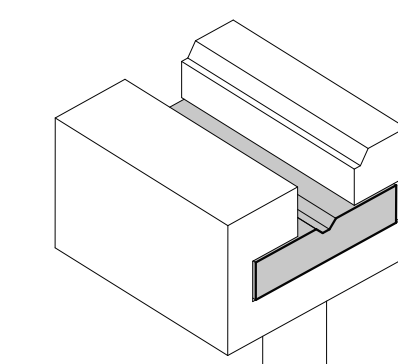

2. Cast-In-Place foundation base

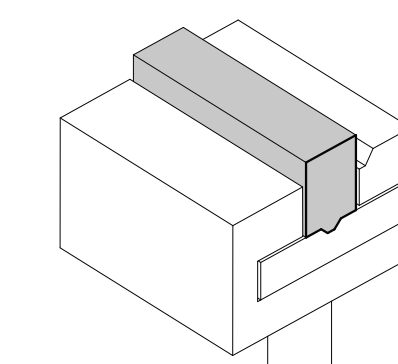

3. Prefabricated foundation top

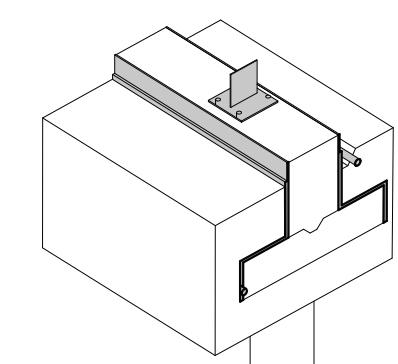

4. Membrane, drainage and steel connector

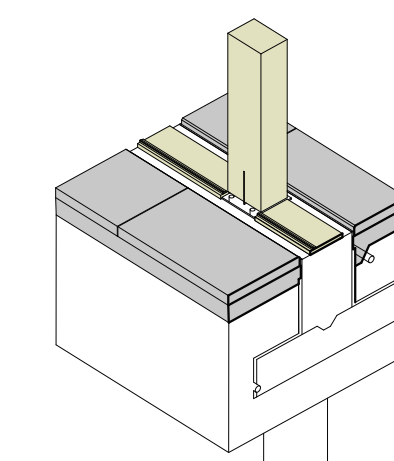

5. Prefab timber elements

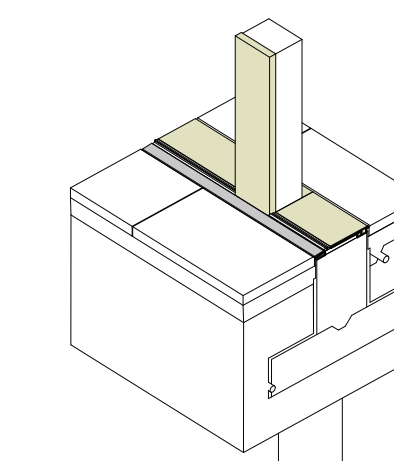

6. Prefab covers

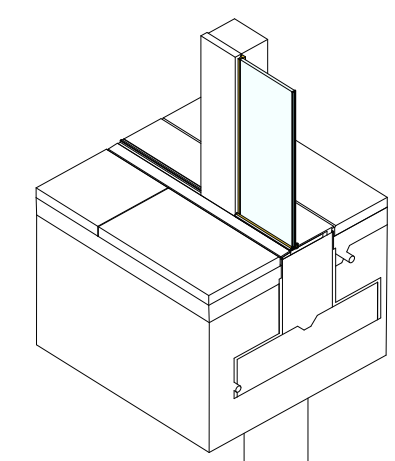

7. Sliding frame connected to prefab timber element

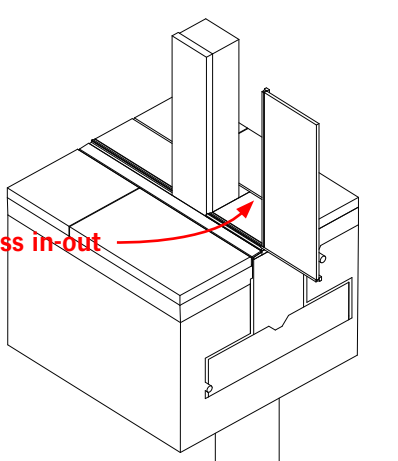

seamless in-out



A VIBRANT CATALYST PAVILION WITH CONCENTRATION ON MUSICAL VARIETY



View from the S108

FLEXIBILITY OF USAGE & MANIPULATION OF PERFORMANCE SCALE

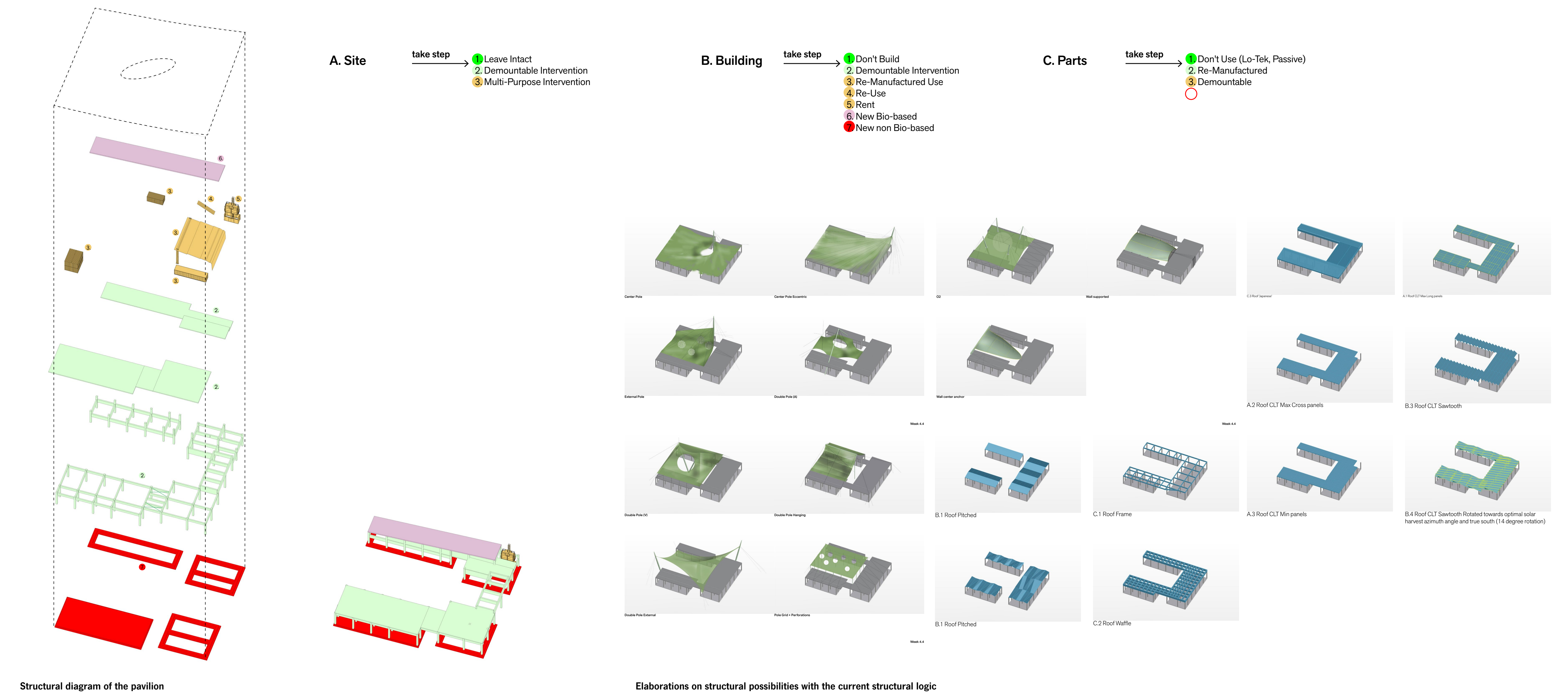

STRUCTURAL AUTONOMY BETWEEN ELEMENTS FOR MULTIPLICITY OF USE

