

THE TEMPORARY CITIZEN

*and the implications of the next
mode of energy in Vlissingen*

*Graduation Anouk Klapwijk
29-06-2017*

*Supervised by:
M. Emmerik
V. Munoz Sanz*







Metrocosm.com: global-immigration-map

DESIGN AS POLITICS PRESENTS
A CITY OF COMINGS AND GOINGS
DESIGNING FOR MIGRATION AND MOBILITY
GRADUATION STUDIO 2017/2018



“How can we design buildings, cities and landscapes that make the best of our restless, migratory, lives?”

DESIGN AS POLITICS

Design as Politics



Increase of mobility of individuals
Increase of labour migration

LABOUR MIGRATION: ENERGY SECTOR

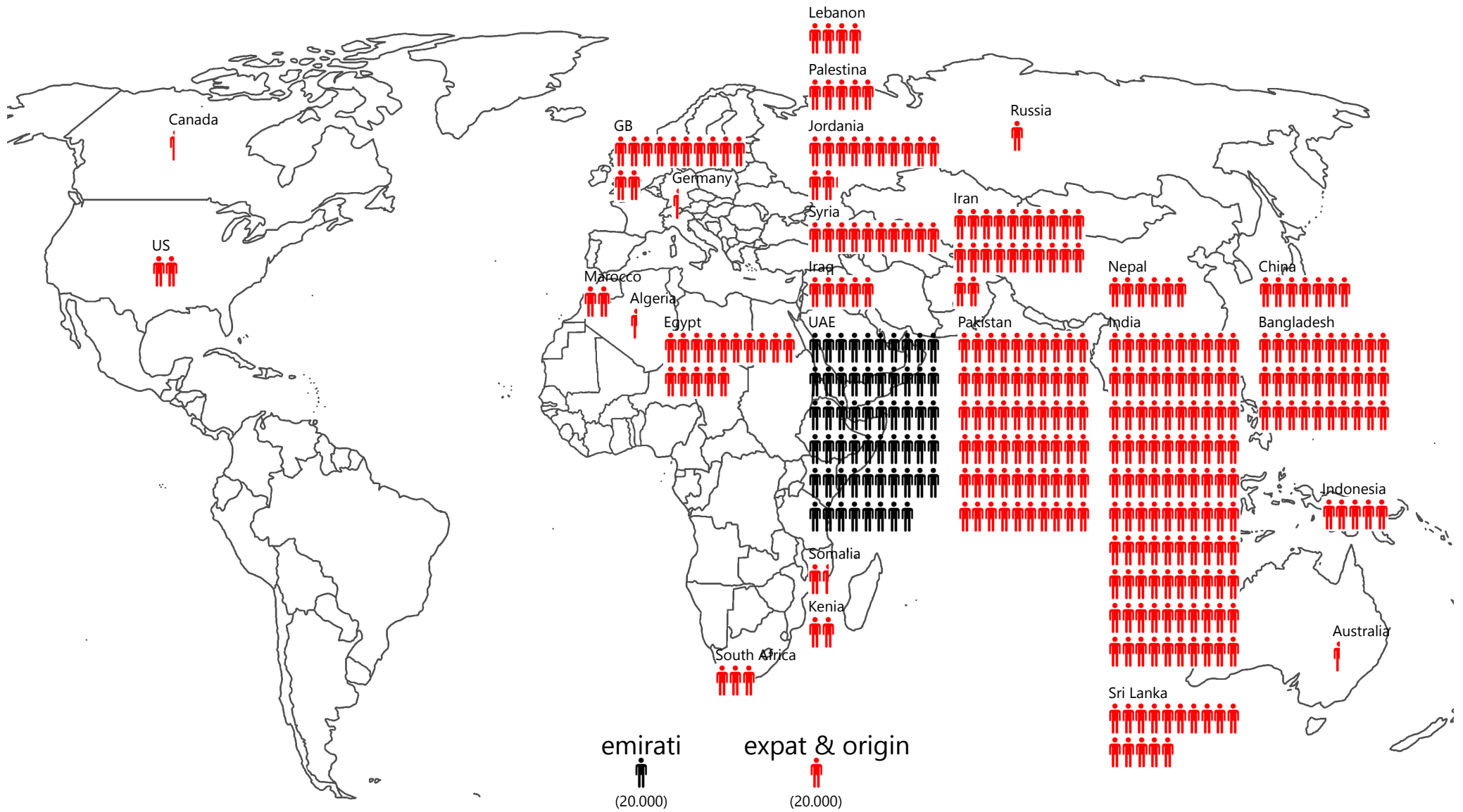

URBAN DESIGN: SHAPING CITIES



One and Only Resorts



SNC Lavalin

ENERGY SECTOR: TRANSITION



TWO TRENDS



Increase of mobility of individuals
Increase of labour migration

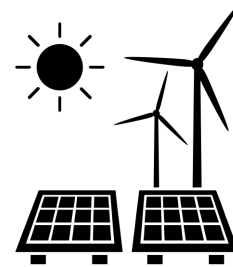

Shifting the focus to renewable
energy resources & northern Europe

CONTEXT



world



Netherlands



region



port & city



city



urban fabric



smallest urban scale

CONTENT



world



Netherlands



region



port & city



city



urban fabric



smallest urban scale

TWO TRENDS IN THE DUTCH CONTEXT



Increase of mobility of individuals
Increase of labour migration

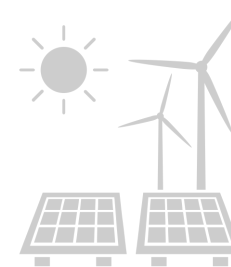

Shifting the focus to renewable
energy resources & northern Europe

SPATIAL IMPLICATIONS



Polendorp, Volkskrant

POLENDORP

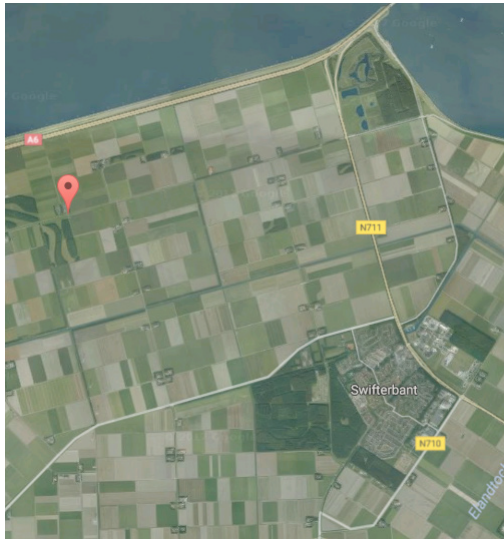

Location: in the middle of nowhere

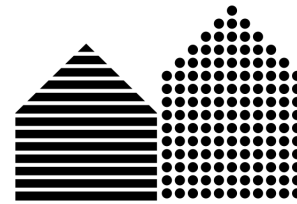

No foundations: to make it disappear quickly



No services, shops, restaurants

It's all about work!

IDEA OF THE COMPANY TOWN



Pullman, Illinois • 1895

Pullman

IDEA OF THE COMPANY TOWN

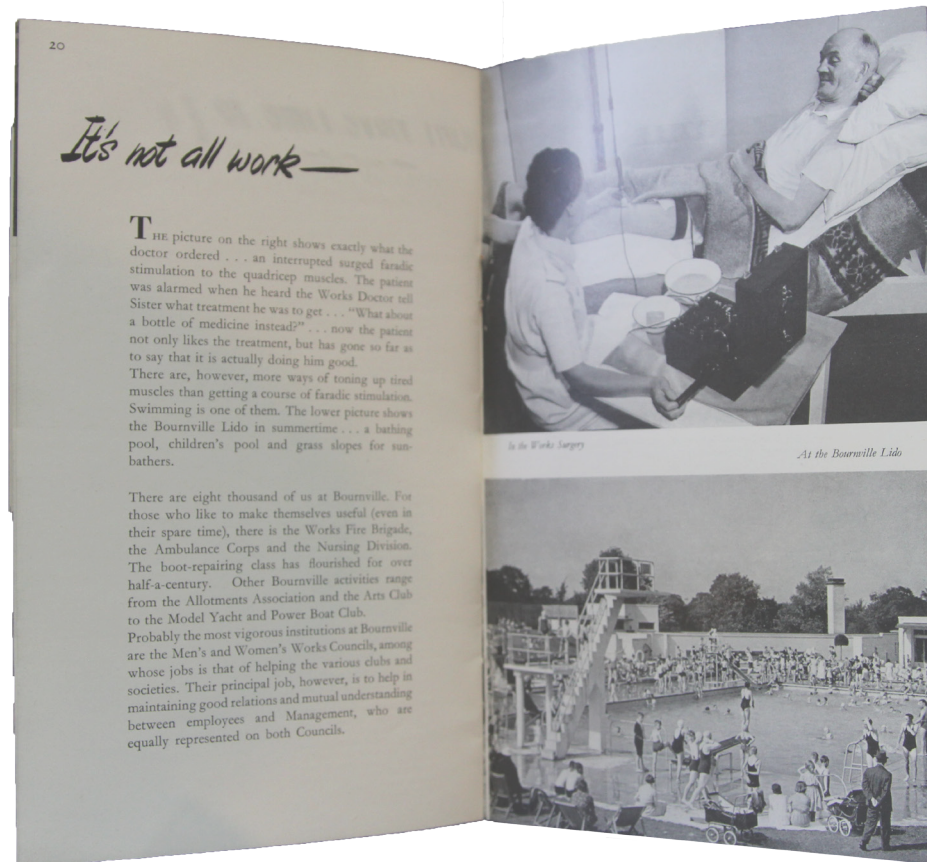

It's not all work

20

THE picture on the right shows exactly what the doctor ordered . . . an interrupted surged faradic stimulation to the quadricep muscles. The patient was alarmed when he heard the Works Doctor tell Sister what treatment he was to get . . . "What about a bottle of medicine instead?" . . . now the patient not only likes the treatment, but has gone so far as to say that it is actually doing him good. There are, however, more ways of toning up tired muscles than getting a course of faradic stimulation. Swimming is one of them. The lower picture shows the Bournville Lido in summertime . . . a bathing pool, children's pool and grass slopes for sun-bathers.

There are eight thousand of us at Bournville. For those who like to make themselves useful (even in their spare time), there is the Works Fire Brigade, the Ambulance Corps and the Nursing Division. The boot-repairing class has flourished for over half-a-century. Other Bournville activities range from the Allotments Association and the Arts Club to the Model Yacht and Power Boat Club. Probably the most vigorous institutions at Bournville are the Men's and Women's Works Councils, among whose jobs is that of helping the various clubs and societies. Their principal job, however, is to help in maintaining good relations and mutual understanding between employees and Management, who are equally represented on both Councils.

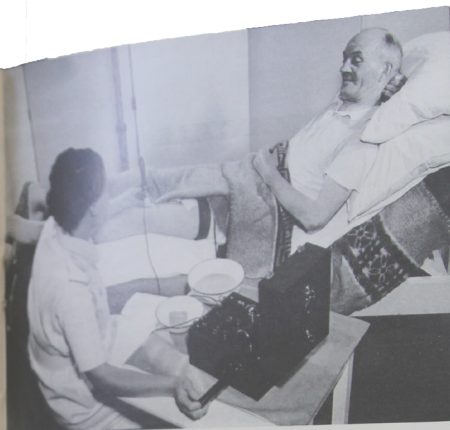

In the Works Surgery

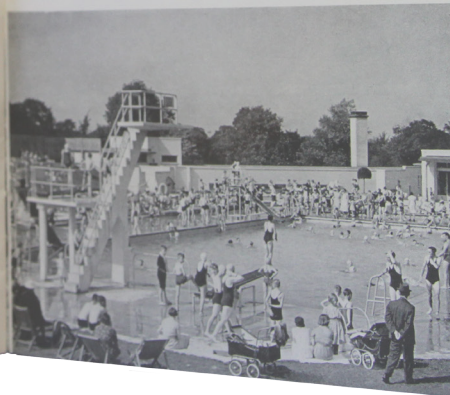

At the Bournville Lido

Bournville: a village to the world's largest cocoa and chocolate

It's not all work!

LEAVING A LEGACY



Northern Soul.uk

WHO'S BENEFIT?



WHO'S BENEFIT?

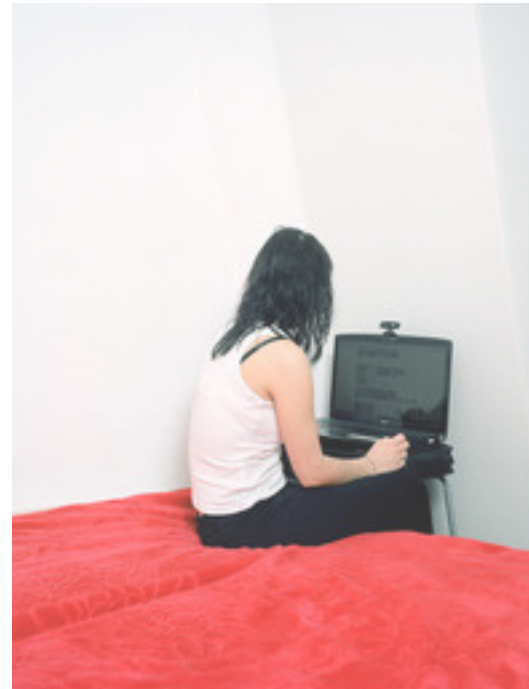

Social exclusion?



Urban upgrade?

TWO TRENDS IN THE DUTCH CONTEXT



Increase of mobility of individuals
Increase of labour migration

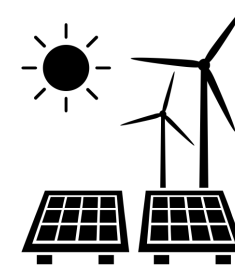

Shifting the focus to renewable
energy resources & northern Europe

ENERGY TRANSITION



THE NEW DUBAI?



What if we could benefit from the comings and goings of people?

How could we use it for local urban change instead of aiming for 'invisibility'?

CHALLENGE

To catalyze long term improvements for the local population, while servicing and improving the conditions for the temporary citizens.

To make the global factors of energy and migrant workers comprehensible and visible.

CASE STUDY



BORSSELE

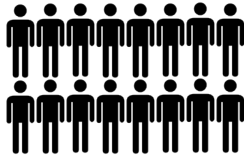
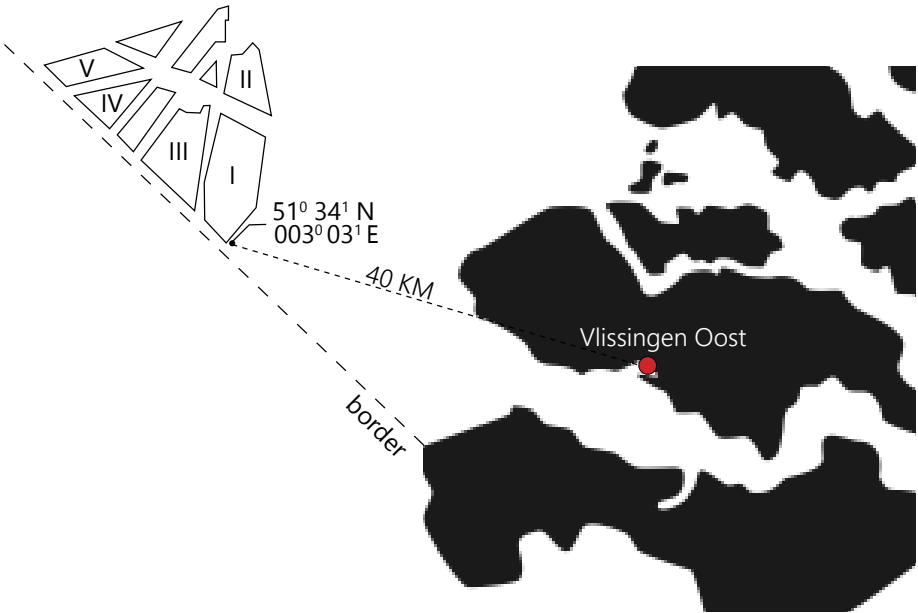

1600
construction phase



200
operation & maintenance



2016 - 2023

A COMINGS & GOINGS



 2016 - 2023



1: preparation of Borssele off site



2: preparation of Borssele on site



3: installation of the foundations and the transformer station



4: preparation of the wind turbines and blades



5: installation of the wind turbines and blades

VLISSINGEN



Vlissingse bode

VLISSINGEN

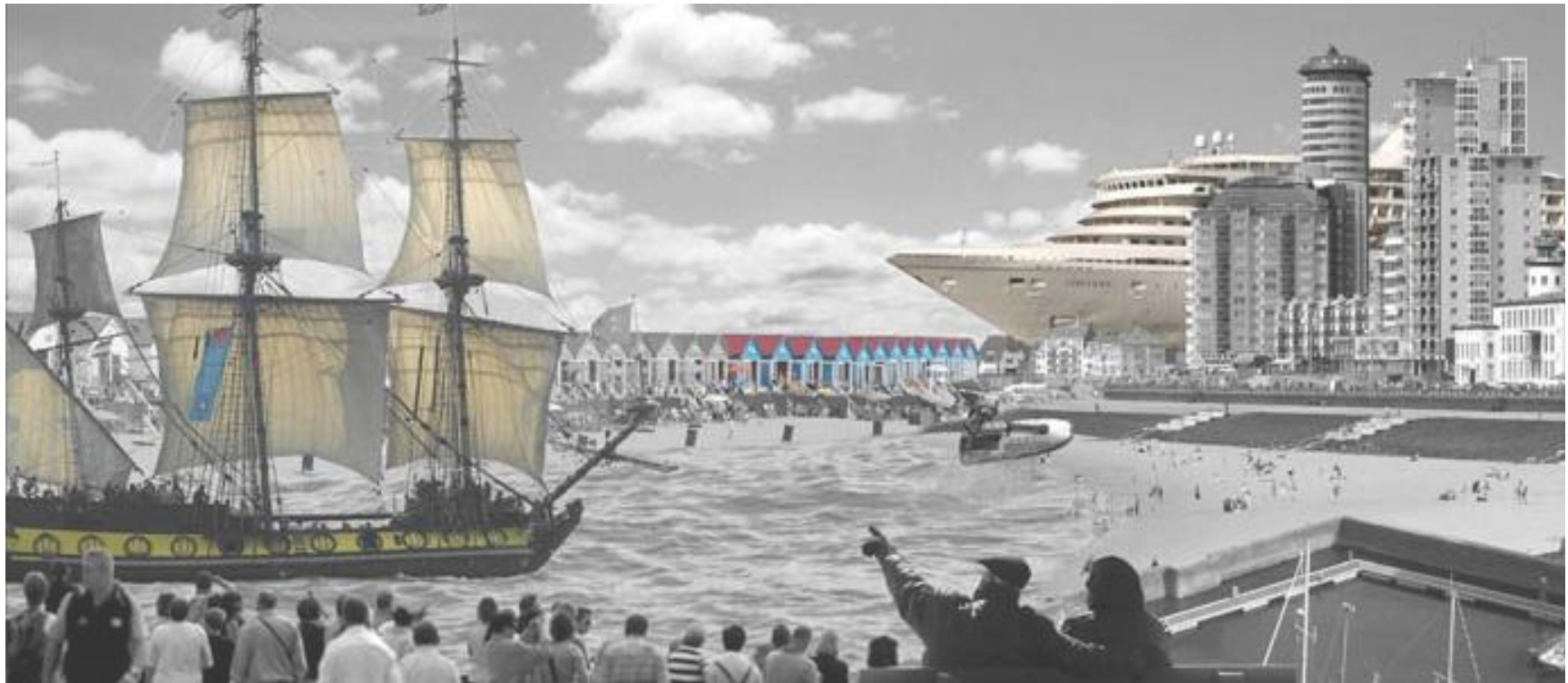

Municipality of Vlissingen

VLISSINGEN



VLISSINGEN

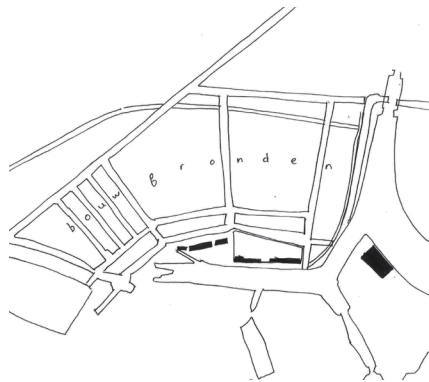

1886

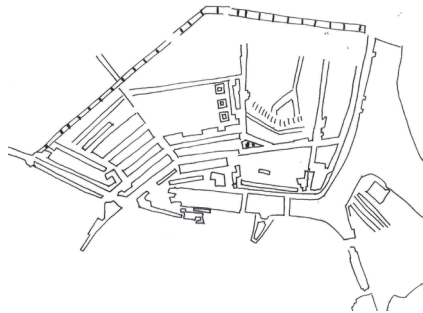

1910

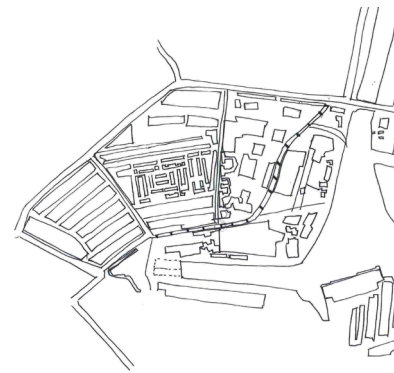

1950

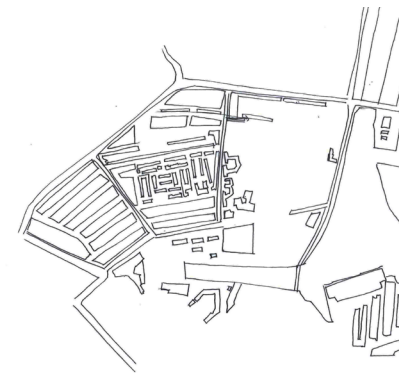

present

COMBINE?



COMBINE?



WIND FARM:
GLOBAL CITIZEN



VLISSINGEN:
LOCAL CITIZEN



REQUIREMENTS



GLOBAL CITIZEN



High skilled
Low skilled

Social exclusion



Collective

Practicalities



Accommodation

LOCAL CITIZEN



Student

Marine

Elderly

Tourist

2nd home owner

Port worker

Visible connection



Port

New activities



Maritime environment

STRATEGY



Insert a piece of urban program into the port.

LOCAL CITIZEN



CITY

GLOBAL POWERS



PORT

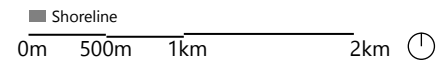

STRATEGY



Insert a piece of urban program into the port.

LOCAL CITIZEN



GLOBAL POWERS



CITY

PORT

LOCAL LIFE



GLOBAL CITIZEN



Insert the global migrant workers into the city.

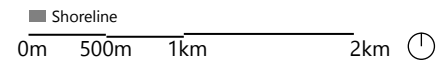

HOW TO START?

ANALYSIS



LOCATIONS



URBAN AREA: SCHELDETERRAIN



picture Ruben Oreel

SCALE?



Stella Maris (NL), 2016

400



De Bosruiter (NL), 2016

600



PATCHWORK URBANISM



Brent Ryan

URBAN AREA: SCHELDETERRAIN

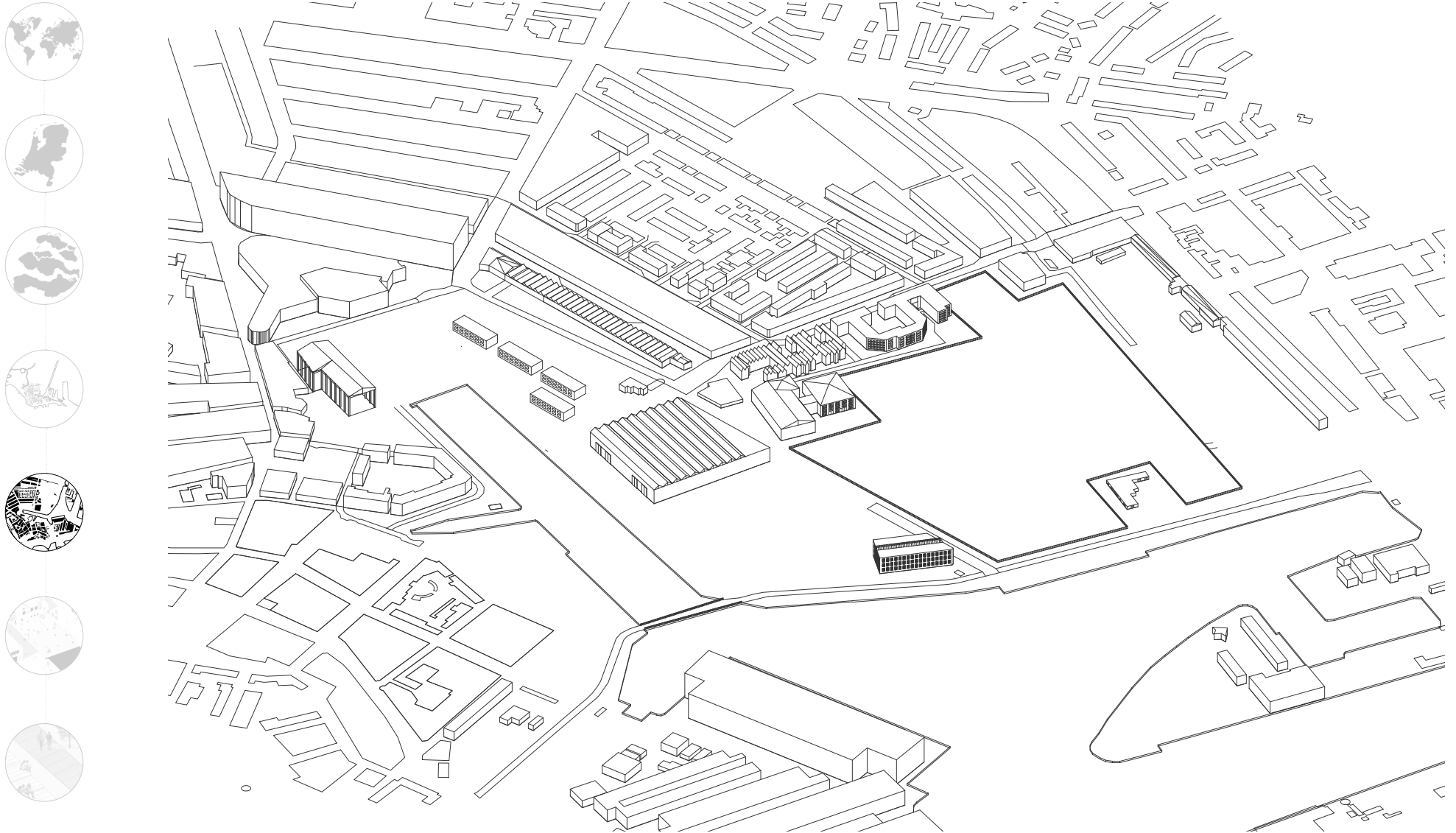

FOUR LOCATIONS

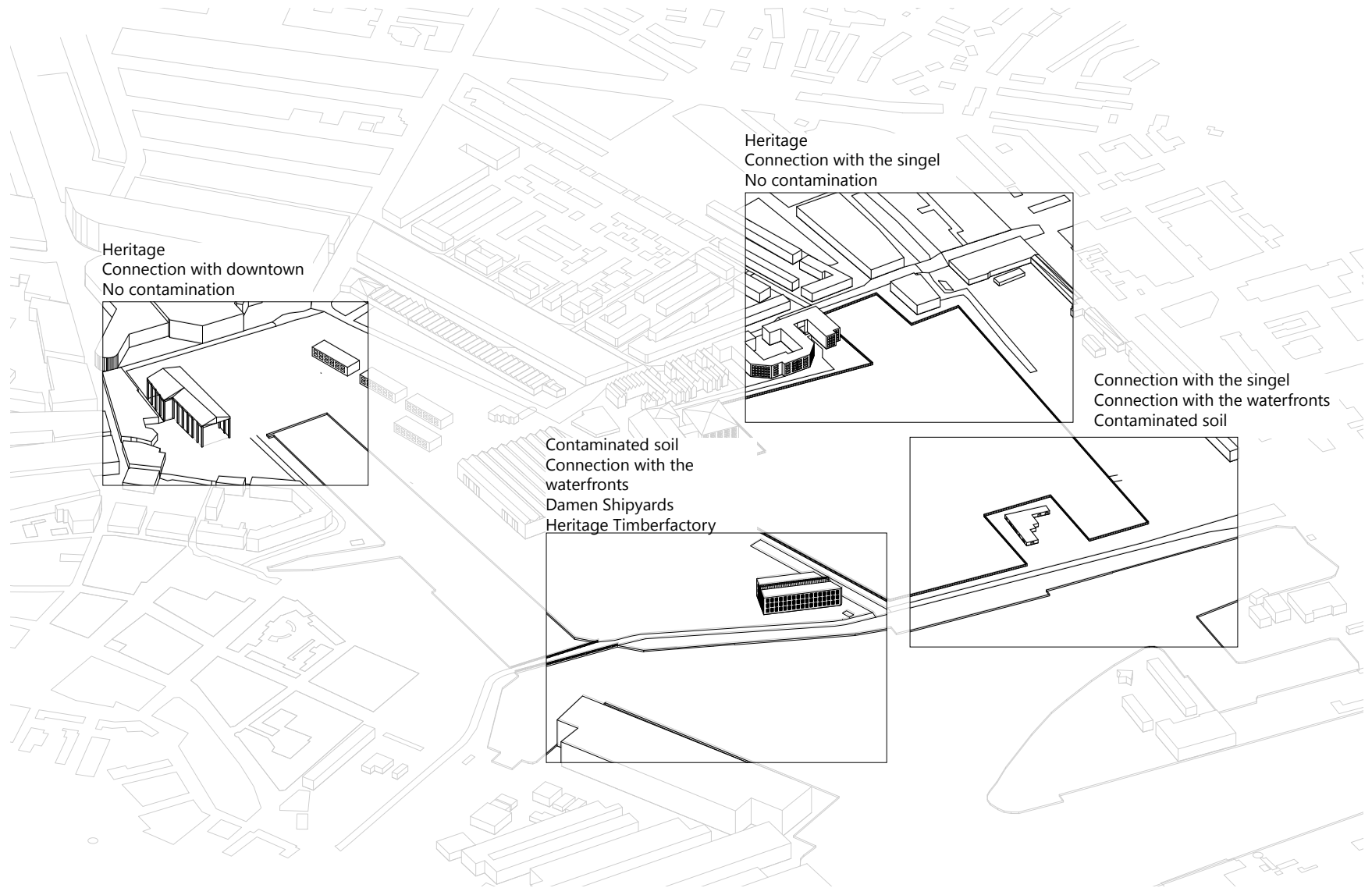

PROGRAM

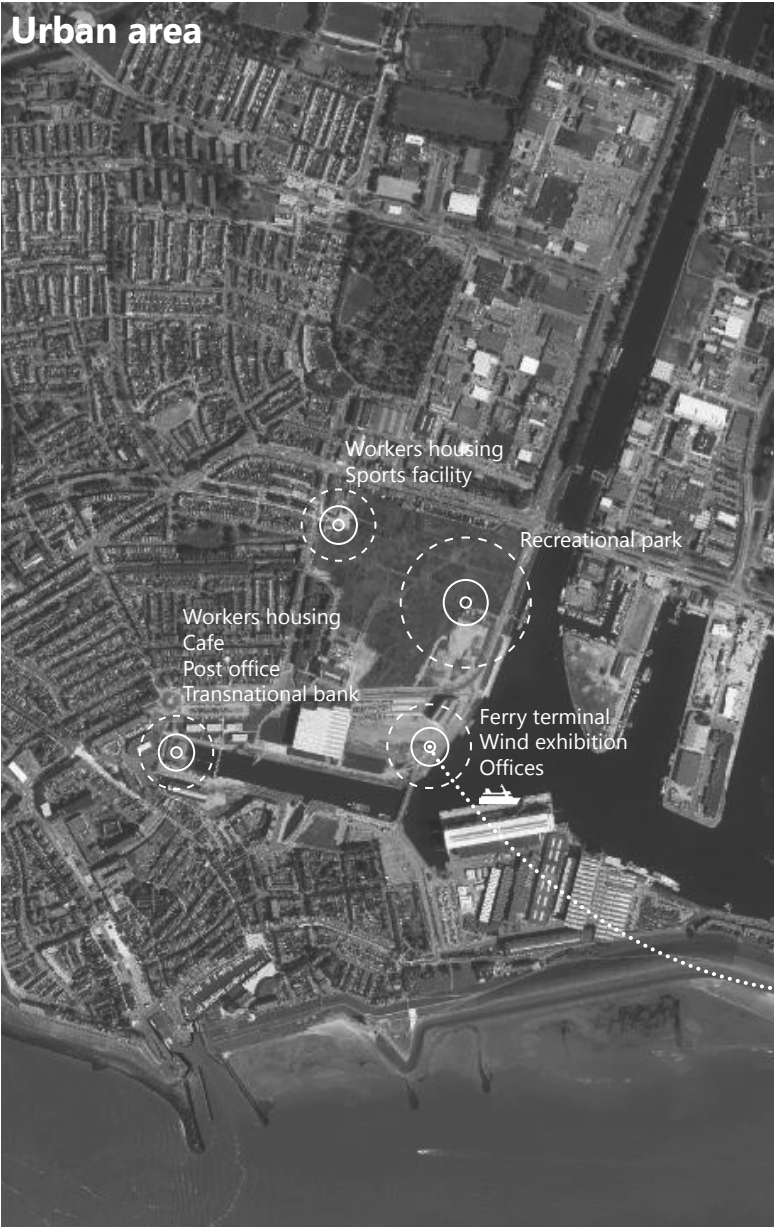

ONE LOCATION

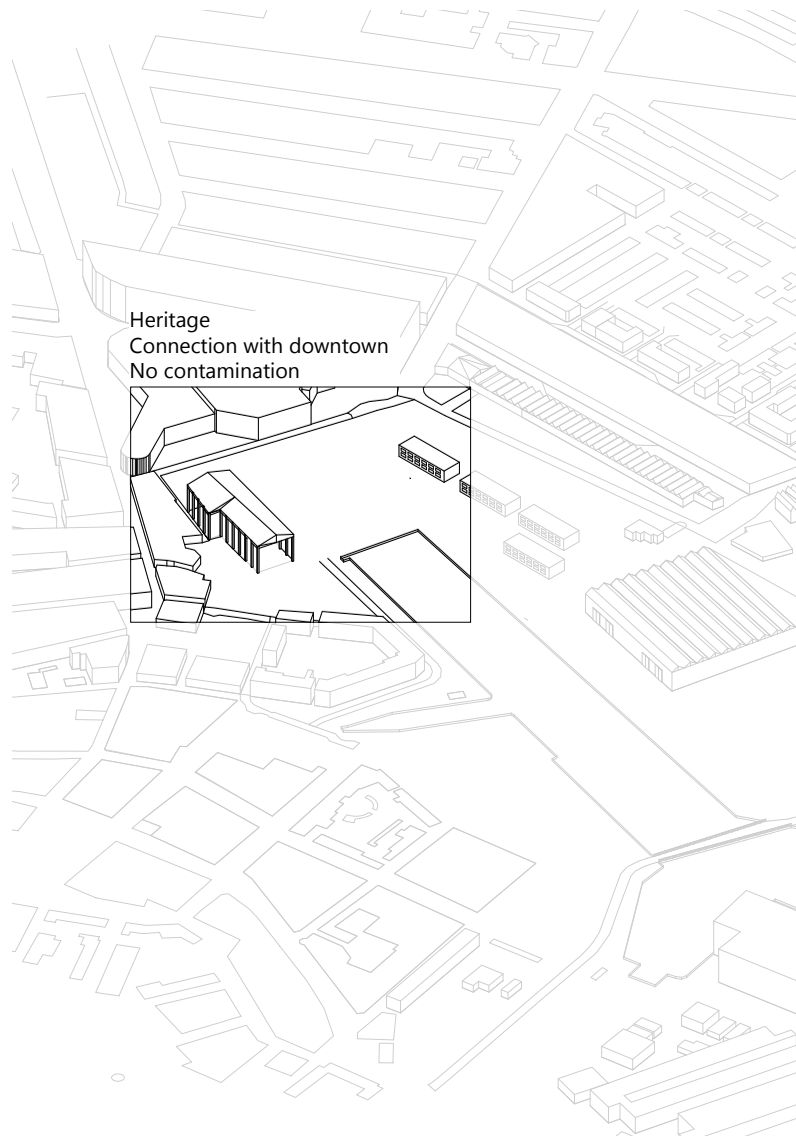

Heritage
Connection with downtown
No contamination



Urban area

Workers housing
Cafe
Post office
Transnational bank

'TEMPORARY' CITIZENS

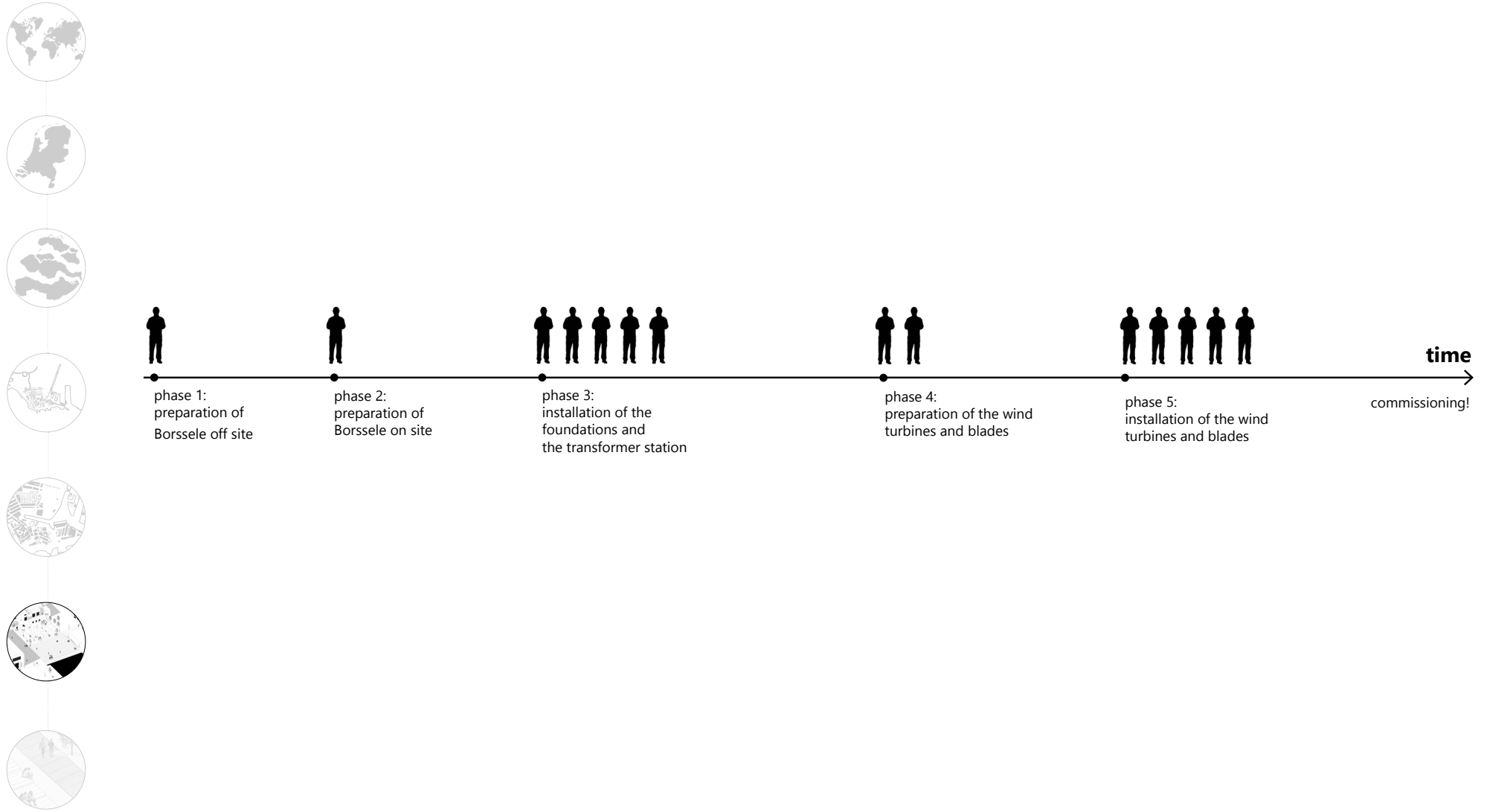

PHASE 1

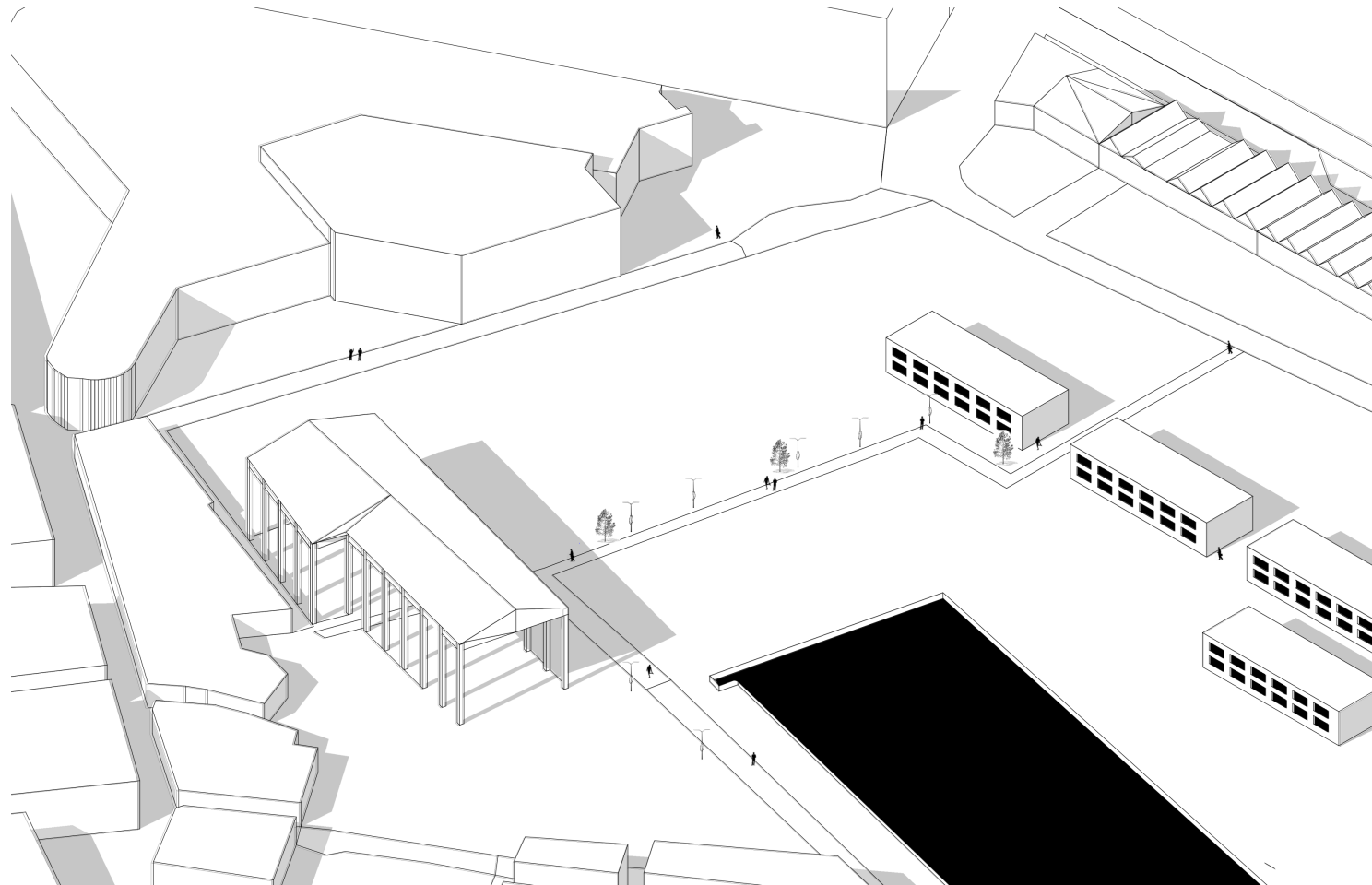

PHASE 2

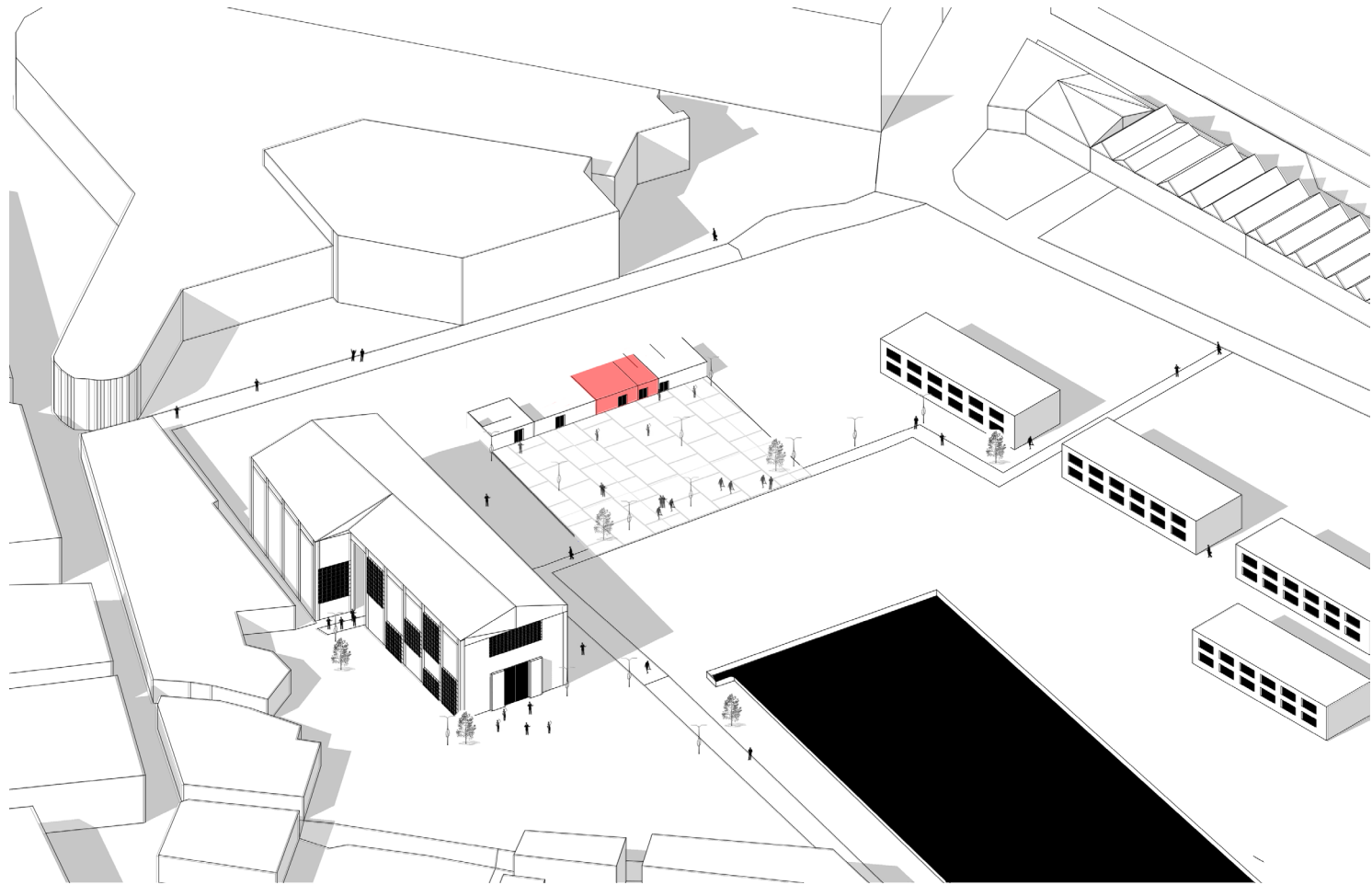

PHASE 3

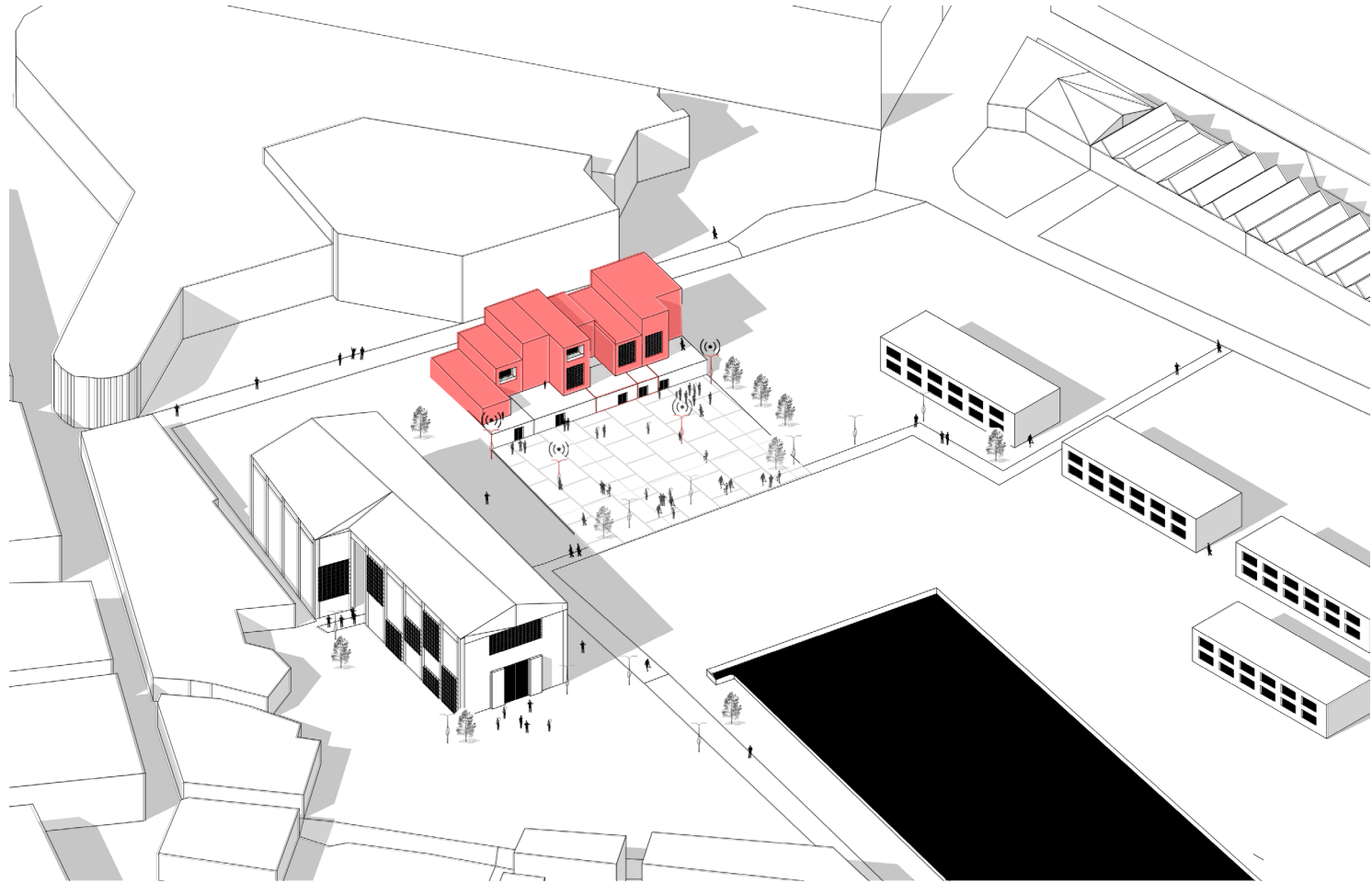

PHASE 4

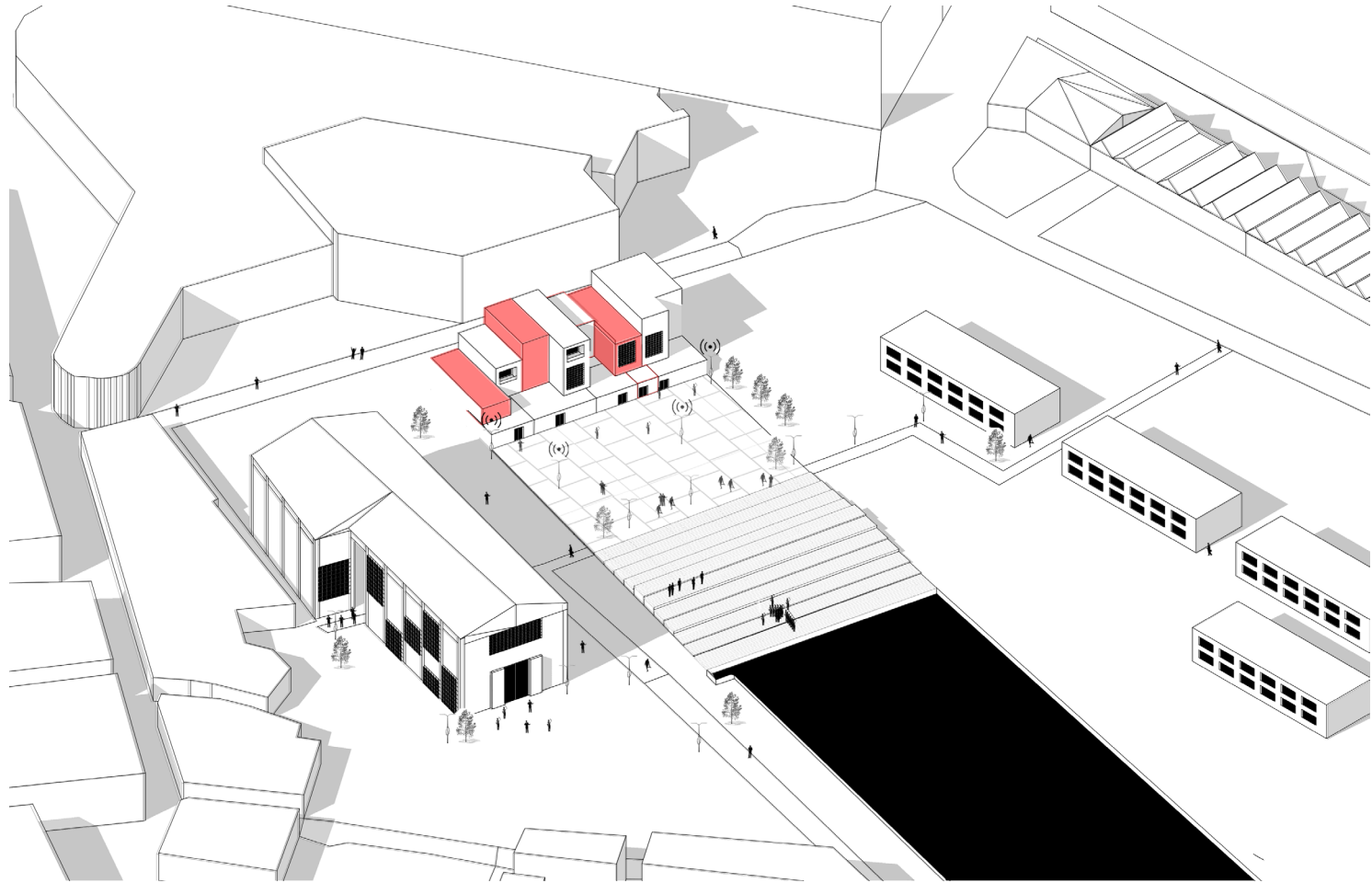

PHASE 5

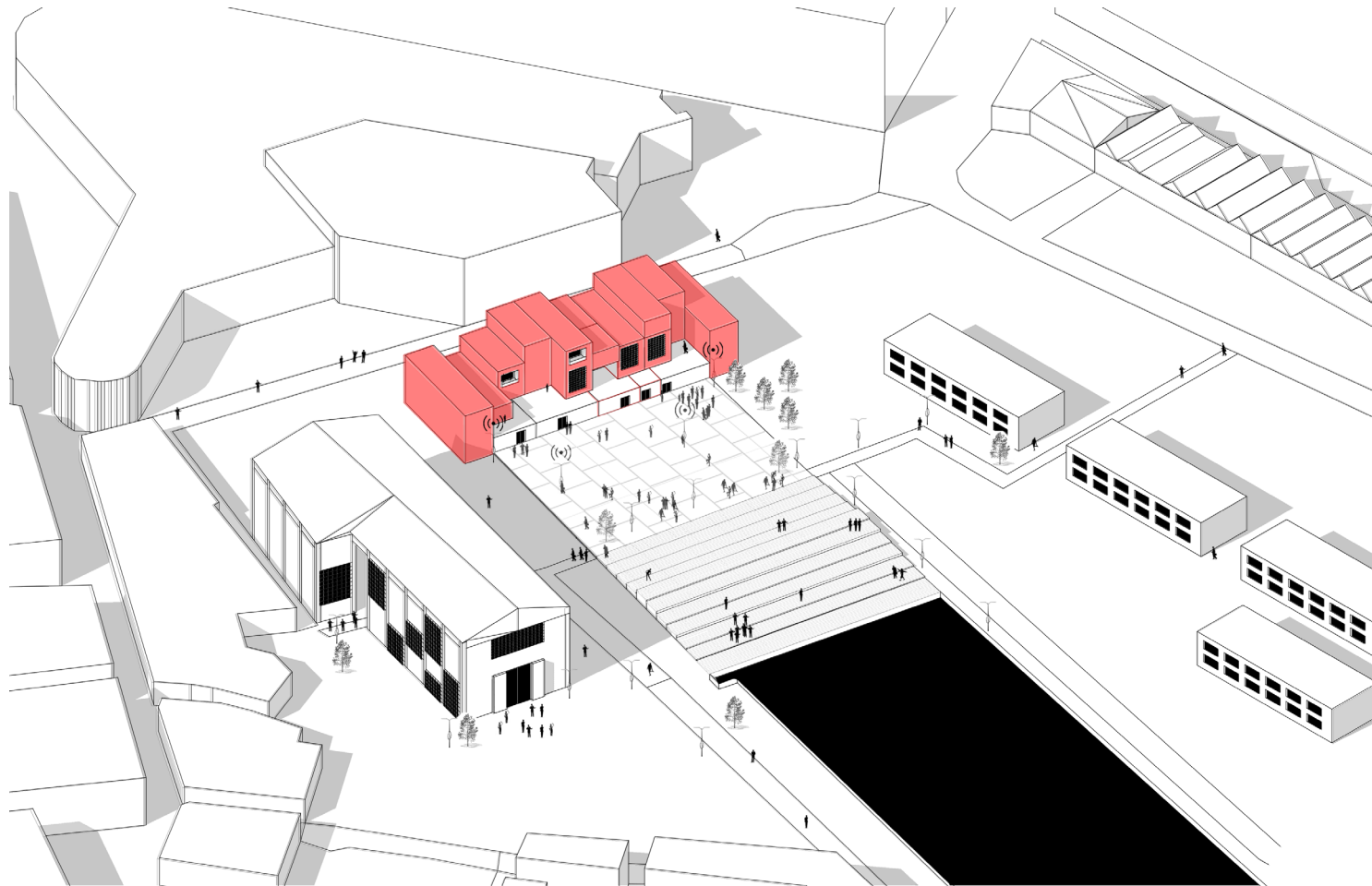

CELEBRATION DOCK

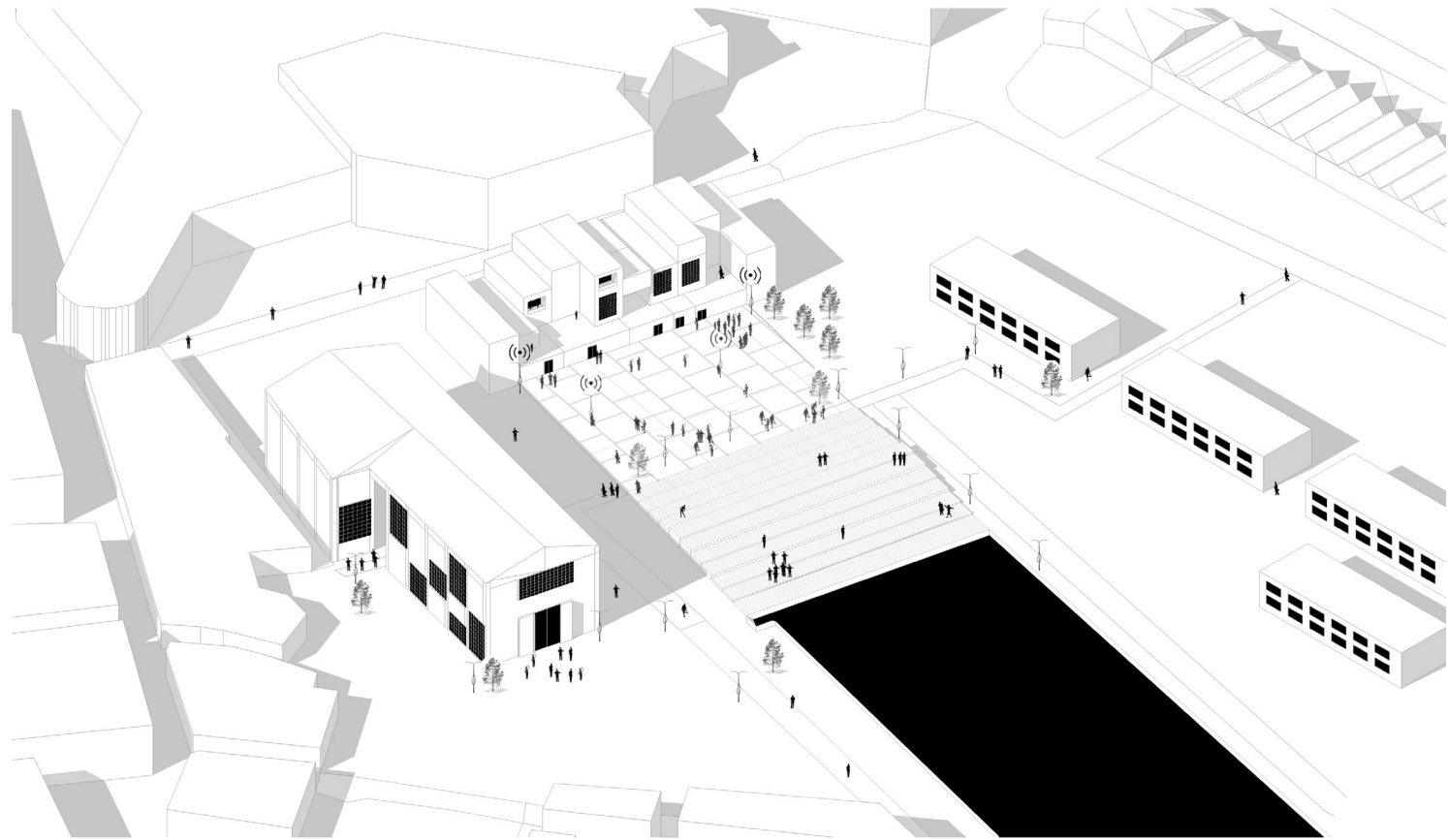

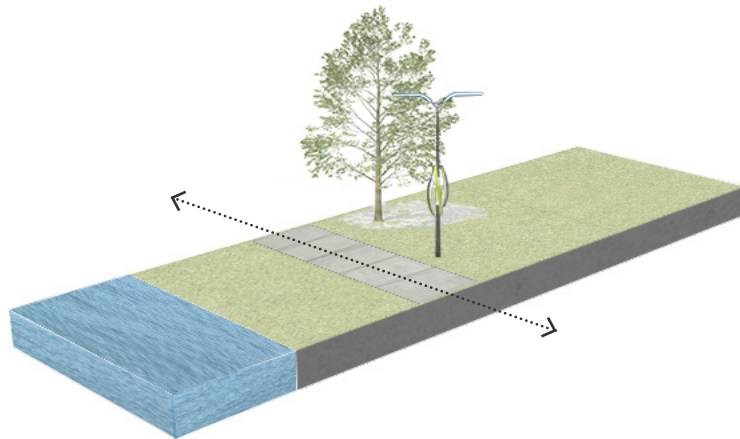

Connection
Make the site accessible
and develop a route.

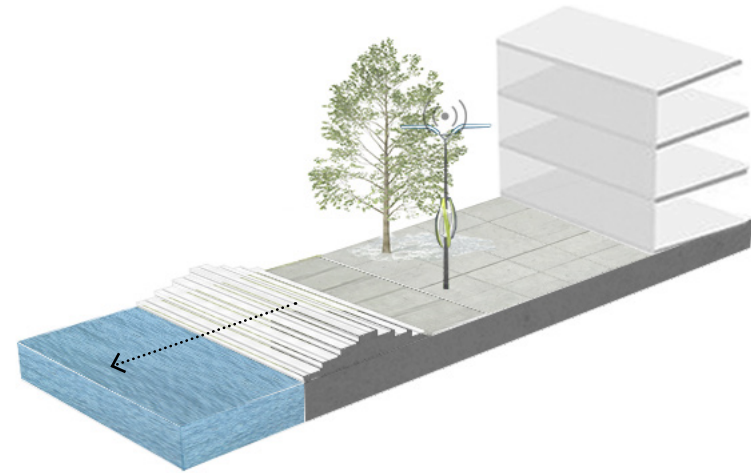

Waterfront
Re-establish a connection
with the water and provide
places to meet.

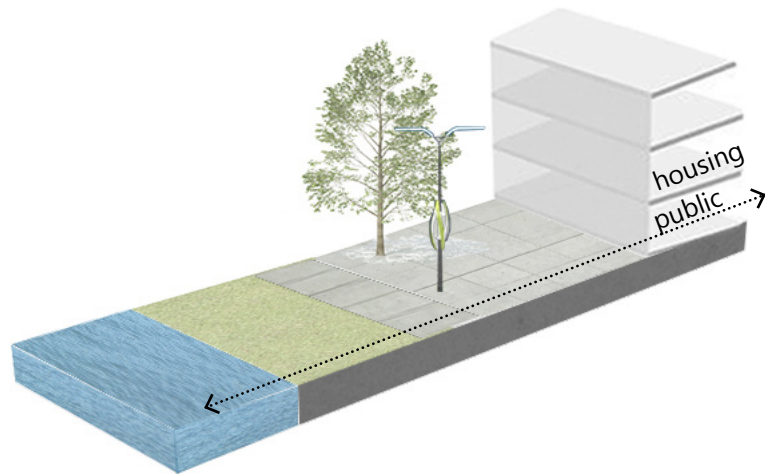

Public functions

Add public functions to the site, extending from the waterfront towards the building. Housing is added on top of the public functions.

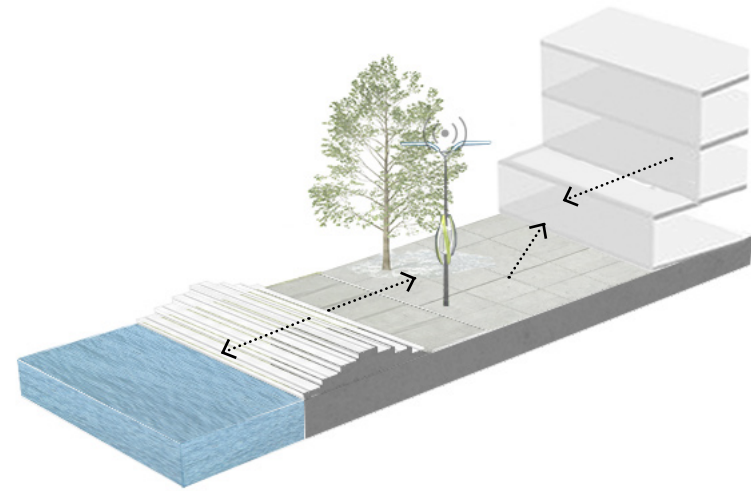

Visual interaction

Making use of different levels to stimulate visual interaction.

PUBLIC FUNCTIONS

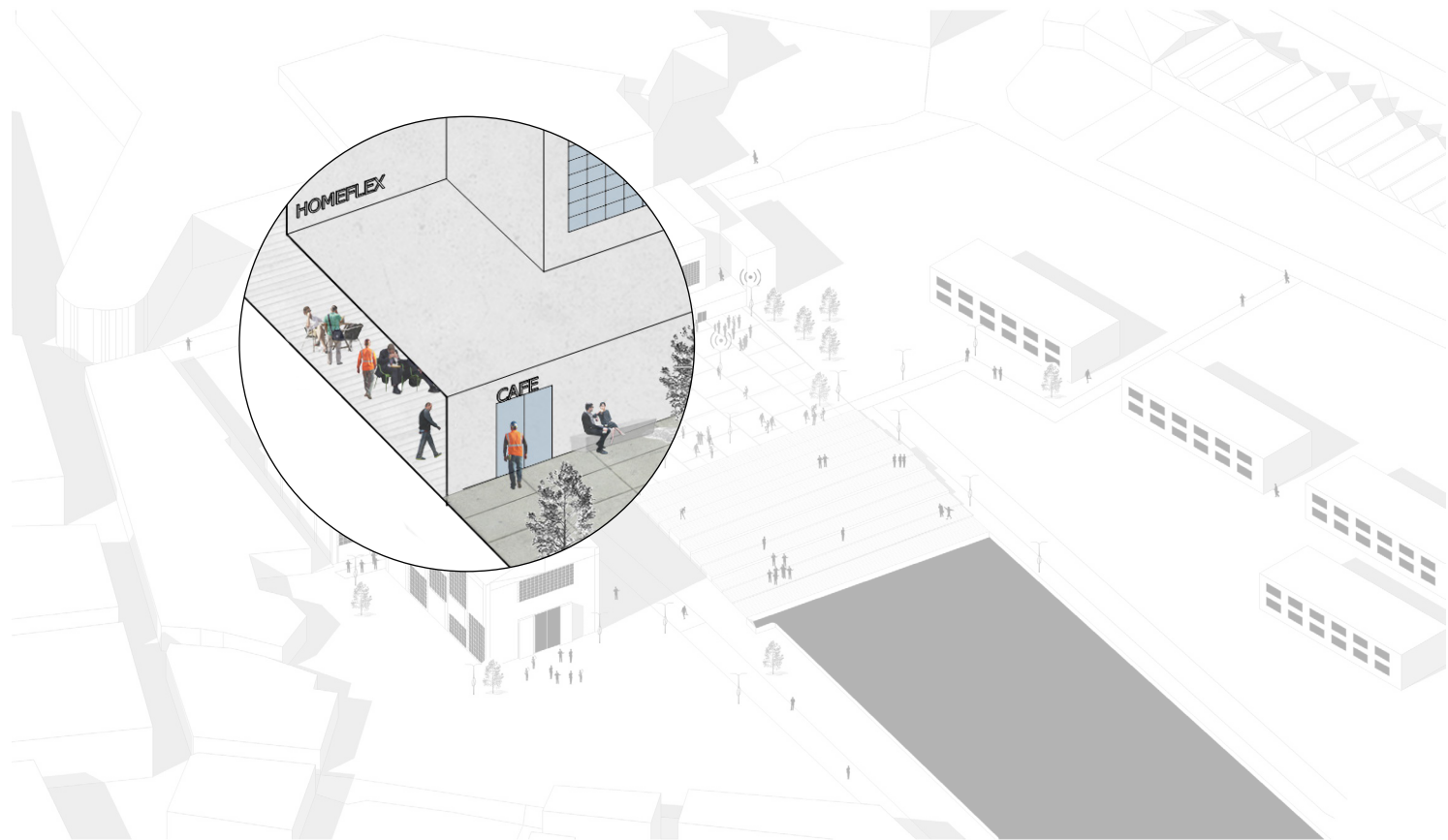

WATERFRONT & CONNECTION

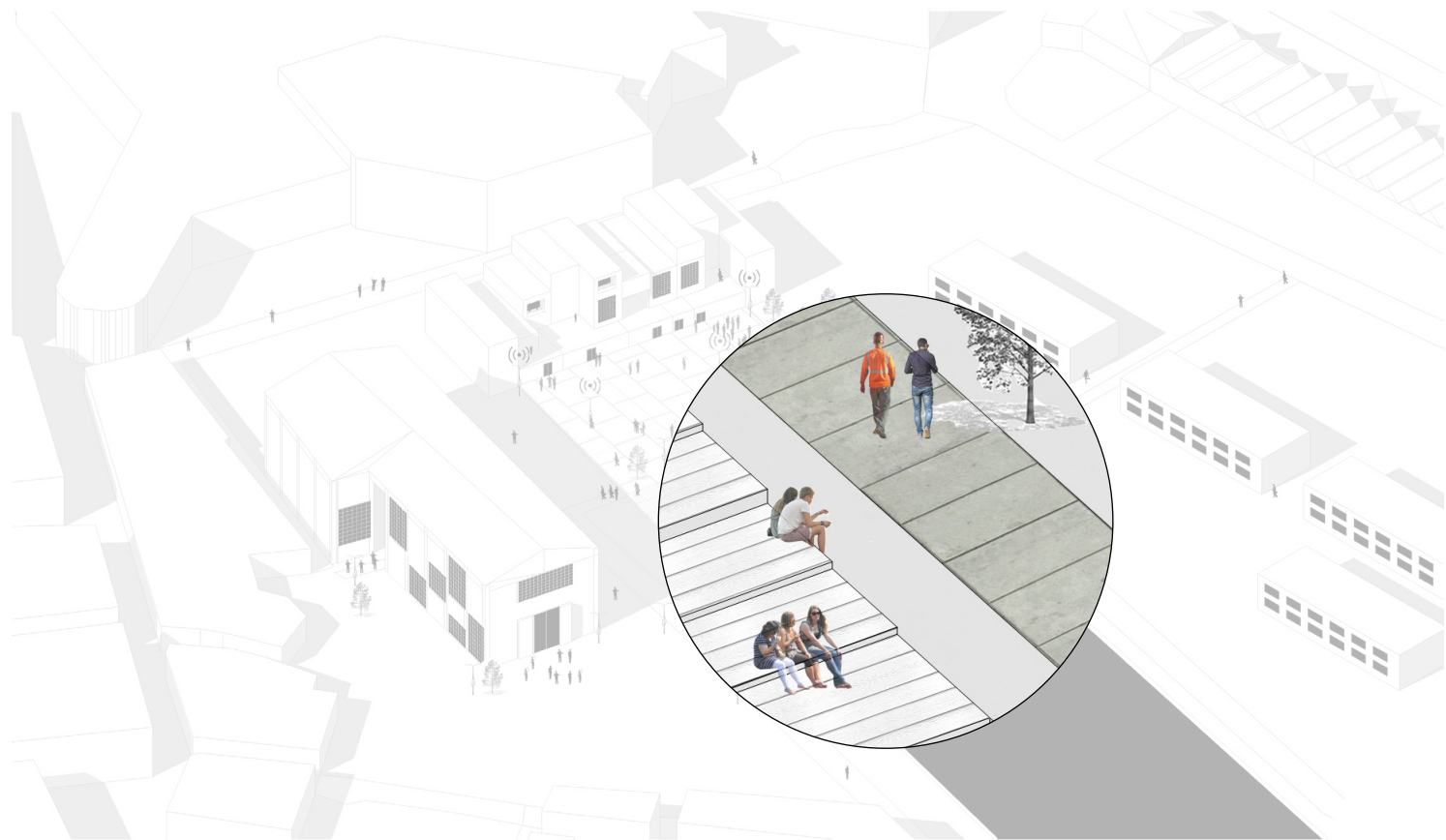

VISUAL INTERACTION

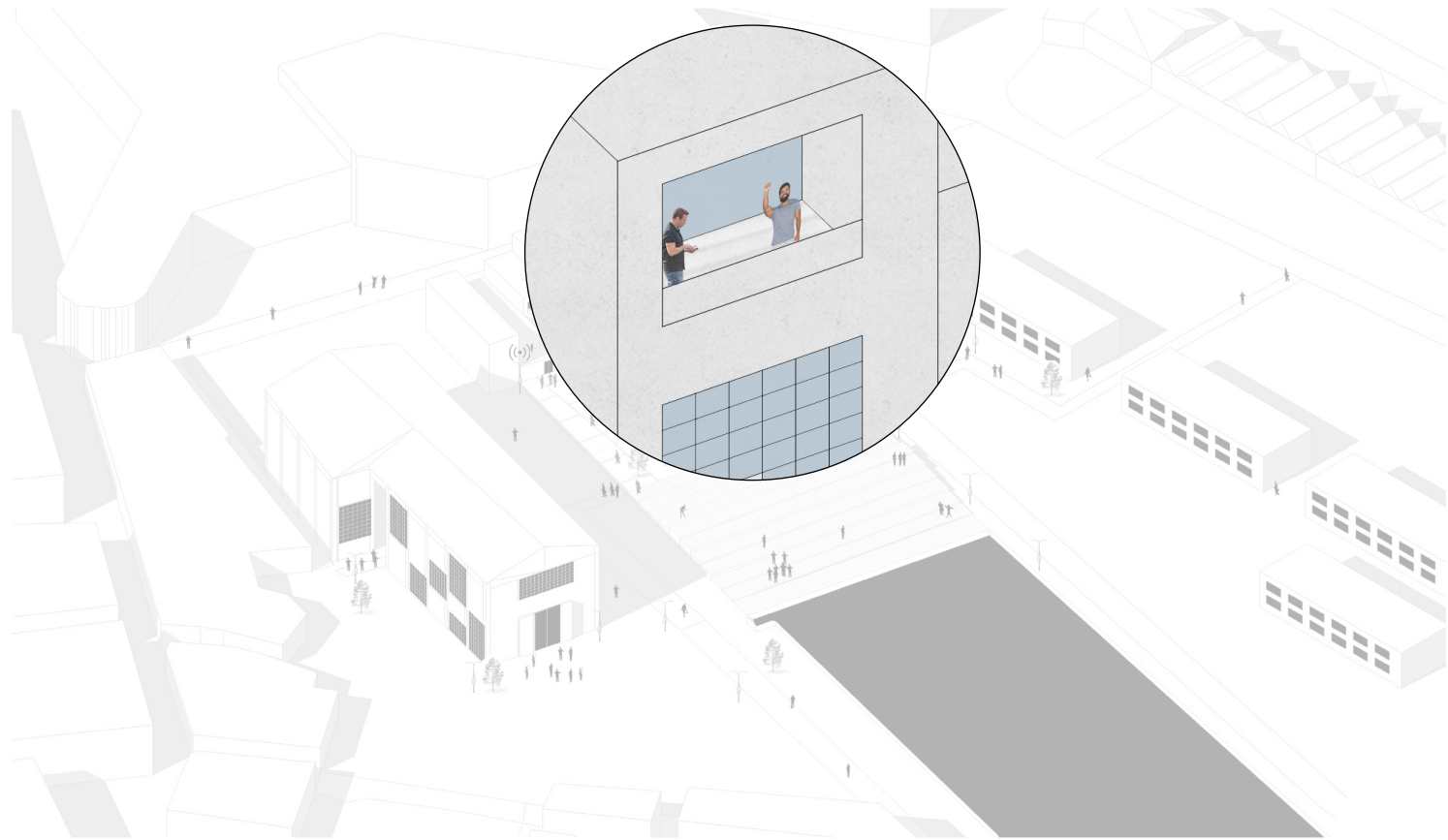

URBAN AREA

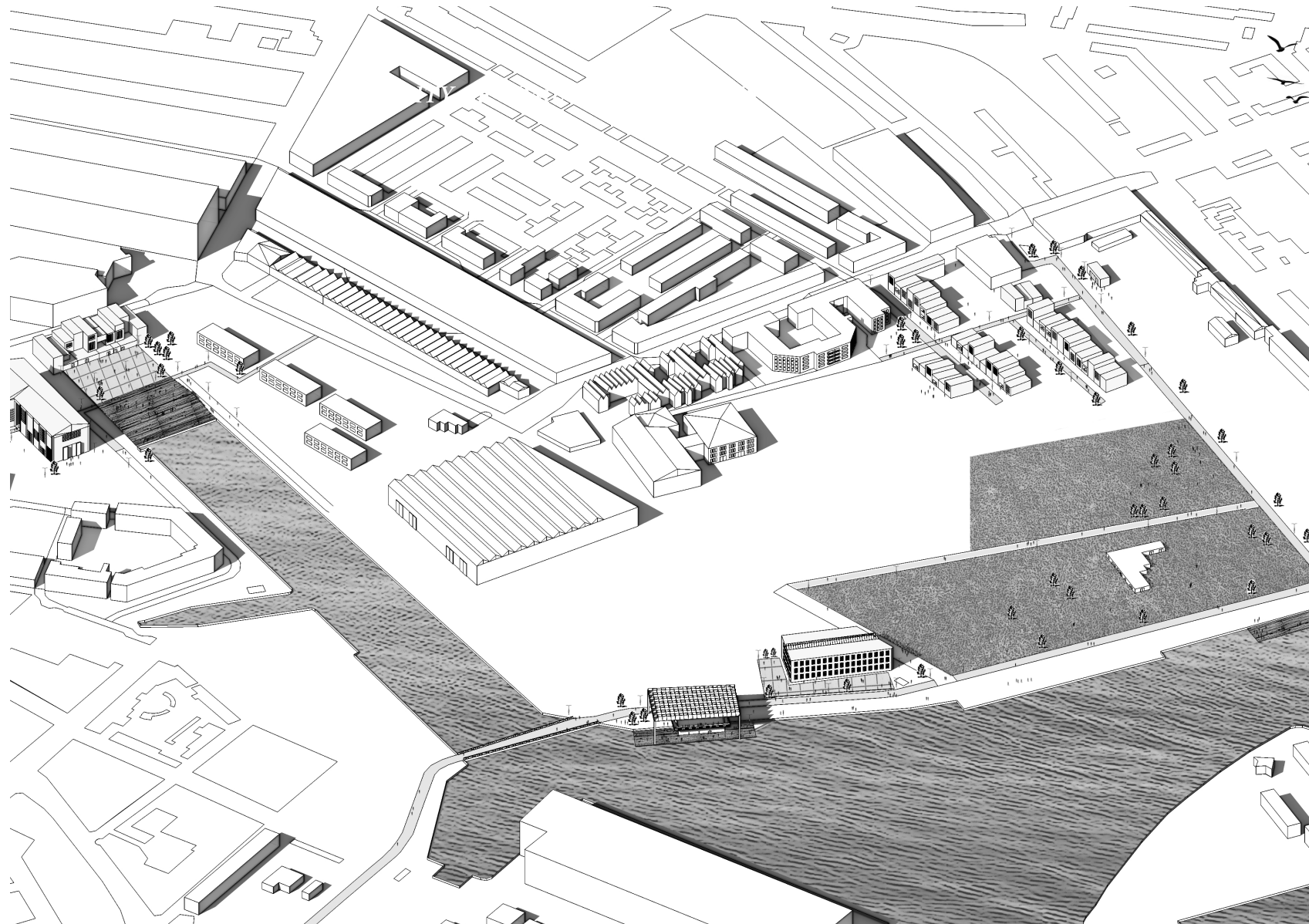

URBAN AREA

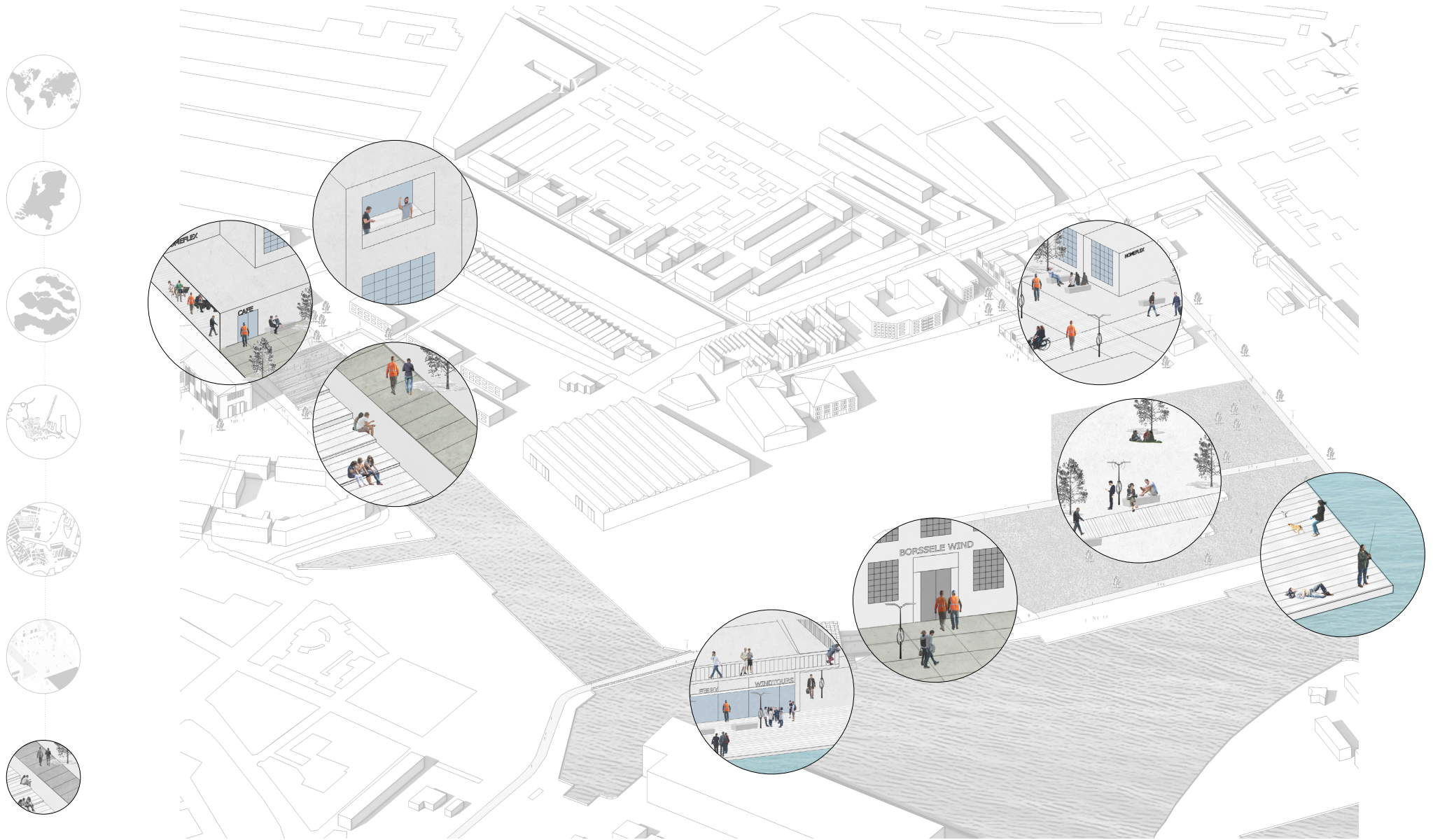

PORT AREA

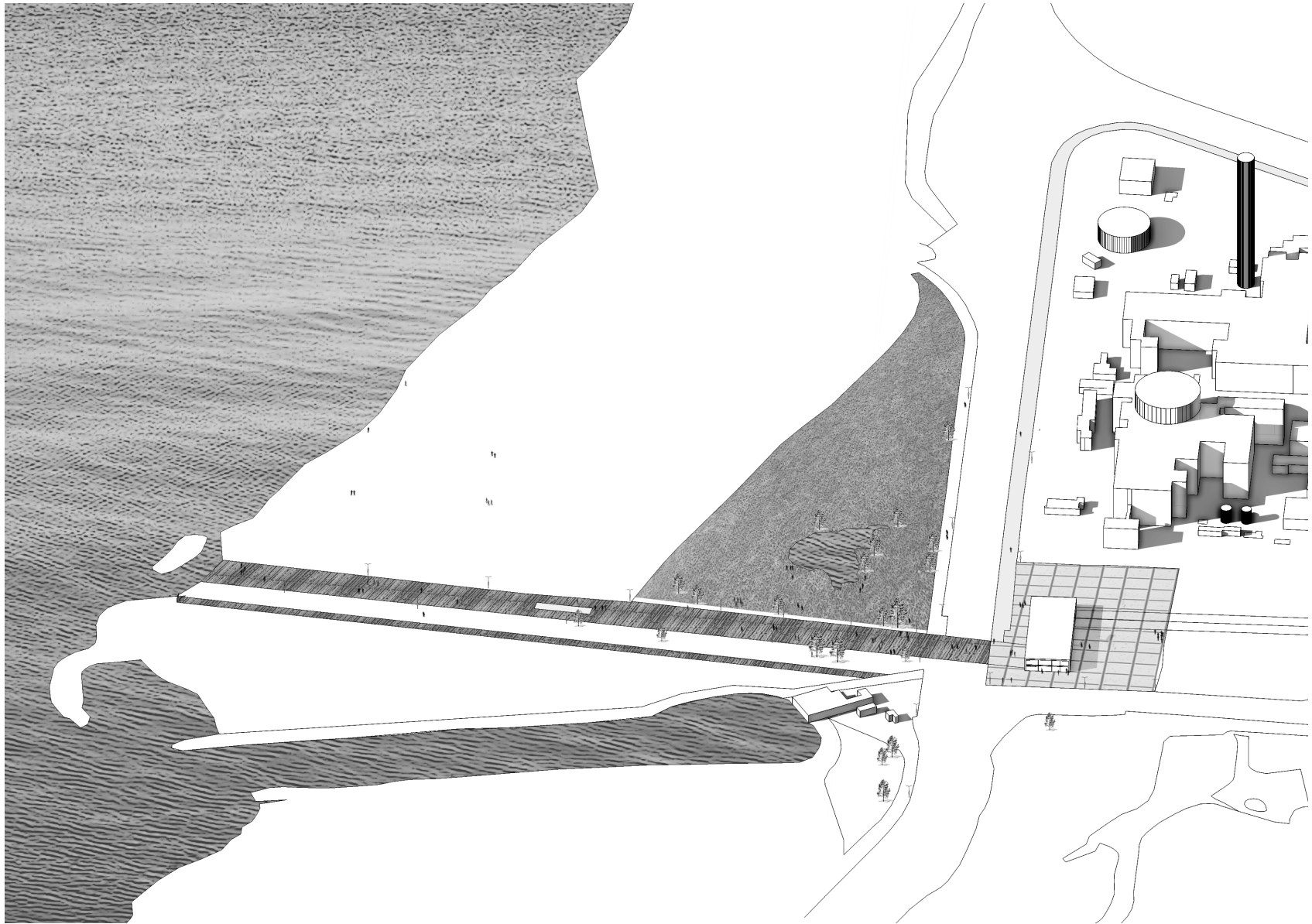

PORT AREA

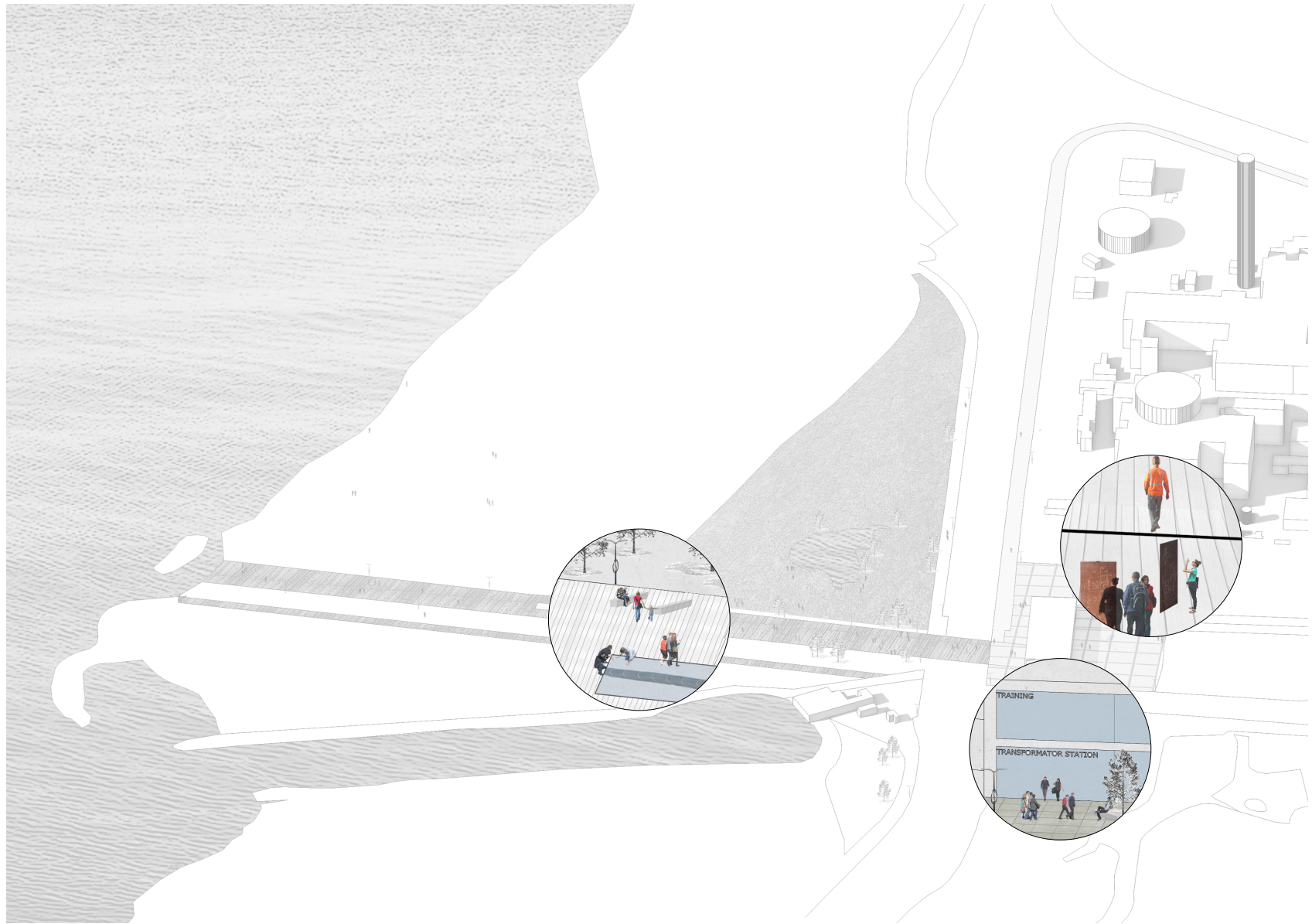

CONCLUSION

From a global context to a local design.

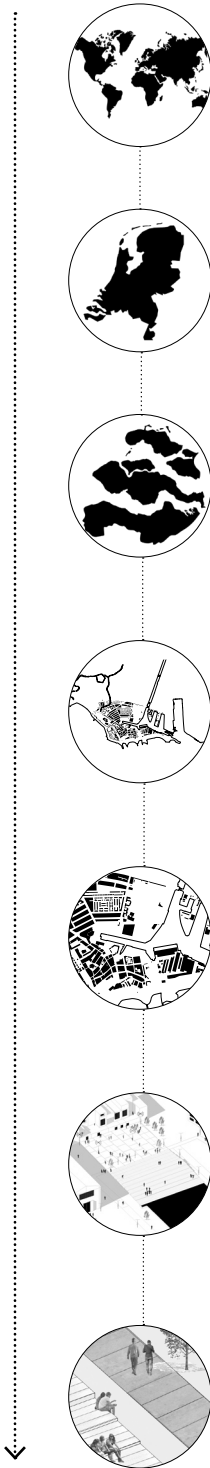

What if we could benefit from the **comings and goings** of people?

To catalyze **long term improvements** for the local population, while servicing and improving the conditions for the temporary citizens.

LOCAL/GLOBAL?

Test the local design in the global context

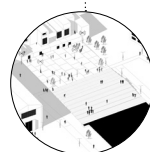
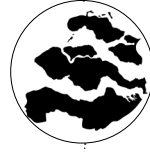

Changes?

THREE SCENARIO'S

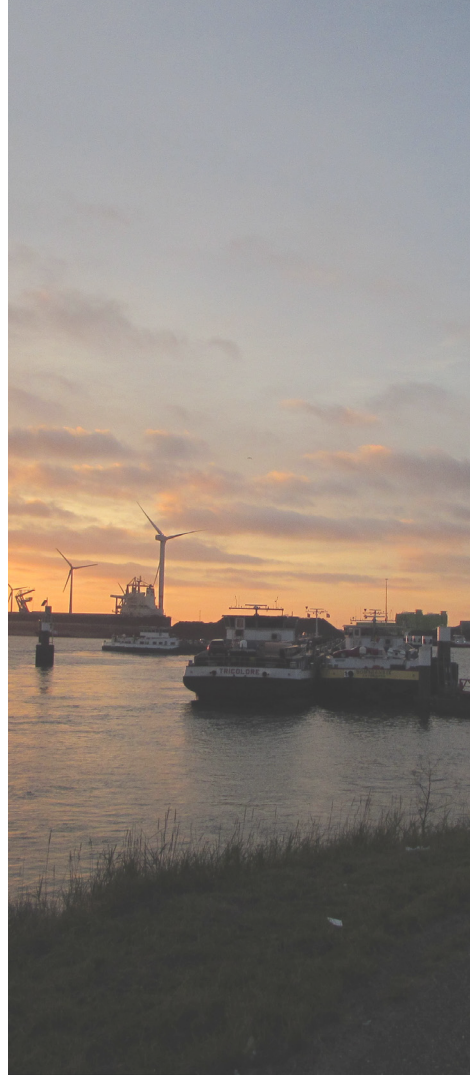

DECLINE

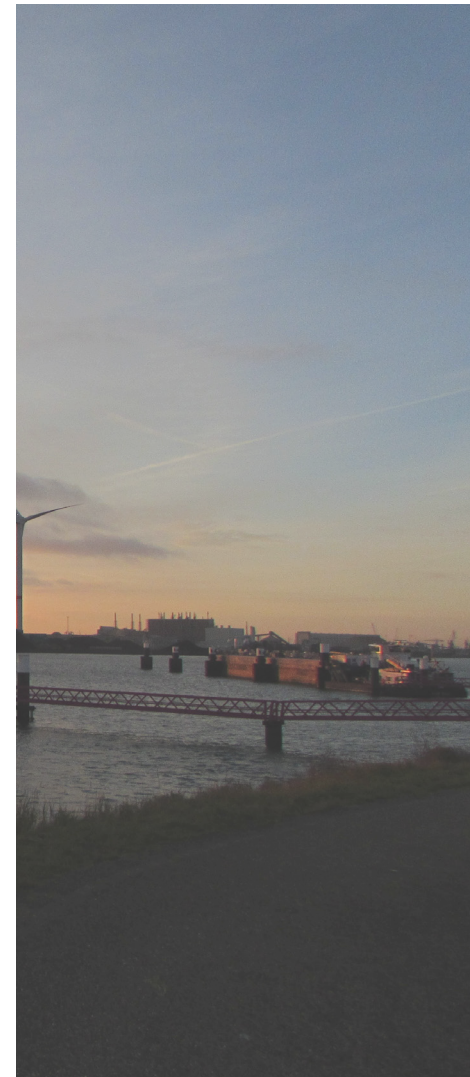

LEGACY DECLINE

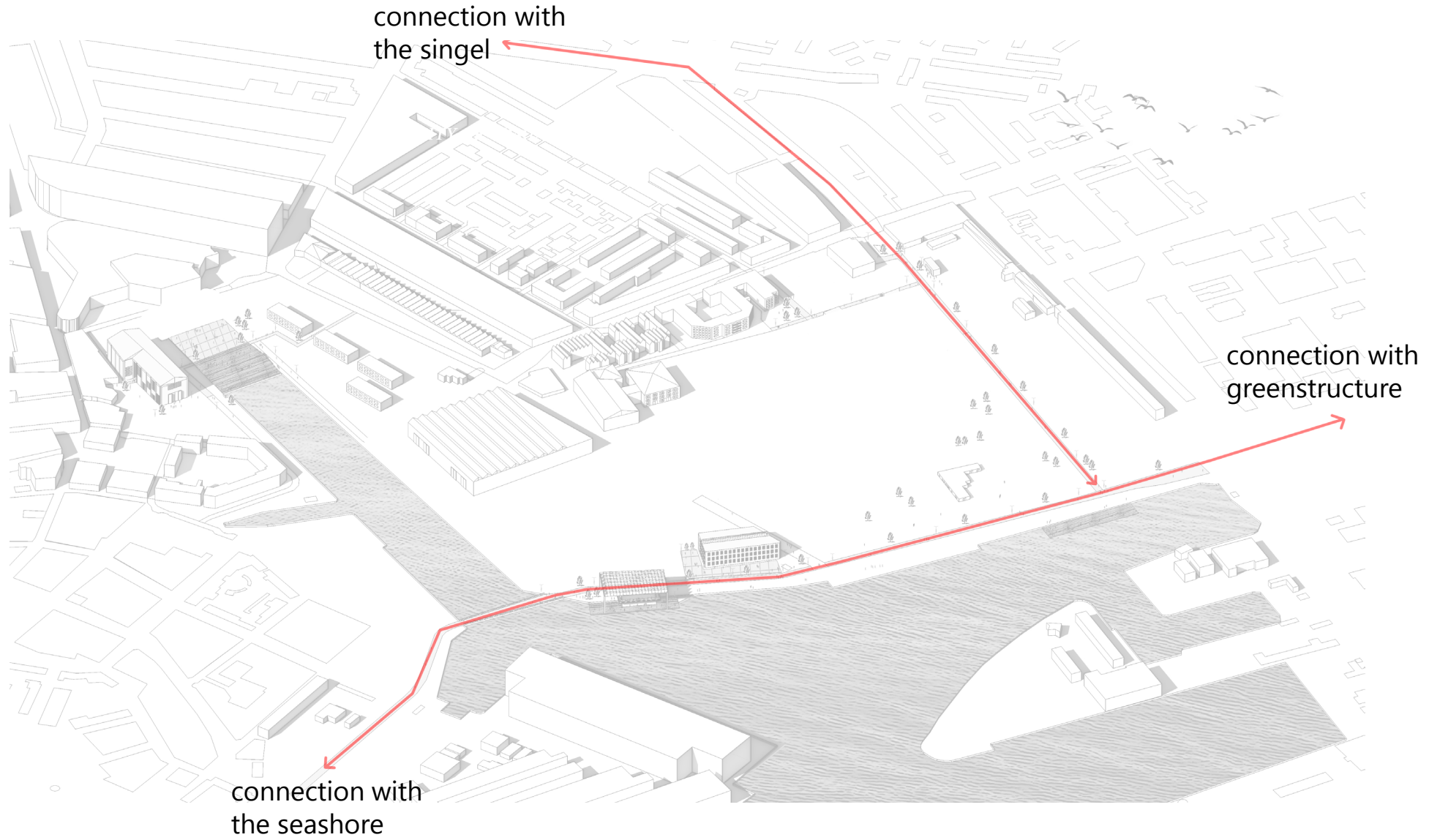



Dismantling oil platforms
industry

Temporary citizen stays

Growth in 1 person
households



LEGACY STABLE

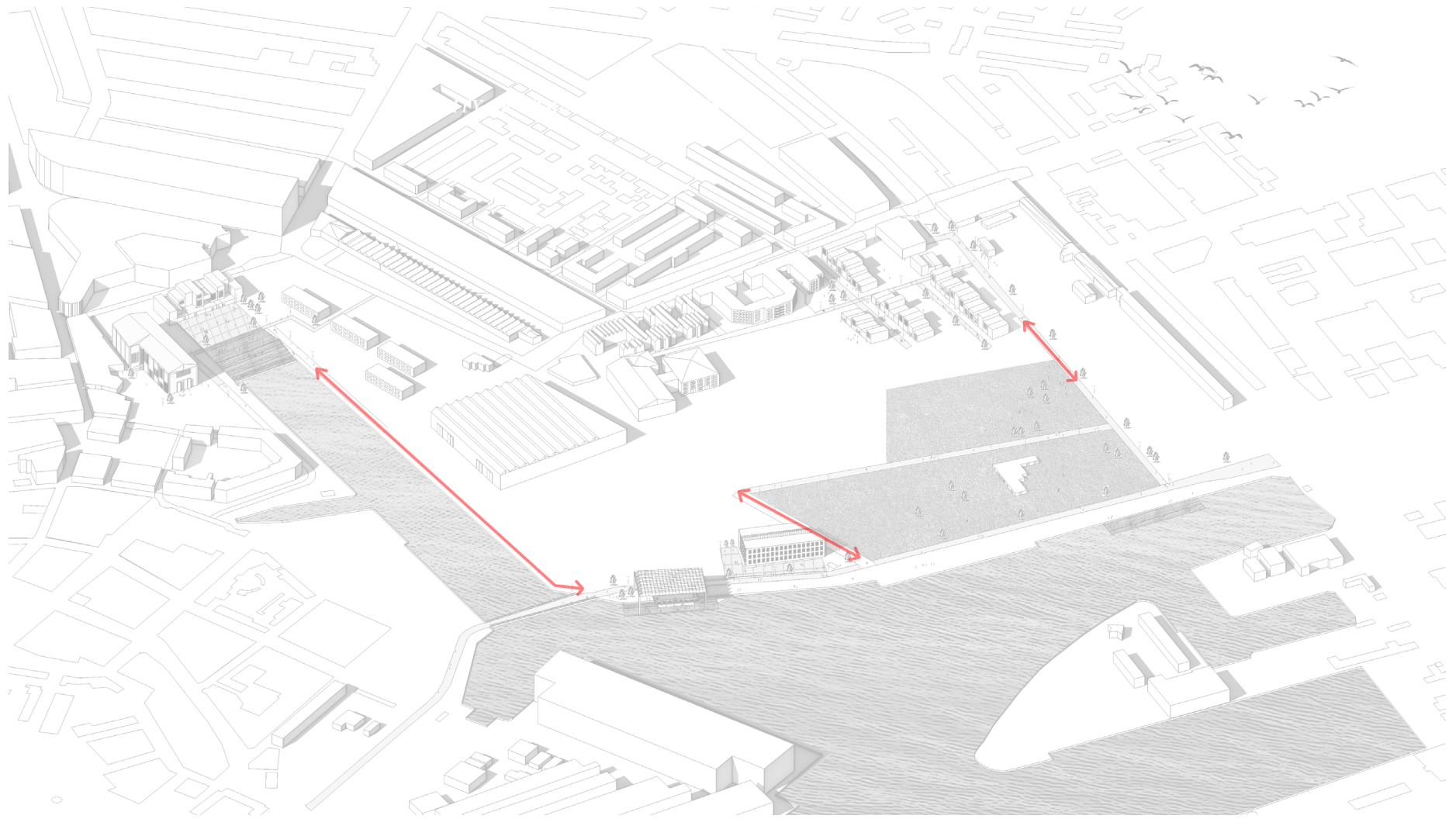

GROWTH

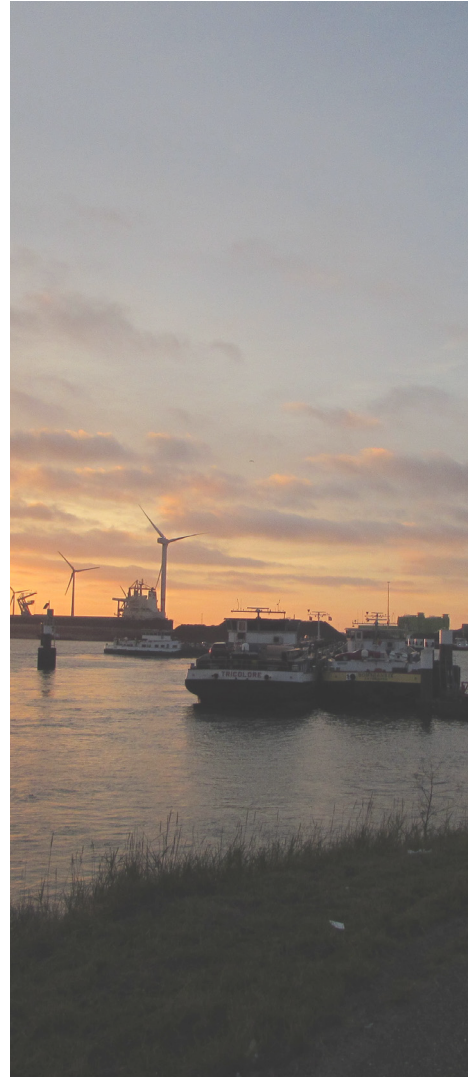

Expertise in offshore wind industry

Temporary citizen stays

Growth in population

LEGACY GROWTH

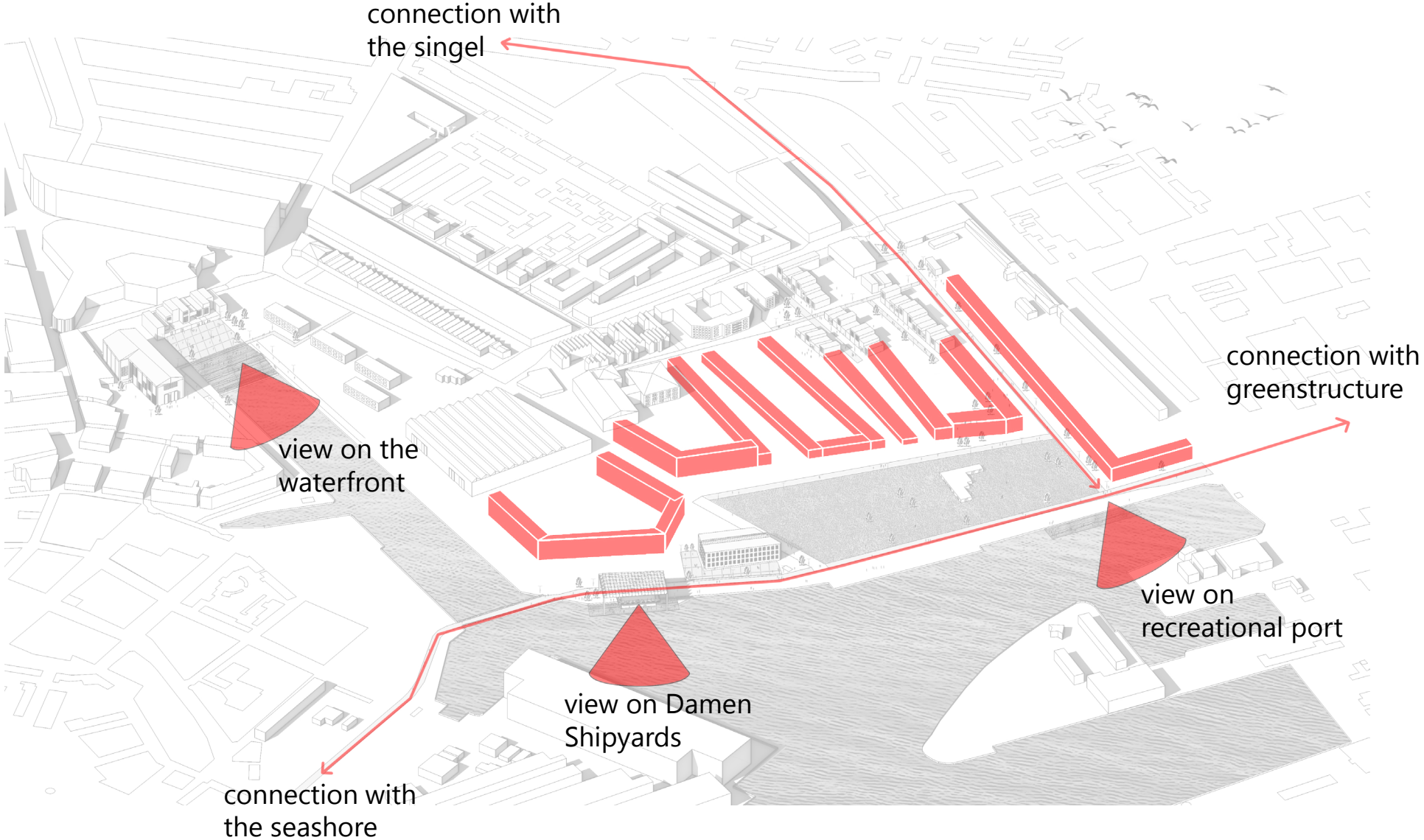

CONCLUSION

DIFFERENT WAY OF THINKING FOR THE URBANIST:

TEMPORARY POPULATION

OPPORTUNITY TO BENEFIT

AWARENESS OF CYCLES

OTHER PLACES





With the new scale of operating and constructing large offshore wind farms, the city of Vlissingen and the port of Vlissingen-Oost are facing a transition. A part of this transition will include an increase of work migration and temporary citizens within the area for the next five years. This project is a research into this phenomenon of comings and goings.

The design is an attempt to make the global factors of energy and migrant workers comprehensible and visible, while using this as a catalyst to local urban change. This project illustrates the idea that services for the temporary needs of migrant workers can be combined with long term improvements for the local population. The temporary citizens are seen as a window of opportunity for the transformation of the urban area, as well as the industrial port area.

As final product of the project, this two-sided document in the format of a folded city map, combining research and design proposal, shows a common new future for Vlissingen. It imagines a potential migrant worker or tourist arriving in Vlissingen, learning about Vlissingen and the Borssele wind farm, and using the facilities the city and the port have to offer. On the other hand, it informs the permanent resident about the new adaptations made in their urban fabric and invites them to participate and celebrate the Borssele wind project as an upgrade to their environment.

Colophon
Anouk Klapwijk
anoukklapwijk@gmail.com

Map made as part of:
Design as Politics Graduation Studio, 2016/2017
A City of Comings and Goings - designing for migration and mobility



MAP OF VISSINGEN

Revealing a new side of Vlissingen through a design proposal based on the spatial implications of the Borssele offshore wind project.

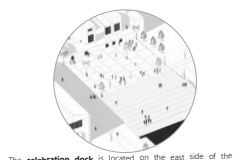
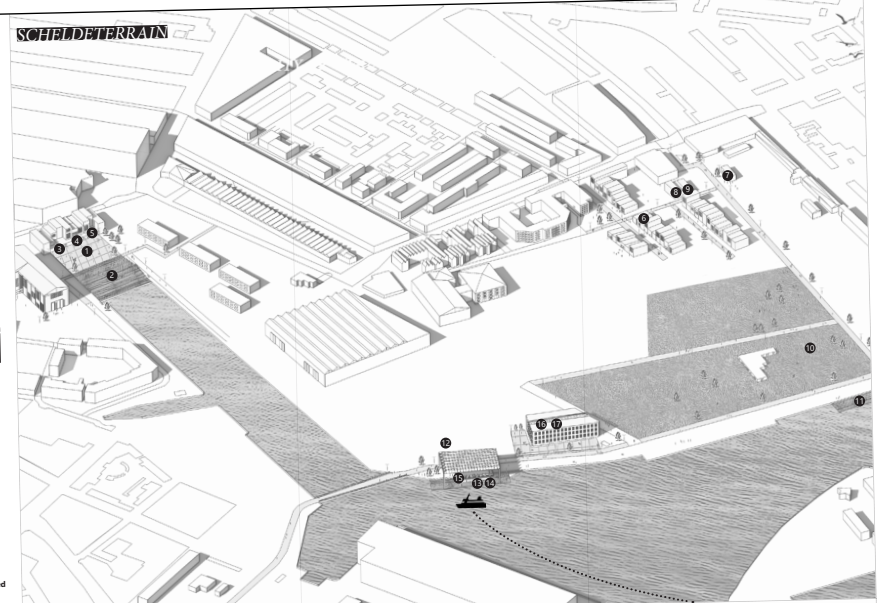

The **celebration dock** is located on the east side of the Scheidelerrain, the location near the city center. It used to be the place where new build ships were launched and celebrated, after the building process was finished. Besides this historical meaning, the building of the (shuttle)work is still intact on the edge of the site. For the design of this site, the aspect of celebration and the combination of the different user groups is the most important.



The location of the **waterfront** is characterized by the old timberfactory and the last shipyard in the old harbour, Damm. This offers an opportunity to activate the waterfront. The pier for the already existing watertaxi is moved to the location. For the workers, the site will offer a way to commute to the port of Vlissingen-Oost by boat. The timberfactory is suitable to host an exhibition about the wind farm and offer office space for employment agencies in the energy industry.

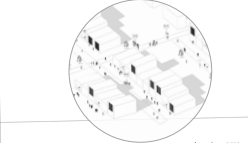

This area of the Scheidelerrain is adjacent to an housing area, originally built by the Scheide company for their workers. With the reactivation of the 'wall', the site is suitable for building for temporary citizens. This

WELCOME TO VISSINGEN

With this map, we take you to along the new hotspots of Vlissingen during the construction of the offshore wind farm of Borssele. Vlissingen, already famous for its rich maritime history, adds another chapter to this history: the chapter of offshore wind energy. While the offshore wind farm largely remains invisible on land, this guide shows you the spatial implications it does have on the city and its port. The map will guide you around the new opportunities that are on offer. See for yourself and enjoy!

SCHIEDELERRAIN

- 1 CELEBRATION SQUARE
- 2 WATERFRONT STAIRS
- 3 CAFE
- 4 POST OFFICE
- 5 WESTERN UNION BANK

KALLOOT

- 6 ACCOMMODATION
- 7 FITNESS CENTER
- 8 HOMEFLEX OFFICE
- 9 AIRBNB HOUSE

FERRY SHUTTLE

- 10 CENTRAL PARK
- 11 FISHING DOCK

Explore Vlissingen, Vlissingen-Oost and Borssele by ferry! You can buy a hop-on-hop-off day trip or buy a subscription for commuting. Tickets are only available at the ferry terminal. Use the app for current departure times and a personal timetable.

●●●●● Route
▲ Pick up points

KALLOOT

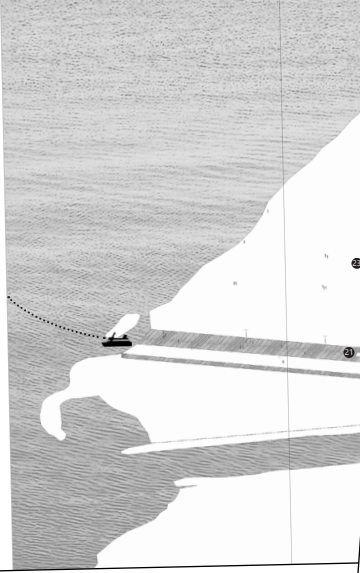

NOW AVAILABLE IN APP STORE

SPATIAL QUALITY



USE OF HERITAGE



NEW ROUTES



NEW ACTIVITIES



VISIBILITY



CONNECTION

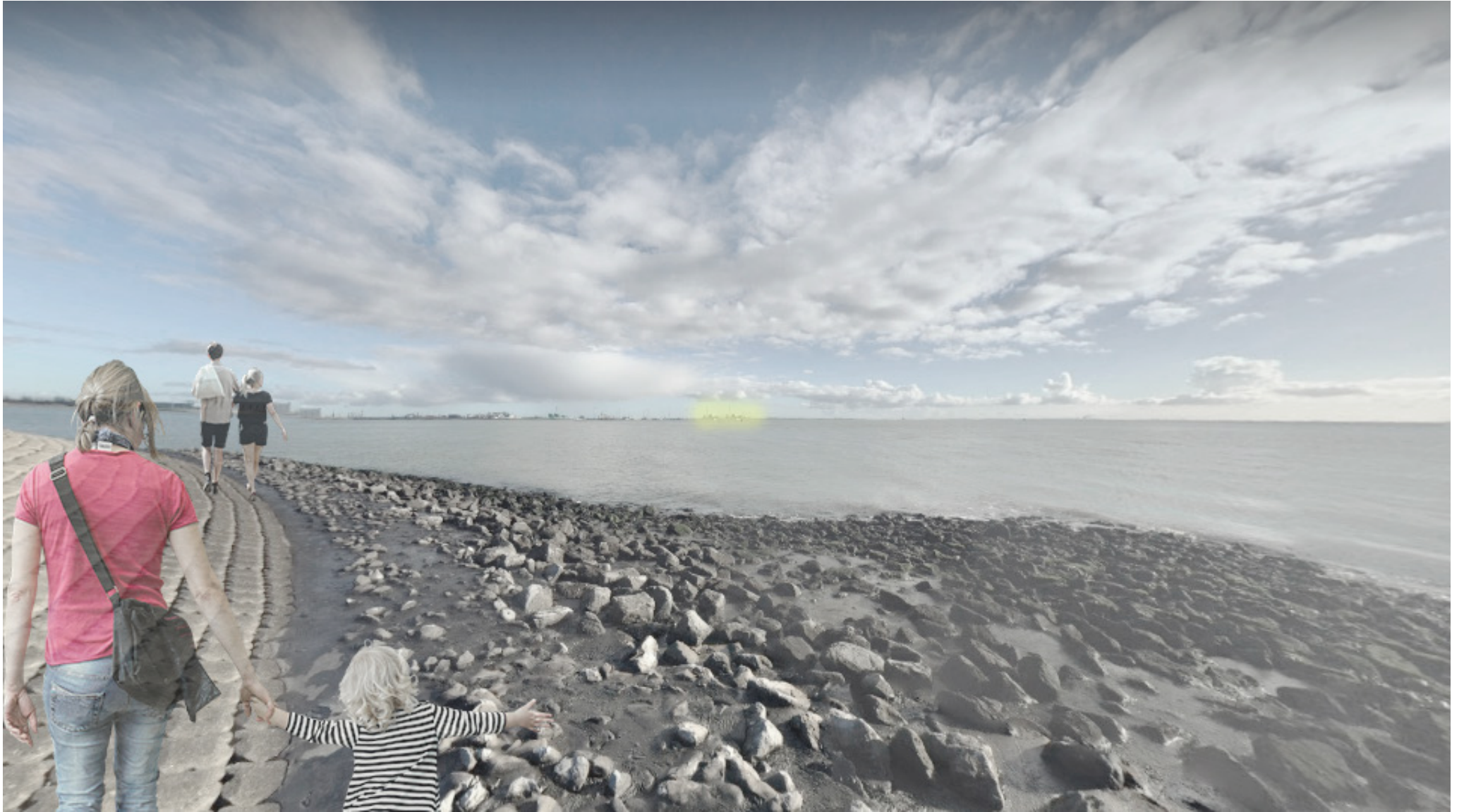

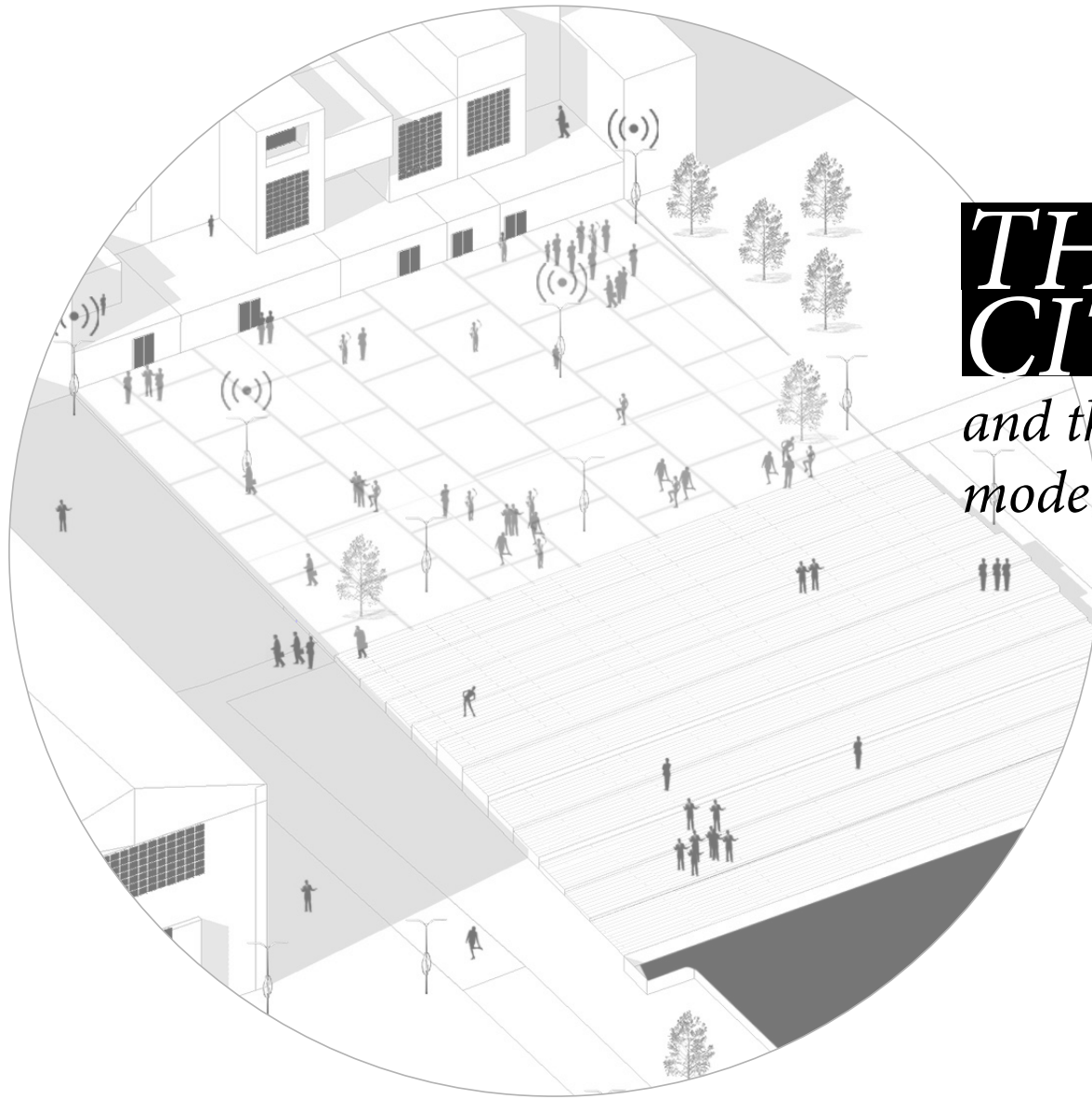

THE TEMPORARY CITIZEN

*and the implications of the next
mode of energy in Vlissingen*

*Graduation Anouk Klapwijk
29-06-2017*

*Supervised by:
M. Emmerik
V. Munoz Sanz*

A balcony offers a view on the waterfront and creates opportunity for visual interaction.

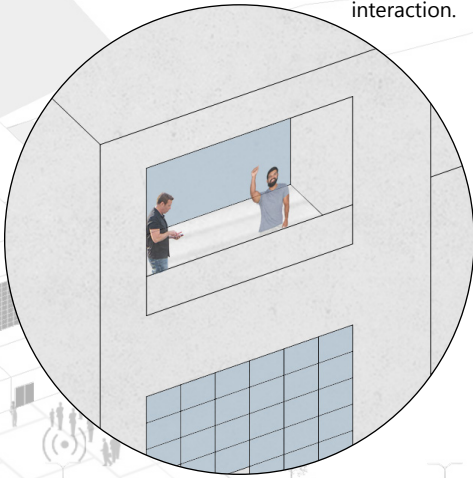

A cafe on the ground floor extends the public space from the square to the inside and forms the entrance to the workers housing.



Stairs provide a meeting place along the waterfront while a path connects to the surrounding urban area.

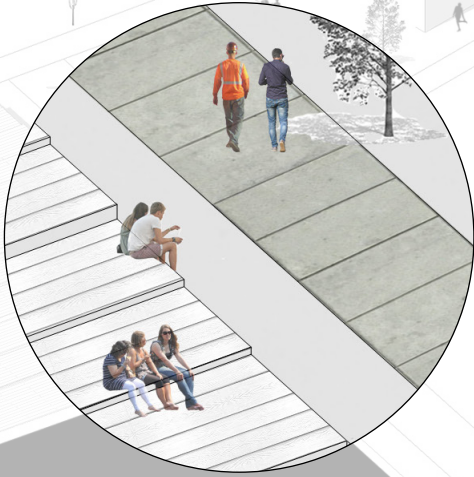

The ferry terminal; commuting to the port for the temporary citizens, offering wind tours for the permanent inhabitant.

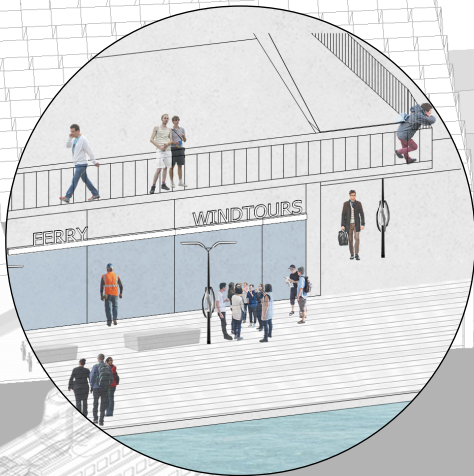

Entrance of the timberfactory giving space to employment agencies and a windpower exhibition.



Area for workers housing, while offering access through the terrain for the inhabitants of Vlissingen.

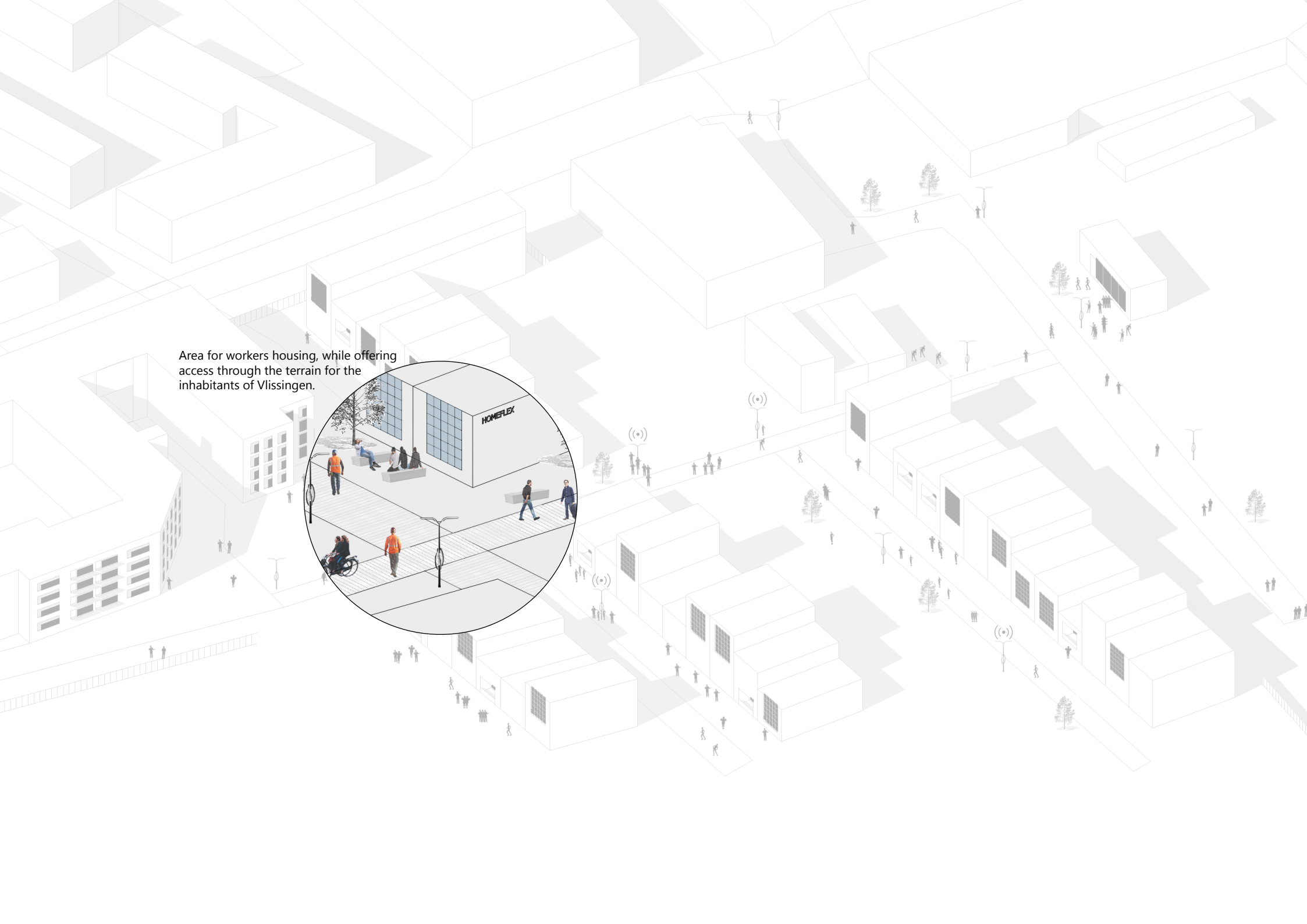
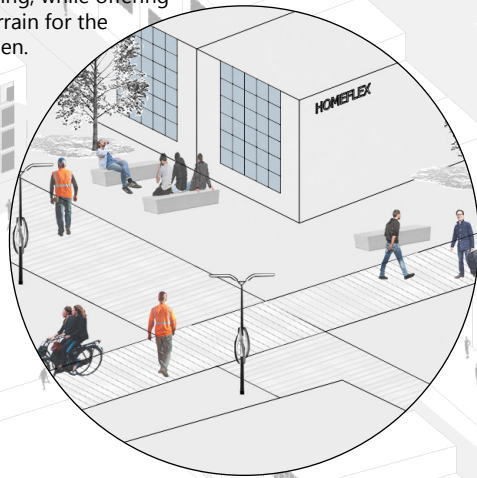

The park offering spaces to meet and
recreate.

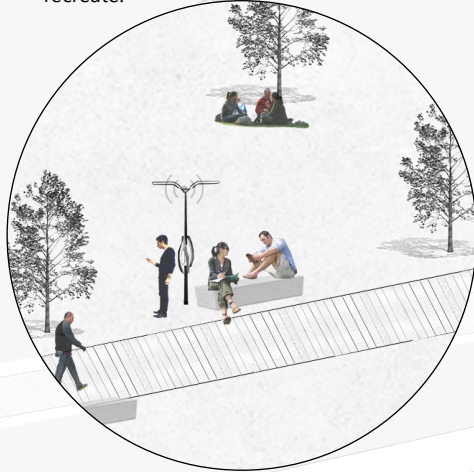

The park connecting to the waterfront,
offering possibilities for recreation.

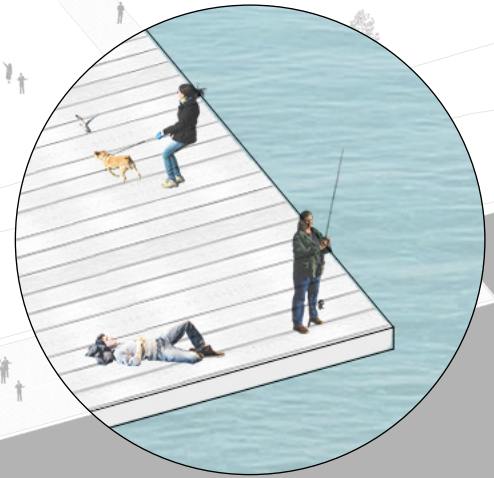

The path connects the transformer station to the water on top of the cable trajectory of Borssele.

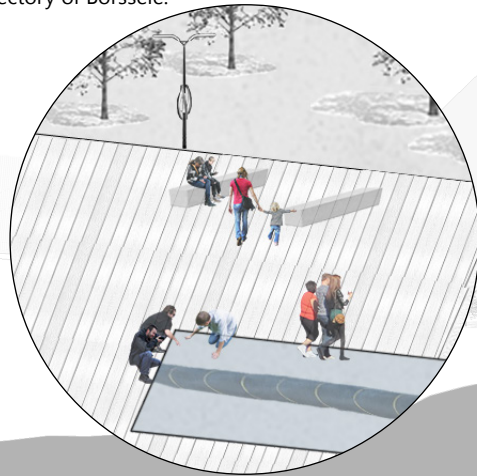

Space for training the workers on top of the public function of the transformer station.

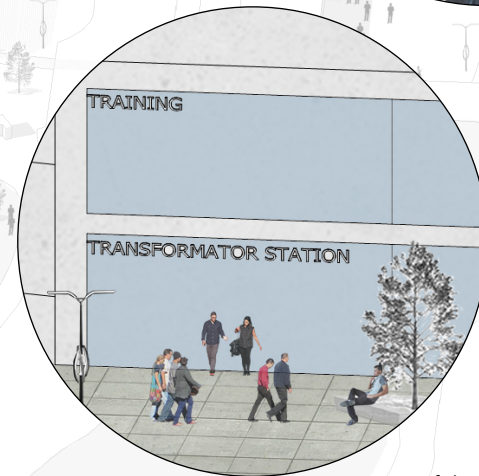

Entrance of the transformer station and training center.