



HAPPY ACCIDENTS

Eveline Scheffel

MSC ARCHITECTURE - TU DELFT
ADVANCE HOUSING - AMSTERDAM
HARALD MOOIJ - ARCHITECTURE
ROBBERT GUIJ - RESEARCH
ELINA KARANASTASI - BUILDING TECHNOLOGY
SILVIA NALDINI - BOARD OF EXAMINERS

PROBLEMSTATEMENT

150.00 NEW HOUSING UNITS

SOLUTION 1970

LONELINESS AMONGST NEIGHBOURS

STRONG VS WEAK TIES

1.000.000
HOUSES



150.000
HOUSES

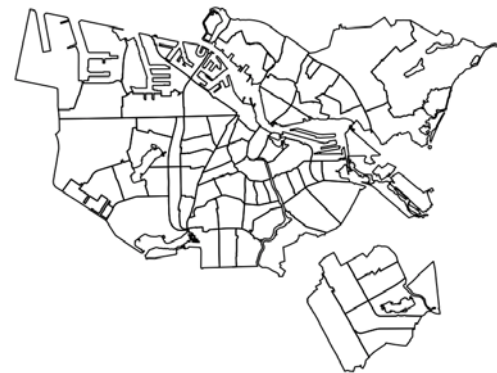

PROBLEMSTATEMENT

150.00 NEW HOUSING UNITS

SOLUTION 1970

LONELINESS AMONGST NEIGHBOURS

STRONG VS WEAK TIES

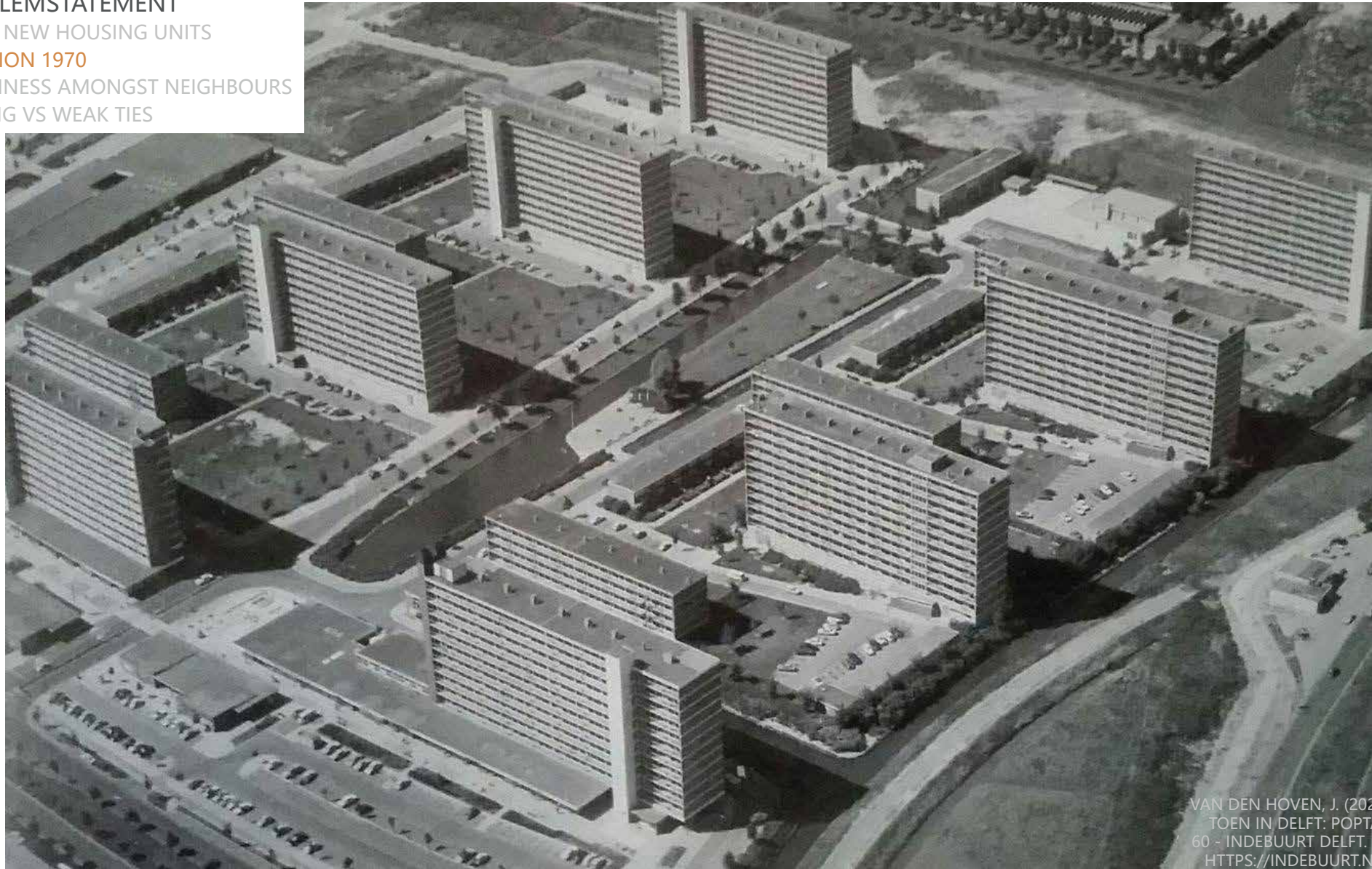

VAN DEN HOVEN, J. (2025, 21 NOVEMBER).
TOEN IN DELFT: POPTAHOF IN DE JAREN
60 - INDEBUURT DELFT. INDEBUURT DELFT.
[HTTPS://INDEBUURT.NL/DELFT/TOEN-IN/
TOEN-DELFT-POPTAHOF-JAREN-60~15448/](https://indebuurt.nl/delft/toen-in-toen-delft-poptahof-jaren-60~15448/)

PROBLEMSTATEMENT

150.00 NEW HOUSING UNITS

SOLUTION 1970

LONELINESS AMONGST NEIGHBOURS

STRONG VS WEAK TIES



BUILDING QUICKLY



COPY-PASTE



ANONYMOUS

PROBLEMSTATEMENT

150.00 NEW HOUSING UNITS

SOLUTION 1970

LONELINESS AMONGST NEIGHBOURS

STRONG VS WEAK TIES



EENZAAMHEID, JE BENT NOOIT TE JONG OM ER IETS AAN TE DOEN – DE DAGERAAD. (Z.D.). [HTTPS://WWW.PRAKTIJKDEDAGERAAD.NL/EENZAAMHEID/EENZAAMHEID-JE-BENT-NOOIT-TE-JONG-OM-ER-IETS-AAN-TE-DOEN/](https://www.praaktijkdedageraad.nl/eenzaamheid/eenzaamheid-je-bent-nooit-te-jong-om-er-iets-aan-te-doen/)

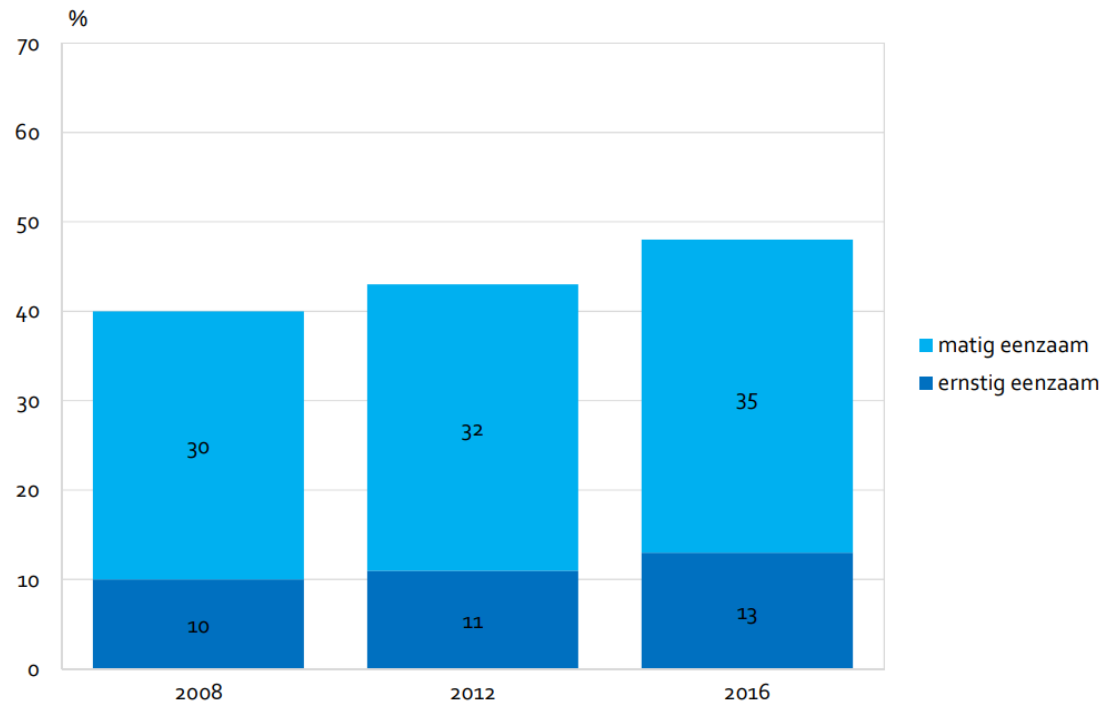

SOURCE: EENZAAMHEID IN AMSTERDAM FACTSHEET | WEBSITE ONDERZOEK EN STATISTIEK. (2017, 31 DECEMBER). [HTTPS://ONDERZOEK.AMSTERDAM.NL/PUBLICATIE/EENZAAMHEID-IN-AMSTERDAM-FACTSHEET](https://onderzoek.amsterdam.nl/publicatie/eenzaamheid-in-amsterdam-factsheet)

PROBLEMSTATEMENT

150.00 NEW HOUSING UNITS

SOLUTION 1970

LONELINESS AMONGST NEIGHBOURS

STRONG VS WEAK TIES

The Strength of Weak Ties

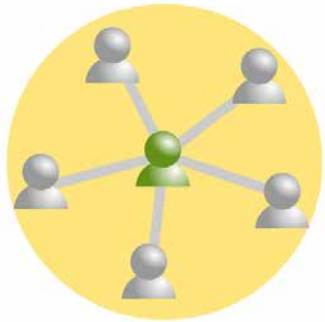

CONNECTIONS THROUGH STRONG TIES

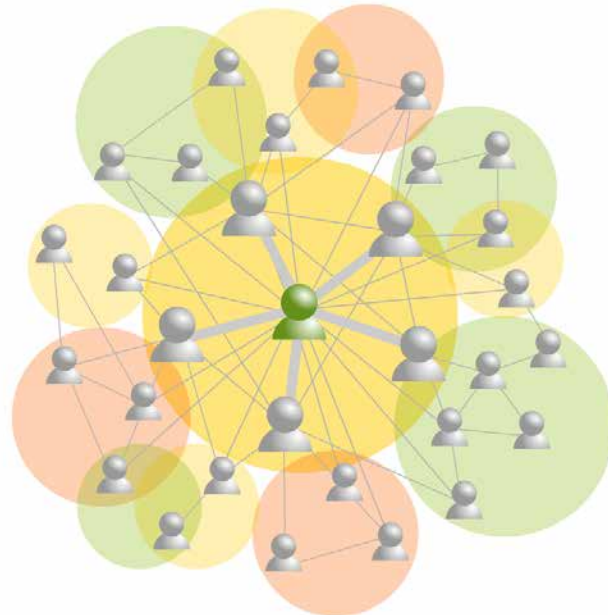

CONNECTIONS THROUGH WEAK TIES



SOURCE: MORGAN, J. (2014, 11 MAART). WHY EVERY EMPLOYEE SHOULD BE BUILDING WEAK TIES AT WORK. FORBES. [HTTPS://WWW.FORBES.COM/SITES/JACOBMORGAN/2014/03/11/EVERY-EMPLOYEE-WEAK-TIES-WORK/](https://www.forbes.com/sites/jacobmorgan/2014/03/11/every-employee-weak-ties-work/)

WILLIS, R. (2025, 2 MEI). SIX SMALL (BUT EFFECTIVE) WAYS TO CONNECT WITH YOUR NEIGHBOURS. THE SYDNEY MORNING HERALD. [HTTPS://WWW.SMH.COM.AU/LIFESTYLE/LIFE-AND-RELATIONSHIPS/SIX-SMALL-BUT-EFFECTIVE-WAYS-TO-CONNECT-WITH-YOUR-NEIGHBOURS-20250502-P5LVZ0.HTML](https://www.smh.com.au/lifestyle/life-and-relationships/six-small-but-effective-ways-to-connect-with-your-neighbours-20250502-p5lvz0.html)

RESEARCH QUESTION

“How can mixed use apartment blocks be improved to create more opportunities for social interaction?”

RESEARCH

RESEARCH

LITERATURE RESEARCH

CASE STUDIES

ENSURE A FEELING OF HOME

ENSURE COLLISION

ENSURE SPACE

ENSURE ALTERNATIVE

ROUTE THROUGH

THE BUILDING

GUIDELINES

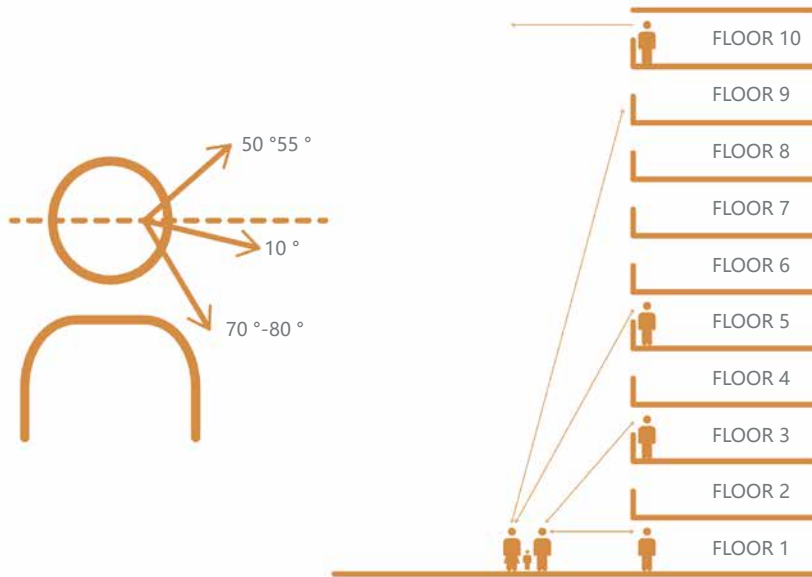
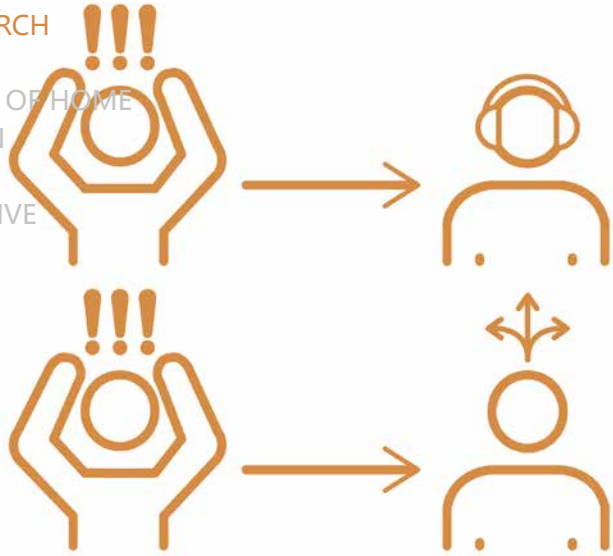

RESEARCH

LITERATURE RESEARCH

CASE STUDIES

ENSURE A FEELING OF HOME

ENSURE COLLISION

ENSURE SPACE

ENSURE ALTERNATIVE

ROUTE THROUGH

THE BUILDING

GUIDELINES



PRIVACY



OWNERSHIP

RESEARCH

LITERATURE RESEARCH

CASE STUDIES

ENSURE A FEELING OF HOME

ENSURE COLLISION

ENSURE SPACE

ENSURE ALTERNATIVE

ROUTE THROUGH

THE BUILDING

GUIDELINES



Brekersveld Zuidwijk
Rotterdam
The Netherlands
Zijdekwartier architecten

RESEARCH

LITERATURE RESEARCH

CASE STUDIES

ENSURE A FEELING OF HOME

ENSURE COLLISION

ENSURE SPACE

ENSURE ALTERNATIVE

ROUTE THROUGH

THE BUILDING

GUIDELINES

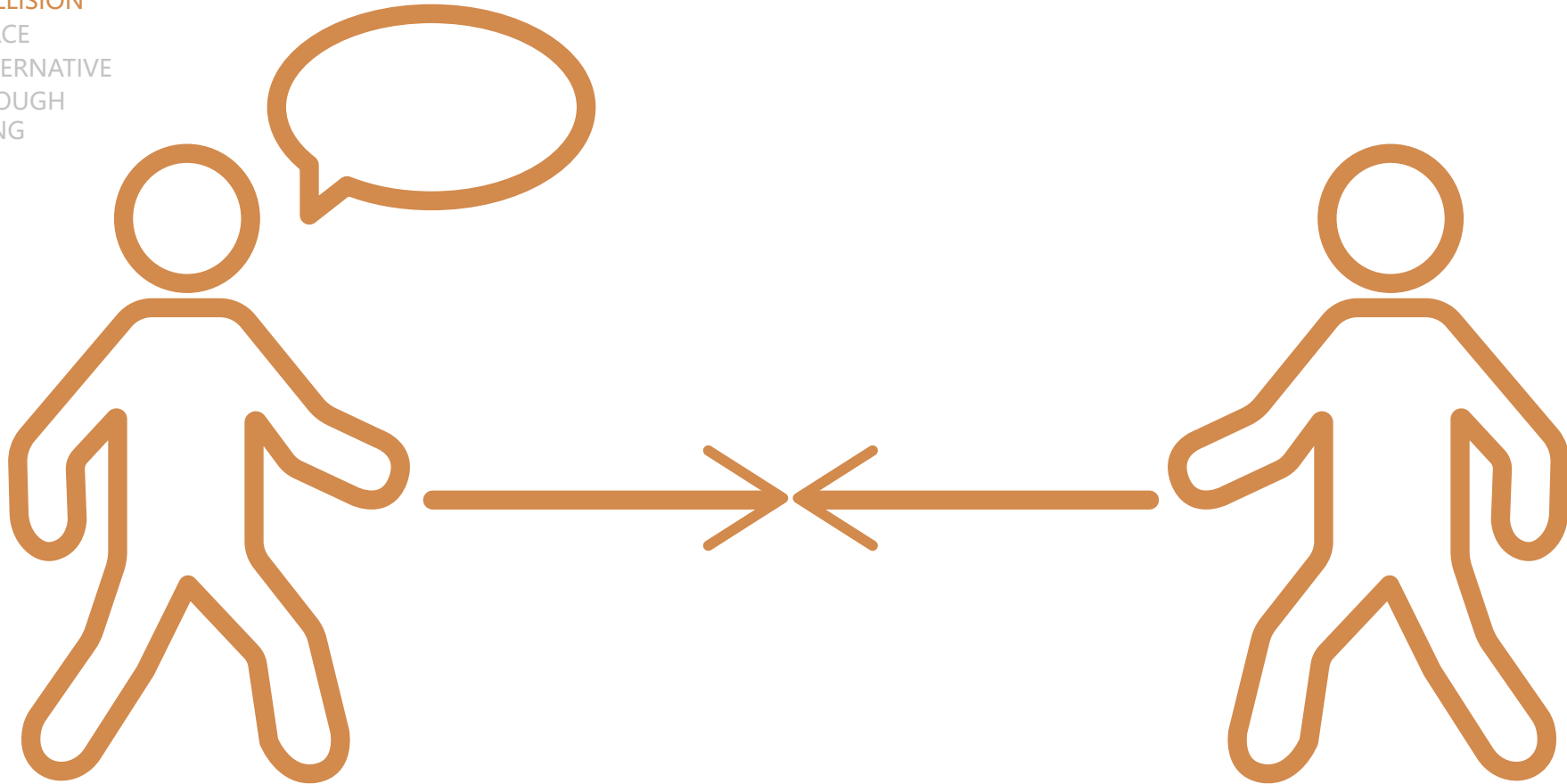

RESEARCH

LITERATURE RESEARCH

CASE STUDIES

ENSURE A FEELING OF HOME

ENSURE COLLISION

ENSURE SPACE

ENSURE ALTERNATIVE

ROUTE THROUGH

THE BUILDING

GUIDELINES

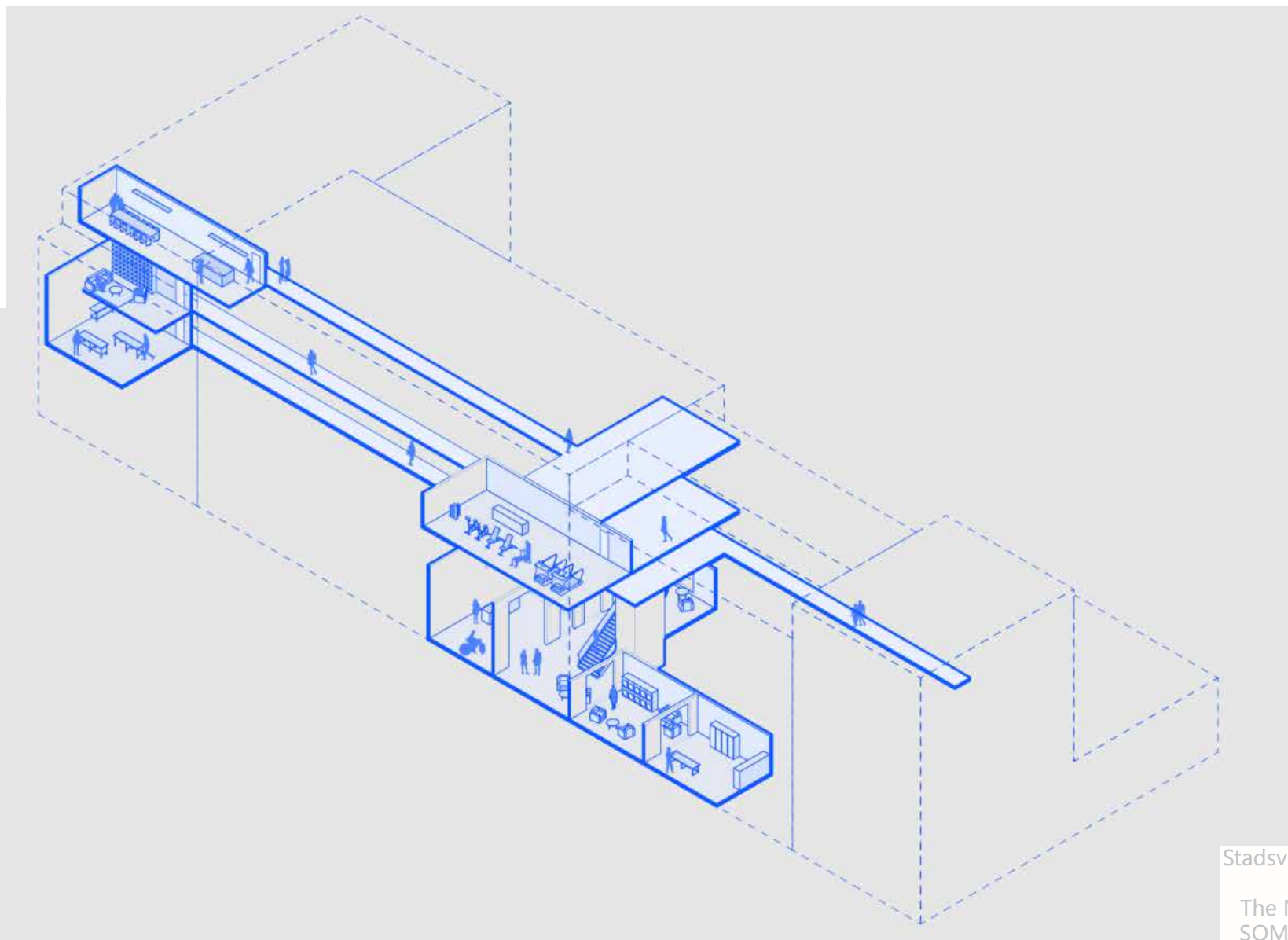

Stadsveteraan 020
Amsterdam
The Netherlands
SOME Architects

RESEARCH

LITERATURE RESEARCH

CASE STUDIES

ENSURE A FEELING OF HOME

ENSURE COLLISION

ENSURE SPACE

ENSURE ALTERNATIVE

ROUTE THROUGH

THE BUILDING

GUIDELINES

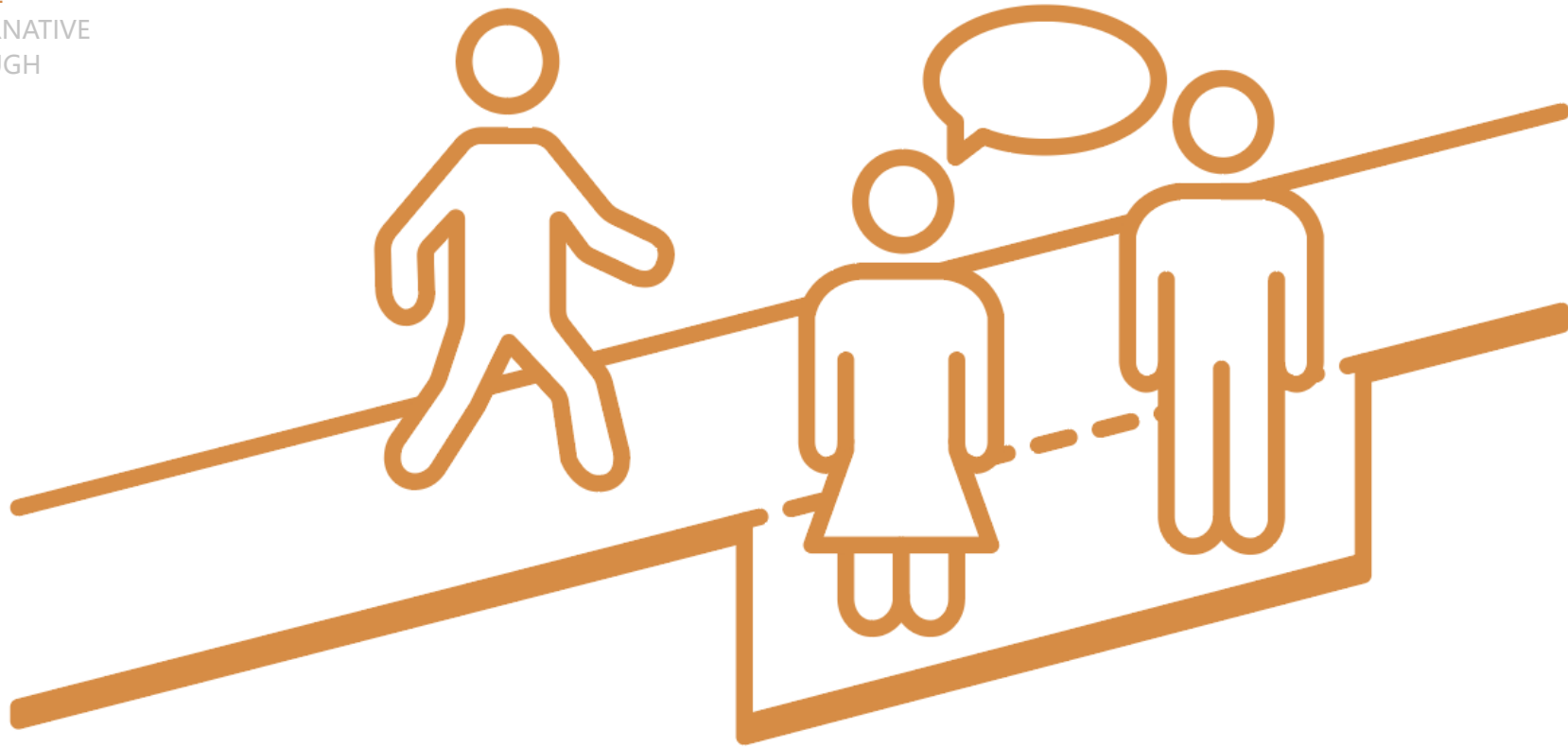

RESEARCH

LITERATURE RESEARCH

CASE STUDIES

ENSURE A FEELING OF HOME

ENSURE COLLISION

ENSURE SPACE

ENSURE ALTERNATIVE

ROUTE THROUGH

THE BUILDING

GUIDELINES



Justus van
Effencomplex
Rotterdam
The Netherlands
Michiel Brinkman

RESEARCH

LITERATURE RESEARCH

CASE STUDIES

ENSURE A FEELING OF HOME

ENSURE COLLISION

ENSURE SPACE

ENSURE ALTERNATIVE

ROUTE THROUGH

THE BUILDING

GUIDELINES

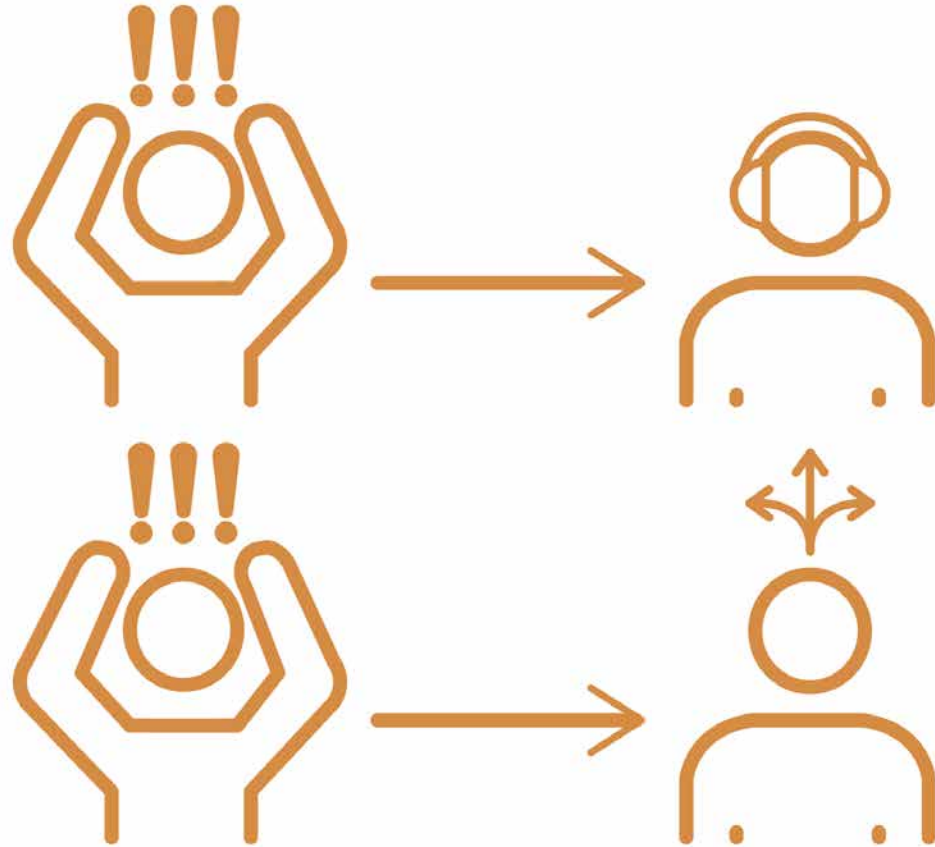

RESEARCH

LITERATURE RESEARCH

CASE STUDIES

ENSURE A FEELING OF HOME

ENSURE COLLISION

ENSURE SPACE

ENSURE ALTERNATIVE

ROUTE THROUGH

THE BUILDING

GUIDELINES



NPD Overvecht
Utrecht
The Netherlands
Paul de Ruiter architecten
& Flux landscape

RESEARCH

LITERATURE RESEARCH

CASE STUDIES

ENSURE A FEELING OF HOME

ENSURE COLLISION

ENSURE SPACE

ENSURE ALTERNATIVE

ROUTE THROUGH

THE BUILDING

GUIDELINES

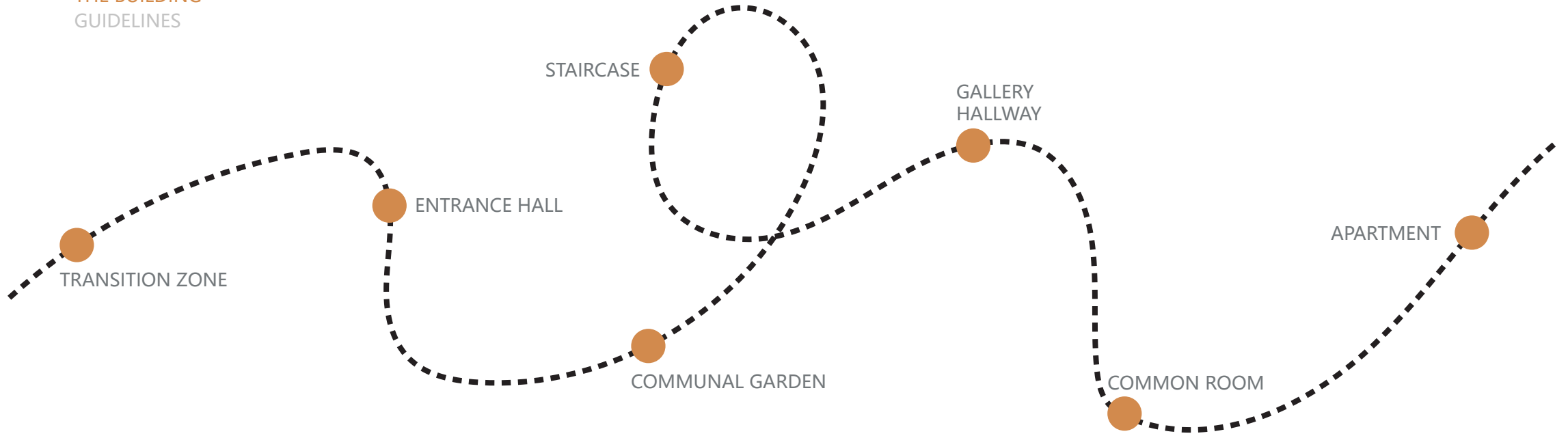

RESEARCH

LITERATURE RESEARCH

CASE STUDIES

ENSURE A FEELING OF HOME

ENSURE COLLISION

ENSURE SPACE

ENSURE ALTERNATIVE

ROUTE THROUGH

THE BUILDING

GUIDELINES



EXCESS SPACE



MIXING TARGET GROUPS



6-10P. PER BLOCK

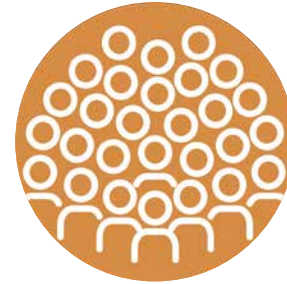

30P. PER COMMON ROOM

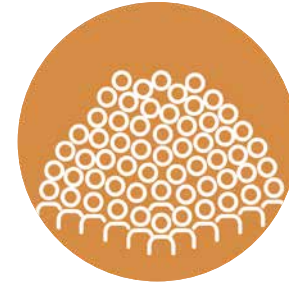

100P. PER SHARED SPACE

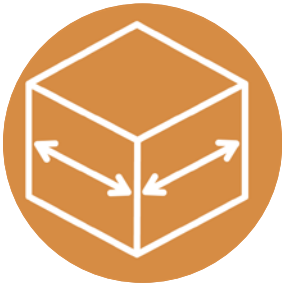

1 BLOCK < 25M

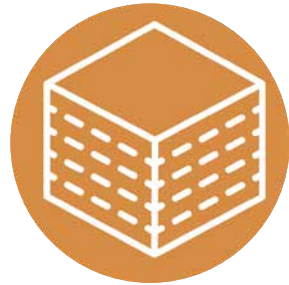

1 BLOCK < 5 STORIES

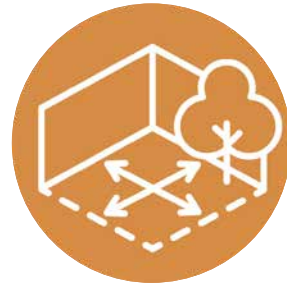

GARDEN < 25M WIDE



> 2 ROUTE OPTIONS

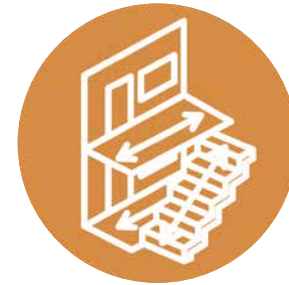

VARIABLE ROUTE



(ADJUSTABLE) SEATING



EYE CATCHER



OPENING WINDOWS AND DOORS



FUNCTION MIX



FRONTDOOR ON THE STREET

DESIGN GOAL

Creating a mixed use apartment block where neighbours know each other, feel at home and live within a high urban, but biodiverse neighbourhood.

DESIGN LOCATION

Hamerkwartier - Amsterdam North

DESIGN LOCATION

HAMERKWARTIER

HISTORY

ANALYSIS

BUILDING CONSERVATION

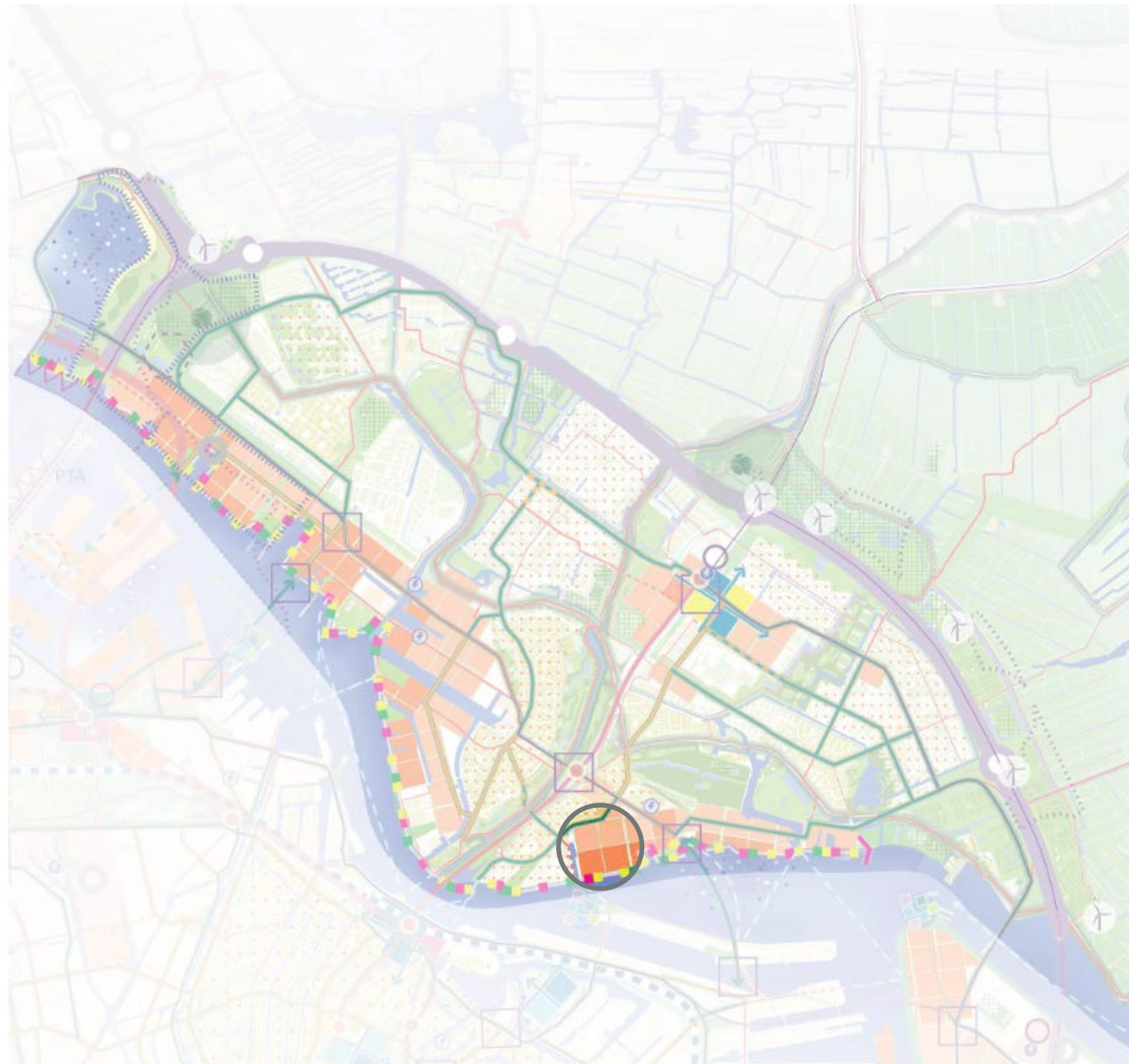

SOURCE: OMGEVINGSVISIE - AMSTERDAM 2050.
(Z.D.). OPENRESEARCH.AMSTERDAM. [HTTPS://
OPENRESEARCH.AMSTERDAM/NL/PAGE/72317/
OMGEVINGSVISIE---AMSTERDAM-2050](https://openresearch.amsterdam/nl/page/72317/omgevingsvisie---amsterdam-2050)

DESIGN LOCATION

HAMERKWARTIER

HISTORY

ANALYSIS

BUILDING CONSERVATION

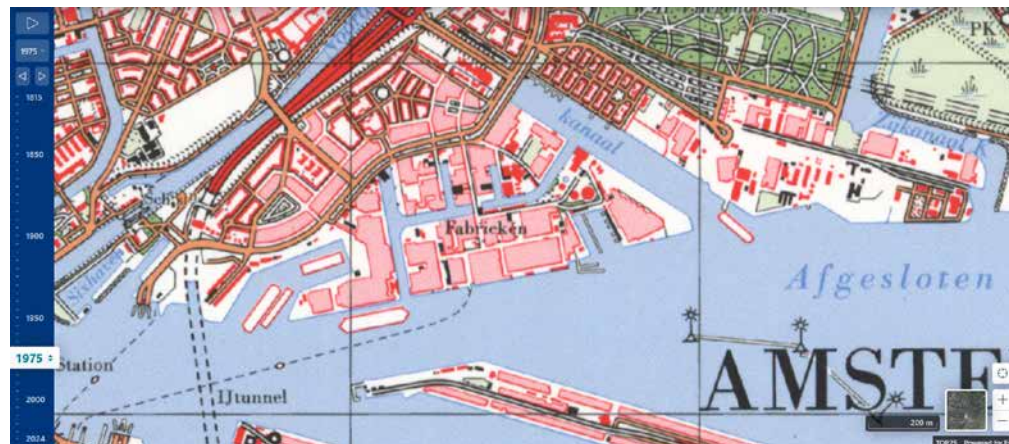
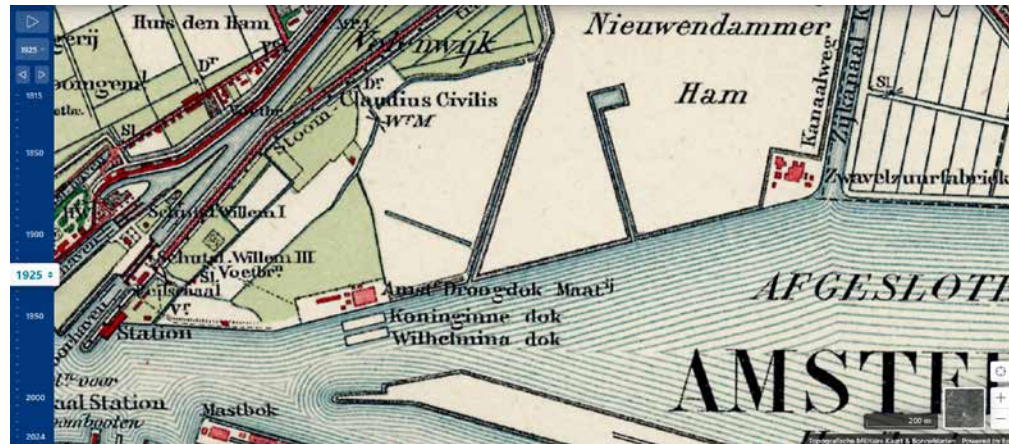

SOURCE: TOPOTIJDRUIS: 200 JAAR TOPOGRAFISCHE KAARTEN. (Z.D.). TOPOTIJDRUIS. [HTTPS://WWW.TOPOTIJDRUIS.NL/KAART/1925/@122991,488107,10.56](https://www.topotijdreis.nl/kaart/1925/@122991,488107,10.56)

DESIGN LOCATION

HAMERKWARTIER

HISTORY

ANALYSIS

BUILDING CONSERVATION



BUILDING FUNCTION



CAR ROADS AND PARKING



BLUE AND GREEN STRUCTURES

DESIGN LOCATION

HAMERKWARTIER

HISTORY

ANALYSIS

BUILDING CONSERVATION



DESIGN

A home in Hamerkwartier

DESIGN

MASTERPLAN

- TRANSITION ZONE
- ENTRANCE HALL
- COMMUNAL GARDEN
- STAIRCASE

- GALLERY
- COMMON ROOM
- APARTMENTS
- FACADE DESIGN
- CLIMATE DESIGN

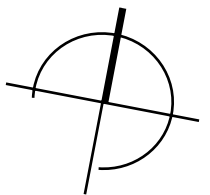
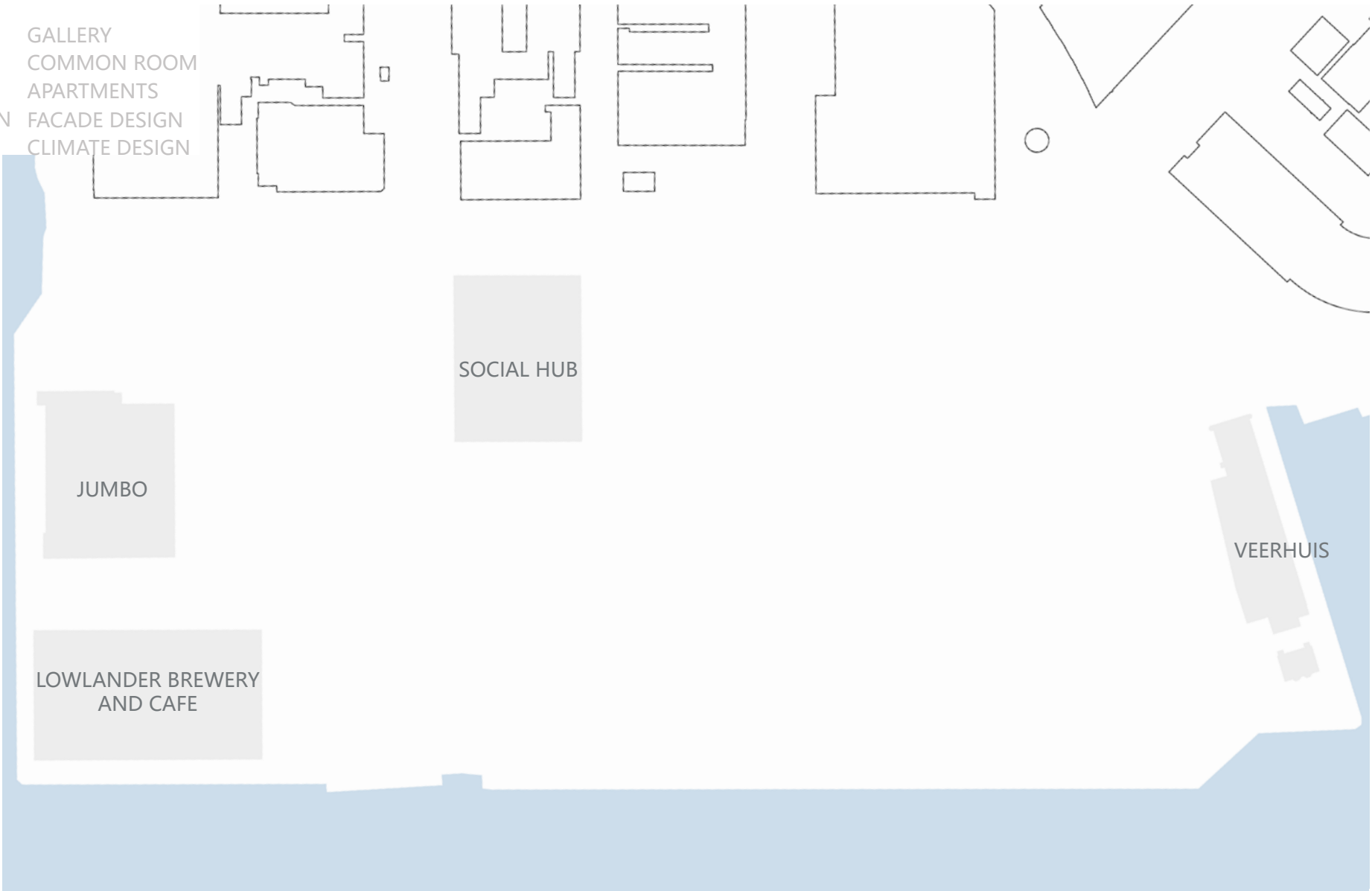

DESIGN

MASTERPLAN

- TRANSITION ZONE
- ENTRANCE HALL
- COMMUNAL GARDEN
- STAIRCASE

- GALLERY
- COMMON ROOM
- APARTMENTS
- FACADE DESIGN
- CLIMATE DESIGN

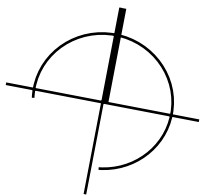
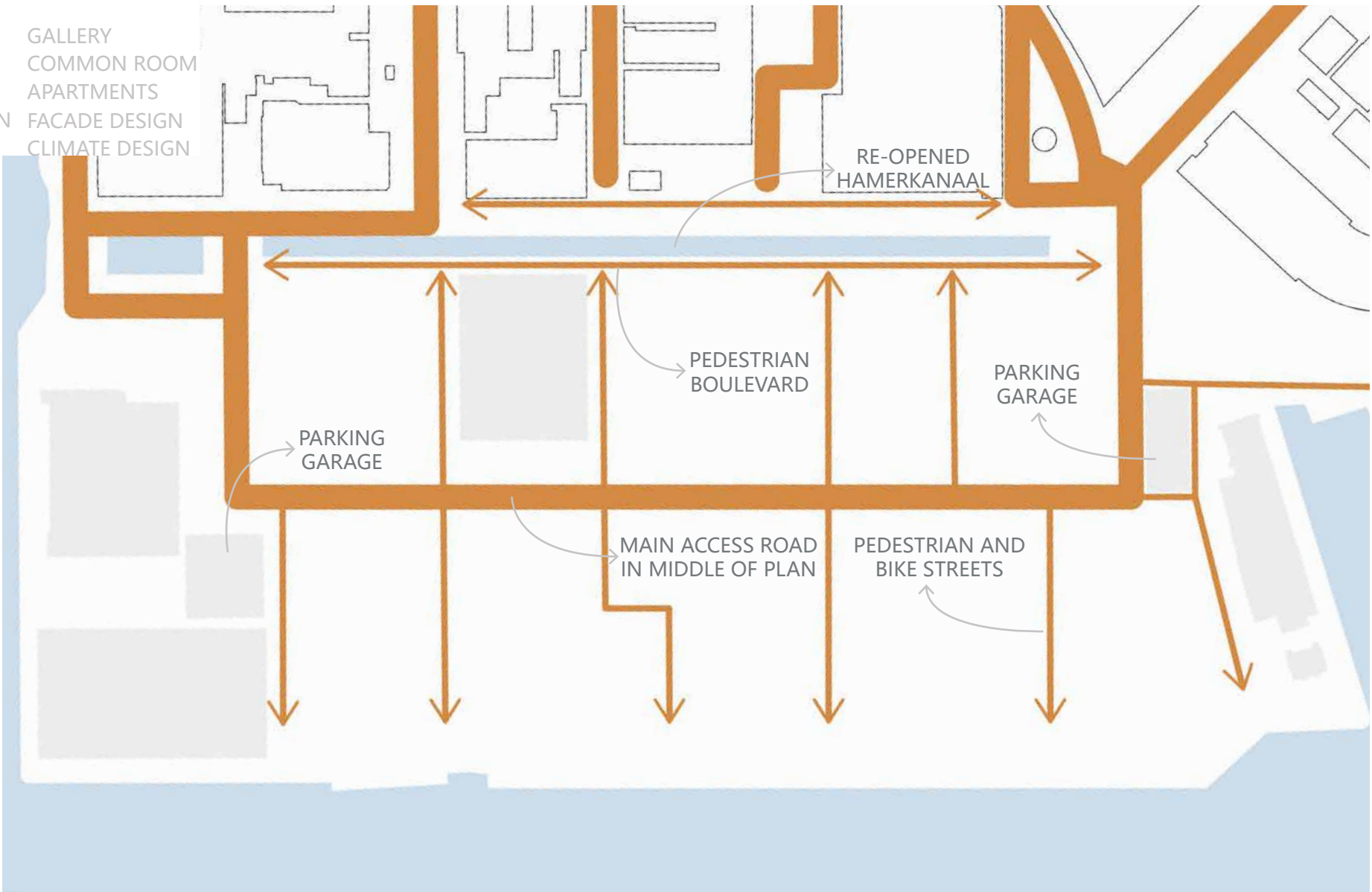

DESIGN

MASTERPLAN

- TRANSITION ZONE
- ENTRANCE HALL
- COMMUNAL GARDEN
- STAIRCASE

- GALLERY
- COMMON ROOM
- APARTMENTS
- FACADE DESIGN
- CLIMATE DESIGN

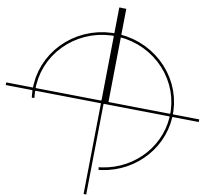
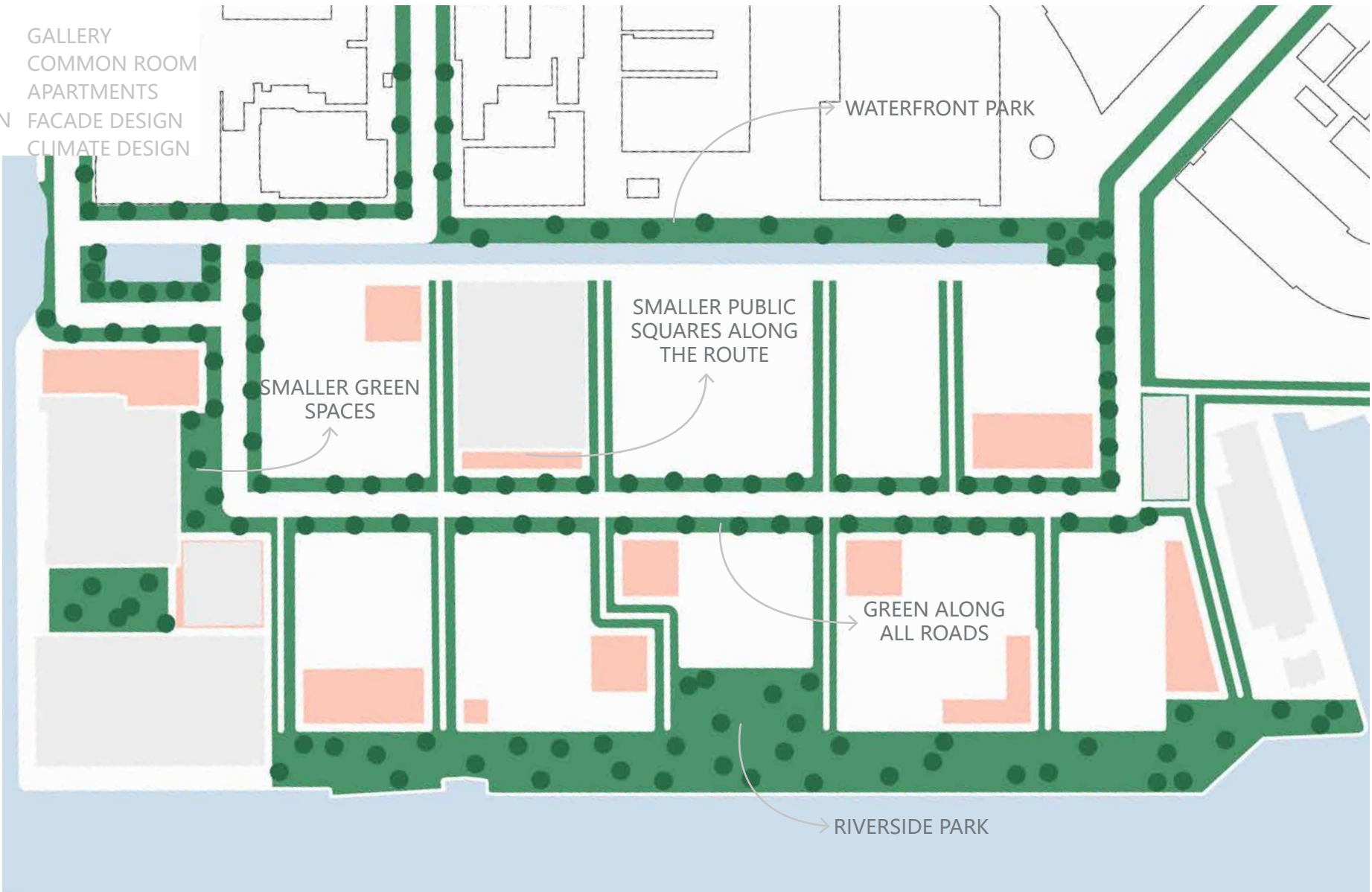

DESIGN

MASTERPLAN

TRANSITION ZONE

ENTRANCE HALL

COMMUNAL GARDEN

STAIRCASE

GALLERY

COMMON ROOM

APARTMENTS

FACADE DESIGN

CLIMATE DESIGN

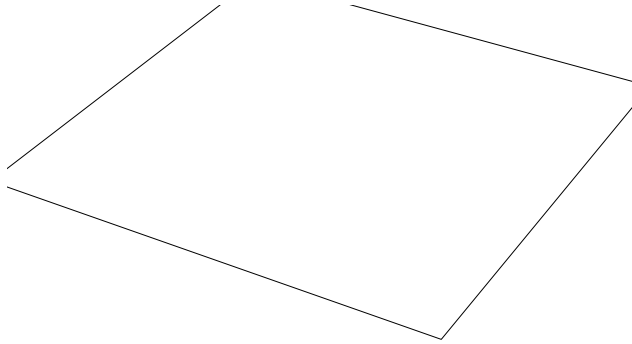

PLOT SIZE

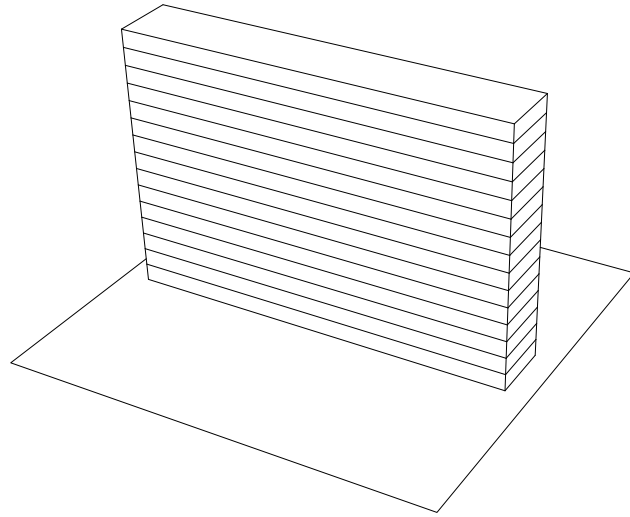

1970' S FLAT INCLUDING GREEN SPACE NEEDED FOR SUN

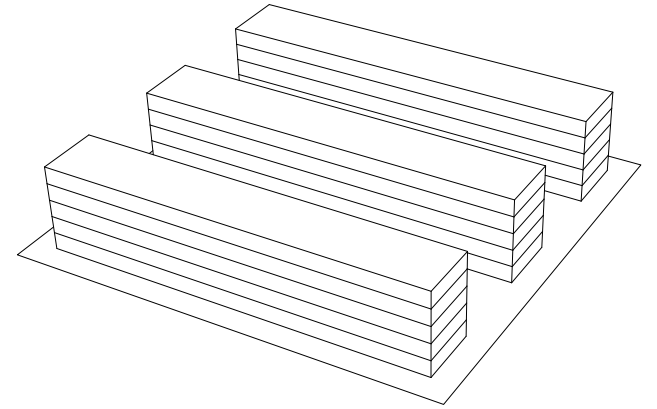

FLAT LOWERED TO 5 STORIES FOR GROUND CONNECTION

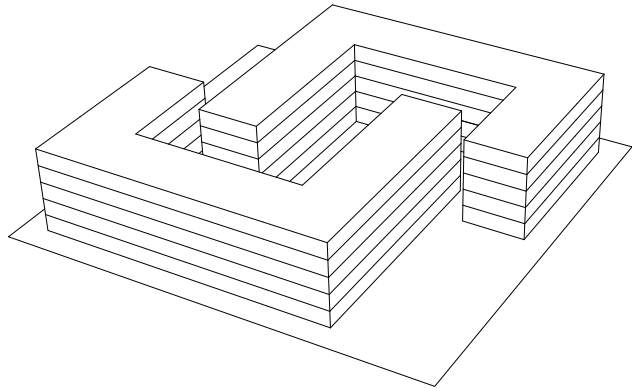

CHANGE THE CONFIGURATION TO OPEN UP SQUARES

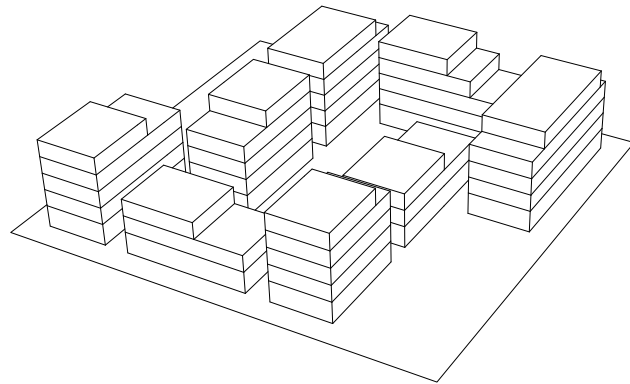

BREAKING OPEN AND CHANGING HEIGHT TO LET IN MORE SUN LIGHT

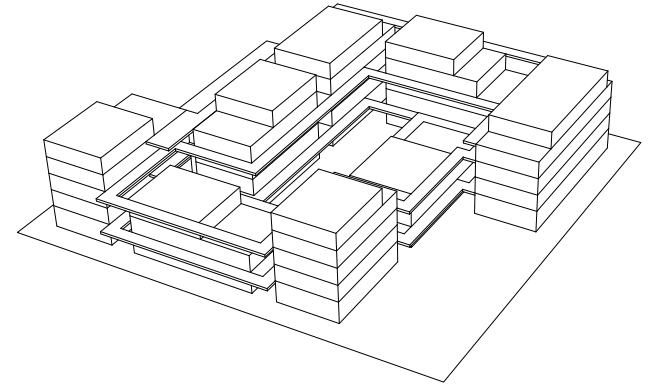

CONNECTION THROUGH 2 DIFFERENT GALLERIES

DESIGN

MASTERPLAN

- TRANSITION ZONE
- ENTRANCE HALL
- COMMUNAL GARDEN
- STAIRCASE

- GALLERY
- COMMON ROOM
- APARTMENTS
- FACADE DESIGN
- CLIMATE DESIGN

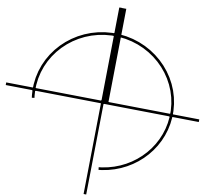

DESIGN

MASTERPLAN

TRANSITION ZONE

ENTRANCE HALL

COMMUNAL GARDEN

STAIRCASE

GALLERY

COMMON ROOM

APARTMENTS

FACADE DESIGN

CLIMATE DESIGN

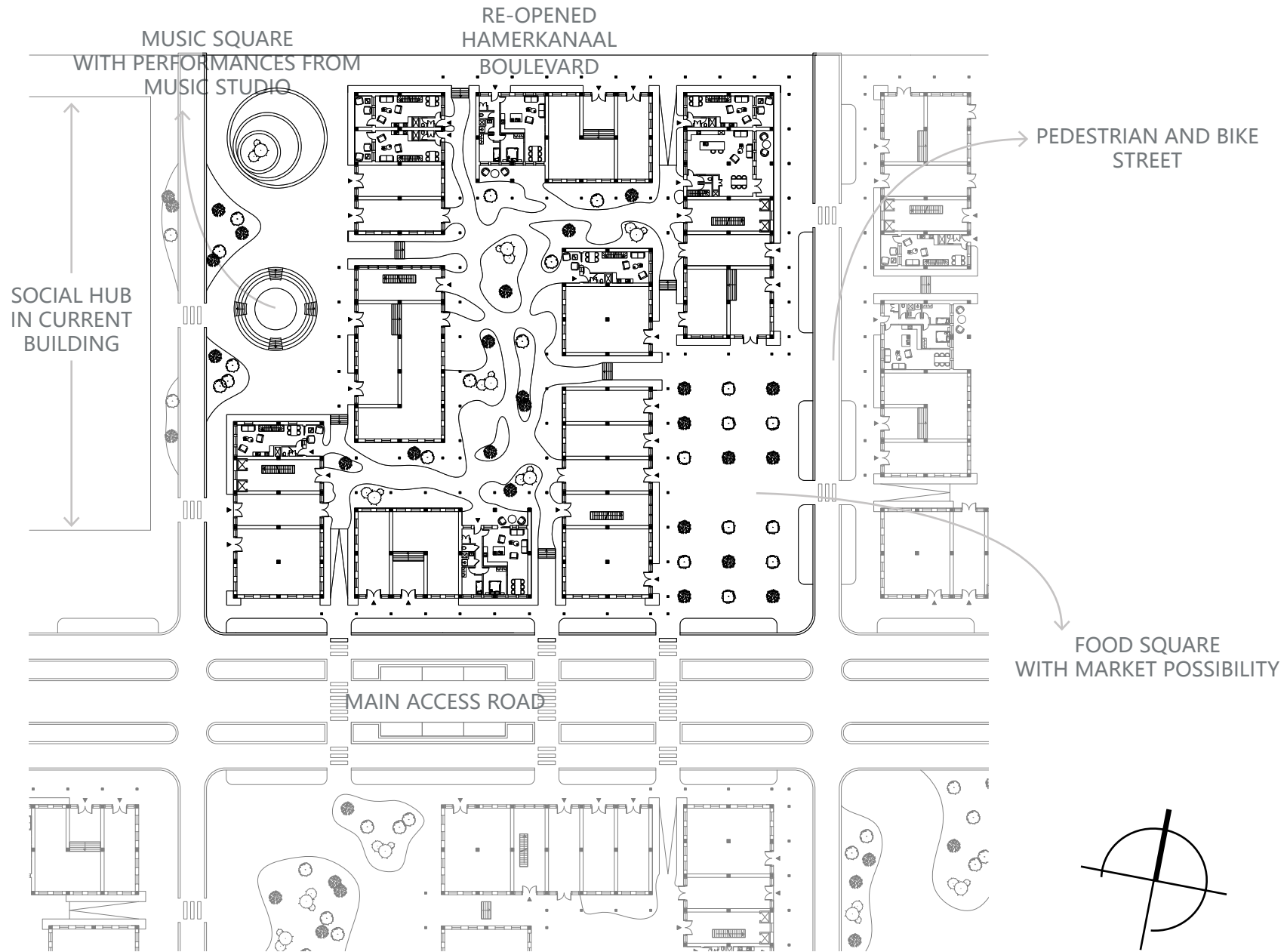

DESIGN
MASTERPLAN

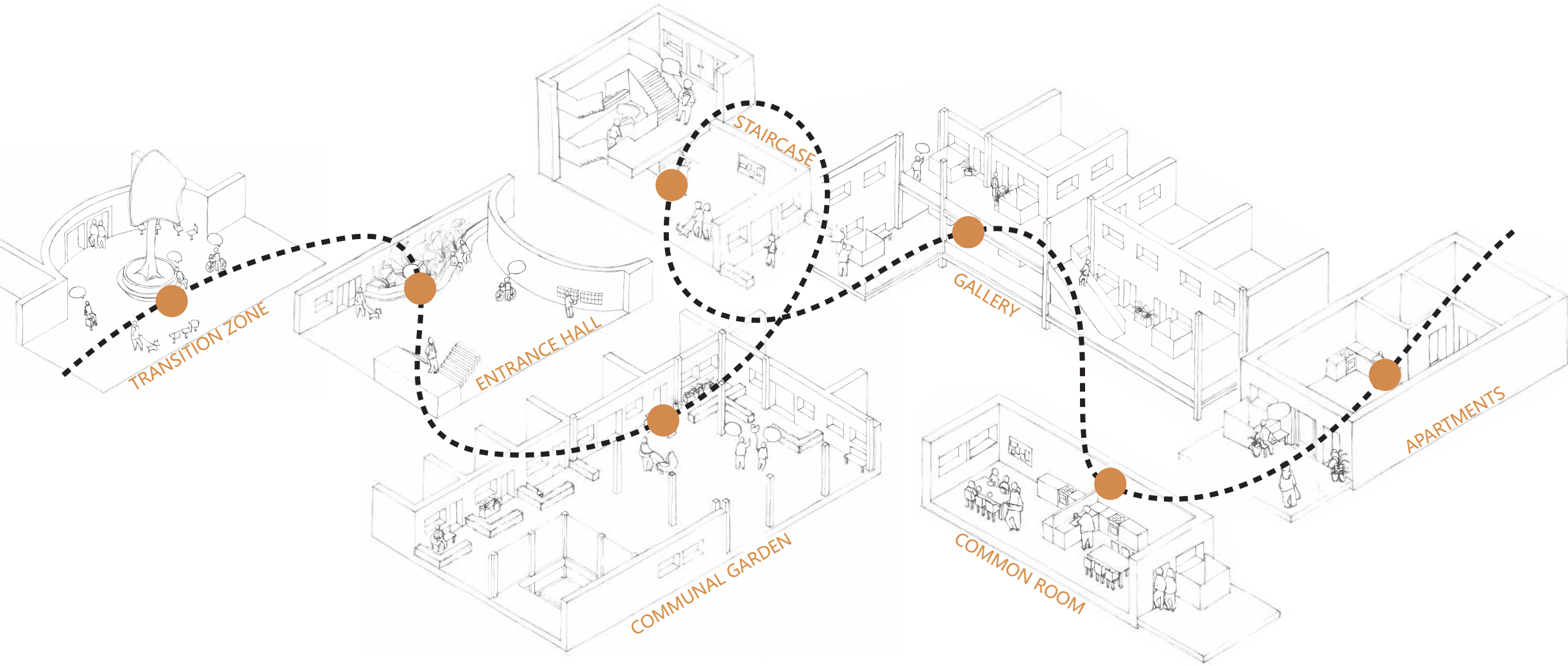

DESIGN

MASTERPLAN

TRANSITION ZONE

ENTRANCE HALL

COMMUNAL GARDEN

STAIRCASE

GALLERY

COMMON ROOM

APARTMENTS

FACADE DESIGN

CLIMATE DESIGN



MIXING TARGET GROUPS



FUNCTION MIX



FRONTDOOR ON THE STREET



DESIGN

- MASTERPLAN
- TRANSITION ZONE
- ENTRANCE HALL
- COMMUNAL GARDEN
- STAIRCASE
- GALLERY
- COMMON ROOM
- APARTMENTS
- FACADE DESIGN
- CLIMATE DESIGN



MIXING TARGET GROUPS



FUNCTION MIX



FRONTDOOR ON THE STREET

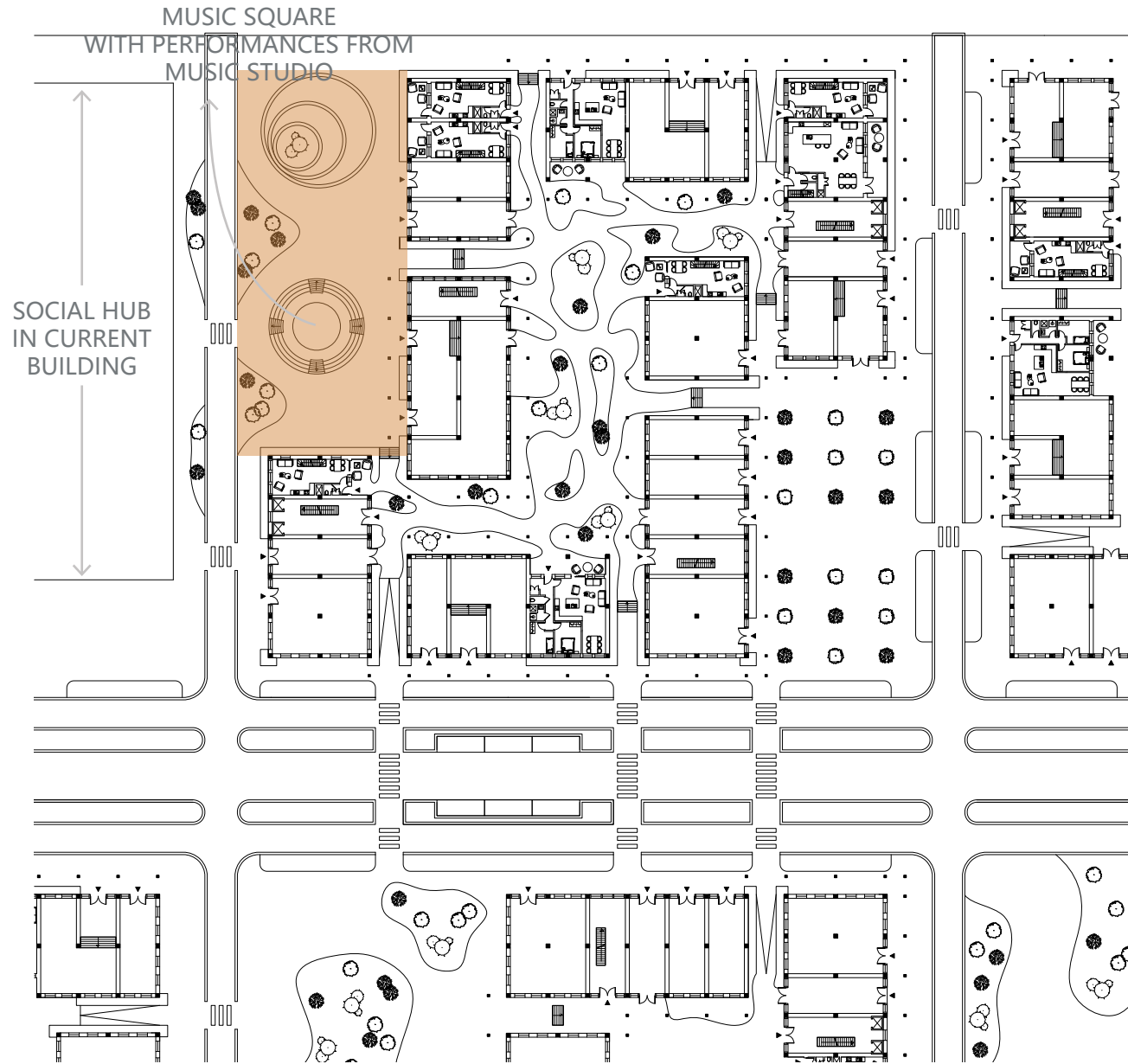

DESIGN

- MASTERPLAN
- TRANSITION ZONE
- ENTRANCE HALL
- COMMUNAL GARDEN
- STAIRCASE
- GALLERY
- COMMON ROOM
- APARTMENTS
- FACADE DESIGN
- CLIMATE DESIGN



MIXING TARGET GROUPS



FUNCTION MIX



FRONTDOOR ON THE STREET

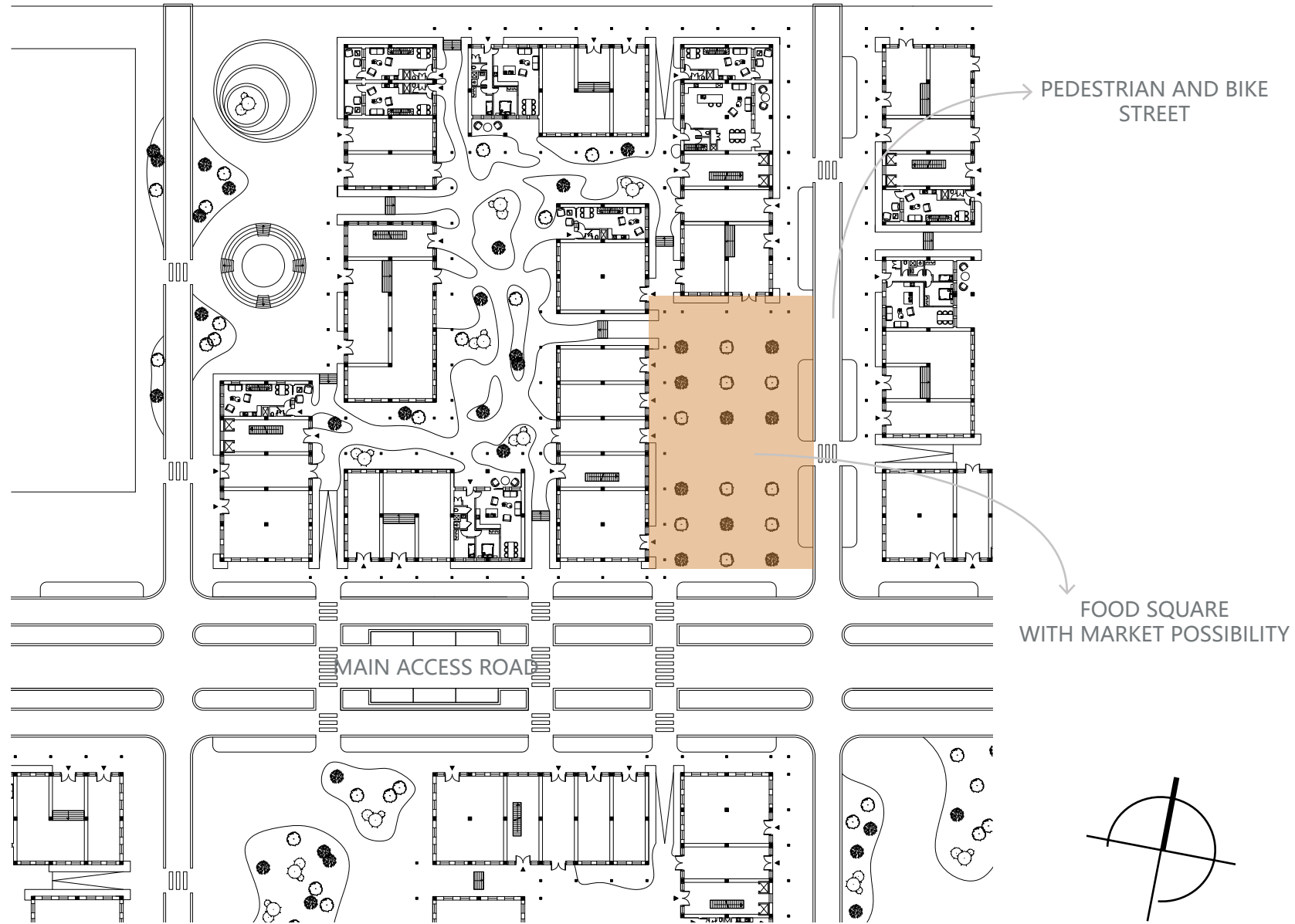

DESIGN

MASTERPLAN

TRANSITION ZONE

ENTRANCE HALL

COMMUNAL GARDEN

STAIRCASE

GALLERY

COMMON ROOM

APARTMENTS

FACADE DESIGN

CLIMATE DESIGN



FUNCTION MIX



EYE CATCHER

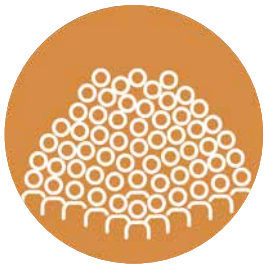

100P. PER SHARED SPACE



DESIGN

- MASTERPLAN
- TRANSITION ZONE
- ENTRANCE HALL
- COMMUNAL GARDEN
- STAIRCASE
- GALLERY
- COMMON ROOM
- APARTMENTS
- FACADE DESIGN
- CLIMATE DESIGN



FUNCTION MIX

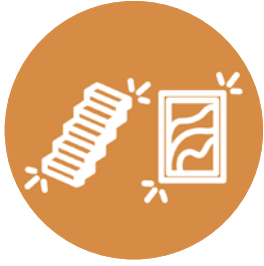

EYE CATCHER

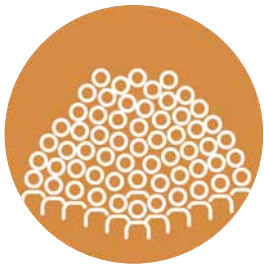

100P. PER SHARED SPACE

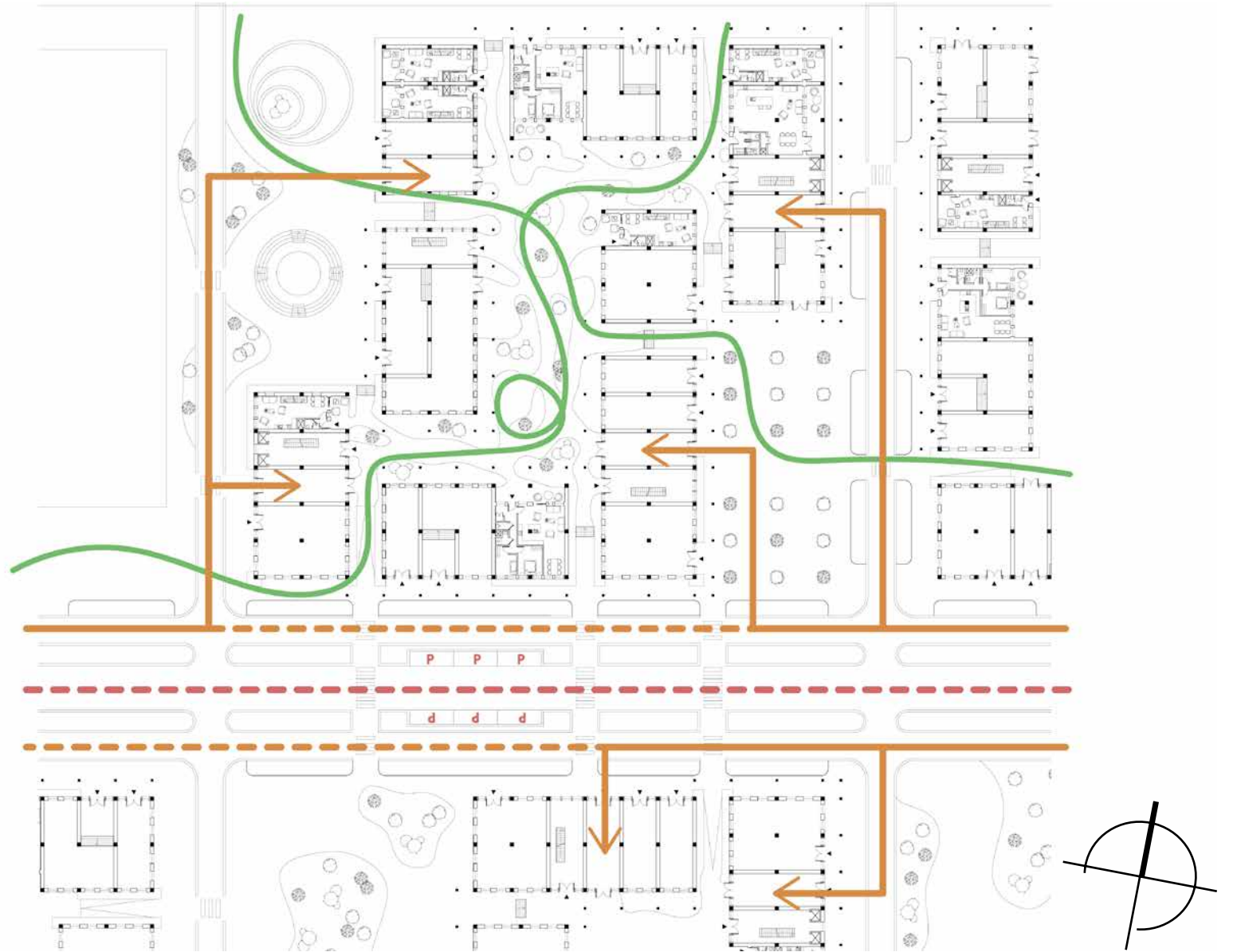

DESIGN

MASTERPLAN

TRANSITION ZONE

ENTRANCE HALL

COMMUNAL GARDEN

STAIRCASE

GALLERY

COMMON ROOM

APARTMENTS

FACADE DESIGN

CLIMATE DESIGN

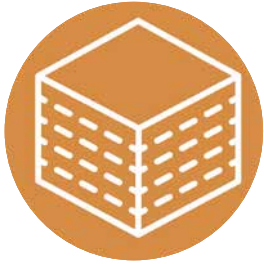

1 BLOCK < 5 STORIES

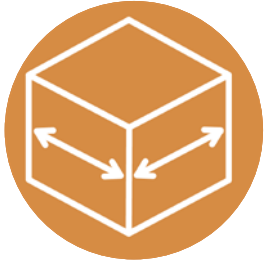

1 BLOCK < 25M



GARDEN < 25M WIDE



DESIGN

MASTERPLAN
TRANSITION ZONE
ENTRANCE HALL
COMMUNAL GARDEN
STAIRCASE

GALLERY
COMMON ROOM
APARTMENTS
FACADE DESIGN
CLIMATE DESIGN

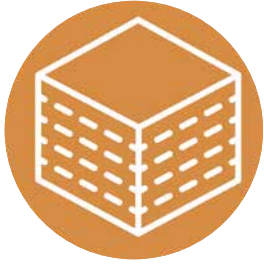

1 BLOCK < 5 STORIES

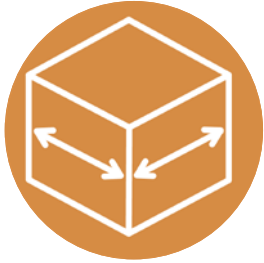

1 BLOCK < 25M



GARDEN < 25M WIDE

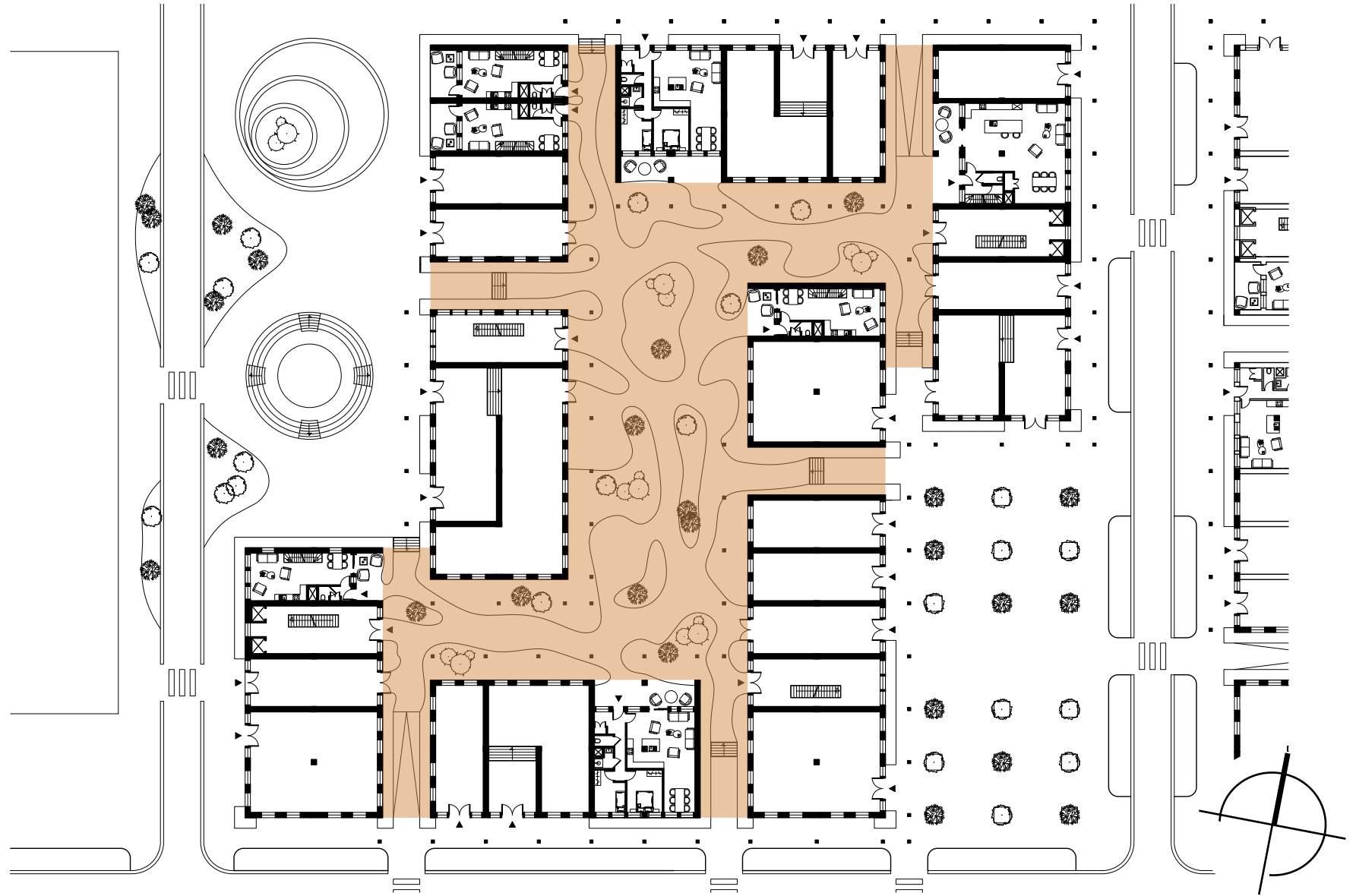

DESIGN

MASTERPLAN
TRANSITION ZONE
ENTRANCE HALL
COMMUNAL GARDEN
STAIRCASE

GALLERY
COMMON ROOM
APARTMENTS
FACADE DESIGN
CLIMATE DESIGN

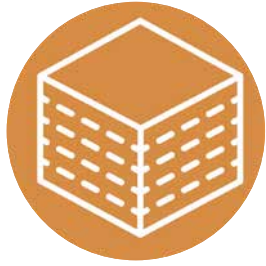

1 BLOCK < 5 STORIES

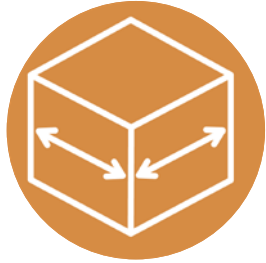

1 BLOCK < 25M



GARDEN < 25M WIDE

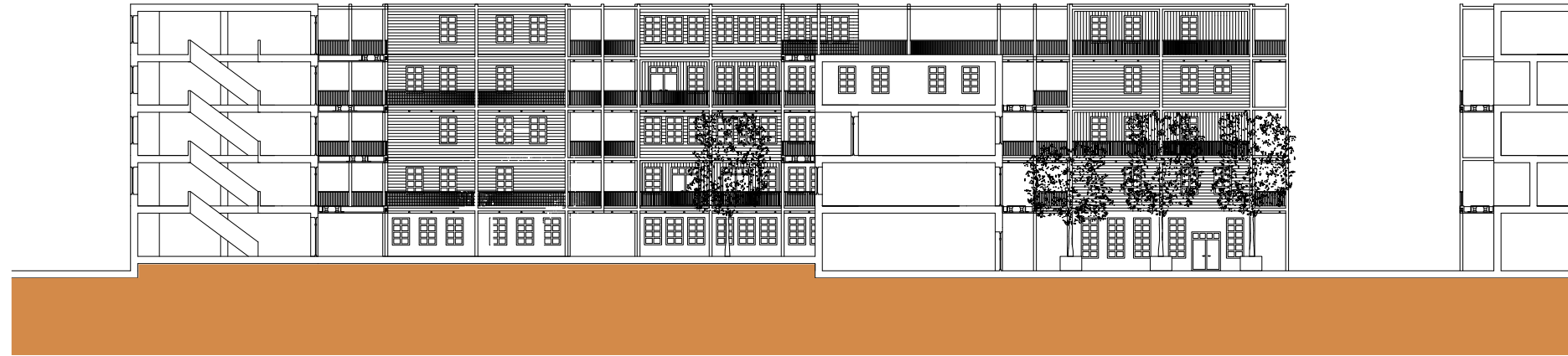

DESIGN

- MASTERPLAN
- TRANSITION ZONE
- ENTRANCE HALL
- COMMUNAL GARDEN
- STAIRCASE
- GALLERY
- COMMON ROOM
- APARTMENTS
- FACADE DESIGN
- CLIMATE DESIGN

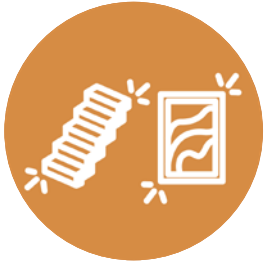

EYE CATCHER



(ADJUSTABLE) SEATING

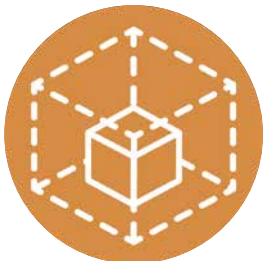

EXCESS SPACE



DESIGN

- MASTERPLAN
- TRANSITION ZONE
- ENTRANCE HALL
- COMMUNAL GARDEN
- STAIRCASE
- GALLERY
- COMMON ROOM
- APARTMENTS
- FACADE DESIGN
- CLIMATE DESIGN



EYE CATCHER



(ADJUSTABLE) SEATING

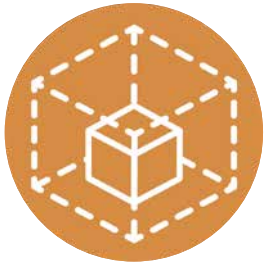

EXCESS SPACE

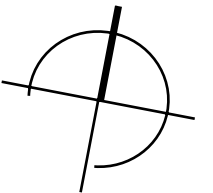
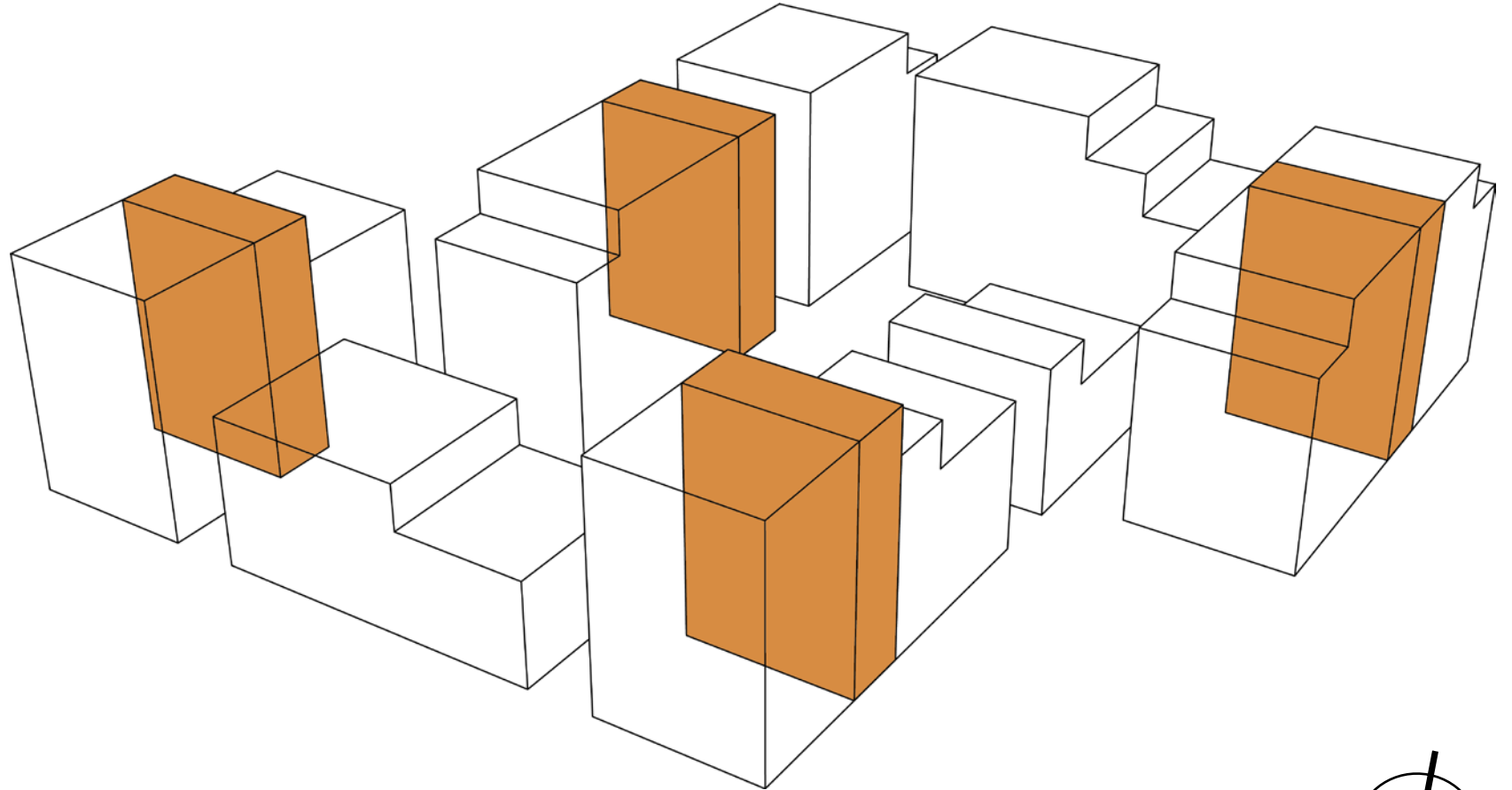

DESIGN

MASTERPLAN
TRANSITION ZONE
ENTRANCE HALL
COMMUNAL GARDEN
STAIRCASE

GALLERY
COMMON ROOM
APARTMENTS
FACADE DESIGN
CLIMATE DESIGN

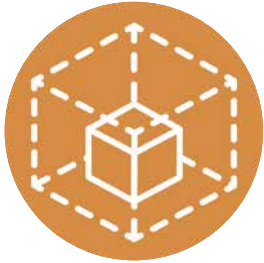

EXCESS SPACE

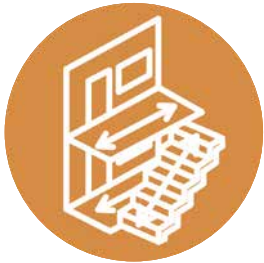

VARIABLE ROUTE



OPENING WINDOWS AND DOORS



DESIGN

MASTERPLAN

TRANSITION ZONE

ENTRANCE HALL

COMMUNAL GARDEN

STAIRCASE

GALLERY

COMMON ROOM

APARTMENTS

FACADE DESIGN

CLIMATE DESIGN

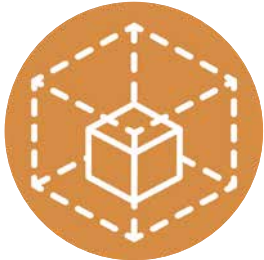

EXCESS SPACE

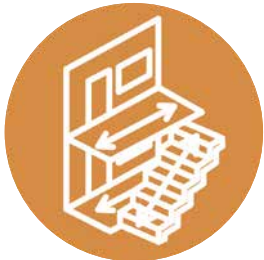

VARIABLE ROUTE



OPENING WINDOWS AND DOORS

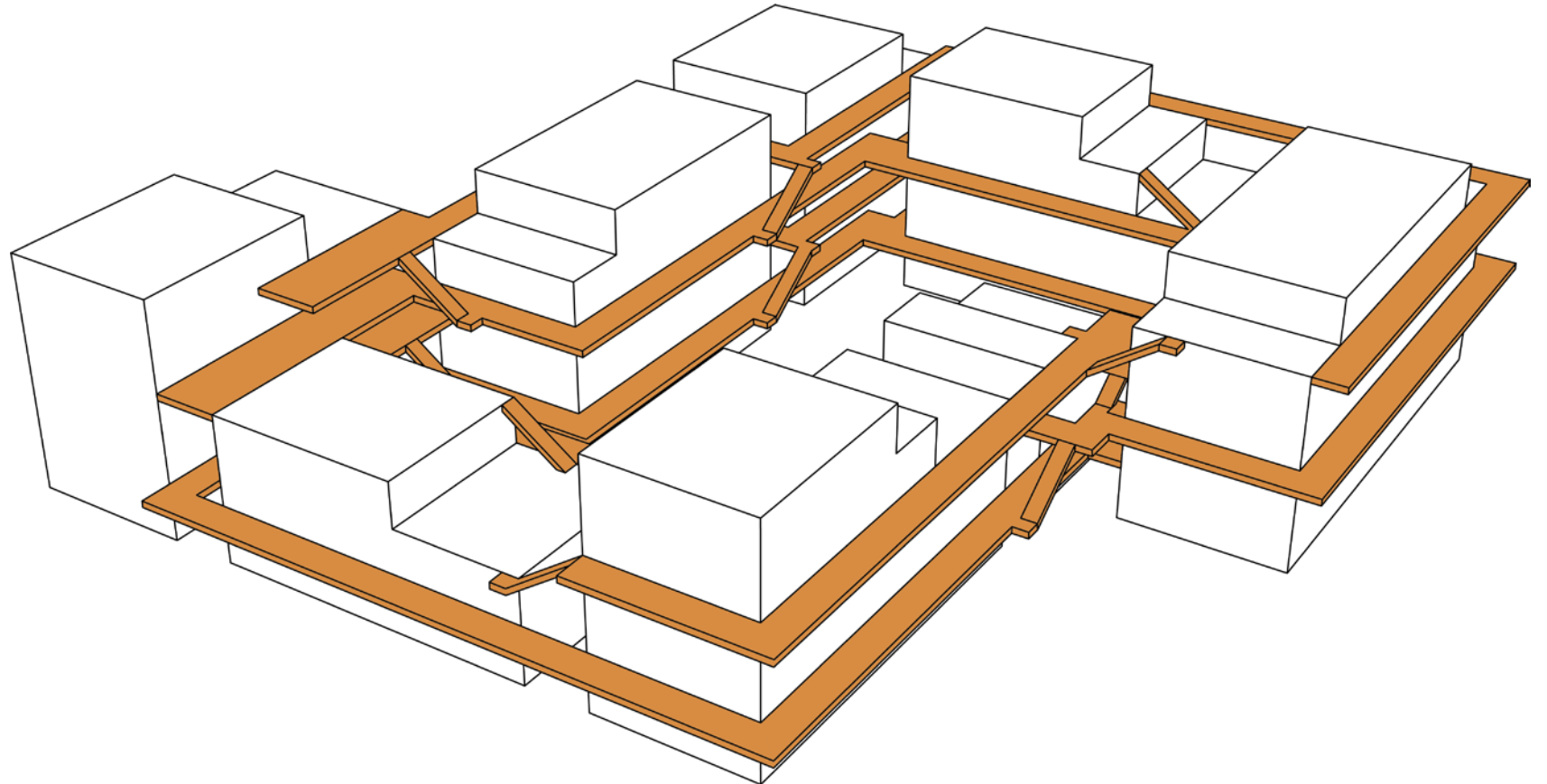

DESIGN

- MASTERPLAN
- TRANSITION ZONE
- ENTRANCE HALL
- COMMUNAL GARDEN
- STAIRCASE

GALLERY

- COMMON ROOM
- APARTMENTS
- FACADE DESIGN
- CLIMATE DESIGN

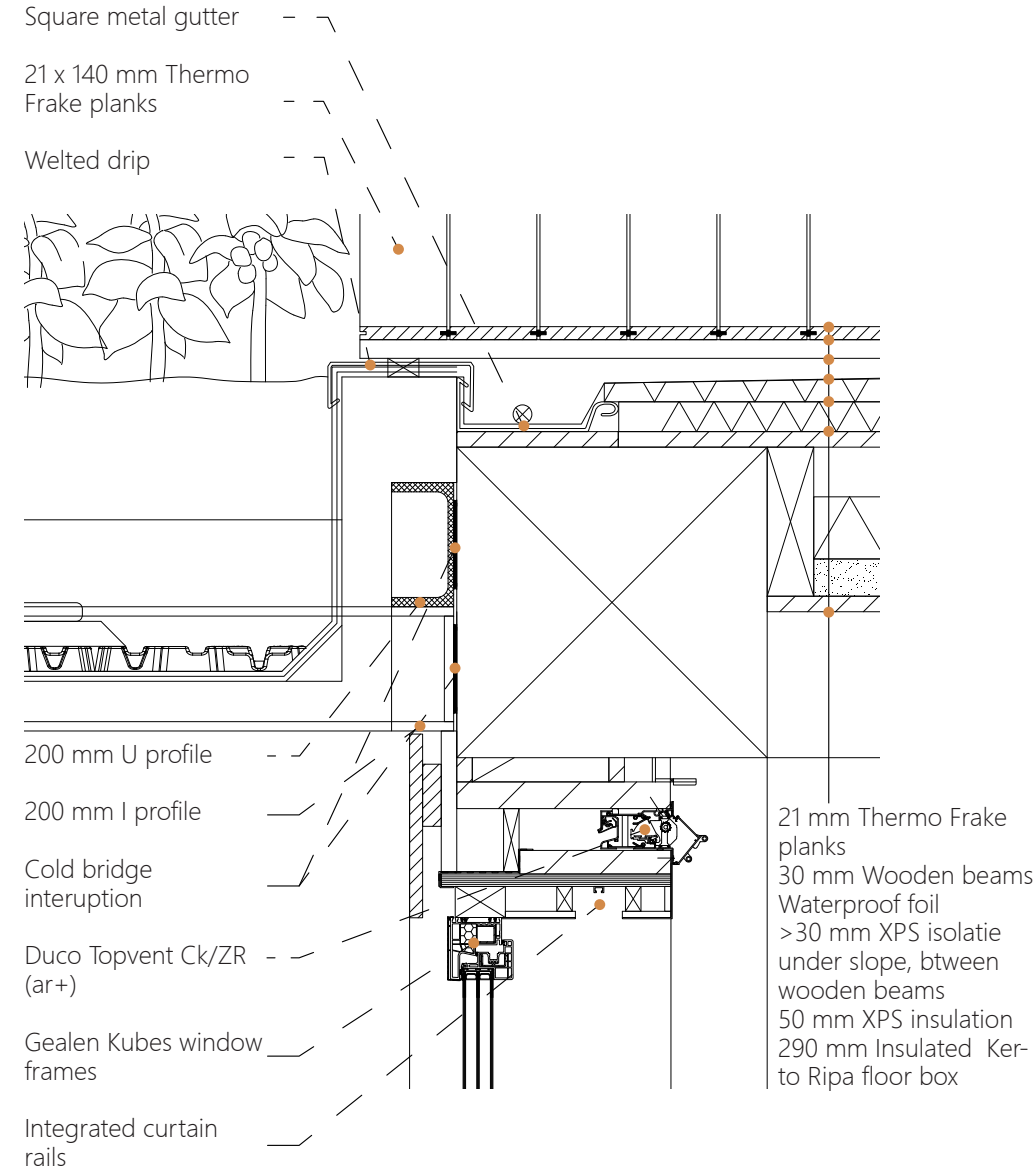
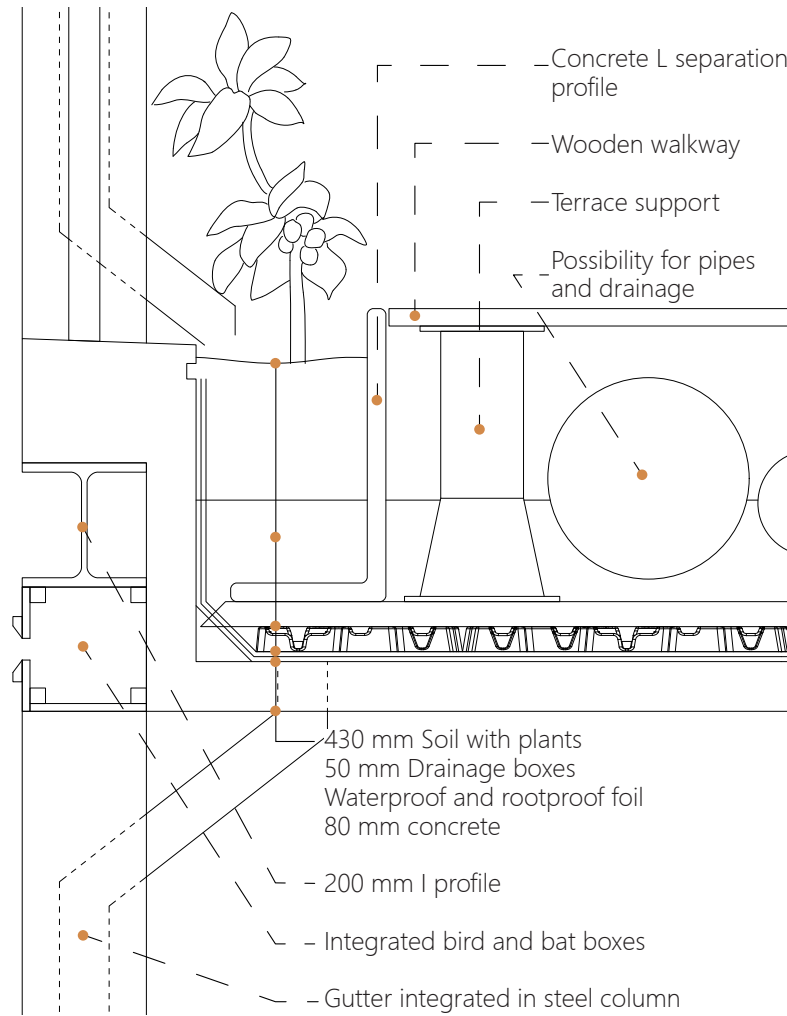

DESIGN

MASTERPLAN
TRANSITION ZONE
ENTRANCE HALL
COMMUNAL GARDEN
STAIRCASE

GALLERY
COMMON ROOM
APARTMENTS
FACADE DESIGN
CLIMATE DESIGN

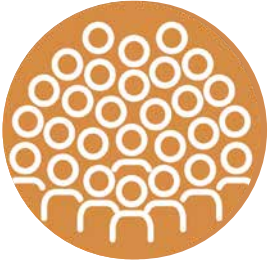

30P. PER COMMON ROOM



FUNCTION MIX



MIXING TARGET GROUPS



DESIGN

MASTERPLAN

TRANSITION ZONE

ENTRANCE HALL

COMMUNAL GARDEN

STAIRCASE

GALLERY

COMMON ROOM

APARTMENTS

FACADE DESIGN

CLIMATE DESIGN

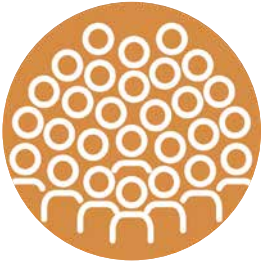

30P. PER COMMON ROOM



FUNCTION MIX



MIXING TARGET GROUPS

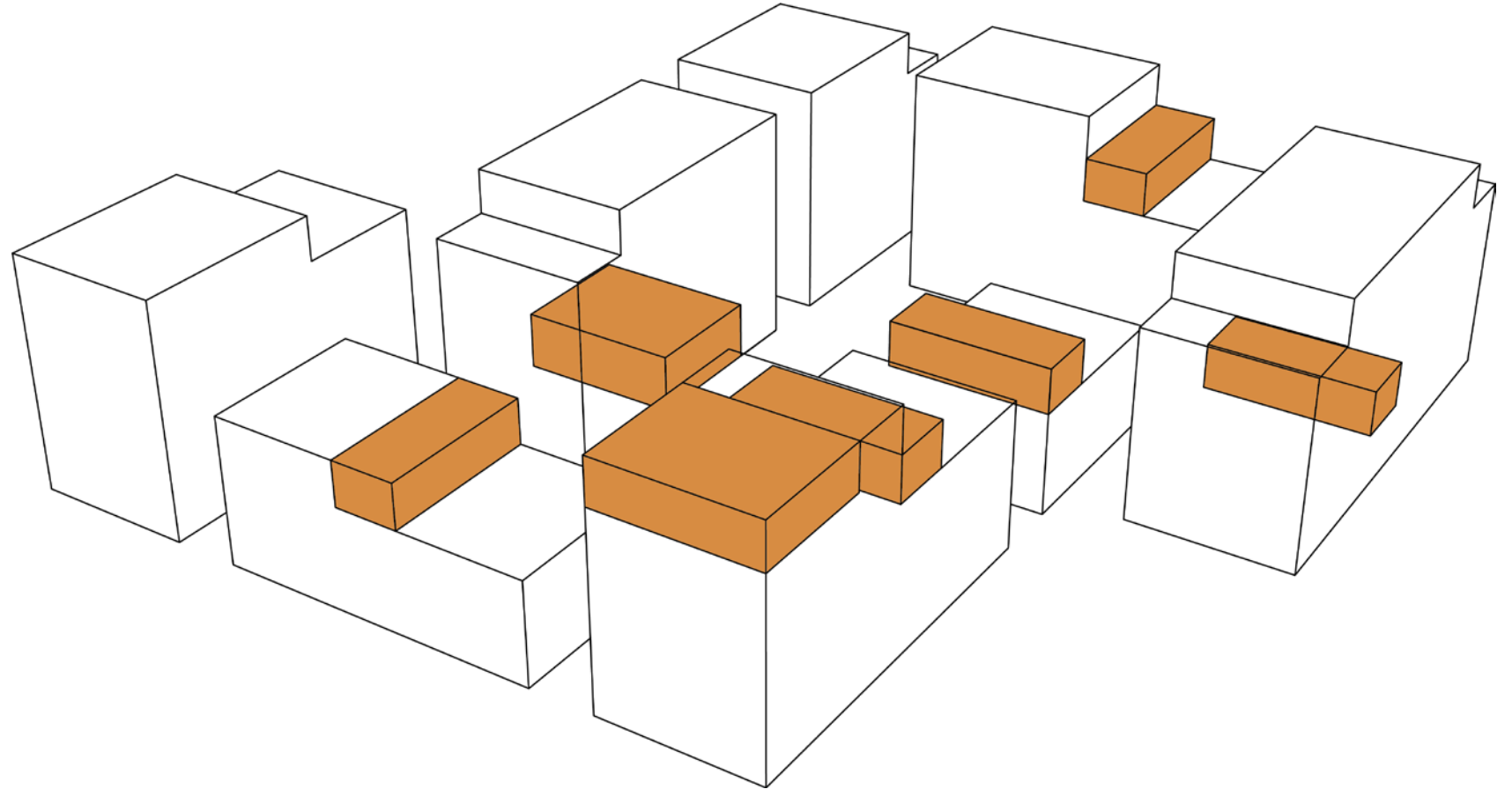

DESIGN

MASTERPLAN
TRANSITION ZONE
ENTRANCE HALL
COMMUNAL GARDEN
STAIRCASE

GALLERY
COMMON ROOM
APARTMENTS
FACADE DESIGN
CLIMATE DESIGN



FRONTDOOR ON THE STREET



OPENING WINDOWS AND DOORS

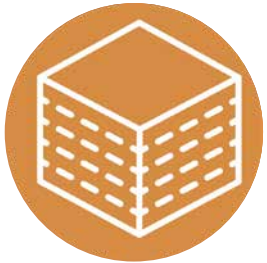

1 BLOCK < 5 STORIES



DESIGN

MASTERPLAN
TRANSITION ZONE
ENTRANCE HALL
COMMUNAL GARDEN
STAIRCASE

GALLERY
COMMON ROOM
APARTMENTS
FACADE DESIGN
CLIMATE DESIGN



FRONTDOOR ON THE STREET



OPENING WINDOWS AND DOORS

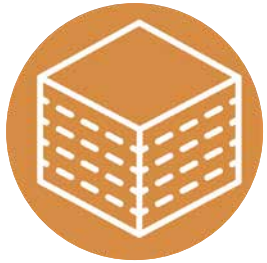

1 BLOCK < 5 STORIES

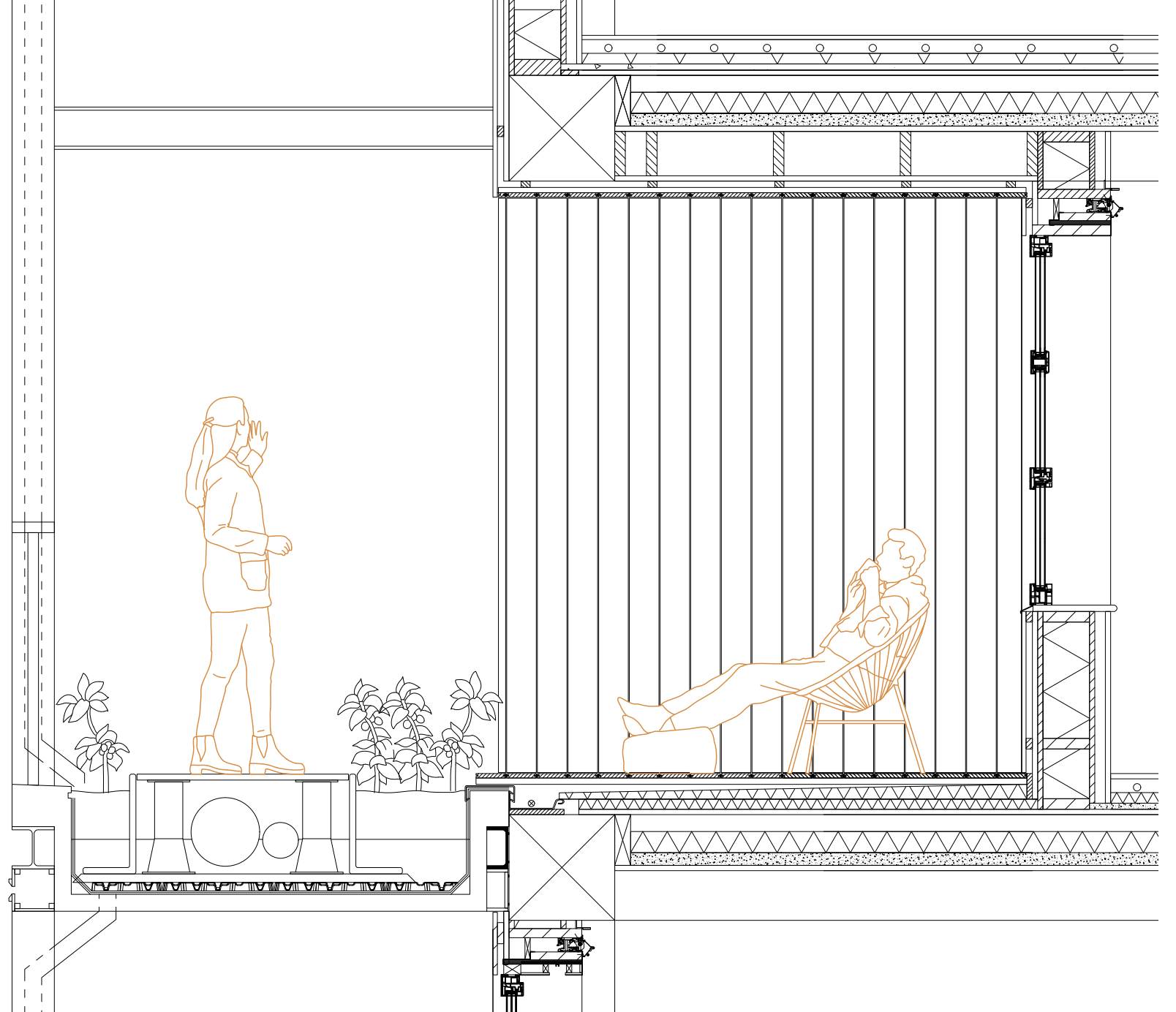

DESIGN

- MASTERPLAN
- TRANSITION ZONE
- ENTRANCE HALL
- COMMUNAL GARDEN
- STAIRCASE
- GALLERY
- COMMON ROOM
- APARTMENTS**
- FACADE DESIGN
- CLIMATE DESIGN



1 BEDROOM
42 M²

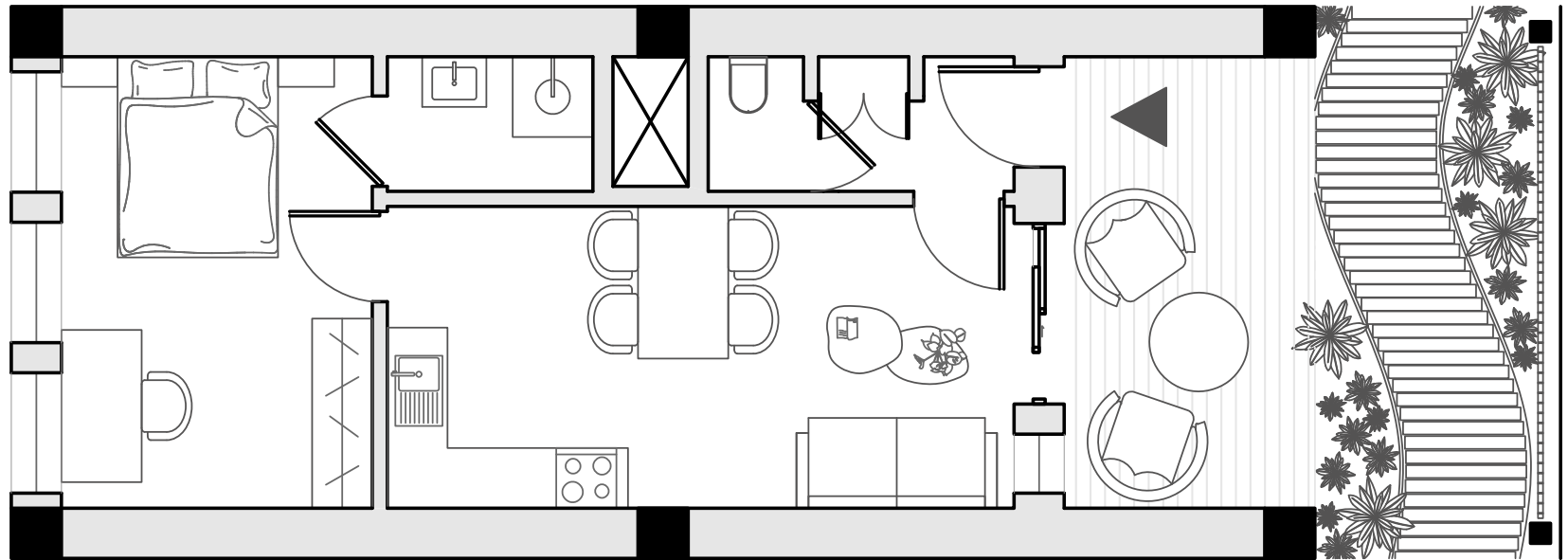

DESIGN

- MASTERPLAN
- TRANSITION ZONE
- ENTRANCE HALL
- COMMUNAL GARDEN
- STAIRCASE

- GALLERY
- COMMON ROOM
- APARTMENTS
- FACADE DESIGN
- CLIMATE DESIGN



1 BEDROOM
60 M²

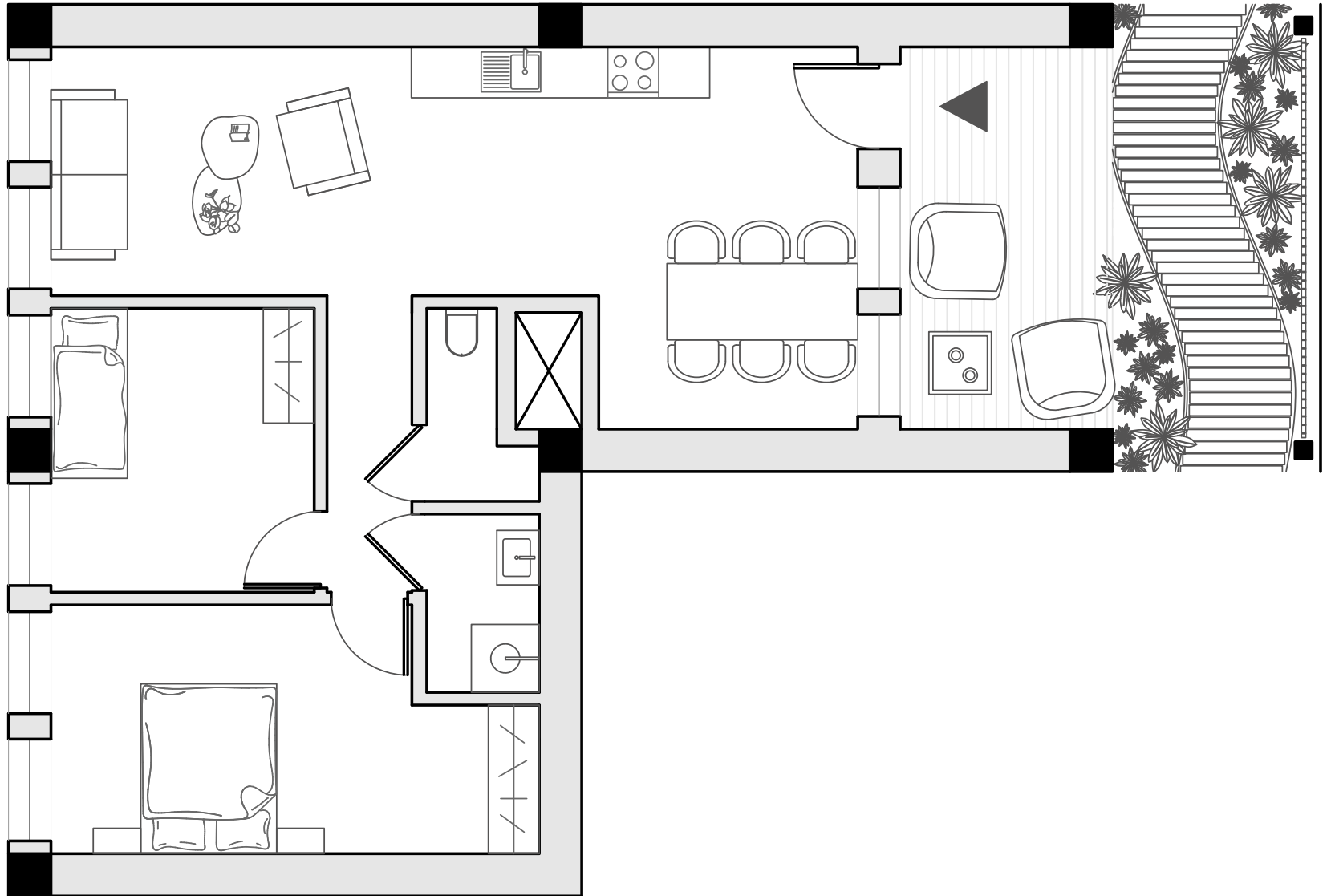

DESIGN

- MASTERPLAN
- TRANSITION ZONE
- ENTRANCE HALL
- COMMUNAL GARDEN
- STAIRCASE
- GALLERY
- COMMON ROOM
- APARTMENTS**
- FACADE DESIGN
- CLIMATE DESIGN



2 BEDROOMS
72 M²

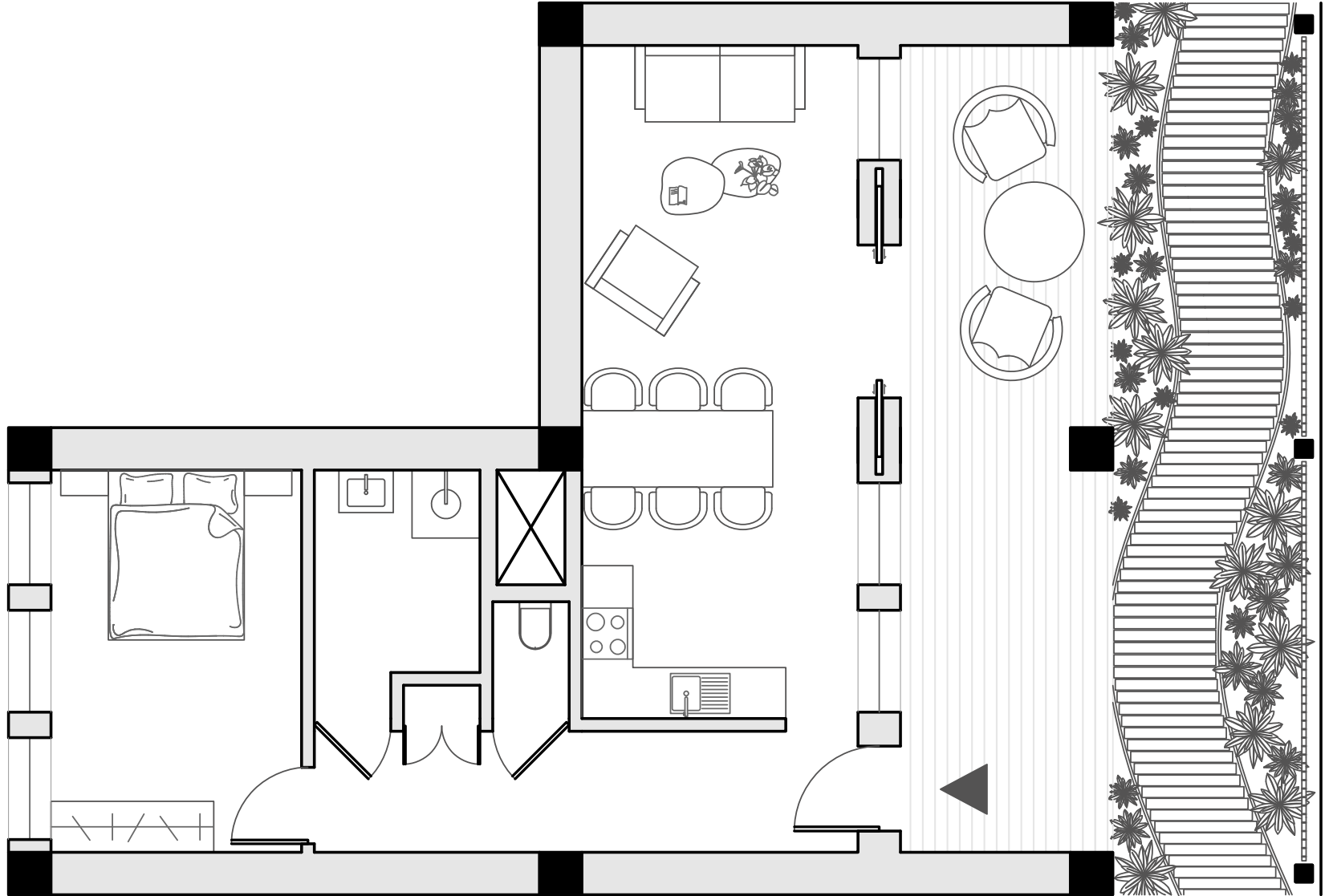

DESIGN

- MASTERPLAN
- TRANSITION ZONE
- ENTRANCE HALL
- COMMUNAL GARDEN
- STAIRCASE

- GALLERY
- COMMON ROOM
- APARTMENTS
- FACADE DESIGN
- CLIMATE DESIGN



2 BEDROOMS
90 M²

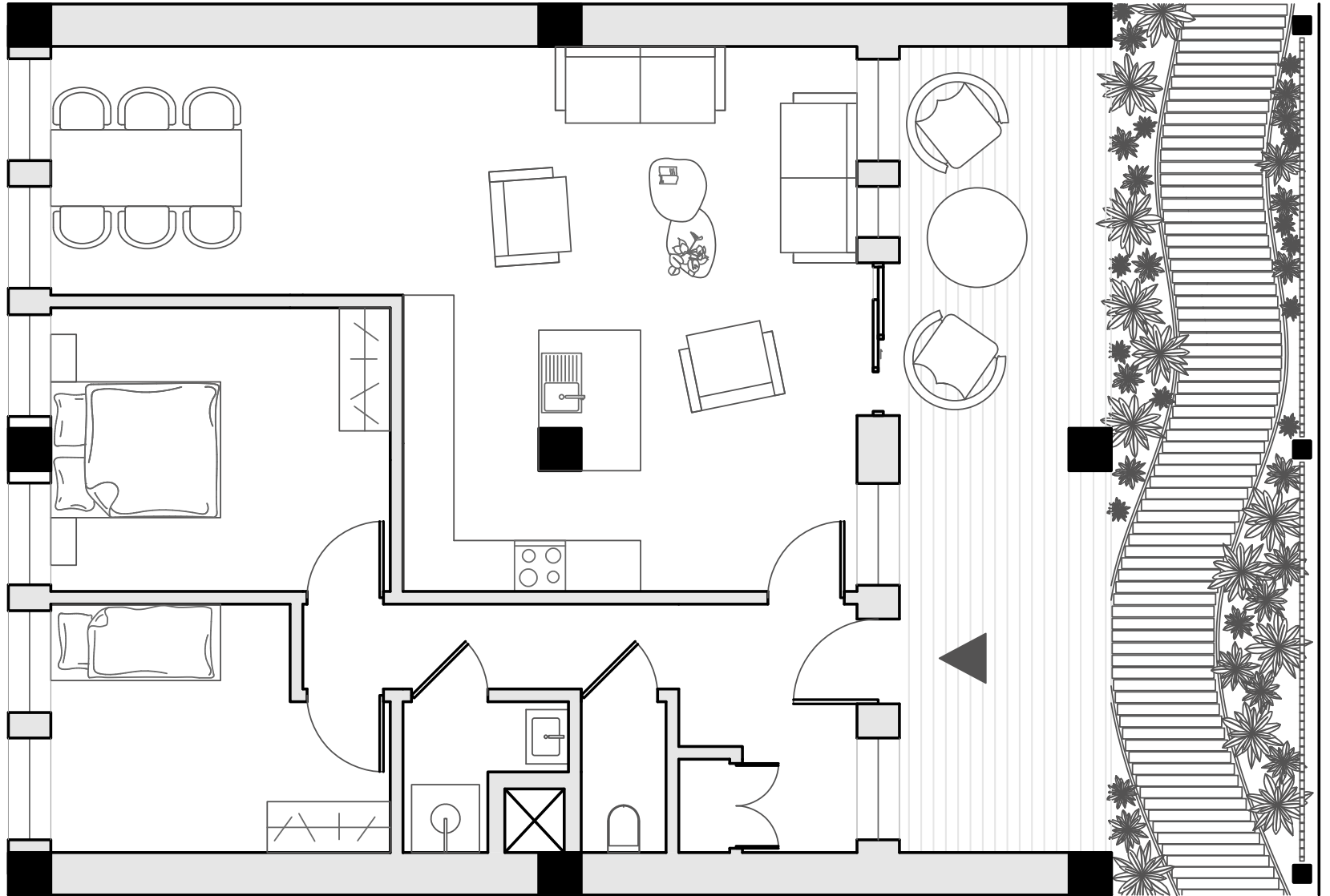

DESIGN

- MASTERPLAN
- TRANSITION ZONE
- ENTRANCE HALL
- COMMUNAL GARDEN
- STAIRCASE

- GALLERY
- COMMON ROOM
- APARTMENTS
- FACADE DESIGN
- CLIMATE DESIGN



3 BEDROOMS
90 M²

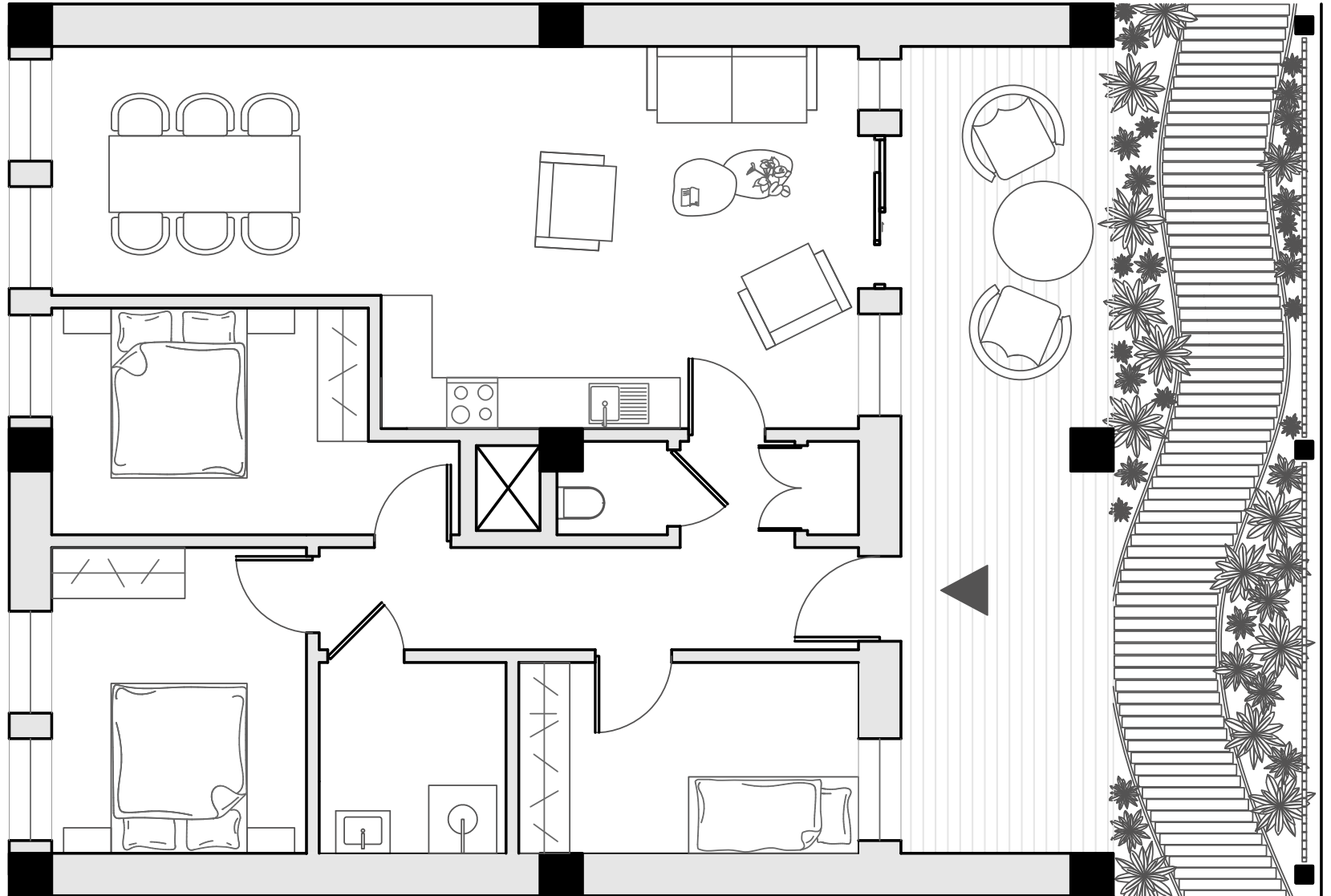

DESIGN

- MASTERPLAN
- TRANSITION ZONE
- ENTRANCE HALL
- COMMUNAL GARDEN
- STAIRCASE

- GALLERY
- COMMON ROOM
- APARTMENTS
- FACADE DESIGN
- CLIMATE DESIGN

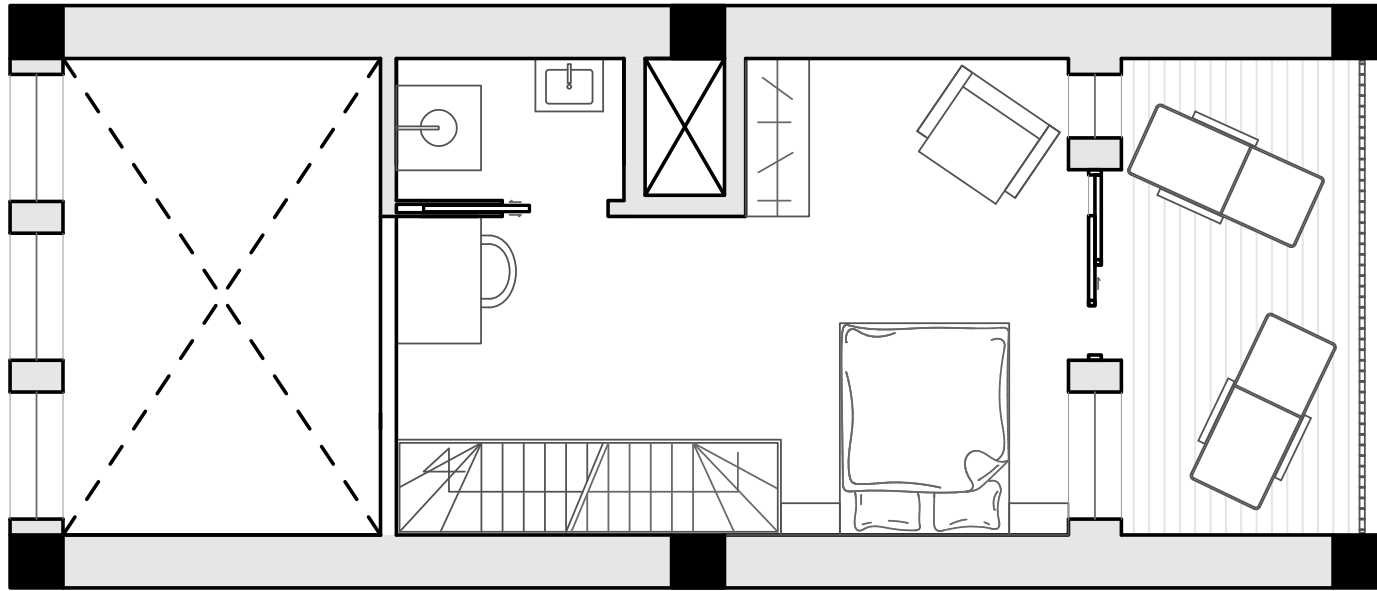

LOFT APARTMENT
71 M²

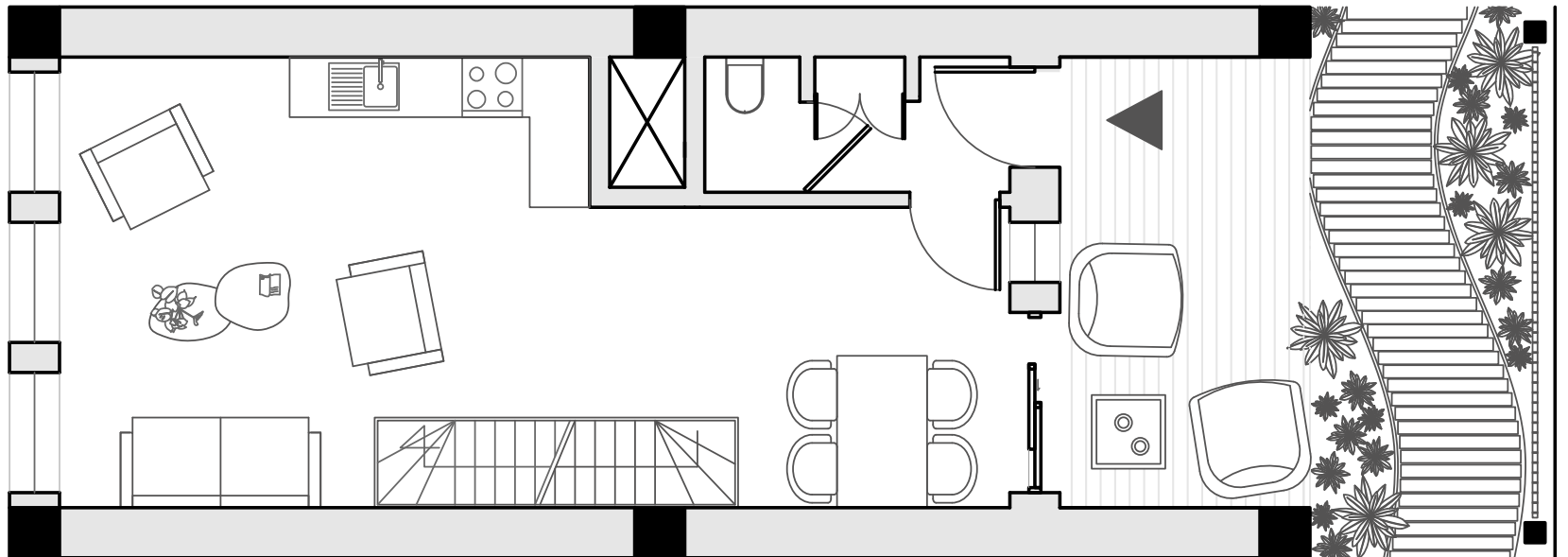

DESIGN

- MASTERPLAN
- TRANSITION ZONE
- ENTRANCE HALL
- COMMUNAL GARDEN
- STAIRCASE
- GALLERY
- COMMON ROOM
- APARTMENTS
- FACADE DESIGN
- CLIMATE DESIGN



FAMILY HOUSE
180 M²

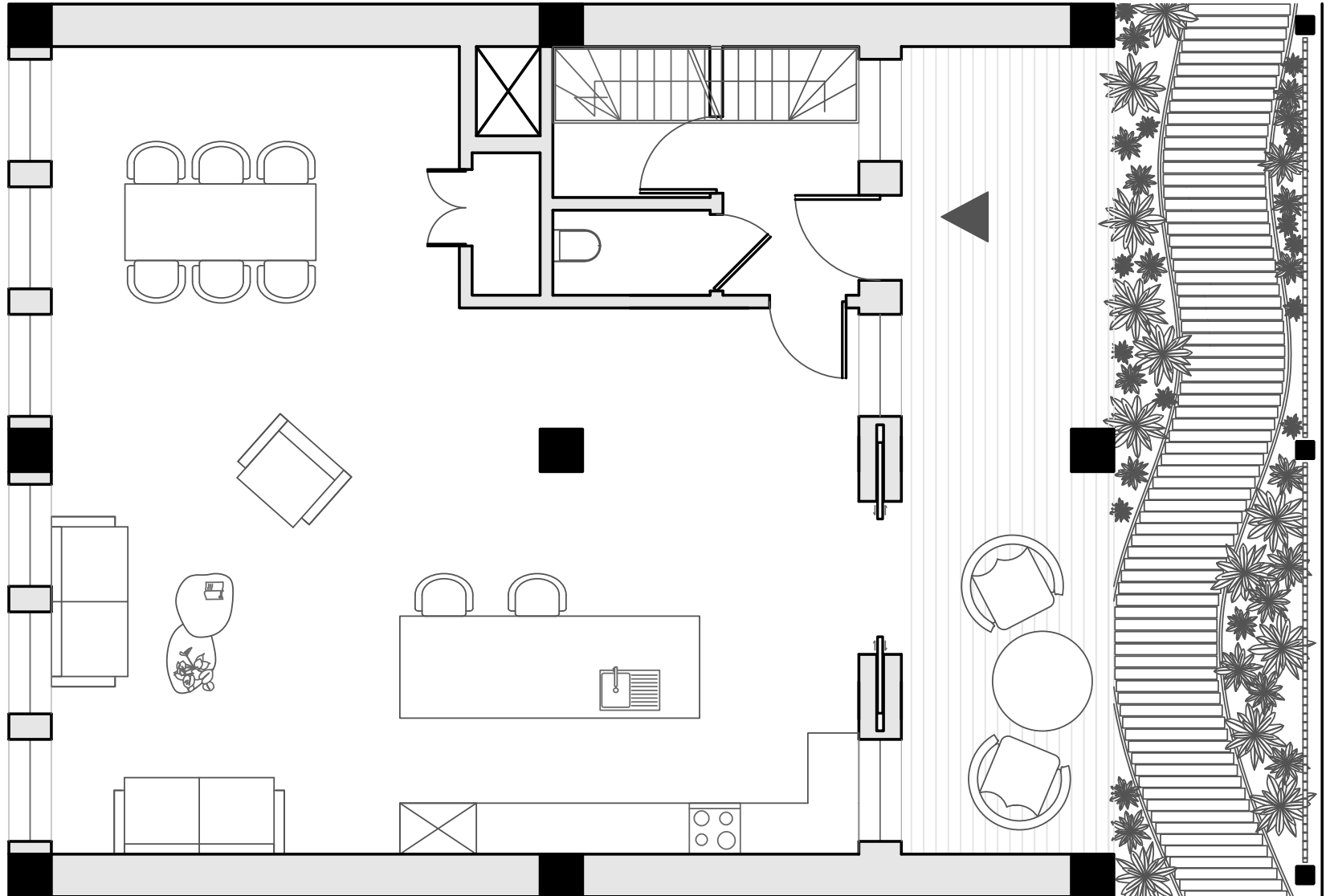

DESIGN

MASTERPLAN
TRANSITION ZONE
ENTRANCE HALL
COMMUNAL GARDEN
STAIRCASE

GALLERY
COMMON ROOM
APARTMENTS
FACADE DESIGN
CLIMATE DESIGN



FAMILY HOUSE
180 M²

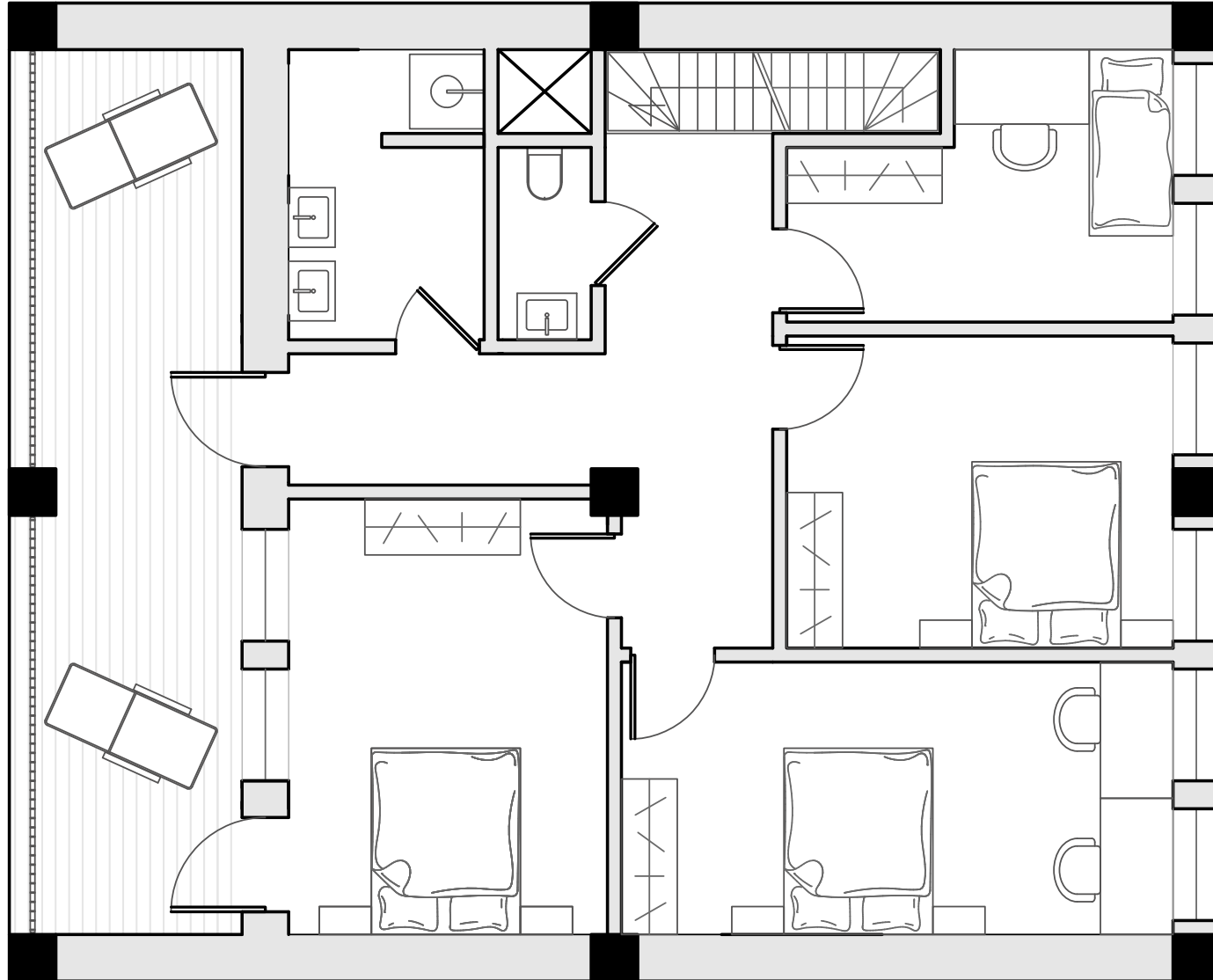

DESIGN

- MASTERPLAN
- TRANSITION ZONE
- ENTRANCE HALL
- COMMUNAL GARDEN
- STAIRCASE
- GALLERY
- COMMON ROOM
- APARTMENTS
- FACADE DESIGN
- CLIMATE DESIGN

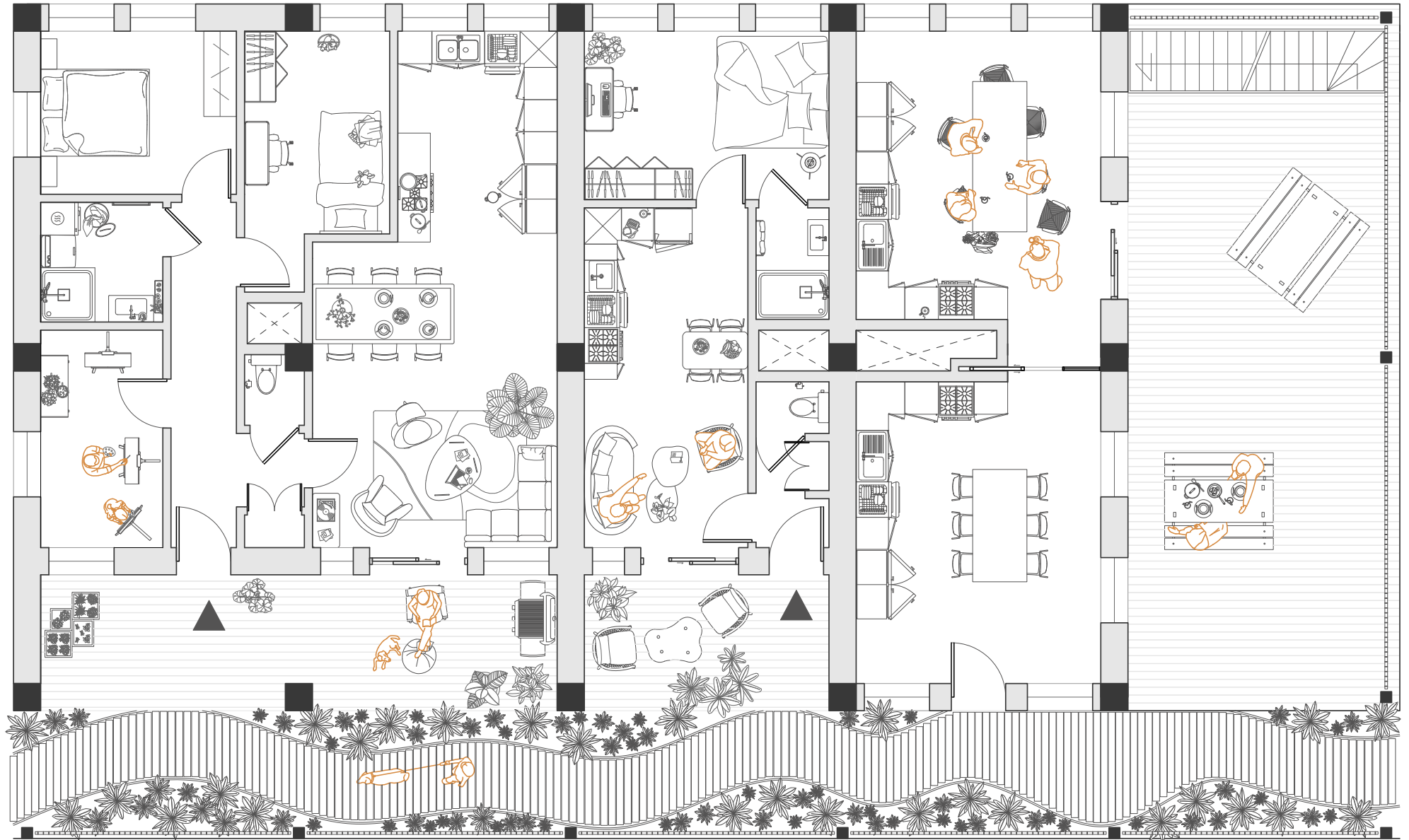

DESIGN

MASTERPLAN
TRANSITION ZONE
ENTRANCE HALL
COMMUNAL GARDEN
STAIRCASE

GALLERY
COMMON ROOM
APARTMENTS
FACADE DESIGN
CLIMATE DESIGN



Cellulose



Kerto Ripa floor box



21x140 mm Thermo Frake planks, GevenHout



Thermo Frake planks
GevenHout



Gealen Kubes window frames

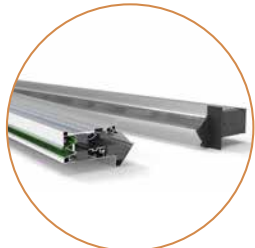

Duco Topvent CK-ZR (Ak+)

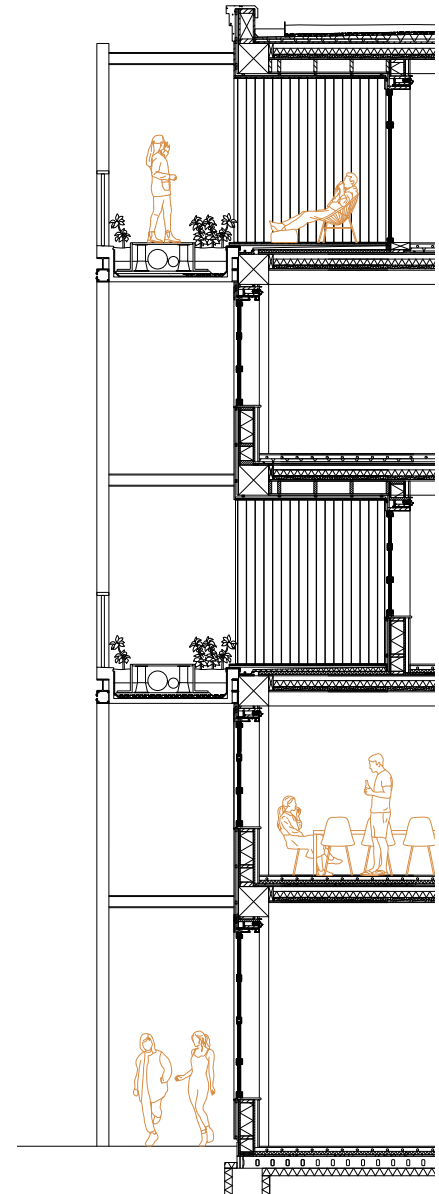
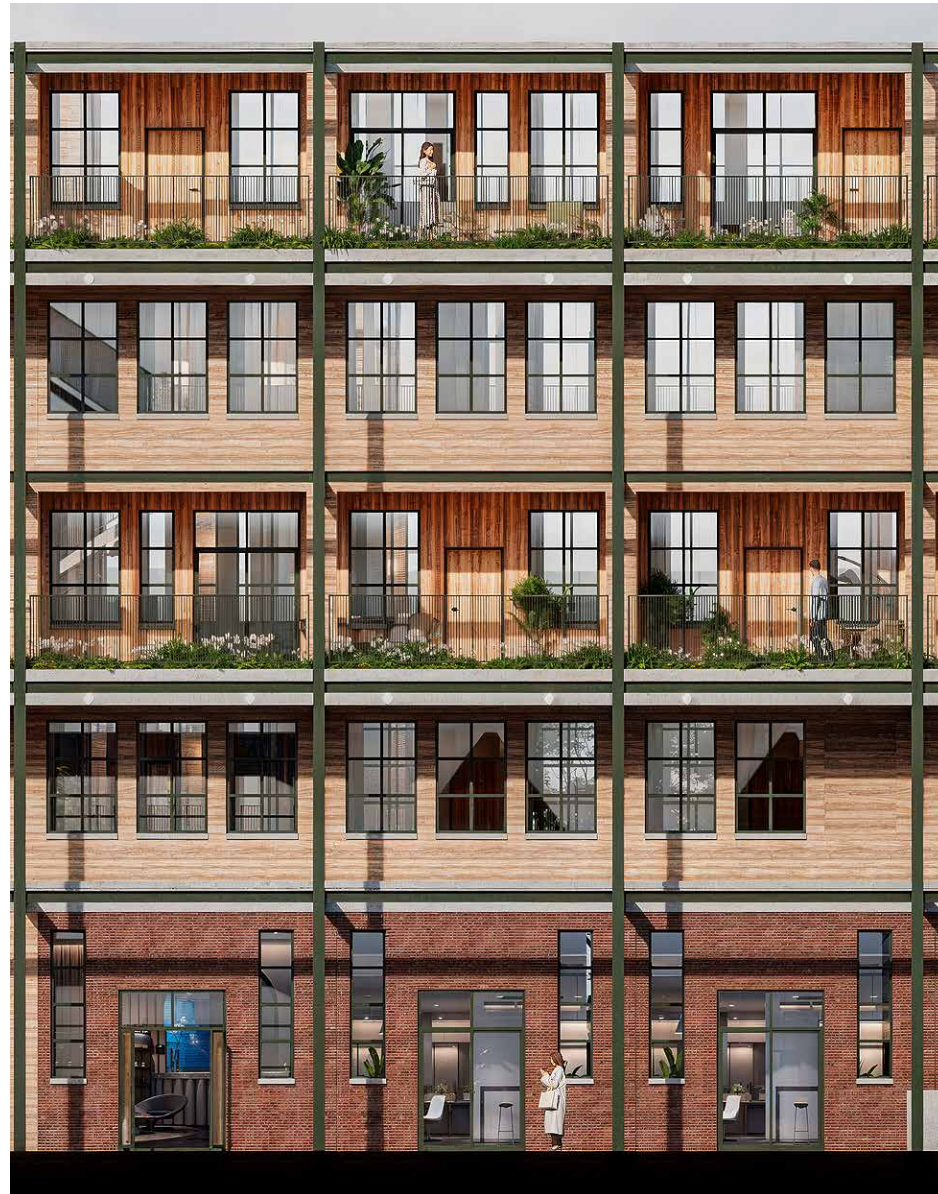

DESIGN

MASTERPLAN
TRANSITION ZONE
ENTRANCE HALL
COMMUNAL GARDEN
STAIRCASE

GALLERY
COMMON ROOM
APARTMENTS
FACADE DESIGN
CLIMATE DESIGN

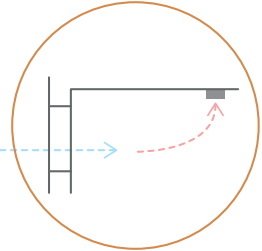

Ventilation type C

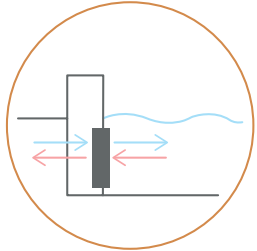

TEO instalation harnessing heat from the river

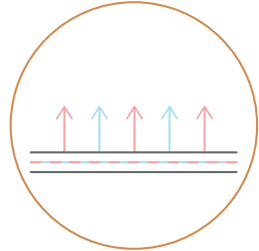

Floor heating and cooling



Demountable wooden construction



Sustainable insulation

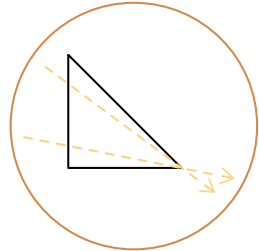

Natural sunshading due to balconies



High biodiversity such as green roofs



Bird and bat boxes integrated in galleries



Reuse of rainwater for plant irrigation

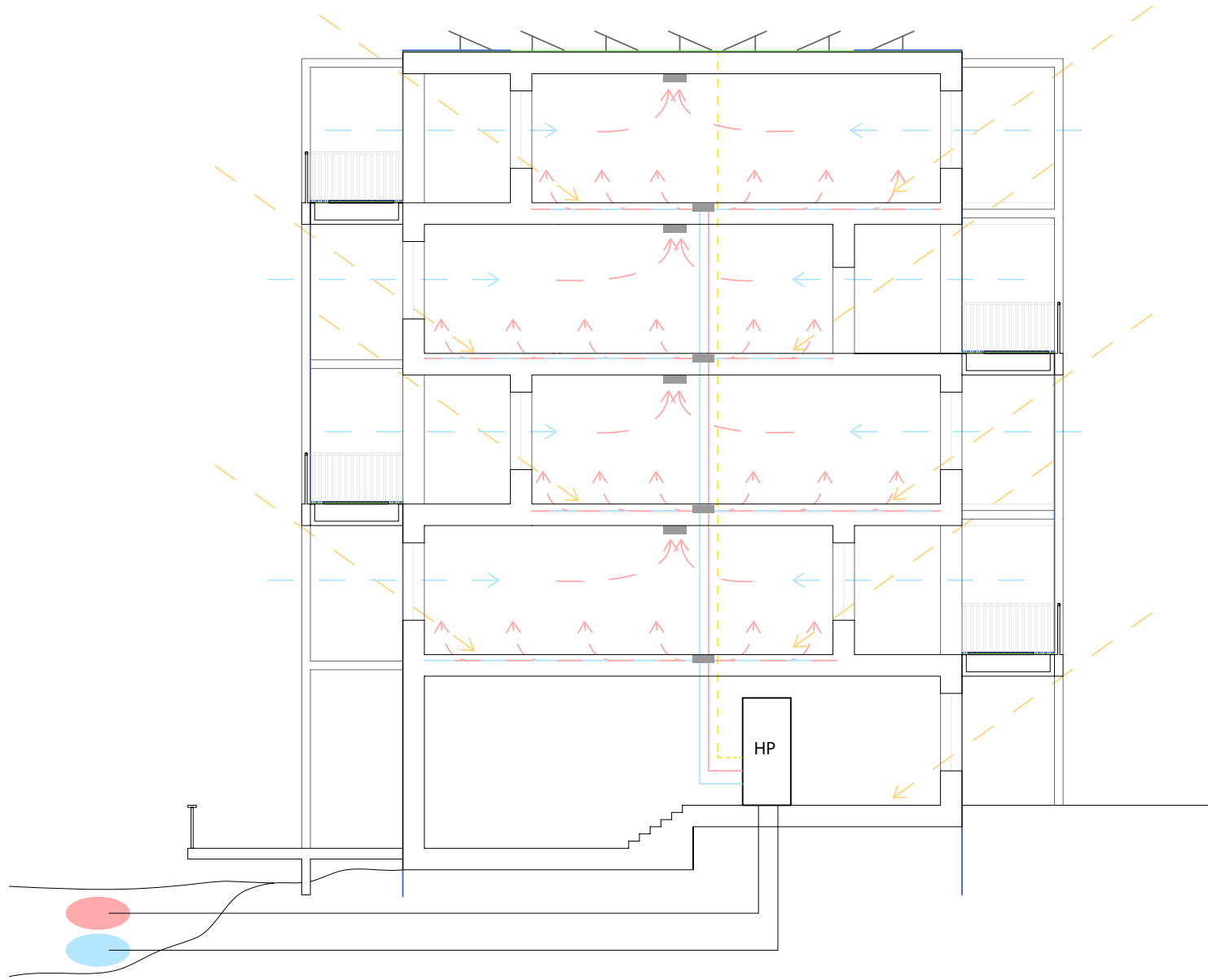

DESIGN

MASTERPLAN
TRANSITION ZONE
ENTRANCE HALL
COMMUNAL GARDEN
STAIRCASE

GALLERY
COMMON ROOM
APARTMENTS
FACADE DESIGN
CLIMATE DESIGN

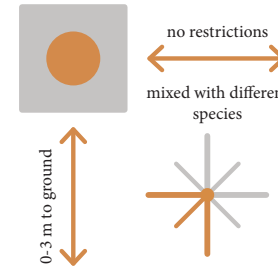
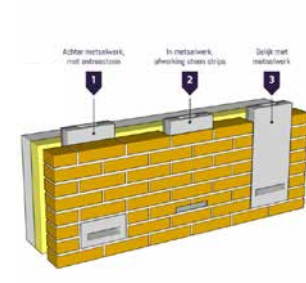
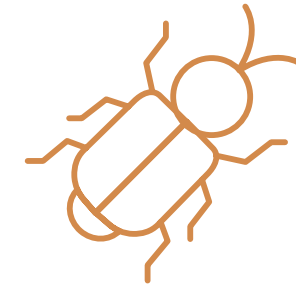
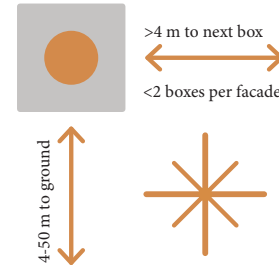
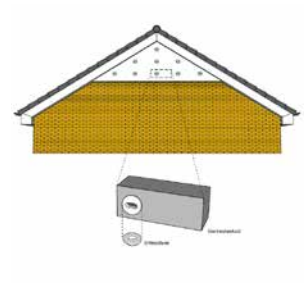
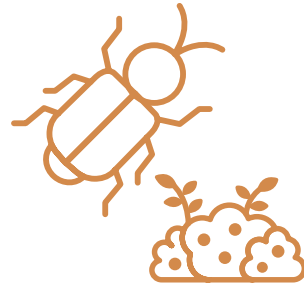
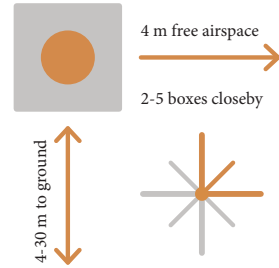
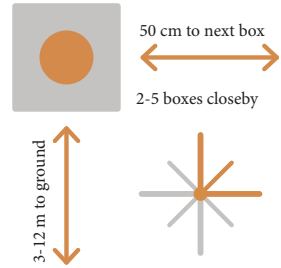

DESIGN

- MASTERPLAN
- TRANSITION ZONE
- ENTRANCE HALL
- COMMUNAL GARDEN
- STAIRCASE
- GALLERY
- COMMON ROOM
- APARTMENTS
- FACADE DESIGN
- CLIMATE DESIGN



Malus sylvestris



Juniperus communis



Sorbus aucuparia



Corylus avellana



Clematis Vitalba



Ribes Rubrum



Valeriana officinalis



Verbascum Nigrum



Viburnum Opulus



Sambucus Nigra



Prunus spinosa



Carpinus Betulus



Ilex aquifolium



Salix caprea



Alchemilla Mollis



Geranium Sanguineum



Asplenium Scolopendrium



Polystichum Setiferum



Hylothelephium Telephium



Sedum Matrona



Lavandula



Briza media



Avenella Flexuosa



Carex Spicata

