

## The Zone of Disassembly







3.00 MT

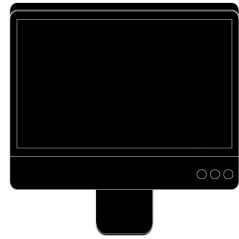

6.30 MT

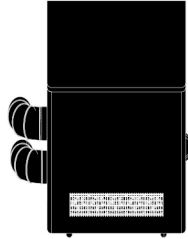

7.00 MT



11.80 MT



12.90 MT

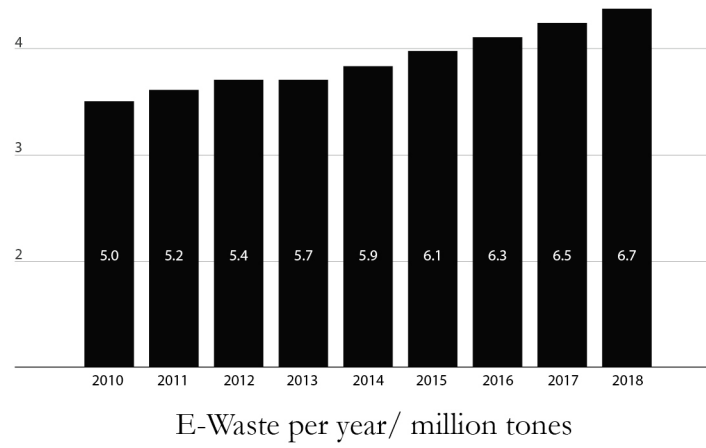

*RESEARCH QUESTIONS*

1. How can one unveil the hidden e-streams regarding the global network of flows?
2. How can one expose the sensitivity of the issue and the hidden dynamics which catalyze it?

# e-waste flows



# North Sea - waste patterns

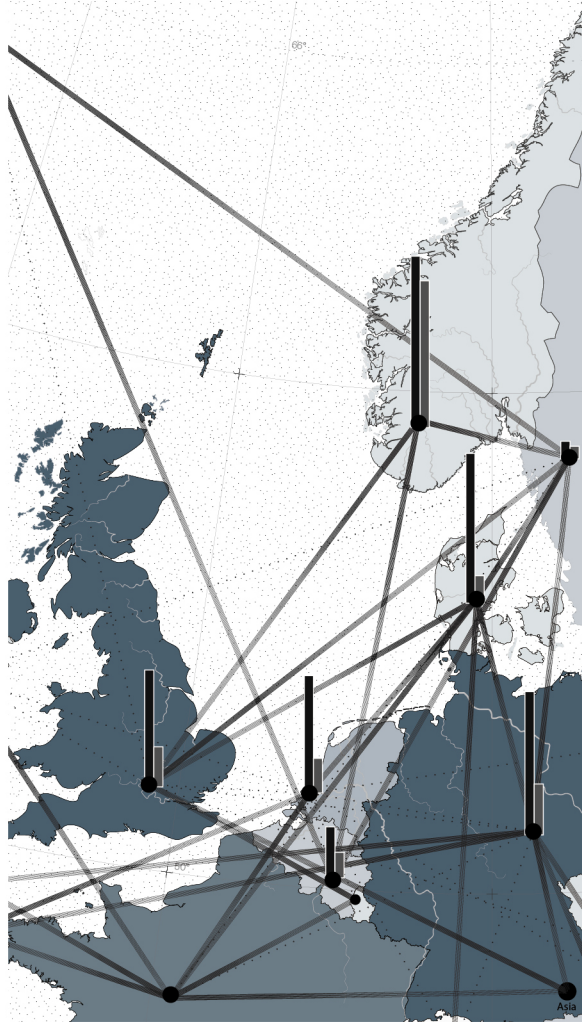

E-Waste Collection Rate  
Waste Transboundary Shipment

- 6,20-34,9%
- 35,0-39,9%
- 39,0-45,6%
- 45,6-50,3%
- 50,3-111,9%

- Amount of Control-Checks
- Amount of Legal Violations



E-Waste per Capita

- 8,00-10,00 kg/cap
- 10,00-12,00 kg/cap
- 12,00-14,00 kg/cap
- 14,00-16,00 kg/cap
- 16,00-18,00 kg/cap
- 18,00-20,00 kg/cap
- 20,00-22,00 kg/cap
- 22,00-24,00 kg/cap
- 24,00-26,00 kg/cap
- 26,00-28,00 kg/cap
- 28,00-28,36 kg/cap

- ≡ Shipping Flows - Density
- Harbour Growth (fast)
- Harbour Growth (slow)
- Small Harbour

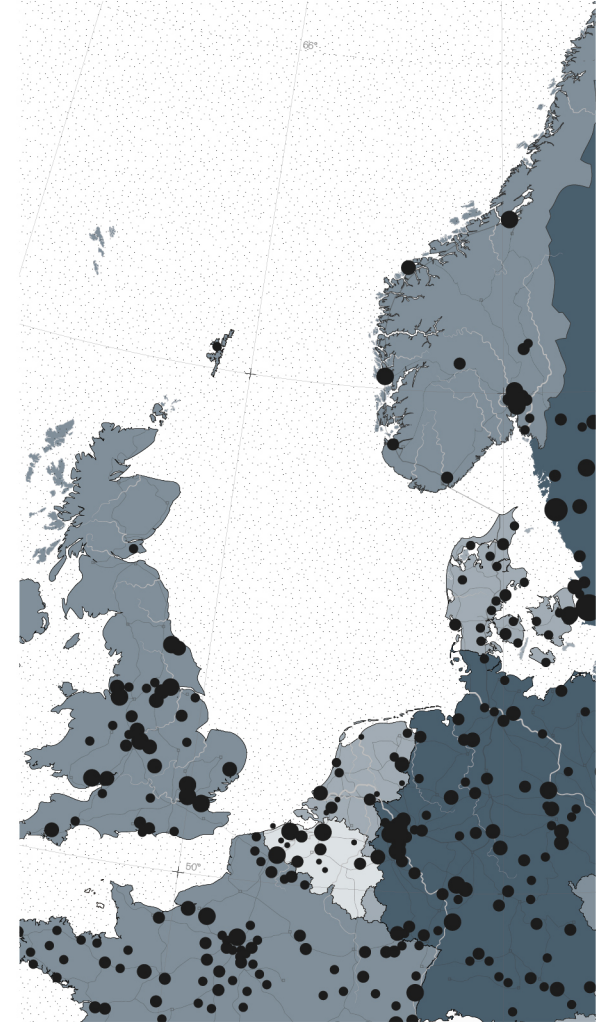

Waste Recycling Rates

Scale 1:10 000 000  
Source Eurostat

- 10.0-34.9%
- 35.0-44.9%
- 45.0-54.9%
- 55.0-64.9%
- 65.0-153%
- Waste-to-Energy Plant



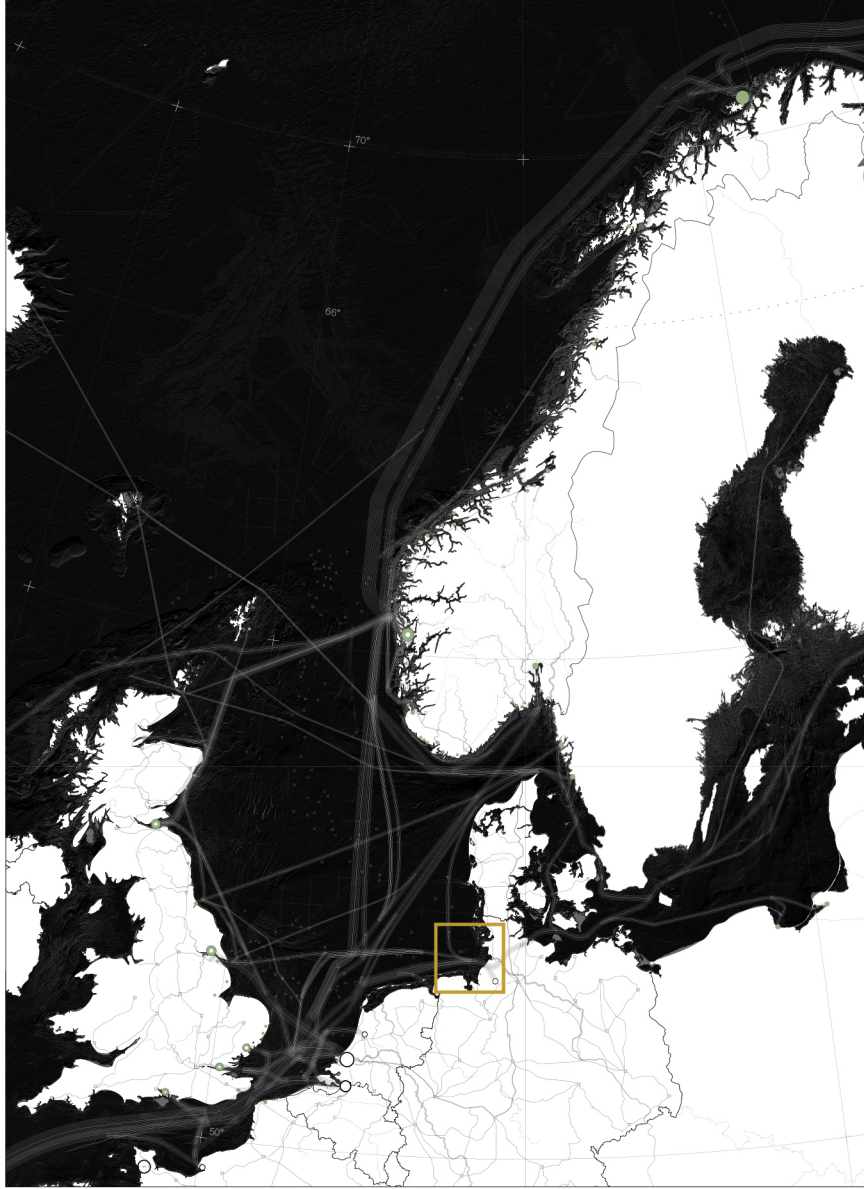

# zone of disassembly

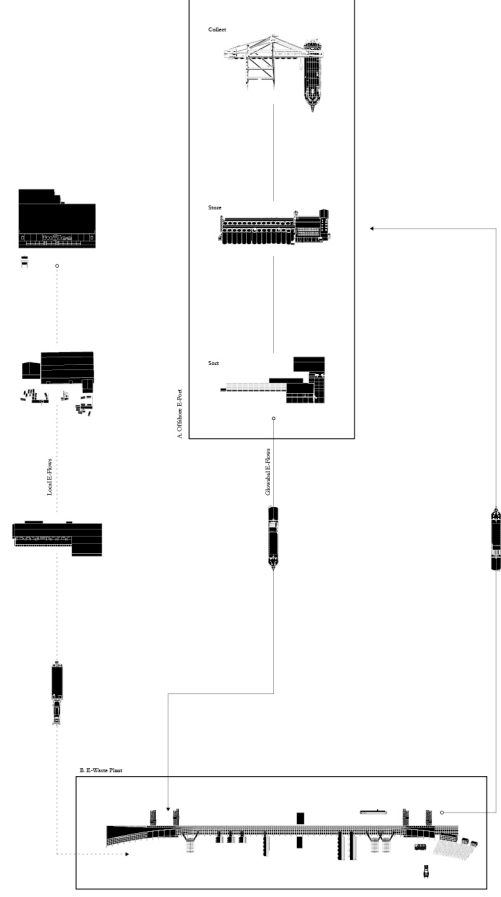

# e-processing

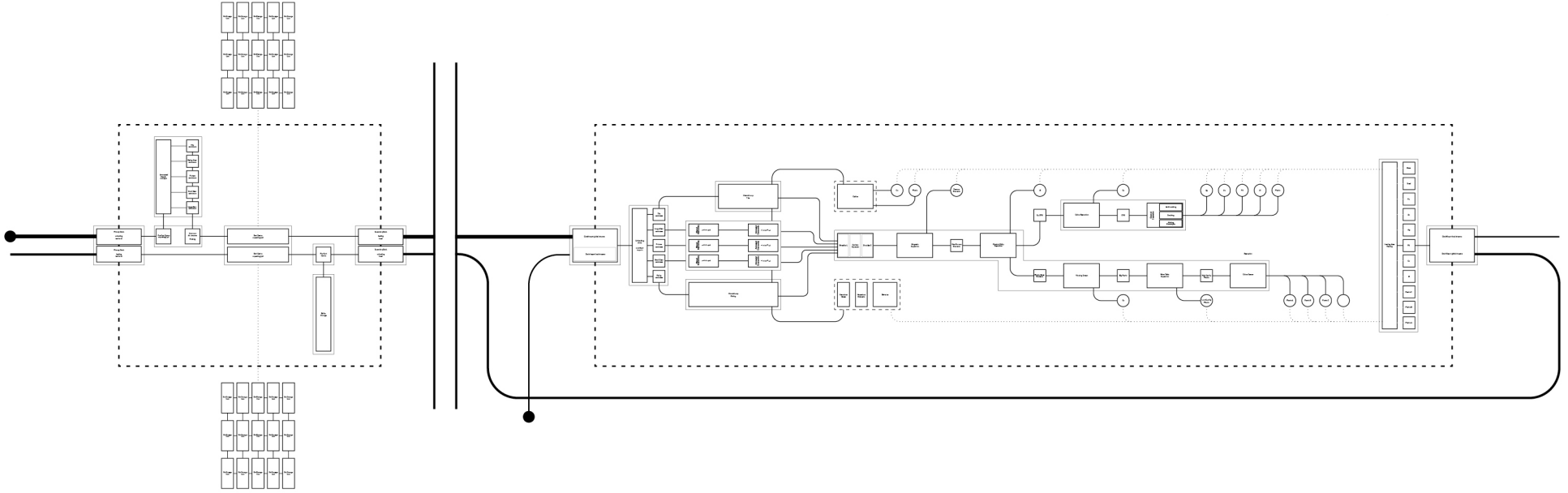

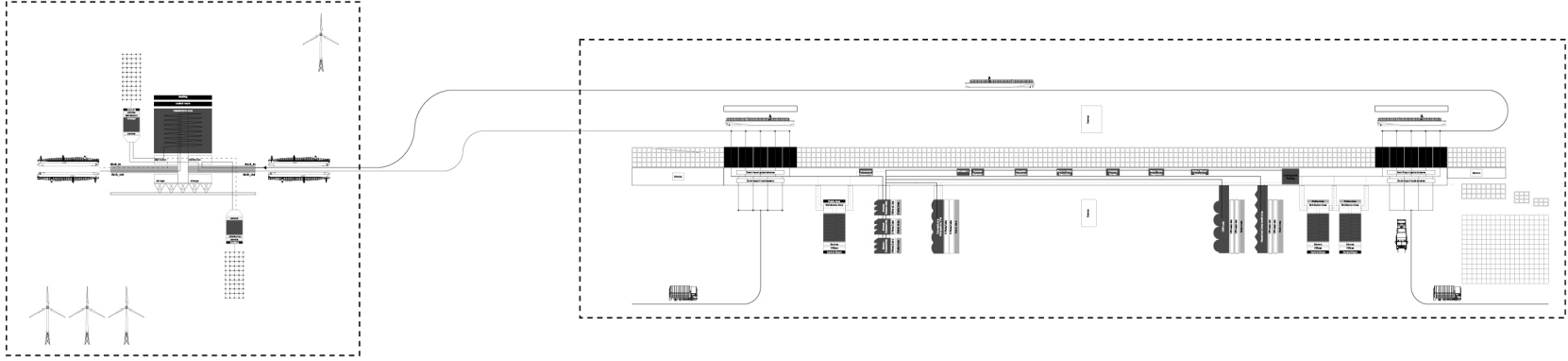

# territorial connectivity

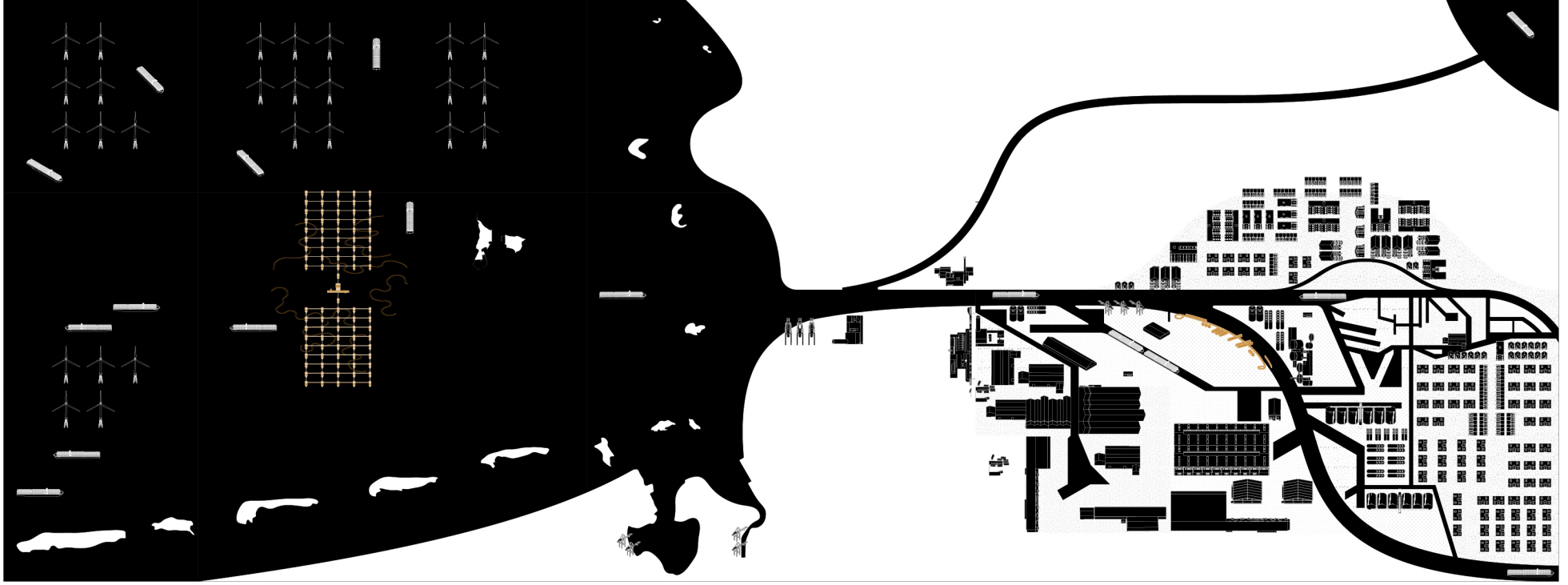

# location



# archipelago

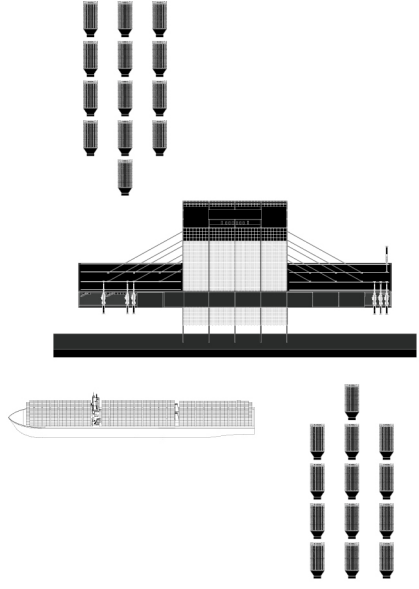

# location

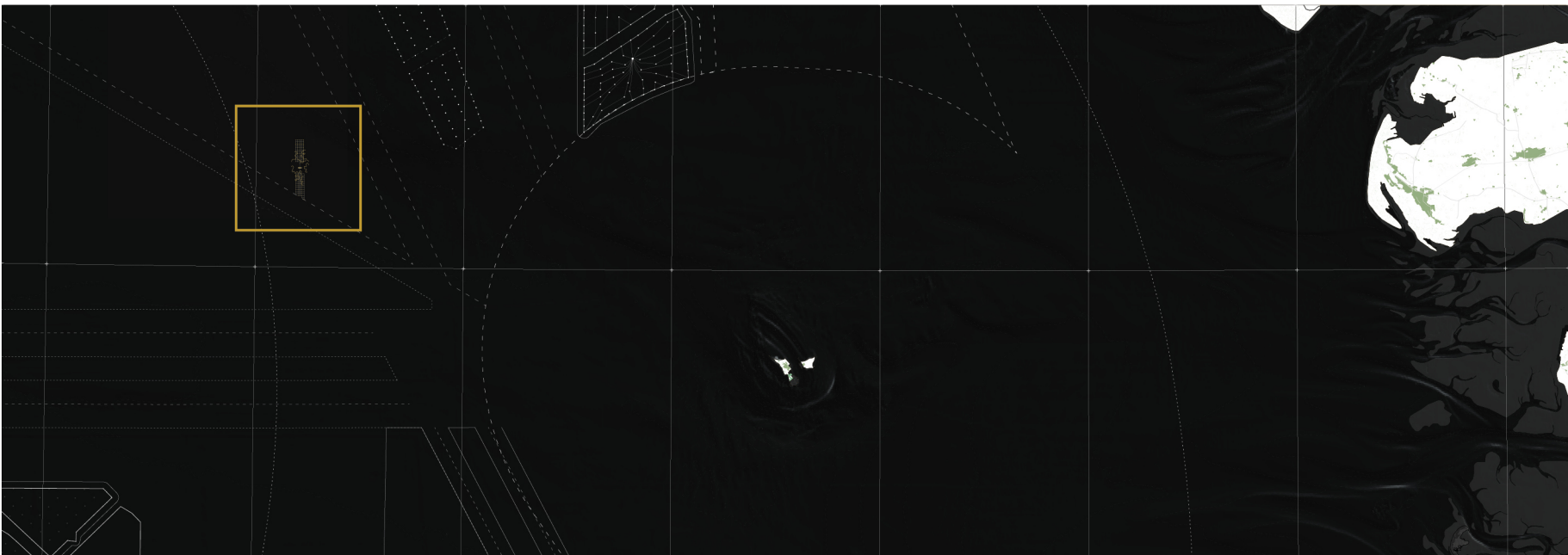



# architectural syntax

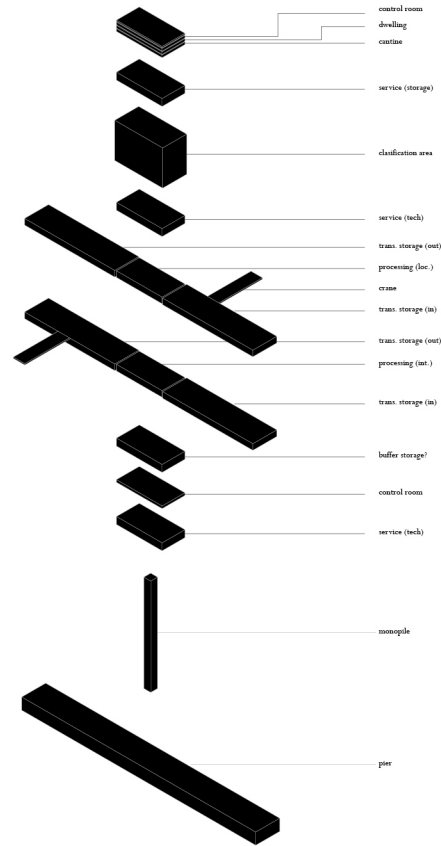
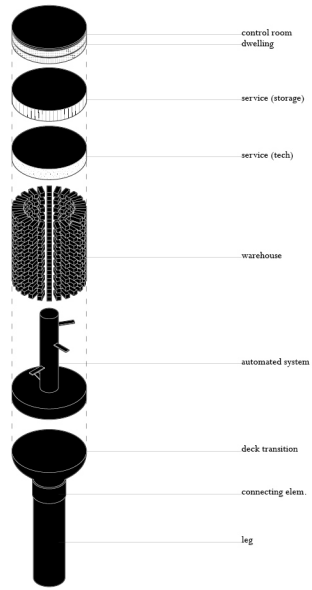

part a.

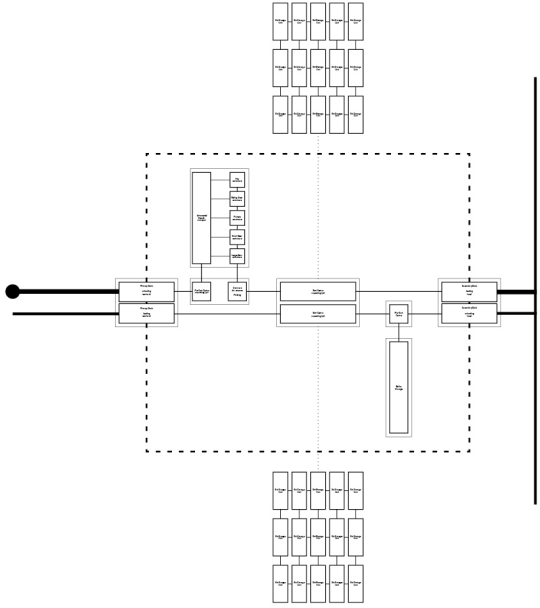

# flows management

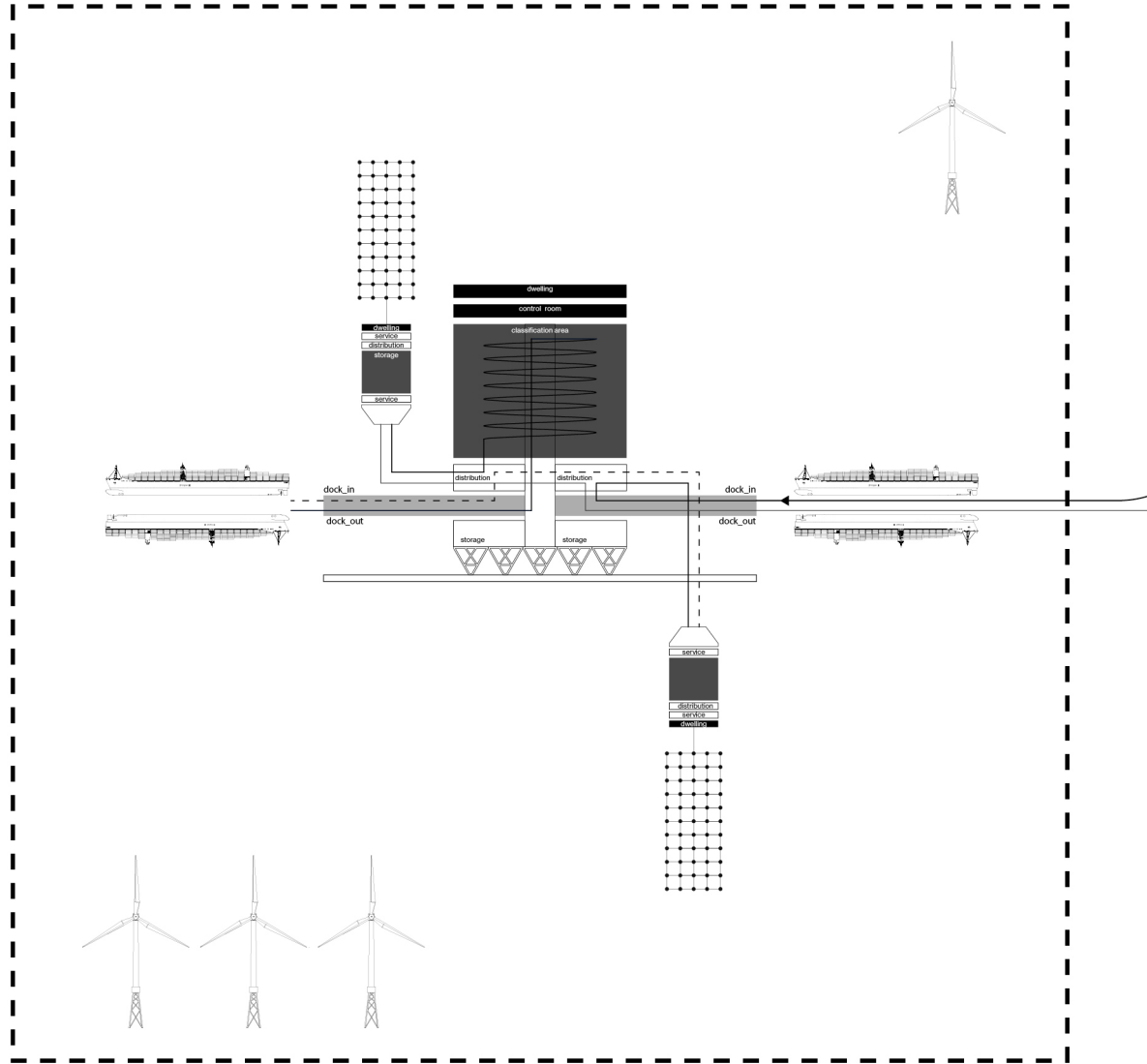

sections

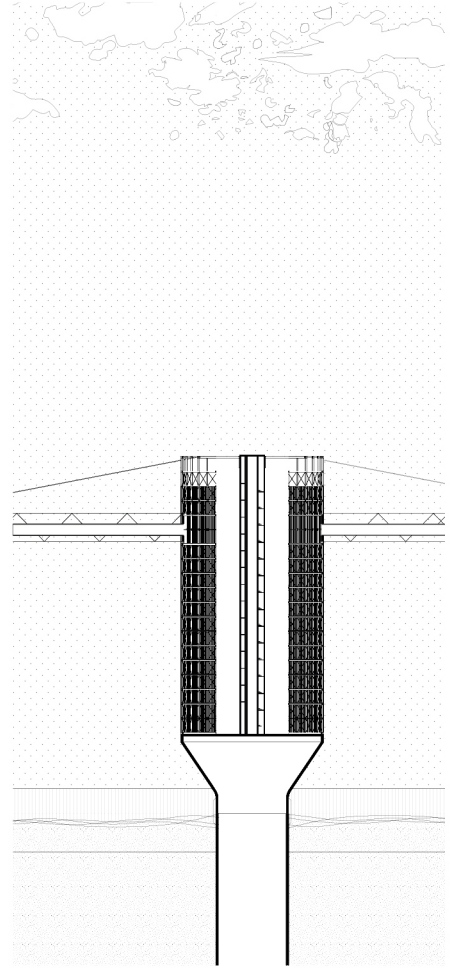
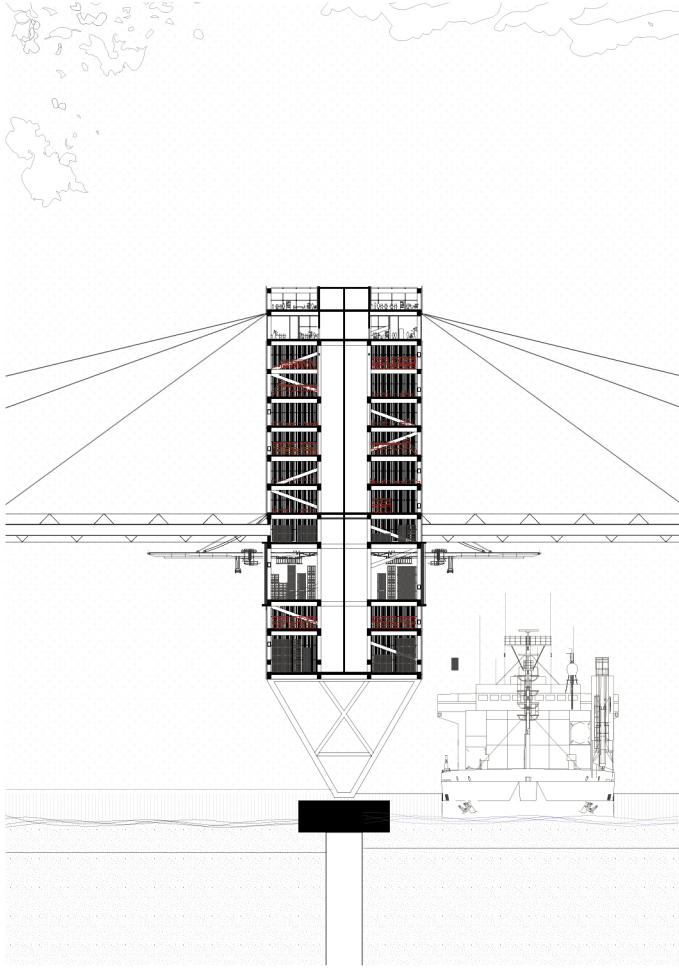
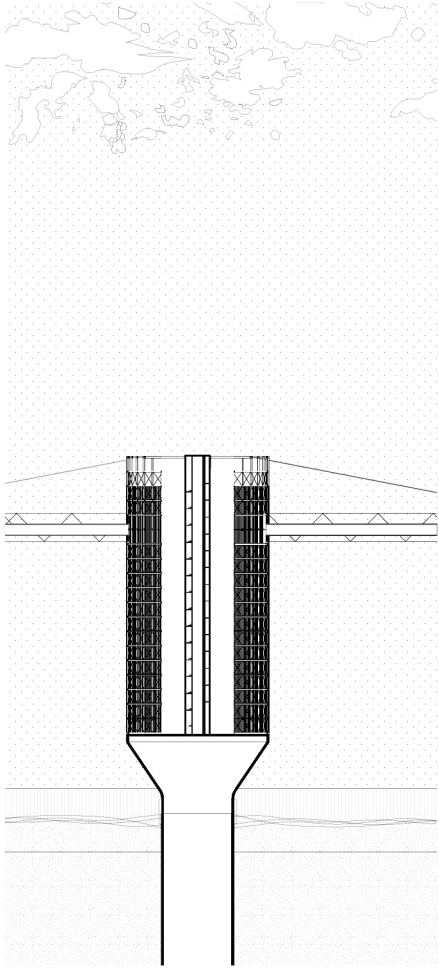



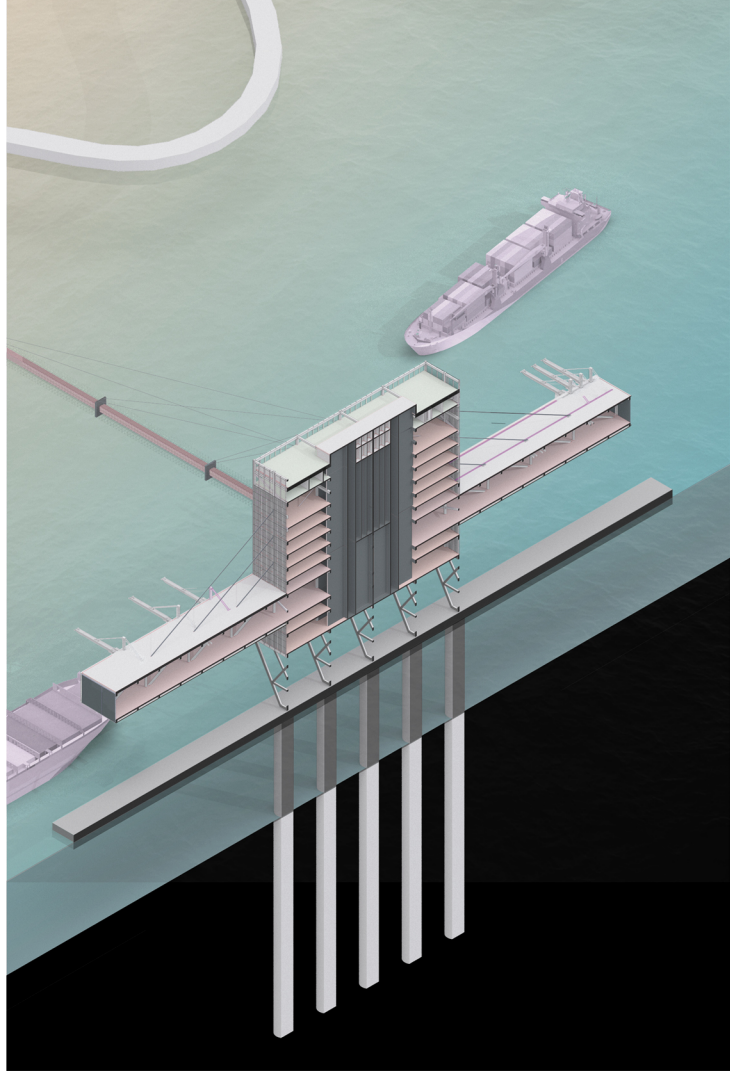

plant

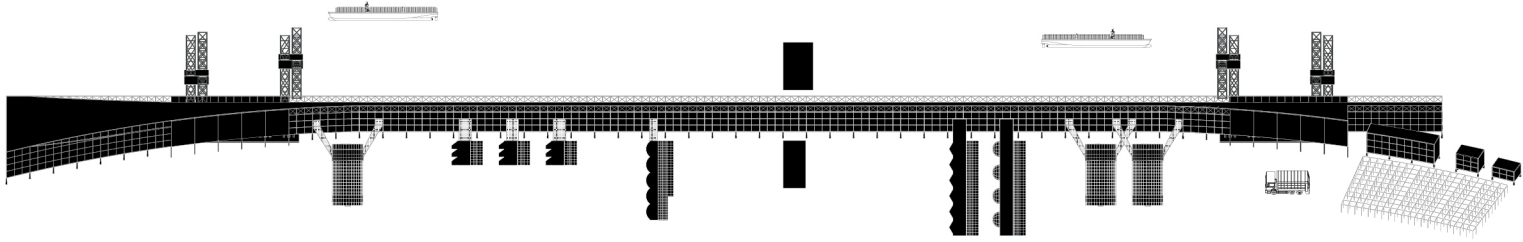

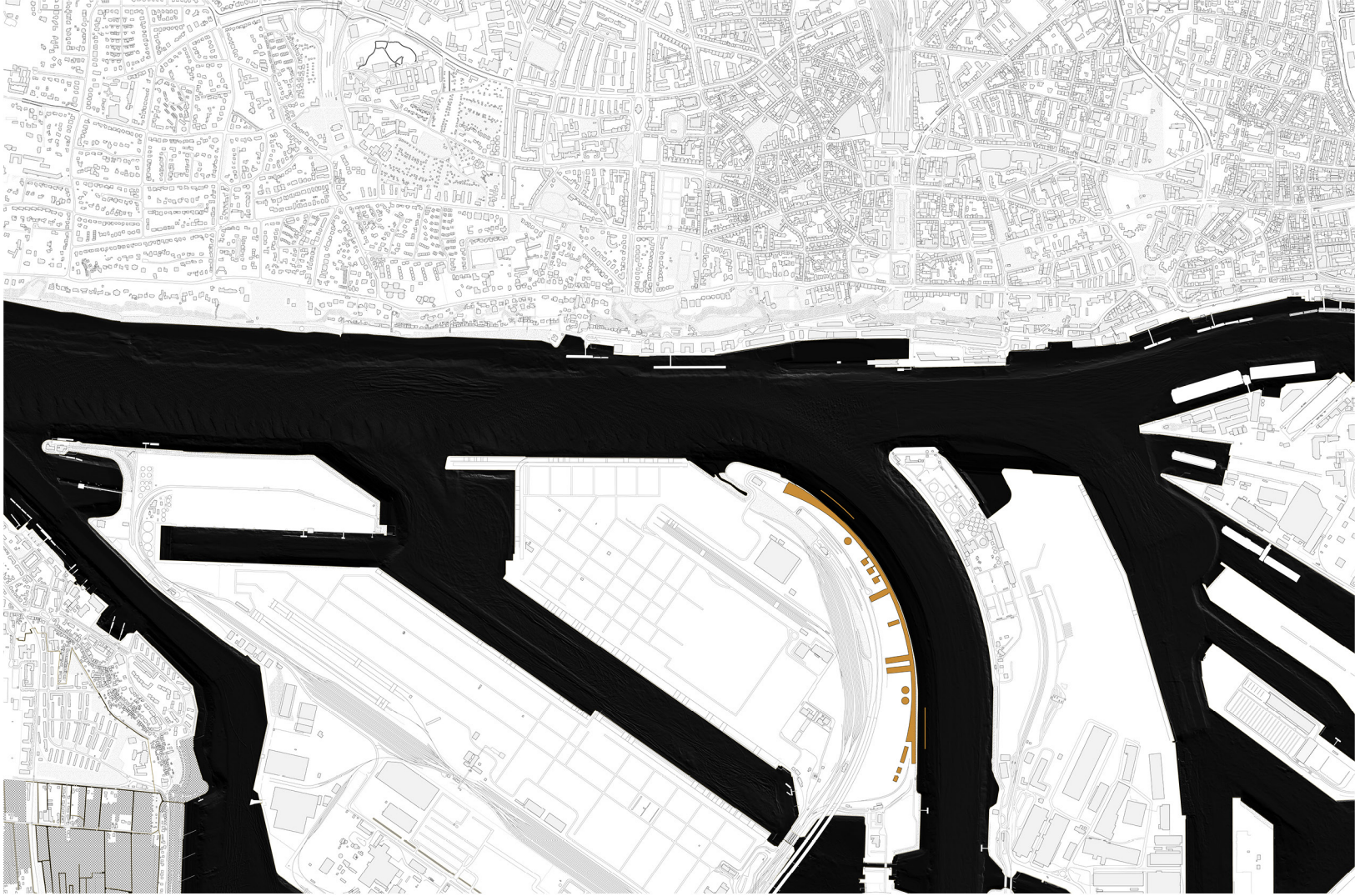





urban perspective



# urban map

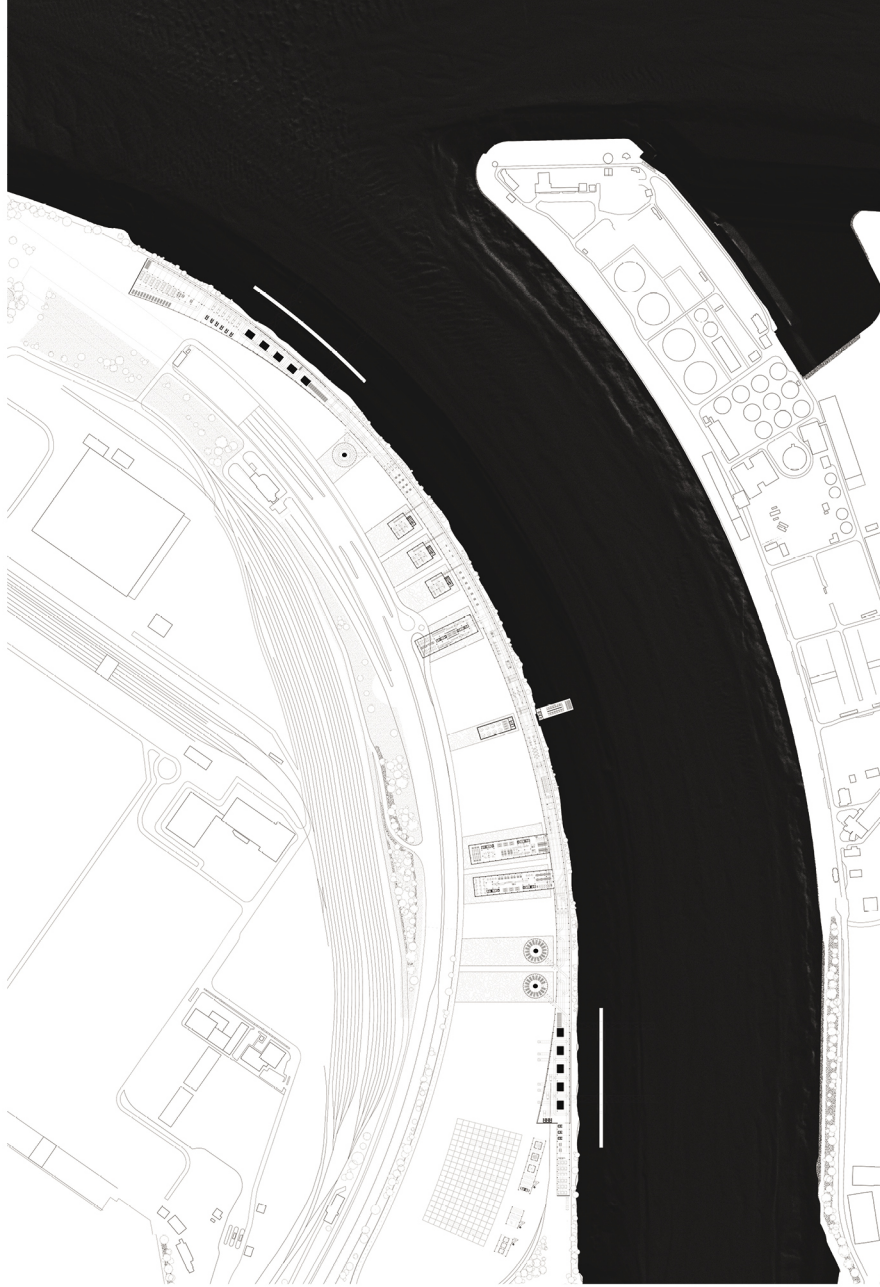

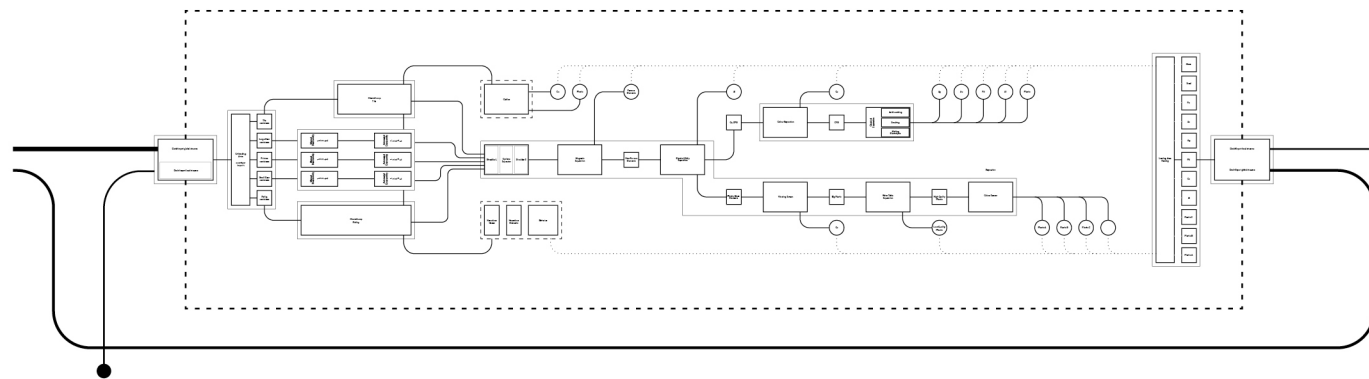

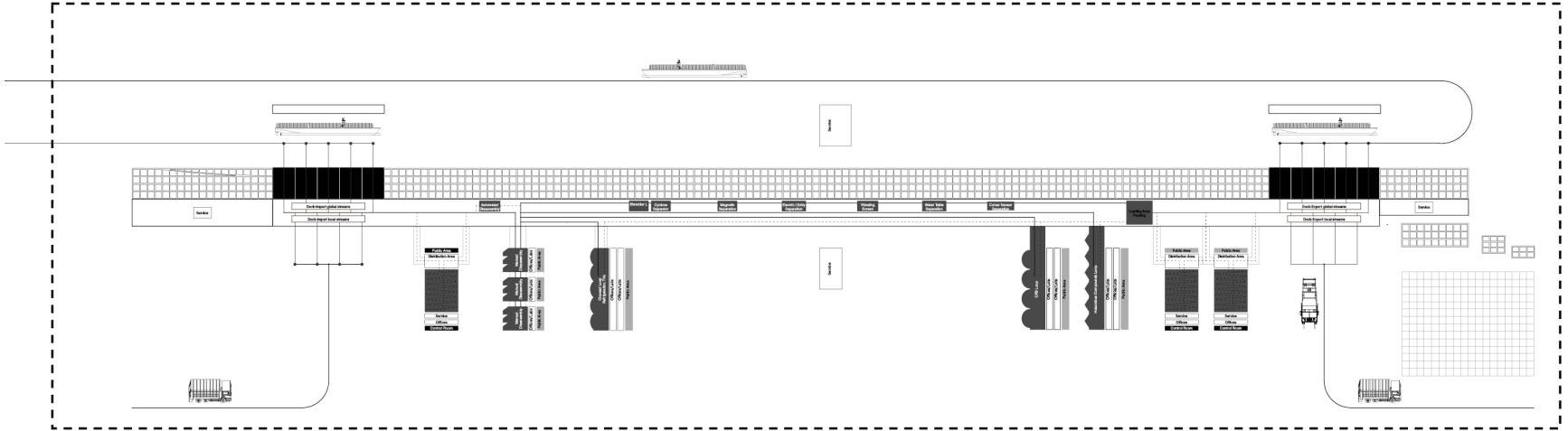

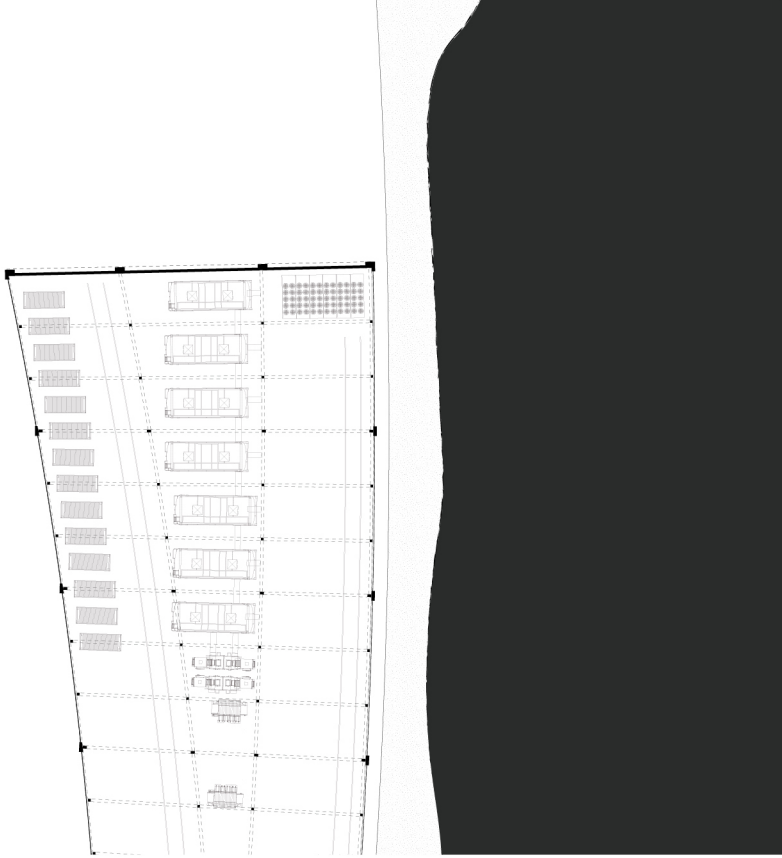

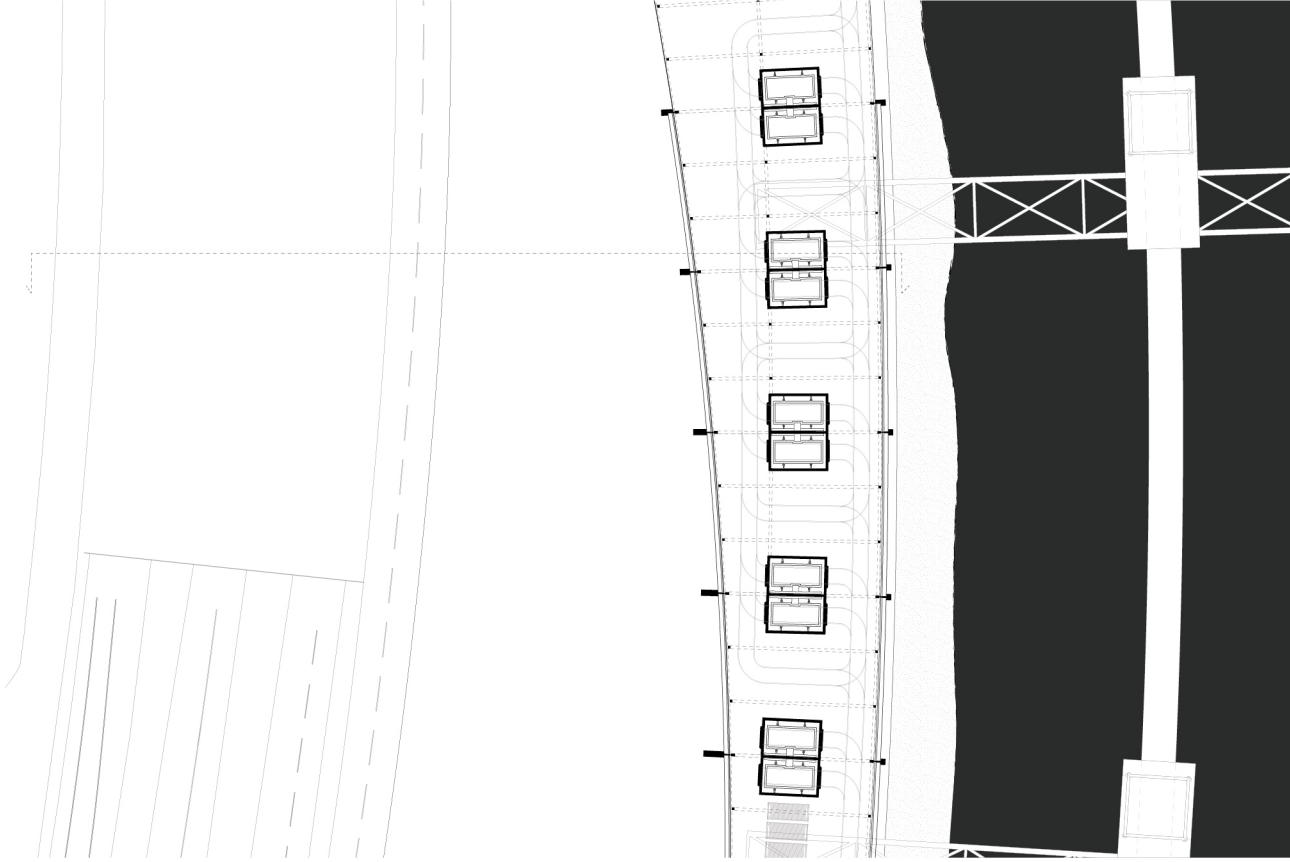

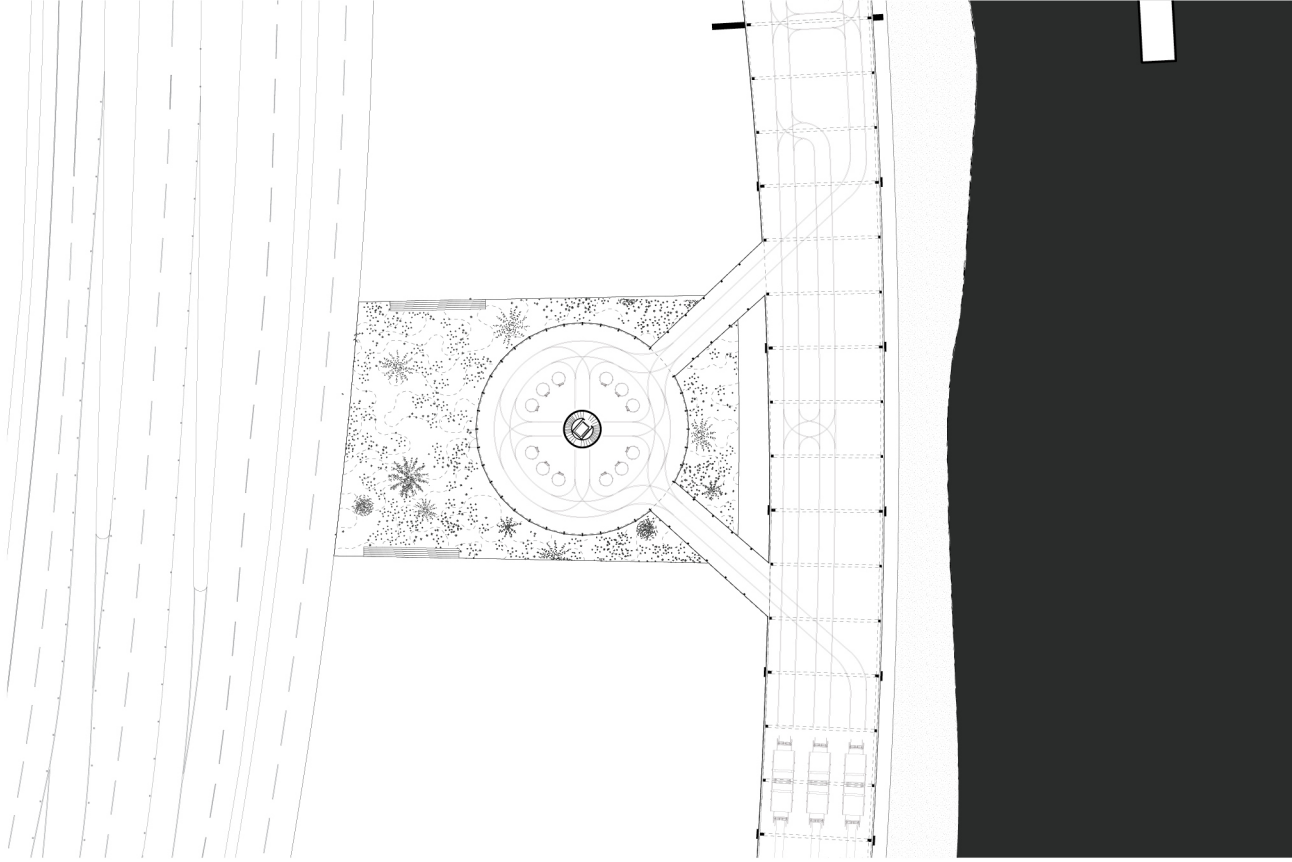



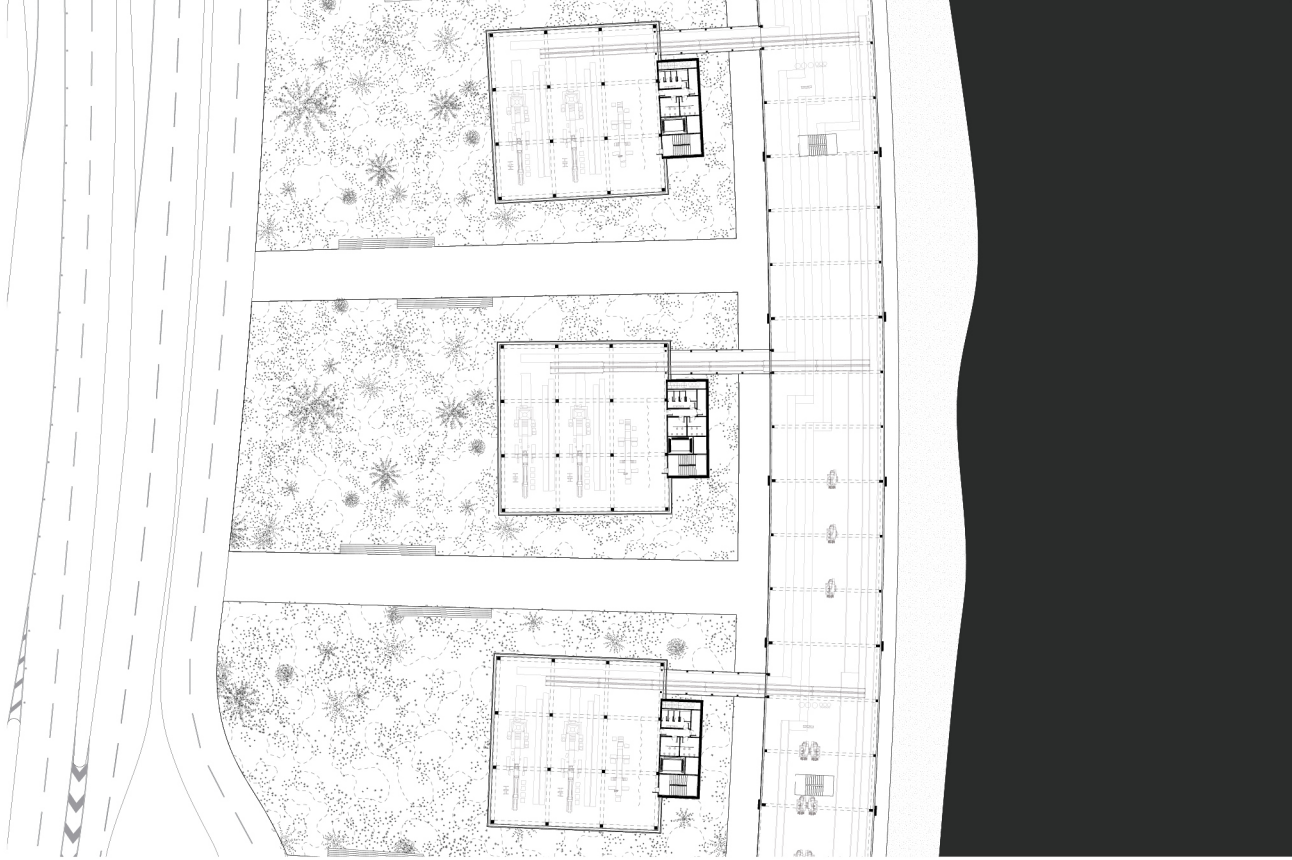

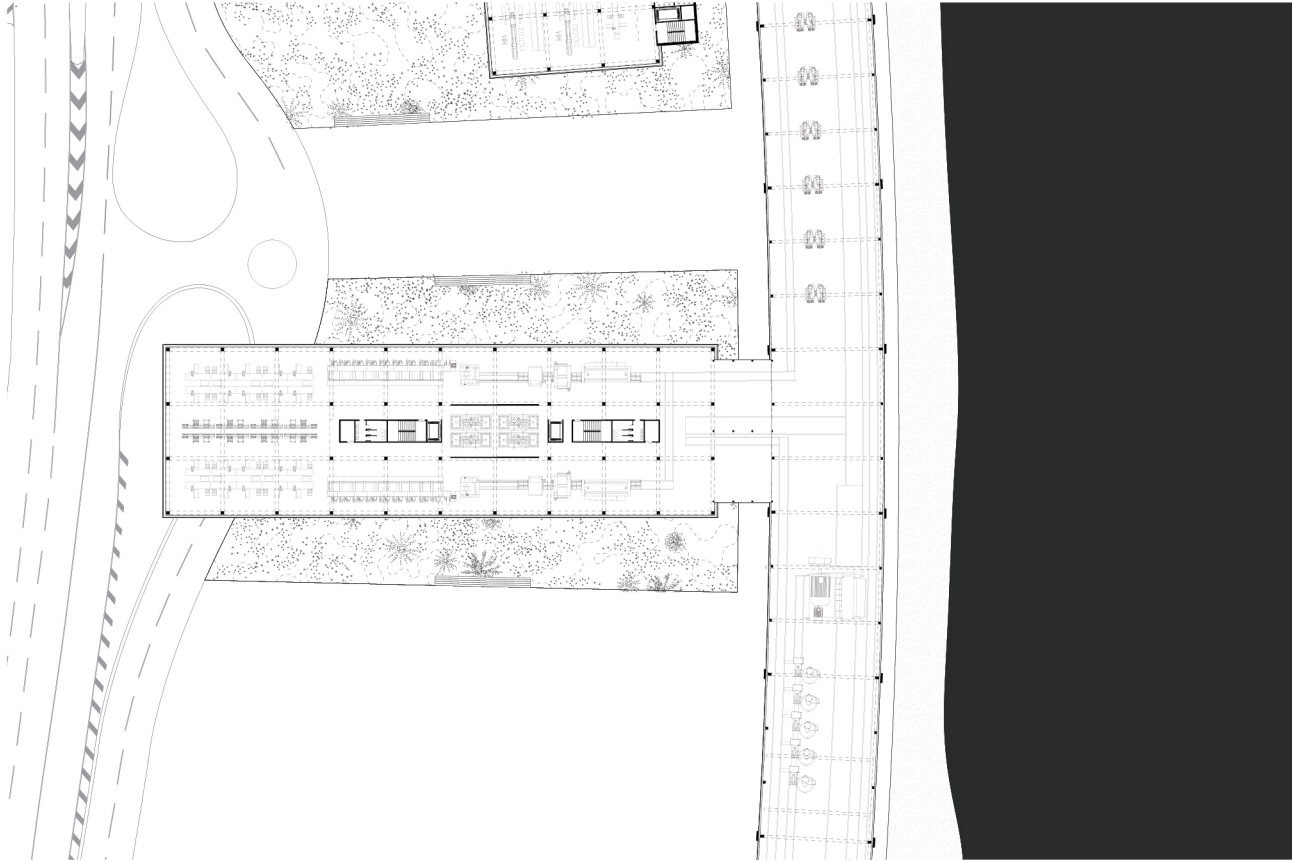

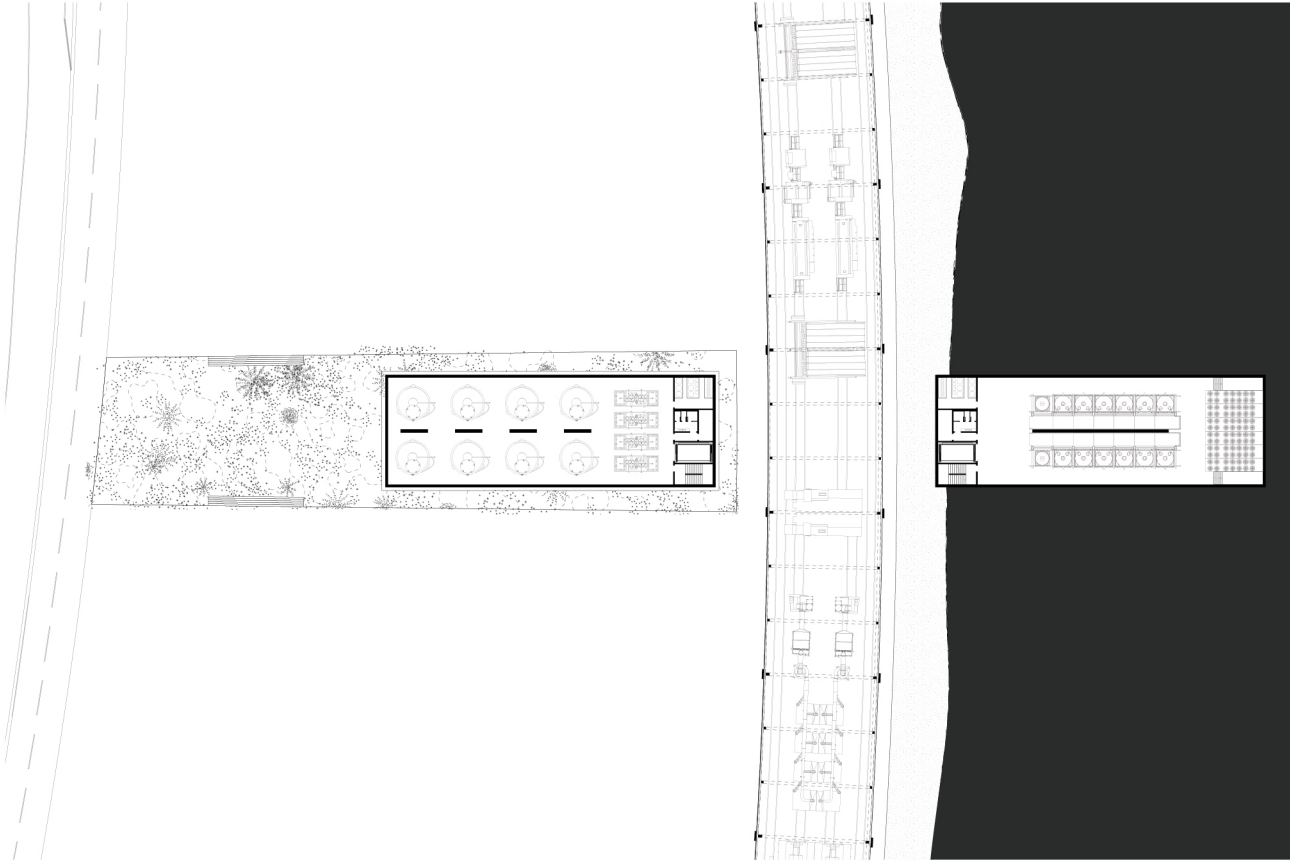

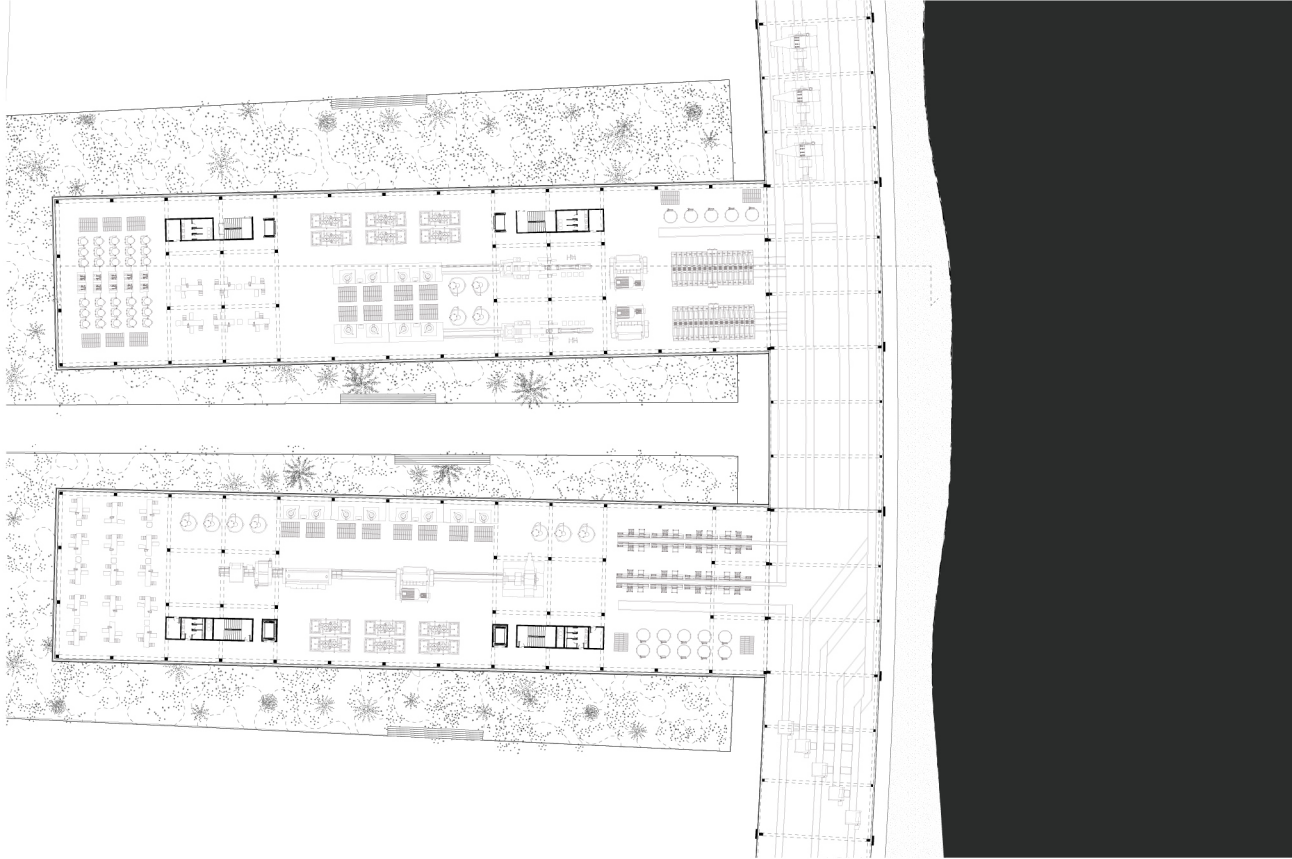

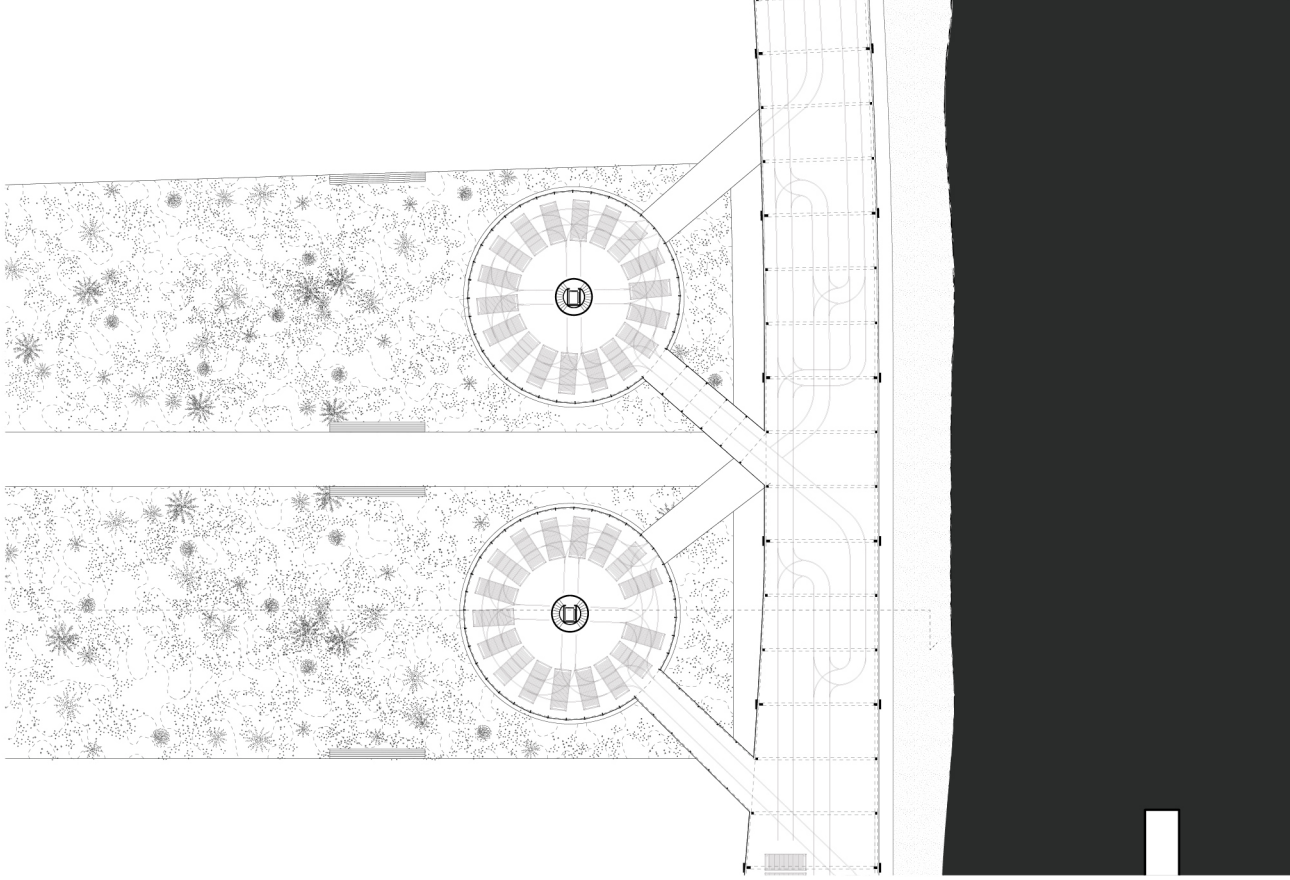

# organisation

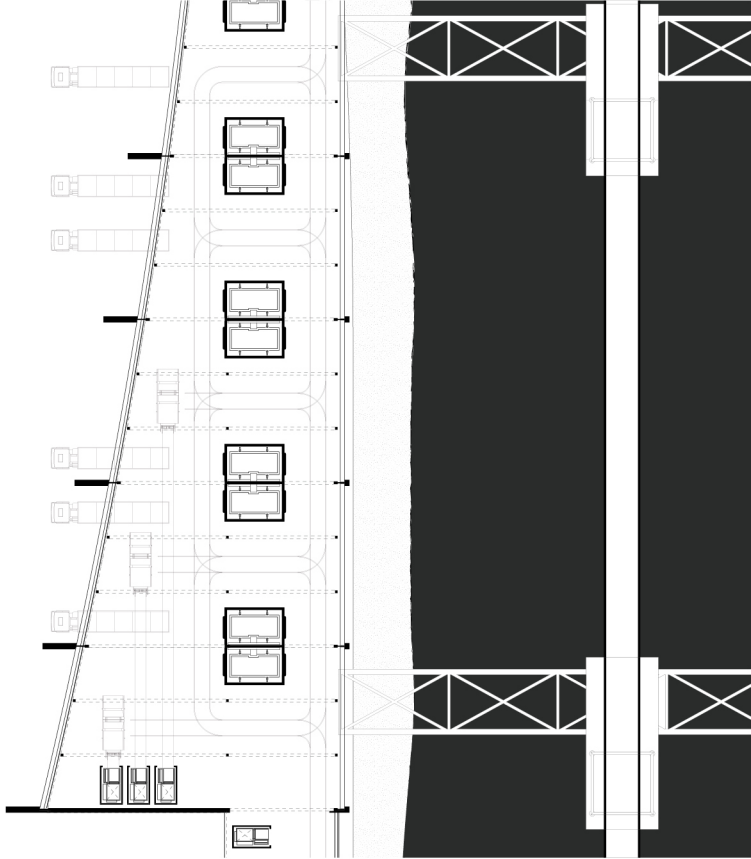

# organisation

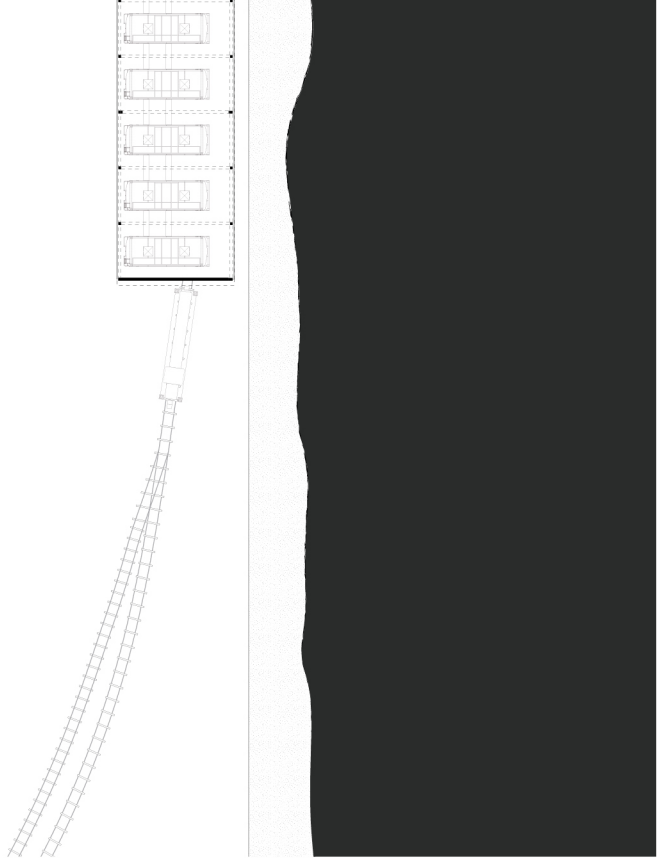
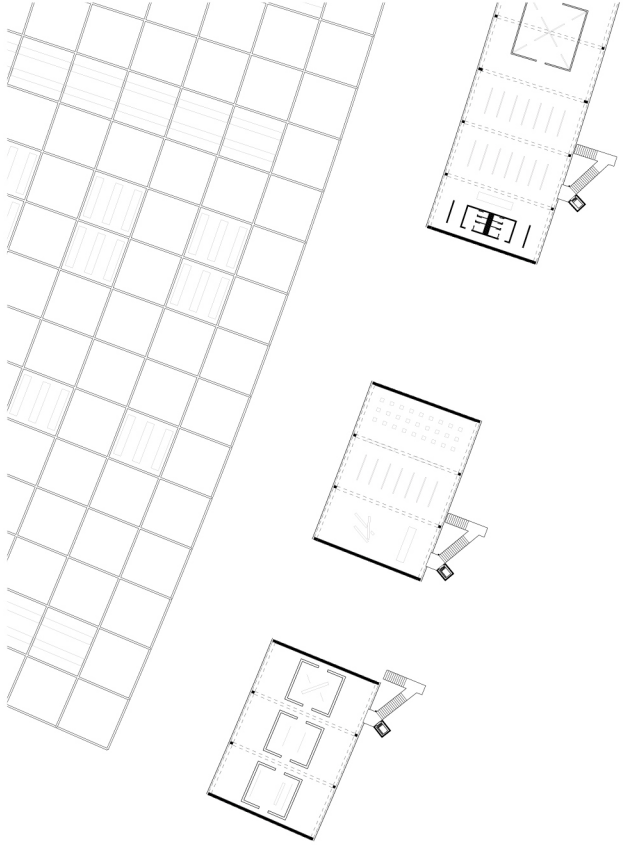

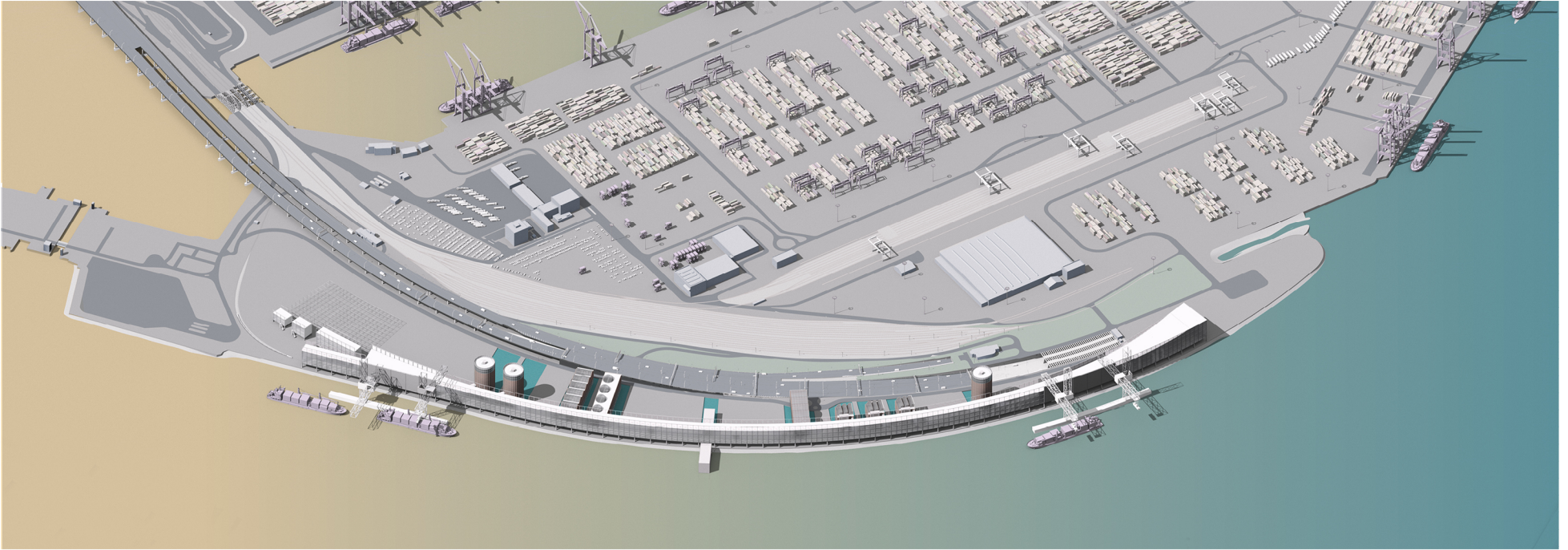



visual permeability

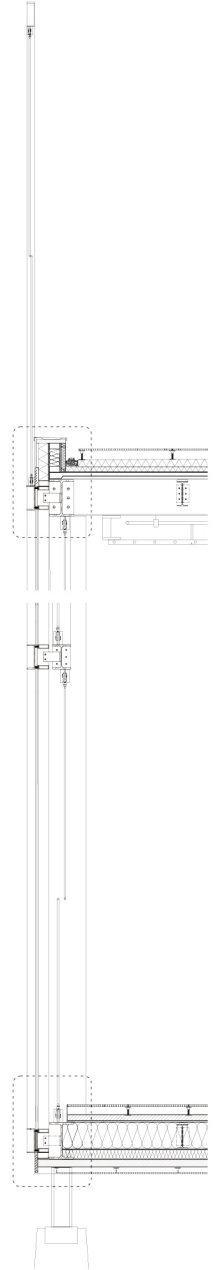
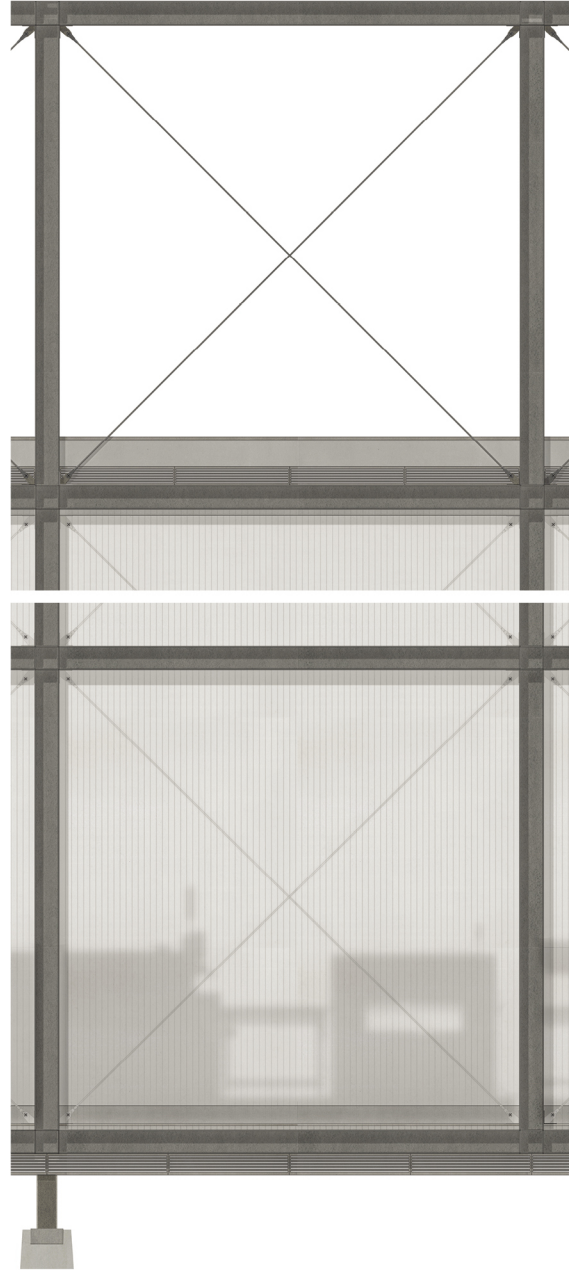
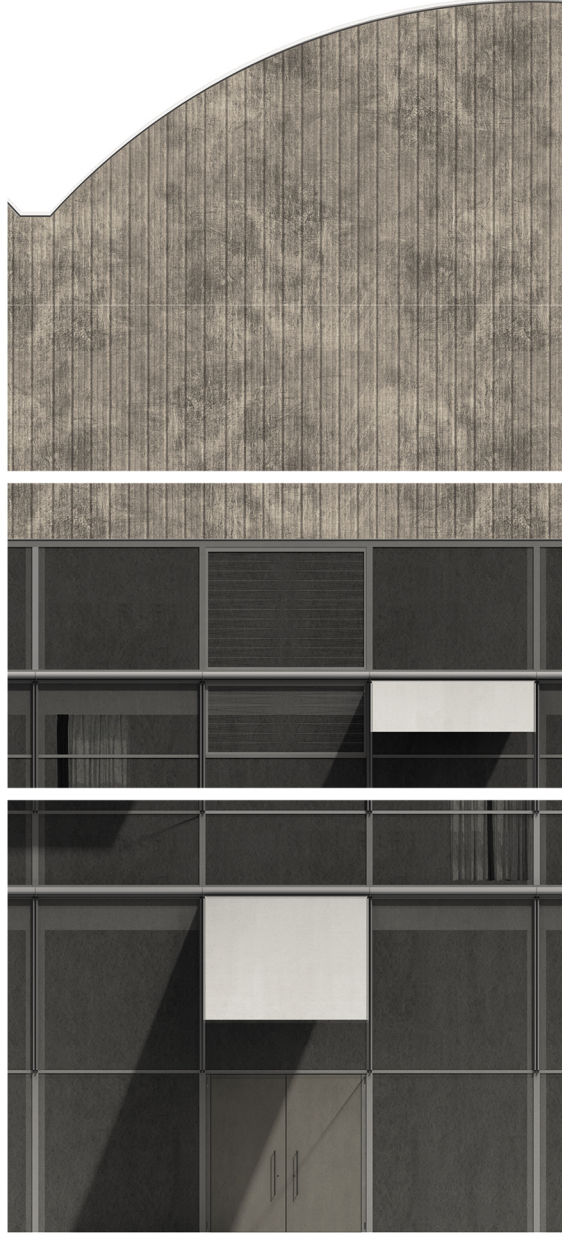
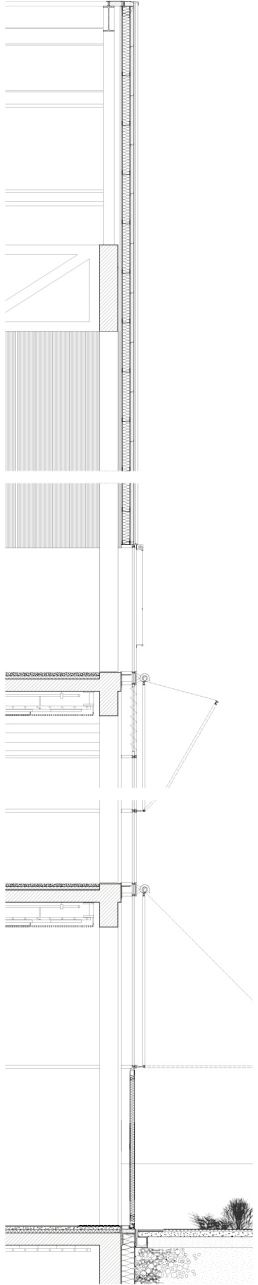

automated stage

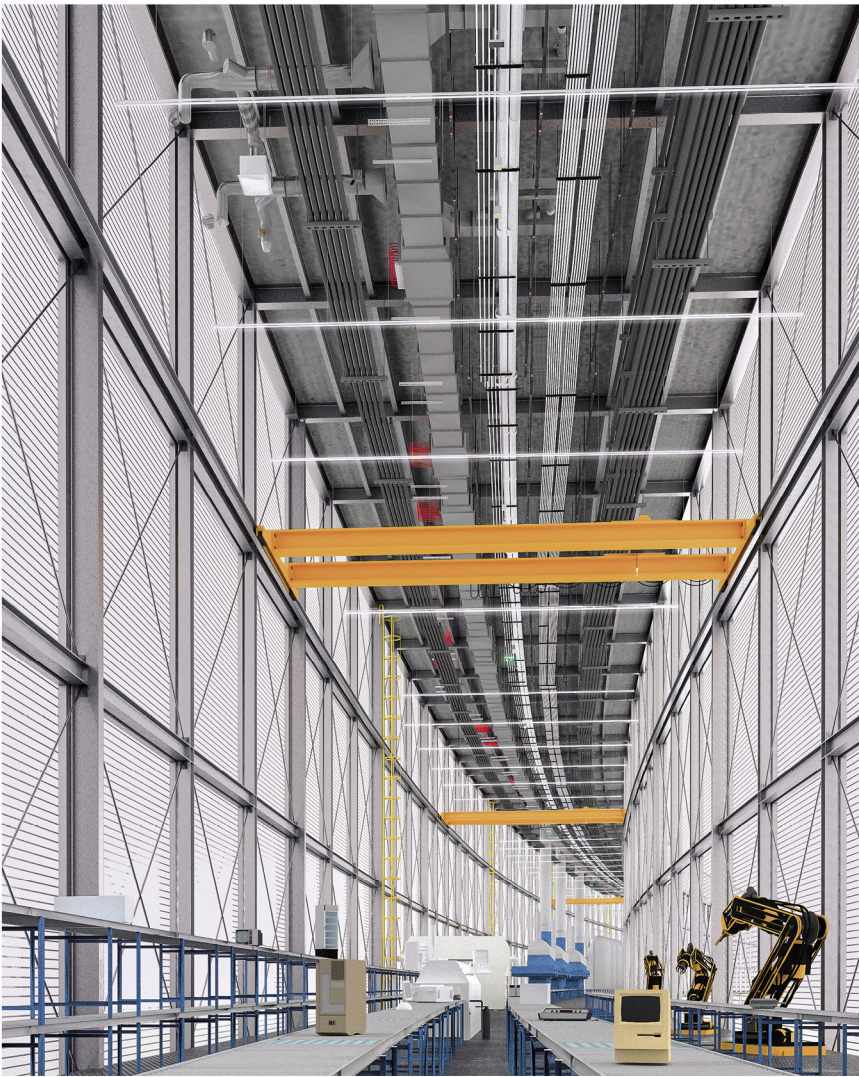

section body

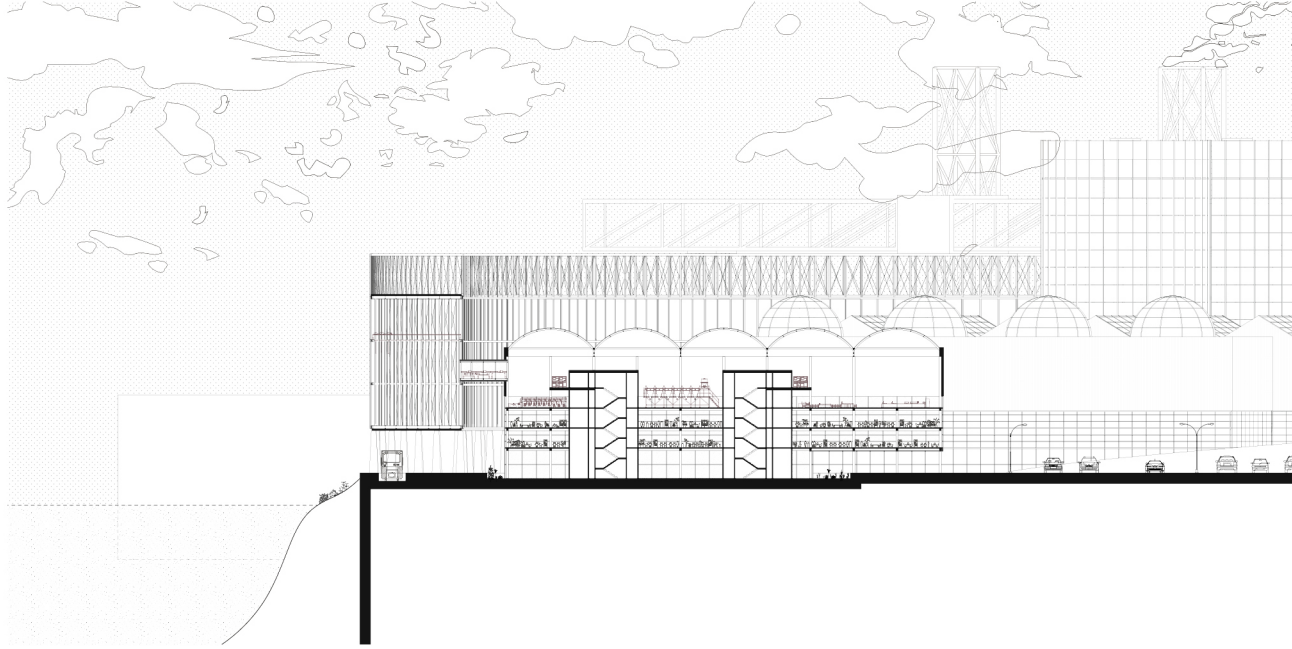

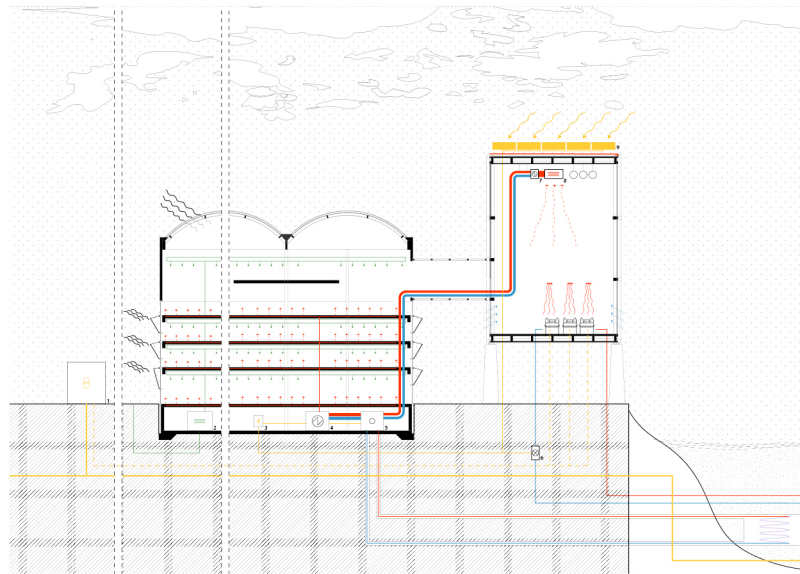
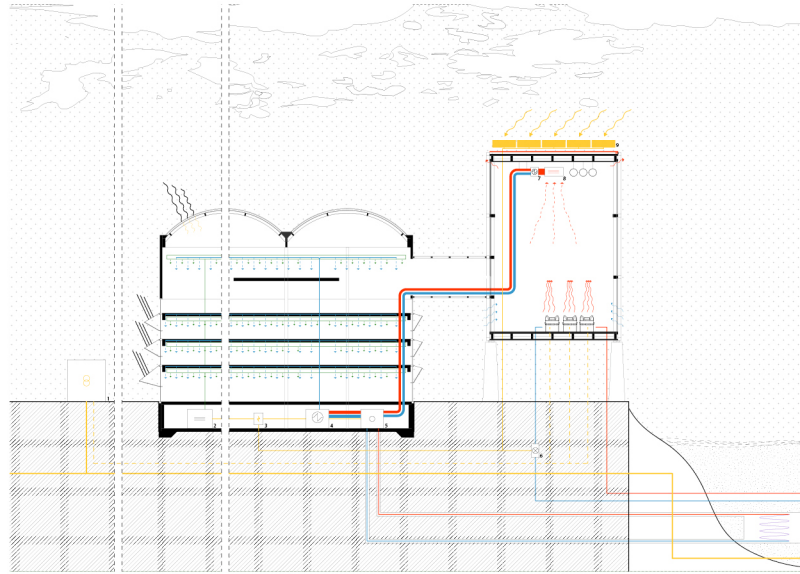

- High voltage electricity
- Low voltage electricity
- Ventilation
- Liquid cooling system
- Liquid heating system

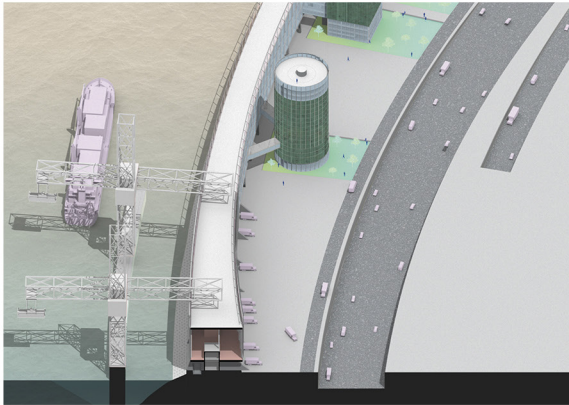
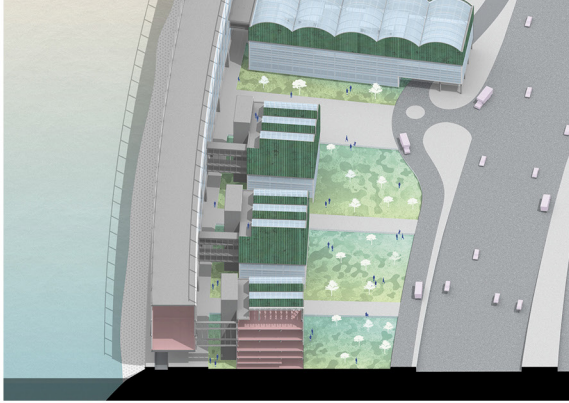
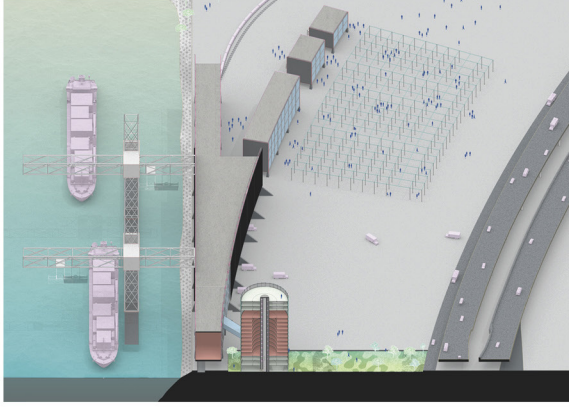









*RESULT*



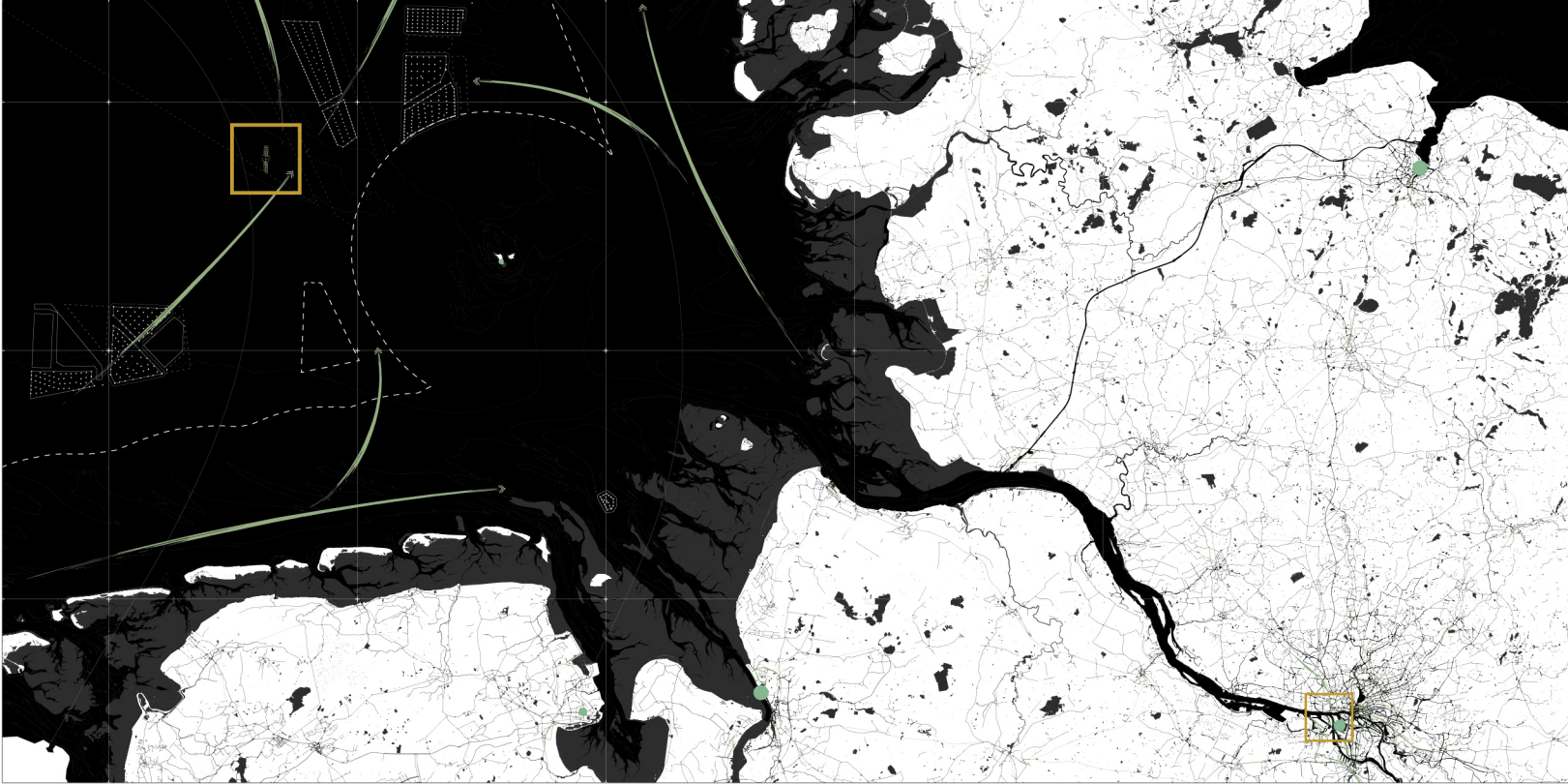

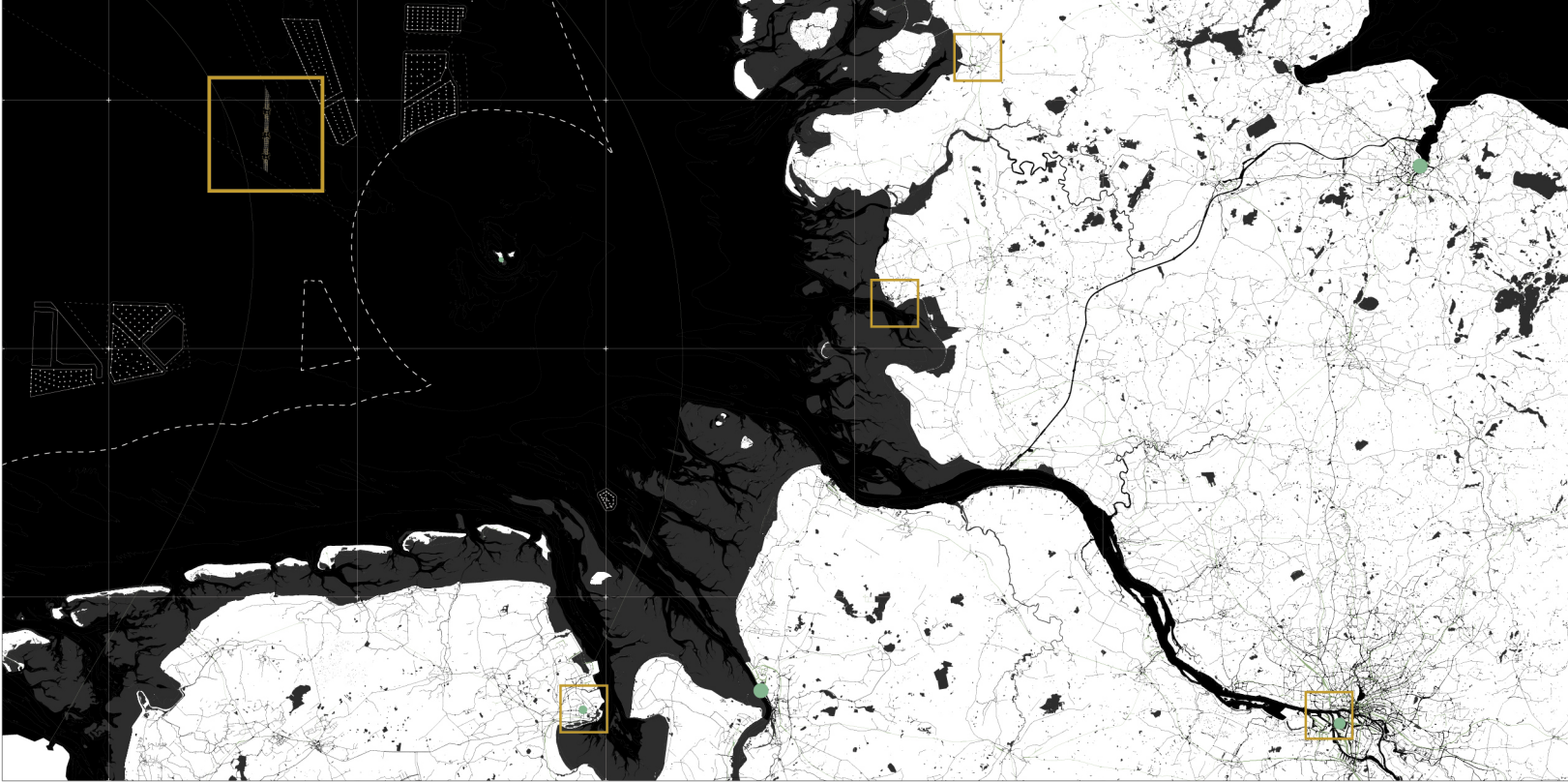

# densification

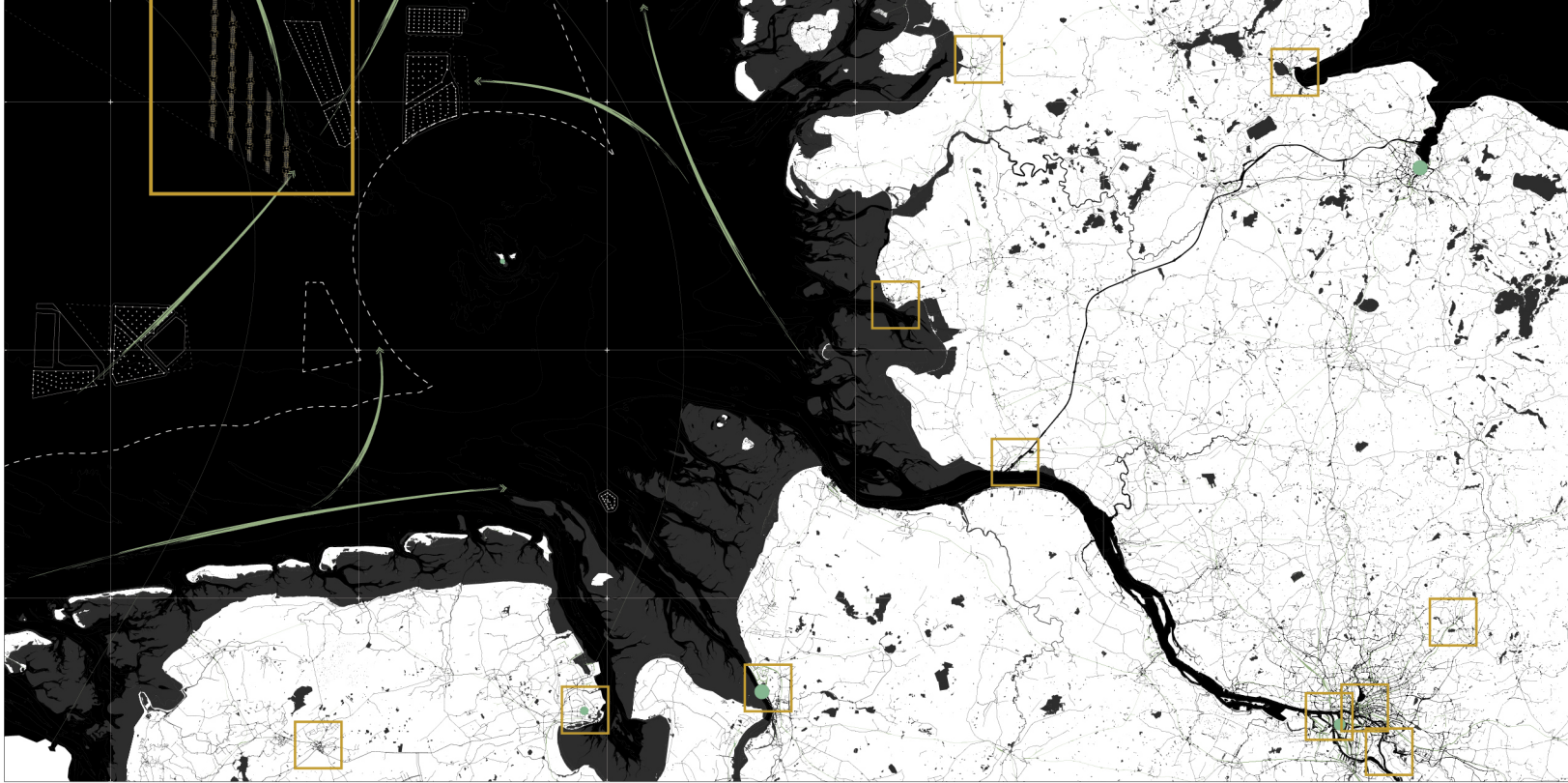



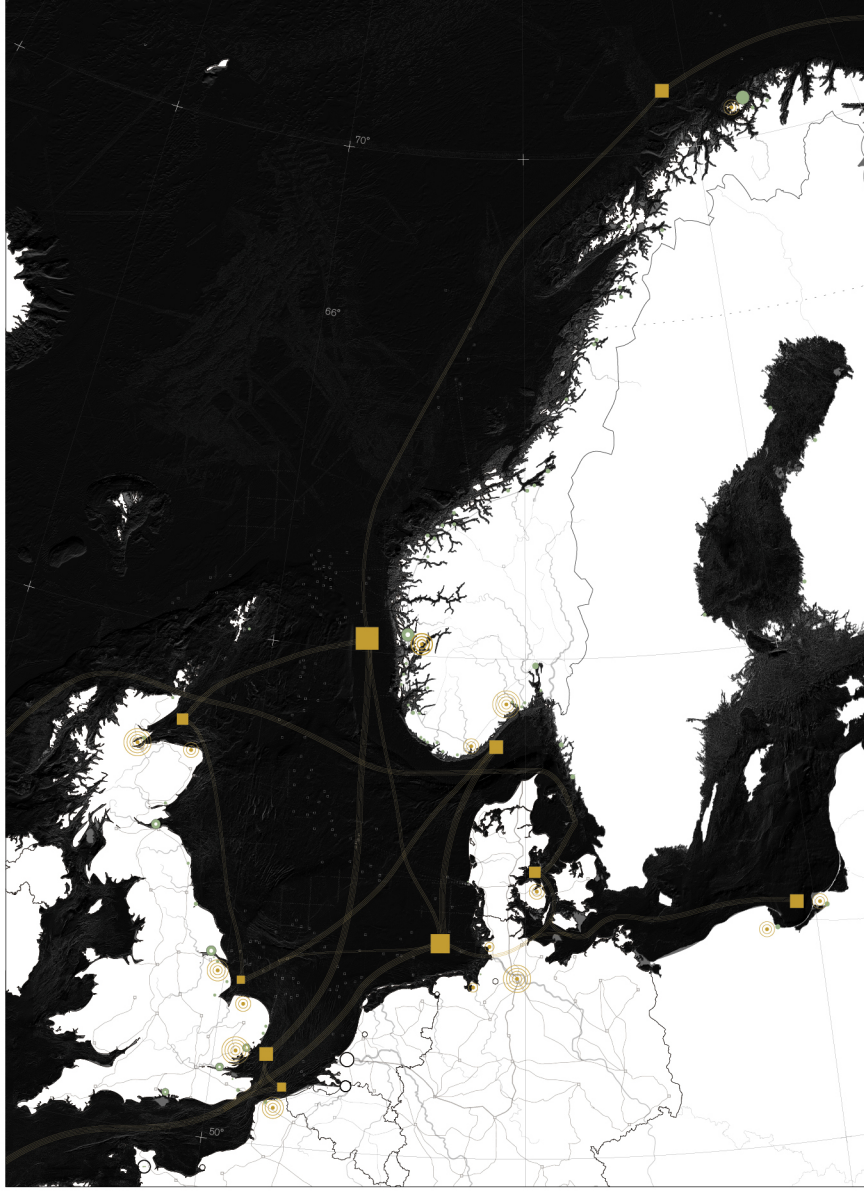

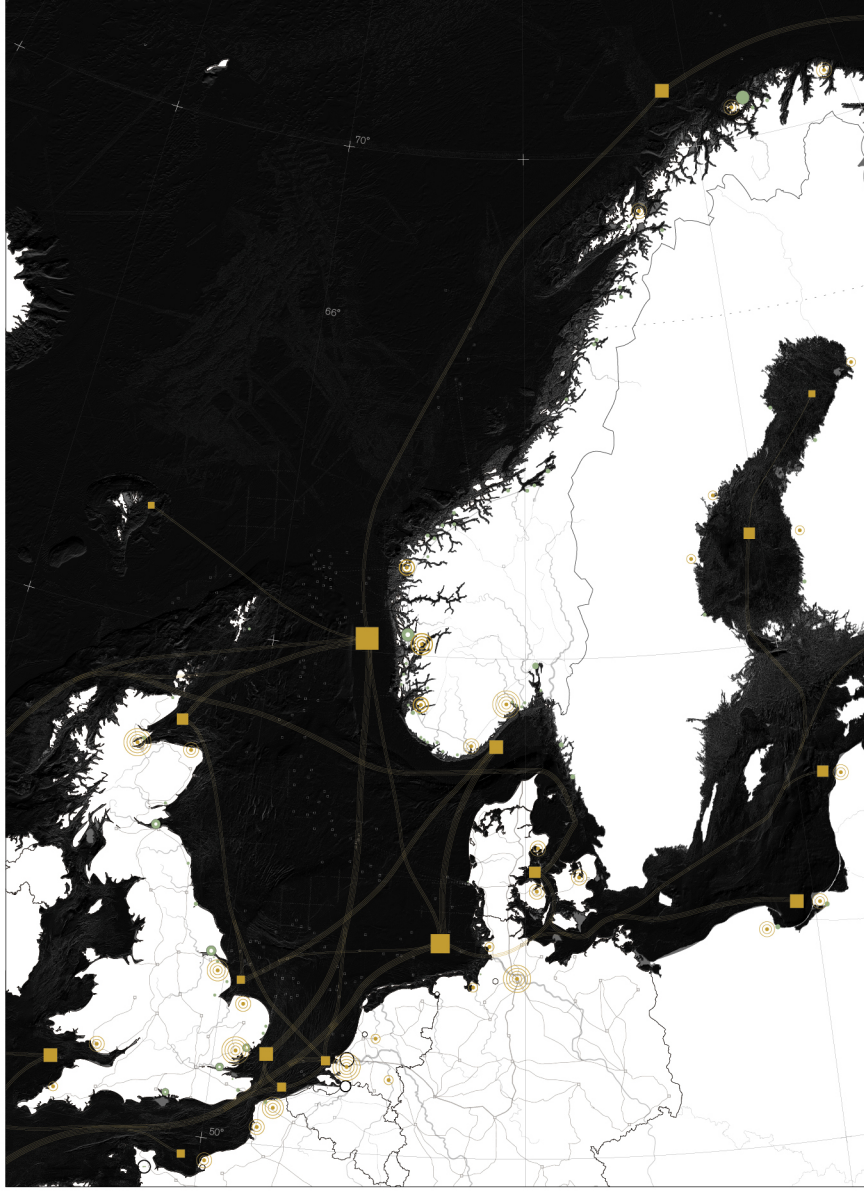







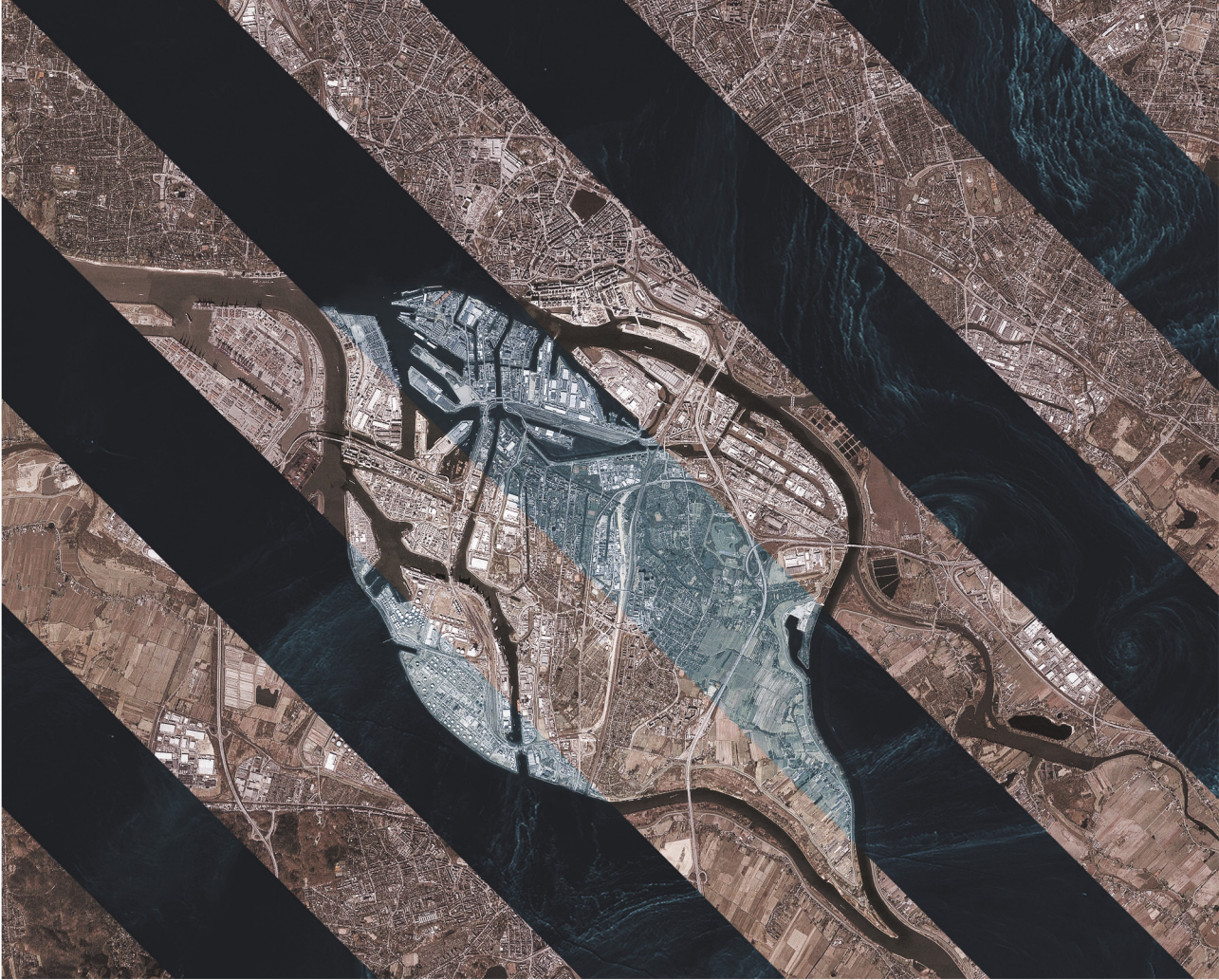

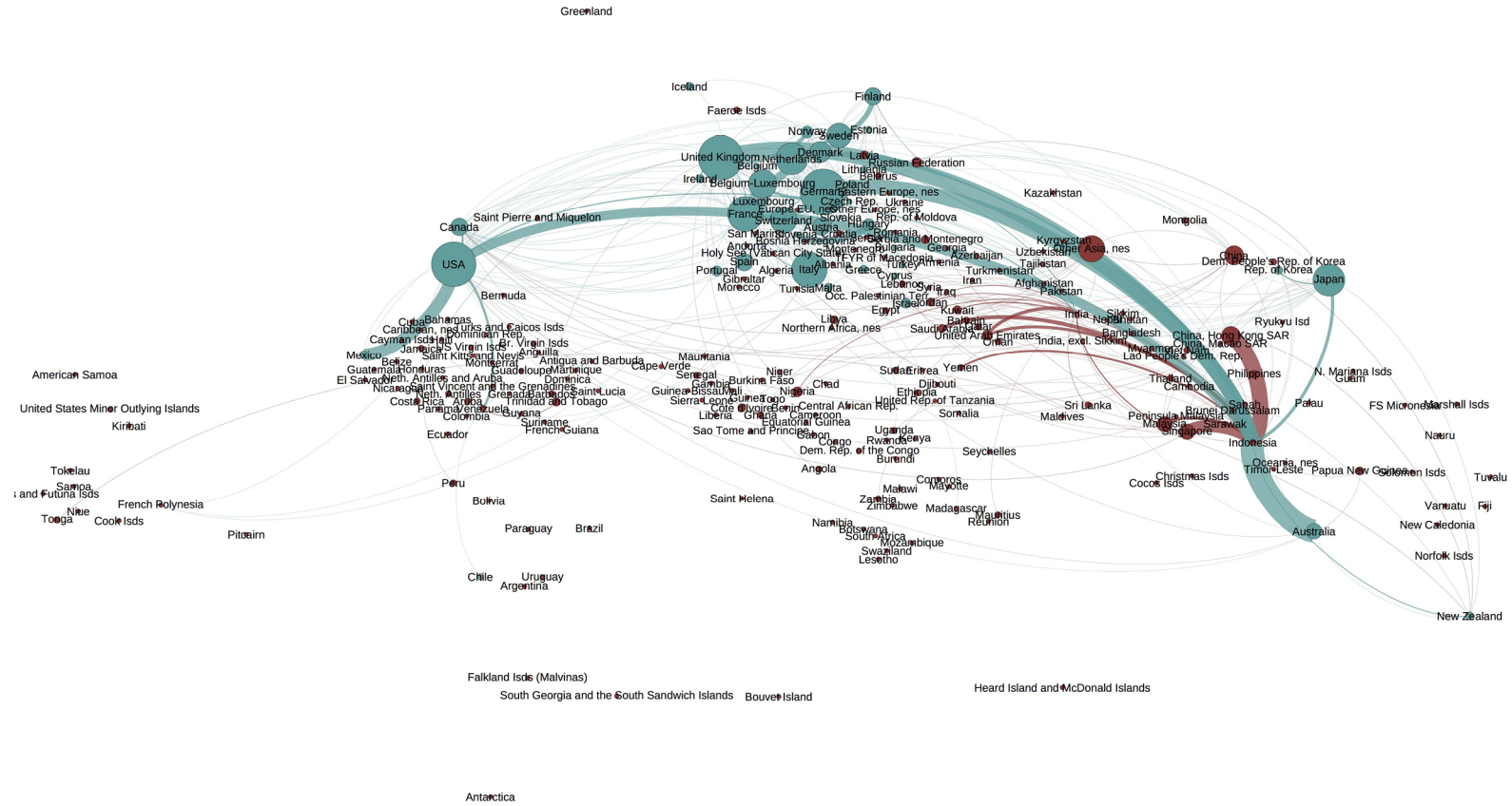

# Island of Exception

