

N

SITE PLAN
1:200'

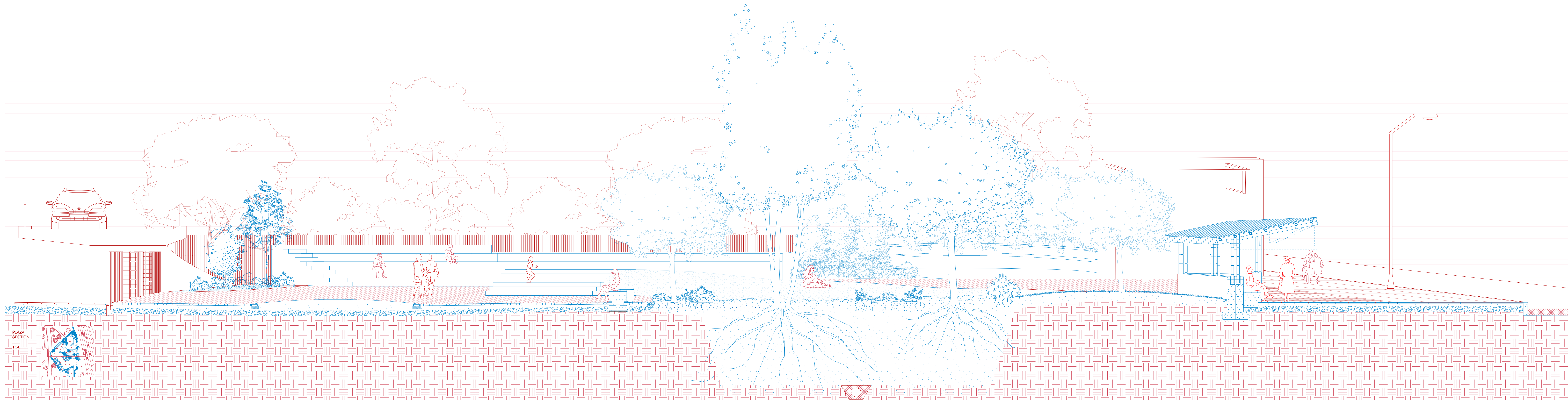

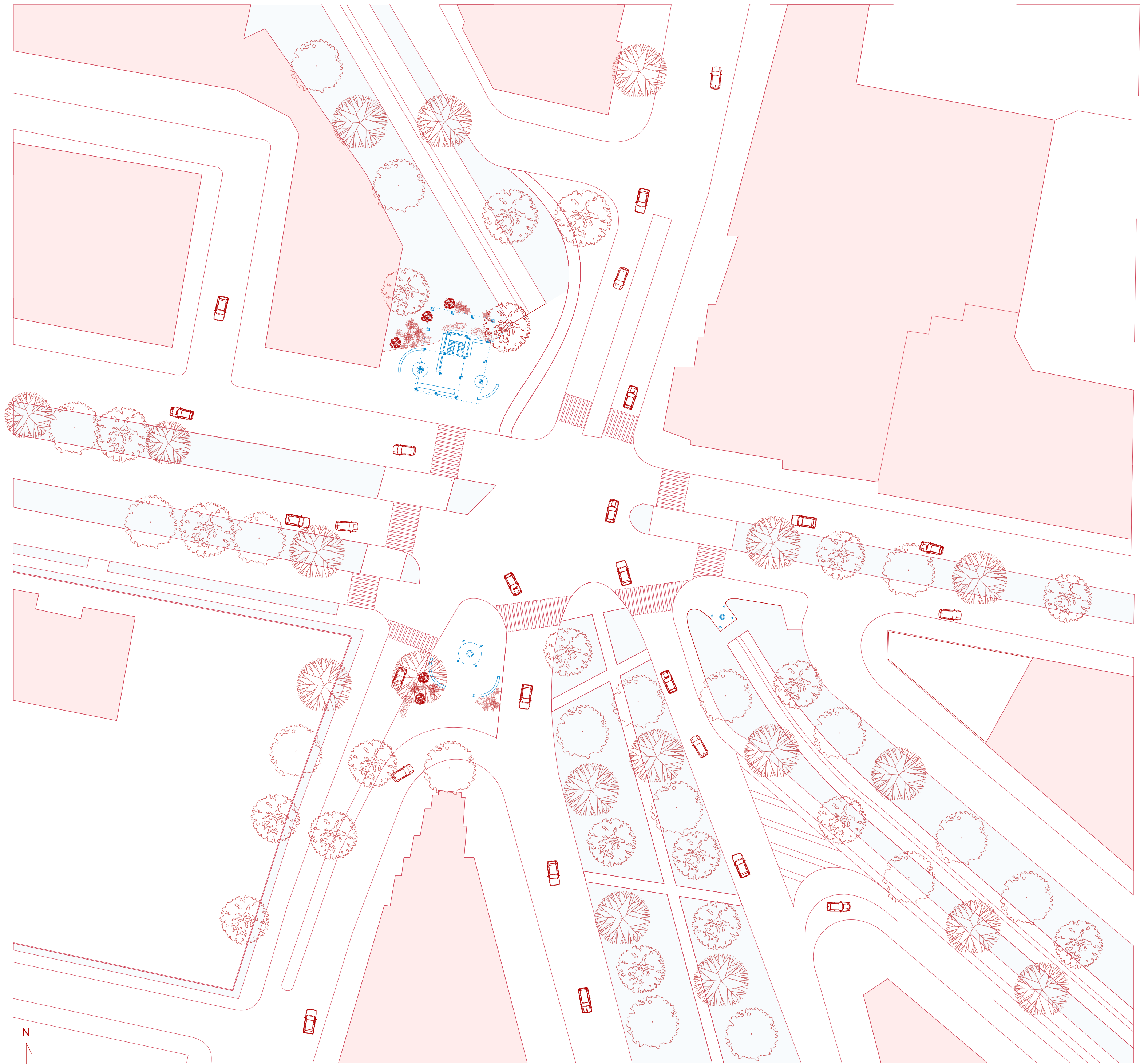



SITE PLAN
1:500



TOWER
AXONOMETRIC
VIEW
1:100

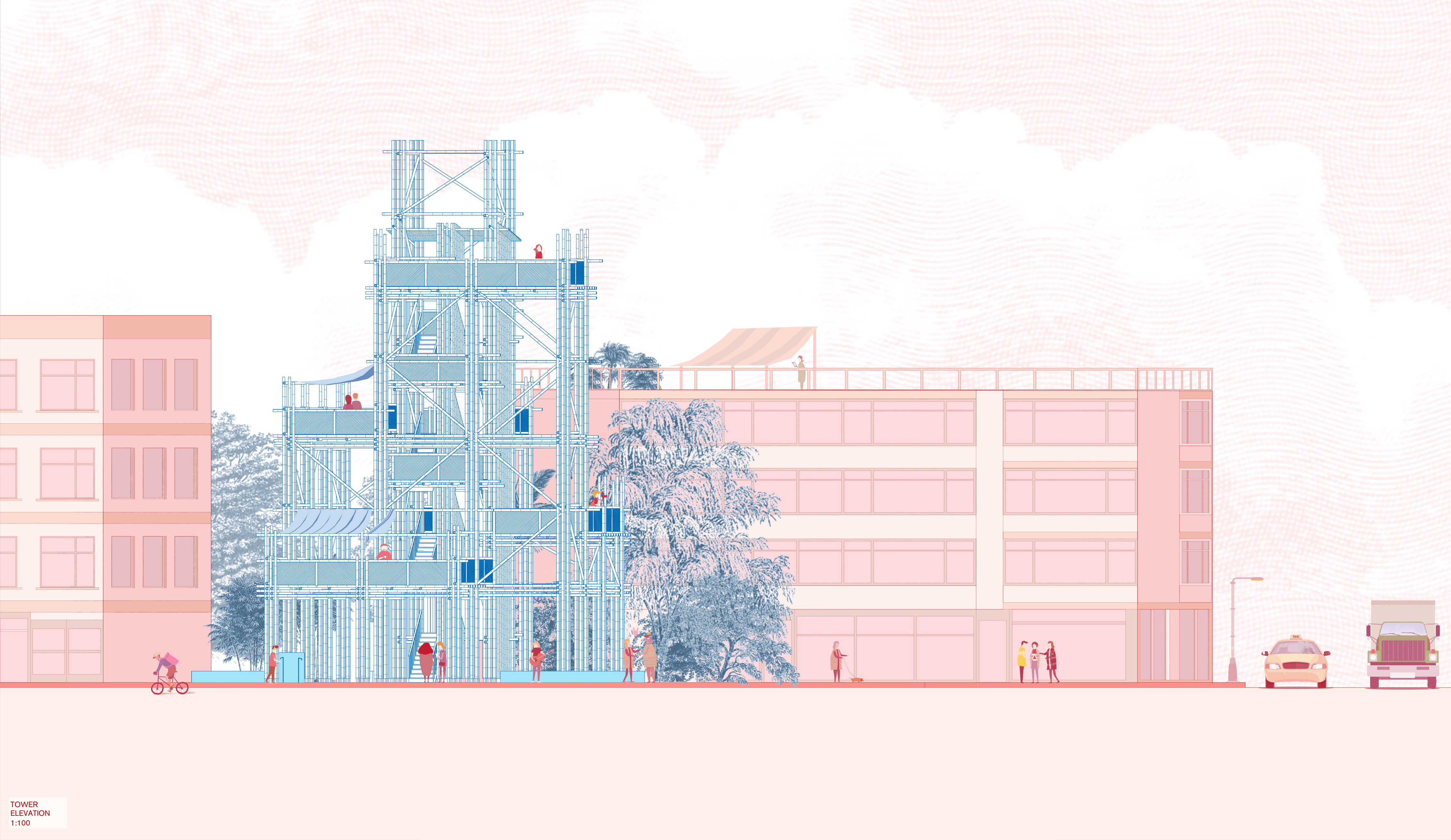

TOWER
ELEVATION
1:100



TOWER SECTION
1:50

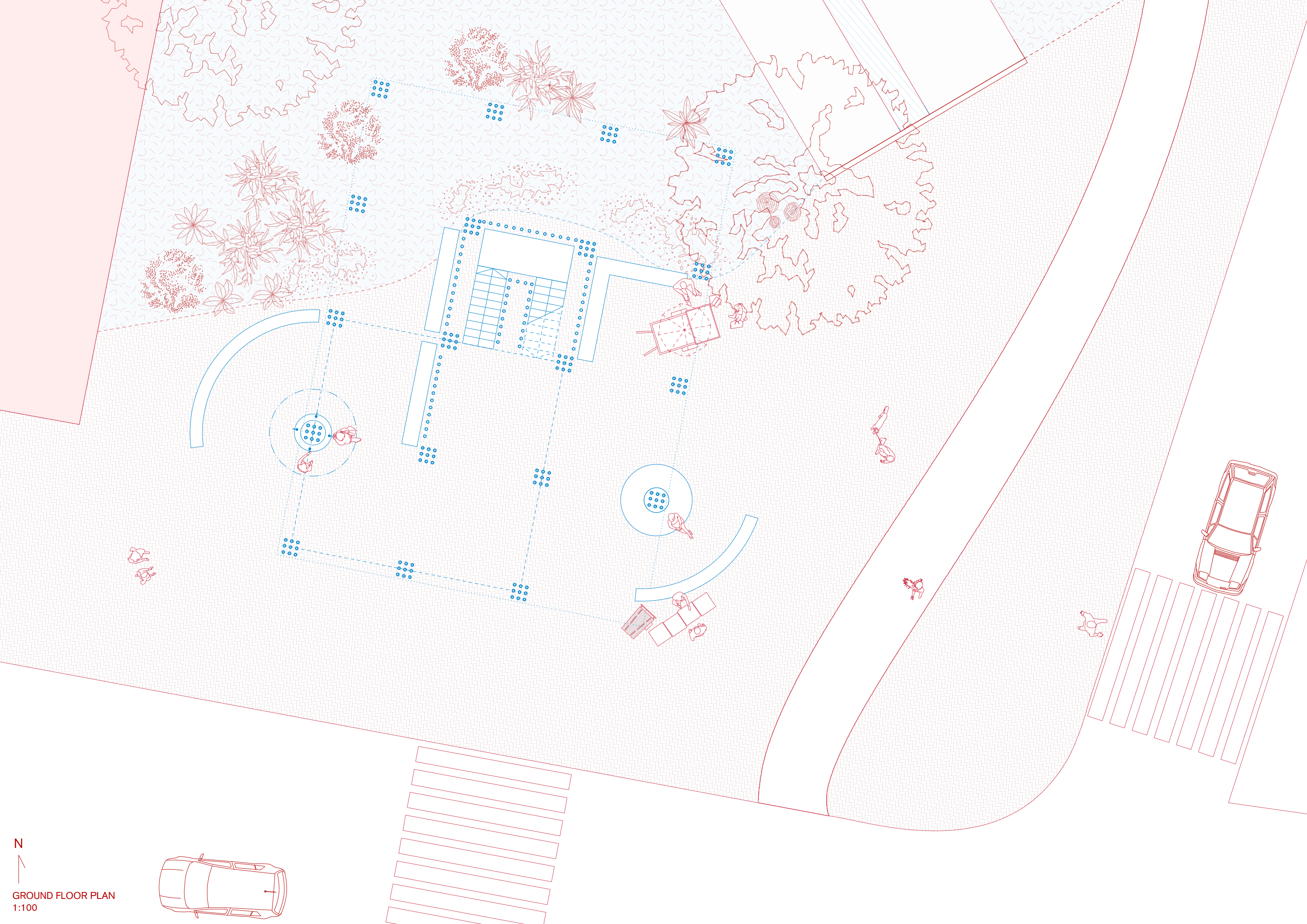

N



GROUND FLOOR PLAN
1:100

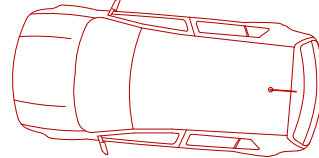

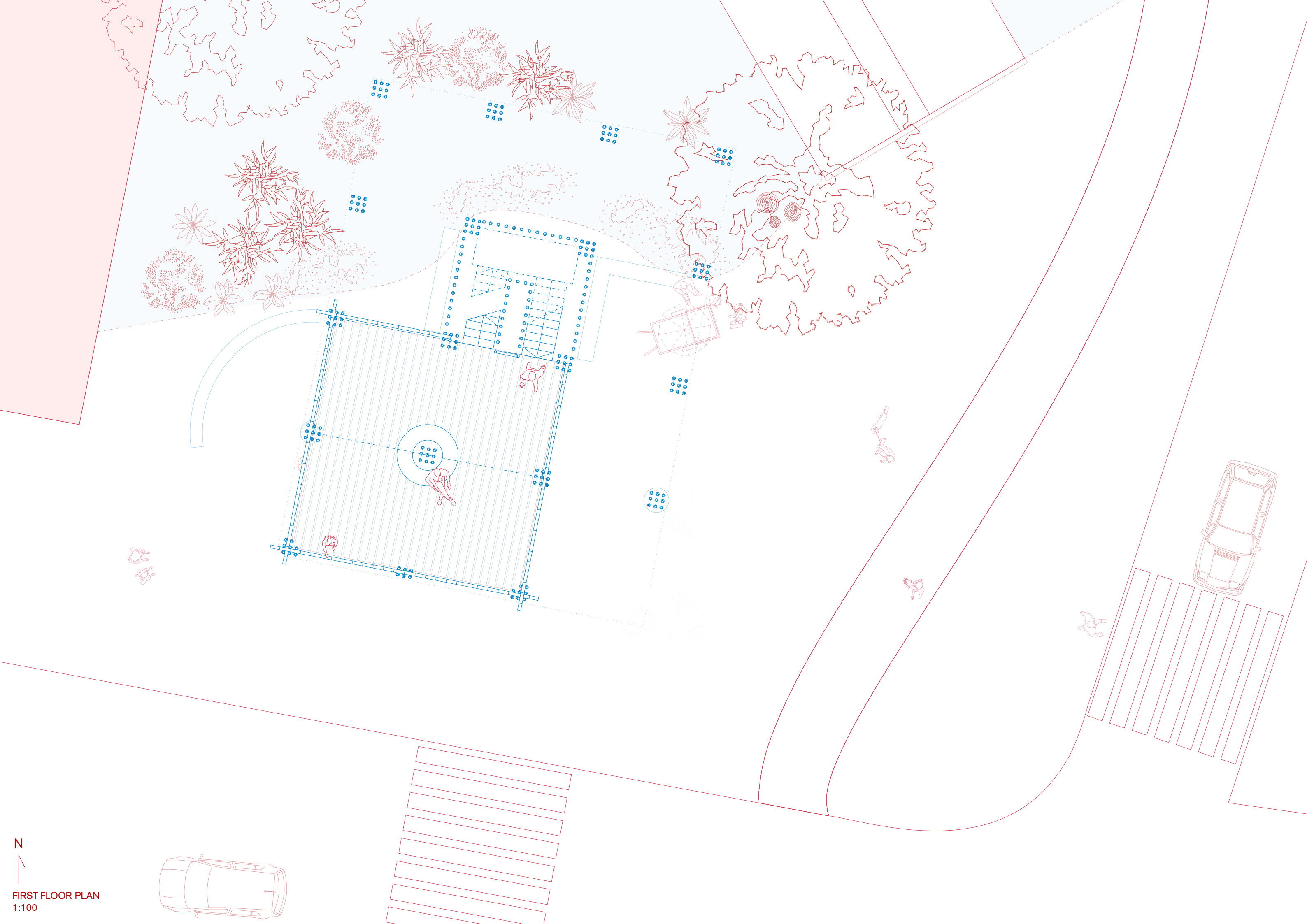

N



FIRST FLOOR PLAN
1:100



N



SECOND FLOOR PLAN
1:100

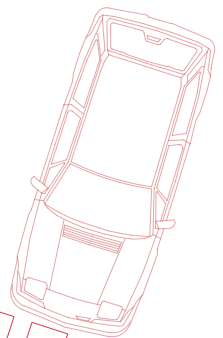
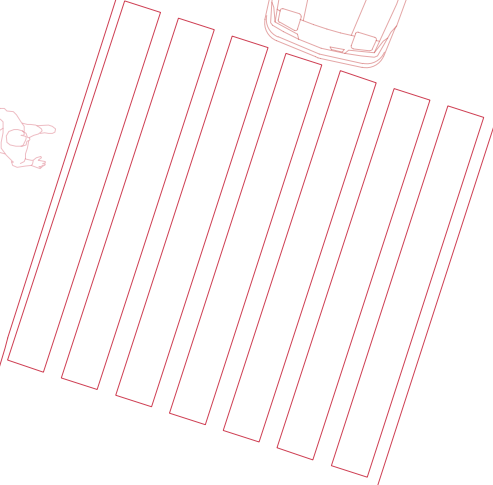
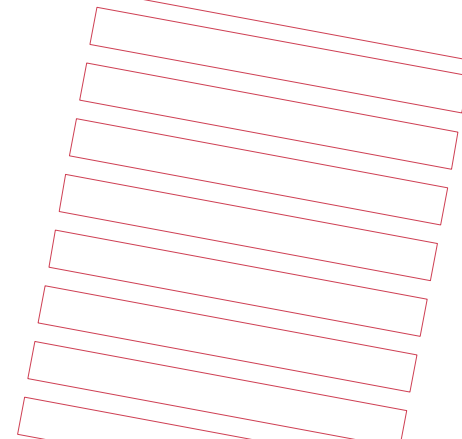
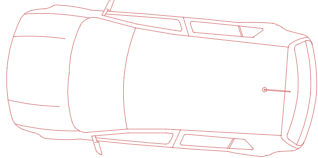



N



THIRD FLOOR PLAN
1:100



N



FOURTH FLOOR PLAN
1:100

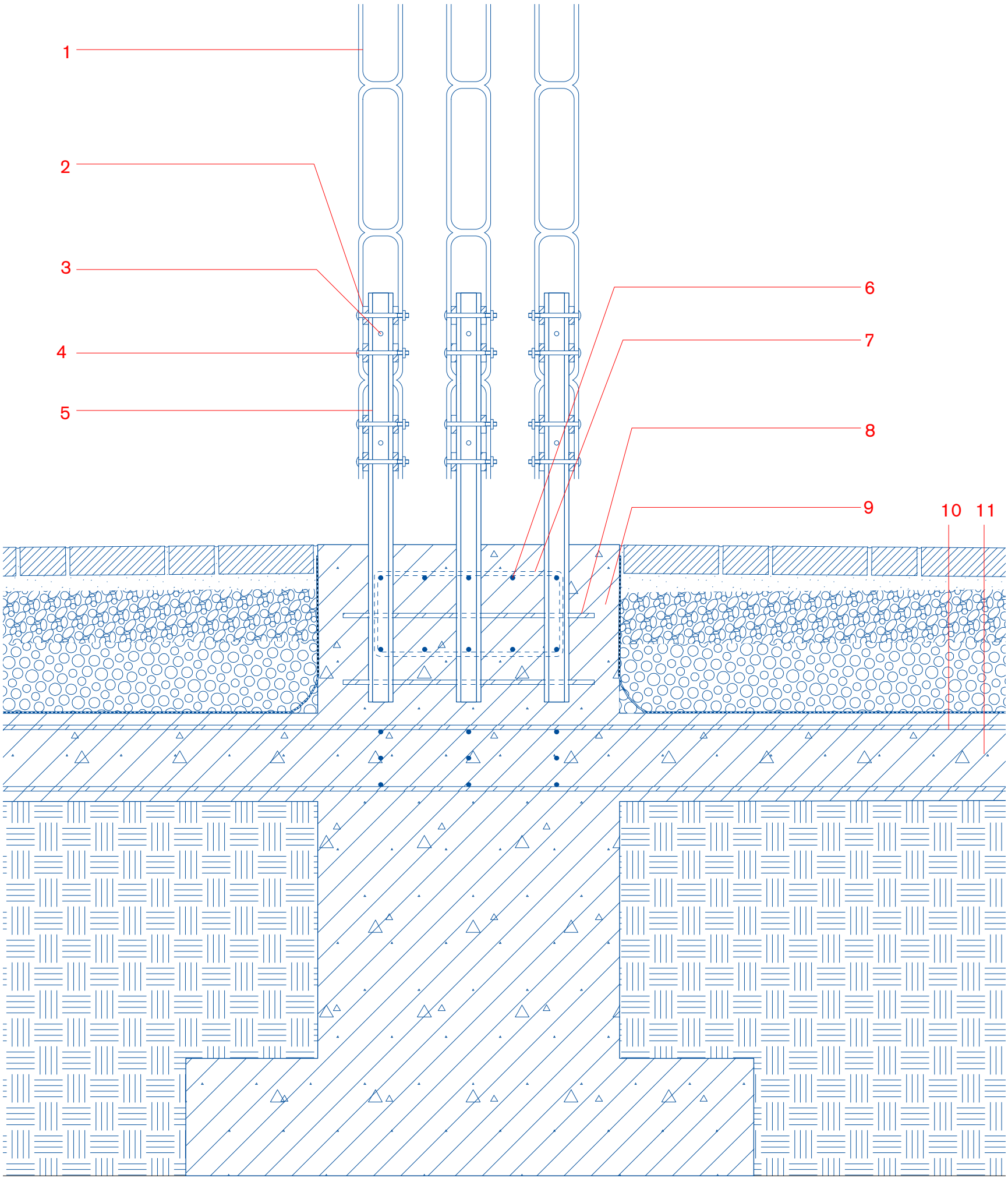

- 1 - *Guadua angustifolia* bamboo column, 100mm diameter
- 2 - Rubber binding around steel rod
- 3 - Steel bolt, 10mm diameter
- 4 - Flatheaded steel bolt with hex bolt, 10mm diameter
- 5 - Steel anchor rod, 55mm diameter, 950mm long
- 6 - Steel reinforcement rod
- 7 - Steel reinforcement binding
- 8 - Steel rod bolt through anchors
- 9 - Reinforced concrete pile foundation, 1400mm deep
- 10 - Steel reinforcement rods
- 11 - Grid concrete foundation

Tower Foundation Section Detail
1:10

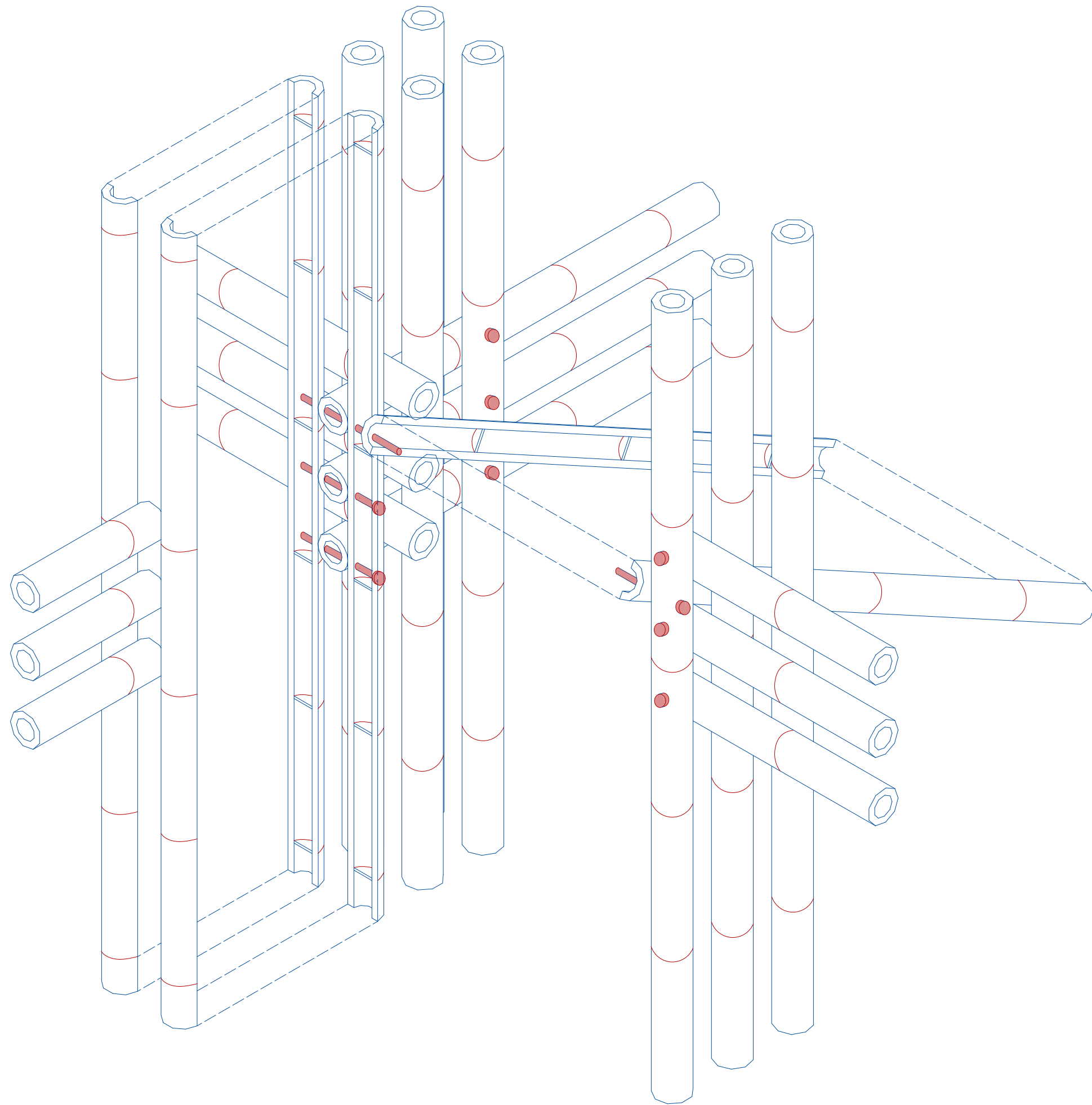
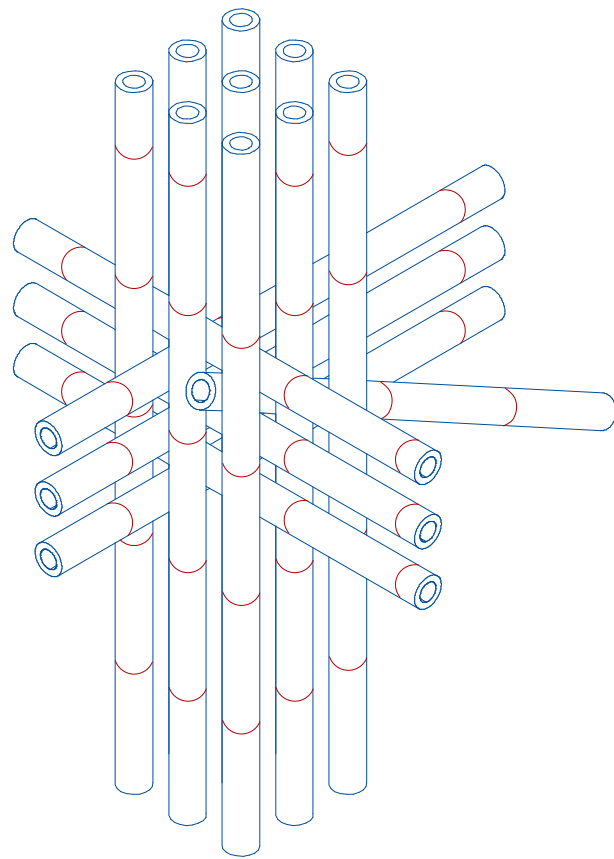

Exploded Axonometric
Tower Joint - Column, Beam and Cross Bracing
1:10