

Courts for Music and City

House of Music in London

Jun Yang
4620194

Interiors Buildings Cities
House of Music, London

Tutors: Daniel Rosbottom, Mauro Parravicini, Sam de Vocht

Table of content

1. House of Music
2. London and The Site
3. Design

House of Music



La Scala, Milan



Opéra Garnier, Paris



Musikverein, Vienna

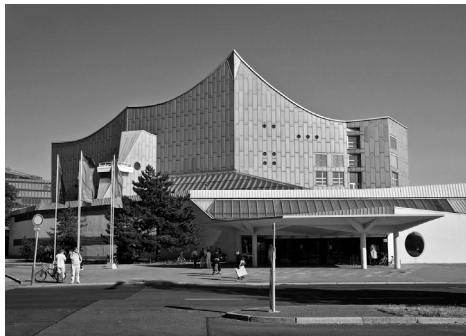

Berliner Philharmonie, Berlin



IRCAM, Paris



Concertgebouw, Bruges



Philharmonic Hall, Szczecin



Philharmonie de Paris, Paris



Elbphilharmonie, Hamburg



Opéra Garnier, Paris, 1875



Concertgebouw, Bruges, 2002

a place for the music lovers, music education, and music promotion

but also **a place for the general public**

Rhapsody in Blue

George Gershwin

Rhapsody in Blue is a 1924 musical composition by American composer George Gershwin for solo piano and jazz band, which combines elements of classical music with jazz-influenced effects.

The piece received its premiere in the concert, An Experiment in Modern Music, which was held on February 12, 1924, in Aeolian Hall, New York, by Paul Whiteman and his band with Gershwin playing the piano.

The orchestration version of Rhapsody in Blue came later on when Ferde Grofé, Whiteman's pianist and chief arranger, made new orchestrations in 1926 (theater orchestra) and in 1942 (symphony orchestra).

Since the mid-20th century, the 1942 version has usually been performed by classical orchestras playing the expanded arrangement. In this form, it has become a staple of the concert repertoire. It has direct popular appeal while also being regarded respectfully by classical musicians.

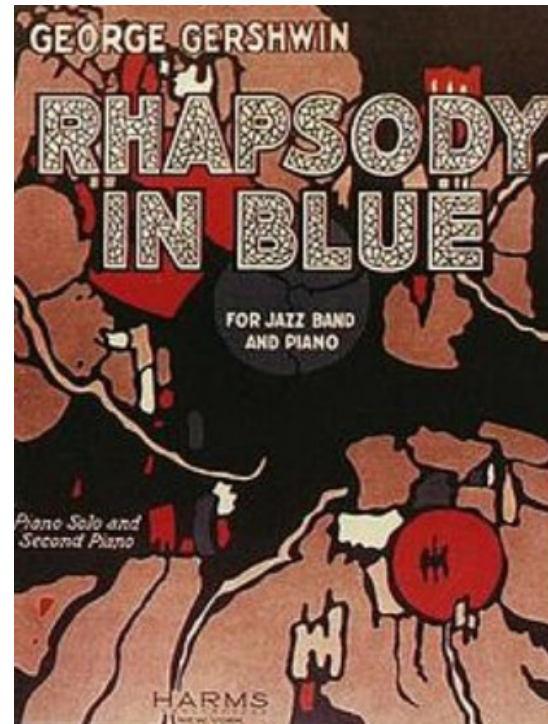



A courtyard in Naples

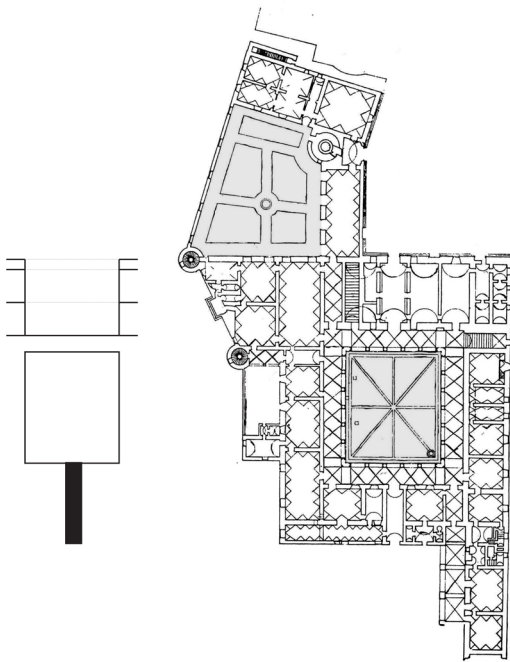

Courtyard study
Palazzo Ducale di Urbino, 1500s

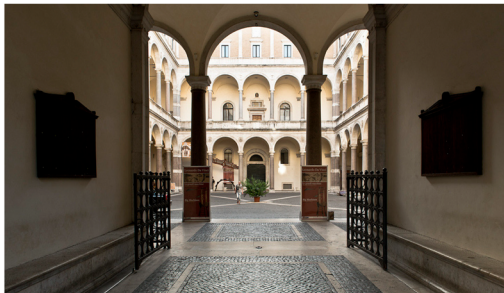
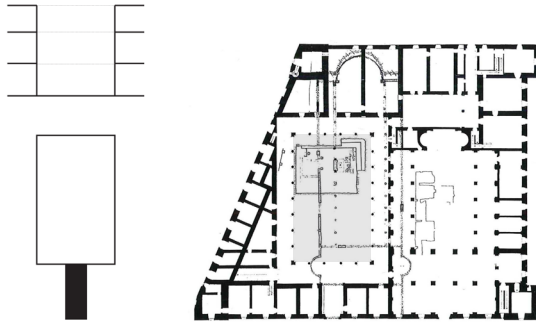

Courtyard study
Palazzo Cancellaria, Rome, 1513



Sectional model
study of the hall in relationship to surrounding spaces

London and The Site

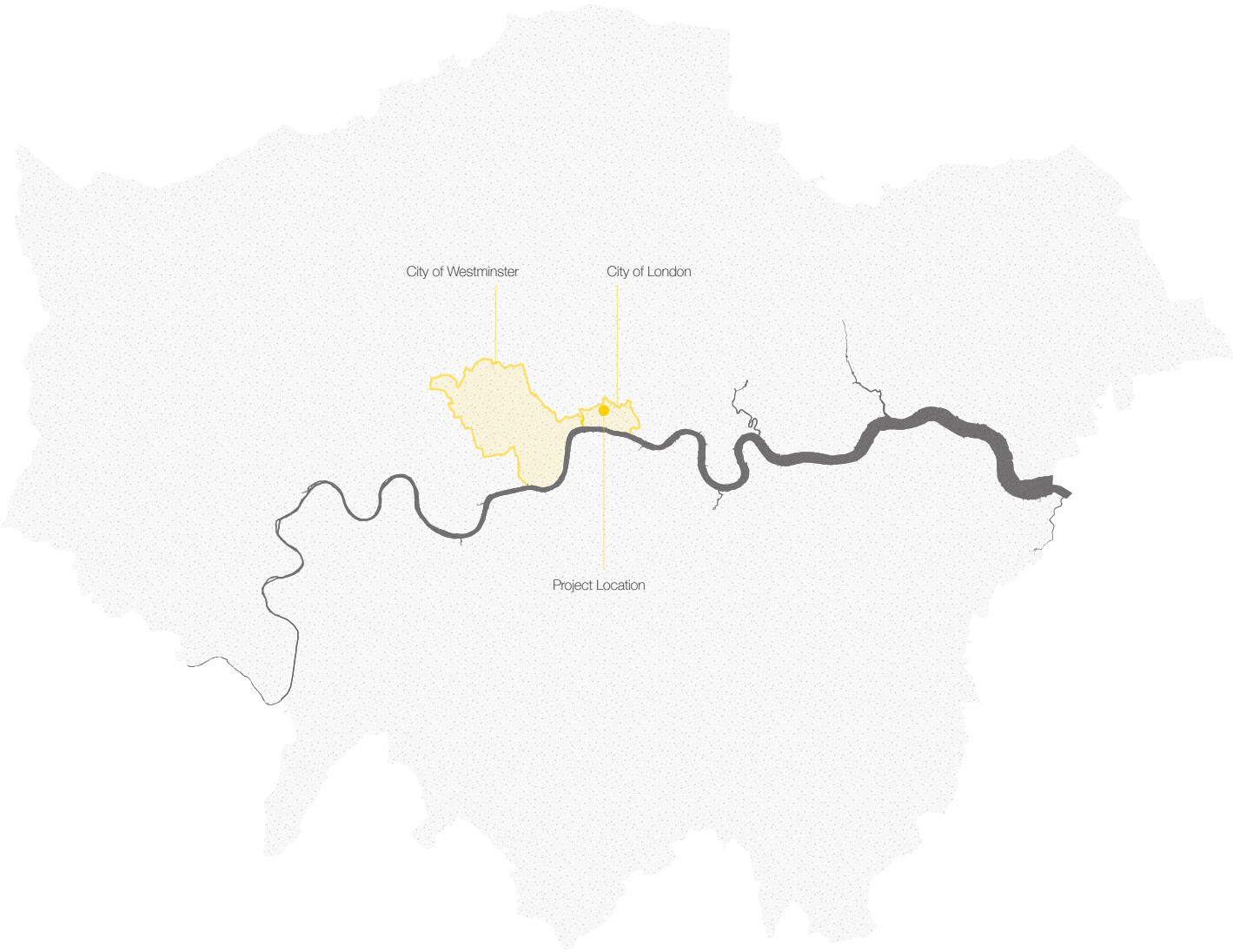

Metropolitan area of London



Important music venues in London

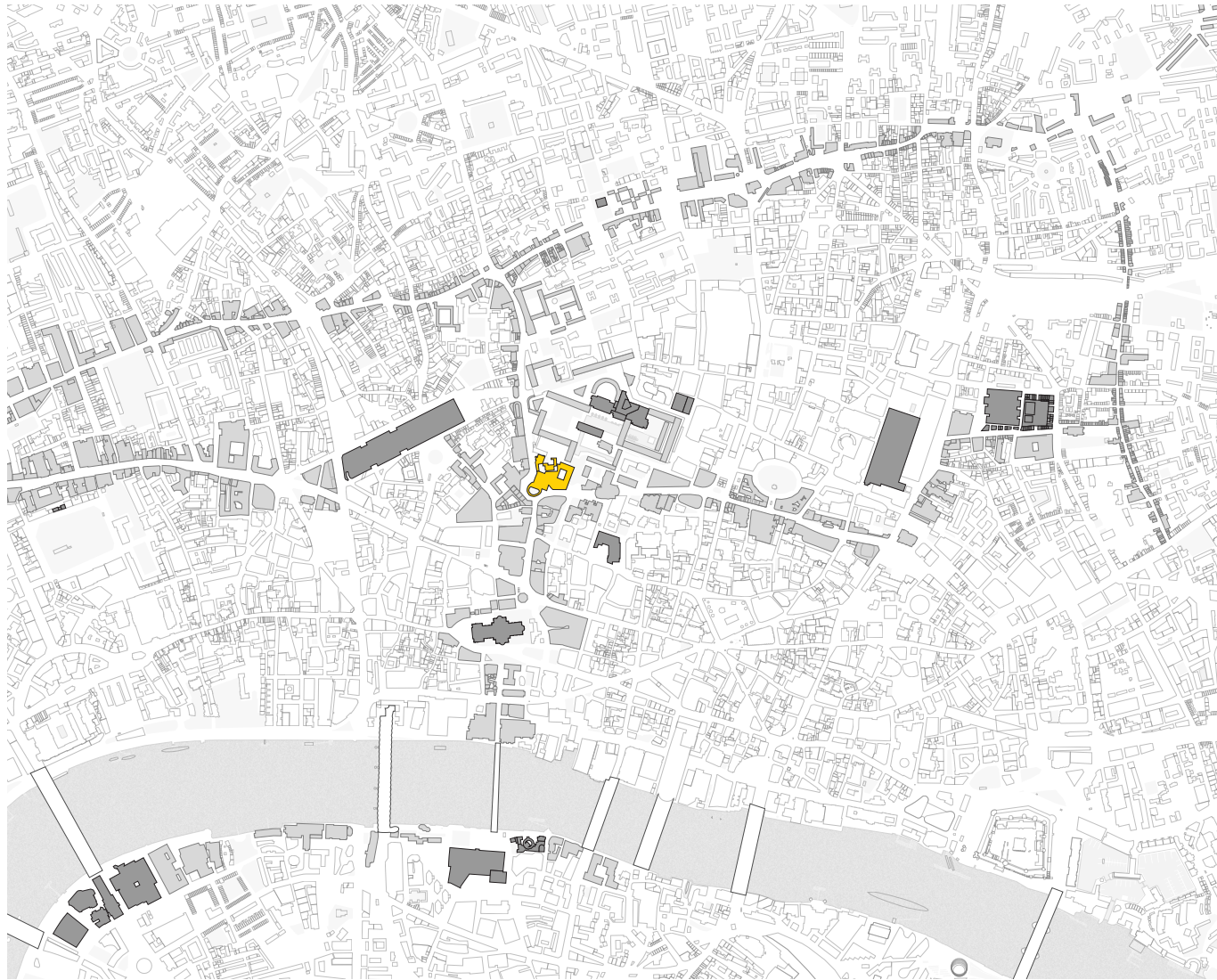

The project sits at a very important junction in London, where it connects the south bank of River Thames to the north, and links the west and the east sides of the city.

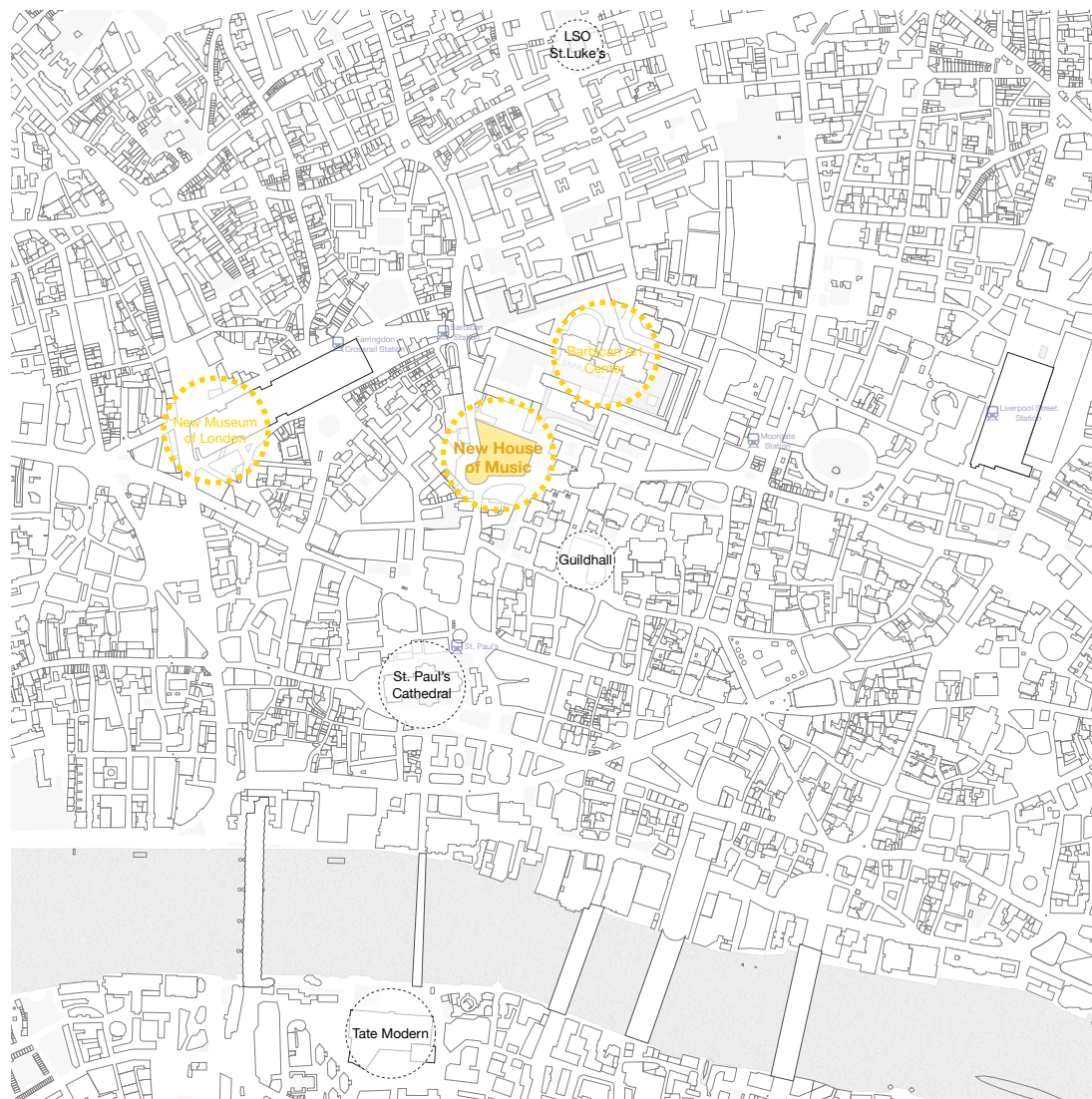

The site is located at the center point of a cultural project led by the City of London Corporation, called "Culture Mile". The new house of music will be one of the major project facilitating this cultural project, which aims at creating a vibrant and exciting cultural atmosphere to this area.

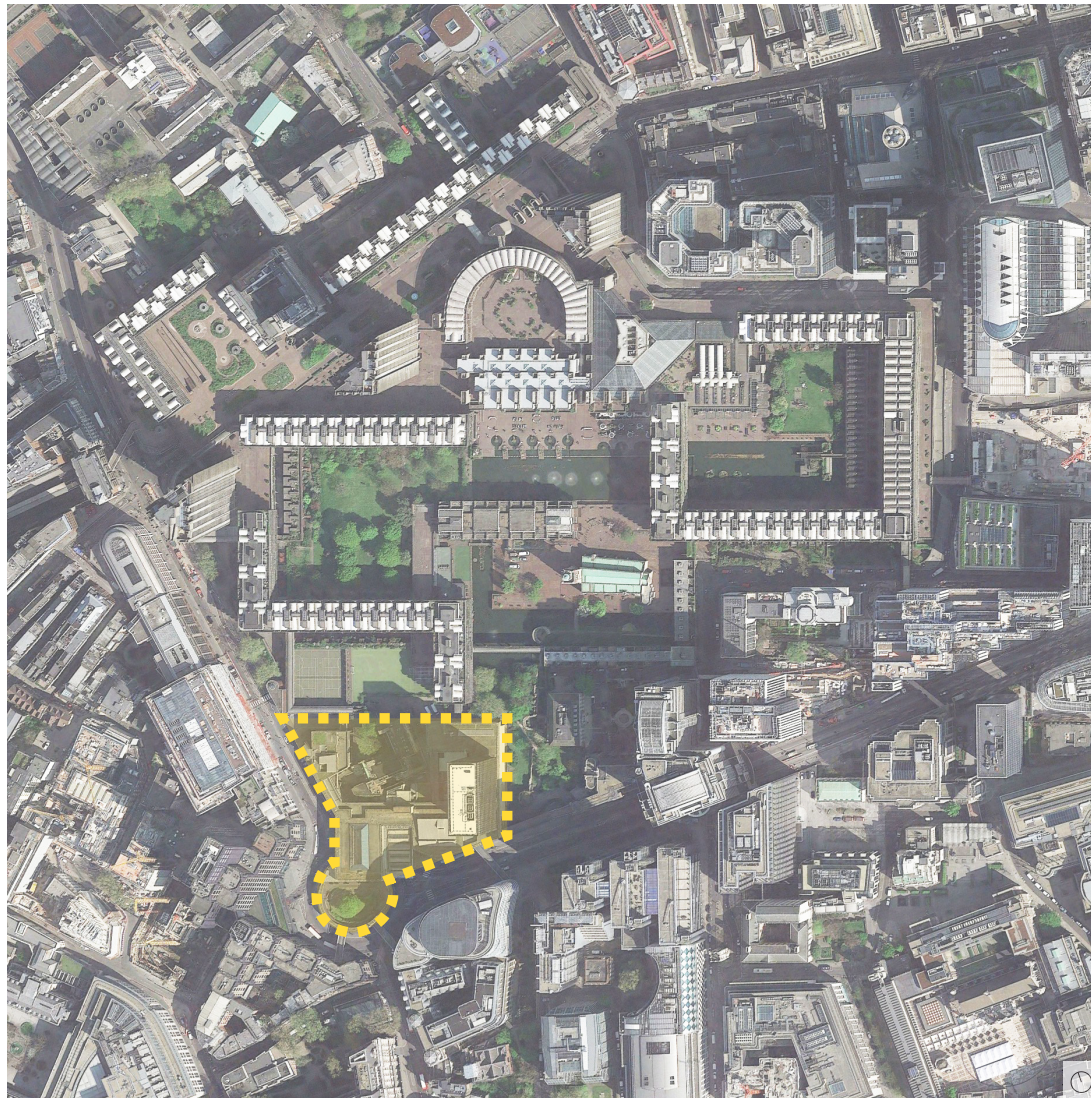

The new complex is placed at the current site of Museum of London, at the corner of the modernist Barbican complex.
On the east side of the site, there sits the archeological site of the ancient Roman Wall.

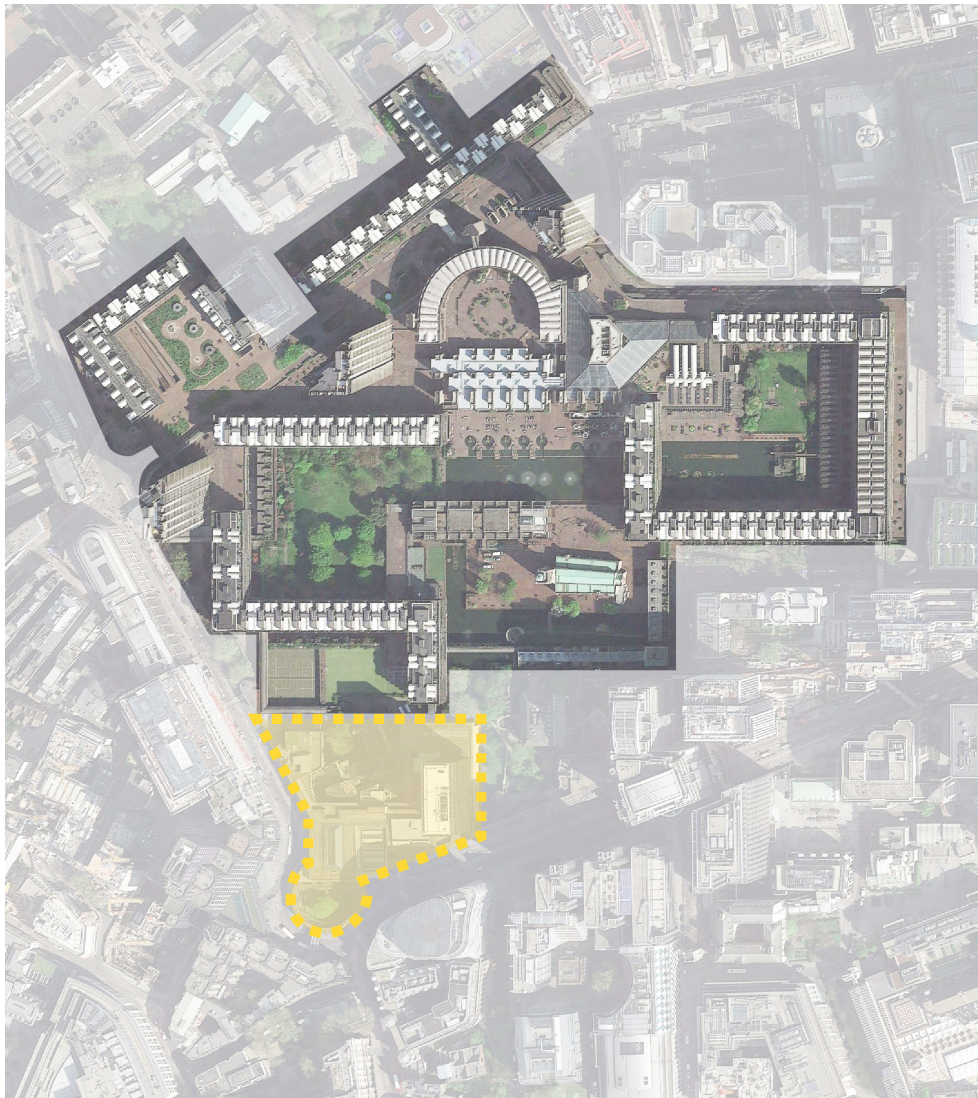

Barbican complex

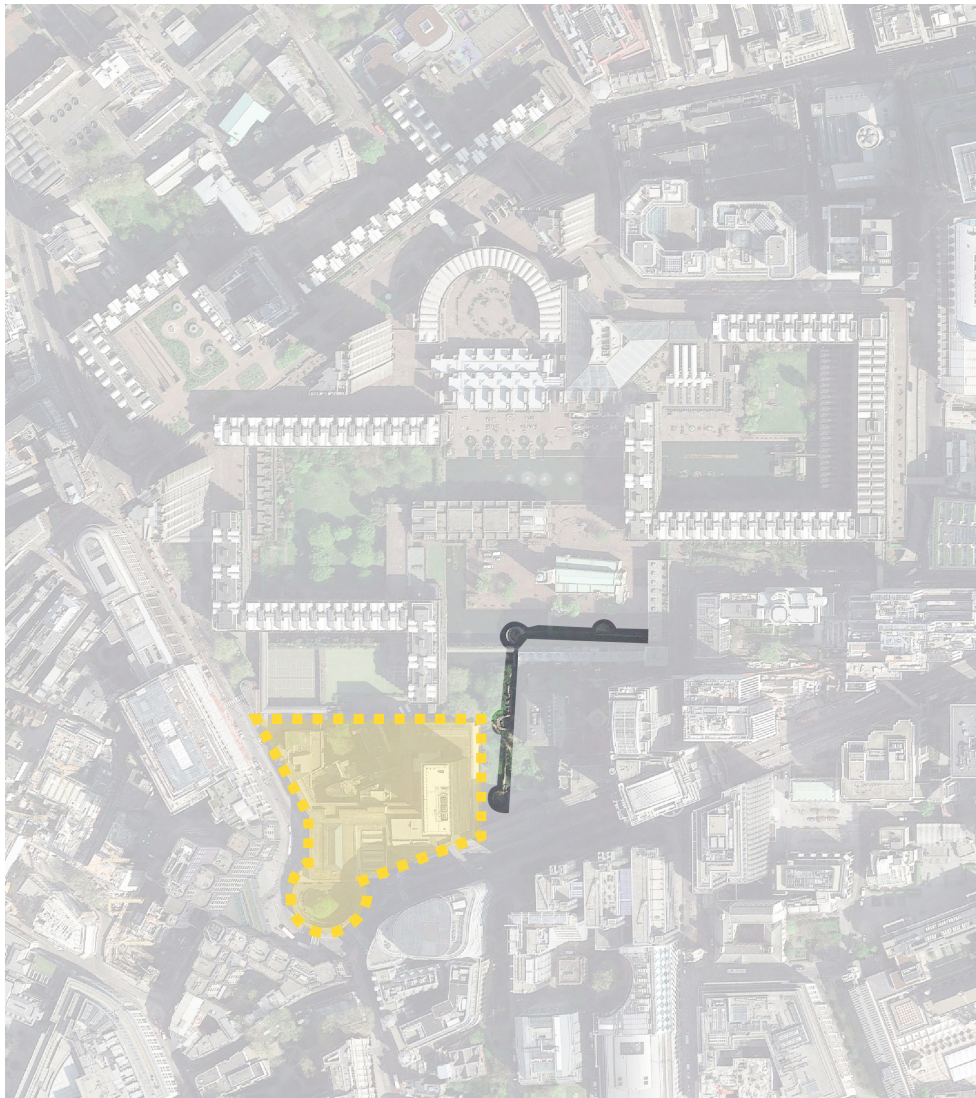

The archaeological site of the ancient Roman Wall



Residents' garden enclosed by residential blocks



The London Symphony Orchestra performed an open-air concert on the sculpture court in the Barbican Art Center in August 1982.

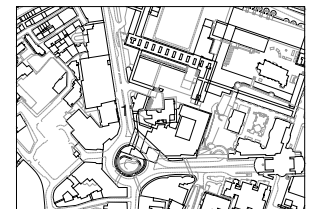

Conditions around the site
Folly and the Barbican tower

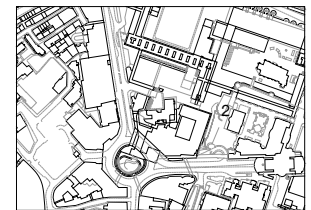

Conditions around the site
Amphitheater of the Girl's school

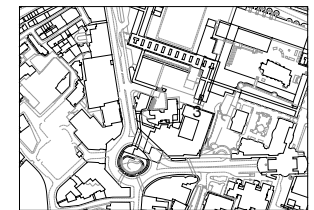

Conditions around the site
A dead-end highwalk bridge

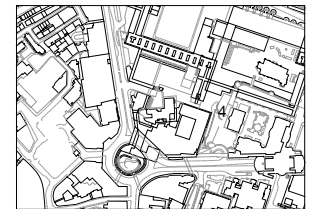

Conditions around the site
A locked gate prevents access from the Roman Wall to the other side

Design

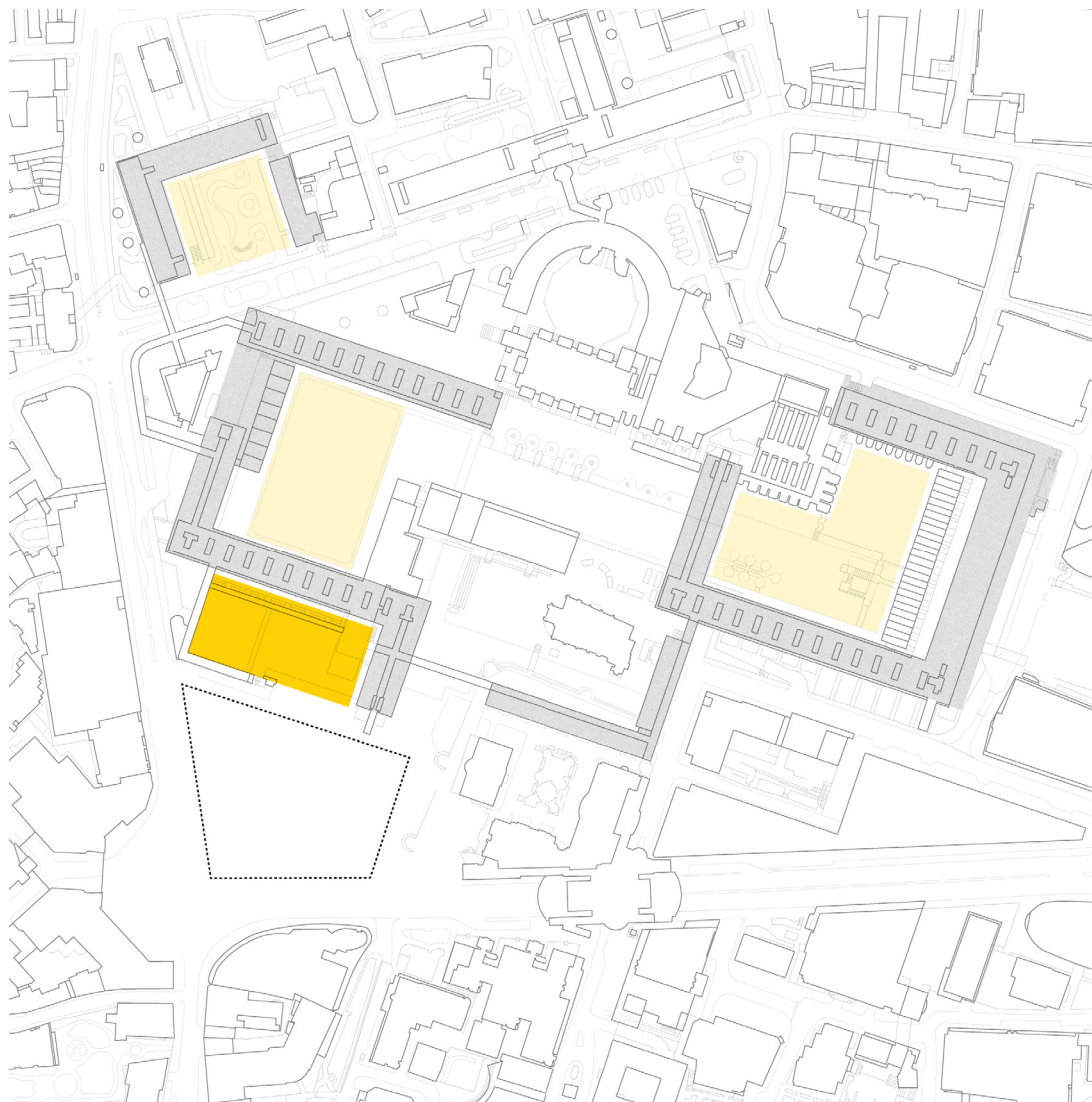

Barbican gardens and sports field

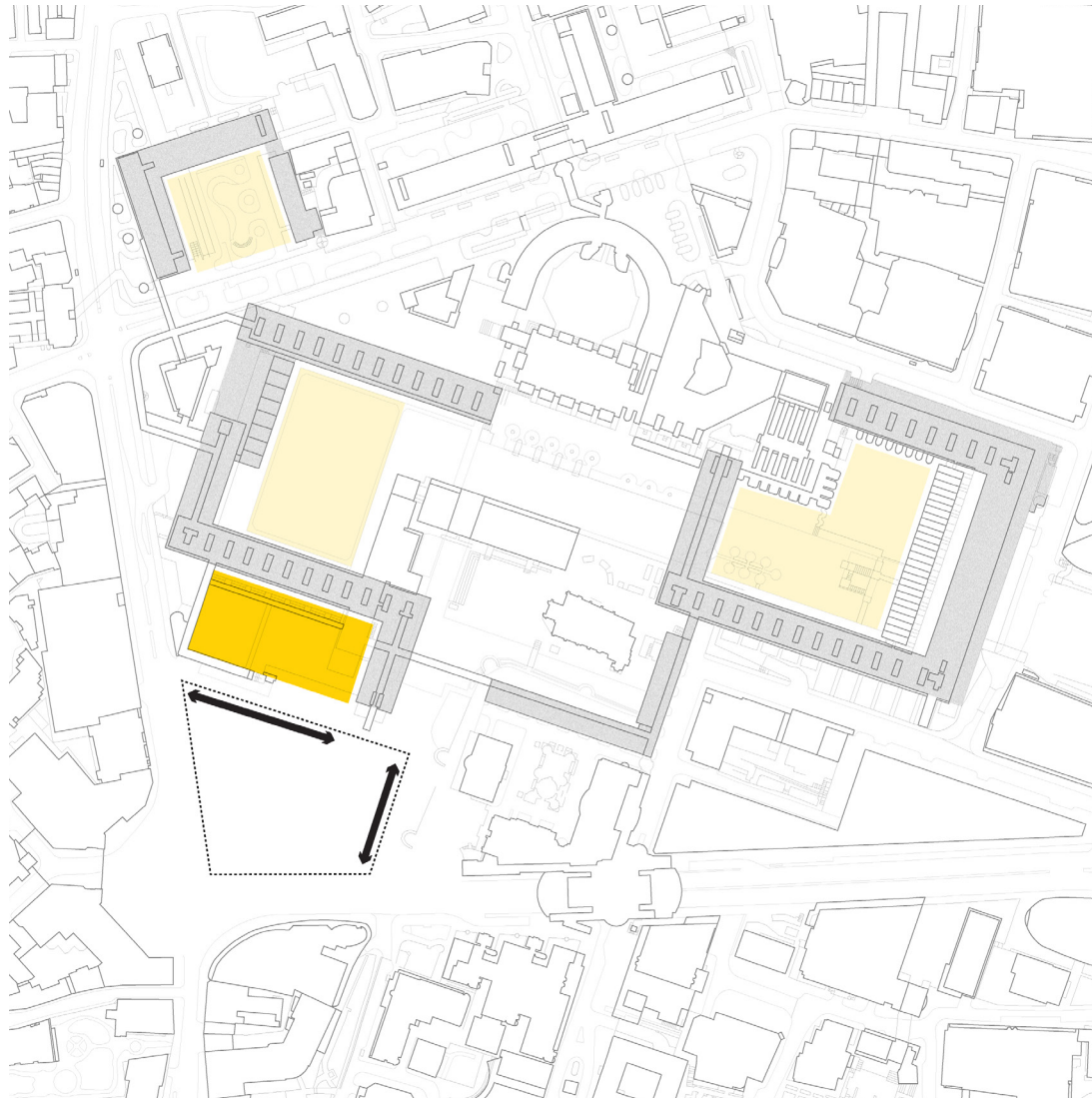

Define boundaries for the sports field and the Roman Wall garden

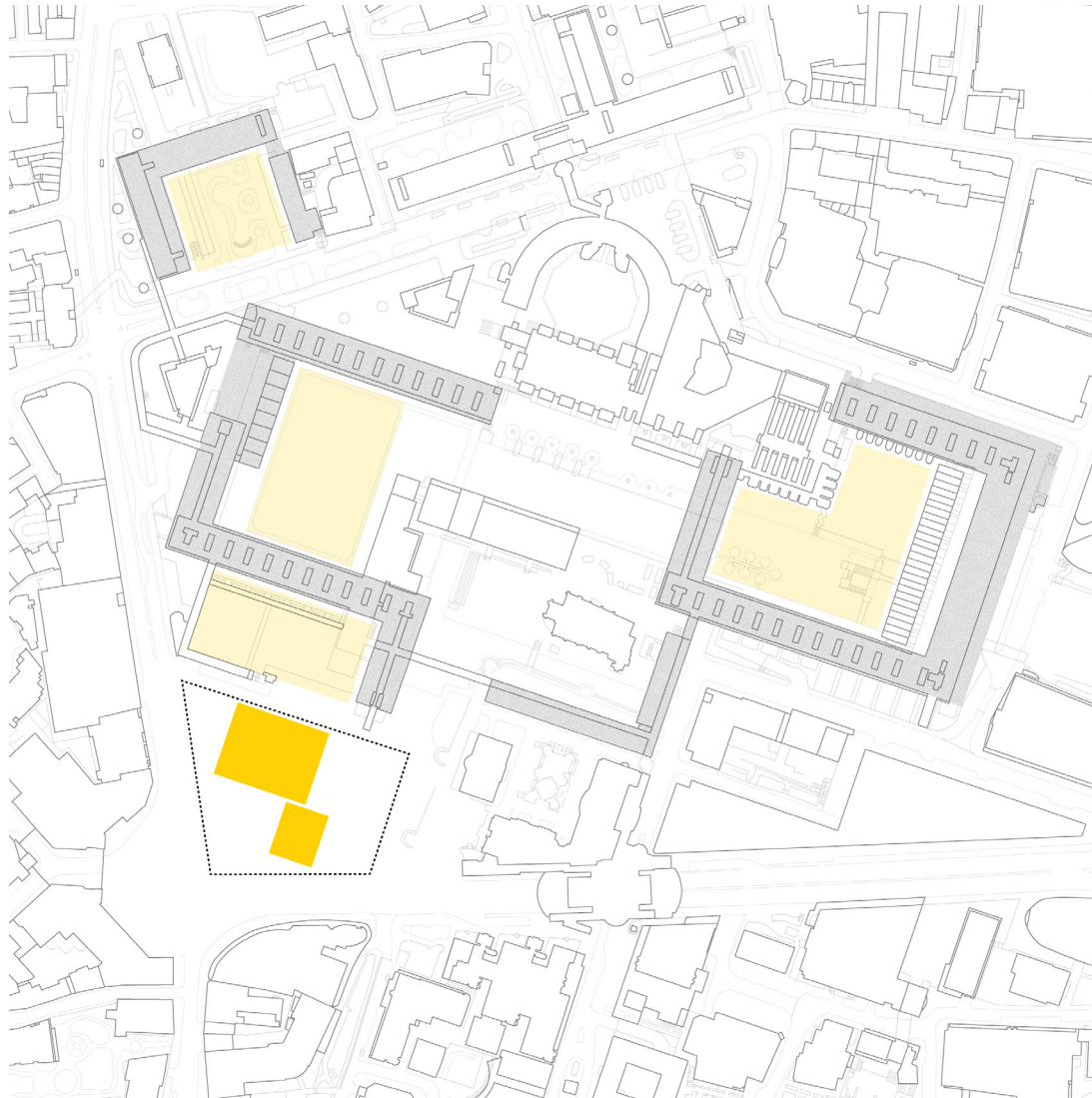

Concert hall as courtyard

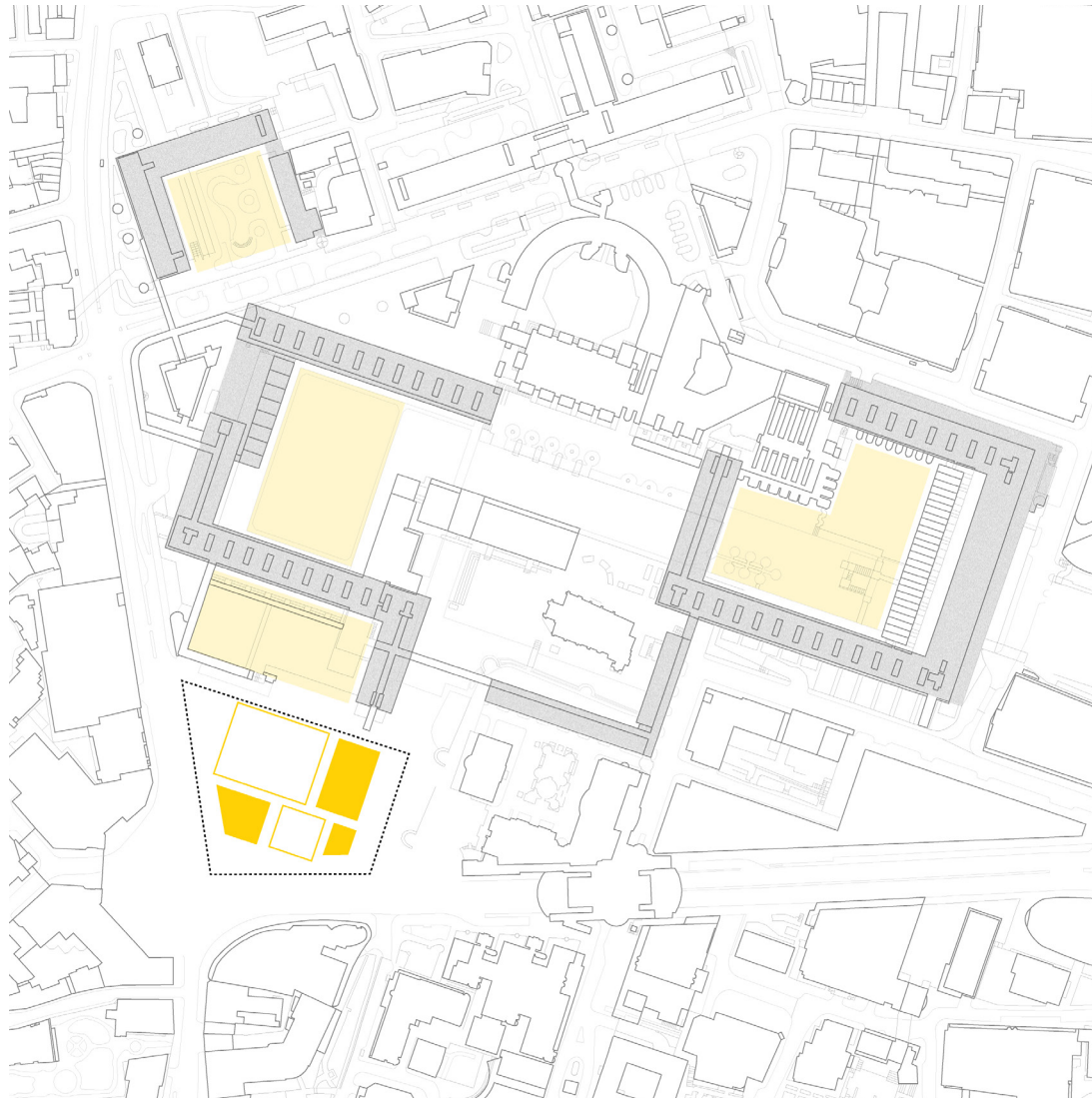

Five courtyards



New courtyards added to the existing urban courtyards network



Street view to the site from Aldersgate Street



Street view to the site from London Wall

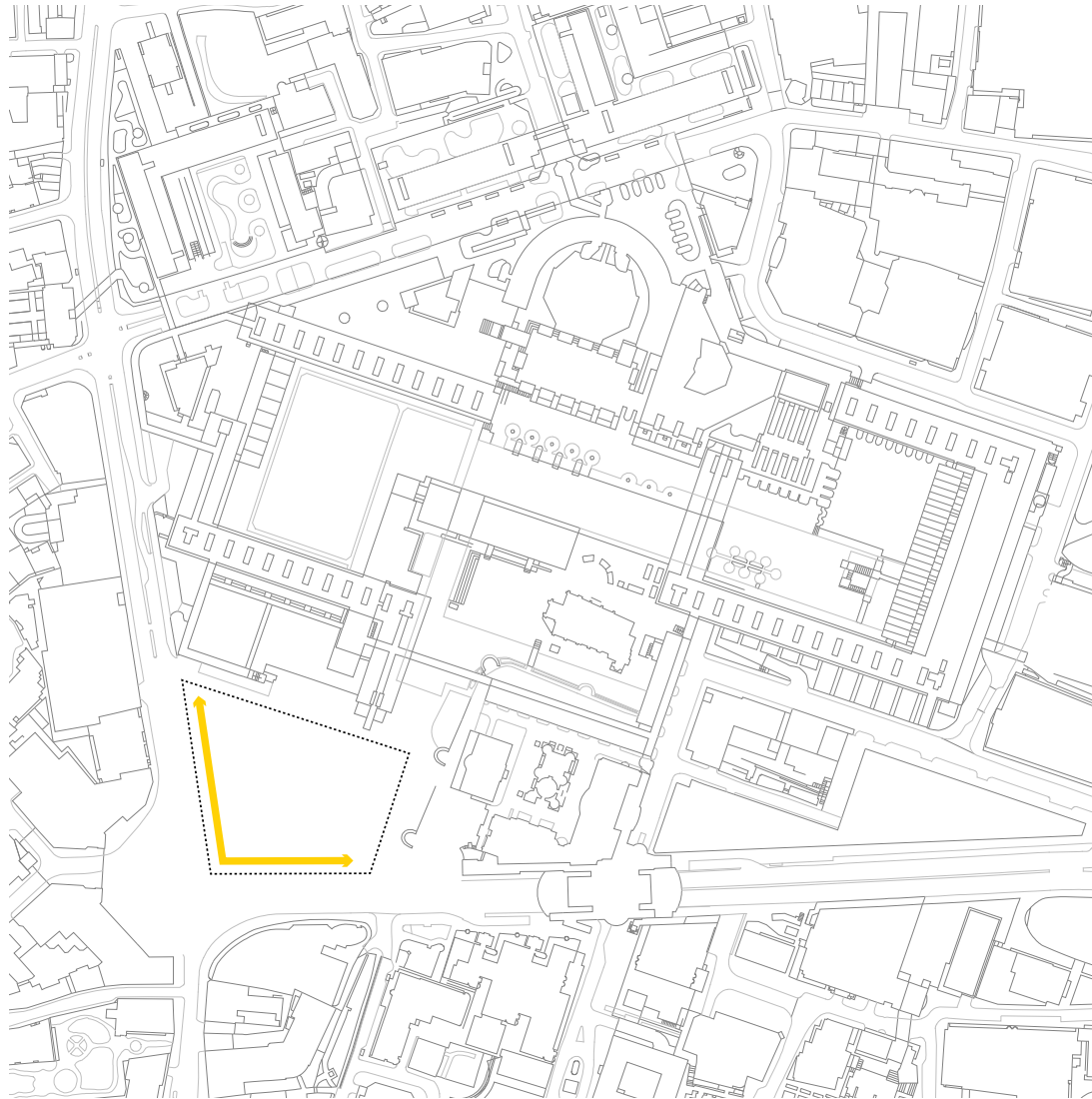

Define new boundary of the street corner based on the main streets to create a new streetscape

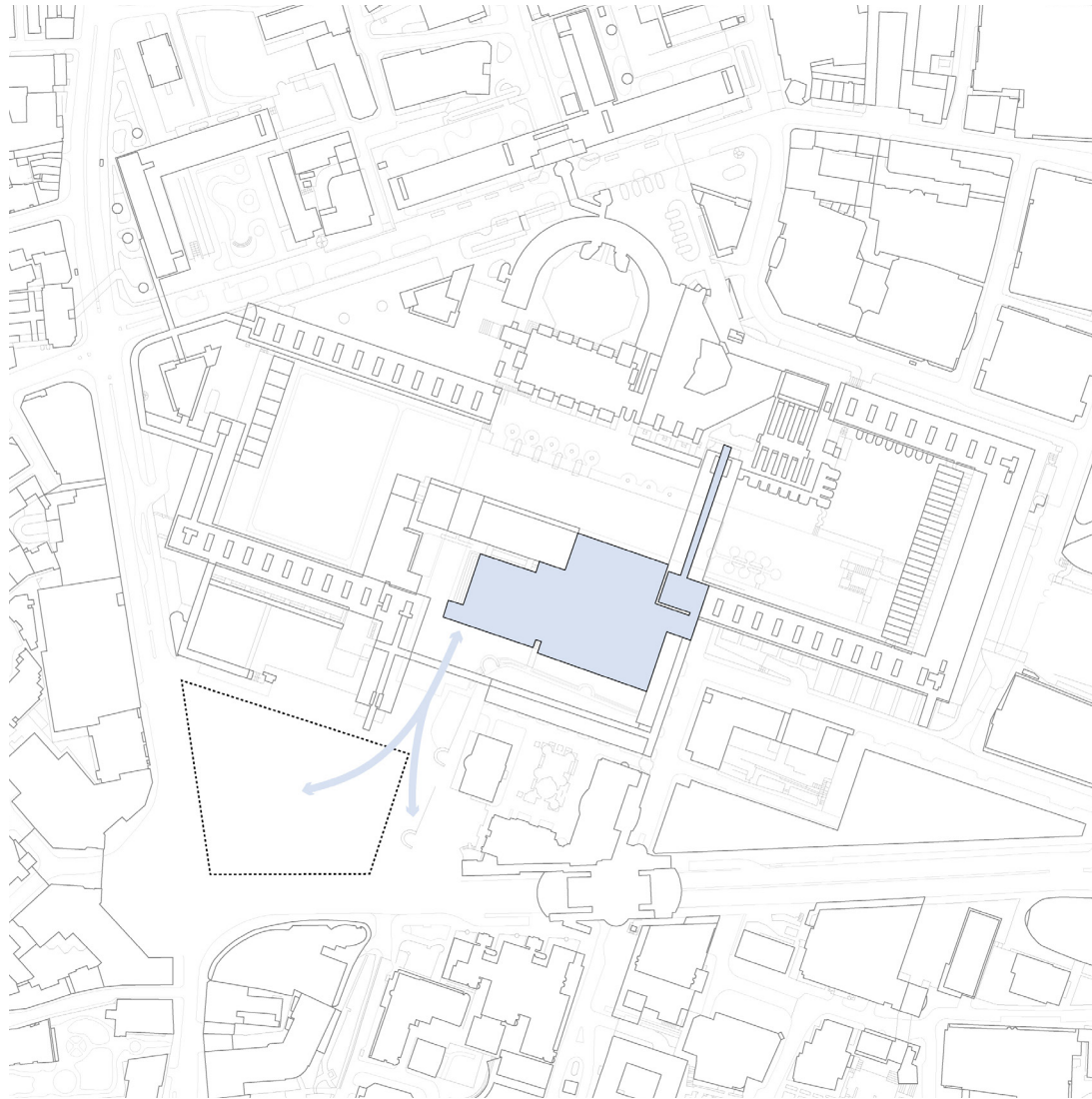

A bridge to connect the site to the Barbican Art Center through ground level

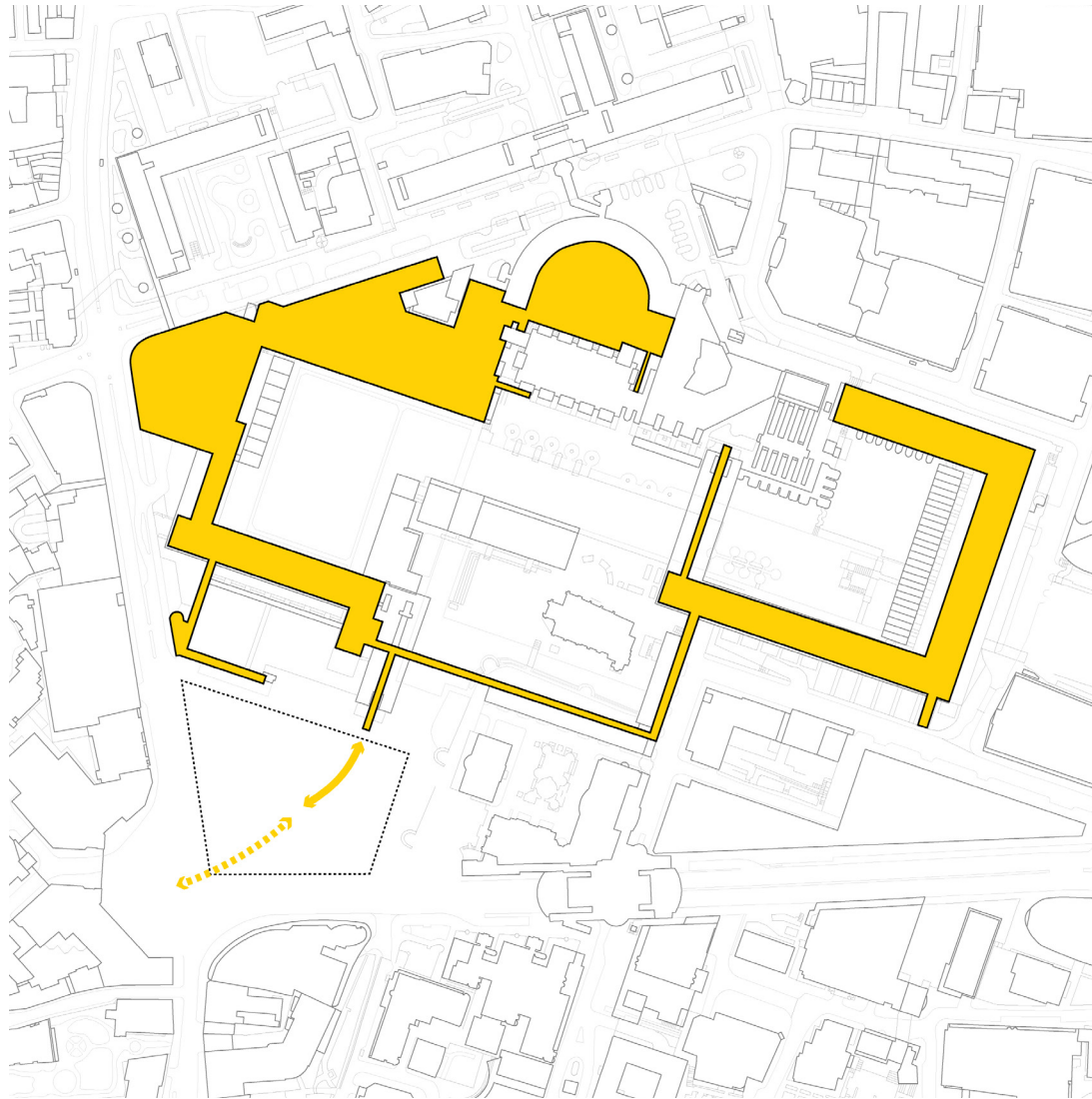

Connect the site to the Barbican highwalk system and open up the system to the city

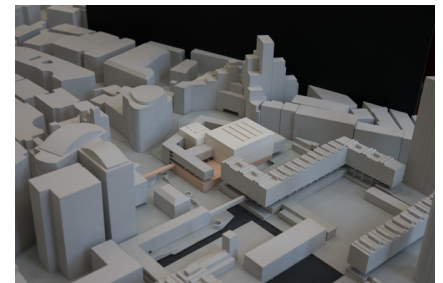
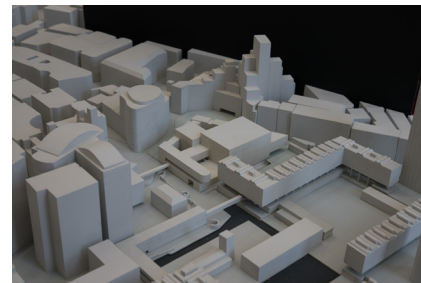
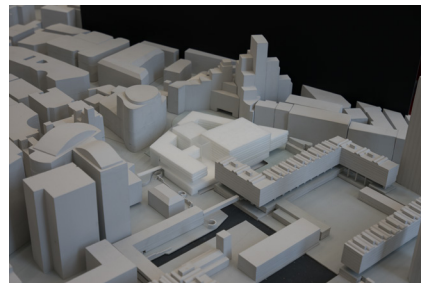
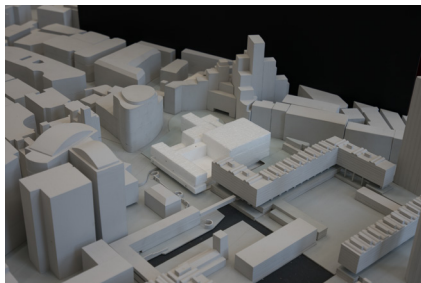
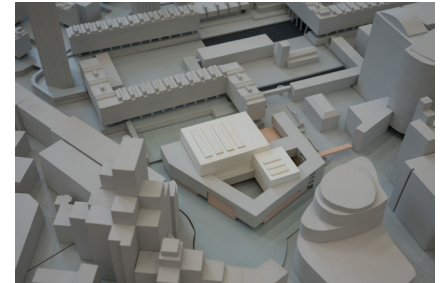
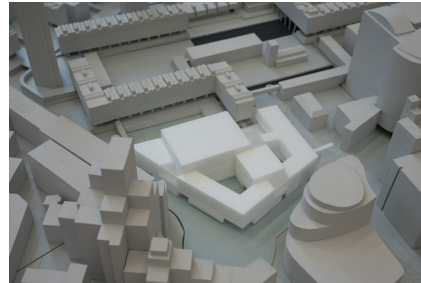
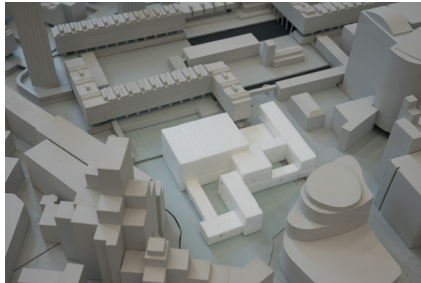

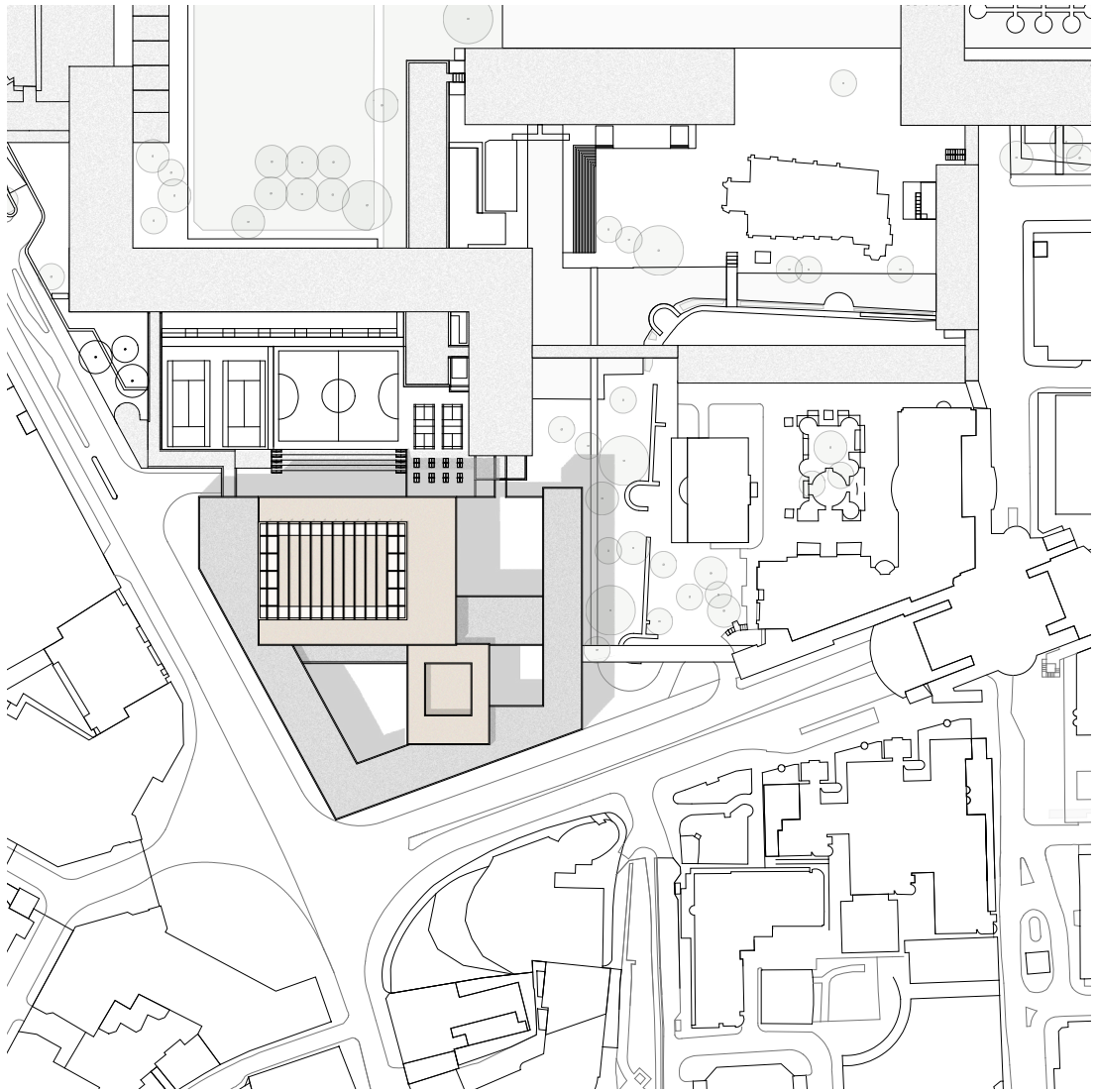

Urban masterplan

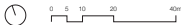

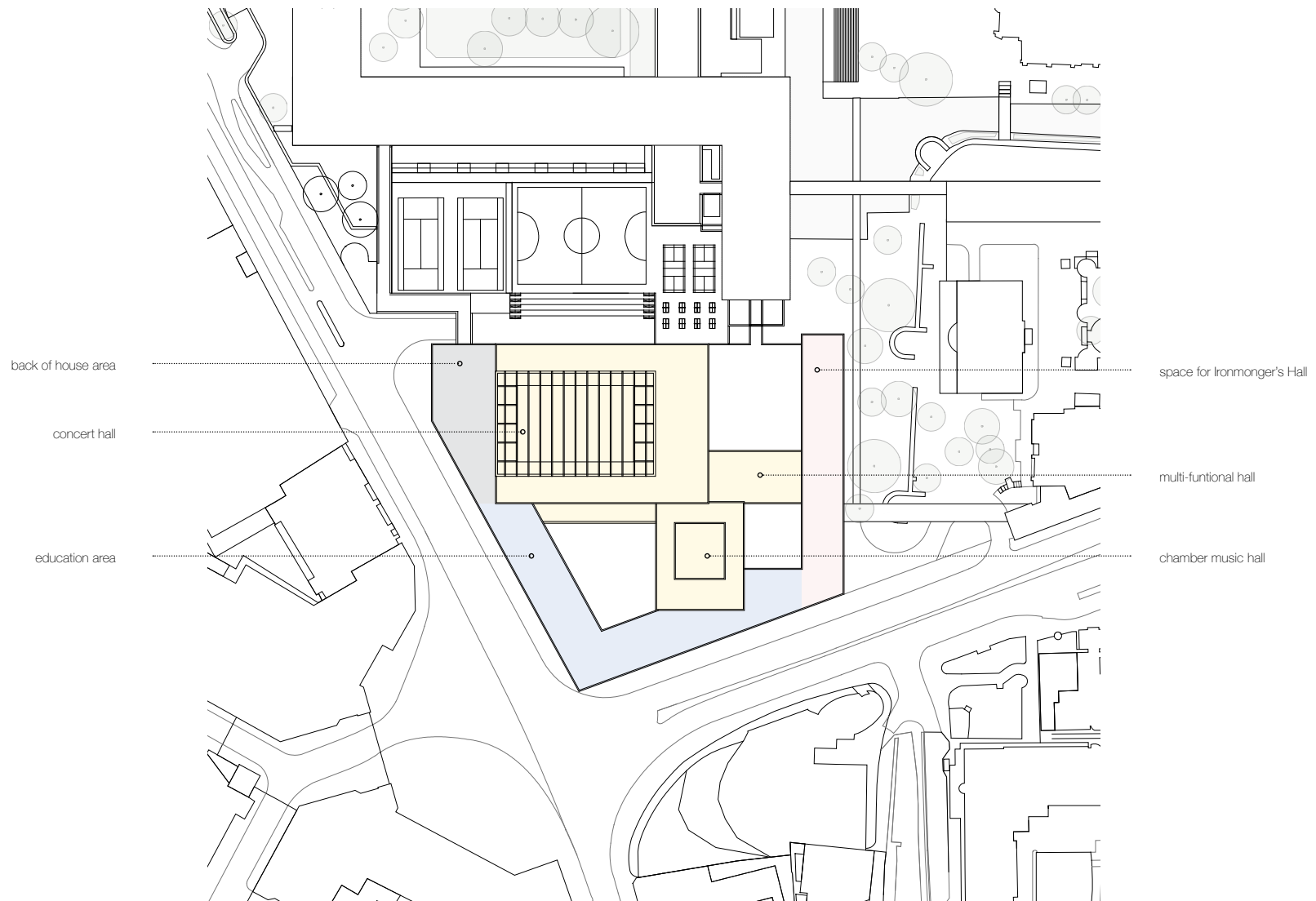

Function organization



Real ground and figured ground

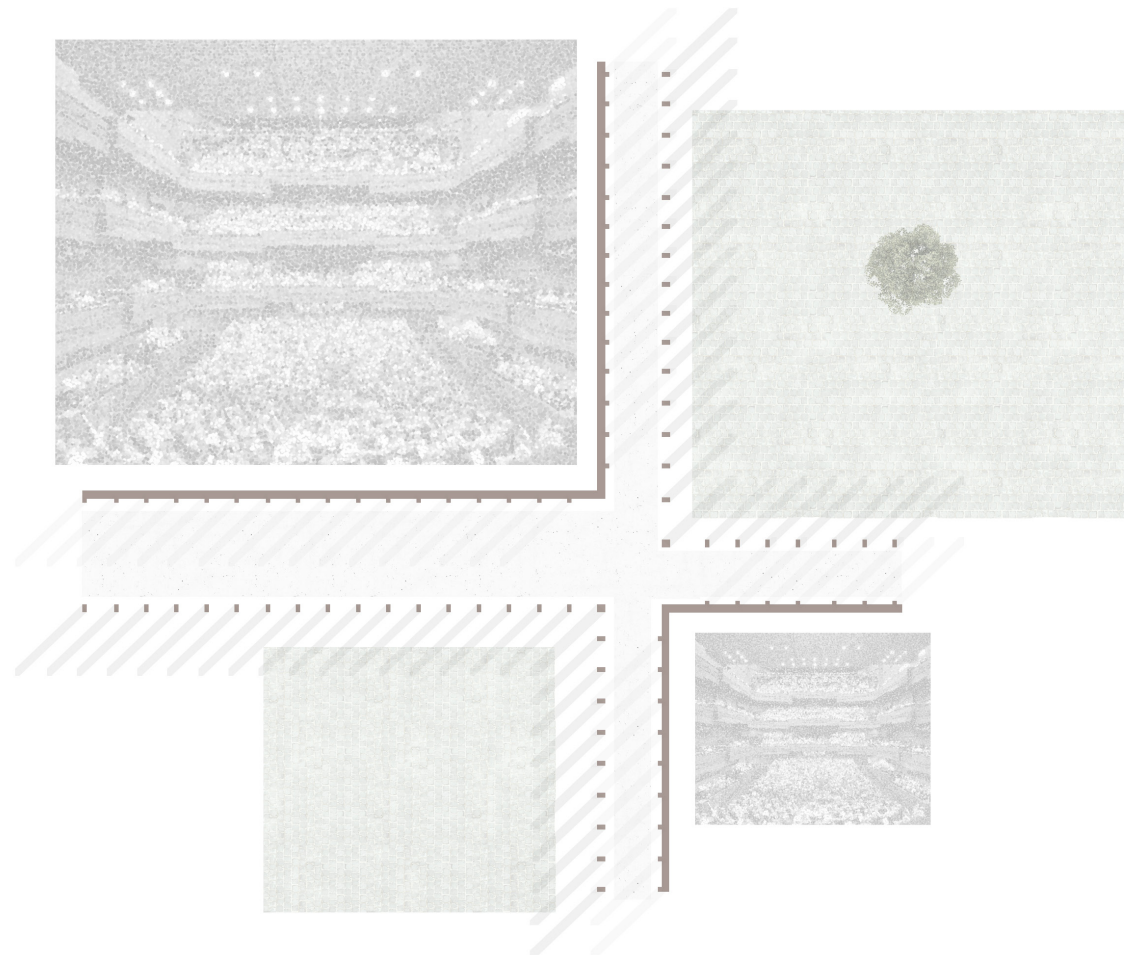

Spatial relationship among music halls, exterior courtyards and foyer spaces



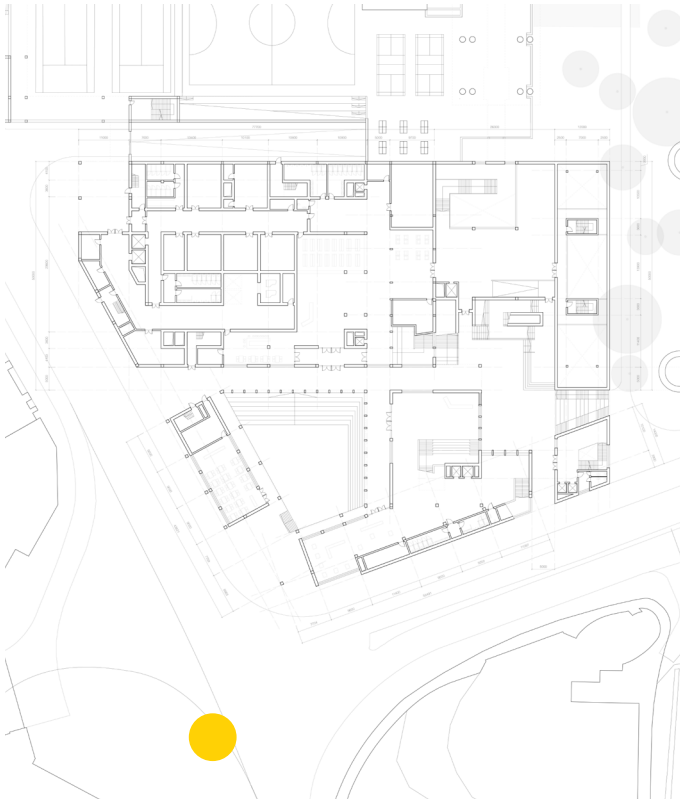

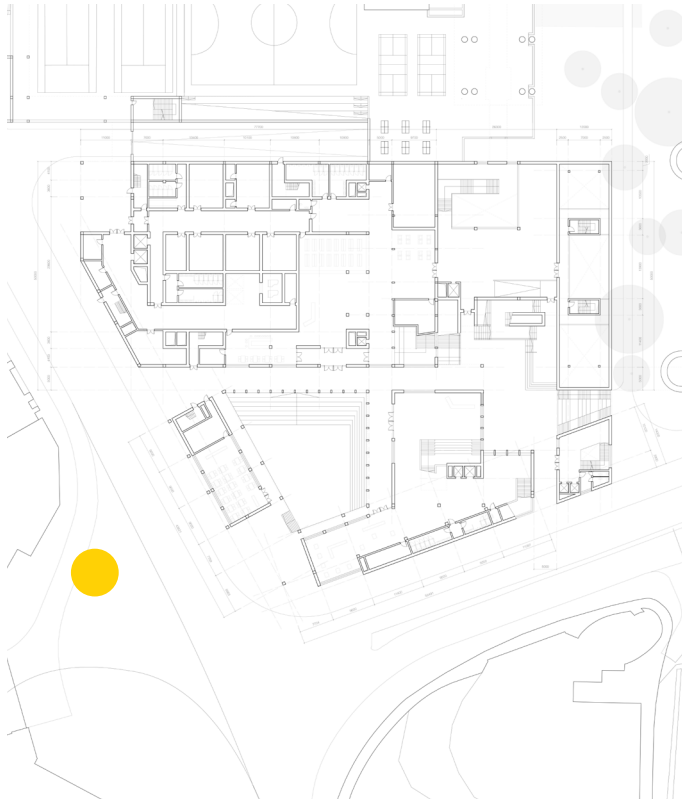

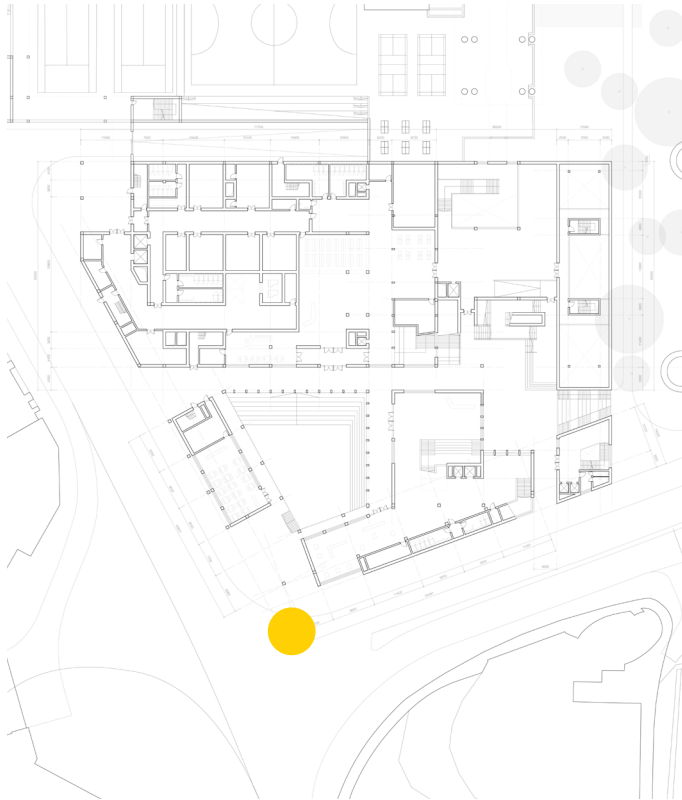

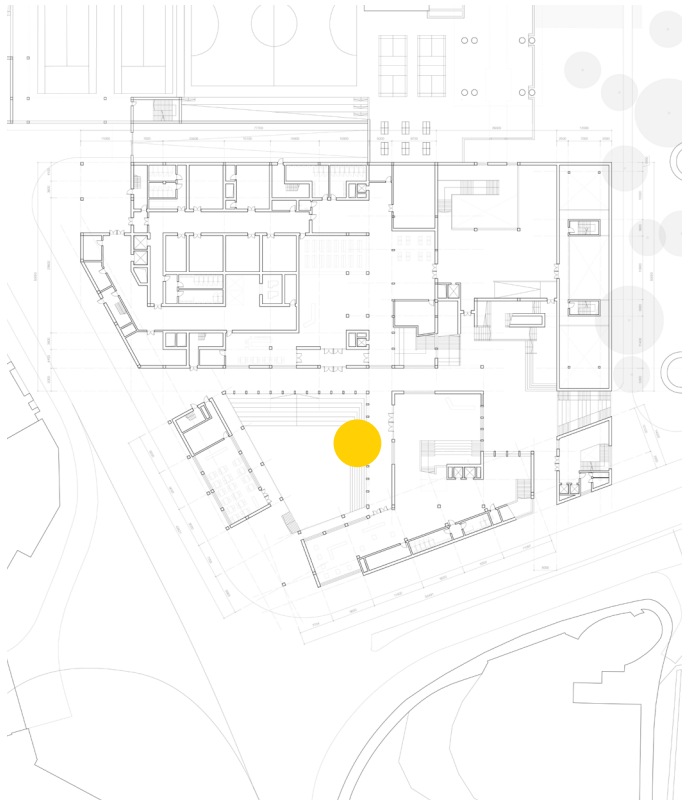

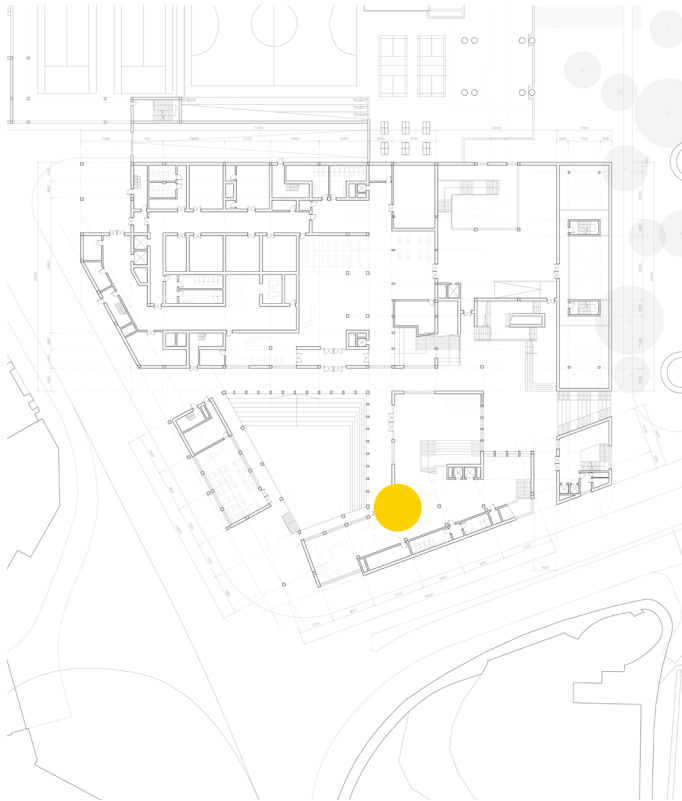

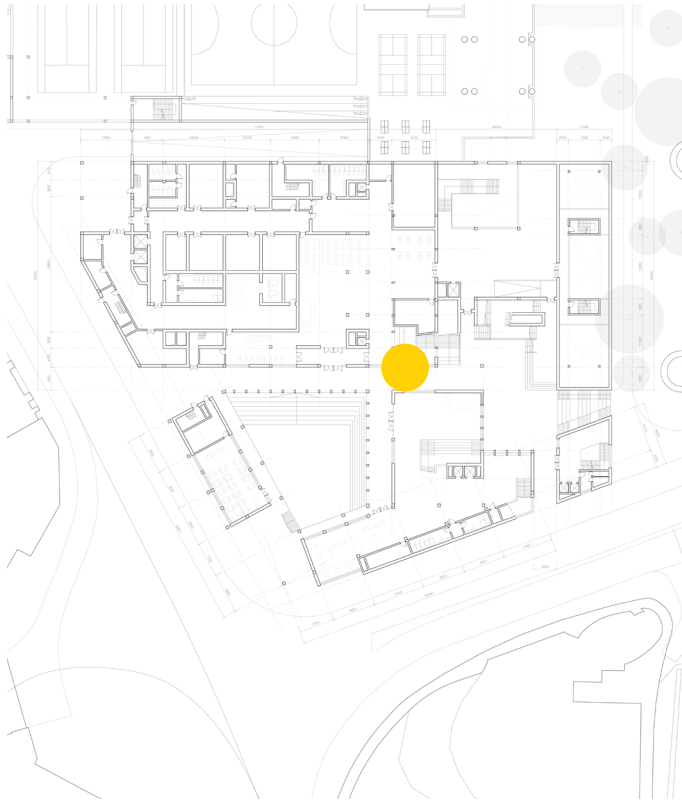

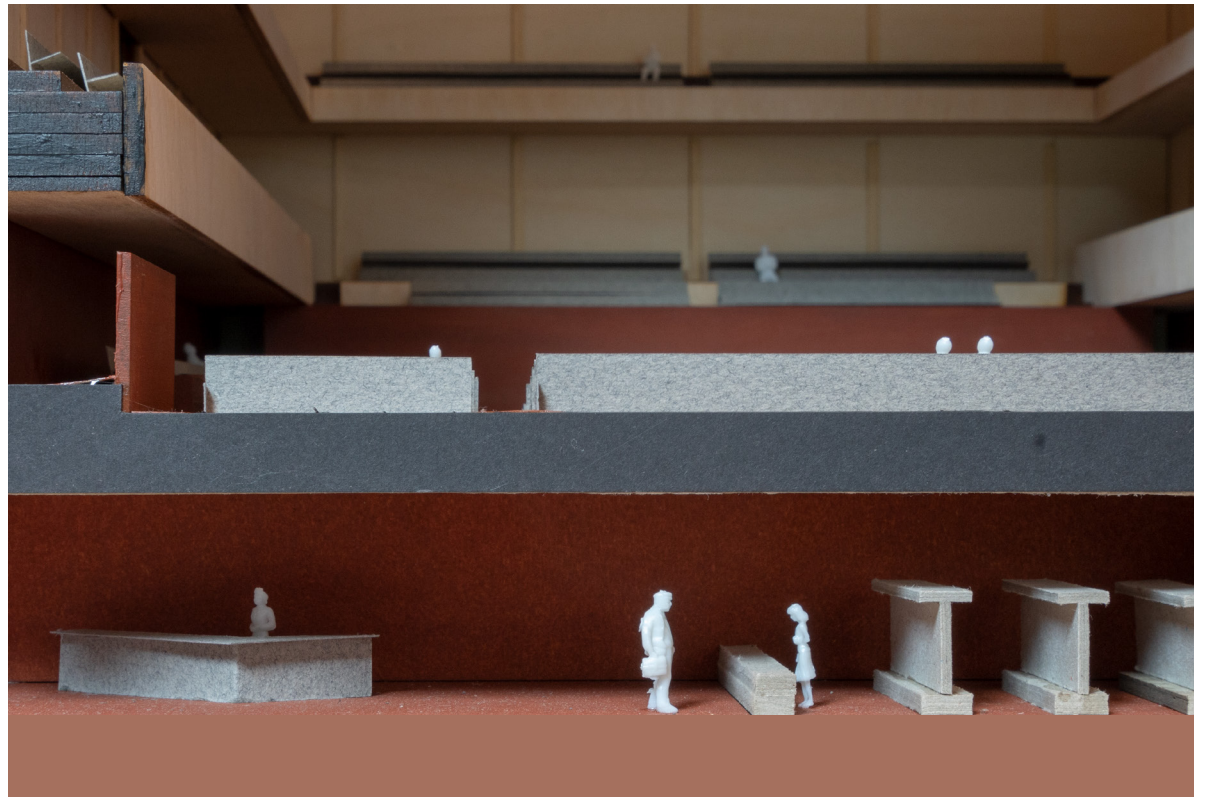
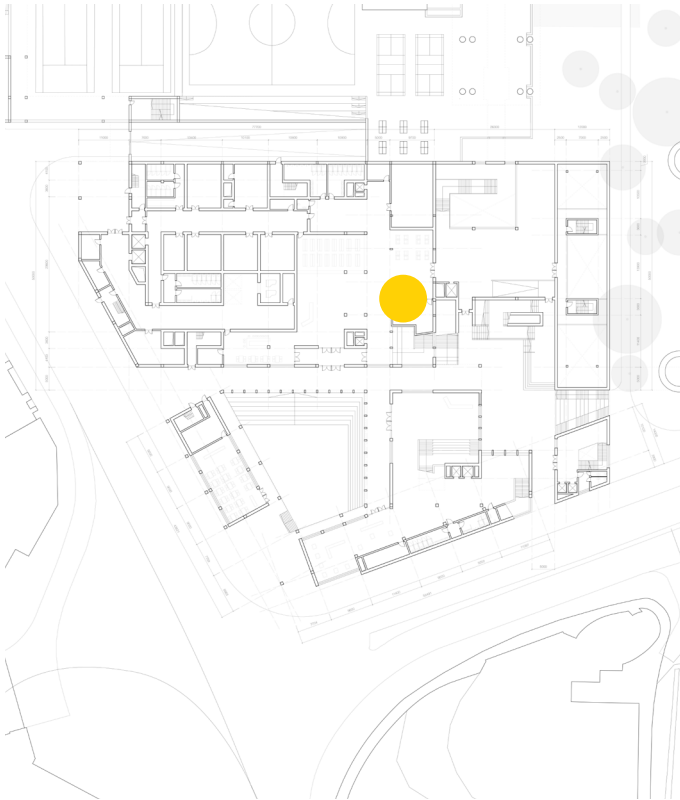



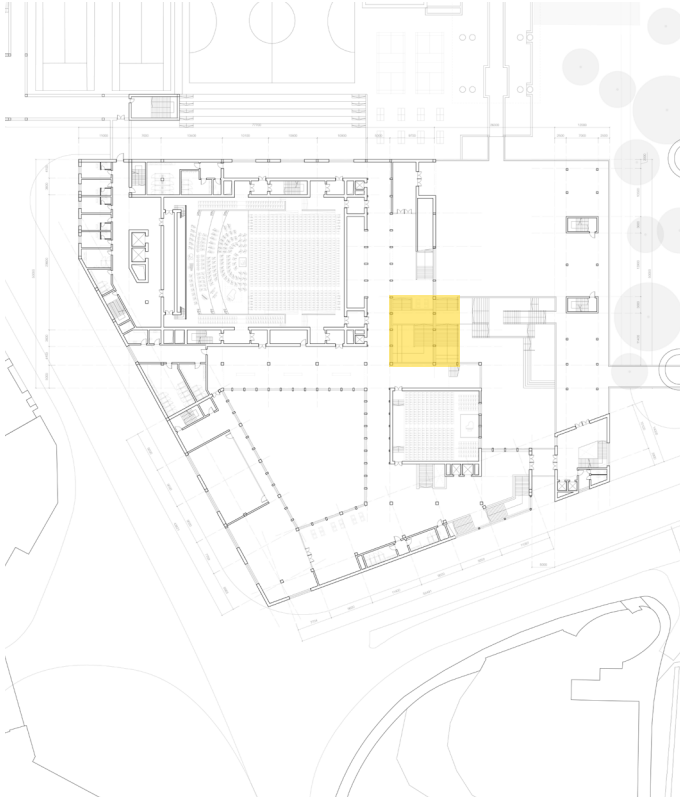

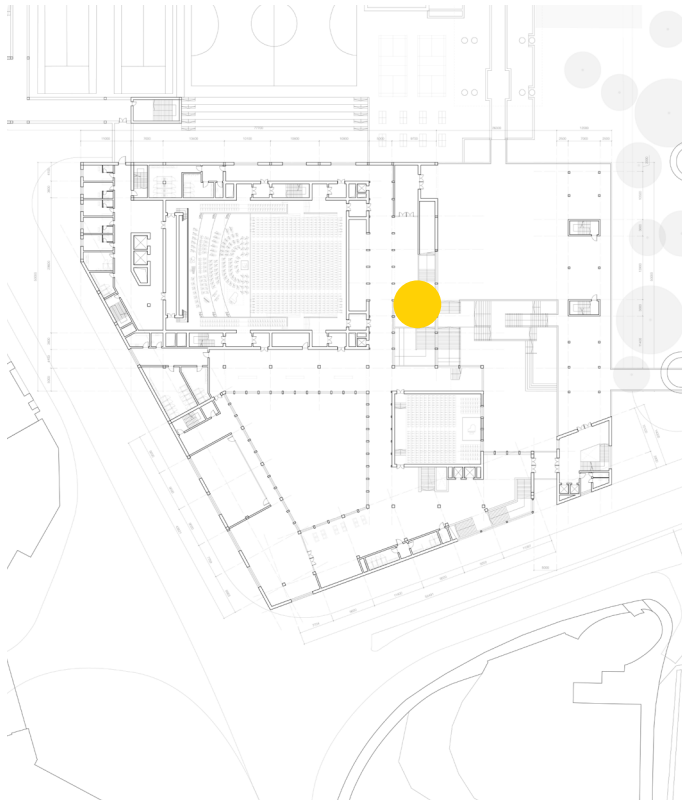

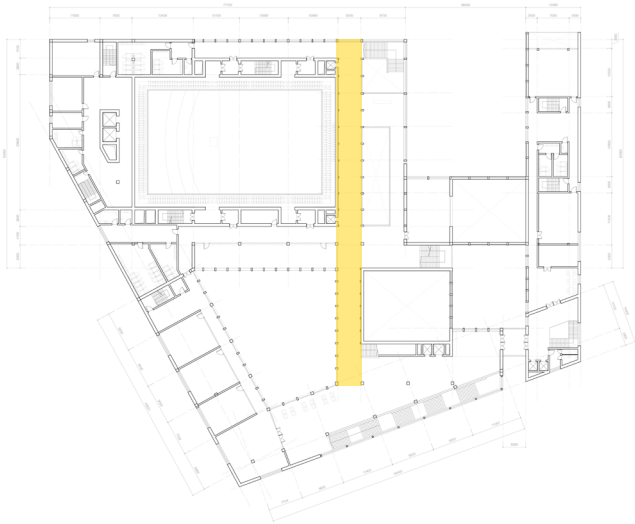

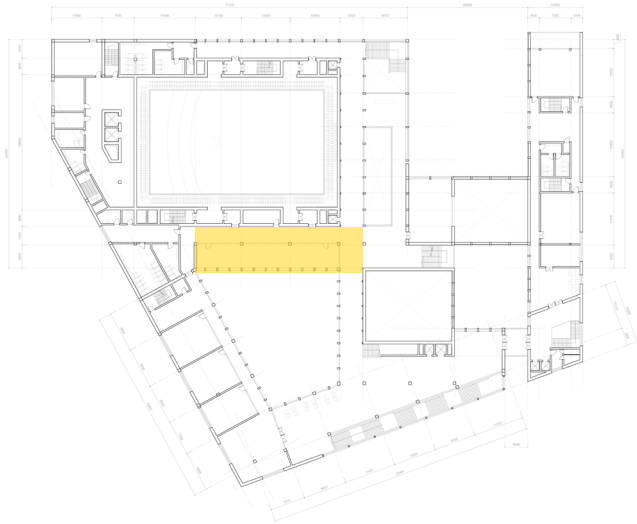

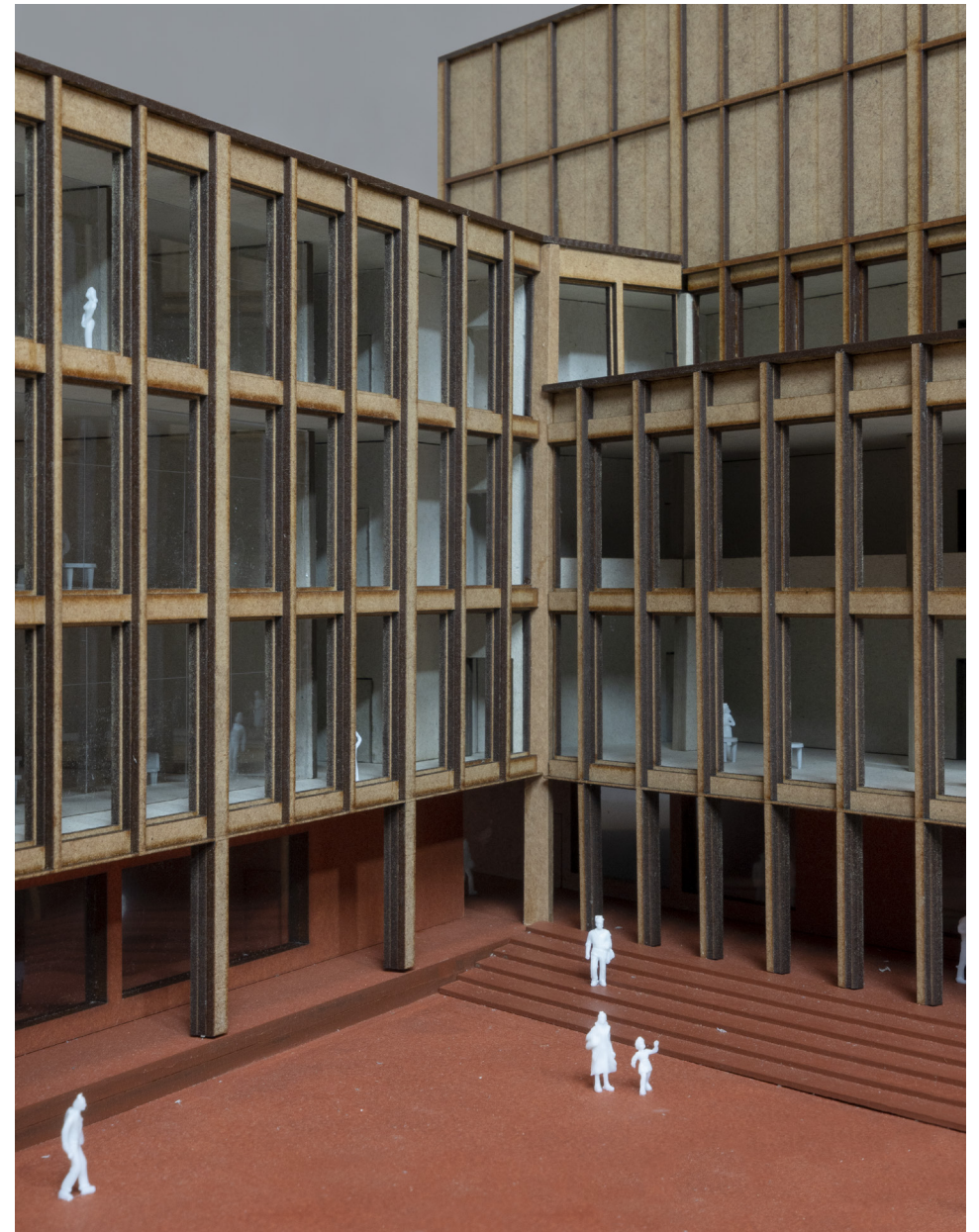
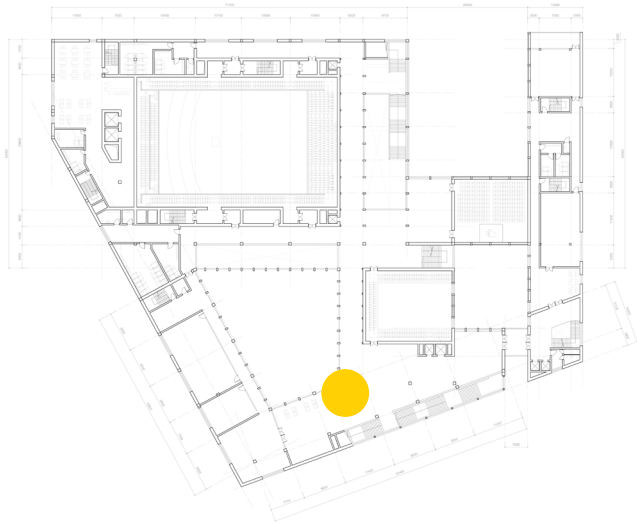

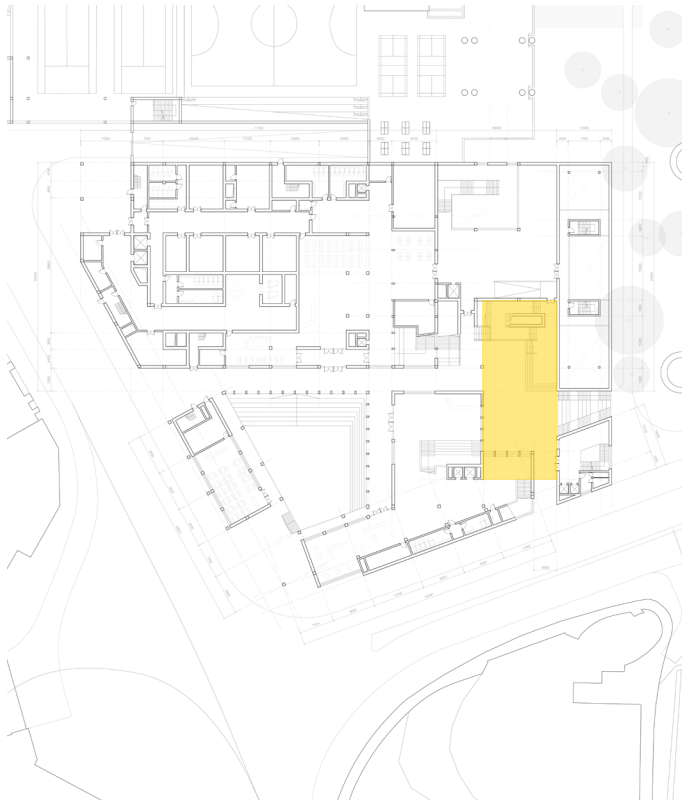

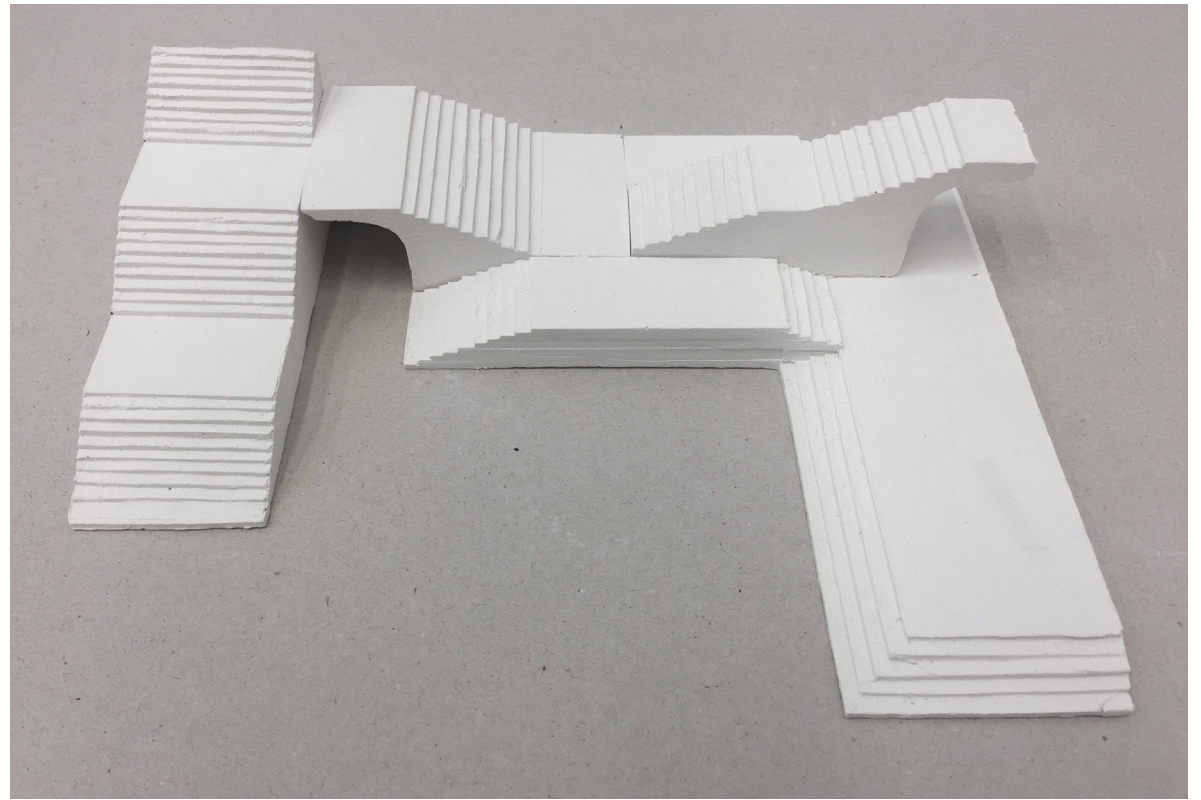
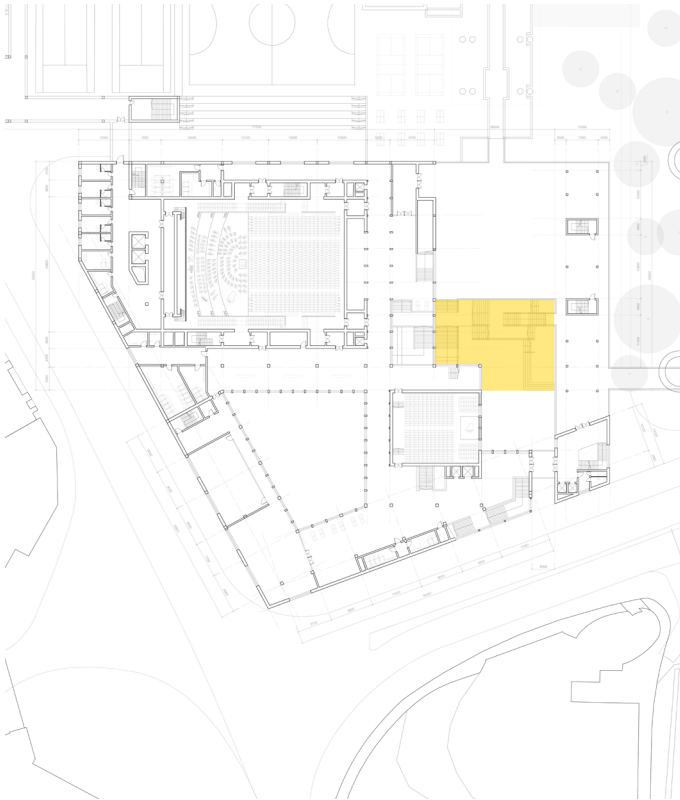

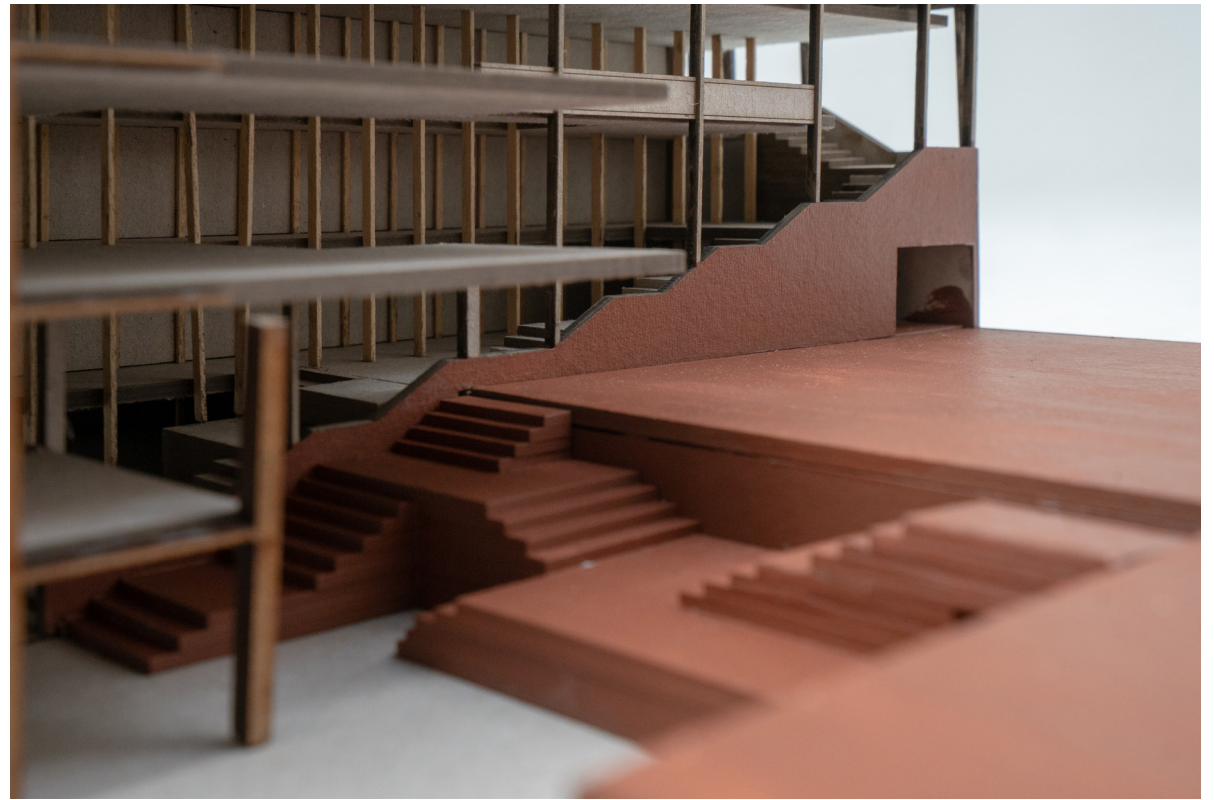
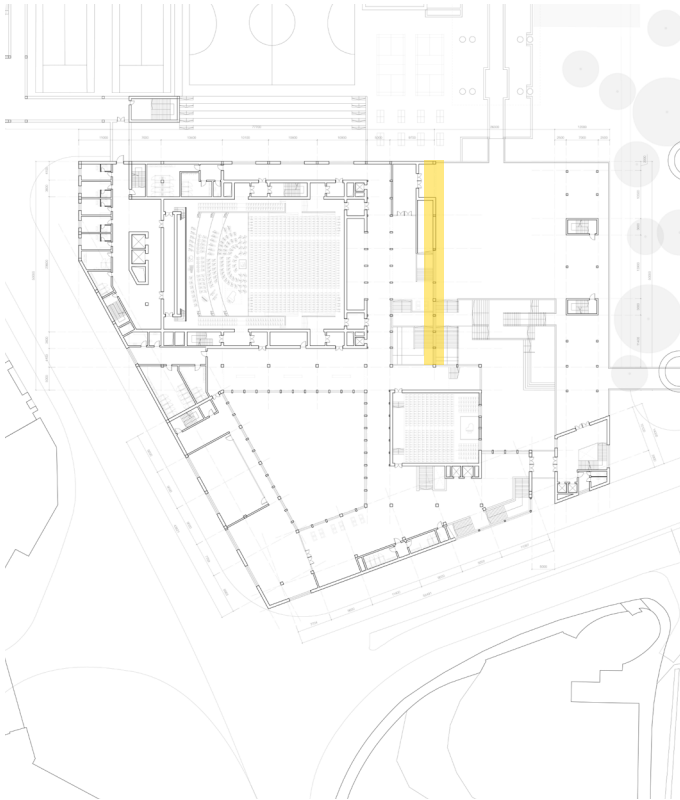

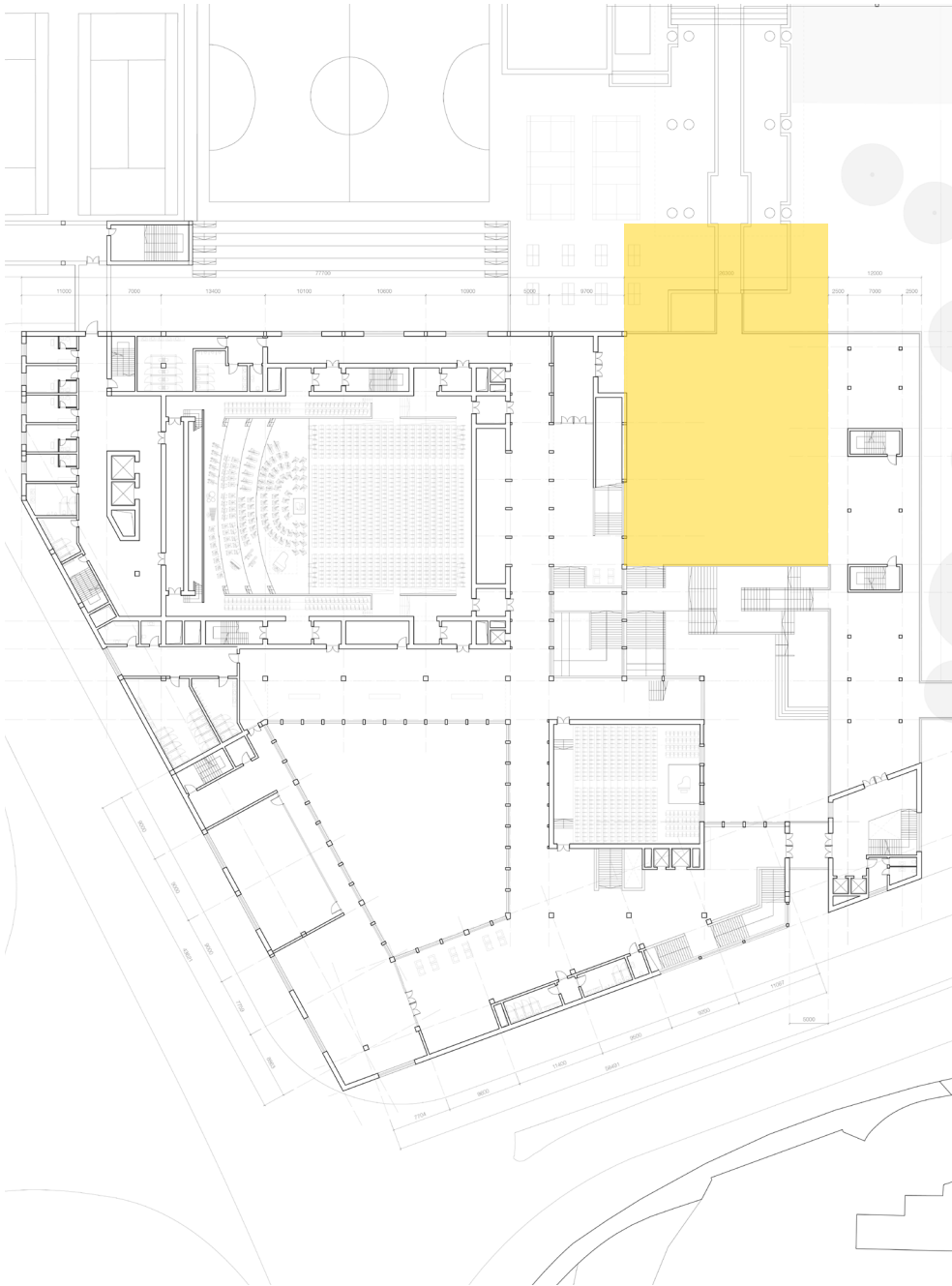



The roof in relationship with the Barbican block

Materialization



Material in Barbican
Red Brick



Material in Barbican
pitted concrete



Prefabricated concrete panel
with smooth surface

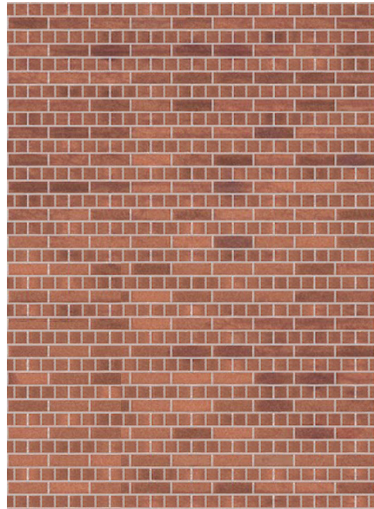

Standard red brick
215x112.5x65mm



Wood panel
with varnish treatment



Brick at the base
Concrete on the upper part



Wooden elements in the courtyards

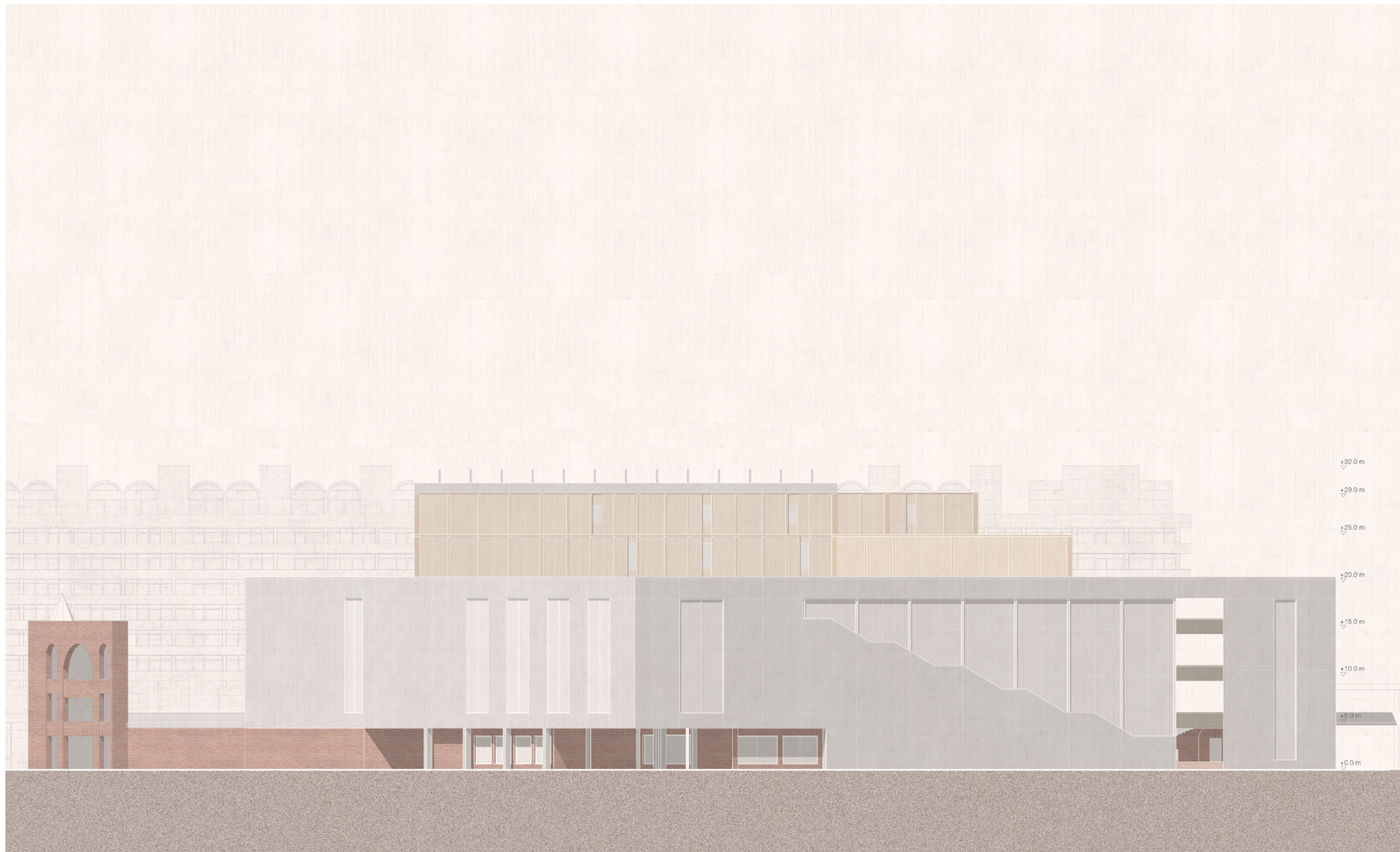

Facade along Roman Wall street

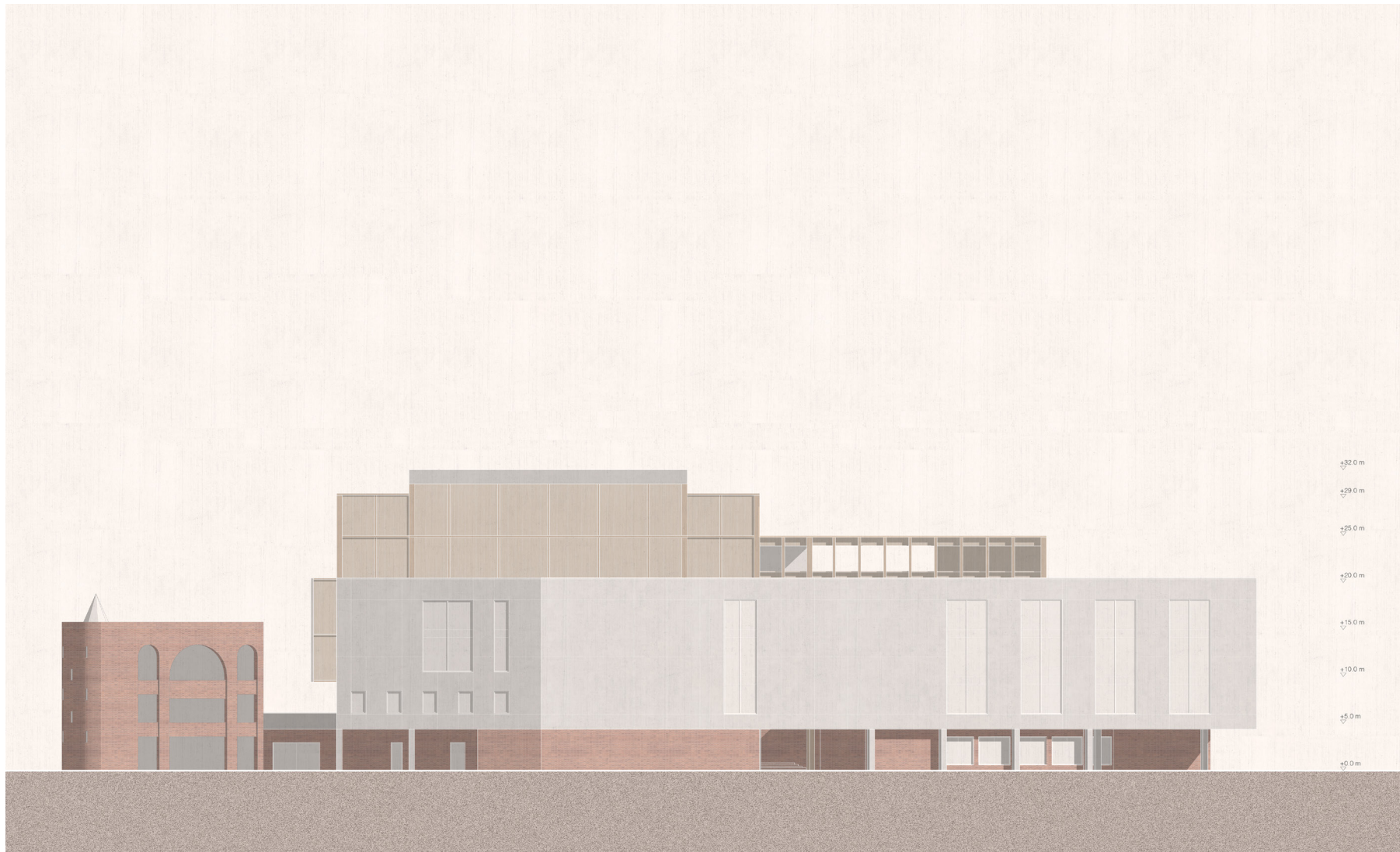

Facade along Aldersgate street

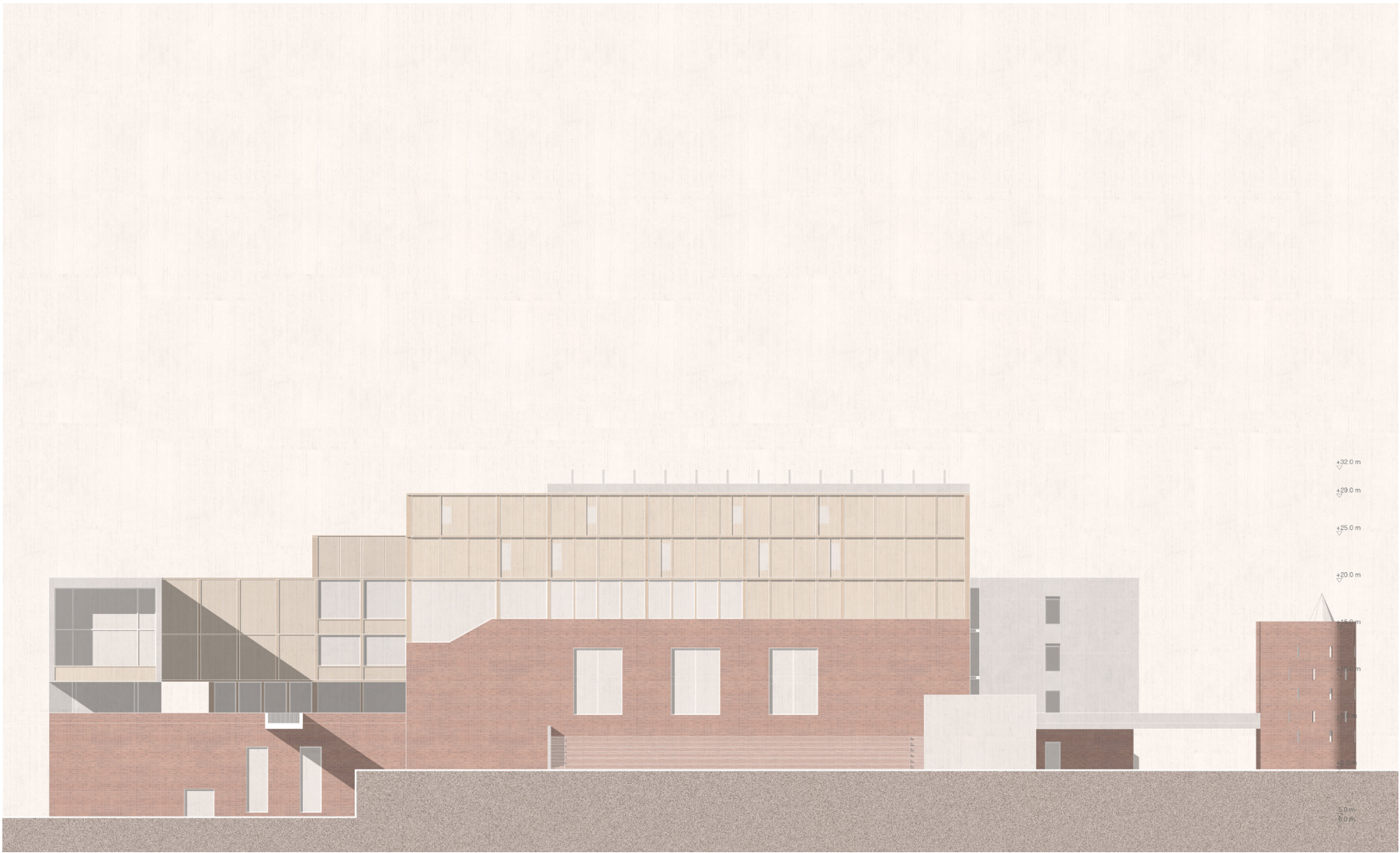

Facade facing Barbican

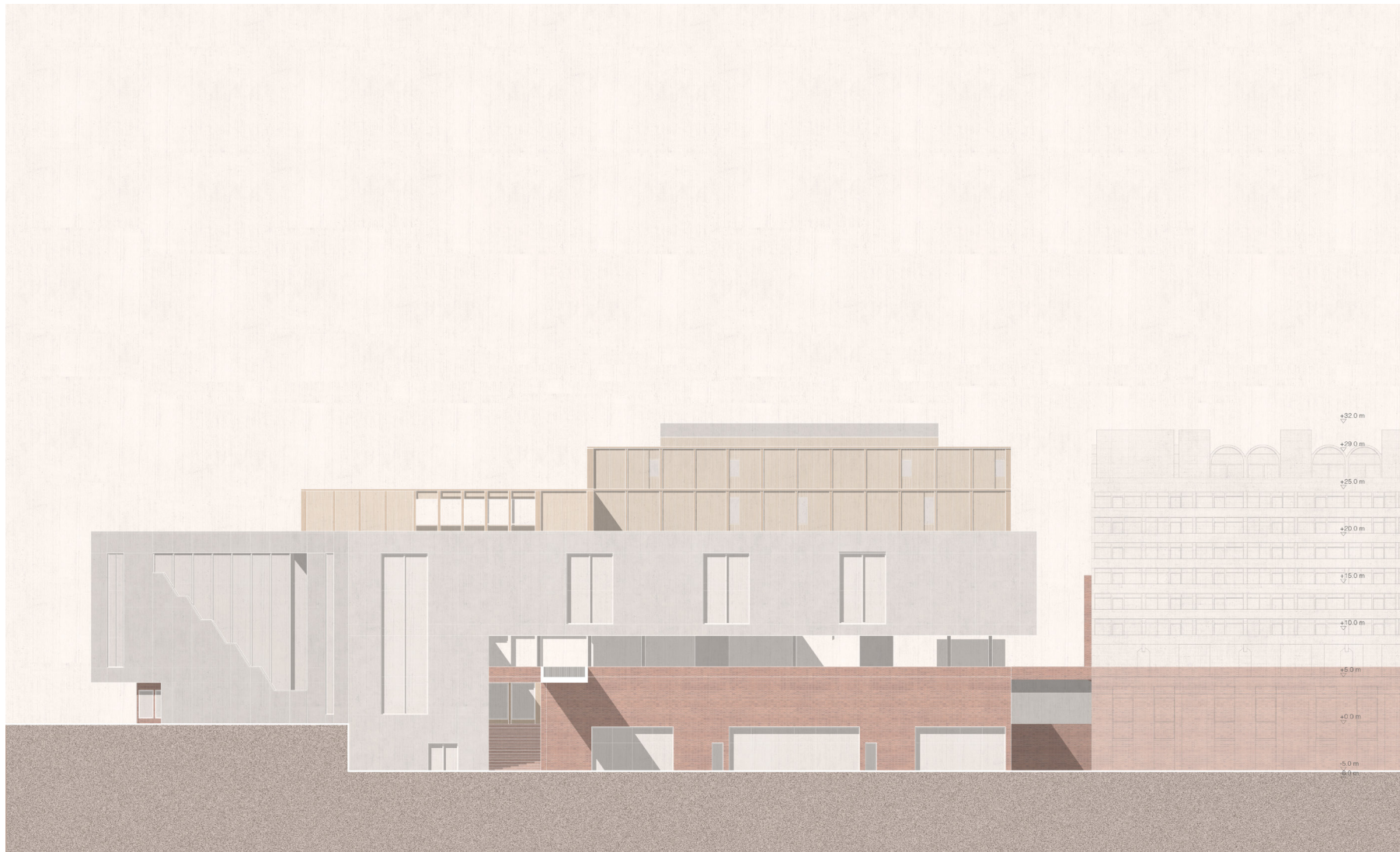

Facade facing Roman Wall garden

The Concert Court



Sectional model of the concert hall

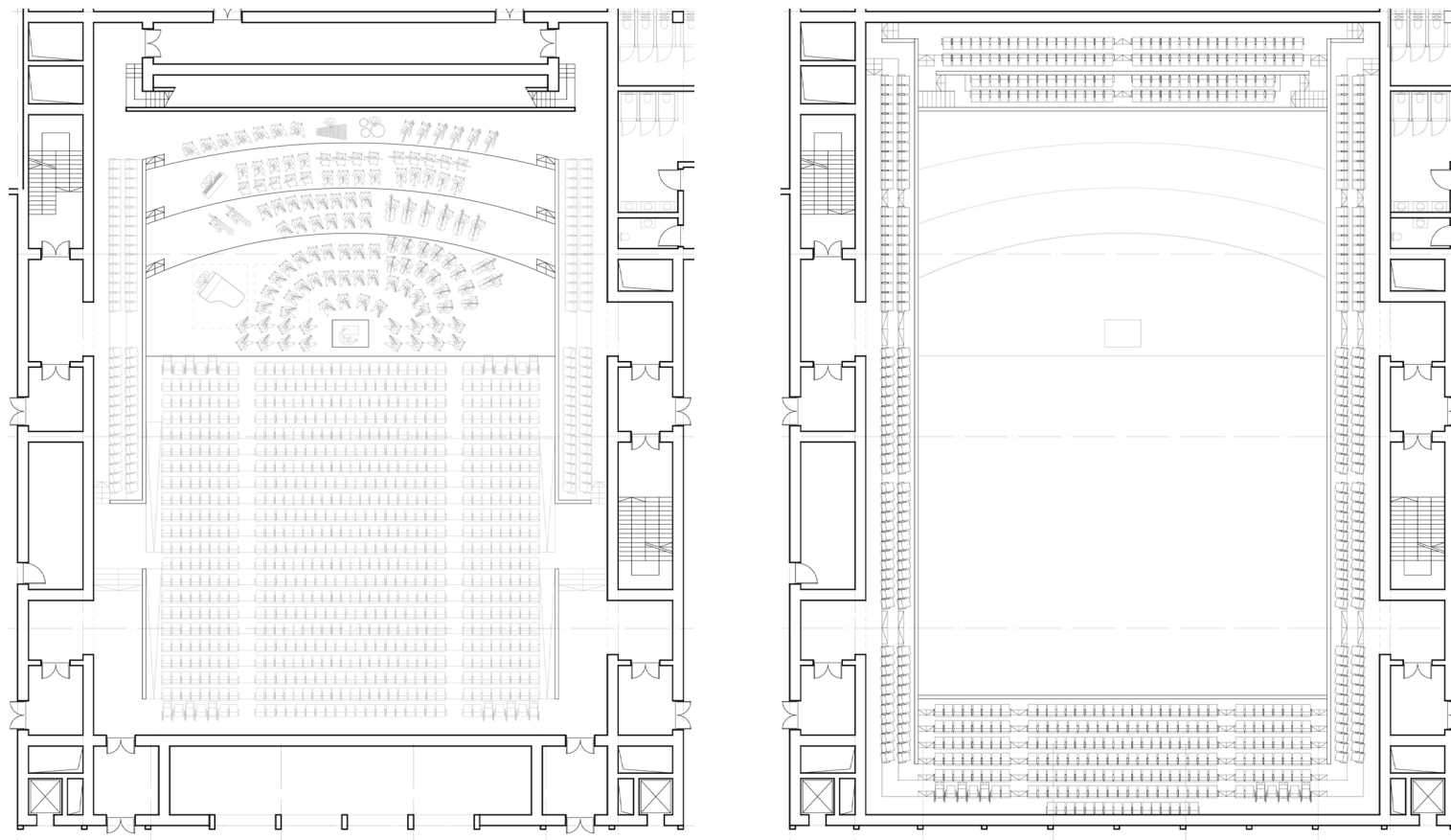

Floor plan of the concert hall
Stall level & 1st balcony level

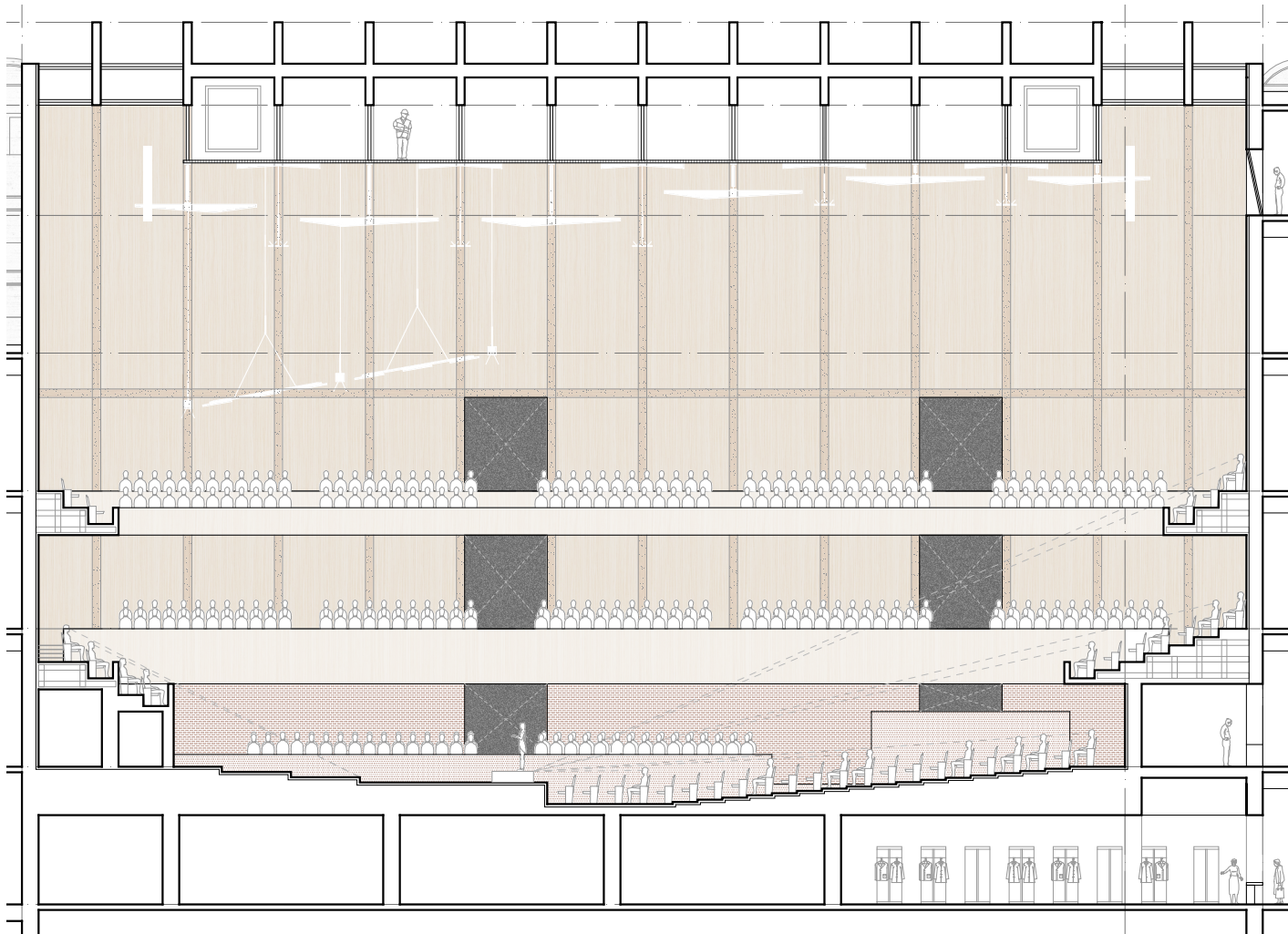

Facade along Aldersgate street



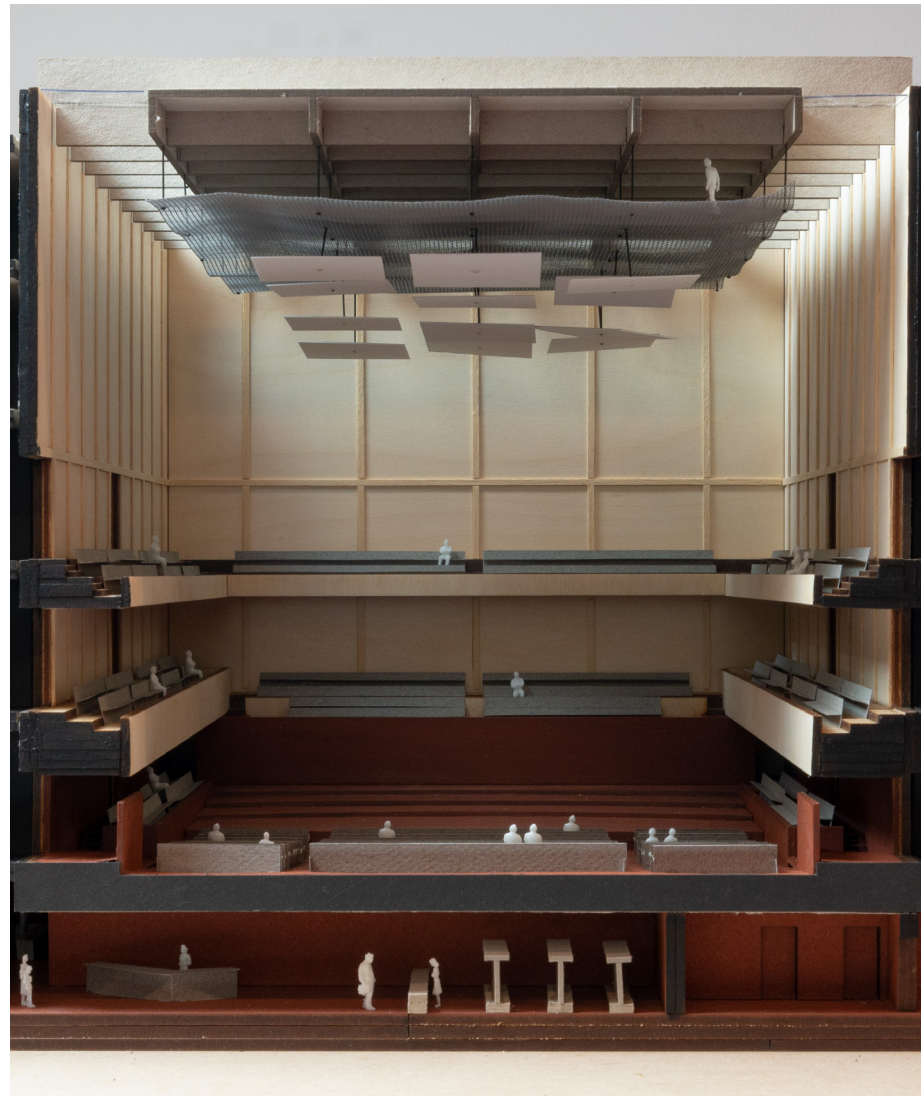

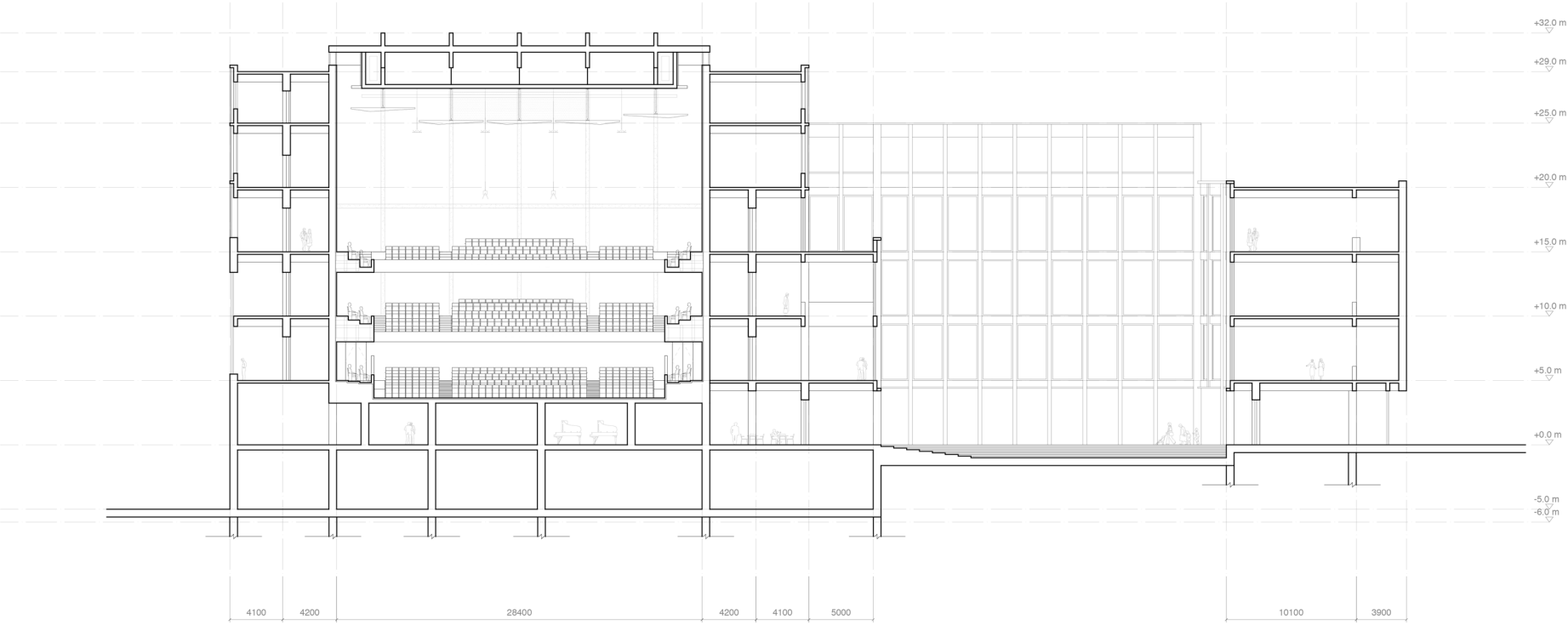

Section through the concert hall in relationship to the entrance courtyard

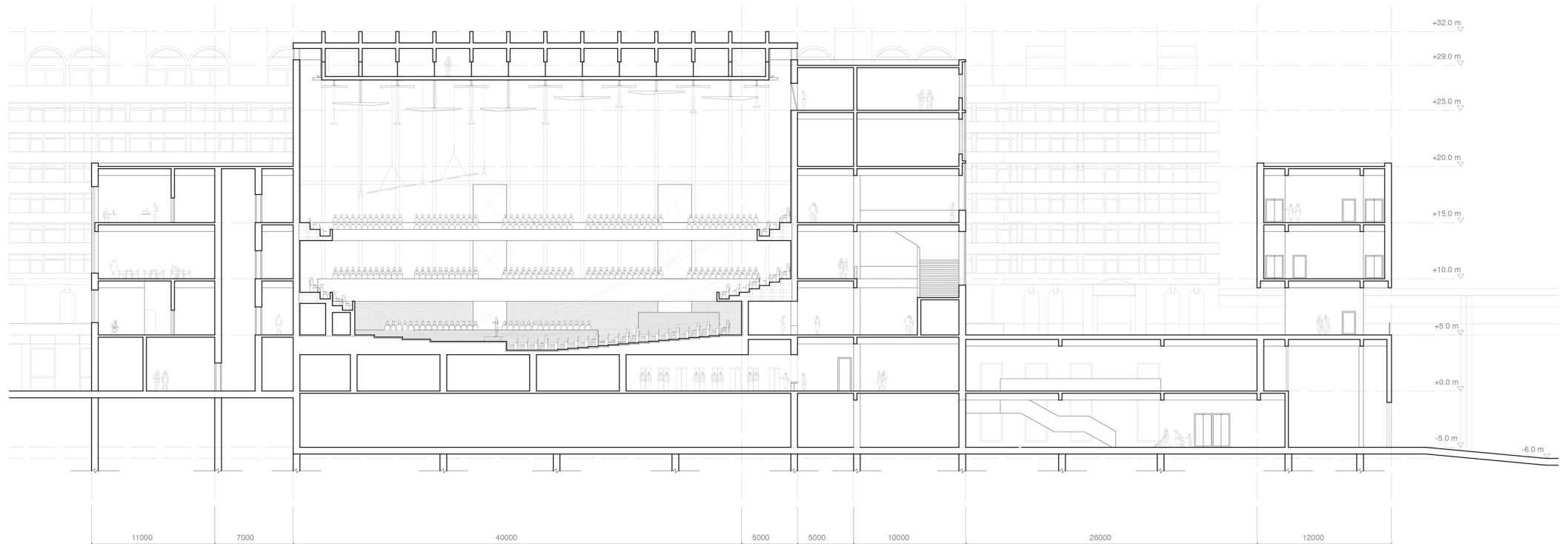

Section through the concert hall in relationship to the highwalk courtyard

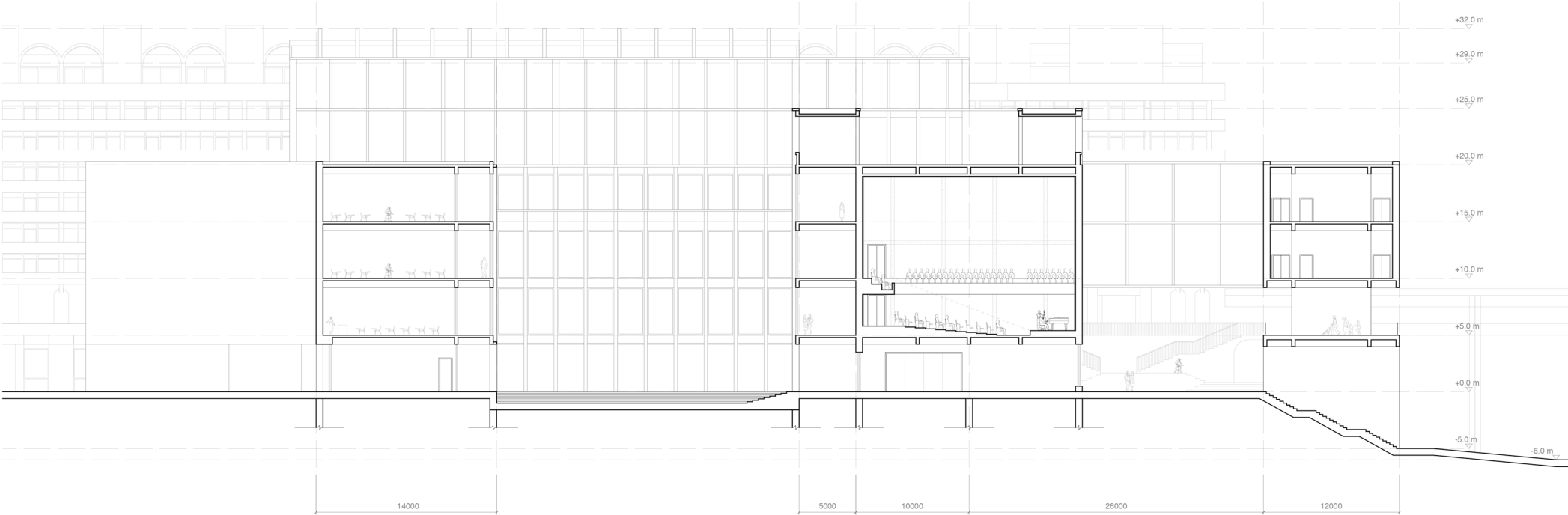

Section through the chamber music hall in relationship to the courtyards next to it

Details

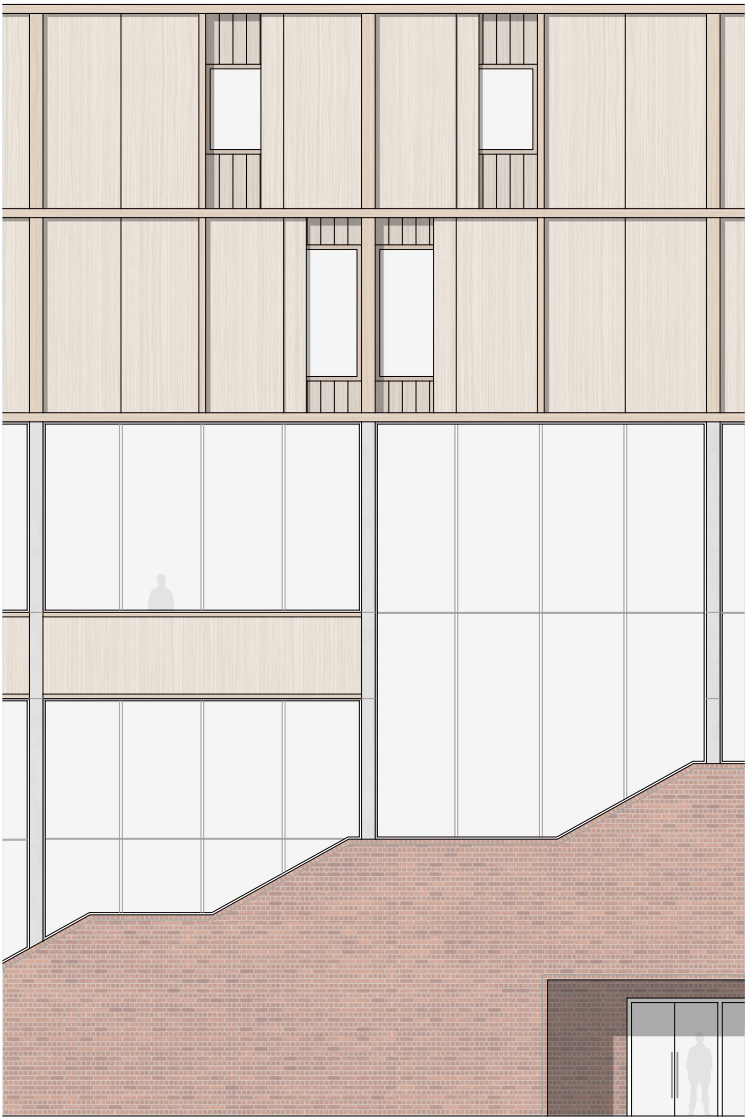
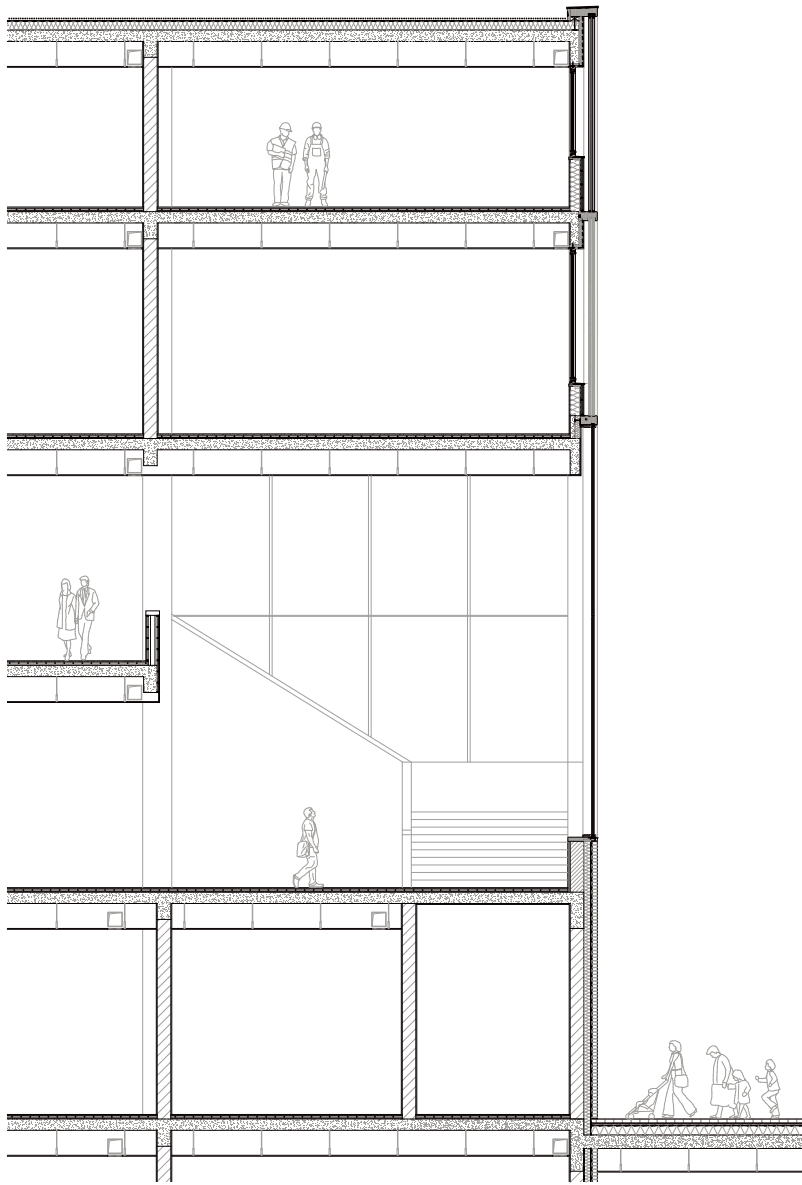

Detail drawing of the foyer facade

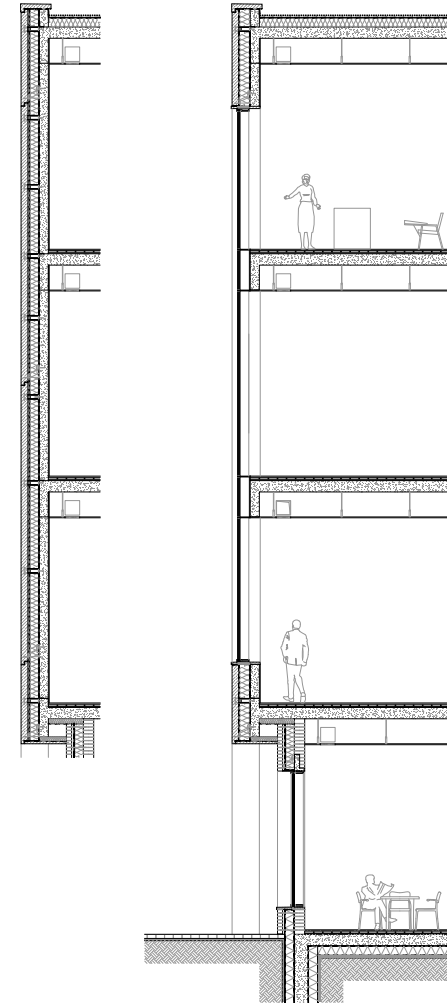

Detail drawing of the facade facing Aldersgate street



Thank you.

