

The HYBRID: Skatepark & Urban Facilitator in Bandung

Graduation Project / Matteo Biella // with Monique Smit, Maarten Meijs, Jan Jongert



URBAN CONCEPT

PASUPATI FLYOVER AS CATALYZER OF ACTIVITIES

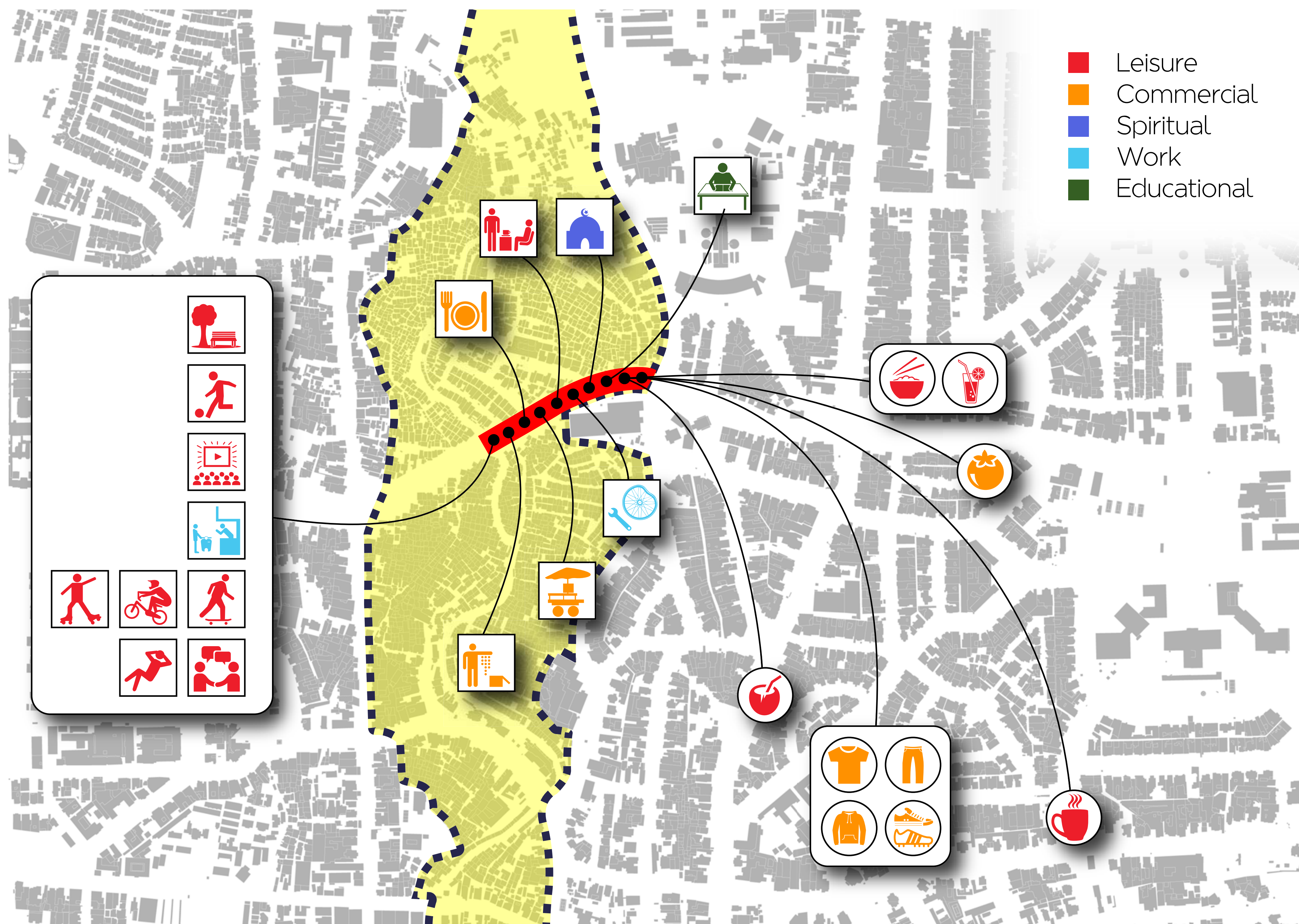
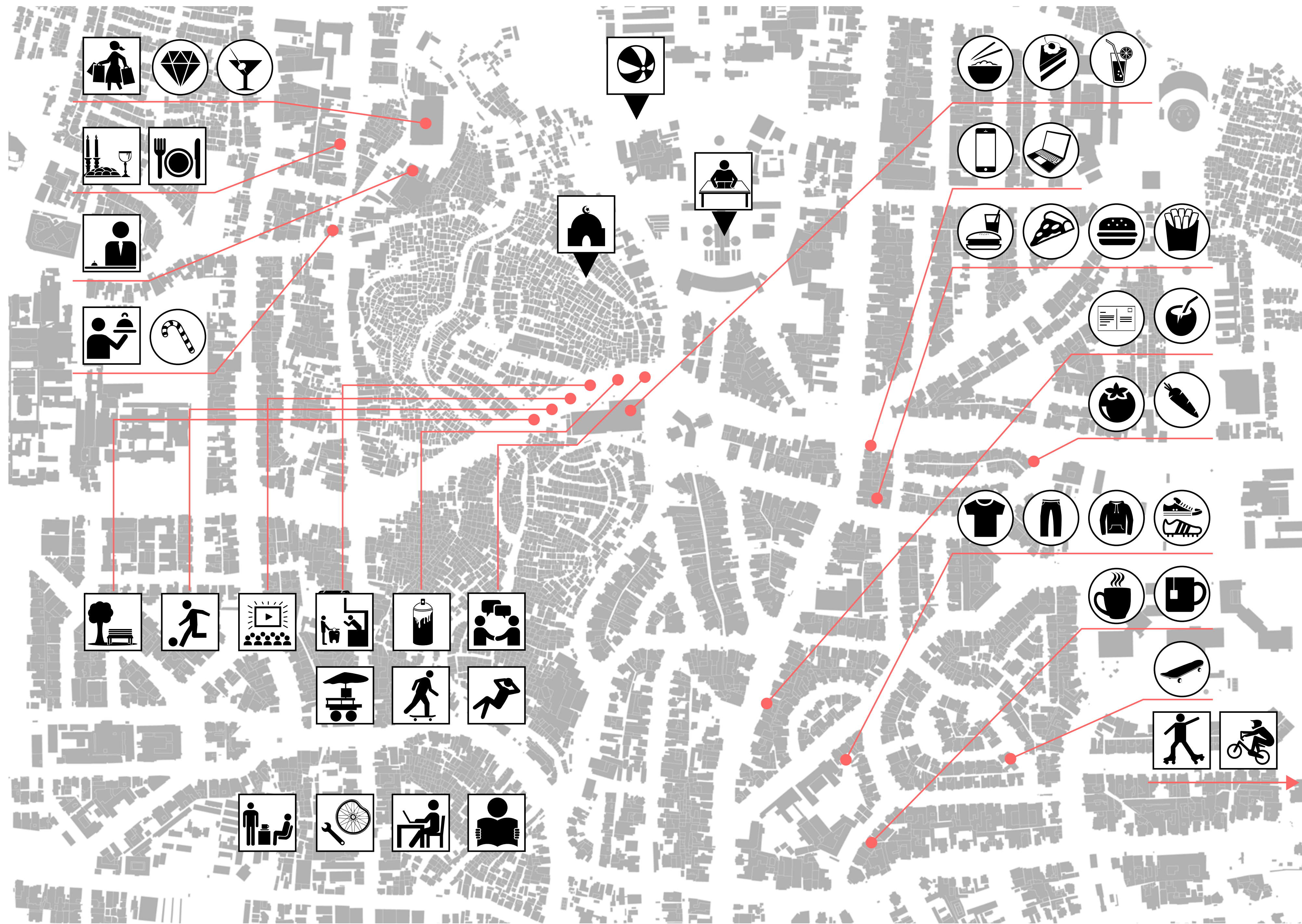

PROGRAMME

URBAN FACILITATOR AREAS DISTRIBUTION

GOODS	ACTIVITIES	DESCRIPTION	CATEGORY
		PARKING & BIKE REPAIR	WORKING
		WOOD FACTORY producing / assembly / repairing / upgrading	
		ARTISTIC ROUTE: promoting youth-culture design...	EDUCATIONAL
		MUSUEM OF SKATE: skateart, decks, sculptures...	
		MOSQUE	RELIGIOUS
		SELF PROMOTION OF LOCAL BRANDS	COMMERCIAL
		KAMPUNG SELLERS MAKING BUSINESS	
		ELDERS' PLAYGROUND	COMMUNAL
		YOUNGSTERS' PLAYGROUND	
		FAMILIES' PLAYGROUND	
		EVERYBODY'S PLAYGROUND	

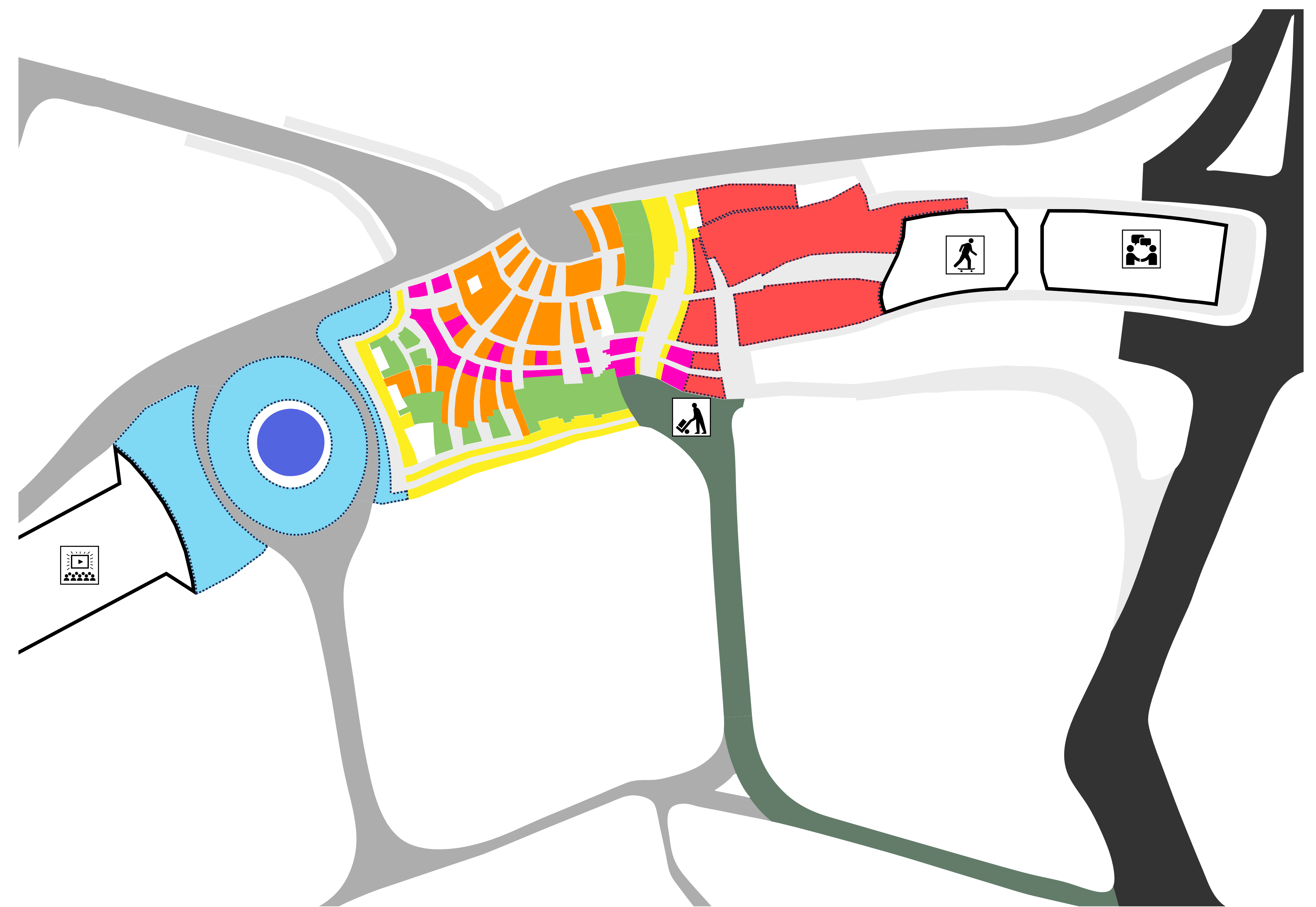

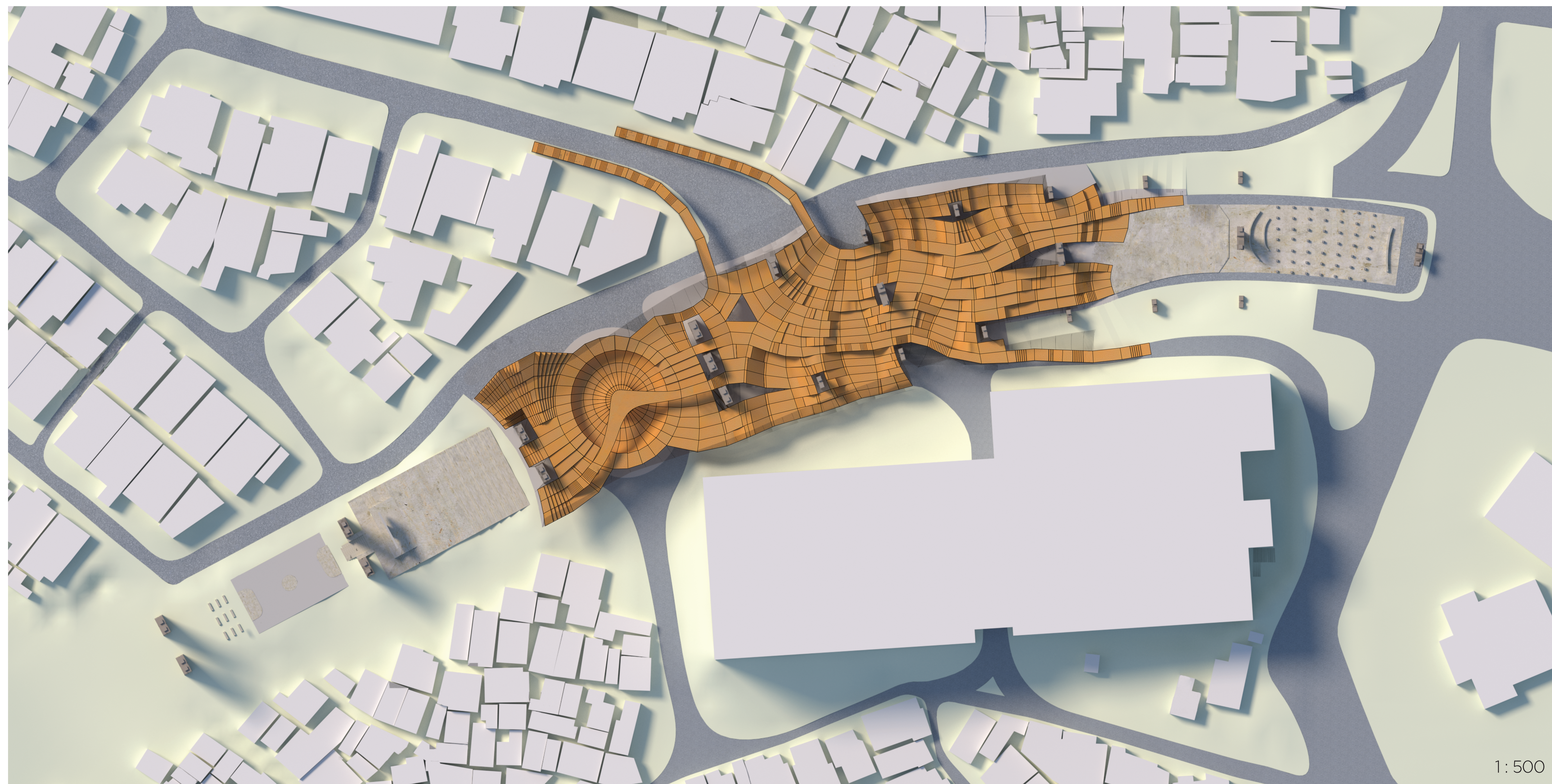
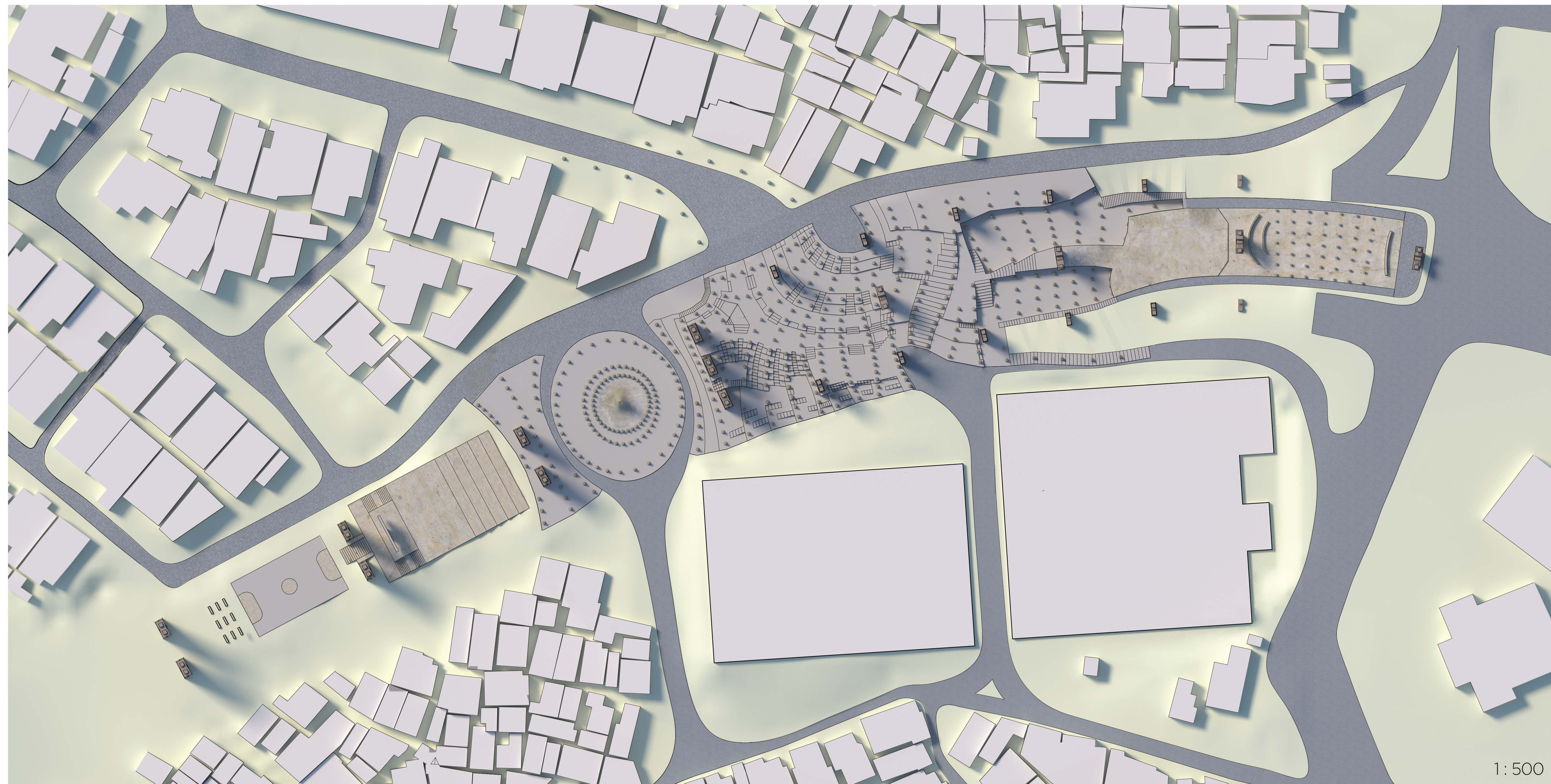

- 1a 1b KAMPUNG TO CHAMPÉLAS
- 2a 2b ITS
- 3 OLD SKATEPARK
- 4 OLD SKATEPARK
- 5 OLD SKATEPARK
- 6 TOURISTIC CENTER

SKATEPARK
ACCESSIBILITY & PATHWAYS

LANDSCAPE (up)
SKATEPARK

URBAN FACILITATOR
STRUCTURAL COLUMNS

LANDSCAPE (below)
URBAN FACILITATOR

ACTUAL STATE

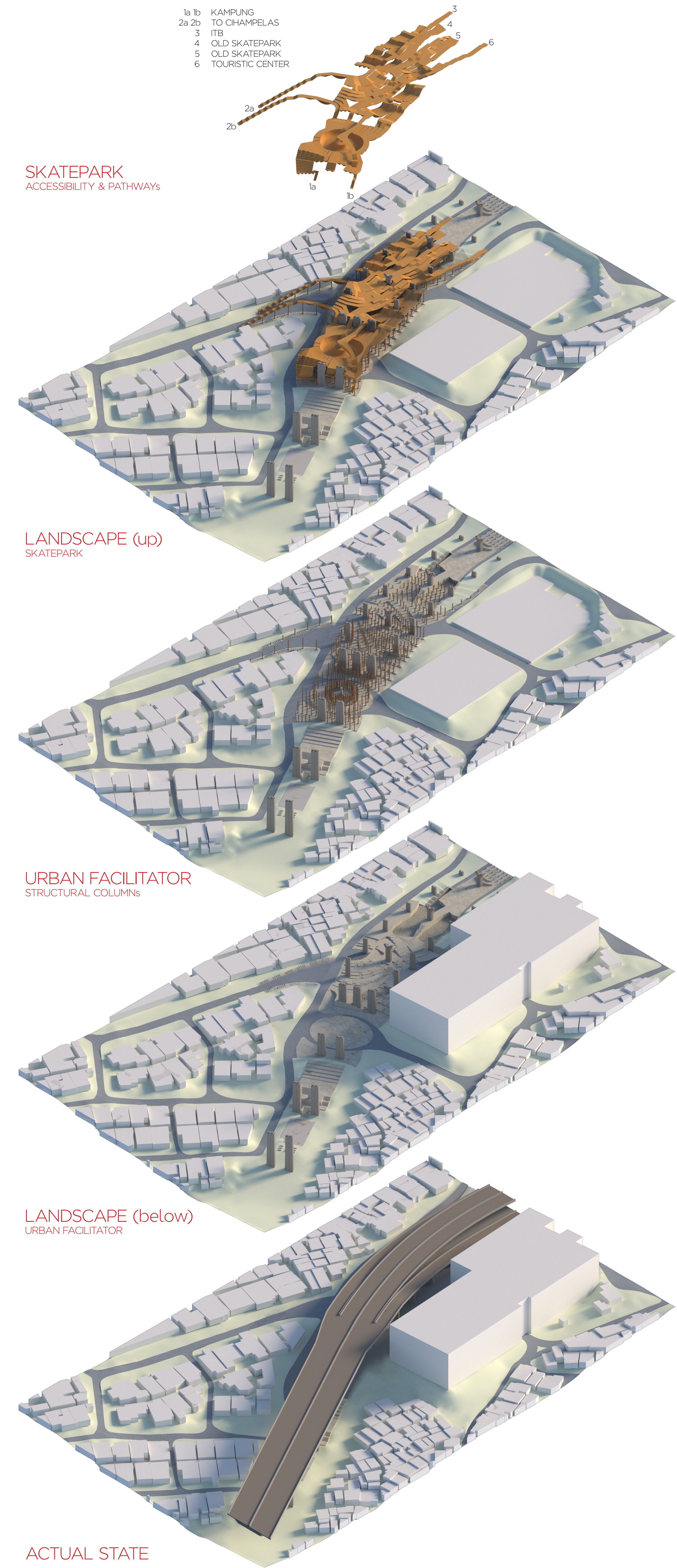

ARCHITECTURAL GRAMMAR

SKATERAMPs COMPONENTS

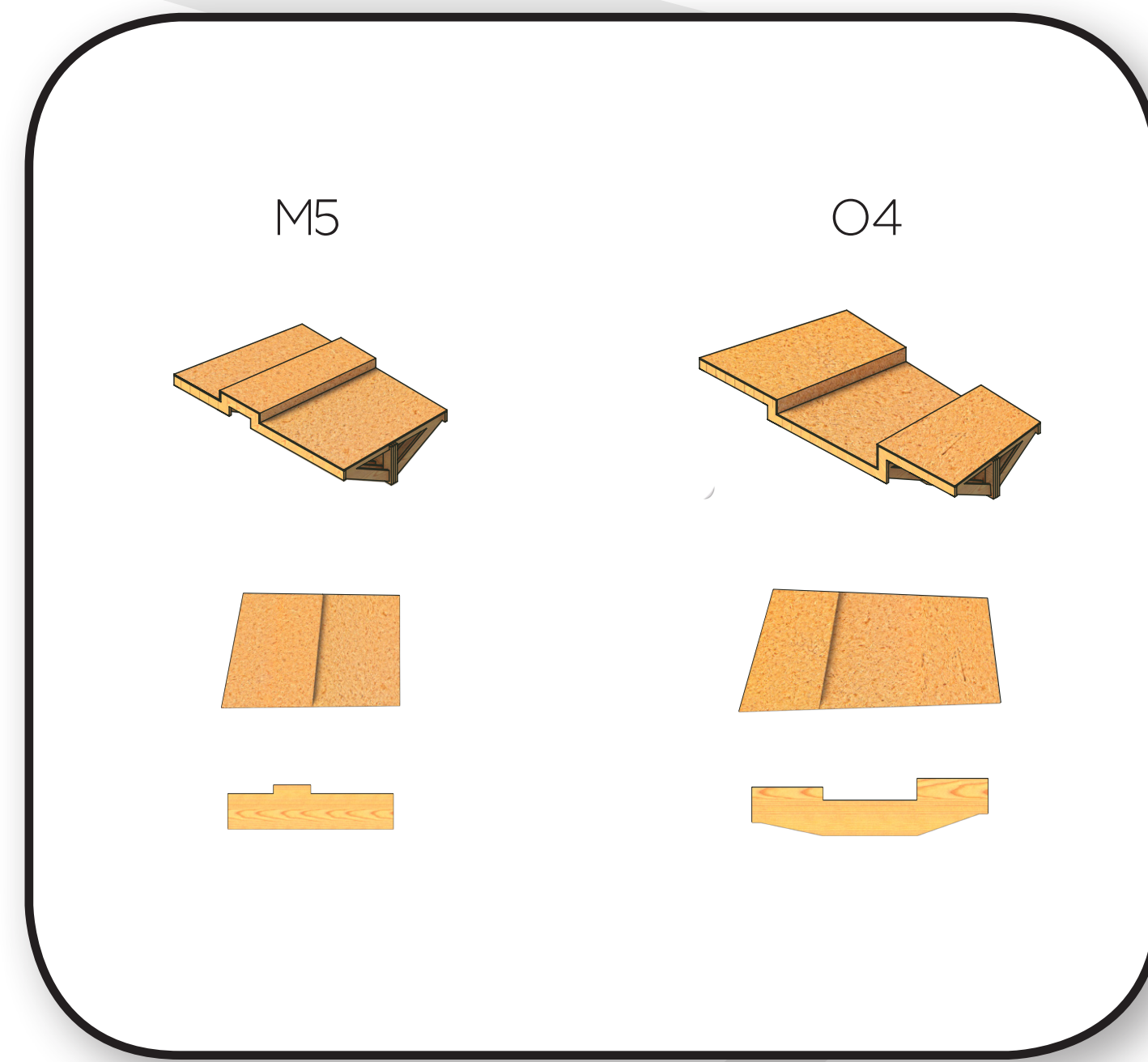

MANUALS & LEDGES

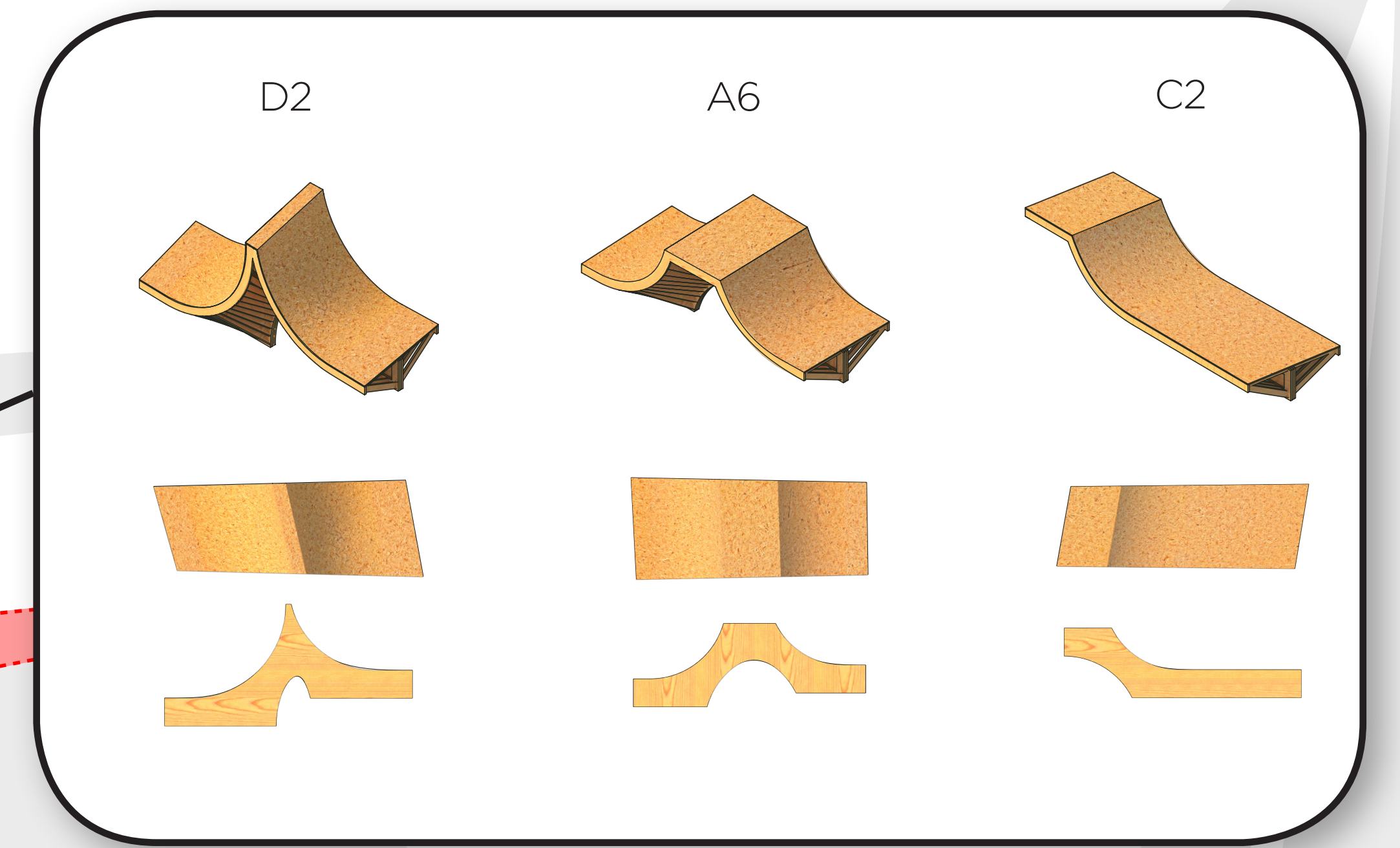

MINI-VERT RAMPS

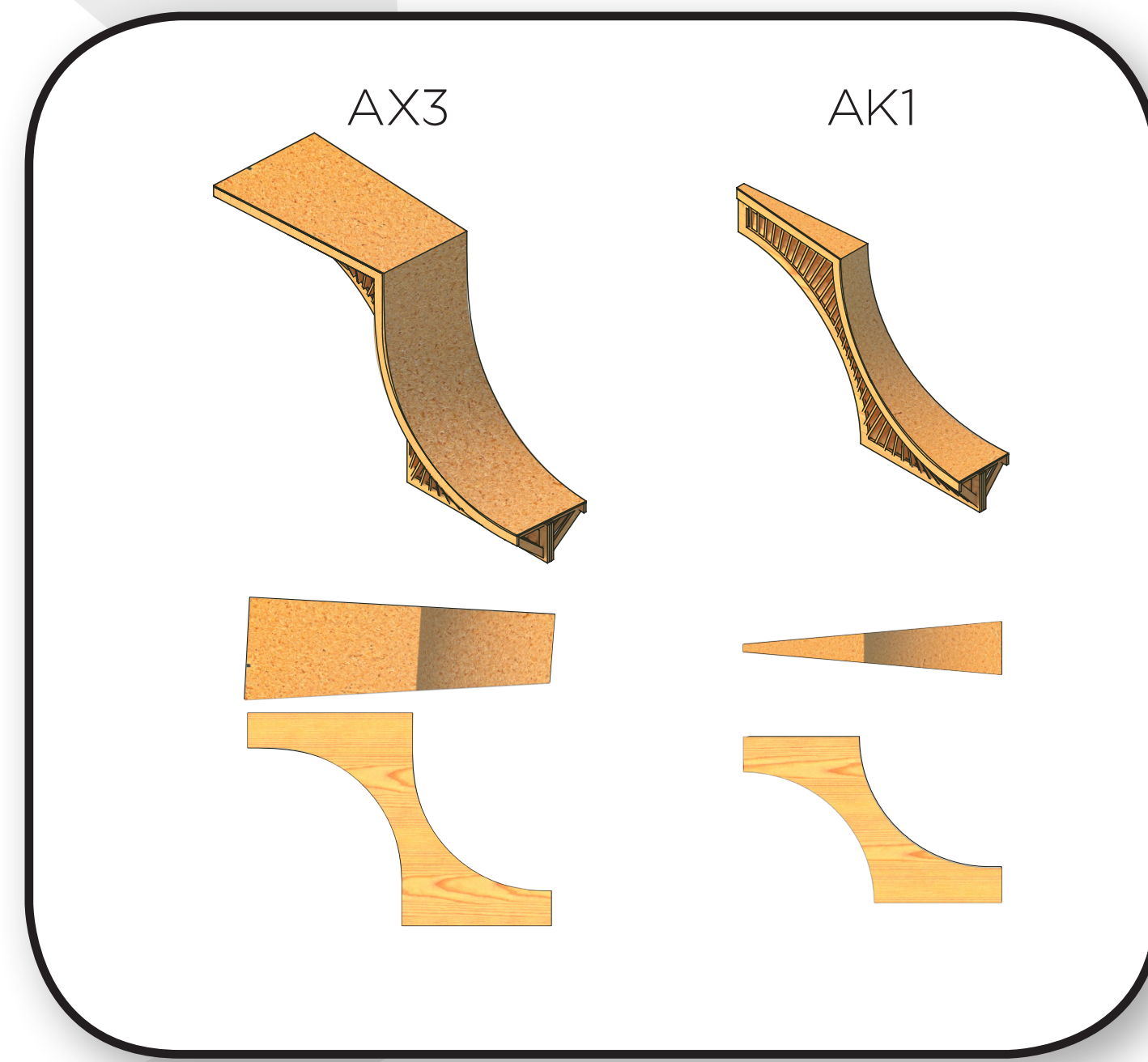

BOWL PARK

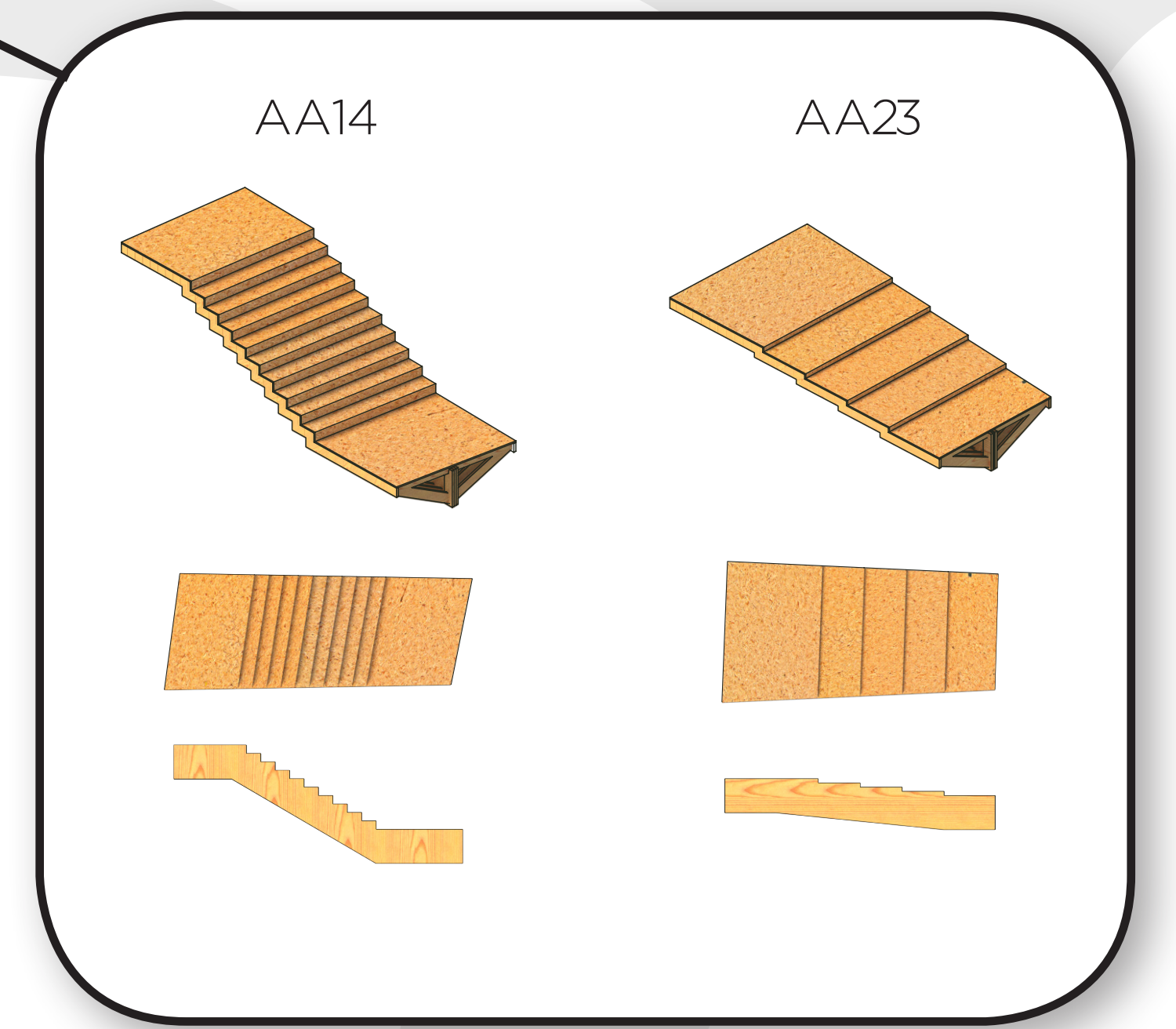

IMPACT AREAS

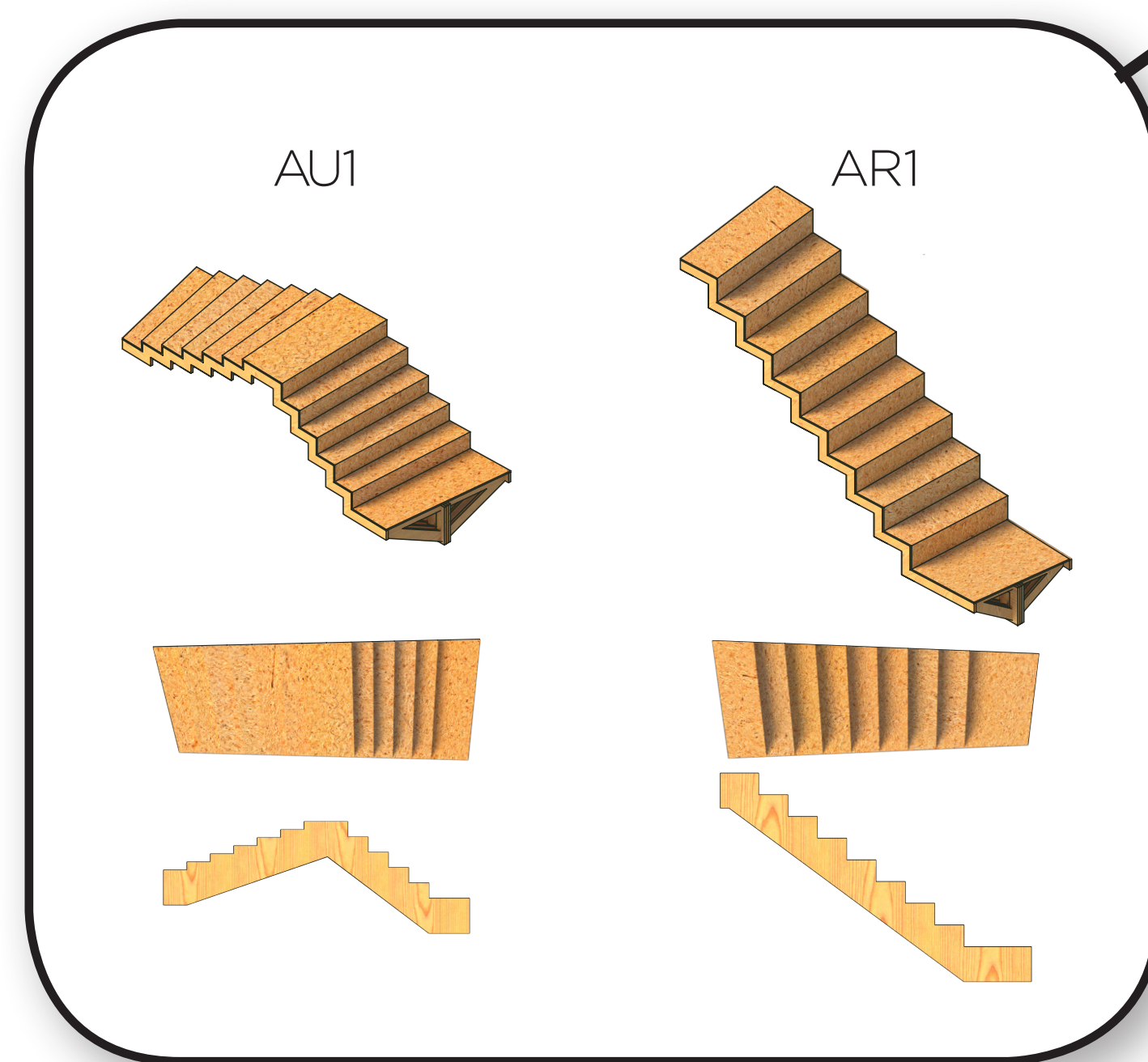

AUDIENCE SEATING

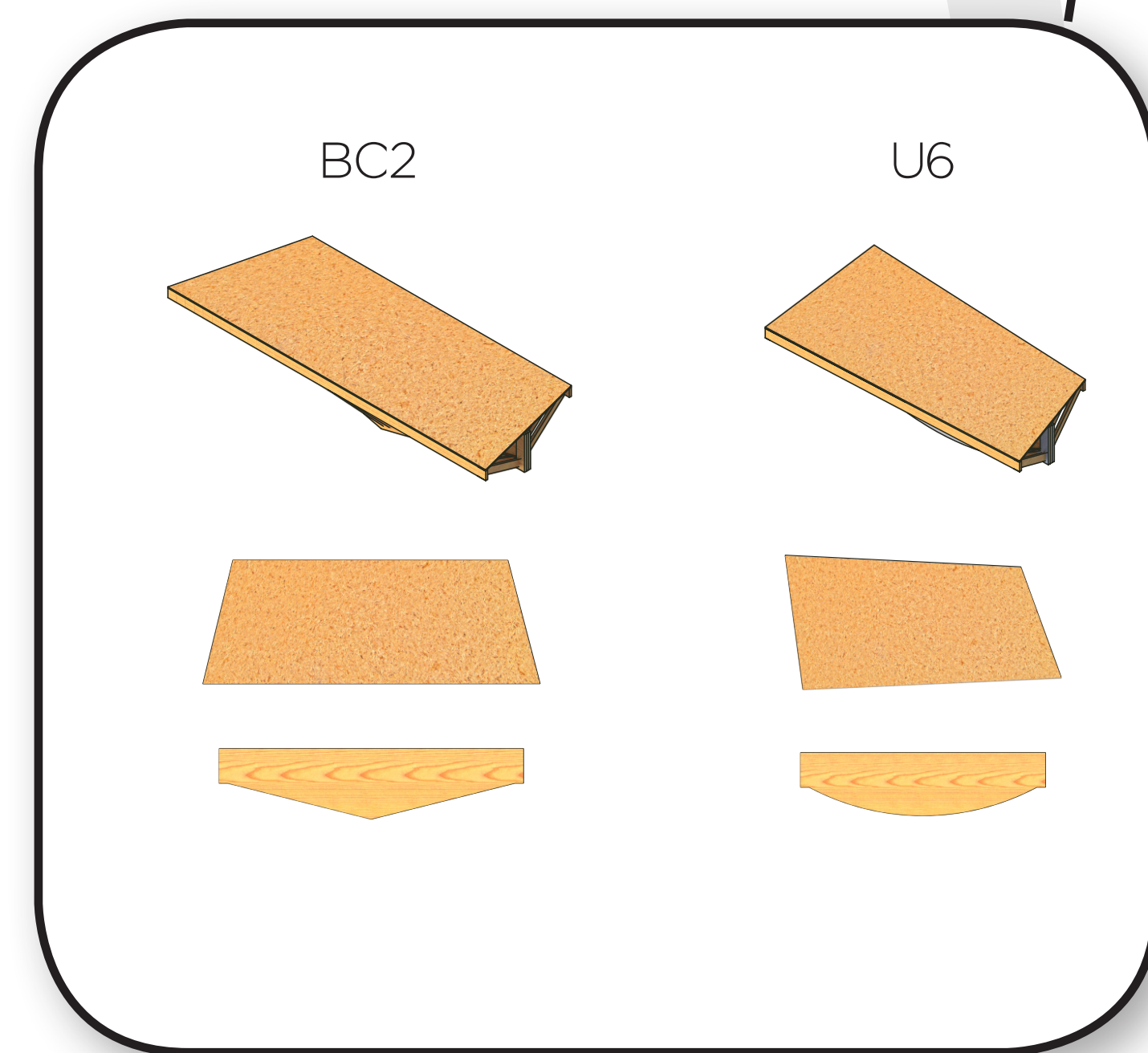

FLATGROUND

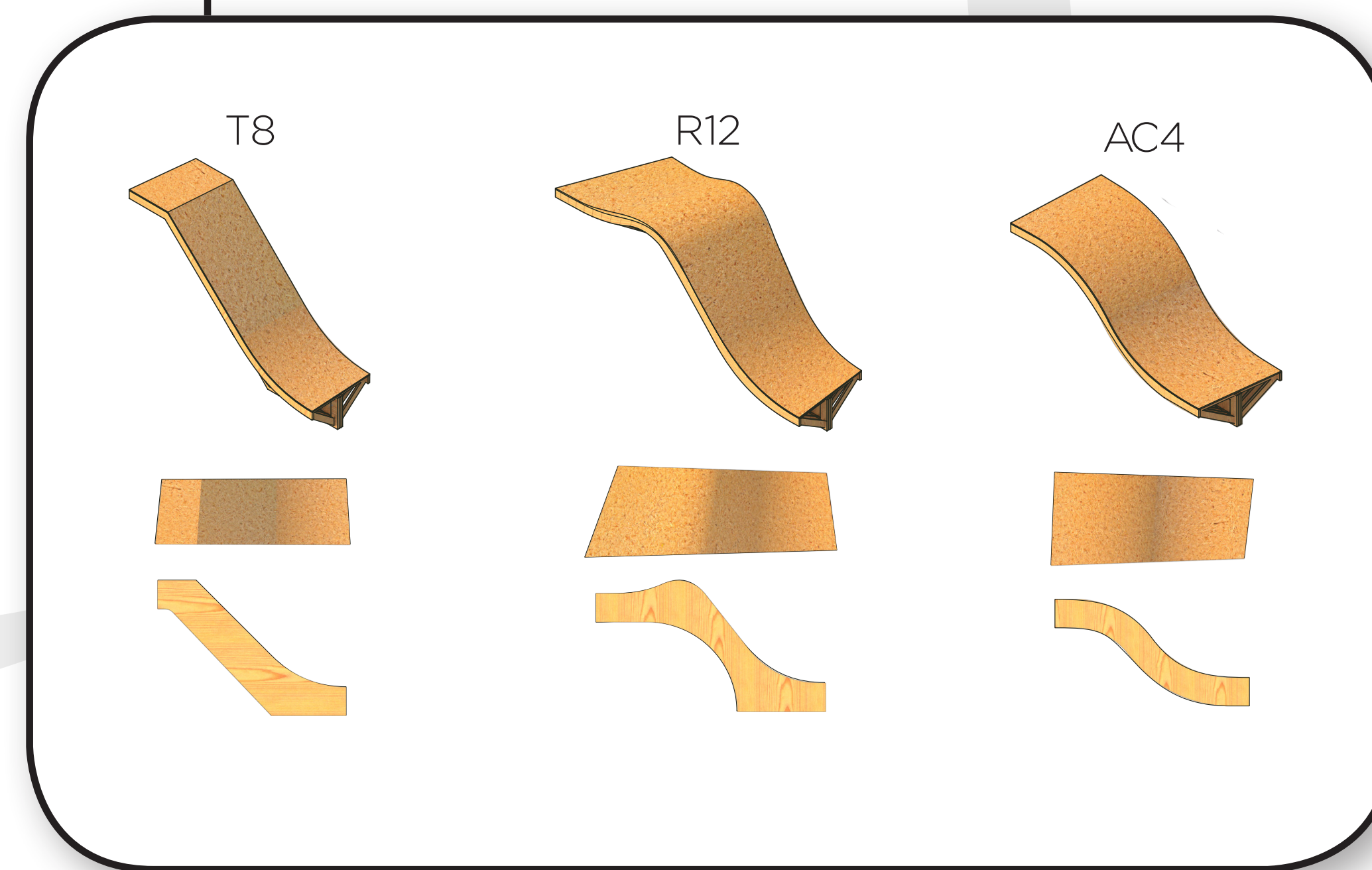

BMX DIRT JUMP

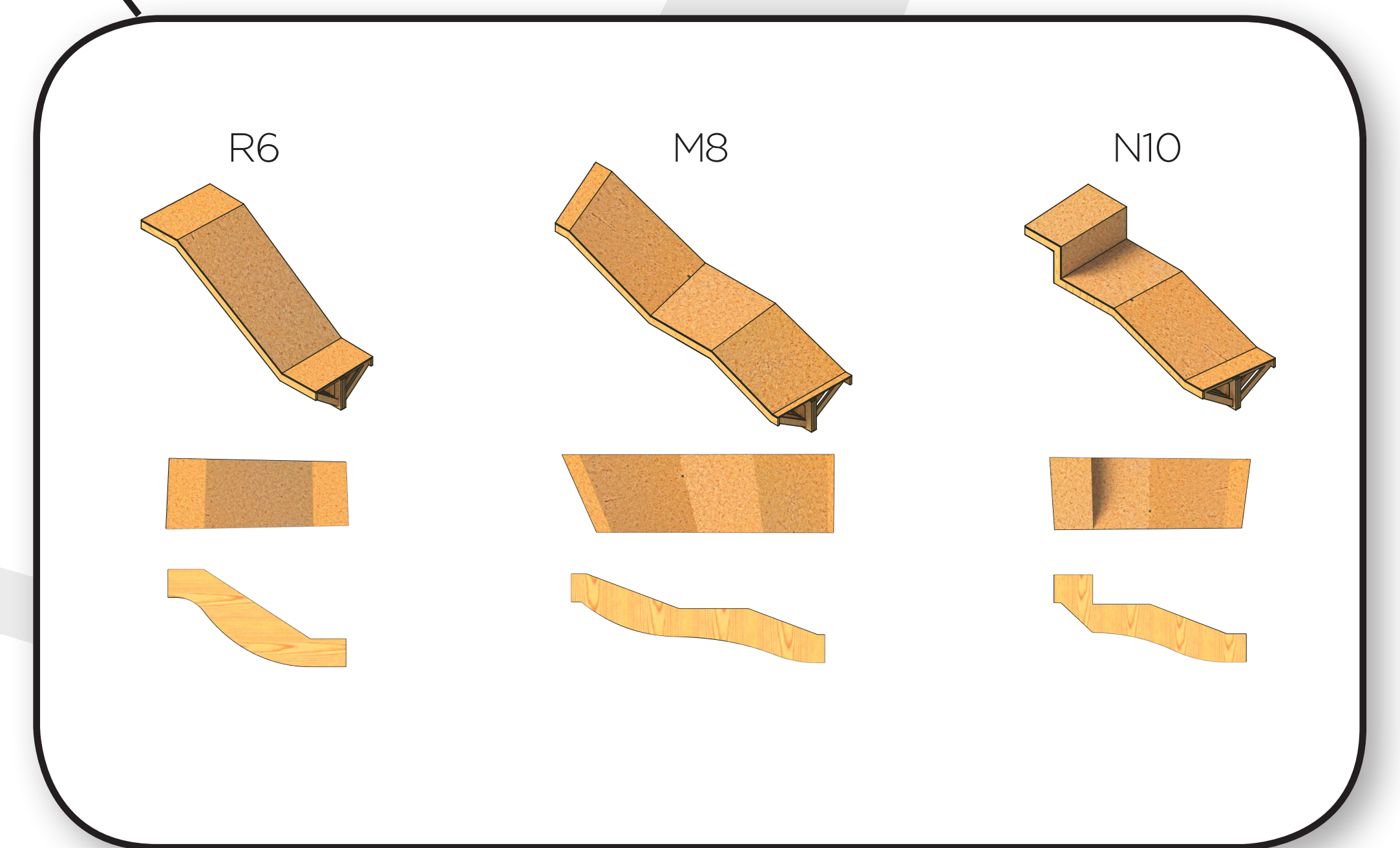

SKATEPLAZA



STARTING OUTLINES

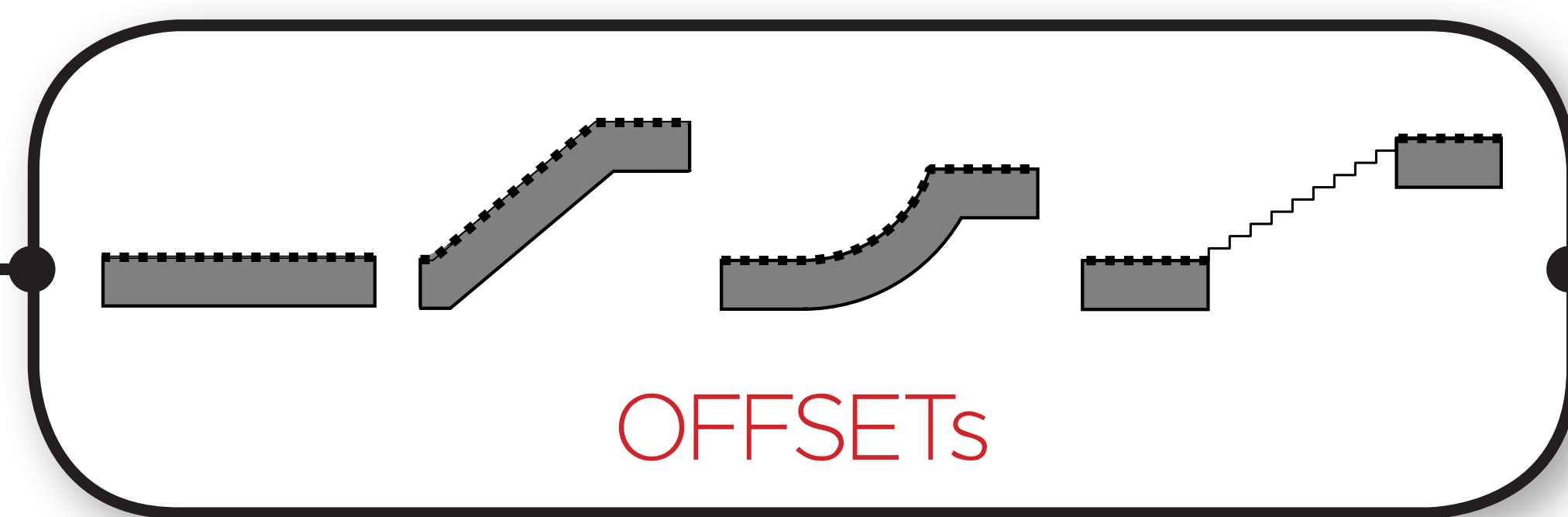

OFFSETS

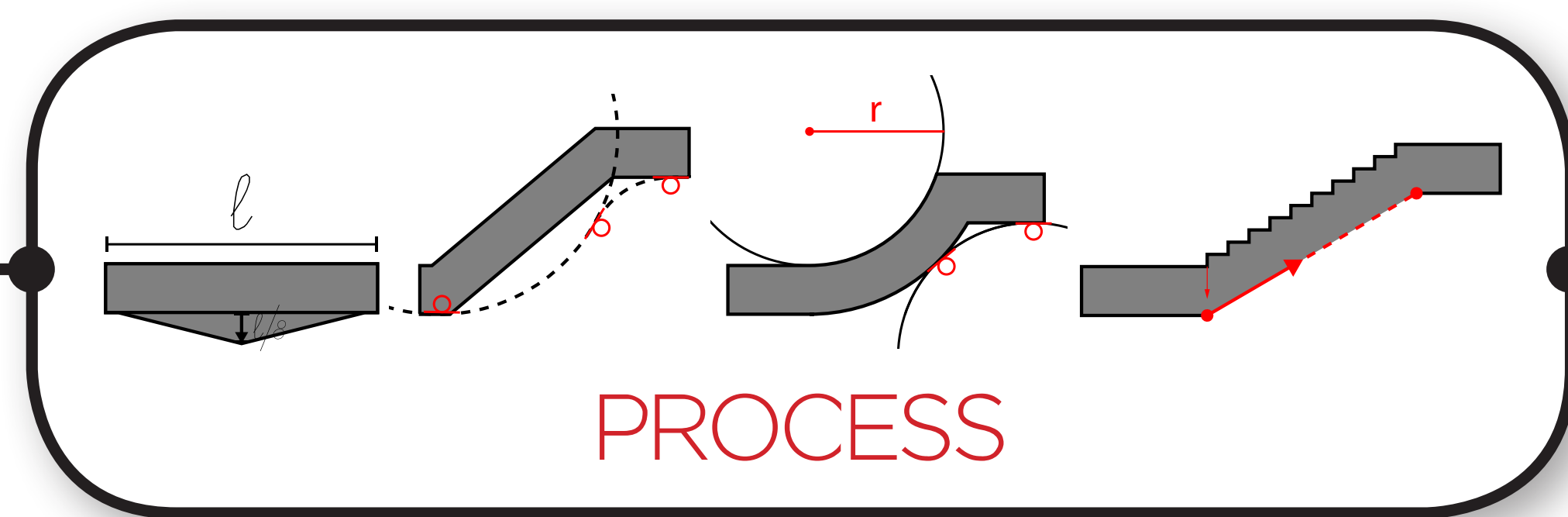

PROCESS



FINAL OUTLINES

LEGEND

- A Availability (locally)
- V Volume of wood
- C Cheapness
- S Sustainability level

- A Assembling
- dB deBarking
- C Connecting
- CNC CNC Milling
- Cs Chainsawing
- D Drying
- kD Kiln drying
- Dr Drilling
- G Gluing
- H Harvesting
- M Mounting
- N Notching
- P Pressing
- PT Preservation Treatment
- Rc Rotary cut
- S Sanding
- Sc Screwing
- Sm Sawmilling
- T Trimming
- X Multiplying by
- W Waste material

- WASTE RESOURCE
- ADDITIVE
- ACTIONS
- STAGES

- WORKING TIME (%)
- 1 HOUR OF LABOR

- ### RESULTS (sum)
- 19 Hours to assembly 1 skate module
 - 8 Hours to assembly 2 complete columns on site
 - 3 Hours to connect the 2 building sections
 - 30 Hours to connect the 2 building sections

DETAILS

- 1 PILE FOUNDATION STILT prefabricated concrete, 3m deep
- 2 PLINT 12 types prefabricated concrete, 6500mm upper base, 1000mm ground-base, 1000mm height
- 3 DEMU SCREW galvanized steel
- 4 STEEL JOINT prefabricated, 150mm slit
- 5 TIE GRIP steel
- 6 MIXED RESIN/CONCRETE sprayed through 15mm hoses in bamboo culms
- 7 INNER RING Sengon wood, 50mm thickness
- 8 ROPE 5 threads rope overall, 1 steel thread, 4 coconut fiber interlaced threads
- 9 STEEL SPACERS
- 10 RUBBERWOOD SUPPORTS various lengths x 150mm x 50mm
- 11 RUBBERWOOD RAFTERS various lengths x 150mm x 50mm
- 12 SKATEBOARD COPING galvanized steel
- 13 TURNBUCKLES galvanized steel
- 14 RUBBERWOOD PLYWOODS panels 2440mm X 1220mm X 10mm
- 15 WOODEN PLASTIC COMPOSITE WPC panels 2440mm X 1220mm X 10mm
- 16 SKATEBOARD COPING galvanized steel
- 17 TENSION BELT 5mm thickness galvanized steel, welded on site
- 18 COMPRESSION BELT with 36 welded steel wings
- 19 NET overall 5 threads inter-twined, 1 steel thread, 4 coconut fiber interlaced, pattern checker 100mm x 100mm

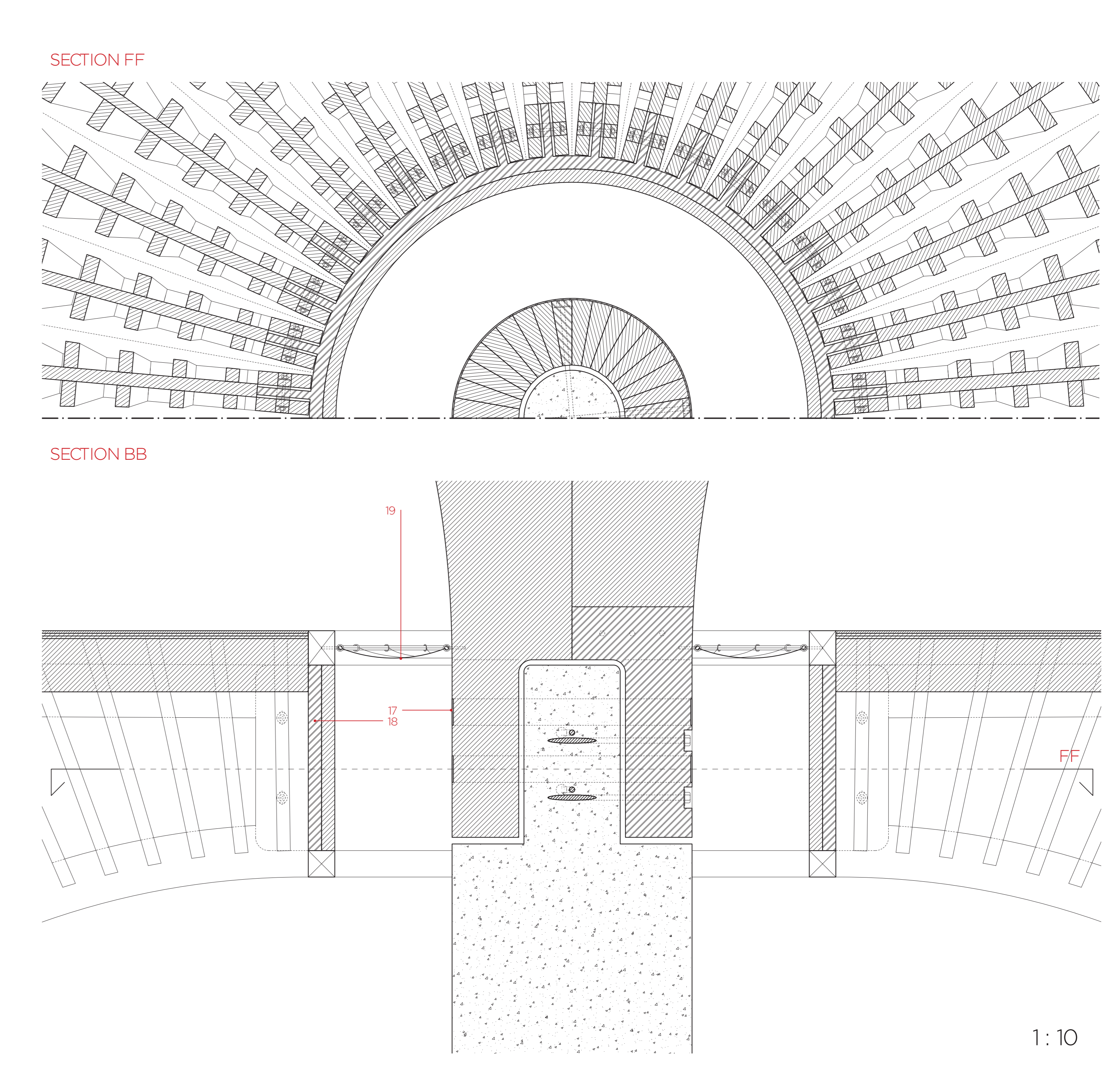
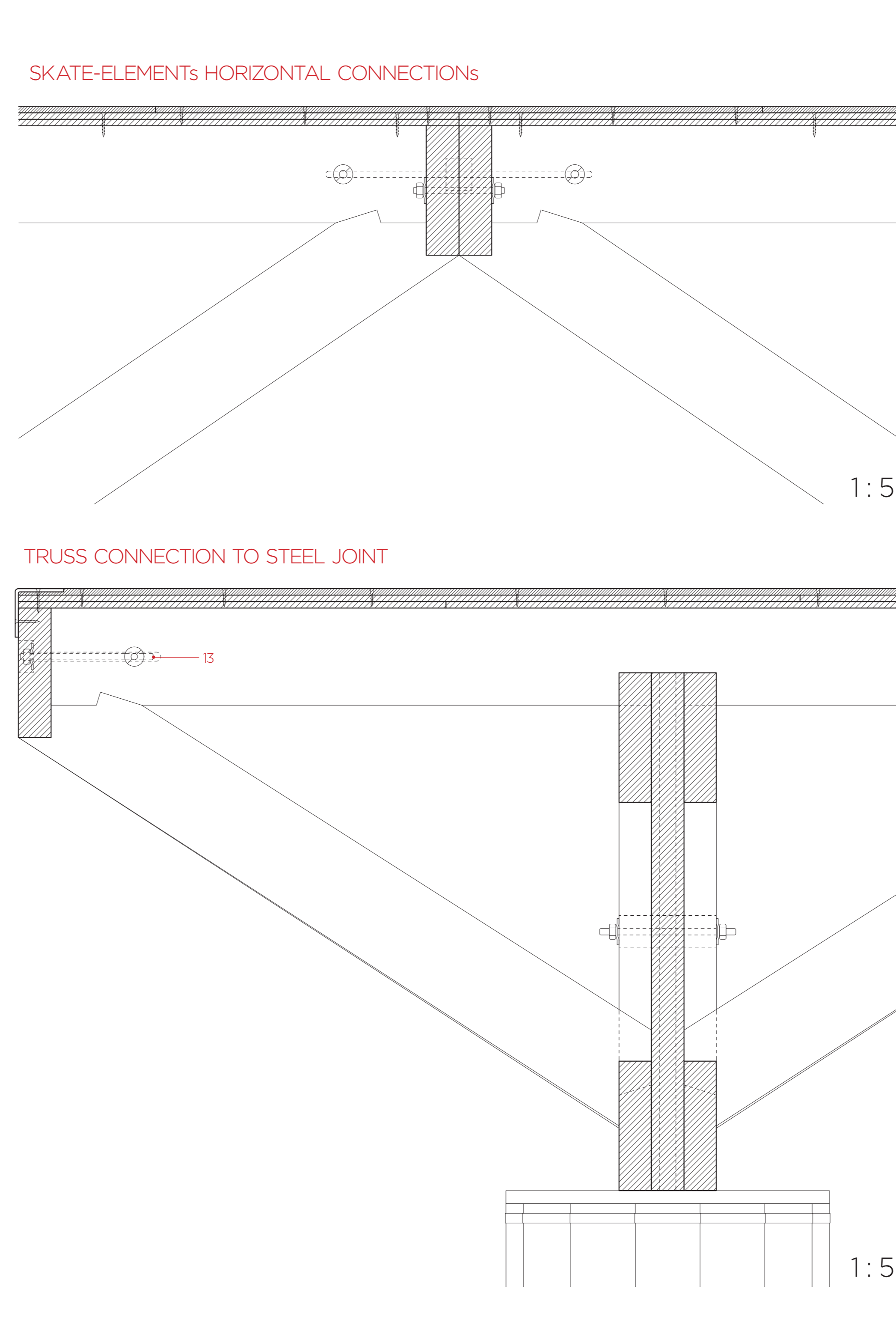
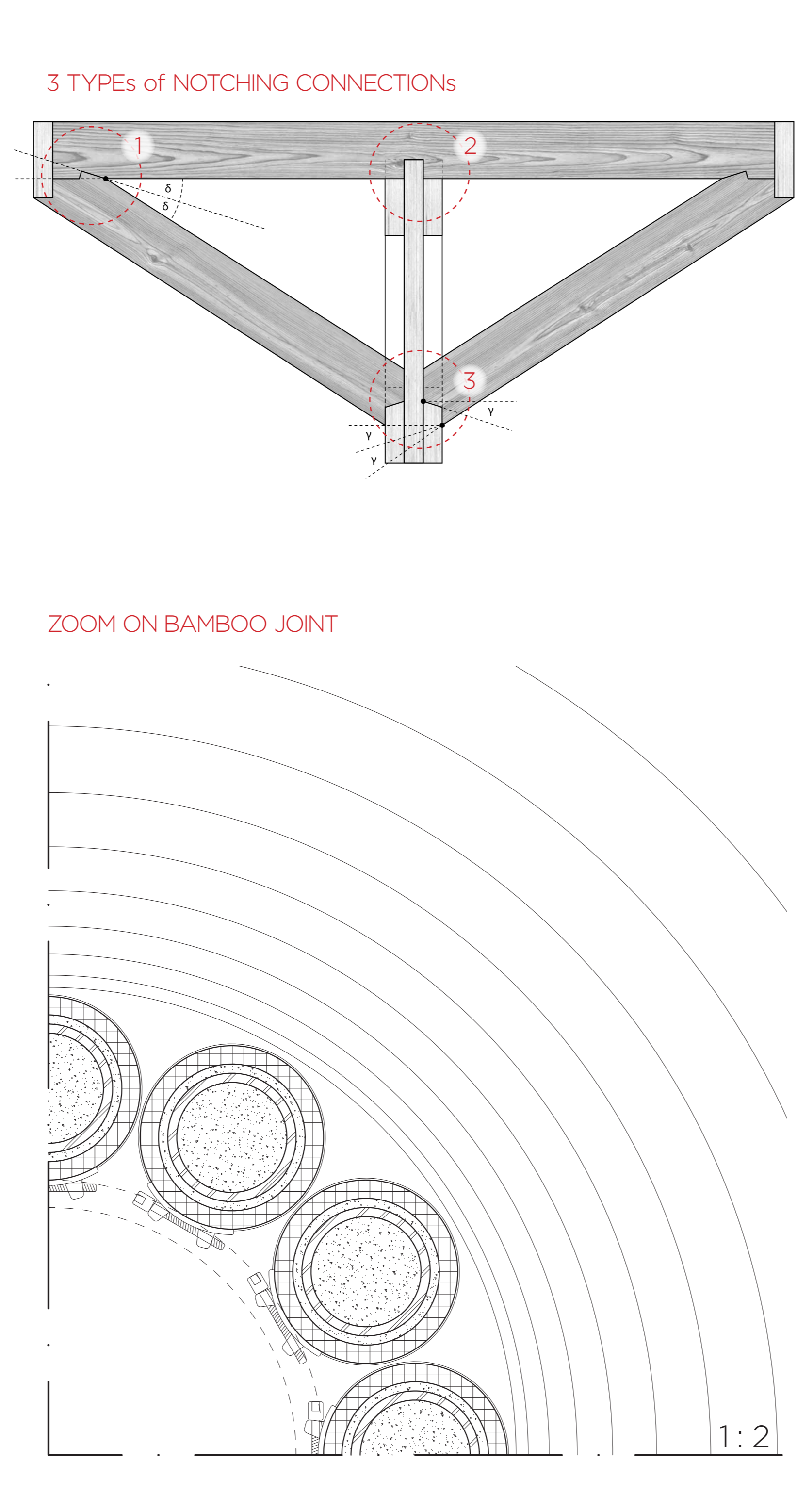
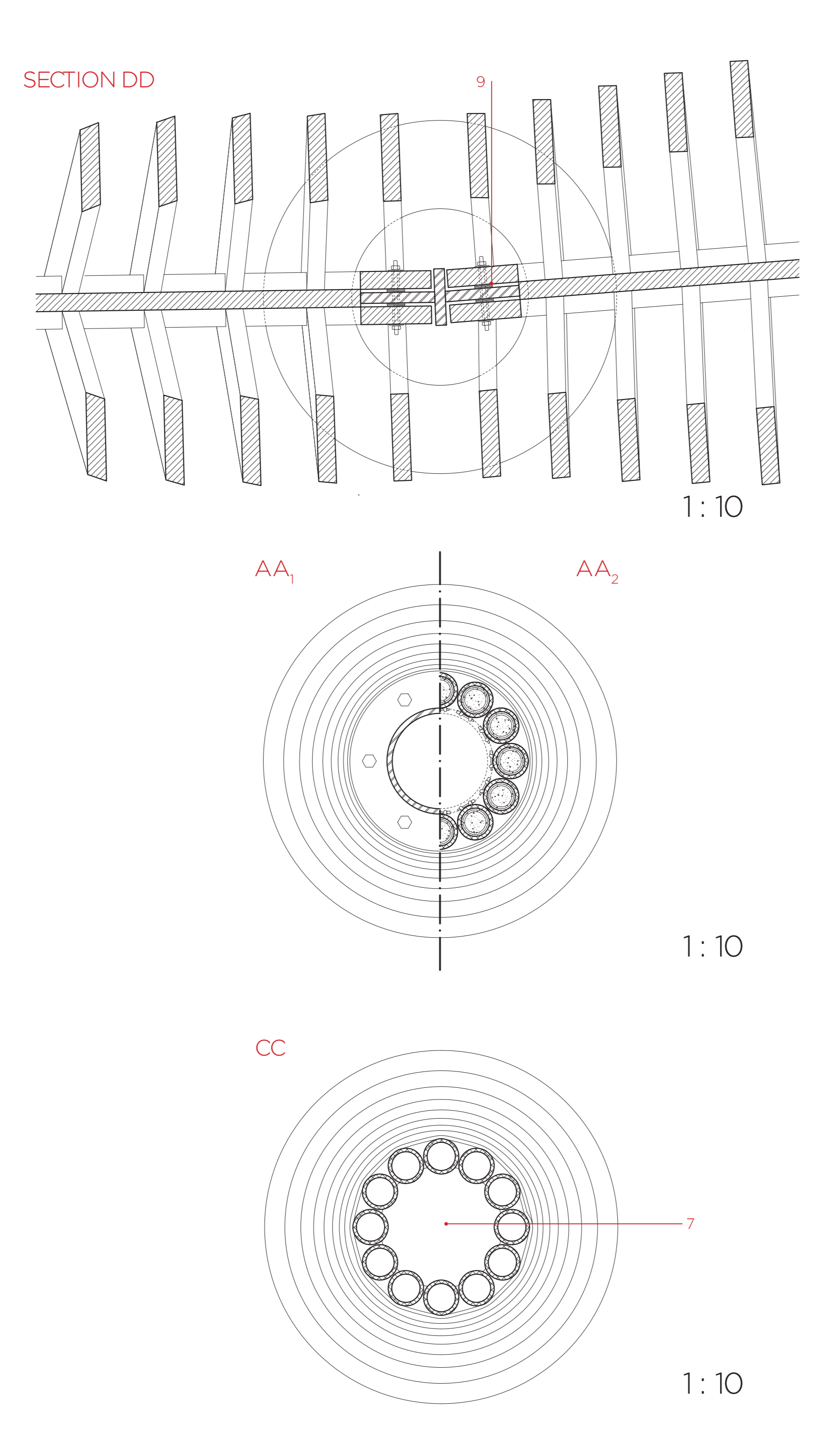
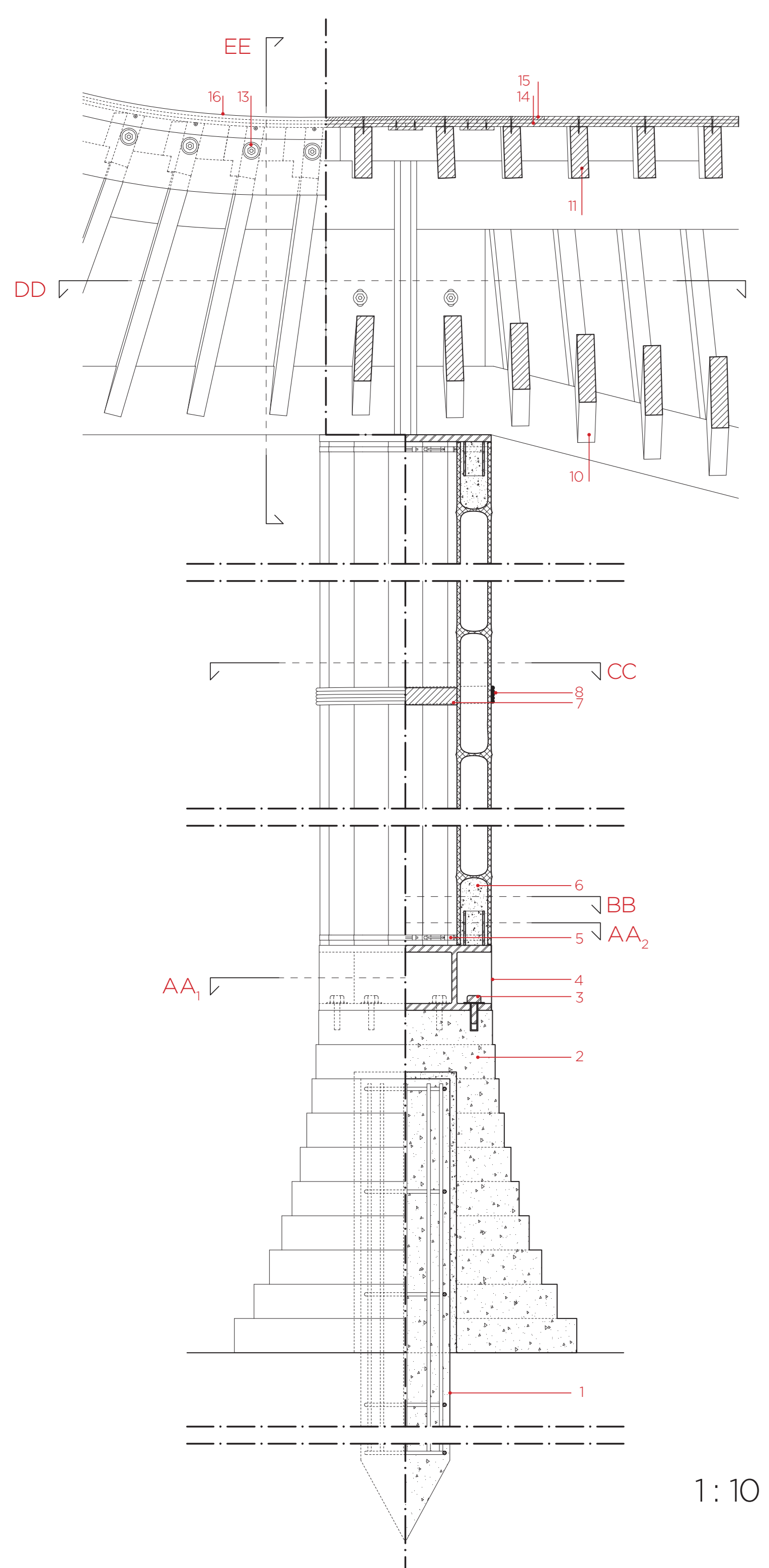


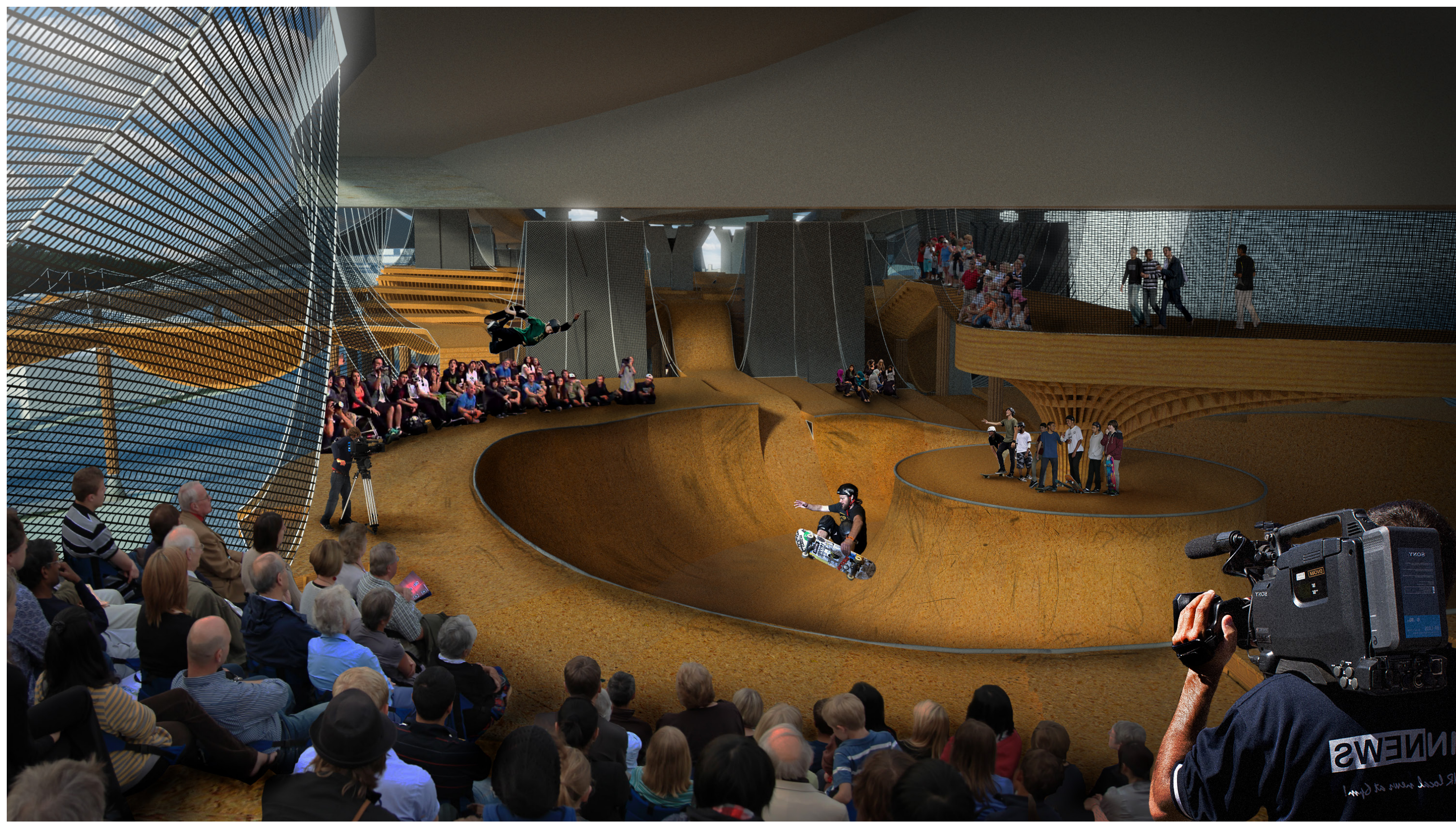

Bandung BOWL-A-RAMA International Skate Contest

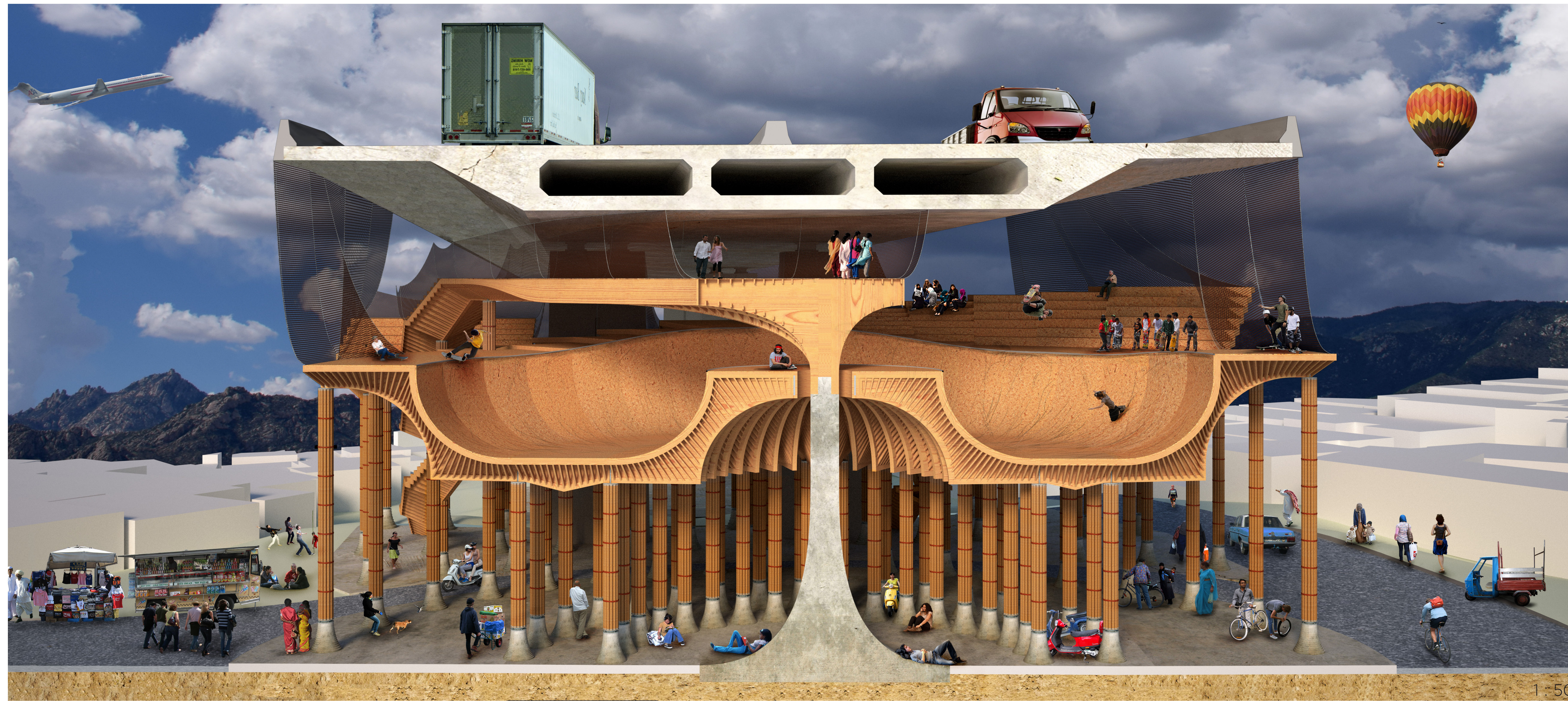

Threefold hierarchy of activities



permanent exhibition in the Museum of Skate



everyday skateboarding scene

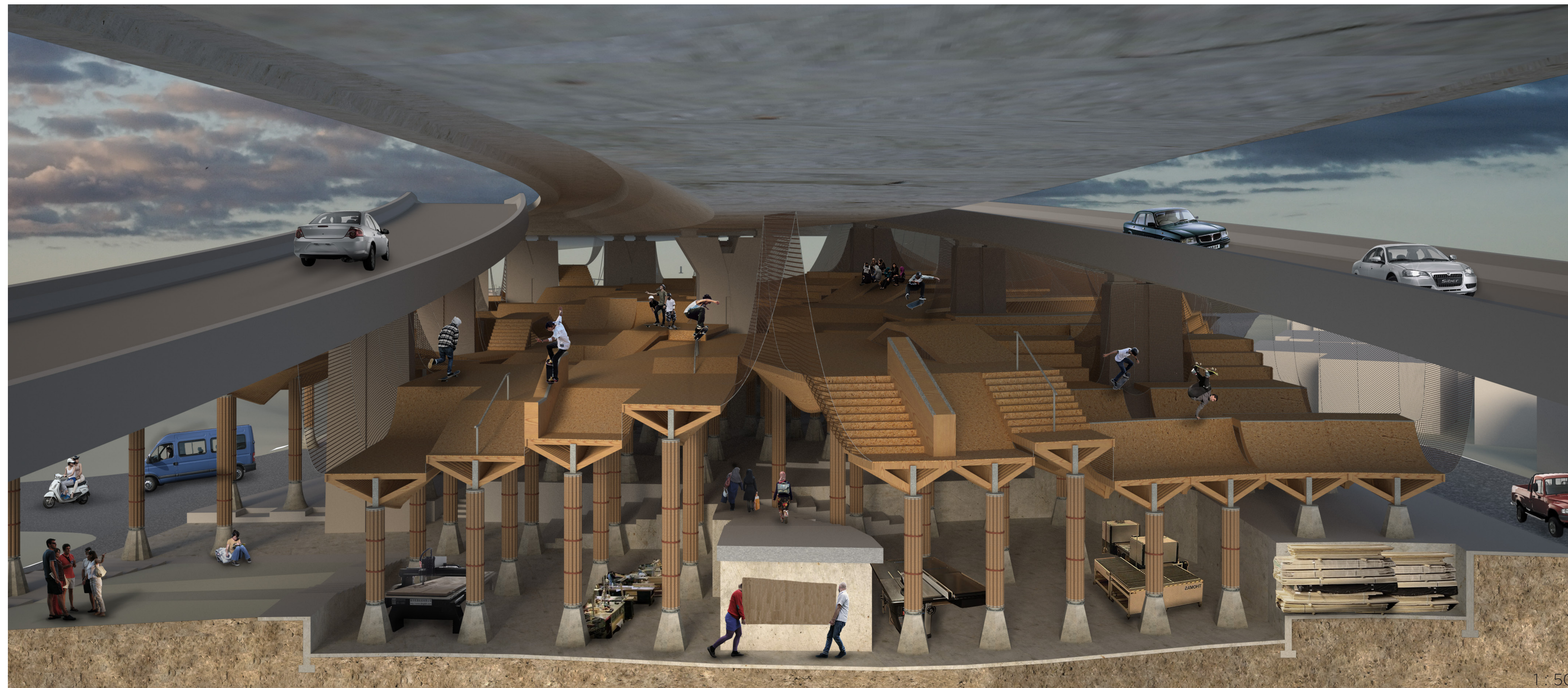

wood factory embedded in the Urban Facilitator



everyday commercial & leisure activities in the Urban Facilitator



Wednesday neighborhood kampung market



emergent bands showtime night