

# Thrive through art.



How does the urban living environment regarding art facilities facilitate talent development of children?

# Importance

## Grote zorgen over cultuur op Zuid: 'De bodem valt weg, het stort als een kaartenhuis in elkaar'

7 oktober 2024, 09:32 Algemeen 11.991 keer gelezen

 Vers Beton

### Cultuurorganisaties op Zuid vechten voor hun bestaan

Lees de opinies van drie culturele organisaties die vechten voor hun voortbestaan op Rotterdam-Zuid.

2 okt 2024



NOS Nieuws • Dinsdag, 18:26

Zorgen over niveau Nederlands  
muziekonderwijs, 'aanwas jong talent  
stagneert'



 Rijnmond

### Zorgen over toekomst probleemwijken: 'Onorthodoxe maatregelen nodig'

De problemen in achterstandswijken zoals in Rotterdam-Zuid lopen steeds meer op. Twaalf directeuren van het Nationaal Programma Leefbaarheid...

29 mrt 2024

 de Volkskrant

### De balans na tien jaar stadsvernieuwing in Rotterdam- Zuid: de vooruitgang is er, maar nog lang niet genoeg

Naar het zogenoemde Nationaal Programma Rotterdam Zuid (NPRZ) wordt sinds 2012 met argusogen gekeken in de rest van het land.

11 jul 2022



## Iedere vier jaar bibberen en beven voor de cultuursector: 'Je moet de juiste woorden gebruiken'



# Impact of poverty on talent development of children in Rotterdam-Zuid

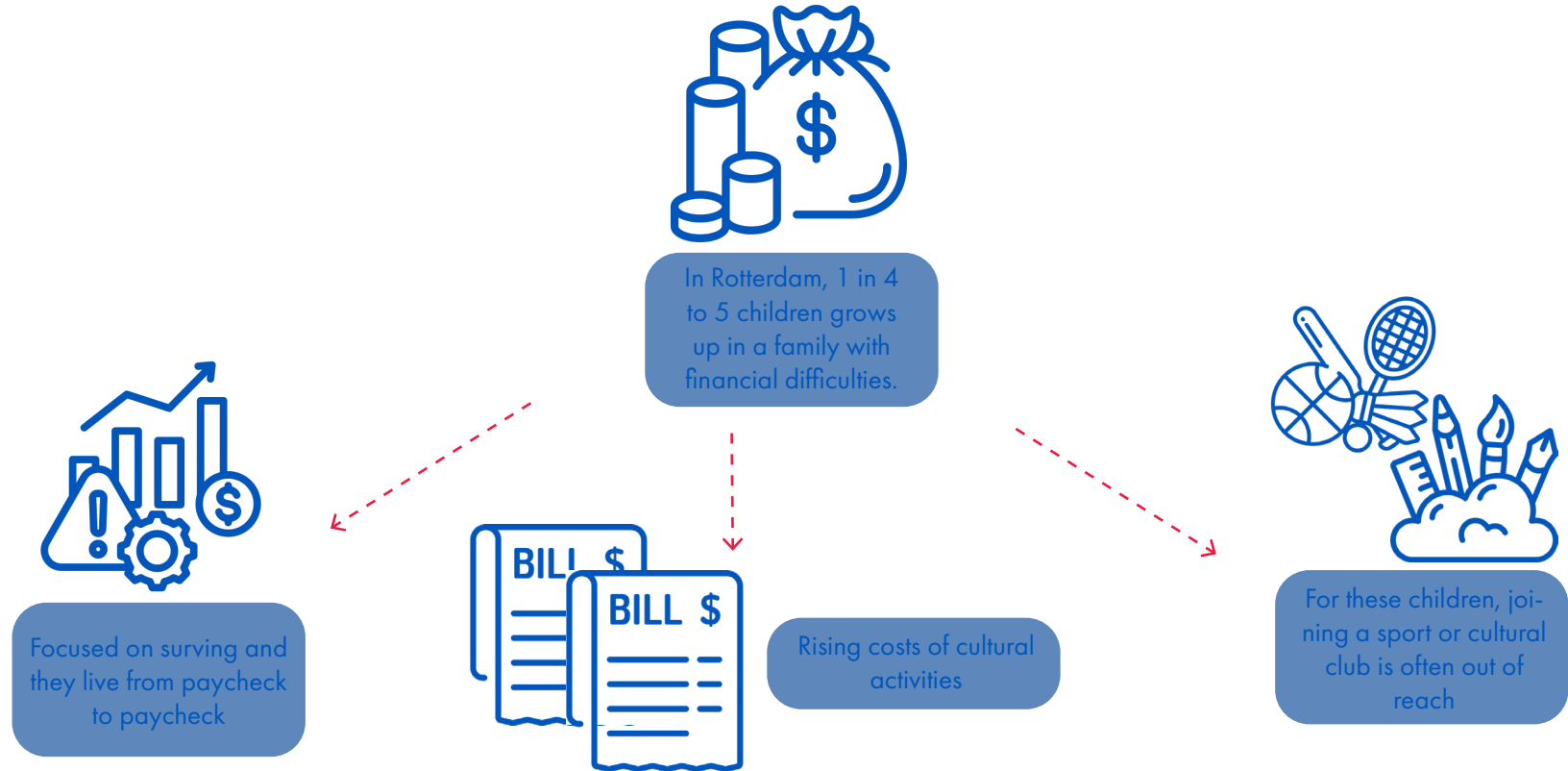

# Why is art important for young people in Rotterdam-Zuid?



Stimulating talent development



Loneliness among children

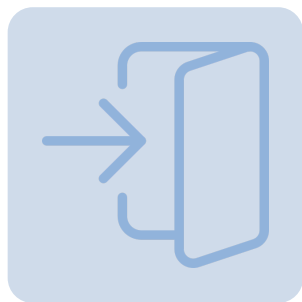

Accessibility of arts

# Why is art important for young people in Rotterdam-Zuid?



Stimulating talent development



Loneliness among children

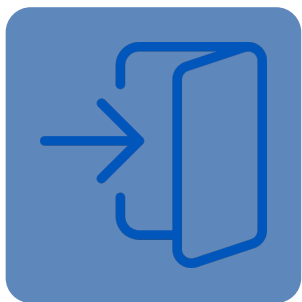

Accessibility of arts

# Talent development

the ability to do something well

social skills, experiences and develop knowledge

creativity, solution-oriented,

starting at an early age

# Target group



pre-conventional stage  
4 to 10/12 years old



conventional stage  
12 to 18 years old

# Research



primary school

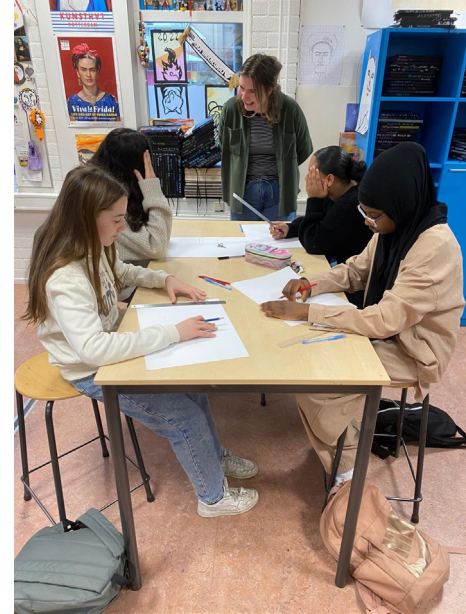

high school

# Design guide lines - base

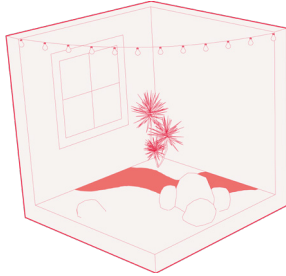

including outside in the design

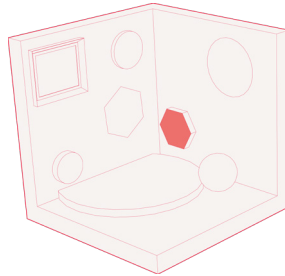

stimulative

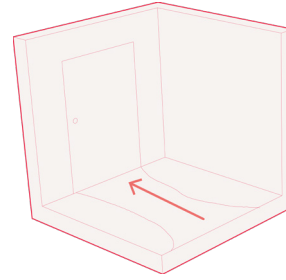

easy accessible

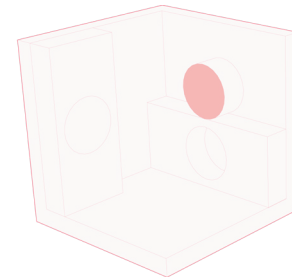

adaptability

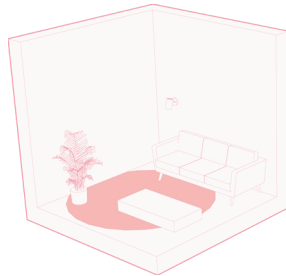

decorative



social safety

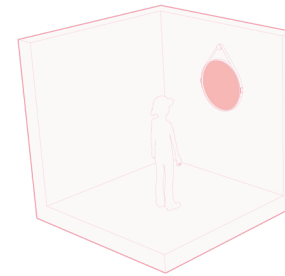

admiration

# Design guide lines - best

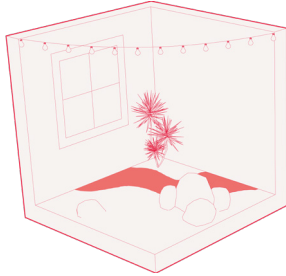

including outside in the design

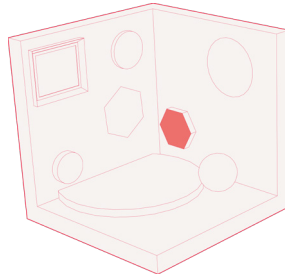

stimulative

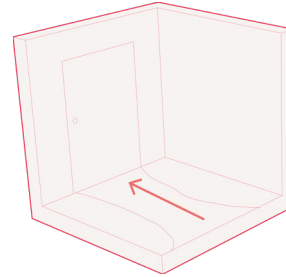

easy accessible

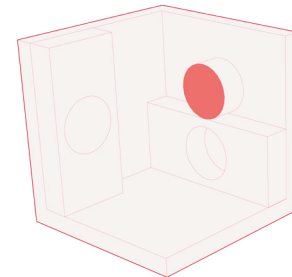

adaptability

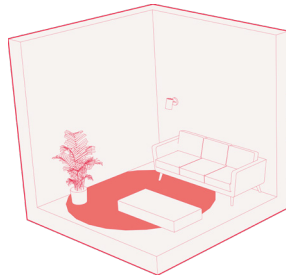

decorative



social safety

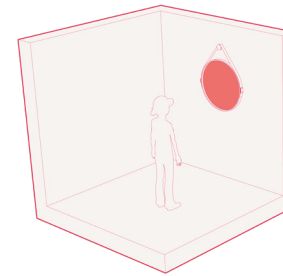

admiration



# Rotterdam-Zuid

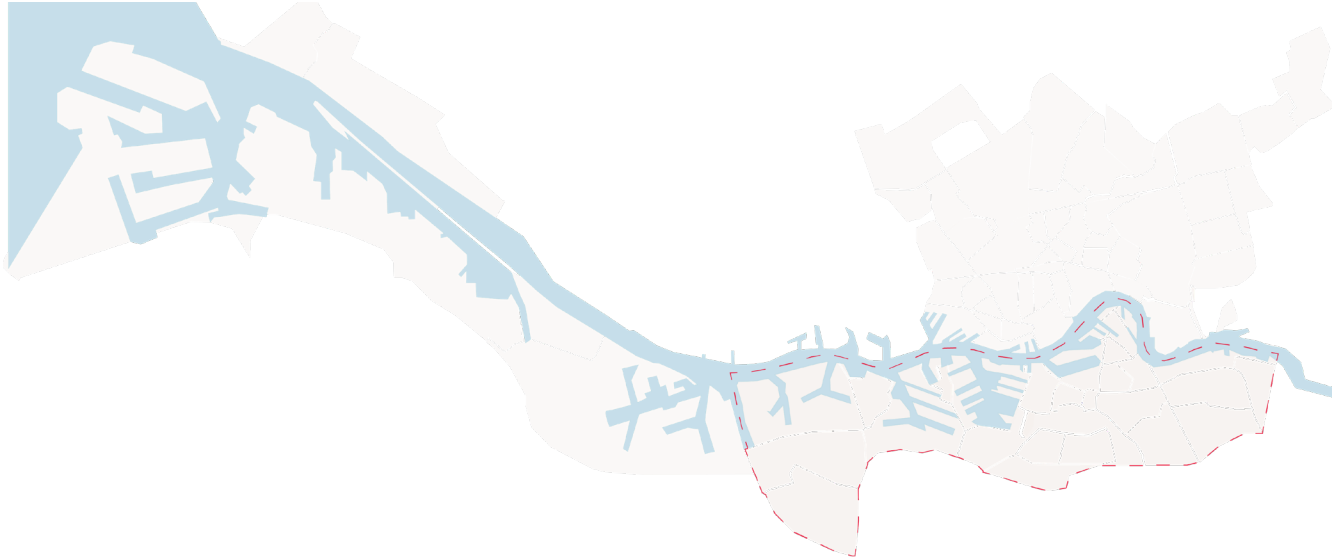

# Graphs

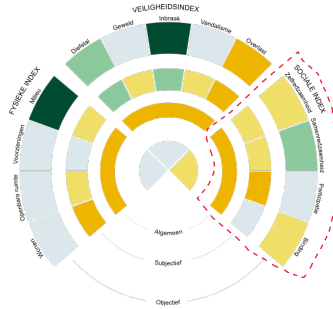

Charlois

Lid zijn van een vereniging, 4 t/m 11 jaar  
Charlois

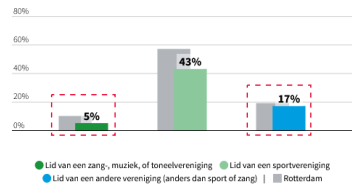

Feijenoord

Lid zijn van een vereniging, 4 t/m 11 jaar  
Feijenoord

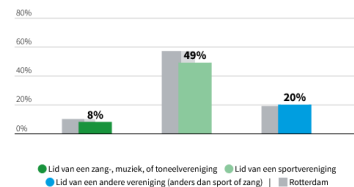

IJsselmonde

Lid zijn van een vereniging, 4 t/m 11 jaar  
IJsselmonde

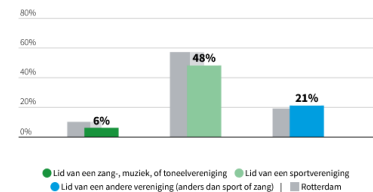

# Tarwewijk

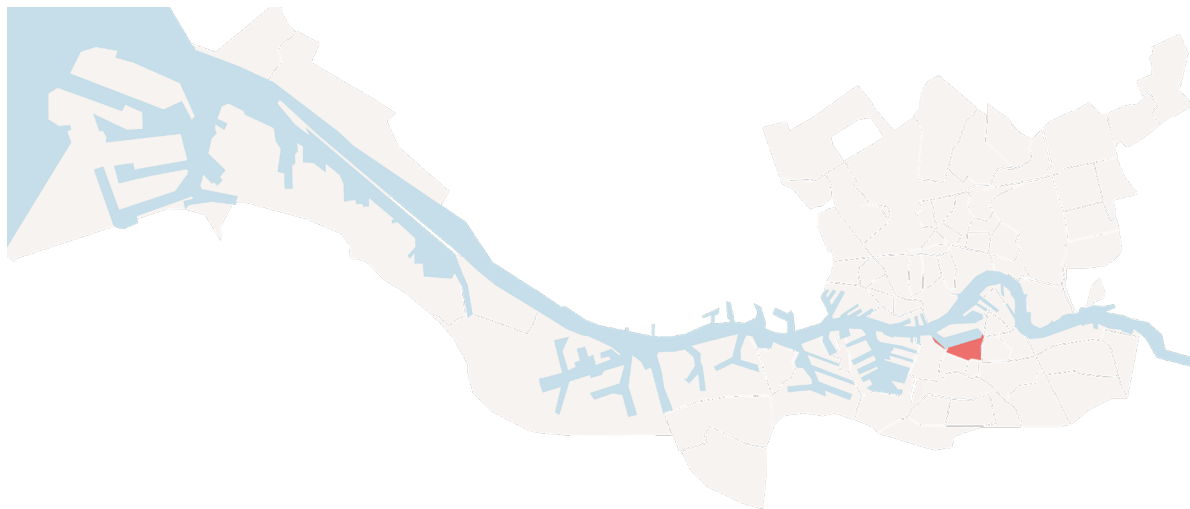

# Tarwewijk



# Culture policy

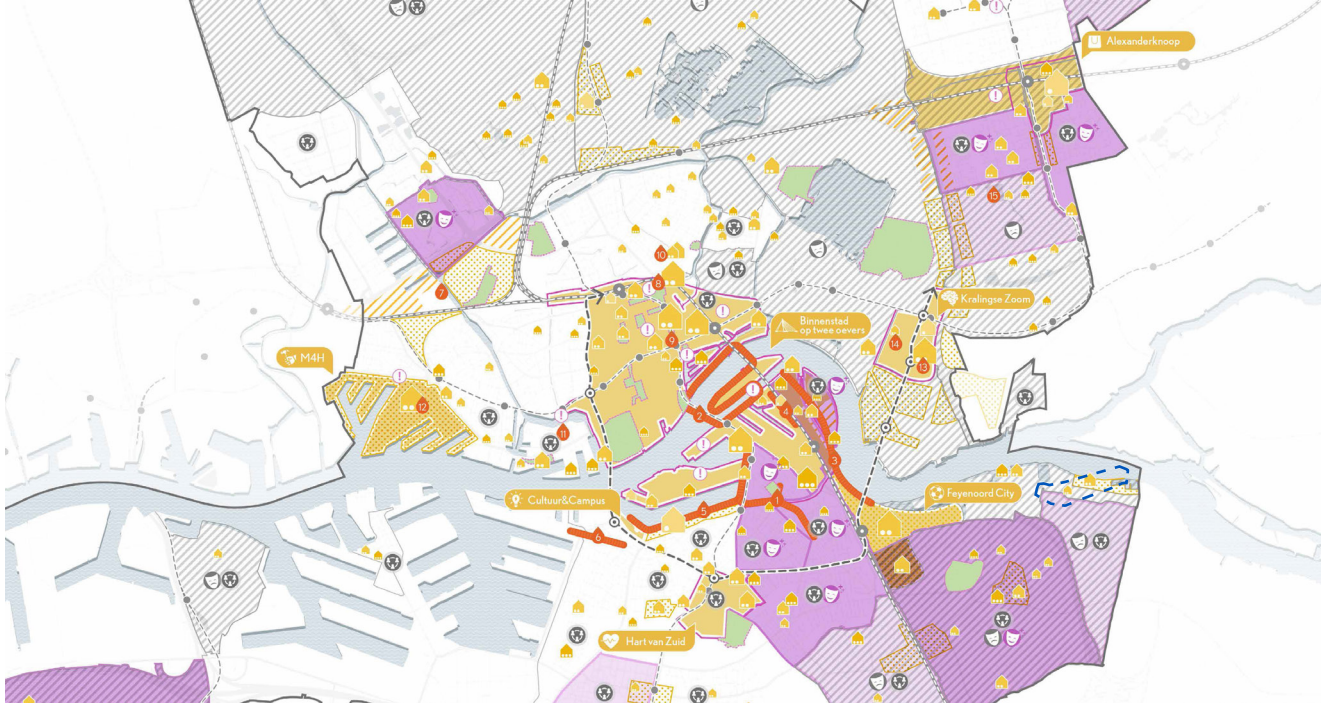

# Culture policy



# Amenities/accessibility

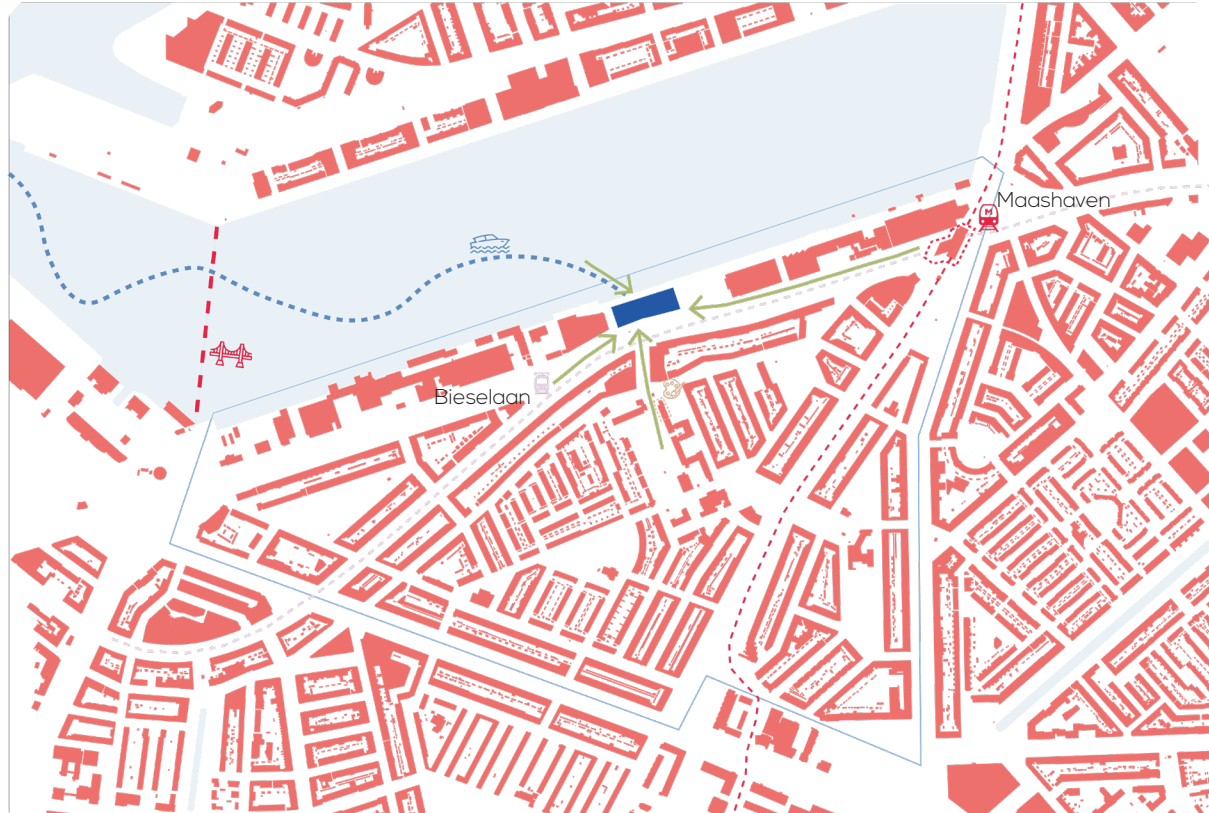



# Location





# Form development

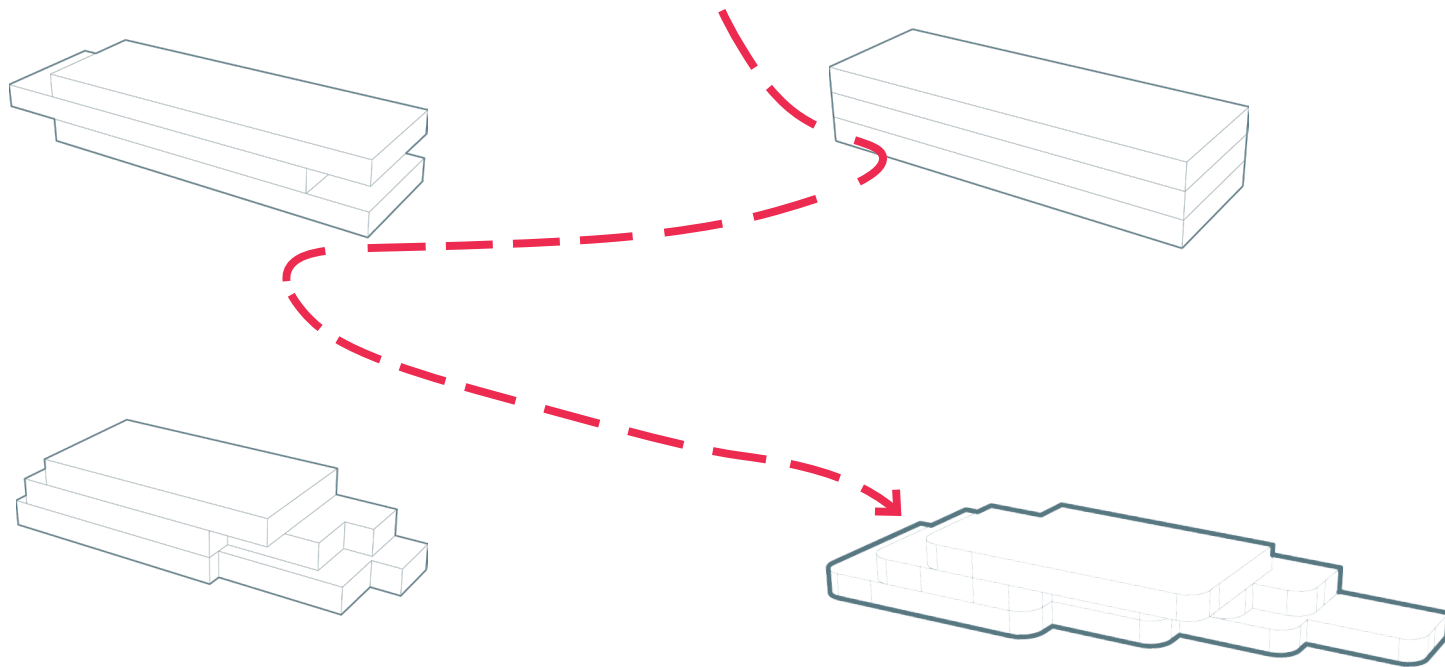

# Form in context

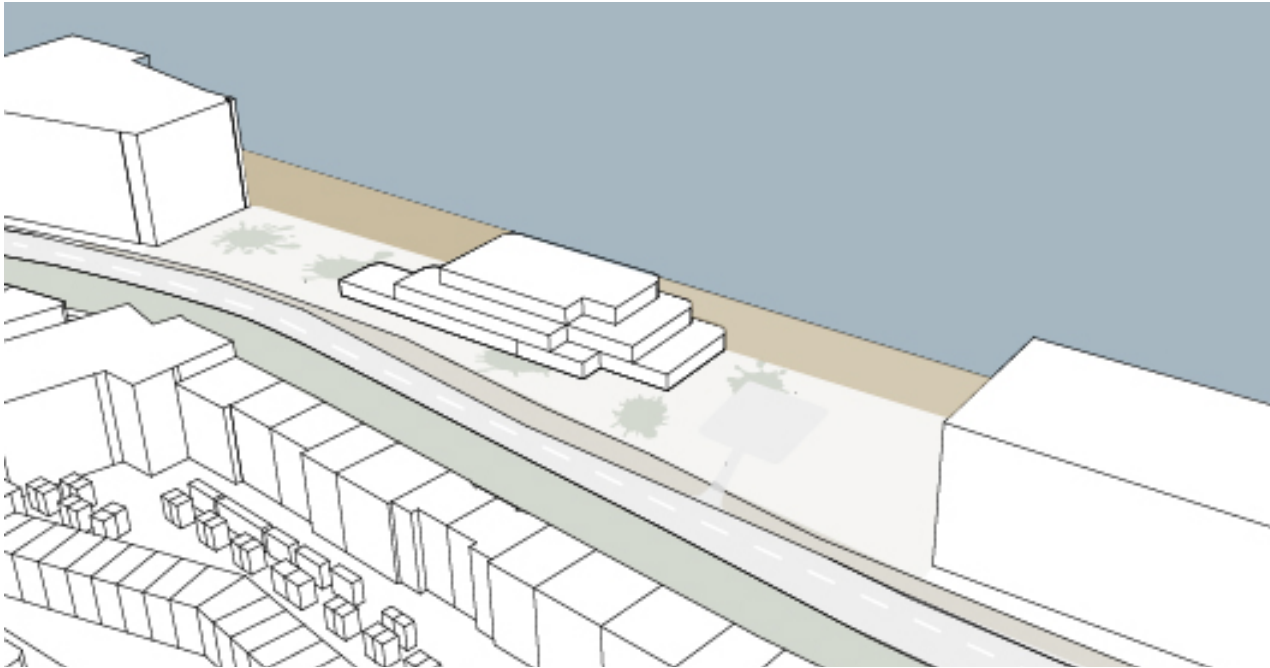

# Approach

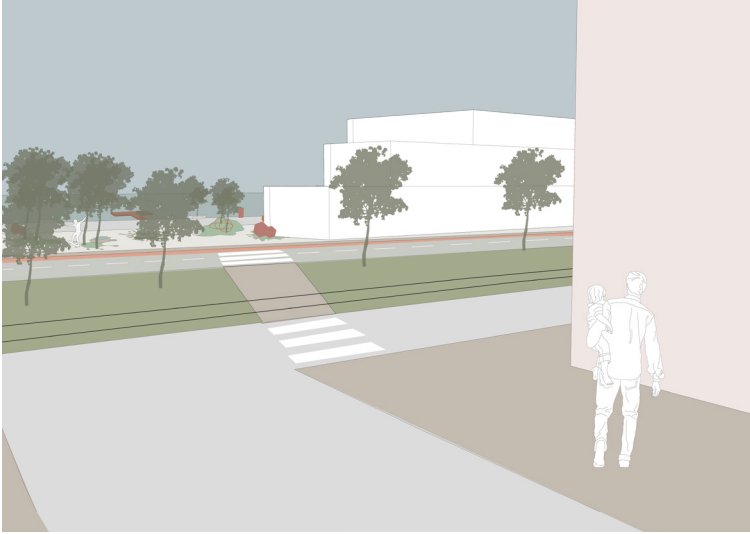

Tarwewijk



Boulevard

# Program

## Ground floor



## First floor



## Second floor



# Program

## Ground floor



## First floor



## Second floor



# Program

## Ground floor



## First floor



## Second floor



# Outdoor space

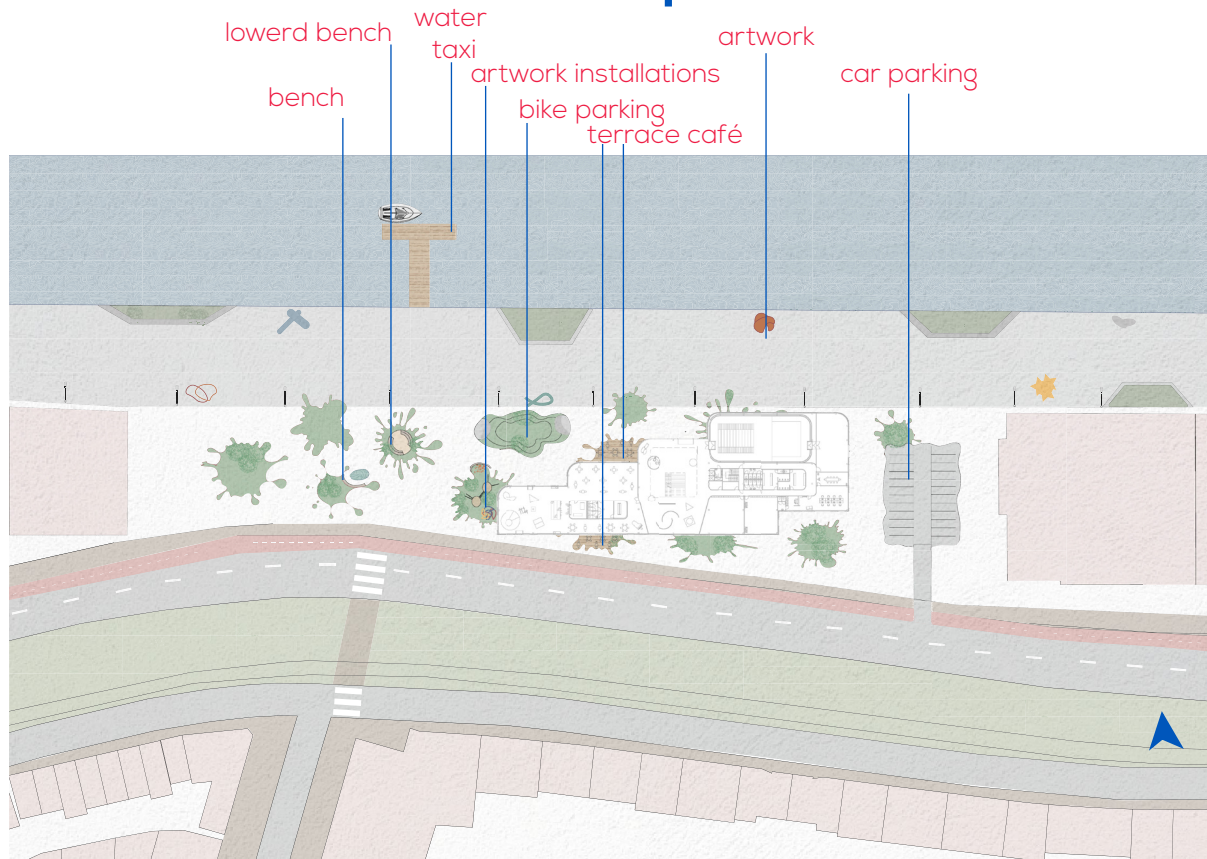

# Bicycle parking

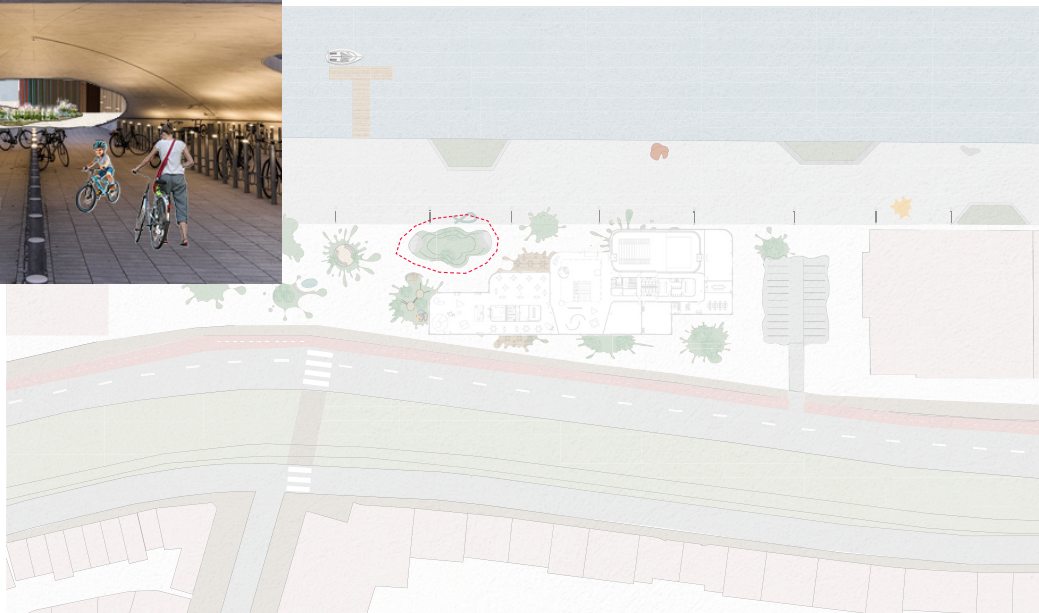



# Outdoor space



# Entrance



# Atrium



# ground floor

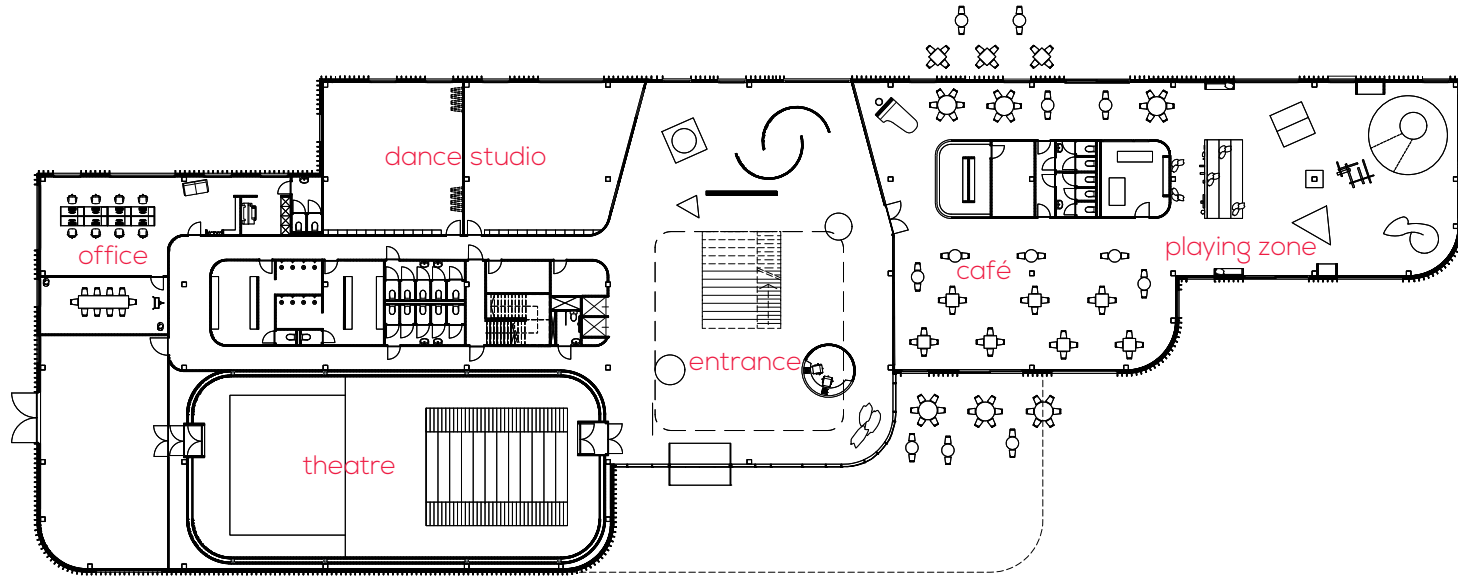

# first level

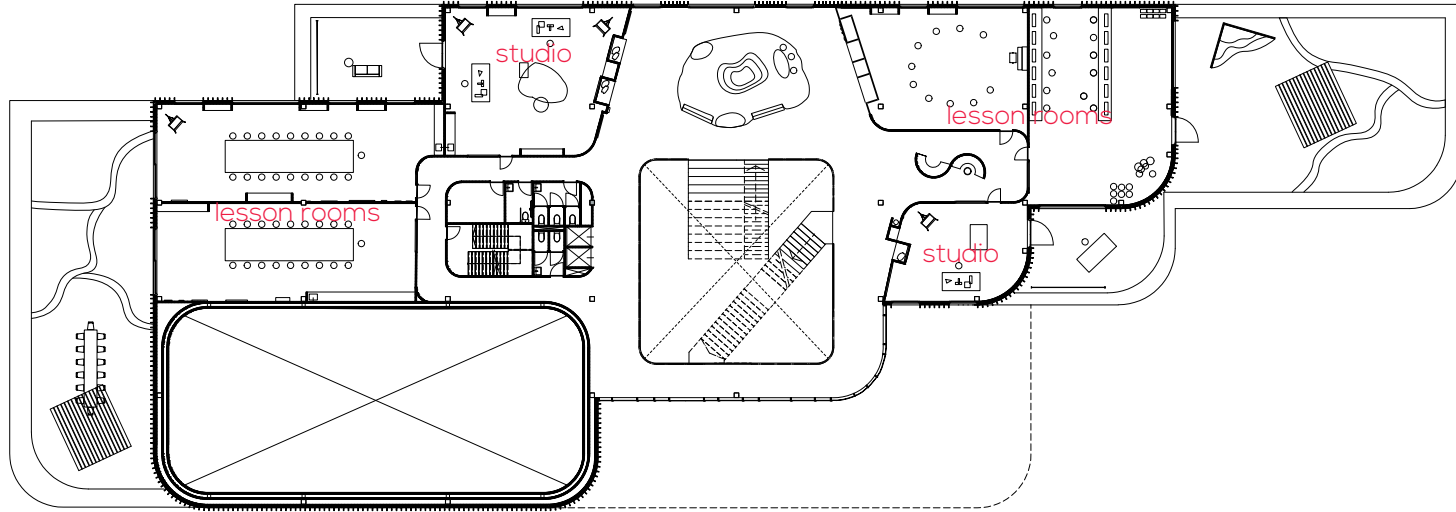



# Interior children

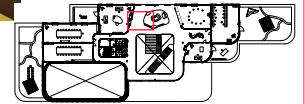

# Interior children

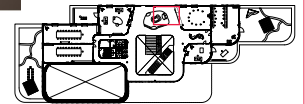

# first level

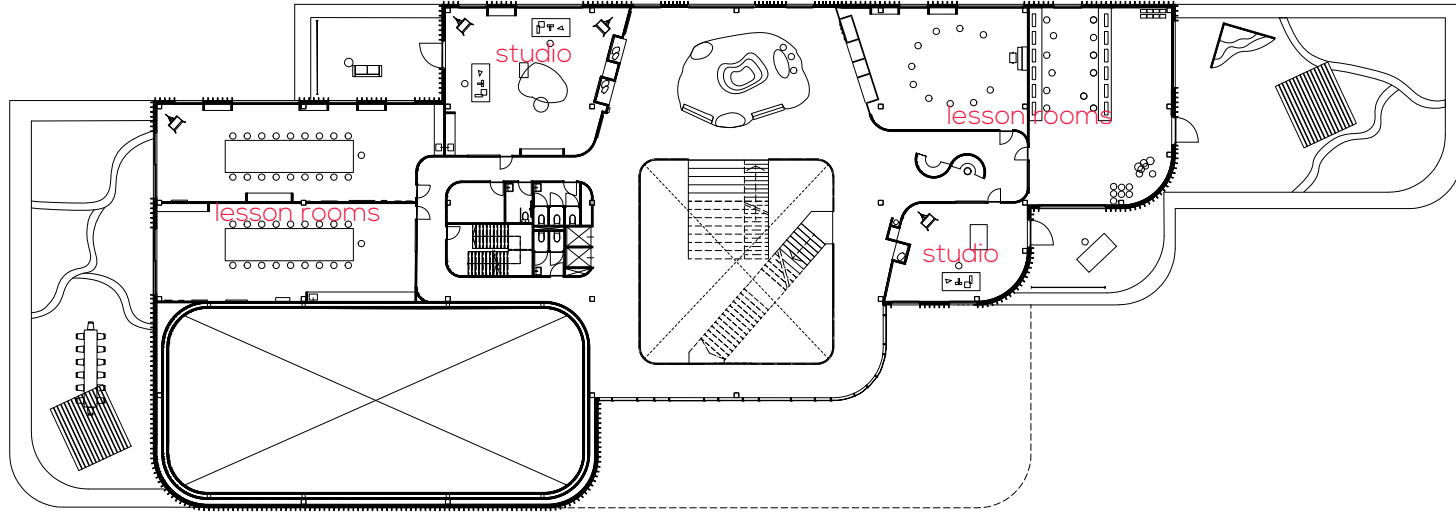



# Second level

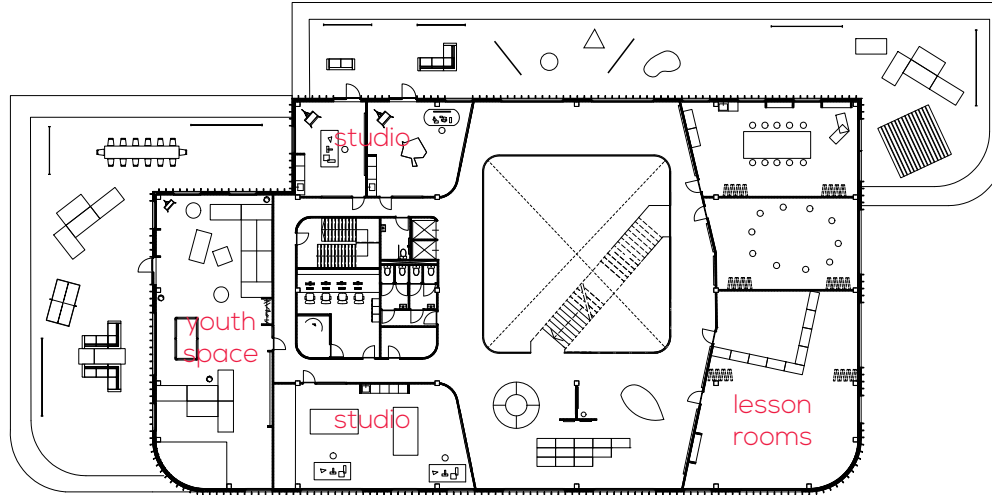

# Interior youngsters

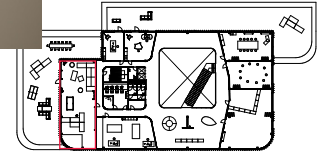

# Second level

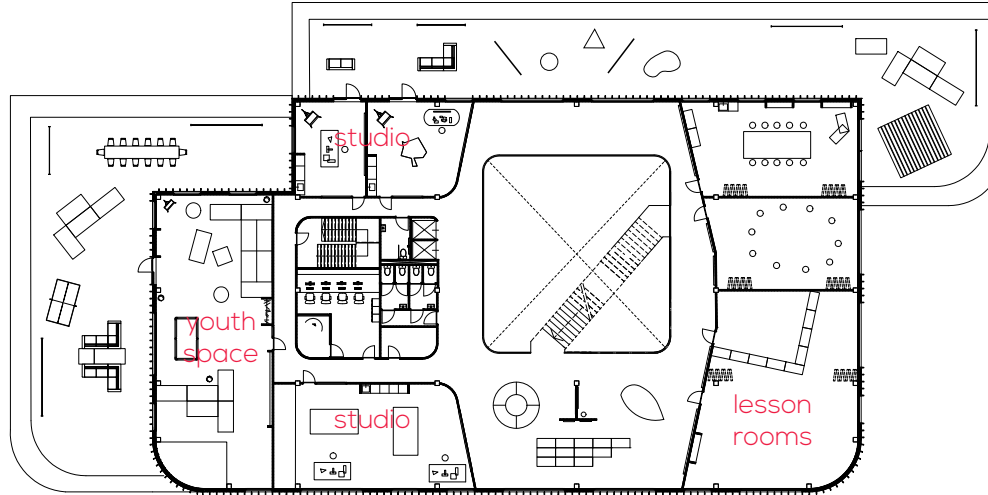

# Section

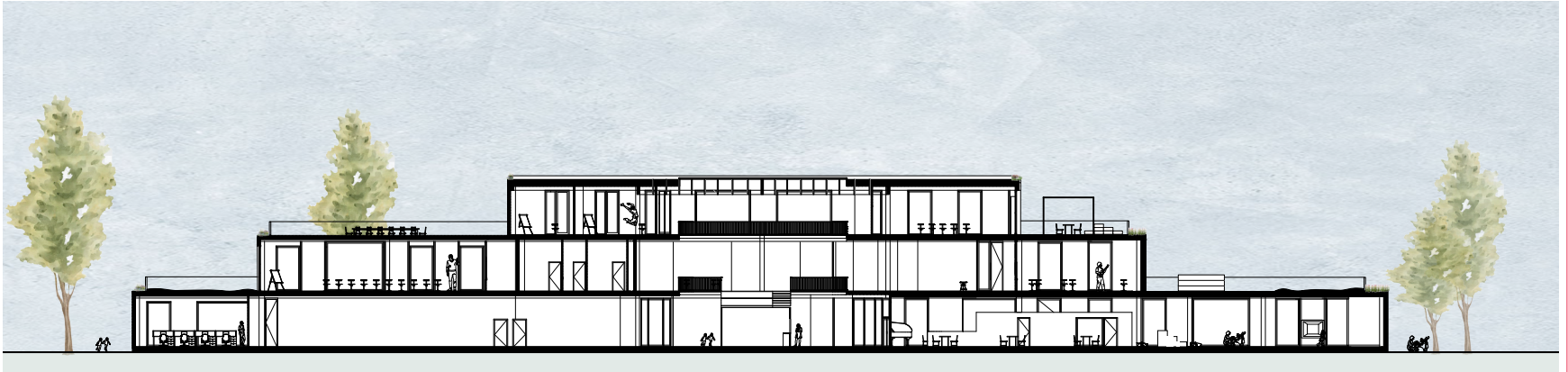

# Facade



north



# Facade



South

# Climate design - winter

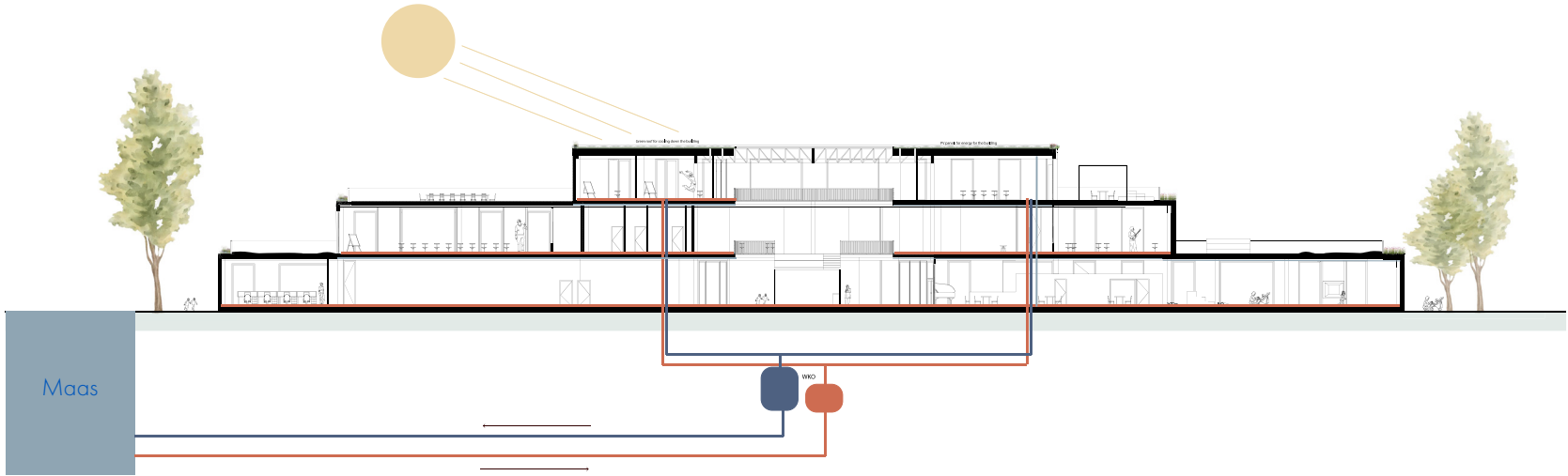

# Climate design - summer

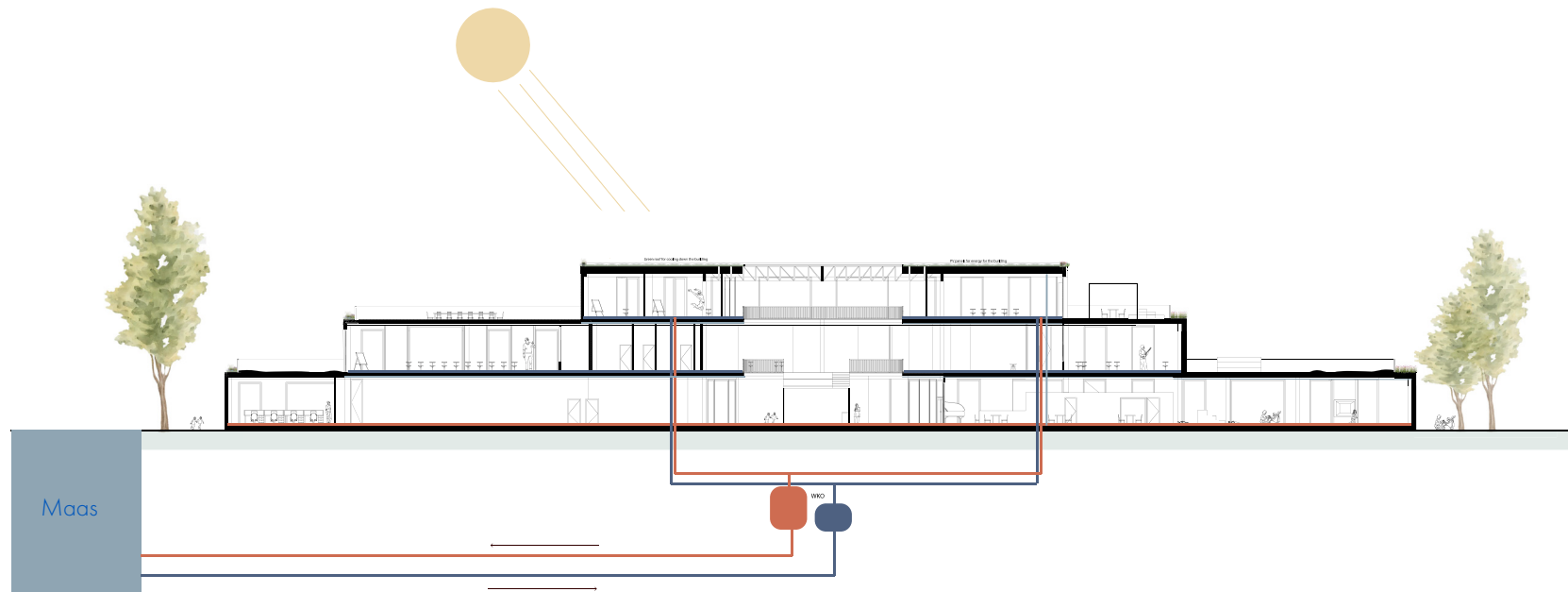



# Kunsthaven



“People have a right to art  
[...] Art is for everyone”  
~ Keith Haring