

AR3MET105 Methods of Analysis and Imagination: A Matter of Scale

P4 Reflection

Xiang Yun

5796563

1. Project Introduction

My project is a tourist center located in the Tallinn harbor area. Its functions include tourist guidance, exhibitions, and a bus station. Through this project, I aim to provide tourists with a deeper understanding and appreciation of the city. Additionally, besides serving tourists, it offers a comfortable public space for the surrounding urban environment, enhancing the connection with nearby areas.

It is designed to be a transitional space within the urban environment and the first impression visitors have of the city. Therefore, I have paid special attention to the connection between the interior and exterior environments of the building. The center utilizes Estonia's most iconic wood and recycled limestone, integrating them with the existing limestone walls on the site. My hope is for it to become a window through which people can learn about the city.

2. Current Project Status

Since P3, my project has focused primarily on structure and materials, while simultaneously advancing functionality, aesthetics, and form. Currently, I have determined the specific construction methods for the main structure, which include not only the connections within a single material—timber—but also the connections between different materials, such as timber and limestone. Moreover, after completing the primary structural work, I also designed the decorative elements and other secondary constructions that affect the user experience within the building.

I am pleased that I did not limit my design to the materials of the main structure alone but explored and incorporated other materials that enhance the spatial experience through model tests. Beyond materials, considerations of climate design have significantly aided the development of my project, ensuring that the structure not only provides support but also really serves the users.

For the building itself, I have completed the functional layout in both horizontal and vertical spaces, organized closely around the structure. Externally, I have consistently worked to strengthen the connection between the building and the urban space. How can the building become a natural part of the urban fabric? How can the external spaces of the building be made more attractive? How can the extension of the structure facilitate the transition between interior and exterior spaces? These questions have driven the development of my project, and I am pleased that they have been addressed through design.

As of the P4 presentation, I believe I have completed a feasible and comprehensive architectural project design. More importantly, the work experience throughout this journey has been thorough and coherent, allowing me to benefit greatly. Admittedly, there are still areas for improvement,

and I will continue to refine this project in the next phase of my work.

3. Work experience

During P1, I found my area of interest based on an understanding of the city of Tallinn; in P2, I identified the project site and established the basic functions and form of my project; in P3, I completed the main architectural structure; and in P4, I refined various construction details and material effects based on the foundation laid in P3.

Our studio's name includes the word "scale," which inspired me to always approach problems from different scales. For example, at the start of P2, while I had some interest in urban public spaces, I had no idea what type of building to design or where to locate it. However, the multi-scale approach helped me gradually pinpoint the most suitable site for my project. Macro-scale analysis ensured that my site could impact a sufficient range of urban space, while focusing on a micro-scale allowed me to determine specific project functions. This laid a solid foundation for my subsequent work.

Additionally, this course is about methodology. From the beginning, my tutor guided us to explore the integration of research and design, which greatly inspired me. Initially, at the start of P3, I struggled to adapt to the mode of developing structure and other aspects simultaneously each week. However, under our tutors' guidance, I slowly realized that different parts of the work are ultimately interconnected, and the development of one aspect inevitably supports the others. I began to try coordinating different parts of the work. For instance, I used physical models to explore local structures and material effects while also using 3D modeling to adjust the overall design. This ensured that I always had a clear understanding of my spatial effects.

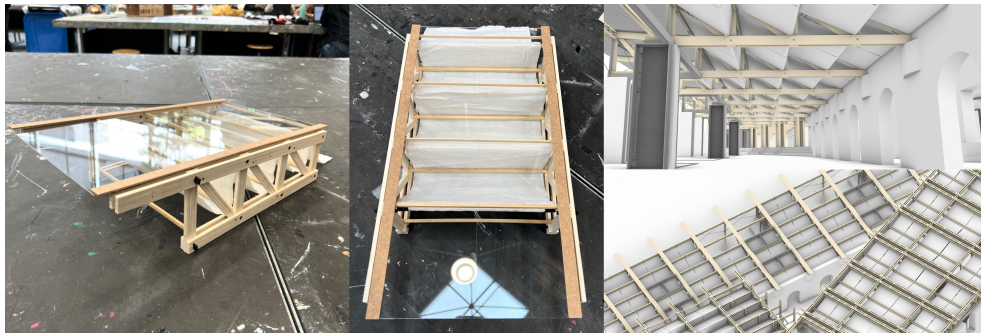

Test roof effect with physical model and 3D model.

In conclusion, as I mentioned earlier, this process has been coherent and progressive, teaching me not only the research methodology from investigation to problem discovery and resolution but also the workflow from an empty site to a feasible project. This, I believe, is what I envision for a graduation project.

4. Research Plan Adjustment

I would like to specifically mention the adjustments I made to my research plan. During P1, due to the uncertainty of the site location, I proposed only a general direction for development. I called it "urban corner spaces," driven by my interest in urban public spaces and aiming to explore the potential of small spaces in the city that have not been properly utilized. As my work progressed, I

gradually clarified my project objectives. My research focus shifted from "corner spaces" to how urban public spaces transition and connect with their surroundings.

I believe this shift is not a denial or waste of the work done in P1 but a necessary evolution that came with a deeper understanding of the research subject. In fact, my research focus and interests have not changed; I have simply found a more precise way to describe the issues I encountered. Clarifying the research question has undoubtedly been beneficial for me to continue refining my project in a targeted manner.

5. Next Stage Plan

Firstly, due to the changes in the research plan, I need to adjust the previously outlined narrative approach. Therefore, before P5, I will continue to refine the overall logic and key themes of the project.

Secondly, I will address and enhance the issues raised in the feedback from P4, thereby improving the completeness of the project.

Lastly, I will consider the presentation format of the project, including graphical representations, model expressions, and other ways that contribute to showcasing the project effectively.