

Inventory

Material analysis of the Molenpoort

2020/2021

Urban Architecture - Studio Bricolage

Alessandro de Cadilhac, Jasmine Montina, Kamelia Marinkoyova, Louise Gillett, Robert Bichlmaier, Sofia Pavlova, Tomi Akinyemi, Vittoria Poletto, Stanislaw Klajs, Aleksandra Wróbel

Content

Introduction

Steel

Atrium

Stairs

Tiles

Windows external

Windows internal

Introduction

The 'Material Inventory of Molenpoort' is a catalogue of the available materials and building elements of the Molenpoort shopping mall, the site for our project, which is planned to be demolished by the Municipality of Nijmegen in the near future. The collection embodies a collective piece of work, stemming from the shared interest in investigating the levels of reuse which are possible within the Molenpoort, which is seen as a valuable resource, and rejects the idea of an ex-novo approach to the built environment, where pre-existing elements and structures are mindlessly demolished and discarded.

As the main concrete column and slab structure becomes the base onto which our designs and urban plans take form, our interest brought us deeper in the exploration of what are the other building elements which compose the shopping mall, and which can be extracted, treated and reused.

By means of a substantial presence on site, careful measuring, observing and re-tracing of the mall's details, we were able to obtain precise plans, as well as photographic documentation of the current state of the mall. Through an attentive analysis of the detailed drawings found in the Archives and the collected precise information on location, we were able to extract detailed information on exactly which components could be taken apart and reused in a possible future project. This resulted in a collection of doors, windows, balustrades, glass panels, stairs and steel structures, which are precisely drawn and dimensioned, located within the mall via a key plan, and each given a specific name and number in relation to its location and type.

It is worth mentioning that discussions with a professional structural engineer and a workshop with Rotor (a Belgian company with years of expertise on reuse and extraction) helped refine the catalogue and further informed us on the complexities of material reuse. From this, we came to the realisation that many of the elements within the mall could not be extracted intact or be reused at all, as a reflection of the building methods used in the past decades, when the building was built (1972) and then renovated.

Our aim for the inventory is to bring awareness to the importance of an attentive observation and understanding of the existing building so as to bring forward the particular material culture of Molenpoort and its value as a source of reusable materials from something that is otherwise considered useless and to be demolished.

Structural Elements

- Tweede Walstraat Ramp

Steel Columns and Beams

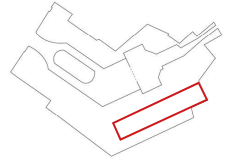

Photo Source: Opalis.eu



Steel - Tweede Walstraat Ramp

HEA 120

StT.01

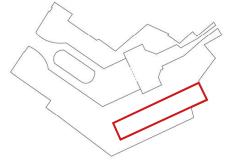

Cross Section 1:5

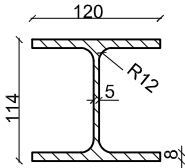

Elevation 1:50

600
StT.01

Steel - Tweede Walstraat Ramp

HEA 160

StT.02-09

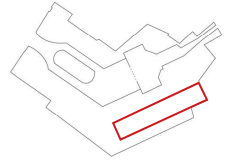

Cross Section 1:5

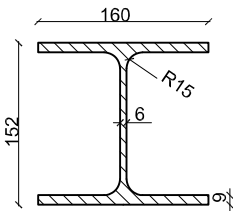

StT.02
StT.03
StT.04-09

1215
1235
1255

x6

Elevations 1:50

Steel - Tweede Walstraat Ramp

HEA 180

StT.10-27

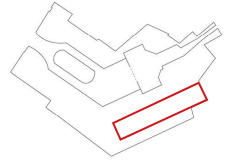

Cross Section 1:5

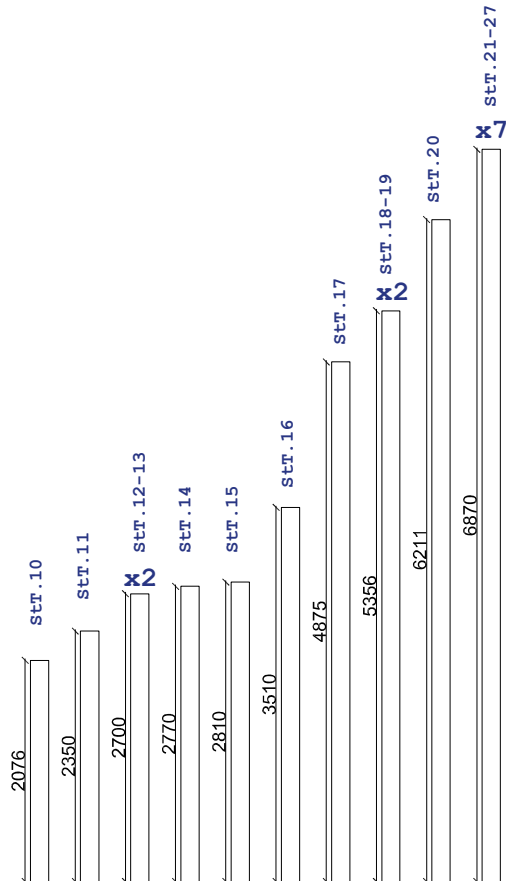
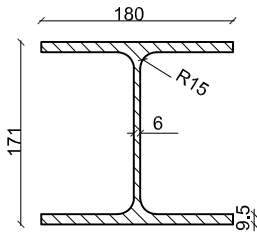

Elevations 1:50

Steel - Tweede Walstraat Ramp

HEA 200

StT.28-33

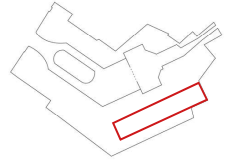

Cross Section 1:5

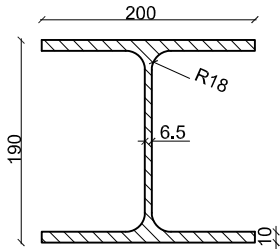

Elevations 1:50

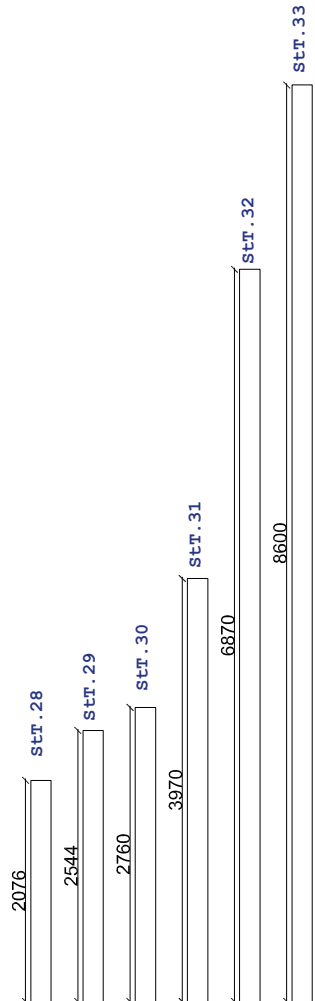

Steel - Tweede Walstraat Ramp

HEA 220

StT.34-39

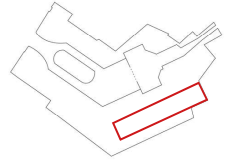

Cross Section 1:5

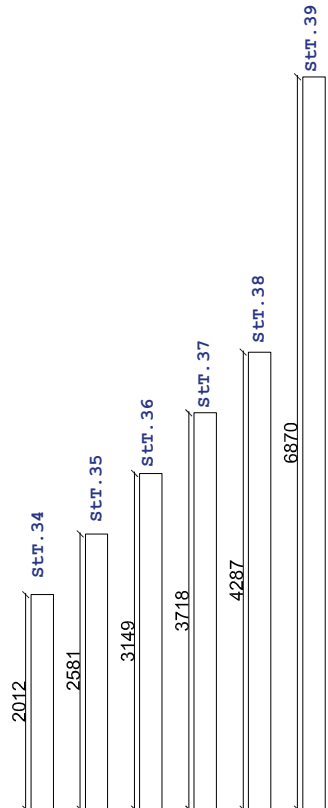
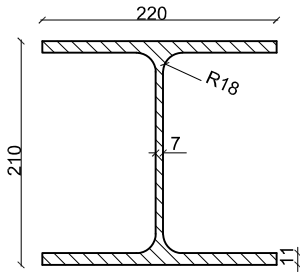

Elevations 1:50

Steel - Tweede Walstraat Ramp

HEA 240

StT.40-43

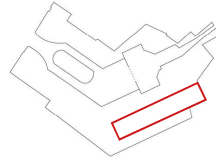

Cross Section 1:5

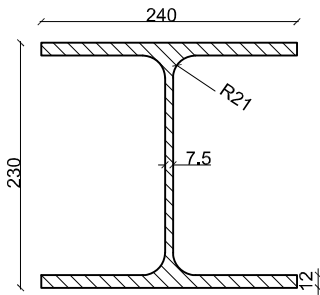

Elevations 1:50

1565



StT.40-42

13720

StT.43

Steel - Tweede Walstraat Ramp

HEA 260

StT.44-50

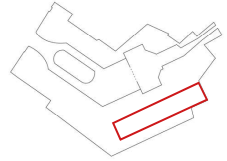

Cross Section 1:5

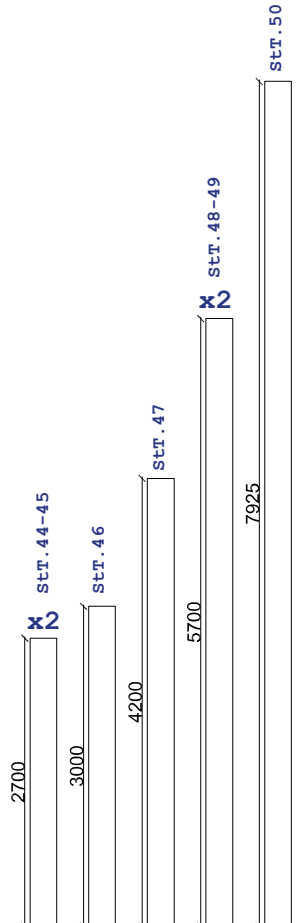
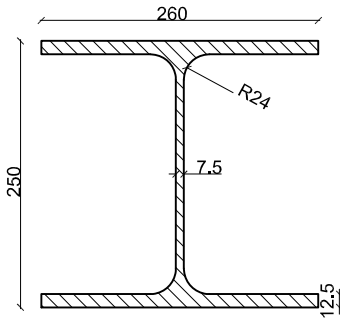

Elevations 1:50

Steel - Tweede Walstraat Ramp

HEB 300

StT.51-57

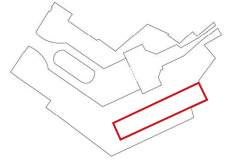

Cross Section 1:5

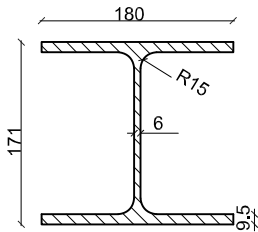

X 6 StT.51-56

StT.57

7855

7875

Elevations 1:50

Steel - Tweede Walstraat Ramp

HEA 360

StT.58-60

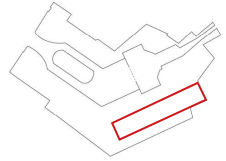

Cross Section 1:5

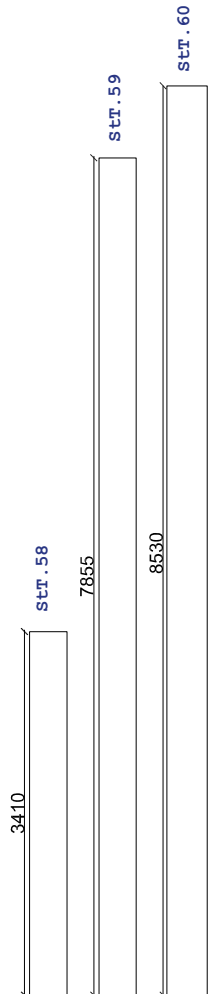
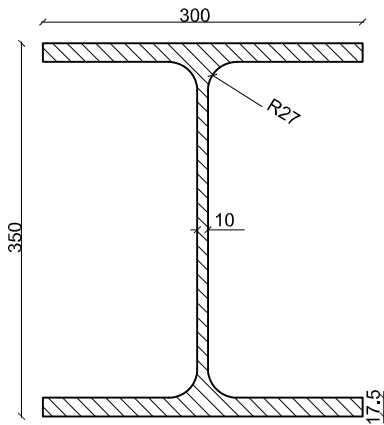

Elevations 1:50

Steel - Tweede Walstraat Ramp

IPE 200

StT. 61-71

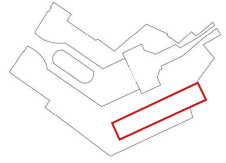

Cross Section 1:5

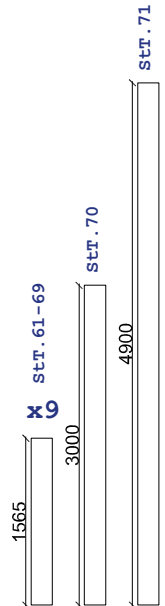
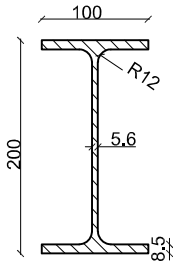

Elevations 1:50

Steel - Tweede Walstraat Ramp

IPE 220

StT.72

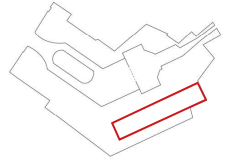

Cross Section 1:5

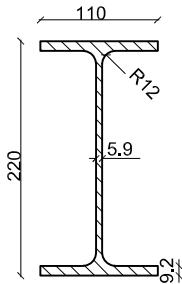

Elevation 1:50

Steel - Tweede Walstraat Ramp

IPE 360

StT.73

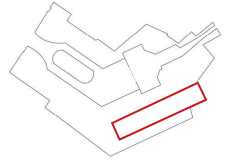

Cross Section 1:5

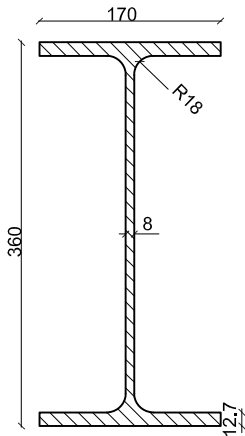

Elevation 1:50

Steel - Tweede Walstraat Ramp

UNP 140

StT. 74-84

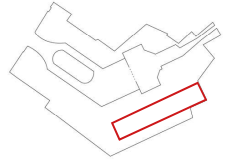

Cross Section 1:5

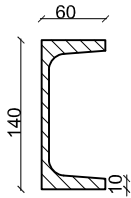

StT. 74-84

x11

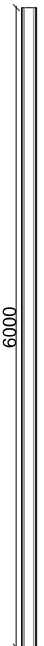

Elevation 1:50

Steel - Tweede Walstraat Ramp

L 200x100x10

StT.85-88

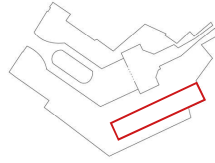

Cross Section 1:5

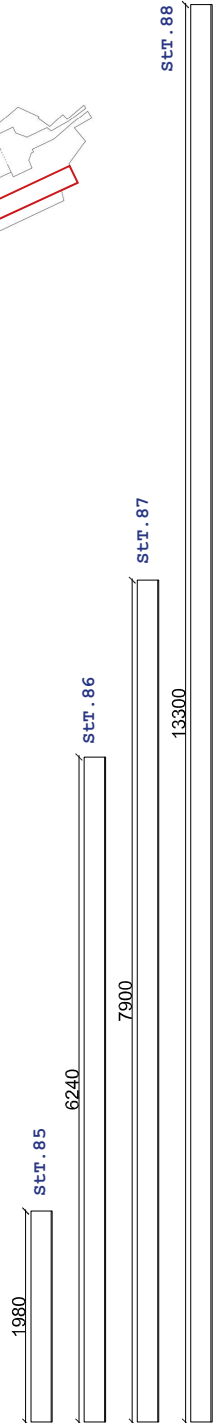
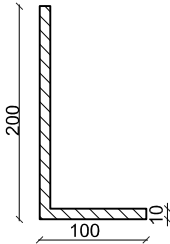

Elevations 1:50

Structural Elements

- Tweede Walstraat Coop Extension

Steel Columns and Beams

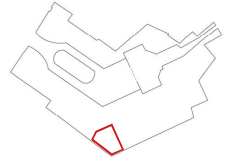

Photo Source: Opalis.eu



Steel - Tweede Walstraat Coop Extension

HEA 180

StT. 89-90

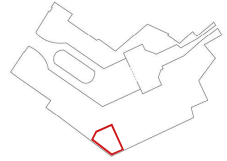

Cross Section 1:5

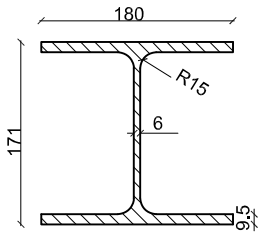

Elevations 1:50

Steel - Tweede Walstraat Coop Extension

HEA 220

StT. 91

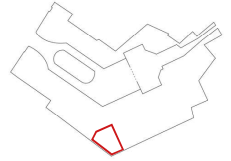

Cross Section 1:5

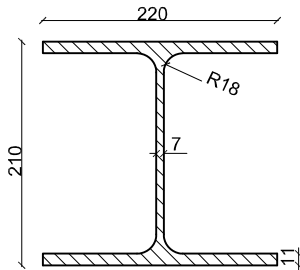

Elevation 1:50

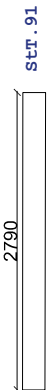

Steel - Tweede Walstraat Coop Extension

HEA 240

StT. 92-97

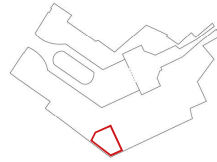

Cross Section 1:5

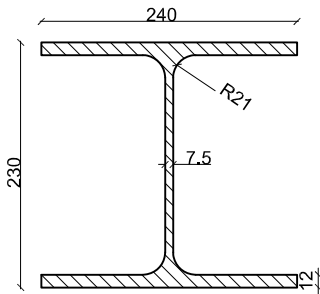

5680 StT. 92

7030 StT. 93

8600 StT. 94-95 x2

11330 StT. 96

14800 StT. 97

Elevations 1:50

Steel - Tweede Walstraat Coop Extension

HEB 260

StT.98

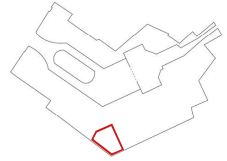

Cross Section 1:5

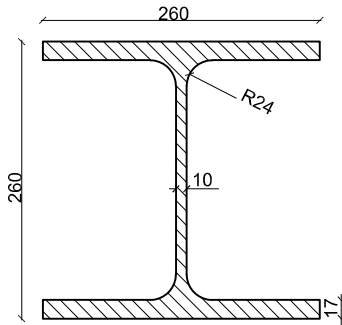

Elevation 1:50

Steel - Tweede Walstraat Coop Extension

HEA 340

StT. 99-101

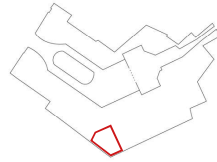

Cross Section 1:5

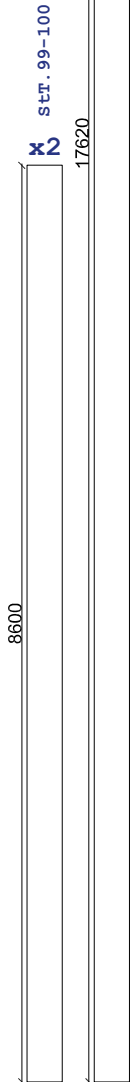
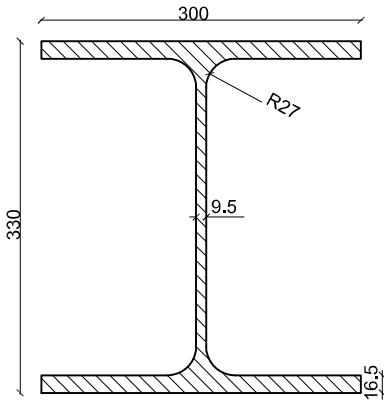

Elevations 1:50

Steel - Tweede Walstraat Coop Extension

IPE 300

StT.102-103

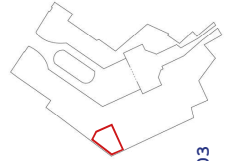

Cross Section 1:5

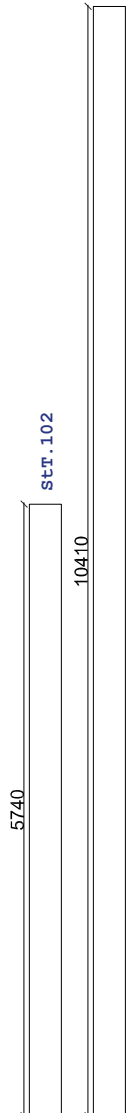
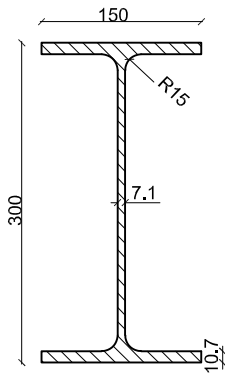

Elevations 1:50

Steel - Tweede Walstraat Coop Extension

IPE 400

StT.104

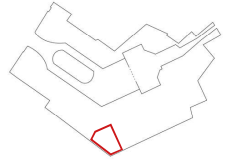

StT.104

Cross Section 1:5

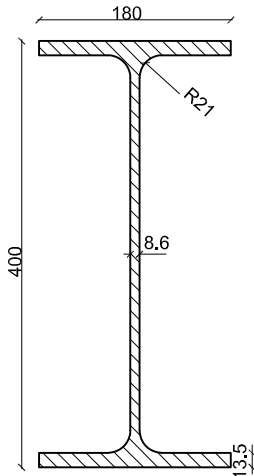

Elevation 1:50

Steel - Tweede Walstraat Coop Extension

IPE 450

StT.105

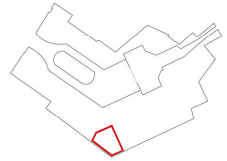

Cross Section 1:5

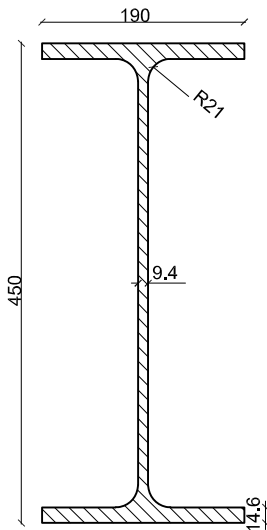

Elevation 1:50



Steel - Tweede Walstraat Coop Extension

UNP 220

StT.106

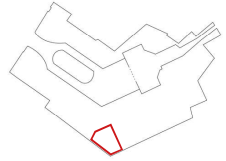

Cross Section 1:5

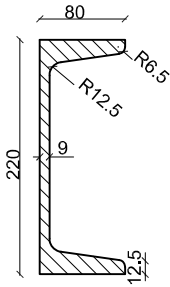

Elevation 1:50



Steel - Tweede Walstraat Coop Extension

L 150x100x10

StT.107-110

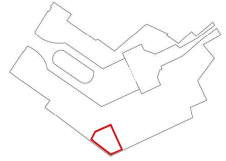

Cross Section 1:5

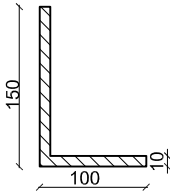

Elevations 1:50

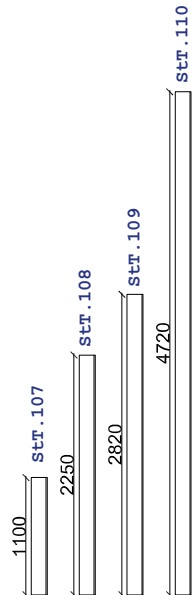

1 : 20

LOCATION

elements/furnishings

Ba. 01



ELEVATION

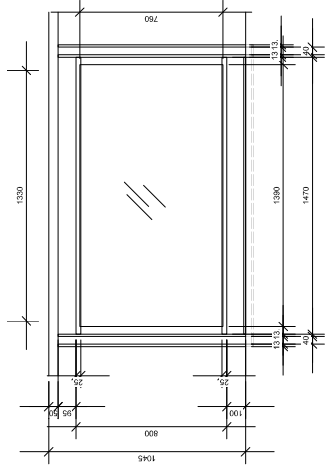

x6

SECTION

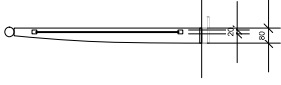

x24

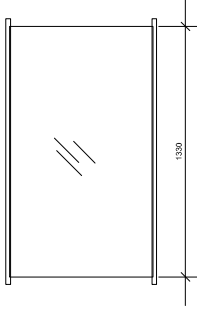

x8

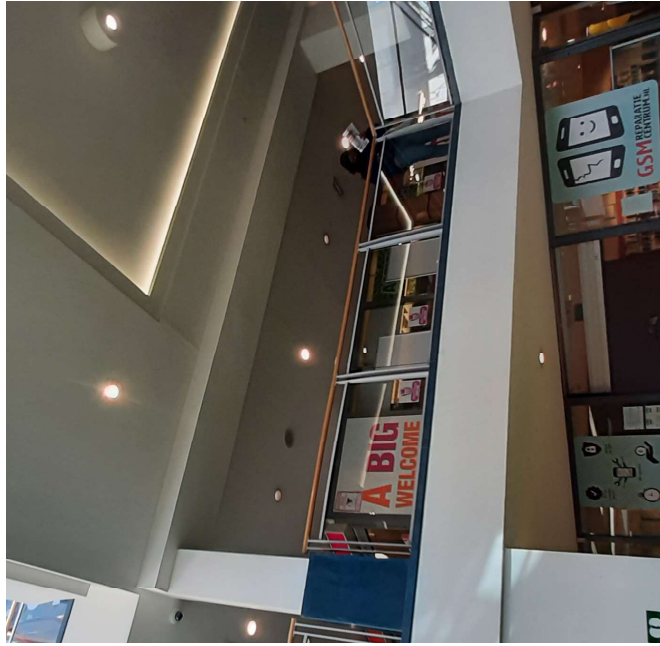
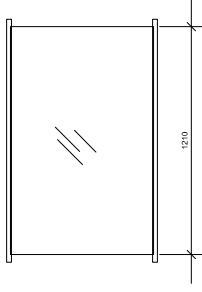

LOCATION



1 : 200

ISONOMETRY

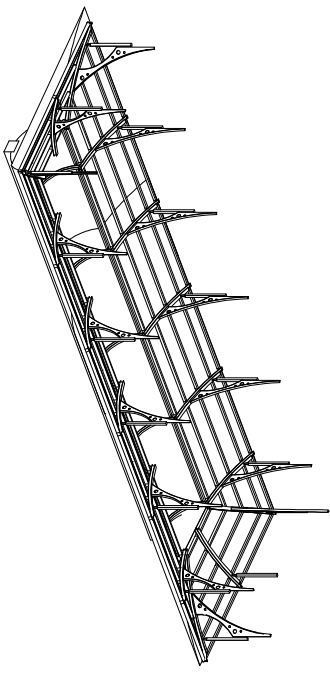

structural elements

A. 01

1 : 100

ELEVATION

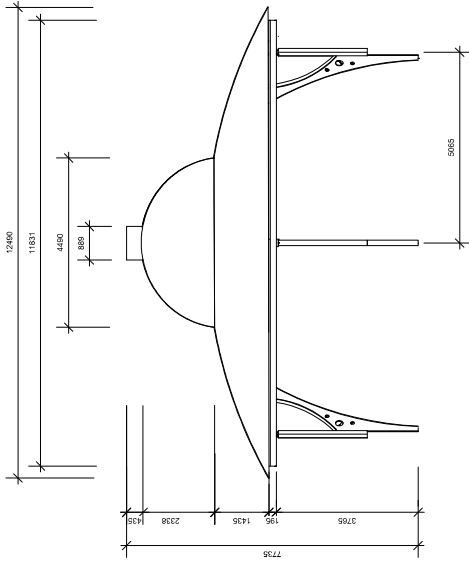

1 : 150

ELEVATION

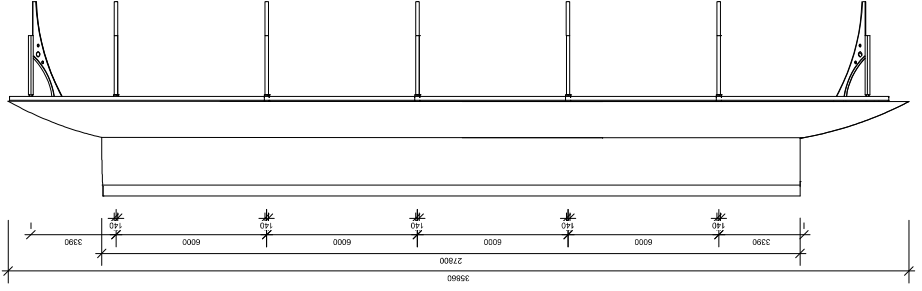

SECTION

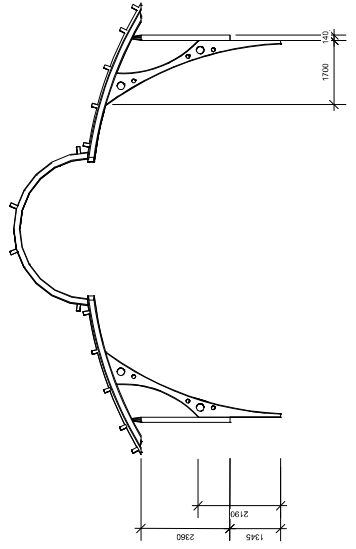

1:1000

elements/furnishings

SS.01

Metal railing SS.01

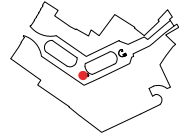

PHOTO



2122



0 / 50

2122

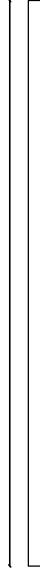

1:1000

elements/furnishings

SS.02

Metal railing SS.02

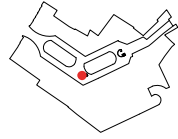

PHOTO



2387



0 | 50

2387



1:1000

elements/furnishings

SS.03

Glass parapets SS.03

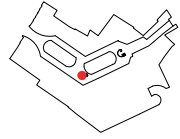

PHOTO



1:20

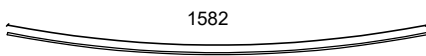
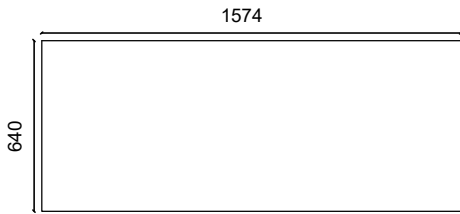

x3

1:1000

elements/furnishings

SS.04

Glass parapets SS.04

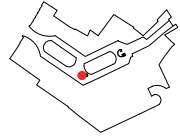

PHOTO



1:20

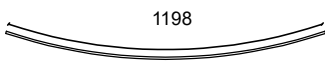
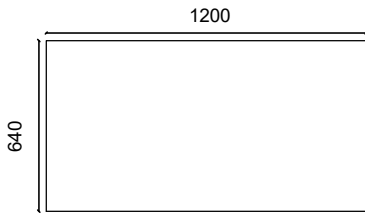

x2

1:1000

elements/furnishings

SS.05

Glass parapets SS.05

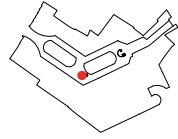

PHOTO



1:20

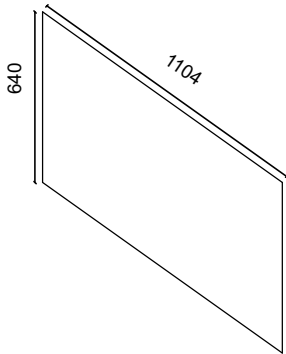

900



x8

1:1000

elements/furnishings

SS.06

Metal railing SS.06

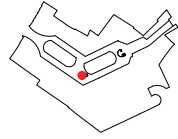

PHOTO



1:10

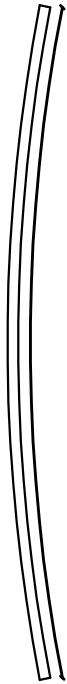

1582

50



X12

1:1000

elements/furnishings

SS.07

Metal railing SS.07

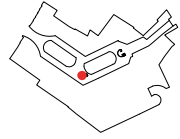

PHOTO



1:10

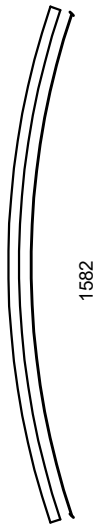

50



x8

1:1000

elements/furnishings

SS.08

Wood railing SS.08

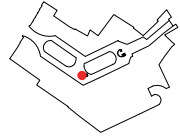

PHOTO



2387



50
01

1:1000

elements/furnishings

SS.09

Wood railing SS.09

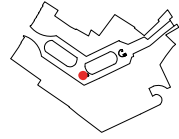

PHOTO



2122



50
01

1:1000

elements/furnishings

SS.10

Wood railing SS.10

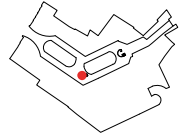

PHOTO



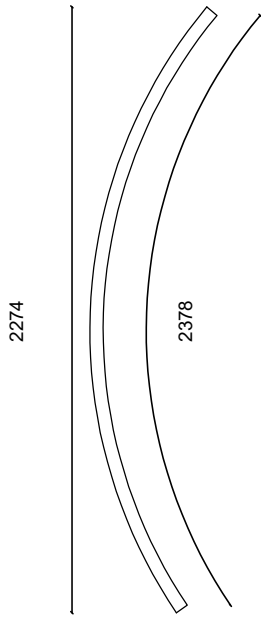

50
O |

1:1000

elements/furnishings

SS.11

Wood railing SS.11

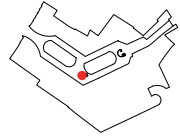

PHOTO



1:20

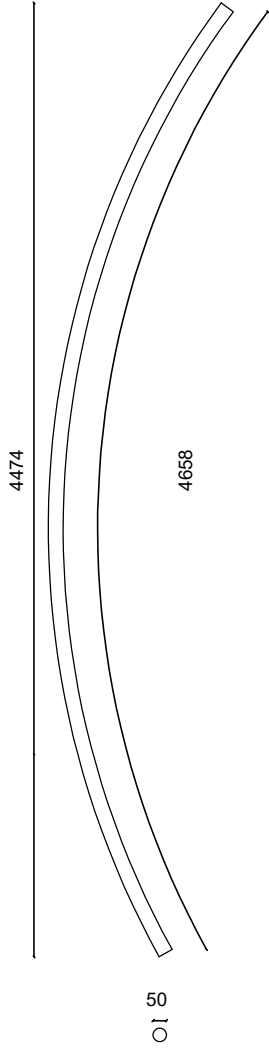

x1

1:1000

elements/furnishings

SS.11

Metal step SS.11

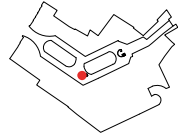

PHOTO



1:20

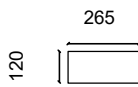
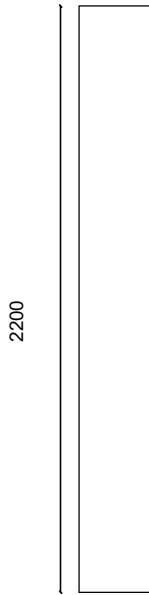

X17

1:1000

elements/furnishings

SS.12

Metal step SS.12

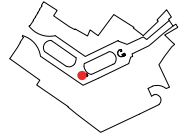

PHOTO



1:20

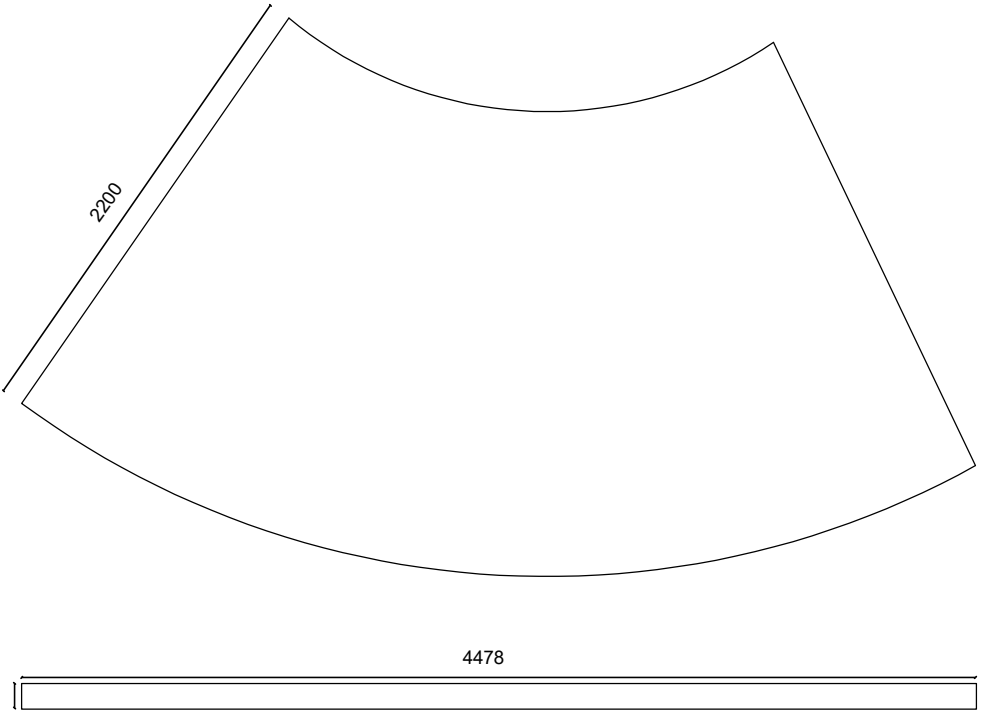

x1

1:1000

elements/furnishings

SS.13

Metal railing SS.13

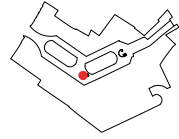

PHOTO



1:10

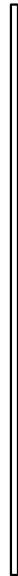
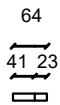
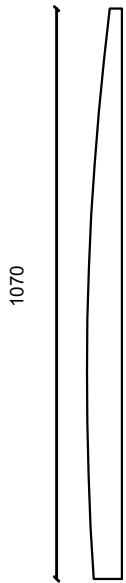

x30

1:1000

Floor tiles

T.00

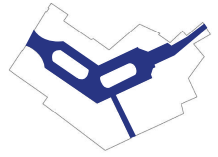

Floor tiles

T.01

white tiles

count: 12 800

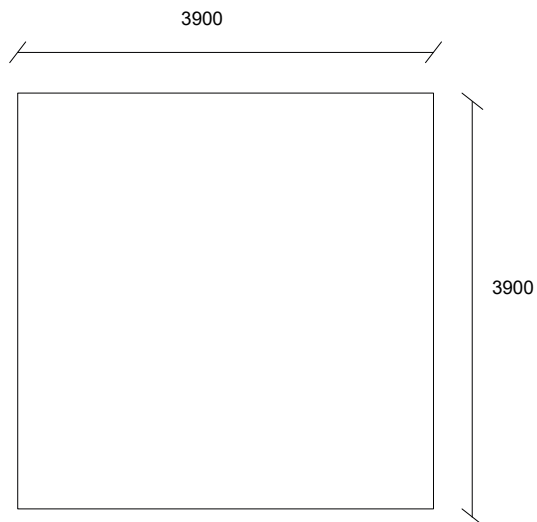

Plan 1:5

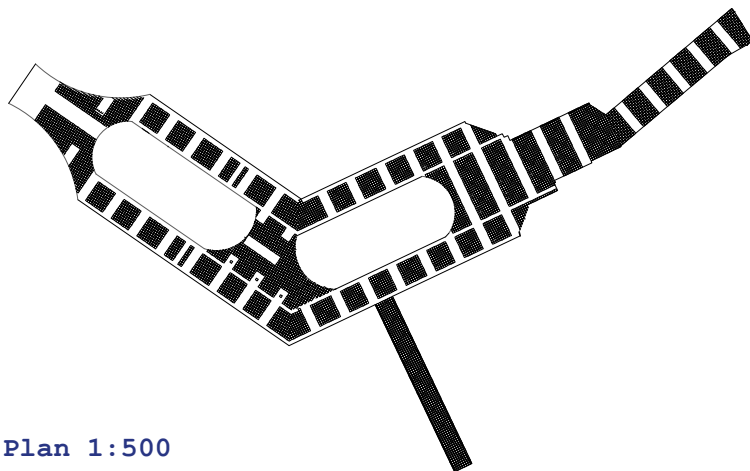

Floor tiles

T.02

red tiles

count: 1 835

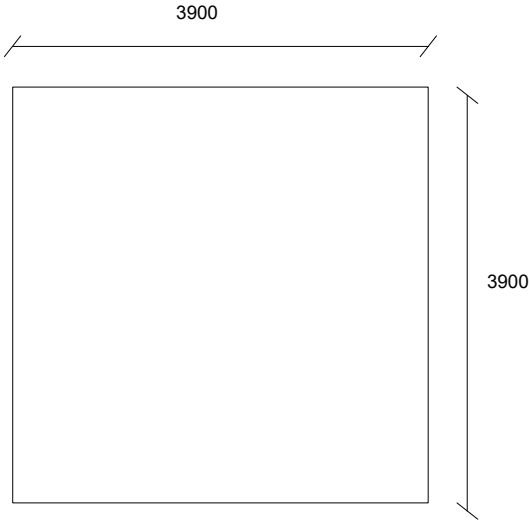

Plan 1:5

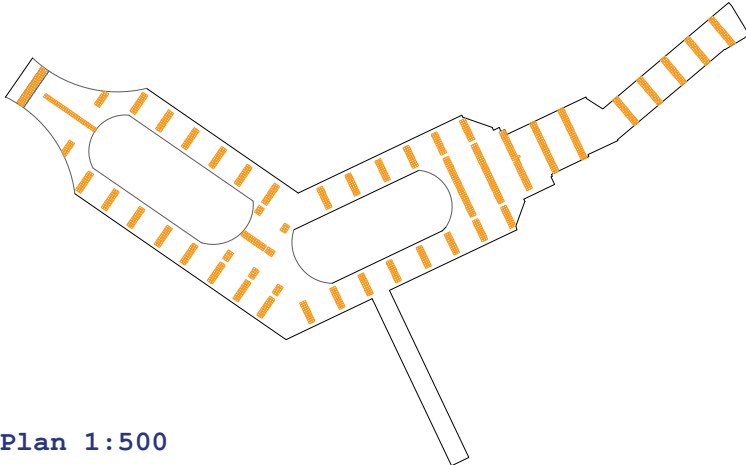

Plan 1:500

Floor tiles

T.03

blue tiles

count: 3 350

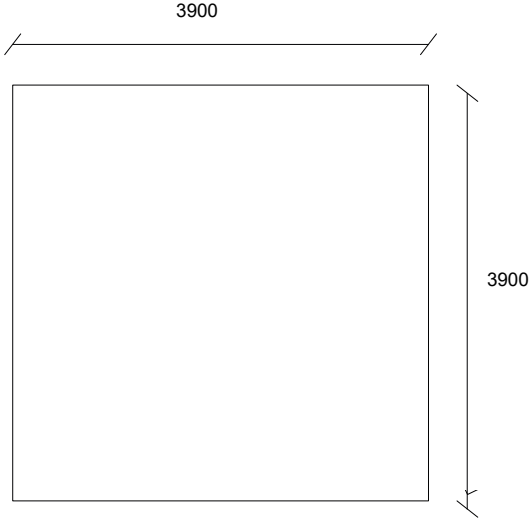

Plan 1:5

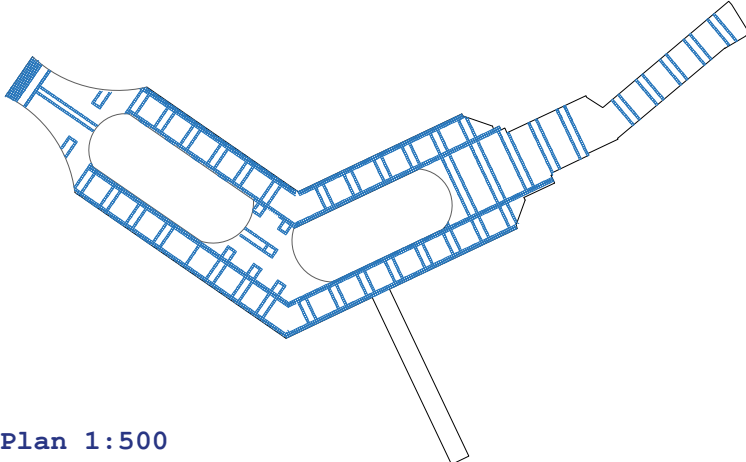

Plan 1:500

Details

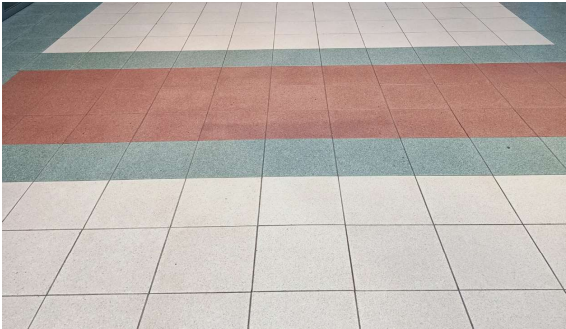

1:1000

External Windows

Em. 0.01

Ground Floor Window

count: 6

Elevation

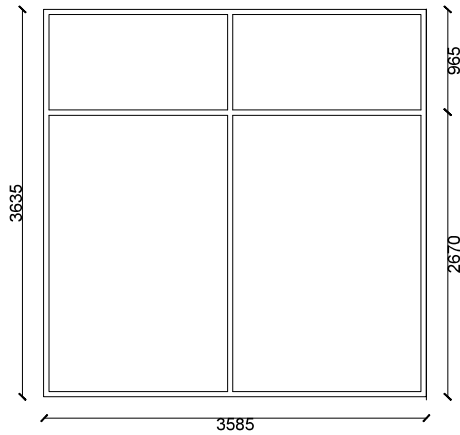
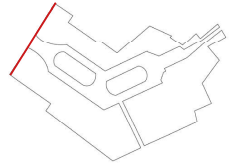

1:1000

External Windows

Em. 0.02

Ground Floor Window

count: 1

Elevation

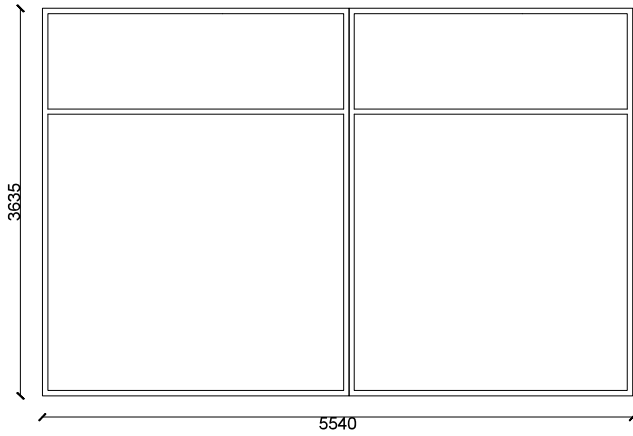
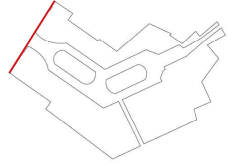

1:1000

External Windows

Em. 0.03

Ground Floor Window

count: 1

Elevation

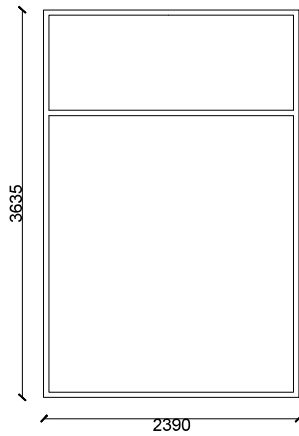
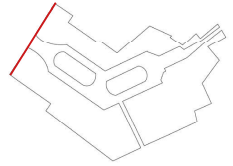

1:1000

External Windows

Em. 0.04

Ground Floor Window

count: 1

Elevation

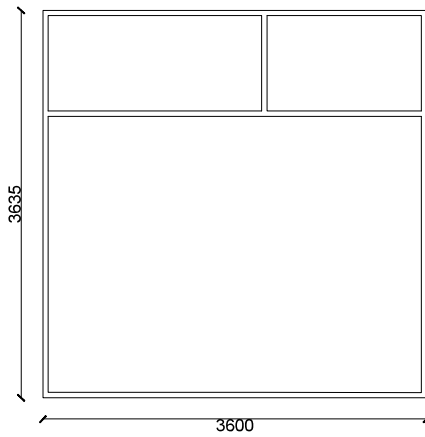
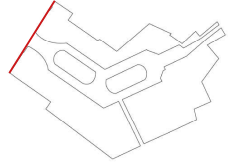

1:1000

External Windows

Em. 0.05

Ground Floor Window

count: 1

Elevation

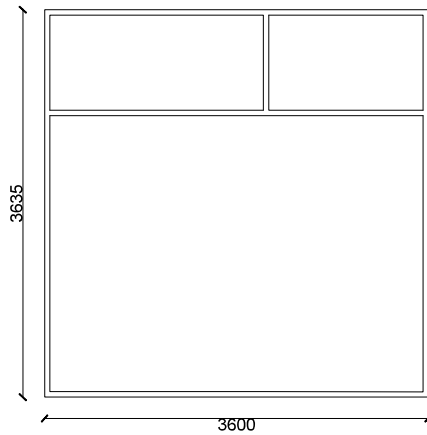
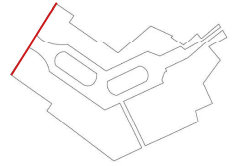

1:1000

External Windows

Em. 0.06

Ground Floor Window

count: 1

Elevation

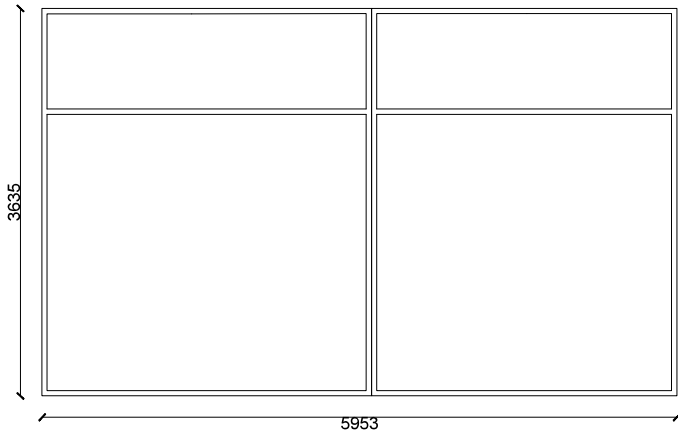
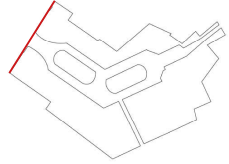

1:1000

External Windows

Em. 1. 01

First Floor Window

count: 2

Elevation

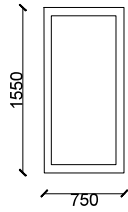
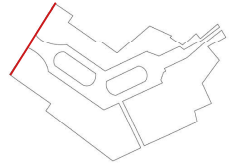

1:1000

External Windows

Em. 1.02

First Floor Window

count: 2

Elevation

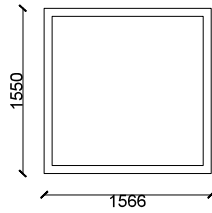
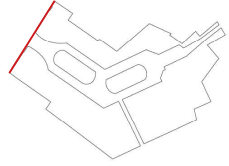

1:1000

External Windows

Em. 1.03

First Floor Window

count: 2

Elevation

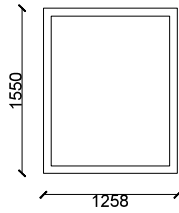
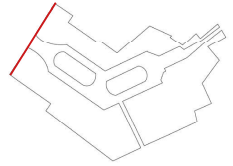

1:1000

External Windows

Em. 1.04

First Floor Window

count: 2

Elevation

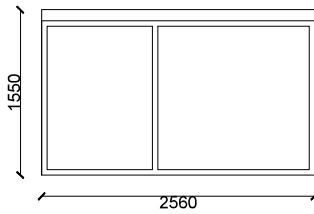
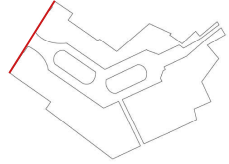

1:1000

External Windows

Em. 1.05

First Floor Window

count: 2

Elevation

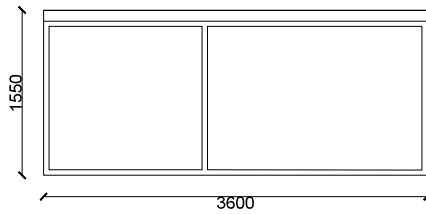
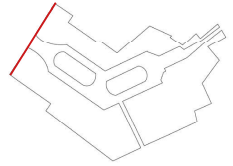

1:1000

External Windows

Em. 1.06

First Floor Window

count: 2

Elevation

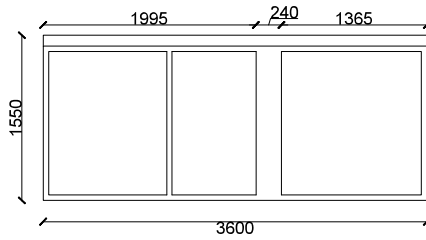
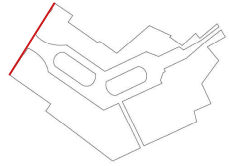

1:1000

External Windows

Em. 1.07

First Floor Window

count: 1

Elevation

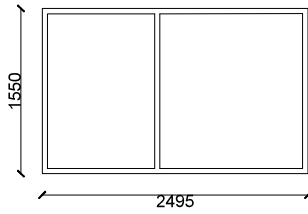
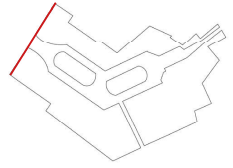

1:1000

External Windows

Em. 1.08

First Floor Window

count: 1

Elevation

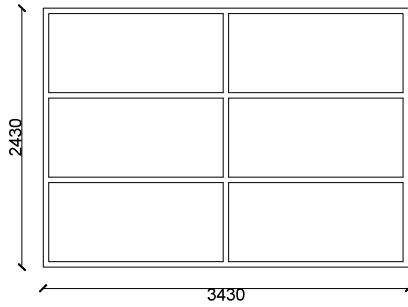
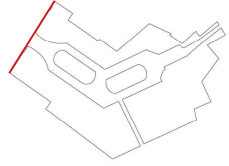

1:1000

External Windows

Em. 2.01

Second Floor Window

count: 6

Elevation

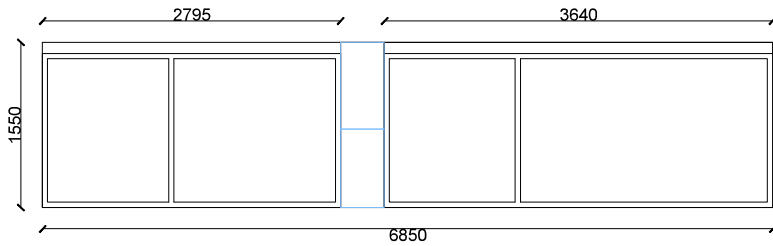
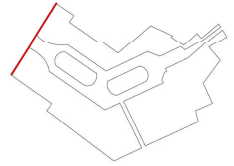

1:1000

External Windows

Em. 2.02

Second Floor Window

count: 1

Elevation

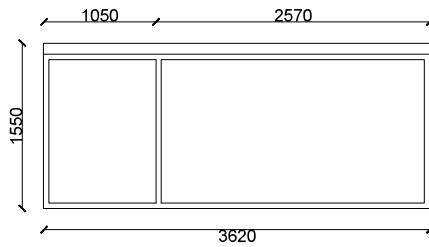
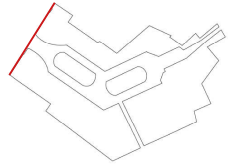

1:1000

External Windows

Em. 2.03

Second Floor Window

count: 9

Elevation

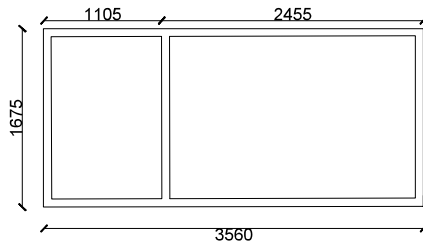
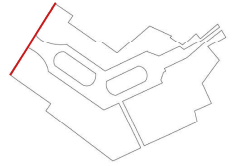

1:1000

External Windows

Em. 2.04

Second Floor Window

count: 2

Elevation

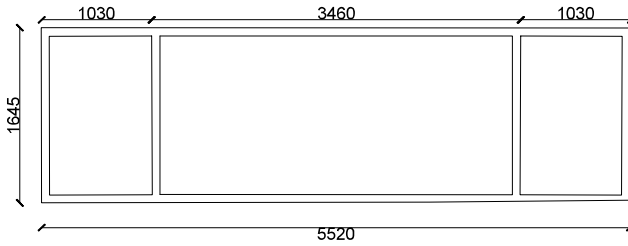
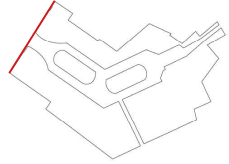

1:1000

External Windows

Em. 2.05

Second Floor Window

count: 1

Elevation

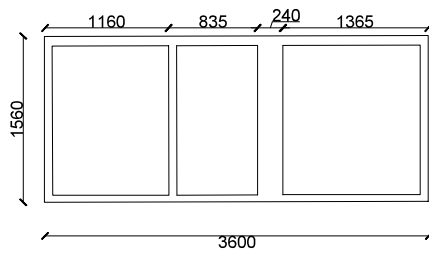
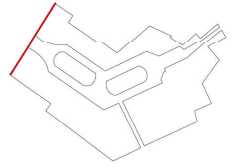

1:1000

External Windows

Em. 2.06

Second Floor Window

count: 1

Elevation

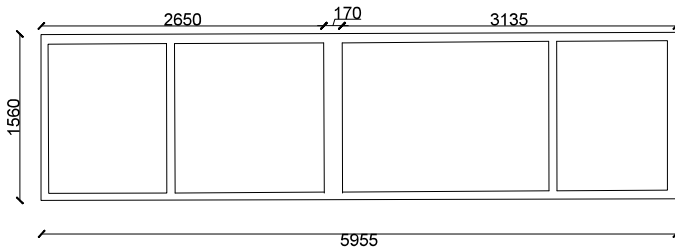
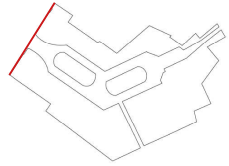

1:1000

External Windows

Ems . 1 . 01

First Floor Window- Slab

count: 3

Elevation

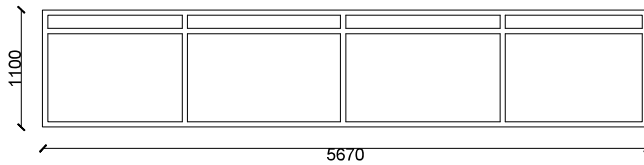
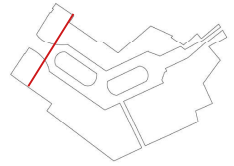

1:1000

External Windows

Ems . 1 . 02

First Floor Window- Slab

count: 5

Elevation

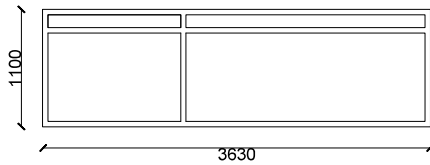
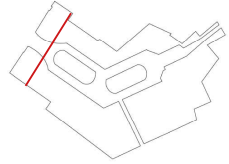

1:1000

External Windows

Ems . 1 . 03

First Floor Window- Slab

count: 1

Elevation

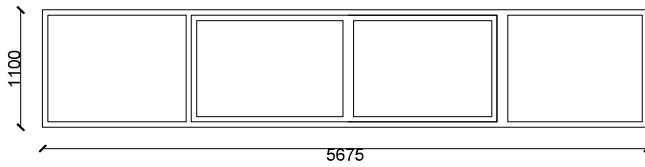
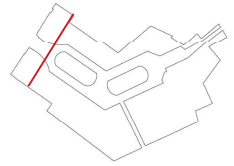

1:1000

External Windows

Ems . 2 . 01

Second Floor Window- Slab

count: 3

Elevation

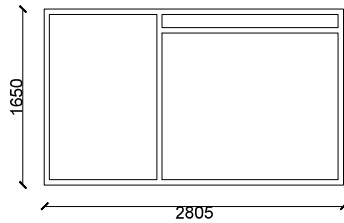
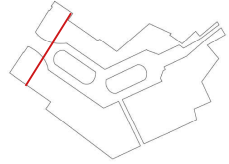

1:1000

External Windows

Ems . 2 . 02

Second Floor Window- Slab

count: 2

Elevation

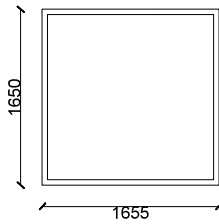
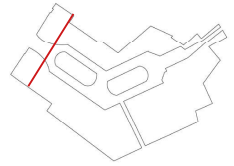

1:1000

External Windows

Ems . 2 . 03

Second Floor Window- Slab

count: 2

Elevation

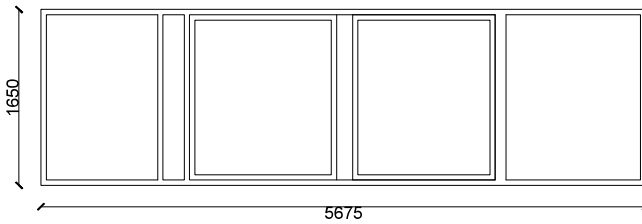
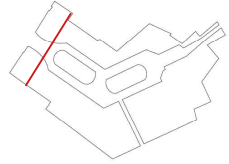

1:1000

External Windows

Ems . 2 . 04

Second Floor Window- Slab

count: 2

Elevation

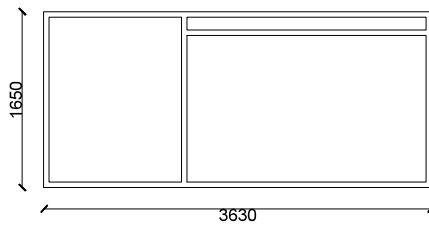
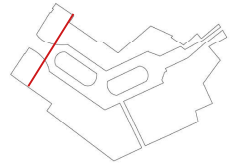

1:1000

External Windows

Ems . 2 . 05

Second Floor Window- Slab

count: 4

Elevation

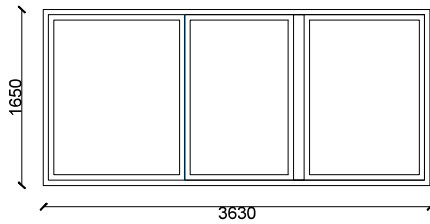
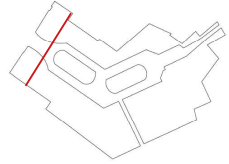

1:1000

External Windows

Ems . 2 . 06

Second Floor Window- Slab

count: 6

Elevation

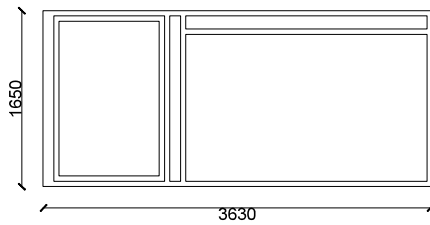
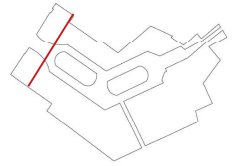

1:1000

External Windows

Ems . 2 . 07

Second Floor Window- Slab

count: 2

Elevation

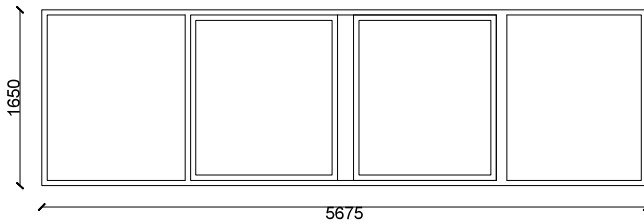
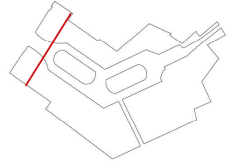

Passage Facade Elements

Internal Windows + Doors (Detail)

Passage

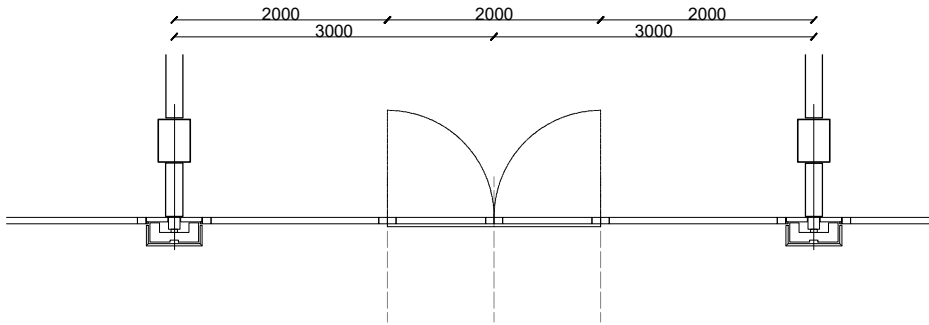

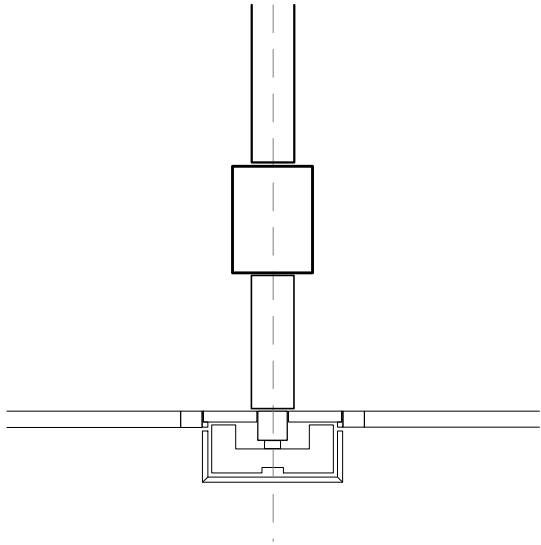

Passage Facade Elements

Window Location Groundfloor





Passage Facade Elements

Window Location 1. Floor



Passage Facade Elements

Internal Windows + Doors

Passage





pipoos

Shop online
and save
pipoos.com

TANTE HAN

SPEEL

Passage Windows

IW.01.01

Window

count: 25 + 4 in blue color

Elevation

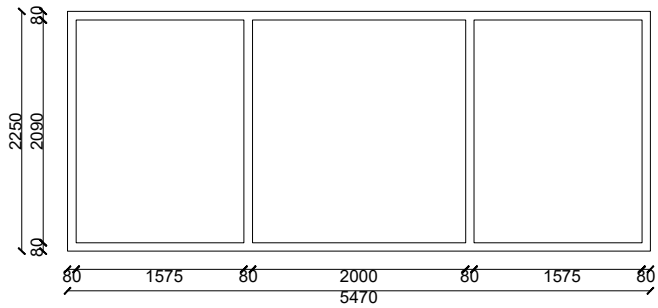

Passage Windows

IW.01.02

Window

count: 2

Elevation

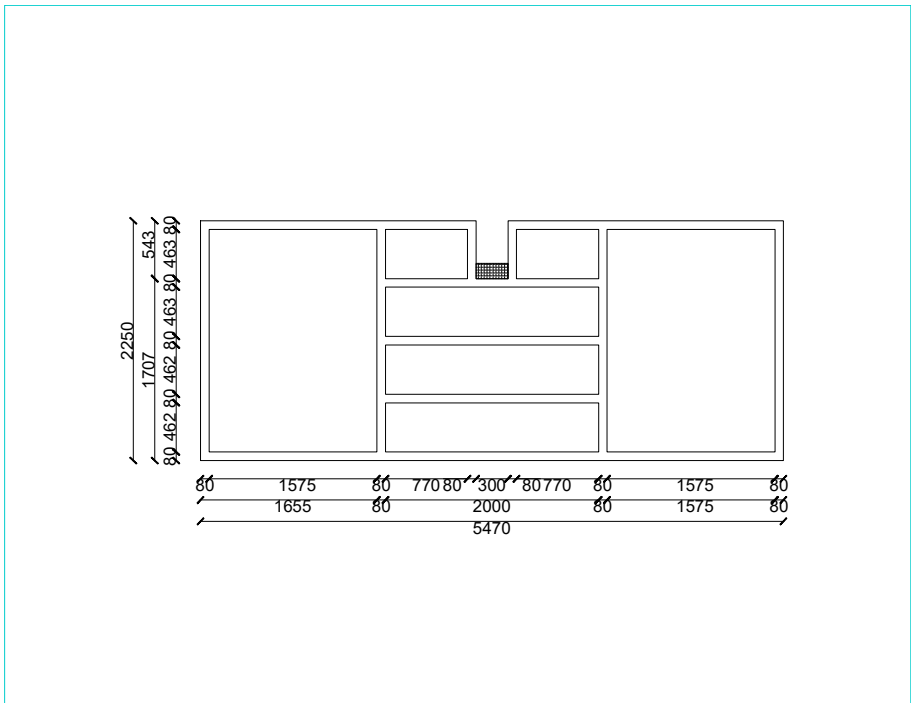

Passage Windows

IW.01.03

Window

count: 6

Elevation

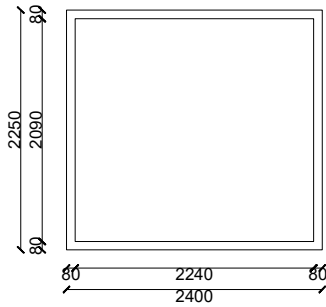

Passage Windows

IW.01.04

Window

count: 6

Elevation

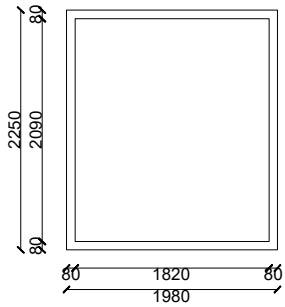

Passage Windows

IW.01.05.b

Window

count: 1

Elevation

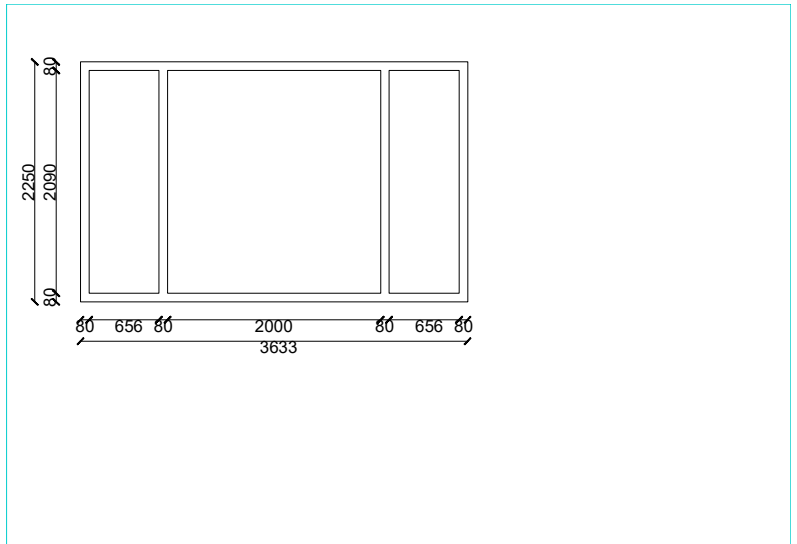

Passage Windows

IW.01.06

Window

count: 1 + 6 in grey color)

Elevation

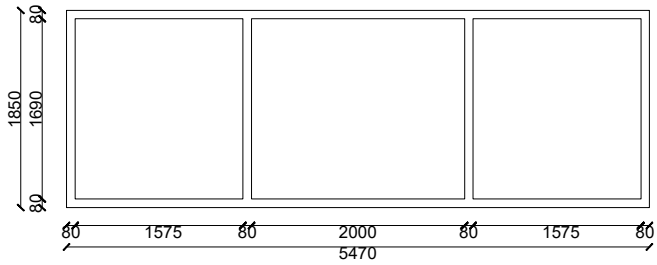

Passage Windows

IW.01.07

Window

count: 1

Elevation

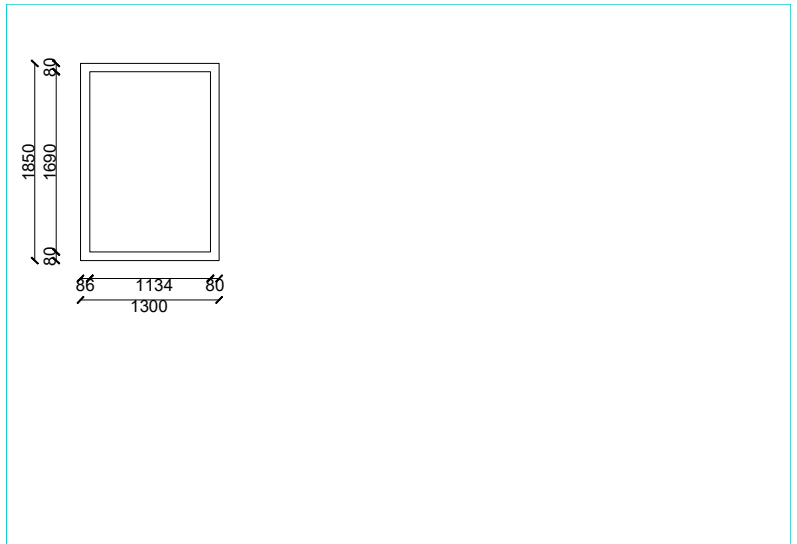

Passage Windows

IW.01.08

Window

count: 3

Elevation

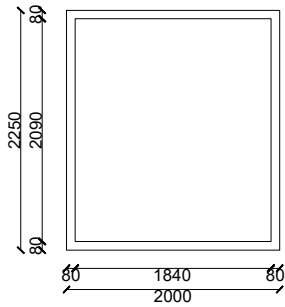

Passage Windows

IW.01.09

Window

count: 2

Elevation

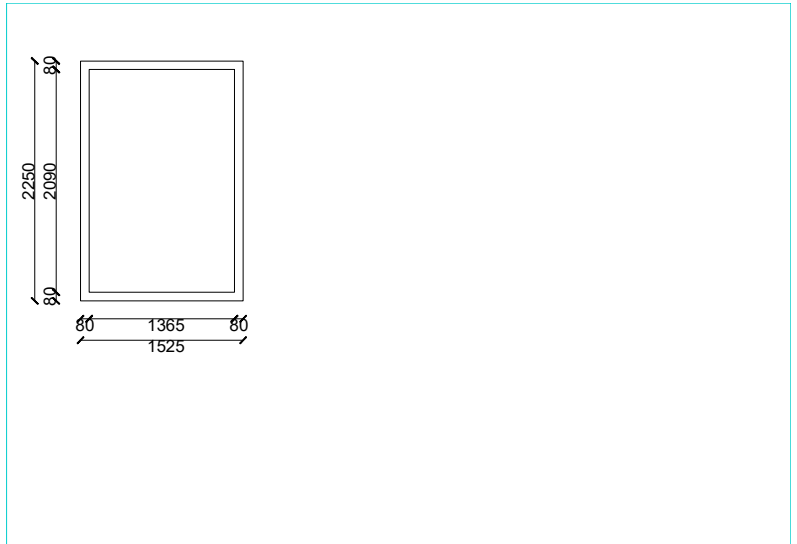

Passage Windows

IW.01.10

Window

count: 1

Elevation

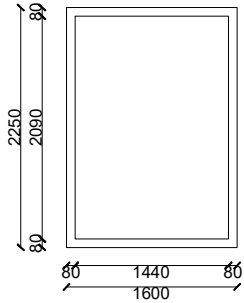

Passage Windows

IW.01.11

Window

count: 4

Elevation

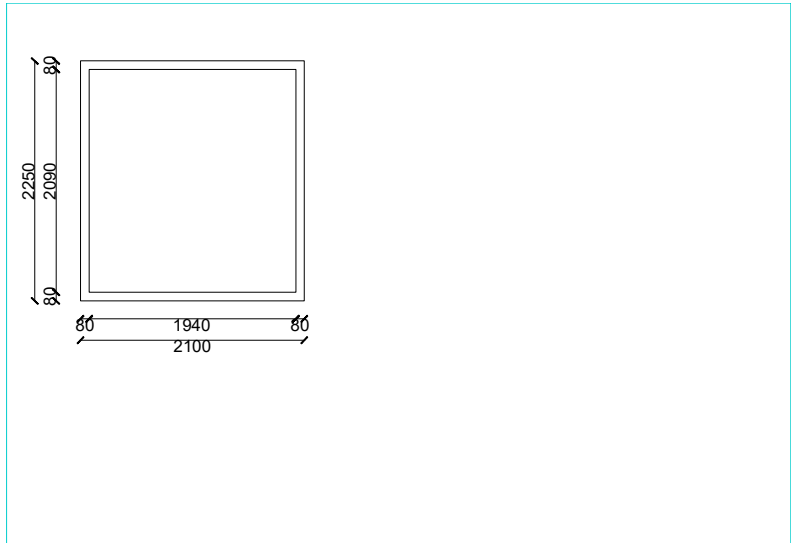

Passage Windows

IW.01.12

Window

count: 2

Elevation

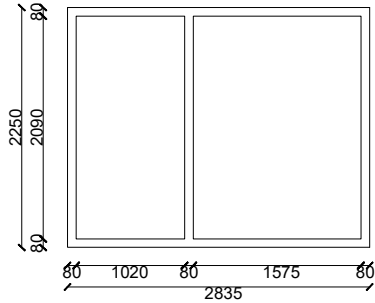

Passage Windows

IW.01.13

Window

count: 2

Elevation

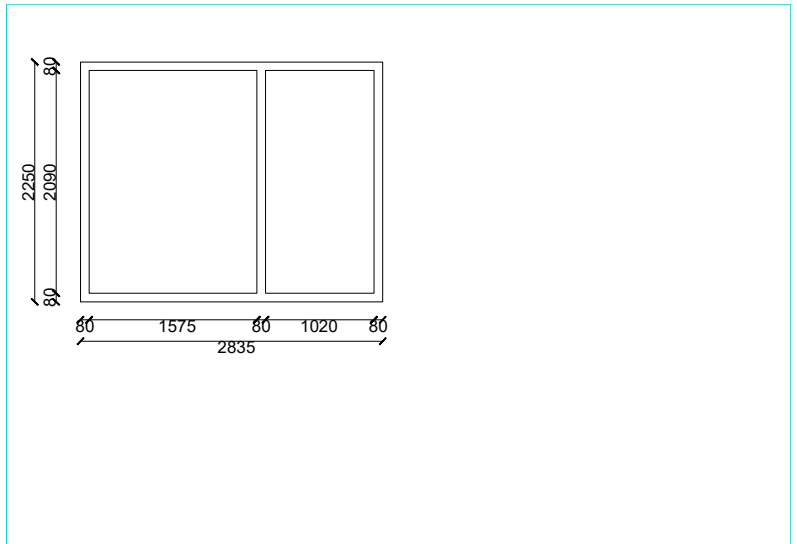

Passage Windows

IW.01.14

Window

count: 2

Elevation

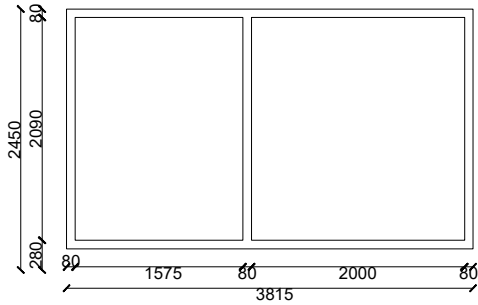

Passage Windows

IW.00.15

Window

count: 4

Elevation

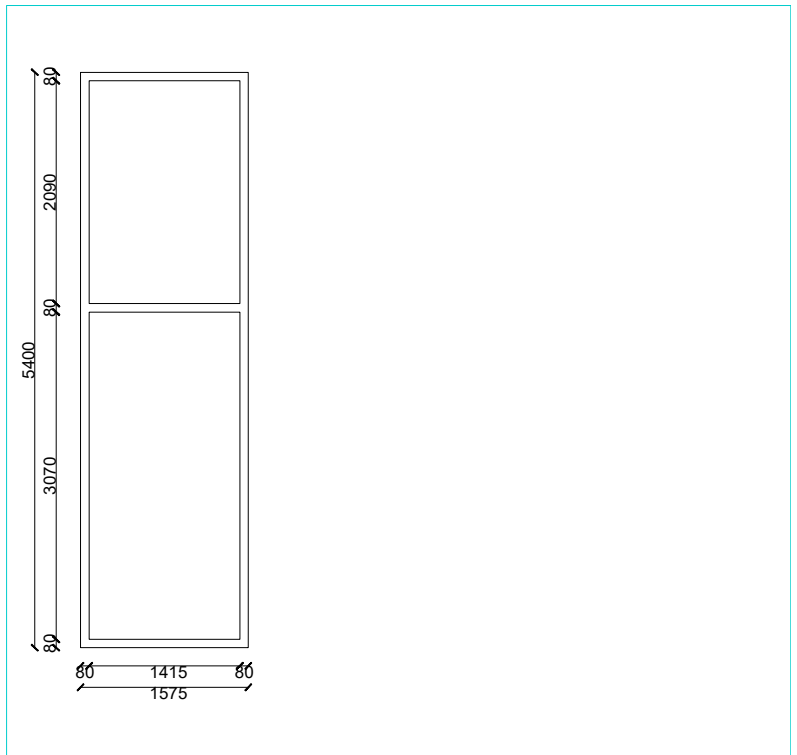

Passage Windows

IW.00.16

Window

count: 2

Elevation

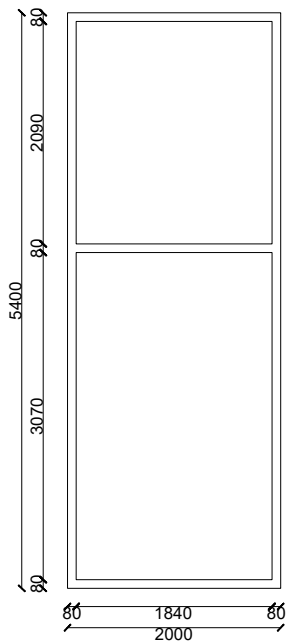

Passage Windows

IW.00.17

Window

count: 19 + 1 in blue color

Elevation

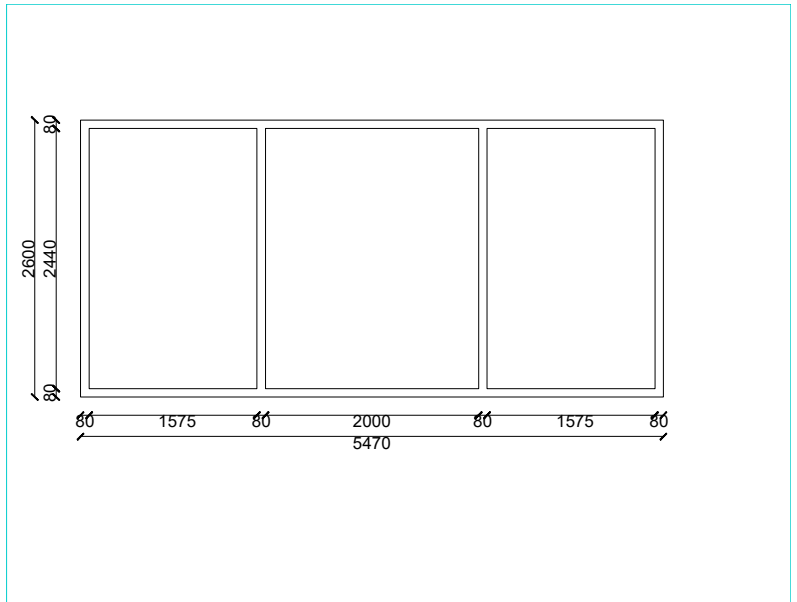

Passage Windows

IW.00.18

Window

count: 6

Elevation

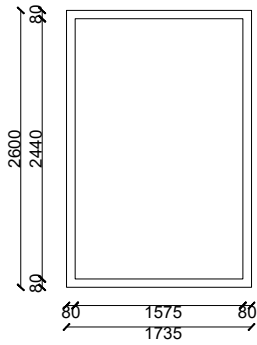

Passage Windows

IW.00.19

Window

count: 1

Elevation

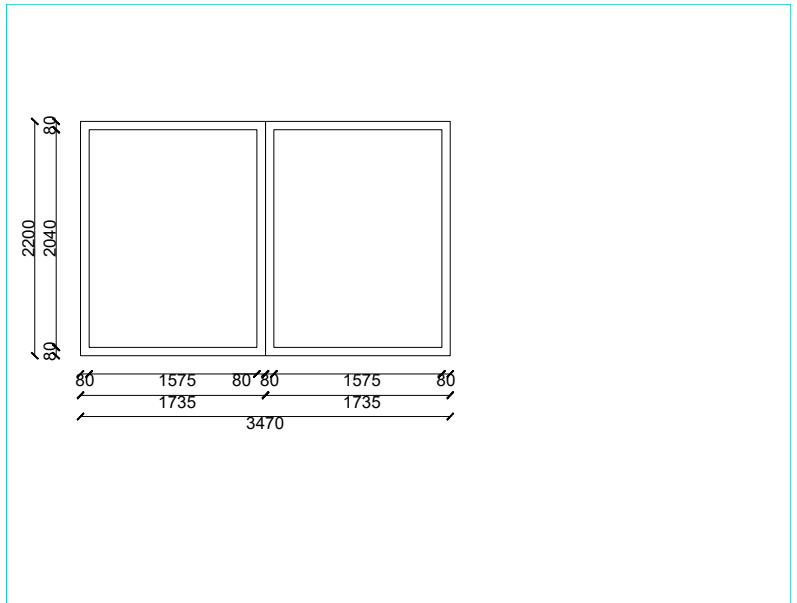

Passage Windows

IW.00.20

Window

count: 2

Elevation

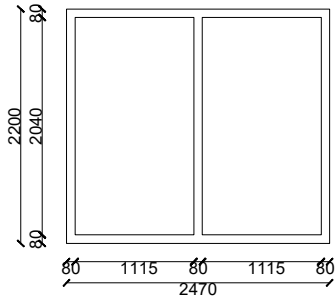

Passage Windows

IW.00.21

Window

count: 1

Elevation

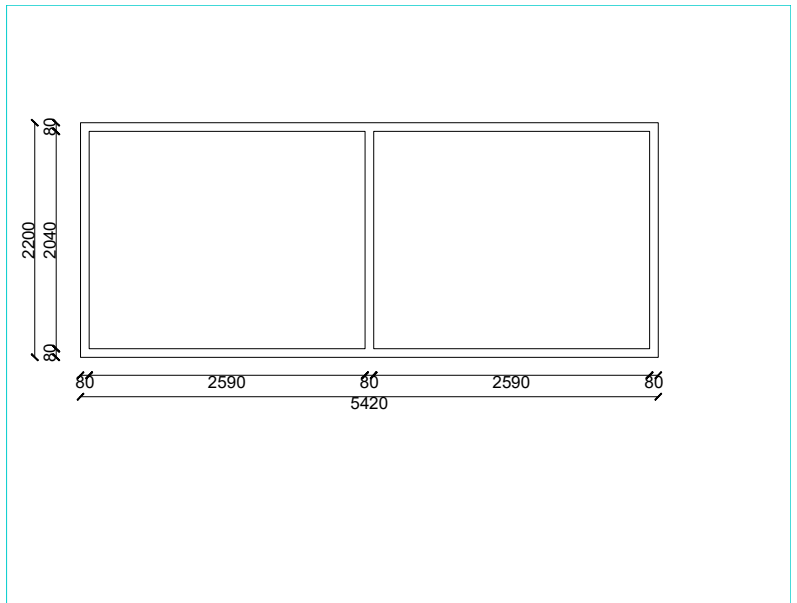

Passage Windows

IW.00.22

Window

count: 1

Elevation

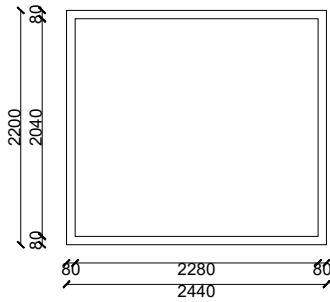

Passage Windows

IW.00.23

Window

count: 4

Elevation

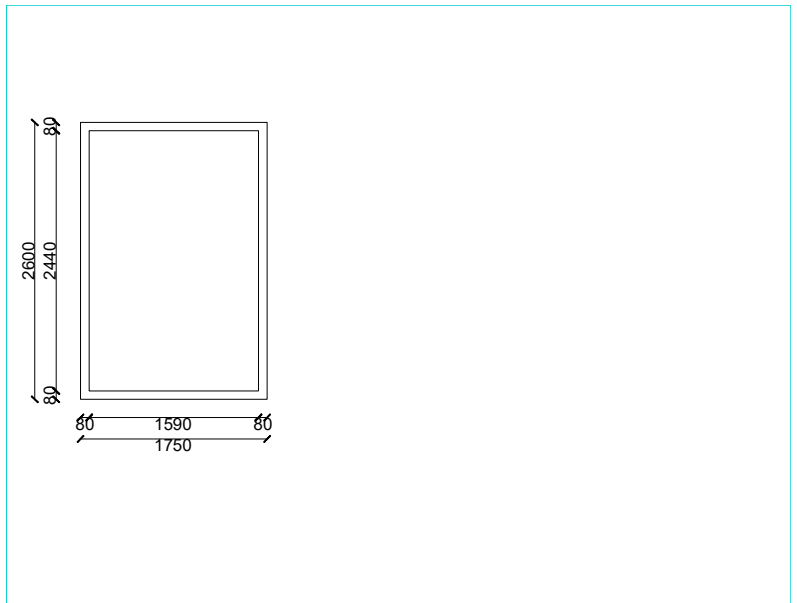

Passage Windows

IW.00.24

Window

count: 3

Elevation

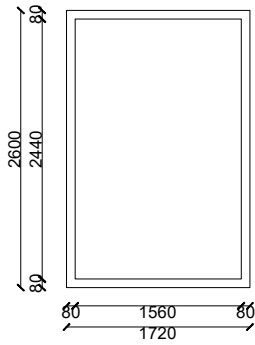

Passage Windows

IW.00.25

Window

count: 2

Elevation

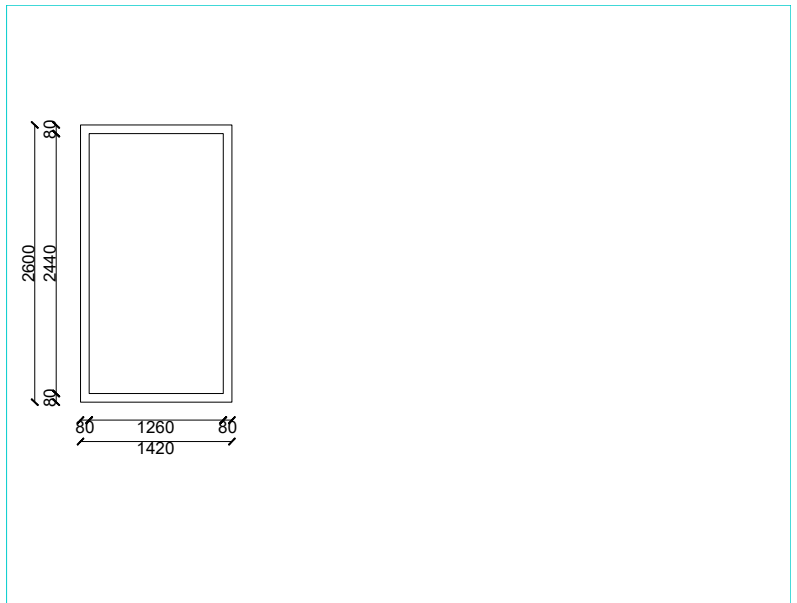

Passage Windows

IW.00.26

Window

count: 2

Elevation

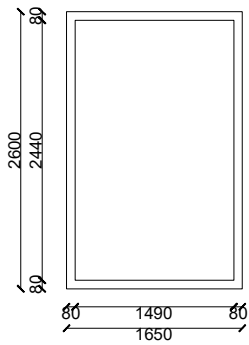

Passage Windows

IW.00.27

Window

count: 2

Elevation

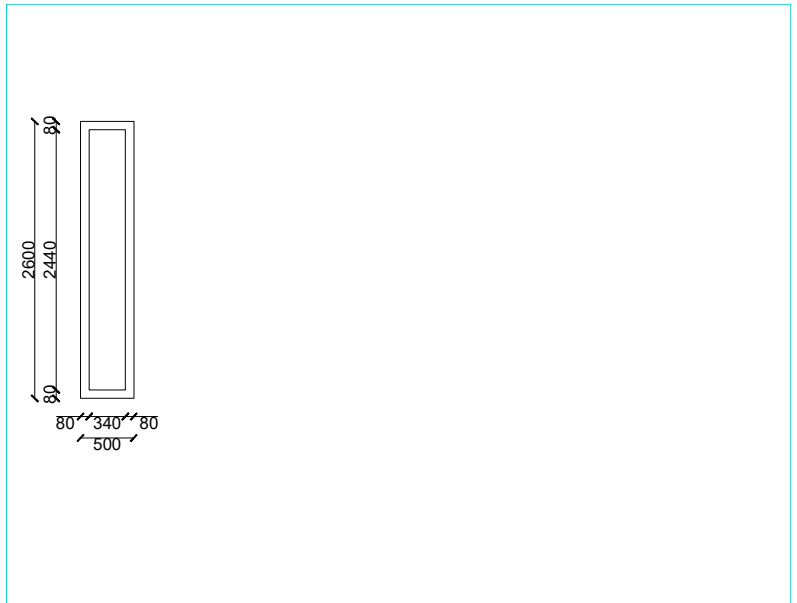

Passage Windows

IW.00.28

Window

count: 2

Elevation

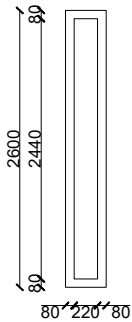

Passage Windows

IW.00.29

Window

count: 1

Elevation

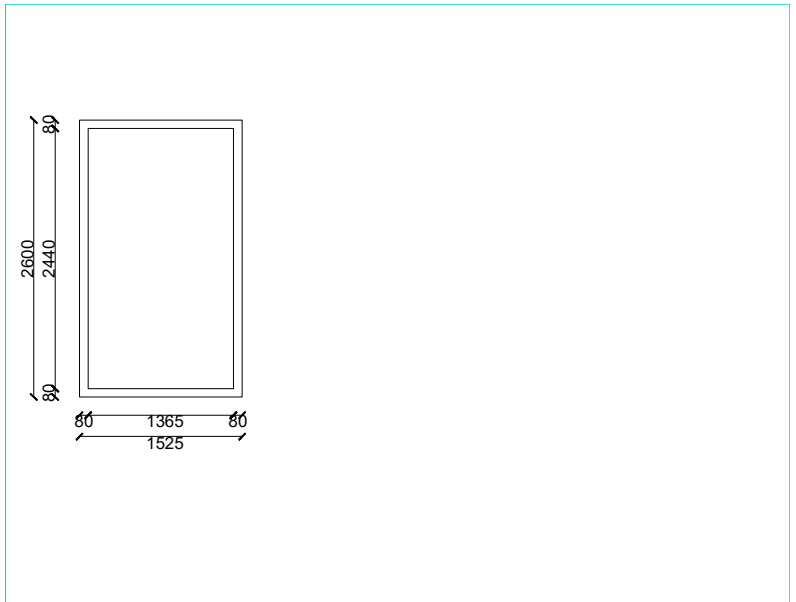

Passage Windows

IW.00.30

Window

count: 3

Elevation

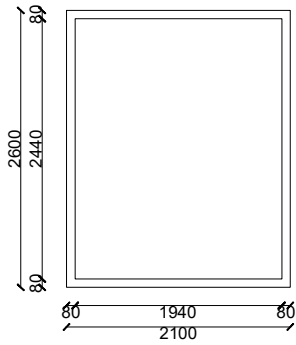

Passage Windows

IW.00.31

Window

count: 2

Elevation

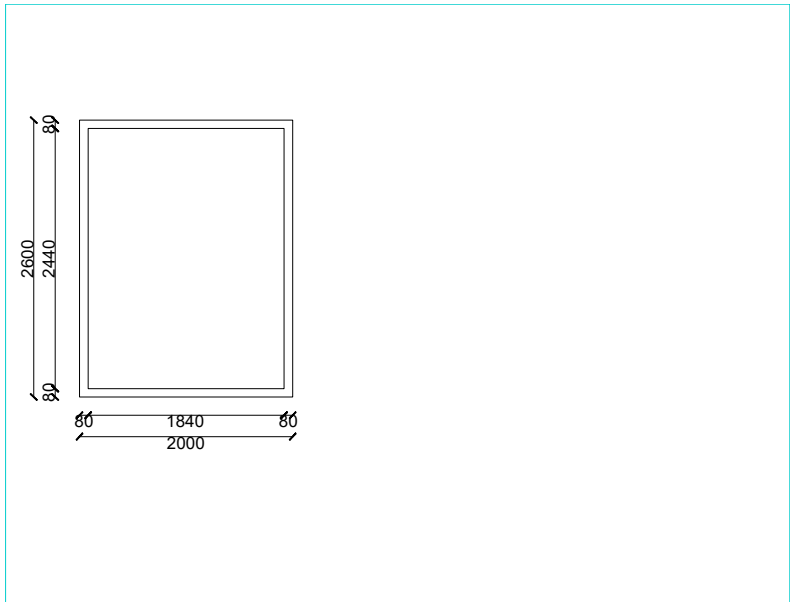

Passage Windows

IW.00.32

Window

count: 1

Elevation

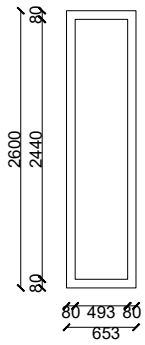

Passage Windows

IW.00.33

Window

count: 5

Elevation

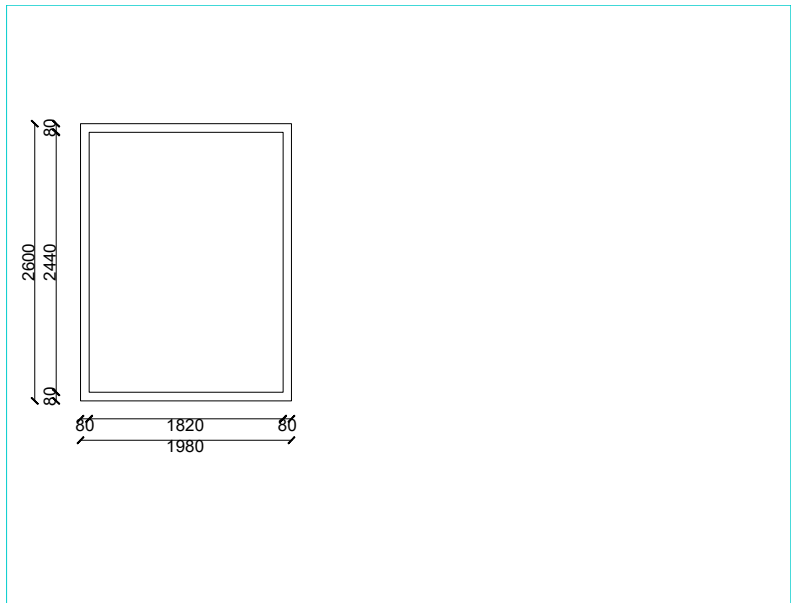

Passage Windows

IW.00.34

Window

count: 3

Elevation

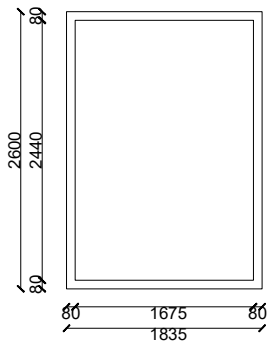

Passage Windows

IW.00.35

Window

count: 3

Elevation

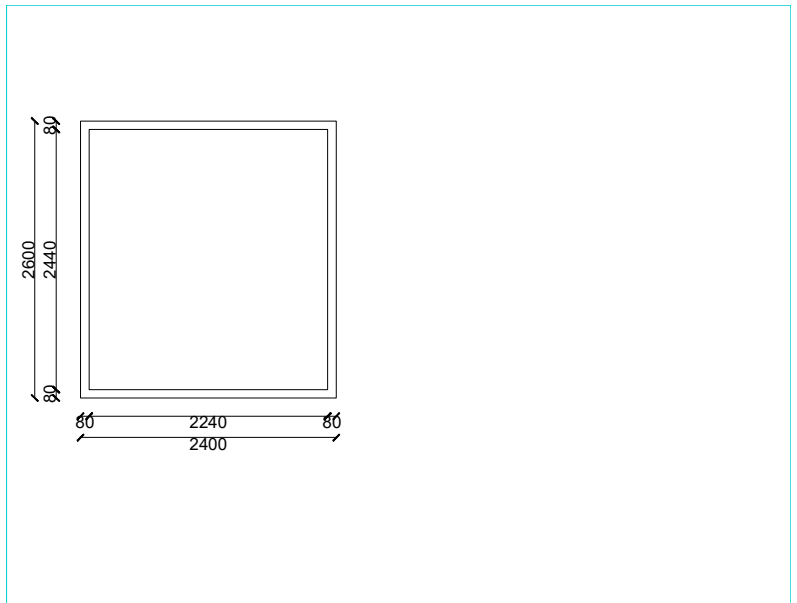

Passage Windows

IW.00.36

Window

count: 1

Elevation

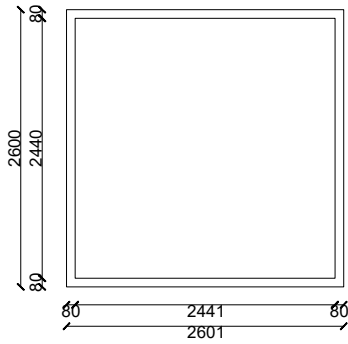

Passage Windows

IW.00.37

Window

count: 1

Elevation

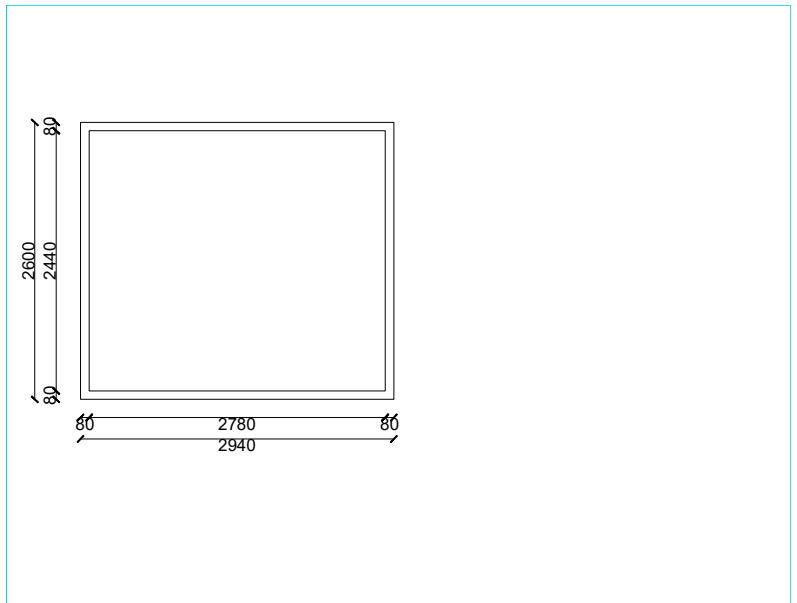

Passage Windows

IW.00.38

Window

count: 2

Elevation

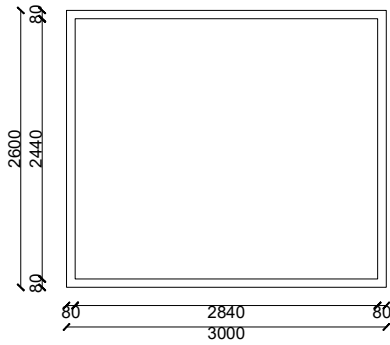

Passage Windows

IW.00.39

Window

count: 2

Elevation

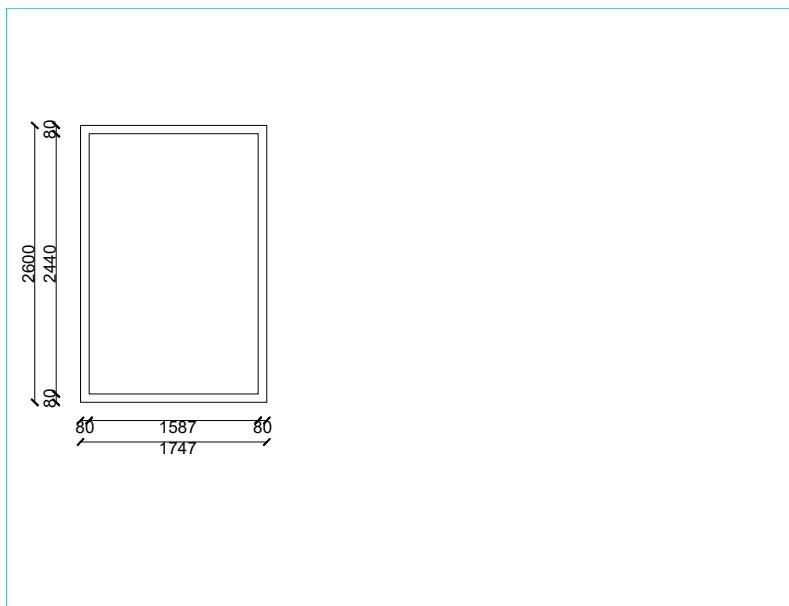

Passage Windows

IW.00.40

Window

count: 1

Elevation

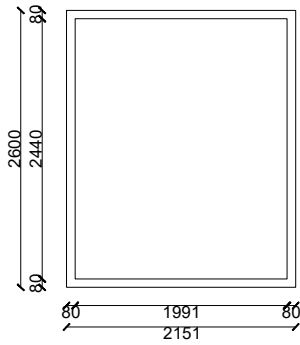

Passage Windows

IW.00.41

Window

count: 6

Elevation

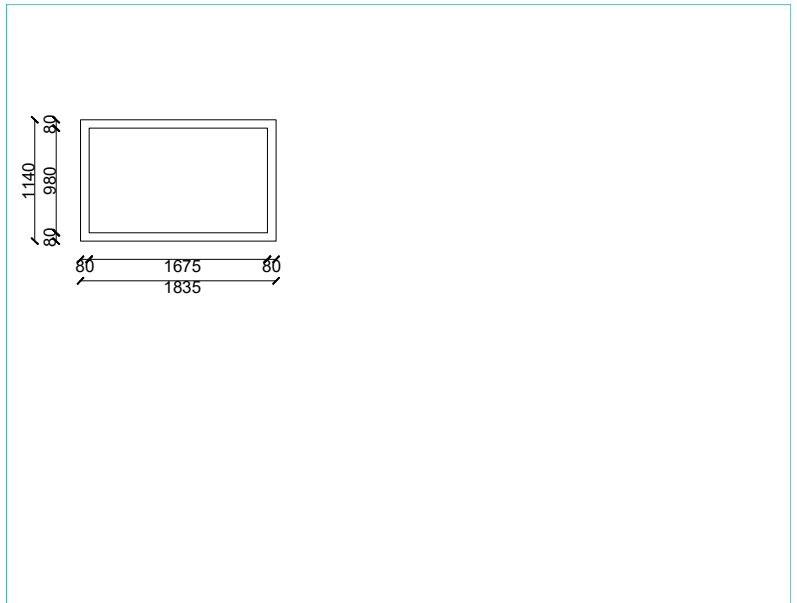

Passage Windows

IW.00.42

Window

count: 1

Elevation

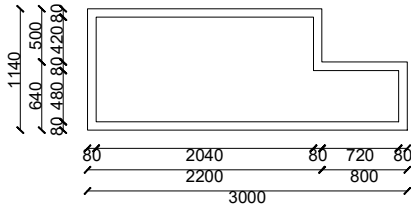

Passage Windows

IW.00.43

Window

count: 1

Elevation

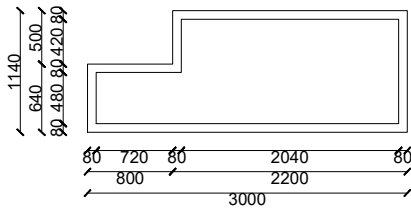

Passage Windows

IW.00.44

Window

count: 1

Elevation

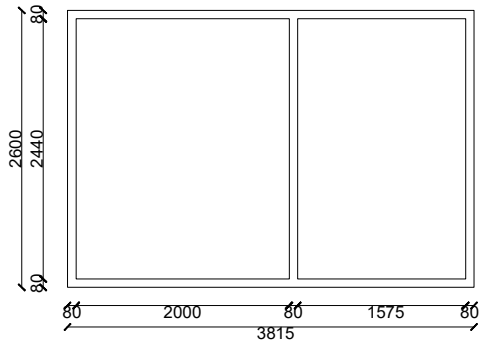

Passage Windows

IW.00.45

Window

count: 1

Elevation

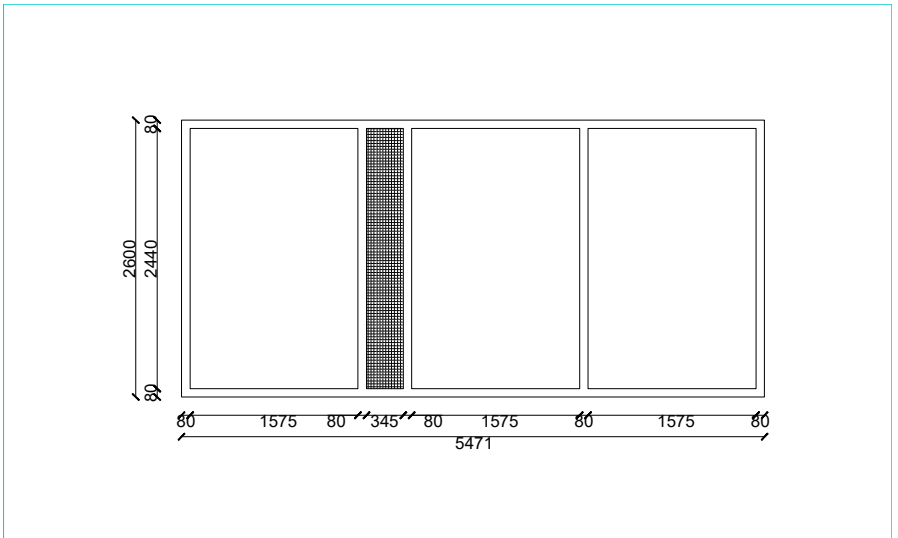

Passage Windows

IW.00.46

Window

count: 1

Elevation

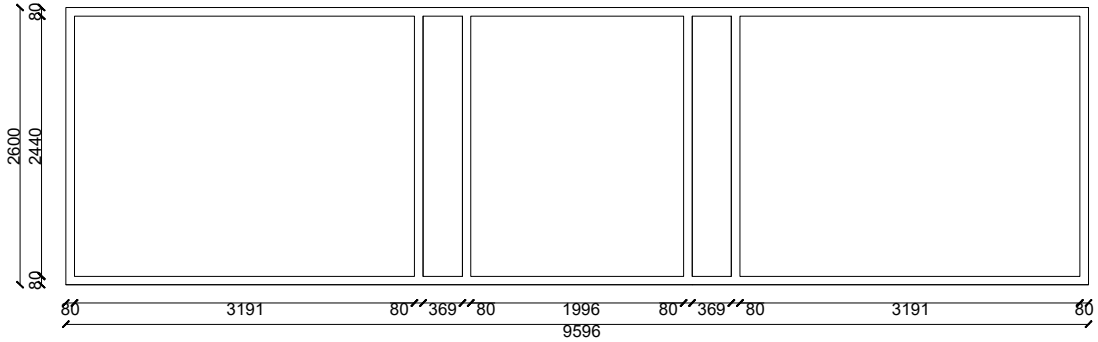

Passage Windows

IW.00.47

Window

count: 1

Elevation

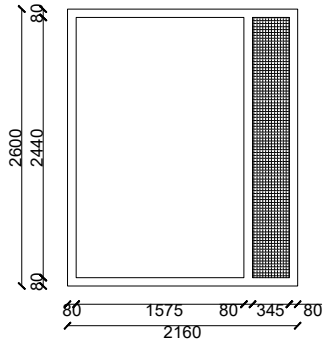

Window Doors

WD.01.02

Door

count: 2

Elevation

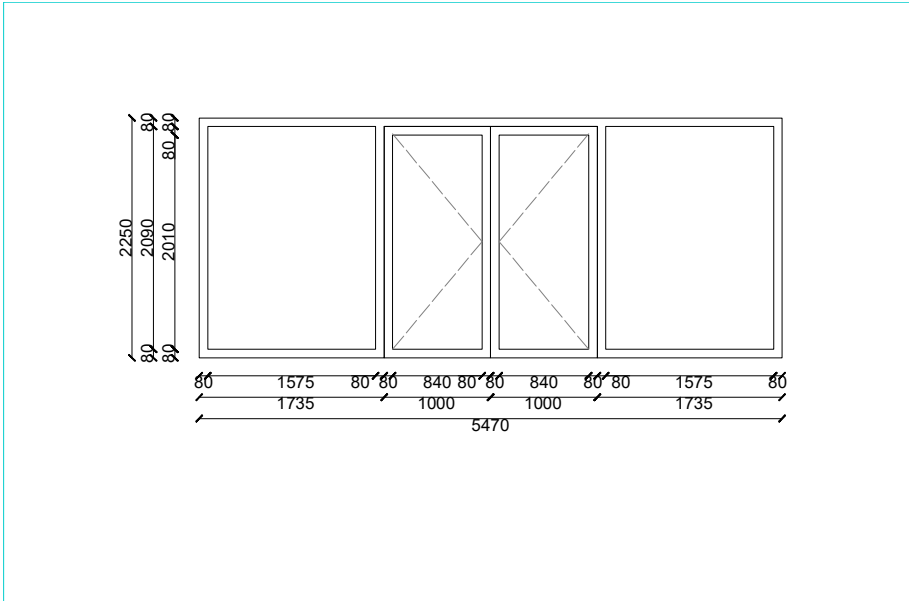

Window Doors

WD.01.03

Door

count: 2

Elevation

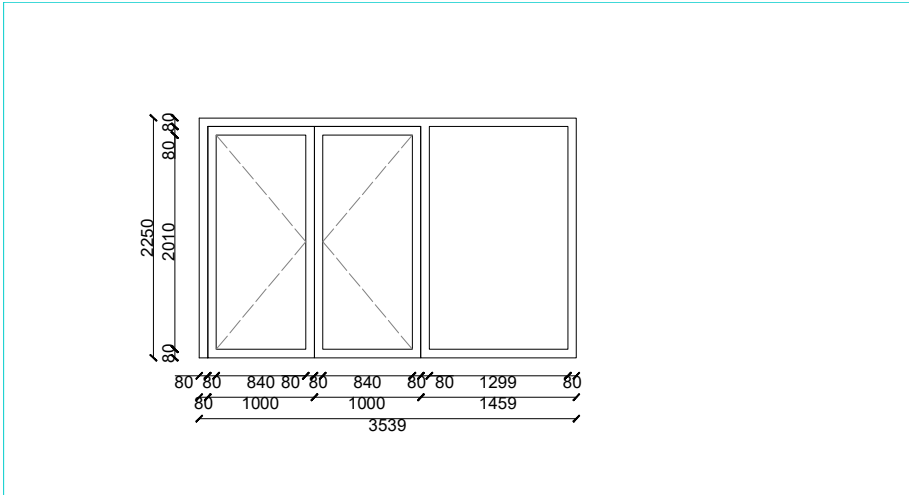

Window Doors

WD.00.05

Door

count: 11

Elevation

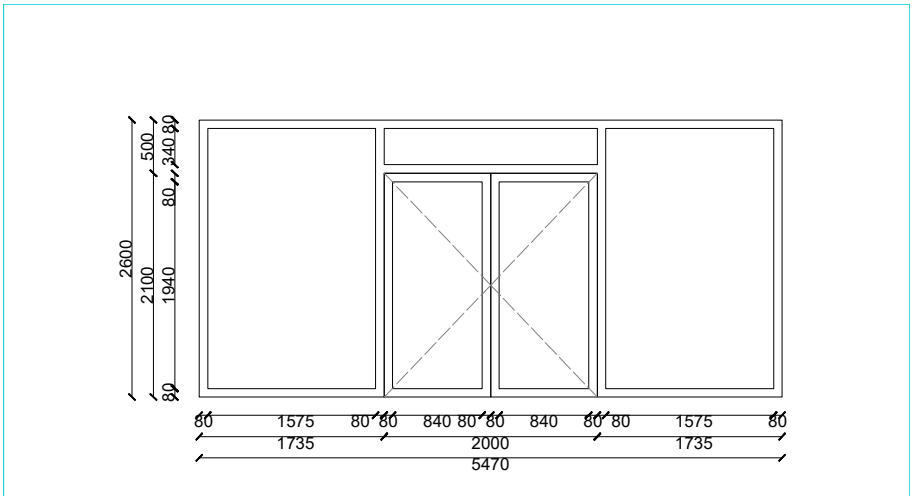

Window Doors

WD.01.06

Door

count: 2

Elevation

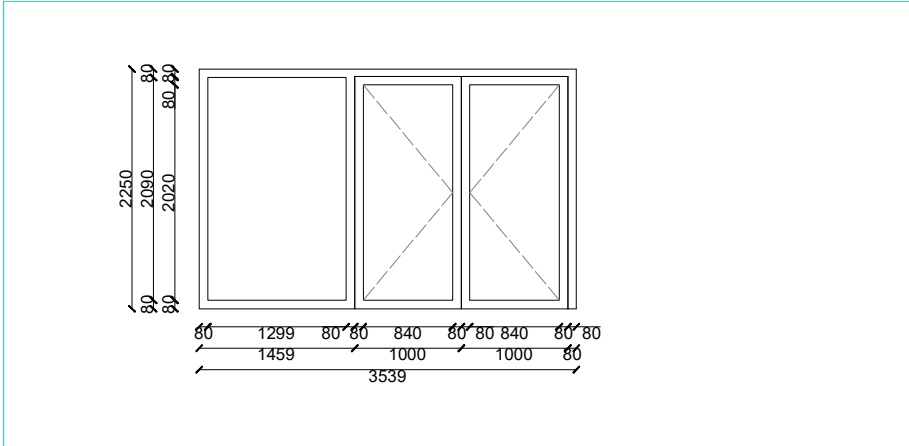

Window Doors

WD.00.07

Door

count: 2

Elevation

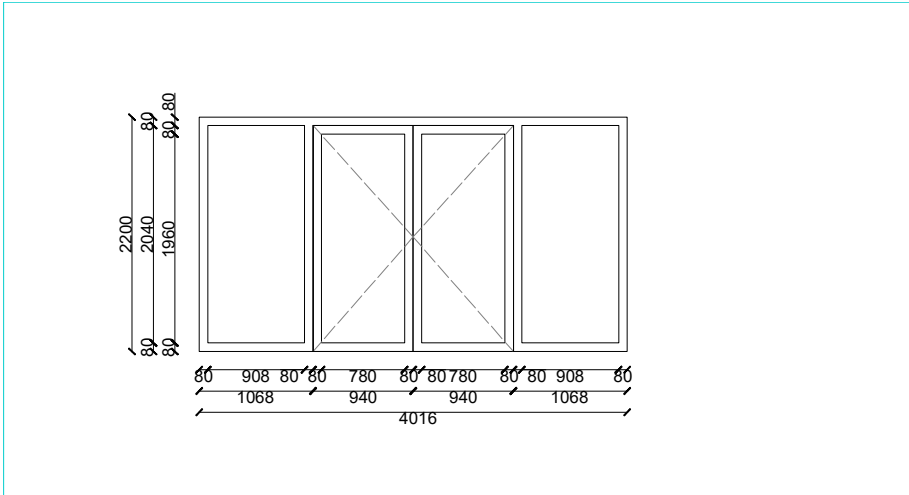

Window Doors

WD.00.08

Door

count: 3

Elevation

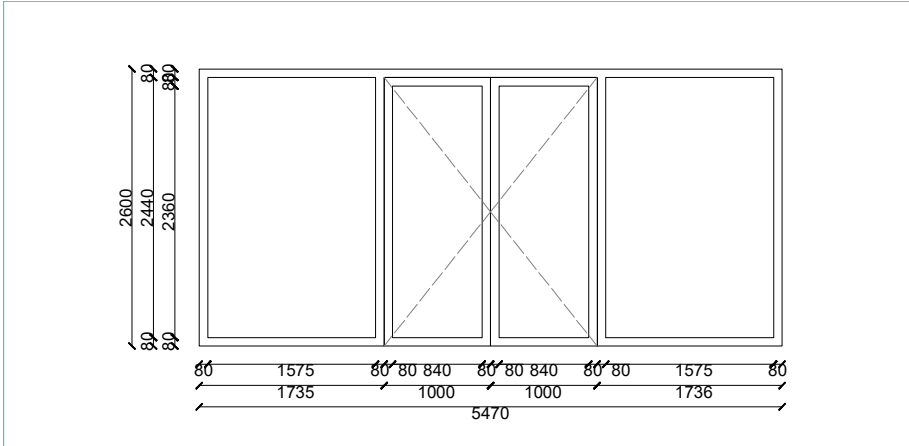

Window Doors

WD.00.10

Door

count: 1

Elevation

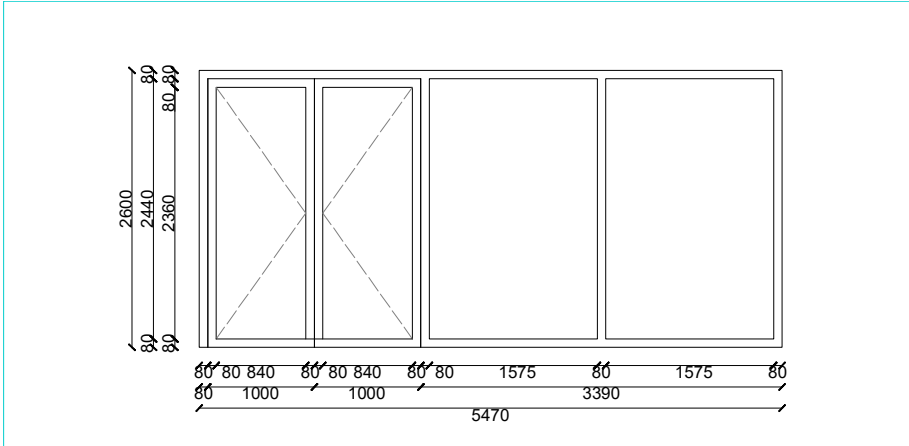

Window Doors

WD.00.11

Door

count: 1

Elevation

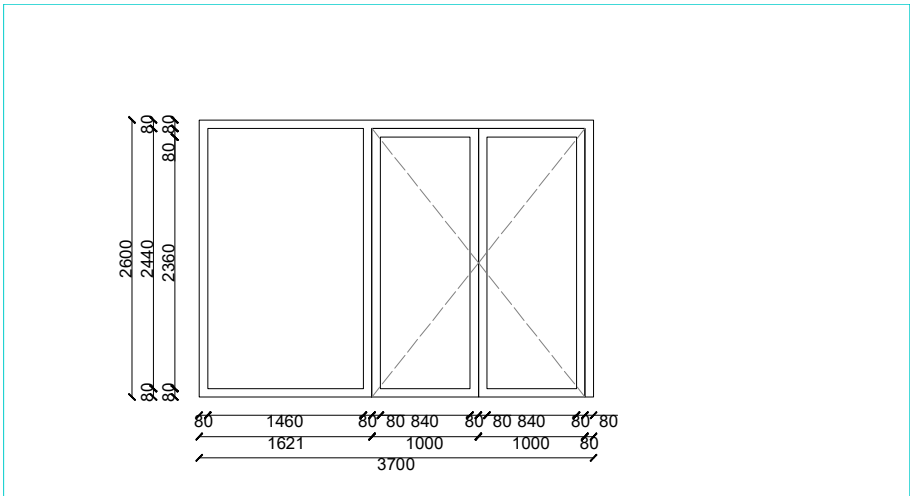

Window Doors

WD.00.12

Door

count: 1

Elevation

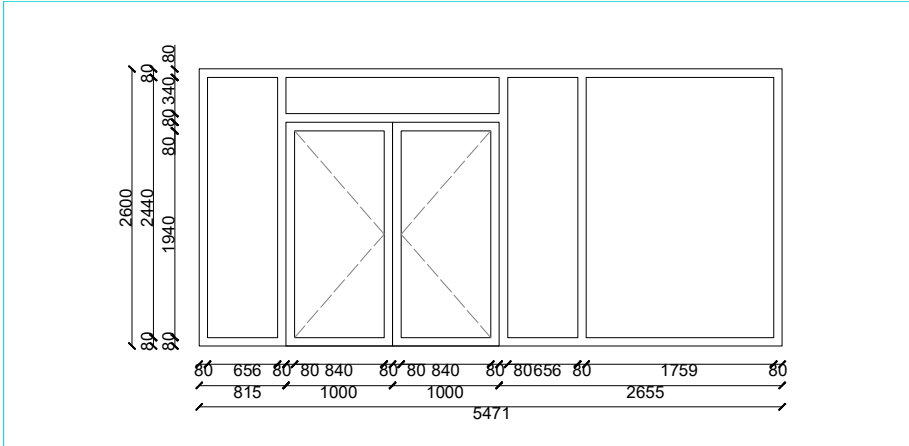

Window Doors

WD.00.13.b

Door

count: 1 (blue color)

Elevation

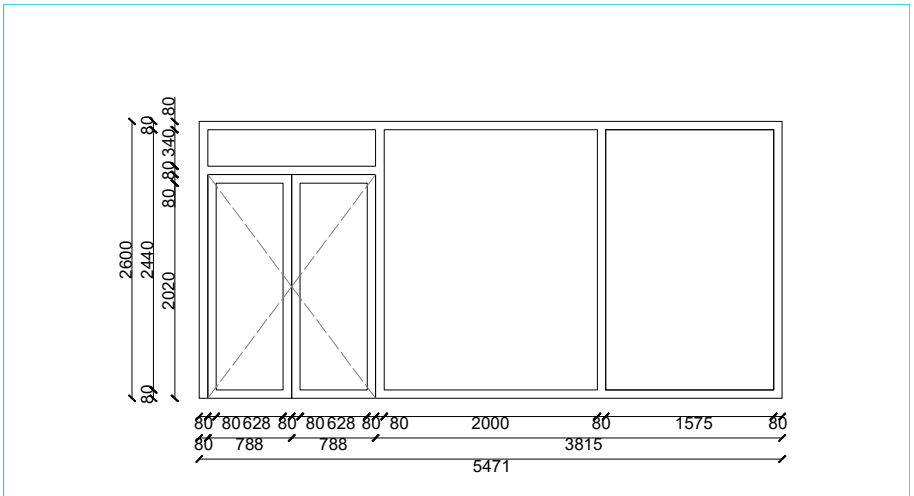

Window Doors

WD.00.14

Door

count: 1

Elevation

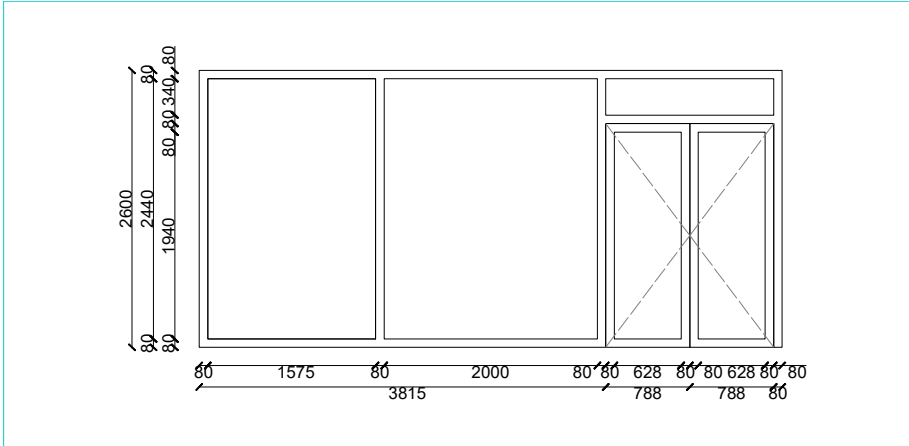

Window Doors

WD.00.15

Door

count: 1

Elevation

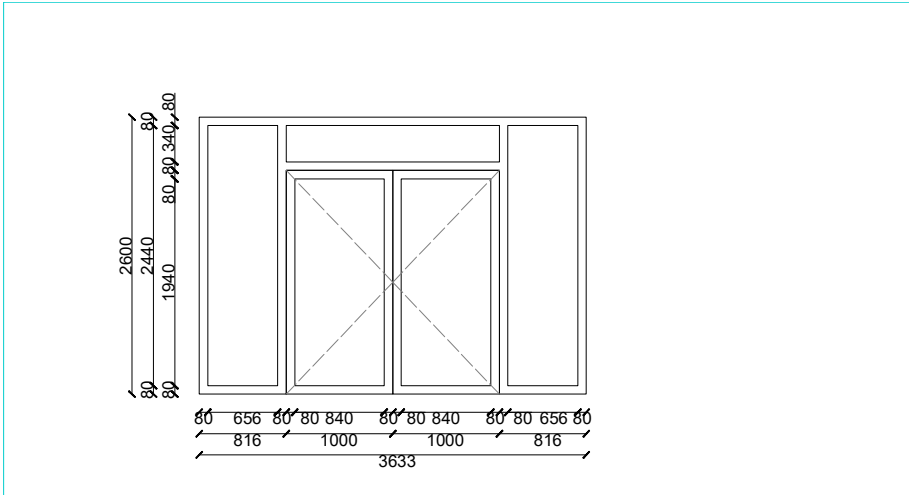

Door Types

D.00.01

Door

count: 1

Elevation

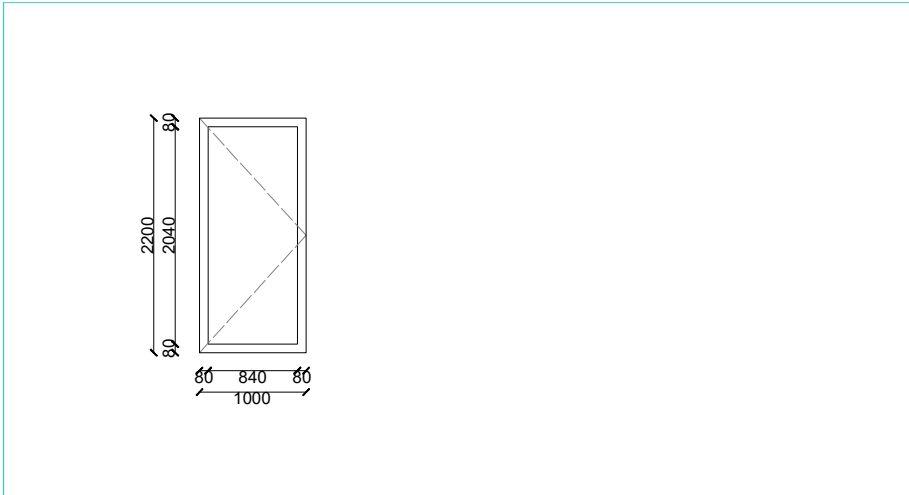

Door Types

D.00.02

Door

count: 1

Elevation

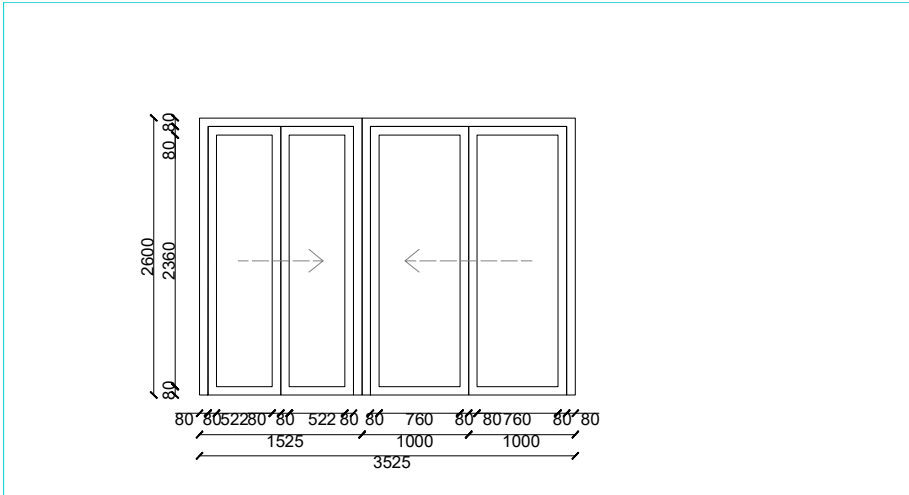

Door Types

D.00.03

Door

count: 1

Elevation

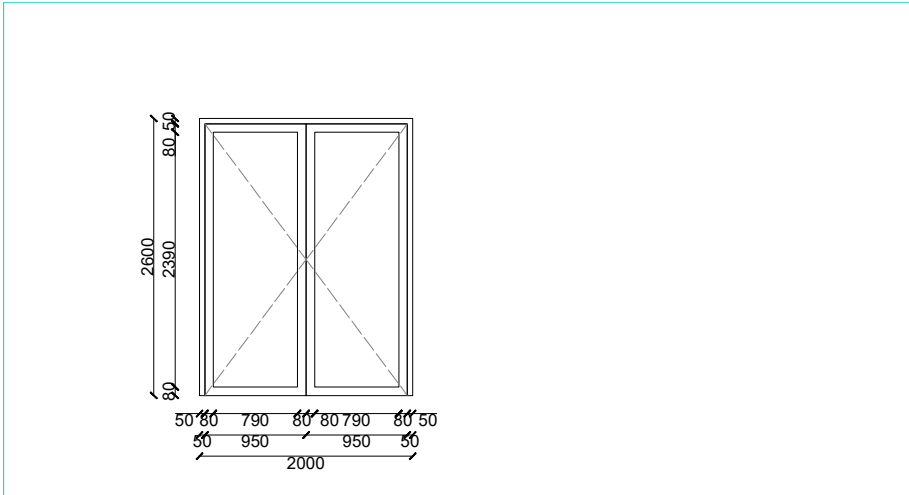

Door Types

D.00.04

Door

count: 1

Elevation

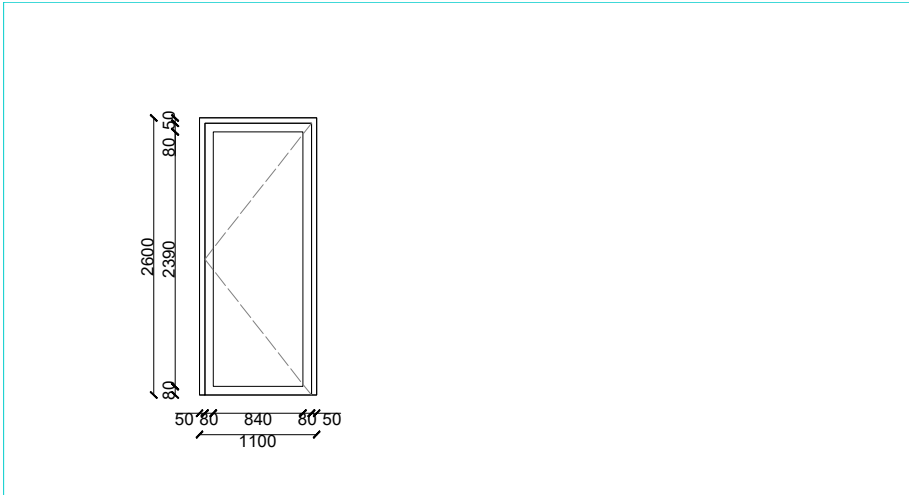

Door Types

D.00.05

Door

count: 1

Elevation

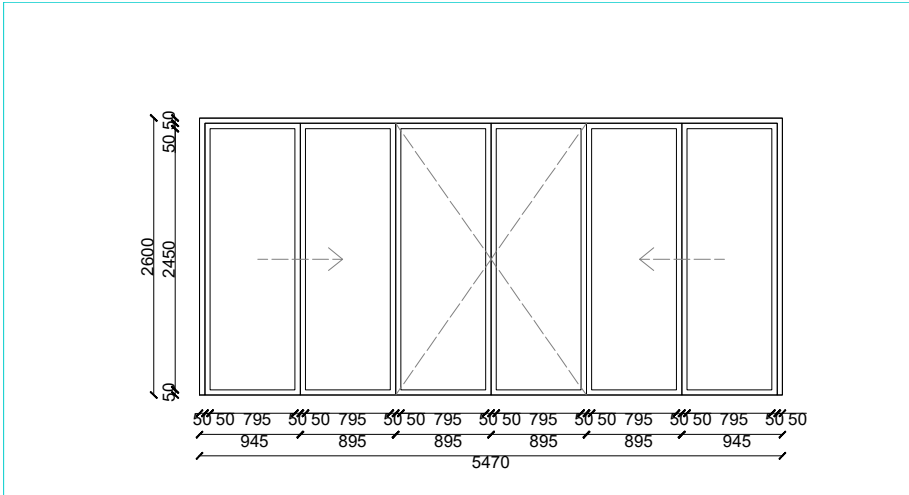

Door Types

D.00.06

Door

count: 2

Elevation

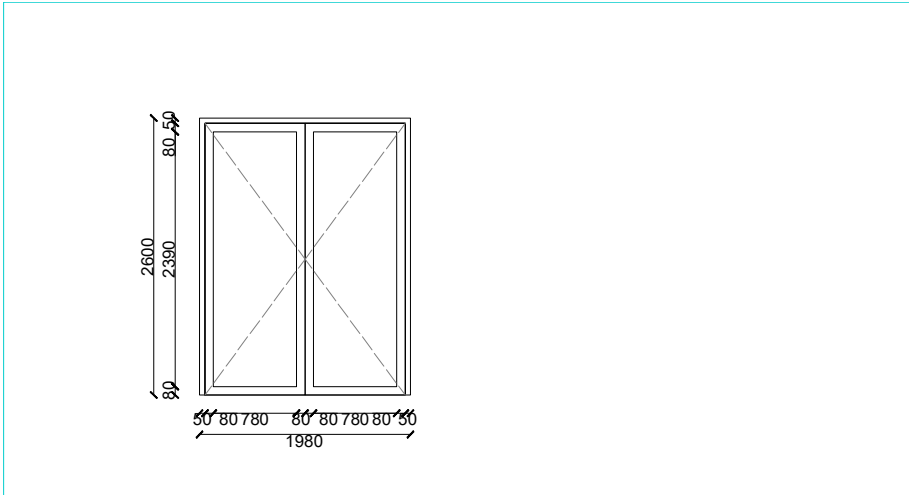

Door Types

D.00.07

Door

count: 1

Elevation

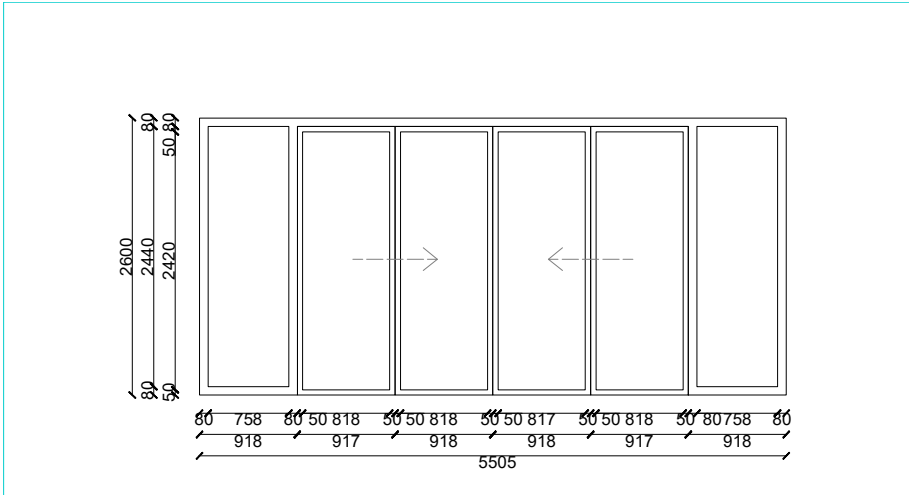

Shop Frame - Type

SF.00.01

Shop Frame

count: 1

Elevation

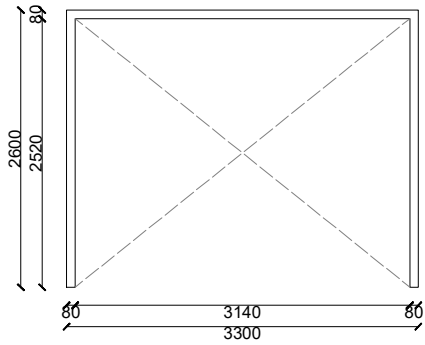

Shop Frame - Type

SF.00.02

Shop Frame

count: 2

Elevation

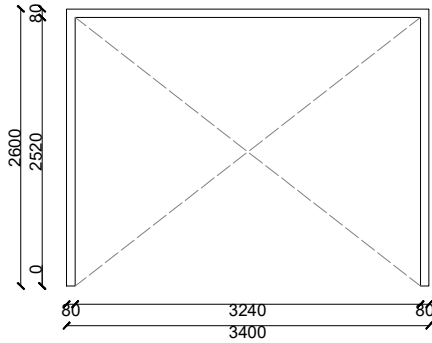

Shop Frame - Type

SF.00.03

Shop Frame

count: 1

Elevation

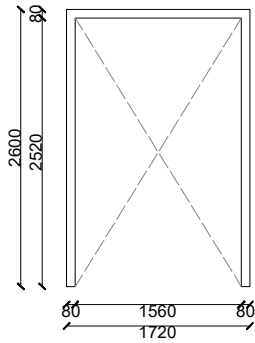

Shop Frame - Type

SF.00.04

Shop Frame

count: 5

Elevation

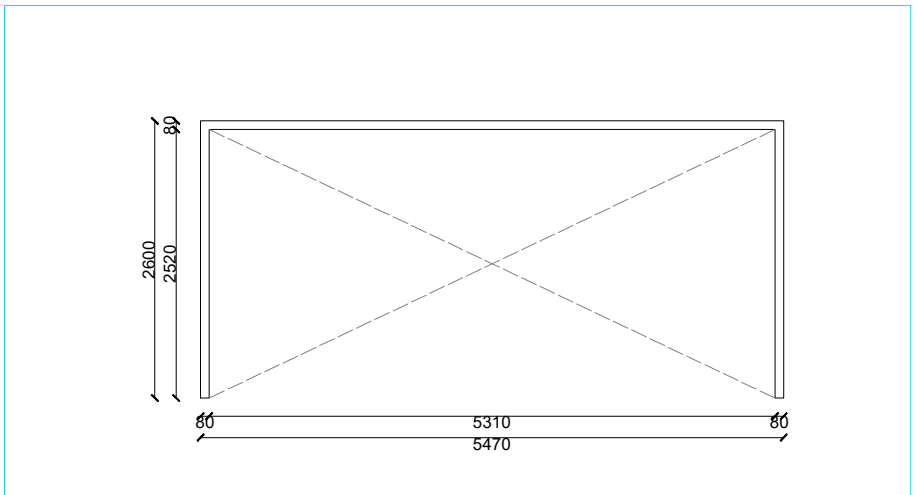

Shop Frame - Type

SF.00.05

Shop Frame

count: 1

Elevation

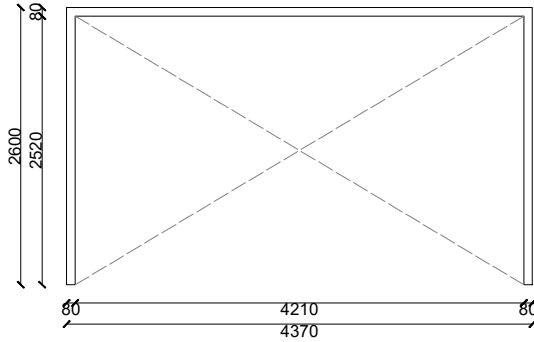

Shop Frame - Type

SF.00.06

Shop Frame

count: 1

Elevation

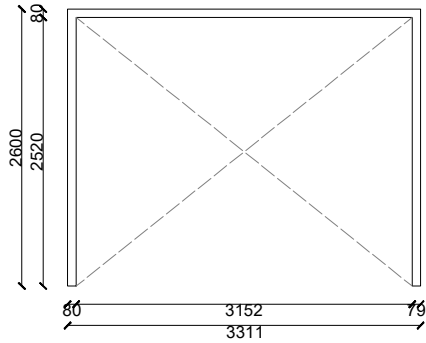

Shop Frame - Type

SF.00.07

Shop Frame

count: 1

Elevation

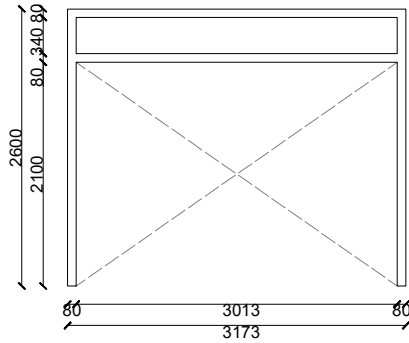

Shop Frame - Type

SF.00.08

Shop Frame

count: 2

Elevation

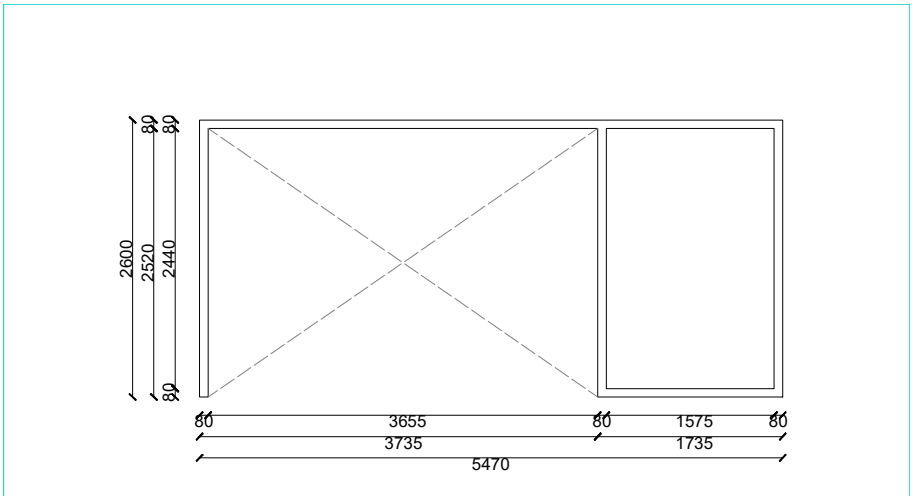

Shop Frame - Type

SF.00.09

Shop Frame

count: 2

Elevation

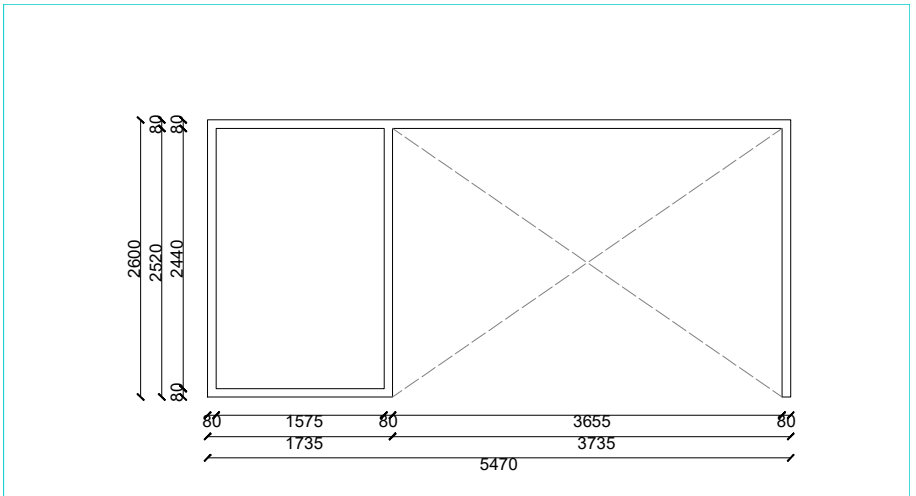

Shop Frame - Type

SF.00.10

Shop Frame

count: 1

Elevation

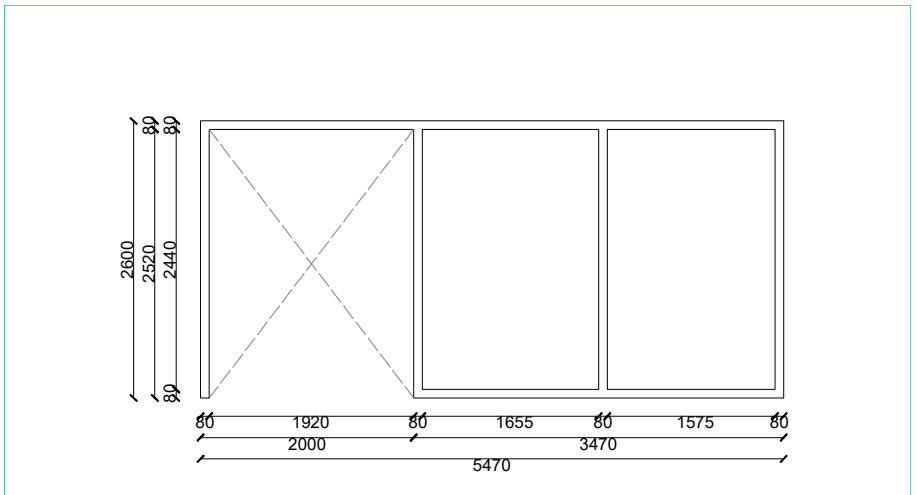

Shop Frame - Type

SF.00.11

Shop Frame

count: 1

Elevation

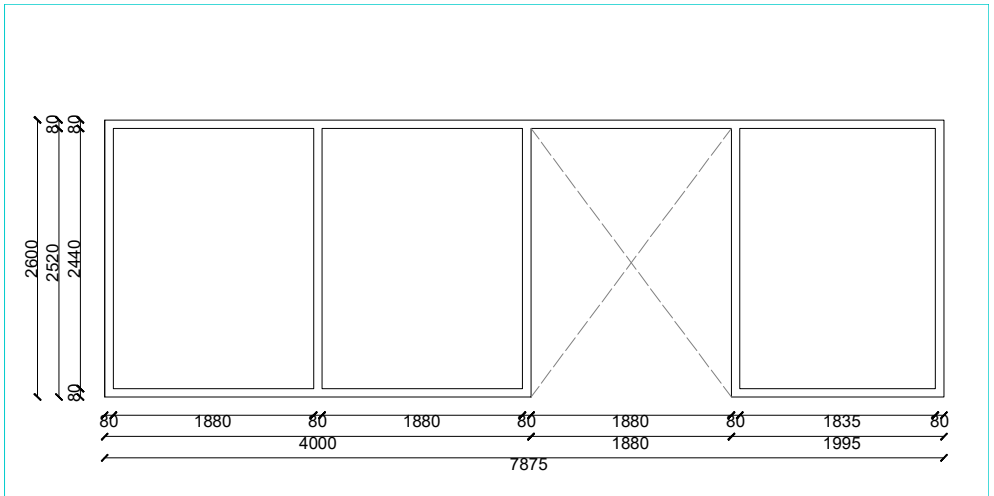

Shop Frame - Type

SF.00.12

Shop Frame

count: 1

Elevation

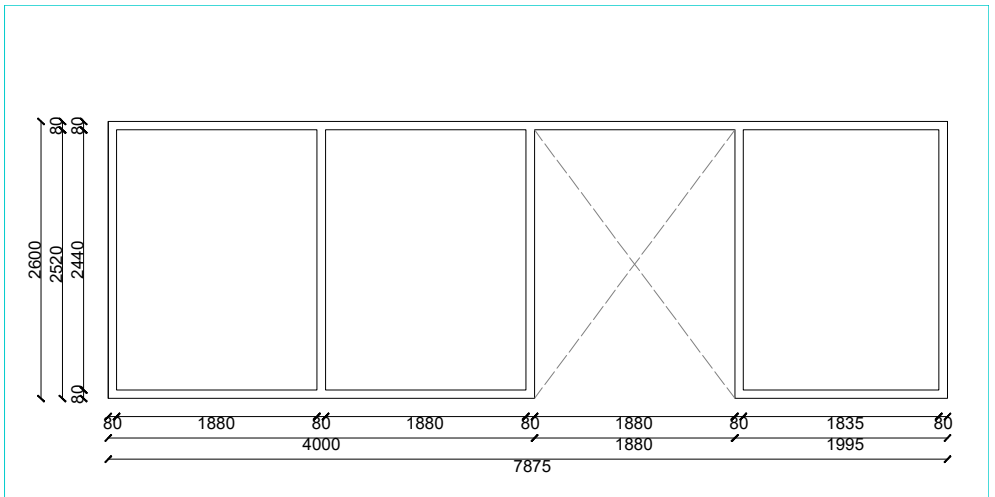

Shop Frame - Type

SF.00.13

Shop Frame

count: 1

Elevation

