

An architectural rendering of a proposed urban intervention in the Blokhuispoort area. The scene features a canal in the foreground with a small boat. A tall, slender, grey concrete pillar stands on the left. In the background, traditional Dutch brick houses line the canal. To the right, a large, modern building with a complex, angular, and translucent facade is integrated into the existing urban fabric. A green lawn area in front of this building is populated with people sitting and lying down, suggesting a public space. The sky is a pale, overcast blue.

# EVENTBASED INTERVENTIONS FOR THE LONG TERM IMPROVEMENT

*Designing the transformation of the Blokhuispoort catalysed by LWD 2018*

## P5 PRESENTATION

14-04-2015

Delft University of Technology  
Faculty Architecture, Urbanism and Building  
Sciences  
Graduation Project  
ExploreLab 20  
Spring 2016

Geerte Baars















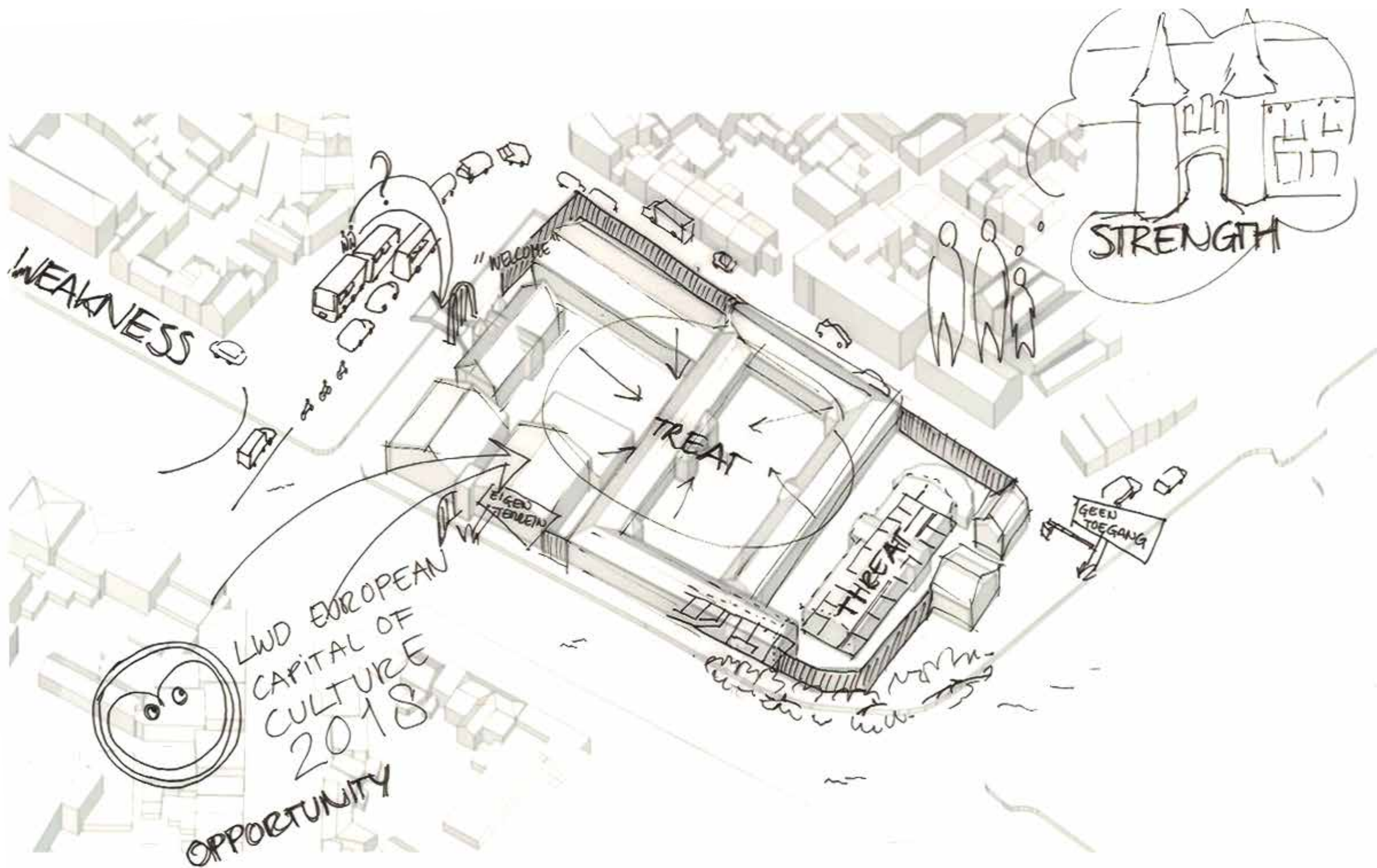

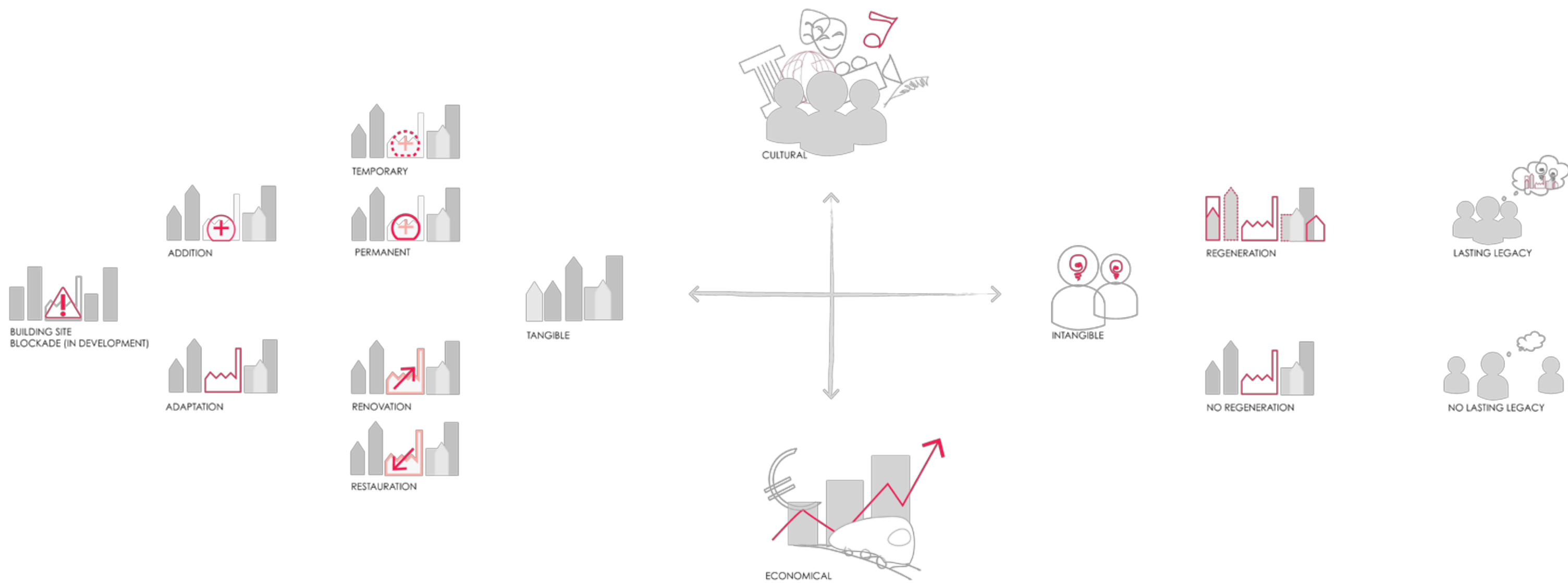

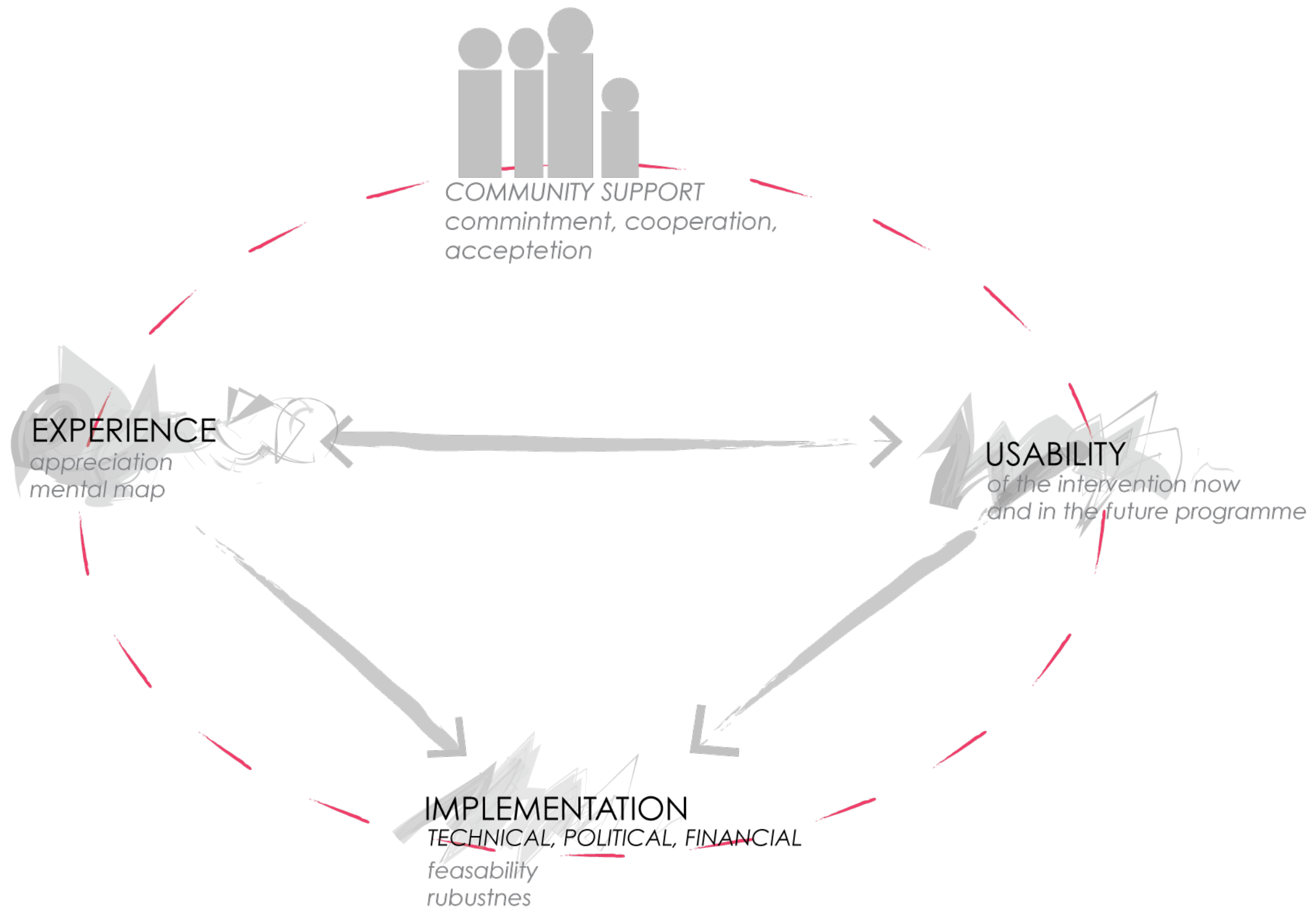

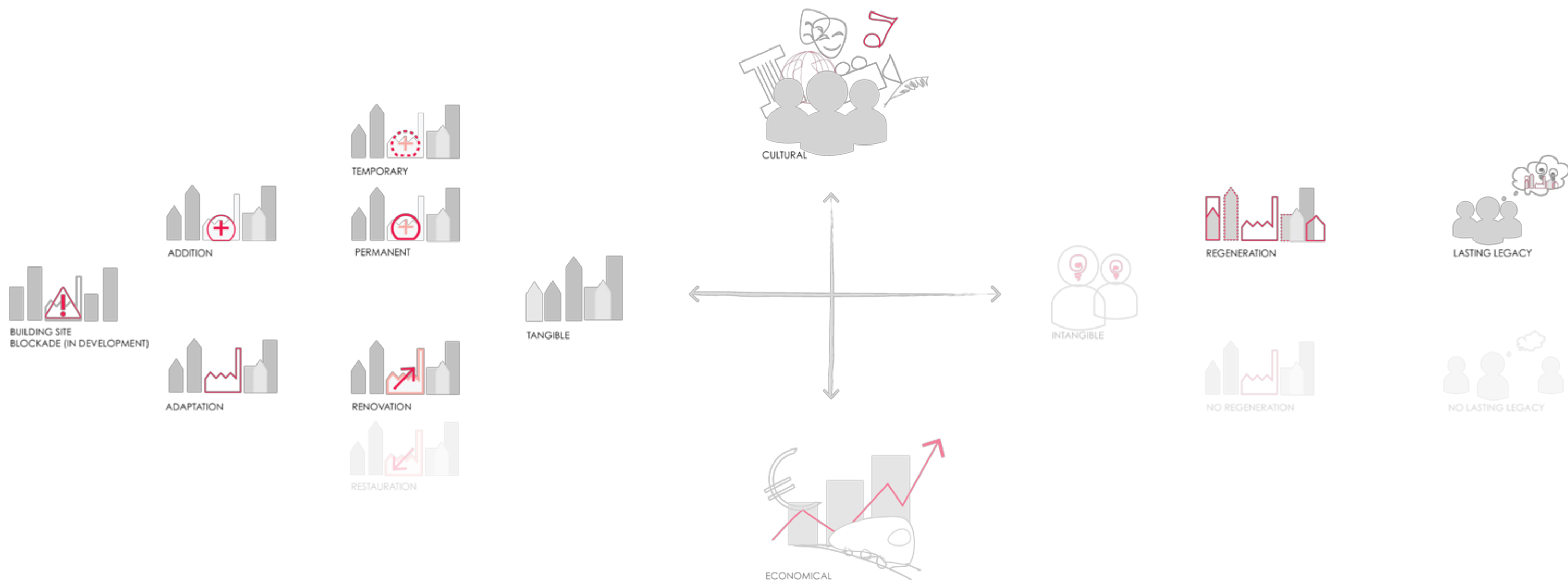



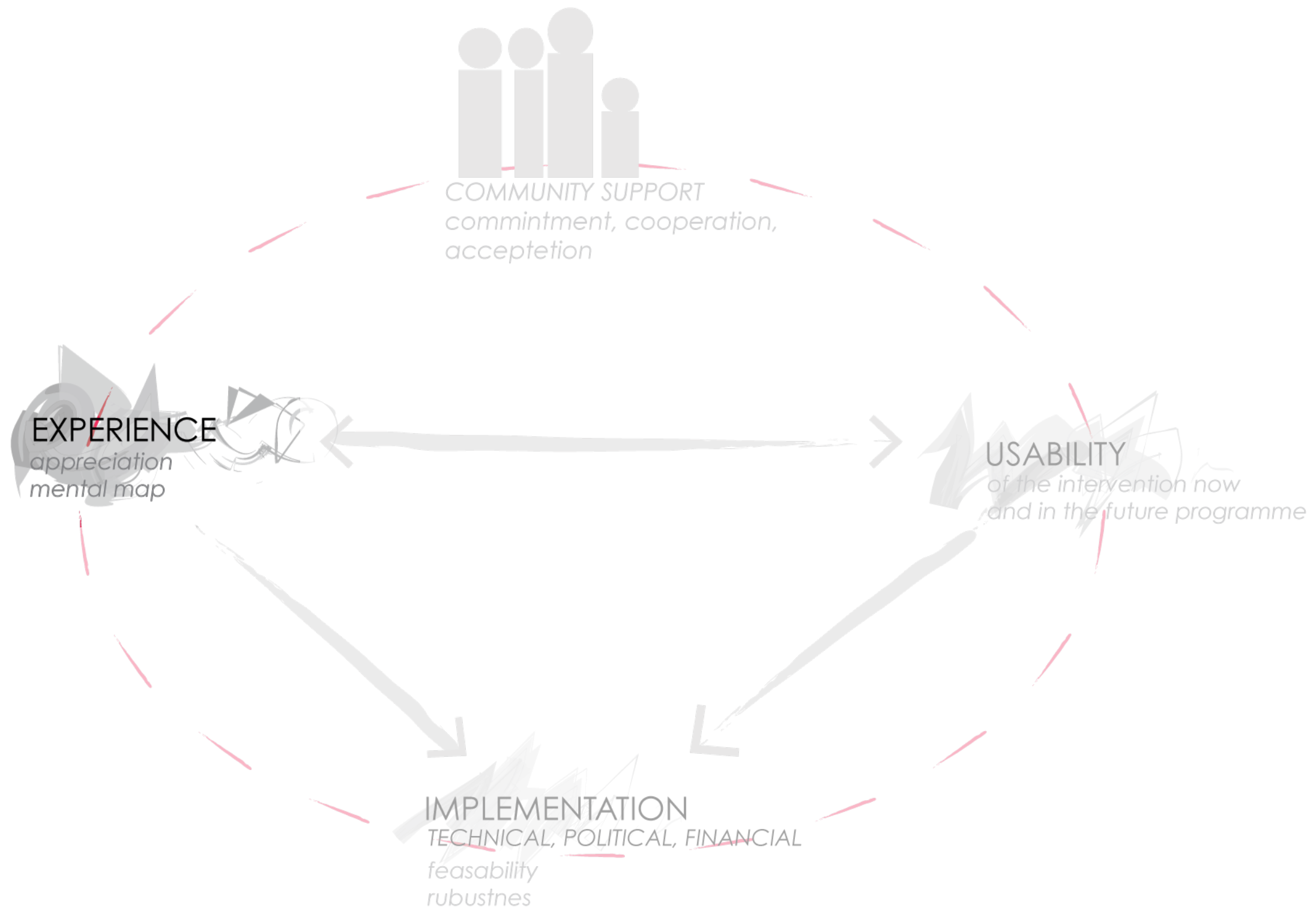



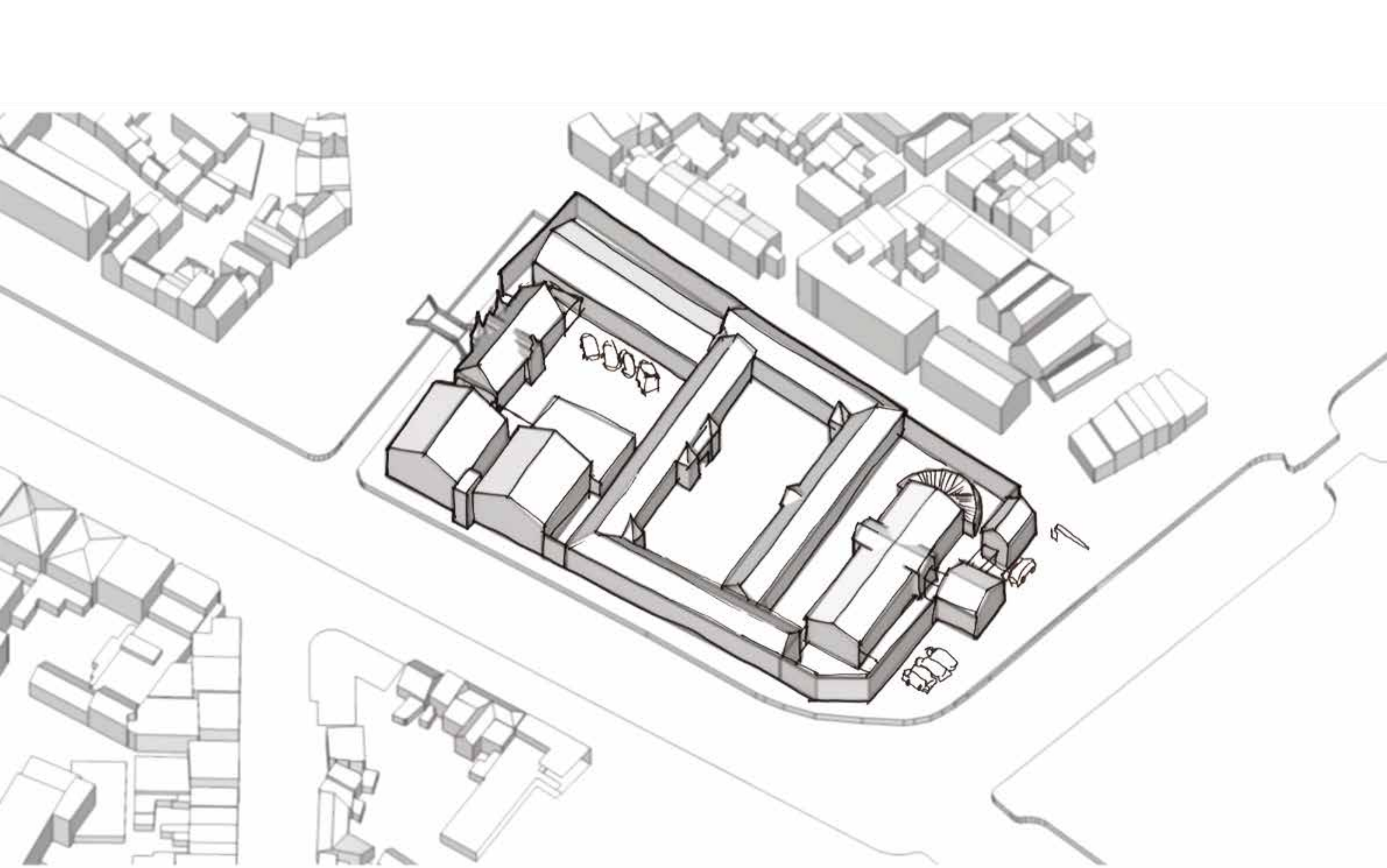



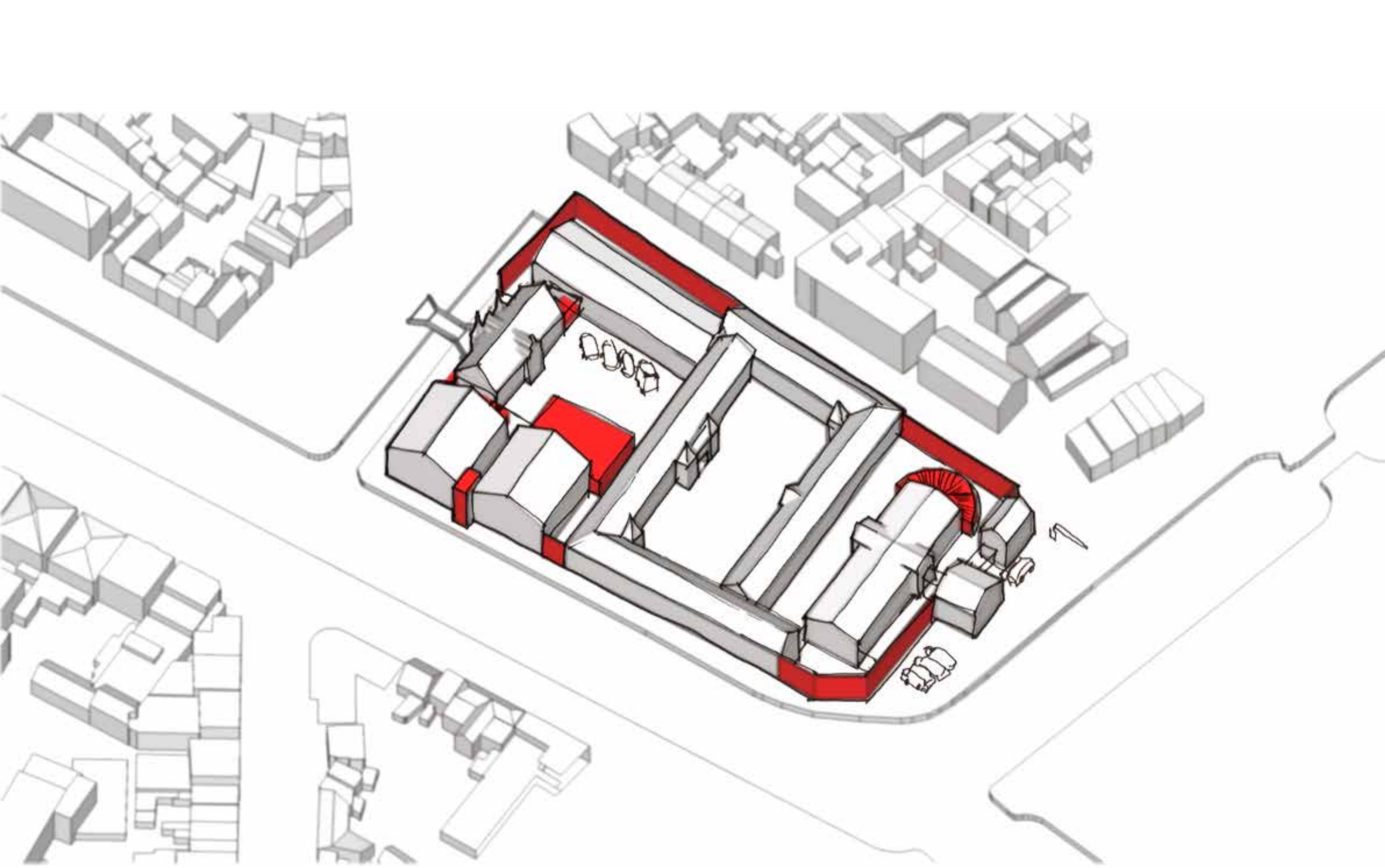



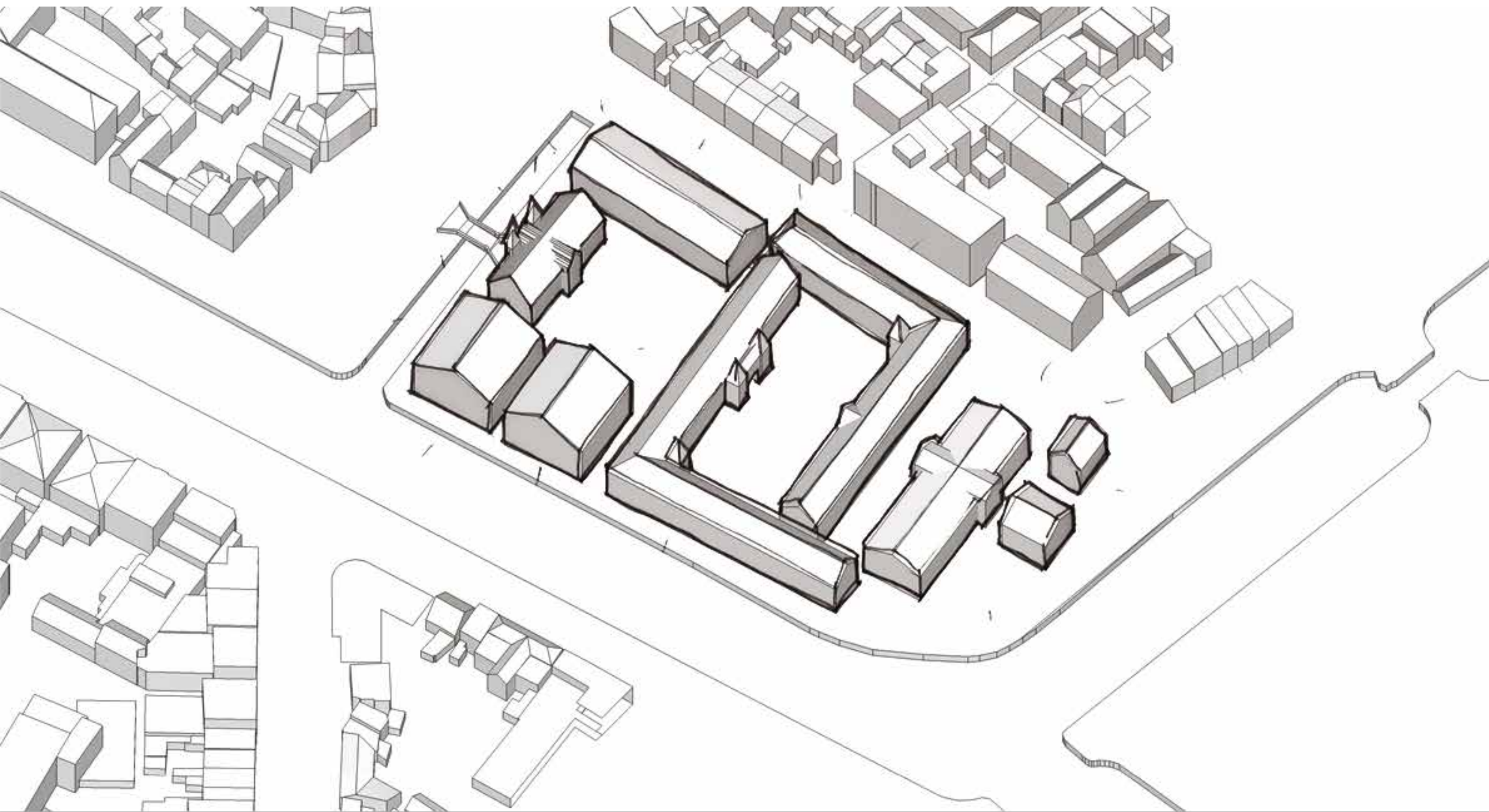



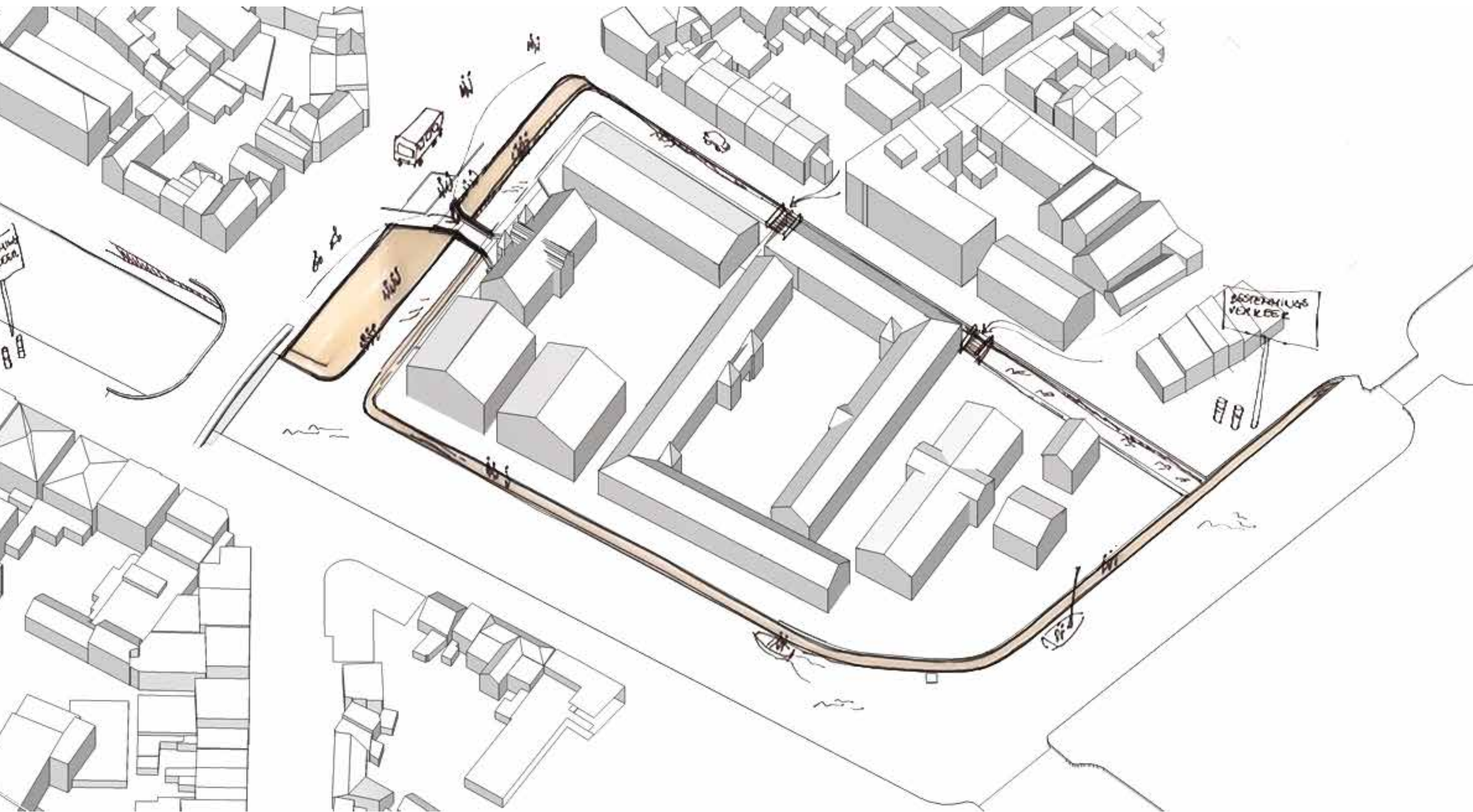











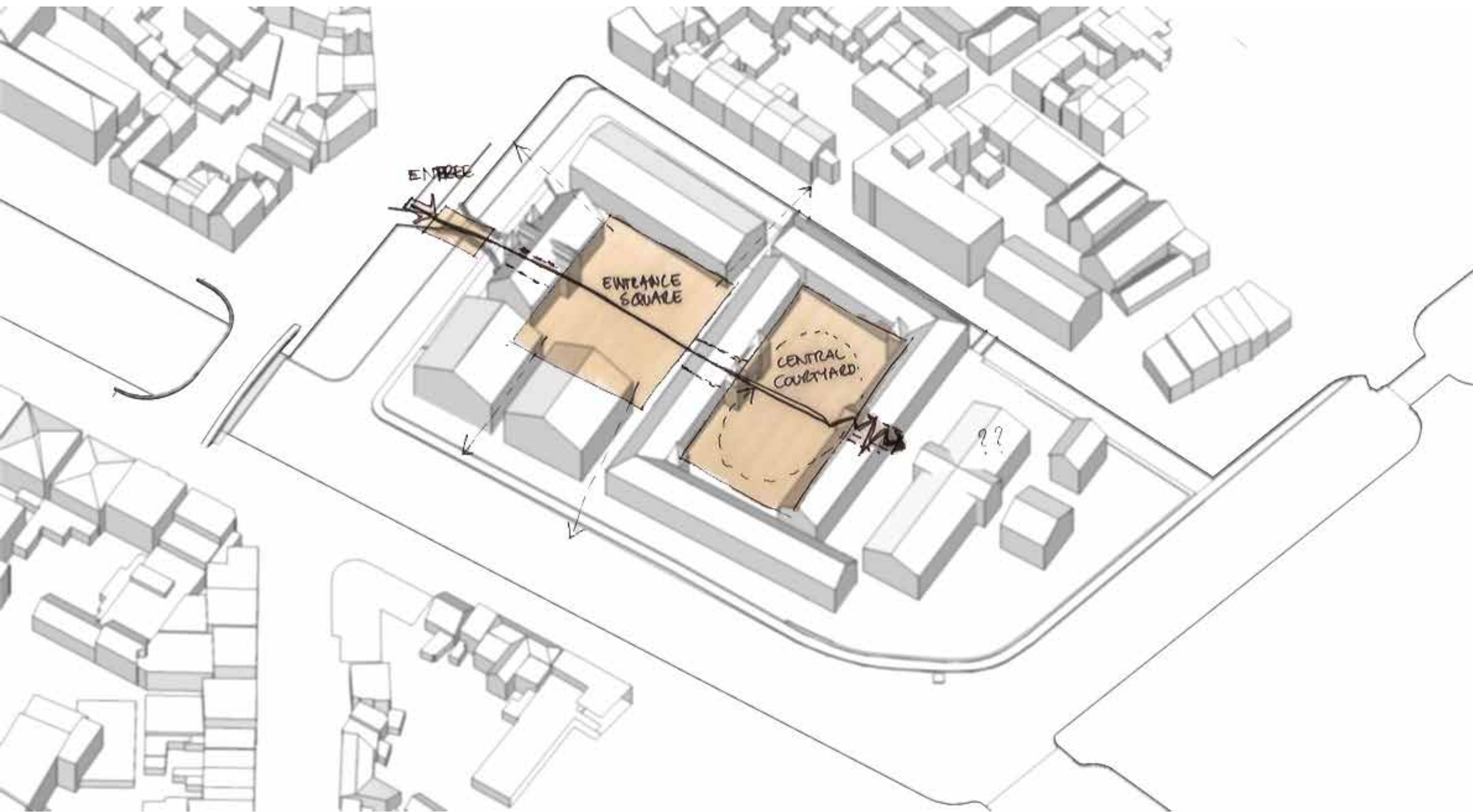







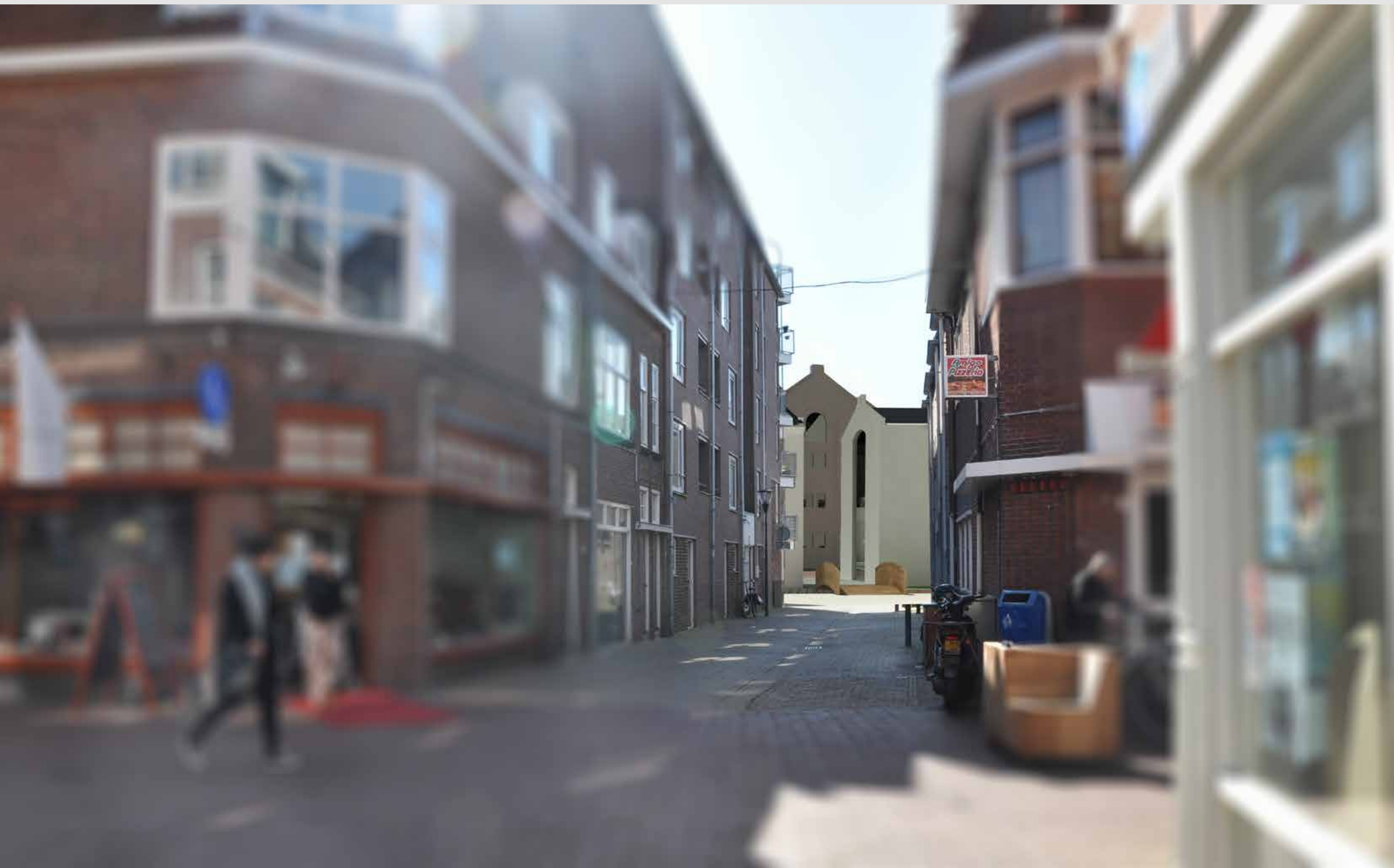



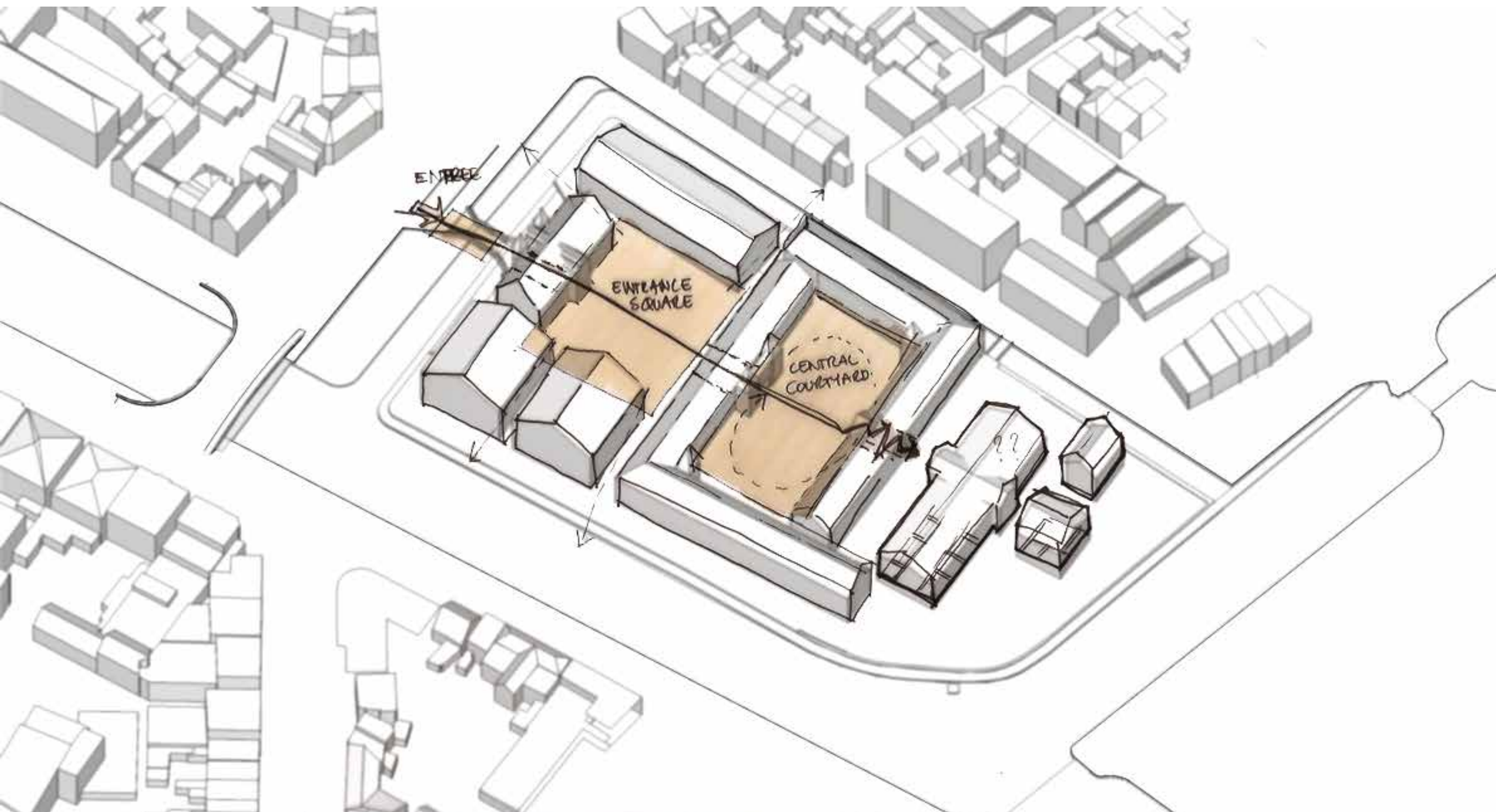







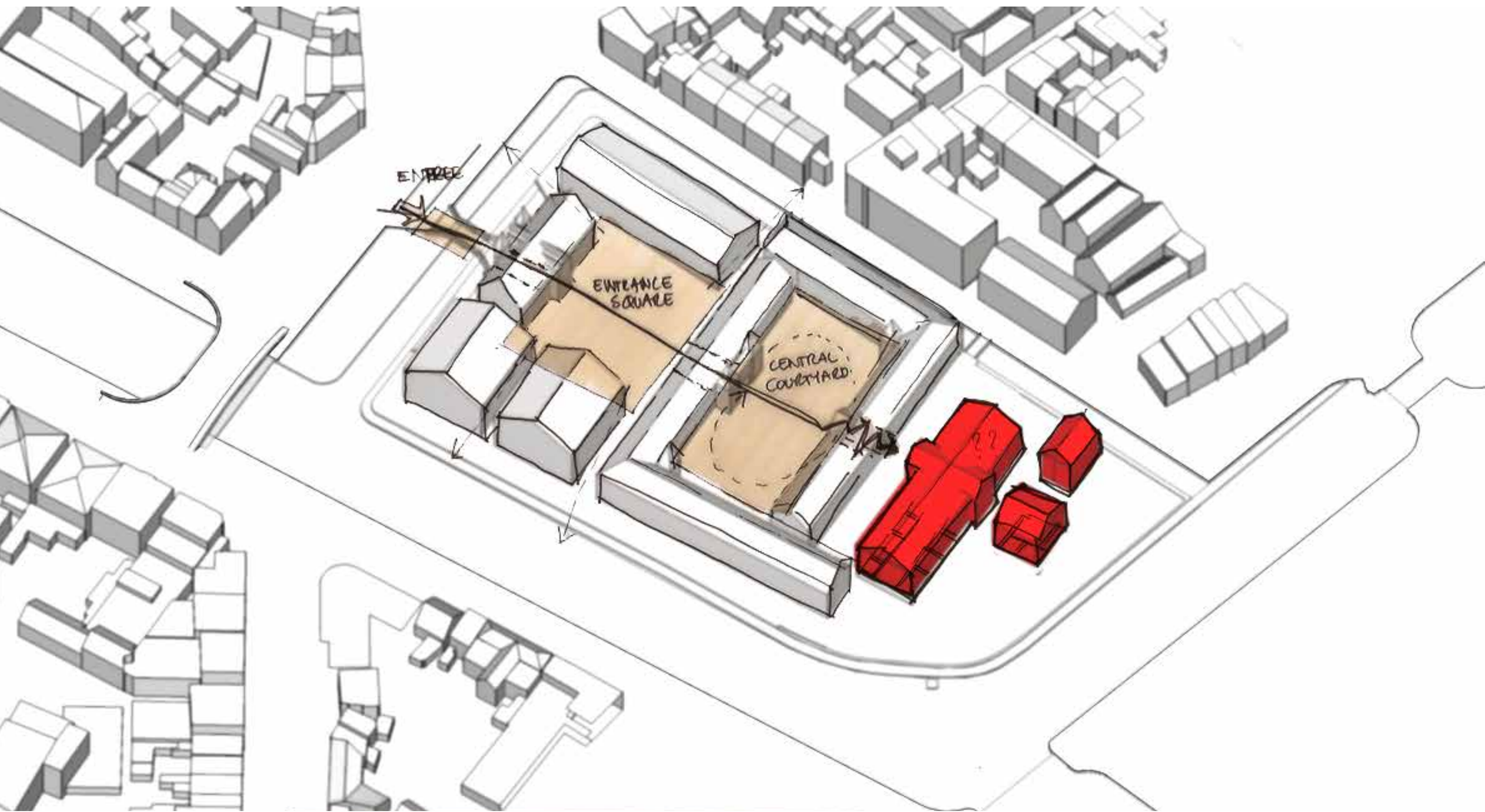



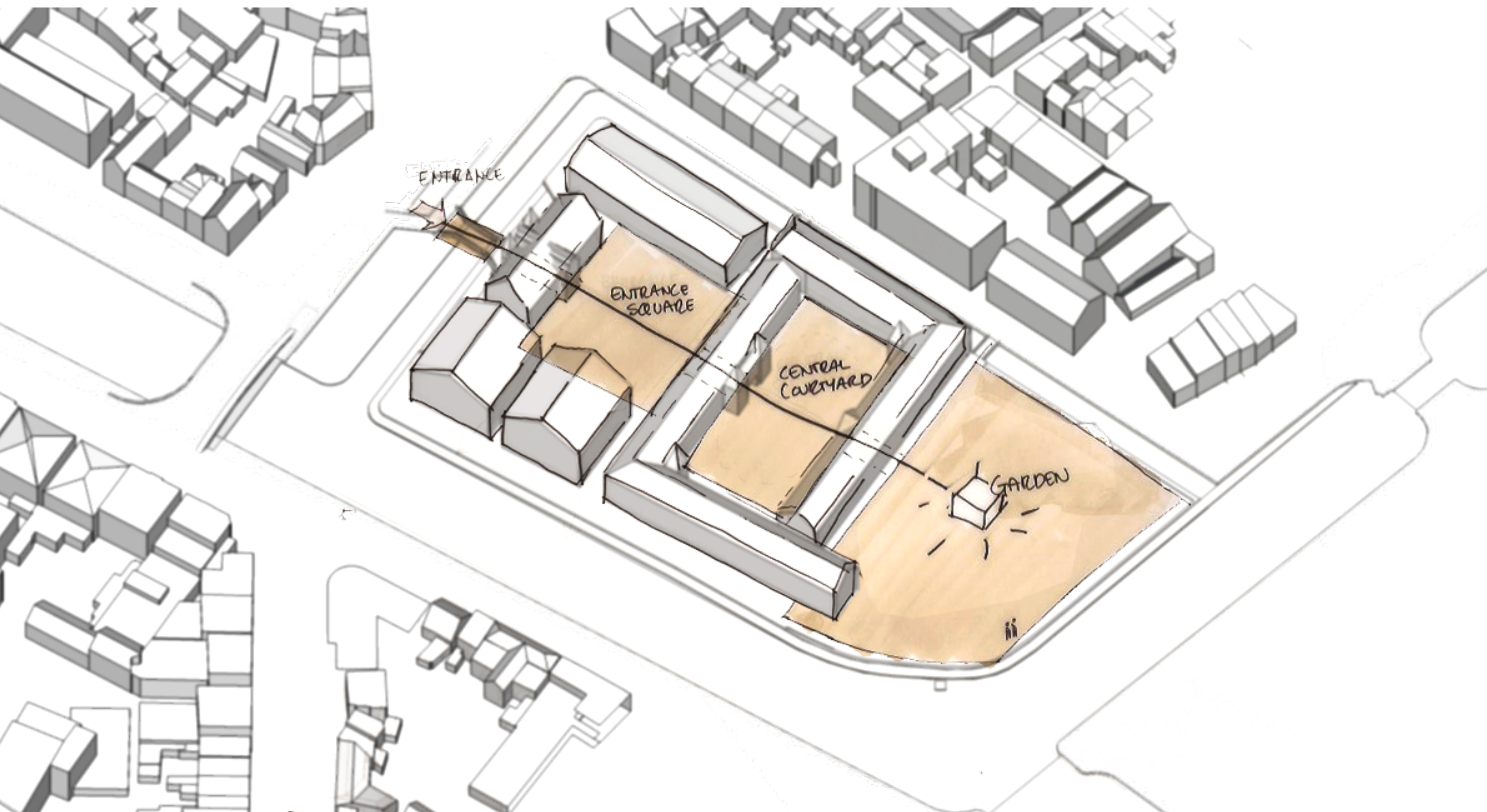



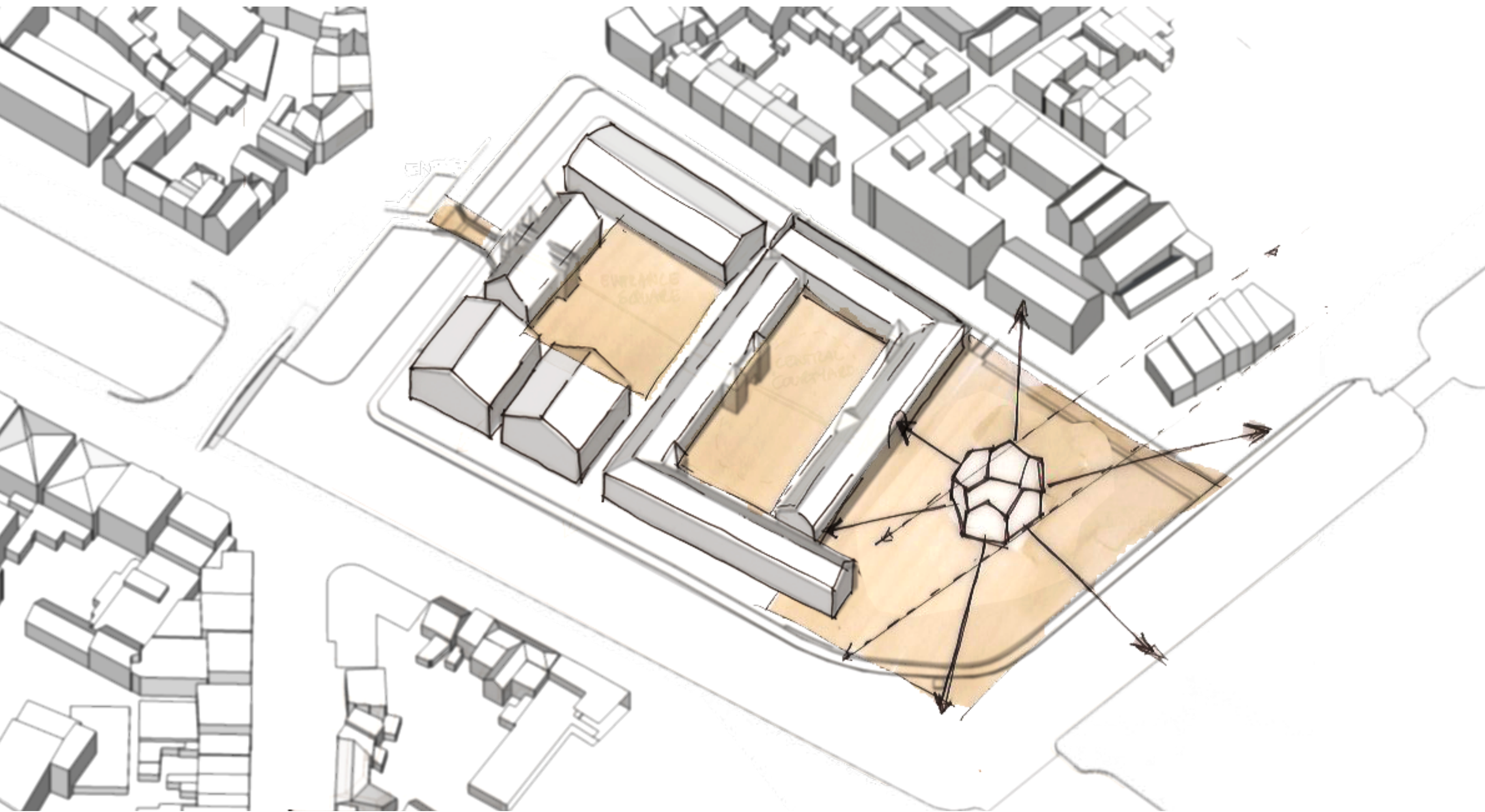



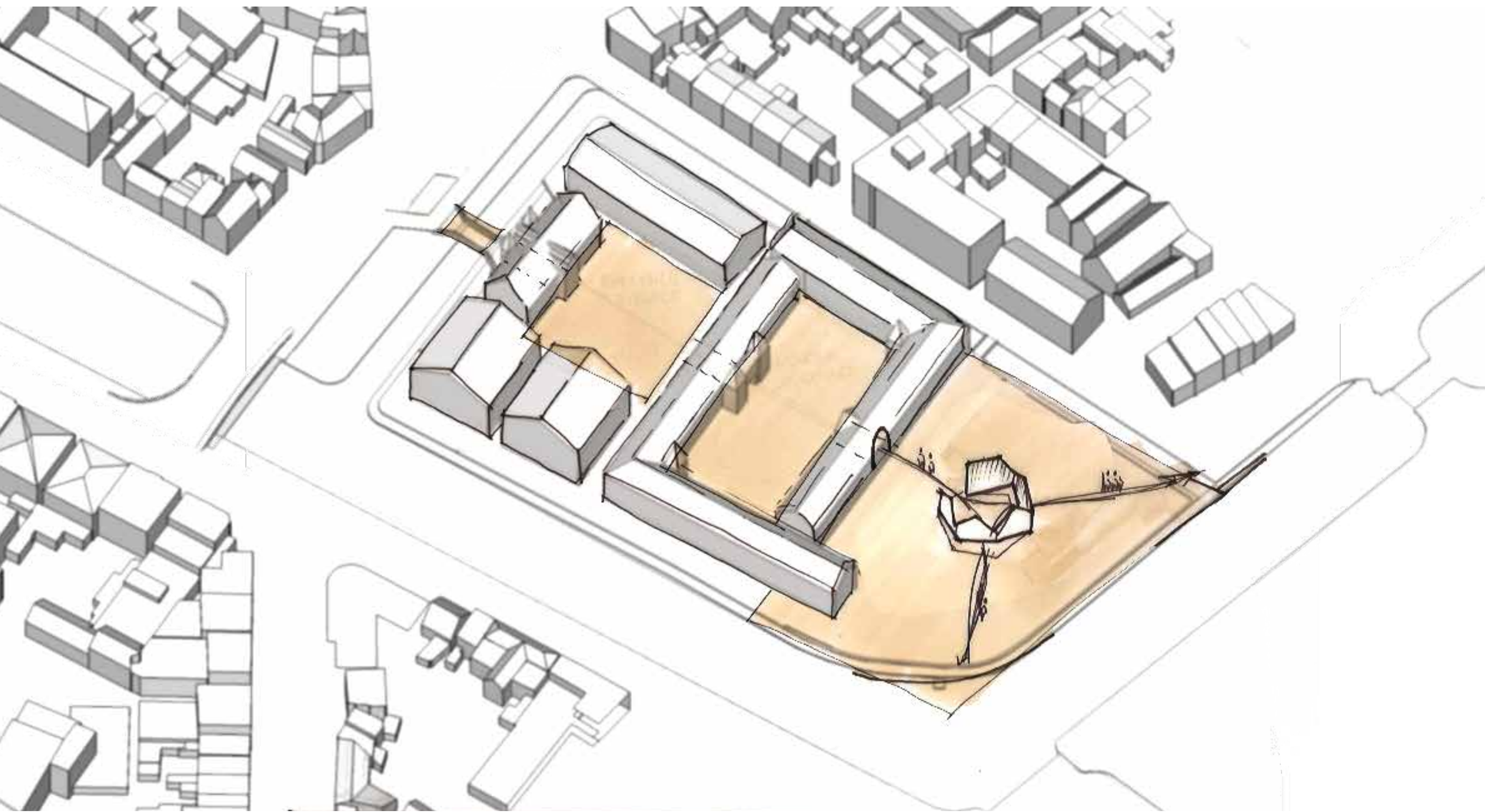



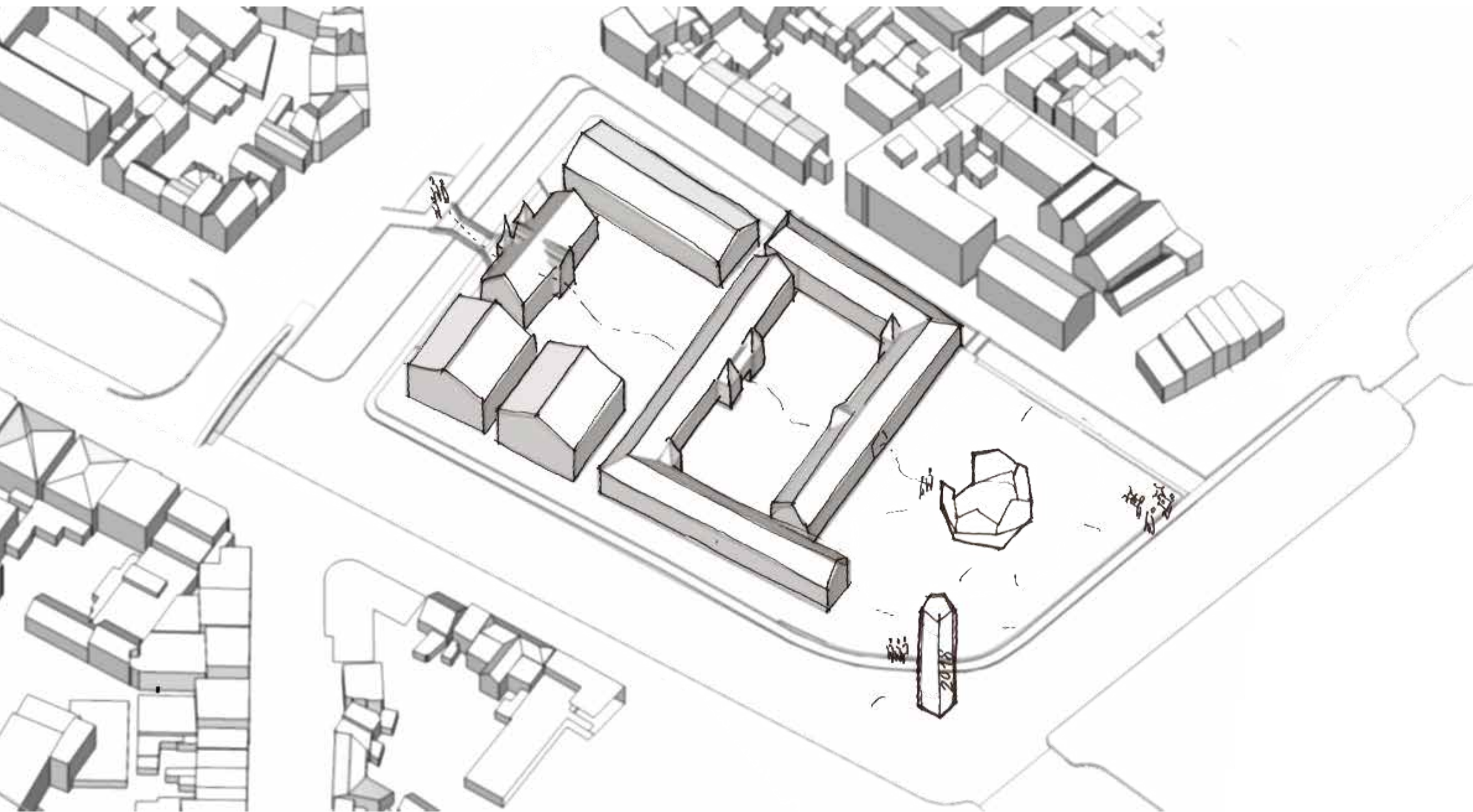



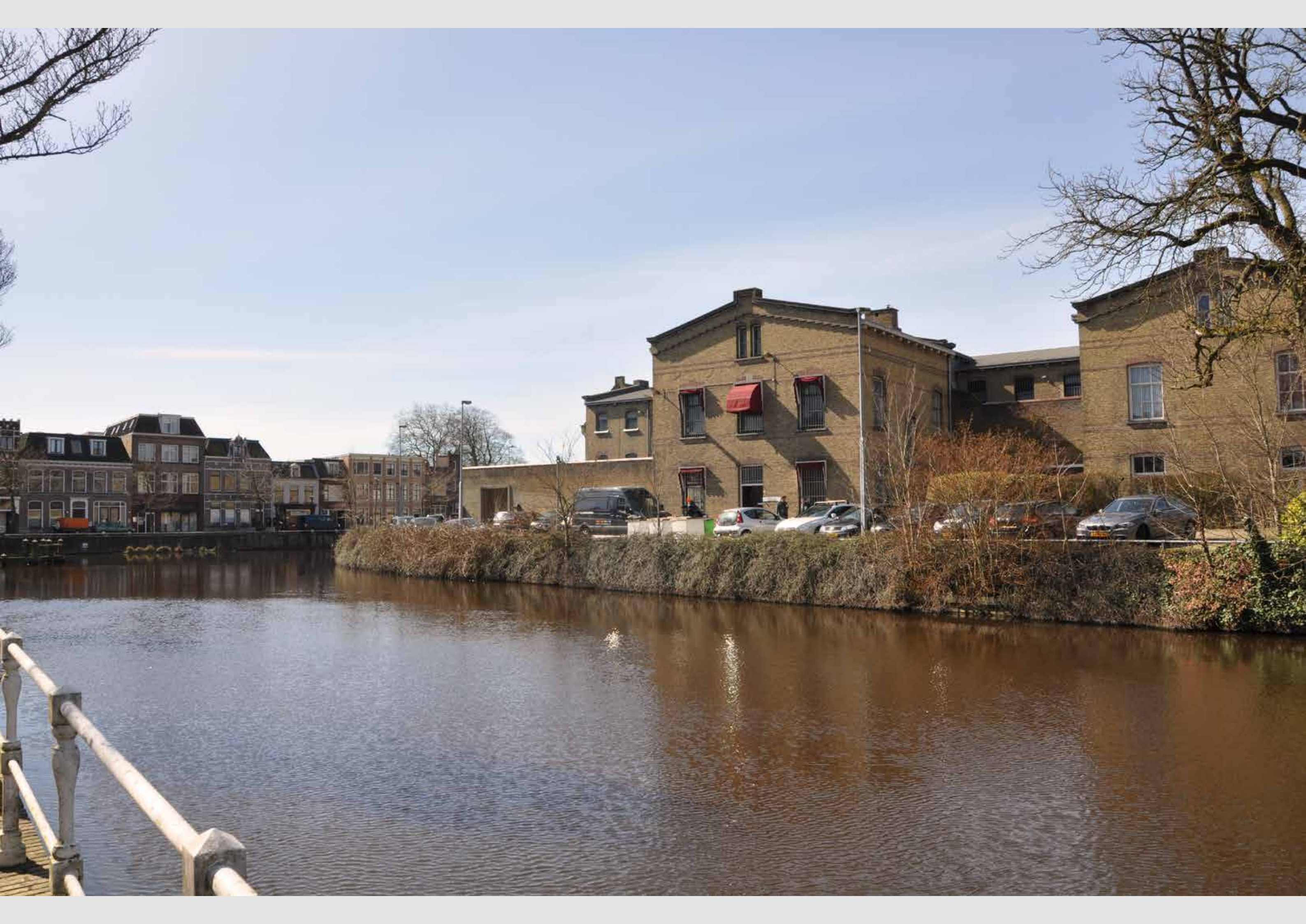







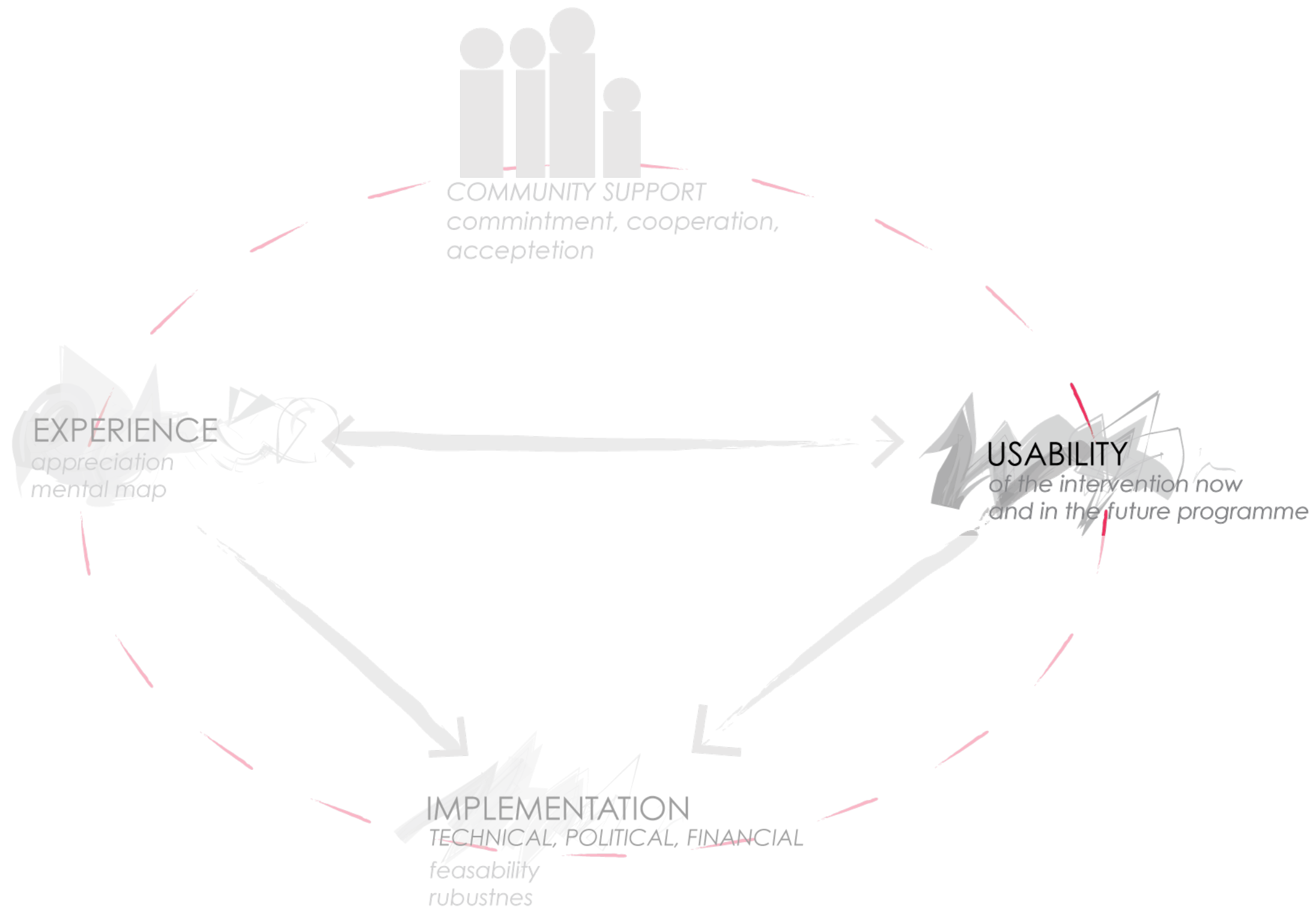



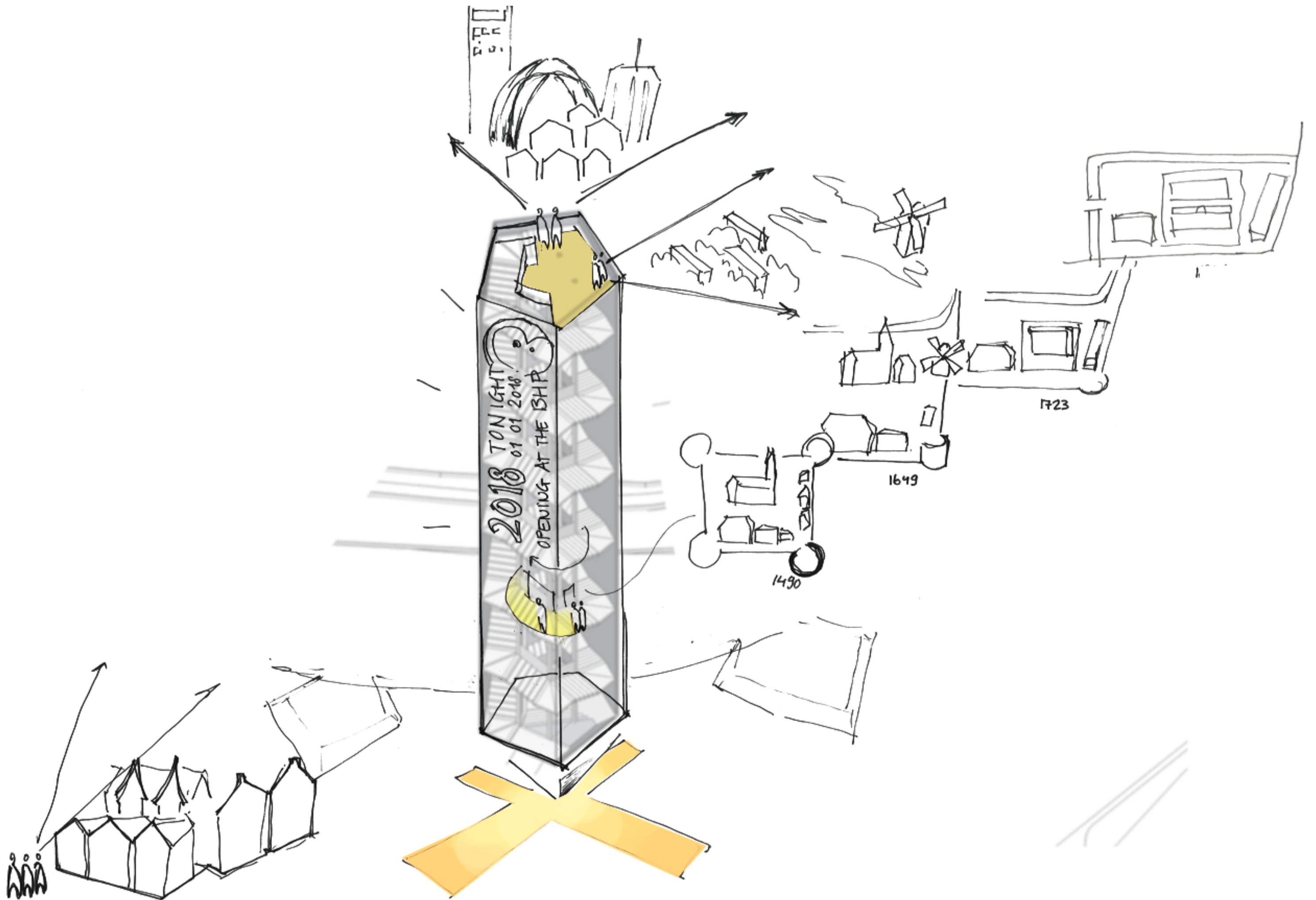







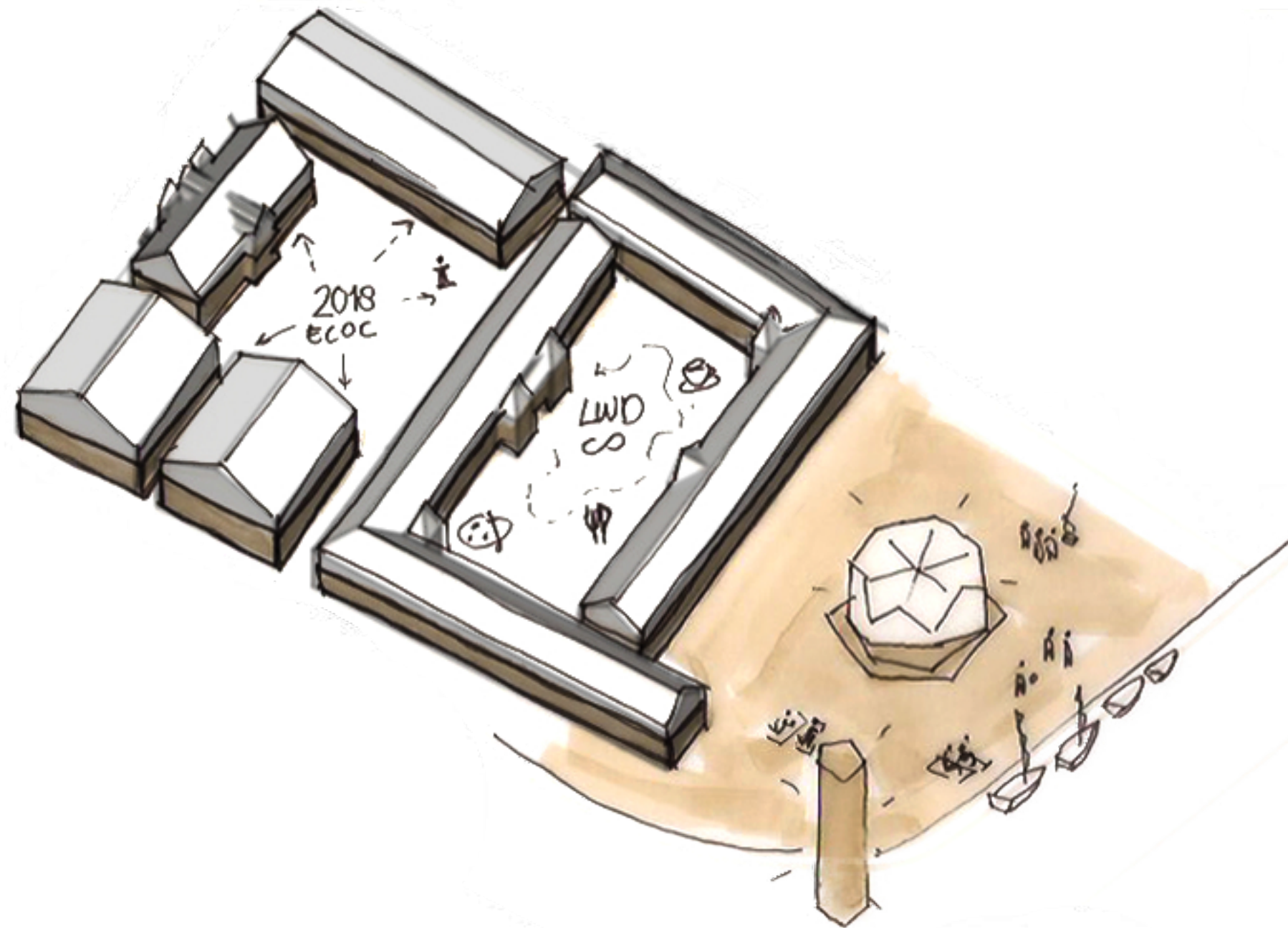





2018

#### LEGENDA

- OFFICE 2018/CONCIERGE
- HOSTEL/ HOTEL
- EXHIBITION SPACES
- FLEXIBLE SPACE
- INFORMATION OFFICE LWD2018
- CREATIVE SHOPS/ATELIERS
- HORECA / RESTAURANT/BAR/SPECIAALZAAK



na 2018

- VIEWING POINT / HISTORY OF THE CITY
- STUDY/ FLEXWERK/ RESEARCH SPACES
- ENTREPRENEURS/RESEARCHERS
- SMALL-SCALE EXHIBITIONS/ MEETING ROOMS/ ATELIERS/ OFFICES 2018
- (INTERACTIVE) ART EXHIBITION
- CONCIERGE/ OFFICE



