

Master thesis presentation P5

Timmo de Haas – 4987314

02-07-21

Research Conclusions	06
Design The infill	07
Design The parts	17
Design The case study	30
Design Conclusion	46
VR Exhibition	48

The research

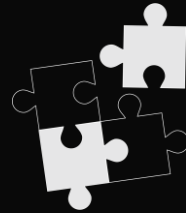
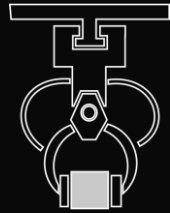

RESEARCH

1. Research
2. Design | The infill
3. Design | The parts
4. Design | The case study
5. Conclusion
6. Until P5

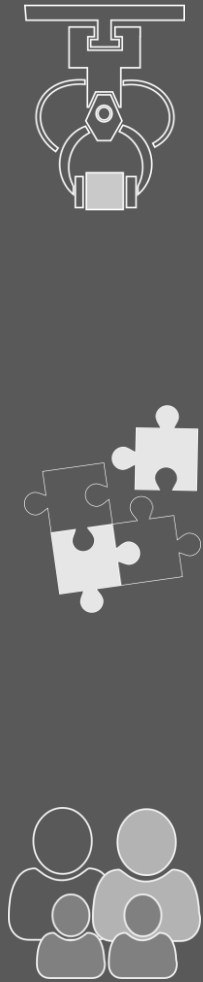

Design components

The infill system

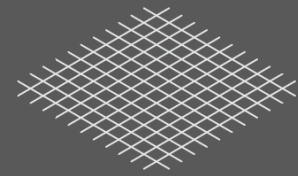

Dimensional coordination System

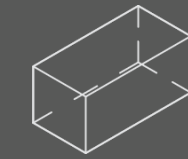

Volumetric unit

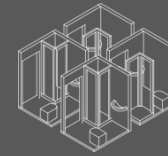

Catalog of modular pods

The open Building parts

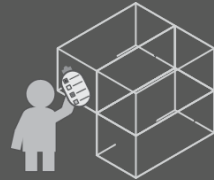

User interaction

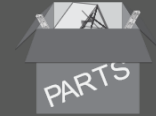

Kit of parts

Case study

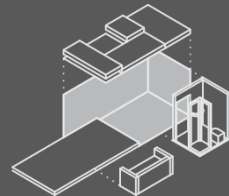

Example units

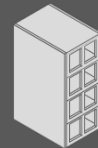

Existing building

Design parts

The infill

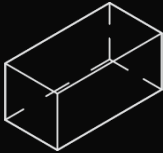
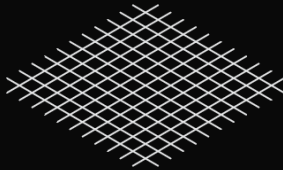

THE INFILL SYSTEM | DESIGN

1. Research
2. Design | The infill
3. Design | The parts
4. Design | The case study
5. Conclusion
6. Until P5

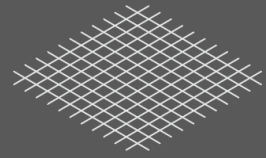

The Support



The infill

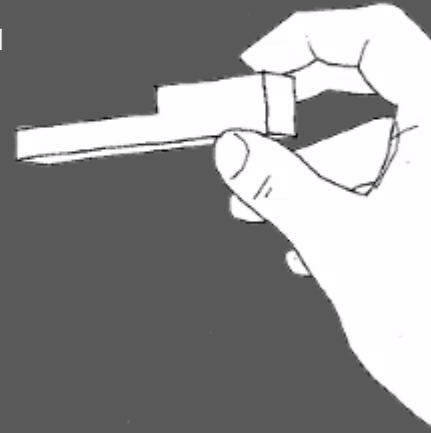

THE INFILL SYSTEM | DESIGN

1. Research
2. Design | The infill
3. Design | The parts
4. Design | The case study
5. Conclusion
6. Until P5

Dimensional coordination

- Create a system

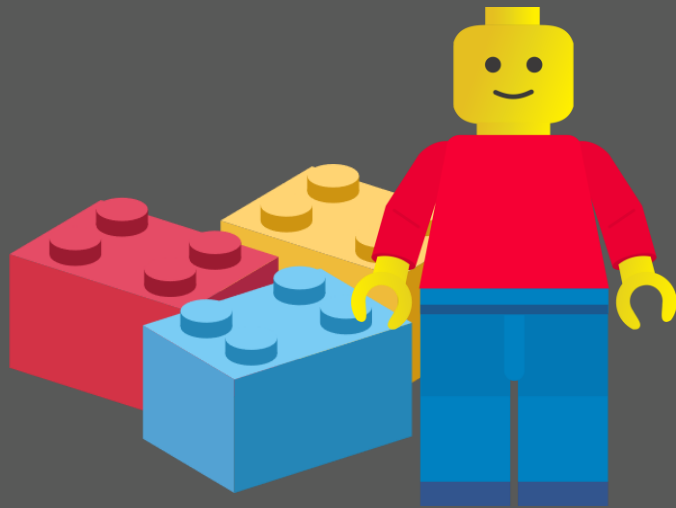

THE INFILL SYSTEM | DESIGN

1. Research
2. Design | The infill
3. Design | The parts
4. Design | The case study
5. Conclusion
6. Until P5

Dimensional coordination

- Based on the human measurements
- Of a dimensional coordination system the most important part is the module.

The module

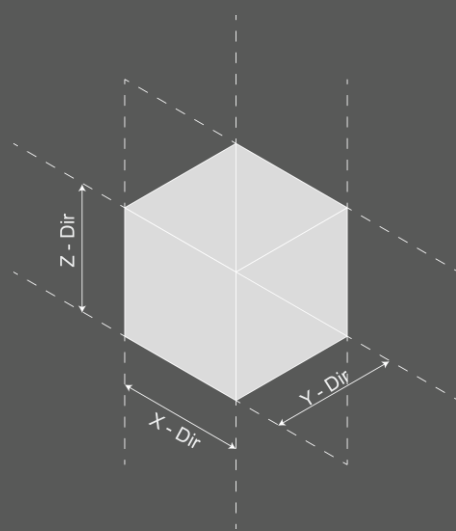

The micro voxel

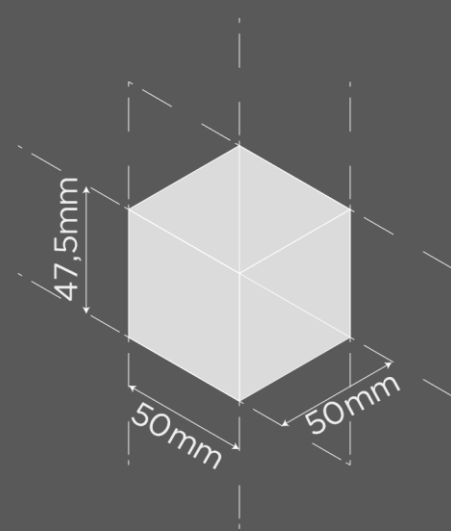

THE INFILL SYSTEM | DESIGN

1. Research
2. Design | The infill
3. Design | The parts
4. Design | The case study
5. Conclusion
6. Until P5

The open building unit

The maximum

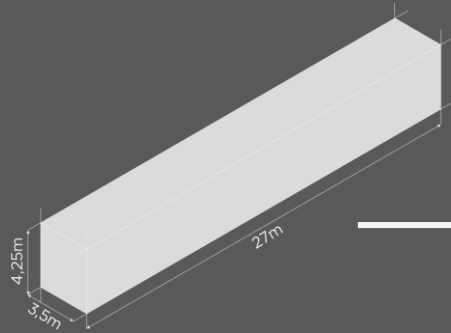

Two mezo voxels:
The unit

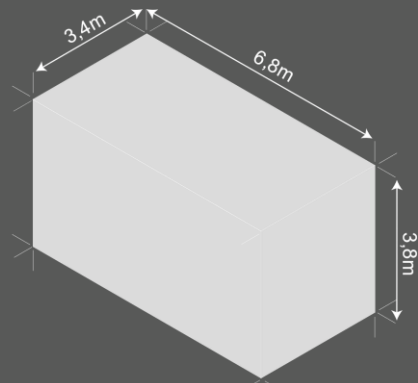

The minimum

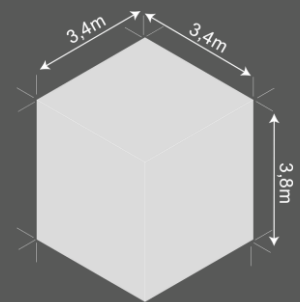
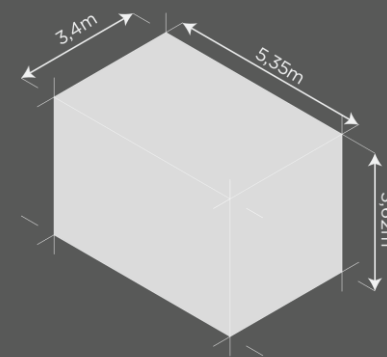

The open building concept: the
mezo voxel

THE INFILL SYSTEM | DESIGN

Catalog of elements

- A element is a prefabricated room/ component
- Requirements:
 - o Abide by the dimensional system
 - o High accuracy, low precision



Low accuracy
Low precision



Low accuracy
High precision



High accuracy
Low precision



High accuracy
High precision

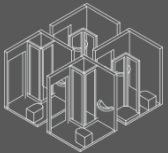

THE INFILL SYSTEM | DESIGN

1. Research
2. Design | The infill
3. Design | The parts
4. Design | The case study
5. Conclusion
6. Until P5

Catalog of pods - Kitchen

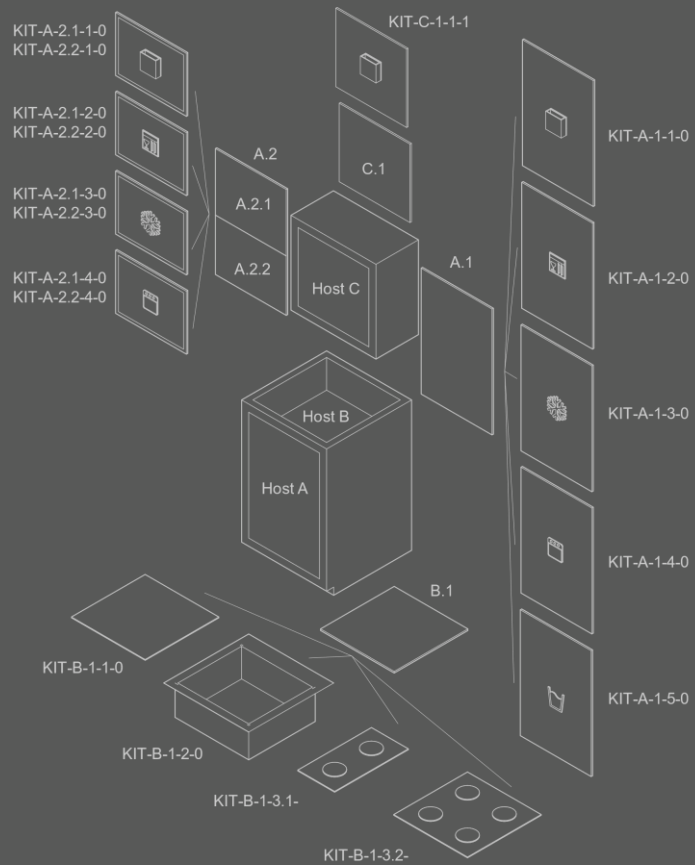

Legend



Possible configurations

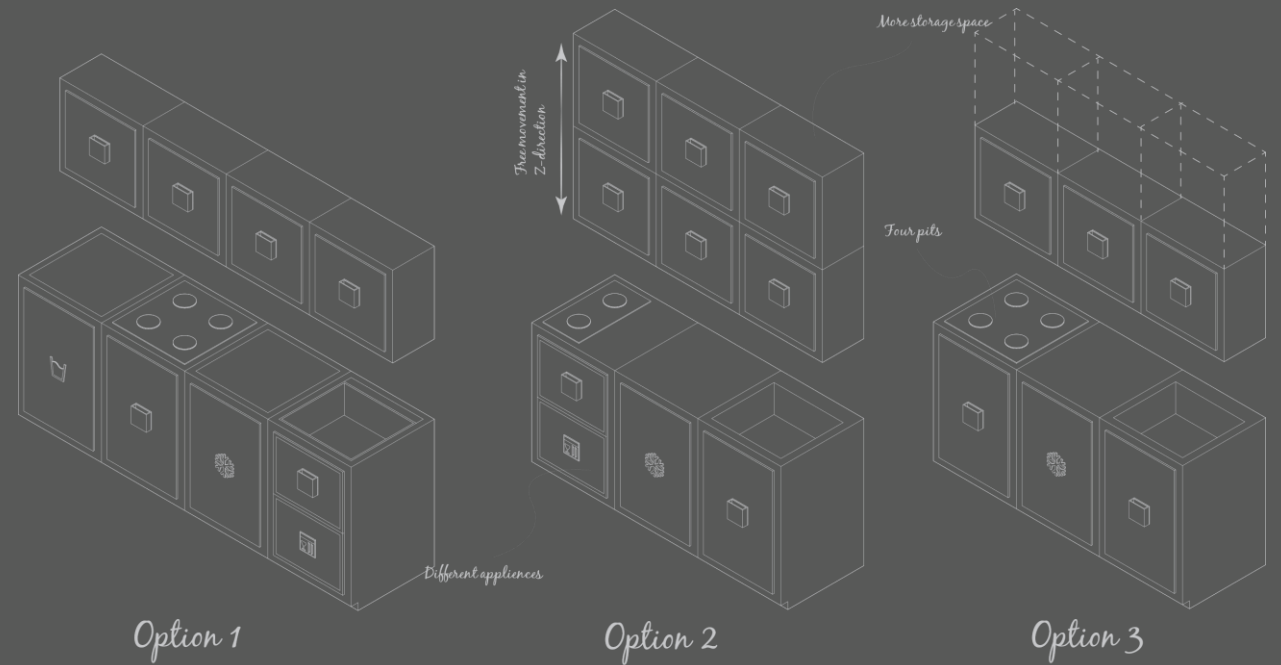

THE INFILL SYSTEM | DESIGN

1. Research
2. Design | The infill
3. Design | The parts
4. Design | The case study
5. Conclusion
6. Until P5

Catalog of pods - living room

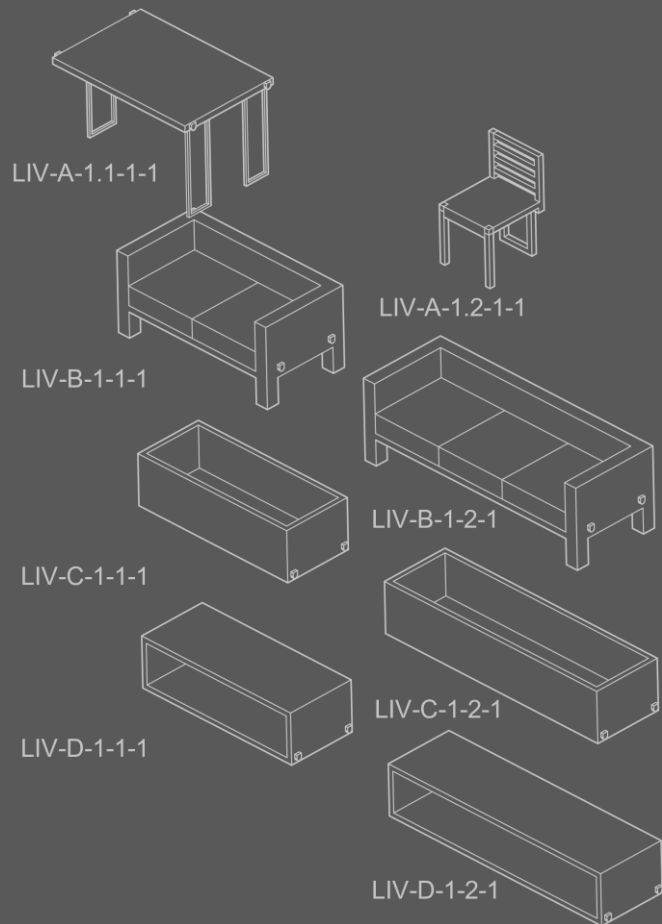

Possible configurations

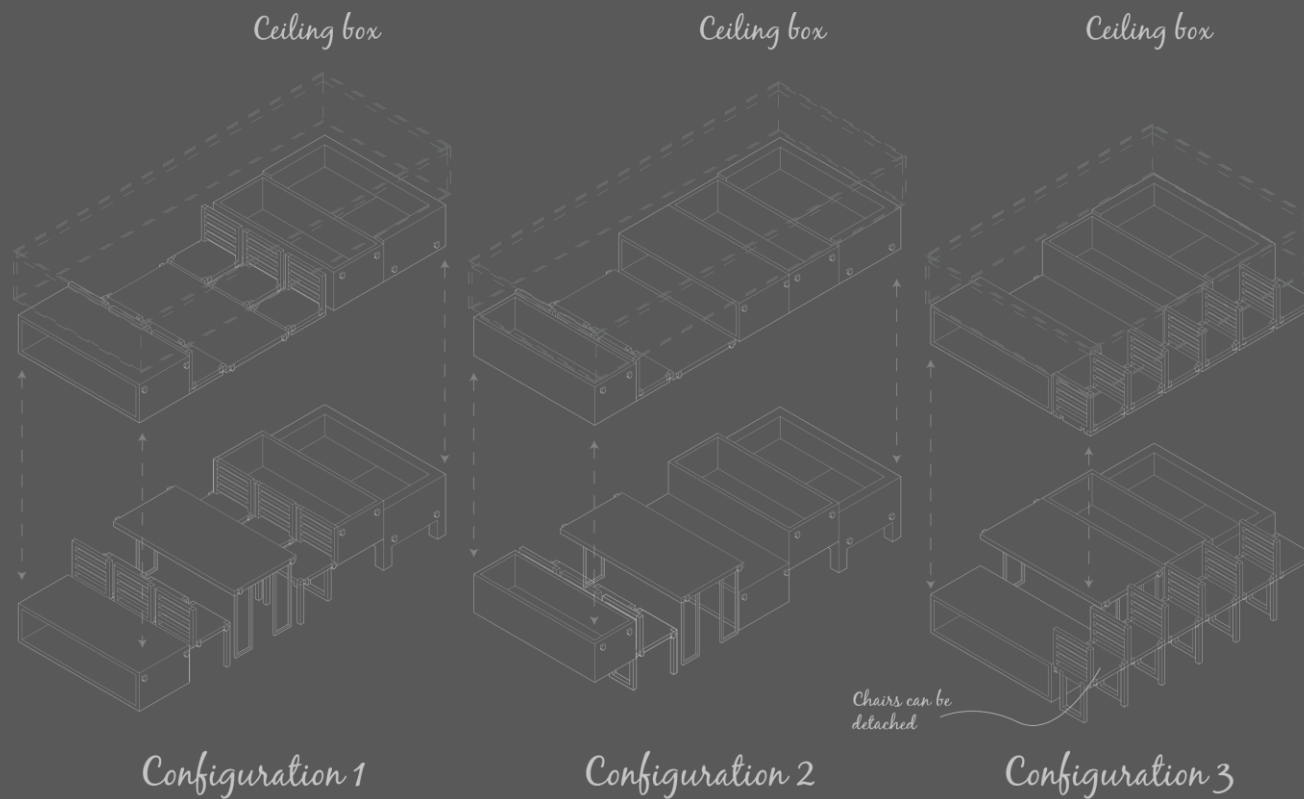

THE INFILL SYSTEM | DESIGN

1. Research
2. Design | The infill
3. Design | The parts
4. Design | The case study
5. Conclusion
6. Until P5

Catalog of pods - bedroom

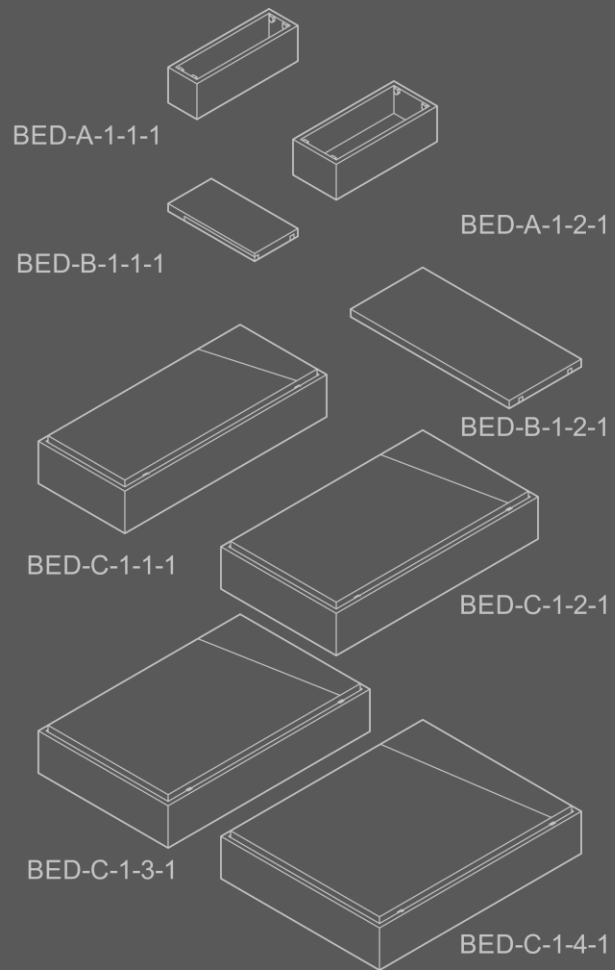

Possible configurations

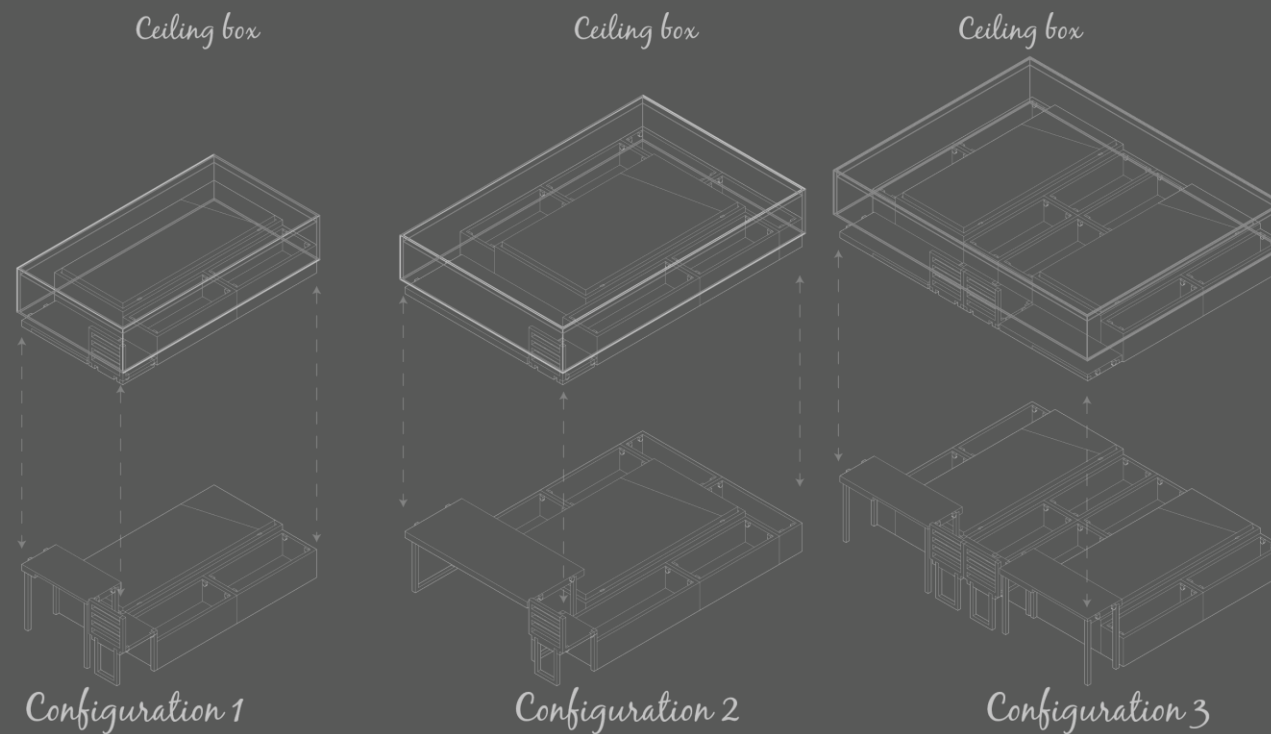

The building parts

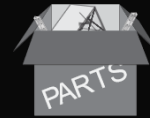
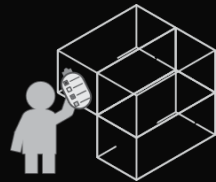

OPEN BUILDING PARTS | DESIGN

1. Research
2. Design | The infill
3. **Design | The parts**
4. Design | The case study
5. Conclusion
6. Until P5

Final open building proposal

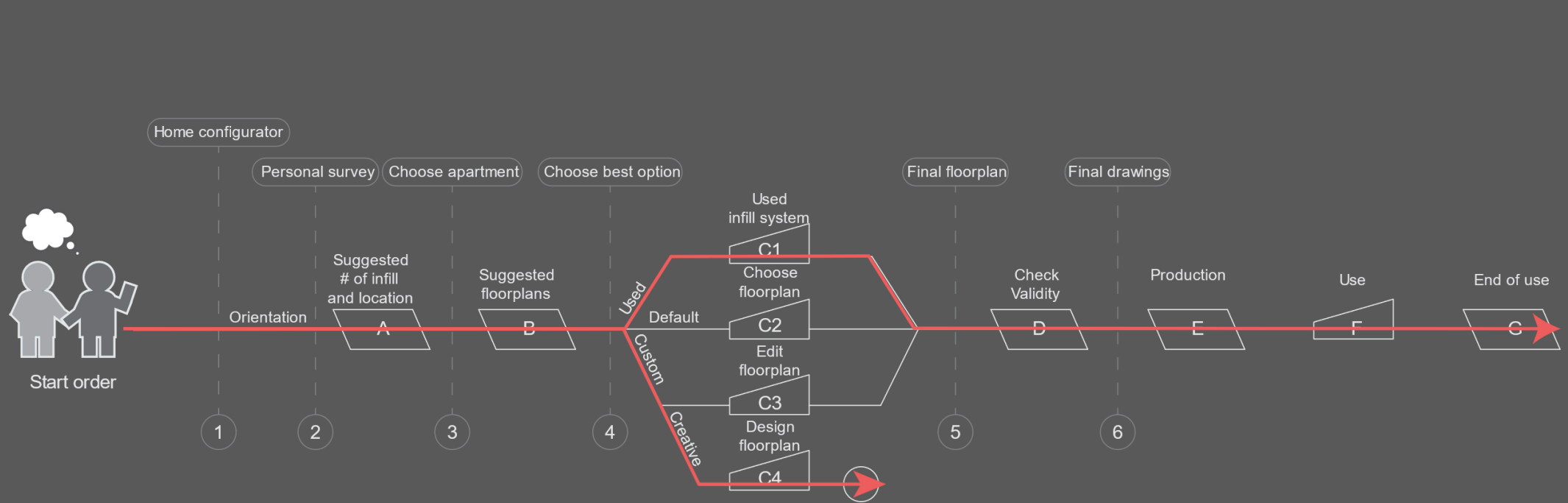

OPEN BUILDING PARTS | DESIGN

1. Research
2. Design | The infill
3. **Design | The parts**
4. Design | The case study
5. Conclusion
6. Until P5

Final open building proposal

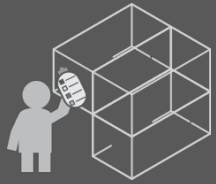

Options zone

Preview geometry zone

Preview data zone



OPEN BUILDING PARTS | DESIGN

1. Research
2. Design | The infill
3. **Design | The parts**
4. Design | The case study
5. Conclusion
6. Until P5

Final open building proposal

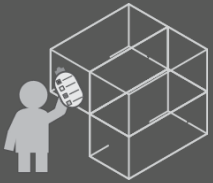

The screenshot shows a mobile application interface for building design. It features a progress bar at the top, followed by two sections of questions: 'Resident questions' (Age, number of residents, hobbies, capital) and 'Location questions' (Geological location, orientation, height). A 3D grid of building units is displayed in the center, with some units highlighted in dark gray. A 'Preview data zone' box on the right shows 'Recommended number of units' and 'Estimated cost'. Navigation buttons 'Previous' and 'Next' are at the bottom.

1. Progress bar

2. Data to estimate a fitting location and number of units

3. Available units that fit requirements are displayed in dark gray

4. If the appropriate unit is selected the client can advance to the next step

Resident questions
Age, number of residents, hobbies, capital

Location questions
Geological location, orientation, height

Preview data zone
Recommended number of units
Estimated cost

Previous Next

OPEN BUILDING PARTS | DESIGN

1. Research
2. Design | The infill
3. **Design | The parts**
4. Design | The case study
5. Conclusion
6. Until P5

Final open building proposal

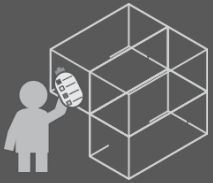

B. Suggested unit

Unit options

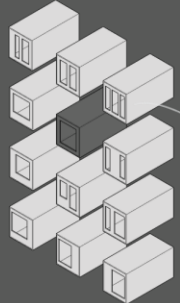

Unit configurations

Empty Working
 Living Sleeping
 Dining Storage

1. Selection of suggested unit options

2. Selection of configurations

3. Preview of the selected unit and unit configuration

Preview data zone

Estimated cost

OPEN BUILDING PARTS | DESIGN

1. Research
2. Design | The infill
3. **Design | The parts**
4. Design | The case study
5. Conclusion
6. Until P5

Final open building proposal

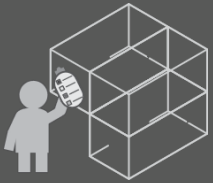

C.3. Edit unit

Materials

Cataloge
Kitchen
Bathroom
Living room

Couches

1. Color and material of elements can change

2. Catalog of available elements

3. Preview of the selected unit and unit configuration

Preview data zone
Estimated cost

Previous Next

PARTS

OPEN BUILDING PARTS | DESIGN

1. Research
2. Design | The infill
3. **Design | The parts**
4. Design | The case study
5. Conclusion
6. Until P5

Final open building proposal

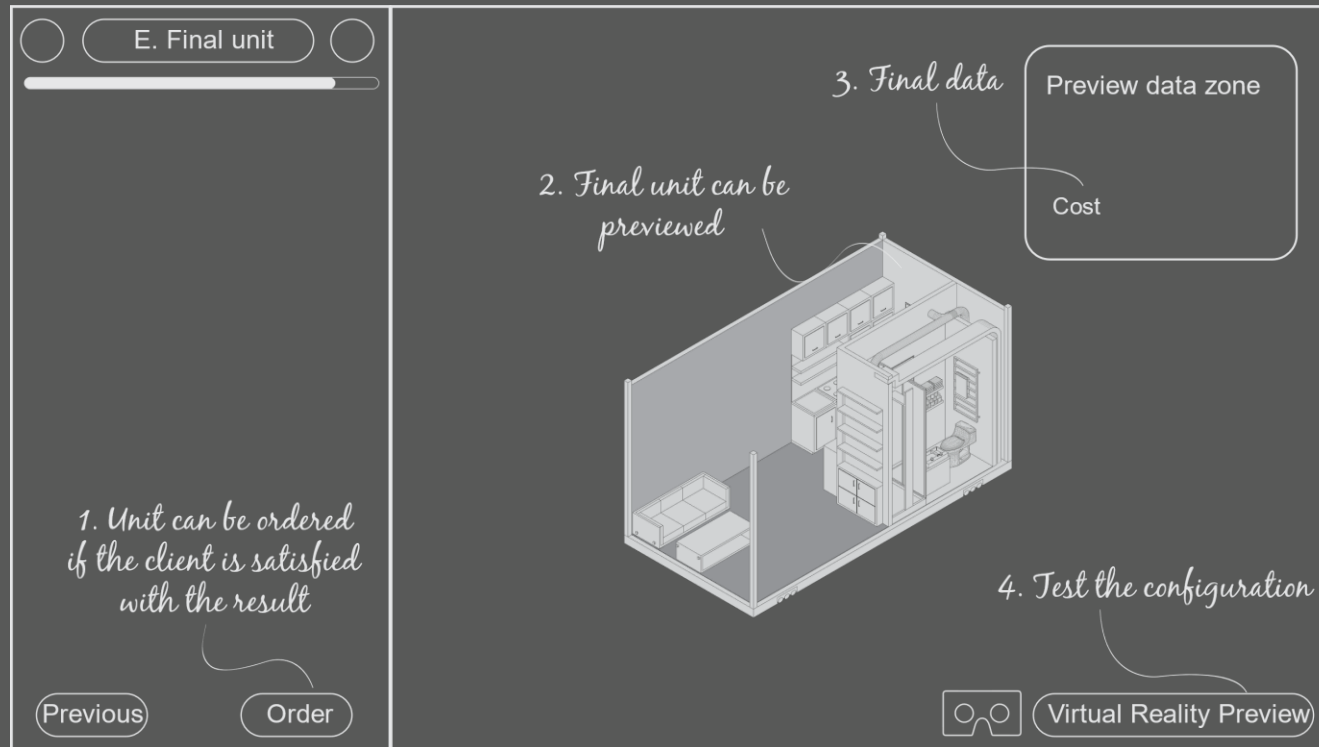
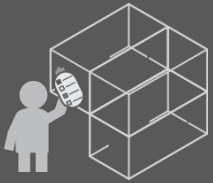

OPEN BUILDING PARTS | DESIGN

1. Research
2. Design | The infill
3. **Design | The parts**
4. Design | The case study
5. Conclusion
6. Until P5

Implementation of the method



OPEN BUILDING PARTS | DESIGN

1. Research
2. Design | The infill
- 3. Design | The parts**
4. Design | The case study
5. Conclusion
6. Until P5

The kit of parts



OPEN BUILDING PARTS | DESIGN

1. Research
2. Design | The infill
3. **Design | The parts**
4. Design | The case study
5. Conclusion
6. Until P5

The unit

Rail system for pod connection

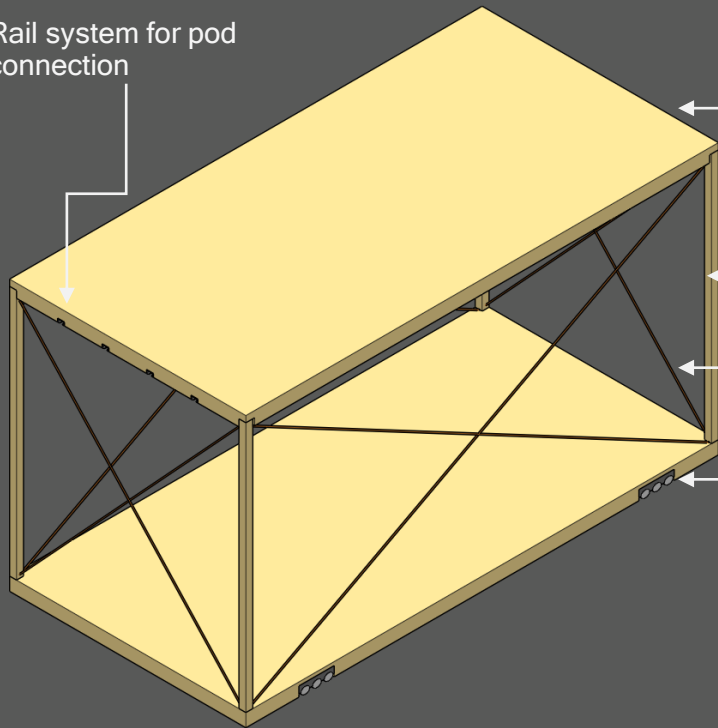

CLT Floor and ceiling

Secondary possibility: Corrugated steel with steel beams

Wooden column

Secondary possibility: Steel columns

Temporal support

Rolling system



1M

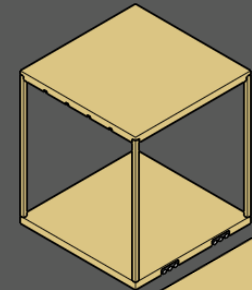

2M

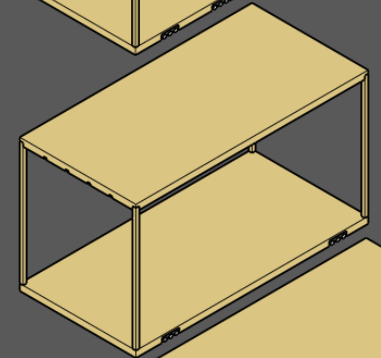

3M

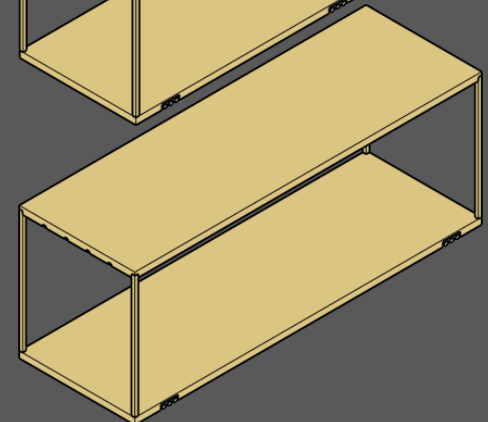

OPEN BUILDING PARTS | DESIGN

1. Research
2. Design | The infill
- 3. Design | The parts**
4. Design | The case study
5. Conclusion
6. Until P5

The infill subsystems

Empty slot for routing of service systems

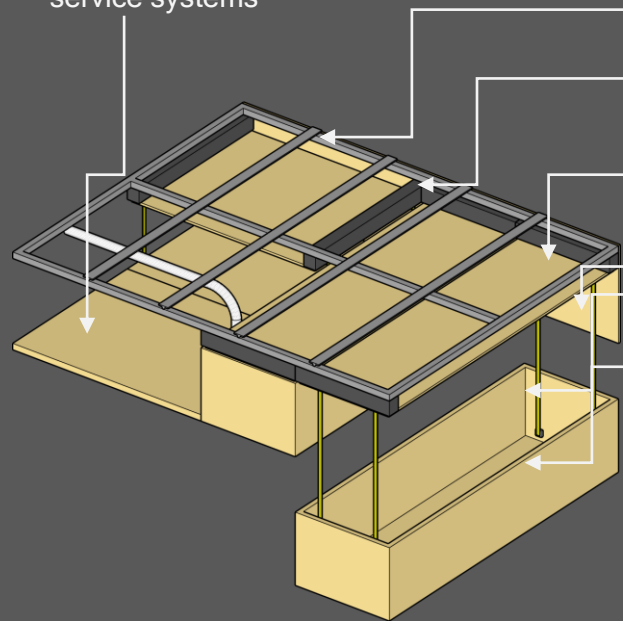

Mounting rail

Electric motor

Ceiling board

Facing board

Suspension system

Storage box sub-component

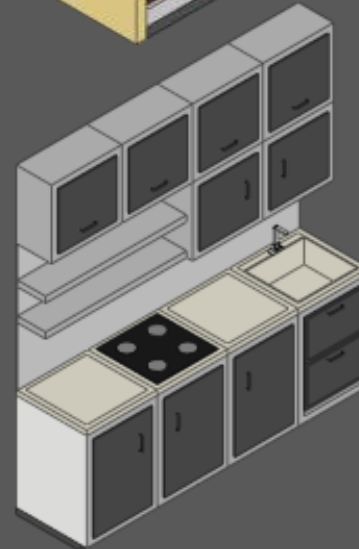
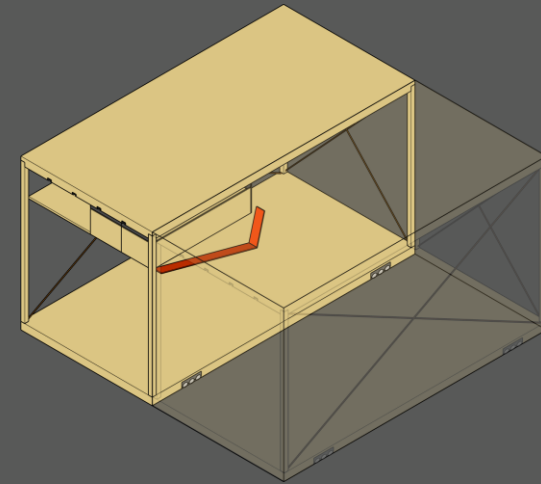
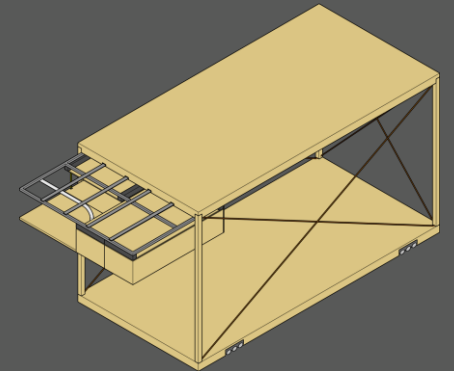
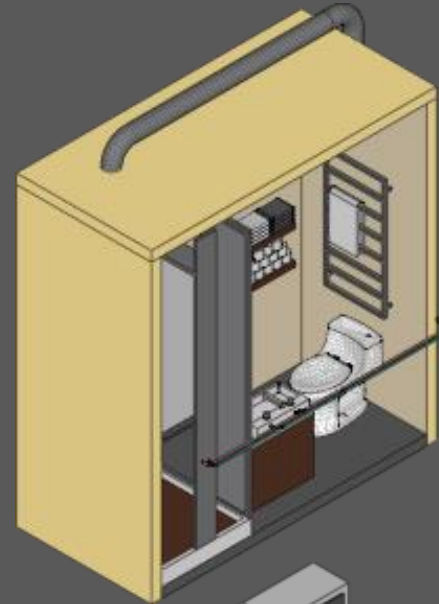

OPEN BUILDING PARTS | DESIGN

1. Research
2. Design | The infill
3. **Design | The parts**
4. Design | The case study
5. Conclusion
6. Until P5

The connector

Pressure resistant insulation

Horizontal shaft

Vertical shaft

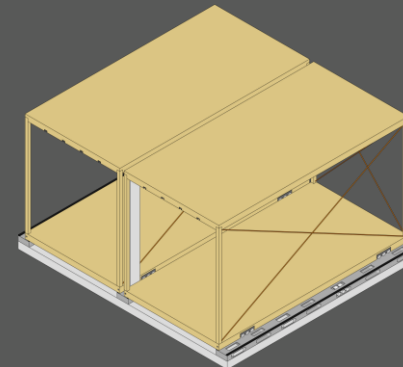
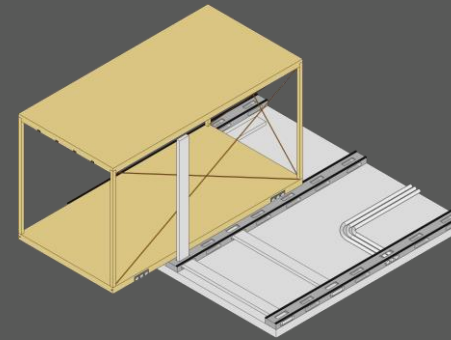
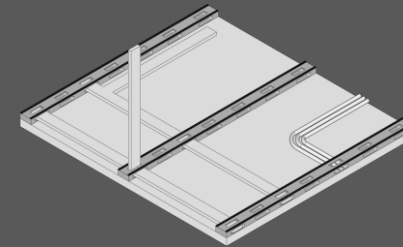
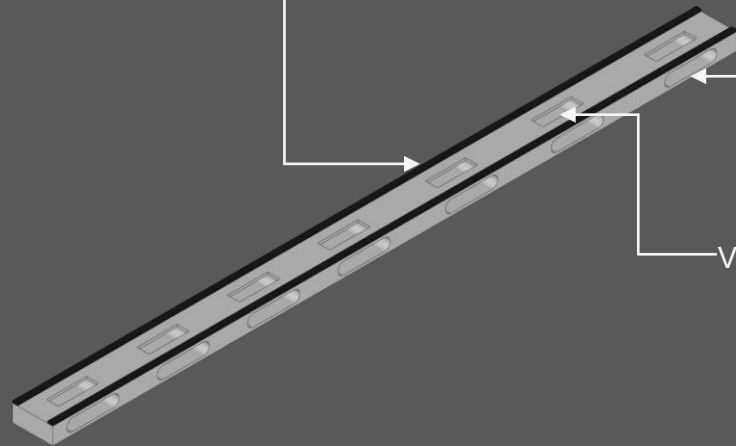



OPEN BUILDING PARTS | DESIGN



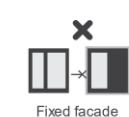

1. Research
2. Design | The infill
3. **Design | The parts**
4. Design | The case study
5. Conclusion
6. Until P5

The support rulebook









New Building

<p>1</p>  <p>Removable facade per level</p>	<p>X</p>  <p>Fixed facade</p>
<p>2</p>  <p>Flexible facade infill elements</p>	<p>X</p>  <p>Fixed facade elements</p>

Existing building stock

<p>1</p>  <p>Removable from top to bottom</p>	<p>?</p>  <p>Fixed facade</p>
<p>2</p>  <p>Recyclable elements</p>	<p>?</p>  <p>Non recyclable elements</p>

Existing building stock

<p>1</p>  <p>System does not cross over multiple units</p>	<p>X</p>  <p>System does cross multiple units</p>
<p>2</p>  <p>System does not block door from opening</p>	<p>X</p>  <p>System can block door from opening</p>
<p>3</p>  <p>System alligns with the grid</p>	<p>X</p>  <p>System does not alligi with the grid</p>
<p>4</p>  <p>System is usable</p>	<p>X</p>  <p>System is not usable</p>

Rulebook page 4

Rulebook page 5



The case study

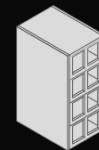
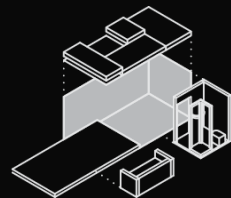

THE CASE STUDY | DESIGN

- 1. Research
- 2. Design | The infill
- 3. Design | The parts
- 4. **Design | The case study**
- 5. Conclusion
- 6. Until P5

Implementation of the method

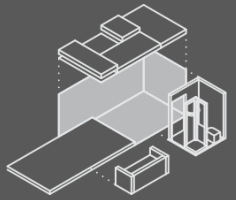

THE CASE STUDY | DESIGN

1. Research
2. Design | The infill
3. Design | The parts
4. Design | The case study
5. Conclusion
6. Until P5

Implementation of the method

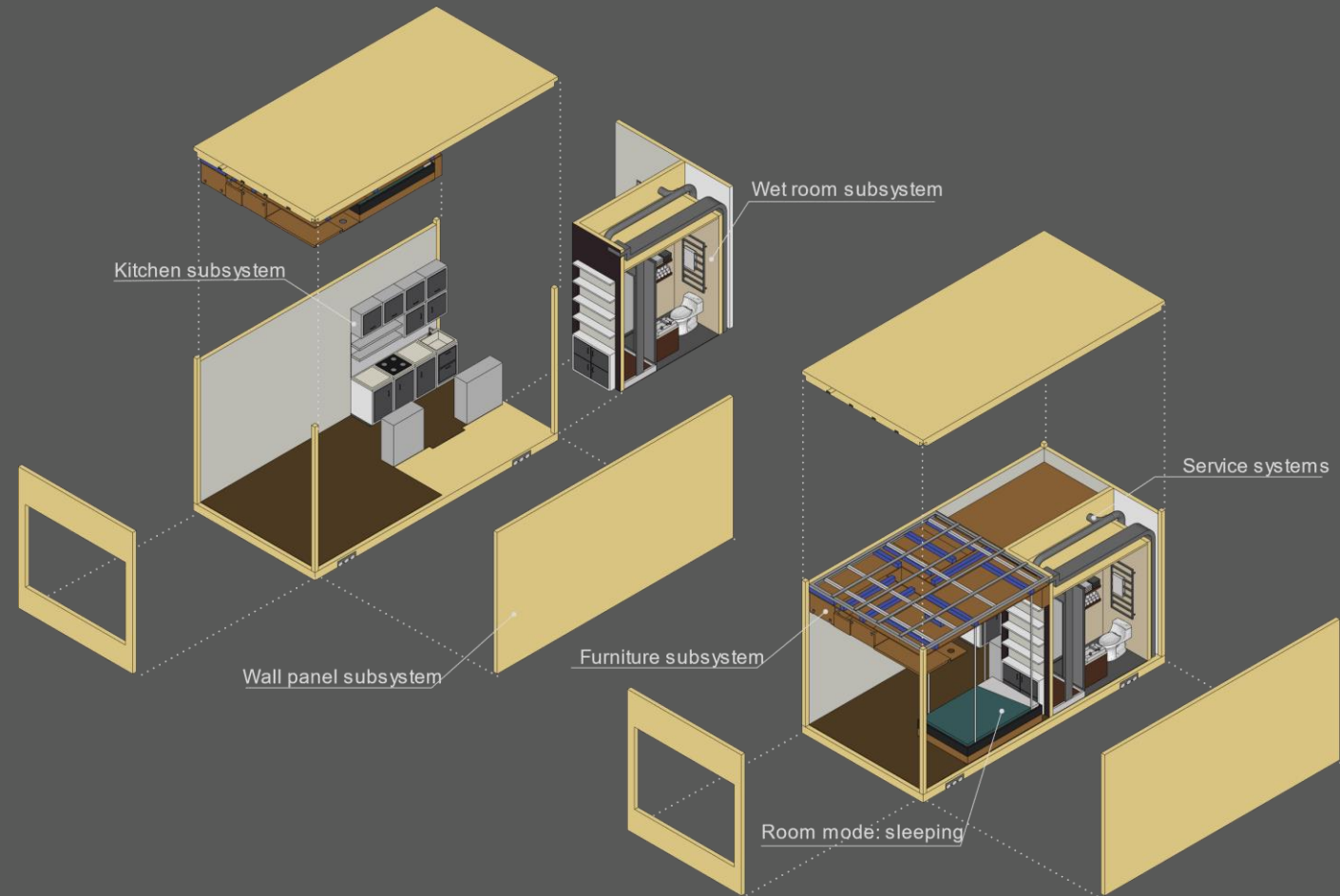

THE CASE STUDY | DESIGN

- 1. Research
- 2. Design | The infill
- 3. Design | The parts
- 4. Design | The case study
- 5. Conclusion
- 6. Until P5

Implementation of the method

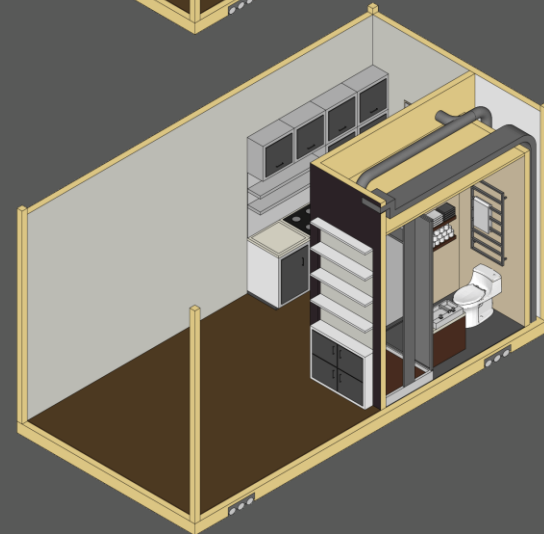
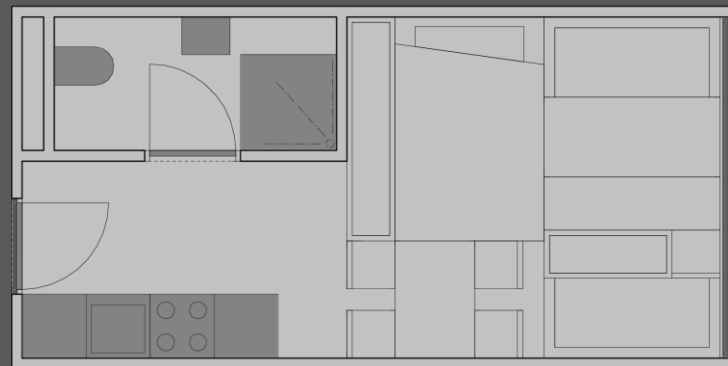
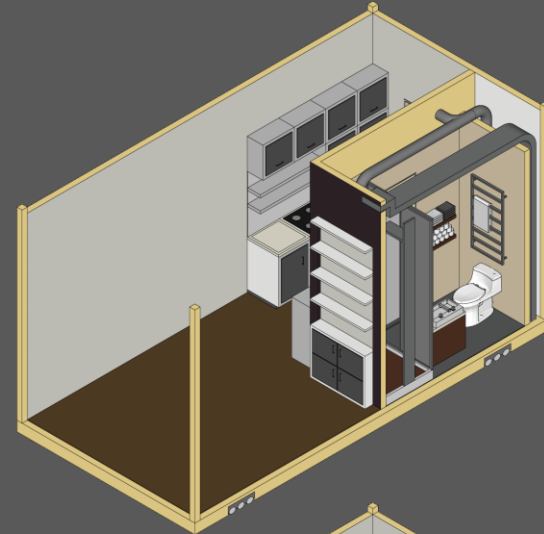
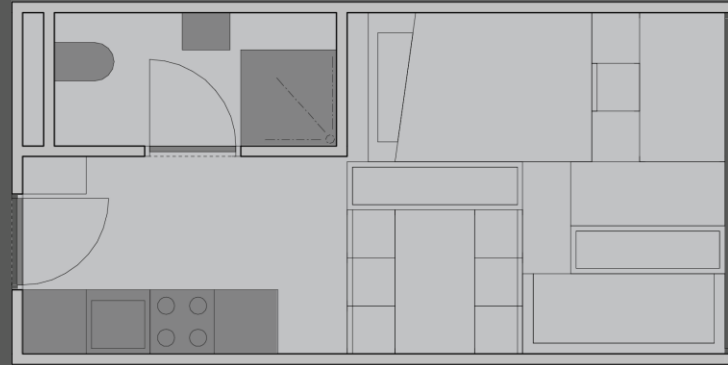
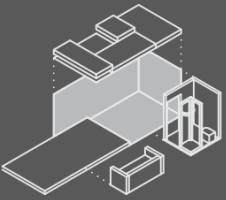

THE CASE STUDY | DESIGN

- 1. Research
- 2. Design | The infill
- 3. Design | The parts
- 4. Design | The case study
- 5. Conclusion
- 6. Until P5

The case study



THE CASE STUDY | DESIGN

1. Research
2. Design | The infill
3. Design | The parts
4. Design | The case study
5. Conclusion
6. Until P5

Analysis

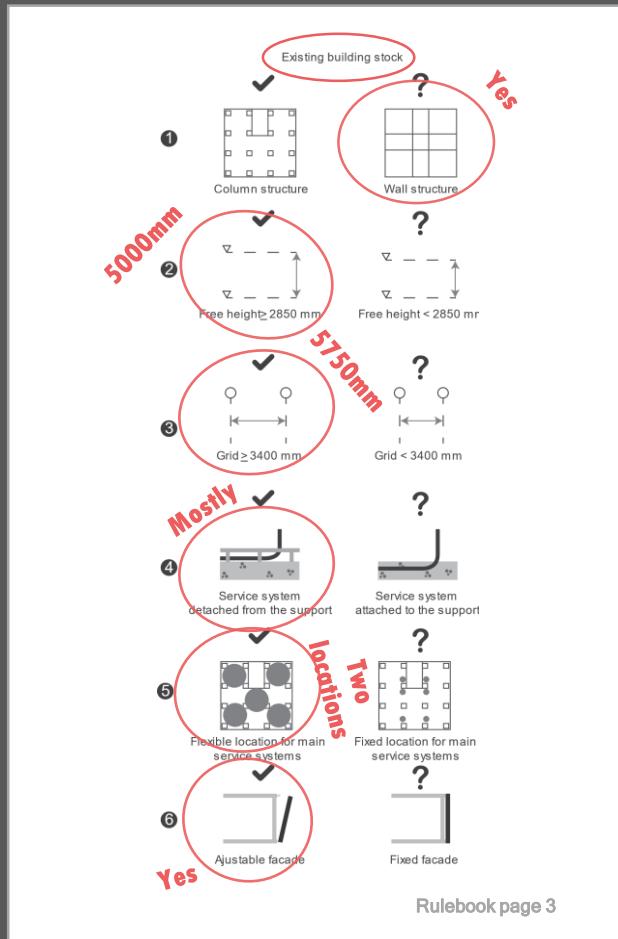

THE CASE STUDY | DESIGN

1. Research
2. Design | The infill
3. Design | The parts
4. **Design | The case study**
5. Conclusion
6. Until P5

Procedure

- Overview of the support structure

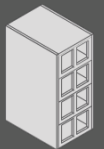
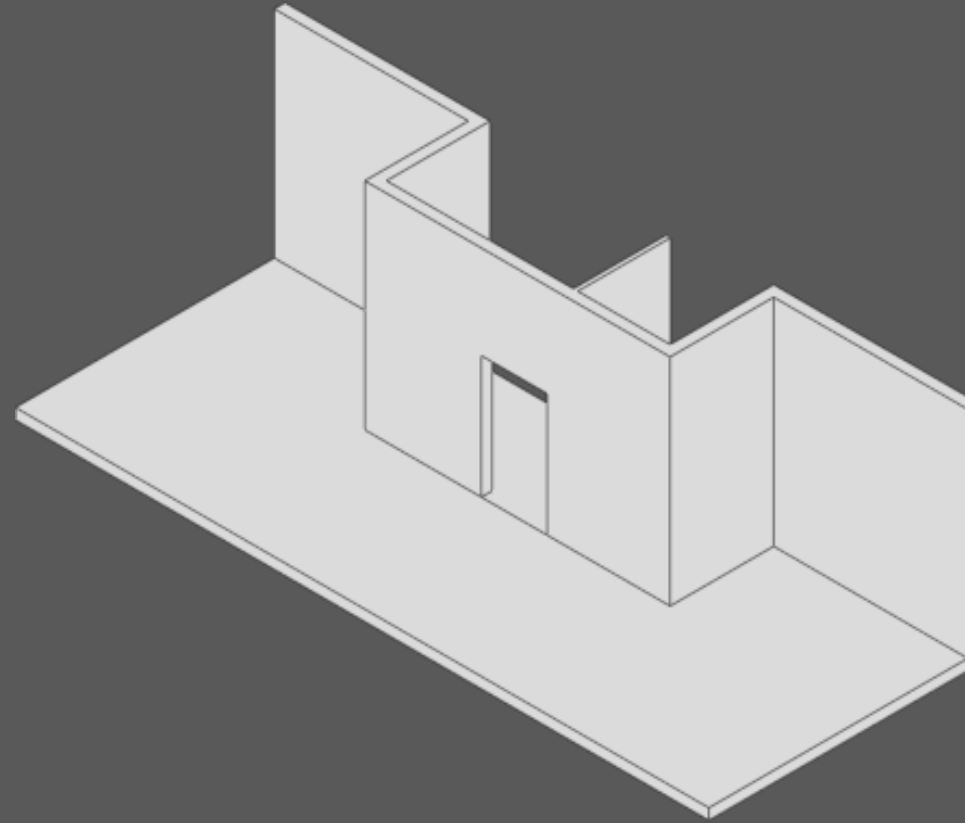

THE CASE STUDY | DESIGN

1. Research
2. Design | The infill
3. Design | The parts
4. Design | The case study
5. Conclusion
6. VR Exhibition

Procedure

- Overview of the support structure
- New floor height

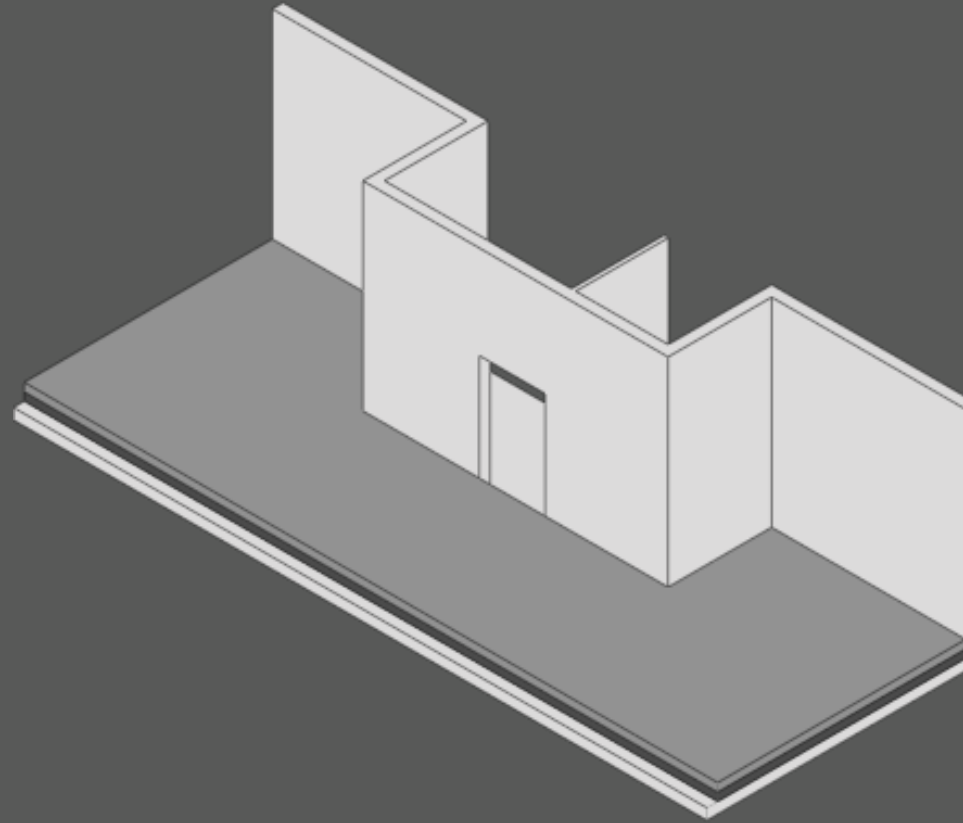

THE CASE STUDY | DESIGN

1. Research
2. Design | The infill
3. Design | The parts
4. **Design | The case study**
5. Conclusion
6. VR Exhibition

Procedure

- Overview of the support structure
- New floor height
- Arrangement of new apartments

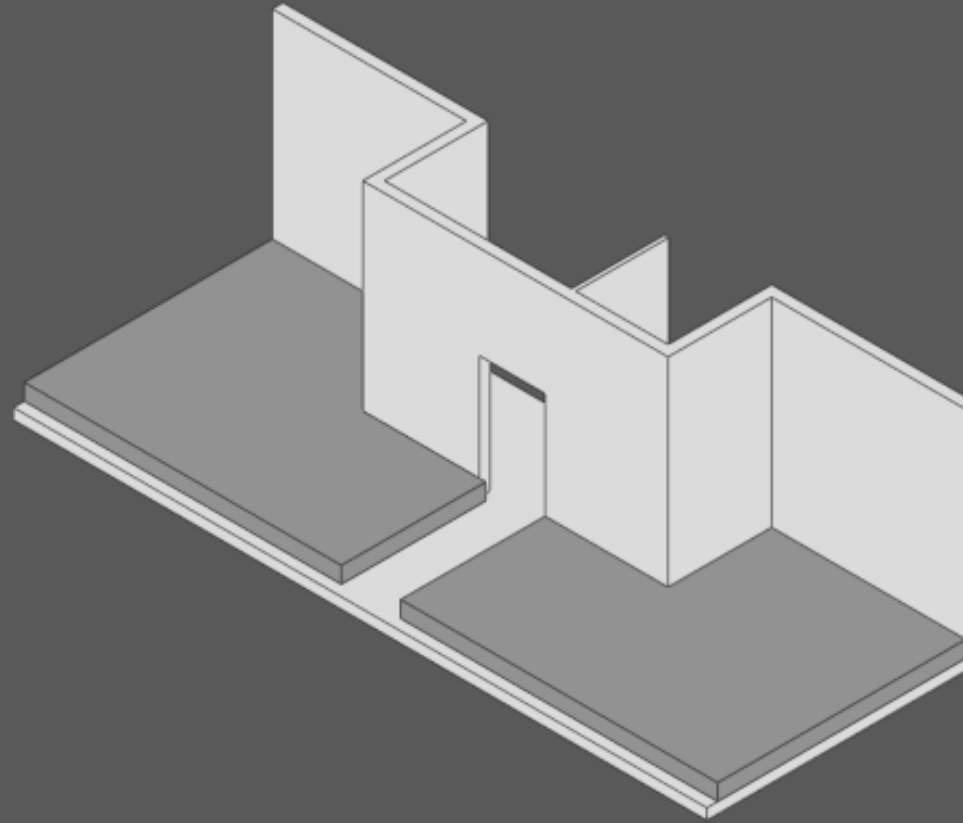

THE CASE STUDY | DESIGN

1. Research
2. Design | The infill
3. Design | The parts
4. Design | The case study
5. Conclusion
6. VR Exhibition

Procedure

- Overview of the support structure
- New floor height
- Arrangement of new apartments
- Place new vertical connection

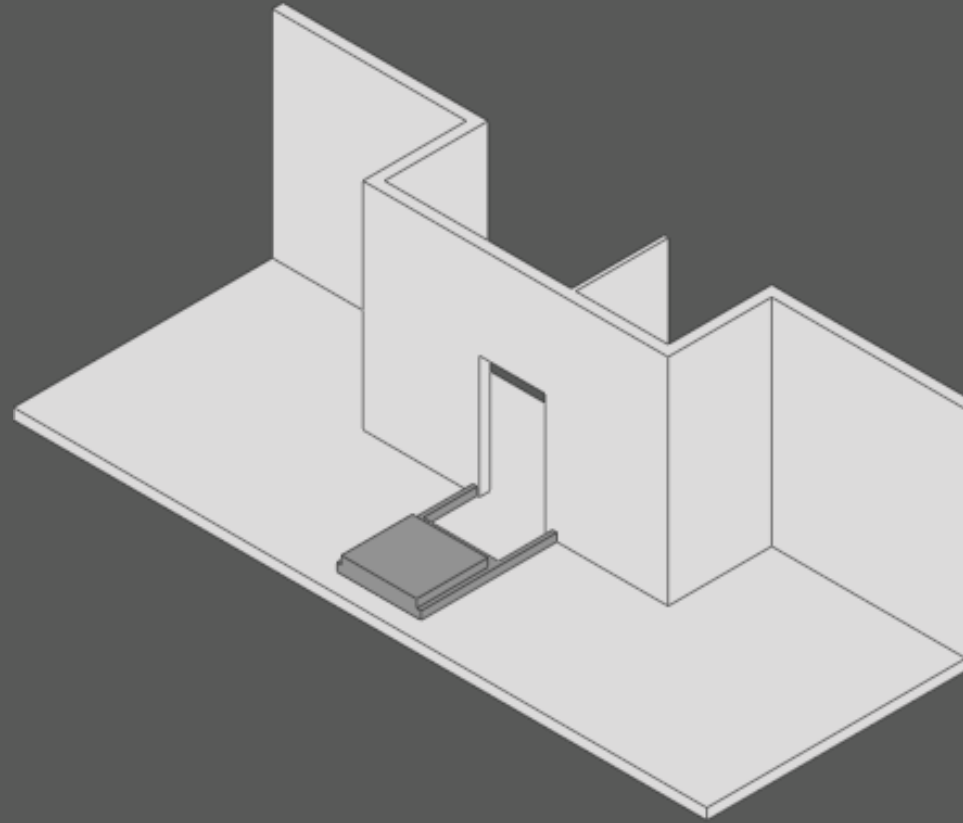

THE CASE STUDY | DESIGN

1. Research
2. Design | The infill
3. Design | The parts
4. **Design | The case study**
5. Conclusion
6. VR Exhibition

Procedure

- Overview of the support structure
- New floor height
- Arrangement of new apartments
- Place new vertical connection
- Decide on preferred location for wet rooms

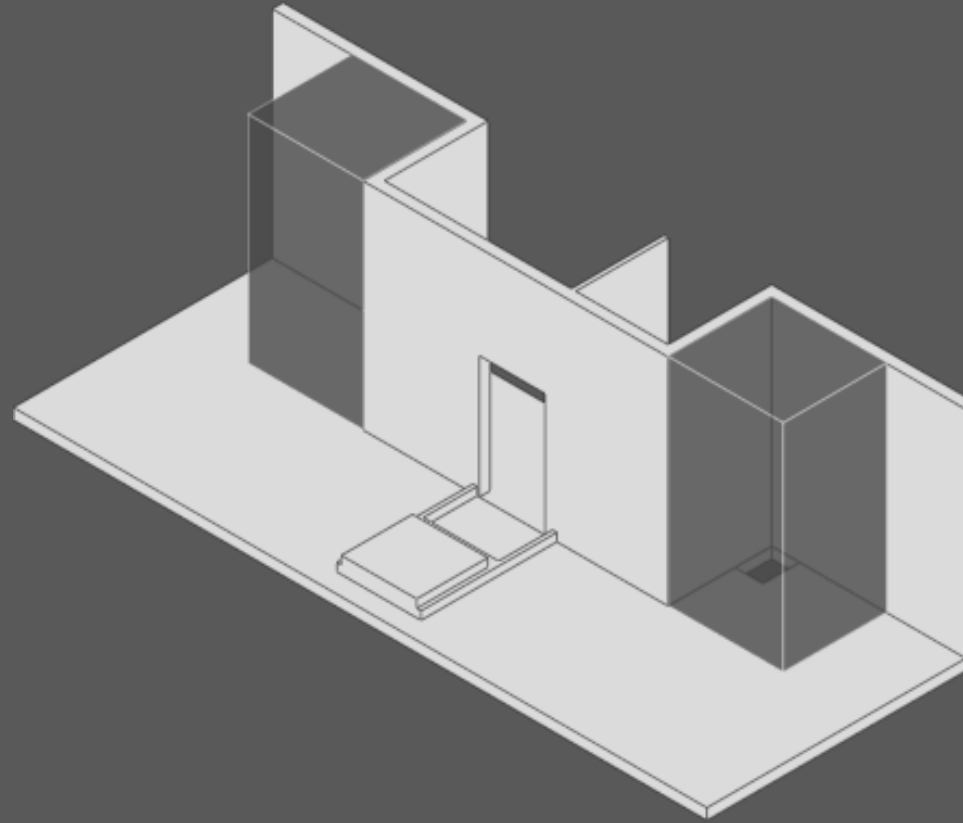

THE CASE STUDY | DESIGN

1. Research
2. Design | The infill
3. Design | The parts
4. Design | The case study
5. Conclusion
6. VR Exhibition

Procedure

- Overview of the support structure
- New floor height
- Arrangement of new apartments
- Place new vertical connection
- Decide on preferred location for wet rooms
- Design size and placement of units

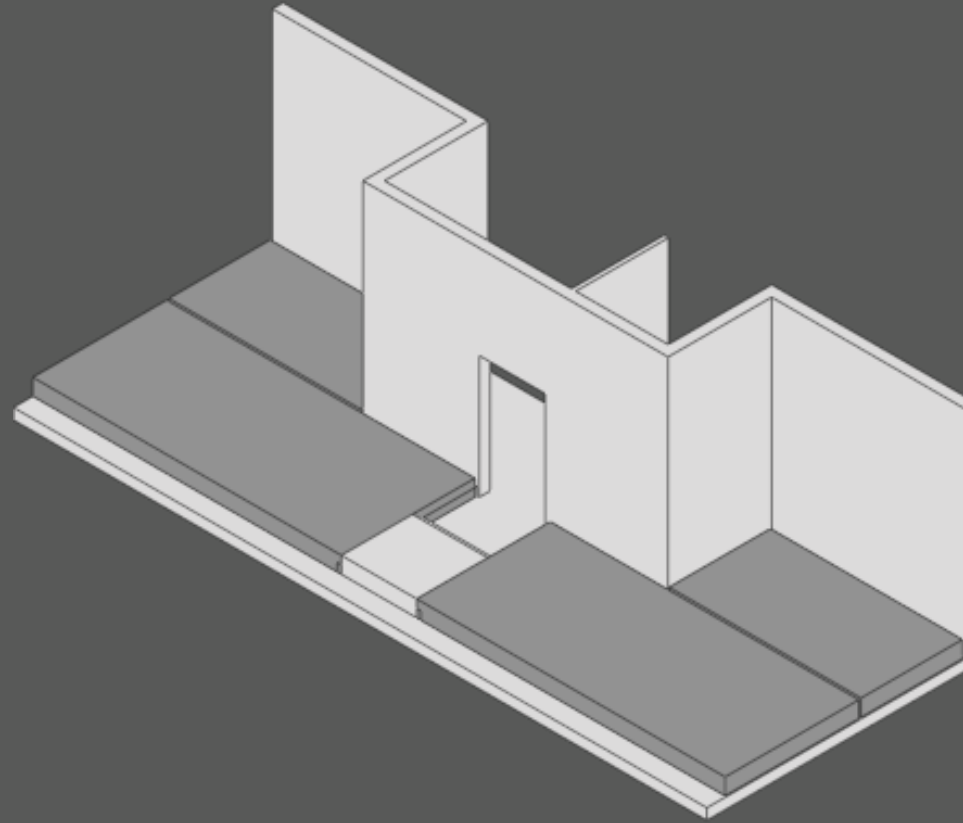

Procedure

- Overview of the support structure
- New floor height
- Arrangement of new apartments
- Place new vertical connection
- Decide on preferred location for wet rooms
- Design size and placement of units
- Place the connector

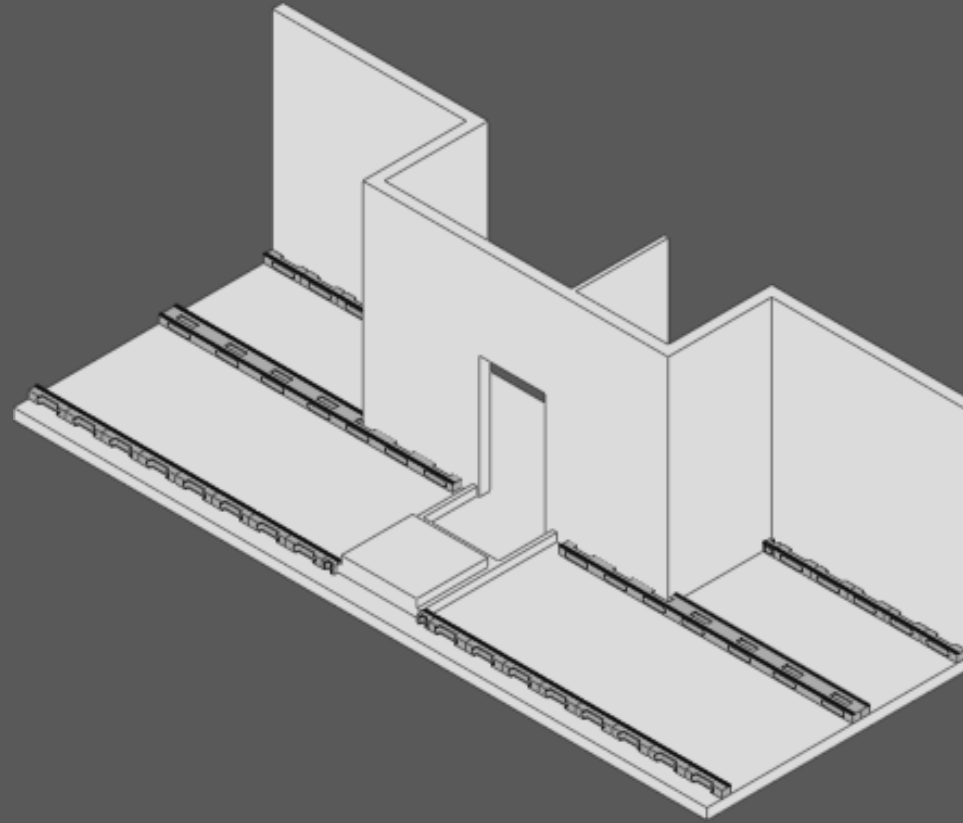

Procedure

- Overview of the support structure
- New floor height
- Arrangement of new apartments
- Place new vertical connection
- Decide on preferred location for wet rooms
- Design size and placement of units
- Place the connector
- Place the units

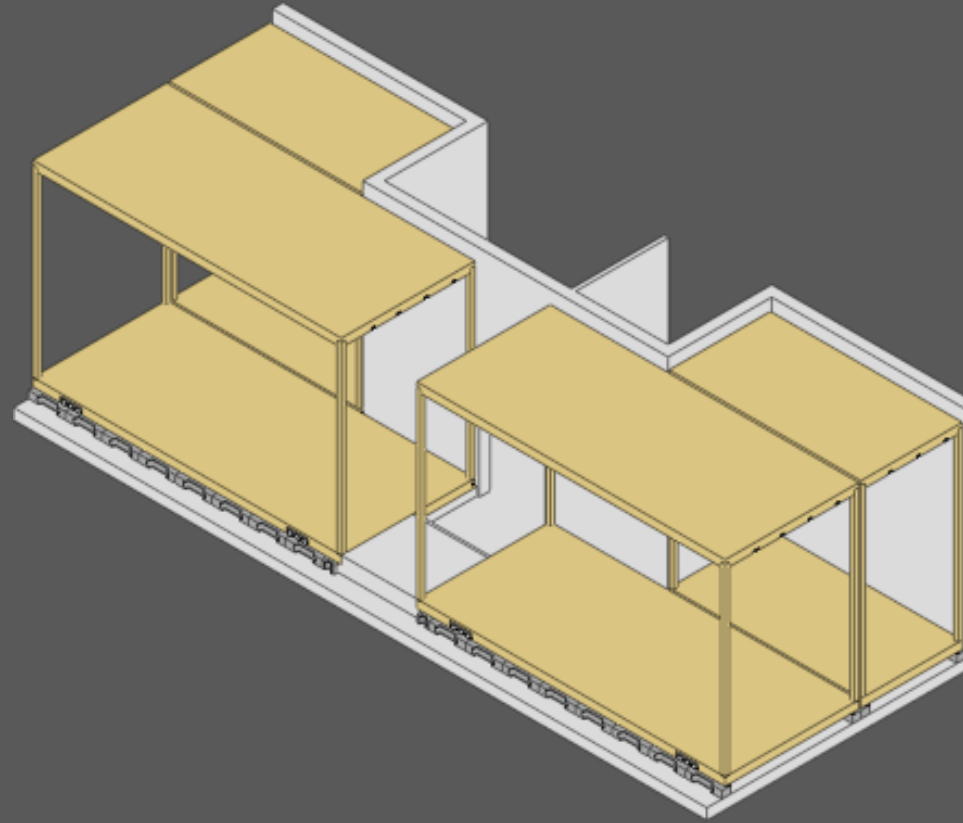

THE CASE STUDY | DESIGN

1. Research
2. Design | The infill
3. Design | The parts
4. Design | The case study
5. Conclusion
6. VR Exhibition

Configurations

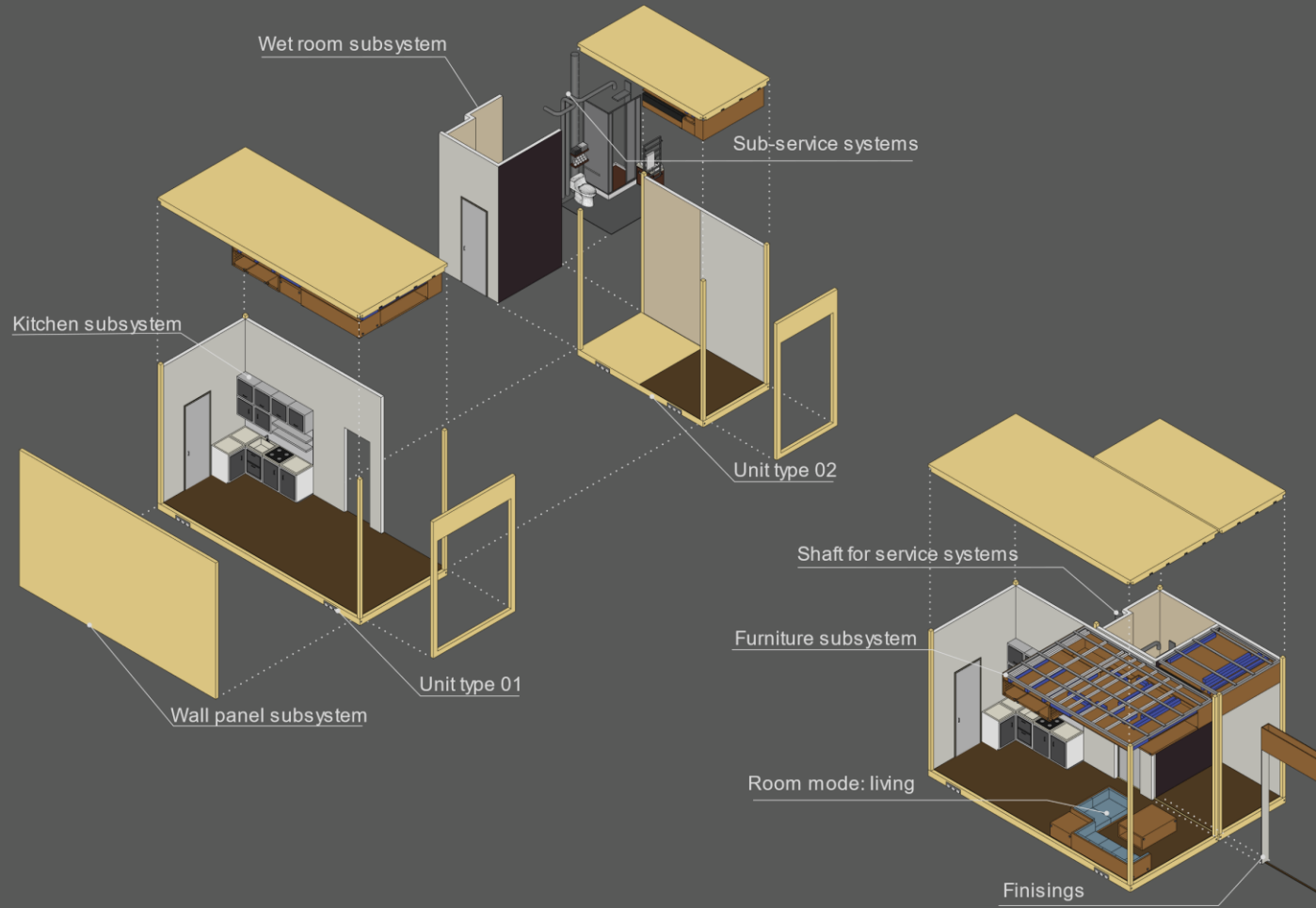

THE CASE STUDY | DESIGN

- 1. Research
- 2. Design | The infill
- 3. Design | The parts
- 4. Design | The case study
- 5. Conclusion
- 6. VR Exhibition

Configurations

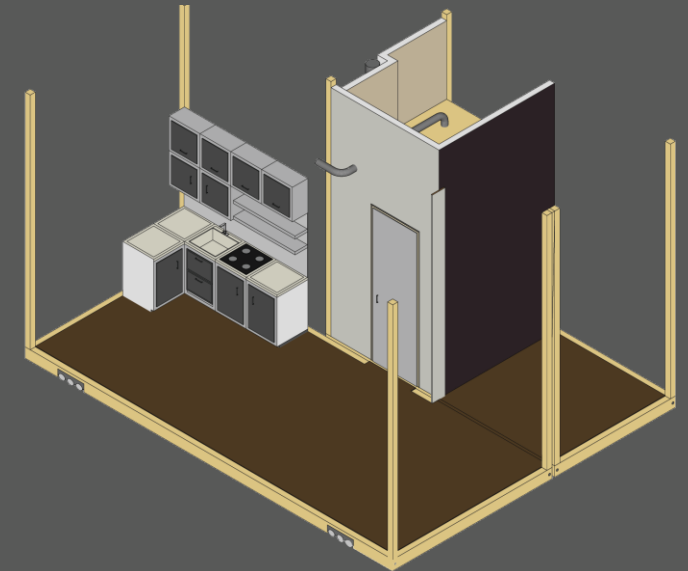
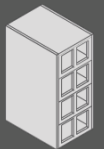

Conclusion



CONCLUSION

1. Research
2. Design | The infill
3. Design | The parts
4. Design | The case study
5. **Conclusion**
6. VR Exhibition

Design components

The infill system

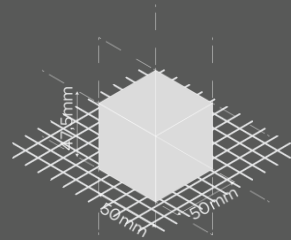

Dimensional coordination System

Design parts

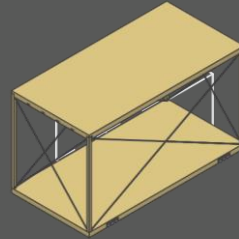

Volumetric unit

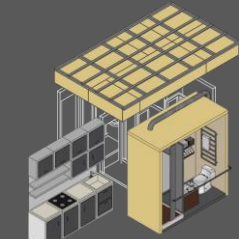

Catalog of modular pods

Future research



Technical proposal

The open Building parts

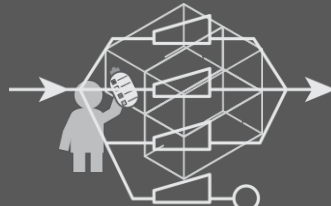

User interaction

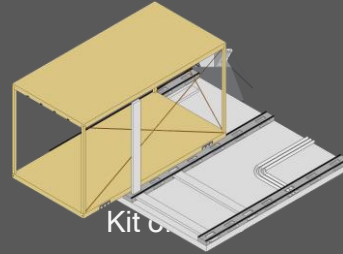

Kit of parts

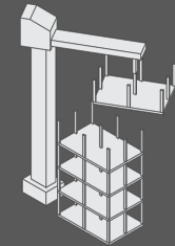

The support system

Case study

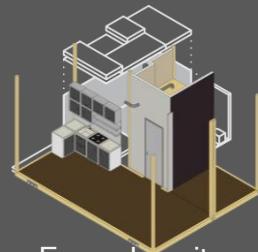

Example units

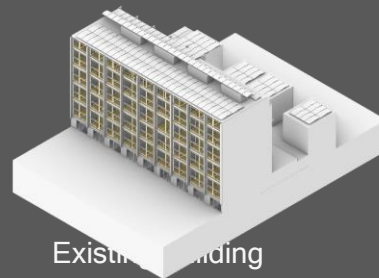

Existing building



Road map and business model

VR Exhibition

1. Research
2. Design | The infill
3. Design | The parts
4. Design | The case study
5. Conclusion
6. VR Exhibition



Master thesis presentation P5