

# THE LEARNERS INSTITUTE

## a new educational typology

Sjoerd Marijnissen  
Netherlands

### The concept

Zutphen is known for its anthroposophic education and they claim it to be their speciality. But the educational system is outdated. K. Robinson, an educationalist, calls for schools to stimulate creativity. M. Csikszentmihalyi, also an educationalist defines creativity as something that happens in an existing cultural context. The term is related to community. Creativity consists of a talented individual, the domain (existing) and the field (an elite that controls the domain). This translates into the function, an institution with archives (domain) a school (talented individual) and a museum function (the field).

### The process

Design input is generated with (historical) analyses on urban, architectural, technical and cultural level. To gain input for the educational system a literature study has been done.

### The design

The design creates tension and intimacy well known to Zutphen. Porosity of the existing urban fabric inspires to let new courtyards emerge which create this intimacy. Borders are redefined and re-experienced on different levels. It elevates the current idea of a school and a museum.

The building has multiple entrances for different experiences, fragile children can use it on a small scale and others can experience the full capacity of the complex through space, light and scale. Although it seems radical it respects the values of the area and is derived from historical analysis. It tells multiple heritage stories and could make Zutphen truly a city well known for secondary education of the highest quality. Answering to the need of the current population and eventually attracting younger intellectual people.

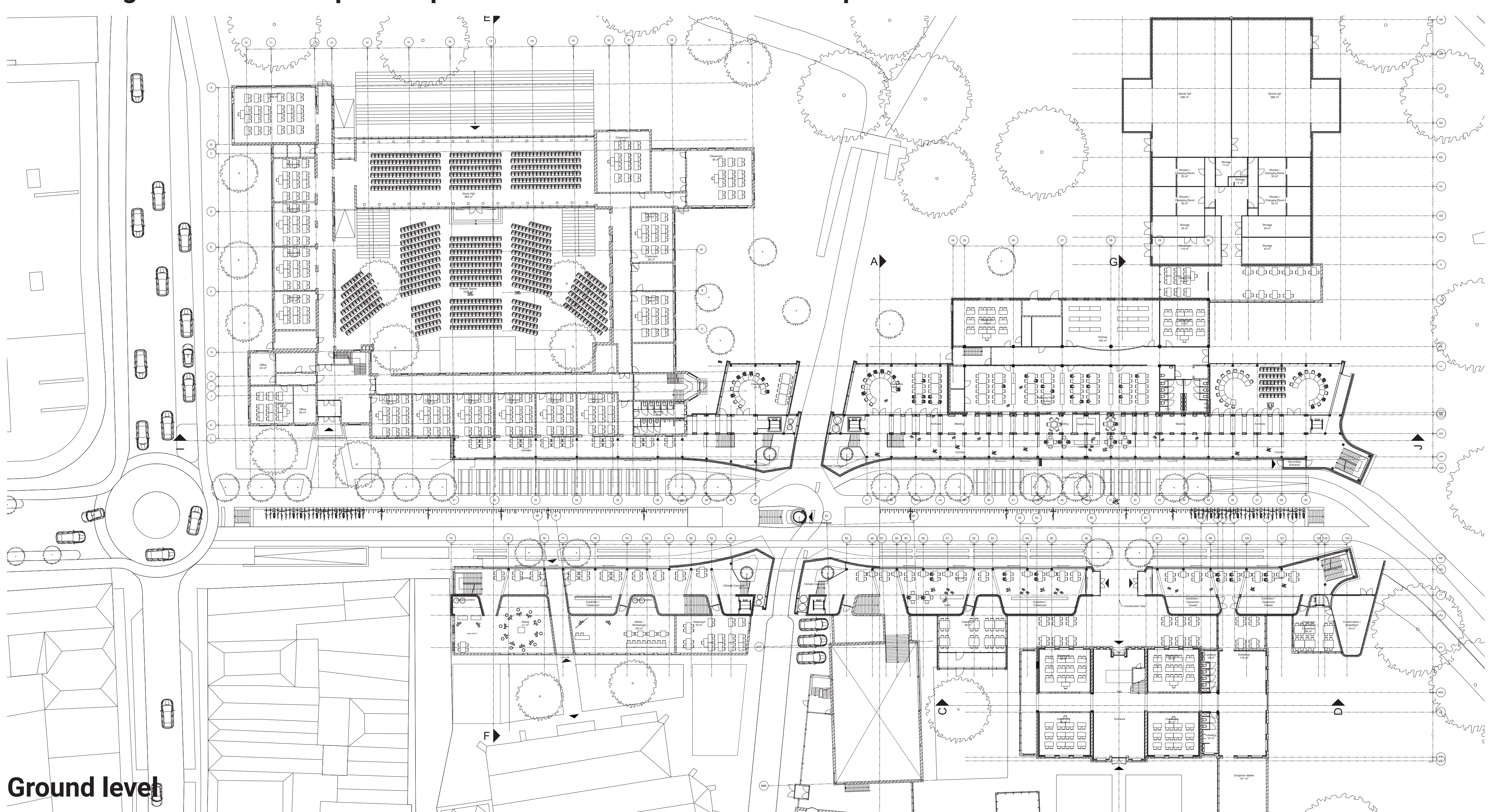
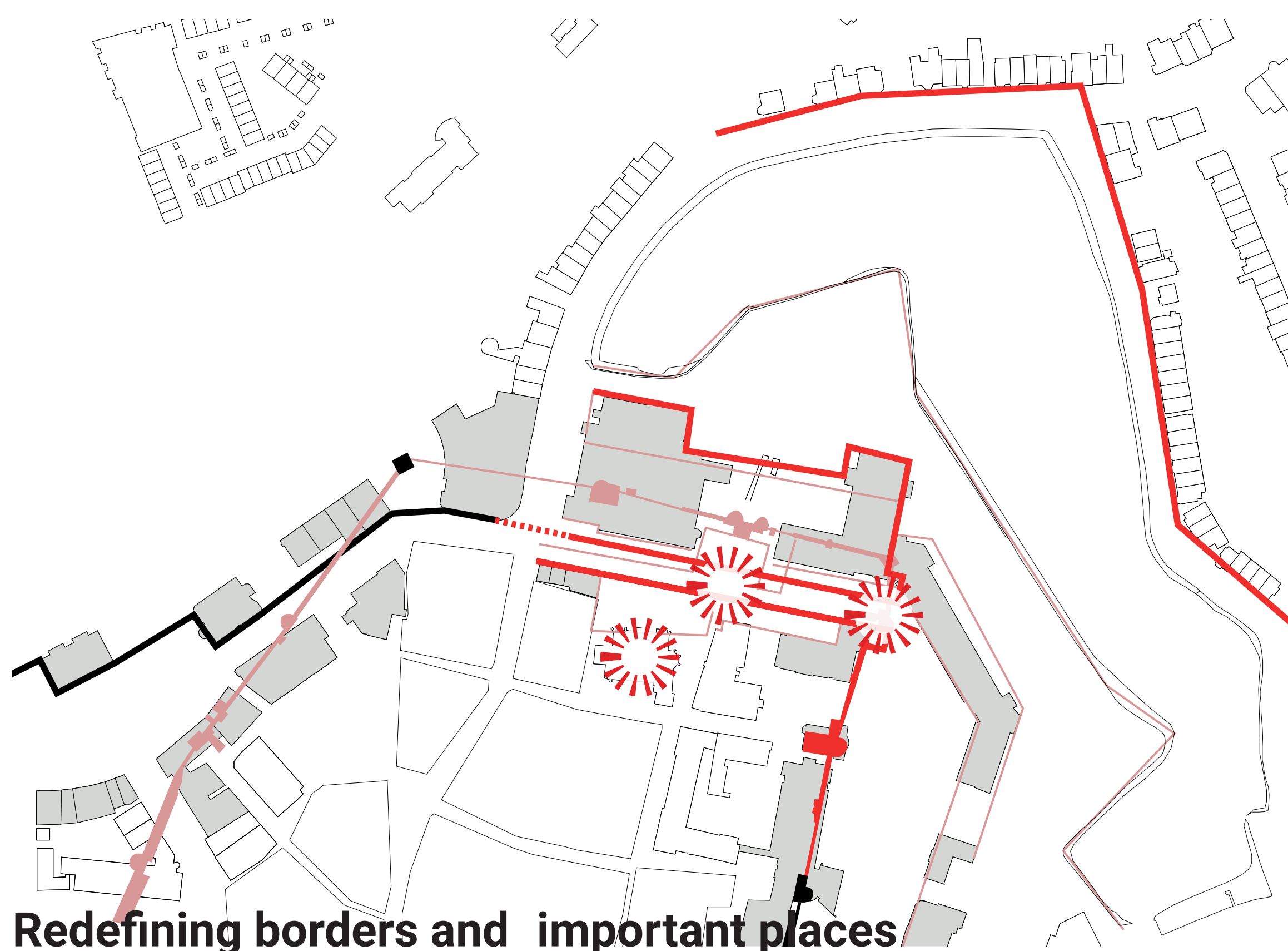



# THE LEARNERS INSTITUTE

a new educational typology

Sjoerd Marijnissen  
Netherlands

