

Global Housing Graduation Studio:

Mixing Mumbai.

Affordable Housing for Inclusive Development

**Redevelopment Project of Baithi Chawls
in Nalasopara, Mumbai**

Xiaozhu Huang-4617460

July 2018

RESEARCH

Community-oriented Housing
without Developers

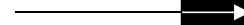

DESIGN

Self-growing Communities
for Building-up Groups



ARCHITECTURE & DWELLING

Architecture must yield meaningful places, the reflection of a balance between an artist's design and a human dwelling.

Human
Society
Culture

Economy

Human
Society
Culture

Economy



Self-sufficiency



Supply and Demand

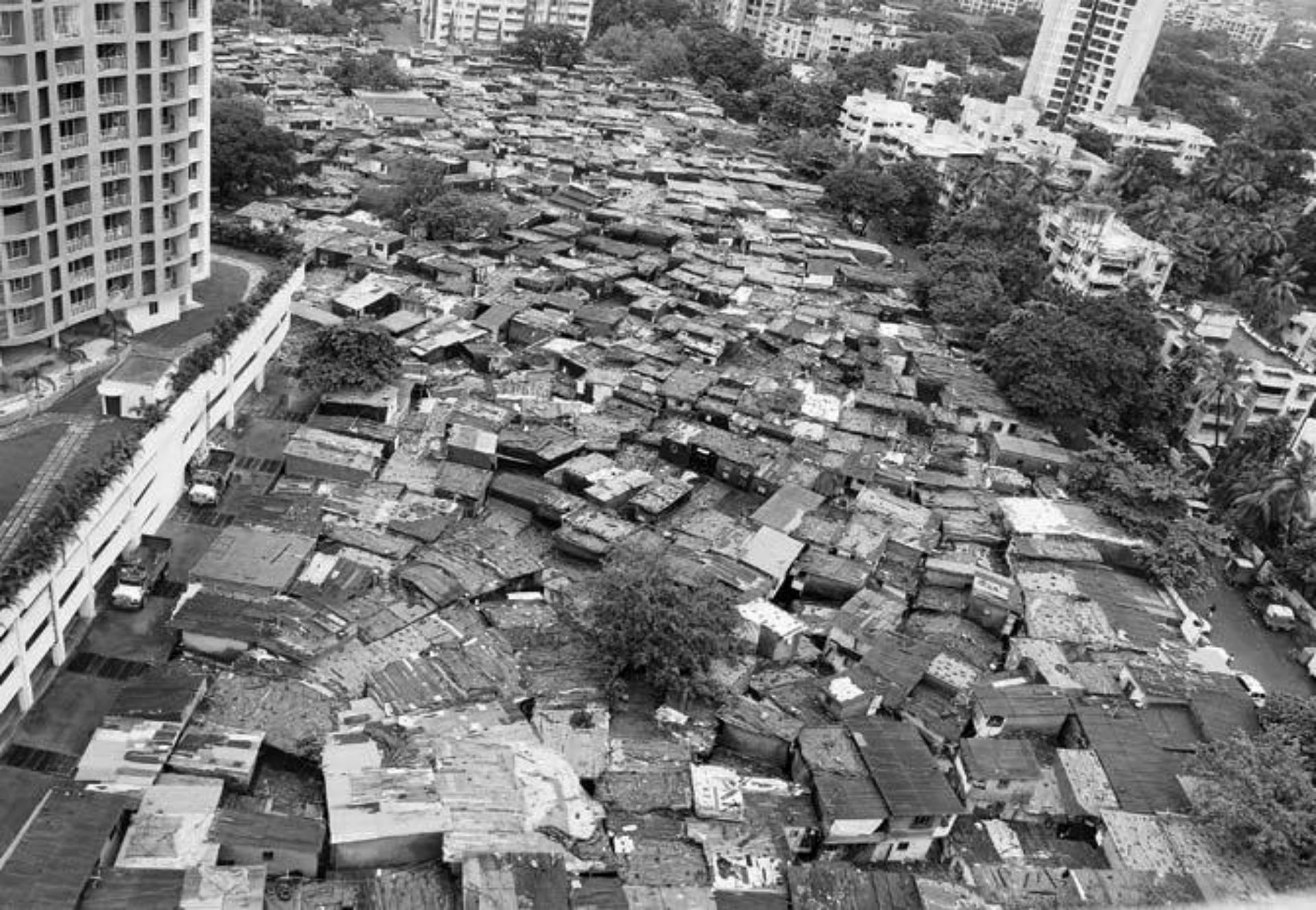

Slums in Mumbai

Affordability

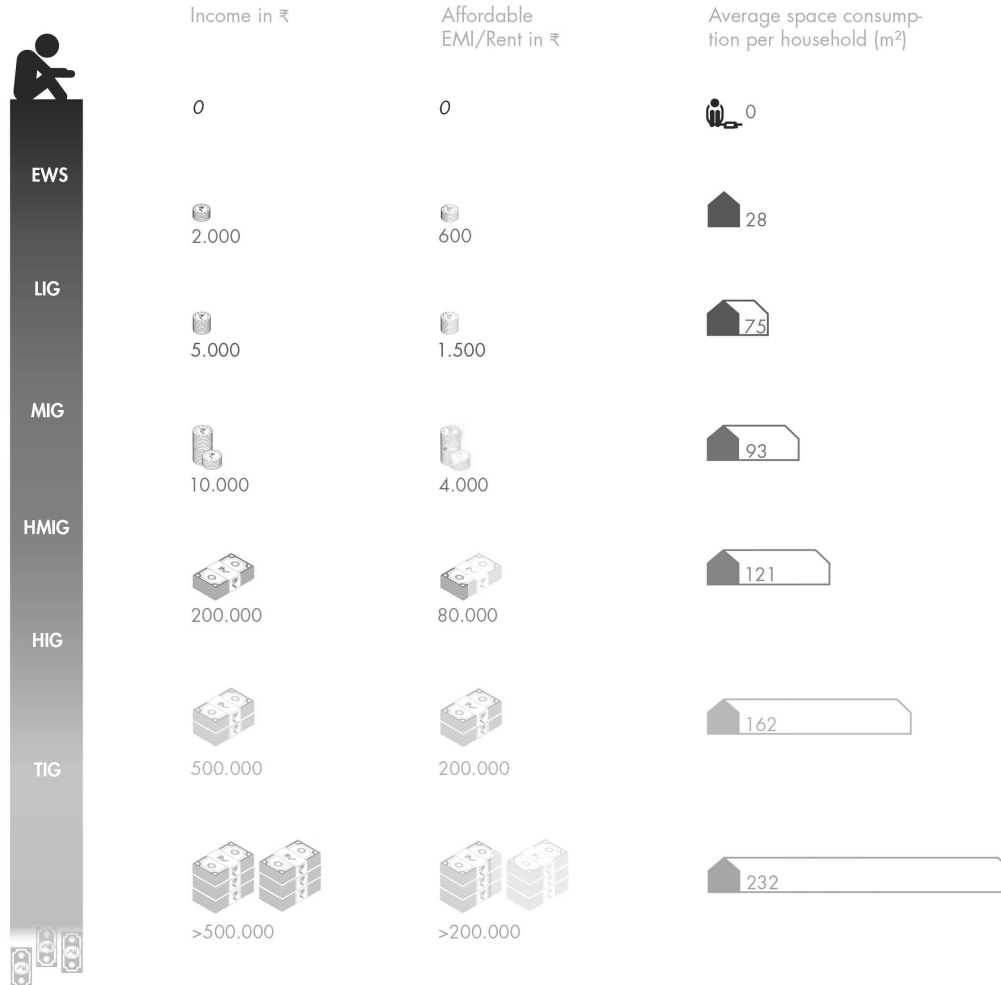

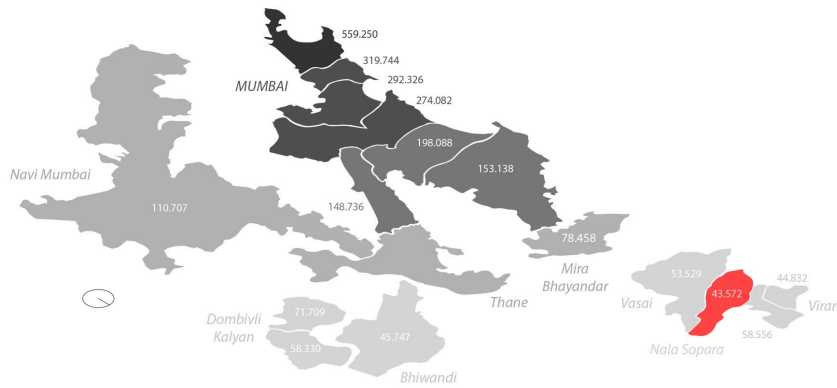

PROPERTY RATES

Property rates of residential apartments in the Mumbai Metropolitan Region in rupee/m²

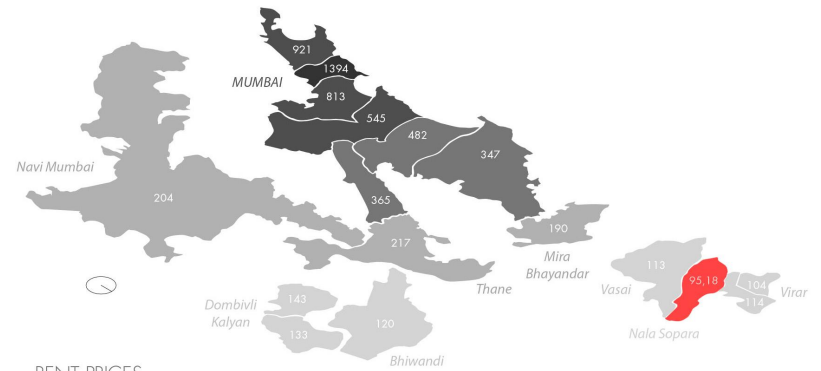

RENT PRICES

Rent prices of residential apartments in the Mumbai Metropolitan Region in rupee/m²

Affordable areas (m2) in Nala Sapara

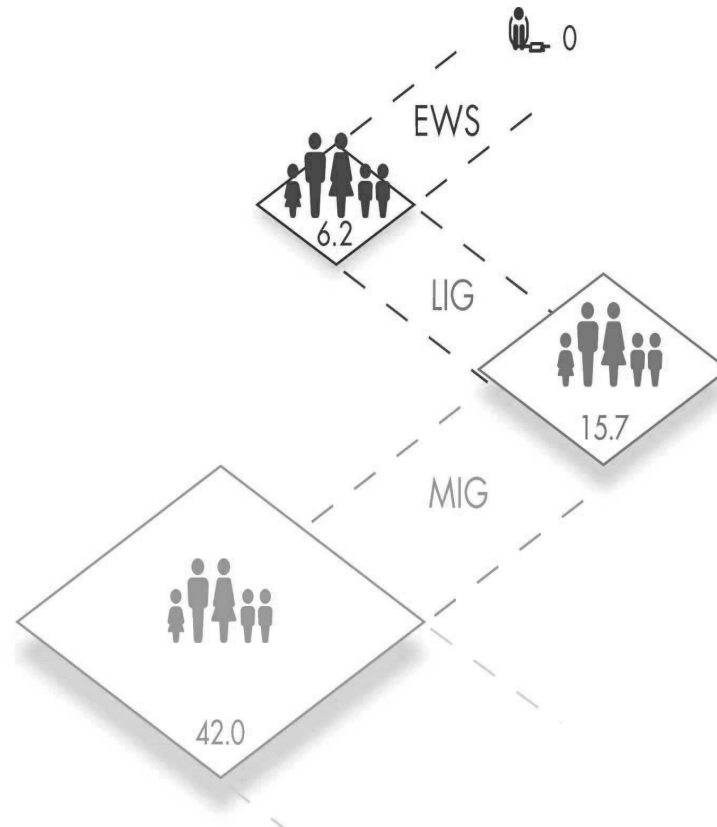

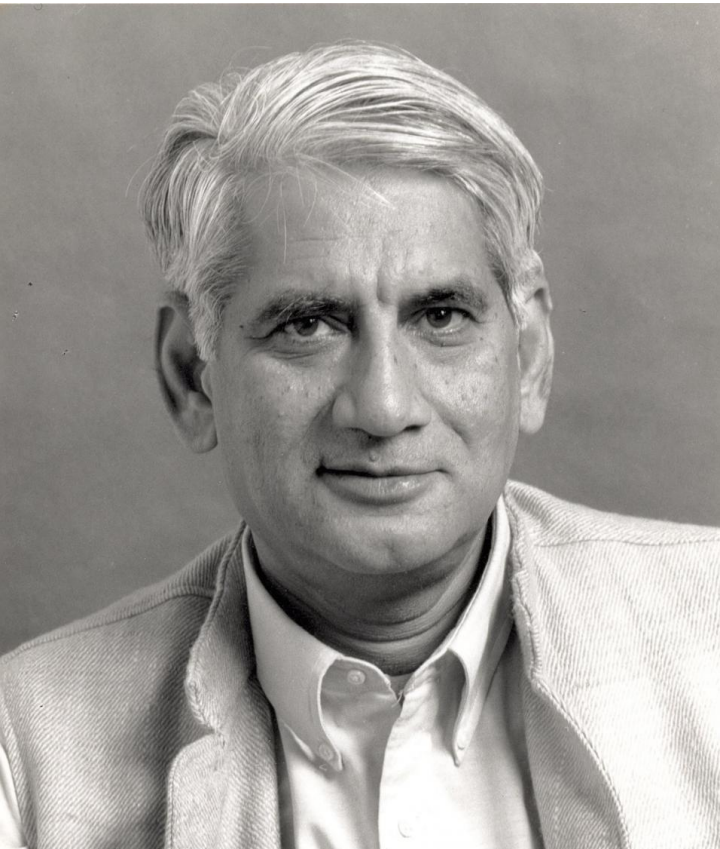

If adequate housing is not appearing in our cities it is sign that something wrong with the system.

Housing policy of slum redevelopment

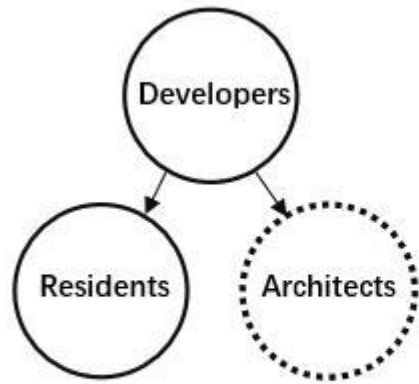

Market-Dominant Model

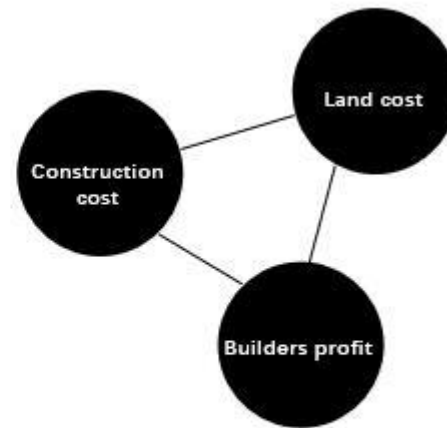

Housing Price

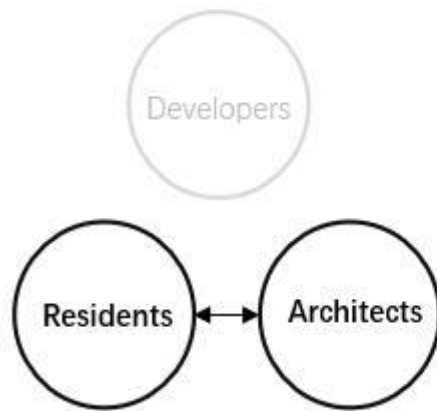

Building up group Model

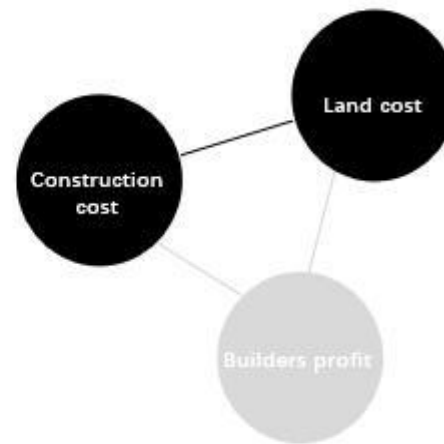

Housing profit

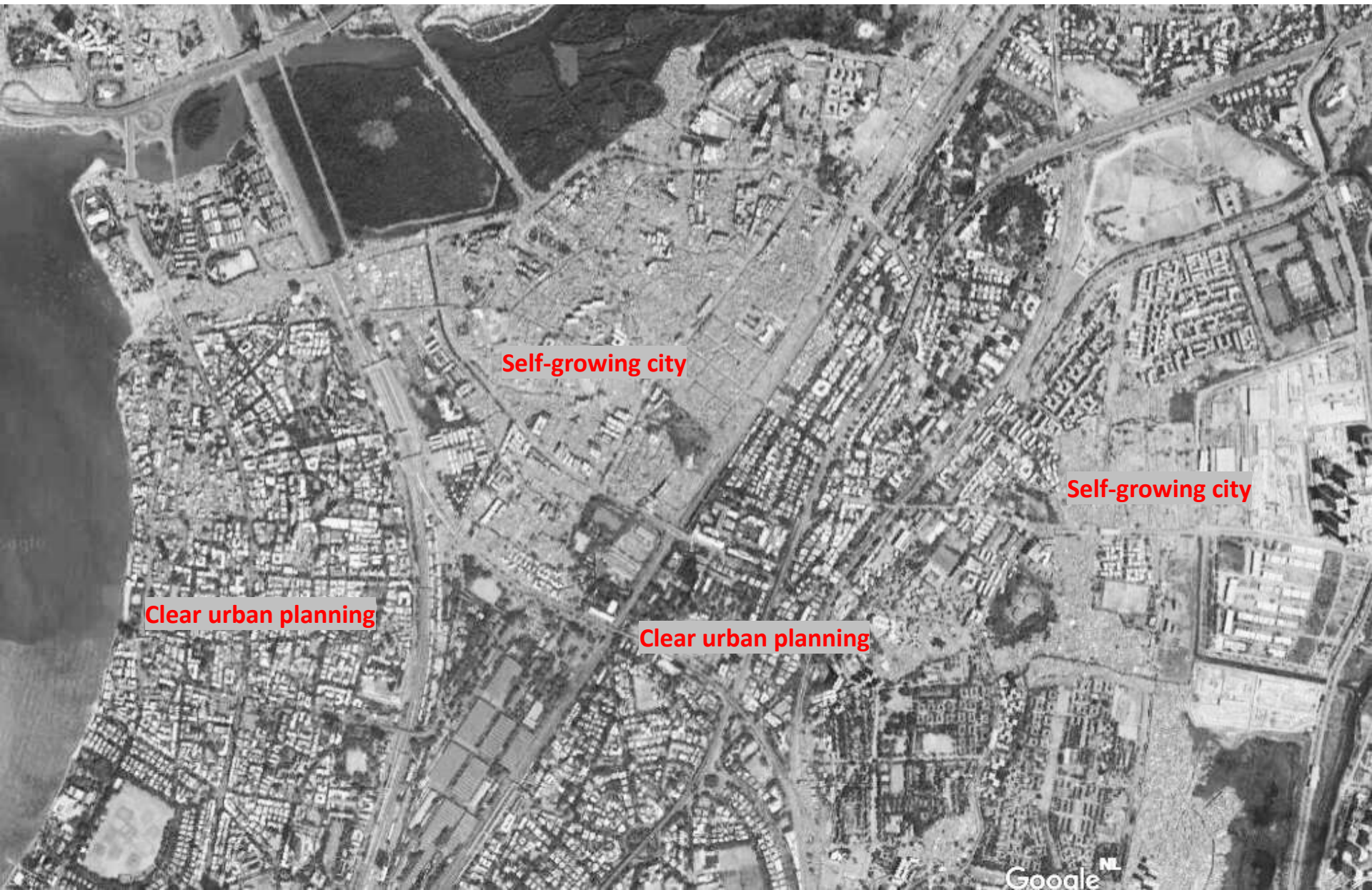

Self-growing city

Self-growing city

Clear urban planning

Clear urban planning

One space and Two worlds



Spacious high-rise residence in the city



Self-built slums along the transport line



The rich's comfortable lifestyles



The poor's struggle for life



Organized big malls



Disordered street markets



-City's messiness

-Neighborhoods' vitality





Round Trip - from Mumbai to Ratnagiri

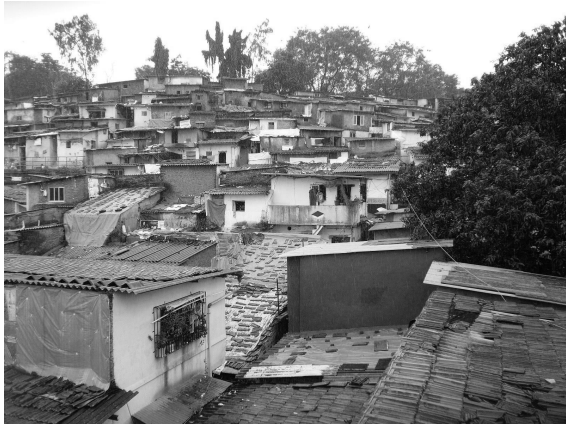

Slums in Mumbai City



A Homegrown Neighborhood in the village

Their world evokes another narrative of imagined communities, where conceptions of home and belonging are extended beyond geographical limits.

How does the Building-up Group Model accomplish a community-oriented housing to integrate the urban poor into the city of Mumbai ?

Building up group model system

Community design strategy

Housing system model without developers

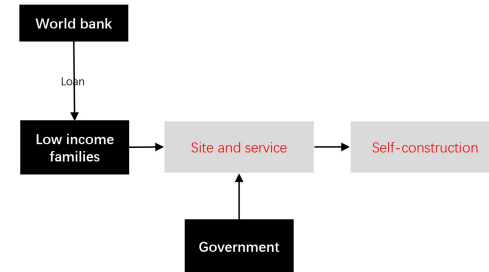
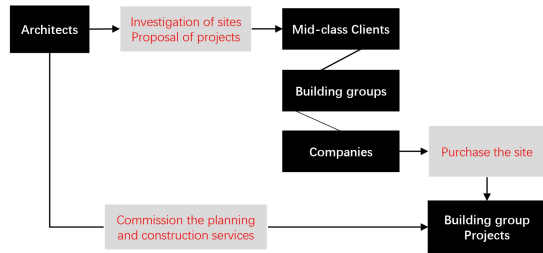

SmartHoming / Germany

My Life, My House/ Brazil

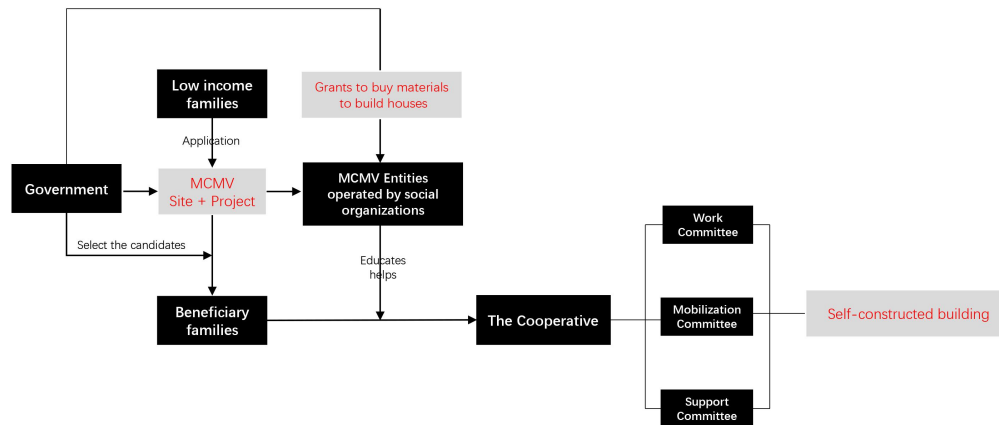

site & service scheme / Mumbai

Building up group model system

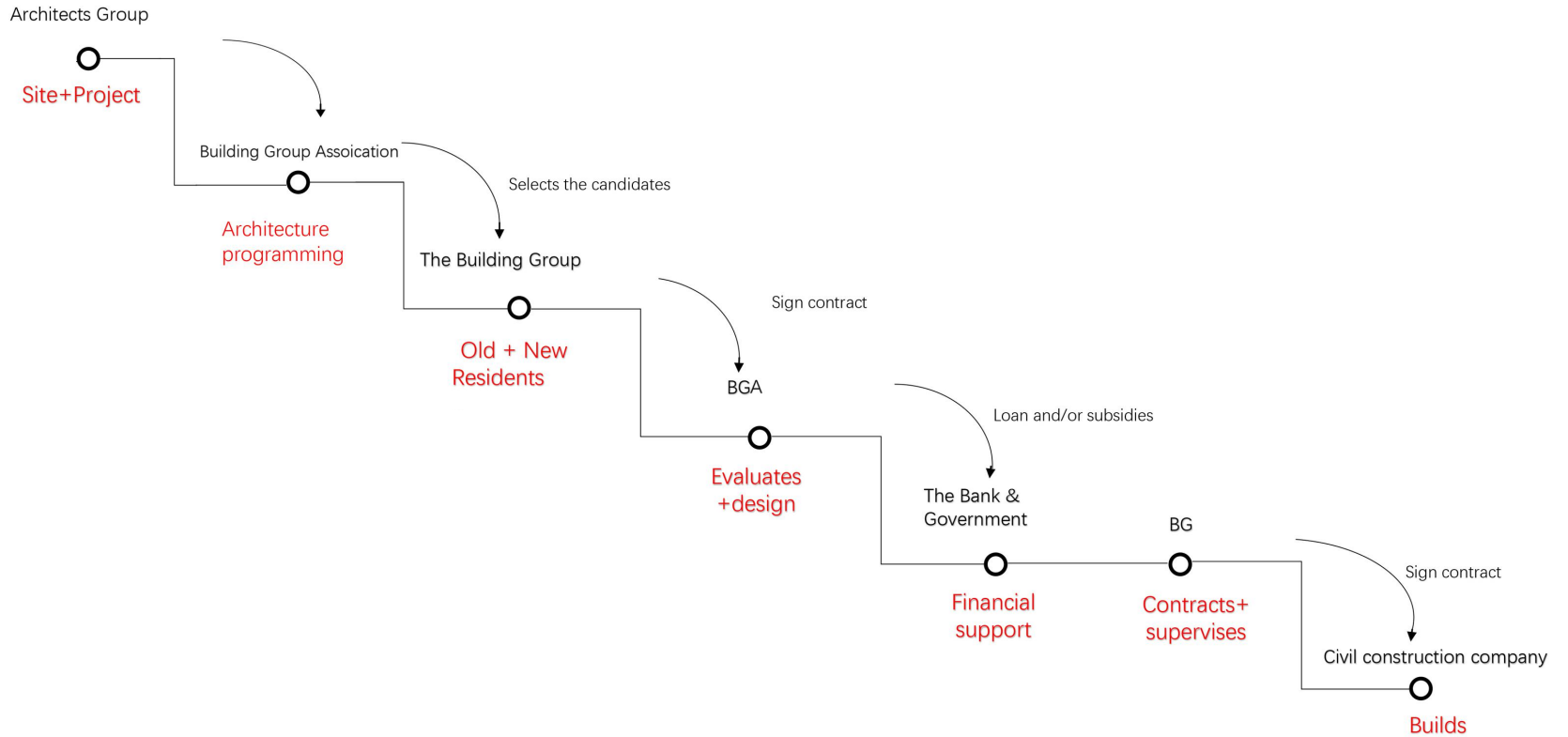

Platform for Building group Model



Platform for Building group Model

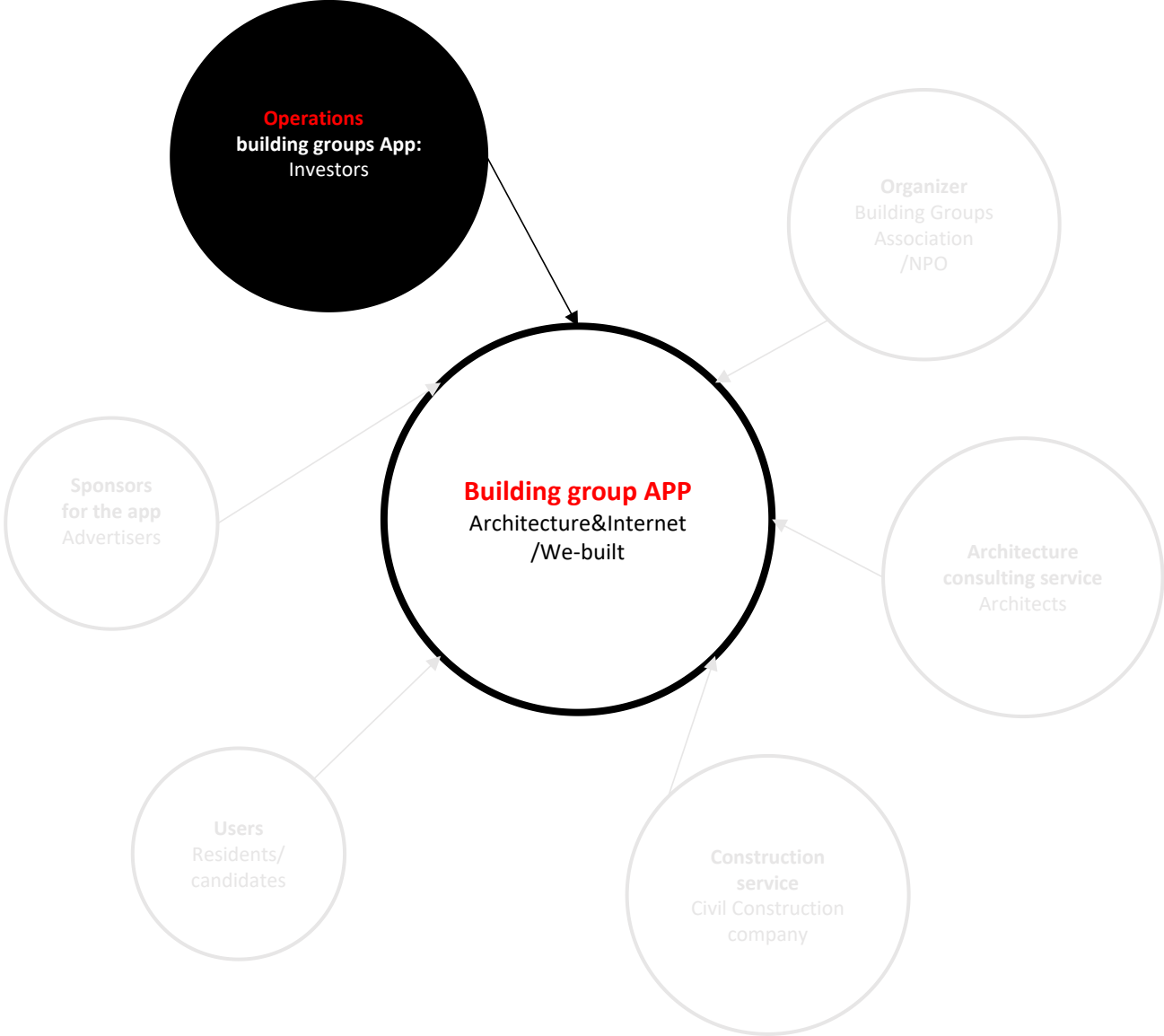

Platform for Building group Model

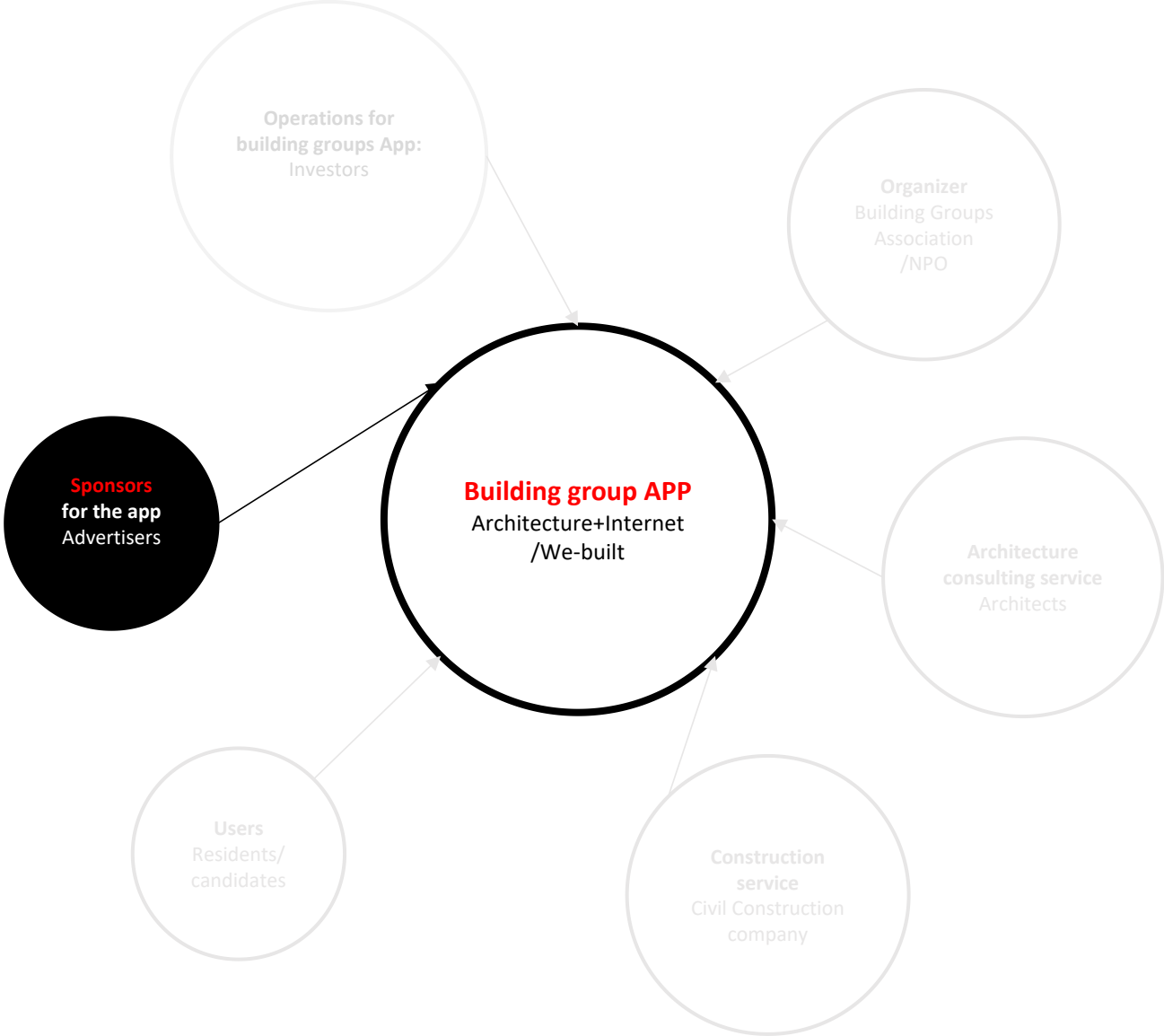

Platform for Building group Model

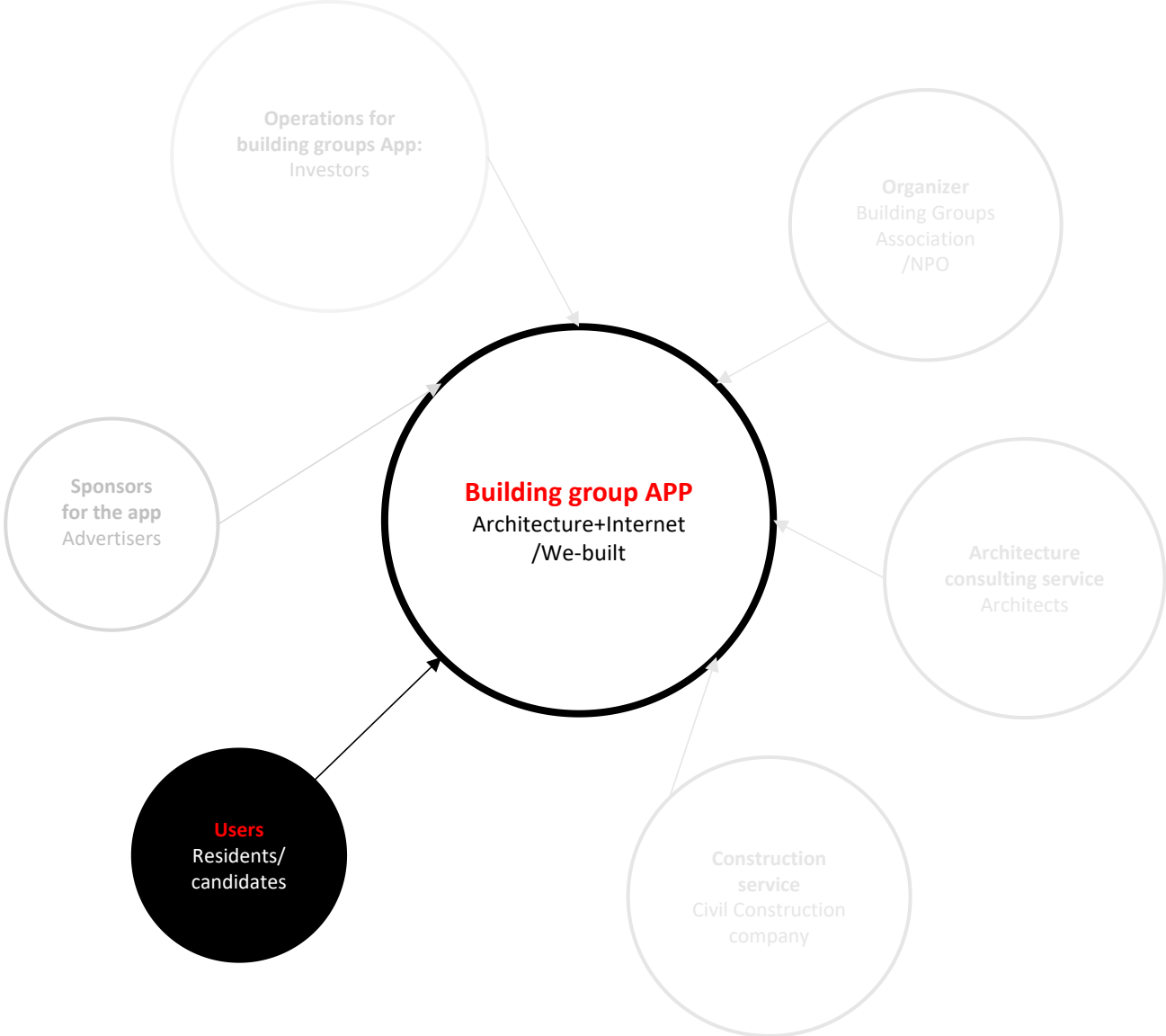

Platform for Building group Model

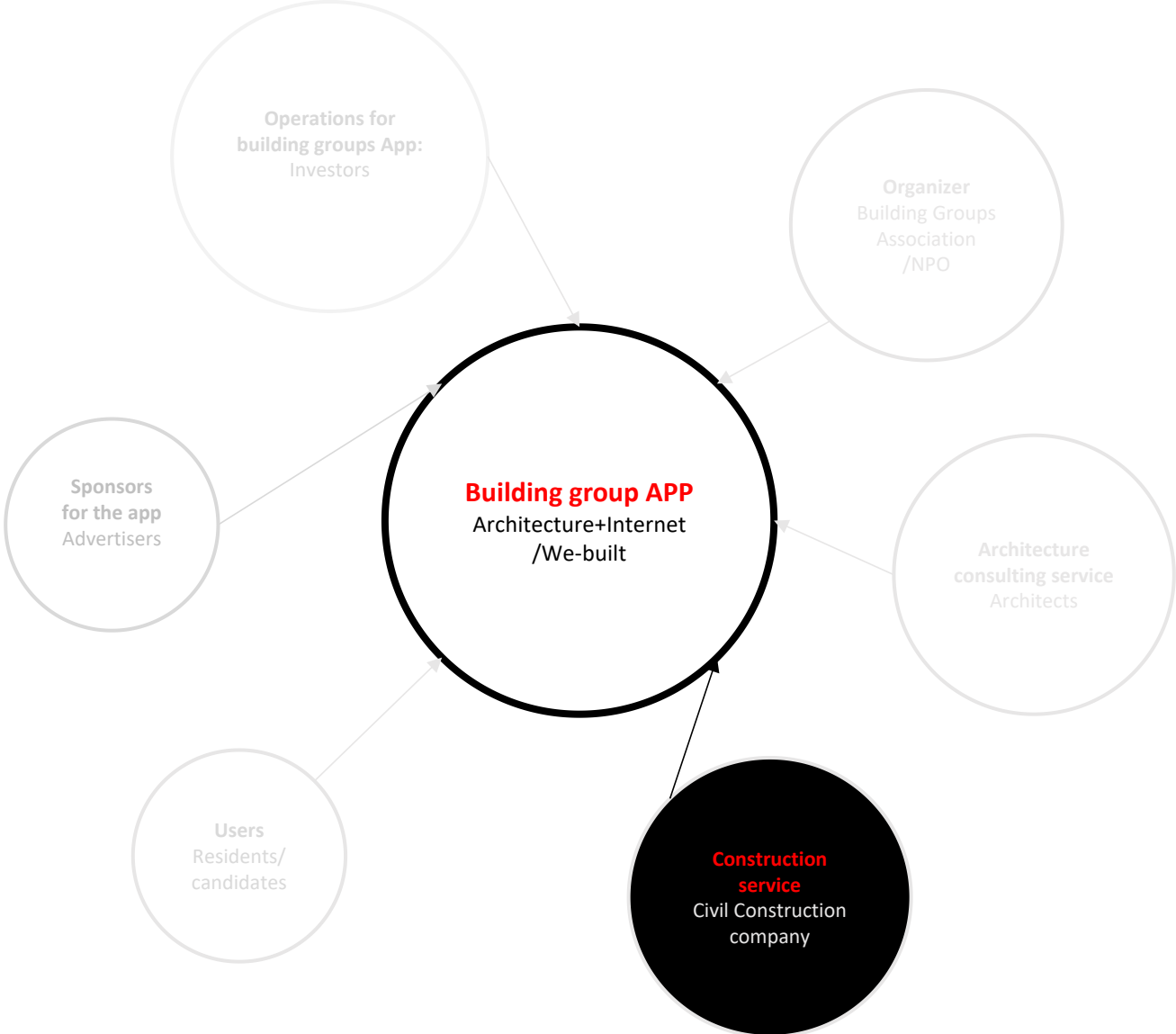

Platform for Building group Model

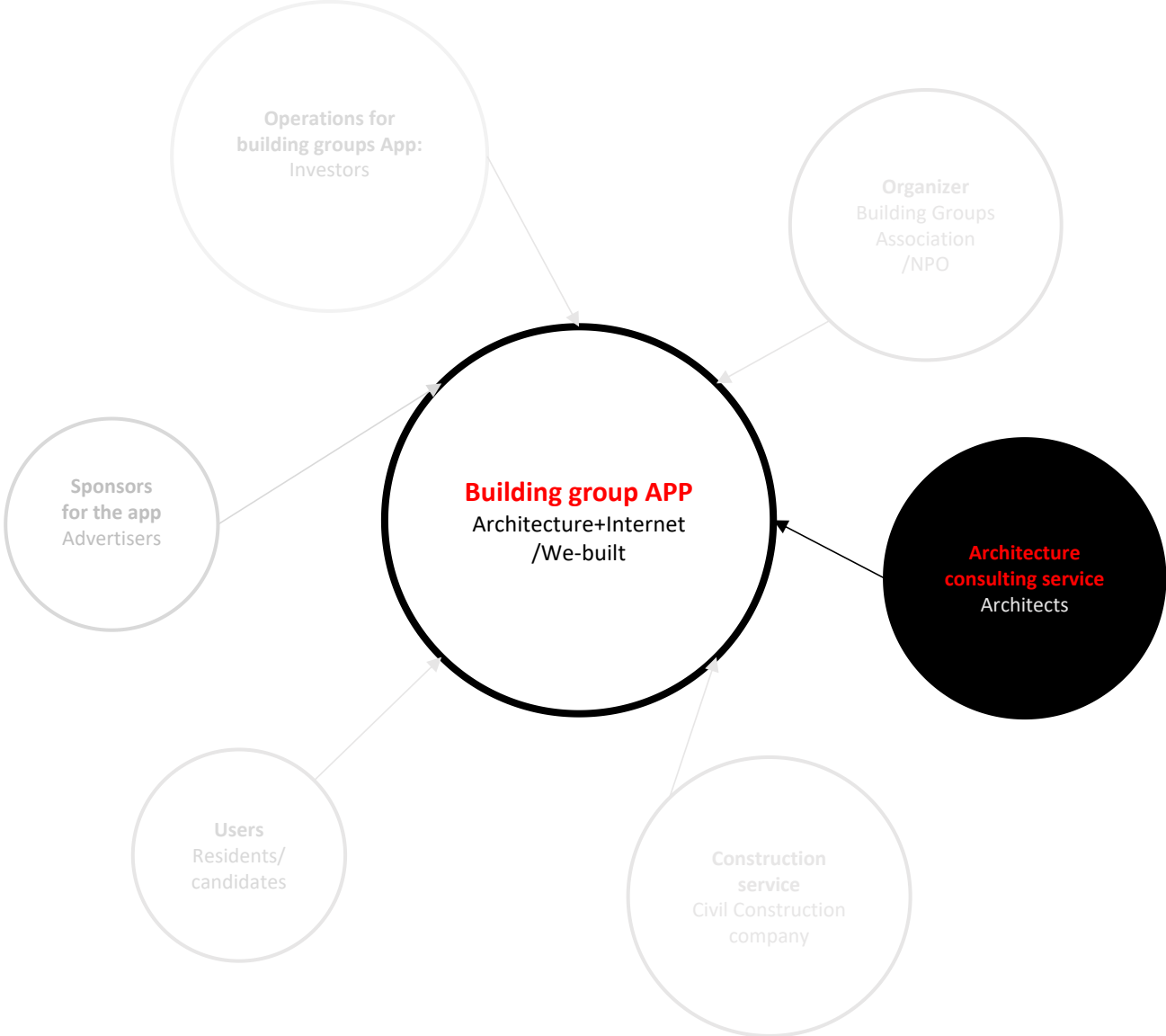

Platform for Building group Model

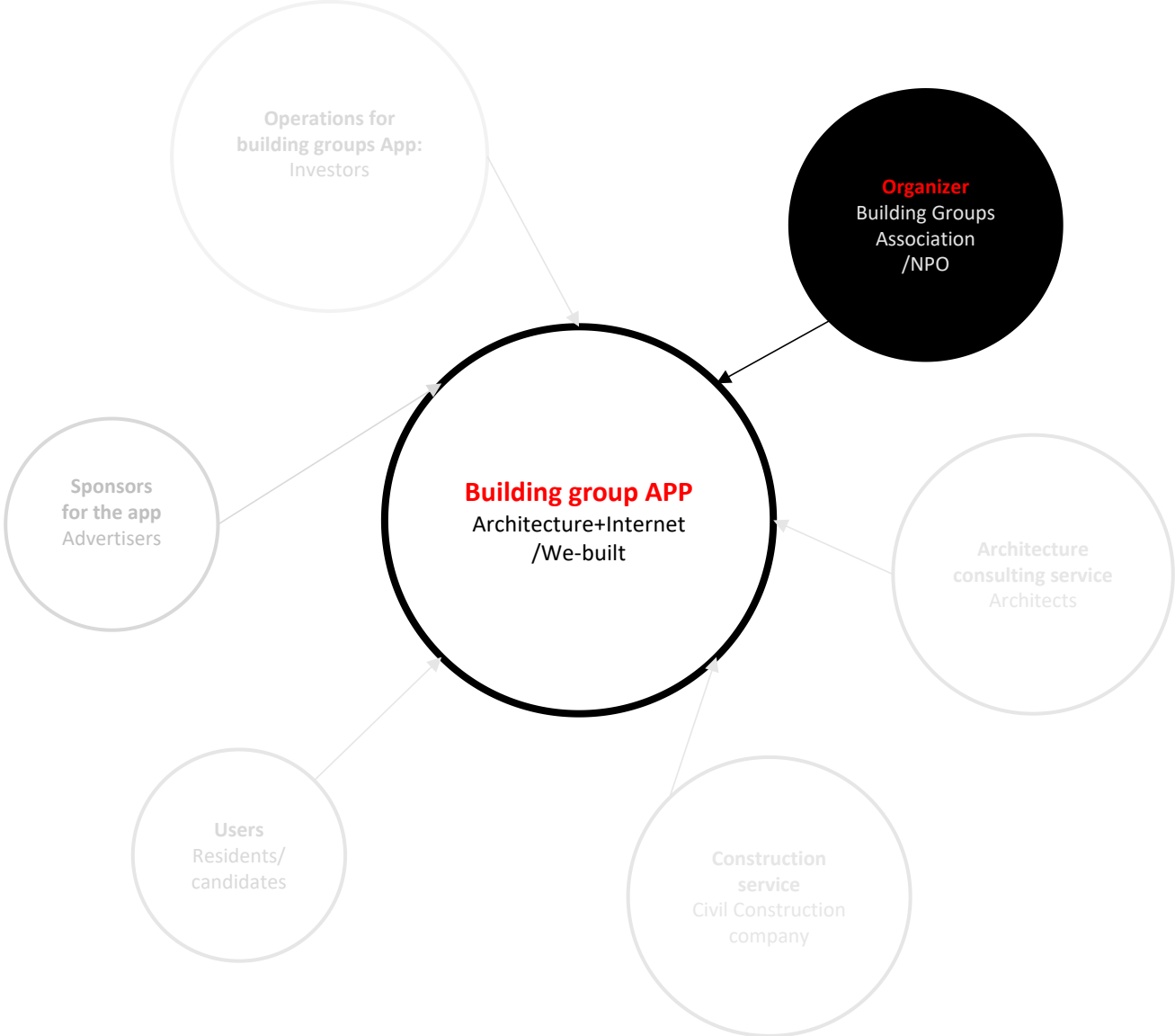

Platform for Building group Model

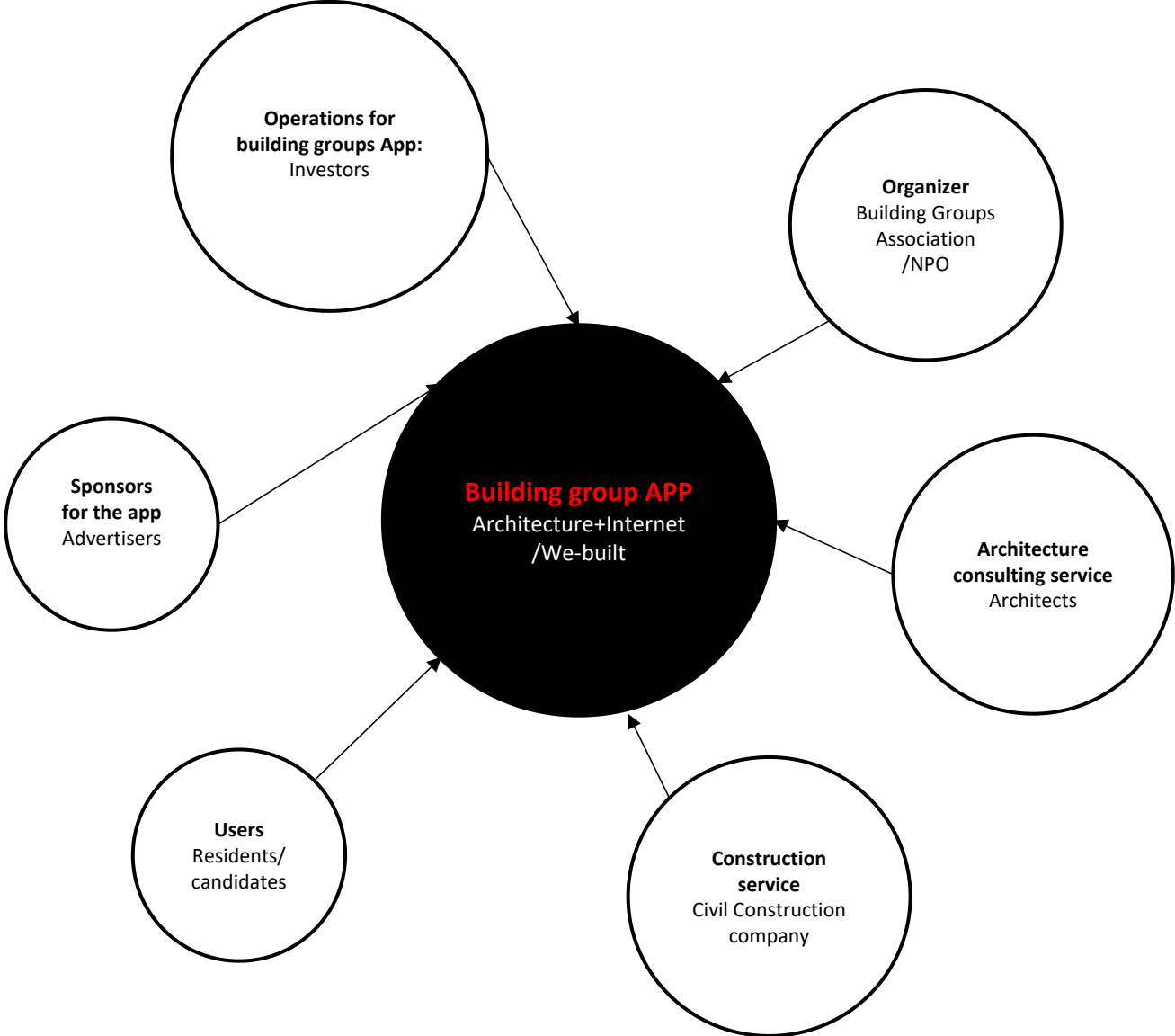



Old village

Self-growing old village of Sopara

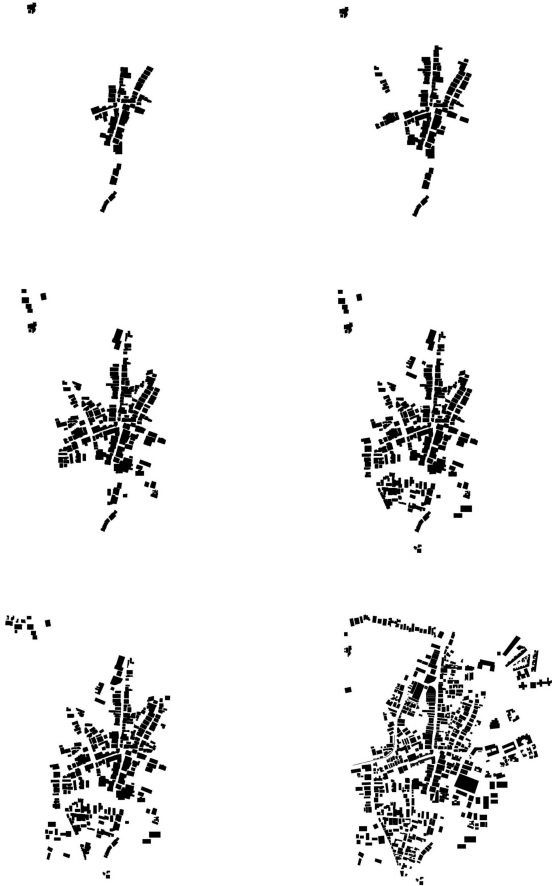

Structure of old village



Buildings



Streets



Yards



Shared courtyard



Clusters

The size of different communities



Small ~ 5-10 Building units/5-20 Households



Medium ~ 10-20 Building units/30-60 Households



Big ~ 20-60 building units/70-100 Households



The morphology of different communities' open space

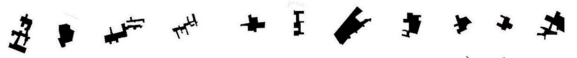

Small



Medium

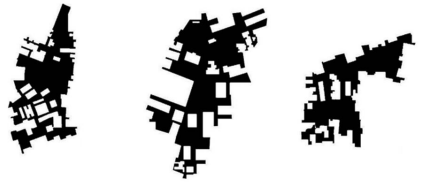
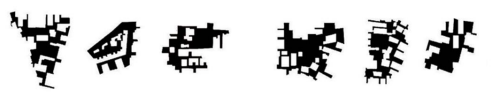

Big





From Chawls community to Building up community

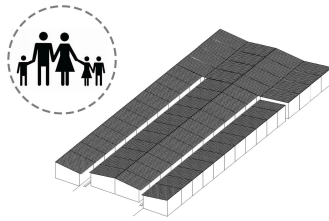

The Chawl Community

Original inhabitants living in same Baithi Chawls area have stable social interaction with each other, the chawl community has been evolving. Although the community set up is in a low income group, it has been maintaining a dignified and a safe living environment.

The Chawl community revolves around the concepts of living together, sharing things which are personal and understanding neighbors in deprived spaces of inappropriate proportions.

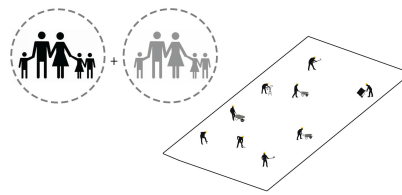

The Building up Group

The Building Group is made up of original inhabitants of the same chawl community. Also, a certain amount of residents' friends or relatives can join in the group to purchase the land together, and take charge of design and construction processes themselves with the guidance of architects.

Community networks are formed and consolidated through the process of design and construction with the Building Group system. The cooperative model strengthens the social and economic relationships amongst neighbors and facilitates the establishment

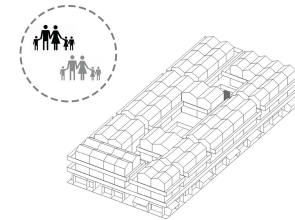

The Building-up Community

According to different sizes of the Building-up Group, various social spaces for the new community will be created in the new residence. Also, considering the various occupations and background of the Building-up Group's members, mixed-use community space should be created to meet the needs of religion, commerce and education.

Architectural elements identified from local community space in Mumbai, such as courtyards, balconies, by-lane, place of worship and so on, can be added to new house typologies to design the Building-up Community.

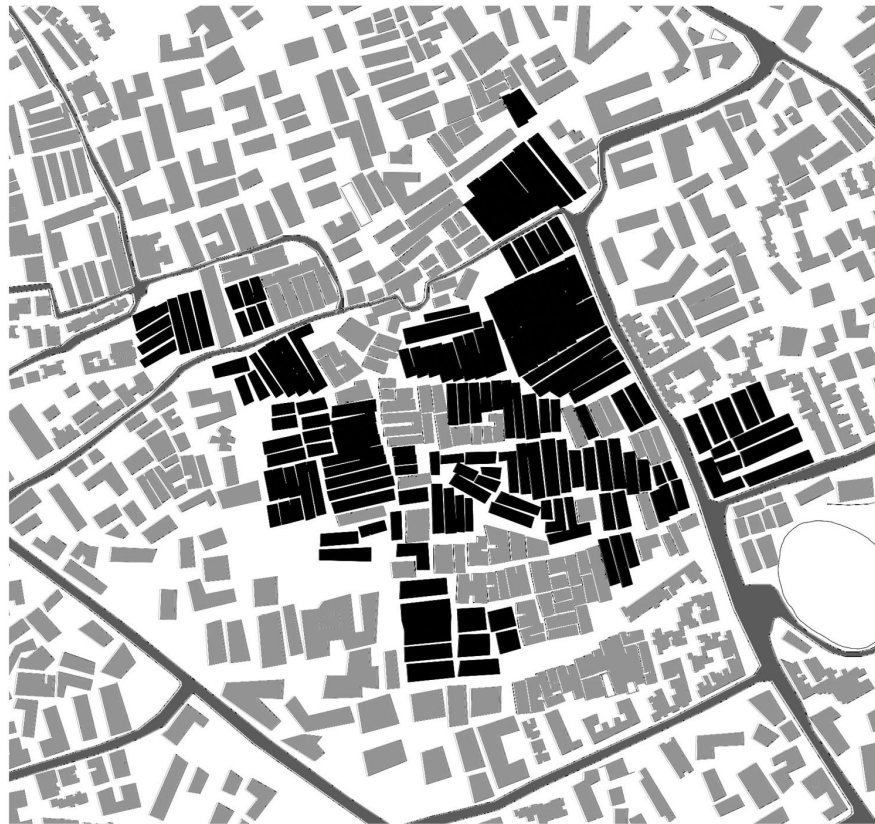

Original fabric of baithi chawls area

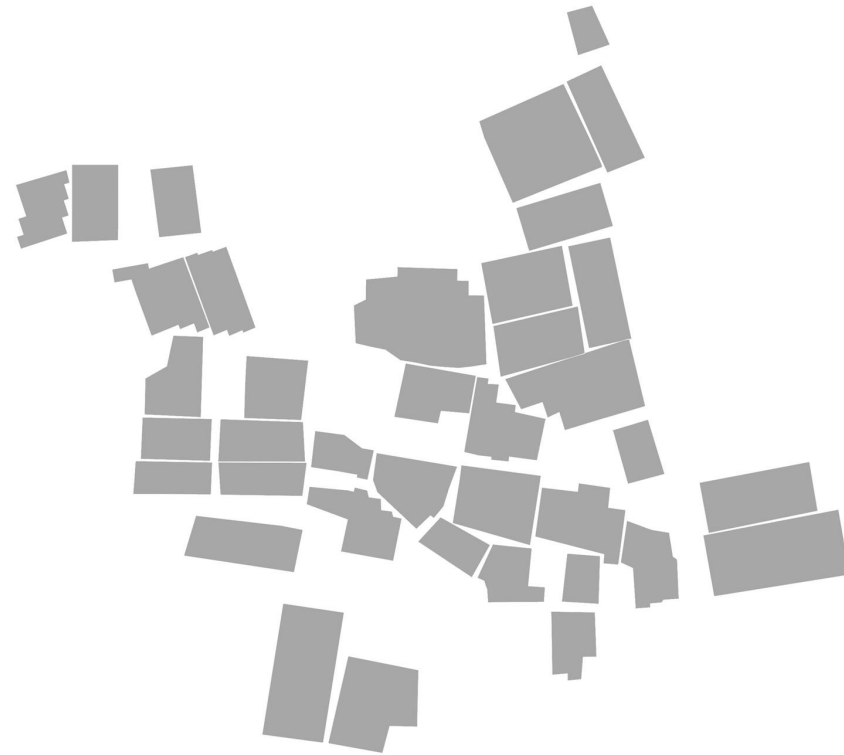

Building groups cluster

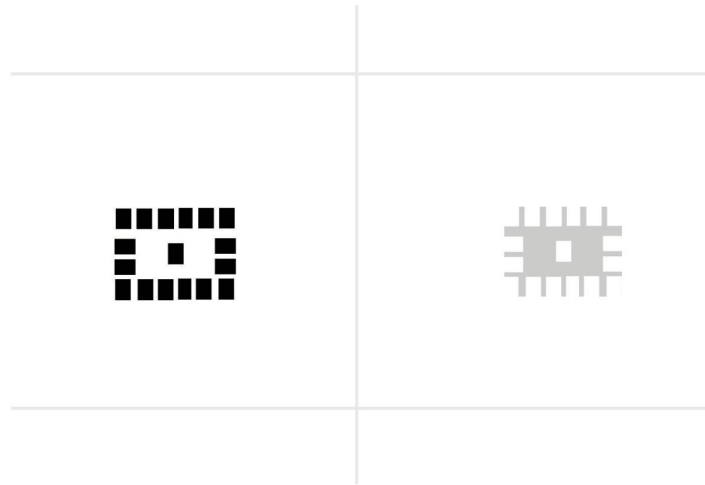

Prototype of medium community structure



Building units

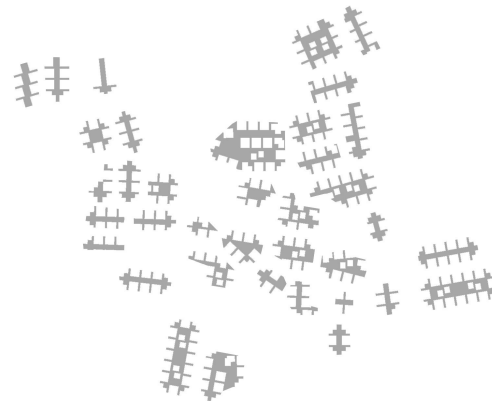

Community's open space

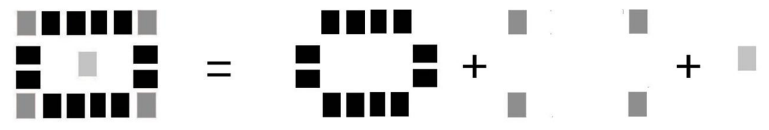

- - Outer House
- - Corner House
- - Center House

Three house types in the community

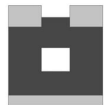

- Outer House



- Corner House



- Center House

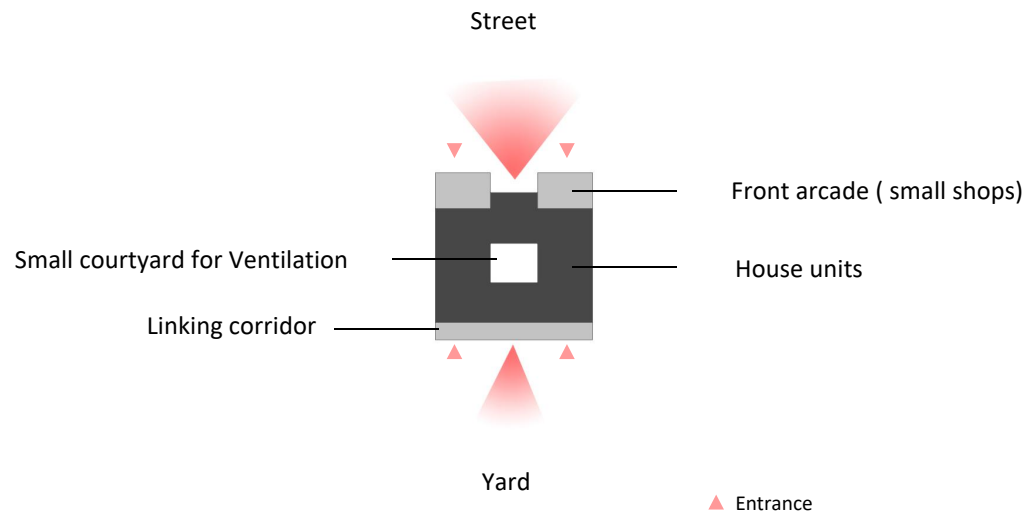

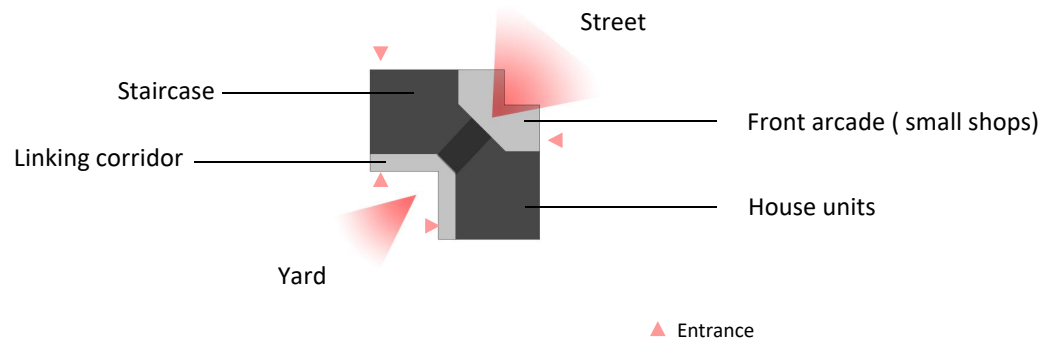

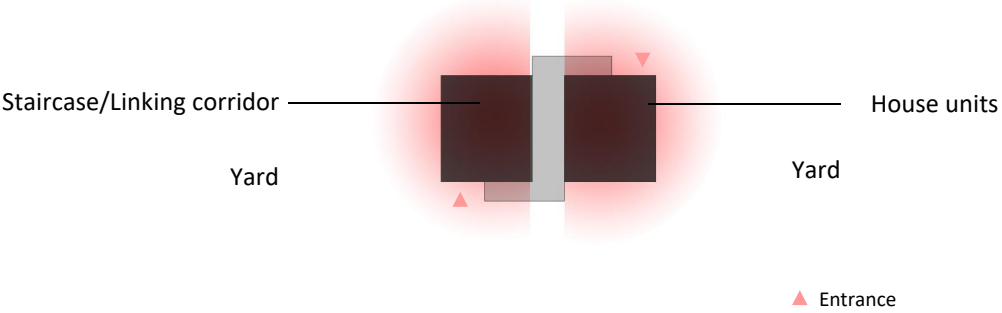

Configuration of three house types for different Building-up group community

