

Never Finish

A plug-and-play institution building full-scale repairs
for Athens



Broken curb

Uneven and broken floor pavement

Bent railing

The Reality of the Athens Street Fabric

Uneven and
broken floor
pavement



The Reality of the Athens Street Fabric

NEWS

City of Athens struggling to keep up with public works tearing up capital's streets, sidewalks



Illustration by Loukia Kattis

■ Vassilis Andrianopoulos, Dimitra Triantafyllou

05.03.2024 • 13:26



The Athens Municipal Authority does not have the resources to keep up with more

The Municipal Governance and Maintenance Gap



Typically, public repairs rely on a rigid, standardized playbook managed entirely by the state.

But what if city maintenance became a creative, participatory process? By combining art and physical craft, we can reshape urban spaces in a fun way—encouraging everyday citizens to pitch in, spark conversation, and build a deep sense of local ownership and belonging.

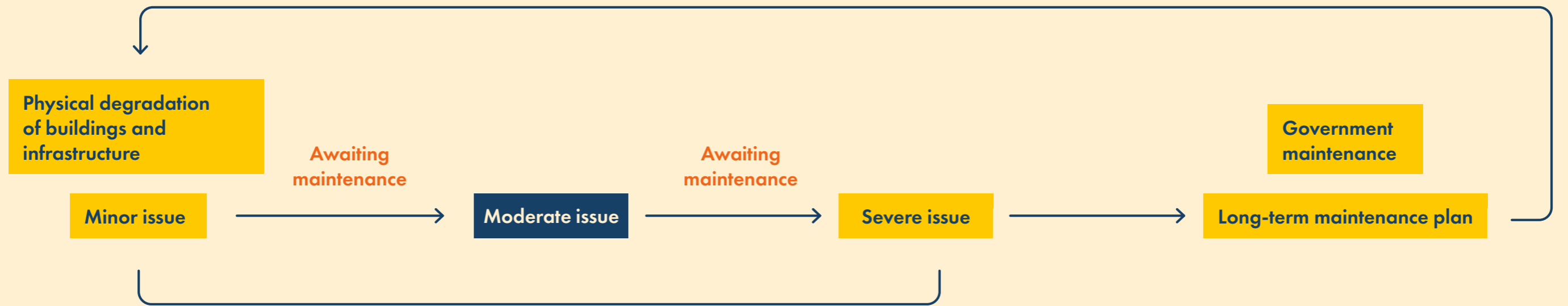

The Operational Intervention Timeline

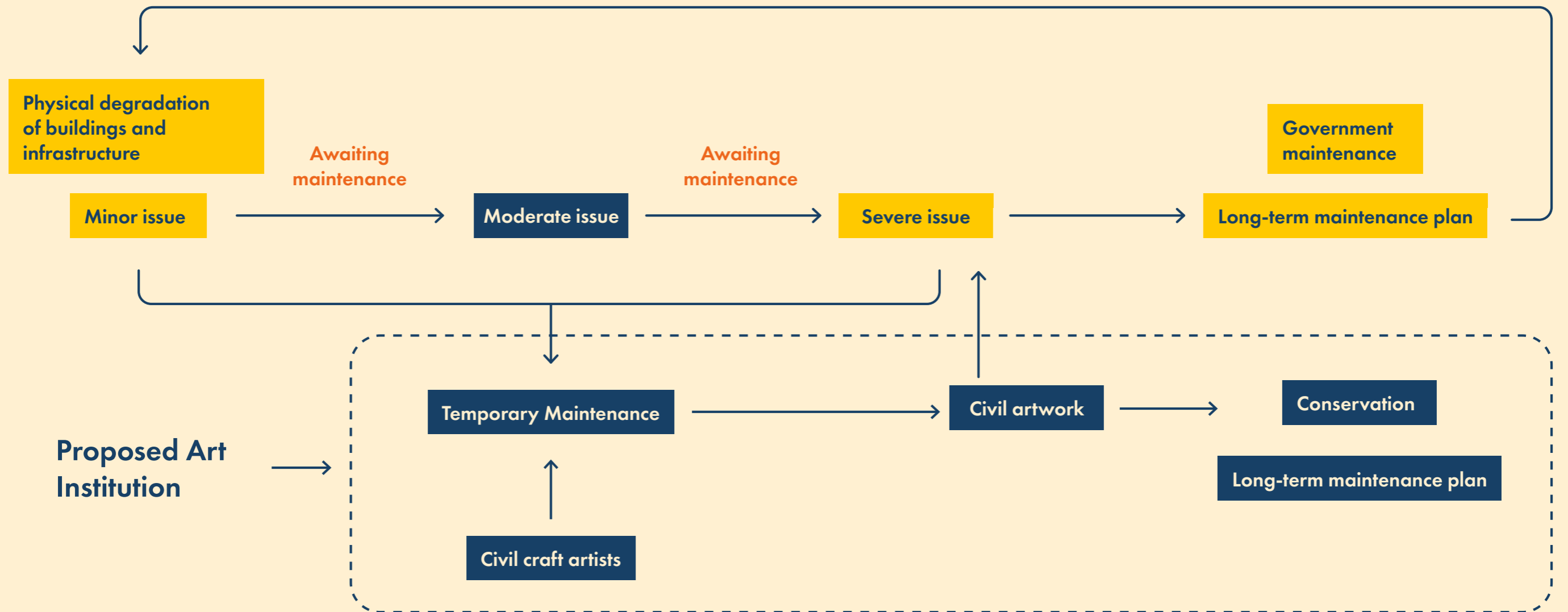

The Operational Intervention Timeline

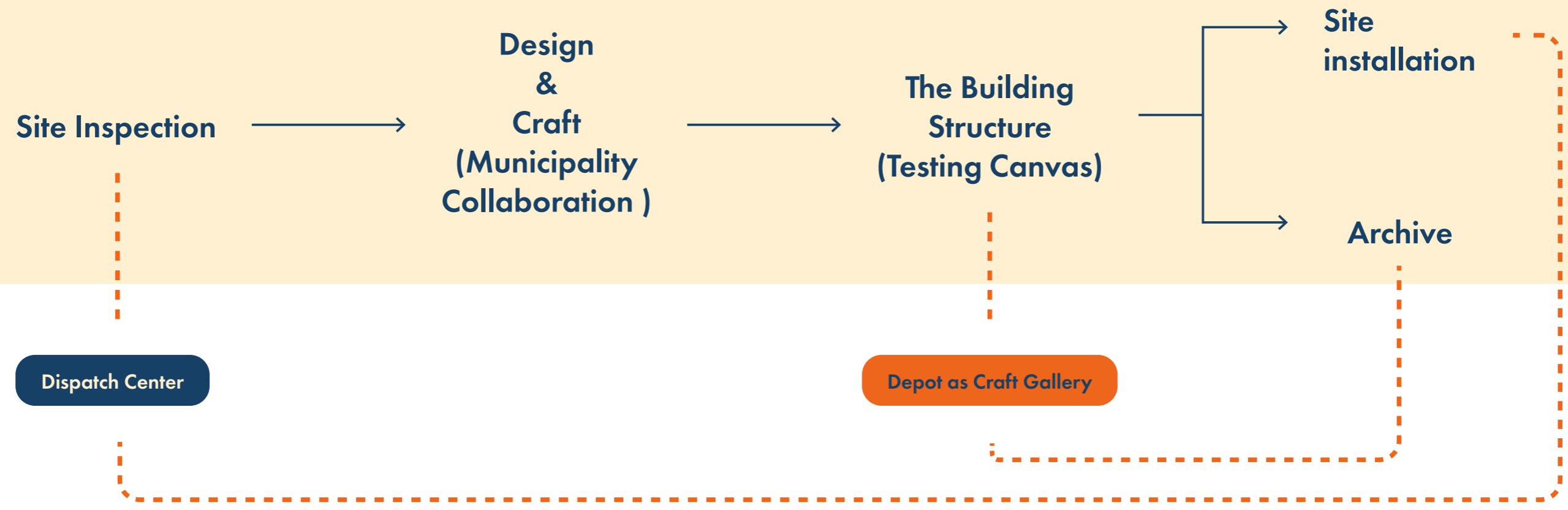

Program

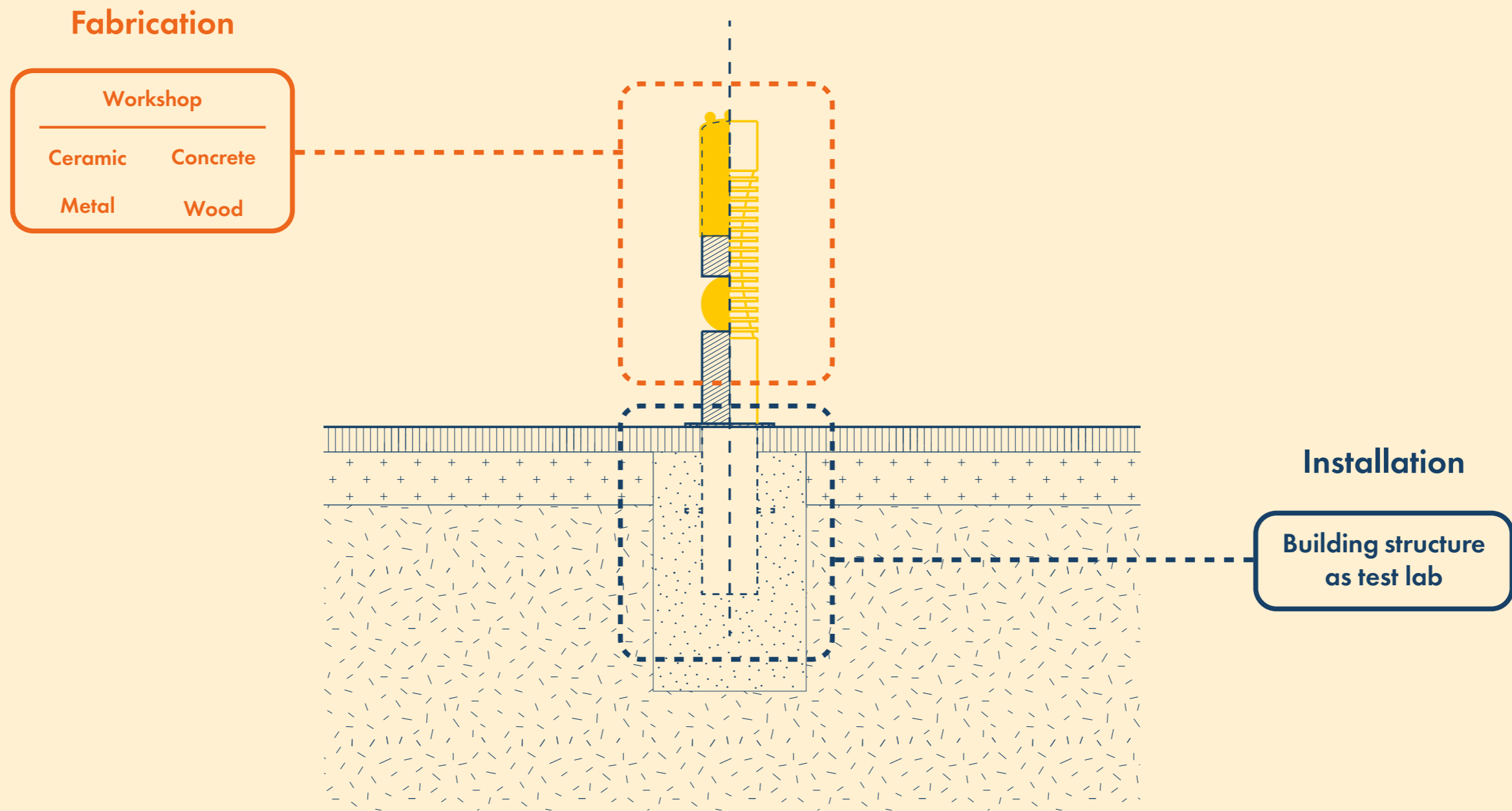

From Workshop Fabrication to Installation Studies

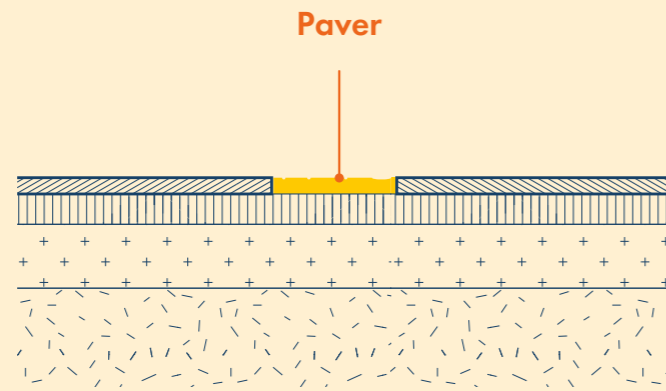

**Public works maintenance
(Surface material)**

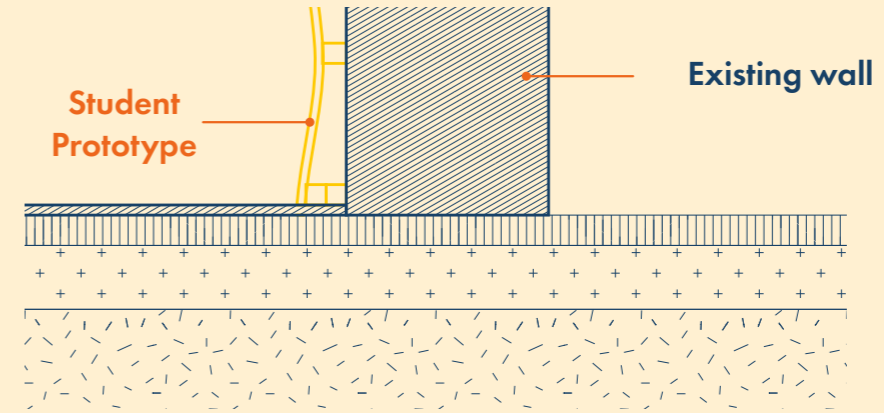

Building maintenance

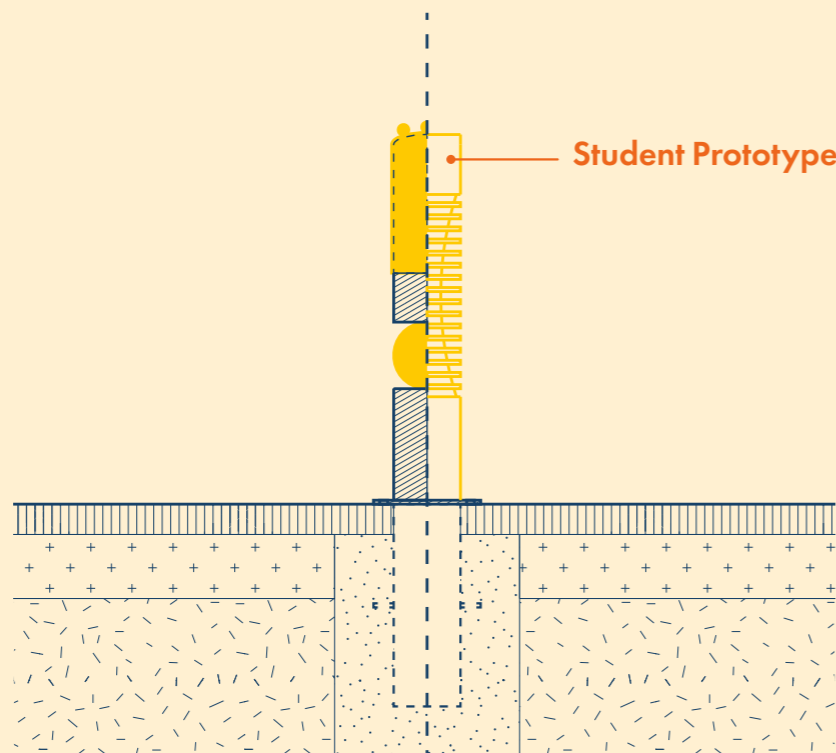

**Public works maintenance
(Street furniture)**

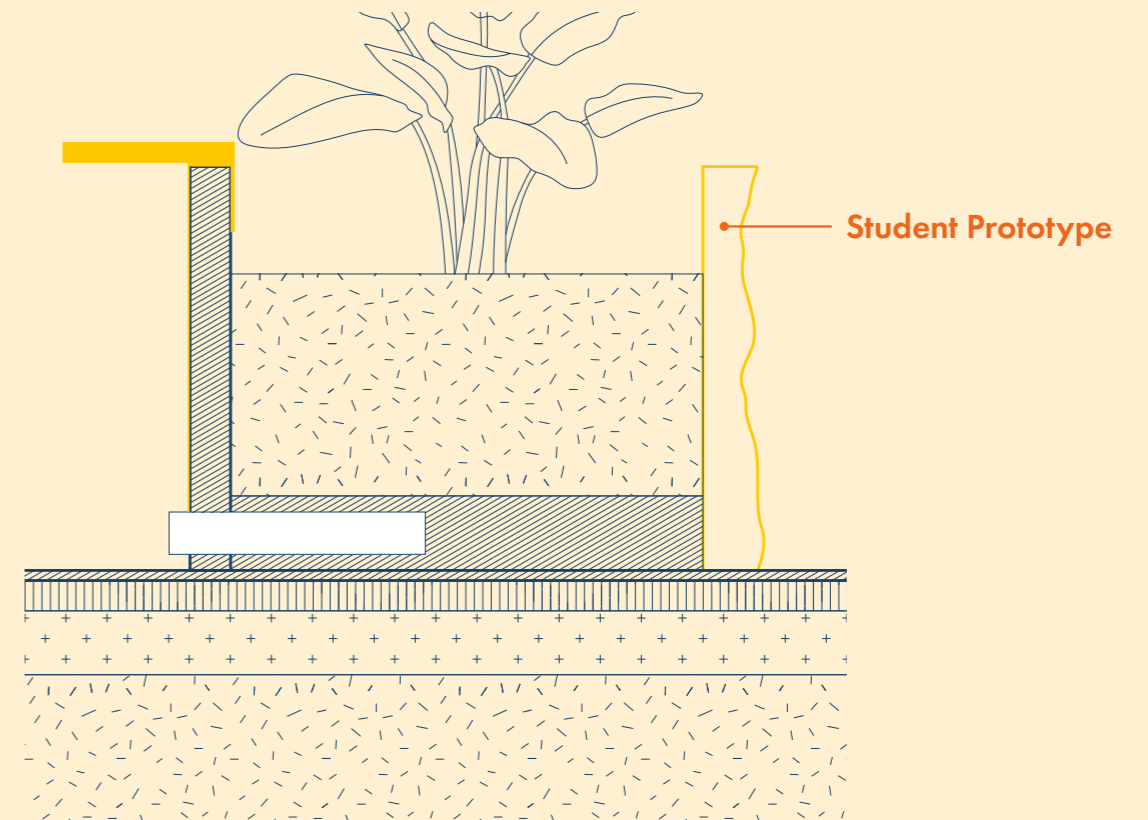

**Ground maintenance
(Park maintenance)**

The Taxonomy of Public-Realm Production

Plato's Academy Park

Site Context



Legend

- Plato's academy
- Plato's academy
- Residential building
- Industrial building
- Commercial building
- Archaeological site
- Related industry

Did you see the competition proposal? If they implement it, we'll lose 30% of the park's free space and they'll cut down 580 large trees!

Municipality proposed museum location

Trees proposed for removal in the area

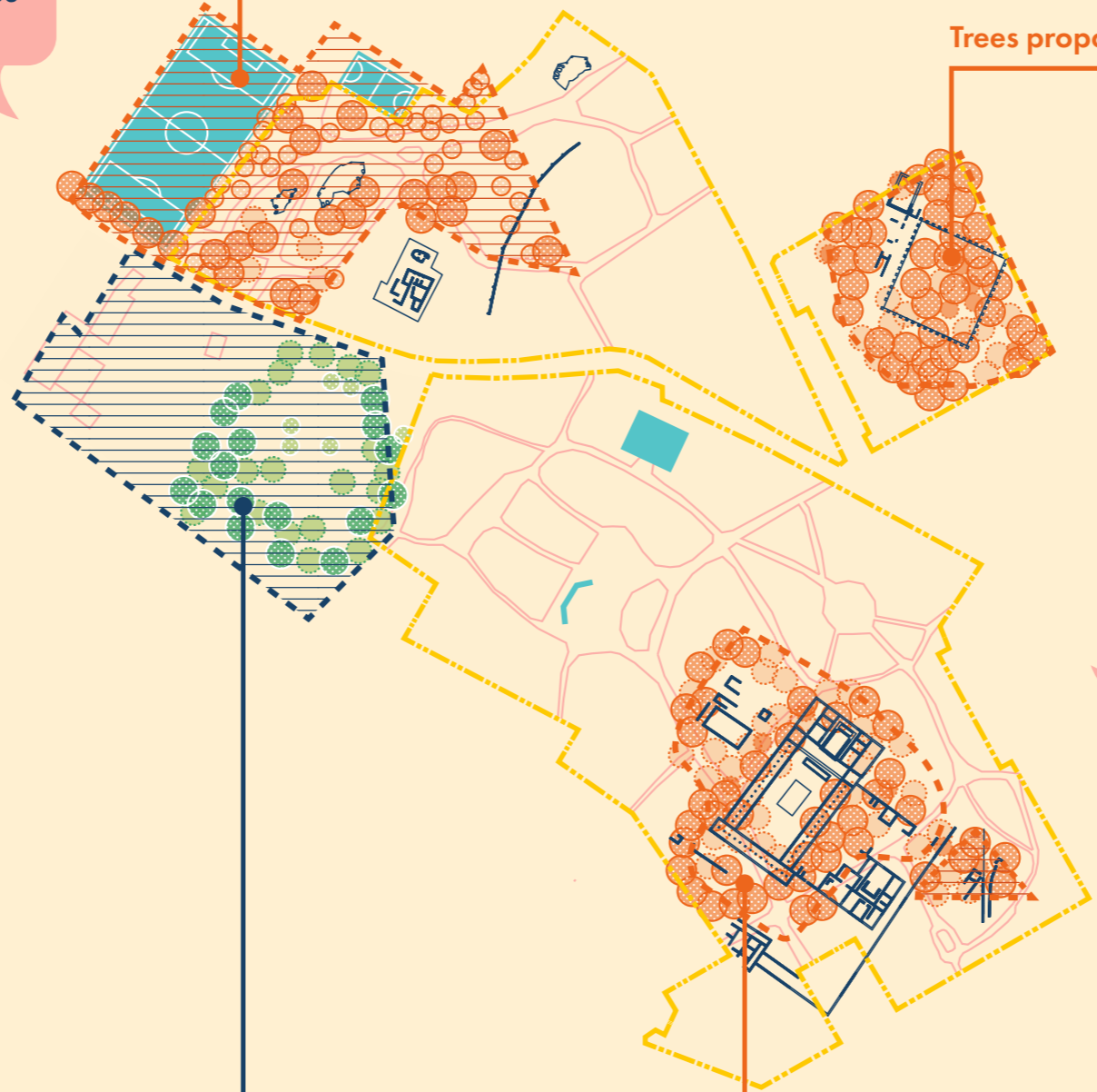

This place is such an important green lung for western Athens and one of the most significant archaeological sites we have.

New proposed institution

- Abandoned buildings owned by the municipality to be demolished
- Low-impact construction to the neighborhood
- Limit tree removal

Trees proposed for removal in the area





How to design an art institution that actively builds, tests, and stores real-world repairs to renew the streets of Athens?

Research question

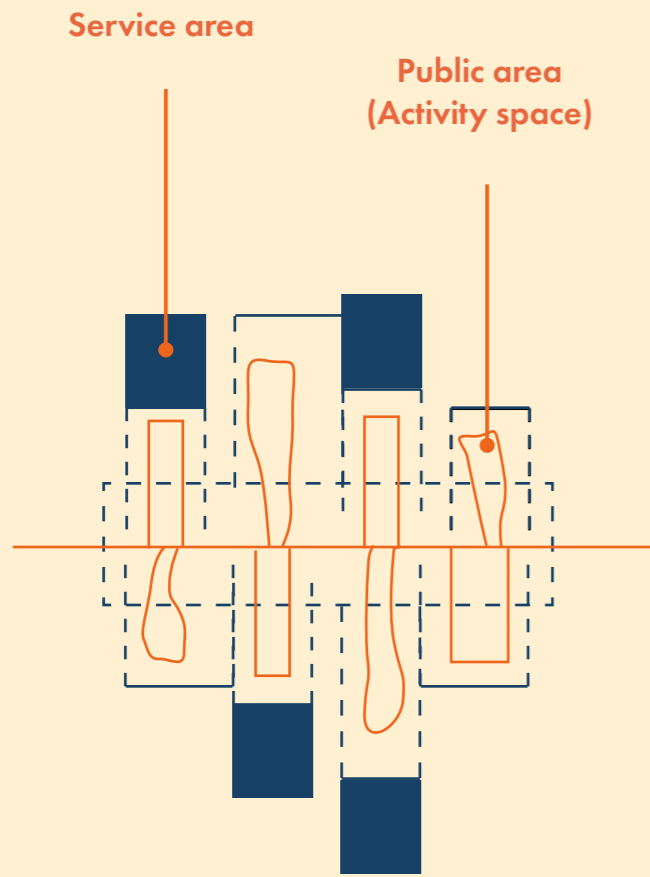

1

Public Space and Craft on the Street, Utility in the Core

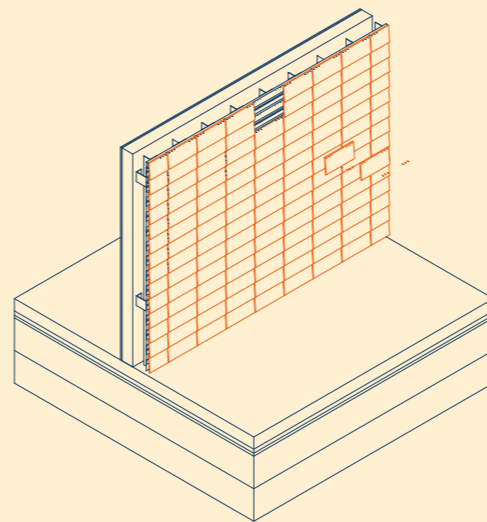

2

The Building as a Living Tectonic Archive

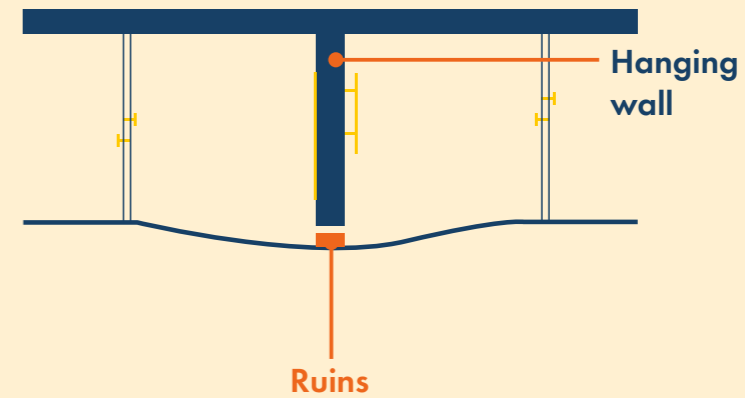

3

Reversible Heritage Activation

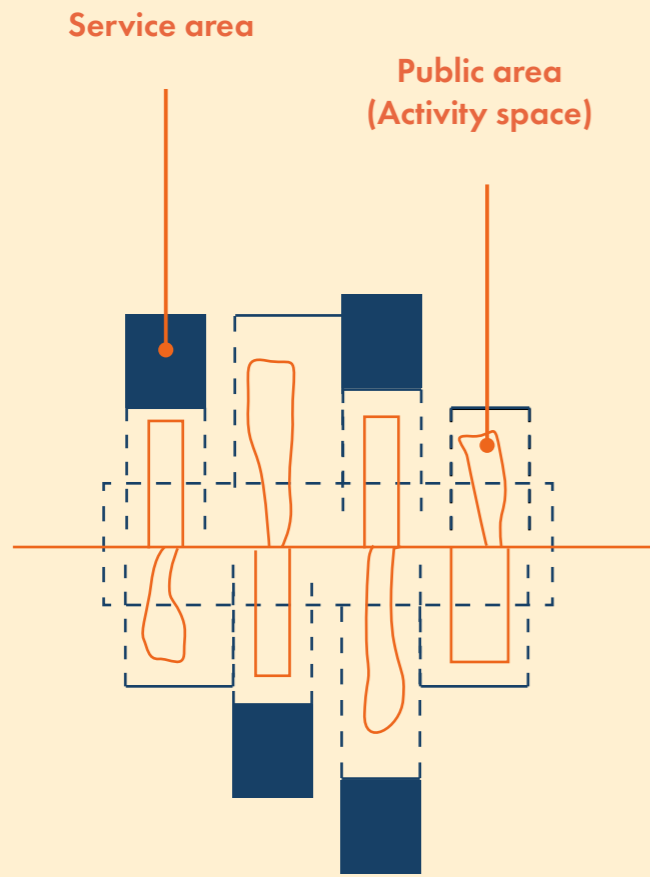

1

Public Space and Craft on the Street, Utility in the Core



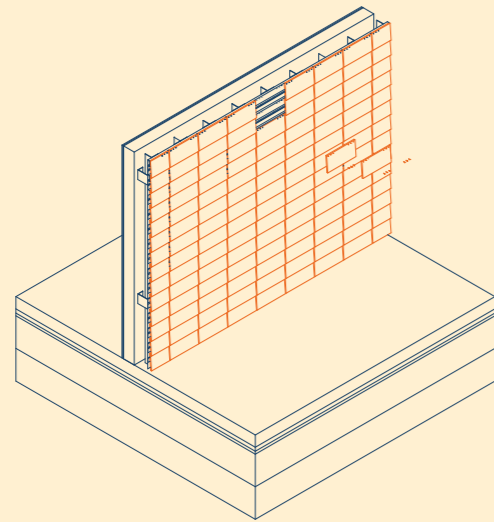

2

The Building structure as a Living Tectonic Archive

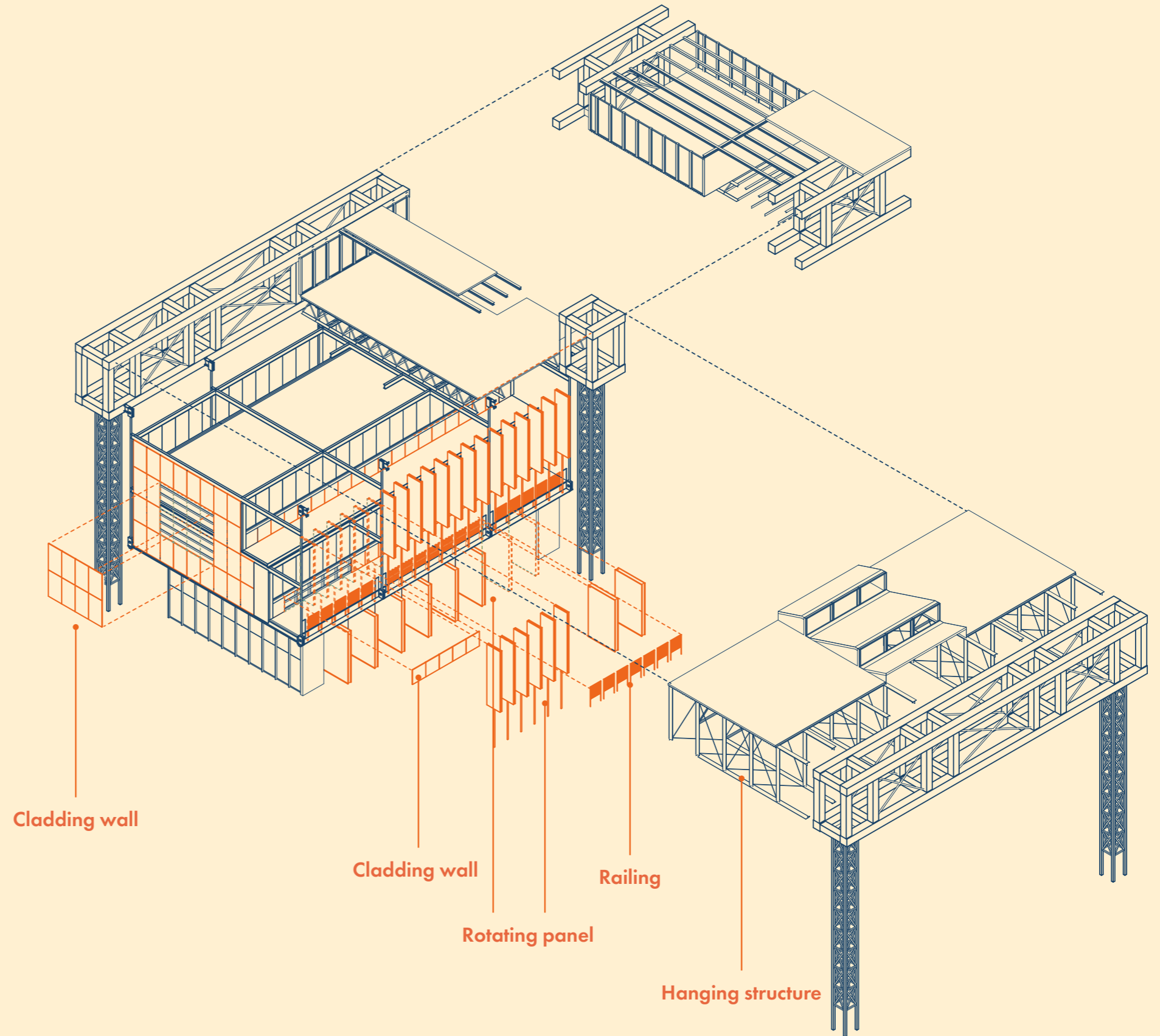

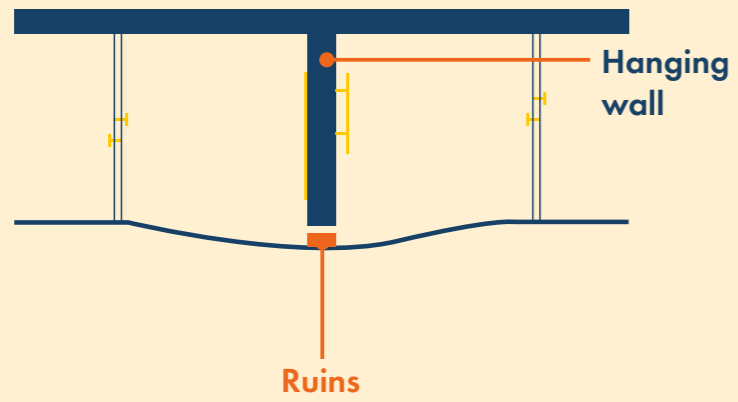

3

**Reversible Heritage
Activation**

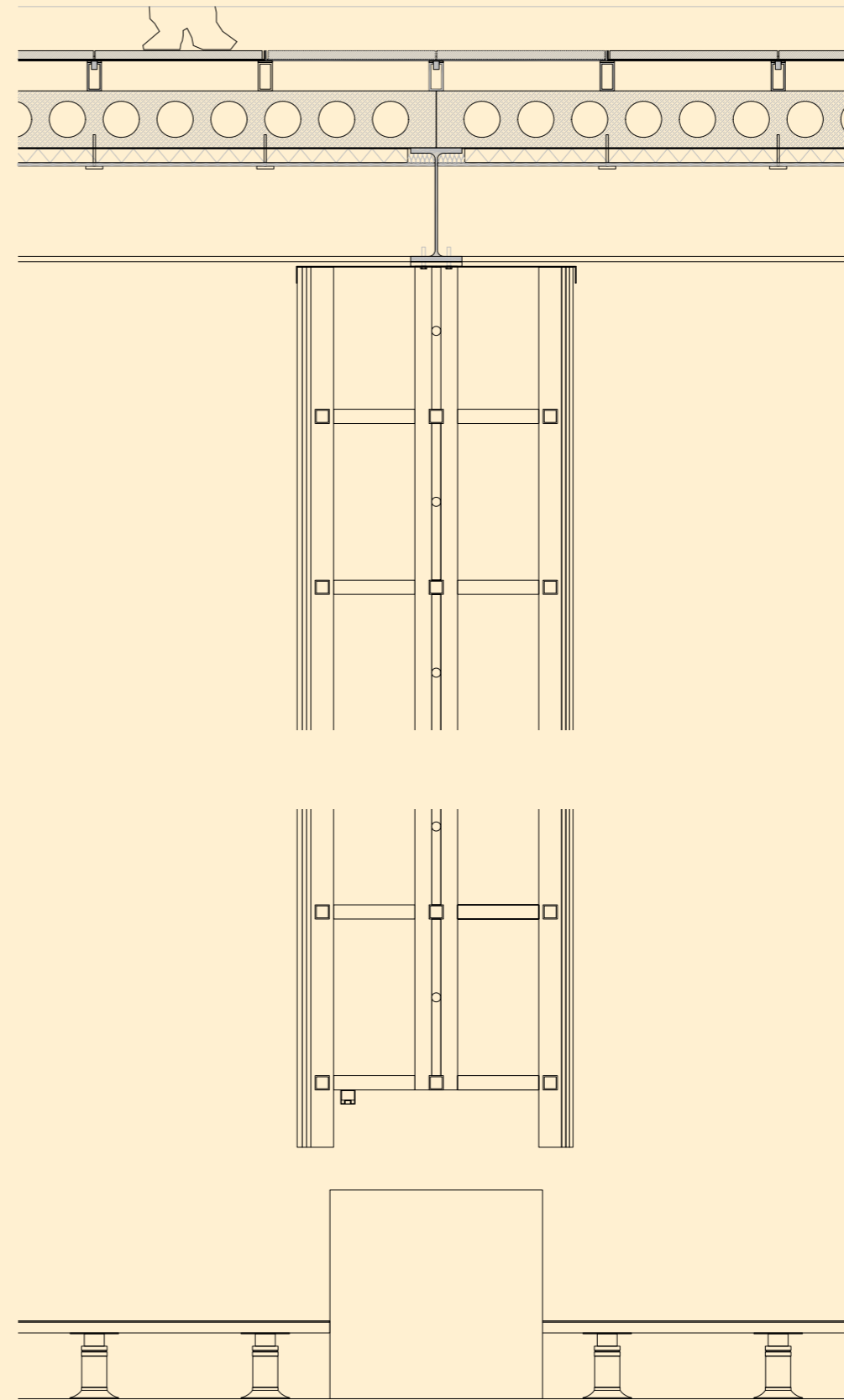

**Tension-Suspended
Exhibition Walls**

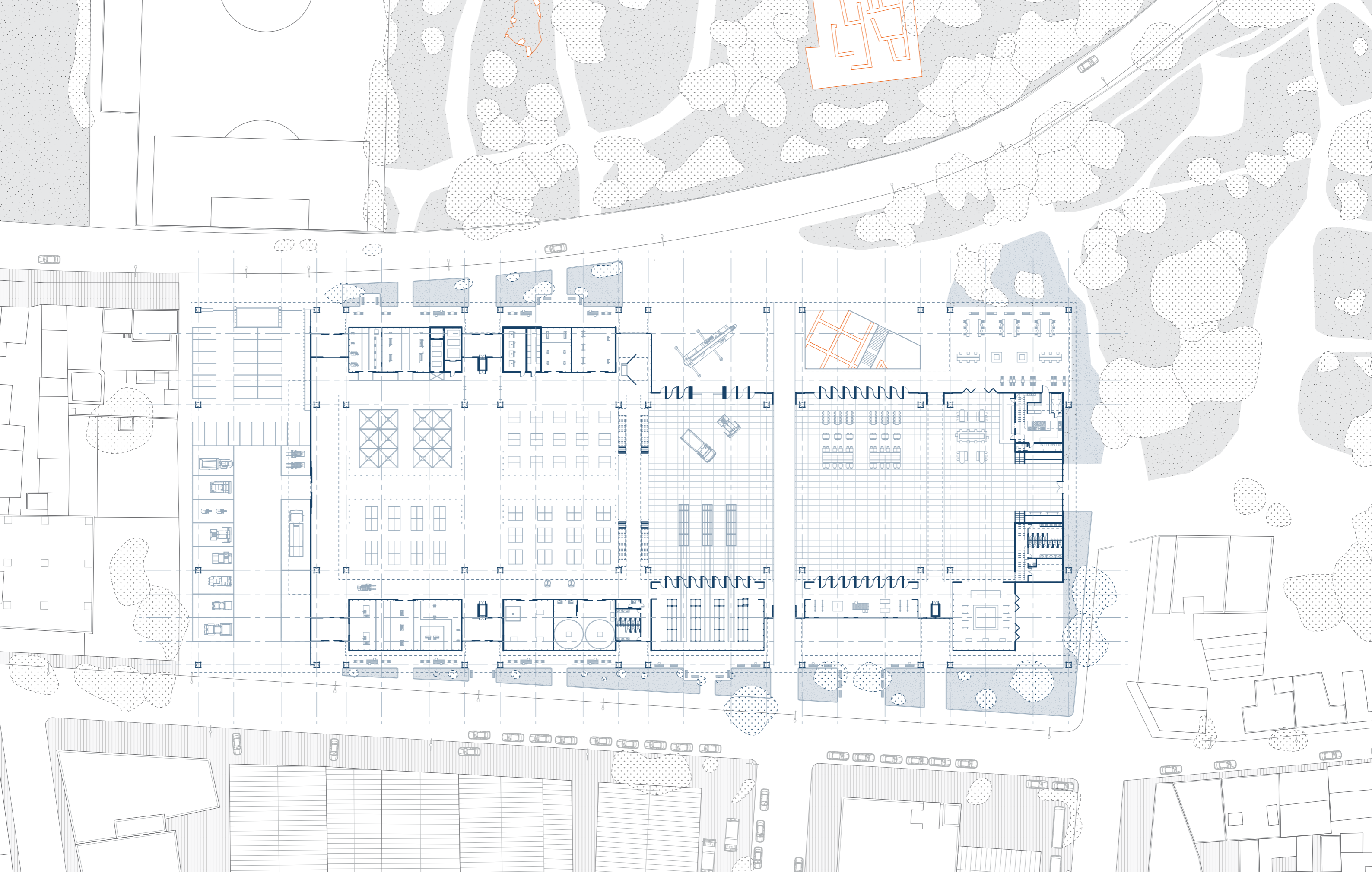

0 10 20m

Ground floor plan

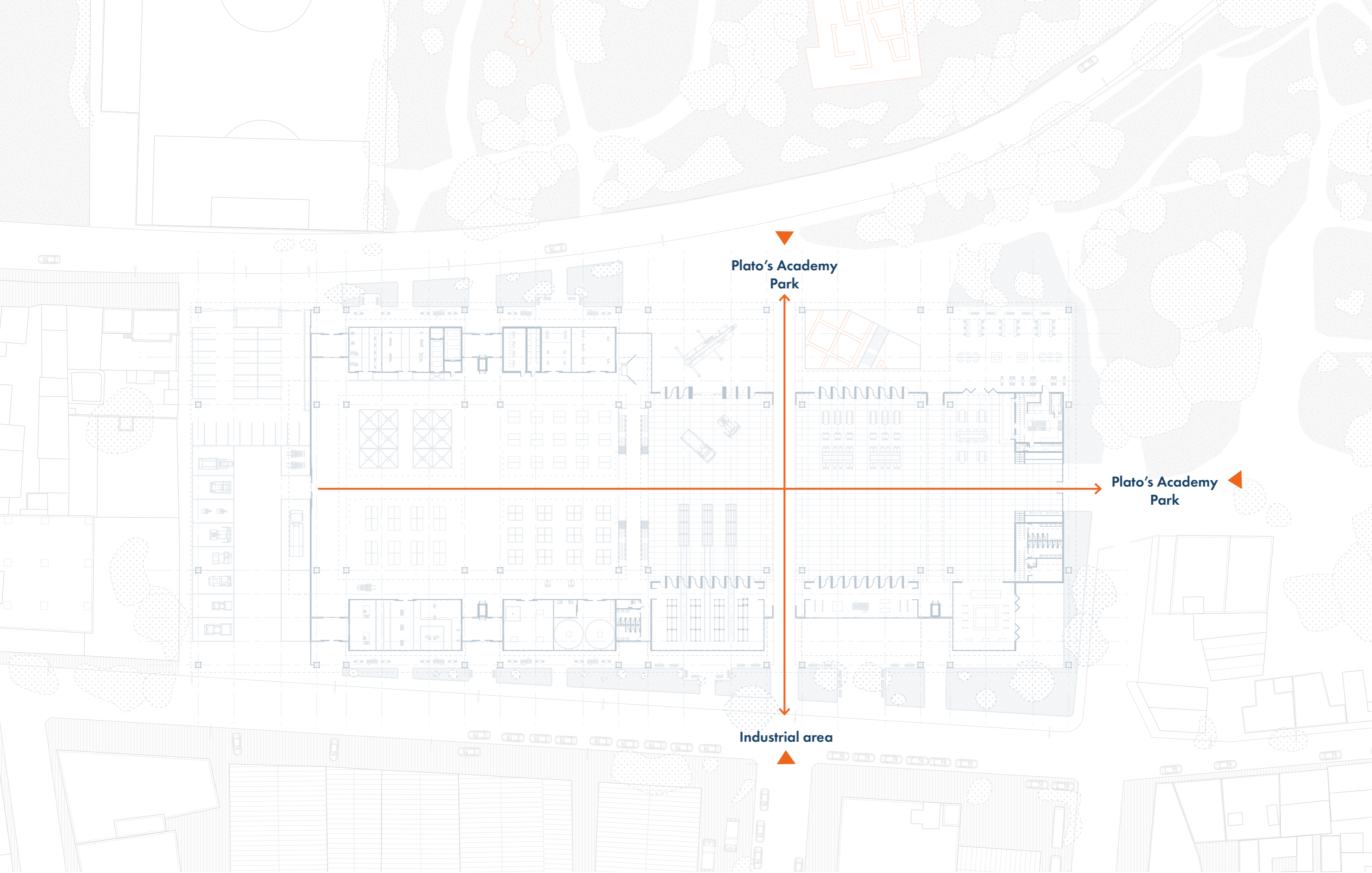

Plato's Academy
Park

Plato's Academy
Park

Industrial area



0 10 20m

Ground floor plan

Zone 1
Industrial
interface

Zone 2&3
The fabrication
Core

Zone 4
The depot &
staging street

Zone 5
The Archaeological
Threshold

Zone 6
The Civic Park
Interface

Plato's Academy
Park

Plato's Academy
Park

Industrial area

Private

Public



Ground floor plan

Zone 5
The Archaeological
Threshold

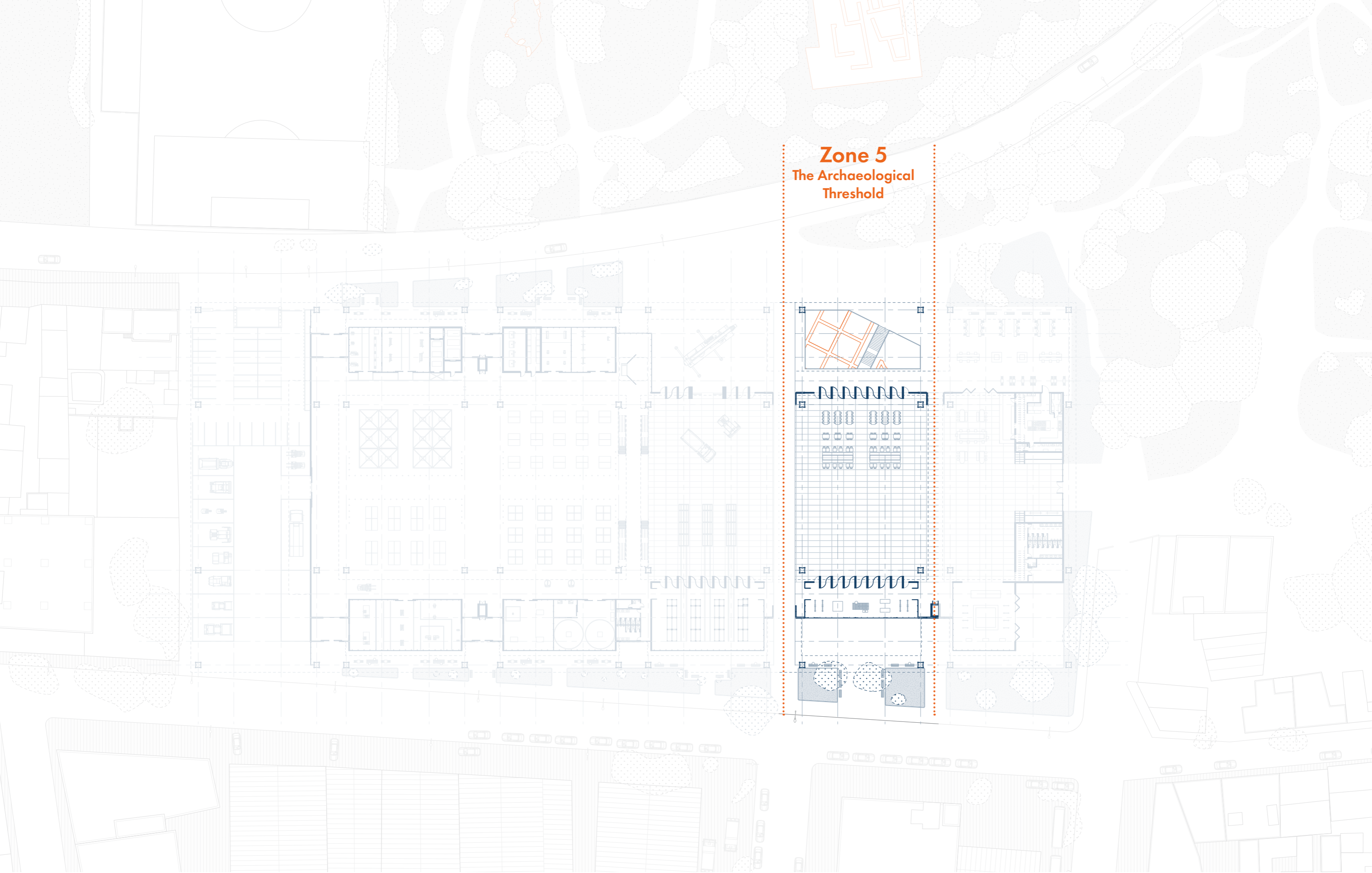

0 10 20m

Ground floor plan

Zone 5
The Archaeological
Threshold

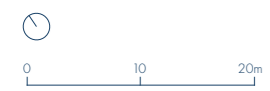
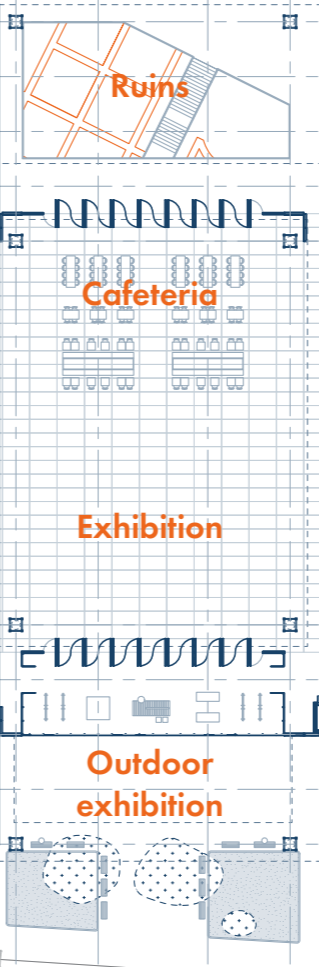

Ground floor plan

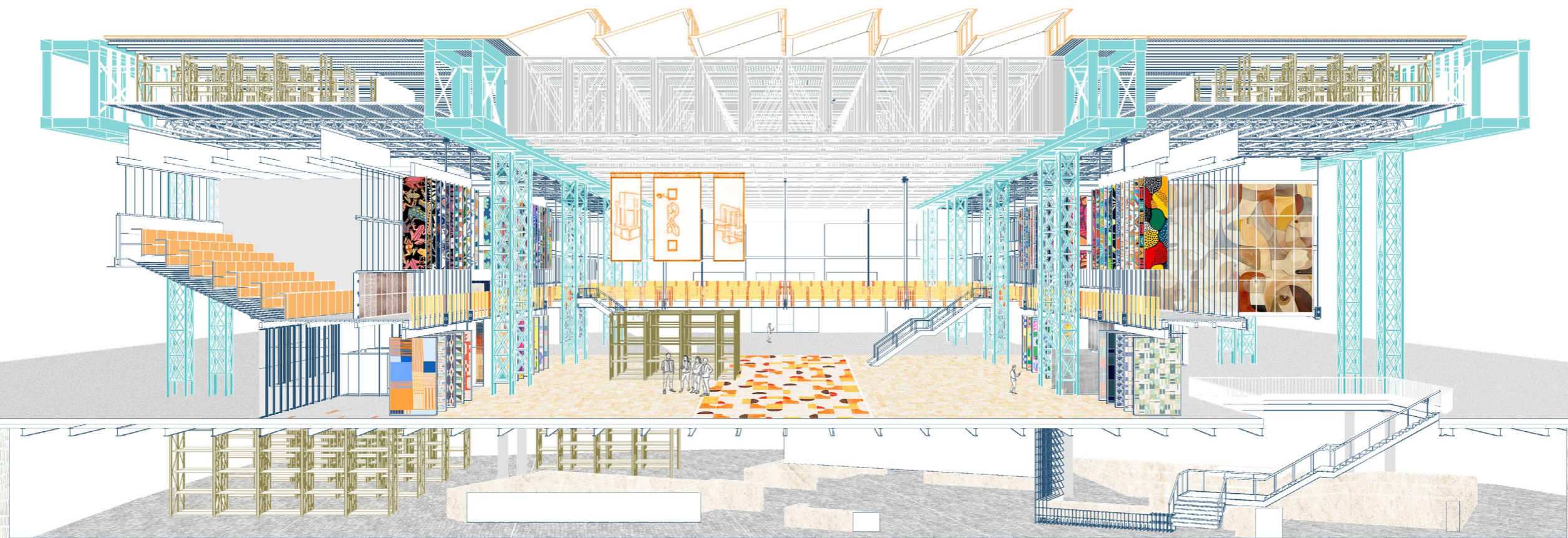

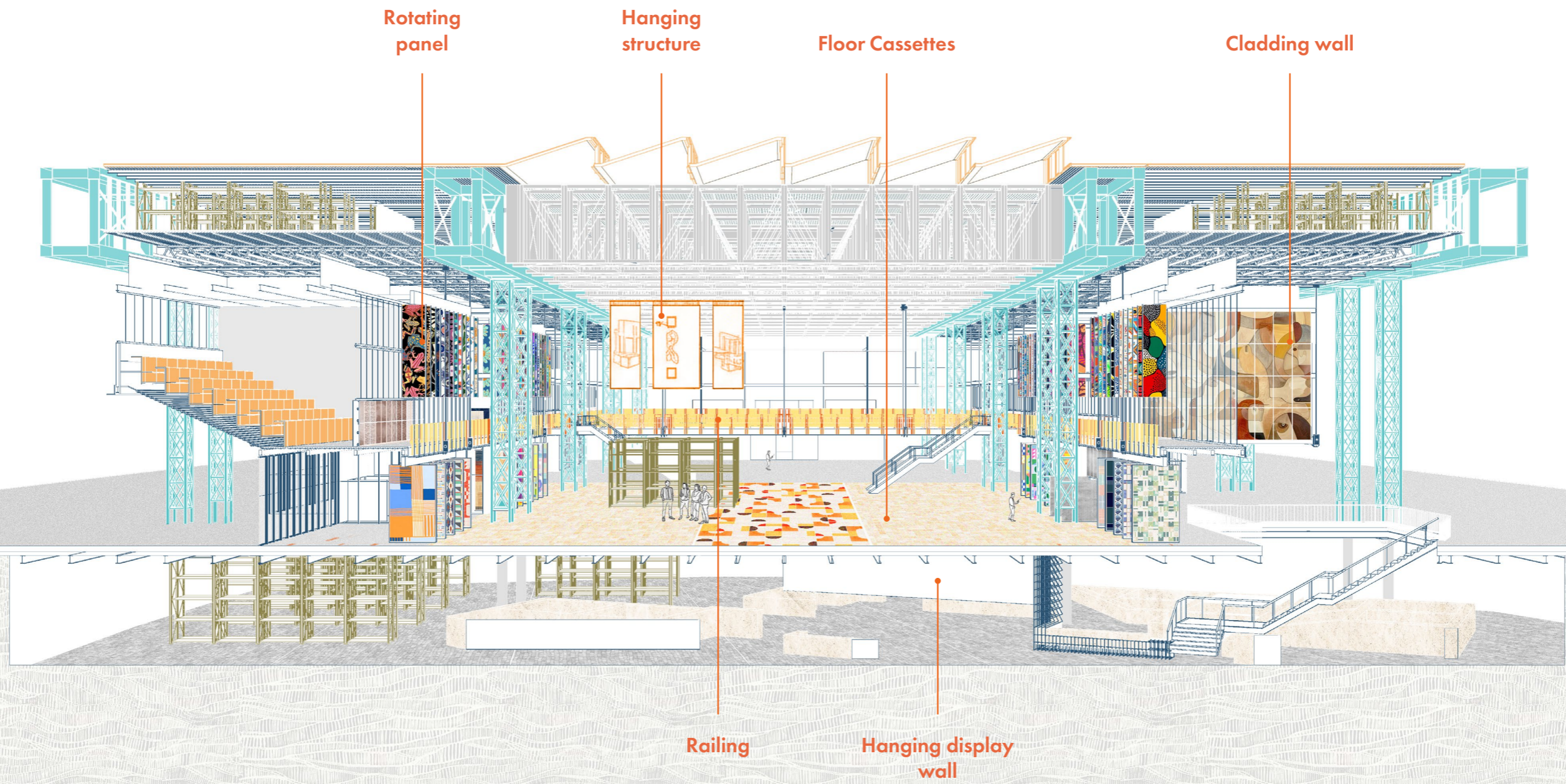

Zone 4
The depot & staging street

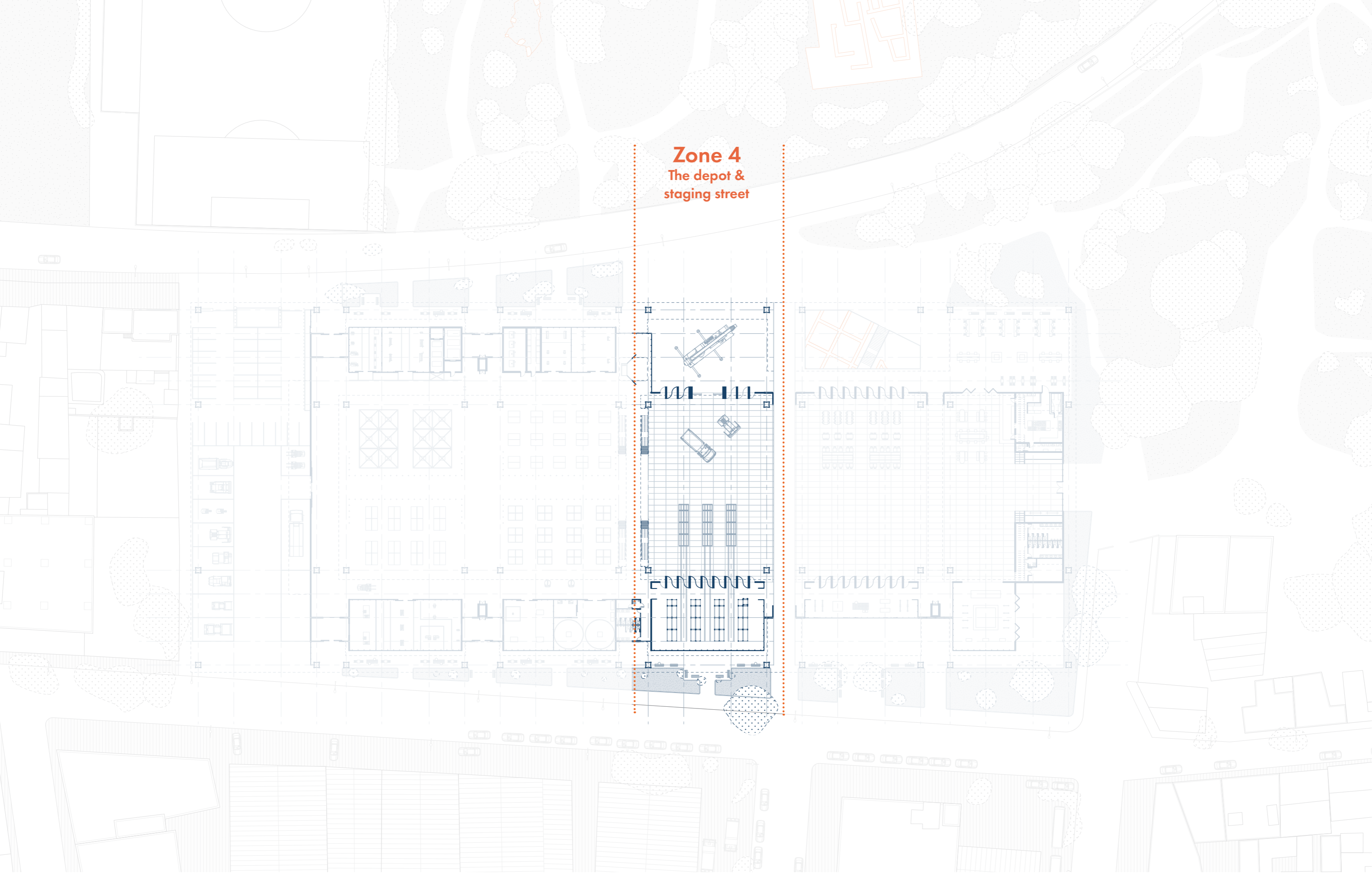

Ground floor plan

Zone 4

The depot & staging street

Outdoor staging

Indoor staging

Depot



Ground floor plan

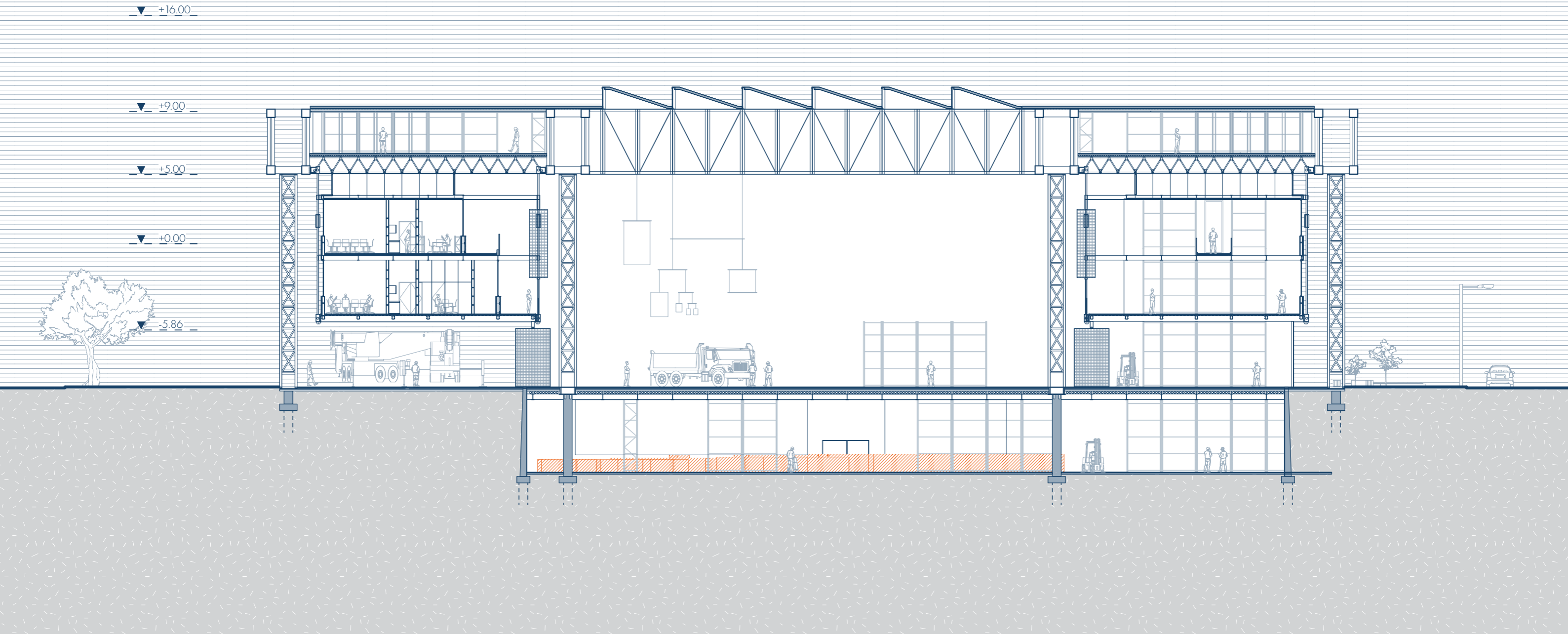
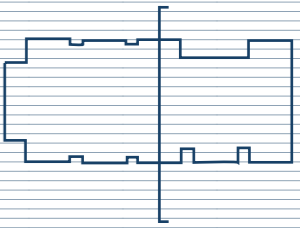

0 5 10m

Section B

Zone 4
The depot & staging street

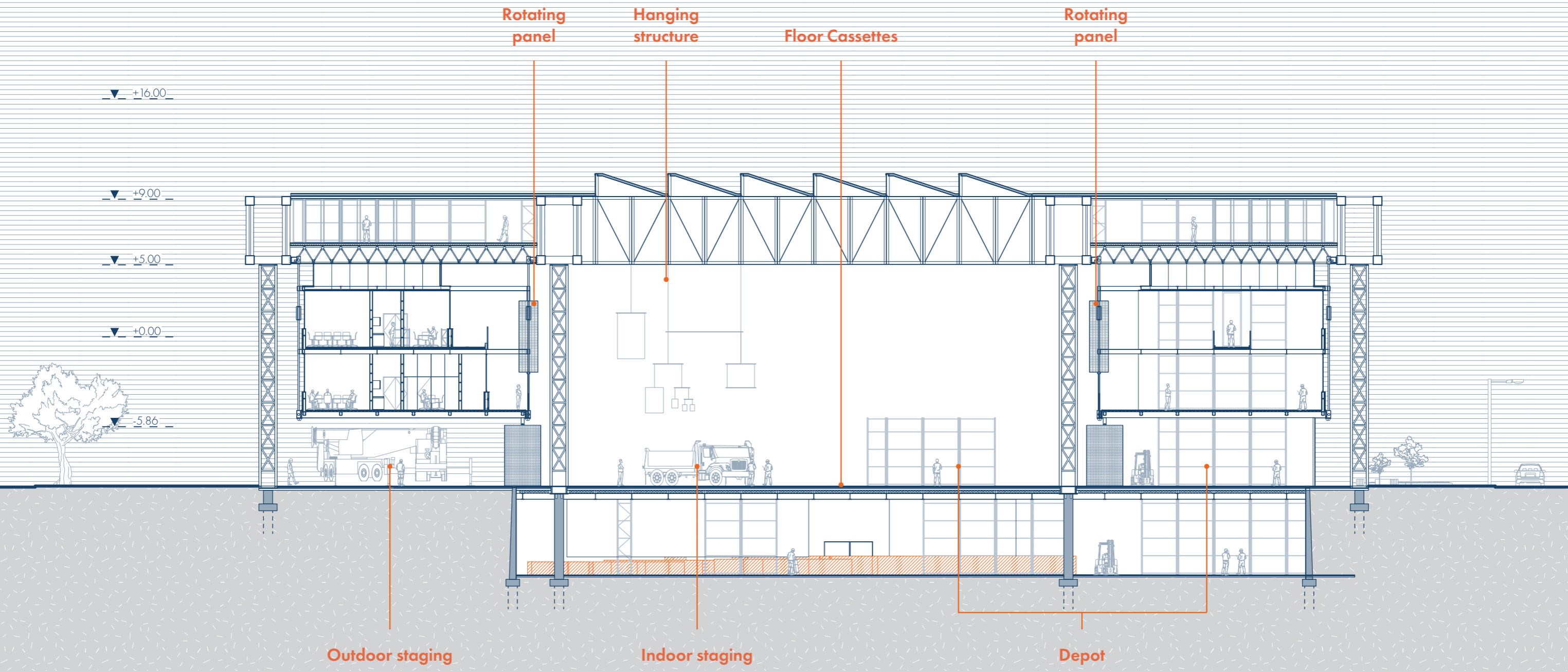
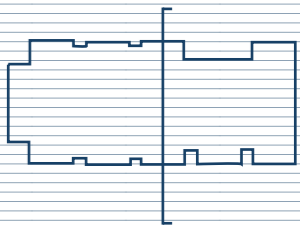

Section B

Zone 4
The depot & staging street

Zone 2&3
The fabrication Core

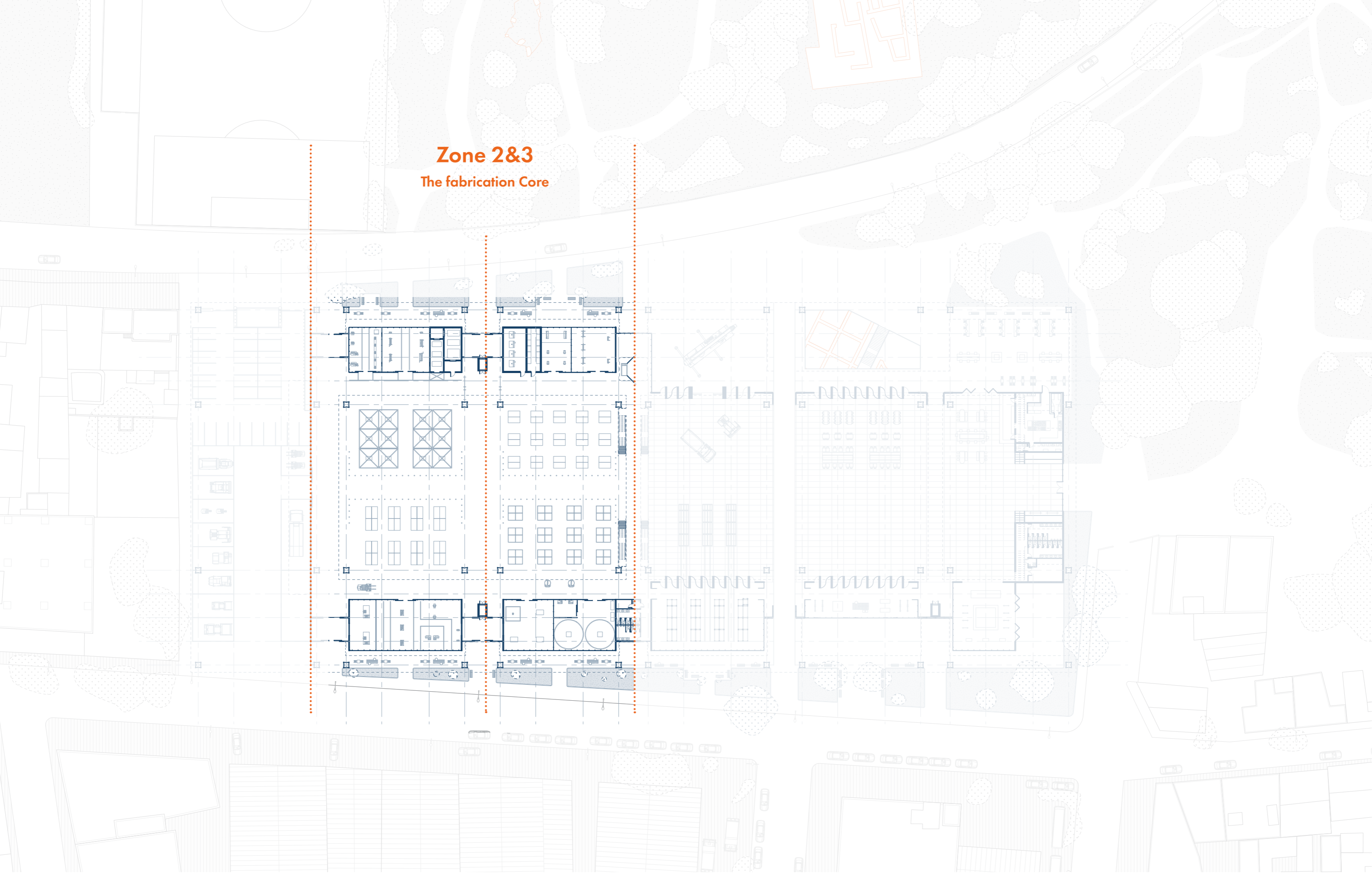

0 10 20m

Ground floor plan

Zone 2&3
The fabrication Core

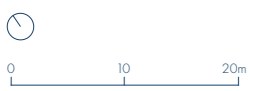
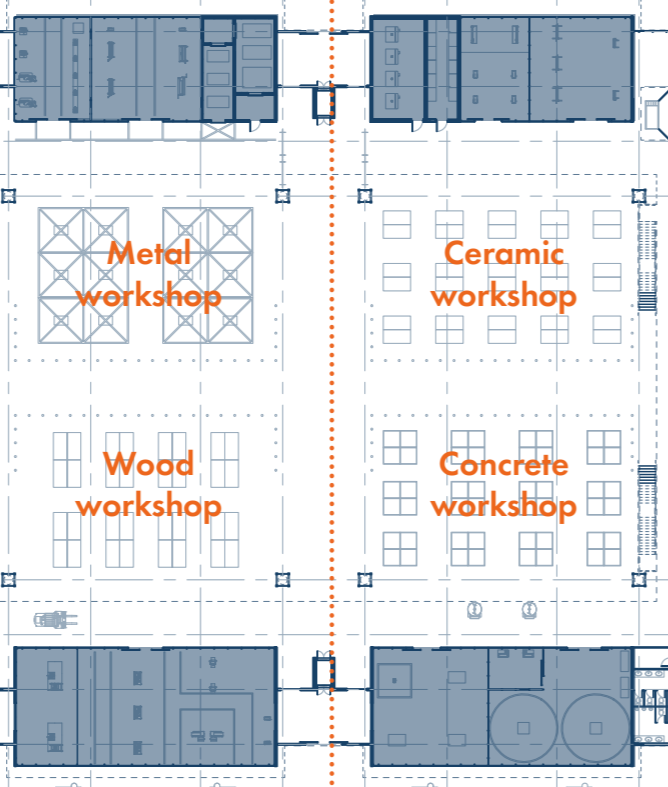

Ground floor plan

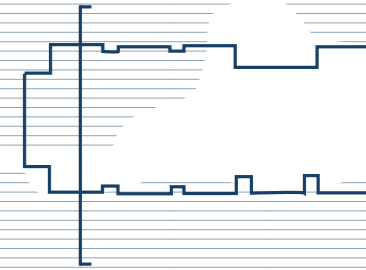

▼ +16.00

▼ +9.00

▼ +5.00

▼ +0.00

▼ -5.86

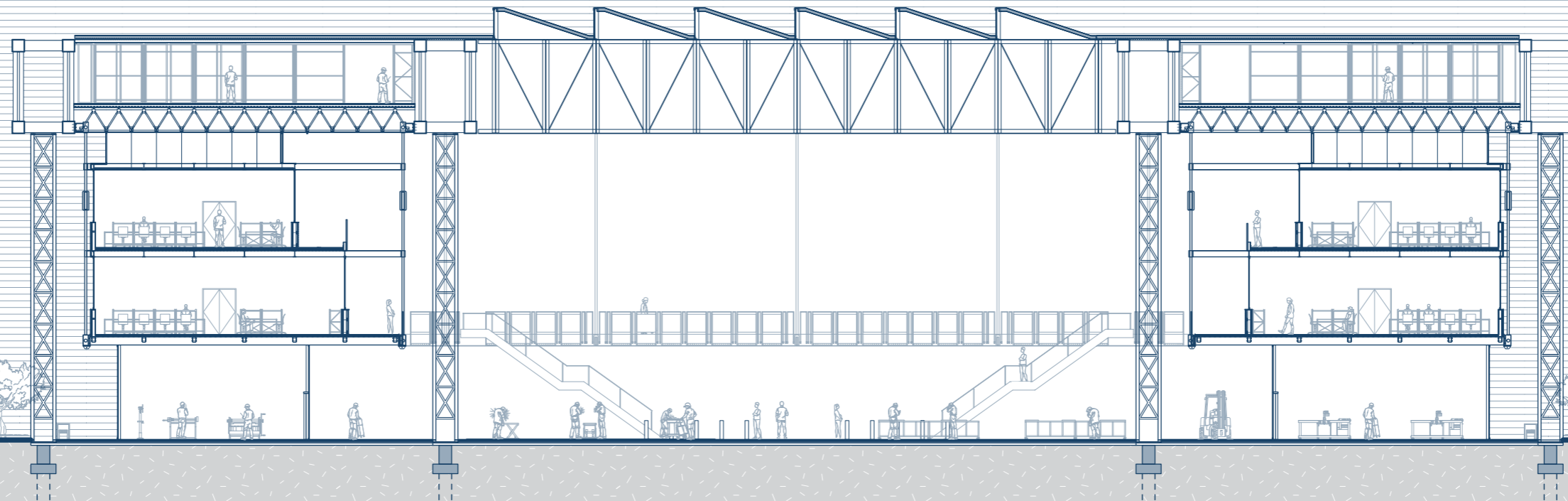

0 5 10m

Section C

Zone 2 & 3
The fabrication Core

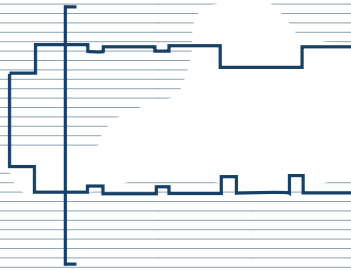

▼ +16.00

▼ +9.00

▼ +5.00

▼ +0.00

▼ -5.86

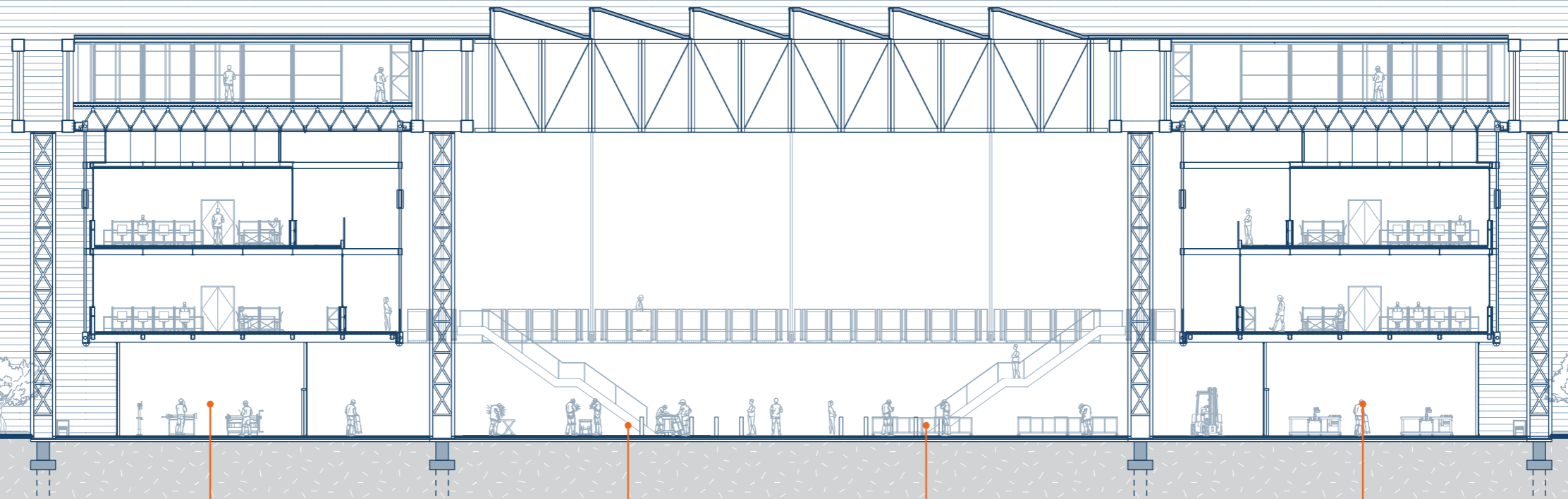

Enclosed Machine Cores

Metal workshop

Wood workshop

Enclosed Machine Cores

0 5 10m

Section C

Zone 2 & 3
The fabrication Core

Leaving the Lab: Deploying Craft to the Streets

Conclusion

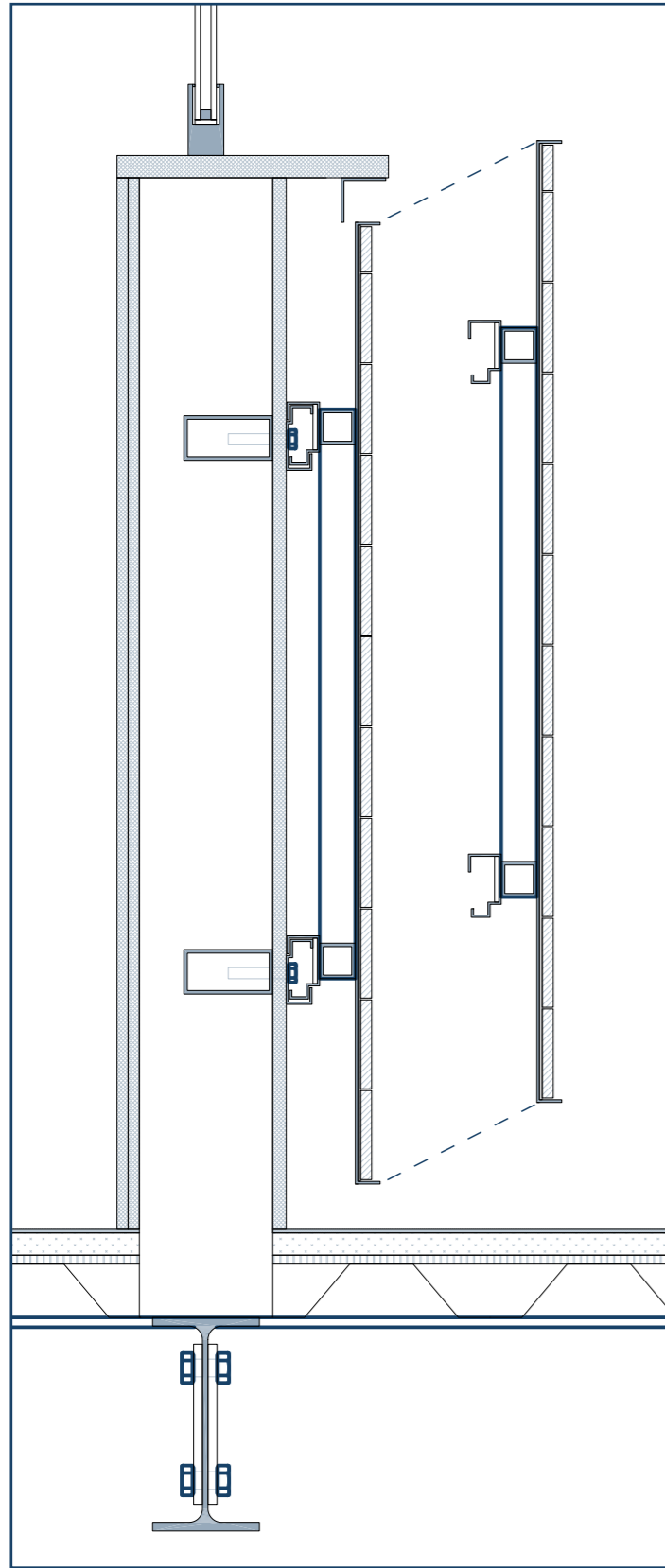

**Rainscreen Cladding
Bracket System**

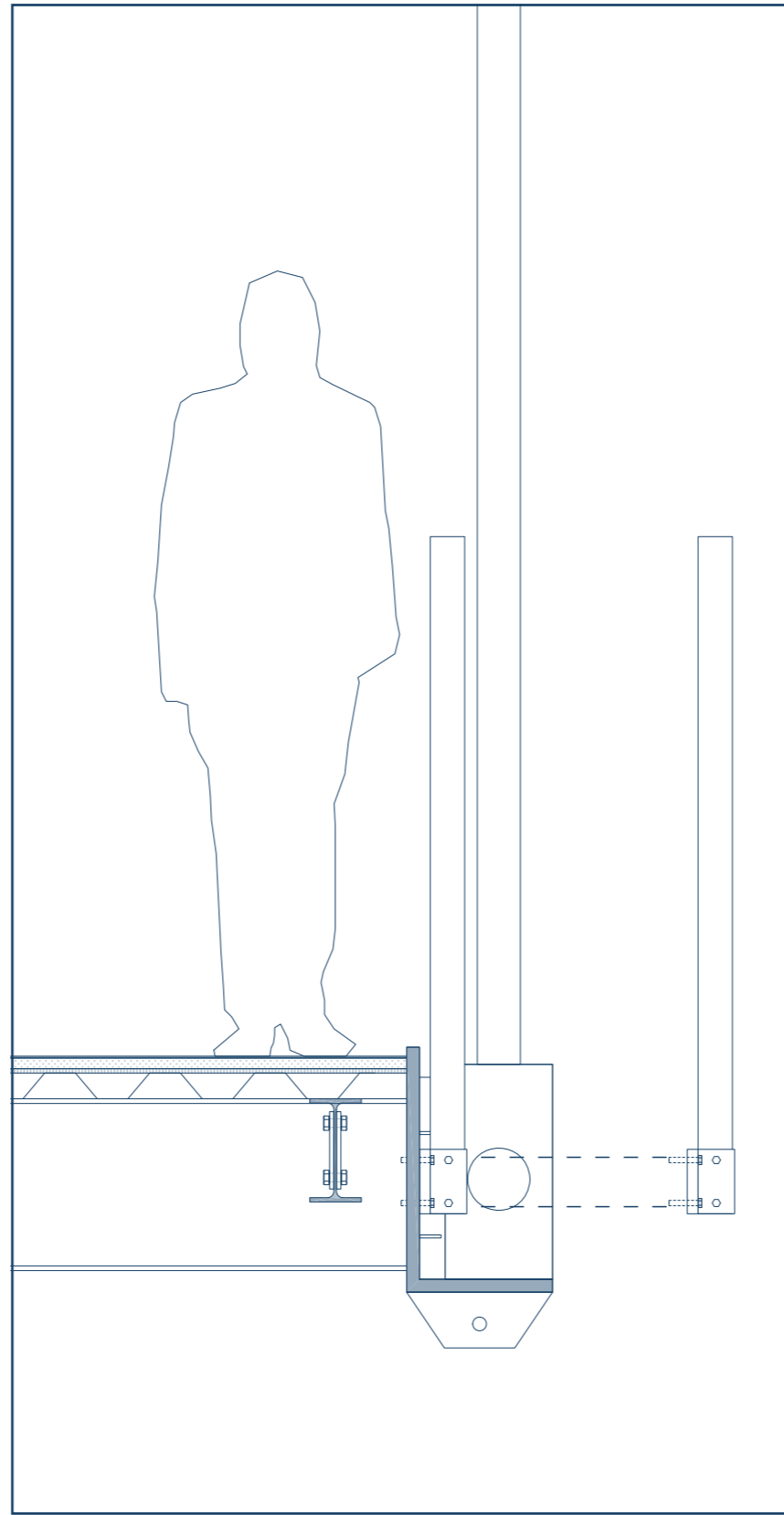

Dry-Demountable Modular Railing

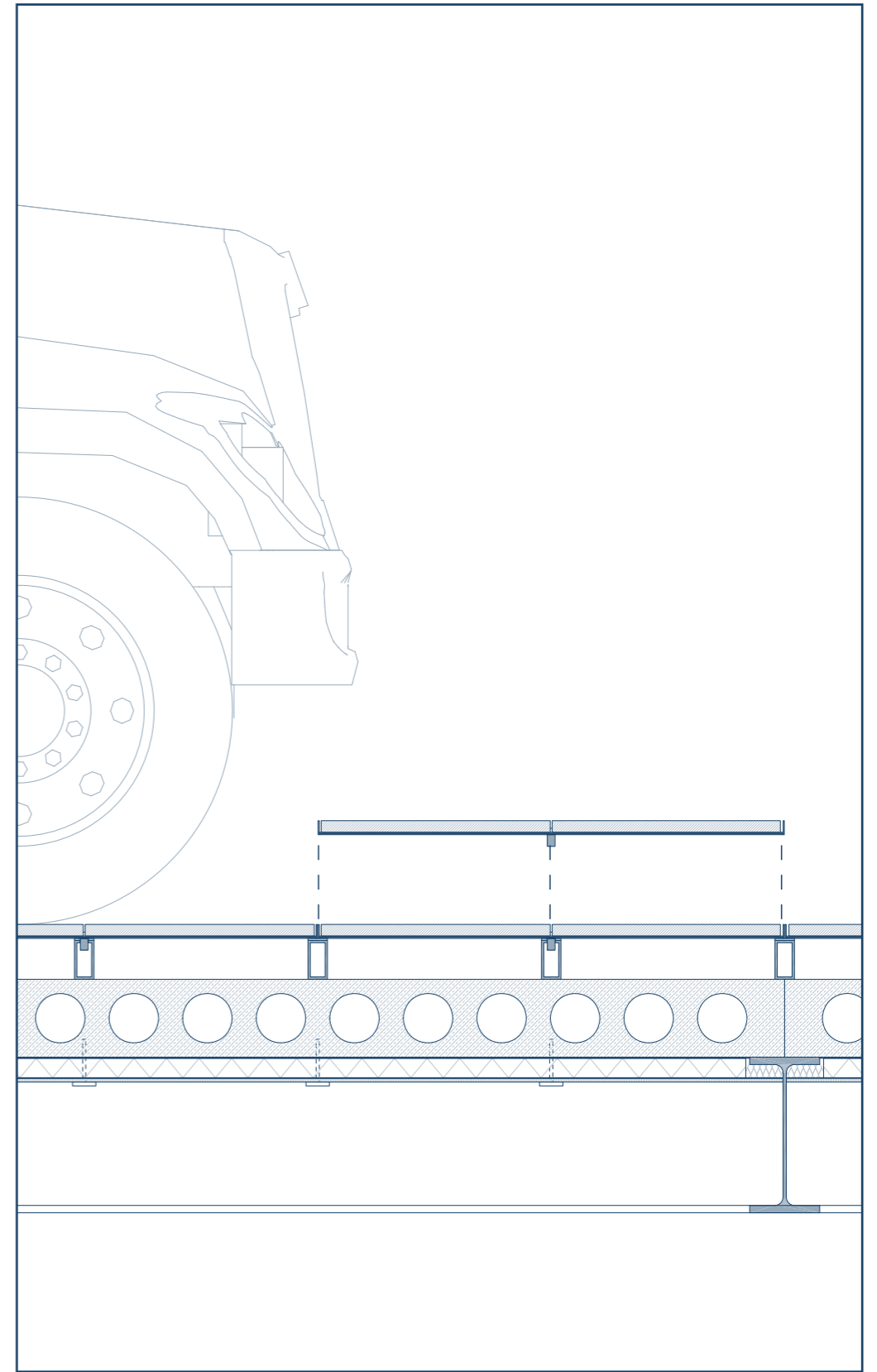

Heavy-Duty Vehicle Plenum Access Floor System



END